



Chevron U.S.A. Inc.

2410 Camino Ramon, San Ramon, California • Phone (510) 842-9500
Mail Address: P.O. Box 5004, San Ramon, CA 94583-0804

Marketing Department

December 5, 1991

Mr. Dennis Byrne
Alameda County Health Care Services
80 Swan Way, Room 200
Oakland, CA 94621

**Re: Chevron Service Station #9-4587
609 Oak Street, Oakland**

Dear Mr. Byrne:

Enclosed we are forwarding the Quarterly Ground Water Monitoring Report dated November 21, 1991, prepared by our consultant Alton Geoscience for the above referenced site. As indicated in the report, groundwater samples collected were analyzed for total petroleum hydrocarbons as gasoline and BTEX. Benzene was detected in monitor wells C-2, C-5, CR-1 and tank pit backfill well A at concentrations of 3700, 1.1, and 9400 ppb, respectively. Separate phase hydrocarbons were observed in monitor well C-1 and tank pit backfill wells B and C at measured thicknesses of 0.01-feet. Approximately 2.06 gallons of separate phase hydrocarbons were removed during this quarter. Purging of the phase separated hydrocarbons will continue until a dedicated recovery system can be installed.

As mentioned in my letter to you dated September 5, 1991, I am still pending a decision regarding the disposition of the tank system. However, I do expect to hear a decision soon. Chevron will continue to examine all monitor wells for the presence of separate phase hydrocarbons on a monthly basis and perform quarterly chemical analysis. Monitor wells which exhibit separate phase hydrocarbons are bailed during this inspection. *only monthly?*

If you have any questions or comments, please do not hesitate to contact me at (510) 842-9581.

Very truly yours,
CHEVRON U.S.A. INC.

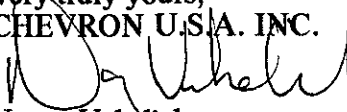

Nancy Vukelich
Environmental Engineer

Enclosure

cc: Mr. Eddy So, RWQCB
Mr. S.A. Willer
File (9-4587Q2)

November 21, 1991

Ms. Nancy Vukelich
Chevron U.S.A., Inc.
Post Office Box 5004
San Ramon, California 94583-0804

310-564

Subject: Quarterly Ground Water Monitoring Report
Chevron Station No. 9-4587
609 Oak Street
Oakland, California

Dear Ms. Vukelich:

In accordance with our agreement, Alton Geoscience transmits this Quarterly Ground Water Monitoring and Sampling Report for Chevron Station No. 9-4587, located at 609 Oak Street, Oakland, California. Figure 1 shows the site location.

Monitoring and sampling of the ground water monitoring wells was performed on October 7, 1991, in accordance with the requirements and procedures of the California Regional Water Quality Control Board (RWQCB) and local regulatory agencies.

FIELD PROCEDURES

Prior to purging and sampling the wells, each well was checked for liquid-phase hydrocarbons or sheen. The depth to ground water and, if present, free product was measured in each well from the top of casing using an electronic interface probe with 0.01 foot tolerance.

Ground water samples were collected after more than 3 casing volumes of ground water was purged from each well. Each sample was collected using a clean bailer. Ground water samples were then decanted into the appropriate clean sample containers for delivery to a California-certified laboratory following proper preservation and chain of custody procedures. Purged ground water was stored onsite in DOT-approved, 55-gallon drums pending removal by Erickson Inc., a licensed hauler. The purged ground water was transported as non-hazardous to Gibson Oil/ Pilot Petroleum of Redwood City, California for recycling.

Ms. Nancy Vukelich
November 21, 1991
Page 2

310-564

SAMPLING AND ANALYTICAL RESULTS

The results of the monitoring and laboratory analyses of ground water samples for this quarter, as well as the results of previous monitoring and sampling events, are summarized in Table 1. Based on the previous wellhead elevation survey data and depth to water measurements collected during this monitoring event, ground water elevations and the general ground water gradient direction at this site are presented in Figure 2.

Free product was noted in monitoring wells C-1, C-B, and C-C and was subsequently removed by manual methods. Approximately 2.03 gallons of free product, in total, was removed from the three wells on September 20, 1991, and approximately 0.03 gallons of free product was removed from the three wells on October 7, 1991. The official laboratory reports and chain of custody records are included in Appendix A.

Please call John De George at (510) 682-1582 if you have any questions regarding this report.

Sincerely,

ALTON GEOSCIENCE,

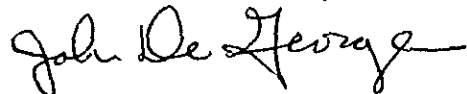

John De George
Staff Geologist

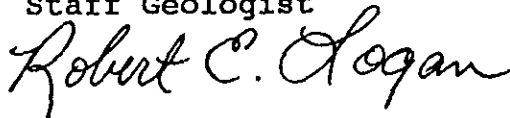

Robert E. Logan R. G. 5088
Manager, Concord Operations

wp94587jd

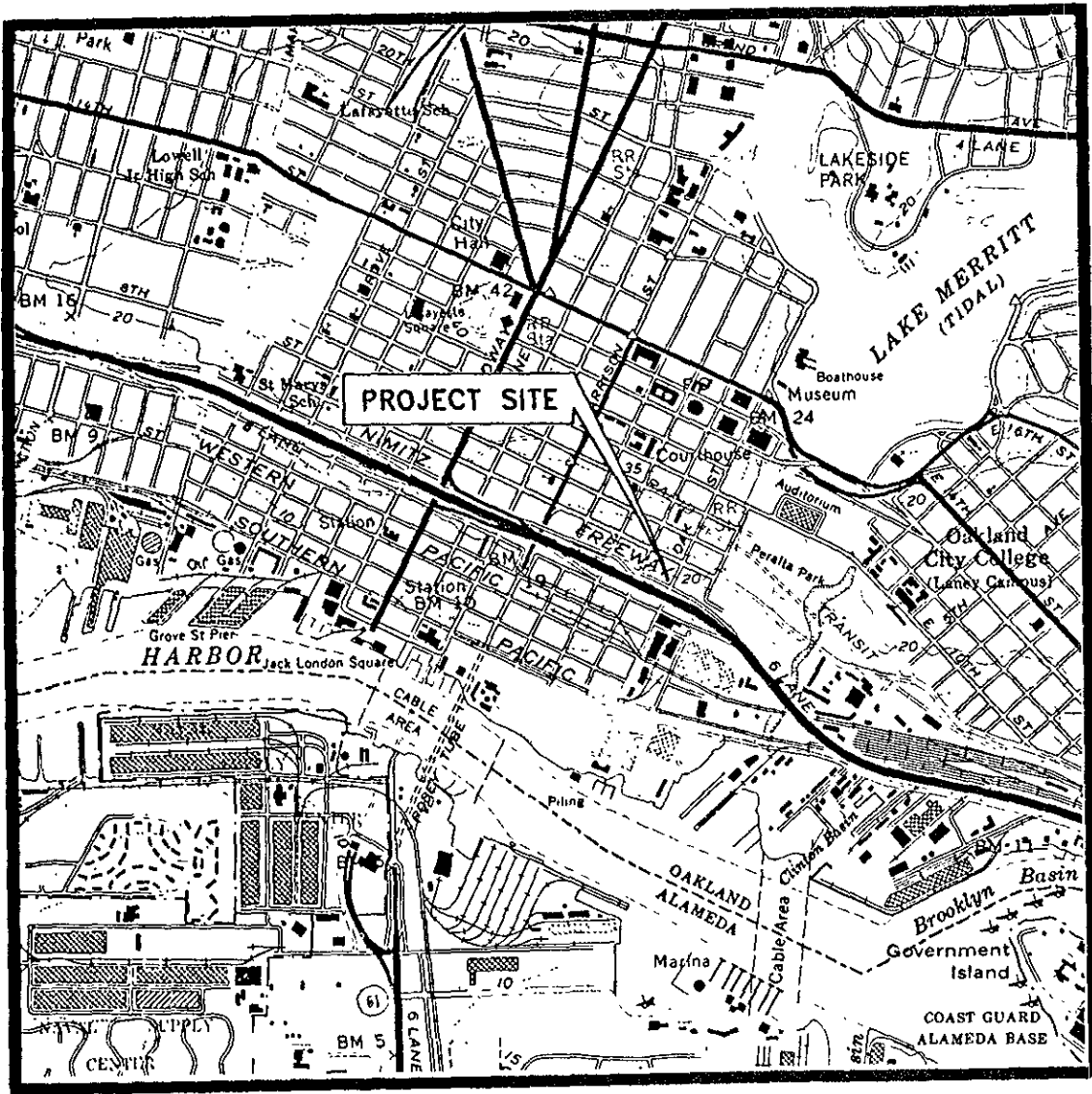

FIGURE 1: SITE VICINITY MAP

CHEVRON SERVICE STATION
 NUMBER 9-4587
 609 OAK STREET
 OAKLAND, CALIFORNIA

SOURCE: U.S.G.S. OAKLAND WEST
 QUADRANGLE, CALIFORNIA,
 7.5 MINUTE SERIES (TOPOGRAPHIC)



PROJECT NO. 310-564

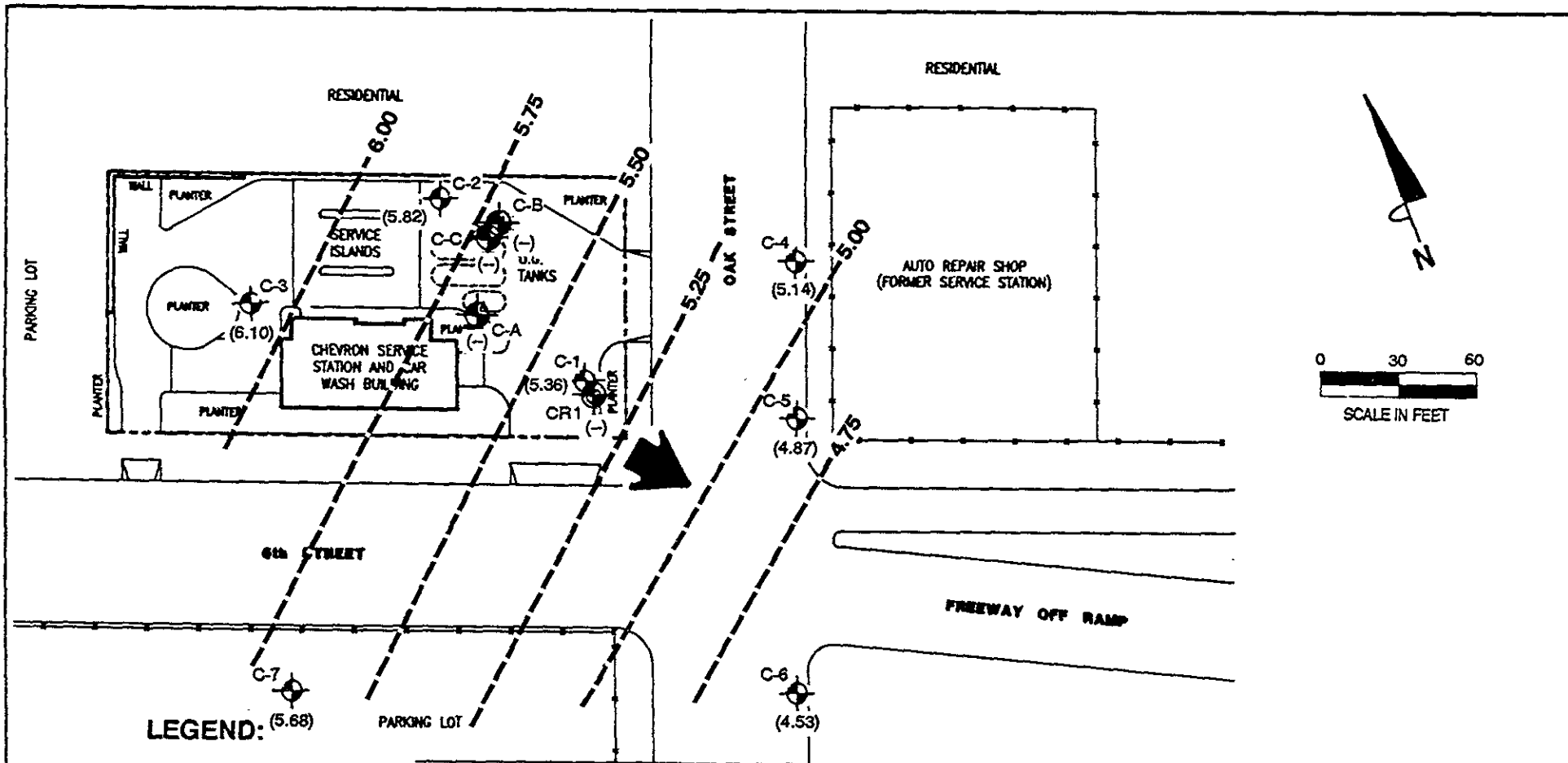

ALTON GEOSCIENCE
 1000 Burnett Ave. Ste. 140
 Concord, California



LEGEND:

-  GROUND WATER MONITORING WELL
- (5.36) GROUND WATER ELEVATION
(FEET ABOVE MEAN SEA LEVEL [NGVD-1929])
- (-) REFERENCE ELEVATIONS NOT AVAILABLE FOR CALCULATING GROUND WATER ELEVATIONS
-  GENERAL GROUND WATER GRADIENT DIRECTION

NOTE:

1. CONTOUR LINES ARE INTERPRETIVE BASED ON FLUID LEVELS IN MONITORING WELLS MEASURED ON 10/7/91.

FIGURE 2.
GROUND WATER ELEVATION CONTOUR MAP

CHEVRON SERVICE STATION
NUMBER 9-4587
609 OAK STREET
OAKLAND, CALIFORNIA



ALTON GEOSCIENCE
1000 Burnett Ave. Ste. 140
Concord, California

Table 1
 Summary of Results of Ground Water Sampling
 Chevron Station No. 9-4587
 609 Oak Street, Oakland, California

Concentrations in parts per billion (ppb)

WELL ID	DATE OF SAMPLING/ MONITORING	TOP OF WELL BOX ELEVATION	DEPTH TO WATER	FREE PRODUCT THICKNESS	FREE PRODUCT BAILED (GALLONS)	GROUND WATER ELEVATION	TPH-G	B	T	E	X	LAB
C-A	12/06/89	---	---	0.00	0.00	---	44000	20000	66	1600	2220	NA
C-A	10/30/90	---	11.20	SHEEN	0.00	---	31000	23000	110	1100	160	SAL
C-AD	10/30/90	---	11.20	SHEEN	0.00	---	30000	23000	150	1000	180	SAL
C-A	01/14/91	---	11.25	0.00	0.00	---	12000	30000	540	1400	560	SAL
C-A	04/03/91	---	9.82	0.00	0.00	---	59000	33000	2400	2200	3100	SAL
C-A	07/17/91	---	10.93	0.00	0.00	---	52000	38000	380	1300	500	SAL
C-A***	10/07/91	---	---	---	---	---	---	---	---	---	---	NA
C-B	12/06/89	---	---	0.01	---	---	---	---	---	---	---	NA
C-B	10/30/90	---	11.19	0.01	---	---	---	---	---	---	---	NA
C-B	01/14/91	---	11.40	0.01	---	---	---	---	---	---	---	NA
C-B	04/03/91	---	9.55	1.00	---	---	---	---	---	---	---	NA
C-B	04/04/91	---	10.54	1.06	0.75	---	---	---	---	---	---	NA
C-B	07/17/91	---	10.84	0.03	---	---	---	---	---	---	---	NA
C-B	10/07/91	---	11.10	0.04	0.01	---	---	---	---	---	---	NA
C-C	12/06/89	---	---	0.15	---	---	---	---	---	---	---	NA
C-C	10/30/90	---	10.84	0.03	---	---	---	---	---	---	---	NA
C-C	01/14/91	---	11.01	0.11	---	---	---	---	---	---	---	NA
C-C	04/03/91	---	9.19	0.02	---	---	---	---	---	---	---	NA
C-C	07/17/91	---	10.53	0.03	---	---	---	---	---	---	---	NA
C-C	10/07/91	---	10.98	0.08	0.01	---	---	---	---	---	---	NA
C-1	12/06/89	16.07	---	0.20	---	---	---	---	---	---	---	NA
C-1	10/30/90	16.07	10.79	0.02	---	5.30	---	---	---	---	---	NA
C-1	01/14/91	16.07	11.39	0.02	---	4.70	---	---	---	---	---	NA
C-1	04/03/91	16.07	9.43	0.02	---	6.66	---	---	---	---	---	NA
C-1	07/17/91	16.07	10.46	0.04	---	5.64	---	---	---	---	---	NA
C-1	10/07/91	16.07	10.74	0.04	0.01	5.36	---	---	---	---	---	NA
C-2	12/06/89	16.84	---	0.00	0.00	---	16000	250	1200	550	1400	NA
C-2	10/30/90	16.84	11.16	0.00	0.00	5.68	28000	3700	1900	1200	4300	SAL
C-2	01/14/91	16.84	11.11	0.00	0.00	5.73	24000	3300	1200	1100	4100	SAL
C-2D	01/14/91	16.84	11.11	0.00	0.00	5.73	30000	3900	1500	1500	5000	SAL
C-2	04/03/91	16.84	9.53	0.00	0.00	7.31	12000	1100	840	650	1800	SAL
C-2D	04/03/91	16.84	9.53	0.00	0.00	7.31	14000	1100	990	680	1800	SAL
C-2	07/17/91	16.84	10.68	0.00	0.00	6.16	13000	1700	560	650	1700	SAL
C-2D	07/17/91	16.84	10.68	0.00	0.00	6.16	14000	1700	640	720	1900	SAL
C-2	10/07/91	16.84	11.02	0.00	0.00	5.82	25000	3700	1300	1400	3800	SAL

Table 1
 Summary of Results of Ground Water Sampling
 Chevron Station No. 9-4587
 609 Oak Street, Oakland, California

Concentrations in parts per billion (ppb)

WELL ID	DATE OF SAMPLING/ MONITORING	TOP OF WELL BOX ELEVATION	DEPTH TO WATER	FREE PRODUCT THICKNESS	FREE PRODUCT BAILED (GALLONS)	GROUND WATER ELEVATION	TPH-G	B	T	E	X	LAB
C-3	12/06/89	16.48	---	0.00	0.00	---	ND<500	ND<0.5	ND<0.5	ND<0.5	0.74	NA
C-3	10/30/90	16.48	10.44	0.00	0.00	6.04	410	4	4	2	9	SAL
C-3	01/14/91	16.48	10.34	0.00	0.00	6.14	80	ND<0.5	ND<0.5	ND<0.5	1	SAL
C-3	04/03/91	16.48	9.01	0.00	0.00	7.47	53	ND<0.5	ND<0.5	ND<0.5	2	SAL
C-3	07/17/91	16.48	10.00	0.00	0.00	6.48	ND<50	5.9	ND<0.5	ND<0.5	ND<0.5	SAL
C-3	10/07/91	16.48	10.38	0.00	0.00	6.10	ND<50	ND<0.5	ND<0.5	ND<0.5	ND<0.5	SAL
C-4	12/06/89	16.53	---	0.00	0.00	---	---	---	---	---	---	NA
C-4	10/30/90	16.53	11.56	0.00	0.00	4.97	ND<50	ND<0.5	ND<0.5	ND<0.5	ND<0.5	SAL
C-4	01/14/91	16.53	11.44	0.00	0.00	5.09	ND<50	ND<0.5	ND<0.5	ND<0.5	ND<0.5	SAL
C-4	04/03/91	16.53	10.00	0.00	0.00	6.53	150	3	ND<0.5	12	9	SAL
C-4	07/17/91	16.53	11.16	0.00	0.00	5.37	290	2.3	0.4	52	0.4	SAL
C-4	10/07/91	16.53	11.39	0.00	0.00	5.14	ND<50	ND<0.5	ND<0.5	4.6	ND<0.5	SAL
C-5	12/06/89	14.70	9.97	0.00	0.00	4.73	---	---	---	---	---	NA
C-5	10/30/90	14.70	---	0.00	0.00	---	ND<50	0.8	ND<0.5	ND<0.5	0.5	SAL
C-5	01/14/91	14.70	9.87	0.00	0.00	4.83	54	ND<0.5	ND<0.5	ND<0.5	ND<0.5	SAL
C-5	04/03/91	14.70	8.72	0.00	0.00	5.98	1800	330	200	52	170	SAL
C-5	07/17/91	14.70	9.63	0.00	0.00	5.07	170	120	5.3	12	20	SAL
C-5	10/07/91	14.70	9.83	0.00	0.00	4.87	ND<50	1.1	ND<0.5	ND<0.5	ND<0.5	SAL
C-6	12/06/89	13.87	---	0.00	0.00	---	---	---	---	---	---	NA
C-6	10/30/90	13.87	9.43	0.00	0.00	4.44	ND<50	ND<0.5	ND<0.5	ND<0.5	ND<0.5	SAL
C-6	01/14/91	13.87	9.41	0.00	0.00	4.46	ND<0.5	ND<0.5	ND<0.5	ND<0.5	ND<0.5	SAL
C-6	04/03/91	13.87	8.66	0.00	0.00	5.21	ND<0.5	ND<0.5	ND<0.5	ND<0.5	ND<0.5	SAL
C-6	07/17/91	13.87	9.25	0.00	0.00	4.62	ND<0.5	ND<0.5	ND<0.5	ND<0.5	ND<0.5	SAL
C-6	10/07/91	13.87	9.34	0.00	0.00	4.53	67	ND<0.5	0.6	ND<0.5	0.6	SAL
C-7	02/07/91	15.78	9.88	0.00	0.00	5.90	ND<50	ND<0.5	0.8	ND<0.5	ND<0.5	SAL
C-7	04/03/91	15.78	9.04	0.00	0.00	6.74	ND<50	ND<0.5	ND<0.5	ND<0.5	ND<0.5	SAL
C-7	07/17/91	15.78	9.86	0.00	0.00	5.92	ND<50	ND<0.5	ND<0.5	ND<0.5	ND<0.5	SAL
C-7	10/07/91	15.78	10.10	0.00	0.00	5.68	ND<50	ND<0.5	ND<0.5	ND<0.5	ND<0.5	SAL

Table 1
 Summary of Results of Ground Water Sampling
 Chevron Station No. 9-4587
 609 Oak Street, Oakland, California

Concentrations in parts per billion (ppb)

WELL ID	DATE OF SAMPLING/ MONITORING	TOP OF WELL BOX ELEVATION	DEPTH TO WATER	FREE PRODUCT THICKNESS	FREE PRODUCT BAILED (GALLONS)	GROUND WATER ELEVATION	TPH-G	B	T	E	X	LAB
CR-1**	10/30/90	---	10.51	---	---	---	9600	7100	65	610	190	SAL
CR-1	01/14/91	---	10.29	0.00	0.00	---	1500	3200	52	190	77	SAL
CR-1	07/17/91	---	10.19	0.00	0.00	---	15000	9300	220	680	530	SAL
CR-1	10/07/91	---	10.46	0.00	0.00	---	17000	7600	50	440	68	SAL
CR-1D	10/07/91	---	10.46	0.00	0.00	---	14000	9400	52	430	110	SAL
TB*	10/30/90	---	---	---	---	---	---	---	---	---	---	NA
TB	01/14/91	---	---	---	---	---	ND<50	ND<0.5	ND<0.5	ND<0.5	ND<0.5	SAL
TB	02/07/91	---	---	---	---	---	ND<50	ND<0.5	ND<0.5	ND<0.5	ND<0.5	SAL
TB	04/03/91	---	---	---	---	---	ND<50	ND<0.5	ND<0.5	ND<0.5	ND<0.5	SAL
TB	07/17/91	---	---	---	---	---	ND<50	ND<0.5	ND<0.5	ND<0.5	ND<0.5	SAL
TB	10/07/91	---	---	---	---	---	ND<50	ND<0.5	ND<0.5	ND<0.5	ND<0.5	SAL
RINSATE	10/30/90	---	---	---	---	---	ND<50	ND<0.5	0.6	ND<0.5	ND<0.5	SAL
RINSATE	10/07/91	---	---	---	---	---	ND<50	ND<0.5	0.5	ND<0.5	ND<0.5	SAL

EXPLANATION OF ABBREVIATIONS:

TPH-G :Total Petroleum Hydrocarbons as Gasoline (EPA method 8015 modified)

B :Benzene (EPA method 8020 or 8240)

T :Toluene (EPA method 8020 or 8240)

E :Ethylbenzene (EPA method 8020 or 8240)

X :Xylenes (EPA method 8020 or 8240)

--- :Not Analyzed/Not Measured

NA :Not Applicable/Not Available

ND :Not Detected

TB :Trip Blank

D :Duplicate

SAL :Superior Analytical Laboratory

* :TB on 10/30/90 was broken

*** :Unable to locate well.

Note :Top of well box and ground water elevations are expressed as feet above mean sea level (NGVD - 1229).

** :The following constituents were detected in one ground water sample collected from well CR-1 on October 30, 1990:

:1,2-Dichloroethane	-EPA Method 8240	60 ppb
:Di-n-octylphthalate	EPA Method 8270	13 ppb
:2-Methylnaphthalene	EPA Method 8270	10 ppb
:Naphthalene	- EPA Method 8270	47 ppb
:2,4-Dimethylphenol	-EPA Method 8270	16 ppb
:4-Nitrophenol	- EPA Method 8270	9 ppb
:Phenol	- EPA Method 8270	47 ppb
:Arsenic	- EPA Method 206.2	22 ppb
:Chromium	- EPA Method 200.7	15 ppb
:Copper	- EPA Method 200.7	8 ppb
:Lead	- EPA Method 239.2	61 ppb
:Mercury	- EPA Method 245.1	0.6 ppb
:Nickel	- EPA Method 200.7	20 ppb
:Zinc	- EPA Method 200.7	13 ppb

Summary of Results of Ground Water Monitoring
Chevron Station No. 9-4587
609 Oak Street, Oakland, California

Concentrations in parts per billion (ppb)

WELL ID	DATE OF MONITORING	TOP OF WELL BOX ELEVATION	DEPTH TO WATER	FREE PRODUCT THICKNESS	FREE PRODUCT BAILED (GALLONS)	GROUND WATER ELEVATION
C-A	12/06/89	---	---	0.00	0.00	---
C-A	10/30/90	---	11.20	SHEEN	0.00	---
C-A	12/06/90	---	11.27	0.00	0.00	---
C-A	12/13/90	---	11.25	0.00	0.00	---
C-A	12/20/90	---	11.20	0.00	0.00	---
C-A	12/27/90	---	11.15	0.00	0.00	---
C-A	01/03/91	---	11.16	0.00	0.00	---
C-A	01/10/91	---	11.09	0.00	0.00	---
C-A	01/14/91	---	11.25	0.00	0.00	---
C-A	01/17/91	---	11.04	0.00	0.00	---
C-A	01/24/91	---	11.14	0.00	0.00	---
C-A	01/31/91	---	11.18	0.00	0.00	---
C-A	02/07/91	---	10.90	0.00	0.00	---
C-A	02/14/91	---	10.80	0.00	0.00	---
C-A	02/21/91	---	10.92	0.00	0.00	---
C-A	02/28/91	---	10.82	0.00	0.00	---
C-A	03/07/91	---	10.32	SHEEN	0.00	---
C-A	03/14/91	---	10.26	0.00	0.00	---
C-A	03/21/91	---	10.27	0.00	0.00	---
C-A	03/28/91	---	9.90	0.00	0.00	---
C-A	04/03/91	---	9.82	0.00	0.00	---
C-A	04/04/91	---	9.58	0.00	0.00	---
C-A	04/11/91	---	9.87	0.00	0.00	---
C-A	04/18/91	---	10.02	0.00	0.00	---
C-A	04/25/91	---	10.06	0.00	0.00	---
C-A	05/02/91	---	10.28	0.00	0.00	---
C-A	05/09/91	---	10.30	0.00	0.00	---
C-A	05/16/91	---	10.44	0.00	0.00	---
C-A	05/23/91	---	10.58	0.00	0.00	---
C-A	05/30/91	---	10.64	0.00	0.00	---
C-A	06/06/91	---	10.65	0.00	0.00	---
C-A	06/13/91	---	10.77	0.00	0.00	---
C-A	07/17/91	---	10.93	0.00	0.00	---
C-A	09/20/91	---	---	---	---	---
C-A	10/07/91	---	---	---	---	---

Summary of Results of Ground Water Monitoring
Chevron Station No. 9-4587
609 Oak Street, Oakland, California

Concentrations in parts per billion (ppb)

WELL ID	DATE OF MONITORING	TOP OF WELL BOX ELEVATION	DEPTH TO WATER	FREE PRODUCT THICKNESS	FREE PRODUCT BAILED (GALLONS)	GROUND WATER ELEVATION
C-B	12/06/89	---	---	0.01	---	---
C-B	10/30/90	---	11.19	0.01	---	---
C-B	12/06/90	---	11.27	0.00	0.00	---
C-B	12/13/90	---	11.19	0.00	0.00	---
C-B	12/20/90	---	11.08	0.00	0.00	---
C-B	12/27/90	---	11.08	SHEEN	0.00	---
C-B	01/03/91	---	11.09	SHEEN	0.00	---
C-B	01/10/91	---	11.14	SHEEN	0.00	---
C-B	01/14/91	---	11.40	0.01	---	---
C-B	01/17/91	---	11.12	SHEEN	0.00	---
C-B	01/24/91	---	11.14	SHEEN	0.00	---
C-B	01/31/91	---	11.15	SHEEN	0.00	---
C-B	02/07/91	---	10.82	SHEEN	0.00	---
C-B	02/14/91	---	10.82	0.00	0.00	---
C-B	02/21/91	---	10.80	SHEEN	0.00	---
C-B	02/28/91	---	10.82	SHEEN	0.00	---
C-B	03/07/91	---	10.35	0.03	0.10	---
C-B	03/14/91	---	9.74	0.20	0.25	---
C-B	03/21/91	---	10.08	0.14	0.10	---
C-B	03/28/91	---	9.56	0.03	0.10	---
C-B	04/03/91	---	9.55	1.00	---	---
C-B	04/04/91	---	10.54	1.06	0.75	---
C-B	04/11/91	---	10.65	1.00	0.50	---
C-B	04/18/91	---	10.57	0.67	0.75	---
C-B	04/25/91	---	10.44	0.50	0.10	---
C-B	05/02/91	---	10.45	0.35	0.75	---
C-B	05/09/91	---	10.35	0.25	0.10	---
C-B	05/16/91	---	10.54	0.20	0.50	---
C-B	05/23/91	---	10.51	0.15	0.10	---
C-B	05/30/91	---	10.57	0.10	0.25	---
C-B	06/06/91	---	10.54	0.05	0.10	---
C-B	06/13/91	---	10.65	0.03	0.25	---
C-B	07/17/91	---	10.84	0.03	---	---
C-B	09/20/91	---	11.10	0.05	0.02	---
C-B	10/07/91	---	11.10	0.04	0.01	---

Summary of Results of Ground Water Monitoring
Chevron Station No. 9-4587
609 Oak Street, Oakland, California

Concentrations in parts per billion (ppb)

WELL ID	DATE OF MONITORING	TOP OF WELL BOX ELEVATION	DEPTH TO WATER	FREE PRODUCT THICKNESS	FREE PRODUCT BAILED (GALLONS)	GROUND WATER ELEVATION
C-C	12/06/89	---	---	0.15	---	---
C-C	10/30/90	---	10.84	0.03	---	---
C-C	12/06/90	---	11.24	0.23	0.50	---
C-C	12/13/90	---	11.09	0.13	0.50	---
C-C	12/20/90	---	11.00	0.11	0.00	---
C-C	12/27/90	---	10.91	0.04	0.00	---
C-C	01/03/91	---	11.02	0.14	0.25	---
C-C	01/10/91	---	11.01	0.13	0.50	---
C-C	01/14/91	---	11.01	0.11	---	---
C-C	01/17/91	---	11.02	0.12	0.25	---
C-C	01/24/91	---	11.05	0.13	0.10	---
C-C	01/31/91	---	11.03	0.08	0.25	---
C-C	02/07/91	---	10.86	0.06	0.50	---
C-C	02/14/91	---	10.80	0.06	0.25	---
C-C	02/21/91	---	10.84	0.12	0.50	---
C-C	02/28/91	---	10.72	0.13	0.25	---
C-C	03/07/91	---	10.51	0.20	0.50	---
C-C	03/14/91	---	10.18	0.15	0.25	---
C-C	03/21/91	---	9.88	0.15	0.50	---
C-C	03/28/91	---	9.15	0.21	0.25	---
C-C	04/03/91	---	9.19	0.02	---	---
C-C	04/04/91	---	9.43	0.25	0.75	---
C-C	04/11/91	---	9.61	0.19	0.50	---
C-C	04/18/91	---	9.72	0.11	0.25	---
C-C	04/25/91	---	9.72	0.17	0.20	---
C-C	05/02/91	---	9.88	0.16	0.25	---
C-C	05/09/91	---	10.00	0.13	0.50	---
C-C	05/16/91	---	10.01	0.10	0.25	---
C-C	05/23/91	---	10.10	0.09	0.20	---
C-C	05/30/91	---	10.27	0.17	0.50	---
C-C	06/06/91	---	10.34	0.16	0.50	---
C-C	06/13/91	---	10.43	0.15	0.25	---
C-C	07/17/91	---	10.53	0.03	---	---
C-C	09/20/91	---	10.80	0.35	2.00	---
C-C	10/07/91	---	10.98	0.08	0.01	---

Summary of Results of Ground Water Monitoring
Chevron Station No. 9-4587
609 Oak Street, Oakland, California

Concentrations in parts per billion (ppb)

WELL ID	DATE OF MONITORING	TOP OF WELL BOX ELEVATION	DEPTH TO WATER	FREE PRODUCT THICKNESS	FREE PRODUCT BAILED (GALLONS)	GROUND WATER ELEVATION
C-1	12/06/89	16.07	---	0.20	---	---
C-1	10/30/90	16.07	10.79	0.02	---	5.30
C-1	12/06/90	16.07	10.89	0.01	0.10	5.19
C-1	12/13/90	16.07	10.80	0.01	0.10	5.28
C-1	12/20/90	16.07	10.69	0.01	0.00	5.39
C-1	12/27/90	16.07	10.66	0.02	0.00	5.43
C-1	01/03/91	16.07	10.74	0.02	0.10	5.35
C-1	01/10/91	16.07	10.73	0.01	0.10	5.35
C-1	01/14/91	16.07	11.39	0.02	---	4.70
C-1	01/17/91	16.07	10.74	SHEEN	0.00	5.33
C-1	01/24/91	16.07	10.76	SHEEN	0.00	5.31
C-1	01/31/91	16.07	10.76	SHEEN	0.00	5.31
C-1	02/07/91	16.07	10.46	SHEEN	0.00	5.61
C-1	02/14/91	16.07	---	---	---	---
C-1	02/21/91	16.07	10.49	SHEEN	0.00	5.58
C-1	02/28/91	16.07	9.69	0.00	0.00	6.38
C-1	03/07/91	16.07	10.05	SHEEN	0.00	6.02
C-1	03/14/91	16.07	9.94	SHEEN	0.00	6.13
C-1	03/21/91	16.07	9.82	SHEEN	0.00	6.25
C-1	03/28/91	16.07	9.27	0.00	0.00	6.80
C-1	04/03/91	16.07	9.43	0.02	---	6.66
C-1	04/04/91	16.07	9.44	0.04	0.25	6.66
C-1	04/11/91	16.07	9.62	0.04	0.10	6.48
C-1	04/18/91	16.07	9.77	0.06	0.25	6.35
C-1	04/25/91	16.07	9.97	0.17	0.10	6.24
C-1	05/02/91	16.07	9.89	0.04	0.25	6.21
C-1	05/09/91	16.07	9.97	0.03	0.10	6.12
C-1	05/16/91	16.07	10.00	SHEEN	0.00	6.07
C-1	05/23/91	16.07	10.11	0.02	0.10	5.98
C-1	05/30/91	16.07	10.13	SHEEN	0.00	5.94
C-1	06/06/91	16.07	10.23	0.01	0.10	5.85
C-1	06/13/91	16.07	10.28	SHEEN	---	5.79
C-1	07/17/91	16.07	10.46	0.04	---	5.64
C-1	09/20/91	16.07	10.68	0.01	0.01	5.40
C-1	10/07/91	16.07	10.74	0.04	0.01	5.36

Summary of Results of Ground Water Monitoring
Chevron Station No. 9-4587
609 Oak Street, Oakland, California

Concentrations in parts per billion (ppb)

WELL ID	DATE OF MONITORING	TOP OF WELL BOX ELEVATION	DEPTH TO WATER	FREE PRODUCT THICKNESS	FREE PRODUCT BAILED (GALLONS)	GROUND WATER ELEVATION
C-2	12/06/89	16.84	---	0.00	0.00	---
C-2	10/30/90	16.84	11.16	0.00	0.00	5.68
C-2	12/06/90	16.84	11.23	0.00	0.00	5.61
C-2	12/13/90	16.84	11.14	0.00	0.00	5.70
C-2	12/20/90	16.84	11.03	0.00	0.00	5.81
C-2	12/27/90	16.84	11.02	0.00	0.00	5.82
C-2	01/03/91	16.84	11.08	0.00	0.00	5.76
C-2	01/10/91	16.84	11.09	0.00	0.00	5.75
C-2	01/14/91	16.84	11.11	0.00	0.00	5.73
C-2	01/17/91	16.84	11.09	0.00	0.00	5.75
C-2	01/24/91	16.84	11.12	0.00	0.00	5.72
C-2	01/31/91	16.84	11.12	0.00	0.00	5.72
C-2	02/07/91	16.84	10.75	0.00	0.00	6.09
C-2	02/14/91	16.84	10.77	0.00	0.00	6.07
C-2	02/21/91	16.84	10.82	0.00	0.00	6.02
C-2	02/28/91	16.84	10.73	0.00	0.00	6.11
C-2	03/07/91	16.84	10.27	0.00	0.00	6.57
C-2	03/14/91	16.84	10.14	0.00	0.00	6.70
C-2	03/21/91	16.84	9.48	0.00	0.00	7.36
C-2	03/28/91	16.84	9.33	0.00	0.00	7.51
C-2	04/03/91	16.84	9.53	0.00	0.00	7.31
C-2	04/04/91	16.84	9.50	0.00	0.00	7.34
C-2	04/11/91	16.84	9.73	0.00	0.00	7.11
C-2	04/18/91	16.84	9.89	0.00	0.00	6.95
C-2	04/25/91	16.84	9.95	0.00	0.00	6.89
C-2	05/02/91	16.84	10.05	0.00	0.00	6.79
C-2	05/09/91	16.84	10.15	0.00	0.00	6.69
C-2	05/16/91	16.84	10.20	0.00	0.00	6.64
C-2	05/23/91	16.84	10.31	0.00	0.00	6.53
C-2	05/30/91	16.84	10.37	0.00	0.00	6.47
C-2	06/06/91	16.84	10.46	0.00	0.00	6.38
C-2	06/13/91	16.84	10.52	0.00	0.00	6.32
C-2	07/17/91	16.84	10.68	0.00	0.00	6.16
C-2	09/20/91	16.84	10.99	0.00	0.00	5.85
C-2	10/07/91	16.84	11.02	0.00	0.00	5.82

Summary of Results of Ground Water Monitoring
Chevron Station No. 9-4587
609 Oak Street, Oakland, California

Concentrations in parts per billion (ppb)

WELL ID	DATE OF MONITORING	TOP OF WELL BOX ELEVATION	DEPTH TO WATER	FREE PRODUCT THICKNESS	FREE PRODUCT BAILED (GALLONS)	GROUND WATER ELEVATION
C-3	12/06/89	16.48	---	0.00	0.00	---
C-3	10/30/90	16.48	10.44	0.00	0.00	6.04
C-3	12/06/90	16.48	10.56	0.00	0.00	5.92
C-3	12/13/90	16.48	---	0.00	0.00	---
C-3	12/20/90	16.48	10.33	0.00	0.00	6.15
C-3	12/27/90	16.48	10.30	0.00	0.00	6.18
C-3	01/03/91	16.48	10.36	0.00	0.00	6.12
C-3	01/10/91	16.48	10.37	0.00	0.00	6.11
C-3	01/14/91	16.48	10.34	0.00	0.00	6.14
C-3	01/17/91	16.48	10.37	0.00	0.00	6.11
C-3	01/24/91	16.48	10.42	0.00	0.00	6.06
C-3	01/31/91	16.48	10.43	0.00	0.00	6.05
C-3	02/07/91	16.48	10.05	0.00	0.00	6.43
C-3	02/14/91	16.48	---	0.00	0.00	---
C-3	02/21/91	16.48	10.12	0.00	0.00	6.36
C-3	02/28/91	16.48	9.98	0.00	0.00	6.50
C-3	03/07/91	16.48	---	0.00	0.00	---
C-3	03/14/91	16.48	---	0.00	0.00	---
C-3	03/21/91	16.48	9.40	0.00	0.00	7.08
C-3	03/28/91	16.48	---	0.00	0.00	---
C-3	04/03/91	16.48	9.01	0.00	0.00	7.47
C-3	04/04/91	16.48	---	0.00	0.00	---
C-3	04/11/91	16.48	9.15	0.00	0.00	7.33
C-3	04/18/91	16.48	9.26	0.00	0.00	7.22
C-3	04/25/91	16.48	9.30	0.00	0.00	7.18
C-3	05/02/91	16.48	9.40	0.00	0.00	7.08
C-3	05/09/91	16.48	9.51	0.00	0.00	6.97
C-3	05/16/91	16.48	9.53	0.00	0.00	6.95
C-3	05/23/91	16.48	9.66	0.00	0.00	6.82
C-3	05/30/91	16.48	---	0.00	0.00	---
C-3	06/06/91	16.48	---	0.00	0.00	---
C-3	06/13/91	16.48	---	0.00	0.00	---
C-3	07/17/91	16.48	10.00	0.00	0.00	6.48
C-3	09/20/91	16.48	10.36	0.00	0.00	6.12
C-3	10/07/91	16.48	10.38	0.00	0.00	6.10

Summary of Results of Ground Water Monitoring
Chevron Station No. 9-4587
609 Oak Street, Oakland, California

Concentrations in parts per billion (ppb)

WELL ID	DATE OF MONITORING	TOP OF WELL BOX ELEVATION	DEPTH TO WATER	FREE PRODUCT THICKNESS	FREE PRODUCT BAILED (GALLONS)	GROUND WATER ELEVATION
C-4	12/06/89	16.53	---	0.00	0.00	---
C-4	10/30/90	16.53	11.56	0.00	0.00	4.97
C-4	12/06/90	16.53	11.60	0.00	0.00	4.93
C-4	12/13/90	16.53	11.52	0.00	0.00	5.01
C-4	12/20/90	16.53	11.42	0.00	0.00	5.11
C-4	12/27/90	16.53	11.40	0.00	0.00	5.13
C-4	01/03/91	16.53	11.43	0.00	0.00	5.10
C-4	01/10/91	16.53	11.43	0.00	0.00	5.10
C-4	01/14/91	16.53	11.44	0.00	0.00	5.09
C-4	01/17/91	16.53	11.56	0.00	0.00	4.97
C-4	01/24/91	16.53	11.56	0.00	0.00	4.97
C-4	01/31/91	16.53	11.51	0.00	0.00	5.02
C-4	02/07/91	16.53	11.35	0.00	0.00	5.18
C-4	02/14/91	16.53	11.27	0.00	0.00	5.26
C-4	02/21/91	16.53	11.27	0.00	0.00	5.26
C-4	02/28/91	16.53	11.13	0.00	0.00	5.40
C-4	03/07/91	16.53	10.82	0.00	0.00	5.71
C-4	03/14/91	16.53	10.68	0.00	0.00	5.85
C-4	03/21/91	16.53	10.61	0.00	0.00	5.92
C-4	03/28/91	16.53	9.43	0.00	0.00	7.10
C-4	04/03/91	16.53	10.00	0.00	0.00	6.53
C-4	04/04/91	16.53	10.02	0.00	0.00	6.51
C-4	04/11/91	16.53	10.24	0.00	0.00	6.29
C-4	04/18/91	16.53	10.36	0.00	0.00	6.17
C-4	04/25/91	16.53	10.44	0.00	0.00	6.09
C-4	05/02/91	16.53	10.51	0.00	0.00	6.02
C-4	05/09/91	16.53	10.62	0.00	0.00	5.91
C-4	05/16/91	16.53	10.67	0.00	0.00	5.86
C-4	05/23/91	16.53	10.73	0.00	0.00	5.80
C-4	05/30/91	16.53	10.78	0.00	0.00	5.75
C-4	06/06/91	16.53	10.92	0.00	0.00	5.61
C-4	06/13/91	16.53	10.93	0.00	0.00	5.60
C-4	07/17/91	16.53	11.16	0.00	0.00	5.37
C-4	09/20/91	16.53	11.35	0.00	0.00	5.18
C-4	10/07/91	16.53	11.39	0.00	0.00	5.14

Summary of Results of Ground Water Monitoring
Chevron Station No. 9-4587
609 Oak Street, Oakland, California

Concentrations in parts per billion (ppb)

WELL ID	DATE OF MONITORING	TOP OF WELL BOX ELEVATION	DEPTH TO WATER	FREE PRODUCT THICKNESS	FREE PRODUCT BAILED (GALLONS)	GROUND WATER ELEVATION
C-5	12/06/89	14.70	9.97	0.00	0.00	4.73
C-5	10/30/90	14.70	---	0.00	0.00	---
C-5	12/06/90	14.70	9.97	0.00	0.00	4.73
C-5	12/13/90	14.70	9.89	0.00	0.00	4.81
C-5	12/20/90	14.70	9.80	0.00	0.00	4.90
C-5	12/27/90	14.70	9.79	0.00	0.00	4.91
C-5	01/03/91	14.70	9.83	0.00	0.00	4.87
C-5	01/10/91	14.70	9.85	0.00	0.00	4.85
C-5	01/14/91	14.70	9.87	0.00	0.00	4.83
C-5	01/17/91	14.70	9.84	0.00	0.00	4.86
C-5	01/24/91	14.70	9.90	0.00	0.00	4.80
C-5	01/31/91	14.70	---	0.00	0.00	---
C-5	02/07/91	14.70	9.62	0.00	0.00	5.08
C-5	02/14/91	14.70	9.62	0.00	0.00	5.08
C-5	02/21/91	14.70	9.66	0.00	0.00	5.04
C-5	02/28/91	14.70	9.57	0.00	0.00	5.13
C-5	03/07/91	14.70	9.23	0.00	0.00	5.47
C-5	03/14/91	14.70	9.13	0.00	0.00	5.57
C-5	03/21/91	14.70	9.05	0.00	0.00	5.65
C-5	03/28/91	14.70	8.56	0.00	0.00	6.14
C-5	04/03/91	14.70	8.72	0.00	0.00	5.98
C-5	04/04/91	14.70	8.72	0.00	0.00	5.98
C-5	04/11/91	14.70	8.87	0.00	0.00	5.83
C-5	04/18/91	14.70	9.01	0.00	0.00	5.69
C-5	04/25/91	14.70	9.05	0.00	0.00	5.65
C-5	05/02/91	14.70	9.14	0.00	0.00	5.56
C-5	05/09/91	14.70	9.20	0.00	0.00	5.50
C-5	05/16/91	14.70	9.25	0.00	0.00	5.45
C-5	05/23/91	14.70	9.31	0.00	0.00	5.39
C-5	05/30/91	14.70	9.35	0.00	0.00	5.35
C-5	06/06/91	14.70	9.44	0.00	0.00	5.26
C-5	06/13/91	14.70	9.45	0.00	0.00	5.25
C-5	07/17/91	14.70	9.63	0.00	0.00	5.07
C-5	09/20/91	14.70	9.81	0.00	0.00	4.89
C-5	10/07/91	14.70	9.83	0.00	0.00	4.87

Summary of Results of Ground Water Monitoring
Chevron Station No. 9-4587
609 Oak Street, Oakland, California

Concentrations in parts per billion (ppb)

WELL ID	DATE OF MONITORING	TOP OF WELL BOX ELEVATION	DEPTH TO WATER	FREE PRODUCT THICKNESS	FREE PRODUCT BAILED (GALLONS)	GROUND WATER ELEVATION
C-6	12/06/89	13.87	---	0.00	0.00	---
C-6	10/30/90	13.87	9.43	0.00	0.00	4.44
C-6	12/06/90	13.87	9.47	0.00	0.00	4.40
C-6	12/13/90	13.87	9.43	0.00	0.00	4.44
C-6	12/20/90	13.87	9.32	0.00	0.00	4.55
C-6	12/27/90	13.87	9.36	0.00	0.00	4.51
C-6	01/03/91	13.87	9.36	0.00	0.00	4.51
C-6	01/10/91	13.87	9.38	0.00	0.00	4.49
C-6	01/14/91	13.87	9.41	0.00	0.00	4.46
C-6	01/17/91	13.87	9.36	0.00	0.00	4.51
C-6	01/24/91	13.87	9.42	0.00	0.00	4.45
C-6	01/31/91	13.87	---	0.00	0.00	---
C-6	02/07/91	13.87	9.25	0.00	0.00	4.62
C-6	02/14/91	13.87	9.25	0.00	0.00	4.62
C-6	02/21/91	13.87	9.24	0.00	0.00	4.63
C-6	02/28/91	13.87	9.20	0.00	0.00	4.67
C-6	03/07/91	13.87	9.03	0.00	0.00	4.84
C-6	03/14/91	13.87	8.97	0.00	0.00	4.90
C-6	03/21/91	13.87	8.91	0.00	0.00	4.96
C-6	03/28/91	13.87	8.64	0.00	0.00	5.23
C-6	04/03/91	13.87	8.66	0.00	0.00	5.21
C-6	04/04/91	13.87	8.66	0.00	0.00	5.21
C-6	04/11/91	13.87	8.74	0.00	0.00	5.13
C-6	04/18/91	13.87	8.82	0.00	0.00	5.05
C-6	04/25/91	13.87	8.85	0.00	0.00	5.02
C-6	05/02/91	13.87	8.88	0.00	0.00	4.99
C-6	05/09/91	13.87	8.95	0.00	0.00	4.92
C-6	05/16/91	13.87	8.99	0.00	0.00	4.88
C-6	05/23/91	13.87	9.02	0.00	0.00	4.85
C-6	05/30/91	13.87	9.07	0.00	0.00	4.80
C-6	06/06/91	13.87	9.10	0.00	0.00	4.77
C-6	06/13/91	13.87	9.15	0.00	0.00	4.72
C-6	07/17/91	13.87	9.25	0.00	0.00	4.62
C-6	09/20/91	13.87	8.97	0.00	0.00	4.90
C-6	10/07/91	13.87	9.34	0.00	0.00	4.53

Summary of Results of Ground Water Monitoring
 Chevron Station No. 9-4587
 609 Oak Street, Oakland, California

Concentrations in parts per billion (ppb)

WELL ID	DATE OF MONITORING	TOP OF WELL BOX ELEVATION	DEPTH TO WATER	FREE PRODUCT THICKNESS	FREE PRODUCT BAILED (GALLONS)	GROUND WATER ELEVATION
C-7	02/07/91	15.78	9.88	0.00	0.00	5.90
C-7	04/03/91	15.78	9.04	0.00	0.00	6.74
C-7	04/04/91	15.78	9.04	0.00	0.00	6.74
C-7	04/11/91	15.78	9.19	0.00	0.00	6.59
C-7	04/18/91	15.78	---	0.00	0.00	---
C-7	04/25/91	15.78	9.28	0.00	0.00	6.50
C-7	05/02/91	15.78	---	0.00	0.00	---
C-7	05/09/91	15.78	9.46	0.00	0.00	6.32
C-7	05/16/91	15.78	9.47	0.00	0.00	6.31
C-7	05/23/91	15.78	9.55	0.00	0.00	6.23
C-7	05/30/91	15.78	---	0.00	0.00	---
C-7	06/06/91	15.78	9.71	0.00	0.00	6.07
C-7	06/13/91	15.78	9.77	0.00	0.00	6.01
C-7	07/17/91	15.78	9.86	0.00	0.00	5.92
C-7	09/20/91	15.78	10.13	0.00	0.00	5.65
C-7	10/07/91	15.78	10.10	0.00	0.00	5.68

Summary of Results of Ground Water Monitoring
Chevron Station No. 9-4587
609 Oak Street, Oakland, California

Concentrations in parts per billion (ppb)

WELL ID	DATE OF MONITORING	TOP OF WELL BOX ELEVATION	DEPTH TO WATER	FREE PRODUCT THICKNESS	FREE PRODUCT BAILED (GALLONS)	GROUND WATER ELEVATION
CR-1	10/30/90	---	10.51	---	---	---
CR-1	12/06/90	---	10.59	0.00	0.00	---
CR-1	12/13/90	---	10.54	0.00	0.00	---
CR-1	12/20/90	---	10.43	0.00	0.00	---
CR-1	12/27/90	---	10.43	0.00	0.00	---
CR-1	01/03/91	---	10.42	0.00	0.00	---
CR-1	01/10/91	---	10.46	0.00	0.00	---
CR-1	01/14/91	---	10.29	0.00	0.00	---
CR-1	01/17/91	---	10.44	0.00	0.00	---
CR-1	01/24/91	---	10.52	0.00	0.00	---
CR-1	01/31/91	---	10.30	0.00	0.00	---
CR-1	02/07/91	---	10.22	0.00	0.00	---
CR-1	02/14/91	---	10.21	0.00	0.00	---
CR-1	02/21/91	---	10.25	0.00	0.00	---
CR-1	02/28/91	---	10.15	0.00	0.00	---
CR-1	03/07/91	---	9.80	0.00	0.00	---
CR-1	03/14/91	---	9.68	0.00	0.00	---
CR-1	03/21/91	---	9.57	0.00	0.00	---
CR-1	03/28/91	---	9.20	0.00	0.00	---
CR-1	04/03/91	---	---	---	---	---
CR-1	04/04/91	---	9.35	0.00	0.00	---
CR-1	04/11/91	---	9.49	0.00	0.00	---
CR-1	04/18/91	---	9.60	0.00	0.00	---
CR-1	04/25/91	---	9.60	0.00	0.00	---
CR-1	05/02/91	---	9.42	0.00	0.00	---
CR-1	05/09/91	---	9.72	0.00	0.00	---
CR-1	05/16/91	---	9.77	0.00	0.00	---
CR-1	05/23/91	---	9.84	0.00	0.00	---
CR-1	05/30/91	---	9.90	0.00	0.00	---
CR-1	06/06/91	---	9.98	0.00	0.00	---
CR-1	06/13/91	---	10.02	0.00	0.00	---
CR-1	07/17/91	---	10.19	0.00	0.00	---
CR-1	09/20/91	---	10.43	0.00	0.00	---
CR-1	10/07/91	---	10.46	0.00	0.00	---

Note: Top of well box and Ground Water Elevations are expressed
as feet above mean sea level (NGVD - 1929).

APPENDIX A
OFFICIAL LABORATORY RESULTS
AND
CHAIN OF CUSTODY FORMS



Superior Precision Analytical, Inc.

825 Arnold Drive, Suite 114 • Martinez, California 94553 • (510) 229-1512 / fax (510) 229-1526

OCT 22 1991

C E R T I F I C A T E O F A N A L Y S I S

LABORATORY NO.: 84090
CLIENT: Alton Geoscience
CLIENT JOB NO.: 310-564

DATE RECEIVED: 10/07/91
DATE REPORTED: 10/18/91

Page 1 of 2

Lab Number	Customer Sample Identification	Date Sampled	Date Analyzed
84090- 1	TB	10/07/91	10/12/91
84090- 2	RIN	10/07/91	10/14/91
84090- 3	C6	10/07/91	10/12/91
84090- 4	C7	10/07/91	10/12/91
84090- 5	C3	10/07/91	10/12/91
84090- 6	C4	10/07/91	10/14/91
84090- 7	C5	10/07/91	10/14/91
84090- 8	C2	10/07/91	10/14/91
84090- 9	CR1	10/07/91	10/17/91
84090-10	CR1	10/07/91	10/17/91

Laboratory Number:	84090	84090	84090	84090	84090
	1	2	3	4	5

ANALYTE LIST	Amounts/Quantitation Limits (ug/L)				
OIL AND GREASE:	NA	NA	NA	NA	NA
TPH/GASOLINE RANGE:	ND<50	ND<50	67	ND<50	ND<50
TPH/DIESEL RANGE:	NA	NA	NA	NA	NA
BENZENE:	ND<0.5	ND<0.5	ND<0.5	ND<0.5	ND<0.5
TOLUENE:	ND<0.5	0.5	0.6	ND<0.5	ND<0.5
ETHYL BENZENE:	ND<0.5	ND<0.5	ND<0.5	ND<0.5	ND<0.5
XYLENES:	ND<0.5	ND<0.5	0.6	ND<0.5	ND<0.5

Laboratory Number:	84090	84090	84090	84090	84090
	6	7	8	9	10

ANALYTE LIST	Amounts/Quantitation Limits (ug/L)				
OIL AND GREASE:	NA	NA	NA	NA	NA
TPH/GASOLINE RANGE:	ND<50	ND<50	25000	17000	14000
TPH/DIESEL RANGE:	NA	NA	NA	NA	NA
BENZENE:	ND<0.5	1.1	3700	7600	9400
TOLUENE:	ND<0.5	ND<0.5	1300	50	52
ETHYL BENZENE:	4.6	ND<0.5	1400	440	430
XYLENES:	ND<0.5	ND<0.5	3800	68	110



C E R T I F I C A T E O F A N A L Y S I S

ANALYSIS FOR TOTAL PETROLEUM HYDROCARBONS

Page 2 of 2
QA/QC INFORMATION
SET: 84090

NA = ANALYSIS NOT REQUESTED
ND = ANALYSIS NOT DETECTED ABOVE QUANTITATION LIMIT
ug/L= part per billion (ppb)

OIL AND GREASE ANALYSIS By Standard Methods Method 5520F:
Minimum Detection Limit in Water: 5000ug/L

Modified EPA-SW846 Method 8015 for Extractable Hydrocarbons:
Minimum Quantitation Limit for Diesel in Water: 50ug/L
Standard Reference: NA

EPA-SW846 Method 8015/5030 Total Purgable Petroleum Hydrocarbons:
Minimum Quantitation Limit for Gasoline in Water: 50ug/L
Standard Reference: 10/04/91

SW-846 Method 8020/BTXE
Minimum Quantitation Limit in Water: 0.5ug/L
Standard Reference: 10/11/91

ANALYTE	REFERENCE	SPIKE LEVEL	MS/MSD RECOVERY	RPD	CONTROL LIMIT
Oil & Grease	NA	NA	NA	NA	NA
Diesel	NA	NA	NA	NA	NA
Gasoline	10/04/91	200 ng	87/89	3	70-130
Benzene	10/11/91	200 ng	93/92	2	70-130
Toluene	10/11/91	200 ng	91/90	2	70-130
Ethyl Benzene	10/11/91	200 ng	93/91	2	70-130
Total Xylene	10/11/91	200 ng	93/92	1	70-130

Richard Srna, Ph.D.

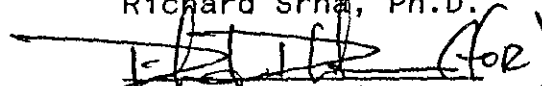
Laboratory Director

Fax copy of Lab Report and COC to Chevron Contact: Yes No

84090 Chain-of-Custody-Record

Chevron U.S.A. Inc.
P.O. BOX 5004
San Ramon, CA 94583
FAX (415)842-9591

Chevron Facility Number SS. # 4587
Facility Address 109 Oak St. Oakland CA
Consultant Project Number 310-564
Consultant Name Alton Geoscience
Address 1000 Burnett Ave Concord CA
Project Contact (Name) John De George
(Phone) 682-1582 (Fax Number)

Chevron Contact (Name) Nancy Venkelwich
(Phone) 415 824-9581
Laboratory Name Superior
Laboratory Release Number 2746840
Samples Collected by (Name) Patricia Gigante / Domingo Bernal
Collection Date 10-07-91
Signature Patricia Gigante

Sample Number	Lab Sample Number	Number of Containers	Matrix S = Soil W = Water A = Air C = Charcoal	Type G = Grab C = Composite D = Discrete	Time	Sample Preservation	Iced (Yes or No)	Analyses To Be Performed											Remarks	
								BTEX + TPH GAS (8020 + 8015)	TPH Diesel (8015)	Oil and Grease (5520)	Purgeable Halocarbons (8010)	Purgeable Aromatics (8020)	Purgeable Organics (8240)	Extractable Organics (8270)	Metals Cd, Cr, Pb, Zn, Ni (ICAP or AA)					
TB	1	1	W	G		HCL	X	X												
RIN	2	1	W	G		HCL	X	X												
C6	3	2	W	G		HCL	X	X												
C7	4	2	W	G		HCL	X	X												
C3	5	2	W	G		HCL	X	X												
C4	6	2	W	G		HCL	X	X												
C5	7	2	W	G		HCL	X	X												
C2	8	2	W	G		HCL	X	X												
CR1	9	2	W	G		HCL	X	X												
CR1	10	1	W	S		HCL	X	X												

Please Initial: PN
 Samples Stored in ice: M
 Appropriate containers: M
 Samples preserved: M
 VCA's without headspace: L
 Comments: _____

Relinquished By (Signature) <u>Patricia Gigante</u>	Organization <u>Alton</u>	Date/Time <u>10-07-91</u>	Received By (Signature) <u>[Signature]</u>	Organization	Date/Time	Turn Around Time (Circle Choice) 24 Hrs. 48 Hrs. 5 Days 10 Days <u>As Contracted</u>
Relinquished By (Signature) <u>[Signature]</u>	Organization	Date/Time	Received By (Signature) <u>[Signature]</u>	Organization	Date/Time	
Relinquished By (Signature) <u>[Signature]</u>	Organization	Date/Time	Received For Laboratory By (Signature) <u>[Signature]</u>		Date/Time <u>10/24/1990</u>	

COC-3.DWG/03 91/HCH