



RECEIVED

1:31 pm, Jul 23, 2008

Alameda County
Environmental Health

Jerry Wickham
Alameda County Health Care Services Agency
1131 Harbor Bay Parkway, Suite 250
Alameda, California 94502-6577

Denis L. Brown
Shell Oil Products US
HSE - Environmental Services
20945 S. Wilmington Ave.
Carson, CA 90810-1039
Tel (707) 865 0251
Fax (707) 865 2542
Email denis.l.brown@shell.com

Re: Shell-branded Service Station
5755 Broadway
Oakland, California
SAP Code 135699
Incident No. 98995756
ACHCSA Case No. RO-0026

Dear Mr. Wickham:

The attached document is provided for your review and comment. Upon information and belief, I declare, under penalty of perjury, that the information contained in the attached document is true and correct.

If you have any questions or concerns, please call me at (707) 865-0251.

Sincerely,

A handwritten signature in black ink, appearing to read "Denis L. Brown", is located below the "Sincerely," text.

Denis L. Brown
Project Manager



**CONESTOGA-ROVERS
& ASSOCIATES**

5900 Hollis Street, Suite A, Emeryville, California 94608
Telephone: 510-420-0700 Facsimile: 510-420-9170
www.CRAworld.com

July 22, 2008

Mr. Jerry Wickham
Alameda County Health Care Services Agency
1131 Harbor Bay Parkway, Suite 250
Alameda, California 94502-6577

Re: **Groundwater Monitoring Report –Second Quarter 2008**
Shell-branded Service Station
5755 Broadway
Oakland, California
SAP Code 135699
Incident No. 98995756
ACHCSA Case No. RO-0026

Dear Mr. Wickham:

Conestoga-Rovers and Associates (CRA) prepared this report on behalf of Equilon Enterprises LLC dba Shell Oil Products US (Shell) in accordance with the quarterly reporting requirements of 23 CCR 2652d.

If you have any questions regarding the contents of this document, please call Peter Schaefer at (510) 420-3319.

Sincerely,
Conestoga-Rovers and Associates

Peter Schaefer, CHG, CEG
Project Manager

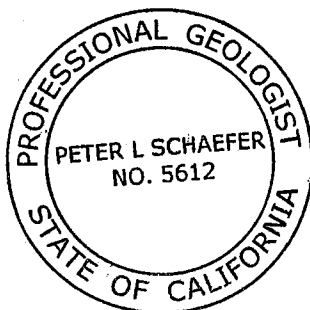

for: Ana Friel, PG
Professional Geologist

cc: Denis Brown, Shell Oil Products US, 20945 S. Wilmington Ave., Carson, CA 90810
Thrifty Oil Company, c/o Mr. Raymond Fredricksen, PO Box 2128, Santa Fe Springs,
CA 90670 (property owner)

Equal
Employment
Opportunity Employer



**CONESTOGA-ROVERS
& ASSOCIATES**

Mr. Jerry Wickham
July 22, 2008

GROUNDWATER MONITORING REPORT – SECOND QUARTER 2008

Site Address	<u>5755 Broadway, Oakland</u>
Site Use	<u>Shell-branded Service Station</u>
Shell Project Manager	<u>Denis Brown</u>
Consultant and Contact Person	<u>CRA, Peter Schaefer</u>
Lead Agency and Contact	<u>ACHCSA, Jerry Wickham</u>
Agency Case No.	<u>RO 0026</u>
Shell SAP Code	<u>135699</u>
Shell Incident No.	<u>98995756</u>
Date of Most Recent Agency Correspondence	<u>August 9, 2006</u>

Current Quarter's Activities

1. Blaine Tech Services, Inc. (Blaine) gauged and sampled wells according to the established monitoring program for this site.
2. CRA prepared a vicinity map (Figure 1) and a groundwater contour and chemical concentration map (Figure 2). The Blaine report, presenting the analytical data, is included in Attachment A.

Current Quarter's Findings

Groundwater Flow Direction	<u>South-Southwest</u>
Hydraulic Gradient	<u>0.02</u>
Depth to Water	<u>1.00 to 3.60 feet below top of well casing</u>

Proposed Activities for Next Quarter

1. Blaine will gauge and sample wells during the second month of the quarter, according to the established monitoring program for this site.



**CONESTOGA-ROVERS
& ASSOCIATES**

Mr. Jerry Wickham
July 22, 2008

Figures: 1 - Vicinity Map
 2 - Groundwater Contour and Chemical Concentration Map

Attachment: A - Blaine Tech Services, Inc. - Groundwater Monitoring Report

Conestoga-Rovers and Associates (CRA) prepared this document for use by our client and appropriate regulatory agencies. It is based partially on information available to CRA from outside sources and/or in the public domain, and partially on information supplied by CRA and its subcontractors. CRA makes no warranty or guarantee, expressed or implied, included or intended in this document, with respect to the accuracy of information obtained from these outside sources or the public domain, or any conclusions or recommendations based on information that was not independently verified by CRA. This document represents the best professional judgment of CRA. None of the work performed hereunder constitutes or shall be represented as a legal opinion of any kind or nature.

\\son-s1\shared\Sonoma.Shell\Oakland 5755 Broadway\QM\2008\2q08\2q08qm.doc

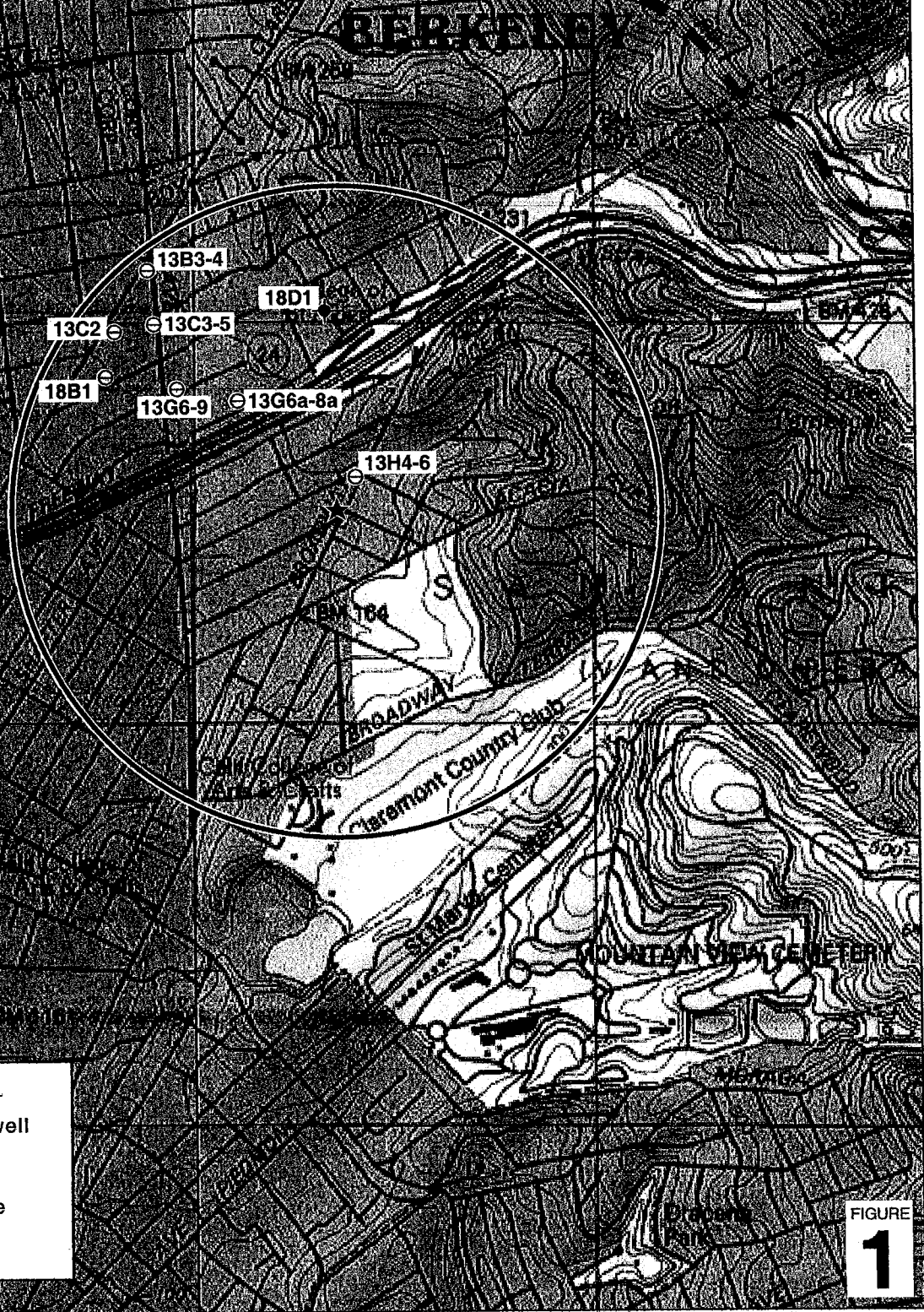
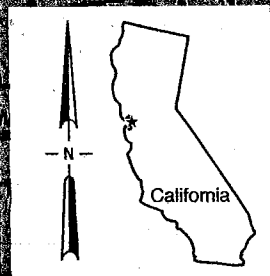

J:\SHELL\OAKLAND 5755 BROADWAY\FIGURES\VICINITY.A1

EXPLANATION

- 18D1 ◆ Municipal well
- 13B3 ⊖ Other well
- ★ Subject site
- Study area

SOURCE: TOPOI MAPS

FIGURE
1

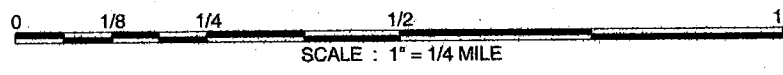

Shell-branded Service Station
5755 Broadway
Oakland, California



**CONESTOGA-ROVERS
& ASSOCIATES**

Vicinity Map

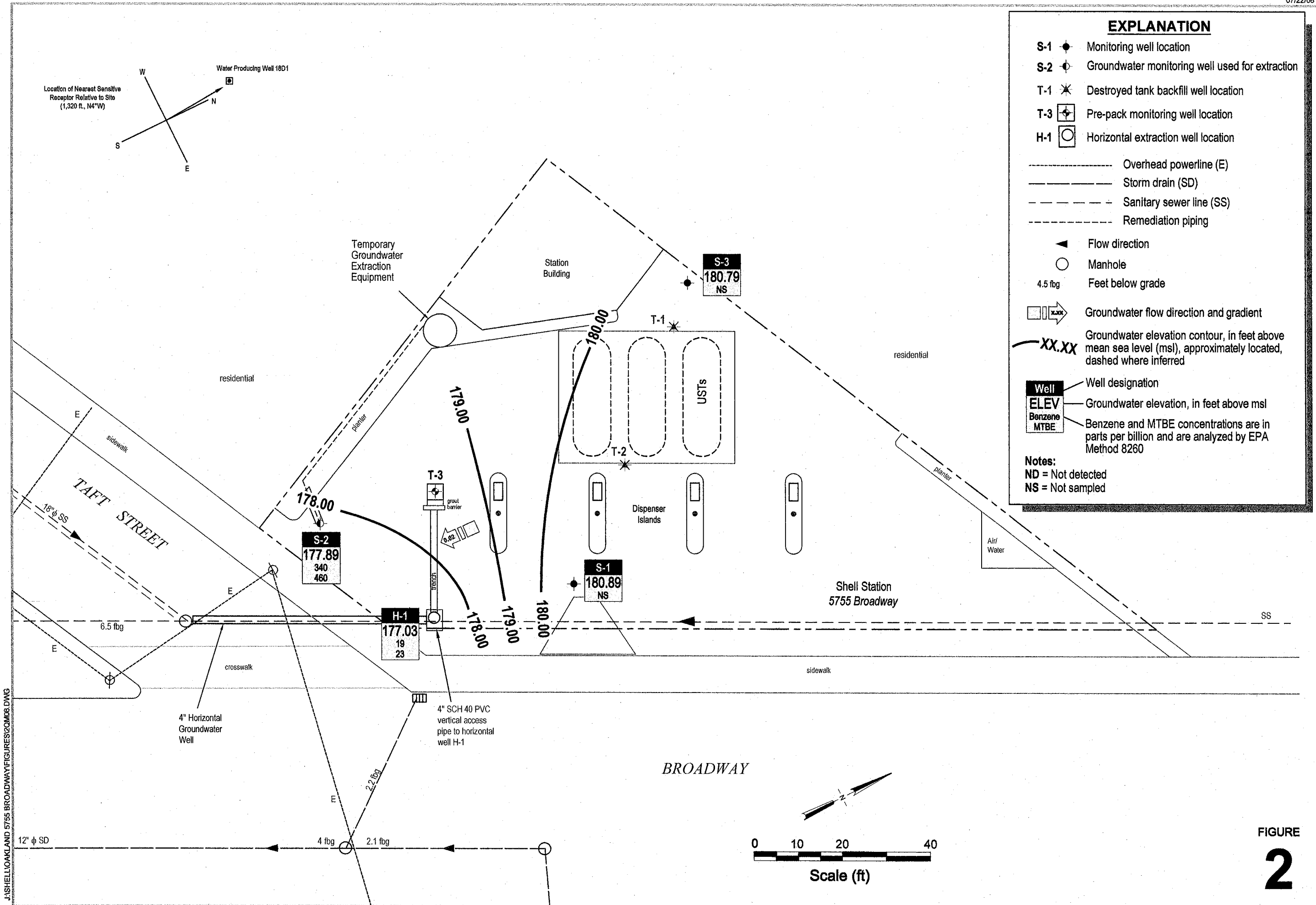

FIGURE 2

J:\SHELL\OAKLAND 5755 BROADWAY\FIGURES\CONESTOGA.DWG

Attachment A

**Blaine Tech Services, Inc.
Groundwater Monitoring Report**

BLAINE
TECH SERVICES INC.

GROUNDWATER SAMPLING SPECIALISTS
SINCE 1985

June 12, 2008

Denis Brown
Shell Oil Products US
20945 South Wilmington Avenue
Carson, CA 90810

Second Quarter 2008 Groundwater Monitoring at
Shell-branded Service Station
5755 Broadway
Oakland, CA

Monitoring performed on May 20, 2008

Groundwater Monitoring Report 080520-MT-1

This report covers the routine monitoring of groundwater wells at this Shell-branded facility. In accordance with standard procedures that conform to Regional Water Quality Control Board requirements, routine field data collection includes depth to water, total well depth, thickness of any separate immiscible layer, water column volume, calculated purge volume (if applicable), elapsed evacuation time (if applicable), total volume of water removed (if applicable), and standard water parameter instrument readings. Sample material is collected, contained, stored, and transported to the laboratory in conformance with EPA standards. Purgewater (if applicable) is, likewise, collected and transported to the Martinez Refining Company.

Basic field information is presented alongside analytical values excerpted from the laboratory report in the cumulative table of **WELL CONCENTRATIONS**. The full analytical report for the most recent samples and the field data sheets are attached to this report.

At a minimum, Blaine Tech Services, Inc. field personnel are certified on completion of a forty-hour Hazardous Materials and Emergency Response training course per 29 CFR 1910.120. Field personnel are also enrolled in annual eight-hour refresher courses.

Blaine Tech Services, Inc. conducts sampling and documentation assignments of this type as an independent third party. Our activities at this site consisted of objective data and sample collection only. No interpretation of analytical results, defining of hydrological conditions or formulation of recommendations was performed.

Please call if you have any questions.

Yours truly,

Mike Ninokata
Project Manager

MN/tm

attachments: Cumulative Table of WELL CONCENTRATIONS
Certified Analytical Report
Field Data Sheets

cc: Anni Kreml
Conestoga-Rovers & Associates
5900 Hollis Street, Suite A
Emeryville, CA 94608

WELL CONCENTRATIONS
Shell-branded Service Station
5755 Broadway
Oakland, CA

Well ID	Date	TPPH (ug/L)	B (ug/L)	T (ug/L)	E (ug/L)	X (ug/L)	MTBE 8020 (ug/L)	MTBE 8260 (ug/L)	DIPE (ug/L)	ETBE (ug/L)	TAME (ug/L)	TBA (ug/L)	TOC (MSL)	Depth to Water (ft.)	GW Elevation (MSL)	DO Reading (ppm)
S-1	01/25/1991	<30	<0.3	<0.3	<0.3	<0.3	NA	NA	NA	NA	NA	NA	100.00	3.88	96.12	NA
S-1	06/03/1991	<30	<0.3	<0.3	<0.3	<0.3	NA	NA	NA	NA	NA	NA	100.00	3.51	96.49	NA
S-1	08/30/1991	<30	<0.3	<0.3	<0.3	<0.3	NA	NA	NA	NA	NA	NA	100.00	4.24	95.76	NA
S-1	11/22/1991	<30	2.3	<0.46	0.3	<0.65	NA	NA	NA	NA	NA	NA	100.00	4.29	95.71	NA
S-1	03/13/1992	<30	<0.52	<0.3	<0.3	<0.3	NA	NA	NA	NA	NA	NA	100.00	2.87	97.13	NA
S-1	05/28/1992	<50	<0.5	<0.5	<0.5	<0.5	NA	NA	NA	NA	NA	NA	100.00	3.79	96.21	NA
S-1	08/19/1992	<50	<0.5	<0.5	<0.5	<0.5	NA	NA	NA	NA	NA	NA	100.00	4.43	95.57	NA
S-1	11/18/1992	<50	<0.5	<0.5	<0.5	<0.5	NA	NA	NA	NA	NA	NA	100.00	4.34	95.66	NA
S-1	02/10/1993	51	1.4	<0.5	<0.5	<0.5	NA	NA	NA	NA	NA	NA	100.00	4.20	95.80	NA
S-1 (D)	02/10/1993	<50	1.2	<0.5	<0.5	<0.5	NA	NA	NA	NA	NA	NA	100.00	4.20	95.80	NA
S-1	06/11/1993	<50	<0.5	<0.5	<0.5	<0.5	NA	NA	NA	NA	NA	NA	100.00	3.39	96.61	NA
S-1	08/03/1993	<50	<0.5	<0.5	<0.5	<0.5	NA	NA	NA	NA	NA	NA	100.00	3.69	96.31	NA
S-1	11/02/1993	70a	<0.5	<0.5	<0.5	<0.5	NA	NA	NA	NA	NA	NA	100.00	4.26	95.74	NA
S-1	12/16/1993	NA	NA	NA	NA	NA	NA	NA	NA	NA	NA	NA	100.00	2.73	97.27	NA
S-1	02/01/1994	60a	<0.5	<0.5	<0.5	<0.5	NA	NA	NA	NA	NA	NA	100.00	3.38	96.62	NA
S-1	05/04/1994	<50	1.1	<0.5	<0.5	<0.5	NA	NA	NA	NA	NA	NA	100.00	3.00	97.00	NA
S-1	08/18/1994	<50	0.6	<0.5	<0.5	<0.5	NA	NA	NA	NA	NA	NA	100.00	3.70	96.30	NA
S-1 (D)	08/18/1994	60a	0.5	<0.5	<0.5	<0.5	NA	NA	NA	NA	NA	NA	100.00	3.70	96.30	NA
S-1	11/09/1994	<50	4	<0.5	<0.5	<0.5	NA	NA	NA	NA	NA	NA	100.00	2.52	97.48	NA
S-1	02/22/1995	50	0.8	0.7	<0.5	1.3	NA	NA	NA	NA	NA	NA	100.00	4.08	95.92	NA
S-1	05/02/1995	<50	<0.5	<0.5	<0.5	<0.5	NA	NA	NA	NA	NA	NA	100.00	2.58	97.42	NA
S-1	08/30/1995	<50	1.7	<0.5	<0.5	<0.5	NA	NA	NA	NA	NA	NA	100.00	3.48	96.52	NA
S-1	11/28/1995	<50	<0.5	<0.5	<0.5	<0.5	NA	NA	NA	NA	NA	NA	100.00	3.99	96.01	NA
S-1	02/02/1996	<50	11	<0.5	0.9	<0.5	NA	NA	NA	NA	NA	NA	100.00	2.00	98.00	NA
S-1	03/09/1996	<50	<0.5	<0.5	<0.5	<0.5	NA	NA	NA	NA	NA	NA	100.00	3.38	99.62	NA
S-1	08/22/1996	<50	1.5	<0.5	<0.5	<0.5	130	NA	NA	NA	NA	NA	100.00	3.43	96.57	NA
S-1	11/07/1996	<50	<0.5	<0.5	<0.5	<0.5	57	NA	NA	NA	NA	NA	100.00	3.70	96.30	4.33
S-1	02/20/1997	<50	0.64	<0.50	<0.50	1.6	6.5	NA	NA	NA	NA	NA	100.00	3.60	96.40	2

WELL CONCENTRATIONS
Shell-branded Service Station
5755 Broadway
Oakland, CA

Well ID	Date	TPPH (ug/L)	B (ug/L)	T (ug/L)	E (ug/L)	X (ug/L)	MTBE 8020 (ug/L)	MTBE 8260 (ug/L)	DIPE (ug/L)	ETBE (ug/L)	TAME (ug/L)	TBA (ug/L)	TOC (MSL)	Depth to Water (ft.)	GW Elevation (MSL)	DO Reading (ppm)
S-1	05/30/1997	<50	<0.50	<0.50	<0.50	<0.50	46	NA	NA	NA	NA	NA	100.00	3.47	96.53	7
S-1 (D)	05/30/1997	<50	<0.50	<0.50	<0.50	<0.50	47	NA	NA	NA	NA	NA	100.00	3.47	96.53	7
S-1	08/21/1997	<50	<0.50	<0.50	<0.50	0.84	26	NA	NA	NA	NA	NA	100.00	3.01	96.99	3.1
S-1	11/03/1997	<50	<0.50	1.1	<0.50	1.3	190	NA	NA	NA	NA	NA	100.00	3.66	96.34	2
S-1	01/20/1998	110	7.9	2.8	4.4	13	53	NA	NA	NA	NA	NA	100.00	1.84	98.16	4.6
S-1 (D)	01/20/1998	130	9.2	6.9	5.2	15	93	NA	NA	NA	NA	NA	100.00	1.84	98.16	4.6
S-1	02/16/1999	<50	<0.50	<0.50	<0.50	<0.50	8.6	NA	NA	NA	NA	NA	100.00	2.43	97.57	2.2
S-1	09/07/1999	NA	NA	NA	NA	NA	NA	NA	NA	NA	NA	NA	100.00	2.84	97.16	NA
S-1	02/02/2000	<50.0	<0.500	<0.500	<0.500	<0.500	202	NA	NA	NA	NA	NA	100.00	3.10	96.90	2.1
S-1	04/26/2000	NA	NA	NA	NA	NA	NA	NA	NA	NA	NA	NA	100.00	2.91	97.09	NA
S-1	07/25/2000	<50.0	<0.500	<0.500	<0.500	<0.500	811	NA	NA	NA	NA	NA	100.00	3.21	96.79	1.8
S-1	11/15/2000	NA	NA	NA	NA	NA	NA	NA	NA	NA	NA	NA	100.00	3.18	96.82	NA
S-1	02/12/2001	<50.0	<0.500	<0.500	<0.500	<0.500	209	NA	NA	NA	NA	NA	100.00	1.34	98.66	2.2
S-1	06/07/2001	NA	NA	NA	NA	NA	NA	NA	NA	NA	NA	NA	100.00	1.27	98.73	NA
S-1	08/31/2001	<50	<0.50	<0.50	<0.50	<0.50	NA	<5.0	NA	NA	NA	NA	100.00	3.16	96.84	4.0
S-1	12/05/2001	NA	NA	NA	NA	NA	NA	2.6	NA	NA	NA	NA	100.00	1.90	98.10	NA
S-1	01/31/2002	<50	<0.50	<0.50	<0.50	<0.50	NA	<5.0	NA	NA	NA	NA	100.00	2.67	97.33	NA
S-1	06/04/2002	NA	NA	NA	NA	NA	NA	NA	NA	NA	NA	NA	100.00	1.87	98.13	NA
S-1	07/25/2002	<50	<0.50	<0.50	<0.50	<0.50	NA	<5.0	NA	NA	NA	NA	100.00	2.01	97.99	NA
S-1	11/07/2002	NA	NA	NA	NA	NA	NA	NA	NA	NA	NA	NA	181.89	3.01	178.88	NA
S-1	11/14/2002	NA	NA	NA	NA	NA	NA	NA	NA	NA	NA	NA	181.89	3.40	178.49	NA
S-1	01/30/2003	<50	<0.50	<0.50	<0.50	<0.50	NA	27	NA	NA	NA	NA	181.89	2.12	179.77	NA
S-1	06/03/2003	NA	NA	NA	NA	NA	NA	NA	NA	NA	NA	NA	181.89	1.83	180.06	NA
S-1	08/27/2003	<50	0.50	1.5	<0.50	2.0	NA	130	NA	NA	NA	NA	181.89	3.32	178.57	NA
S-1	11/25/2003	NA	NA	NA	NA	NA	NA	NA	NA	NA	NA	NA	181.89	3.28	178.61	NA
S-1	02/05/2004	270	2.4	6.4	5.8	19	NA	8.3	NA	NA	NA	NA	181.89	2.09	179.80	NA
S-1	04/21/2004	NA	NA	NA	NA	NA	NA	NA	NA	NA	NA	NA	181.89	2.61	179.28	NA
S-1	08/12/2004	<500	<5.0	<5.0	<5.0	<10	NA	1,100	<20	<20	<20	<50	181.89	3.70	178.19	NA

WELL CONCENTRATIONS
Shell-branded Service Station
5755 Broadway
Oakland, CA

Well ID	Date	TPPH (ug/L)	B (ug/L)	T (ug/L)	E (ug/L)	X (ug/L)	MTBE 8020 (ug/L)	MTBE 8260 (ug/L)	DIPE (ug/L)	ETBE (ug/L)	TAME (ug/L)	TBA (ug/L)	TOC (MSL)	Depth to Water (ft.)	GW Elevation (MSL)	DO Reading (ppm)
---------	------	----------------	-------------	-------------	-------------	-------------	------------------------	------------------------	----------------	----------------	----------------	---------------	--------------	----------------------------	--------------------------	------------------------

S-1	11/08/2004	NA	NA	NA	NA	NA	NA	NA	NA	NA	NA	NA	181.89	3.04	178.85	NA
S-1	05/16/2005	<50	<0.50	<0.50	<0.50	<1.0	NA	4.9	NA	NA	NA	NA	181.89	3.10	178.79	NA
S-1	08/16/2005	<50	<0.50	<0.50	<0.50	<1.0	NA	64	<2.0	<2.0	<2.0	52	181.89	0.73	181.16	NA
S-1	11/03/2005	NA	NA	NA	NA	NA	NA	NA	NA	NA	NA	NA	181.89	3.49	178.40	NA
S-1	02/16/2006	<50.0	<0.500	<0.500	<0.500	<0.500	NA	22.7	NA	NA	NA	NA	181.89	0.73	181.16	NA
S-1	05/05/2006	NA	NA	NA	NA	NA	NA	NA	NA	NA	NA	NA	181.89	0.71	181.18	NA
S-1	08/21/2006	<50.0	0.630	<0.500	<0.500	1.71	NA	44.6	<0.500	<0.500	<0.500	<10.0	181.89	3.34	178.55	NA
S-1	11/13/2006	NA	NA	NA	NA	NA	NA	NA	NA	NA	NA	NA	181.89	2.55	179.34	NA
S-1	01/30/2007	<50	<0.50	<0.50	<0.50	<1.0	NA	24	NA	NA	NA	NA	181.89	0.91	180.98	NA
S-1	05/23/2007	NA	NA	NA	NA	NA	NA	NA	NA	NA	NA	NA	181.89	2.50	179.39	NA
S-1	08/09/2007	<50 h	0.35 i	<1.0	<1.0	<1.0	NA	33	<2.0	<2.0	<2.0	<10	181.89	0.81	181.08	NA
S-1	11/13/2007	NA	NA	NA	NA	NA	NA	NA	NA	NA	NA	NA	181.89	0.55	181.34	NA
S-1	02/13/2008	<50 h	0.56	<1.0	<1.0	<1.0	NA	2.9	NA	NA	NA	NA	181.89	0.45	181.44	NA
S-1	05/20/2008	NA	NA	NA	NA	NA	NA	NA	NA	NA	NA	NA	181.89	1.00	180.89	NA

S-2	01/25/1991	450	140	1.8	6.2	15	NA	NA	NA	NA	NA	NA	98.92	4.52	94.40	NA
S-2	06/03/1991	490	150	2.7	8.2	7	NA	NA	NA	NA	NA	NA	98.92	4.02	94.90	NA
S-2	08/30/1991	70	0.37	<0.3	<0.3	<0.3	NA	NA	NA	NA	NA	NA	98.92	4.70	94.22	NA
S-2	11/22/1991	1,600	110	9.3	29	150	NA	NA	NA	NA	NA	NA	98.92	4.72	94.20	NA
S-2	03/13/1992	1,300	210	5.7	34	79	NA	NA	NA	NA	NA	NA	98.92	3.47	95.45	NA
S-2	05/28/1992	100	28	<0.5	<0.5	<0.5	NA	NA	NA	NA	NA	NA	98.92	4.45	94.45	NA
S-2	08/19/1992	470	42	<0.5	8.3	4	NA	NA	NA	NA	NA	NA	98.92	4.84	94.08	NA
S-2	11/18/1992	490	43	39	17	29	NA	NA	NA	NA	NA	NA	98.92	4.73	94.19	NA
S-2	02/10/1993	19,000	710	760	80	370	NA	NA	NA	NA	NA	NA	98.92	4.83	94.09	NA
S-2	06/11/1993	33,000	3,100	1,600	370	1,100	NA	NA	NA	NA	NA	NA	98.92	3.74	95.18	NA
S-2	08/03/1993	18,000	1,400	130	81	130	NA	NA	NA	NA	NA	NA	98.92	4.23	94.69	NA
S-2 (D)	08/03/1993	19,000	1,400	140	86	150	NA	NA	NA	NA	NA	NA	98.92	4.23	94.69	NA
S-2	11/02/1993	12,000 a	470	47	31	92	NA	NA	NA	NA	NA	NA	98.92	4.72	94.20	NA

WELL CONCENTRATIONS
Shell-branded Service Station
5755 Broadway
Oakland, CA

Well ID	Date	TPPH (ug/L)	B (ug/L)	T (ug/L)	E (ug/L)	X (ug/L)	MTBE 8020 (ug/L)	MTBE 8260 (ug/L)	DIPE (ug/L)	ETBE (ug/L)	TAME (ug/L)	TBA (ug/L)	TOC (MSL)	Depth to Water (ft.)	GW Elevation (MSL)	DO Reading (ppm)
S-2 (D)	11/02/1993	13,000 a	530	47	35	96	NA	NA	NA	NA	NA	NA	98.92	4.72	94.20	NA
S-2	12/16/1993	NA	NA	NA	NA	NA	NA	NA	NA	NA	NA	NA	98.92	3.00	95.92	NA
S-2	02/01/1994	31,000 a	430	46	50	130	NA	NA	NA	NA	NA	NA	98.92	3.48	95.44	NA
S-2 (D)	02/01/1994	31,000 a	300	33	30	100	NA	NA	NA	NA	NA	NA	98.92	3.48	95.44	NA
S-2	05/04/1994	3,900	1,200	31	53	71	NA	NA	NA	NA	NA	NA	98.92	3.26	95.66	NA
S-2 (D)	05/04/1994	4,500	1,200	37	57	110	NA	NA	NA	NA	NA	NA	98.92	3.26	95.66	NA
S-2	08/18/1994	24,000	600	8.3	15	27	NA	NA	NA	NA	NA	NA	98.92	3.98	94.94	NA
S-2	11/09/1994	1,400 a	240	9.3	13	20	NA	NA	NA	NA	NA	NA	98.92	3.10	95.82	NA
S-2 (D)	11/09/1994	1,800	260	8.5	13	21	NA	NA	NA	NA	NA	NA	98.92	3.10	95.82	NA
S-2	02/22/1995	29,000	550	18	12	63	NA	NA	NA	NA	NA	NA	98.92	4.02	94.90	NA
S-2 (D)	02/22/1995	28,000	530	17	10	60	NA	NA	NA	NA	NA	NA	98.92	4.02	94.90	NA
S-2	05/02/1995	4,400	1,000	25	38	77	NA	NA	NA	NA	NA	NA	98.92	2.86	96.06	NA
S-2 (D)	05/02/1995	4,400	1,000	26	41	83	NA	NA	NA	NA	NA	NA	98.92	2.86	96.06	NA
S-2	08/30/1995	800	350	20	6.7	16	NA	NA	NA	NA	NA	NA	98.92	4.06	94.86	NA
S-2 (D)	08/30/1995	960	220	22	12	48	NA	NA	NA	NA	NA	NA	98.92	4.06	94.86	NA
S-2	11/28/1995	2,000	230	220	50	230	NA	NA	NA	NA	NA	NA	98.92	4.48	94.44	NA
S-2 (D)	11/28/1995	2,100	240	230	51	230	NA	NA	NA	NA	NA	NA	98.92	4.48	94.44	NA
S-2	02/02/1996	18,000	540	18	12	22	NA	NA	NA	NA	NA	NA	98.92	1.99	96.93	NA
S-2 (D)	02/02/1996	11,000	600	18	13	28	NA	NA	NA	NA	NA	NA	98.92	1.99	96.93	NA
S-2	03/09/1996	3,800	1,500	27	30	58	NA	NA	NA	NA	NA	NA	98.92	3.27	95.65	NA
S-2 (D)	03/09/1996	3,500	1,300	24	21	53	NA	NA	NA	NA	NA	NA	98.92	3.27	95.65	NA
S-2	08/22/1996	<20,000	490	<200	<200	<200	43,000	NA	NA	NA	NA	NA	98.92	3.85	95.07	NA
S-2 (D)	08/22/1996	<20,000	570	<200	<200	<200	59,000	51,000	NA	NA	NA	NA	98.92	3.85	95.07	NA
S-2	11/07/1996	<5,000	290	<50	<50	<50	32,000	NA	NA	NA	NA	NA	98.92	4.00	94.92	3.51
S-2 (D)	11/07/1996	<5,000	290	<50	<50	<50	32,000	NA	NA	NA	NA	NA	98.92	4.00	94.92	3.51
S-2	02/20/1997	<10,000	520	<100	<100	<100	28,000	NA	NA	NA	NA	NA	98.92	3.20	95.72	1
S-2 (D)	02/20/1997	<10,000	520	<100	<100	<100	35,000	NA	NA	NA	NA	NA	98.92	3.20	95.72	1
S-2	05/30/1997	150	15	11	3.5	15	11	NA	NA	NA	NA	NA	98.92	3.87	95.05	6

WELL CONCENTRATIONS
Shell-branded Service Station
5755 Broadway
Oakland, CA

Well ID	Date	TPPH (ug/L)	B (ug/L)	T (ug/L)	E (ug/L)	X (ug/L)	MTBE 8020 (ug/L)	MTBE 8260 (ug/L)	DIPE (ug/L)	ETBE (ug/L)	TAME (ug/L)	TBA (ug/L)	TOC (MSL)	Depth to Water (ft.)	GW Elevation (MSL)	DO Reading (ppm)
S-2	08/21/1997	1,600	220	<10	20	<10	18,000	NA	NA	NA	NA	NA	98.92	3.29	95.63	3.3
S-2 (D)	08/21/1997	1,500	180	<10	16	<10	21,000	NA	NA	NA	NA	NA	98.92	3.29	95.63	3.3
S-2	11/03/1997	1,000	94	<10	<10	<10	<50	NA	NA	NA	NA	NA	98.92	4.02	94.90	1.8
S-2	01/20/1998	590	110	8.3	18	23	7,800	NA	NA	NA	NA	NA	98.92	1.54	97.38	3.2
S-2	07/23/1998	2,600	840	<10	44	22	15,000	NA	NA	NA	NA	NA	98.92	2.89	96.03	NA
S-2	02/16/1999	680	140	6.1	10	18	19,000	NA	NA	NA	NA	NA	98.92	1.86	97.06	2.0
S-2	09/07/1999	<2,000	248	<20.0	<20.0	<20.0	22,800	NA	NA	NA	NA	NA	98.92	3.66	95.26	1.8
S-2	02/02/2000	103	0.825	<0.500	<0.500	<0.500	11,700	10,500	NA	NA	NA	NA	98.92	4.02	94.90	2.0
S-2	04/26/2000	4,040	799	<20.0	40.9	255	19,000	17,100 b	NA	NA	NA	NA	98.92	2.63	96.29	2.3
S-2	07/25/2000	1,120	195	5.94	5.62	11.3	26,600	21,100	NA	NA	NA	NA	98.92	3.42	95.50	0.6
S-2 b	11/15/2000	613	35.6	<5.00	<5.00	7.36	18,100	17,800	NA	NA	NA	NA	98.92	3.31	95.61	1.8
S-2	02/12/2001	9,010	1,430	<20.0	219	848	28,300	17,000	NA	NA	NA	NA	98.92	1.47	97.45	2.0
S-2	06/07/2001	31,000	1,000	<25	630	3,200	NA	17,000	NA	NA	NA	NA	98.92	3.43	95.49	10.4
S-2	08/31/2001	50,000	950	<20	1,500	6,000	NA	17,000	NA	NA	NA	NA	98.92	4.72	94.20	0.9
S-2	12/05/2001	49,000	590	7.2	1,400	4,900	NA	11,000	NA	NA	NA	NA	98.92	1.53	97.39	NA
S-2	01/31/2002	37,000	860	<25	1,100	4,000	NA	14,000	NA	NA	NA	NA	98.92	2.13	96.79	NA
S-2	06/04/2002	150,000	800	<20	1,200	4,000	NA	9,200	NA	NA	NA	NA	98.92	2.24	96.68	NA
S-2	07/25/2002	37,000	350	<20	660	2,400	NA	10,000	NA	NA	NA	NA	98.92	2.03	96.89	NA
S-2	11/14/2002	25,000	510	<25	590	2,000	NA	10,000	NA	NA	NA	NA	180.79	3.17	177.62	NA
S-2	01/02/2003	NA	710	<25	560	2,074	NA	NA	NA	NA	NA	NA	180.79	2.15	178.64	NA
S-2	01/30/2003	21,000	670	<20	360	1,200	NA	9,300	NA	NA	NA	NA	180.79	2.09	178.70	NA
S-2	06/03/2003	42,000	800	<50	660	1,500	NA	9,600	NA	NA	NA	NA	180.79	3.08	177.71	NA
S-2	08/27/2003	31,000	630	<100	510	1,200	NA	15,000	NA	NA	NA	NA	180.79	2.55	178.24	NA
S-2	11/25/2003 d	8,400 a	<50	<50	<50	<100	NA	4,500	NA	NA	NA	NA	180.79	NA	NA	NA
S-2	02/05/2004	Well inaccessible		NA	NA	NA	NA	NA	NA	NA	NA	NA	180.79	NA	NA	NA
S-2	02/10/2004 d	<2,500	130	<25	<25	<50	NA	3,800	NA	NA	NA	NA	180.79	NA	NA	NA
S-2	04/21/2004	4,700	100	<25	<25	<50	NA	2,900	NA	NA	NA	NA	180.79	7.38	173.41	NA
S-2	08/12/2004	2,600	63	<13	<13	<25	NA	1,400	<50	<50	<50	1,200	180.79	e	NA	NA

WELL CONCENTRATIONS
Shell-branded Service Station
5755 Broadway
Oakland, CA

Well ID	Date	TPPH (ug/L)	B (ug/L)	T (ug/L)	E (ug/L)	X (ug/L)	MTBE 8020 (ug/L)	MTBE 8260 (ug/L)	DIPE (ug/L)	ETBE (ug/L)	TAME (ug/L)	TBA (ug/L)	TOC (MSL)	Depth to Water (ft.)	GW Elevation (MSL)	DO Reading (ppm)
S-2	11/08/2004	3,600	<25	<25	<25	<50	NA	1,300	NA	NA	NA	NA	180.79	f	NA	NA
S-2	05/16/2005	73 g	<0.50	<0.50	<0.50	<1.0	NA	3.3	NA	NA	NA	NA	180.79	3.33	177.46	NA
S-2	08/16/2005	10,000	370	<13	60	63	NA	1,300	<50	<50	<50	2,900	180.79	4.03	176.76	NA
S-2	11/03/2005	1,010	31.4	<0.500	2.81	31.4	NA	349	NA	NA	NA	880	180.79	NA	NA	NA
S-2	02/16/2006	5,350	79.0	<0.500	2.90	59.5	NA	687	NA	NA	NA	690	180.79	5.86	174.93	NA
S-2	05/05/2006	5,240	148	<0.500	17.1	48.8	NA	815	NA	NA	NA	478	180.79	NA	NA	NA
S-2	08/21/2006	4,640	162	0.910	25.8	27.2	NA	519	<0.500	<0.500	0.780	711	180.79	4.72	176.07	NA
S-2	11/13/2006	2,100	200	<5.0	58	21	NA	820	NA	NA	NA	1,300	180.79	3.44	177.35	NA
S-2	01/30/2007	3,300	250	<5.0	59	17	NA	1,100	NA	NA	NA	1,600	180.79	2.32	178.47	NA
S-2	05/23/2007	4,600 h	410	2.3 i	92	24.8 i	NA	890	NA	NA	NA	620	180.79	2.61	178.18	NA
S-2	08/09/2007	4,100 h	320	<10	30	11	NA	650	<20	<20	<20	1,400	180.79	3.72	177.07	NA
S-2	11/13/2007	4,900 h	230	<10	33	12	NA	540	<20	<20	<20	590	180.79	2.31	178.48	NA
S-2	02/13/2008	4,800 h	560	<10	67	37	NA	1,500	NA	NA	NA	610	180.79	1.83	178.96	NA
S-2	05/20/2008	5,400	340	<10	11	17	NA	460	NA	NA	NA	310	180.79	2.90	177.89	NA

S-3	01/25/1991	<30	<0.3	<0.3	<0.3	<0.3	NA	NA	NA	NA	NA	NA	101.67	3.84	97.83	NA
S-3	06/03/1991	<30	<0.3	0.3	0.3	0.3	NA	NA	NA	NA	NA	NA	101.67	3.25	98.42	NA
S-3	08/03/1991	<30	<0.3	<0.3	<0.3	<0.3	NA	NA	NA	NA	NA	NA	101.67	4.73	96.94	NA
S-3	11/22/1991	<30	<0.3	<0.3	<0.3	<0.3	NA	NA	NA	NA	NA	NA	101.67	4.81	96.86	NA
S-3	03/13/1992	<30	<0.3	0.3	0.3	0.3	NA	NA	NA	NA	NA	NA	101.67	2.29	99.38	NA
S-3	05/28/1992	<50	<0.5	<0.5	<0.5	<0.5	NA	NA	NA	NA	NA	NA	101.67	3.62	98.05	NA
S-3	08/19/1992	<50	<0.5	<0.5	<0.5	0.5	NA	NA	NA	NA	NA	NA	101.67	4.66	97.01	NA
S-3	11/18/1992	<50	<0.5	<0.5	<0.5	<0.5	NA	NA	NA	NA	NA	NA	101.67	4.51	97.16	NA
S-3	02/10/1993	30	1.9	3.2	2.4	5.6	NA	NA	NA	NA	NA	NA	101.67	4.36	97.31	NA
S-3	06/11/1993	<50	<0.5	<0.5	<0.5	<0.5	NA	NA	NA	NA	NA	NA	101.67	2.91	98.76	NA
S-3 (D)	06/11/1993	<50	<0.5	<0.5	<0.5	<0.5	NA	NA	NA	NA	NA	NA	101.67	2.91	98.76	NA
S-3	08/03/1993	<50	<0.5	<0.5	<0.5	<0.5	NA	NA	NA	NA	NA	NA	101.67	3.70	97.97	NA
S-3	11/02/1993	Well inaccessible		NA	NA	NA	NA	NA	NA	NA	NA	NA	101.67	NA	NA	NA

WELL CONCENTRATIONS
Shell-branded Service Station
5755 Broadway
Oakland, CA

Well ID	Date	TPPH (ug/L)	B (ug/L)	T (ug/L)	E (ug/L)	X (ug/L)	MTBE 8020 (ug/L)	MTBE 8260 (ug/L)	DIPE (ug/L)	ETBE (ug/L)	TAME (ug/L)	TBA (ug/L)	TOC (MSL)	Depth to Water (ft.)	GW Elevation (MSL)	DO Reading (ppm)
S-3	12/16/1993	NA	NA	NA	NA	NA	NA	NA	NA	NA	NA	NA	101.67	2.12	99.55	NA
S-3	02/01/1994	<50	<0.5	<0.5	<0.5	<0.5	NA	NA	NA	NA	NA	NA	101.67	2.90	98.77	NA
S-3	05/04/1994	<50	<0.5	<0.5	<0.5	<0.5	NA	NA	NA	NA	NA	NA	101.67	2.54	99.13	NA
S-3	08/18/1994	<50	<0.5	<0.5	<0.5	<0.5	NA	NA	NA	NA	NA	NA	101.67	3.51	98.16	NA
S-3	11/09/1994	<50	<0.5	<0.5	<0.5	<0.5	NA	NA	NA	NA	NA	NA	101.67	2.44	99.23	NA
S-3	02/22/1995	80	<0.5	0.5	<0.5	0.5	NA	NA	NA	NA	NA	NA	101.67	4.12	97.55	NA
S-3	05/02/1995	<50	<0.5	<0.5	<0.5	<0.5	NA	NA	NA	NA	NA	NA	101.67	2.83	98.84	NA
S-3	08/30/1995	<50	0.5	<0.5	<0.5	<0.5	NA	NA	NA	NA	NA	NA	101.67	3.16	98.51	NA
S-3	11/28/1995	<50	<0.5	<0.5	<0.5	<0.5	NA	NA	NA	NA	NA	NA	101.67	3.87	97.80	NA
S-3	02/02/1996	<50	<0.5	<0.5	<0.5	<0.5	NA	NA	NA	NA	NA	NA	101.67	2.24	99.43	NA
S-3	03/09/1996	<50	<0.5	<0.5	<0.5	<0.5	NA	NA	NA	NA	NA	NA	101.67	3.05	98.62	NA
S-3	08/22/1996	<50	0.8	<0.5	<0.5	<0.5	<2.5	NA	NA	NA	NA	NA	101.67	2.85	98.82	4.6
S-3	11/07/1996	<50	<0.5	<0.5	<0.5	<0.5	<2.5	NA	NA	NA	NA	NA	101.67	3.35	98.32	4.6
S-3	02/20/1997	<50	<0.50	<0.50	<0.50	<0.50	<2.5	NA	NA	NA	NA	NA	101.67	3.00	98.67	1
S-3	05/30/1997	140	14	10	3.3	14	8.6	NA	NA	NA	NA	NA	101.67	3.00	98.67	8
S-3	08/21/1997	<50	<0.50	<0.50	<0.50	<0.50	<2.5	NA	NA	NA	NA	NA	101.67	2.94	98.73	3.3
S-3	11/03/1997	<50	<0.50	<0.50	<0.50	<0.50	<2.5	NA	NA	NA	NA	NA	101.67	3.36	98.31	2.4
S-3 (D)	11/03/1997	<50	<0.50	<0.50	<0.50	<0.50	<2.5	NA	NA	NA	NA	NA	101.67	3.36	98.31	2.4
S-3	01/20/1998	Well inaccessible		NA	NA	NA	NA	NA	NA	NA	NA	NA	101.67	NA	NA	NA
S-3	07/23/1998	NA	NA	NA	NA	NA	NA	NA	NA	NA	NA	NA	101.67	2.69	98.98	NA
S-3	02/16/1999	<50	<0.50	0.92	0.59	3.9	3.7	NA	NA	NA	NA	NA	101.67	2.20	99.47	2.8
S-3	09/07/1999	NA	NA	NA	NA	NA	NA	NA	NA	NA	NA	NA	101.67	2.81	98.86	NA
S-3	02/02/2000	<50.0	<0.500	<0.500	<0.500	<0.500	<5.00	NA	NA	NA	NA	NA	101.67	3.97	97.70	2.7
S-3	04/26/2000	NA	NA	NA	NA	NA	NA	NA	NA	NA	NA	NA	101.67	2.96	98.71	NA
S-3	07/25/2000	<50.0	<0.500	<0.500	<0.500	<0.500	<2.50	NA	NA	NA	NA	NA	101.67	3.00	98.67	0.8
S-3	11/15/2000	NA	NA	NA	NA	NA	NA	NA	NA	NA	NA	NA	101.67	2.86	98.81	NA
S-3	02/12/2001	<50.0	<0.500	<0.500	<0.500	<0.500	<2.50	NA	NA	NA	NA	NA	101.67	2.47	99.20	2.3
S-3	06/07/2001	NA	NA	NA	NA	NA	NA	NA	NA	NA	NA	NA	101.67	2.78	98.89	NA

WELL CONCENTRATIONS
Shell-branded Service Station
5755 Broadway
Oakland, CA

Well ID	Date	TPPH (ug/L)	B (ug/L)	T (ug/L)	E (ug/L)	X (ug/L)	MTBE 8020 (ug/L)	MTBE 8260 (ug/L)	DIPE (ug/L)	ETBE (ug/L)	TAME (ug/L)	TBA (ug/L)	TOC (MSL)	Depth to Water (ft.)	GW Elevation (MSL)	DO Reading (ppm)
S-3	08/31/2001	<50	<0.50	<0.50	<0.50	<0.50	NA	<5.0	NA	NA	NA	NA	101.67	3.94	97.73	0.5
S-3	12/05/2001	NA	NA	NA	NA	NA	NA	NA	NA	NA	NA	NA	101.67	2.05	99.62	NA
S-3	01/31/2002	<50	<0.50	<0.50	<0.50	<0.50	NA	<5.0	NA	NA	NA	NA	101.67	2.29	99.38	NA
S-3	06/04/2002	NA	NA	NA	NA	NA	NA	NA	NA	NA	NA	NA	101.67	2.56	99.11	NA
S-3	07/25/2002	<50	<0.50	<0.50	<0.50	<0.50	NA	<5.0	NA	NA	NA	NA	101.67	2.70	98.97	NA
S-3	11/14/2002	NA	NA	NA	NA	NA	NA	NA	NA	NA	NA	NA	183.54	3.43	180.11	NA
S-3	01/30/2003	<50	<0.50	<0.50	<0.50	<0.50	NA	<5.0	NA	NA	NA	NA	183.54	2.16	181.38	NA
S-3	01/30/2003	NA	NA	NA	NA	NA	NA	NA	NA	NA	NA	NA	183.54	2.65	180.89	NA
S-3	08/27/2003	<50	<0.50	<0.50	<0.50	<1.0	NA	0.55	NA	NA	NA	NA	183.54	2.75	180.79	NA
S-3	11/25/2003	NA	NA	NA	NA	NA	NA	NA	NA	NA	NA	NA	183.54	2.85	180.69	NA
S-3	02/05/2004	<50	<0.50	<0.50	<0.50	<1.0	NA	<0.50	NA	NA	NA	NA	183.54	2.04	181.50	NA
S-3	04/21/2004	NA	NA	NA	NA	NA	NA	NA	NA	NA	NA	NA	183.54	2.50	181.04	NA
S-3	08/12/2004	<50	<0.50	<0.50	<0.50	<1.0	NA	<0.50	<2.0	<2.0	<2.0	<5.0	183.54	3.91	179.63	NA
S-3	11/08/2004	NA	NA	NA	NA	NA	NA	NA	NA	NA	NA	NA	183.54	2.84	180.70	NA
S-3	05/16/2005	<50	<0.50	<0.50	<0.50	<1.0	NA	<0.50	NA	NA	NA	NA	183.54	3.05	180.49	NA
S-3	08/16/2005	<100	<1.0	<1.0	<1.0	<2.0	NA	<1.0	<4.0	<4.0	<4.0	<10	183.54	3.42	180.12	NA
S-3	11/03/2005	NA	NA	NA	NA	NA	NA	NA	NA	NA	NA	NA	183.54	4.09	179.45	NA
S-3	02/16/2006	<50.0	<0.500	<0.500	<0.500	<0.500	NA	<0.500	NA	NA	NA	NA	183.54	2.25	181.29	NA
S-3	05/05/2006	NA	NA	NA	NA	NA	NA	NA	NA	NA	NA	NA	183.54	2.27	181.27	NA
S-3	08/21/2006	<50.0	<0.500	<0.500	<0.500	<0.500	NA	<0.500	<0.500	<0.500	0.570	36.4	183.54	3.17	180.37	NA
S-3	11/13/2006	NA	NA	NA	NA	NA	NA	NA	NA	NA	NA	NA	183.54	3.42	180.12	NA
S-3	01/30/2007	<50	<0.50	<0.50	<0.50	<1.0	NA	<0.50	NA	NA	NA	NA	183.54	2.36	181.18	NA
S-3	05/23/2007	NA	NA	NA	NA	NA	NA	NA	NA	NA	NA	NA	183.54	2.65	180.89	NA
S-3	08/09/2007	<50 h	<0.50	<1.0	<1.0	<1.0	NA	<1.0	<2.0	<2.0	<2.0	<10	183.54	2.93	180.61	NA
S-3	11/13/2007	NA	NA	NA	NA	NA	NA	NA	NA	NA	NA	NA	183.54	2.04	181.50	NA
S-3	02/13/2008	<50 h	<0.50	<1.0	<1.0	<1.0	NA	<1.0	NA	NA	NA	NA	183.54	2.03	181.51	NA
S-3	05/20/2008	NA	NA	NA	NA	NA	NA	NA	NA	NA	NA	NA	183.54	2.75	180.79	NA

WELL CONCENTRATIONS
Shell-branded Service Station
5755 Broadway
Oakland, CA

Well ID	Date	TPPH (ug/L)	B (ug/L)	T (ug/L)	E (ug/L)	X (ug/L)	MTBE 8020 (ug/L)	MTBE 8260 (ug/L)	DIPE (ug/L)	ETBE (ug/L)	TAME (ug/L)	TBA (ug/L)	TOC (MSL)	Depth to Water (ft.)	GW Elevation (MSL)	DO Reading (ppm)
H-1	12/05/2001	150	<0.50	8.3	1.6	16	NA	52	NA	NA	NA	NA	NA	1.43	NA	NA
H-1	01/31/2002	3,200	12	<0.50	5.7	3.7	NA	650	NA	NA	NA	NA	NA	2.34	NA	NA
H-1	06/04/2002	280,000	<10	150	62	9,500	NA	<100	NA	NA	NA	NA	NA	2.56	NA	NA
H-1	07/25/2002	8,200	2.2	46	5.3	99	NA	<10	NA	NA	NA	NA	NA	2.83	NA	NA
H-1	11/14/2002	1,700	2.1	2.6	1.5	14	NA	380	NA	NA	NA	NA	180.63	3.74	176.89	NA
H-1	01/02/2003	NA	1.1	<0.50	<0.50	3.6	NA	NA	NA	NA	NA	NA	180.63	1.45	179.18	NA
H-1	01/30/2003	630	0.99	2.0	1.6	12	NA	21	NA	NA	NA	NA	180.63	2.10	178.53	NA
H-1	06/03/2003	55	<0.50	1.3	<0.50	2.4	NA	2.6	NA	NA	NA	NA	180.63	3.38	177.25	NA
H-1	08/27/2003	<50	0.55	<0.50	<0.50	1.2	NA	2.8	NA	NA	NA	NA	180.63	4.10	176.53	NA
H-1	11/25/2003	77 a	9.7	<0.50	<0.50	<1.0	NA	21	NA	NA	NA	NA	180.63	3.72	176.91	NA
H-1	02/05/2004	380	41	1.2	5.1	8.0	NA	21	NA	NA	NA	NA	180.63	1.69	178.94	NA
H-1	04/21/2004	640	27	0.63	2.0	2.3	NA	33	NA	NA	NA	NA	180.63	2.14	178.49	NA
H-1	08/12/2004	340	18	0.75	<0.50	1.7	NA	43	NA	NA	NA	NA	180.63	4.78	175.85	NA
H-1	11/08/2004	1,500	29	<1.0	1.7	<2.0	NA	57	NA	NA	NA	NA	180.63	4.17	176.46	NA
H-1	05/16/2005	150 g	<0.50	<0.50	<0.50	<1.0	NA	48	NA	NA	NA	NA	180.63	4.16	176.47	NA
H-1	08/16/2005	100 g	<0.50	<0.50	<0.50	<1.0	NA	57	NA	NA	NA	NA	180.63	4.66	175.97	NA
H-1	11/03/2005	<50.0	<0.500	<0.500	<0.500	<0.500	NA	12.1	NA	NA	NA	NA	180.63	5.13	175.50	NA
H-1	02/16/2006	4,230	<0.500	<0.500	37.7	80.5	NA	7.12	NA	NA	NA	NA	180.63	1.87	178.76	NA
H-1	05/05/2006	368	<0.500	<0.500	2.56	<0.500	NA	22.2	NA	NA	NA	NA	180.63	2.21	178.42	NA
H-1	08/21/2006	NA	NA	NA	NA	NA	NA	NA	NA	NA	NA	NA	180.63	4.62	176.01	NA
H-1	11/13/2006	NA	NA	NA	NA	NA	NA	NA	NA	NA	NA	NA	180.63	3.89	176.74	NA
H-1	01/30/2007	NA	NA	NA	NA	NA	NA	NA	NA	NA	NA	NA	180.63	3.04	177.59	NA
H-1	05/23/2007	330 h	7.9	0.32 i	0.48 i	0.61 i	NA	74	NA	NA	NA	NA	180.63	3.38	177.25	NA
H-1	08/09/2007	NA	NA	NA	NA	NA	NA	NA	NA	NA	NA	NA	180.63	4.30	176.33	NA
H-1	11/13/2007	NA	NA	NA	NA	NA	NA	NA	NA	NA	NA	NA	180.63	1.97	178.66	NA
H-1	02/13/2008	NA	NA	NA	NA	NA	NA	NA	NA	NA	NA	NA	180.63	1.78	178.85	NA
H-1	05/20/2008	230	19	<1.0	2.8	2.2	NA	23	NA	NA	NA	NA	180.63	3.60	177.03	NA

WELL CONCENTRATIONS
Shell-branded Service Station
5755 Broadway
Oakland, CA

Well ID	Date	TPPH (ug/L)	B (ug/L)	T (ug/L)	E (ug/L)	X (ug/L)	MTBE 8020 (ug/L)	MTBE 8260 (ug/L)	DIPE (ug/L)	ETBE (ug/L)	TAME (ug/L)	TBA (ug/L)	TOC (MSL)	Depth to Water (ft.)	GW Elevation (MSL)	DO Reading (ppm)
T-1	05/30/1997	NA	NA	NA	NA	NA	NA	NA	NA	NA	NA	NA	NA	2.65	NA	NA
T-1	08/21/1997	NA	NA	NA	NA	NA	NA	NA	NA	NA	NA	NA	NA	2.69	NA	NA
T-1	11/03/1997	NA	NA	NA	NA	NA	NA	NA	NA	NA	NA	NA	NA	3.09	NA	NA
T-1	01/20/1998	NA	NA	NA	NA	NA	NA	NA	NA	NA	NA	NA	NA	0.61	NA	NA
T-1	07/23/1998	NA	NA	NA	NA	NA	NA	NA	NA	NA	NA	NA	NA	2.32	NA	NA
T-1	02/16/1999	NA	NA	NA	NA	NA	NA	NA	NA	NA	NA	NA	NA	1.95	NA	NA
T-1	09/07/1999	NA	NA	NA	NA	NA	NA	NA	NA	NA	NA	NA	NA	2.48	NA	NA
T-1	02/02/2000	<50.0	<0.500	<0.500	<0.500	<0.500	<5.00	NA	NA	NA	NA	NA	NA	2.66	NA	2.5
T-1	04/26/2000	NA	NA	NA	NA	NA	NA	NA	NA	NA	NA	NA	NA	2.56	NA	NA
T-1	07/25/2000	NA	NA	NA	NA	NA	NA	NA	NA	NA	NA	NA	NA	2.60	NA	NA
T-1	11/15/2000	NA	NA	NA	NA	NA	NA	NA	NA	NA	NA	NA	NA	2.47	NA	NA
T-1	02/12/2001	NA	NA	NA	NA	NA	NA	NA	NA	NA	NA	NA	NA	1.20	NA	NA
T-1	06/07/2001	NA	NA	NA	NA	NA	NA	NA	NA	NA	NA	NA	NA	2.36	NA	NA
T-1	08/31/2001	NA	NA	NA	NA	NA	NA	NA	NA	NA	NA	NA	NA	3.45	NA	NA
T-1	01/09/2002 c	NA	NA	NA	NA	NA	NA	NA	NA	NA	NA	NA	183.08	NA	NA	NA
T-2	05/30/1997	NA	NA	NA	NA	NA	NA	NA	NA	NA	NA	NA	NA	1.81	NA	NA
T-2	08/21/1997	NA	NA	NA	NA	NA	NA	NA	NA	NA	NA	NA	NA	1.89	NA	NA
T-2	11/03/1997	NA	NA	NA	NA	NA	NA	NA	NA	NA	NA	NA	NA	2.25	NA	NA
T-2	01/20/1998	NA	NA	NA	NA	NA	NA	NA	NA	NA	NA	NA	NA	0.55	NA	NA
T-2	07/23/1998	NA	NA	NA	NA	NA	NA	NA	NA	NA	NA	NA	NA	1.21	NA	NA
T-2	02/16/1999	NA	NA	NA	NA	NA	NA	NA	NA	NA	NA	NA	NA	1.08	NA	NA
T-2	09/07/1999	NA	NA	NA	NA	NA	NA	NA	NA	NA	NA	NA	NA	0.72	NA	NA
T-2	02/02/2000	1,540	53.4	20.8	11.4	21.8	1,330	NA	NA	NA	NA	NA	NA	0.98	NA	3.0
T-2	04/26/2000	NA	NA	NA	NA	NA	NA	NA	NA	NA	NA	NA	NA	1.02	NA	NA
T-2	07/25/2000	815	17.6	10.8	1.63	3.47	133	NA	NA	NA	NA	NA	NA	1.80	NA	0.8
T-2	11/15/2000	NA	NA	NA	NA	NA	NA	NA	NA	NA	NA	NA	NA	1.68	NA	NA
T-2	02/12/2001	310	7.48	7.76	0.693	2.28	301	NA	NA	NA	NA	NA	NA	1.45	NA	1.6

WELL CONCENTRATIONS
Shell-branded Service Station
5755 Broadway
Oakland, CA

Well ID	Date	TPPH (ug/L)	B (ug/L)	T (ug/L)	E (ug/L)	X (ug/L)	MTBE 8020 (ug/L)	MTBE 8260 (ug/L)	DIPE (ug/L)	ETBE (ug/L)	TAME (ug/L)	TBA (ug/L)	TOC (MSL)	Depth to Water (ft.)	GW Elevation (MSL)	DO Reading (ppm)
T-2	06/07/2001	NA	NA	NA	NA	NA	NA	NA	NA	NA	NA	NA	NA	1.57	NA	NA
T-2	08/31/2001	720	30	0.67	<0.50	2.3	NA	540	NA	NA	NA	NA	NA	2.69	NA	0.8
T-2	12/05/2001	NA	NA	NA	NA	NA	NA	NA	NA	NA	NA	NA	NA	0.58	NA	NA
T-2	01/31/2002	NA	NA	NA	NA	NA	NA	NA	NA	NA	NA	NA	NA	1.32	NA	NA
T-2	02/04/2002	1,000	41	30	4.6	20	NA	1,200	NA	NA	NA	NA	NA	1.46	NA	NA
T-2	06/04/2002	NA	NA	NA	NA	NA	NA	NA	NA	NA	NA	NA	NA	1.50	NA	NA
T-2	07/25/2002	660	11	0.59	<0.50	2.6	NA	97	NA	NA	NA	NA	NA	1.53	NA	NA
T-2	11/14/2002	NA	NA	NA	NA	NA	NA	NA	NA	NA	NA	NA	182.30	2.39	179.91	NA
T-2	01/30/2003	560	11	<0.50	<0.50	0.53	NA	160	NA	NA	NA	NA	182.30	1.01	181.29	NA
T-2	06/03/2003	NA	NA	NA	NA	NA	NA	NA	NA	NA	NA	NA	182.30	1.55	180.75	NA
T-2	08/27/2003	180 a	1.6	<0.50	<0.50	<1.0	NA	10	NA	NA	NA	NA	182.30	1.60	180.70	NA
T-2	11/25/2003	NA	NA	NA	NA	NA	NA	NA	NA	NA	NA	NA	182.30	1.64	180.66	NA
T-2	02/05/2004	940	110	10	2.4	14	NA	67	NA	NA	NA	NA	182.30	0.66	181.64	NA
T-2	04/21/2004	NA	NA	NA	NA	NA	NA	NA	NA	NA	NA	NA	182.30	1.50	180.80	NA
T-2	08/12/2004	450	<0.50	<0.50	<0.50	<1.0	NA	33	NA	NA	NA	NA	182.30	2.72	179.58	NA
T-2	11/08/2004	NA	NA	NA	NA	NA	NA	NA	NA	NA	NA	NA	182.30	1.72	180.58	NA
T-3	05/30/1997	NA	NA	NA	NA	NA	NA	NA	NA	NA	NA	NA	NA	2.31	NA	NA
T-3	08/21/1997	NA	NA	NA	NA	NA	NA	NA	NA	NA	NA	NA	NA	1.57	NA	NA
T-3	11/03/1997	NA	NA	NA	NA	NA	NA	NA	NA	NA	NA	NA	NA	3.50	NA	NA
T-3	01/20/1998	NA	NA	NA	NA	NA	NA	NA	NA	NA	NA	NA	NA	0.76	NA	NA
T-3	07/23/1998	NA	NA	NA	NA	NA	NA	NA	NA	NA	NA	NA	NA	0.82	NA	NA
T-3	02/16/1999	NA	NA	NA	NA	NA	NA	NA	NA	NA	NA	NA	NA	0.55	NA	NA
T-3	09/07/1999	NA	NA	NA	NA	NA	NA	NA	NA	NA	NA	NA	NA	2.89	NA	NA
T-3	02/02/2000	<50.0	<0.500	<0.500	<0.500	<0.500	<5.00	NA	NA	NA	NA	NA	NA	3.02	NA	2.9
T-3	04/26/2000	NA	NA	NA	NA	NA	NA	NA	NA	NA	NA	NA	NA	2.81	NA	NA
T-3	07/25/2000	NA	NA	NA	NA	NA	NA	NA	NA	NA	NA	NA	NA	3.00	NA	NA
T-3	11/15/2000	NA	NA	NA	NA	NA	NA	NA	NA	NA	NA	NA	NA	1.70	NA	NA

WELL CONCENTRATIONS
Shell-branded Service Station
5755 Broadway
Oakland, CA

Well ID	Date	TPPH (ug/L)	B (ug/L)	T (ug/L)	E (ug/L)	X (ug/L)	MTBE 8020 (ug/L)	MTBE 8260 (ug/L)	DIPE (ug/L)	ETBE (ug/L)	TAME (ug/L)	TBA (ug/L)	TOC (MSL)	Depth to Water (ft.)	GW Elevation (MSL)	DO Reading (ppm)
T-3	02/12/2001	NA	NA	NA	NA	NA	NA	NA	NA	NA	NA	NA	NA	2.11	NA	NA
T-3	06/07/2001	NA	NA	NA	NA	NA	NA	NA	NA	NA	NA	NA	NA	1.68	NA	NA
T-3	08/31/2001	NA	NA	NA	NA	NA	NA	NA	NA	NA	NA	NA	NA	3.14	NA	NA
T-3	01/09/2002 c	NA	NA	NA	NA	NA	NA	NA	NA	NA	NA	NA	180.95	NA	NA	NA

Abbreviations:

TPPH = Total petroleum hydrocarbons as gasoline by EPA Method 8260B; prior to June 7, 2001, analyzed by EPA Method 8015.

BTEX = Benzene, toluene, ethylbenzene, xylenes by EPA Method 8260B; prior to June 7, 2001, analyzed by EPA Method 8020.

MTBE = Methyl tertiary butyl ether

DIPE = Di-isopropyl ether, analyzed by EPA Method 8260B

ETBE = Ethyl tertiary butyl ether, analyzed by EPA Method 8260B

TAME = Tertiary amyl methyl ether, analyzed by EPA Method 8260B

TBA = Tertiary butyl alcohol, analyzed by EPA Method 8260B

TOC = Top of Casing Elevation

SPH = Separate-Phase Hydrocarbons

GW = Groundwater

DO = Dissolved Oxygen

ug/L = Parts per billion

ppm = Parts per million

MSL = Mean sea level

ft. = Feet

<n = Below detection limit

(D) = Duplicate sample

NA = Not applicable

WELL CONCENTRATIONS
Shell-branded Service Station
5755 Broadway
Oakland, CA

Well ID	Date	TPPH (ug/L)	B (ug/L)	T (ug/L)	E (ug/L)	X (ug/L)	MTBE 8020 (ug/L)	MTBE 8260 (ug/L)	DIPE (ug/L)	ETBE (ug/L)	TAME (ug/L)	TBA (ug/L)	TOC (MSL)	Depth to Water (ft.)	GW Elevation (MSL)	DO Reading (ppm)
---------	------	----------------	-------------	-------------	-------------	-------------	------------------------	------------------------	----------------	----------------	----------------	---------------	--------------	----------------------------	--------------------------	------------------------

- Notes:
- a = Chromatogram pattern indicated an unidentified hydrocarbon/Hydrocarbon does not match pattern of laboratory's standard.
 - b = This sample analyzed outside of EPA recommended hold time.
 - c = Survey date only.
 - d = Sampled by client; Cambria Environmental.
 - e = Unable to gauge depth to water due to extraction tubing.
 - f = Unable to gauge.
 - g = Quantity of unknown hydrocarbon(s) in sample based on gasoline.
 - h = Analyzed by EPA Method 8015B (M).
 - i = Analyte was detected at a concentration below the reporting limit and above the laboratory method detection limit. Reported value is estimated.
- Site surveyed January 9, 2002 by Virgil Chavez Land Surveying of Vallejo, CA.

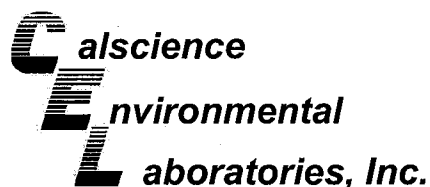

June 02, 2008

Michael Ninokata
Blaine Tech Services, Inc.
1680 Rogers Avenue
San Jose, CA 95112-1105

Subject: **Calscience Work Order No.: 08-05-1996**
Client Reference: **5755 Broadway, Oakland, CA**

Dear Client:

Enclosed is an analytical report for the above-referenced project. The samples included in this report were received 5/22/2008 and analyzed in accordance with the attached chain-of-custody.

Unless otherwise noted, all analytical testing was accomplished in accordance with the guidelines established in our Quality Systems Manual, applicable standard operating procedures, and other related documentation. The original report of subcontracted analysis, if any, is provided herein, and follows the standard Calscience data package. The results in this analytical report are limited to the samples tested and any reproduction thereof must be made in its entirety.

If you have any questions regarding this report, please do not hesitate to contact the undersigned.

Sincerely,

A handwritten signature in black ink, appearing to read "Jessie Kim". The signature is fluid and cursive, with a large loop at the end.

Calscience Environmental
Laboratories, Inc.
Jessie Kim
Project Manager

Analytical Report



Blaine Tech Services, Inc.
 1680 Rogers Avenue
 San Jose, CA 95112-1105

Date Received: 05/22/08
 Work Order No: 08-05-1996
 Preparation: EPA 5030B
 Method: LUFT GC/MS / EPA 8260B
 Units: ug/L

Project: 5755 Broadway, Oakland, CA

Page 1 of 1

Client Sample Number	Lab Sample Number	Date/Time Collected	Matrix	Instrument	Date Prepared	Date/Time Analyzed	QC Batch ID
H-1	08-05-1996-2-A	05/20/08 09:34	Aqueous	GC/MS R	05/24/08	05/25/08 03:39	080524L02

Parameter	Result	RL	DF	Qual	Parameter	Result	RL	DF	Qual
TPPH	230	50	1		p/m-Xylene	2.2	1.0	1	
Benzene	19	0.50	1		o-Xylene	ND	1.0	1	
Ethylbenzene	2.8	1.0	1		Methyl-t-Butyl Ether (MTBE)	23	1.0	1	
Toluene	ND	1.0	1						
Surrogates:	REC (%)	Control Limits		Qual	Surrogates:	REC (%)	Control Limits		Qual
1,4-Bromofluorobenzene	92	70-130			1,4-Bromofluorobenzene-TPPH	97	70-130		

Method Blank	Lab Sample Number	Date/Time Collected	Matrix	Instrument	Date Prepared	Date/Time Analyzed	QC Batch ID
Method Blank	099-12-715-402	N/A	Aqueous	GC/MS R	05/24/08	05/25/08 01:38	080524L02

Parameter	Result	RL	DF	Qual	Parameter	Result	RL	DF	Qual
TPPH	ND	50	1		p/m-Xylene	ND	1.0	1	
Benzene	ND	0.50	1		o-Xylene	ND	1.0	1	
Ethylbenzene	ND	1.0	1		Methyl-t-Butyl Ether (MTBE)	ND	1.0	1	
Toluene	ND	1.0	1						
Surrogates:	REC (%)	Control Limits		Qual	Surrogates:	REC (%)	Control Limits		Qual
1,4-Bromofluorobenzene	89	70-130			1,4-Bromofluorobenzene-TPPH	93	70-130		

RL - Reporting Limit , DF - Dilution Factor , Qual - Qualifiers

Analytical Report

 Blaine Tech Services, Inc.
 1680 Rogers Avenue
 San Jose, CA 95112-1105

 Date Received: 05/22/08
 Work Order No: 08-05-1996
 Preparation: EPA 5030B
 Method: LUFT GC/MS / EPA 8260B
 Units: ug/L

Project: 5755 Broadway, Oakland, CA

Page 1 of 1

Client Sample Number	Lab Sample Number	Date/Time Collected	Matrix	Instrument	Date Prepared	Date/Time Analyzed	QC Batch ID
S-2	08-05-1996-1-A	05/20/08 10:25	Aqueous	GC/MS R	05/24/08	05/25/08 04:09	080524L02

Parameter	Result	RL	DF	Qual	Parameter	Result	RL	DF	Qual
TPPH	5400	500	10		p/m-Xylene	17	10	10	
Benzene	340	5.0	10		o-Xylene	ND	10	10	
Ethylbenzene	11	10	10		Methyl-t-Butyl Ether (MTBE)	460	10	10	
Toluene	ND	10	10		Tert-Butyl Alcohol (TBA)	310	100	10	
Surrogates:	REC (%)	Control Limits		Qual	Surrogates:	REC (%)	Control Limits		Qual
1,4-Bromofluorobenzene	92	70-130			1,4-Bromofluorobenzene-TPPH	95	70-130		

Method Blank	Lab Sample Number	Date/Time Collected	Matrix	Instrument	Date Prepared	Date/Time Analyzed	QC Batch ID
Method Blank	099-12-715-402	N/A	Aqueous	GC/MS R	05/24/08	05/25/08 01:38	080524L02

Parameter	Result	RL	DF	Qual	Parameter	Result	RL	DF	Qual
TPPH	ND	50	1		p/m-Xylene	ND	1.0	1	
Benzene	ND	0.50	1		o-Xylene	ND	1.0	1	
Ethylbenzene	ND	1.0	1		Methyl-t-Butyl Ether (MTBE)	ND	1.0	1	
Toluene	ND	1.0	1		Tert-Butyl Alcohol (TBA)	ND	10	1	
Surrogates:	REC (%)	Control Limits		Qual	Surrogates:	REC (%)	Control Limits		Qual
1,4-Bromofluorobenzene	89	70-130			1,4-Bromofluorobenzene-TPPH	93	70-130		

RL - Reporting Limit , DF - Dilution Factor , Qual - Qualifiers

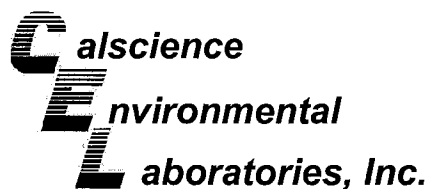

Quality Control - Spike/Spike Duplicate



Blaine Tech Services, Inc.
1680 Rogers Avenue
San Jose, CA 95112-1105

Date Received: 05/22/08
Work Order No: 08-05-1996
Preparation: EPA 5030B
Method: LUFT GC/MS / EPA
8260B

Project 5755 Broadway, Oakland, CA

Quality Control Sample ID	Matrix	Instrument	Date Prepared	Date Analyzed	MS/MSD Batch Number
08-05-2069-4	Aqueous	GC/MS R	05/24/08	05/25/08	080524S01

Parameter	MS %REC	MSD %REC	%REC CL	RPD	RPD CL	Qualifiers
Benzene	104	106	70-130	2	0-30	
Ethylbenzene	104	105	70-130	0	0-30	
Toluene	104	105	70-130	1	0-30	
p/m-Xylene	102	103	70-130	0	0-30	
o-Xylene	102	103	70-130	1	0-30	
Methyl-t-Butyl Ether (MTBE)	92	95	70-130	3	0-30	
Tert-Butyl Alcohol (TBA)	83	83	70-130	0	0-30	
Diisopropyl Ether (DIPE)	96	100	70-130	4	0-30	
Ethyl-t-Butyl Ether (ETBE)	86	90	70-130	4	0-30	
Tert-Amyl-Methyl Ether (TAME)	86	90	70-130	4	0-30	
Ethanol	91	93	70-130	3	0-30	

RPD - Relative Percent Difference , CL - Control Limit

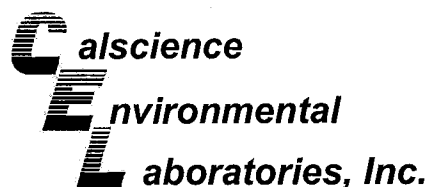

Quality Control - LCS/LCS Duplicate



Blaine Tech Services, Inc.
1680 Rogers Avenue
San Jose, CA 95112-1105

Date Received: N/A
Work Order No: 08-05-1996
Preparation: EPA 5030B
Method: LUFT GC/MS / EPA 8260B

Project: 5755 Broadway, Oakland, CA

Quality Control Sample ID	Matrix	Instrument	Date Prepared	Date Analyzed	LCS/LCSD Batch Number
099-12-715-402	Aqueous	GC/MS R	05/24/08	05/25/08	080524L02

Parameter	LCS %REC	LCSD %REC	%REC CL	RPD	RPD CL	Qualifiers
TPPH	93	89	65-135	4	0-30	
Benzene	105	106	70-130	1	0-30	
Ethylbenzene	107	106	70-130	0	0-30	
Toluene	105	106	70-130	1	0-30	
p/m-Xylene	105	105	70-130	0	0-30	
o-Xylene	102	104	70-130	1	0-30	
Methyl-t-Butyl Ether (MTBE)	83	88	70-130	5	0-30	
Tert-Butyl Alcohol (TBA)	84	86	70-130	2	0-30	
Diisopropyl Ether (DIPE)	87	89	70-130	2	0-30	
Ethyl-t-Butyl Ether (ETBE)	77	86	70-130	11	0-30	
Tert-Amyl-Methyl Ether (TAME)	81	86	70-130	6	0-30	
Ethanol	97	96	70-130	1	0-30	

RPD - Relative Percent Difference, CL - Control Limit

Work Order Number: 08-05-1996

<u>Qualifier</u>	<u>Definition</u>
*	See applicable analysis comment.
1	Surrogate compound recovery was out of control due to a required sample dilution, therefore, the sample data was reported without further clarification.
2	Surrogate compound recovery was out of control due to matrix interference. The associated method blank surrogate spike compound was in control and, therefore, the sample data was reported without further clarification.
3	Recovery of the Matrix Spike (MS) or Matrix Spike Duplicate (MSD) compound was out of control due to matrix interference. The associated LCS and/or LCSD was in control and, therefore, the sample data was reported without further clarification.
4	The MS/MSD RPD was out of control due to matrix interference. The LCS/LCSD RPD was in control and, therefore, the sample data was reported without further clarification.
5	The PDS/PDSD associated with this batch of samples was out of control due to a matrix interference effect. The associated batch LCS/LCSD was in control and, hence, the associated sample data was reported with no further corrective action required.
A	Result is the average of all dilutions, as defined by the method.
B	Analyte was present in the associated method blank.
C	Analyte presence was not confirmed on primary column.
E	Concentration exceeds the calibration range.
H	Sample received and/or analyzed past the recommended holding time.
J	Analyte was detected at a concentration below the reporting limit and above the laboratory method detection limit. Reported value is estimated.
N	Nontarget Analyte.
ND	Parameter not detected at the indicated reporting limit.
Q	Spike recovery and RPD control limits do not apply resulting from the parameter concentration in the sample exceeding the spike concentration by a factor of four or greater.
U	Undetected at the laboratory method detection limit.
X	% Recovery and/or RPD out-of-range.
Z	Analyte presence was not confirmed by second column or GC/MS analysis.

LAB (LOCATION)

- CALSCIENCE ()
- SPL ()
- XENCO ()
- TEST AMERICA ()
- OTHER ()



Shell Oil Products Chain Of Custody Record

Please Check Appropriate Box:

<input checked="" type="checkbox"/> ENV. SERVICES	<input type="checkbox"/> MOTIVA RETAIL	<input type="checkbox"/> SHELL RETAIL
<input type="checkbox"/> MOTIVA SD&CM	<input type="checkbox"/> CONSULTANT	<input type="checkbox"/> LUBES
<input type="checkbox"/> SHELL PIPELINE	<input type="checkbox"/> OTHER	

Print Bill To Contact Name: Denis Brown

INCIDENT # (ENV SERVICES): 9 8 9 9 5 7 5 6

PO #: **SAP #:**

CHECK IF NO INCIDENT # APPLIES

DATE: 05-20-08

PAGE: 1 of 1

SAMPLING COMPANY: Blaine Tech Services

LOG CODE: BTSS

ADDRESS: 1680 Rogers Ave, San Jose, CA 95112

PROJECT CONTACT (Hardcopy or PDF Report to): Michael Ninokata

TELEPHONE: (408)573-0555 FAX: (408)573-7774 E-MAIL: mnlnokata@blainetech.com

TURNAROUND TIME (CALENDAR DAYS):

STANDARD (14 DAY) 5 DAYS 3 DAYS 2 DAYS 24 HOURS RESULTS NEEDED ON WEEKEND

LA - RWQCB REPORT FORMAT UST AGENCY:

SITE ADDRESS: Street and City: 5755 Broadway, Oakland

State: CA **GLOBAL ID NO:** T0600101270

EDF DELIVERABLE TO (Name, Company, Office Location): Anni Kremi, CRA, Emeryville

PHONE NO.: (510) 420-3335 **E-MAIL:** Shelledf@cravorld.com

CONSULTANT PROJECT NO: BTS # 080520-1M1

SAMPLER NAME(S) (Print): M. Todi

LAB USE ONLY: 05-1996

SPECIAL INSTRUCTIONS OR NOTES :

SHELL CONTRACT RATE APPLIES

STATE REIMBURSEMENT RATE APPLIES

EDD NOT NEEDED

RECEIPT VERIFICATION REQUESTED

LAB USE ONLY	Field Sample Identification	SAMPLING		MATRIX	PRESERVATIVE					NO. OF CONT.	REQUESTED ANALYSIS											TEMPERATURE ON RECEIPT °C	Container PID Readings or Laboratory Notes				
		DATE	TIME		HCL	HNO3	H2SO4	NONE	OTHER		TPH - Purgeable (8260B)	TPH - Extractable (8015M)	BTEX (8260B)	5 Oxygenates (8260B)	MTBE (8260B)	TBA (8260B)	DIPE (8260B)	TAME (8260B)	ETBE (8260B)	1,2 DCA (8260B)	EDB (8260B)			Ethanol (8260B)	Methanol (8015M)		
1	S-2	5/20/08	1025	U						3	X	X	X	X													
2	H-1	5/21/08	0934	U						3	X	X	X														

Relinquished by: (Signature) <i>[Signature]</i>	Received by: (Signature) <i>[Signature]</i> (Sample Custodian)	Date: 05-20-08	Time: 17:10
Relinquished by: (Signature) <i>[Signature]</i> (Sample Custodian)	Received by: (Signature) Tom O'Malley CEC	Date: 5/21/08	Time: 1005
Relinquished by: (Signature) Tom O'Malley TO 650 1730 509618440	Received by: (Signature) <i>[Signature]</i>	Date: 5/22/08	Time: 1030

05/2/06 Revision

WORK ORDER #: **08** - **0** **5** - **1** **9** **9** **6**

Cooler 1 of 1

SAMPLE RECEIPT FORM

CLIENT: Blaine Tech

DATE: 5/22/08

TEMPERATURE – SAMPLES RECEIVED BY:

CALSCIENCE COURIER:

- Chilled, cooler with temperature blank provided.
- Chilled, cooler without temperature blank.
- Chilled and placed in cooler with wet ice.
- Ambient and placed in cooler with wet ice.
- Ambient temperature.
- °C Temperature blank.

LABORATORY (Other than Calscience Courier):

- 3.8 °C Temperature blank.
- °C IR thermometer.
- Ambient temperature.

Initial: JP

CUSTODY SEAL INTACT:

Sample(s): _____ Cooler: _____ No (Not Intact) : _____ Not Present:

Initial: JP

SAMPLE CONDITION:

	Yes	No	N/A
Chain-Of-Custody document(s) received with samples.....	<input checked="" type="checkbox"/>	<input type="checkbox"/>	<input type="checkbox"/>
Sampler's name indicated on COC.....	<input checked="" type="checkbox"/>	<input type="checkbox"/>	<input type="checkbox"/>
Sample container label(s) consistent with custody papers.....	<input checked="" type="checkbox"/>	<input type="checkbox"/>	<input type="checkbox"/>
Sample container(s) intact and good condition.....	<input checked="" type="checkbox"/>	<input type="checkbox"/>	<input type="checkbox"/>
Correct containers and volume for analyses requested.....	<input checked="" type="checkbox"/>	<input type="checkbox"/>	<input type="checkbox"/>
Proper preservation noted on sample label(s).....	<input checked="" type="checkbox"/>	<input type="checkbox"/>	<input type="checkbox"/>
VOA vial(s) free of headspace.....	<input checked="" type="checkbox"/>	<input type="checkbox"/>	<input type="checkbox"/>
Tedlar bag(s) free of condensation.....	<input type="checkbox"/>	<input type="checkbox"/>	<input checked="" type="checkbox"/>

Initial: JP

COMMENTS:

WELL GAUGING DATA

Project # 080520-MTI

Date 05-20-08

Client Shell

Site 5755 Broadway Oakland, CA

Well ID	Time	Well Size (in.)	Sheen / Odor	Depth to Immiscible Liquid (ft.)	Thickness of Immiscible Liquid (ft.)	Volume of Immiscibles Removed (ml)	Depth to water (ft.)	Depth to well bottom (ft.)	Survey Point: TOB or TOC	Notes
S-1	0900	3"					1.00	11.20	↓	GO
S-2	0911	4"				2.90	9.45			
S-3	0855	4"				2.75	9.50	GO		
H1	0905	4"				3.60	11.98			

SHELL WELL MONITORING DATA SHEET

BTS #: 080520-MT1	Site: 5755 Broadway, Oakland
Sampler: MT	Date: 05-20-08
Well I.D.: H1	Well Diameter: 2 3 (4) 6 8 ____
Total Well Depth (TD): 11.98	Depth to Water (DTW): 3.60
Depth to Free Product:	Thickness of Free Product (feet):
Referenced to: (PVC) Grade	D.O. Meter (if req'd): YSI HACH
DTW with 80% Recharge [(Height of Water Column x 0.20) + DTW]: 5.27	

Purge Method: Bailer
 Disposable Bailer
 Positive Air Displacement
 Electric Submersible

Watera
 Peristaltic
 Extraction Pump
 Other _____

Sampling Method: Bailer
 Disposable Bailer
 Extraction Port
 Dedicated Tubing
 Other: _____

5.4 (Gals.) X 3 = 16.2 Gals.
 1 Case Volume Specified Volumes Calculated Volume

Well Diameter	Multiplier	Well Diameter	Multiplier
1"	0.04	4"	0.65
2"	0.16	6"	1.47
3"	0.37	Other	radius ² * 0.163

Time	Temp (°F)	pH	Cond. (mS or <u>(µS)</u>)	Turbidity (NTUs)	Gals. Removed	Observations
0923	66.9	6.6 ³	487.6	6.22	5.4	
0925	67.1	7.24	454.8	3.79	10.8	
0926	67.0	7.41	460.4	3.35	16.2	

Did well dewater? Yes No Gallons actually evacuated: **16.2**

Sampling Date: **05-20-08** Sampling Time: **0934** Depth to Water: **4.05**

Sample I.D.: **H-1** Laboratory: **STL** Other **CAL Science**

Analyzed for: **TPH-G** **BTEX** **MTBE** **TPH-D** Other: _____

EB I.D. (if applicable): _____ Time Duplicate I.D. (if applicable): _____

Analyzed for: **TPH-G** **BTEX** **MTBE** **TPH-D** Other: _____

D.O. (if req'd): Pre-purge: _____ mg/L Post-purge: _____ mg/L

O.R.P. (if req'd): Pre-purge: _____ mV Post-purge: _____ mV

SHELL WELL MONITORING DATA SHEET

BTS #: <u>080520-MT1</u>	Site: <u>5755 Broadway, Oakland</u>
Sampler: <u>MT</u>	Date: <u>05-20-08</u>
Well I.D.: <u>S-2</u>	Well Diameter: 2 3 <u>4</u> 6 8 _____
Total Well Depth (TD): <u>9.45</u>	Depth to Water (DTW): <u>2.90</u>
Depth to Free Product:	Thickness of Free Product (feet):
Referenced to: <u>PVC</u> Grade	D.O. Meter (if req'd): YSI HACH
DTW with 80% Recharge [(Height of Water Column x 0.20) + DTW]: <u>4.21</u>	

Purge Method: Bailer Watertra Sampling Method: Bailer
 Disposable Bailer Peristaltic Disposable Bailer
 Positive Air Displacement Extraction Pump Extraction Port
 Electric Submersible Other _____ Dedicated Tubing

$\underline{4.2} \text{ (Gals.)} \times \underline{3} = \underline{12.6} \text{ Gals.}$ 1 Case Volume Specified Volumes Calculated Volume	<table border="1" style="width: 100%; border-collapse: collapse;"> <tr> <th>Well Diameter</th> <th>Multiplier</th> <th>Well Diameter</th> <th>Multiplier</th> </tr> <tr> <td>1"</td> <td>0.04</td> <td>4"</td> <td>0.65</td> </tr> <tr> <td>2"</td> <td>0.16</td> <td>6"</td> <td>1.47</td> </tr> <tr> <td>3"</td> <td>0.37</td> <td>Other</td> <td>radius² * 0.163</td> </tr> </table>	Well Diameter	Multiplier	Well Diameter	Multiplier	1"	0.04	4"	0.65	2"	0.16	6"	1.47	3"	0.37	Other	radius ² * 0.163
Well Diameter	Multiplier	Well Diameter	Multiplier														
1"	0.04	4"	0.65														
2"	0.16	6"	1.47														
3"	0.37	Other	radius ² * 0.163														

Time	Temp (°F)	pH	Cond. (mS or µS)	Turbidity (NTUs)	Gals. Removed	Observations
<u>0948</u>	<u>65.3</u>	<u>7.08</u>	<u>676.5</u>	<u>22.3</u>	<u>4.2</u>	
	<u>De-aerated @ 4.2 gls</u>			<u>0948</u>		
				<u>DTW @ 0951 7.05</u>		
<u>1025</u>	<u>64.7</u>	<u>7.15</u>	<u>660.4</u>	<u>8.32</u>		

Did well dewater? Yes No Gallons actually evacuated: 4.2

Sampling Date: 05-20-08 Sampling Time: 10:25 Depth to Water: 4.20 @ 10:22

Sample I.D.: S-2 Laboratory: STL Other: CAB Science

Analyzed for: TPH-G BTEX MTBE TPH-D Other:

EB I.D. (if applicable): _____ @ _____ Time Duplicate I.D. (if applicable): _____

Analyzed for: TPH-G BTEX MTBE TPH-D Other:

D.O. (if req'd):	Pre-purge:	mg/L	Post-purge:	mg/L
O.R.P. (if req'd):	Pre-purge:	mV	Post-purge:	mV