

(916) 638-2765

Time sheet

RO 23

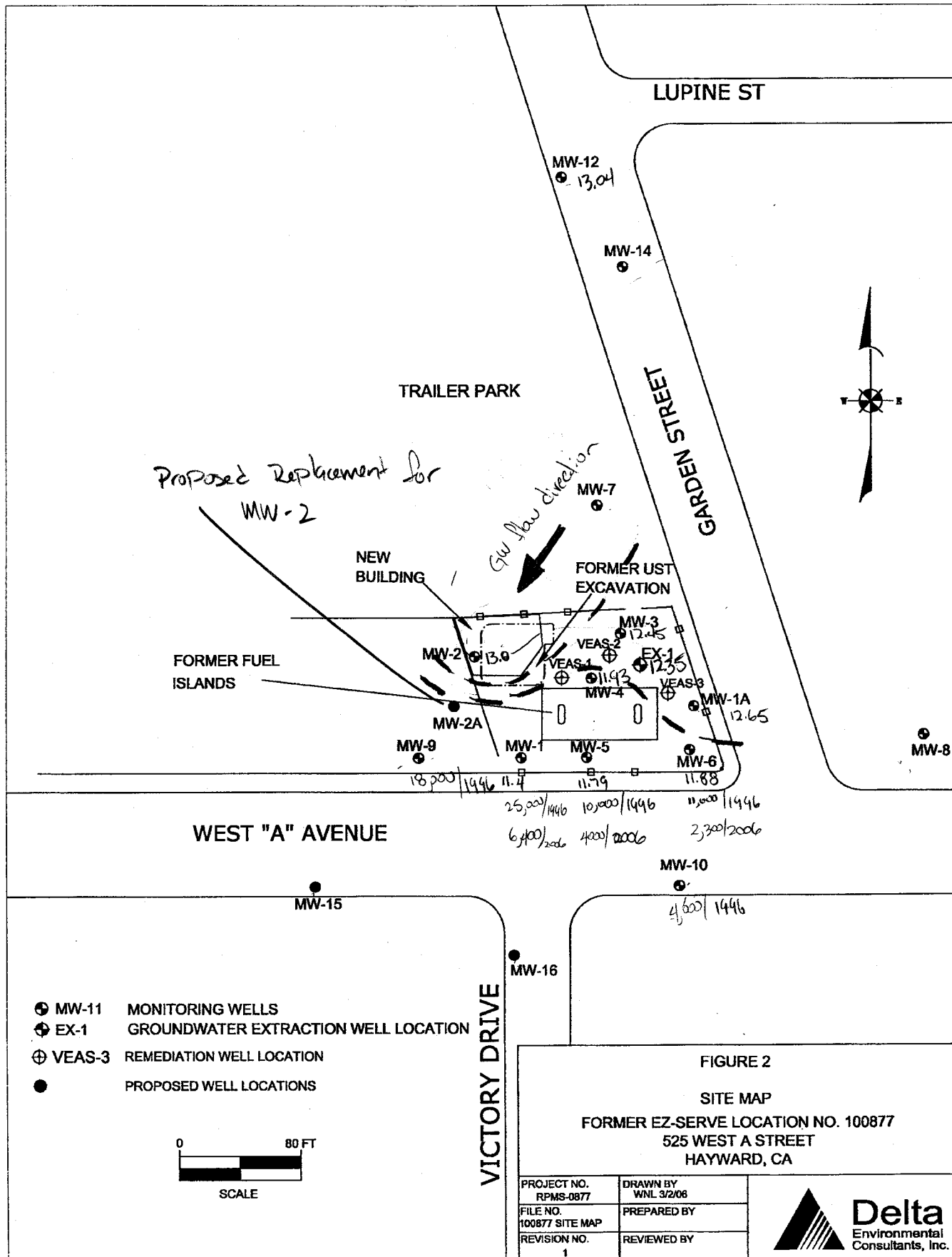



Solving environment-related business problems worldwide

3164 Gold Camp Drive • Suite 200
Rancho Cordova, California 95670 USA

916.638.2085 800.477.7411
Fax 916.638.8385

www.deltaenv.com

Ro 23

RECEIVED

By loprojectop at 8:38 am, May 16, 2006

May 4, 2006

Alameda County
Department of Environmental Health
1131 Harbor Bay Park Way
Alameda, CA 94502

Subject: Case Number # 3580
Quarterly Groundwater Monitoring Report- First Quarter 2006
Former RPMS (E-Z Serve) Location 100877
525 West A Street, Hayward, California
Delta Project RPMS 100877

To Whom it may concern:

Delta Environmental Consultants, Inc. (Delta) has been contracted by Restructure Petroleum Marketing Services of California (RPMS) to perform environmental services at the Former RPMS (E-Z Serve) Location 100877 (Figure 1).

The groundwater monitoring data discussed in this report were collected on March 20, 2006. The work was performed in accordance with the field methods and procedures included in Enclosure A.

Groundwater Level Measurements

On March 20, 2006, Delta personnel visited the site to conduct groundwater monitoring activities. The depth to groundwater was measured in 10 total monitoring and extraction wells MW-1, MW-1A, MW-2, MW-3, MW-4 MW-5, MW-6, MW-12, MW-14 and EX-1. MW-7 could not be located for measuring, and MW-8, MW-9, MW10, MW-11, and MW-13 have been paved over or could not be located.

Groundwater ranged from 11.44 feet to 13.04 feet below top of casing. No LPH was detected in any of the monitoring wells during the March 20, 2006 gauging activities. The direction of groundwater flow is inferred to be westerly at a hydraulic gradient of 0.01 ft/ft. Depths to groundwater and groundwater elevations are presented in Table 1, Groundwater Analytical Data.

Groundwater Sampling and Analytical Results

The groundwater samples were transported, under strict chain-of-custody protocols, to *Kiff Analytical LLC of Davis, California*, for analysis for benzene, toluene, ethyl-benzene, total xylenes (BTEX), total petroleum hydrocarbons (TPHg) in the gasoline range, methyl tert butyl ether (MTBE), diisopropyl ether (DIPE), ethyl tert butyl ether (ETBE), tert-amyl methyl ether (TAME) and tert butyl alcohol (TBA) by EPA Method 8260B.

A member of:



Laboratory chemical analysis on the groundwater samples collected on March 20, 2006 indicate that the majority of hydrocarbon concentrations have decreased in monitoring wells MW-1, MW-1A, MW-2, MW-3, MW-4, and MW-5, and have increased in monitoring wells MW-6, and EX-1. The only detection for MW-12 and MW-14 was TPHg in MW-14. The highest TPHg concentration was 8,700 µg/L in MW-2. The highest benzene and MTBE concentrations were found in MW-1 at 290 µg/L and 8.8 µg/L respectively. The analytical data for the March 20, 2006 sampling event are presented in Table 1, Groundwater Analytical Data. Field sampling information sheets are presented in Enclosure B. Laboratory analytical results, chain-of-custody documentation and graphs are presented in Enclosure C.

Future Work

Delta recommends continued quarterly groundwater monitoring and sampling. Delta also recommends attempting to locate well heads of monitoring wells MW-8 through MW-11. Delta has proposed adding well MW-2A between MW-2 and MW-9 and two wells MW-15 and MW-16 south of the site on Victory Drive and West "A" Street to further delineate the lateral and vertical extent of impacted soil and groundwater.

Remarks

The recommendations contained in this report represent Delta's professional opinions based upon the currently available information and are arrived at in accordance with currently acceptable professional standards. This report is based upon a specific scope of work requested by the client. The Contract between Delta and its client outlines the scope of work, and only those tasks specifically authorized by that contract or outlined in this report were performed. This report is intended only for the use of Delta's Client and anyone else specifically listed on this report. Delta will not and cannot be liable for unauthorized reliance by any other third party. Other than as contained in this paragraph, Delta makes no express or implied warranty as to the contents of this report.

If you have any questions regarding this report please call John Smith at (916) 503-1266.

Sincerely,

DELTA ENVIRONMENTAL CONSULTANTS, INC.

Robert Pierce

Robert Pierce
Staff Engineer

Kenneth Earnest

Kenneth Earnest
California Registered Geologist No. 6613

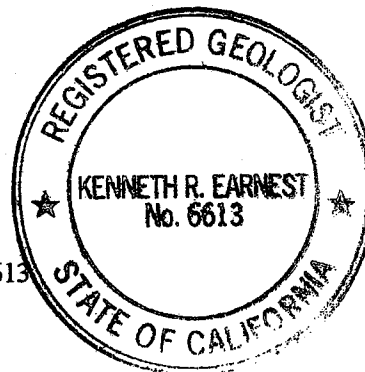

cc: Jack Ceccarelli, RPMS of CA

FIGURES

R023

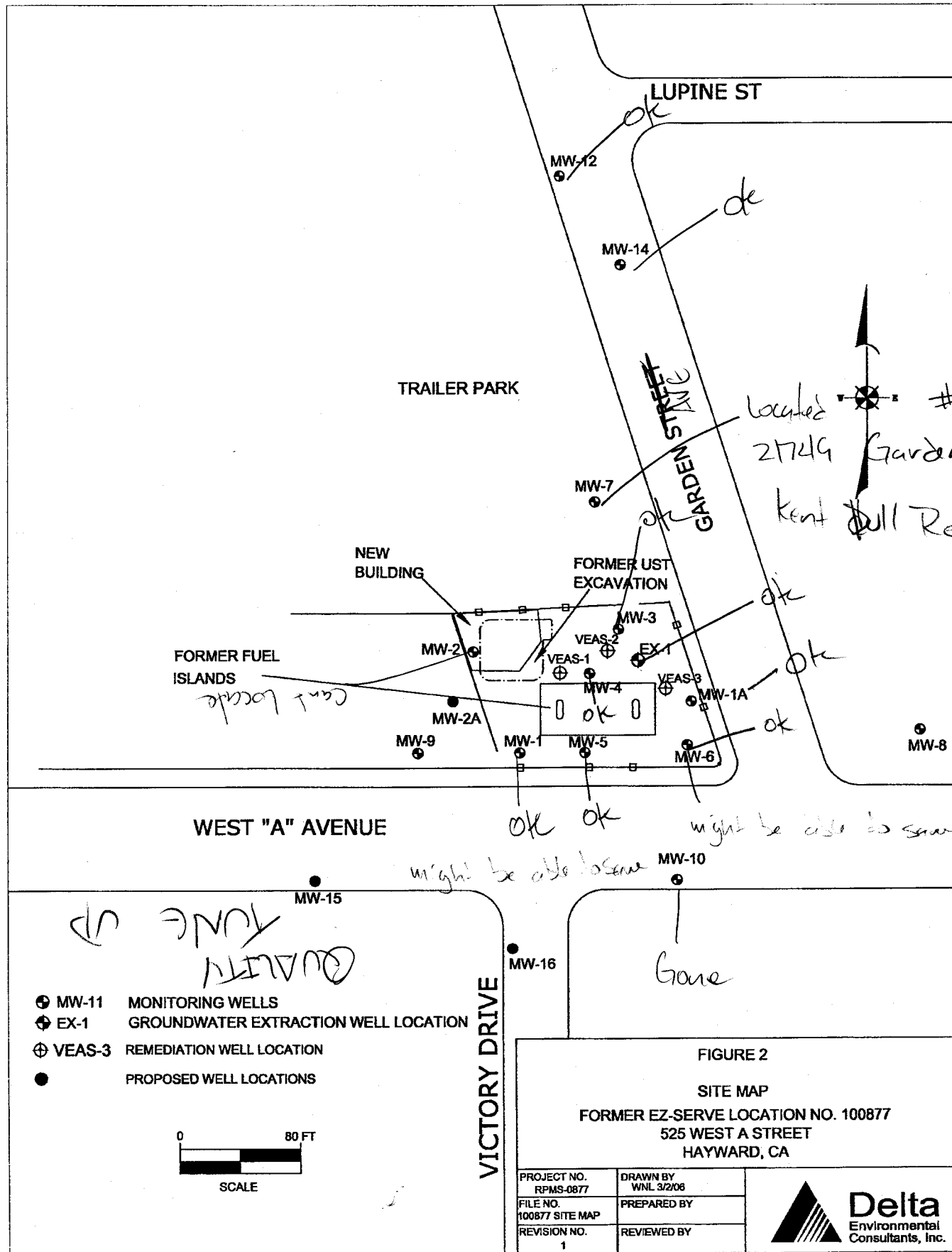

R023

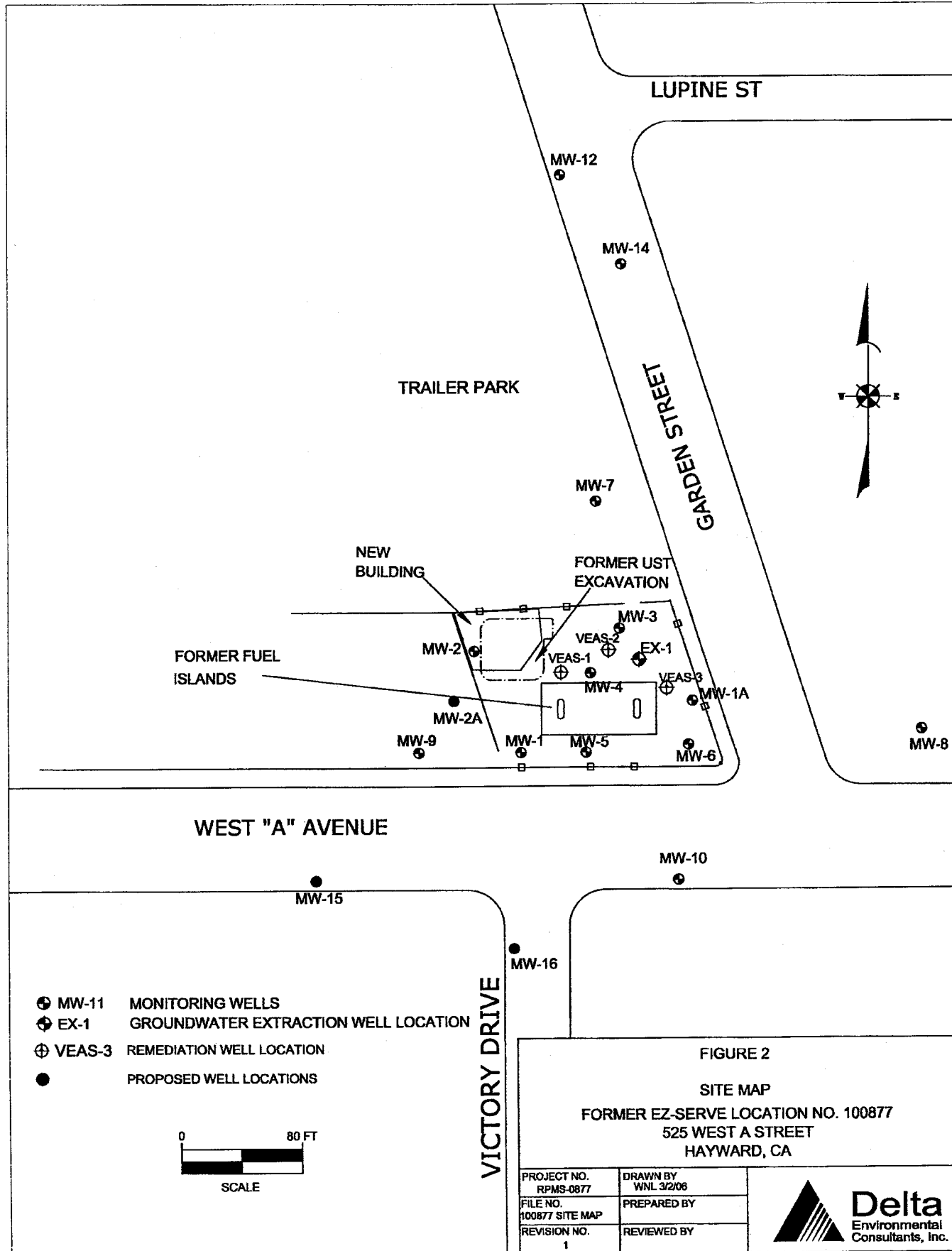



AEI CONSULTANTS
2500 Camino Diablo, Suite 200
Walnut Creek, CA 94597
PHONE: (925) 283-6000, ex 104
(800) 801-3224
FAX: (925) 283-6121

Date: June 1, 2006

Hard Copy Sent? Y N

To: **Mr. Steven Plunkett**
ACHCSA
Phone: 510/383-1767
Fax: 510/337-9335

From: **Peter McIntyre**

Pages: 2, including this cover page

Subject: 1450 Fruitvale Ave, Oakland RO0000307

Good Afternoon Steven:

Following is the most recent correspondence I have on file in this matter.

Please let me know if you have any other questions or need anything else.

Thank you -- Peter

A handwritten signature in black ink, appearing to read 'Peter McIntyre', is written over the typed name. The signature is stylized and cursive.



Solving environment-related business problems worldwide

www.deltaenv.com

3164 Gold Camp Drive • Suite 200
Rancho Cordova, California 95670 USA

916.638.2085 800.477.7411
Fax 916.638.8385

RECEIVED

By lopprojectop at 8:38 am, May 16, 2006

May 4, 2006

Alameda County
Department of Environmental Health
1131 Harbor Bay Park Way
Alameda, CA 94502

Subject: Case Number # 3580
Quarterly Groundwater Monitoring Report- First Quarter 2006
Former RPMS (E-Z Serve) Location 100877
525 West A Street, Hayward, California
Delta Project RPMS 100877

To Whom it may concern:

Delta Environmental Consultants, Inc. (Delta) has been contracted by Restructure Petroleum Marketing Services of California (RPMS) to perform environmental services at the Former RPMS (E-Z Serve) Location 100877 (Figure 1).

The groundwater monitoring data discussed in this report were collected on March 20, 2006. The work was performed in accordance with the field methods and procedures included in Enclosure A.

Groundwater Level Measurements

On March 20, 2006, Delta personnel visited the site to conduct groundwater monitoring activities. The depth to groundwater was measured in 10 total monitoring and extraction wells MW-1, MW-1A, MW-2, MW-3, MW-4 MW-5, MW-6, MW-12, MW-14 and EX-1. MW-7 could not be located for measuring, and MW-8, MW-9, MW10, MW-11, and MW-13 have been paved over or could not be located.

Groundwater ranged from 11.44 feet to 13.04 feet below top of casing. No LPH was detected in any of the monitoring wells during the March 20, 2006 gauging activities. The direction of groundwater flow is inferred to be westerly at a hydraulic gradient of 0.01 ft/ft. Depths to groundwater and groundwater elevations are presented in Table 1, Groundwater Analytical Data.

Groundwater Sampling and Analytical Results

The groundwater samples were transported, under strict chain-of-custody protocols, to *Kiff Analytical LLC of Davis, California*, for analysis for benzene, toluene, ethyl-benzene, total xylenes (BTEX), total petroleum hydrocarbons (TPHg) in the gasoline range, methyl tert butyl ether (MTBE), diisopropyl ether (DIPE), ethyl tert butyl ether (ETBE), tert-amyl methyl ether (TAME) and tert butyl alcohol (TBA) by EPA Method 8260B.

A member of:

