

✓ R023



Solving environment-related business problems worldwide

www.deltaenv.com

3164 Gold Camp Drive • Suite 200  
Rancho Cordova, California 95670 USA

916.638.2085 800.477.7411  
Fax 916.638.8385

April 28, 2005

Amir Gholami  
Alameda County  
Department of Environmental Health  
1131 Harbor Bay Park Way  
Alameda, CA 94502

MAILED  
MAY 11 C 2005  
ALAMEDA COUNTY DEPARTMENT OF ENVIRONMENTAL HEALTH  
1131 HARBOR BAY PARK WAY  
ALAMEDA, CA 94502

Re: Case Number # 3580  
Quarterly Groundwater Monitoring Report First Quarter 2005  
Former RPMS (E-Z Serve) Location 100877  
525 West A Street  
Hayward, California  
Delta Project RPMS0-877

Dear Mr. Gholami:

Delta Environmental Consultants, Inc. is pleased to submit this Quarterly Groundwater Monitoring Report presenting groundwater monitoring results for the subject site. Recommendations for future work are also included.

If you have any questions regarding this report please contact me at (916) 638-2765.

Sincerely,

DELTA ENVIRONMENTAL CONSULTANTS, INC.

James R. Brownell  
California Registered Geologist No. 5078

Enc: Quarterly Groundwater Monitoring Report

cc: Jack Ceccarelli, RPMS of CA  
Vinod Bansal, Site Owner

**QUARTERLY GROUNDWATER MONITORING REPORT  
FIRST QUARTER 2005**

Former RPMS (E-Z Serve) Location 100877  
525 West A Street  
Hayward, California

Case Number # 3580  
Delta Project RPMS0-877

April 28, 2005

Prepared for:

Jack Ceccarelli  
Restructure Petroleum Marketing Services of California  
205 S. Hoover Boulevard, Suite 101  
Tampa, Florida 33609-9905

Submitted to:

Amir Gholami  
Alameda County  
Department of Environmental Health  
1131 Harbor Bay Park Way  
Alameda, CA 94502

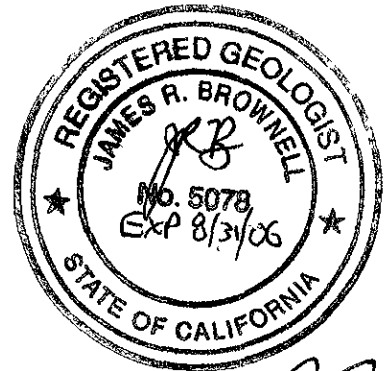

Prepared by:

  
Jason M. Mata  
Staff Technician

Reviewed by:

  
James R. Brownell  
California Registered Geologist No. 5078



**Delta Environmental Consultants, Inc.**  
3164 Gold Camp Drive, Suite 200, Rancho Cordova, California 95670  
916 638 2765 1 800 477 7411

**TABLE OF CONTENTS**

1.0 INTRODUCTION.....1  
1.1 Purpose.....1  
1.2 Scope of Services .....1  
1.3 Site Location.....1  
2.0 GROUNDWATER MONITORING DATA.....2  
2.1 Groundwater Gauging and Sampling.....2  
2.2 Analytical Data.....2  
3.0 CONCLUSIONS AND RECOMMENDATIONS.....4  
3.1 Conclusions .....4  
3.2 Recommendations .....4  
4.0 REMARKS .....5

**List of Tables**

Table 1 Groundwater Data Summary

**List of Figures**

Figure 1 Site Location Map  
Figure 2 Groundwater Contour Map

**List of Appendices**

Appendix A Field Notes  
Appendix B Groundwater Laboratory Analytical Data

## **QUARTERLY GROUNDWATER MONITORING REPORT**

### **FIRST QUARTER 2005**

**FORMER RPMS (E-Z SERVE) LOCATION 100877  
525 WEST A STREET  
HAYWARD, CALIFORNIA**

### **1.0 INTRODUCTION**

#### **1.1 Purpose**

The purpose of this Quarterly Groundwater Monitoring Report (QGMR) is to present the groundwater monitoring results completed by Delta Environmental Consultants, Inc. (Delta) at former RPMS (E-Z Serve) Location 100877 located at 525 West A Street in Hayward, California.

#### **1.2 Scope of Services**

The scope of services provided by Delta on the project consisted of the following:

- Gauged groundwater monitoring wells.
- Sampled groundwater monitoring wells.
- Analyzed groundwater samples for selected hydrocarbon constituents.
- Prepared this Quarterly Groundwater Monitoring Report.

#### **1.3 Site Location**

The site is a former E-Z Serve convenience store and retail gasoline station located at 525 West A Street in Hayward, California. The site is located in an area of commercial and residential properties.

## **2.0 GROUNDWATER MONITORING DATA**

### **2.1 Groundwater Gauging and Sampling**

On February 25, 2005, Delta personnel mobilized to the site to conduct groundwater monitoring activities. Prior to purging, the monitoring wells were gauged for liquid phase hydrocarbons (LPH) and depth to water utilizing an oil water interface probe. Groundwater ranged from 12.79 feet to 14.72 feet below top of casing. No LPH was detected in any of the monitoring wells during the February 25, 2005 gauging activities. Monitoring wells MW-7 and MW-13 were not gauged or sampled during the February 25, 2005 gauging event due to the inability to locate the monitoring wells. Depths to groundwater and groundwater elevations are presented in Table 1, Groundwater Analytical Data.

Prior to sampling, three well volumes were purged utilizing a submersible pump. After purging, wells were sampled utilizing disposable polyurethane bailers. The groundwater samples collected were decanted into properly labeled, laboratory prepared sample containers and placed on ice for storage prior to transporting to the laboratory. The samples were transported, under strict chain-of-custody protocols, to *Kiff Analytical LLC of Davis, California*, for analysis for benzene, toluene, ethyl-benzene, total xylenes (BTEX), total petroleum hydrocarbons (TPH) in the gasoline range, methyl tert butyl ether (MTBE), diisopropyl ether (DIPE), ethyl tert butyl ether (ETBE), tert-amyl methyl ether (TAME) and tert butyl alcohol (TBA) by EPA Method 8260B.

### **2.2 Analytical Data**

Laboratory chemical analyses on the groundwater samples collected on February 25, 2005 indicate that benzene concentrations have increased in monitoring wells MW-1A, MW-2, and EX-1, and have decreased in monitoring wells MW-1, MW-3, MW-4, MW-5 and MW-6. Benzene concentrations ranged from below reporting limits to 710 µg/L in monitoring well MW-1. MTBE concentrations have remained below laboratory reporting limits in monitoring wells MW-1A, MW-12, MW-14 and EX-1; meanwhile, MTBE concentrations have decreased in monitoring wells MW-2, MW-4, MW-5 and MW-6, and have increased in monitoring wells MW-1, MW-1A, MW-2, and MW-3. MTBE concentrations ranged from Below Reporting Limits (BRL) to 24 µg/L in monitoring wells MW-1 and MW-1A.

The analytical data for the February 25, 2005 sampling event are presented in Table 1, Groundwater Analytical Data. Field sampling information sheets are presented in Appendix A. Laboratory analytical results, chain-of-custody documentation and graphs are presented in Appendix B.

### **3.0 CONCLUSIONS AND RECOMMENDATIONS**

#### **3.1 Conclusions**

Groundwater table elevation data were used to approximate the flow direction and gradient across the site on February 25, 2005 by contouring. Based on the contours presented on Figure 2 – Groundwater Contour Map, the flow direction was toward the west-southwest at a hydraulic gradient of approximately 0.003.

Reported analytical data for the groundwater samples collected on February 25, 2005 indicate that benzene concentrations have increased in three of the ten monitoring wells sampled. Reported MTBE concentrations increased in three monitoring wells, two of which are downgradient from the UST location. The three upgradient monitoring wells have remained below laboratory reporting limits.

#### **3.2 Recommendations**

Delta recommends continued quarterly groundwater monitoring and sampling. Delta also recommends attempting to locate well heads of monitoring wells MW-8 through MW-11.

#### 4.0 REMARKS

The recommendations contained in this report represent Delta's professional opinions based upon the currently available information and are arrived at in accordance with currently acceptable professional standards. This report is based upon a specific scope of work requested by the client. The Contract between Delta and its client outlines the scope of work, and only those tasks specifically authorized by that contract or outlined in this report were performed. This report is intended only for the use of Delta's Client and anyone else specifically listed on this report. Delta will not and cannot be liable for unauthorized reliance by any other third party. Other than as contained in this paragraph, Delta makes no express or implied warranty as to the contents of this report.

This report was prepared by **DELTA ENVIRONMENTAL CONSULTANTS, INC.**

If you have any questions, please call Jim Brownell at (916) 638-2765.

**Table 1**  
**Groundwater Analytical Data**  
**Former EZ Serve Location #100877**  
**Delta Project No. RPMS-877-A**

Well	Sample Collection Date	Casing Elevation (msl)	Depth to Water (feet)	Depth to Product (feet)	Water Table Elevation (msl)	TPHg (µg/L)	Benzene (µg/L)	Toluene (µg/L)	Ethyl-benzene (µg/L)	Total Xylenes (µg/L)	MTBE (µg/L)	DIPE (µg/L)	ETBE (µg/L)	TBA (µg/L)	TAME (µg/L)
MW-1	2/5/1992	41.75	20.82	0.00	20.93	46000	7600	2300	2400	6500	--	--	--	--	--
MW-1	9/11/1992	41.75	20.08	0.00	21.67	48000	9000	1200	1800	4600	--	--	--	--	--
MW-1	12/22/1992	41.75	19.79	0.00	21.96	84000	22000	1600	4800	17000	--	--	--	--	--
MW-1	3/3/1993	41.75	16.23	0.00	25.52	54000	16000	1600	1900	4300	--	--	--	--	--
MW-1	6/23/1993	41.75	16.86	0.00	24.89	30000	18000	1100	1400	3700	--	--	--	--	--
MW-1	9/30/1993	41.75	18.04	0.00	23.71	33000	10000	440	940	1700	--	--	--	--	--
MW-1	2/6/1994	41.75	18.15	0.00	23.60	64000	18000	1600	4700	12000	--	--	--	--	--
MW-1	5/2/1994	41.75	17.26	0.00	24.49	7200	2100	29	490	520	--	--	--	--	--
MW-1	7/1/1994	41.75	17.60	0.00	24.15	13000	3700	150	550	12000	--	--	--	--	--
MW-1	9/20/1994	41.75	20.59	0.00	21.16	10000	3100	75	440	870	--	--	--	--	--
MW-1	12/5/1994	41.75	17.83	0.00	23.92	8700	3700	87	520	950	--	--	--	--	--
MW-1	3/10/1995	41.75	14.67	0.00	27.08	--	--	--	--	--	--	--	--	--	--
MW-1	3/15/1995	41.75	14.43	0.00	27.32	290	56	2	12	47	--	--	--	--	--
MW-1	9/23/1996	41.75	14.92	0.00	26.83	20000	5200	860	700	1100	270	--	--	--	--
MW-1	12/4/1996	41.75	15.61	0.00	26.14	17000	3100	64	610	1200	280	--	--	--	--
MW-1	4/8/1997	41.75	13.25	0.00	28.50	2100	430	15	52	85	100	--	--	--	--
MW-1	6/30/1997	41.75	14.68	0.00	27.07	10000	2100	<	<	320	<	--	--	--	--
MW-1	11/25/1997	41.75	15.99	0.00	25.76	16000	2100	23	76	240	<	--	--	--	--
MW-1	6/1/1998	41.75	9.98	0.00	31.77	19000	6100	430	1100	2300	420	--	--	--	--
MW-1	6/14/2001	41.75	15.05	0.00	26.70	6000	380	8	260	180	<25	--	--	--	--
MW-1	11/7/2001	41.75	16.31	0.00	25.44	12000	1000	30	1000	740	11	<5.0	<5.0	<50	<5.0
MW-1	1/30/2002	41.75	14.15	0.00	27.60	8800	690	16	480	270	14	<5.0	<5.0	<50	<5.0
MW-1	5/29/2002	41.75	14.55	0.00	27.20	6400	330	13	250	260	12	3	<2.0	<20	<2.0
MW-1	8/14/2002	41.75	15.56	0.00	26.19	5500	470	14	360	160	10	<10	<10	<100	<10
MW-1	11/15/2002	41.75	16.10	0.00	25.65	10000	440	16	310	150	15	<10	<10	<100	<10
MW-1	10/25/2004	41.75	15.99	0.00	25.76	4300	260	3	150	32	14	<0.90	<0.90	6	<0.90
MW-1	12/23/2004	41.75	15.64	0.00	26.11	11000	860	6	880	280	16	<0.90	<0.90	11	<0.90
MW-1	2/25/2005	41.75	12.79	0.00	28.96	11000	710	7	720	330	24	<1.5	<1.5	11	<1.5



**Table 1**  
**Groundwater Analytical Data**  
**Former EZ Serve Location #100877**  
**Delta Project No. RPMS-877-A**

Well	Sample Collection  Date	Casing Elevation  (msl)	Depth to Water  (feet)	Depth to Product  (feet)	Water Table Elevation  (msl)	TPHg  (µg/L)	Benzene  (µg/L)	Toluene  (µg/L)	Ethyl- benzene  (µg/L)	Total Xylenes  (µg/L)	MTBE  (µg/L)	DIPE  (µg/L)	ETBE  (µg/L)	TBA  (µg/L)	TAME  (µg/L)
MW-1A	9/30/1993	43.40	--	--	--	--	--	--	--	--	--	--	--	--	--
MW-1A	2/6/1994	43.40	18.89	0.00	24.51	8900	1700	42	1000	400	--	--	--	--	--
MW-1A	5/2/1994	43.40	18.35	0.09	25.05	--	--	--	--	--	--	--	--	--	--
MW-1A	7/1/1994	43.40	18.45	0.00	24.95	12000	1100	<1	920	1100	--	--	--	--	--
MW-1A	9/20/1994	43.40	21.72	21.50	21.84	--	--	--	--	--	--	--	--	--	--
MW-1A	12/5/1994	43.40	18.87	18.80	24.58	--	--	--	--	--	--	--	--	--	--
MW-1A	3/10/1995	43.40	15.83	0.00	27.57	--	--	--	--	--	--	--	--	--	--
MW-1A	3/15/1995	43.40	15.55	15.50	27.89	--	--	--	--	--	--	--	--	--	--
MW-1A	9/23/1996	43.40	16.00	15.99	27.41	--	--	--	--	--	--	--	--	--	--
MW-1A	12/4/1996	43.40	16.55	0.00	26.85	52000	420	140	1000	3500	130	--	--	--	--
MW-1A	4/8/1997	43.40	14.15	SHEEN	29.25	--	--	--	--	--	--	--	--	--	--
MW-1A	6/30/1997	43.40	15.57	0.00	27.83	17000	180	<	140	1100	<	--	--	--	--
MW-1A	11/25/1997	43.40	16.91	0.00	26.49	19000	110	37	290	910	<	--	--	--	--
MW-1A	6/1/1998	43.40	10.78	0.00	32.62	18000	200	17	230	820	91	--	--	--	--
MW-1A	6/14/2001	43.40	15.93	15.92	27.48	27000	29	<5.0	620	520	<50	--	--	--	--
MW-1A	11/7/2001	43.40	17.32	0.00	26.08	21000	51	<5.0	700	510	<5.0	<5.0	<5.0	<50	<5.0
MW-1A	1/30/2002	43.40	15.05	0.00	28.35	24000	22	<5.0	390	330	<5.0	<5.0	<5.0	<50	<5.0
MW-1A	5/29/2002	43.40	15.49	0.00	27.91	12000	32	<5.0	550	270	<5.0	<5.0	<5.0	<50	<5.0
MW-1A	8/14/2002	43.40	16.50	0.00	26.90	14000	22	<2.0	510	240	<2.0	<2.0	<2.0	<20	<2.0
MW-1A	11/15/2002	43.40	17.04	0.00	26.36	17000	59	2	630	250	<2.0	<2.0	<2.0	<20	<2.0
MW-1A	10/25/2004	43.40	16.90	0.00	26.50	2200	1	<0.50	58	4	<0.50	<0.50	<0.50	<5.0	<0.50
MW-1A	12/23/2004	43.40	16.60	0.00	26.80	3100	2	<0.50	96	5	<0.50	<0.50	<0.50	<5.0	<0.50
MW-1A	2/25/2005	43.40	13.75	0.00	29.65	7300	4.7	1.1	140	24	<0.50	<0.50	<0.50	<5.0	<0.50

**Table 1**  
**Groundwater Analytical Data**  
**Former EZ Serve Location #100877**  
**Delta Project No. RPMS-877-A**

Well	Sample Collection Date	Casing Elevation (msl)	Depth to Water (feet)	Depth to Product (feet)	Water Table Elevation (msl)	TPHg (µg/L)	Benzene (µg/L)	Toluene (µg/L)	Ethyl-benzene (µg/L)	Total Xylenes (µg/L)	MTBE (µg/L)	DIPE (µg/L)	ETBE (µg/L)	TBA (µg/L)	TAME (µg/L)
MW-2	2/5/1992	43.26	22.35	0.00	20.91	67000	13000	4700	820	1300	--	--	--	--	--
MW-2	9/11/1992	43.26	21.67	0.00	21.59	57000	9000	1400	1200	8400	--	--	--	--	--
MW-2	12/22/1992	43.26	21.39	0.00	21.87	31000	9900	350	2000	4100	--	--	--	--	--
MW-2	3/3/1993	43.26	17.75	0.00	25.51	17000	5100	1300	720	1900	--	--	--	--	--
MW-2	6/23/1993	43.26	18.42	0.00	24.84	60000	23000	1500	4500	17000	--	--	--	--	--
MW-2	9/30/1993	43.26	19.63	0.00	23.63	38000	12000	780	1500	6500	--	--	--	--	--
MW-2	2/6/1994	43.26	19.61	0.00	23.65	34000	8900	450	2000	5500	--	--	--	--	--
MW-2	5/2/1994	43.26	19.84	0.00	23.42	18000	3800	260	1100	3500	--	--	--	--	--
MW-2	7/1/1994	43.26	19.18	0.00	24.08	18000	3700	510	870	2600	--	--	--	--	--
MW-2	9/20/1994	43.26	22.17	0.00	21.09	19000	4500	300	1200	4000	--	--	--	--	--
MW-2	12/6/1994	43.26	19.37	0.00	23.89	22000	4700	340	1400	4500	--	--	--	--	--
MW-2	3/10/1995	43.26	16.33	0.00	26.93	--	--	--	--	--	--	--	--	--	--
MW-2	3/15/1995	43.26	16.89	0.00	26.37	29000	5600	350	1900	6300	--	--	--	--	--
MW-2	9/23/1996	43.26	16.61	0.00	26.65	29000	3700	150	1000	4300	860	--	--	--	--
MW-2	12/4/1996	43.26	17.19	0.00	26.07	31000	3800	140	2000	5100	690	--	--	--	--
MW-2	4/8/1997	43.26	14.86	0.00	28.40	20000	2500	80	1300	3400	880	--	--	--	--
MW-2	6/30/1997	43.26	16.28	0.00	26.98	41000	2700	130	1200	4000	890	--	--	--	--
MW-2	11/25/1997	43.26	17.56	0.00	25.70	51000	2900	140	1800	7000	1200	--	--	--	--
MW-2	6/1/1998	43.26	11.58	0.00	31.68	33000	2700	130	1800	5700	610	--	--	--	--
MW-2	6/14/2001	43.26	16.63	0.00	26.63	18000	860	14	1100	2200	<100	--	--	--	--
MW-2	11/7/2001	43.26	17.85	0.00	25.41	20000	880	20	1100	2600	21	<5.0	<5.0	<50	<5.0
MW-2	1/30/2002	43.26	15.65	0.00	27.61	19000	880	19	1100	2400	56	<5.0	<5.0	<50	<5.0
MW-2	5/29/2002	43.26	16.12	0.00	27.14	8100	390	16	560	1400	32	<5.0	<5.0	<50	<5.0
MW-2	8/14/2002	43.26	17.20	0.00	26.06	19000	820	21	1200	2600	29	<20	<20	<200	<20
MW-2	11/15/2002	43.26	17.63	0.00	25.63	34000	910	31	1000	1400	39	<20	<20	<200	<20
MW-2	10/25/2004	43.26	17.53	0.00	25.73	9300	280	4	500	980	8	<2.0	<2.0	<9.0	<2.0
MW-2	12/23/2004	43.26	17.15	0.00	26.11	10000	310	4	470	840	10	<2.0	<2.0	<9.0	<2.0
MW-2	2/25/2005	43.26	14.30	0.00	28.96	15000	320	4.8	860	1600	7.7	<2.0	<2.0	<9.0	<2.0

**Table 1**  
**Groundwater Analytical Data**  
**Former EZ Serve Location #100877**  
**Delta Project No. RPMS-877-A**

Well	Sample Collection Date	Casing Elevation (msl)	Depth to Water (feet)	Depth to Product (feet)	Water Table Elevation (msl)	TPHg	Benzene	Toluene	Ethyl-benzene	Total Xylenes	MTBE	DIPE	ETBE	TBA	TAME
						(µg/L)	(µg/L)	(µg/L)	(µg/L)	(µg/L)	(µg/L)	(µg/L)	(µg/L)	(µg/L)	(µg/L)
MW-3	2/5/1992	43.89	21.85	0.00	22.04	16000	2700	410	<1	3400	--	--	--	--	--
MW-3	9/11/1992	43.89	21.13	0.00	22.76	43000	7600	1600	1400	4100	--	--	--	--	--
MW-3	12/22/1992	43.89	20.88	0.00	23.01	29000	8800	1200	1500	3700	--	--	--	--	--
MW-3	3/3/1993	43.89	17.29	0.00	26.60	17000	5000	1500	680	1700	--	--	--	--	--
MW-3	6/23/1993	43.89	17.88	0.00	26.01	5700	3000	120	560	790	--	--	--	--	--
MW-3	9/30/1993	43.89	19.18	0.00	24.71	21000	7000	2100	970	2600	--	--	--	--	--
MW-3	2/6/1994	43.89	19.21	0.00	24.68	24000	7200	1600	990	3200	--	--	--	--	--
MW-3	5/2/1994	43.89	18.30	0.00	25.59	10000	2200	440	470	1200	--	--	--	--	--
MW-3	7/1/1994	43.89	18.63	0.00	25.26	8200	2000	370	350	930	--	--	--	--	--
MW-3	9/20/1994	43.89	21.64	0.00	22.25	7200	2000	360	380	1000	--	--	--	--	--
MW-3	12/6/1994	43.89	19.15	0.00	24.74	9000	2300	400	440	1100	--	--	--	--	--
MW-3	3/10/1995	43.89	16.33	0.00	27.56	--	--	--	--	--	--	--	--	--	--
MW-3	3/15/1995	43.89	16.89	0.00	27.00	4300	980	47	370	780	--	--	--	--	--
MW-3	9/23/1996	43.89	16.11	0.00	27.78	10000	950	20	700	780	80	--	--	--	--
MW-3	12/4/1996	43.89	16.63	0.00	27.26	13000	1100	25	1000	1100	67	--	--	--	--
MW-3	4/8/1997	43.89	14.25	0.00	29.64	3800	210	5	270	280	56	--	--	--	--
MW-3	6/30/1997	43.89	15.70	0.00	28.19	3500	280	<	32	180	<	--	--	--	--
MW-3	11/25/1997	43.89	16.99	0.00	26.90	6800	230	<	370	290	130	--	--	--	--
MW-3	6/1/1998	43.89	--	--	--	--	--	--	--	--	--	--	--	--	--
MW-3	6/14/2001	43.89	16.02	0.00	27.87	2100	9	<0.5	78	43	<5.0	--	--	--	--
MW-3	11/7/2001	43.89	17.33	0.00	26.56	7700	75	<5.0	410	150	<5.0	<5.0	<5.0	<50	<5.0
MW-3	1/30/2002	43.89	15.10	0.00	28.79	3600	27	<5.0	120	34	<5.0	<5.0	<5.0	<50	<5.0
MW-3	5/29/2002	43.89	15.63	0.00	28.26	2000	18	<5.0	53	13	<5.0	<5.0	<5.0	<50	<5.0
MW-3	8/14/2002	43.89	16.63	0.00	27.26	2400	19	<0.5	50	7	<0.5	<0.5	<0.5	<5.0	<0.5
MW-3	11/15/2002	43.89	17.10	0.00	26.79	4300	8	<0.5	22	1	1	<0.5	<0.5	<5.0	<0.5
MW-3	10/25/2004	43.89	17.01	0.00	26.88	460	1	<0.50	10	2	<0.50	<0.50	<0.50	<5.0	<0.50
MW-3	12/20/2004	43.89	16.64	0.00	27.25	5400	9	<0.50	280	74	<0.50	<0.50	<0.50	<5.0	<0.50
MW-3	2/25/2005	43.89	13.68	0.00	30.21	90	1.1	<0.50	0.70	1.3	1.4	<0.50	<0.50	<5.0	<0.50

**Table 1**  
**Groundwater Analytical Data**  
**Former EZ Serve Location #100877**  
**Delta Project No. RPMS-877-A**

Well	Sample Collection Date	Casing Elevation (msl)	Depth to Water (feet)	Depth to Product (feet)	Water Table Elevation (msl)	TPHg (µg/L)	Benzene (µg/L)	Toluene (µg/L)	Ethyl-benzene (µg/L)	Total Xylenes (µg/L)	MTBE (µg/L)	DIPE (µg/L)	ETBE (µg/L)	TBA (µg/L)	TAME (µg/L)
MW-4	2/5/1992	42.76	21.31	0.00	21.45	16000	2700	410	<1	3400	--	--	--	--	--
MW-4	9/11/1992	42.76	20.62	0.00	22.14	43000	7600	1600	1400	4100	--	--	--	--	--
MW-4	12/22/1992	42.76	20.37	0.00	22.39	29000	8800	1200	1500	3700	--	--	--	--	--
MW-4	3/3/1993	42.76	16.78	0.00	25.98	17000	5000	1500	680	1700	--	--	--	--	--
MW-4	6/23/1993	42.76	17.45	0.00	25.31	5700	3000	120	560	790	--	--	--	--	--
MW-4	9/30/1993	42.76	18.64	0.00	24.12	21000	7000	2100	970	2600	--	--	--	--	--
MW-4	2/6/1994	42.76	18.59	0.00	24.17	24000	7200	1600	990	3200	--	--	--	--	--
MW-4	5/2/1994	42.76	17.81	0.00	24.95	10000	2200	440	470	1200	--	--	--	--	--
MW-4	7/1/1994	42.76	18.13	0.00	24.63	8200	2000	370	350	930	--	--	--	--	--
MW-4	9/20/1994	42.76	21.13	0.00	21.63	7200	2000	360	380	1000	--	--	--	--	--
MW-4	12/6/1994	42.76	18.36	0.00	24.40	9000	2300	400	440	1100	--	--	--	--	--
MW-4	3/10/1995	42.76	15.25	0.00	27.51	--	--	--	--	--	--	--	--	--	--
MW-4	3/15/1995	42.76	14.89	0.00	27.87	15000	4400	600	770	2660	--	--	--	--	--
MW-4	9/23/1996	42.76	15.56	0.00	27.20	32000	7400	540	1500	2800	2100	--	--	--	--
MW-4	12/4/1996	42.76	16.11	0.00	26.65	23000	7800	140	1200	1200	1900	--	--	--	--
MW-4	4/8/1997	42.76	13.73	0.00	29.03	16000	3900	680	850	2300	980	--	--	--	--
MW-4	6/30/1997	42.76	15.19	0.00	27.57	63000	7000	430	1400	4400	1700	--	--	--	--
MW-4	11/25/1997	42.76	16.49	0.00	26.27	30000	4300	61	810	1500	880	--	--	--	--
MW-4	6/1/1998	42.76	10.42	0.00	32.34	33000	5700	710	1700	2900	720	--	--	--	--
MW-4	6/14/2001	42.76	15.55	0.00	27.21	9500	690	45	560	600	<50	--	--	--	--
MW-4	11/7/2001	42.76	16.81	0.00	25.95	6000	710	20	630	190	27	<5.0	<5.0	<5.0	<5.0
MW-4	1/30/2002	42.76	14.60	0.00	28.16	4800	830	16	600	61	42	<5.0	<5.0	<5.0	<5.0
MW-4	5/29/2002	42.76	15.14	0.00	27.62	5300	720	57	600	200	35	<20	<20	<200	<20
MW-4	8/14/2002	42.76	16.07	0.00	26.69	5000	640	15	550	35	28	<2.0	<2.0	<20	<2.0
MW-4	11/15/2002	42.76	16.61	0.00	26.15	3700	330	10	260	200	20	<2.0	<2.0	<20	<2.0
MW-4	10/25/2004	42.76	16.50	0.00	26.26	4000	180	15	200	190	4	<0.50	<0.50	<5.0	<0.50
MW-4	12/23/2004	42.76	16.20	0.00	26.56	7400	280	24	340	340	8	<0.90	<0.90	<5.0	<0.90
MW-4	2/25/2005	42.76	13.30	0.00	29.46	4200	160	15	280	420	6	<0.90	<0.90	<5.0	<0.90

**Table 1**  
**Groundwater Analytical Data**  
**Former EZ Serve Location #100877**  
**Delta Project No. RPMS-877-A**

Well	Sample Collection Date	Casing Elevation (msl)	Depth to Water (feet)	Depth to Product (feet)	Water Table Elevation (msl)	TPHg (µg/L)	Benzene (µg/L)	Toluene (µg/L)	Ethyl-benzene (µg/L)	Total Xylenes (µg/L)	MTBE (µg/L)	DIPE (µg/L)	ETBE (µg/L)	TBA (µg/L)	TAME (µg/L)
MW-5	2/5/1992	42.10	20.93	0.00	21.17	78000	7900	5000	2900	1800	--	--	--	--	--
MW-5	9/11/1992	42.10	20.27	0.00	21.83	49000	4700	400	1400	4100	--	--	--	--	--
MW-5	12/22/1992	42.10	19.99	0.00	22.11	34000	8600	340	2200	4800	--	--	--	--	--
MW-5	3/3/1993	42.10	16.49	0.00	25.61	22000	7500	640	1300	3400	--	--	--	--	--
MW-5	6/23/1993	42.10	17.02	0.00	25.08	15000	5800	120	1100	2100	--	--	--	--	--
MW-5	9/30/1993	42.10	18.25	0.00	23.85	25000	7600	410	1000	4400	--	--	--	--	--
MW-5	2/6/1994	42.10	18.26	0.00	23.84	23000	6000	180	2000	5900	--	--	--	--	--
MW-5	5/2/1994	42.10	17.50	0.00	24.60	8000	1300	29	440	770	--	--	--	--	--
MW-5	7/1/1994	42.10	17.79	0.00	24.31	10000	1700	97	600	1400	--	--	--	--	--
MW-5	9/20/1994	42.10	20.77	0.00	21.33	8400	1600	54	650	1400	--	--	--	--	--
MW-5	12/5/1994	42.10	18.02	0.00	24.08	10000	1800	<50	620	1400	--	--	--	--	--
MW-5	3/10/1995	42.10	14.93	0.00	27.17	--	--	--	--	--	--	--	--	--	--
MW-5	3/15/1995	42.10	14.70	0.00	27.40	5300	1100	11	180	320	--	--	--	--	--
MW-5	9/23/1996	42.10	15.19	0.00	26.91	9800	1800	11	470	510	100	--	--	--	--
MW-5	12/4/1996	42.10	15.78	0.00	26.32	10000	2200	9	550	430	70	--	--	--	--
MW-5	4/8/1997	42.10	13.39	0.00	28.71	11000	1300	15	450	720	180	--	--	--	--
MW-5	6/30/1997	42.10	14.83	0.00	27.27	3800	500	<	75	84	<	--	--	--	--
MW-5	11/25/1997	42.10	16.14	0.00	25.96	8200	1300	14	310	220	<	--	--	--	--
MW-5	6/1/1998	42.10	10.10	0.00	32.00	3600	290	12	52	52	81	--	--	--	--
MW-5	6/14/2001	42.10	15.19	0.00	26.91	5100	44	1	110	23	<5.0	--	--	--	--
MW-5	11/7/2001	42.10	16.47	0.00	25.63	7600	220	<5.0	550	30	<5.0	<5.0	<5.0	<50	<5.0
MW-5	1/30/2002	42.10	14.27	0.00	27.83	6200	180	<20	310	130	<20	<20	<20	<200	<20
MW-5	5/29/2002	42.10	14.73	0.00	27.37	3900	66	1	110	7	1	2	<0.5	<5.0	<0.5
MW-5	8/14/2002	42.10	15.73	0.00	26.37	4300	80	1	150	12	1	<0.5	<0.5	<5.0	<0.5
MW-5	11/15/2002	42.10	16.27	0.00	25.83	7000	99	<5.0	250	500	<5.0	<5.0	<5.0	<50	<5.0
MW-5	10/25/2004	42.10	16.15	0.00	25.95	4800	27	1	50	4	1	<0.50	<0.50	<5.0	<0.50
MW-5	12/23/2004	42.10	15.88	0.00	26.22	6300	55	<0.90	140	6	<0.90	<0.90	<0.90	<5.0	<0.90
MW-5	2/25/2005	42.10	12.97	0.00	29.13	4700	44	0.59	110	4.8	0.85	<0.50	<0.50	<5.0	<0.50

**Table 1  
Groundwater Analytical Data  
Former EZ Serve Location #100877  
Delta Project No. RPMS-877-A**

Well	Sample Collection  Date	Casing Elevation  (msl)	Depth to Water  (feet)	Depth to Product  (feet)	Water Table Elevation  (msl)	TPHg  (µg/L)	Benzene  (µg/L)	Toluene  (µg/L)	Ethyl- benzene  (µg/L)	Total Xylenes  (µg/L)	MTBE  (µg/L)	DIPE  (µg/L)	ETBE  (µg/L)	TBA  (µg/L)	TAME  (µg/L)
MW-6	9/11/1992	42.33	20.56	0.00	21.77	24000	2500	830	1400	2300	--	--	--	--	--
MW-6	12/22/1992	42.33	20.31	0.00	22.02	23000	5100	630	2000	3100	--	--	--	--	--
MW-6	3/3/1993	42.33	16.83	0.00	25.50	18000	4400	820	1400	2400	--	--	--	--	--
MW-6	6/23/1993	42.33	17.30	0.00	25.03	18000	4600	850	2700	3400	--	--	--	--	--
MW-6	9/30/1993	42.33	19.05	0.00	23.28	--	--	--	--	--	--	--	--	--	--
MW-6	2/6/1994	42.33	18.55	0.00	23.78	20000	4600	690	2100	2500	--	--	--	--	--
MW-6	5/2/1994	42.33	17.74	0.00	24.59	5300	930	54	610	240	--	--	--	--	--
MW-6	7/1/1994	42.33	18.09	0.00	24.24	10000	1500	160	850	690	--	--	--	--	--
MW-6	9/20/1994	42.33	21.05	0.00	21.28	11000	2000	140	1200	760	--	--	--	--	--
MW-6	12/6/1994	42.33	18.33	0.00	24.00	8600	1300	87	980	610	--	--	--	--	--
MW-6	3/10/1995	42.33	15.35	0.00	26.98	--	--	--	--	--	--	--	--	--	--
MW-6	3/15/1995	42.33	14.91	0.00	27.42	9800	1600	110	1000	1000	--	--	--	--	--
MW-6	9/23/1996	42.33	15.50	0.00	26.83	12000	520	55	930	350	51	--	--	--	--
MW-6	12/4/1996	42.33	16.06	0.00	26.27	11000	390	25	680	170	130	--	--	--	--
MW-6	4/8/1997	42.33	13.64	0.00	28.69	17000	700	92	1400	900	2700	--	--	--	--
MW-6	6/30/1997	42.33	15.08	0.00	27.25	11000	270	37	590	450	<	--	--	--	--
MW-6	11/25/1997	42.33	16.40	0.00	25.93	9100	130	26	500	150	310	--	--	--	--
MW-6	6/1/1998	42.33	10.31	0.00	32.02	14000	190	50	680	400	160	--	--	--	--
MW-6	6/14/2001	42.33	15.46	0.00	26.87	6400	29	6	200	55	<20	--	--	--	--
MW-6	11/7/2001	42.33	16.71	0.00	25.62	7200	34	9	180	31	<5.0	<5.0	<5.0	<50	<5.0
MW-6	1/30/2002	42.33	14.60	0.00	27.73	6600	32	7	130	28	<5.0	<5.0	<5.0	<50	<5.0
MW-6	5/29/2002	42.33	14.99	0.00	27.34	5200	26	7	150	27	<5.0	<5.0	<5.0	<50	<5.0
MW-6	8/14/2002	42.33	16.03	0.00	26.30	5300	24	7	120	22	<2.0	<2.0	<2.0	<20	<2.0
MW-6	11/15/2002	42.33	16.53	0.00	25.80	5000	19	5	70	38	<0.5	<0.5	<0.5	<5.0	<0.5
MW-6	10/25/2004	42.33	16.43	0.00	25.90	3600	10	2	83	16	2	<0.50	<0.50	<5.0	<0.50
MW-6	12/23/2004	42.33	16.12	0.00	26.21	2100	8	1	10	2	2	<0.50	<0.50	<5.0	<0.50
MW-6	2/25/2005	42.33	13.13	0.00	29.20	2500	6.6	1.4	29	5.2	0.74	<0.50	<0.50	<5.0	<0.50

**Table 1**  
**Groundwater Analytical Data**  
**Former EZ Serve Location #100877**  
**Delta Project No. RPMS-877-A**

Well	Sample Collection Date	Casing Elevation (msl)	Depth to Water (feet)	Depth to Product (feet)	Water Table Elevation (msl)	TPHg (µg/L)	Benzene (µg/L)	Toluene (µg/L)	Ethyl-benzene (µg/L)	Total Xylenes (µg/L)	MTBE (µg/L)	DIPE (µg/L)	ETBE (µg/L)	TBA (µg/L)	TAME (µg/L)
MW-7	6/23/1993	42.70	17.87	0.00	24.83	29000	4200	71	4400	5600	--	--	--	--	--
MW-7	9/30/1993	42.70	18.94	0.00	23.76	30000	3200	71	2800	3400	--	--	--	--	--
MW-7	2/6/1994	42.70	19.11	19.05	23.63	--	--	--	--	--	--	--	--	--	--
MW-7	5/2/1994	42.70	18.11	0.00	24.59	5700	630	13	660	400	--	--	--	--	--
MW-7	7/1/1994	42.70	18.72	0.00	23.98	3100	180	99	160	520	--	--	--	--	--
MW-7	9/20/1994	42.70	21.41	0.00	21.29	6100	540	6	750	730	--	--	--	--	--
MW-7	12/5/1994	42.70	18.66	0.00	24.04	3700	280	<10	430	350	--	--	--	--	--
MW-7	3/10/1995	42.70	15.72	0.00	26.98	3900	310	<10	540	540	--	--	--	--	--
MW-7	3/14/1995	42.70	15.23	0.00	27.47	1900	290	4	26	296	--	--	--	--	--
MW-7	9/23/1996	42.70	15.94	0.00	26.76	6300	76	<	420	270	15	--	--	--	--
MW-7	12/4/1996	42.70	16.43	0.00	26.27	7800	67	<	600	350	22	--	--	--	--
MW-7	4/8/1997	42.70	14.10	0.00	28.60	5600	42	<	240	96	<	--	--	--	--
MW-7	6/30/1997	42.70	15.51	0.00	27.19	5500	<	79	<	44	280	--	--	--	--
MW-7	11/25/1997	42.70	16.80	0.00	25.90	2400	23	5	<	54	120	--	--	--	--
MW-7	6/1/1998	42.70	10.31	0.00	32.39	14000	190	50	680	400	160	--	--	--	--
MW-7	6/14/2001	42.70	15.46	0.00	27.24	6400	29	6	200	55	<20	--	--	--	--
MW-7	11/7/2001	42.70	--	--	--	--	--	--	--	--	--	--	--	--	--
MW-7	1/30/2002	42.70	14.97	0.00	27.73	6200	2	<0.5	96	5	<0.5	<5.0	<5.0	<5.0	<5.0
MW-7	5/29/2002	42.70	15.49	0.00	27.21	1600	1	<0.5	3	2	<0.5	<0.5	<0.5	<5.0	<0.5
MW-7	8/14/2002	42.70	16.44	0.00	26.26	4100	1	<0.5	74	1	<0.5	<0.5	<0.5	<5.0	<0.5
MW-7	11/15/2002	42.70	16.91	0.00	25.79	1000	1	<0.5	<0.5	1	<0.5	<0.5	<0.5	<5.0	<0.5
MW-7	10/25/2004														

well not sampled, can't locate well

**Table 1**  
**Groundwater Analytical Data**  
**Former EZ Serve Location #100877**  
**Delta Project No. RPMS-877-A**

Well	Sample Collection Date	Casing Elevation (msl)	Depth to Water (feet)	Depth to Product (feet)	Water Table Elevation (msl)	TPHg (µg/L)	Benzene (µg/L)	Toluene (µg/L)	Ethyl-benzene (µg/L)	Total Xylenes (µg/L)	MTBE (µg/L)	DIPE (µg/L)	ETBE (µg/L)	TBA (µg/L)	TAME (µg/L)
MW-8	6/23/1993	97.61	17.64	0.00	79.97	350	43	9	35	67	--	--	--	--	--
MW-8	9/30/1993	97.61	18.85	0.00	78.76	2700	190	340	170	720	--	--	--	--	--
MW-8	2/6/1994	97.61	18.91	0.00	78.70	<100	<1	1	1	2	--	--	--	--	--
MW-8	5/2/1994	97.61	18.11	0.00	79.50	<100	<1	3	<1	7	--	--	--	--	--
MW-8	7/1/1994	97.61	18.43	0.00	79.18	300	18	48	19	37	--	--	--	--	--
MW-8	9/20/1994	97.61	21.43	0.00	76.18	<100	<1	<1	<1	<1	--	--	--	--	--
MW-8	12/5/1994	97.61	18.72	0.00	78.89	<50	<0.5	<0.5	<0.5	<0.5	--	--	--	--	--
MW-8	3/10/1995	97.61	18.69	0.00	78.92	--	--	--	--	--	--	--	--	--	--
MW-8	3/14/1995	97.61	14.83	0.00	82.78	<50	<0.5	<0.5	<0.5	1	--	--	--	--	--
MW-8	9/23/1996	97.61	15.83	0.00	81.78	<	<	<	<	<	<	<	<	<	<
MW-8						Not Sampled, well inaccessible since 4th Quarter, 1996.									
MW-9	6/23/1993	95.41	15.94	0.00	79.47	45000	14000	1200	2800	12000	--	--	--	--	--
MW-9	9/30/1993	95.41	17.05	0.00	78.36	86000	22000	1100	3300	15000	--	--	--	--	--
MW-9	2/6/1994	95.41	17.07	0.00	78.34	43000	10000	460	2100	7500	--	--	--	--	--
MW-9	5/2/1994	95.41	16.24	0.00	79.17	17000	5400	270	1300	4700	--	--	--	--	--
MW-9	7/1/1994	95.41	16.59	0.00	78.82	10000	2100	120	450	1300	--	--	--	--	--
MW-9	9/20/1994	95.41	19.61	0.00	75.80	7500	2200	97	400	1200	--	--	--	--	--
MW-9	12/5/1994	95.41	16.85	0.00	78.56	10000	2700	130	530	1600	--	--	--	--	--
MW-9	3/10/1995	95.41	--	--	--	--	--	--	--	--	--	--	--	--	--
MW-9	3/14/1995	95.41	14.18	0.00	81.23	18000	5900	270	1200	3680	--	--	--	--	--
MW-9						Not Sampled, well inaccessible since 1st Quarter, 1995.									



**Table 1  
Groundwater Analytical Data  
Former EZ Serve Location #100877  
Delta Project No. RPMS-877-A**

Well	Sample Collection Date	Casing Elevation (msl)	Depth to Water (feet)	Depth to Product (feet)	Water Table Elevation (msl)	TPHg (µg/L)	Benzene (µg/L)	Toluene (µg/L)	Ethyl- benzene (µg/L)	Total Xylenes (µg/L)	MTBE (µg/L)	DIPE (µg/L)	ETBE (µg/L)	TBA (µg/L)	TAME (µg/L)
MW-10	6/23/1993	97.11	17.39	0.00	79.72	35000	980	640	3500	12000	--	--	--	--	--
MW-10	9/30/1993	97.11	18.58	0.00	78.53	4000	230	12	100	680	--	--	--	--	--
MW-10	2/6/1994	97.11	18.61	0.00	78.50	2000	69	12	220	120	--	--	--	--	--
MW-10	5/2/1994	97.11	17.83	0.00	79.28	710	16	6	85	62	--	--	--	--	--
MW-10	7/1/1994	97.11	18.17	0.00	78.94	2000	52	43	120	210	--	--	--	--	--
MW-10	9/20/1994	97.11	21.15	0.00	75.96	2800	34	16	270	560	--	--	--	--	--
MW-10	12/5/1994	97.11	18.43	0.00	78.68	2700	30	13	260	430	--	--	--	--	--
MW-10	3/10/1995	97.11	15.37	0.00	81.74	--	--	--	--	--	--	--	--	--	--
MW-10	3/14/1995	97.11	15.93	0.00	81.18	1400	18	6	200	239	--	--	--	--	--
MW-10	9/23/1996	97.11	15.59	0.00	81.52	3800	4	3	220	170	397	--	--	--	--
MW-10	12/4/1996	97.11	16.15	0.00	80.96	4600	2	8	260	150	20	--	--	--	--
MW-10						Not Sampled, well inaccessible since 4th Quarter, 1996.									
MW-11	2/10/1995	92.68	11.80	0.00	80.88	7000	140	22	600	1000	--	--	--	--	--
MW-11	3/10/1995	92.68	11.58	0.00	81.10	--	--	--	--	--	--	--	--	--	--
MW-11	3/14/1995	92.68	13.96	0.00	78.72	6000	200	17	750	1276	--	--	--	--	--
MW-11	9/23/1996	92.68	12.29	0.00	80.39	27000	55	81	300	3500	40	--	--	--	--
MW-11	12/4/1996	92.68	--	--	--	--	--	--	--	--	--	--	--	--	--
MW-11	4/8/1997	92.68	10.51	0.00	82.17	24000	280	130	3000	3700	<	--	--	--	--
MW-11						Not Sampled, well inaccessible since 2nd Quarter, 1997.									

**Table 1**  
**Groundwater Analytical Data**  
**Former EZ Serve Location #100877**  
**Delta Project No. RPMS-877-A**

Well	Sample Collection  Date	Casing Elevation  (msl)	Depth to Water  (feet)	Depth to Product  (feet)	Water Table Elevation  (msl)	TPHg  (µg/L)	Benzene  (µg/L)	Toluene  (µg/L)	Ethyl- benzene  (µg/L)	Total Xylenes  (µg/L)	MTBE  (µg/L)	DİPE  (µg/L)	ETBE  (µg/L)	TBA  (µg/L)	TAME  (µg/L)
MW-12	3/10/1995	43.25	16.37	0.00	26.88	--	--	--	--	--	--	--	--	--	--
MW-12	3/14/1995	43.25	15.69	0.00	27.56	<50	<0.5	<0.5	<0.5	1	--	--	--	--	--
MW-12	9/23/1996	43.25	16.67	0.00	26.58	<	<	2	<	<	<	--	--	--	--
MW-12	12/4/1996	43.25	17.16	0.00	26.09	<	3	<	2	3	<	--	--	--	--
MW-12	4/8/1997	43.25	14.88	0.00	28.37	<	<	<	<	<	<	--	--	--	--
MW-12	6/30/1997	43.25	16.33	0.00	26.92	--	--	--	--	--	--	--	--	--	--
MW-12	11/25/1997	43.25	17.61	0.00	25.64	--	--	--	--	--	--	--	--	--	--
MW-12	6/1/1998	43.25	11.58	0.00	31.67	--	--	--	--	--	--	--	--	--	--
MW-12	6/14/2001	43.25	16.62	0.00	26.63	<50	<0.50	<0.50	<0.50	<0.50	<5.0	--	--	--	--
MW-12	11/7/2001	43.25	17.91	0.00	25.34	<50	<0.5	<0.5	<0.5	<0.5	<0.5	<0.5	<0.5	<5.0	<0.5
MW-12	1/30/2002	43.25	15.60	0.00	27.65	<50	<0.5	<0.5	<0.5	<0.5	<0.5	<0.5	<0.5	<5.0	<0.5
MW-12	5/29/2002	43.25	16.24	0.00	27.01	<50	<0.5	<0.5	<0.5	<0.5	<0.5	<0.5	<0.5	<5.0	<0.5
MW-12	8/14/2002	43.25	17.20	0.00	26.05	<50	<0.5	<0.5	<0.5	<0.5	<0.5	<0.5	<0.5	<5.0	<0.5
MW-12	11/15/2002	43.25	17.62	0.00	25.63	<50	<0.5	<0.5	<0.5	<0.5	<0.5	<0.5	<0.5	<5.0	<0.5
MW-12	10/25/2004					well not sampled, cars parked on well									
MW-12	2/25/2005	43.25	14.72	0.00	28.53	<50	<0.5	<0.5	<0.5	<0.5	<0.5	<0.5	<0.5	<5.0	<0.5

**Table 1**  
**Groundwater Analytical Data**  
**Former EZ Serve Location #100877**  
**Delta Project No. RPMS-877-A**

Well	Sample Collection Date	Casing Elevation (msl)	Depth to Water (feet)	Depth to Product (feet)	Water Table Elevation (msl)	TPHg (µg/L)	Benzene (µg/L)	Toluene (µg/L)	Ethyl-benzene (µg/L)	Total Xylenes (µg/L)	MTBE (µg/L)	DIPE (µg/L)	ETBE (µg/L)	TBA (µg/L)	TAME (µg/L)
MW-13	2/10/1995	40.97	14.45	0.00	26.52	<50	<0.5	<0.5	<0.5	<0.5	--	--	--	--	--
MW-13	3/10/1995	40.97	14.30	0.00	26.67	--	--	--	--	--	--	--	--	--	--
MW-13	3/14/1995	40.97	15.81	0.00	25.16	<50	<0.5	<0.5	<0.5	1	--	--	--	--	--
MW-13	9/23/1996	40.97	14.60	0.00	26.37	<	<	1	1	<	<	--	--	--	--
MW-13	12/4/1996	40.97	--	--	--	--	--	--	--	--	--	--	--	--	--
MW-13	4/8/1997	40.97	12.75	0.00	28.22	<	<	<	<	<	<	--	--	--	--
MW-13	6/30/1997	40.97	14.13	0.00	26.84	--	--	--	--	--	--	--	--	--	--
MW-13	11/25/1997	40.97	15.48	0.00	25.49	--	--	--	--	--	--	--	--	--	--
MW-13	6/1/1998	40.97	9.58	0.00	31.39	--	--	--	--	--	--	--	--	--	--
MW-13	6/14/2001	40.97	14.51	0.00	26.46	<50	<0.50	<0.50	<0.50	<0.50	<5.0	--	--	--	--
MW-13	11/7/2001	40.97	15.85	0.00	25.12	<50	<0.5	<0.5	<0.5	<0.5	<0.5	<0.5	<0.5	<5.0	<0.5
MW-13	1/30/2002	40.97	13.65	0.00	27.32	<50	<0.5	<0.5	<0.5	<0.5	<0.5	<0.5	<0.5	<5.0	<0.5
MW-13	5/29/2002	40.97	14.10	0.00	26.87	<50	<0.5	<0.5	<0.5	<0.5	<0.5	<0.5	<0.5	<5.0	<0.5
MW-13	8/14/2002	40.97	15.13	0.00	25.84	<50	<0.5	<0.5	<0.5	<0.5	<0.5	<0.5	<0.5	<5.0	<0.5
MW-13	11/15/2002	40.97	--	--	--	--	--	--	--	--	--	--	--	--	--
MW-13	10/25/2004														

well not sampled, can't locate well

**Table 1  
Groundwater Analytical Data  
Former EZ Serve Location #100877  
Delta Project No. RPMS-877-A**

Well	Sample Collection  Date	Casing Elevation  (msl)	Depth to Water  (feet)	Depth to Product  (feet)	Water Table Elevation  (msl)	TPHg  (µg/L)	Benzene  (µg/L)	Toluene  (µg/L)	Ethyl- benzene  (µg/L)	Total Xylenes  (µg/L)	MTBE  (µg/L)	DIPE  (µg/L)	ETBE  (µg/L)	TBA  (µg/L)	TAME  (µg/L)
MW-14	3/10/1995	43.19	16.33	0.00	26.86	--	--	--	--	--	--	--	--	--	--
MW-14	3/14/1995	43.19	14.87	0.00	28.32	1400	6	2	36	298	--	--	--	--	--
MW-14	9/23/1996	43.19	16.67	0.00	26.52	6400	3	<	690	96	10	--	--	--	--
MW-14	12/4/1996	43.19	17.06	0.00	26.13	9500	6	<	1100	400	30	--	--	--	--
MW-14	4/8/1997	43.19	14.77	0.00	28.42	2900	<	3	220	21	<	--	--	--	--
MW-14	6/30/1997	43.19	16.22	0.00	26.97	74	1	<	1	1	<	--	--	--	--
MW-14	11/25/1997	43.19	17.52	0.00	25.67	<	<	<	<	<	<	--	--	--	--
MW-14	6/1/1998	43.19	11.46	0.00	31.73	<50	<0.5	<0.5	<0.5	<0.5	<5	--	--	--	--
MW-14	6/14/2001	43.19	16.53	0.00	26.66	470	<0.5	<0.5	3	1	<5	--	--	--	--
MW-14	11/7/2001	43.19	17.84	0.00	25.35	<50	<0.5	<0.5	<0.5	<0.5	<0.5	<0.5	<0.5	<5.0	<0.5
MW-14	1/30/2002	43.19	15.55	0.00	27.64	<50	<0.5	<0.5	<0.5	<0.5	<0.5	<0.5	<0.5	<5.0	<0.5
MW-14	5/29/2002	43.19	16.14	0.00	27.05	<50	<0.5	<0.5	<0.5	<0.5	<0.5	<0.5	<0.5	<5.0	<0.5
MW-14	8/14/2002	43.19	17.12	0.00	26.07	<50	<0.5	<0.5	<0.5	<0.5	<0.5	<0.5	<0.5	<5.0	<0.5
MW-14	11/15/2002	43.19	17.56	0.00	25.63	<50	<0.5	<0.5	<0.5	<0.5	<0.5	<0.5	<0.5	<5.0	<0.5
MW-14	10/25/2004		well not sampled, can't locate well / cars parked on well												
MW-14	2/25/2005	43.19	14.20	0.00	28.99	210.00	<0.5	<0.5	0.56	<0.5	<0.5	<0.5	<0.5	<5.0	<0.5

**Table 1**  
**Groundwater Analytical Data**  
**Former EZ Serve Location #100877**  
**Delta Project No. RPMS-877-A**

Well	Sample Collection  Date	Casing Elevation  (msl)	Depth to Water  (feet)	Depth to Product  (feet)	Water Table Elevation  (msl)	TPHg  (µg/L)	Benzene  (µg/L)	Toluene  (µg/L)	Ethyl- benzene  (µg/L)	Total Xylenes  (µg/L)	MTBE  (µg/L)	DIPE  (µg/L)	ETBE  (µg/L)	TBA  (µg/L)	TAME  (µg/L)
EX-1	11/15/2002	--	17.02	0.00	--	67	4	<0.5	<0.5	<0.5	1	<0.5	<0.5	<5.0	<0.5
EX-1	10/25/2004	--	16.91	0.00	--	96	2	<0.50	5	2	<0.5	<0.5	<0.5	<5.0	<0.50
EX-1	12/23/2004	--	16.60	0.00	--	<50	<0.50	<0.50	1	<0.50	<0.50	<0.50	<0.50	<5.0	<0.50
EX-1	2/25/2005	--	13.72	0.00	--	59	1.4	<0.50	2.0	0.87	<0.50	<0.50	<0.50	<5.0	<0.50

Notes: No known groundwater monitoring or sampling was conducted between June 1, 1998 and June 14, 2001 and June 14, 2001 and November 7, 2001 Wellhead elevations resurveyed on January 30, 2002.

Explanations

- msl = mean seal level
- (µg/L) = micrograms per liter
- TBA = Tertiary butyl alcohol
- MTBE = Methyl tertiary butyl ether
- DIPE = Di-isopropyl ether
- ETBE = Ethyl tertiary butyl ether
- TAME = Tertiary amyl methyl ether
- EDB = 1,2-Dibromoethane
- = Not measured, or analyzed
- DRY = Insufficient water to sample
- TPHg = Total Petroleum Hydrocarbons as gasoline (EPA Method 8015).
- SHEEN = Discontinuous, non-measurable thickness of PSH.
- < = Sample reported as "not detected," in previous tables, reporting limit not known.



0 1000 FT 2000 FT  
SCALE: 1 : 24,000



FIGURE 1

SITE LOCATION MAP

FORMER E-Z SERVE NO. 100877  
525 WEST A STREET  
HAYWARD, CALIFORNIA

PROJECT NO RPMS-0877	DRAWN BY MC 11/10/04
FILE NO EZ-100877-F1	PREPARED BY JS
REVISION NO. 1	REVIEWED BY



SOURCE: USGS 7 5 MINUTE TOPOGRAPHIC MAP, HAYWARD QUADRANGLE, 1962

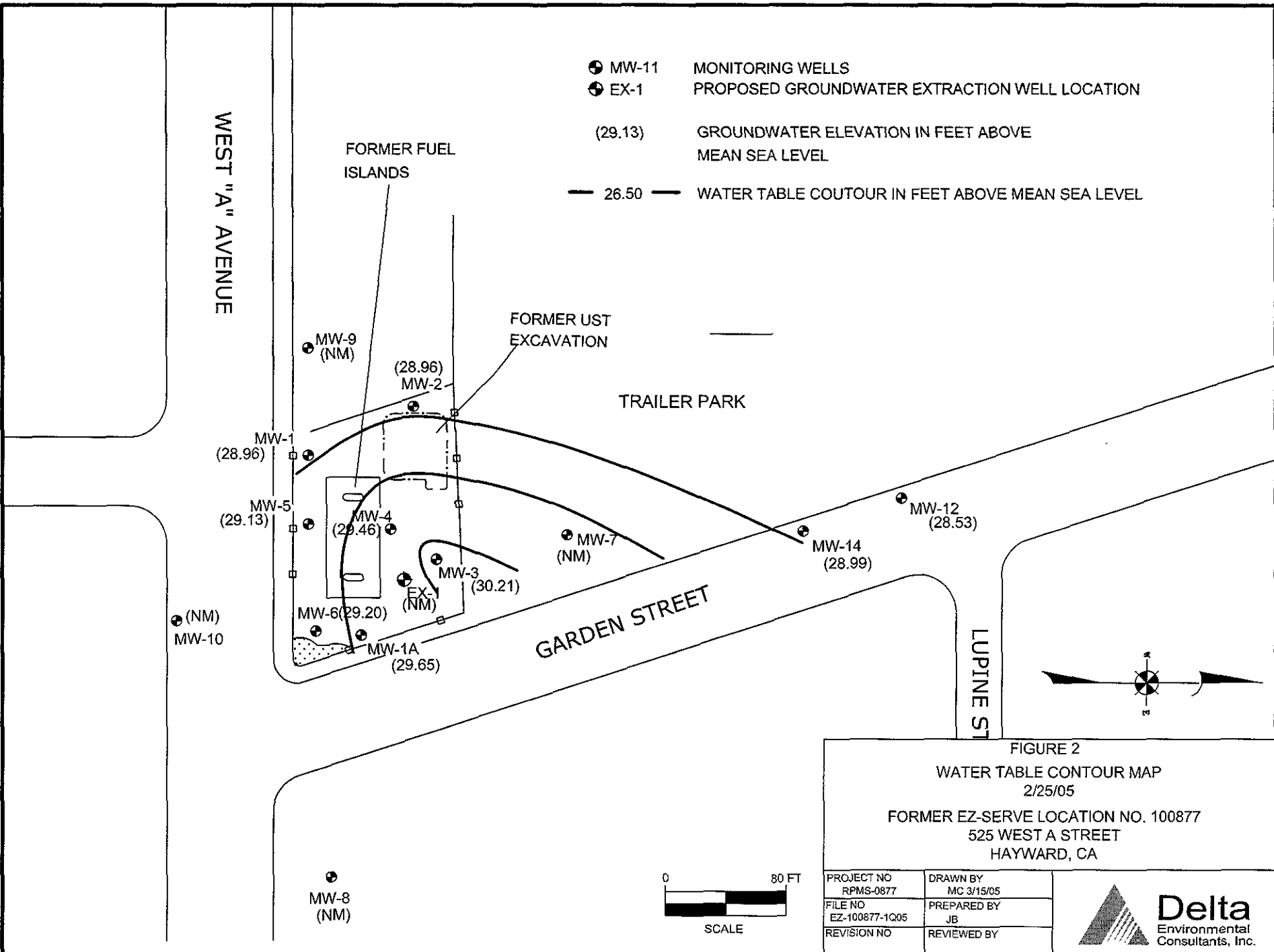

- MW-11 MONITORING WELLS
- EX-1 PROPOSED GROUNDWATER EXTRACTION WELL LOCATION
- (29.13) GROUNDWATER ELEVATION IN FEET ABOVE MEAN SEA LEVEL
- 26.50 — WATER TABLE COUTOUR IN FEET ABOVE MEAN SEA LEVEL

FIGURE 2  
 WATER TABLE CONTOUR MAP  
 2/25/05

FORMER EZ-SERVE LOCATION NO. 100877  
 525 WEST A STREET  
 HAYWARD, CA



PROJECT NO RPMS-0877	DRAWN BY MC 3/15/05
FILE NO EZ-100877-1Q05	PREPARED BY JB
REVISION NO	REVIEWED BY



**Appendix A**  
Groundwater Sampling Information Sheets



SAMPLING INFORMATION SHEET



Sample ID# MW-1 Project Name: E2 Sewer # 10877 Project No. RPMS-0877

Location (address) 525 West A Street, Hayward CA

Date Sampled: 2/24/05 Time: 2:10

Wellhead assembly condition:  Good  Fair  Poor (If poor, see comments)

Equipment Replaced:  bolts  locks  locking cap

Well Depth 29.89 ft below top of casing Casing diameter 4 inches

Depth to water (below top of casing) 12.79 ft. Date: 2/24/05 Time 1:45

Well Casing Volume Multiplier: 0.16 for 2", 0.65 for 4", 1.47 for 6"

Purging method:  Submersible pump  Bailor  Centrifugal pump  Other

At least 3 well volumes have been evacuated before sampling.

Tubing (type: \_\_\_\_\_). (new or previously used) was used to purge well

Sampling method:  Disposable bailer  Sampling port

Samples collected 3 Sample appearance Clear

Note any sampling problems \_\_\_\_\_

GROUND WATER EVACUATION/STABILIZATION DATA

Time	Temperature (°F)	pH Units	Conductance (umhos/cm)	Water Level (Nearest 0.01 ft)	Cumulative Volume of Water Removed from Well (gallons)
1:50	17.1	8.26	619	13.39	1
1:54	18.1	8.23	611	13.84	11
1:58	18.1	8.26	601	14.40	22
2:05	18.2	8.25	600	15.02	33

Comments: \_\_\_\_\_  
 \_\_\_\_\_  
 \_\_\_\_\_

Transportation (thermal preservation)

Form completed by: Todd Shelton

Sampled by: [Signature]

SAMPLING INFORMATION SHEET



Sample ID# MW-1A Project Name: EZ serve 10877 Project No. RPMS-0877  
 Location (address) 525 West A Street, Hayward CA  
 Date Sampled: 2/24/05 Time: 2:55  
 Wellhead assembly condition:  Good  Fair  Poor (If poor, see comments)  
 Equipment Replaced:  bolts  locks  locking cap  
 Well Depth 29.05 ft below top of casing Casing diameter 2 inches  
 Depth to water (below top of casing) 13.75 ft. Date: 2/24/05 Time 2:40  
 Well Casing Volume Multiplier: 0.16 for 2", 0.65 for 4", 1.47 for 6"  
 Purging method:  Submersible pump  Bailor  Centrifugal pump  Other \_\_\_\_\_  
 At least 3 well volumes have been evacuated before sampling.  
 Tubing (type: \_\_\_\_\_). (new or previously used) was used to purge well  
 Sampling method:  Disposable bailer  Sampling port  
 Samples collected 3 Sample appearance Slightly Turbid  
 Note any sampling problems \_\_\_\_\_

GROUND WATER EVACUATION/STABILIZATION DATA

Time	Temperature (°F)	pH Units	Conductance (umhos/cm)	Water Level (Nearest 0.01 ft)	Cumulative Volume of Water Removed from Well (gallons)
2:45	17.2	8.38	582	16.98	1
2:47	18.5	8.39	582	17.37	3
2:49	18.7	8.41	584	17.82	6
2:52	18.8	8.40	587	18.29	9

Comments: Strong Hydrocarbon odor

Transportation (thermal preservation) \_\_\_\_\_

Form completed by: Todd Shelton

Sampled by: Todd Shelton

SAMPLING INFORMATION SHEET



Sample ID# MW-2 Project Name: EZ Sewer 10877 Project No. RPMS-0877  
 Location (address) 525 West A Street  
 Date Sampled: 2/24/05 Time: 2:35  
 Wellhead assembly condition:  Good  Fair  Poor (If poor, see comments)  
 Equipment Replaced:  bolts  locks  locking cap  
 Well Depth 30.14 ft below top of casing Casing diameter 4 inches  
 Depth to water (below top of casing) 14.30 ft Date: 2/24/05 Time 2:10  
 Well Casing Volume Multiplier: 0.16 for 2", 0.65 for 4", 1.47 for 6"  
 Purging method:  Submersible pump  Bailer  Centrifugal pump  Other  
 At least 3 well volumes have been evacuated before sampling.  
 Tubing (type: \_\_\_\_\_). (new or previously used) was used to purge well  
 Sampling method:  Disposable bailer  Sampling port  
 Samples collected 3 Sample appearance Clear  
 Note any sampling problems \_\_\_\_\_

GROUND WATER EVACUATION/STABILIZATION DATA

Time	Temperature (°F)	pH Units	Conductance (umhos/cm)	Water Level (Nearest 0.01 ft)	Cumulative Volume of Water Removed from Well (gallons)
2:15	16.9	8.37	584	17.85	1
2:20	17.3	8.35	588	18.36	10
2:25	17.3	8.34	600	18.94	20
2:30	17.4	8.32	600	19.57	30

Comments: \_\_\_\_\_  
 \_\_\_\_\_  
 \_\_\_\_\_

Transportation (thermal preservation) \_\_\_\_\_  
 Form completed by: Todd Shelton Sampled by: Todd Shelton

SAMPLING INFORMATION SHEET



Sample ID# MW-3 Project Name: EZ-Serve #10877 Project No. RPMS-0877  
 Location (address) 525 West A Street, Hayward CA  
 Date Sampled: 2/24/05 Time: \_\_\_\_\_  
 Wellhead assembly condition:  Good \_\_\_\_\_ Fair \_\_\_\_\_ Poor (If poor, see comments)  
 Equipment Replaced: \_\_\_\_\_ bolts \_\_\_\_\_ locks \_\_\_\_\_ locking cap  
 Well Depth ~~29.74~~ 14.8 ft below top of casing Casing diameter 4 inches  
 Depth to water (below top of casing) 13.68 ft. Date: 2/24/05 Time \_\_\_\_\_  
 Well Casing Volume Multiplier: 0.16 for 2", 0.65 for 4", 1.47 for 6"  
 Purging method:  Submersible pump \_\_\_\_\_ Bailer \_\_\_\_\_ Centrifugal pump \_\_\_\_\_ Other \_\_\_\_\_  
 At least \_\_\_\_\_ well volumes have been evacuated before sampling.  
 Tubing (type: \_\_\_\_\_). (new or previously used) was used to purge well  
 Sampling method:  Disposable bailer \_\_\_\_\_ Sampling port  
 Samples collected 3 Sample appearance Cloudy  
 Note any sampling problems Well Total Depth - 14.8'  
Grab Sample collected

GROUND WATER EVACUATION/STABILIZATION DATA

Time	Temperature (°F)	pH Units	Conductance (umhos/cm)	Water Level (Nearest 0.01 ft)	Cumulative Volume of Water Removed from Well (gallons)
1235	16.9	8.50	796	13.68	1
					10
					20
					30

Comments: \_\_\_\_\_  
There was an obstructions @ 14.8'. I Grabbed a sample, very slow  
Recharge if any.

Transportation (thermal preservation) \_\_\_\_\_  
 Form completed by: Todd Shelton Sampled by: [Signature]

SAMPLING INFORMATION SHEET



Sample ID# MW-4 Project Name: EZ Sene 10877 Project No. RPMs-10877  
 Location (address) 525 West A Street, Hayward, CA  
 Date Sampled: 2/24/05 Time: 1:10  
 Wellhead assembly condition:  Good  Fair  Poor (If poor, see comments)  
 Equipment Replaced:  bolts  locks  locking cap  
 Well Depth 30.00 ft below top of casing Casing diameter 4 inches  
 Depth to water (below top of casing) 13.30 ft Date: 2/24/05 Time 1245  
 Well Casing Volume Multiplier: 0.16 for 2", 0.65 for 4", 1.47 for 6"  
 Purging method:  Submersible pump  Bailer  Centrifugal pump  Other  
 At least 3 well volumes have been evacuated before sampling.  
 Tubing (type: \_\_\_\_\_). (new or previously used) was used to purge well  
 Sampling method:  Disposable bailer  Sampling port  
 Samples collected 3 Sample appearance Clear  
 Note any sampling problems \_\_\_\_\_

GROUND WATER EVACUATION/STABILIZATION DATA

Time	Temperature (°F)	pH Units	Conductance (umhos/cm)	Water Level (Nearest 0.01 ft)	Cumulative Volume of Water Removed from Well (gallons)
12:50	16.9	8.30	672	15.85	1
12:55	17.6	8.30	640	16.48	10
1:00	17.7	8.37	648	17.14	20
1:05	17.9	8.38	651	17.82	30

Comments: Strong Hydrocarbon odor.

Transportation (thermal preservation) \_\_\_\_\_  
 Form completed by: Todd Seton Sampled by: Todd Seton

SAMPLING INFORMATION SHEET



Sample ID# MW-5 Project Name: EZ Sene 10877 Project No. RMS-0877  
 Location (address) 525 West A Street, Hayward CA  
 Date Sampled: 2/24/05 Time: 1:50  
 Wellhead assembly condition:  Good  Fair  Poor (If poor, see comments)  
 Equipment Replaced:  bolts  locks  locking cap  
 Well Depth 30.20 ft below top of casing Casing diameter 4 inches  
 Depth to water (below top of casing) 12.97 ft. Date: 2/24/05 Time 1:35  
 Well Casing Volume Multiplier: 0.16 for 2", 0.65 for 4", 1.47 for 6"  
 Purging method:  Submersible pump  Bailer  Centrifugal pump  Other  
 At least 3 well volumes have been evacuated before sampling.  
 Tubing (type: \_\_\_\_\_). (new or previously used) was used to purge well  
 Sampling method:  Disposable bailer  Sampling port  
 Samples collected 3 Sample appearance Clear  
 Note any sampling problems \_\_\_\_\_

GROUND WATER EVACUATION/STABILIZATION DATA

Time	Temperature (°F)	pH Units	Conductance (umhos/cm)	Water Level (Nearest 0.01 ft)	Cumulative Volume of Water Removed from Well (gallons)
1:38	17.2	8.22	451	15.83	1
1:41	18.5	8.21	636	16.26	11
1:44	18.4	8.26	629	16.74	22
1:48	18.4	8.27	626	17.21	33

Comments: \_\_\_\_\_  
 \_\_\_\_\_  
 \_\_\_\_\_

Transportation (thermal preservation)

Form completed by: Todd Shelton

Sampled by: [Signature]

SAMPLING INFORMATION SHEET



Sample ID# MW-6 Project Name: E7 Sene 10877 Project No. RPM5-0877  
 Location (address) 525 West A Street, Hayward CA  
 Date Sampled: 2/24/05 Time: 1:30  
 Wellhead assembly condition:  Good  Fair  Poor (If poor, see comments)  
 Equipment Replaced:  bolts  locks  locking cap  
 Well Depth 30.00 ft below top of casing Casing diameter 4 inches  
 Depth to water (below top of casing) 13.13 ft Date: 2/24/05 Time 1:10  
 Well Casing Volume Multiplier: 0.16 for 2", 0.65 for 4", 1.47 for 6"  
 Purging method:  Submersible pump  Bailer  Centrifugal pump  Other \_\_\_\_\_  
 At least 3 well volumes have been evacuated before sampling.  
 Tubing (type: \_\_\_\_\_). (new or previously used) was used to purge well  
 Sampling method:  Disposable bailer  Sampling port  
 Samples collected 3 Sample appearance clear  
 Note any sampling problems \_\_\_\_\_

GROUND WATER EVACUATION/STABILIZATION DATA

Time	Temperature (°F)	pH Units	Conductance (umhos/cm)	Water Level (Nearest 0.01 ft)	Cumulative Volume of Water Removed from Well (gallons)
1:15	10.5	8.25	679	15.68	1
1:18	10.5	8.28	670	15.76	10
1:22	10.9	8.23	670	16.36	20
1:25	10.8	8.25	670	17.07	30

Comments: \_\_\_\_\_

Transportation (thermal preservation) \_\_\_\_\_

Form completed by: Todd Shelton

Sampled by: [Signature]

SAMPLING INFORMATION SHEET



Sample ID# EX-1 Project Name: EZ Sene 10877 Project No. RPMS-0877  
 Location (address) 525 West A Street, Hayward, CA  
 Date Sampled: 2/24/05 Time: 12:25  
 Wellhead assembly condition:  Good  Fair  Poor (If poor, see comments)  
 Equipment Replaced:  bolts  locks  locking cap  
 Well Depth 34.45 ft below top of casing Casing diameter 6 inches  
 Depth to water (below top of casing) 13.72 ft Date: 2/24/05 Time 11:38  
 Well Casing Volume Multiplier: 0.16 for 2", 0.65 for 4", 1.47 for 6"  
 Purging method:  Submersible pump  Bailer  Centrifugal pump  Other \_\_\_\_\_  
 At least 3 well volumes have been evacuated before sampling.  
 Tubing (type: \_\_\_\_\_). (new or previously used) was used to purge well  
 Sampling method:  Disposable bailer  Sampling port  
 Samples collected 3 Sample appearance Clear  
 Note any sampling problems \_\_\_\_\_

GROUND WATER EVACUATION/STABILIZATION DATA

Time	Temperature (°F)	pH Units	Conductance (umhos/cm)	Water Level (Nearest 0.01 ft)	Cumulative Volume of Water Removed from Well (gallons)
1200	18.1	8.77	552	15.26	1
1210	18.5	8.25	610	15.92	30
1215	18.5	8.23	621	16.54	60
1222	18.3	8.22	625	17.14	90

Comments: mild hydrocarbon odor

Transportation (thermal preservation) \_\_\_\_\_  
 Form completed by: Todd Skelton Sampled by: Callie Bell



SAMPLING INFORMATION SHEET



Sample ID# MW-12 Project Name: Force FZ Sense # 100877 Project No. RPMS-0877  
 Location (address) 525 West A Street Hayward CA  
 Date Sampled: 2/25/05 Time: 1200  
 Wellhead assembly condition:  Good  Fair  Poor (If poor, see comments)  
 Equipment Replaced:  bolts  locks  locking cap  
 Well Depth 29.7 ft below top of casing Casing diameter 2 inches  
 Depth to water (below top of casing) 14.07 ft. Date: 2/25/05 Time 11:35  
 Well Casing Volume Multiplier: 0.16 for 2", 0.65 for 4", 1.47 for 6"  
 Purging method:  Submersible pump  Bailor  Centrifugal pump  Other  
 At least 3 well volumes have been evacuated before sampling.  
 Tubing (type: \_\_\_\_\_). (new or previously used) was used to purge well  
 Sampling method:  Disposable bailer  Sampling port  
 Samples collected 3 Sample appearance Slightly Turbid  
 Note any sampling problems \_\_\_\_\_

GROUND WATER EVACUATION/STABILIZATION DATA

Time	Temperature (°F)	pH Units	Conductance (umhos/cm)	Water Level (Nearest 0.01 ft)	Cumulative Volume of Water Removed from Well (gallons)
1145	15.6	8.95	230	19.03	1
1148	18.3	8.26	450	19.71	4
1151	18.1	8.18	460	20.53	8
1155	18.1	8.14	465	21.41	12

Comments: \_\_\_\_\_  
 \_\_\_\_\_  
 \_\_\_\_\_

Transportation (thermal preservation) \_\_\_\_\_  
 Form completed by: Todd Shelton Sampled by: [Signature]

SAMPLING INFORMATION SHEET



Sample ID# MW-14 Project Name: Fence E.Z. Sene # 100877 Project No. EPMS-0877  
 Location (address) 525 West A Street, Hayward CA  
 Date Sampled: 2/25/05 Time: 1240  
 Wellhead assembly condition:  Good  Fair  Poor (If poor, see comments)  
 Equipment Replaced:  bolts  locks  locking cap  
 Well Depth 30.1 ft below top of casing Casing diameter 2 inches  
 Depth to water (below top of casing) 14.00 ft. Date: 2/25/05 Time 12:15  
 Well Casing Volume Multiplier: 0.16 for 2", 0.65 for 4", 1.47 for 6"  
 Purging method:  Submersible pump  Bailor  Centrifugal pump  Other \_\_\_\_\_  
 At least 3 well volumes have been evacuated before sampling.  
 Tubing (type: \_\_\_\_\_). (new or previously used) was used to purge well  
 Sampling method:  Disposable bailer  Sampling port  
 Samples collected 3 Sample appearance Clear  
 Note any sampling problems \_\_\_\_\_

GROUND WATER EVACUATION/STABILIZATION DATA

Time	Temperature (°F)	pH Units	Conductance (umhos/cm)	Water Level (Nearest 0.01 ft)	Cumulative Volume of Water Removed from Well (gallons)
1220	20.1	8.46	464	18.62	1
1223	18.1	<del>8.33</del> 8.33	480	19.17	3
1227	18.0	8.28	482	19.76	6
1233	18.0	8.26	484	20.26	9

Comments: Need New Expansion plug  
manhole cover will NOT screw down

Transportation (thermal preservation) \_\_\_\_\_  
 Form completed by: Todd Shelton Sampled by: [Signature]

**APPENDIX B**  
Groundwater Laboratory Analytical Data and Graphs



Report Number : 42547

Date : 3/4/2005

Jim Brownell  
Delta Environmental Consultants, Inc.  
3164 Gold Camp Drive, Suite 200  
Rancho Cordova, CA 95670

Subject : 10 Water Samples  
Project Name : EZ Serve # 100877  
Project Number : RPMS.0877

Dear Mr. Brownell,

Chemical analysis of the samples referenced above has been completed. Summaries of the data are contained on the following pages. Sample(s) were received under documented chain-of-custody. US EPA protocols for sample storage and preservation were followed.

Kiff Analytical is certified by the State of California (# 2236). If you have any questions regarding procedures or results, please call me at 530-297-4800.

Sincerely,

A handwritten signature in black ink, appearing to read "Joel Kiff".

Joel Kiff



Report Number : 42547

Date : 3/4/2005

Project Name : EZ Serve # 100877

Project Number : RPMS.0877

Sample : MW-1

Matrix : Water

Lab Number : 42547-01

Sample Date :2/24/2005

Parameter	Measured Value	Method Reporting Limit	Units	Analysis Method	Date Analyzed
<b>Benzene</b>	<b>710</b>	1.5	ug/L	EPA 8260B	3/4/2005
<b>Toluene</b>	<b>6.7</b>	1.5	ug/L	EPA 8260B	3/4/2005
<b>Ethylbenzene</b>	<b>720</b>	1.5	ug/L	EPA 8260B	3/4/2005
<b>Total Xylenes</b>	<b>330</b>	1.5	ug/L	EPA 8260B	3/4/2005
<b>Methyl-t-butyl ether (MTBE)</b>	<b>24</b>	1.5	ug/L	EPA 8260B	3/4/2005
<b>Diisopropyl ether (DIPE)</b>	<b>&lt; 1.5</b>	1.5	ug/L	EPA 8260B	3/4/2005
<b>Ethyl-t-butyl ether (ETBE)</b>	<b>&lt; 1.5</b>	1.5	ug/L	EPA 8260B	3/4/2005
<b>Tert-amyl methyl ether (TAME)</b>	<b>&lt; 1.5</b>	1.5	ug/L	EPA 8260B	3/4/2005
<b>Tert-Butanol</b>	<b>11</b>	7.0	ug/L	EPA 8260B	3/4/2005
<b>TPH as Gasoline</b>	<b>11000</b>	150	ug/L	EPA 8260B	3/4/2005
Toluene - d8 (Surr)	94.6		% Recovery	EPA 8260B	3/4/2005
4-Bromofluorobenzene (Surr)	111		% Recovery	EPA 8260B	3/4/2005

Approved By:

Joel Kiff



Report Number : 42547

Date : 3/4/2005

Project Name : EZ Serve # 100877

Project Number : RPMS.0877

Sample : MW-1A

Matrix : Water

Lab Number : 42547-02

Sample Date :2/24/2005

Parameter	Measured Value	Method Reporting Limit	Units	Analysis Method	Date Analyzed
Benzene	4.7	0.50	ug/L	EPA 8260B	3/2/2005
Toluene	1.1	0.50	ug/L	EPA 8260B	3/2/2005
Ethylbenzene	140	0.50	ug/L	EPA 8260B	3/2/2005
Total Xylenes	24	0.50	ug/L	EPA 8260B	3/2/2005
Methyl-t-butyl ether (MTBE)	< 0.50	0.50	ug/L	EPA 8260B	3/2/2005
Diisopropyl ether (DIPE)	< 0.50	0.50	ug/L	EPA 8260B	3/2/2005
Ethyl-t-butyl ether (ETBE)	< 0.50	0.50	ug/L	EPA 8260B	3/2/2005
Tert-amyl methyl ether (TAME)	< 0.50	0.50	ug/L	EPA 8260B	3/2/2005
Tert-Butanol	< 5.0	5.0	ug/L	EPA 8260B	3/2/2005
TPH as Gasoline	7300	200	ug/L	EPA 8260B	3/2/2005
Toluene - d8 (Surr)	96.6		% Recovery	EPA 8260B	3/2/2005
4-Bromofluorobenzene (Surr)	108		% Recovery	EPA 8260B	3/2/2005

Approved By:

Joel Kiff



Report Number : 42547

Date : 3/4/2005

Project Name : EZ Serve # 100877

Project Number : RPMS.0877

Sample : MW-2

Matrix : Water

Lab Number : 42547-03

Sample Date :2/24/2005

Parameter	Measured Value	Method Reporting Limit	Units	Analysis Method	Date Analyzed
<b>Benzene</b>	<b>320</b>	2.0	ug/L	EPA 8260B	3/3/2005
<b>Toluene</b>	<b>4.8</b>	2.0	ug/L	EPA 8260B	3/3/2005
<b>Ethylbenzene</b>	<b>860</b>	2.0	ug/L	EPA 8260B	3/3/2005
<b>Total Xylenes</b>	<b>1600</b>	4.0	ug/L	EPA 8260B	3/4/2005
<b>Methyl-t-butyl ether (MTBE)</b>	<b>7.7</b>	2.0	ug/L	EPA 8260B	3/3/2005
<b>Diisopropyl ether (DIPE)</b>	<b>&lt; 2.0</b>	2.0	ug/L	EPA 8260B	3/3/2005
<b>Ethyl-t-butyl ether (ETBE)</b>	<b>&lt; 2.0</b>	2.0	ug/L	EPA 8260B	3/3/2005
<b>Tert-amyl methyl ether (TAME)</b>	<b>&lt; 2.0</b>	2.0	ug/L	EPA 8260B	3/3/2005
<b>Tert-Butanol</b>	<b>&lt; 9.0</b>	9.0	ug/L	EPA 8260B	3/3/2005
<b>TPH as Gasoline</b>	<b>15000</b>	200	ug/L	EPA 8260B	3/3/2005
Toluene - d8 (Surr)	101		% Recovery	EPA 8260B	3/3/2005
4-Bromofluorobenzene (Surr)	100		% Recovery	EPA 8260B	3/3/2005

Approved By:

Joe Kiff



Report Number : 42547

Date : 3/4/2005

Project Name : EZ Serve # 100877

Project Number : RPMS.0877

Sample : MW-3

Matrix : Water

Lab Number : 42547-04

Sample Date :2/24/2005

Parameter	Measured Value	Method Reporting Limit	Units	Analysis Method	Date Analyzed
<b>Benzene</b>	<b>1.1</b>	0.50	ug/L	EPA 8260B	3/3/2005
<b>Toluene</b>	<b>&lt; 0.50</b>	0.50	ug/L	EPA 8260B	3/3/2005
<b>Ethylbenzene</b>	<b>0.70</b>	0.50	ug/L	EPA 8260B	3/3/2005
<b>Total Xylenes</b>	<b>1.3</b>	0.50	ug/L	EPA 8260B	3/3/2005
<b>Methyl-t-butyl ether (MTBE)</b>	<b>1.4</b>	0.50	ug/L	EPA 8260B	3/3/2005
<b>Diisopropyl ether (DIPE)</b>	<b>&lt; 0.50</b>	0.50	ug/L	EPA 8260B	3/3/2005
<b>Ethyl-t-butyl ether (ETBE)</b>	<b>&lt; 0.50</b>	0.50	ug/L	EPA 8260B	3/3/2005
<b>Tert-amyl methyl ether (TAME)</b>	<b>&lt; 0.50</b>	0.50	ug/L	EPA 8260B	3/3/2005
<b>Tert-Butanol</b>	<b>&lt; 5.0</b>	5.0	ug/L	EPA 8260B	3/3/2005
<b>TPH as Gasoline</b>	<b>90</b>	50	ug/L	EPA 8260B	3/3/2005
Toluene - d8 (Surr)	99.4		% Recovery	EPA 8260B	3/3/2005
4-Bromofluorobenzene (Surr)	101		% Recovery	EPA 8260B	3/3/2005

Approved By:

Joel Kiff





Report Number : 42547

Date : 3/4/2005

Project Name : EZ Serve # 100877

Project Number : RPMS.0877

Sample : MW-4

Matrix : Water

Lab Number : 42547-05

Sample Date :2/24/2005

Parameter	Measured Value	Method Reporting Limit	Units	Analysis Method	Date Analyzed
<b>Benzene</b>	<b>160</b>	0.90	ug/L	EPA 8260B	3/3/2005
<b>Toluene</b>	<b>15</b>	0.90	ug/L	EPA 8260B	3/3/2005
<b>Ethylbenzene</b>	<b>280</b>	0.90	ug/L	EPA 8260B	3/3/2005
<b>Total Xylenes</b>	<b>420</b>	0.90	ug/L	EPA 8260B	3/3/2005
<b>Methyl-t-butyl ether (MTBE)</b>	<b>6.2</b>	0.90	ug/L	EPA 8260B	3/3/2005
<b>Diisopropyl ether (DIPE)</b>	<b>&lt; 0.90</b>	0.90	ug/L	EPA 8260B	3/3/2005
<b>Ethyl-t-butyl ether (ETBE)</b>	<b>&lt; 0.90</b>	0.90	ug/L	EPA 8260B	3/3/2005
<b>Tert-amyl methyl ether (TAME)</b>	<b>&lt; 0.90</b>	0.90	ug/L	EPA 8260B	3/3/2005
<b>Tert-Butanol</b>	<b>&lt; 5.0</b>	5.0	ug/L	EPA 8260B	3/3/2005
<b>TPH as Gasoline</b>	<b>4200</b>	90	ug/L	EPA 8260B	3/3/2005
Toluene - d8 (Surr)	98.9		% Recovery	EPA 8260B	3/3/2005
4-Bromofluorobenzene (Surr)	103		% Recovery	EPA 8260B	3/3/2005

Approved By:

Joel Kiff



Report Number : 42547

Date : 3/4/2005

Project Name : EZ Serve # 100877

Project Number : RPMS.0877

Sample : MW-5

Matrix : Water

Lab Number : 42547-06

Sample Date :2/24/2005

Parameter	Measured Value	Method Reporting Limit	Units	Analysis Method	Date Analyzed
<b>Benzene</b>	<b>44</b>	0.50	ug/L	EPA 8260B	3/3/2005
<b>Toluene</b>	<b>0.59</b>	0.50	ug/L	EPA 8260B	3/3/2005
<b>Ethylbenzene</b>	<b>110</b>	0.50	ug/L	EPA 8260B	3/3/2005
<b>Total Xylenes</b>	<b>4.8</b>	0.50	ug/L	EPA 8260B	3/3/2005
<b>Methyl-t-butyl ether (MTBE)</b>	<b>0.85</b>	0.50	ug/L	EPA 8260B	3/3/2005
<b>Diisopropyl ether (DIPE)</b>	<b>&lt; 0.50</b>	0.50	ug/L	EPA 8260B	3/3/2005
<b>Ethyl-t-butyl ether (ETBE)</b>	<b>&lt; 0.50</b>	0.50	ug/L	EPA 8260B	3/3/2005
<b>Tert-amyl methyl ether (TAME)</b>	<b>&lt; 0.50</b>	0.50	ug/L	EPA 8260B	3/3/2005
<b>Tert-Butanol</b>	<b>&lt; 5.0</b>	5.0	ug/L	EPA 8260B	3/3/2005
<b>TPH as Gasoline</b>	<b>4700</b>	50	ug/L	EPA 8260B	3/3/2005
Toluene - d8 (Surr)	91.9		% Recovery	EPA 8260B	3/3/2005
4-Bromofluorobenzene (Surr)	110		% Recovery	EPA 8260B	3/3/2005

Approved By:

Joel Kiff



Report Number : 42547

Date : 3/4/2005

Project Name : EZ Serve # 100877

Project Number : RPMS.0877

Sample : MW-6

Matrix : Water

Lab Number : 42547-07

Sample Date :2/24/2005

Parameter	Measured Value	Method Reporting Limit	Units	Analysis Method	Date Analyzed
<b>Benzene</b>	<b>6.6</b>	0.50	ug/L	EPA 8260B	3/3/2005
<b>Toluene</b>	<b>1.4</b>	0.50	ug/L	EPA 8260B	3/3/2005
<b>Ethylbenzene</b>	<b>29</b>	0.50	ug/L	EPA 8260B	3/3/2005
<b>Total Xylenes</b>	<b>5.2</b>	0.50	ug/L	EPA 8260B	3/3/2005
<b>Methyl-t-butyl ether (MTBE)</b>	<b>0.74</b>	0.50	ug/L	EPA 8260B	3/3/2005
<b>Diisopropyl ether (DIPE)</b>	<b>&lt; 0.50</b>	0.50	ug/L	EPA 8260B	3/3/2005
<b>Ethyl-t-butyl ether (ETBE)</b>	<b>&lt; 0.50</b>	0.50	ug/L	EPA 8260B	3/3/2005
<b>Tert-amyl methyl ether (TAME)</b>	<b>&lt; 0.50</b>	0.50	ug/L	EPA 8260B	3/3/2005
<b>Tert-Butanol</b>	<b>&lt; 5.0</b>	5.0	ug/L	EPA 8260B	3/3/2005
<b>TPH as Gasoline</b>	<b>2500</b>	50	ug/L	EPA 8260B	3/3/2005
Toluene - d8 (Surr)	101		% Recovery	EPA 8260B	3/3/2005
4-Bromofluorobenzene (Surr)	98.5		% Recovery	EPA 8260B	3/3/2005

Approved By:

Joel Kiff



Report Number : 42547

Date : 3/4/2005

Project Name : EZ Serve # 100877

Project Number : RPMS.0877

Sample : MW-12

Matrix : Water

Lab Number : 42547-08

Sample Date :2/25/2005

Parameter	Measured Value	Method Reporting Limit	Units	Analysis Method	Date Analyzed
Benzene	< 0.50	0.50	ug/L	EPA 8260B	3/2/2005
Toluene	< 0.50	0.50	ug/L	EPA 8260B	3/2/2005
Ethylbenzene	< 0.50	0.50	ug/L	EPA 8260B	3/2/2005
Total Xylenes	< 0.50	0.50	ug/L	EPA 8260B	3/2/2005
Methyl-t-butyl ether (MTBE)	< 0.50	0.50	ug/L	EPA 8260B	3/2/2005
Diisopropyl ether (DIPE)	< 0.50	0.50	ug/L	EPA 8260B	3/2/2005
Ethyl-t-butyl ether (ETBE)	< 0.50	0.50	ug/L	EPA 8260B	3/2/2005
Tert-amyl methyl ether (TAME)	< 0.50	0.50	ug/L	EPA 8260B	3/2/2005
Tert-Butanol	< 5.0	5.0	ug/L	EPA 8260B	3/2/2005
TPH as Gasoline	< 50	50	ug/L	EPA 8260B	3/3/2005
Toluene - d8 (Surr)	99.1		% Recovery	EPA 8260B	3/2/2005
4-Bromofluorobenzene (Surr)	110		% Recovery	EPA 8260B	3/2/2005

Approved By:

Joel Kiff



Report Number : 42547

Date : 3/4/2005

Project Name : EZ Serve # 100877

Project Number : RPMS.0877

Sample : MW-14

Matrix : Water

Lab Number : 42547-09

Sample Date :2/25/2005

Parameter	Measured Value	Method Reporting Limit	Units	Analysis Method	Date Analyzed
Benzene	< 0.50	0.50	ug/L	EPA 8260B	3/2/2005
Toluene	< 0.50	0.50	ug/L	EPA 8260B	3/2/2005
Ethylbenzene	0.56	0.50	ug/L	EPA 8260B	3/2/2005
Total Xylenes	< 0.50	0.50	ug/L	EPA 8260B	3/2/2005
Methyl-t-butyl ether (MTBE)	< 0.50	0.50	ug/L	EPA 8260B	3/2/2005
Diisopropyl ether (DIPE)	< 0.50	0.50	ug/L	EPA 8260B	3/2/2005
Ethyl-t-butyl ether (ETBE)	< 0.50	0.50	ug/L	EPA 8260B	3/2/2005
Tert-amyl methyl ether (TAME)	< 0.50	0.50	ug/L	EPA 8260B	3/2/2005
Tert-Butanol	< 5.0	5.0	ug/L	EPA 8260B	3/2/2005
TPH as Gasoline	210	50	ug/L	EPA 8260B	3/2/2005
Toluene - d8 (Surr)	99.2		% Recovery	EPA 8260B	3/2/2005
4-Bromofluorobenzene (Surr)	112		% Recovery	EPA 8260B	3/2/2005

Approved By:

Joel Kiff



Report Number : 42547

Date : 3/4/2005

Project Name : EZ Serve # 100877

Project Number : RPMS.0877

Sample : EX-1

Matrix : Water

Lab Number : 42547-10

Sample Date : 2/24/2005

Parameter	Measured Value	Method Reporting Limit	Units	Analysis Method	Date Analyzed
Benzene	1.4	0.50	ug/L	EPA 8260B	3/3/2005
Toluene	< 0.50	0.50	ug/L	EPA 8260B	3/3/2005
Ethylbenzene	2.0	0.50	ug/L	EPA 8260B	3/3/2005
Total Xylenes	0.87	0.50	ug/L	EPA 8260B	3/3/2005
Methyl-t-butyl ether (MTBE)	< 0.50	0.50	ug/L	EPA 8260B	3/3/2005
Diisopropyl ether (DIPE)	< 0.50	0.50	ug/L	EPA 8260B	3/3/2005
Ethyl-t-butyl ether (ETBE)	< 0.50	0.50	ug/L	EPA 8260B	3/3/2005
Tert-amyl methyl ether (TAME)	< 0.50	0.50	ug/L	EPA 8260B	3/3/2005
Tert-Butanol	< 5.0	5.0	ug/L	EPA 8260B	3/3/2005
TPH as Gasoline	59	50	ug/L	EPA 8260B	3/3/2005
Toluene - d8 (Surr)	100		% Recovery	EPA 8260B	3/3/2005
4-Bromofluorobenzene (Surr)	100		% Recovery	EPA 8260B	3/3/2005

Approved By:

Joel Kiff

Report Number : 42547

Date : 3/4/2005

QC Report : Method Blank Data

Project Name : EZ Serve # 100877

Project Number : RPMS.0877

Parameter	Measured Value	Method Reporting Limit	Units	Analysis Method	Date Analyzed
Benzene	< 0.50	0.50	ug/L	EPA 8260B	3/3/2005
Toluene	< 0.50	0.50	ug/L	EPA 8260B	3/3/2005
Ethylbenzene	< 0.50	0.50	ug/L	EPA 8260B	3/3/2005
Total Xylenes	< 0.50	0.50	ug/L	EPA 8260B	3/3/2005
Methyl-t-butyl ether (MTBE)	< 0.50	0.50	ug/L	EPA 8260B	3/3/2005
Diisopropyl ether (DIPE)	< 0.50	0.50	ug/L	EPA 8260B	3/3/2005
Ethyl-t-butyl ether (ETBE)	< 0.50	0.50	ug/L	EPA 8260B	3/3/2005
Tert-amyl methyl ether (TAME)	< 0.50	0.50	ug/L	EPA 8260B	3/3/2005
Tert-Butanol	< 5.0	5.0	ug/L	EPA 8260B	3/3/2005
TPH as Gasoline	< 50	50	ug/L	EPA 8260B	3/3/2005
Toluene - d8 (Surr)	97.0		%	EPA 8260B	3/3/2005
4-Bromofluorobenzene (Surr)	106		%	EPA 8260B	3/3/2005
Benzene	< 0.50	0.50	ug/L	EPA 8260B	3/3/2005
Toluene	< 0.50	0.50	ug/L	EPA 8260B	3/3/2005
Ethylbenzene	< 0.50	0.50	ug/L	EPA 8260B	3/3/2005
Total Xylenes	< 0.50	0.50	ug/L	EPA 8260B	3/3/2005
Methyl-t-butyl ether (MTBE)	< 0.50	0.50	ug/L	EPA 8260B	3/3/2005
Diisopropyl ether (DIPE)	< 0.50	0.50	ug/L	EPA 8260B	3/3/2005
Ethyl-t-butyl ether (ETBE)	< 0.50	0.50	ug/L	EPA 8260B	3/3/2005
Tert-amyl methyl ether (TAME)	< 0.50	0.50	ug/L	EPA 8260B	3/3/2005
Tert-Butanol	< 5.0	5.0	ug/L	EPA 8260B	3/3/2005
TPH as Gasoline	< 50	50	ug/L	EPA 8260B	3/3/2005
Toluene - d8 (Surr)	98.8		%	EPA 8260B	3/3/2005
4-Bromofluorobenzene (Surr)	107		%	EPA 8260B	3/3/2005

Parameter	Measured Value	Method Reporting Limit	Units	Analysis Method	Date Analyzed
Benzene	< 0.50	0.50	ug/L	EPA 8260B	3/1/2005
Toluene	< 0.50	0.50	ug/L	EPA 8260B	3/1/2005
Ethylbenzene	< 0.50	0.50	ug/L	EPA 8260B	3/1/2005
Total Xylenes	< 0.50	0.50	ug/L	EPA 8260B	3/1/2005
Methyl-t-butyl ether (MTBE)	< 0.50	0.50	ug/L	EPA 8260B	3/1/2005
Diisopropyl ether (DIPE)	< 0.50	0.50	ug/L	EPA 8260B	3/1/2005
Ethyl-t-butyl ether (ETBE)	< 0.50	0.50	ug/L	EPA 8260B	3/1/2005
Tert-amyl methyl ether (TAME)	< 0.50	0.50	ug/L	EPA 8260B	3/1/2005
Tert-Butanol	< 5.0	5.0	ug/L	EPA 8260B	3/1/2005
TPH as Gasoline	< 50	50	ug/L	EPA 8260B	3/1/2005
Toluene - d8 (Surr)	99.2		%	EPA 8260B	3/1/2005
4-Bromofluorobenzene (Surr)	103		%	EPA 8260B	3/1/2005
Benzene	< 0.50	0.50	ug/L	EPA 8260B	3/2/2005
Toluene	< 0.50	0.50	ug/L	EPA 8260B	3/2/2005
Ethylbenzene	< 0.50	0.50	ug/L	EPA 8260B	3/2/2005
Total Xylenes	< 0.50	0.50	ug/L	EPA 8260B	3/2/2005
Methyl-t-butyl ether (MTBE)	< 0.50	0.50	ug/L	EPA 8260B	3/2/2005
Diisopropyl ether (DIPE)	< 0.50	0.50	ug/L	EPA 8260B	3/2/2005
Ethyl-t-butyl ether (ETBE)	< 0.50	0.50	ug/L	EPA 8260B	3/2/2005
Tert-amyl methyl ether (TAME)	< 0.50	0.50	ug/L	EPA 8260B	3/2/2005
Tert-Butanol	< 5.0	5.0	ug/L	EPA 8260B	3/2/2005
TPH as Gasoline	< 50	50	ug/L	EPA 8260B	3/2/2005
Toluene - d8 (Surr)	100		%	EPA 8260B	3/2/2005
4-Bromofluorobenzene (Surr)	97.1		%	EPA 8260B	3/2/2005

Approved By:

Joel Kiff

KIFF ANALYTICAL, LLC

2795 2nd St, Suite 300 Davis, CA 95616 530-297-4800

Report Number : 42547

Date : 3/4/2005

QC Report : Method Blank Data

Project Name : EZ Serve # 100877

Project Number : RPMS.0877

Parameter	Measured Value	Method Reporting Limit	Units	Analysis Method	Date Analyzed
Benzene	< 0.50	0.50	ug/L	EPA 8260B	3/3/2005
Toluene	< 0.50	0.50	ug/L	EPA 8260B	3/3/2005
Ethylbenzene	< 0.50	0.50	ug/L	EPA 8260B	3/3/2005
Total Xylenes	< 0.50	0.50	ug/L	EPA 8260B	3/3/2005
Methyl-t-butyl ether (MTBE)	< 0.50	0.50	ug/L	EPA 8260B	3/3/2005
Diisopropyl ether (DIPE)	< 0.50	0.50	ug/L	EPA 8260B	3/3/2005
Ethyl-t-butyl ether (ETBE)	< 0.50	0.50	ug/L	EPA 8260B	3/3/2005
Tert-amyl methyl ether (TAME)	< 0.50	0.50	ug/L	EPA 8260B	3/3/2005
Tert-Butanol	< 5.0	5.0	ug/L	EPA 8260B	3/3/2005
TPH as Gasoline	< 50	50	ug/L	EPA 8260B	3/3/2005
Toluene - d8 (Surr)	98.8		%	EPA 8260B	3/3/2005
4-Bromofluorobenzene (Surr)	108		%	EPA 8260B	3/3/2005
Benzene	< 0.50	0.50	ug/L	EPA 8260B	3/2/2005
Toluene	< 0.50	0.50	ug/L	EPA 8260B	3/2/2005
Ethylbenzene	< 0.50	0.50	ug/L	EPA 8260B	3/2/2005
Total Xylenes	< 0.50	0.50	ug/L	EPA 8260B	3/2/2005
Methyl-t-butyl ether (MTBE)	< 0.50	0.50	ug/L	EPA 8260B	3/2/2005
Diisopropyl ether (DIPE)	< 0.50	0.50	ug/L	EPA 8260B	3/2/2005
Ethyl-t-butyl ether (ETBE)	< 0.50	0.50	ug/L	EPA 8260B	3/2/2005
Tert-amyl methyl ether (TAME)	< 0.50	0.50	ug/L	EPA 8260B	3/2/2005
Tert-Butanol	< 5.0	5.0	ug/L	EPA 8260B	3/2/2005
TPH as Gasoline	< 50	50	ug/L	EPA 8260B	3/2/2005
Toluene - d8 (Surr)	99.4		%	EPA 8260B	3/2/2005
4-Bromofluorobenzene (Surr)	97.9		%	EPA 8260B	3/2/2005

Parameter	Measured Value	Method Reporting Limit	Units	Analysis Method	Date Analyzed
Benzene	< 0.50	0.50	ug/L	EPA 8260B	3/3/2005
Toluene	< 0.50	0.50	ug/L	EPA 8260B	3/3/2005
Ethylbenzene	< 0.50	0.50	ug/L	EPA 8260B	3/3/2005
Total Xylenes	< 0.50	0.50	ug/L	EPA 8260B	3/3/2005
Methyl-t-butyl ether (MTBE)	< 0.50	0.50	ug/L	EPA 8260B	3/3/2005
Diisopropyl ether (DIPE)	< 0.50	0.50	ug/L	EPA 8260B	3/3/2005
Ethyl-t-butyl ether (ETBE)	< 0.50	0.50	ug/L	EPA 8260B	3/3/2005
Tert-amyl methyl ether (TAME)	< 0.50	0.50	ug/L	EPA 8260B	3/3/2005
Tert-Butanol	< 5.0	5.0	ug/L	EPA 8260B	3/3/2005
TPH as Gasoline	< 50	50	ug/L	EPA 8260B	3/3/2005
Toluene - d8 (Surr)	98.4		%	EPA 8260B	3/3/2005
4-Bromofluorobenzene (Surr)	97.3		%	EPA 8260B	3/3/2005
Benzene	< 0.50	0.50	ug/L	EPA 8260B	3/3/2005
Toluene	< 0.50	0.50	ug/L	EPA 8260B	3/3/2005
Ethylbenzene	< 0.50	0.50	ug/L	EPA 8260B	3/3/2005
Total Xylenes	< 0.50	0.50	ug/L	EPA 8260B	3/3/2005
Methyl-t-butyl ether (MTBE)	< 0.50	0.50	ug/L	EPA 8260B	3/3/2005
Diisopropyl ether (DIPE)	< 0.50	0.50	ug/L	EPA 8260B	3/3/2005
Ethyl-t-butyl ether (ETBE)	< 0.50	0.50	ug/L	EPA 8260B	3/3/2005
Tert-amyl methyl ether (TAME)	< 0.50	0.50	ug/L	EPA 8260B	3/3/2005
Tert-Butanol	< 5.0	5.0	ug/L	EPA 8260B	3/3/2005
TPH as Gasoline	< 50	50	ug/L	EPA 8260B	3/3/2005
Toluene - d8 (Surr)	95.9		%	EPA 8260B	3/3/2005
4-Bromofluorobenzene (Surr)	98.0		%	EPA 8260B	3/3/2005

Approved By:

  
 \_\_\_\_\_  
 Joel Kiff

KIFF ANALYTICAL, LLC

2795 2nd St, Suite 300 Davis, CA 95616 530-297-4800



Report Number : 42547

Date : 3/4/2005

## QC Report : Matrix Spike/ Matrix Spike Duplicate

Project Name : EZ Serve # 100877

Project Number : RPMS.0877

Parameter	Spiked Sample	Sample Value	Spike Level	Spike Dup. Level	Spiked Sample Value	Duplicate Spiked Sample Value	Units	Analysis Method	Date Analyzed	Spiked Sample Percent Recov.	Duplicate Spiked Sample Percent Recov.	Relative Percent Diff.	Spiked Sample Recov. Limit	Relative Percent Diff. Limit
Benzene	42587-01	2.2	40.0	40.0	42.6	43.3	ug/L	EPA 8260B	3/3/05	101	103	1.76	70-130	25
Toluene	42587-01	<0.50	40.0	40.0	39.8	39.9	ug/L	EPA 8260B	3/3/05	99.6	99.7	0.0769	70-130	25
Tert-Butanol	42587-01	<5.0	200	200	207	209	ug/L	EPA 8260B	3/3/05	103	104	0.993	70-130	25
Methyl-t-Butyl Ether	42587-01	3.8	40.0	40.0	43.7	44.0	ug/L	EPA 8260B	3/3/05	99.8	100	0.588	70-130	25
Benzene	42583-07	<0.50	40.0	40.0	39.7	39.6	ug/L	EPA 8260B	3/3/05	99.4	99.1	0.241	70-130	25
Toluene	42583-07	<0.50	40.0	40.0	40.4	39.3	ug/L	EPA 8260B	3/3/05	101	98.3	2.85	70-130	25
Tert-Butanol	42583-07	8.4	200	200	213	217	ug/L	EPA 8260B	3/3/05	102	104	1.93	70-130	25
Methyl-t-Butyl Ether	42583-07	5.5	40.0	40.0	44.9	45.3	ug/L	EPA 8260B	3/3/05	98.6	99.4	0.846	70-130	25
Benzene	42560-03	<0.50	40.0	40.0	39.4	38.5	ug/L	EPA 8260B	3/1/05	98.6	96.3	2.34	70-130	25
Toluene	42560-03	<0.50	40.0	40.0	38.5	37.2	ug/L	EPA 8260B	3/1/05	96.3	93.1	3.45	70-130	25
Tert-Butanol	42560-03	28	200	200	231	228	ug/L	EPA 8260B	3/1/05	101	100	1.34	70-130	25
Methyl-t-Butyl Ether	42560-03	4.3	40.0	40.0	41.9	41.4	ug/L	EPA 8260B	3/1/05	94.0	92.9	1.16	70-130	25
Benzene	42576-02	<0.50	40.0	40.0	40.6	38.9	ug/L	EPA 8260B	3/2/05	102	97.3	4.39	70-130	25
Toluene	42576-02	<0.50	40.0	40.0	40.2	38.7	ug/L	EPA 8260B	3/2/05	100	96.8	3.74	70-130	25
Tert-Butanol	42576-02	<5.0	200	200	206	201	ug/L	EPA 8260B	3/2/05	103	101	2.55	70-130	25
Methyl-t-Butyl Ether	42576-02	<0.50	40.0	40.0	37.0	35.9	ug/L	EPA 8260B	3/2/05	92.4	89.7	2.97	70-130	25
Benzene	42587-08	<0.50	40.0	40.0	40.0	38.8	ug/L	EPA 8260B	3/3/05	100	97.1	3.04	70-130	25
Toluene	42587-08	<0.50	40.0	40.0	39.3	37.6	ug/L	EPA 8260B	3/3/05	98.2	94.1	4.21	70-130	25

Approved By: Joel Kiff

KIFF ANALYTICAL, LLC

2795 2nd St, Suite 300 Davis, CA 95616 530-297-4800

Report Number : 42547

Date : 3/4/2005

QC Report : Matrix Spike/ Matrix Spike Duplicate

Project Name : EZ Serve # 100877

Project Number : RPMS.0877

Parameter	Spiked Sample	Sample Value	Spike Level	Spike Dup. Level	Spiked Sample Value	Duplicate Spiked Sample Value	Units	Analysis Method	Date Analyzed	Spiked Sample Percent Recov.	Duplicate Spiked Sample Percent Recov.	Relative Percent Diff.	Spiked Sample Percent Recov. Limit	Relative Percent Diff. Limit
Tert-Butanol	42587-08	<5.0	200	200	186	197	ug/L	EPA 8260B	3/3/05	93.0	98.4	5.65	70-130	25
Methyl-t-Butyl Ether	42587-08	<0.50	40.0	40.0	38.6	37.8	ug/L	EPA 8260B	3/3/05	96.5	94.4	2.15	70-130	25
Benzene	42574-09	<0.50	40.0	40.0	43.0	41.6	ug/L	EPA 8260B	3/2/05	107	104	3.08	70-130	25
Toluene	42574-09	<0.50	40.0	40.0	41.8	40.6	ug/L	EPA 8260B	3/2/05	104	101	2.89	70-130	25
Tert-Butanol	42574-09	<5.0	200	200	200	198	ug/L	EPA 8260B	3/2/05	100	99.2	0.828	70-130	25
Methyl-t-Butyl Ether	42574-09	22	40.0	40.0	61.8	60.5	ug/L	EPA 8260B	3/2/05	99.9	96.7	3.22	70-130	25
Benzene	42573-03	<0.50	40.0	40.0	42.2	41.4	ug/L	EPA 8260B	3/3/05	106	103	2.00	70-130	25
Toluene	42573-03	<0.50	40.0	40.0	41.1	40.2	ug/L	EPA 8260B	3/3/05	103	100	2.22	70-130	25
Tert-Butanol	42573-03	<5.0	200	200	202	201	ug/L	EPA 8260B	3/3/05	101	100	0.661	70-130	25
Methyl-t-Butyl Ether	42573-03	2.1	40.0	40.0	41.2	40.9	ug/L	EPA 8260B	3/3/05	97.6	96.9	0.716	70-130	25
Benzene	42561-02	<0.50	40.0	40.0	38.6	38.2	ug/L	EPA 8260B	3/3/05	96.5	95.5	1.00	70-130	25
Toluene	42561-02	<0.50	40.0	40.0	37.7	37.7	ug/L	EPA 8260B	3/3/05	94.2	94.2	0.00111	70-130	25
Tert-Butanol	42561-02	12	200	200	209	204	ug/L	EPA 8260B	3/3/05	98.5	96.1	2.46	70-130	25
Methyl-t-Butyl Ether	42561-02	4.1	40.0	40.0	44.5	45.0	ug/L	EPA 8260B	3/3/05	101	102	1.38	70-130	25

Approved By:  Joel Kiff

## QC Report : Laboratory Control Sample (LCS)

Project Name : **EZ Serve # 100877**Project Number : **RPMS.0877**

Parameter	Spike Level	Units	Analysis Method	Date Analyzed	LCS Percent Recov.	LCS Percent Recov. Limit
Benzene	40.0	ug/L	EPA 8260B	3/3/05	94.8	70-130
Toluene	40.0	ug/L	EPA 8260B	3/3/05	95.2	70-130
Tert-Butanol	200	ug/L	EPA 8260B	3/3/05	101	70-130
Methyl-t-Butyl Ether	40.0	ug/L	EPA 8260B	3/3/05	94.4	70-130
Benzene	40.0	ug/L	EPA 8260B	3/3/05	97.2	70-130
Toluene	40.0	ug/L	EPA 8260B	3/3/05	99.1	70-130
Tert-Butanol	200	ug/L	EPA 8260B	3/3/05	103	70-130
Methyl-t-Butyl Ether	40.0	ug/L	EPA 8260B	3/3/05	95.3	70-130
Benzene	40.0	ug/L	EPA 8260B	3/1/05	107	70-130
Toluene	40.0	ug/L	EPA 8260B	3/1/05	107	70-130
Tert-Butanol	200	ug/L	EPA 8260B	3/1/05	108	70-130
Methyl-t-Butyl Ether	40.0	ug/L	EPA 8260B	3/1/05	102	70-130
Benzene	40.0	ug/L	EPA 8260B	3/2/05	95.9	70-130
Toluene	40.0	ug/L	EPA 8260B	3/2/05	96.6	70-130
Tert-Butanol	200	ug/L	EPA 8260B	3/2/05	98.3	70-130
Methyl-t-Butyl Ether	40.0	ug/L	EPA 8260B	3/2/05	88.9	70-130
Benzene	40.0	ug/L	EPA 8260B	3/3/05	93.8	70-130

KIFF ANALYTICAL, LLC

Approved By:

  
 Joel Kiff

Report Number : 42547

Date : 3/4/2005

QC Report : Laboratory Control Sample (LCS)

Project Name : EZ Serve # 100877

Project Number : RPMS.0877

Parameter	Spike Level	Units	Analysis Method	Date Analyzed	LCS Percent Recov.	LCS Percent Recov. Limit
Toluene	40.0	ug/L	EPA 8260B	3/3/05	94.7	70-130
Tert-Butanol	200	ug/L	EPA 8260B	3/3/05	92.0	70-130
Methyl-t-Butyl Ether	40.0	ug/L	EPA 8260B	3/3/05	90.0	70-130
Benzene	40.0	ug/L	EPA 8260B	3/2/05	100	70-130
Toluene	40.0	ug/L	EPA 8260B	3/2/05	101	70-130
Tert-Butanol	200	ug/L	EPA 8260B	3/2/05	95.9	70-130
Methyl-t-Butyl Ether	40.0	ug/L	EPA 8260B	3/2/05	91.8	70-130
Benzene	40.0	ug/L	EPA 8260B	3/3/05	93.7	70-130
Toluene	40.0	ug/L	EPA 8260B	3/3/05	93.1	70-130
Tert-Butanol	200	ug/L	EPA 8260B	3/3/05	91.3	70-130
Methyl-t-Butyl Ether	40.0	ug/L	EPA 8260B	3/3/05	91.0	70-130
Benzene	40.0	ug/L	EPA 8260B	3/3/05	88.5	70-130
Toluene	40.0	ug/L	EPA 8260B	3/3/05	86.6	70-130
Tert-Butanol	200	ug/L	EPA 8260B	3/3/05	95.3	70-130
Methyl-t-Butyl Ether	40.0	ug/L	EPA 8260B	3/3/05	87.6	70-130

KIFF ANALYTICAL, LLC

Approved By:

  
Joel Kiff

2795 2nd St, Suite 300 Davis, CA 95616 530-297-4800



2795 2nd Street, Suite 300  
 Davis, CA 95616  
 Lab: 530.297.4800  
 Fax: 530.297.4808

Lab No. 412547 Page 1 of 1

Project Contact (Hardcopy or PDF To): Jim Brownell California EDF Report?  Yes  No

Company/Address: Delta Env., Sac Recommended but not mandatory to complete this section:  
 Sampling Company Log Code: . . . . .

Phone No.: . . . . . FAX No.: . . . . . Global ID: . . . . .

Project Number: RPM-0877 P.O. No.: . . . . . EDF Deliverable To (Email Address): . . . . .

Project Name: EZ Gene # 100877 Sampler Signature: [Signature]

Project Address: 525 West A Street  
 Hayward, CA

### Chain-of-Custody Record and Analysis Request

#### Analysis Request

Sample Designation	Sampling		Container		Preservative				Matrix		BTEX (8021B)	BTEX/TPH Gas/MTBE (8021B/M8015)	TPH as Diesel (M8015)	TPH as Motor Oil (M8015)	TPH Gas/BTEX/MTBE (8260B)	5 Oxygenates/TPH Gas/BTEX (8260B)	7 Oxygenates/TPH Gas/BTEX (8260B)	5 Oxygenates (8260B)	7 Oxygenates (8260B)	Lead Scav. (1,2 DCA & 1,2 EDB - 8260B)	EPA 8260B (Full List)	Volatile Halocarbons (EPA 8260B)	Lead (7421/238.2) TOTAL (X) WIE T. (X)	TAT	For Lab Use Only		
	Date	Time	40 ml VOA	SLEEVE	HCl	HNO <sub>3</sub>	ICE	NONE	WATER	SOIL																	
MW-1	2/24/05		3		X	X			X						X									X	-01		
MW-1A																										-02	
MW-2																										-03	
MW-3																										-04	
MW-4																										-05	
MW-5																										-06	
MW-6																										-07	
MW-12	2/25/05																									-08	
MW-19																										-09	
EX-1	2/24/05																									-10	

Relinquished by: [Signature] Date: 2/25/05 Time: 4:45 Received by: \_\_\_\_\_  
 Relinquished by: \_\_\_\_\_ Date: \_\_\_\_\_ Time: \_\_\_\_\_ Received by: \_\_\_\_\_  
 Relinquished by: \_\_\_\_\_ Date: 022505 Time: 1645 Received by Laboratory: [Signature]

Remarks: All samples iced in field MW-1A, Steen

Bill to: \_\_\_\_\_