

CONSOLIDATED TESTING LABORATORIES, INC.

SOILS INVESTIGATIONS

SOILS AND MATERIALS TESTING

FIELD INSPECTION

CHAIN OF CUSTODY RECORD

PROJECT NO. 1875-90

PROJECT LOCATION British Petroleum (EZ Serve) 5225 W. "A" St. Hayward, CA

TRANSPORTED BY Truck

COMMENTS

COLLECTOR'S SAMPLE #	THERMOMETER TEMP. READING BEFORE SAMPLING	DEPTH OF SAMPLE BELOW EXIST. GRADE	DEPTH TO BOTTOM OF TANK/PIPELINE BELOW EXIST. GRADE	ANALYSIS REQUIRED	DATE/TIME SAMPLED
25	3016 32°	2'-3'	8"	BTK-T.P.H. GAS & DIESEL EPA 5030/8020 ORGANIC LEAD	8-24-90 2:30p
26	3017 32°	2'-3'	8"	"	" 3:00
27	3018 32°	2'-3'	8"	"	" 3:32
28	3019 32°	2'-3'	8"	"	" 3:50
29	3020 32°	2'-3'	8"	"	" 4:20
30	3021 34°	2'-3'	8"	"	" 4:50
31	3022 35°	2'-3'	8"	"	" 5:25 ^{PM}
32	3023 35°	2'-3'	8"	"	" 5:45

CHAIN OF POSSESSION

samples cod & sealed

1. *Salv. Espinosa*

SAMPLE COLLECTED BY

CONSOLIDATED TESTING LABS., INC.

AFFILIATION

8-24-90 2:30pm

DATE/TIME

2. *Mary Ruiz*

SAMPLE RECEIVED BY

SMC Lab

AFFILIATION

8-27-90 / 4:00pm

DATE/TIME

3. _____

SAMPLE RECEIVED BY

AFFILIATION

DATE/TIME

TEMP. OF ICE CHEST AT LAB.

37°

1055 W. Morton, Suite C, Porterville, CA 93257

(209) 781-0571

(209) 688-2925 * Tulare, CA

FAX (209) 782-8389

Client Name: Consolidated Testing Laboratories, Inc.
Address : 1055 W. Morton, Suite C
Porterville, CA 93257

Date samples received : 08-27-90
Date analysis completed: 09-06-90
Date of report : 09-06-90

Project Name: British Petroleum (EZ Serve)/Hayward, CA
Project # : 1875-90
Attention : Mr. Wayne Harris

RESULTS OF ANALYSIS:

#	ID: #	ugm/gm	MDL, ugm/gm
# 3016	#25		
	Benzene	0.026	0.005
	Toluene	0.011	0.005
	Ethylbenzene	ND	0.005
	p-Xylene	ND	0.005
	m-Xylene	0.0056	0.005
	o-Xylene	ND	0.005
	Isopropylbenzene	ND	0.005
	TPH (Gasoline)	ND	1.0
	TPH (Diesel)	ND	10.

#	ID: #	ugm/gm	MDL, ugm/gm
# 3017	#26		
	Benzene	0.098	0.005
	Toluene	0.031	0.005
	Ethylbenzene	0.0084	0.005
	p-Xylene	0.020	0.005
	m-Xylene	0.041	0.005
	o-Xylene	0.030	0.005
	Isopropylbenzene	ND	0.005
	TPH (Gasoline)	ND	1.0
	TPH (Diesel)	ND	10.

Method of Analysis: 5030/8020/8015(MOD)
MDL = Minimum Detection Level
TPH = Total Petroleum Hydrocarbons
ugm/gm = micrograms per gram
ND = None Detected



Brian Thompson
Laboratory Supervisor

RESULTS OF ANALYSIS

# 3018 ID: #27	ugm/gm	MDL, ugm/gm
Benzene	0.097	0.005
Toluene	0.050	0.005
Ethylbenzene	0.010	0.005
p-Xylene	0.032	0.005
m-Xylene	0.027	0.005
o-Xylene	0.0091	0.005
Isopropylbenzene	ND	0.005
TPH (Gasoline)	ND	1.0
TPH (Diesel)	ND	10.

# 3019 ID: #28	ugm/gm	MDL, ugm/gm
Benzene	0.43	0.005
Toluene	0.47	0.005
Ethylbenzene	1.2	0.005
p-Xylene	1.6	0.005
m-Xylene	4.0	0.005
o-Xylene	3.5	0.005
Isopropylbenzene	0.66	0.005
TPH (Gasoline)	89.	1.0
TPH (Diesel)	ND	10.

# 3020 ID: #29	ugm/gm	MDL, ugm/gm
Benzene	ND	0.005
Toluene	0.0050	0.005
Ethylbenzene	ND	0.005
p-Xylene	0.012	0.005
m-Xylene	0.011	0.005
o-Xylene	0.0054	0.005
Isopropylbenzene	ND	0.005
TPH (Gasoline)	ND	1.0
TPH (Diesel)	820.	10.



 Brian Thompson
 Laboratory Supervisor

RESULTS OF ANALYSIS

# 3021 ID: #30	ugm/gm	MDL, ugm/gm
Benzene	ND	0.005
Toluene	0.028	0.005
Ethylbenzene	ND	0.005
p-Xylene	0.053	0.005
m-Xylene	0.0093	0.005
o-Xylene	0.0050	0.005
Isopropylbenzene	ND	0.005
TPH (Gasoline)	ND	1.0
TPH (Diesel)	ND	10.

# 3022 ID: #31	ugm/gm	MDL, ugm/gm
Benzene	3.9	0.005
Toluene	0.91	0.005
Ethylbenzene	4.3	0.005
p-Xylene	6.1	0.005
m-Xylene	13.	0.005
o-Xylene	5.0	0.005
Isopropylbenzene	0.53	0.005
TPH (Gasoline)	150.	1.0
TPH (Diesel)	ND	10.

# 3023 ID: #32	ugm/gm	MDL, ugm/gm
Benzene	1.6	0.005
Toluene	0.67	0.005
Ethylbenzene	1.5	0.005
p-Xylene	1.4	0.005
m-Xylene	3.0	0.005
o-Xylene	1.1	0.005
Isopropylbenzene	0.27	0.005
TPH (Gasoline)	61.	1.0
TPH (Diesel)	ND	10.

 Brian Thompson
 Laboratory Supervisor

Client Name: Consolidated Testing Laboratories, Inc.
Address: 1055 W. Morton, Suite C
Porterville, CA 93257

Date Samples Received : 8-27-90
Date Analysis Completed: 8-29-90
Date of Report : 8-29-90

Attn: Mr. Wayne Harris

Project Name: British Petroleum Project # 1875-90
(EZ Serve)

RESULTS OF ANALYSIS

ORGANIC LEAD

<u>Sample #</u>	<u>ID</u>	<u>Org. Pb, ugm/gm</u>	<u>MDL, ugm/gm</u>
3016	25	ND	0.5
3017	26	ND	0.5
3018	27	ND	0.5
3019	28	ND	0.5
3020	29	ND	0.5
3021	30	ND	0.5
3022	31	ND	0.5
3023	32	ND	0.5

Method of Analysis: HML Method 938
ND = None Detected
MDL = Minimum Detection Level
ugm/gm = micrograms per gram



Stan Comer
Laboratory Director

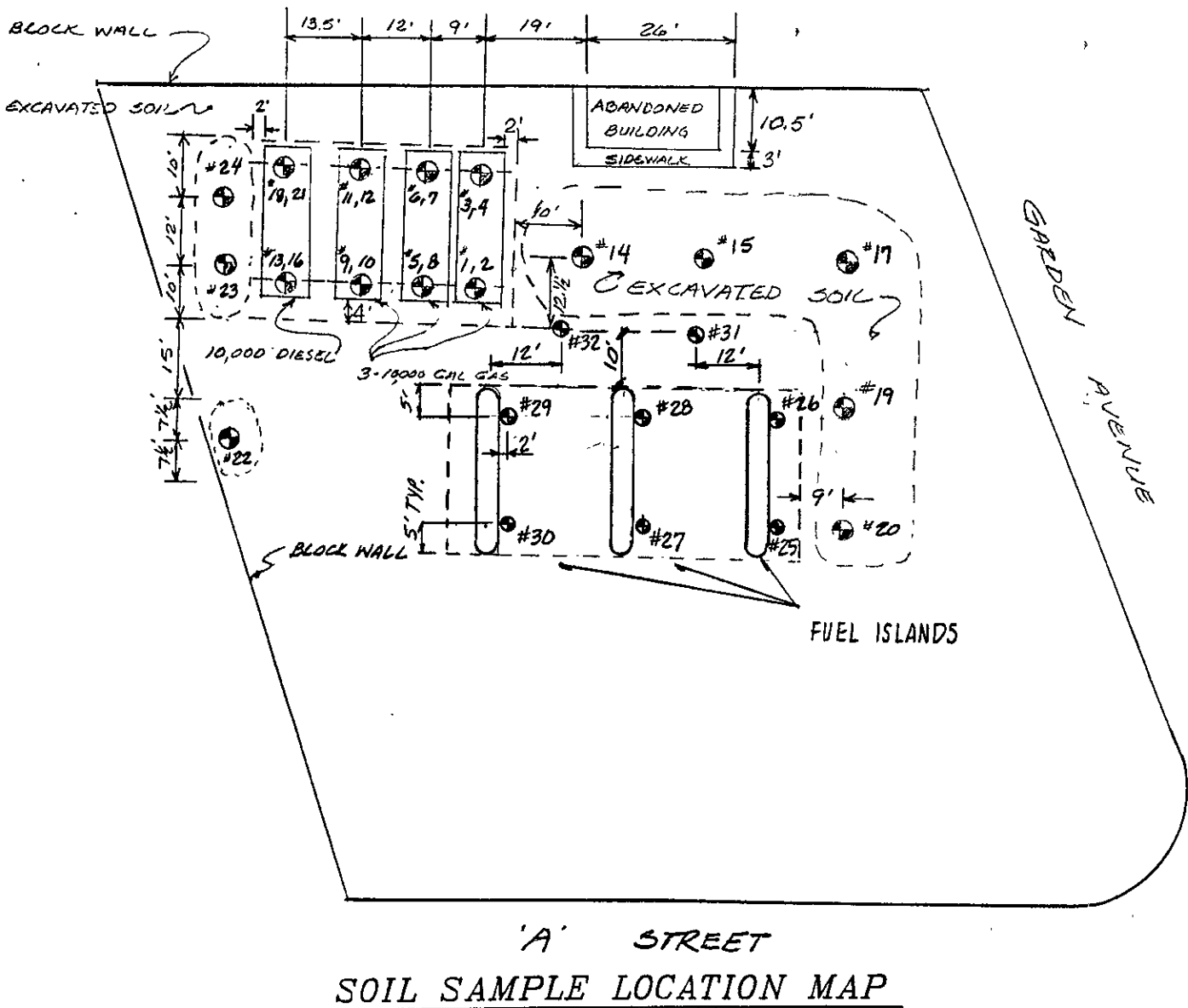

'A' STREET
SOIL SAMPLE LOCATION MAP



NORTH
SCALE: 1" = 30'

LEGEND

- ⊕ APPROXIMATE LOCATION OF SOIL SAMPLE
- 669 SOIL SAMPLE NUMBER

NOTES

1. SOIL SAMPLES No. 1-24 COLLECTED ON 6-15-90 DURING TANK REMOVAL PROJECT.
2. SOIL SAMPLES No. 25 - 32 COLLECTED ON 8-24-90 USING HAND AUGERS AND DRIVE TUBE SAMPLER.

JOB LOCATION: BRITISH PETROLEUM
5225 WEST 'A' STREET
HAYWARD CALIF.
JOB NUMBER: 1875-90

CONSOLIDATED TESTING LABORATORIES, INC.

1055 W. Morton, Suite C
Porterville, CA 93257
(209) 781-0571