



BP OIL

BP Oil Company
Environmental Remediation Management
295 SW 41st Street
Renton, Washington 98055-4931
(206) 251-0667
Fax No (206) 251-0736

March 19, 1997

Ms. Susan Hugo
Alameda County Health Care Services Agency
1131 Harbor Bay Parkway Room 250
Oakland CA 94621

3878

RE: BP OIL FACILITY #11132
3201 - 35th Street
Oakland, CA

Dear Ms Hugo:

Attached please find our **GROUNDWATER MONITORING AND SAMPLING REPORT DATED MARCH 3, 1997** for the above referenced facility. Plans for the following quarter include additional groundwater monitoring and product removal.

If you should have any questions regarding this site, I may be reached at (206) 251-0689.

Respectfully,

Scott T. Hooton
Environmental Resources Management
Corrective Action Manager

STH:sb msword\ERM11132

cc: Mr. Eddy So, California Regional Water Quality Control Board, San Francisco Bay Region,
2101 Webster St. Suite 500, Oakland CA 94612 (without attachment)

Mr. Brady Nagle, Alisto Engineering Group, 1777 Oakland Blvd., Suite 200, Walnut Creek,
CA 94596

TOSCO Northwest, 601 Union Street, Suite 2500, Seattle WA 98101

Site File

ENVIRONMENTAL
PROTECTION
97 MAR 24 PM 1:10



BP OIL

SH
3878

BP Oil Company
Environmental Resources Management
Building 13, Suite N
295 SW 41st Street
Renton, Washington 98055-4931
(206) 251-0667
Fax No (206) 251-0736

April 10, 1997

Mr. Raymond Maxwell
East Bay Municipal Utility District
Source Control Division
P.o. Box 24055
Oakland, California, 94623

Subject: Sewer Discharge Permit - Semi-Annual Report
BP Oil Branded Service Station No. 11132
3201 35th Street
Oakland, California
Wastewater Discharge Permit No. 502-62901

Dear Mr. Gonzalez,

This is to inform you that the remediation system at the branded BP Oil Service Station No.11132, 3201 35th Street, Oakland California has been shut down during the reporting period of October 1, 1996 to March 31,1997.

Please call if you have any questions regarding this submittal.

Respectfully,

Scott T. Hooton
Environmental Resources Management
Corrective Action Manager

STH:sb msword\dis11266

cc: Peter Beaver, Alisto Engineering

Mr. Barney Chan, Alameda County Health Care Services Agency

Site File

GROUNDWATER MONITORING AND SAMPLING REPORT

**BP Oil Company Service Station No. 11132
3201 35th Street
Oakland, California**

Project No. 10-024-09-003

MAR 10 1997

BP OIL CO
ENVIRONMENTAL
WEST COAST REGION

Prepared for:

**BP Oil Company
Environmental Resources Management
295 S.W. 41st Street
Building 13, Suite N
Renton, Washington**

Prepared by:

**Alisto Engineering Group
1575 Treat Boulevard, Suite 201
Walnut Creek, California**

March 3, 1997

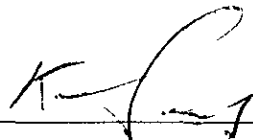

**Ken Simas
Project Manager**

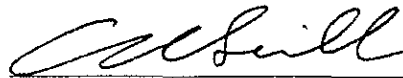

**Al Sevilla, P.E.
Principal**



GROUNDWATER MONITORING AND SAMPLING REPORT

BP Oil Company Service Station No. 11132
3201 35th Street
Oakland, California

Project No. 10-024-09-003

March 3, 1997

INTRODUCTION

This report presents the results and findings of the January 21, 1997 groundwater monitoring and sampling conducted by Alisto Engineering Group at BP Oil Company Service Station No. 11132, 3201 35th Street, Oakland, California. A site vicinity map is shown on Figure 1.

FIELD PROCEDURES

Field activities were performed in accordance with the procedures and guidelines of the Alameda County Health Care Services Agency and the California Regional Water Quality Control Board, San Francisco Bay Region.

Before purging and sampling, the groundwater level in each well was measured from a permanent mark on top of the casing to the nearest 0.01 foot using an electronic sounder. The depth to groundwater and top of casing elevation data were used to calculate the groundwater elevation in each well relative to mean sea level. The survey data and groundwater elevation measurements collected to date are presented in Table 1.

Before sample collection, each well was purged of 3 casing volumes, while recording field readings of pH, temperature, electrical conductivity, and dissolved oxygen. Groundwater samples were collected for laboratory analysis by lowering a bottom-fill, disposable bailer to just below the water level in the well. The samples were transferred from the bailer into laboratory-supplied containers. The water sampling field survey forms are presented in Appendix A.

SAMPLING AND ANALYTICAL RESULTS

The results of monitoring and laboratory analysis of the groundwater samples for this and previous quarters are summarized in Table 1. The potentiometric groundwater elevations as interpreted from the results of this monitoring event are shown on Figure 2. The results of groundwater analysis are shown on Figure 3. The laboratory report and chain of custody record are presented in Appendix B.



TABLE 1 - SUMMARY OF RESULTS OF GROUNDWATER SAMPLING
 BP OIL COMPANY SERVICE STATION NO 11132
 3201 35TH STREET, OAKLAND, CALIFORNIA

ALISTO PROJECT NO. 10-024

WELL ID	DATE OF SAMPLING/ MONITORING	CASING ELEVATION (a) (Foot)	DEPTH TO WATER (Foot)	PRODUCT THICKNESS (Foot)	GROUNDWATER ELEVATION (b) (Foot)	TPH-G (ug/l)	B (ug/l)	T (ug/l)	E (ug/l)	X (ug/l)	MTBE (ug/l)	DO (ppm)	LAB
MW-1	07/09/90	169.75	---	0.22	---	---	---	---	---	---	---	---	---
MW-1	12/21/90	169.75	---	0.58	---	---	---	---	---	---	---	---	---
MW-1	03/07/91	169.75	20.59	---	---	---	---	---	---	---	---	---	---
MW-1	06/27/91	169.75	---	0.18	---	---	---	---	---	---	---	---	---
MW-1	09/27/91	169.75	---	0.27	---	---	---	---	---	---	---	---	---
MW-1	12/18/91	169.75	---	0.28	---	---	---	---	---	---	---	---	---
MW-1	04/01/91	169.75	16.51	0.15	153.35	---	---	---	---	---	---	---	---
MW-1	07/03/92	169.75	22.30	0.27	147.65	---	---	---	---	---	---	---	---
MW-1	10/05/92	169.75	23.38	0.24	145.95	---	---	---	---	---	---	---	---
MW-1	01/13/93	169.75	17.03	0.24	152.30	---	---	---	---	---	---	---	---
MW-1	04/23/93	169.75	18.10	0.42	151.97	---	---	---	---	---	---	---	---
MW-1	07/12/93	169.75	22.02	0.49	148.10	---	---	---	---	---	---	---	---
MW-1	10/21/93	169.75	25.12	1.09	145.45	---	---	---	---	---	---	---	---
MW-1	01/21/94	169.75	23.02	0.76	147.30	---	---	---	---	---	---	---	---
MW-1	04/20/94	169.75	24.54	1.80	146.56	---	---	---	---	---	---	---	---
MW-1	08/01/94	169.75	24.11	0.35	145.90	---	---	---	---	---	---	---	---
MW-1	12/23/94	169.75	18.19	0.29	151.78	---	---	---	---	---	---	---	---
MW-1	01/26/95	169.75	16.25	1.10	154.33	---	---	---	---	---	---	---	---
MW-1	06/08/95	169.75	22.92	1.20	147.73	---	---	---	---	---	---	---	---
MW-1	08/22/95	169.75	24.45	0.85	145.94	---	---	---	---	---	---	---	---
MW-1	10/27/95	169.75	25.41	0.69	144.86	---	---	---	---	---	---	---	---
MW-1	01/25/96	169.75	18.20	1.40	152.60	---	---	---	---	---	---	---	---
MW-1	04/19/96	169.75	19.06	1.22	151.61	---	---	---	---	---	---	---	---
MW-1	07/23/96	169.75	22.98	0.89	147.44	---	---	---	---	---	---	---	---
MW-1	11/11/96	169.75	23.99	0.98	146.50	---	---	---	---	---	---	---	---
MW-1	01/21/97	169.75	16.80	0.90	153.83	---	---	---	---	---	---	---	---
MW-2	07/09/90	168.14	---	0.10	---	---	---	---	---	---	---	---	---
MW-2	12/21/90	168.14	---	0.48	---	---	---	---	---	---	---	---	---
MW-2	03/07/91	168.14	19.18	---	---	---	---	---	---	---	---	---	---
MW-2	06/27/91	168.14	---	0.19	---	---	---	---	---	---	---	---	---
MW-2	09/27/91	168.14	---	0.15	---	---	---	---	---	---	---	---	---
MW-2	12/18/91	168.14	---	0.36	---	---	---	---	---	---	---	---	---
MW-2	04/01/91	168.14	15.21	0.10	153.01	---	---	---	---	---	---	---	---
MW-2	07/03/92	168.14	20.83	0.03	147.23	---	---	---	---	---	---	---	---
MW-2	10/05/92	168.14	22.74	0.21	145.56	---	---	---	---	---	---	---	---
MW-2	01/13/93	168.14	15.55	0.02	152.61	---	---	---	---	---	---	---	---
MW-2	04/23/93	168.14	18.54	0.21	151.76	---	---	---	---	---	---	---	---
MW-2	07/12/93	168.14	20.46	0.06	147.73	---	---	---	---	---	---	---	---
MW-2	10/21/93	168.14	24.91	0.31	143.46	---	---	---	---	---	---	---	---
MW-2	01/21/94	168.14	21.20	---	146.94	---	---	---	---	---	---	---	---
MW-2	04/20/94	168.14	22.44	---	145.70	1800	140	370	54	290	1.7	1.7	PACE
MW-2	08/01/94	168.14	22.24	0.04	145.93	---	---	---	---	---	---	---	---
MW-2	12/23/94	168.14	16.25	0.03	151.91	---	---	---	---	---	---	---	---
MW-2	01/28/95	168.14	14.55	0.39	153.88	---	---	---	---	---	---	---	---
MW-2	06/08/95	168.14	21.18	0.43	147.28	---	---	---	---	---	---	---	---
MW-2	08/22/95	168.14	22.76	0.36	145.65	---	---	---	---	---	---	---	---
MW-2	10/27/95	168.14	23.61	0.30	144.76	---	---	---	---	---	---	---	---
MW-2	01/25/96	168.14	15.95	0.15	152.30	---	---	---	---	---	---	---	---
MW-2	04/19/96	168.14	17.33	0.07	150.86	---	---	---	---	---	---	---	---
MW-2	07/23/96	168.14	21.25	0.05	146.93	---	---	---	---	---	---	---	---
MW-2	11/11/96	168.14	22.27	0.01	145.88	---	---	---	---	---	---	---	---
MW-2	01/21/97	168.14	15.19	0.01	152.96	---	---	---	---	---	---	---	---

TABLE 1. SUMMARY OF RESULTS OF GROUNDWATER SAMPLING
 BP OIL COMPANY SERVICE STATION NO. 11132
 3201 36TH STREET, OAKLAND, CALIFORNIA

ALISTO PROJECT NO. 10-024

WELL ID	DATE OF SAMPLING/ MONITORING	CASING ELEVATION (a) (Foot)	DEPTH TO WATER (Foot)	PRODUCT THICKNESS (Foot)	GROUNDWATER ELEVATION (b) (Foot)	TPH-G (ug/l)	B (ug/l)	T (ug/l)	E (ug/l)	X (ug/l)	MTBE (ug/l)	DO (ppm)	LAB
MW-3	07/09/90	167.17	---	---	---	140	5.3	4.6	2.0	3.8	---	---	---
MW-3	12/21/90	167.17	---	---	---	0.19	100	6.0	0.9	27	---	---	---
MW-3	03/07/91	167.17	17.40	---	149.77	0.4	69	22	6.1	57	---	---	---
MW-3	06/27/91	167.17	---	---	---	290	28	26	13	46	---	---	---
MW-3	09/27/91	167.17	---	---	---	0.07	7.9	ND	0.4	1.1	---	---	---
MW-3	12/18/91	167.17	---	---	---	0.26	34	24	0.8	28	---	---	---
MW-3	04/01/91	167.17	13.69	---	153.48	ND	ND	ND	ND	ND	---	---	---
MW-3	07/03/92	167.17	19.59	---	147.58	71	9.4	0.9	5.0	13	---	---	ANA
MW-3	10/05/92	167.17	21.22	---	145.95	67	5.1	1.1	6.1	8.1	---	---	ANA
QC-1 (c)	10/05/92	---	---	---	---	ND<50	2.2	ND<0.5	1.5	2.8	---	---	ANA
MW-3	01/13/93	167.17	13.63	---	153.54	830	50	34	42	89	---	---	PACE
MW-3	04/23/93	167.17	15.02	---	152.15	ND<50	ND<0.5	ND<0.5	ND<0.5	ND<0.5	---	---	PACE
QC-1 (c)	04/23/93	---	---	---	---	ND<50	ND<0.5	ND<0.5	ND<0.5	ND<0.5	---	---	PACE
MW-3	07/12/93	167.17	19.16	---	148.01	250	12	4.2	12	16	---	---	PACE
MW-3	10/21/93	167.17	21.81	---	145.36	52	4.4	1.4	4.7	3.3	---	---	PACE
QC-1 (c)	10/21/93	---	---	---	---	65	7.4	1.0	6.9	4.2	---	---	PACE
MW-3	01/21/94	167.17	19.94	---	147.23	57	3.0	3.4	3.6	9.0	---	---	PACE
MW-3	04/20/94	167.17	20.24	---	146.93	600	26	23	33	88	---	1.8	PACE
MW-3	08/01/94	167.17	20.74	---	146.43	99	6.2	1.1	4.5	5.2	---	1.4	PACE
QC-1 (c)	08/01/94	---	---	---	---	120	7.7	1.6	5.9	6.7	---	---	PACE
MW-3	12/23/94	167.17	14.70	---	152.47	ND<50	ND<0.5	0.78	ND<0.5	ND<0.5	---	1.7	PACE
QC-1 (c)	12/23/94	---	---	---	---	ND<50	ND<0.5	ND<0.5	ND<0.5	ND<0.5	---	---	PACE
MW-3	01/26/95	167.17	12.89	---	154.28	190	16	0.5	35	24	---	6.6	ATI
MW-3	06/08/95	167.17	19.95	---	147.22	330	21	4.0	34	32	---	7.0	ATI
MW-3	08/22/95	167.17	21.41	---	145.76	150	14	ND<0.50	ND<0.50	1.6	---	6.6	ATI
MW-3	10/27/95	167.17	22.43	---	144.74	---	---	---	---	---	---	---	---
MW-3	10/30/95	---	---	---	---	51	2.4	ND<0.50	ND<0.50	ND<1.0	ND<5.0	6.9	ATI
MW-3	01/25/96	167.17	14.03	---	153.14	ND<50	ND<0.50	ND<0.50	ND<0.50	ND<1.0	5.1	---	CEI
MW-3	04/19/96	167.17	15.26	---	151.91	460	55	4	33	63	ND<10	9.4	SPL
MW-3	07/23/96	167.17	19.19	---	147.98	ND<50	ND<0.5	ND<0.5	ND<0.5	ND<0.5	ND<10	9.2	SPL
MW-3	11/11/96	167.17	20.24	---	146.93	ND<250	ND<2.5	ND<5.0	ND<5.0	ND<5.0	ND<50	8.4	SPL
MW-3	01/21/97	167.17	13.09	---	154.08	ND<50	ND<0.5	ND<1.0	ND<1.0	ND<1.0	ND<10	5.4	SPL
MW-4	07/09/90	170.36	---	---	---	ND	ND	ND	ND	ND	---	---	---
MW-4	12/21/90	170.36	---	---	---	ND	ND	ND	ND	0.8	---	---	---
MW-4	03/07/91	170.36	20.72	---	149.64	ND	2.2	3.8	1.5	2.8	---	---	---
MW-4	06/27/91	170.36	---	---	---	ND	6.3	1.8	0.4	1.0	---	---	---
MW-4	09/27/91	170.36	---	---	---	ND	ND	ND	ND	ND	---	---	---
MW-4	12/18/91	170.36	---	---	---	ND	ND	ND	ND	ND	---	---	---
MW-4	04/01/91	170.36	17.49	---	152.87	ND	ND	ND	ND	ND	---	---	---
MW-4	07/03/92	170.36	22.16	---	148.20	ND<50	ND<0.5	ND<0.5	ND<0.5	ND<0.5	---	---	ANA
MW-4	10/05/92	170.36	23.38	---	146.98	ND<50	ND<0.5	ND<0.5	ND<0.5	ND<0.5	---	---	ANA
MW-4	01/13/93	170.36	17.58	---	152.78	ND<50	ND<0.5	ND<0.5	ND<0.5	ND<0.5	---	---	PACE
MW-4	04/23/93	170.36	15.72	---	154.64	ND<50	ND<0.5	ND<0.5	ND<0.5	ND<0.5	---	---	PACE
MW-4	07/12/93	170.36	21.74	---	148.62	ND<50	ND<0.5	ND<0.5	ND<0.5	ND<0.5	---	---	PACE
MW-4	10/21/93	170.36	23.84	---	146.52	ND<50	ND<0.5	ND<0.5	ND<0.5	ND<0.5	---	---	PACE
MW-4	01/21/94	170.36	22.42	---	147.94	ND<50	ND<0.5	ND<0.5	ND<0.5	ND<0.5	---	---	PACE
MW-4	04/20/94	170.36	22.66	---	147.70	ND<50	ND<0.5	ND<0.5	ND<0.5	ND<0.5	---	2.2	PACE
MW-4	08/01/94	170.36	23.01	---	147.35	ND<50	ND<0.5	ND<0.5	ND<0.5	ND<0.5	---	1.9	PACE
MW-4	12/23/94	170.36	17.03	---	153.33	---	---	---	---	---	---	---	---
MW-4	01/26/95	170.36	17.42	---	152.94	ND<50	ND<0.5	ND<0.5	ND<0.5	ND<1	---	7.5	ATI
MW-4	06/08/95	170.36	21.55	---	148.81	---	---	---	---	---	---	---	---
MW-4	08/22/95	170.36	23.47	---	146.89	ND<50	ND<0.50	ND<0.50	ND<0.50	ND<1.0	---	6.4	ATI
MW-4	10/27/95	170.36	24.50	---	145.86	---	---	---	---	---	---	---	---
MW-4	01/25/96	170.36	18.74	---	151.62	ND<50	ND<0.50	ND<0.50	ND<0.50	ND<1.0	58	---	CEI
MW-4	04/19/96	170.36	18.63	---	151.73	---	---	---	---	---	---	---	---
MW-4	07/23/96	170.36	22.56	---	147.80	---	---	---	---	---	---	---	---
MW-4	11/11/96	170.36	23.63	---	146.73	ND<50	ND<1.0	ND<1.0	ND<1.0	ND<1.0	34	8.2	SPL
MW-4	01/21/97	170.36	16.59	---	153.77	---	---	---	---	---	---	---	---

TABLE 1. SUMMARY OF THE RESULTS OF GROUNDWATER SAMPLING
 BP OIL COMPANY SERVICE STATION NO. 11132
 3201 35TH STREET, OAKLAND, CALIFORNIA

AUSTO PROJECT NO. 10-024

WELL ID	DATE OF SAMPLING/ MONITORING	CASING ELEVATION (a) (Foot)	DEPTH TO WATER (Foot)	PRODUCT THICKNESS (Foot)	GROUNDWATER ELEVATION (b) (Foot)	TPH-G (ug/l)	B (ug/l)	T (ug/l)	E (ug/l)	X (ug/l)	MTBE (ug/l)	DO (ppm)	LAB
MW-5	07/09/90	165.14	--	--	--	280	200	210	46	290	--	--	--
MW-5	12/21/90	165.14	--	--	--	0.69	300	34	84	39	--	--	--
MW-5	03/07/91	165.14	16.60	--	148.54	ND	17	0.9	0.7	1.6	--	--	--
MW-5	06/27/91	165.14	--	--	--	330	120	10	12	8	--	--	--
MW-5	09/27/91	165.14	--	--	--	0.73	230	16	20	22	--	--	--
MW-5	12/18/91	165.14	--	--	--	ND	ND	ND	ND	ND	--	--	--
MW-5	04/01/91	165.14	11.99	--	153.15	800	250	54	11	60	--	--	--
MW-5	07/03/92	165.14	18.65	--	146.49	150	36	ND<0.5	ND<0.5	1.1	--	--	ANA
MW-5	10/05/92	165.14	20.32	--	144.82	270	79	4	1.7	2.9	--	--	ANA
MW-5	01/13/93	165.14	13.03	--	152.11	180	59	6.0	1.8	7.6	--	--	PACE
MW-5	04/23/93	165.14	13.51	--	151.63	8700	440	96	35	136	--	--	PACE
MW-5	07/12/93	165.14	18.06	--	147.06	250	57	2.9	2.1	6.0	--	--	PACE
MW-5	10/21/93	165.14	20.41	--	144.73	210	82	1.5	ND<0.5	1.4	--	--	PACE
MW-5	01/21/94	165.14	18.86	--	146.28	110	36	1.2	ND<0.5	0.7	--	--	PACE
MW-5	04/20/94	165.14	17.30	--	147.84	690	230	4.5	1.6	11	--	1.3	PACE
MW-5	08/01/94	165.14	17.53	--	147.61	170	44	1.6	0.9	2.7	--	0.9	PACE
MW-5	12/23/94	165.14	11.63	--	153.51	630	180	1.9	0.66	1.9	--	1.4	PACE
MW-5	01/26/95	165.14	11.25	--	153.89	160	68	ND<0.5	ND<0.5	22	--	5.9	ATI
MW-5	06/08/95	165.14	16.80	--	148.34	2000	630	58	61	180	--	6.5	ATI
QC-1 (c)	06/08/95	--	--	--	--	1700	560	51	55	170	--	--	ATI
MW-5	08/22/95	165.14	19.02	--	146.12	3700	1100	18	27	59	--	7.3	ATI
MW-5	10/27/95	165.14	20.94	--	144.20	--	--	--	--	--	--	--	--
MW-5	10/30/95	--	--	--	--	6500	2200	55	180	270	ND<250	7.5	ATI
MW-5	01/25/96	165.14	13.30	--	151.84	590	37	0.70	ND<0.50	ND<1.0	ND<5.0	--	CEI
QC-1 (c)	01/25/96	--	--	--	--	540	37	0.66	ND<0.50	ND<1.0	ND<5.0	--	CEI
MW-5	04/19/96	165.14	13.63	--	151.51	1500	470	38	49	210	ND<50	8.1	SPL
MW-5	07/23/96	165.14	17.61	--	147.53	140	4.6	ND<0.5	ND<0.5	ND<0.5	ND<10	8.0	SPL
MW-5	11/11/96	165.14	18.70	--	146.44	140	40	ND<1.0	ND<1.0	ND<1.0	ND<10	7.9	SPL
MW-5	01/21/97	165.14	11.63	--	153.51	730	300	ND<5.0	7.8	26	ND<50	5.0	SPL
MW-6	07/09/90	165.40	--	--	--	ND	ND	ND	ND	ND	--	--	--
MW-6	12/21/90	165.40	--	--	--	0.17	2.6	7.0	4.9	26	--	--	--
MW-6 (d)	03/07/91	165.40	--	--	--	--	--	--	--	--	--	--	--
MW-6 (d)	06/27/91	165.40	--	--	--	--	--	--	--	--	--	--	--
MW-6 (d)	09/27/91	165.40	--	--	--	--	--	--	--	--	--	--	--
MW-6	12/18/91	165.40	--	--	--	ND	1.3	22	ND	2.7	--	--	--
MW-6	04/01/91	165.40	11.79	--	153.61	ND	ND	ND	ND	ND	--	--	--
MW-6	07/03/92	165.40	17.77	--	147.63	ND<50	ND<0.5	ND<0.5	ND<0.5	ND<0.5	--	--	ANA
MW-6	10/05/92	165.40	19.46	--	145.94	ND<50	ND<0.5	ND<0.5	ND<0.5	ND<0.5	--	--	ANA
MW-6	01/13/93	165.40	11.34	--	154.06	ND<50	ND<0.5	ND<0.5	ND<0.5	ND<0.5	--	--	PACE
MW-6	04/23/93	165.40	12.92	--	152.48	ND<50	ND<0.5	ND<0.5	ND<0.5	ND<0.5	--	--	PACE
MW-6	07/12/93	165.40	17.36	--	148.04	ND<50	ND<0.5	ND<0.5	ND<0.5	0.7	--	--	PACE
MW-6	10/21/93	165.40	19.98	--	145.42	ND<50	ND<0.5	ND<0.5	ND<0.5	ND<0.5	--	--	PACE
MW-6	01/21/94	165.40	18.10	--	147.90	ND<50	ND<0.5	ND<0.5	ND<0.5	ND<0.5	--	--	PACE
MW-6	04/20/94	165.40	18.68	--	146.72	ND<50	ND<0.5	ND<0.5	ND<0.5	ND<0.5	--	2.0	PACE
MW-6	08/01/94	165.40	18.90	--	146.50	ND<50	ND<0.5	ND<0.5	ND<0.5	ND<0.5	--	1.5	PACE
MW-6	12/23/94	165.40	12.94	--	152.46	--	--	--	--	--	--	--	--
MW-6	01/26/95	165.40	10.46	--	154.94	ND<50	ND<0.5	ND<0.5	ND<0.5	ND<1	--	7.3	ATI
MW-6	06/08/95	165.40	16.84	--	148.56	--	--	--	--	--	--	--	--
MW-6	08/22/95	165.40	19.48	--	145.92	ND<50	ND<0.50	ND<0.50	ND<0.50	ND<1.0	--	6.7	ATI
MW-6	10/27/95	165.40	20.39	--	145.01	--	--	--	--	--	--	--	--
MW-6	01/25/96	165.40	12.24	--	153.16	ND<50	ND<0.50	ND<0.50	ND<0.50	ND<1.0	9.9	--	CEI
MW-6	04/19/96	165.40	13.90	--	151.50	--	--	--	--	--	--	--	--
MW-6	07/23/96	165.40	17.83	--	147.57	--	--	--	--	--	--	--	--
MW-6	11/11/96	165.40	18.90	--	146.50	ND<50	ND<0.5	ND<1.0	ND<1.0	ND<1.0	ND<10	7.7	SPL
MW-6	01/21/97	165.40	11.97	--	153.43	--	--	--	--	--	--	--	--

TABLE 1 - SUMMARY OF RESULTS OF GROUNDWATER SAMPLING
 BP OIL COMPANY SERVICE STATION NO. 11132
 3201 35TH STREET, OAKLAND, CALIFORNIA

ALISTO PROJECT NO. 10-024

WELL ID	DATE OF SAMPLING/ MONITORING	CASING ELEVATION (a) (Feet)	DEPTH TO WATER (Feet)	PRODUCT THICKNESS (Feet)	GROUNDWATER ELEVATION (b) (Feet)	TPH-G (ug/l)	B (ug/l)	T (ug/l)	E (ug/l)	X (ug/l)	MTBE (ug/l)	DO (ppm)	LAB
MW-7	07/09/90	167.61	--	--	--	ND	ND	ND	ND	ND	--	--	--
MW-7	12/21/90	167.61	--	--	--	ND	ND	ND	ND	ND	--	--	--
MW-7	03/07/91	167.61	19.04	--	148.57	ND	ND	0.4	0.3	2.4	--	--	--
MW-7	06/27/91	167.61	--	--	--	70	17	4	0.8	2.2	--	--	--
MW-7	09/27/91	167.61	--	--	--	ND	0.4	ND	ND	0.4	--	--	--
MW-7	12/18/91	167.61	--	--	--	ND	0.7	2.9	0.8	3.3	--	--	--
MW-7	04/01/91	167.61	15.18	--	152.43	ND	ND	ND	ND	ND	--	--	--
MW-7	07/03/92	167.61	20.28	--	147.33	ND<50	ND<0.5	ND<0.5	ND<0.5	ND<0.5	--	--	ANA
MW-7	10/05/92	167.61	21.56	--	146.05	ND<50	ND<0.5	ND<0.5	ND<0.5	1.5	--	--	ANA
MW-7	01/13/93	167.61	15.41	--	152.20	ND<50	ND<0.5	ND<0.5	ND<0.5	ND<0.5	--	--	PACE
MW-7	04/23/93	167.61	15.84	--	151.77	ND<50	ND<0.5	ND<0.5	ND<0.5	ND<0.5	--	--	PACE
MW-7	07/12/93	167.61	19.84	--	147.77	ND<50	ND<0.5	ND<0.5	ND<0.5	ND<0.5	--	--	PACE
MW-7	10/21/93	167.61	21.61	--	146.00	ND<50	ND<0.5	ND<0.5	ND<0.5	ND<0.5	--	--	PACE
MW-7	01/21/94	167.61	20.49	--	147.12	ND<50	ND<0.5	ND<0.5	ND<0.5	ND<0.5	--	--	PACE
QC-1 (c)	01/21/94	--	--	--	--	ND<50	ND<0.5	ND<0.5	ND<0.5	ND<0.5	--	--	PACE
MW-7	04/20/94	167.61	20.54	--	147.07	ND<50	ND<0.5	ND<0.5	ND<0.5	ND<0.5	--	1.5	PACE
MW-7	08/01/94	167.61	20.99	--	146.62	ND<50	0.7	ND<0.5	ND<0.5	ND<0.5	--	1.9	PACE
MW-7	12/23/94	167.61	15.00	--	152.61	--	--	--	--	--	--	--	--
MW-7	01/26/95	167.61	14.69	--	152.92	ND<50	ND<0.5	ND<0.5	ND<0.5	ND<1	--	7.0	ATI
MW-7	06/08/95	167.61	19.87	--	147.74	--	--	--	--	--	--	--	--
MW-7	08/22/95	167.61	21.49	--	146.12	ND<50	ND<0.50	ND<0.50	ND<0.50	ND<1.0	--	6.4	ATI
MW-7	10/27/95	167.61	22.53	--	145.08	--	--	--	--	--	--	--	--
MW-7	01/25/96	167.61	17.21	--	150.40	ND<50	ND<0.50	ND<0.50	ND<0.50	ND<1.0	ND<5.0	--	CEI
MW-7	04/19/96	167.61	17.09	--	150.52	--	--	--	--	--	--	--	--
MW-7	07/23/96	167.61	21.02	--	146.59	--	--	--	--	--	--	--	--
MW-7	11/11/96	167.61	22.03	--	145.58	ND<50	ND<0.5	ND<1.0	ND<1.0	ND<1.0	ND<10	7.8	SPL
MW-7	01/21/97	167.61	15.06	--	152.55	--	--	--	--	--	--	--	--
MW-8	03/07/91	165.74	16.72	--	149.02	2.7	780	450	64	310	--	--	--
MW-8	06/27/91	165.74	--	--	--	12000	3400	1100	240	750	--	--	--
MW-8	09/27/91	165.74	--	--	--	41	5700	5200	1100	4300	--	--	--
MW-8	12/18/91	165.74	--	--	--	3.2	990	150	120	250	--	--	--
MW-8	04/01/91	165.74	12.54	--	153.20	15000	3600	2600	410	1900	--	--	--
MW-8	07/03/92	165.74	18.78	--	146.96	72000	19000	32000	3000	15000	--	--	ANA
MW-8	10/05/92	165.74	20.48	0.01	145.27	--	--	--	--	--	--	--	--
MW-8	01/13/93	165.74	12.87	0.01	152.88	--	--	--	--	--	--	--	--
MW-8	04/23/93	165.74	13.90	SHEEN	151.84	--	--	--	--	--	--	--	--
MW-8	07/12/93	165.74	18.30	SHEEN	147.44	--	--	--	--	--	--	--	--
MW-8	10/21/93	165.74	21.91	0.95	144.54	--	--	--	--	--	--	--	--
MW-8	01/21/94	165.74	19.12	0.03	146.64	--	--	--	--	--	--	--	--
MW-8	04/20/94	165.74	19.28	0.03	146.48	26000	1700	4100	960	4000	--	1.1	PACE
MW-8	08/01/94	165.74	--	--	--	--	--	--	--	--	--	--	--
MW-8	12/23/94	165.74	13.81	0.03	151.95	--	--	--	--	--	--	--	--
MW-8	01/26/95	165.74	--	--	--	--	--	--	--	--	--	--	--
MW-8	06/08/95	165.74	17.82	0.29	148.14	--	--	--	--	--	--	--	--
MW-8	08/22/95	165.74	19.41	0.20	146.48	--	--	--	--	--	--	--	--
MW-8	10/27/95	165.74	20.47	0.14	145.38	--	--	--	--	--	--	--	--
MW-8	01/25/96	165.74	13.35	0.22	152.56	--	--	--	--	--	--	--	--
MW-8	04/19/96	165.74	14.40	0.20	151.49	--	--	--	--	--	--	--	--
MW-8	07/23/96	165.74	18.35	0.14	147.50	--	--	--	--	--	--	--	--
MW-8	11/11/96	165.74	19.41	0.02	146.35	--	--	--	--	--	--	--	--
MW-8	01/21/97	165.74	12.29	0.01	153.46	--	--	--	--	--	--	--	--

TABLE 1 - SUMMARY OF RESULTS OF GROUNDWATER SAMPLING
 BP OIL COMPANY SERVICE STATION NO. 11132
 3201 35TH STREET, OAKLAND, CALIFORNIA

ALISTO PROJECT NO. 10-024

WELL ID	DATE OF SAMPLING/ MONITORING	CASING ELEVATION (Foot)	DEPTH TO WATER (Foot)	PRODUCT THICKNESS (Foot)	GROUNDWATER ELEVATION (Foot)	TPH-G (ug/l)	B (ug/l)	T (ug/l)	E (ug/l)	X (ug/l)	MTBE (ug/l)	DO (ppm)	LAB
MW-9	03/07/91	166.20	16.79	--	149.41	7.1	220	4	2.4	2400	--	--	--
MW-9	06/27/91	166.20	--	--	--	3000	520	400	85	310	--	--	--
MW-9	09/27/91	166.20	--	--	--	3.2	720	150	50	180	--	--	--
MW-9	12/18/91	166.20	--	--	--	ND	2.5	1.1	0.3	5.8	--	--	--
MW-9	04/01/91	166.20	12.89	--	153.31	12000	2000	2600	360	1600	--	--	--
MW-9	07/03/92	166.20	18.89	--	147.31	5700	17000	840	230	800	--	--	ANA
MW-9	10/05/92	166.20	20.52	--	145.68	1400	440	17	14	100	--	--	ANA
MW-9	01/13/93	166.20	12.92	--	153.28	11000	1200	1700	340	1400	--	--	PACE
QC-1 (c)	01/13/93	--	--	--	0.00	11000	1200	1600	330	1300	--	--	PACE
MW-9	04/23/93	166.20	14.08	--	152.12	24000	2800	4500	730	3400	--	--	PACE
MW-9	07/12/93	166.20	18.44	--	147.76	13000	1400	1100	360	1400	--	--	PACE
QC-1 (c)	07/12/93	--	--	--	--	10000	1200	900	310	1200	--	--	PACE
MW-9	10/21/93	166.20	21.81	0.89	145.06	--	--	--	--	--	--	--	--
MW-9	01/21/94	166.20	19.28	--	146.92	--	--	--	--	--	--	--	--
MW-9	04/20/94	166.20	19.72	--	146.48	43000	2800	6800	1300	7900	--	1.7	PACE
QC-1 (c)	04/20/94	--	--	--	--	45000	2700	6800	1200	8200	--	--	PACE
MW-9	08/01/94	166.20	20.18	0.05	146.06	--	--	--	--	--	--	--	--
MW-9	12/23/94	166.20	14.22	0.02	152.00	--	--	--	--	--	--	--	--
MW-9	01/26/95	166.20	11.85	0.13	154.45	--	--	--	--	--	--	--	--
MW-9	06/08/95	166.20	18.33	0.80	148.47	--	--	--	--	--	--	--	--
MW-9	08/22/95	166.20	19.95	0.01	146.26	--	--	--	--	--	--	--	--
MW-9	10/27/95	166.20	20.88	0.01	145.33	--	--	--	--	--	--	--	--
MW-9	01/25/96	166.20	13.84	0.07	152.41	--	--	--	--	--	--	--	--
MW-9 (d)	04/19/96	166.20	--	--	--	--	--	--	--	--	--	--	--
MW-9	07/23/96	166.20	18.84	0.03	147.38	--	--	--	--	--	--	--	--
MW-9	11/11/96	166.20	19.91	0.01	146.30	--	--	--	--	--	--	--	--
MW-9	01/21/97	166.20	12.93	0.01	153.28	--	--	--	--	--	--	--	--
MW-10	03/07/91	167.01	18.09	--	148.92	1.6	120	190	32	230	--	--	--
MW-10	06/27/91	167.01	--	--	--	12000	7300	500	150	300	--	--	--
MW-10	09/27/91	167.01	--	--	--	57	12000	7200	1400	4600	--	--	--
MW-10	12/18/91	167.01	--	--	--	5.3	2500	120	36	79	--	--	--
MW-10	04/01/91	167.01	13.92	--	153.09	ND	ND	ND	ND	ND	--	--	--
MW-10	07/03/92	167.01	19.92	--	147.09	8600	5100	1300	180	690	--	--	ANA
MW-10	10/05/92	167.01	21.92	0.19	145.23	--	--	--	--	--	--	--	--
MW-10	01/13/93	167.01	14.43	0.03	152.60	--	--	--	--	--	--	--	--
MW-10	04/23/93	167.01	15.26	0.06	151.80	--	--	--	--	--	--	--	--
MW-10	07/12/93	167.01	19.78	0.45	147.57	--	--	--	--	--	--	--	--
MW-10	10/21/93	167.01	22.90	0.69	144.63	--	--	--	--	--	--	--	--
MW-10	01/21/94	167.01	20.25	0.06	146.81	--	--	--	--	--	--	--	--
MW-10	04/20/94	167.01	20.74	--	146.27	100000	12000	24000	2400	14000	--	1.0	PACE
MW-10	08/01/94	167.01	22.00	0.28	145.22	--	--	--	--	--	--	--	--
MW-10	12/23/94	167.01	16.08	0.25	151.12	--	--	--	--	--	--	--	--
MW-10	01/26/95	167.01	13.68	0.80	153.93	--	--	--	--	--	--	--	--
MW-10	06/08/95	167.01	19.08	0.75	148.49	--	--	--	--	--	--	--	--
MW-10	08/22/95	167.01	20.73	0.70	146.81	--	--	--	--	--	--	--	--
MW-10	10/27/95	167.01	21.69	0.63	145.79	--	--	--	--	--	--	--	--
MW-10	01/25/96	167.01	15.05	0.81	152.57	--	--	--	--	--	--	--	--
MW-10	04/19/96	167.01	16.26	0.58	151.19	--	--	--	--	--	--	--	--
MW-10	07/23/96	167.01	20.18	0.62	147.30	--	--	--	--	--	--	--	--
MW-10	11/11/96	167.01	21.20	0.20	145.96	--	--	--	--	--	--	--	--
MW-10	01/21/97	167.01	13.66	0.14	153.46	--	--	--	--	--	--	--	--

TABLE 1 - SUMMARY OF RESULTS OF GROUNDWATER SAMPLING
 BP OIL COMPANY SERVICE STATION NO. 11132
 3201 35TH STREET, OAKLAND, CALIFORNIA

ALISTO PROJECT NO. 10-024

WELL ID	DATE OF SAMPLING/ MONITORING	CASING ELEVATION (a) (Feet)	DEPTH TO WATER (Feet)	PRODUCT THICKNESS (Feet)	GROUNDWATER ELEVATION (b) (Feet)	TPH-G (ug/l)	B (ug/l)	T (ug/l)	E (ug/l)	X (ug/l)	MTBE (ug/l)	DO (ppm)	LAB
RW-1	07/09/90	168.01	--	1.21	--	--	--	--	--	--	--	--	--
RW-1	12/21/90	168.01	--	0.01	--	--	--	--	--	--	--	--	--
RW-1	03/07/91	168.01	17.62	SHEEN	150.99	--	--	--	--	--	--	--	--
RW-1	06/27/91	168.01	--	0.04	--	--	--	--	--	--	--	--	--
RW-1	09/27/91	168.01	--	0.02	--	--	--	--	--	--	--	--	--
RW-1	12/18/91	168.01	--	0.02	--	--	--	--	--	--	--	--	--
RW-1	04/01/91	168.01	14.40	0.11	153.69	--	--	--	--	--	--	--	--
RW-1	07/03/92	168.01	20.66	SHEEN	147.35	--	--	--	--	--	--	--	--
RW-1	10/05/92	168.01	23.34	0.08	144.73	--	--	--	--	--	--	--	--
RW-1	01/13/93	168.01	16.59	0.05	151.46	--	--	--	--	--	--	--	--
RW-1	04/23/93	168.01	16.17	0.18	151.98	--	--	--	--	--	--	--	--
RW-1	07/12/93	168.01	20.18	0.06	147.88	--	--	--	--	--	--	--	--
RW-1	10/21/93	168.01	25.70	0.56	142.73	--	--	--	--	--	--	--	--
RW-1	01/21/94	168.01	21.24	0.40	147.07	--	--	--	--	--	--	--	--
RW-1	04/20/94	168.01	32.20	--	135.81	--	--	--	--	--	--	--	--
RW-1	08/01/94	168.01	21.70	--	145.31	29000	580	950	300	7800	--	1.1	PACE
RW-1	12/23/94	168.01	16.02	--	151.99	1300	25	8.6	1.4	69	--	1.8	PACE
RW-1	01/26/95	168.01	13.78	--	154.23	ND-50	ND-0.5	ND-0.5	ND-0.5	ND-0.5	--	--	ATI
QC-1 (c)	01/26/95	--	--	--	--	ND-50	ND-0.5	ND-0.5	ND-0.5	ND-0.5	--	--	ATI
RW-1	05/08/95	168.01	20.05	--	147.96	1300	130	ND-1.0	ND-1.0	36	--	--	ATI
RW-1	08/22/95	168.01	21.74	--	146.27	3000	230	13	4.9	280	--	6.6	ATI
QC-1 (c)	08/22/95	--	--	--	--	2800	210	9.3	4.3	250	--	--	ATI
RW-1	10/27/95	168.01	32.00	--	136.01	--	--	--	--	--	--	--	--
RW-1	10/30/95	--	--	--	--	230	1.4	ND-1.0	ND-1.0	ND-2.0	650	6.9	ATI
QC-1 (c)	10/30/95	--	--	--	--	240	1.6	ND-1.0	ND-1.0	ND-2.0	630	--	ATI
RW-1	01/25/96	168.01	15.41	--	152.60	15000	3400	930	330	2500	5300	--	CEI
RW-1	04/19/96	168.01	16.83	--	151.18	35000	5500	3300	1700	9400	14000	7.6	SPL
QC-1 (c)	04/19/96	--	--	--	--	33000	5600	3200	1700	8900	15000	--	SPL
RW-1	07/23/96	168.01	20.76	--	147.25	46000	3600	2300	900	5100	36000	7.4	SPL
QC-1 (c)	07/23/96	--	--	--	--	47000	3700	2500	930	5300	35000	--	SPL
RW-1	11/11/96	168.01	21.73	--	146.28	34000	3000	1200	880	4600	22000	8.3	SPL
QC-1 (c)	11/11/96	--	--	--	--	31000	2900	1000	860	4600	22000	--	SPL
RW-1	01/21/97	168.01	14.20	--	153.81	260	40	16	2.7	34	1500	6.1	SPL
QC-1 (c)	01/21/97	--	--	--	--	270	42	17	2.7	36	1500	--	SPL
QC-2 (e)	10/05/92	--	--	--	--	ND-50	ND-0.5	ND-0.5	ND-0.5	ND-0.5	--	--	ANA
QC-2 (e)	01/13/93	--	--	--	--	ND-50	ND-0.5	ND-0.5	ND-0.5	ND-0.5	--	--	PACE
QC-2 (e)	04/23/93	--	--	--	--	ND-50	ND-0.5	ND-0.5	ND-0.5	ND-0.5	--	--	PACE
QC-2 (e)	07/12/93	--	--	--	--	ND-50	ND-0.5	ND-0.5	ND-0.5	ND-0.5	--	--	PACE
QC-2 (e)	10/21/93	--	--	--	--	ND-50	ND-0.5	ND-0.5	ND-0.5	ND-0.5	--	--	PACE
QC-2 (e)	01/21/94	--	--	--	--	ND-50	ND-0.5	2.1	ND-0.5	2.1	--	--	PACE
QC-2 (e)	04/20/94	--	--	--	--	ND-50	ND-0.5	ND-0.5	ND-0.5	ND-0.5	--	--	PACE
QC-2 (e)	04/20/94	--	--	--	--	ND-50	ND-0.5	ND-0.5	ND-0.5	ND-0.5	--	--	PACE
QC-2 (e)	12/23/94	--	--	--	--	ND-50	ND-0.5	ND-0.5	ND-0.5	ND-0.5	--	--	ATI
QC-2 (e)	01/26/95	--	--	--	--	ND-50	ND-0.5	ND-0.5	ND-0.5	ND-0.5	--	--	ATI
QC-2 (e)	05/08/95	--	--	--	--	ND-50	ND-0.50	ND-0.50	ND-0.50	ND-1.0	--	--	ATI
QC-2 (e)	08/22/95	--	--	--	--	ND-50	ND-0.50	ND-0.50	ND-0.50	ND-1.0	--	--	ATI
QC-2 (e)	10/30/95	--	--	--	--	ND-50	ND-0.50	ND-0.50	ND-0.50	ND-1.0	ND-5.0	--	ATI
QC-2 (e)	01/25/96	--	--	--	--	ND-50	ND-0.50	ND-0.50	ND-0.50	ND-1.0	ND-5.0	--	CEI
QC-2 (e)	04/19/96	--	--	--	--	ND-50	ND-0.5	ND-1	ND-1	ND-1	ND-10	--	SPL

TABLE I. SUMMARY OF RESULTS OF GROUNDWATER SAMPLING
 BP OIL COMPANY SERVICE STATION NO. 11132
 3201 35TH STREET, OAKLAND, CALIFORNIA

ALISTO PROJECT NO. 10-024

WELL ID	DATE OF SAMPLING/ MONITORING	CASING ELEVATION (a) (Foot)	DEPTH TO WATER (Foot)	PRODUCT THICKNESS (Foot)	GROUNDWATER ELEVATION (b) (Foot)	TPH-G (ug/l)	B (ug/l)	T (ug/l)	E (ug/l)	X (ug/l)	MTBE (ug/l)	DO (ppm)	LAB
ABBREVIATIONS.						NOTES							
TPH-G	Total petroleum hydrocarbons as gasoline					(a)	Casing elevations surveyed to the nearest 0.01 foot relative to mean sea level.						
B	Benzene												
T	Toluene												
E	Ethylbenzene					(b)	Groundwater elevations adjusted assuming a specific gravity of 0.75 for free product.						
X	Total xylenes												
MTBE	Methyl tert butyl ether												
DO	Dissolved oxygen					(c)	Blind duplicate						
ug/l	Micrograms per liter												
ppm	Parts per million					(d)	Well inaccessible						
---	Not analyzed/available/applicable/measurable												
ND	Not detected above reported detection limit					(e)	Travel blank.						
PACE	Paco, Inc												
ANA	Anamatrix, Inc												
ATI	Analytical Technologies, Inc.												
CEI	Cemic Corporation												
SPL	Southern Petroleum Laboratories												

F:\010-024\024-9-3 WQ2

TABLE 2 - PRODUCT REMOVAL STATUS
 BP OIL COMPANY SERVICE STATION NO. 11132
 3201 35TH STREET, OAKLAND, CALIFORNIA

ALISTO PROJECT NO. 10-024

WELL ID	DATE	PRODUCT REMOVED (Gallons)	PRODUCT REMOVED CUMULATIVE (Gallons)
MW-1	01/26/95	3.00	3.00
	06/08/95	0.60	3.60
	06/28/95	0.10	3.70
	08/22/95	0.15	3.85
	10/30/95	0.11	3.96
	01/25/96	1.00	4.96
	02/16/95	0.08	5.04
	04/19/96	0.75	5.79
	07/23/96	0	5.79
	11/11/96	0.98	6.77
01/21/97	0.20	6.97	
MW-2	09/29/93	0.10	0.10
	10/05/93	0.10	0.20
	10/14/93	0.10	0.30
	10/20/93	0.25	0.55
	11/02/93	0.10	0.65
	12/07/93	0.05	0.70
	12/17/93	<0.01	0.70
	12/23/93	0.30	1.00
	01/12/94	0.05	1.05
	02/02/94	0.01	1.06
	02/11/94	0.01	1.07
	03/18/94	<0.01	1.07
	10/26/94	0.76	1.83
	11/12/94	0.08	1.91
	12/12/94	0.03	1.94
	01/26/95	0.19	2.13
	06/08/95	Sheen	2.13
	06/28/95	0.05	2.18
	08/22/95	0.10	2.28
	10/30/95	0.05	2.33
	01/25/96	Sheen	2.33
	02/16/95	0.04	2.37
	04/19/96	0.01	2.38
07/23/96	0	2.38	
11/11/96	0.01	2.39	
01/21/97	<0.01	2.39	
MW-8	11/02/93	0.25	0.25
	11/10/93	0.10	0.35
	11/16/93	0.10	0.45
	11/23/93	0.10	0.55
	11/30/93	0.10	0.65
	12/17/93	<0.01	0.65
	12/23/93	<0.01	0.65
	01/12/94	0.01	0.66
	02/02/94	0.05	0.71
	02/11/94	0.08	0.79
	02/18/94	<0.01	0.79
	03/18/94	0.01	0.80
	04/27/94	<0.01	0.80
	05/27/94	<0.01	0.80
	10/26/94	0.10	0.90
	11/12/94	0.02	0.92
	12/12/94	0.01	0.93
	06/08/95	Sheen	0.93
	08/22/95	0.05	0.98
	10/30/95	0.02	1.00
	01/25/96	0.05	1.05
	02/16/95	0.01	1.06
	04/19/96	0.25	1.31
	07/23/96	0	1.31
	11/11/96	0.02	1.33
	01/21/97	<0.01	1.33

TABLE 2 - PRODUCT REMOVAL STATUS
 BP OIL COMPANY SERVICE STATION NO. 11132
 3201 35TH STREET, OAKLAND, CALIFORNIA

ALISTO PROJECT NO 10-024

WELL ID	DATE	PRODUCT REMOVED (Gallons)	PRODUCT REMOVED CUMULATIVE (Gallons)
MW-9	11/02/93	0.10	0.10
	11/10/93	0.10	0.20
	11/16/93	0.10	0.30
	12/23/93	<0.01	0.30
	01/12/94	0.01	0.31
	01/20/93	0.05	0.36
	02/02/94	0.05	0.41
	02/11/94	0.01	0.42
	02/18/94	<0.01	0.42
	03/18/94	0.10	0.52
	10/26/94	0.15	0.67
	11/12/94	<0.01	0.67
	12/12/94	<0.01	0.67
	01/26/95	0.10	0.77
	06/28/95	<0.01	0.77
	08/22/95	<0.01	0.77
	10/30/95	<0.01	0.77
	01/25/96	<0.01	0.77
	02/16/95	<0.01	0.77
	04/19/96	<0.01	0.77
07/23/96	0	0.77	
11/11/96	0.01	0.78	
01/21/97	<0.01	0.78	
MW-10	09/07/93	0.10	0.10
	09/14/93	0.10	0.20
	09/29/93	0.10	0.30
	10/05/93	1.60	1.90
	10/14/93	2.10	4.00
	10/20/93	1.00	5.00
	10/27/93	1.00	6.00
	11/02/93	0.30	6.30
	11/10/93	0.20	6.50
	11/16/93	0.10	6.60
	11/23/93	0.10	6.70
	11/30/93	0.30	7.00
	12/07/93	0.20	7.20
	12/17/93	0.30	7.50
	12/23/93	<0.01	7.50
	01/04/94	0.01	7.51
	01/12/94	0.01	7.52
	01/20/94	0.20	7.72
	02/02/94	0.01	7.73
	02/11/94	0.01	7.74
	02/18/94	0.20	7.94
	05/27/94	<0.01	7.94
	10/26/94	0.60	8.54
	11/12/94	0.43	8.97
	12/12/94	0.26	9.23
	01/26/95	0.13	9.36
	06/28/95	0.10	9.46
	08/22/95	0.15	9.61
	10/30/95	0.10	9.71
	01/25/96	0.25	9.96
02/16/95	0.10	10.06	
04/19/96	0.50	10.56	
07/23/96	0	10.56	
11/11/96	0.20	10.76	
01/21/97	<0.03	10.79	

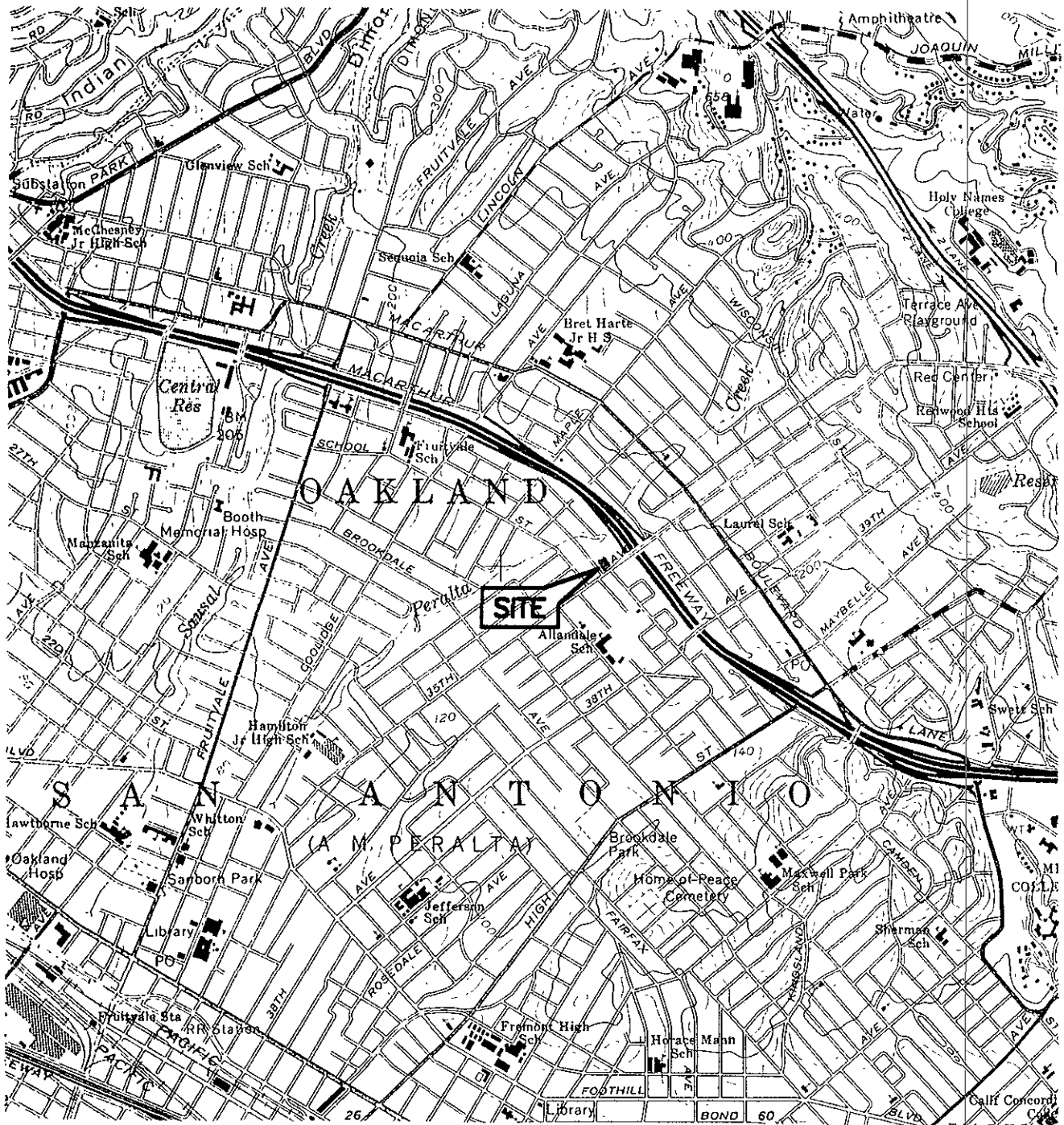

SOURCE:
 USGS MAP, OAKLAND EAST QUADRANGLE,
 CALIFORNIA. 7.5 MINUTE SERIES. 1959.
 PHOTOREVISED 1980.

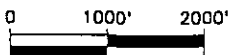

FIGURE 1

SITE VICINITY MAP

BP OIL SERVICE STATION NO. 11132
 3201 35TH STREET
 OAKLAND, CALIFORNIA
 PROJECT NO. 10-024



ALISTO ENGINEERING GROUP
 WALNUT CREEK, CALIFORNIA

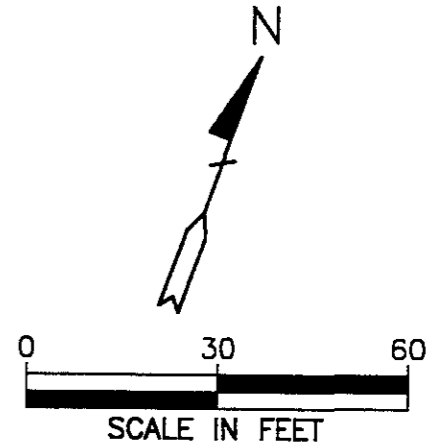
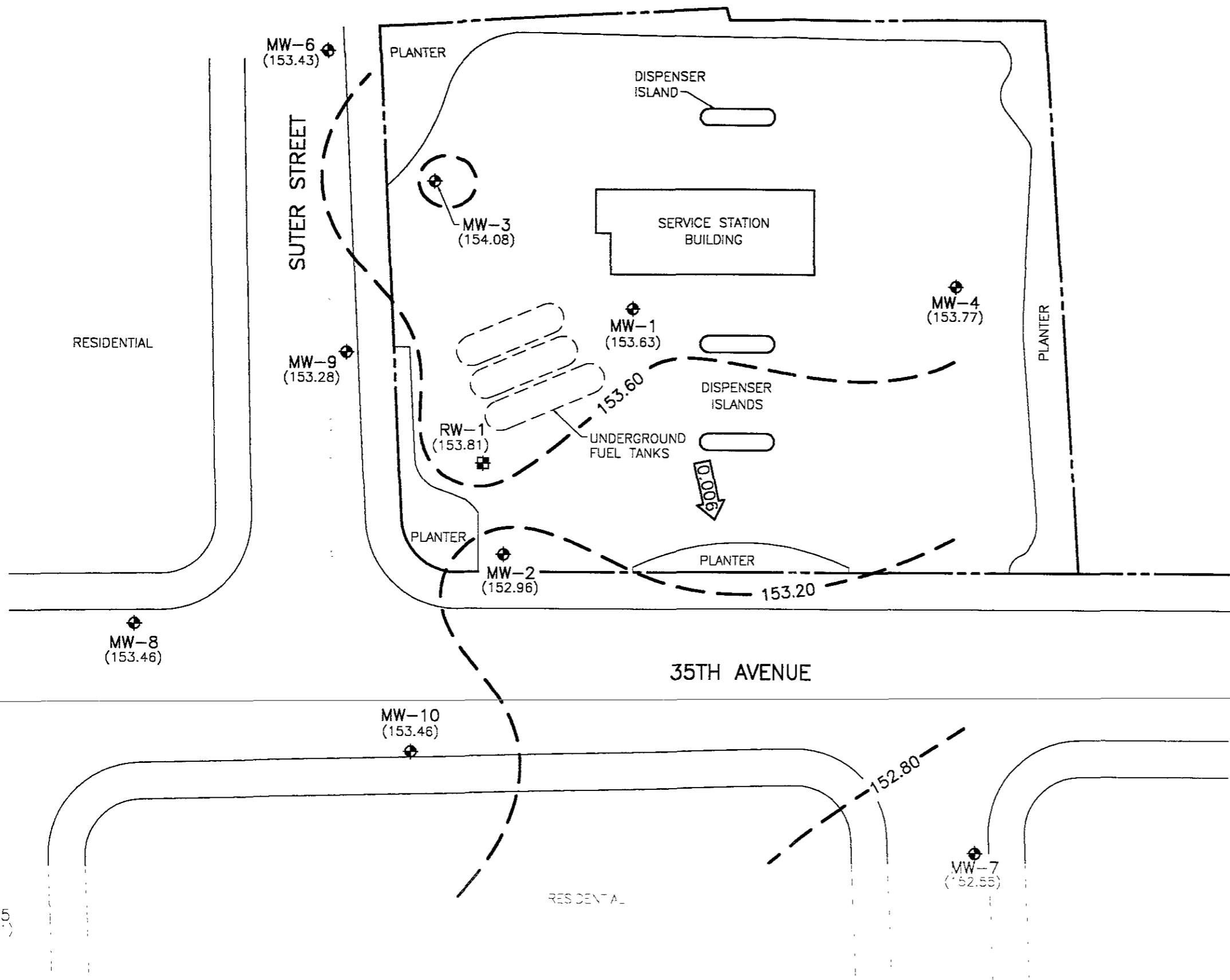

- LEGEND**
- ◆ GROUNDWATER MONITORING WELL
 - ⊕ GROUNDWATER RECOVERY WELL
 - (153.63) GROUNDWATER ELEVATION IN FEET ABOVE MEAN SEA LEVEL
 - 153.60 - GROUNDWATER ELEVATION CONTOUR IN FEET ABOVE MEAN SEA LEVEL (CONTOUR INTERVAL-0.40 FOOT)
 - ← 0.006 → CALCULATED GROUNDWATER GRADIENT DIRECTION AND MAGNITUDE IN FOOT PER FOOT

FIGURE 2
POTENTIOMETRIC GROUNDWATER ELEVATION CONTOUR MAP
 JANUARY 21, 1997
 BP OIL SERVICE STATION NO. 11132
 3201 35TH STREET
 OAKLAND, CALIFORNIA
 PROJECT NO. 10-024

100445 U.DWG 2 11 97 10/11

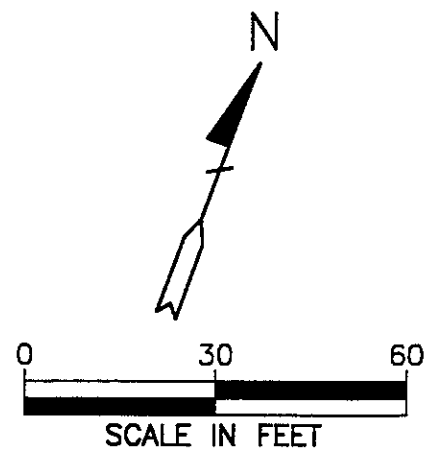
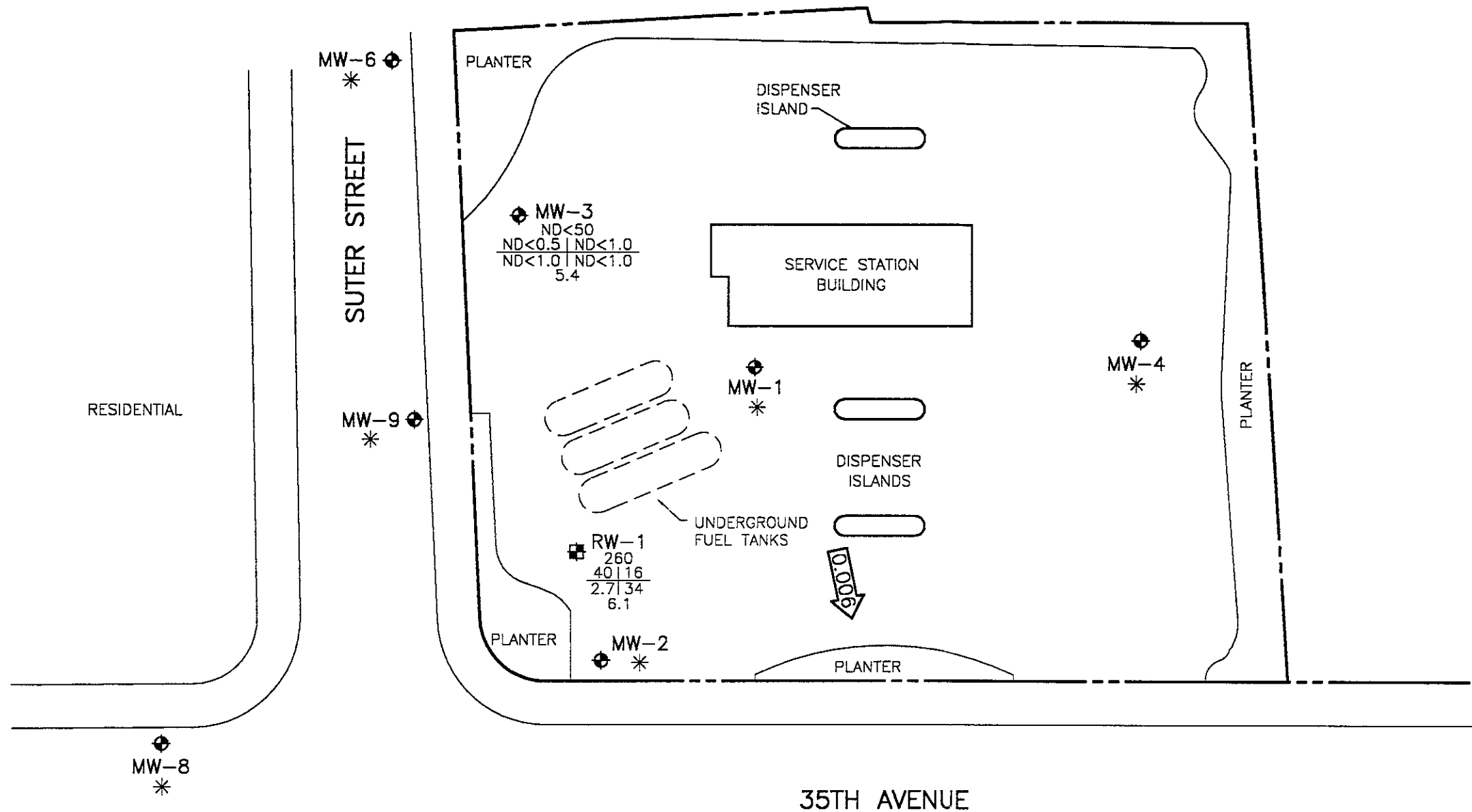

LEGEND

- ◆ GROUNDWATER MONITORING WELL
- GROUNDWATER RECOVERY WELL
- TPH-G
B | T
E | X
DO
DO
- TPH-G
B
T
E
X
DO
ND
- ←0.006
- *

CONCENTRATION OF CONSTITUENTS IN MICROGRAMS PER LITER, EXCEPT DISSOLVED OXYGEN, WHICH IS IN PARTS PER MILLION

TOTAL PETROLEUM HYDROCARBONS AS GASOLINE

BENZENE
TOLUENE
ETHYLBENZENE
TOTAL XYLENES
DISSOLVED OXYGEN
NOT DETECTED ABOVE REPORTED DETECTION LIMIT

CALCULATED GROUNDWATER GRADIENT DIRECTION AND MAGNITUDE IN FOOT PER FOOT

NOT SAMPLED

FIGURE 3
CONCENTRATIONS OF PETROLEUM HYDROCARBONS IN GROUNDWATER
 JANUARY 21, 1997
 BP OIL SERVICE STATION NO. 11132
 3201 35TH STREET
 OAKLAND, CALIFORNIA
 PROJECT NO. 10-024

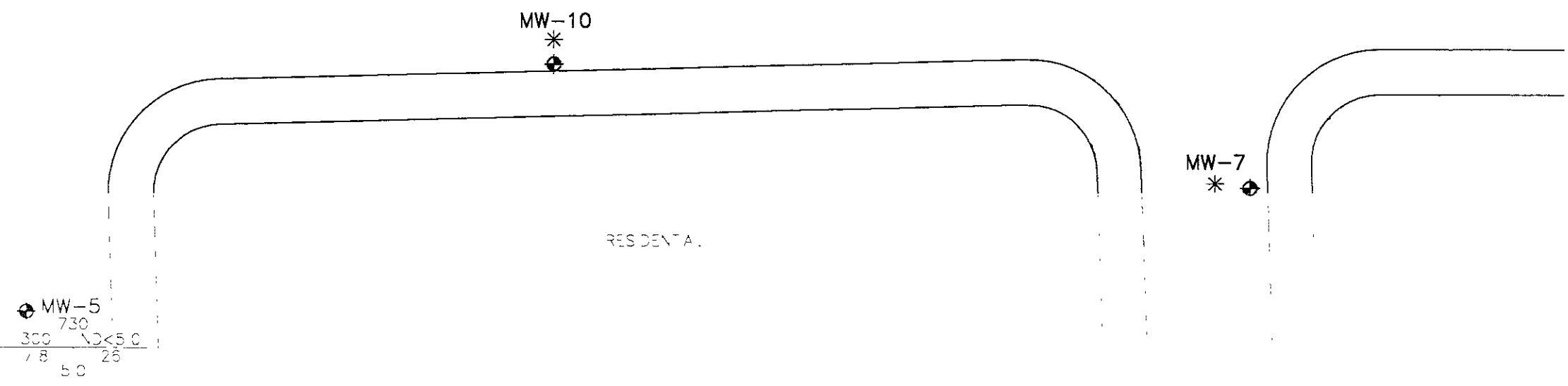

APPENDIX A
WATER SAMPLING FIELD SURVEY FORMS

ALISTO

Field Report / Sampling Data Sheet

ENGINEERING
GROUP
1575 TREAT BOULEVARD, SUITE 201

Project No. 10-024-09-003 Date: 1/21/97
Address 3201 35th Street Day: MKW TH F
Contract No. G797457 City: Oakland
Station No. BP 11132 Sampler: LCB

DEPTH TO GROUNDWATER SUMMARY

WELL ID	SAMPLE ID	WELL DIAM	TOTAL DEPTH	DEPTH TO WATER	PRODUCT THICKNESS	TIME MONITORED	COMMENTS:
MW-1	NIS	2"	N/M	16.80	.90	1037	Removed 1 gal TE, 2.0 gal FP, Serviced PPRS
MW-2	NIS		N/M	15.19	.01	1040	Removed 1 gal TE <.01 gal FP, Serviced PPRS
MW-3	S-1		34.58	13.09	Ø	1027	
MW-4	NIS		N/M	16.59		1022	SEMI/JAN-JULY October / April
MW-5	S-2		30.88	11.63		1031	
MW-6	NIS		N/M	11.97		1012	SEMI/JAN-JULY Oct. / April.
MW-7	NIS			15.06	↓	1015	SEMI/JAN-JULY Oct. April.
MW-8	NIS			12.29	.01	1046	Removed 1 gal TE <.01 gal FP, Serviced PPRS
MW-9	NIS			12.93	.01	1050	Removed 1 gal TE <.01 gal FP, Serviced PPRS
MW-10	NIS	↓	↓	13.66	.14	1054	Removed 1 gal TE <.03 gal FP, Serviced PPRS
RW-1	S-3	6"	38.41	14.80	Ø	1037	Ac-1 (S-4) From this well

FIELD INSTRUMENT CALIBRATION DATA

pH METER Jan 4.00 4 7.00 7 10.00 10 TEMPERATURE COMPENSATED (Y) N TIME 1008
D.O. METER Jan ZERO d.O. SOLUTION _____ BAROMETRIC PRESSURE 760 TEMP 60 WEATHER Cloudy
CONDUCTIVITY METER Jan 10,000 _____ TURBIDITY METER _____ 5.0 NTU _____ OTHER _____
LEAK DETECTOR: _____ ALARM MODE X NON ALARM MODE

Well ID	Depth to Water	Diam	Cap/Lock	Product Dept	Iridescence	Gal.	Time	Temp *F	pH	E.C.	D.O.	
MW-3	13.09	2"	OK	Ø	Y (N)	3	1110	66.7	7.21	769µs	5.2	<input type="checkbox"/> EPA 601 _____ <input checked="" type="checkbox"/> TPH-G/BTEX <u>HCL</u>
Total Depth - Water Level = x Well Vol. Factor = x#vol. to Purge PurgeVol.						7		67.6	7.14	734µs		<input type="checkbox"/> TPH Diesel _____
34.58 - 13.09 = 21.49 x .16 = 3.44 x 3 = 10.32						11	1117	67.9	7.03	720µs	5.4	<input type="checkbox"/> TOG 5520 _____
Purge Method: <input checked="" type="checkbox"/> Surface Pump <input type="checkbox"/> Disp. Tube <input type="checkbox"/> Winch <input type="checkbox"/> Disp. Bailer(s) _____ <input type="checkbox"/> Sys Port												TIME/SAMPLE ID
Comments:												1124

Well ID	Depth to Water	Diam	Cap/Lock	Product Dept	Iridescence	Gal.	Time	Temp *F	pH	E.C.	D.O.	
MW-5	11.63	2"	OK	Ø	Y (N)	3	1137	67.4	7.87	1.63ms	4.7	<input type="checkbox"/> EPA 601 _____ <input checked="" type="checkbox"/> TPH-G/BTEX <u>HCL</u>
Total Depth - Water Level = x Well Vol. Factor = x#vol. to Purge PurgeVol.						6		67.9	7.63	1.34ms		<input type="checkbox"/> TPH Diesel _____
30.88 - 11.63 = 19.25 x .16 = 3.08 x 3 = 9.24						10	1149	68.4	7.56	1.31ms	5.0	<input type="checkbox"/> TOG 5520 _____
Purge Method: <input checked="" type="checkbox"/> Surface Pump <input type="checkbox"/> Disp. Tube <input type="checkbox"/> Winch <input type="checkbox"/> Disp. Bailer(s) _____ <input type="checkbox"/> Sys Port												TIME/SAMPLE ID
Comments:												1155

ALISTO

Field Report / Sampling Data Sheet

ENGINEERING

GROUP

1575 TREAT BOULEVARD, SUITE 201

WALNUT CREEK CA 94598 (510) 295-1650 FAX 295-1823

Project No.

10-024-09-003

Date:

1/21/97

Address

3201 35th Street

Day:

MTWTF

Contract No.

G797457

City:

Oakland

Station No.

BP 11132

Sampler:

LS

Well ID	Depth to Water	Diam	Cap/Lock	Product Dept	Iridescence	Gal.	Time	Temp *F	pH	E.C.	D.O.	
Rw-1	14.20	6"	01C	Ø	Y	35	1210	66.1	7.94	1.73ms	5.6	<input type="radio"/> EPA 601 _____
Total Depth - Water Level=						70		67.6	7.57	1.49ms		<input checked="" type="radio"/> TPH-G/BTEX Hcl
38.41 - 14.20 = 24.21 x 1.47 = 35.59 x 3 = 106.77						107	1239	67.6	7.51	1.41ms	6.1	<input type="radio"/> TPH Diesel _____
Purge Method: <input checked="" type="checkbox"/> Surface Pump <input type="checkbox"/> Disp. Tube <input type="checkbox"/> Winch <input type="checkbox"/> Disp. Bailer(s) <input type="checkbox"/> Sys Port												<input type="radio"/> TOG 5520 _____
Comments: QL-1(S-4) From this well												TIME/SAMPLE ID 1245

APPENDIX B
LABORATORY REPORT AND CHAIN OF CUSTODY RECORD



HOUSTON LABORATORY
8880 INTERCHANGE DRIVE
HOUSTON, TEXAS 77054
PHONE (713) 660-0901

January 30, 1997

Mr. Brady Nagle
Alisto Engineering
1575 Treat Boulevard
Walnut Creek, CA 94598

The following report contains analytical results for samples received at Southern Petroleum Laboratories (SPL) on January 22, 1997. The samples were assigned to Certificate of Analysis No. 9701813 and analyzed for all parameters as listed on the chain of custody.

There were no analytical problems encountered with this group of samples and all quality control data was within acceptance limits.

If you have any questions or comments pertaining to this data report, please do not hesitate to contact me. Please reference the above Work Order Number during any inquiries.

Again, SPL is pleased to be of service to you. We anticipate working with you in fulfilling all your current and future analytical needs.

Southern Petroleum Laboratories

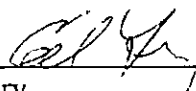

Ed Fry
Project Manager

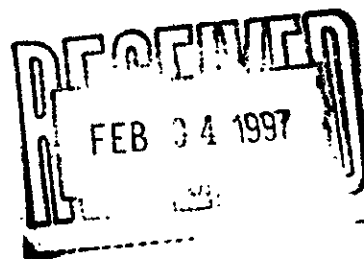



HOUSTON LABORATORY
8880 INTERCHANGE DRIVE
HOUSTON, TEXAS 77054
PHONE (713) 660-0901

SOUTHERN PETROLEUM LABORATORIES, INC.

Certificate of Analysis Number: 97-01-813

Approved for Release by:



Ed Fry, Project Manager

1/30/97

Date:

Greg Grandits
Laboratory Director

Idelis Williams
Quality Assurance Officer

The attached analytical data package may not be reproduced except in full without the express written approval of this laboratory.



Certificate of Analysis No. H9-9701813-01

HOUSTON LABORATORY
8880 INTERCHANGE DRIVE
HOUSTON, TEXAS 77054
PHONE (713) 660-0901

BP Oil Company
295 SW 41st St, Bldg 13, Ste N
Renton, WA 98055
ATTN: Scott Hooton

P.O.#
G797457, COC#083216
DATE: 01/30/97

PROJECT: BP Oil #11132
SITE: Oakland, CA.
SAMPLED BY: Alisto Engineering
SAMPLE ID: S-1

PROJECT NO: 10-024-9-3
MATRIX: WATER
DATE SAMPLED: 01/21/97
DATE RECEIVED: 01/22/97

PARAMETER	ANALYTICAL DATA	RESULTS	DETECTION LIMIT	UNITS
MTBE		ND	10 P	µg/L
Benzene		ND	0.5 P	µg/L
Toluene		ND	1.0 P	µg/L
Ethylbenzene		ND	1.0 P	µg/L
Total Xylene		ND	1.0 P	µg/L
	Surrogate	% Recovery		
	1,4-Difluorobenzene	90		
	4-Bromofluorobenzene	93		
METHOD 8020***				
Analyzed by: fab				
Date: 01/29/97				
Total Petroleum Hydrocarbons-Gasoline		ND	0.05 P	mg/L
	Surrogate	% Recovery		
	1,4-Difluorobenzene	97		
	4-Bromofluorobenzene	103		
CA LUFT - Gasoline				
Analyzed by: fab				
Date: 01/29/97 07:00:00				

ND - Not detected.

(P) - Practical Quantitation Limit

Notes: *Ref: Methods for Chemical Analysis of Water and Wastes, 1983, EPA
**Ref: Standard Methods for Examination of Water & Wastewater, 18th ed.
***Ref: Test Methods for Evaluating Solid Waste, EPA SW846, 3rd Ed.

QUALITY ASSURANCE: These analyses are performed in accordance with EPA guidelines for quality assurance.
SPL California License # 1903



Certificate of Analysis No. H9-9701813-02

HOUSTON LABORATORY
8880 INTERCHANGE DRIVE
HOUSTON, TEXAS 77054
PHONE (713) 660-0901

BP Oil Company
295 SW 41st St, Bldg 13, Ste N
Renton, WA 98055
ATTN: Scott Hooton

P.O.#
G797457, COC#083216
DATE: 01/30/97

PROJECT: BP Oil #11132
SITE: Oakland, CA.
SAMPLED BY: Alisto Engineering
SAMPLE ID: S-2

PROJECT NO: 10-024-9-3
MATRIX: WATER
DATE SAMPLED: 01/21/97
DATE RECEIVED: 01/22/97

ANALYTICAL DATA

PARAMETER	RESULTS	DETECTION LIMIT	UNITS
MTBE	ND	50 P	µg/L
Benzene	300	2.5 P	µg/L
Toluene	ND	5.0 P	µg/L
Ethylbenzene	7.8	5.0 P	µg/L
Total Xylene	26	5.0 P	µg/L

Surrogate	% Recovery
1,4-Difluorobenzene	100
4-Bromofluorobenzene	93

METHOD 8020***
Analyzed by: fab
Date: 01/29/97

Total Petroleum Hydrocarbons-Gasoline 0.73 0.25 P mg/L

Surrogate	% Recovery
1,4-Difluorobenzene	100
4-Bromofluorobenzene	107

CA LUFT - Gasoline
Analyzed by: fab
Date: 01/29/97 11:16:00

ND - Not detected. (P) - Practical Quantitation Limit

Notes: *Ref: Methods for Chemical Analysis of Water and Wastes, 1983, EPA
**Ref: Standard Methods for Examination of Water & Wastewater, 18th ed.
***Ref: Test Methods for Evaluating Solid Waste, EPA SW846, 3rd Ed.

QUALITY ASSURANCE: These analyses are performed in accordance with EPA guidelines for quality assurance.
SPL California License # 1903



Certificate of Analysis No. H9-9701813-03

HOUSTON LABORATORY
8880 INTERCHANGE DRIVE
HOUSTON, TEXAS 77054
PHONE (713) 660-0901

BP Oil Company
295 SW 41st St, Bldg 13, Ste N
Renton, WA 98055
ATTN: Scott Hooton

P.O.#
G797457, COC#083216
DATE: 01/30/97

PROJECT: BP Oil #11132
SITE: Oakland, CA.
SAMPLED BY: Alisto Engineering
SAMPLE ID: S-3

PROJECT NO: 10-024-9-3
MATRIX: WATER
DATE SAMPLED: 01/21/97
DATE RECEIVED: 01/22/97

PARAMETER	ANALYTICAL DATA		DETECTION LIMIT	UNITS
	RESULTS			
MTBE	1500		100 P	µg/L
Benzene	40		0.5 P	µg/L
Toluene	16		1.0 P	µg/L
Ethylbenzene	2.7		1.0 P	µg/L
Total Xylene	34		1.0 P	µg/L
Surrogate	% Recovery			
1,4-Difluorobenzene		93		
4-Bromofluorobenzene		90		
METHOD 8020***				
Analyzed by: fab				
Date: 01/30/97				
Total Petroleum Hydrocarbons-Gasoline	0.26		0.05 P	mg/L
Surrogate	% Recovery			
1,4-Difluorobenzene		97		
4-Bromofluorobenzene		100		
CA LUFT - Gasoline				
Analyzed by: fab				
Date: 01/29/97 09:51:00				

(P) - Practical Quantitation Limit

Notes: *Ref: Methods for Chemical Analysis of Water and Wastes, 1983, EPA
**Ref: Standard Methods for Examination of Water & Wastewater, 18th ed.
***Ref: Test Methods for Evaluating Solid Waste, EPA SW846, 3rd Ed.

QUALITY ASSURANCE: These analyses are performed in accordance with EPA guidelines for quality assurance.
SPL California License # 1903



Certificate of Analysis No. H9-9701813-04

HOUSTON LABORATORY
8880 INTERCHANGE DRIVE
HOUSTON, TEXAS 77054
PHONE (713) 660-0901

BP Oil Company
295 SW 41st St, Bldg 13, Ste N
Renton, WA 98055
ATTN: Scott Hooton

P.O.#
G797457, COC#083216
DATE: 01/30/97

PROJECT: BP Oil #11132
SITE: Oakland, CA.
SAMPLED BY: Alisto Engineering
SAMPLE ID: S-4

PROJECT NO: 10-024-9-3
MATRIX: WATER
DATE SAMPLED: 01/21/97
DATE RECEIVED: 01/22/97

ANALYTICAL DATA

Table with 4 columns: PARAMETER, RESULTS, DETECTION LIMIT, UNITS. Rows include MTBE, Benzene, Toluene, Ethylbenzene, Total Xylene.

Surrogate % Recovery
1,4-Difluorobenzene 97
4-Bromofluorobenzene 93

METHOD 8020***
Analyzed by: fab
Date: 01/29/97

Total Petroleum Hydrocarbons-Gasoline 0.27 0.05 P mg/L

Surrogate % Recovery
1,4-Difluorobenzene 97
4-Bromofluorobenzene 103

CA LUFT - Gasoline
Analyzed by: fab
Date: 01/29/97 10:19:00

(P) - Practical Quantitation Limit

Notes: *Ref: Methods for Chemical Analysis of Water and Wastes, 1983, EPA
**Ref: Standard Methods for Examination of Water & Wastewater, 18th ed.
***Ref: Test Methods for Evaluating Solid Waste, EPA SW846, 3rd Ed.

QUALITY ASSURANCE: These analyses are performed in accordance
with EPA guidelines for quality assurance.
SPL California License # 1903

QUALITY CONTROL

DOCUMENTATION

-



AMOUNT CONC. RECOVERY
ADDED MEASURED

LIMITS

CA LUFT - Gasoline BATCH#:HP_N970129024200
WORK ORDER: 9701813-01A CLIENT SAMPLE ID:S-1

1,4-Difluorobenzene	30	29	97	50- 150
4-Bromofluorobenzene	30	31	103	50- 150

CA LUFT - Gasoline BATCH#:HP_N970129024200
WORK ORDER: 9701813-02A CLIENT SAMPLE ID:S-2

1,4-Difluorobenzene	30	30.0000	100	50- 150
4-Bromofluorobenzene	30	32.0000	107	50- 150

CA LUFT - Gasoline BATCH#:HP_N970129024200
WORK ORDER: 9701813-03A CLIENT SAMPLE ID:S-3

1,4-Difluorobenzene	30	29	97	50- 150
4-Bromofluorobenzene	30	30	100	50- 150

CA LUFT - Gasoline BATCH#:HP_N970129024200
WORK ORDER: 9701813-04A CLIENT SAMPLE ID:S-4

1,4-Difluorobenzene	30	29	97	50- 150
4-Bromofluorobenzene	30	31	103	50- 150

CA LUFT - Gasoline BATCH#:HP_N970129024200
WORK ORDER: Method Blank CLIENT SAMPLE ID:

1,4-Difluorobenzene	30	29	97	50- 150
4-Bromofluorobenzene	30	31	103	50- 150

CA LUFT - Gasoline BATCH#:HP_N970129024200
WORK ORDER: Matrix Spike CLIENT SAMPLE ID:9701813-01A

1,4-Difluorobenzene	30	30	100	50- 150
4-Bromofluorobenzene	30	32	107	50- 150

CA LUFT - Gasoline BATCH#:HP_N970129024200
WORK ORDER: Matrix Spike Dup. CLIENT SAMPLE ID:9701813-01A

1,4-Difluorobenzene	30	30	100	50- 150
4-Bromofluorobenzene	30	30	100	50- 150

METHOD 8020*** BATCH#:HP_N970129123200
WORK ORDER: 9701813-01A CLIENT SAMPLE ID:S-1

1,4-Difluorobenzene	30	27	90	70- 131
---------------------	----	----	----	---------



AMOUNT CONC. RECOVERY
ADDED MEASURED

LIMITS

4-Bromofluorobenzene	30	28	93	43- 135
----------------------	----	----	----	---------

METHOD 8020***

BATCH#:HP_N970129123200

WORK ORDER: 9701813-02A

CLIENT SAMPLE ID:S-2

1,4-Difluorobenzene	30	30.0000	100	70- 131
4-Bromofluorobenzene	30	28.0000	93	43- 135

METHOD 8020***

BATCH#:HP_N970129123200

WORK ORDER: 9701813-03A

CLIENT SAMPLE ID:S-3

1,4-Difluorobenzene	30	29	97	70- 131
4-Bromofluorobenzene	30	28	93	43- 135

METHOD 8020***

BATCH#:HP_N970129123200

WORK ORDER: 9701813-03A

CLIENT SAMPLE ID:S-3

1,4-Difluorobenzene	30	28.0000	93	70- 131
4-Bromofluorobenzene	30	27.0000	90	43- 135

METHOD 8020***

BATCH#:HP_N970129123200

WORK ORDER: 9701813-04A

CLIENT SAMPLE ID:S-4

1,4-Difluorobenzene	30	28.0000	93	70- 131
4-Bromofluorobenzene	30	28.0000	93	43- 135

METHOD 8020***

BATCH#:HP_N970129123200

WORK ORDER: 9701813-04A

CLIENT SAMPLE ID:S-4

1,4-Difluorobenzene	30	29	97	70- 131
4-Bromofluorobenzene	30	28	93	43- 135

METHOD 8020A ***

BATCH#:HP_N970129123200

WORK ORDER: Method Blank

CLIENT SAMPLE ID:

1,4-Difluorobenzene	30	27	27.3	74- 131
4-Bromofluorobenzene	30	27	27.5	43- 135

METHOD 8020***

BATCH#:HP_N970129123200

WORK ORDER: LCS

CLIENT SAMPLE ID:

1,4-Difluorobenzene	30	29	96.7	70- 131
4-Bromofluorobenzene	30	28	93.3	43- 135



SURROGATE RECOVERY SUMMARY

01/30/97 15:23:01

HOUSTON LABORATORY

8880 INTERCHANGE DRIVE

HOUSTON, TEXAS 77054

PHONE (713) 660-0901

AMOUNT CONC. RECOVERY
ADDED MEASURED

LIMITS

METHOD 8020A ***

BATCH#:HP_N970129123200

WORK ORDER: Matrix Spike

CLIENT SAMPLE ID:9701995-01A

1,4-DIFLUOROBENZENE	30	27	90	70-	131
4-BROMOFLUOROBENZENE	30	28	93	43-	135

METHOD 8020A ***

BATCH#:HP_N970129123200

WORK ORDER: Matrix Spike Dup.

CLIENT SAMPLE ID:9701995-01A

1,4-Difluorobenzene	30	28	93	70-	131
4-Bromofluorobenzene	30	27	90	43-	135

<< = Recovery outside of control limits

* = Methods for Chemical Analysis of Water & Wastes,1983,EPA

** = Standard Methods for Examination of Water & Wastewater,17th

*** = Test Methods for Evaluating Solid Waste,EPA SW846,3rd



** SPL BATCH QUALITY CONTROL REPORT **
METHOD 8020***

HOUSTON LABORATORY
8880 INTERCHANGE DRIVE
HOUSTON, TEXAS 77054
PHONE (713) 660-0901

Matrix: Aqueous
Units: µg/L

Batch Id: HP_N970129123200

LABORATORY CONTROL SAMPLE

S P I K E C O M P O U N D S	Method Blank Result <2>	Spike Added <3>	Blank Spike		QC Limits(**) (Mandatory) % Recovery Range
			Result <1>	Recovery %	
MTBE	ND	50	50	100	20 - 110
Benzene	ND	50	47	94.0	62 - 121
Toluene	ND	50	49	98.0	66 - 136
EthylBenzene	ND	50	53	106	70 - 136
O Xylene	ND	50	54.0	108	74 - 134
M & P Xylene	ND	100	98	98.0	77 - 140

MATRIX SPIKES

S P I K E C O M P O U N D S	Sample Results <2>	Spike Added <3>	Matrix Spike		Matrix Spike Duplicate		MS/MSD Relative % Difference	QC Limits(***) (Advisory)	
			Result <1>	Recovery <4>	Result <1>	Recovery <5>		RPD Max.	Recovery Range
MTBE	13	20.0	33	100	33	100	0	20	39 - 150
BENZENE	1.3	20.0	20	93.5	21	98.5	5.21	25	39 - 150
TOLUENE	ND	20.0	21	105	20	100	4.88	26	56 - 134
ETHYLBENZENE	ND	20.0	22	110	21	105	4.65	38	61 - 128
O XYLENE	ND	20.0	22	110	22	110	0	29	40 - 130
M & P XYLENE	ND	40.0	41	102	40	100	1.98	20	43 - 152

Analyst: fab

Sequence Date: 01/29/97

SPL ID of sample spiked: 9701995-01A

Sample File ID: N_A7973.TX0

Method Blank File ID:

Blank Spike File ID: N_A7964.TX0

Matrix Spike File ID: N_A7967.TX0

Matrix Spike Duplicate File ID: N_A7968.TX0

* = Values Outside QC Range. * = Data outside Method Specification Limits.

NC = Not Calculated (Sample exceeds spike by factor of 4 or more)

ND = Not Detected/Below Detection Limit

% Recovery = $\left(\frac{\text{<1> - <2>}}{\text{<3>}} \right) \times 100$

LCS % Recovery = $\left(\frac{\text{<1>}}{\text{<3>}} \right) \times 100$

Relative Percent Difference = $\frac{|\text{<4> - <5>|}{[(\text{<4> + <5>}) \times 0.5]} \times 100$

(**) = Source: SPL-Houston Historical Data (4th Q '95)

(***) = Source: SPL-Houston Historical Data (2nd Q '95)

SAMPLES IN BATCH(SPL ID):

9701813-04A 9701776-07A 9701995-01A 9701813-01A
 9701776-02A 9701776-01A 9701813-03A 9701813-04A
 9701813-02A 9701A00-02A 9701A00-03A 9701813-03A



* SPL BATCH QUALITY CONTROL REPORT **
CA LUFT

HOUSTON LABORATORY
8880 INTERCHANGE DRIVE
HOUSTON, TEXAS 77054
PHONE (713) 660-0901

Matrix: Aqueous
Units: mg/L

Batch Id: HP_N970129024200

LABORATORY CONTROL SAMPLE

SPIKE COMPOUNDS	Method Blank Result <2>	Spike Added <3>	Blank Spike		QC Limits(**) (Mandatory) % Recovery Range
			Result <1>	Recovery %	
Petroleum Hydrocarbons-Gas	ND	1.0	1.2	120	50 - 150

MATRIX SPIKES

SPIKE COMPOUNDS	Sample Results <2>	Spike Added <3>	Matrix Spike		Matrix Spike Duplicate		MS/MSD Relative % Difference	QC Limits(***) (Advisory)	
			Result <1>	Recovery <4>	Result <1>	Recovery <5>		RPD Max.	Recovery Range
PETROLEUM HYDROCARBONS-GAS	ND	0.9	0.97	108	0.98	109	0.922	50	50 - 150

Analyst: fab

Sequence Date: 01/29/97

SPL ID of sample spiked: 9701813-01A

Sample File ID: NNA7974.TX0

Method Blank File ID:

Blank Spike File ID: NNA7965.TX0

Matrix Spike File ID: NNA7969.TX0

Matrix Spike Duplicate File ID: NNA7970.TX0

* = Values Outside QC Range. < = Data outside Method Specification limits.

NC = Not Calculated (Sample exceeds spike by factor of 4 or more)

ND = Not Detected/Below Detection Limit

% Recovery = [(<1> - <2>) / <3>] x 100

LCS % Recovery = (<1> / <3>) x 100

Relative Percent Difference = [(<4> - <5>) / [(<4> + <5>) x 0.5]] x 100

(**) = Source: Temporary Limits

(***) = Source: Temporary Limits

SAMPLES IN BATCH(SPL ID):

9701776-07A 9701995-01A 9701813-01A 9701776-02A
 9701776-01A 9701813-03A 9701813-04A 9701A00-01A
 9701813-02A 9701A00-02A 9701A00-03A 9701861-07A
 9701861-06A

CHAIN OF CUSTODY
AND
SAMPLE RECEIPT CHECKLIST

SPL Houston Environmental Laboratory

Sample Login Checklist

Date: 1-22-97	Time: 1000
--	---

SPL Sample ID:
97-01-813

		Yes	No								
1	Chain-of-Custody (COC) form is present.	✓									
2	COC is properly completed.	✓									
3	If no, Non-Conformance Worksheet has been completed.										
4	Custody seals are present on the shipping container.	✓									
5	If yes, custody seals are intact.	✓									
6	All samples are tagged or labeled.	✓									
7	If no, Non-Conformance Worksheet has been completed.										
8	Sample containers arrived intact	✓									
9	Temperature of samples upon arrival:		30° C								
10	Method of sample delivery to SPL:	<table border="1" style="width: 100%; border-collapse: collapse;"> <tr> <td style="width: 50%; padding: 2px;">SPL Delivery</td> <td style="width: 50%;"></td> </tr> <tr> <td style="padding: 2px;">Client Delivery</td> <td></td> </tr> <tr> <td style="padding: 2px;">FedEx Delivery (airbill #)</td> <td style="text-align: center;">3848469866</td> </tr> <tr> <td style="padding: 2px;">Other:</td> <td></td> </tr> </table>		SPL Delivery		Client Delivery		FedEx Delivery (airbill #)	3848469866	Other:	
SPL Delivery											
Client Delivery											
FedEx Delivery (airbill #)	3848469866										
Other:											
11	Method of sample disposal:	<table border="1" style="width: 100%; border-collapse: collapse;"> <tr> <td style="width: 50%; padding: 2px;">SPL Disposal</td> <td style="width: 50%; text-align: center;">✓</td> </tr> <tr> <td style="padding: 2px;">HOLD</td> <td></td> </tr> <tr> <td style="padding: 2px;">Return to Client</td> <td></td> </tr> </table>		SPL Disposal	✓	HOLD		Return to Client			
SPL Disposal	✓										
HOLD											
Return to Client											

Name:	Date: 1-22-97
-------	--

**BP EXPLORATION & OIL, INC.
ENVIRONMENTAL REMEDIATION MANAGEMENT
DATA REVIEW CHECKLIST**

BP Site Number: 11172
 ERM Contact: Scott Hooton
 Sampling Date: 1/21/97
 Matrix Description: WATER
 Date Final Report Received: 2/4/97
 Laboratory & Location: SPL - TX

	Yes	No	NA
1. Is BP contract release number consistent with analytical report?	<input checked="" type="checkbox"/>	<input type="checkbox"/>	<input type="checkbox"/>
2. Was report submitted within the specified timeframe?	<input checked="" type="checkbox"/>	<input type="checkbox"/>	<input type="checkbox"/>
3. Does report agree with the COC?	<input checked="" type="checkbox"/>	<input type="checkbox"/>	<input type="checkbox"/>
4. Are units consistent with the given matrix?	<input checked="" type="checkbox"/>	<input type="checkbox"/>	<input type="checkbox"/>
5. Were any target analytes/compounds detected in blanks (i.e., trip or equipment)?	<input type="checkbox"/>	<input type="checkbox"/>	<input checked="" type="checkbox"/>
6. Are duplicate water samples within <u>30%</u> ?	<input checked="" type="checkbox"/>	<input type="checkbox"/>	<input type="checkbox"/>
7. Are holding times met?	<input checked="" type="checkbox"/>	<input type="checkbox"/>	<input type="checkbox"/>
8. Are surrogates within limits using laboratory criteria?	<input checked="" type="checkbox"/>	<input type="checkbox"/>	<input type="checkbox"/>
9. Are MS/MSD acceptable using laboratory criteria?	<input checked="" type="checkbox"/>	<input type="checkbox"/>	<input type="checkbox"/>
10. Are LCS results acceptable using laboratory criteria?	<input checked="" type="checkbox"/>	<input type="checkbox"/>	<input type="checkbox"/>

Notes: _____

Data Validation Completed by (print): Ken Simola
 (signature): 
 Date: 2/26/97

TABLE 1 - SUMMARY OF RESULTS OF GROUNDWATER SAMPLING
 BP OIL COMPANY SERVICE STATION NO. 11132
 3201 35TH STREET, OAKLAND, CALIFORNIA

ALISTO PROJECT NO. 10-024

WELL ID	DATE OF SAMPLING/ MONITORING	CASING ELEVATION (a) (Feet)	DEPTH TO WATER (Feet)	PRODUCT THICKNESS (Feet)	GROUNDWATER ELEVATION (b) (Feet)	TPH-G (ug/l)	B (ug/l)	T (ug/l)	E (ug/l)	X (ug/l)	MTBE (ug/l)	DO (ppm)	LAB
MW-1	07/09/90	169.75	---	0.22	---	---	---	---	---	---	---	---	---
MW-1	12/21/90	169.75	---	0.58	---	---	---	---	---	---	---	---	---
MW-1	03/07/91	169.75	20.59	---	---	---	---	---	---	---	---	---	---
MW-1	06/27/91	169.75	---	0.18	---	---	---	---	---	---	---	---	---
MW-1	09/27/91	169.75	---	0.27	---	---	---	---	---	---	---	---	---
MW-1	12/18/91	169.75	---	0.28	---	---	---	---	---	---	---	---	---
MW-1	04/01/91	169.75	16.51	0.15	153.35	---	---	---	---	---	---	---	---
MW-1	07/03/92	169.75	22.30	0.27	147.65	---	---	---	---	---	---	---	---
MW-1	10/05/92	169.75	23.98	0.24	145.95	---	---	---	---	---	---	---	---
MW-1	01/13/93	169.75	17.03	0.24	152.90	---	---	---	---	---	---	---	---
MW-1	04/23/93	169.75	18.10	0.42	151.97	---	---	---	---	---	---	---	---
MW-1	07/12/93	169.75	22.02	0.49	148.10	---	---	---	---	---	---	---	---
MW-1	10/21/93	169.75	25.12	1.09	145.45	---	---	---	---	---	---	---	---
MW-1	01/21/94	169.75	23.02	0.76	147.30	---	---	---	---	---	---	---	---
MW-1	04/20/94	169.75	24.54	1.80	146.56	---	---	---	---	---	---	---	---
MW-1	08/01/94	169.75	24.11	0.35	145.90	---	---	---	---	---	---	---	---
MW-1	12/23/94	169.75	18.19	0.29	151.78	---	---	---	---	---	---	---	---
MW-1	01/26/95	169.75	16.25	1.10	154.33	---	---	---	---	---	---	---	---
MW-1	06/08/95	169.75	22.92	1.20	147.73	---	---	---	---	---	---	---	---
MW-1	08/22/95	169.75	24.45	0.85	145.94	---	---	---	---	---	---	---	---
MW-1	10/27/95	169.75	25.41	0.69	144.86	---	---	---	---	---	---	---	---
MW-1	01/25/96	169.75	18.20	1.40	152.60	---	---	---	---	---	---	---	---
MW-1	04/19/96	169.75	19.06	1.22	151.61	---	---	---	---	---	---	---	---
MW-1	07/23/96	169.75	22.98	0.89	147.44	---	---	---	---	---	---	---	---
MW-1	11/11/96	169.75	23.99	0.98	146.50	---	---	---	---	---	---	---	---
MW-1	01/21/97	169.75	16.80	0.90	153.63	---	---	---	---	---	---	---	---
MW-1	04/29/97	169.75	21.90	0.85	148.49	---	---	---	---	---	---	---	---
MW-1	04/30/97	169.75	---	---	---	100000	3800	8000	4000	21300	7700	5.2	SPL
QC-1 (c)	04/30/97	169.75	---	---	---	92000	3500	8100	4400	23800	6900	---	SPL
MW-2	07/09/90	168.14	---	0.10	---	---	---	---	---	---	---	---	---
MW-2	12/21/90	168.14	---	0.48	---	---	---	---	---	---	---	---	---
MW-2	03/07/91	168.14	19.18	---	---	---	---	---	---	---	---	---	---
MW-2	06/27/91	168.14	---	0.19	---	---	---	---	---	---	---	---	---
MW-2	09/27/91	168.14	---	0.15	---	---	---	---	---	---	---	---	---
MW-2	12/18/91	168.14	---	0.36	---	---	---	---	---	---	---	---	---
MW-2	04/01/91	168.14	15.21	0.10	153.01	---	---	---	---	---	---	---	---
MW-2	07/03/92	168.14	20.93	0.03	147.23	---	---	---	---	---	---	---	---
MW-2	10/05/92	168.14	22.74	0.21	145.56	---	---	---	---	---	---	---	---
MW-2	01/13/93	168.14	15.55	0.02	152.61	---	---	---	---	---	---	---	---
MW-2	04/23/93	168.14	16.54	0.21	151.76	---	---	---	---	---	---	---	---
MW-2	07/12/93	168.14	20.46	0.06	147.73	---	---	---	---	---	---	---	---
MW-2	10/21/93	168.14	24.91	0.31	143.46	---	---	---	---	---	---	---	---
MW-2	01/21/94	168.14	21.20	---	146.94	---	---	---	---	---	---	---	---
MW-2	04/20/94	168.14	22.44	---	145.70	1800	140	370	54	290	1.7	1.7	PACE
MW-2	08/01/94	168.14	22.24	0.04	145.93	---	---	---	---	---	---	---	---
MW-2	12/23/94	168.14	16.25	0.03	151.91	---	---	---	---	---	---	---	---
MW-2	01/26/95	168.14	14.55	0.39	153.88	---	---	---	---	---	---	---	---
MW-2	06/08/95	168.14	21.18	0.43	147.28	---	---	---	---	---	---	---	---
MW-2	08/22/95	168.14	22.76	0.36	145.65	---	---	---	---	---	---	---	---
MW-2	10/27/95	168.14	23.61	0.30	144.76	---	---	---	---	---	---	---	---
MW-2	01/25/96	168.14	15.95	0.15	152.30	---	---	---	---	---	---	---	---
MW-2	04/19/96	168.14	17.33	0.07	150.86	---	---	---	---	---	---	---	---
MW-2	07/23/96	168.14	21.25	0.05	146.93	---	---	---	---	---	---	---	---
MW-2	11/11/96	168.14	22.27	0.01	145.88	---	---	---	---	---	---	---	---
MW-2	01/21/97	168.14	15.19	0.01	152.96	---	---	---	---	---	---	---	---
MW-2	04/29/97	168.14	20.22	0.01	147.93	---	---	---	---	---	---	---	---
MW-2	04/30/97	168.14	---	---	---	130000	4600	15000	6000	37000	ND<5000	5.0	SPL

TABLE 1 - SUMMARY OF RESULTS OF GROUNDWATER SAMPLING
 BP OIL COMPANY SERVICE STATION NO 11132
 3201 35TH STREET, OAKLAND, CALIFORNIA

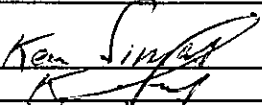
ALISTO PROJECT NO 10-024

WELL ID	DATE OF SAMPLING/ MONITORING	CASING ELEVATION (a) (Feet)	DEPTH TO WATER (Feet)	PRODUCT THICKNESS (Feet)	GROUNDWATER ELEVATION (b) (Feet)	TPH-G (ug/l)	B (ug/l)	T (ug/l)	E (ug/l)	X (ug/l)	MTBE (ug/l)	DO (ppm)	LAB	
MW-3	07/09/90	167.17	---	---	---	140	5.3	4.6	2.0	3.8	---	---	---	
MW-3	12/21/90	167.17	---	---	---	0.19	100	6.0	0.9	27	---	---	---	
MW-3	03/07/91	167.17	17.40	---	149.77	0.4	69	22	6.1	57	---	---	---	
MW-3	06/27/91	167.17	---	---	---	380	28	26	19	46	---	---	---	
MW-3	09/27/91	167.17	---	---	---	0.07	7.9	ND	0.4	1.1	---	---	---	
MW-3	12/18/91	167.17	---	---	---	0.26	34	24	0.8	28	---	---	---	
MW-3	04/01/91	167.17	13.69	---	153.48	ND	ND	ND	ND	ND	---	---	---	
MW-3	07/03/92	167.17	19.59	---	147.58	71	9.4	0.9	5.0	13	---	---	ANA	
MW-3	10/05/92	167.17	21.22	---	145.95	67	5.1	1.1	6.1	6.1	---	---	ANA	
QC-1 (c)	10/05/92	---	---	---	---	ND<50	2.2	ND<0.5	1.5	2.8	---	---	ANA	
MW-3	01/13/93	167.17	13.63	---	153.54	830	50	34	42	89	---	---	PACE	
MW-3	04/23/93	167.17	15.02	---	152.15	ND<50	ND<0.5	ND<0.5	ND<0.5	ND<0.5	---	---	PACE	
QC-1 (c)	04/23/93	---	---	---	---	ND<50	ND<0.5	ND<0.5	ND<0.5	ND<0.5	---	---	PACE	
MW-3	07/12/93	167.17	19.16	---	148.01	250	12	4.2	12	16	---	---	---	
MW-3	10/21/93	167.17	21.81	---	145.36	52	4.4	1.4	4.7	3.3	---	---	PACE	
QC-1 (c)	10/21/93	---	---	---	---	65	7.4	1.0	6.9	4.2	---	---	PACE	
MW-3	01/21/94	167.17	19.94	---	147.23	57	3.0	3.4	3.6	9.0	---	---	PACE	
MW-3	04/20/94	167.17	20.24	---	146.93	600	26	23	33	88	---	---	PACE	
MW-3	08/01/94	167.17	20.74	---	146.43	99	6.2	1.1	4.5	5.2	---	---	1.4 PACE	
QC-1 (c)	08/01/94	---	---	---	---	120	7.7	1.8	5.9	6.7	---	---	PACE	
MW-3	12/23/94	167.17	14.70	---	162.47	ND<50	ND<0.5	0.78	ND<0.5	ND<0.5	---	1.7	PACE	
QC-1 (c)	12/23/94	---	---	---	---	ND<50	ND<0.5	ND<0.5	ND<0.5	ND<0.5	---	---	PACE	
MW-3	01/26/95	167.17	12.89	---	154.28	190	16	0.5	35	24	---	6.6	ATI	
MW-3	06/08/95	167.17	19.95	---	147.22	330	21	4.0	34	32	---	7.0	ATI	
MW-3	06/22/95	167.17	21.41	---	145.76	150	14	ND<0.50	ND<0.50	1.6	---	6.6	ATI	
MW-3	10/27/95	167.17	22.43	---	144.74	---	---	---	---	---	---	---	---	
MW-3	10/30/95	---	---	---	---	51	2.4	ND<0.50	ND<0.50	ND<1.0	ND<5.0	6.9	ATI	
MW-3	01/25/96	167.17	14.09	---	153.14	ND<50	ND<0.50	ND<0.50	ND<0.50	ND<1.0	5.1	---	CEI	
MW-3	04/19/96	167.17	15.26	---	151.91	460	55	4	33	63	ND<10	9.4	SPL	
MW-3	07/23/96	167.17	18.19	---	147.98	ND<50	ND<0.5	ND<0.5	ND<0.5	ND<0.5	ND<10	9.2	SPL	
MW-3	11/11/96	167.17	20.24	---	146.93	ND<250	ND<2.5	ND<5.0	ND<5.0	ND<5.0	ND<5.0	ND<50	8.4	SPL
MW-3	01/21/97	167.17	13.09	---	154.08	ND<60	ND<0.5	ND<1.0	ND<1.0	ND<1.0	ND<10	5.4	SPL	
MW-3	04/29/97	167.17	18.14	---	149.03	ND<50	ND<0.5	ND<1.0	ND<1.0	ND<1.0	ND<10	4.3	SPL	
MW-4	07/09/90	170.36	---	---	---	ND	ND	ND	ND	ND	---	---	---	
MW-4	12/21/90	170.36	---	---	---	ND	ND	ND	ND	0.8	---	---	---	
MW-4	03/07/91	170.36	20.72	---	149.64	ND	2.2	3.8	1.5	2.8	---	---	---	
MW-4	06/27/91	170.36	---	---	---	ND	6.3	1.8	0.4	1.0	---	---	---	
MW-4	09/27/91	170.36	---	---	---	ND	ND	ND	ND	ND	---	---	---	
MW-4	12/18/91	170.36	---	---	---	ND	ND	ND	ND	ND	---	---	---	
MW-4	04/01/91	170.36	17.49	---	152.87	ND	ND	ND	ND	ND	---	---	---	
MW-4	07/03/92	170.36	22.16	---	148.20	ND<50	ND<0.5	ND<0.5	ND<0.5	ND<0.5	---	---	ANA	
MW-4	10/05/92	170.36	23.38	---	146.96	ND<50	ND<0.5	ND<0.5	ND<0.5	ND<0.5	---	---	ANA	
MW-4	01/13/93	170.36	17.58	---	152.78	ND<50	ND<0.5	ND<0.5	ND<0.5	ND<0.5	---	---	PACE	
MW-4	04/23/93	170.36	15.72	---	154.64	ND<50	ND<0.5	ND<0.5	ND<0.5	ND<0.5	---	---	PACE	
MW-4	07/12/93	170.36	21.74	---	148.62	ND<50	ND<0.5	ND<0.5	ND<0.5	ND<0.5	---	---	PACE	
MW-4	10/21/93	170.36	23.84	---	146.52	ND<50	ND<0.5	ND<0.5	ND<0.5	ND<0.5	---	---	PACE	
MW-4	01/21/94	170.36	22.42	---	147.94	ND<50	ND<0.5	ND<0.5	ND<0.5	ND<0.5	---	---	PACE	
MW-4	04/20/94	170.36	22.66	---	147.70	ND<50	ND<0.5	ND<0.5	ND<0.5	ND<0.5	---	2.2	PACE	
MW-4	08/01/94	170.36	23.01	---	147.35	ND<50	ND<0.5	ND<0.5	ND<0.5	ND<0.5	---	1.9	PACE	
MW-4	12/23/94	170.36	17.03	---	153.33	---	---	---	---	---	---	---	---	
MW-4	01/26/95	170.36	17.42	---	152.94	ND<50	ND<0.5	ND<0.5	ND<0.5	ND<1	---	7.5	ATI	
MW-4	06/08/95	170.36	21.55	---	148.81	---	---	---	---	---	---	---	---	
MW-4	08/22/95	170.36	23.47	---	146.89	ND<50	ND<0.50	ND<0.50	ND<0.50	ND<1.0	---	6.4	ATI	
MW-4	10/27/95	170.36	24.50	---	145.66	---	---	---	---	---	---	---	---	
MW-4	01/25/96	170.36	18.74	---	151.62	ND<50	ND<0.50	ND<0.50	ND<0.50	ND<1.0	58	---	CEI	
MW-4	04/19/96	170.36	18.63	---	151.73	---	---	---	---	---	---	---	---	
MW-4	07/23/96	170.36	22.56	---	147.80	---	---	---	---	---	---	---	---	
MW-4	11/11/96	170.36	23.63	---	146.73	ND<50	ND<1.0	ND<1.0	ND<1.0	ND<1.0	34	8.2	SPL	
MW-4	01/21/97	170.36	16.59	---	153.77	---	---	---	---	---	---	---	---	
MW-4	04/29/97	170.36	21.43	---	148.95	ND<50	ND<0.5	ND<1.0	ND<1.0	ND<1.0	ND<10	4.7	SPL	

TABLE 1 - SUMMARY OF RESULTS OF GROUNDWATER SAMPLING
 BP OIL COMPANY SERVICE STATION NO. 11132
 3201 35TH STREET, OAKLAND, CALIFORNIA

ALISTO PROJECT NO. 10-024

WELL ID	DATE OF SAMPLING/ MONITORING	CASING ELEVATION (a) (Feet)	DEPTH TO WATER (Feet)	PRODUCT THICKNESS (Feet)	GROUNDWATER ELEVATION (b) (Feet)	TPH-G (ug/l)	B (ug/l)	T (ug/l)	E (ug/l)	X (ug/l)	MTBE (ug/l)	DO (ppm)	LAB
MW-5	07/09/90	165.14	---	---	---	280	200	210	46	290	---	---	---
MW-5	12/21/90	165.14	---	---	---	0.69	300	34	8.4	39	---	---	---
MW-5	03/07/91	165.14	16.60	---	148.54	ND	17	0.9	0.7	1.6	---	---	---
MW-5	06/27/91	165.14	---	---	---	230	120	10	12	8	---	---	---
MW-5	09/27/91	165.14	---	---	---	0.73	230	16	20	22	---	---	---
MW-5	12/18/91	165.14	---	---	---	ND	ND	ND	ND	ND	---	---	---
MW-5	04/01/91	165.14	11.99	---	153.15	800	250	54	11	60	---	---	---
MW-5	07/03/92	165.14	18.65	---	146.49	150	36	ND<0.5	ND<0.5	1.1	---	---	ANA
MW-5	10/05/92	165.14	20.32	---	144.82	270	79	4	1.7	2.9	---	---	ANA
MW-5	01/13/93	165.14	13.03	---	152.11	180	59	6.0	1.8	7.6	---	---	PACE
MW-5	04/23/93	165.14	13.51	---	151.63	8700	440	96	35	136	---	---	PACE
MW-5	07/12/93	165.14	18.08	---	147.08	250	57	2.9	2.1	6.0	---	---	PACE
MW-5	10/21/93	165.14	20.41	---	144.73	210	82	1.5	ND<0.5	1.4	---	---	PACE
MW-5	01/21/94	165.14	18.86	---	146.28	110	36	1.2	ND<0.5	0.7	---	---	PACE
MW-5	04/20/94	165.14	17.30	---	147.84	690	230	4.5	1.6	11	---	---	1.3 PACE
MW-5	08/01/94	165.14	17.53	---	147.61	170	44	1.6	0.9	2.7	---	---	0.9 PACE
MW-5	12/23/94	165.14	11.63	---	153.51	630	180	1.9	0.66	1.9	---	---	1.4 PACE
MW-5	01/26/95	165.14	11.25	---	153.89	160	89	ND<0.5	ND<0.5	22	---	---	5.9 ATI
MW-5	06/08/95	165.14	16.80	---	148.34	2000	630	58	61	180	---	---	6.5 ATI
QC-1 (c)	06/08/95	---	---	---	---	1700	560	51	55	170	---	---	ATI
MW-5	08/22/95	165.14	19.02	---	146.12	3700	1100	18	27	59	---	---	7.3 ATI
MW-5	10/27/95	165.14	20.94	---	144.20	---	---	---	---	---	---	---	---
MW-5	10/30/95	---	---	---	---	6500	2200	55	180	270	ND<250	7.5	ATI
MW-5	01/25/96	165.14	13.30	---	151.84	590	37	0.70	ND<0.50	ND<1.0	ND<5.0	---	CEI
QC-1 (c)	01/25/96	---	---	---	---	540	37	0.66	ND<0.50	ND<1.0	ND<5.0	---	CEI
MW-5	04/19/96	165.14	13.63	---	151.51	1500	470	38	49	210	ND<50	8.1	SPL
MW-5	07/23/96	165.14	17.61	---	147.53	140	4.6	ND<0.5	ND<0.5	ND<0.5	ND<10	8.0	SPL
MW-5	11/11/96	165.14	18.70	---	146.44	140	40	ND<1.0	ND<1.0	ND<1.0	ND<10	7.9	SPL
MW-5	01/21/97	165.14	11.63	---	153.51	730	300	ND<5.0	7.8	28	ND<50	5.0	SPL
MW-5	04/29/97	165.14	16.74	---	148.40	340	530	ND<5.0	ND<5.0	ND<5.0	ND<50	4.8	SPL
MW-6	07/09/90	165.40	---	---	---	ND	ND	ND	ND	ND	---	---	---
MW-6	12/21/90	165.40	---	---	---	0.17	2.6	7.0	4.9	26	---	---	---
MW-6 (d)	03/07/91	165.40	---	---	---	---	---	---	---	---	---	---	---
MW-6 (d)	06/27/91	165.40	---	---	---	---	---	---	---	---	---	---	---
MW-6 (d)	09/27/91	165.40	---	---	---	---	---	---	---	---	---	---	---
MW-6	12/18/91	165.40	---	---	---	ND	1.3	22	ND	2.7	---	---	---
MW-6	04/01/91	165.40	11.79	---	153.61	ND	ND	ND	ND	ND	---	---	---
MW-6	07/03/92	165.40	17.77	---	147.63	ND<50	ND<0.5	ND<0.5	ND<0.5	ND<0.5	---	---	ANA
MW-6	10/05/92	165.40	19.46	---	145.94	ND<50	ND<0.5	ND<0.5	ND<0.5	ND<0.5	---	---	ANA
MW-6	01/13/93	165.40	11.34	---	154.06	ND<50	ND<0.5	ND<0.5	ND<0.5	ND<0.5	---	---	PACE
MW-6	04/23/93	165.40	12.92	---	152.48	ND<50	ND<0.5	ND<0.5	ND<0.5	ND<0.5	---	---	PACE
MW-6	07/12/93	165.40	17.36	---	148.04	ND<50	ND<0.5	ND<0.5	ND<0.5	0.7	---	---	PACE
MW-6	10/21/93	165.40	19.98	---	145.42	ND<50	ND<0.5	ND<0.5	ND<0.5	ND<0.5	---	---	PACE
MW-6	01/21/94	165.40	18.10	---	147.30	ND<50	ND<0.5	ND<0.5	ND<0.5	ND<0.5	---	---	PACE
MW-6	04/20/94	165.40	18.68	---	146.72	ND<50	ND<0.5	ND<0.5	ND<0.5	ND<0.5	---	---	2.0 PACE
MW-6	08/01/94	165.40	18.90	---	146.50	ND<50	ND<0.5	ND<0.5	ND<0.5	ND<0.5	---	---	1.5 PACE
MW-6	12/23/94	165.40	12.94	---	152.46	---	---	---	---	---	---	---	---
MW-6	01/26/95	165.40	10.46	---	154.94	ND<50	ND<0.5	ND<0.5	ND<0.5	ND<1	---	---	7.3 ATI
MW-6	06/08/95	165.40	16.84	---	148.56	---	---	---	---	---	---	---	---
MW-6	08/22/95	165.40	19.48	---	145.92	ND<50	ND<0.50	ND<0.50	ND<0.50	ND<1.0	---	---	6.7 ATI
MW-6	10/27/95	165.40	20.39	---	145.01	---	---	---	---	---	---	---	---
MW-6	01/25/96	165.40	12.24	---	153.16	ND<50	ND<0.50	ND<0.50	ND<0.50	ND<1.0	9.9	---	CEI
MW-6	04/19/96	165.40	13.90	---	151.50	---	---	---	---	---	---	---	---
MW-6	07/23/96	165.40	17.83	---	147.57	---	---	---	---	---	---	---	---
MW-6	11/11/96	165.40	18.90	---	146.50	ND<50	ND<0.5	ND<1.0	ND<1.0	ND<1.0	ND<10	7.7	SPL
MW-6	01/21/97	165.40	11.97	---	153.43	---	---	---	---	---	---	---	---
MW-6	04/29/97	165.40	17.04	---	148.36	ND<50	ND<0.5	ND<1.0	ND<1.0	ND<1.0	ND<10	4.5	SPL

TABLE 1 - SUMMARY OF RESULTS OF GROUNDWATER SAMPLING
 BP OIL COMPANY SERVICE STATION NO 11132
 3201 35TH STREET, OAKLAND, CALIFORNIA

ALISTO PROJECT NO. 10-024

WELL ID	DATE OF SAMPLING/ MONITORING	CASING ELEVATION (a) (Feet)	DEPTH TO WATER (Feet)	PRODUCT THICKNESS (Feet)	GROUNDWATER ELEVATION (b) (Feet)	TPH-G (ug/l)	B (ug/l)	T (ug/l)	E (ug/l)	X (ug/l)	MTBE (ug/l)	DO (ppm)	LAB
MW-7	07/09/90	167.61	---	---	---	ND	ND	ND	ND	ND	---	---	---
MW-7	12/21/90	167.61	---	---	---	ND	ND	ND	ND	ND	---	---	---
MW-7	03/07/91	167.61	19.04	---	148.57	ND	ND	0.4	0.3	2.4	---	---	---
MW-7	06/27/91	167.61	---	---	---	70	17	4	0.8	2.2	---	---	---
MW-7	09/27/91	167.61	---	---	---	ND	0.4	ND	ND	0.4	---	---	---
MW-7	12/18/91	167.61	---	---	---	ND	0.7	2.9	0.8	3.3	---	---	---
MW-7	04/01/91	167.61	15.18	---	152.43	ND	ND	ND	ND	ND	---	---	---
MW-7	07/03/92	167.61	20.28	---	147.33	ND<50	ND<0.5	ND<0.5	ND<0.5	ND<0.5	---	---	ANA
MW-7	10/05/92	167.61	21.56	---	146.05	ND<50	ND<0.5	ND<0.5	ND<0.5	1.5	---	---	ANA
MW-7	01/13/93	167.61	15.41	---	152.20	ND<50	ND<0.5	ND<0.5	ND<0.5	ND<0.5	---	---	PACE
MW-7	04/23/93	167.61	15.84	---	151.77	ND<50	ND<0.5	ND<0.5	ND<0.5	ND<0.5	---	---	PACE
MW-7	07/12/93	167.61	19.84	---	147.77	ND<50	ND<0.5	ND<0.5	ND<0.5	ND<0.5	---	---	PACE
MW-7	10/21/93	167.61	21.61	---	146.00	ND<50	ND<0.5	ND<0.5	ND<0.5	ND<0.5	---	---	PACE
MW-7	01/21/94	167.61	20.49	---	147.12	ND<50	ND<0.5	ND<0.5	ND<0.5	ND<0.5	---	---	PACE
QC-1 (c)	01/21/94	---	---	---	---	ND<50	ND<0.5	ND<0.5	ND<0.5	ND<0.5	---	---	PACE
MW-7	04/20/94	167.61	20.54	---	147.07	ND<50	ND<0.5	ND<0.5	ND<0.5	ND<0.5	---	1.5	PACE
MW-7	08/01/94	167.61	20.99	---	146.62	ND<50	0.7	ND<0.5	ND<0.5	ND<0.5	---	1.9	PACE
MW-7	12/23/94	167.61	15.00	---	152.61	---	---	---	---	---	---	---	---
MW-7	01/26/95	167.61	14.69	---	152.92	ND<50	ND<0.5	ND<0.5	ND<0.5	ND<1	---	7.0	ATI
MW-7	06/08/95	167.61	19.87	---	147.74	---	---	---	---	---	---	---	---
MW-7	08/22/95	167.61	21.49	---	146.12	ND<50	ND<0.50	ND<0.50	ND<0.50	ND<1.0	---	6.4	ATI
MW-7	10/27/95	167.61	22.53	---	145.08	---	---	---	---	---	---	---	---
MW-7	01/25/96	167.61	17.21	---	150.40	ND<50	ND<0.50	ND<0.50	ND<0.50	ND<1.0	ND<5.0	---	CEI
MW-7	04/19/96	167.61	17.09	---	150.52	---	---	---	---	---	---	---	---
MW-7	07/23/96	167.61	21.02	---	146.59	---	---	---	---	---	---	---	---
MW-7	11/11/96	167.61	22.03	---	145.59	ND<50	ND<0.5	ND<1.0	ND<1.0	ND<1.0	ND<10	7.8	SPL
MW-7	01/21/97	167.61	15.06	---	152.55	---	---	---	---	---	---	---	---
MW-7	04/29/97	167.61	20.11	---	147.50	ND<50	ND<0.5	ND<1.0	ND<1.0	ND<1.0	ND<10	4.4	SPL
MW-8	03/07/91	165.74	16.72	---	149.02	2.7	780	450	64	310	---	---	---
MW-8	06/27/91	165.74	---	---	---	12000	3400	1100	240	750	---	---	---
MW-8	09/27/91	165.74	---	---	---	41	5700	5200	1100	4300	---	---	---
MW-8	12/18/91	165.74	---	---	---	3.2	990	150	120	250	---	---	---
MW-8	04/01/91	165.74	12.54	---	153.20	15000	2600	2600	410	1900	---	---	---
MW-8	07/03/92	165.74	18.78	---	148.96	72000	19000	32000	3000	15000	---	---	ANA
MW-8	10/05/92	165.74	20.48	0.01	145.27	---	---	---	---	---	---	---	---
MW-8	01/13/93	165.74	12.87	0.01	152.88	---	---	---	---	---	---	---	---
MW-8	04/23/93	165.74	13.90	SHEEN	151.84	---	---	---	---	---	---	---	---
MW-8	07/12/93	165.74	18.30	SHEEN	147.44	---	---	---	---	---	---	---	---
MW-8	10/21/93	165.74	21.91	0.95	144.54	---	---	---	---	---	---	---	---
MW-8	01/21/94	165.74	19.12	0.03	146.64	---	---	---	---	---	---	---	---
MW-8	04/20/94	165.74	19.28	0.03	146.48	26000	1700	4100	960	4000	---	1.1	PACE
MW-8	08/01/94	165.74	---	---	---	---	---	---	---	---	---	---	---
MW-8	12/23/94	165.74	13.81	0.03	151.95	---	---	---	---	---	---	---	---
MW-8	01/26/95	165.74	---	---	---	---	---	---	---	---	---	---	---
MW-8	06/08/95	165.74	17.82	0.29	148.14	---	---	---	---	---	---	---	---
MW-8	08/22/95	165.74	19.41	0.20	146.48	---	---	---	---	---	---	---	---
MW-8	10/27/95	165.74	20.47	0.14	145.38	---	---	---	---	---	---	---	---
MW-8	01/25/96	165.74	13.35	0.22	152.56	---	---	---	---	---	---	---	---
MW-8	04/19/96	165.74	14.40	0.20	151.49	---	---	---	---	---	---	---	---
MW-8	07/23/96	165.74	18.35	0.14	147.50	---	---	---	---	---	---	---	---
MW-8	11/11/96	165.74	19.41	0.02	146.35	---	---	---	---	---	---	---	---
MW-8	01/21/97	165.74	12.29	0.01	153.46	---	---	---	---	---	---	---	---
MW-8 (d)	04/29/97	165.74	---	---	---	---	---	---	---	---	---	---	---

TABLE 1 - SUMMARY OF RESULTS OF GROUNDWATER SAMPLING
 BP OIL COMPANY SERVICE STATION NO. 11132
 3201 35TH STREET, OAKLAND, CALIFORNIA

ALUSTO PROJECT NO 10-024

WELL ID	DATE OF SAMPLING/ MONITORING	CASING ELEVATION (a) (Feet)	DEPTH TO WATER (Feet)	PRODUCT THICKNESS (Feet)	GROUNDWATER ELEVATION (b) (Feet)	TPH-G (ug/l)	B (ug/l)	T (ug/l)	E (ug/l)	X (ug/l)	MTBE (ug/l)	DO (ppm)	LAB
MW-9	03/07/91	166.20	16.79	---	149.41	7.1	220	4	2.4	2400	---	---	---
MW-9	06/27/91	166.20	---	---	---	9600	520	400	85	310	---	---	---
MW-9	09/27/91	166.20	---	---	---	3.2	720	150	50	180	---	---	---
MW-9	12/18/91	166.20	---	---	---	ND	2.5	1.1	0.3	5.8	---	---	---
MW-9	04/01/91	166.20	12.89	---	153.31	12000	2000	2600	360	1600	---	---	---
MW-9	07/03/92	166.20	18.89	---	147.31	5700	17000	840	230	800	---	---	ANA
MW-9	10/05/92	166.20	20.52	---	145.68	1400	440	17	14	100	---	---	ANA
MW-9	01/13/93	166.20	12.92	---	153.28	11000	1200	1700	340	1400	---	---	PACE
QC-1 (c)	01/13/93	---	---	---	0.00	11000	1200	1600	330	1300	---	---	PACE
MW-9	04/23/93	166.20	14.08	---	152.12	24000	2800	4500	730	3400	---	---	PACE
MW-9	07/12/93	166.20	18.44	---	147.76	13000	1400	1100	360	1400	---	---	PACE
QC-1 (c)	07/12/93	---	---	---	---	10000	1200	900	310	1200	---	---	PACE
MW-9	10/21/93	166.20	21.81	0.89	145.06	---	---	---	---	---	---	---	---
MW-9	01/21/94	166.20	19.28	---	146.92	---	---	---	---	---	---	---	---
MW-9	04/20/94	166.20	19.72	---	146.48	43000	2800	6800	1300	7900	---	1.7	PACE
QC-1 (c)	04/20/94	---	---	---	---	45000	2700	6800	1200	8200	---	---	PACE
MW-9	08/01/94	166.20	20.18	0.05	146.06	---	---	---	---	---	---	---	---
MW-9	12/23/94	166.20	14.22	0.02	152.00	---	---	---	---	---	---	---	---
MW-9	01/26/95	166.20	11.85	0.13	154.45	---	---	---	---	---	---	---	---
MW-9	06/08/95	166.20	18.33	0.80	148.47	---	---	---	---	---	---	---	---
MW-9	08/22/95	166.20	19.95	0.01	146.26	---	---	---	---	---	---	---	---
MW-9	10/27/95	166.20	20.88	0.01	145.33	---	---	---	---	---	---	---	---
MW-9	01/25/96	166.20	13.84	0.07	152.41	---	---	---	---	---	---	---	---
MW-9 (d)	04/19/96	166.20	---	---	---	---	---	---	---	---	---	---	---
MW-9	07/23/96	166.20	18.84	0.03	147.38	---	---	---	---	---	---	---	---
MW-9	11/11/96	166.20	19.91	0.01	146.30	---	---	---	---	---	---	---	---
MW-9	01/21/97	166.20	12.93	0.01	153.28	---	---	---	---	---	---	---	---
MW-9	04/29/97	166.20	18.03	SHEEN	148.17	---	---	---	---	---	---	---	---
MW-9	04/30/97	166.20	---	---	---	78000	1900	3600	3100	20600	ND<5000	5.5	SPL
MW-10	03/07/91	167.01	18.09	---	148.92	1.6	120	190	32	230	---	---	---
MW-10	06/27/91	167.01	---	---	---	12000	7300	500	150	300	---	---	---
MW-10	09/27/91	167.01	---	---	---	57	12000	7200	1400	4600	---	---	---
MW-10	12/18/91	167.01	---	---	---	5.3	2500	120	36	79	---	---	---
MW-10	04/01/91	167.01	13.92	---	153.09	ND	ND	ND	ND	ND	---	---	---
MW-10	07/03/92	167.01	19.92	---	147.09	8600	5100	1300	160	630	---	---	ANA
MW-10	10/05/92	167.01	21.92	0.19	145.23	---	---	---	---	---	---	---	---
MW-10	01/13/93	167.01	14.43	0.03	152.60	---	---	---	---	---	---	---	---
MW-10	04/23/93	167.01	15.26	0.06	151.80	---	---	---	---	---	---	---	---
MW-10	07/12/93	167.01	19.78	0.45	147.57	---	---	---	---	---	---	---	---
MW-10	10/21/93	167.01	22.90	0.69	144.63	---	---	---	---	---	---	---	---
MW-10	01/21/94	167.01	20.25	0.06	146.81	---	---	---	---	---	---	---	---
MW-10	04/20/94	167.01	20.74	---	146.27	100000	12000	24000	2400	14000	---	1.0	PACE
MW-10	08/01/94	167.01	22.00	0.28	145.22	---	---	---	---	---	---	---	---
MW-10	12/23/94	167.01	16.08	0.25	151.12	---	---	---	---	---	---	---	---
MW-10	01/26/95	167.01	13.68	0.80	153.93	---	---	---	---	---	---	---	---
MW-10	06/08/95	167.01	19.08	0.75	148.49	---	---	---	---	---	---	---	---
MW-10	08/22/95	167.01	20.73	0.70	146.81	---	---	---	---	---	---	---	---
MW-10	10/27/95	167.01	21.69	0.63	145.79	---	---	---	---	---	---	---	---
MW-10	01/25/96	167.01	15.05	0.81	152.57	---	---	---	---	---	---	---	---
MW-10	04/19/96	167.01	16.26	0.58	151.19	---	---	---	---	---	---	---	---
MW-10	07/23/96	167.01	20.18	0.62	147.30	---	---	---	---	---	---	---	---
MW-10	11/11/96	167.01	21.20	0.20	145.96	---	---	---	---	---	---	---	---
MW-10	01/21/97	167.01	13.66	0.14	153.46	---	---	---	---	---	---	---	---
MW-10	04/29/97	167.01	18.71	0.21	148.30	---	---	---	---	---	---	---	---
MW-10	04/30/97	167.01	---	---	---	170000	9700	38000	4700	30500	ND<5000	5.6	SPL

TABLE 1 - SUMMARY OF RESULTS OF GROUNDWATER SAMPLING
 BP OIL COMPANY SERVICE STATION NO. 11132
 3201 25TH STREET, OAKLAND, CALIFORNIA

ALISTO PROJECT NO 10-024

WELL ID	DATE OF SAMPLING/ MONITORING	CASING ELEVATION (a) (Feet)	DEPTH TO WATER (Feet)	PRODUCT THICKNESS (Feet)	GROUNDWATER ELEVATION (b) (Feet)	TPH+G (ug/l)	B (ug/l)	T (ug/l)	E (ug/l)	X (ug/l)	MTBE (ug/l)	DO (ppm)	LAB
RW-1	07/09/90	169.01	---	1.21	---	---	---	---	---	---	---	---	---
RW-1	12/21/90	169.01	---	0.01	---	---	---	---	---	---	---	---	---
RW-1	03/07/91	168.01	17.62	SHEEN	150.39	---	---	---	---	---	---	---	---
RW-1	06/27/91	168.01	---	0.04	---	---	---	---	---	---	---	---	---
RW-1	09/27/91	168.01	---	0.02	---	---	---	---	---	---	---	---	---
RW-1	12/18/91	168.01	---	0.02	---	---	---	---	---	---	---	---	---
RW-1	04/01/91	169.01	14.40	0.11	153.69	---	---	---	---	---	---	---	---
RW-1	07/03/92	168.01	20.66	SHEEN	147.35	---	---	---	---	---	---	---	---
RW-1	10/05/92	168.01	23.54	0.08	144.73	---	---	---	---	---	---	---	---
RW-1	01/13/93	168.01	16.59	0.05	151.46	---	---	---	---	---	---	---	---
RW-1	04/23/93	168.01	16.17	0.18	151.98	---	---	---	---	---	---	---	---
RW-1	07/12/93	168.01	20.18	0.06	147.88	---	---	---	---	---	---	---	---
RW-1	10/21/93	168.01	25.70	0.56	142.73	---	---	---	---	---	---	---	---
RW-1	01/21/94	168.01	21.24	0.40	147.07	---	---	---	---	---	---	---	---
RW-1	04/20/94	168.01	32.20	---	135.81	---	---	---	---	---	---	---	---
RW-1	08/01/94	168.01	21.70	---	148.31	29000	580	950	300	7800	---	1.1	PAGE
RW-1	12/23/94	169.01	16.02	---	151.99	1300	25	8.6	1.4	69	---	1.8	PAGE
RW-1	01/26/95	168.01	13.78	---	154.23	ND<50	ND<0.5	ND<0.5	ND<0.5	ND<1	---	---	ATI
QC-1 (c)	01/26/95	---	---	---	---	ND<50	ND<0.5	ND<0.5	ND<0.5	ND<1	---	---	ATI
RW-1	06/08/95	168.01	20.05	---	147.96	1300	130	ND<1.0	ND<1.0	36	---	---	ATI
RW-1	08/22/95	168.01	21.74	---	148.27	3300	230	13	4.9	280	---	6.6	ATI
QC-1 (c)	08/22/95	---	---	---	---	2800	210	9.3	4.3	250	---	---	ATI
RW-1	10/27/95	168.01	32.00	---	136.01	---	---	---	---	---	---	---	---
RW-1	10/30/95	---	---	---	---	230	1.4	ND<1.0	ND<1.0	ND<2.0	650	6.9	ATI
QC-1 (c)	10/30/95	---	---	---	---	240	1.6	ND<1.0	ND<1.0	ND<2.0	630	---	ATI
RW-1	01/25/96	168.01	15.41	---	152.60	15000	3400	980	330	2500	5300	---	CEI
RW-1	04/19/96	168.01	16.83	---	151.18	35000	5500	3300	1700	9400	14000	7.6	SPL
QC-1 (c)	04/19/96	---	---	---	---	33000	5600	3200	1700	8800	15000	---	SPL
RW-1	07/23/96	168.01	20.76	---	147.25	46000	3600	2300	900	5100	36000	7.4	SPL
QC-1 (c)	07/23/96	---	---	---	---	47000	3700	2500	930	5300	35000	---	SPL
RW-1	11/11/96	168.01	21.73	---	146.28	34000	3000	1200	880	4600	22000	8.3	SPL
QC-1 (c)	11/11/96	---	---	---	---	31000	2900	1000	860	4600	22000	---	SPL
RW-1	01/21/97	168.01	14.20	---	153.81	260	40	16	2.7	34	1500	6.1	SPL
QC-1 (c)	01/21/97	---	---	---	---	270	42	17	2.7	36	1500	---	SPL
RW-1	04/29/97	168.01	19.15	---	148.86	32000	3100	590	1300	6000	46000	5.3	SPL
QC-2 (e)	10/05/92	---	---	---	---	ND<50	ND<0.5	ND<0.5	ND<0.5	ND<0.5	---	---	ANA
QC-2 (e)	01/13/93	---	---	---	---	ND<50	ND<0.5	ND<0.5	ND<0.5	ND<0.5	---	---	PAGE
QC-2 (e)	04/23/93	---	---	---	---	ND<50	ND<0.5	ND<0.5	ND<0.5	ND<0.5	---	---	PAGE
QC-2 (e)	07/12/93	---	---	---	---	ND<50	ND<0.5	ND<0.5	ND<0.5	ND<0.5	---	---	PAGE
QC-2 (e)	10/21/93	---	---	---	---	ND<50	ND<0.5	ND<0.5	ND<0.5	ND<0.5	---	---	PAGE
QC-2 (e)	01/21/94	---	---	---	---	ND<50	ND<0.5	2.1	ND<0.5	2.1	---	---	PAGE
QC-2 (e)	04/20/94	---	---	---	---	ND<50	ND<0.5	ND<0.5	ND<0.5	ND<0.5	---	---	PAGE
QC-2 (e)	04/20/94	---	---	---	---	ND<50	ND<0.5	ND<0.5	ND<0.5	ND<0.5	---	---	PAGE
QC-2 (e)	12/23/94	---	---	---	---	ND<50	ND<0.5	ND<0.5	ND<0.5	ND<0.5	---	---	ATI
QC-2 (e)	01/26/95	---	---	---	---	ND<50	ND<0.5	ND<0.5	ND<0.5	ND<1	---	---	ATI
QC-2 (e)	06/08/95	---	---	---	---	ND<50	ND<0.50	ND<0.50	ND<0.50	ND<1.0	---	---	ATI
QC-2 (e)	08/22/95	---	---	---	---	ND<50	ND<0.50	ND<0.50	ND<0.50	ND<1.0	---	---	ATI
QC-2 (e)	10/30/95	---	---	---	---	ND<50	ND<0.50	ND<0.50	ND<0.50	ND<1.0	ND<5.0	---	ATI
QC-2 (e)	01/25/96	---	---	---	---	ND<50	ND<0.50	ND<0.50	ND<0.50	ND<1.0	ND<5.0	---	CEI
QC-2 (e)	04/19/96	---	---	---	---	ND<50	ND<0.5	ND<1	ND<1	ND<1	ND<10	---	SPL

TABLE 1 - SUMMARY OF RESULTS OF GROUNDWATER SAMPLING
 BP OIL COMPANY SERVICE STATION NO. 11132
 3201 35TH STREET, OAKLAND, CALIFORNIA

ALISTO PROJECT NO. 10-024

WELL ID	DATE OF SAMPLING/ MONITORING	CASING ELEVATION (a) (Feet)	DEPTH TO WATER (Feet)	PRODUCT THICKNESS (Feet)	GROUNDWATER ELEVATION (b) (Feet)	TPH-G (ug/l)	B (ug/l)	T (ug/l)	E (ug/l)	X (ug/l)	MTBE (ug/l)	DO (ppm)	LAB
ABBREVIATIONS						NOTES.							
TPH-G	Total petroleum hydrocarbons as gasoline					(a)	Casing elevations surveyed to the nearest 0.01 foot relative to mean sea level.						
B	Benzene					(b)	Groundwater elevations adjusted assuming a specific gravity of 0.75 for free product.						
T	Toluene												
E	Ethylbenzene					(c)	Blind duplicate						
X	Total xylenes												
MTBE	Methyl tert butyl ether					(d)	Well inaccessible						
DO	Dissolved oxygen												
ug/l	Micrograms per liter					(e)	Travel blank						
ppm	Parts per million												
—	Not analyzed/available/applicable/measurable												
ND	Not detected above reported detection limit												
PACE	Pace, Inc.												
ANA	Anamatrix, Inc.												
ATI	Analytical Technologies, Inc.												
CEI	Celmic Corporation												
SPL	Southern Petroleum Laboratories												

F:\010-024024-9-4 WQ2

TABLE 2 - PRODUCT REMOVAL STATUS
 BP OIL COMPANY SERVICE STATION NO. 11132
 3201 35TH STREET, OAKLAND, CALIFORNIA

ALISTO PROJECT NO. 10-024

WELL ID	DATE	PRODUCT REMOVED (Gallons)	PRODUCT REMOVED CUMULATIVE (Gallons)
MW-9	11/02/93	0.10	0.10
	11/10/93	0.10	0.20
	11/16/93	0.10	0.30
	12/23/93	<0.01	0.30
	01/12/94	0.01	0.31
	01/20/94	0.05	0.36
	02/02/94	0.05	0.41
	02/11/94	0.01	0.42
	02/18/94	<0.01	0.42
	03/18/94	0.10	0.52
	10/26/94	0.15	0.67
	11/12/94	<0.01	0.67
	12/12/94	<0.01	0.67
	01/26/95	0.10	0.77
	06/28/95	<0.01	0.77
	08/22/95	<0.01	0.77
	10/30/95	<0.01	0.77
	01/25/96	<0.01	0.77
	02/16/95	<0.01	0.77
	04/19/96	<0.01	0.77
07/23/96	0	0.77	
11/11/96	0.01	0.78	
01/21/97	<0.01	0.78	
04/29/97	Sheen	0.78	
MW-10	09/07/93	0.10	0.10
	09/14/93	0.10	0.20
	09/29/93	0.10	0.30
	10/05/93	1.60	1.90
	10/14/93	2.10	4.00
	10/20/93	1.00	5.00
	10/27/93	1.00	6.00
	11/02/93	0.30	6.30
	11/10/93	0.20	6.50
	11/16/93	0.10	6.60
	11/23/93	0.10	6.70
	11/30/93	0.30	7.00
	12/07/93	0.20	7.20
	12/17/93	0.30	7.50
	12/23/93	<0.01	7.50
	01/04/94	0.01	7.51
	01/12/94	0.01	7.52
	01/20/94	0.20	7.72
	02/02/94	0.01	7.73
	02/11/94	0.01	7.74
	02/18/94	0.20	7.94
	05/27/94	<0.01	7.94
	10/26/94	0.60	8.54
	11/12/94	0.43	8.97
	12/12/94	0.26	9.23
	01/26/95	0.13	9.36
	06/28/95	0.10	9.46
08/22/95	0.15	9.61	
10/30/95	0.10	9.71	
01/25/96	0.25	9.96	
02/16/95	0.10	10.06	
04/19/96	0.50	10.56	
07/23/96	0	10.56	
11/11/96	0.20	10.76	
01/21/97	<0.03	10.76	
04/29/97	0.04	10.80	

TABLE 2 - PRODUCT REMOVAL STATUS
 BP OIL COMPANY SERVICE STATION NO. 11132
 3201 35TH STREET, OAKLAND, CALIFORNIA

ALISTO PROJECT NO. 10-024

WELL ID	DATE	PRODUCT REMOVED (Gallons)	PRODUCT REMOVED CUMULATIVE (Gallons)
MW-1	01/26/95	3.00	3.00
	06/08/95	0.60	3.60
	06/28/95	0.10	3.70
	08/22/95	0.15	3.85
	10/30/95	0.11	3.96
	01/25/96	1.00	4.96
	02/16/95	0.08	5.04
	04/19/96	0.75	5.79
	07/23/96	0	5.79
	11/11/96	0.98	6.77
	01/21/97	0.20	6.97
	04/29/97	0.25	7.22
	MW-2	09/29/93	0.10
10/05/93		0.10	0.20
10/14/93		0.10	0.30
10/20/93		0.25	0.55
11/02/93		0.10	0.65
12/07/93		0.05	0.70
12/17/93		<0.01	0.70
12/23/93		0.30	1.00
01/12/94		0.05	1.05
02/02/94		0.01	1.06
02/11/94		0.01	1.07
03/18/94		<0.01	1.07
10/26/94		0.76	1.83
11/12/94		0.08	1.91
12/12/94		0.03	1.94
01/26/95		0.19	2.13
06/08/95		Sheen	2.13
06/28/95		0.05	2.18
08/22/95		0.10	2.28
10/30/95		0.05	2.33
01/25/96		Sheen	2.33
02/16/95		0.04	2.37
04/19/96		0.01	2.38
07/23/96		0	2.38
11/11/96		0.01	2.39
01/21/97		<0.01	2.39
04/29/97		<0.01	2.39
MW-8	11/02/93	0.25	0.25
	11/10/93	0.10	0.35
	11/16/93	0.10	0.45
	11/23/93	0.10	0.55
	11/30/93	0.10	0.65
	12/17/93	<0.01	0.65
	12/23/93	<0.01	0.65
	01/12/94	0.01	0.66
	02/02/94	0.05	0.71
	02/11/94	0.08	0.79
	02/18/94	<0.01	0.79
	03/18/94	0.01	0.80
	04/27/94	<0.01	0.80
	05/27/94	<0.01	0.80
	10/26/94	0.10	0.90
	11/12/94	0.02	0.92
	12/12/94	0.01	0.93
	06/08/95	Sheen	0.93
	08/22/95	0.05	0.98
	10/30/95	0.02	1.00
	01/25/96	0.05	1.05
	02/16/95	0.01	1.06
	04/19/96	0.25	1.31
	07/23/96	0	1.31
	11/11/96	0.02	1.33
	01/21/97	<0.01	1.33

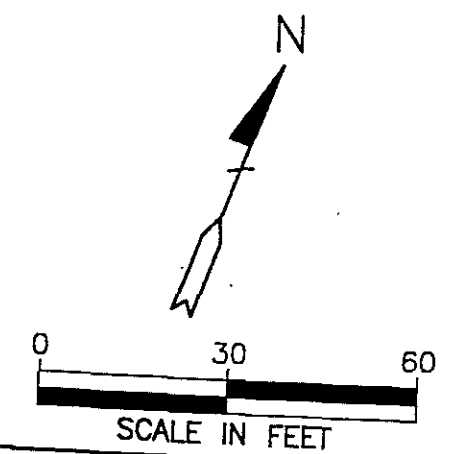
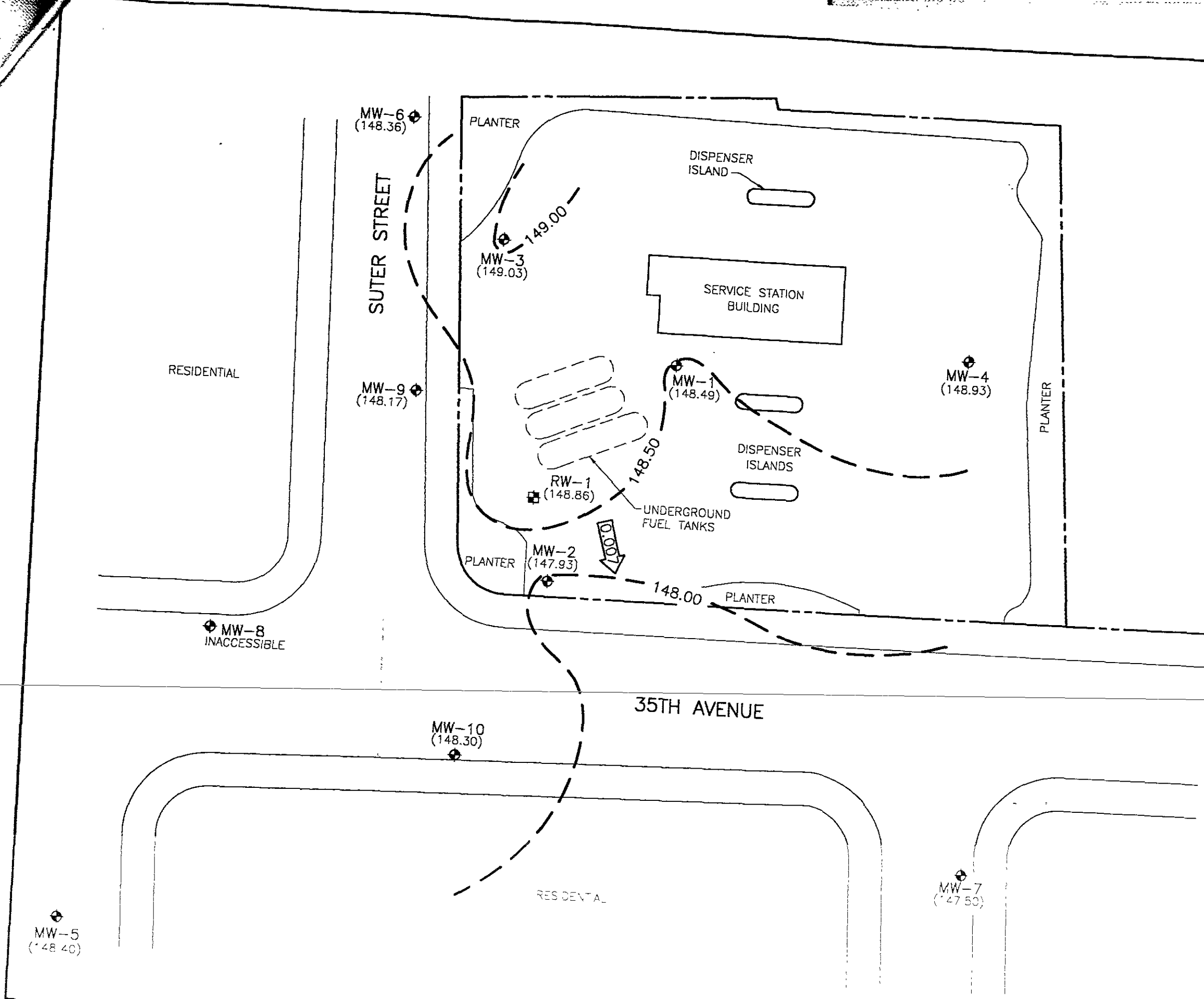

- LEGEND**
- ◆ GROUNDWATER MONITORING WELL
 - ⊠ GROUNDWATER RECOVERY WELL
 - (147.93) GROUNDWATER ELEVATION IN FEET ABOVE MEAN SEA LEVEL
 - 148.50 - GROUNDWATER ELEVATION CONTOUR IN FEET ABOVE MEAN SEA LEVEL (CONTOUR INTERVAL - 0.50 FOOT)
 - ← 0.007 → CALCULATED GROUNDWATER GRADIENT DIRECTION AND MAGNITUDE IN FOOT PER FOOT

FIGURE 2
POTENTIOMETRIC GROUNDWATER ELEVATION CONTOUR MAP
 APRIL 29, 1997
 BP OIL SERVICE STATION NO. 11132
 3201 35TH STREET
 OAKLAND, CALIFORNIA
 PROJECT NO. 10-024

TODAY WITH 6.5.07 10:54 11.31