

FACSIMILE TRANSMITTAL COVER SHEET

CET ENVIRONMENTAL SERVICES, INC.

5845 Doyle Street, Suite 104

Emeryville, California 94608

(510) 652-7001 FAX: (510) 652-7002

DATE: 1-18-96

FAX NO: 337-9335

ATTN: Amy Leech

CO. NAME: Alameda County Health

FROM: Benjamin Berman

RE: Young Property, San Lorenzo

PAGES: 2

(including cover)

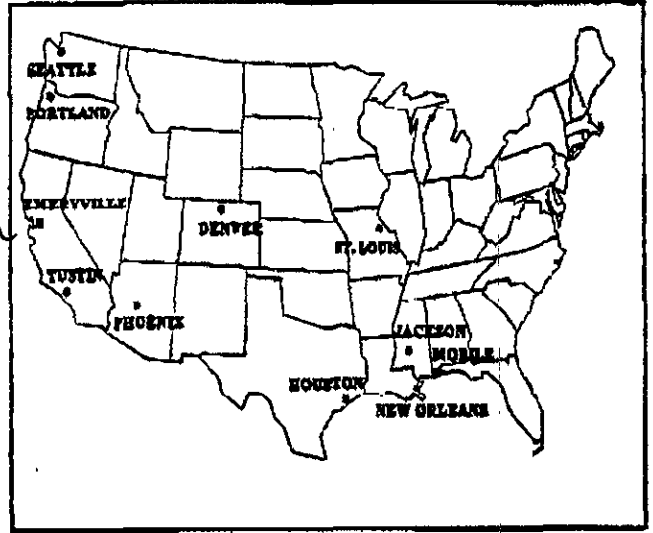

COMMENTS:

Amy,

Map showing proposed well locations for
186 E. Jewelling Blvd, San Lorenzo, CA,
The results of the soil boring investigation
were faxed to you on 11-6-95. CET
will begin obtaining the access agreements to
install these wells on off-site properties.
Please call me soon if you would like a
modification of the proposed well locations.
Thank You - Benjamin.

SAN LORENZO HIGH SCHOOL

ASHLAND AVENUE

EAST LEWELLING BOULEVARD

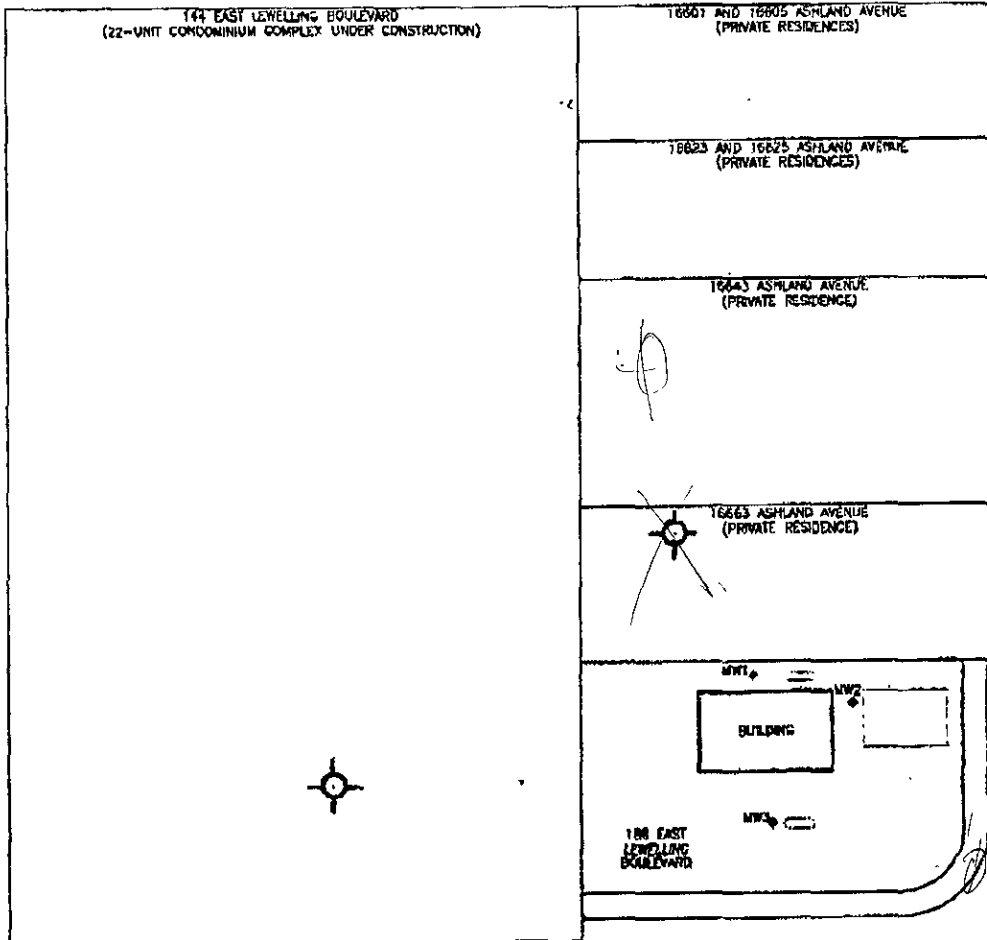

185, 173, 175, 177, AND 181 EAST LEWELLING BOULEVARD
 (PRIVATE RESIDENCES)

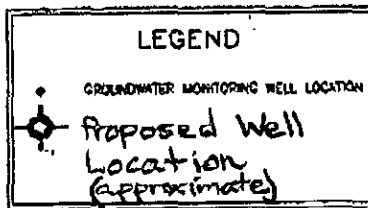
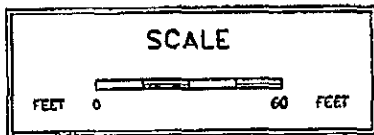

Handwritten signature or initials.



CET Environmental Services, Inc.

SITE VICINITY PLAN

186 E. LEWELLING BLVD
 SAN LORENZO, CALIFORNIA

PLATE

2

JOB NUMBER	DATE	DRAWING	BY	REVISED
3602	01/95	OFFSITE	LONG	02/23