



**CONESTOGA-ROVERS  
& ASSOCIATES**

5900 Hollis Street, Suite A  
Emeryville, California 94608  
Telephone: (510) 420-0700 Fax: (510) 420-9170  
www.CRAworld.com

## TRANSMITTAL

DATE: May 9, 2014 REFERENCE NO.: 240554

PROJECT NAME: 3420 San Pablo Avenue, Oakland

TO: Jerry Wickham  
Alameda County Environmental Health  
1131 Harbor Bay Parkway, Suite 250  
Alameda, CA 94502-6577

RECEIVED

By Alameda County Environmental Health at 2:52 pm, May 09, 2014

Please find enclosed:  Draft  Final  
 Originals  Other  
 Prints

Sent via:  Mail  Same Day Courier  
 Overnight Courier  Other GeoTracker and Alameda County FTP

QUANTITY	DESCRIPTION
1	Well Destruction Report

As Requested  For Review and Comment  
 For Your Use

**COMMENTS:**  
If you have any questions regarding the contents of this document, please call the CRA project manager Peter Schaefer at (510) 420-3319 or the Shell program manager Perry Pineda at (425) 413-1164.

Copy to: Perry Pineda, Shell Oil Products US (electronic copy)  
Shahriar Almasi, Portola Valley LLC (property owner), 965 Laurel Glen Drive, Palo Alto,  
CA 94304

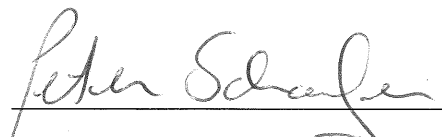
Completed by: Peter Schaefer Signed: 

Filing: Correspondence File



Mr. Jerry Wickham  
Alameda County Environmental Health  
1131 Harbor Bay Parkway, Suite 250  
Alameda, California 94502-6577

**Shell Oil Products US**  
Soil and Groundwater Focus Delivery Group  
20945 S. Wilmington Avenue  
Carson, CA 90810  
Tel (425) 413 1164  
Fax (425) 413 0988  
Email [perry.pineda@shell.com](mailto:perry.pineda@shell.com)  
Internet <http://www.shell.com>

Re: 3420 San Pablo Avenue  
Oakland, California  
SAP Code 139619  
Incident No. 98995748  
ACEH Case No. RO0000006

Dear Mr. Wickham:

The attached document is provided for your review and comment. Upon information and belief, I declare, under penalty of perjury, that the information contained in the attached document is true and correct.

As always, please feel free to contact me directly at (425) 413-1164 with any questions or concerns.

Sincerely,  
Shell Oil Products US

A handwritten signature in black ink, appearing to read "Perry Pineda", is located below the typed name.

Perry Pineda  
Senior Environmental Program Manager



## WELL DESTRUCTION REPORT

**FORMER SHELL SERVICE STATION  
3420 SAN PABLO AVENUE  
OAKLAND, CALIFORNIA**

**SAP CODE            139619  
INCIDENT NO.      98995748  
AGENCY NO.        RO0000006**

**MAY 9, 2014**  
**REF. NO. 240554 (20)**  
This report is printed on recycled paper.

**Prepared by:  
Conestoga-Rovers  
& Associates**

5900 Hollis Street, Suite A  
Emeryville, California  
U.S.A. 94608

Office: (510) 420-0700  
Fax: (510) 420-9170

web: [www.CRAworld.com](http://www.CRAworld.com)

TABLE OF CONTENTS

	<u>Page</u>
1.0 INTRODUCTION.....	1
2.0 WELL DESTRUCTIONS.....	1
2.1 FIELD DATES.....	1
2.2 PERSONNEL PRESENT .....	1
2.3 DESTRUCTION METHOD .....	1
2.4 WASTE DISPOSAL.....	1

LIST OF FIGURES  
(Following Text)

- FIGURE 1 VICINITY MAP  
FIGURE 2 SITE PLAN

LIST OF APPENDICES

- APPENDIX A PERMITS

## 1.0 INTRODUCTION

Conestoga-Rovers & Associates (CRA) prepared this report on behalf of Equilon Enterprises LLC dba Shell Oil Products US (Shell) to document the recent well destructions at the referenced site.

The wells were properly destroyed to facilitate case closure as requested by Alameda County Environmental Health in their January 14, 2014 letter.

## 2.0 WELL DESTRUCTIONS

### 2.1 FIELD DATES

March 26 to 28, 2014.

### 2.2 PERSONNEL PRESENT

Geologist Patrick O'Connell directed the well destructions under the supervision of California Professional Geologist Peter Schaefer.

### 2.3 DESTRUCTION METHOD

After removing the well boxes, wells MW-1, MW-2, MW-3R, MW-4, MW-5, MW-6R, MW-7, and MW-9 through MW-11 were destroyed by pressure grouting. Copies of the Alameda County Public Works Agency well destruction permit and City of Oakland excavation and obstruction permits are included in Appendix A.

### 2.4 WASTE DISPOSAL

No waste was generated during the well destructions. Construction debris generated during the well destructions was recycled by Cascade Drilling, LP at the West Contra Costa Sanitary Landfill in Richmond, California.

All of Which is Respectfully Submitted,  
CONESTOGA-ROVERS & ASSOCIATES

*Peter Schaefer*  
Peter Schaefer, CEG, CHG

*Aubrey K Cool*  
Aubrey K. Cool, PG



## FIGURES





I:\Shell\6-chars\2405--\240554-Oakland 3420 San Pablo\240554-FIGURES\240554 VICINITY.A1

**Former Shell Service Station**  
 3420 San Pablo Avenue  
 Oakland, California



**CONESTOGA-ROVERS  
 & ASSOCIATES**

**Vicinity Map**

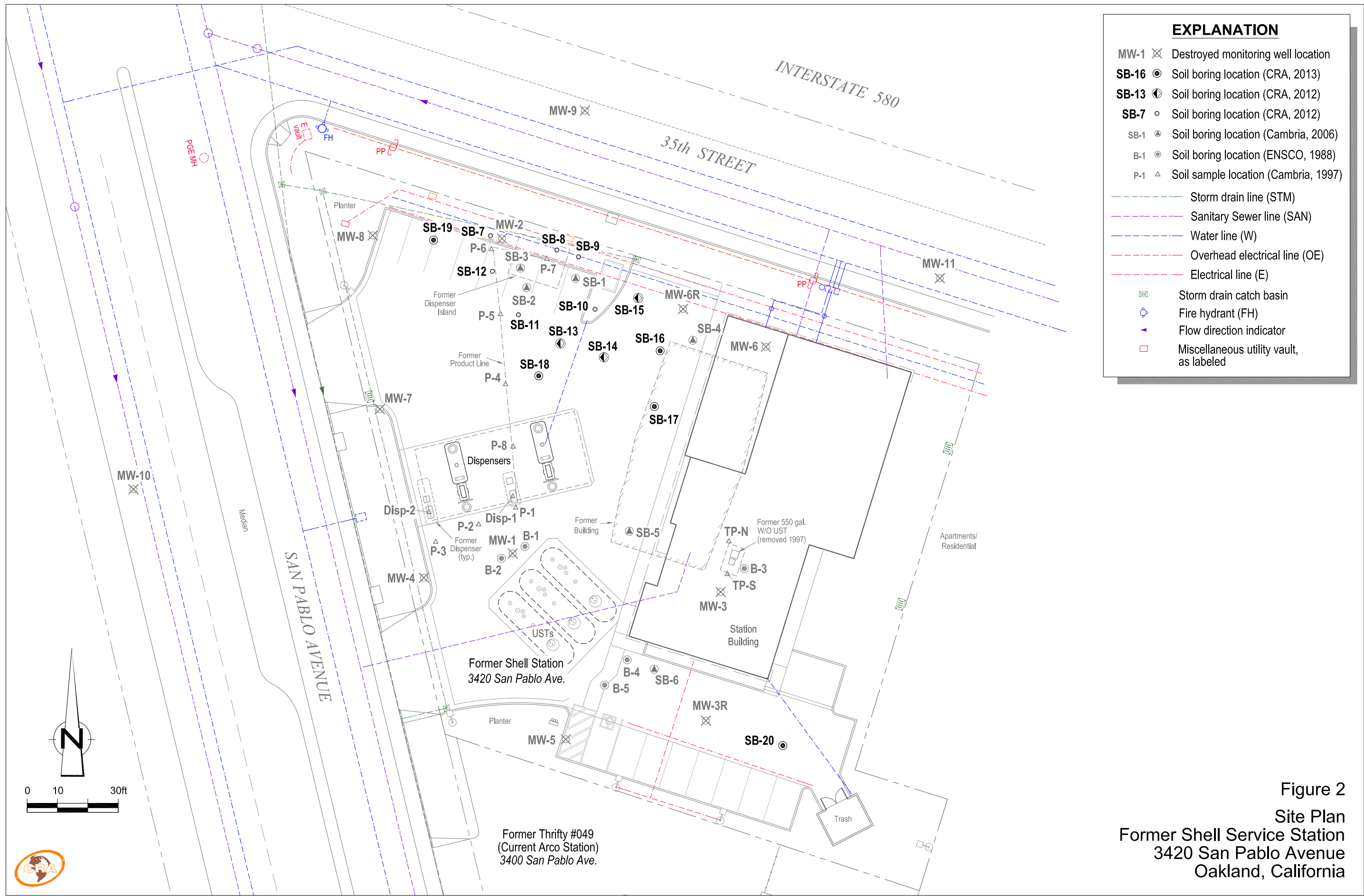

Figure 2  
 Site Plan  
 Former Shell Service Station  
 3420 San Pablo Avenue  
 Oakland, California

APPENDIX A

PERMITS

# Alameda County Public Works Agency - Water Resources Well Permit



**Public Works Agency**  
Alameda County

399 Elmhurst Street  
Hayward, CA 94544-1395  
Telephone: (510)670-6633 Fax:(510)782-1939

**Application Approved on: 03/05/2014 By jamesy**

**Permit Numbers: W2014-0217 to W2014-0226**  
**Permits Valid from 03/24/2014 to 03/28/2014**

**Application Id:** 1393372399034  
**Site Location:** 3420 San Pablo Avenue  
**Project Start Date:** 03/24/2014  
**Assigned Inspector:** Contact Steve Miller at (510) 670-5517 or stevem@acpwa.org

**City of Project Site:**Oakland  
**Completion Date:**03/28/2014

<b>Applicant:</b>	Conestoga-Rovers & Associates, Inc. (CRA) - Patrick O'Connell 5900 Hollis Street, Suite A, Emeryville, CA 94608	<b>Phone:</b> 510-681-6142
<b>Property Owner:</b>	Portola Valley LLC 965 Laurel Glen Drive, Palo Alto, CA 94304	<b>Phone:</b> --
<b>Client:</b>	Shell Oil Products US 20945 S. Wilmington Avenue, Carson, CA 90810	<b>Phone:</b> --
<b>Contact:</b>	Patrick O'Connell	<b>Phone:</b> 510-681-6142 <b>Cell:</b> 510-681-6142

<b>Receipt Number: WR2014-0080</b>	<b>Total Due:</b>	\$3970.00
<b>Payer Name : Patrick OConnell</b>	<b>Total Amount Paid:</b>	\$3970.00
	<b>Paid By: VISA</b>	<b>PAID IN FULL</b>

**Works Requesting Permits:**

Well Destruction-Monitoring - 10 Wells

Driller: Cascade Drilling, L.P. - Lic #: 938110 - Method: press

**Work Total: \$3970.00**

**Specifications**

Permit #	Issued Date	Expire Date	Owner Well Id	Hole Diam.	Casing Diam.	Seal Depth	Max. Depth	State Well #	Orig. Permit #	DWR #
W2014-0217	03/05/2014	06/22/2014	MW-1	10.00 in.	4.00 in.	4.00 ft	25.00 ft	NO Records	NO Records	NO Records
W2014-0218	03/05/2014	06/22/2014	MW-10	10.00 in.	4.00 in.	3.00 ft	19.00 ft	NO Records	NO Records	NO Records
W2014-0219	03/05/2014	06/22/2014	MW-11	10.00 in.	4.00 in.	3.00 ft	19.00 ft	NO Records	NO Records	NO Records
W2014-0220	03/05/2014	06/22/2014	MW-2	10.00 in.	4.00 in.	3.00 ft	19.00 ft	NO Records	NO Records	NO Records
W2014-0221	03/05/2014	06/22/2014	MW-3R	10.00 in.	2.00 in.	3.00 ft	30.00 ft	NO Records	NO Records	NO Records
W2014-0222	03/05/2014	06/22/2014	MW-4	10.00 in.	4.00 in.	4.00 ft	25.00 ft	NO Records	W2009-0938	NO Records
W2014-0223	03/05/2014	06/22/2014	MW-5	10.00 in.	4.00 in.	4.00 ft	25.00 ft	NO Records	W2009-0939	NO Records
W2014-0224	03/05/2014	06/22/2014	MW-6R	10.00 in.	2.00 in.	3.00 ft	30.00 ft	NO Records	NO Records	NO Records
W2014-0225	03/05/2014	06/22/2014	MW-7	10.00 in.	4.00 in.	4.00 ft	20.00 ft	NO Records	NO Records	NO Records
W2014-0226	03/05/2014	06/22/2014	MW-9	10.00 in.	4.00 in.	4.00 ft	20.00 ft	NO Records	NO Records	NO Records

**Specific Work Permit Conditions**

1. Drilling Permit(s) can be voided/ cancelled only in writing. It is the applicant's responsibility to notify Alameda County Public Works Agency, Water Resources Section in writing for an extension or to cancel the drilling permit application. No drilling permit application(s) shall be extended beyond ninety (90) days from the original start date. Applicants may not cancel a drilling permit application after the completion date of the permit issued has passed.



## Alameda County Public Works Agency - Water Resources Well Permit

2. Prior to any drilling activities, it shall be the applicant's responsibility to contact and coordinate an Underground Service Alert (USA), obtain encroachment permit(s), excavation permit(s) or any other permits or agreements required for that Federal, State, County or City, and follow all City or County Ordinances. No work shall begin until all the permits and requirements have been approved or obtained. It shall also be the applicants responsibilities to provide to the Cities or to Alameda County an Traffic Safety Plan for any lane closures or detours planned. No work shall begin until all the permits and requirements have been approved or obtained.
  3. Compliance with the well-sealing specifications shall not exempt the well-sealing contractor from complying with appropriate State reporting-requirements related to well construction or destruction (Sections 13750 through 13755 (Division 7, Chapter 10, Article 3) of the California Water Code). Contractor must complete State DWR Form 188 and mail original to the Alameda County Public Works Agency, Water Resources Section, within 60 days. Include permit number and site map.
  4. Applicant shall submit the copies of the approved encroachment permit to this office within 60 days.
  5. Permittee shall assume entire responsibility for all activities and uses under this permit and shall indemnify, defend and save the Alameda County Public Works Agency, its officers, agents, and employees free and harmless from any and all expense, cost and liability in connection with or resulting from the exercise of this Permit including, but not limited to, property damage, personal injury and wrongful death.
  6. Applicant shall contact Steve Miller for an inspection time at (510) 670-5517 or email to [stevem@acpwa.org](mailto:stevem@acpwa.org) at least five (5) working days prior to starting, once the permit has been approved. Confirm the scheduled date(s) at least 24 hours prior to drilling.
  7. Permittee, permittee's contractors, consultants or agents shall be responsible to assure that all material or waters generated during drilling, boring destruction, and/or other activities associated with this Permit will be safely handled, properly managed, and disposed of according to all applicable federal, state, and local statutes regulating such. In no case shall these materials and/or waters be allowed to enter, or potentially enter, on or off-site storm sewers, dry wells, or waterways or be allowed to move off the property where work is being completed.
  8. Remove the Christy box or similar structure. Destroy wells MW-9, MW-10 and MW-11 by overdrilling the upper 5ft bgs & Tremie Grouting with Cement. After the seal has set, backfill the remaining hole with concrete or compacted material to match existing.
  9. Remove the Christy box or similar structure. Destroy all other wells by grouting neat cement with a tremie pipe or pressure grouting (25 psi for 5min.) to the bottom of the well and by filling with neat cement to three (3-5) feet below surface grade. Allow the sealing material to spill over the top of the casing to fill any annular space between casing and soil. After the seal has set, backfill the remaining hole with concrete or compacted material to match existing conditions.
  10. Copy of approved drilling permit must be on site at all times. Failure to present or show proof of the approved permit application on site shall result in a fine of \$500.00.
-

JOB SITE

Permits for which no major inspection has been approved within 180 days shall expire by limitation. No refund more than 180 days after expiration or final.

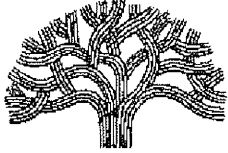

# CITY OF OAKLAND

250 FRANK H. OGAWA PLAZA ▪ 2ND FLOOR ▪ OAKLAND, CA 94612

Department of Planning and Building  
www.oaklandnet.com

PH: 510-238-6402  
FAX: 510-238-2959  
TDD: 510-238-3254

Permit No: X1400655 Excavation Filed Date: 3/20/2014

Job Site: 3420 SAN PABLO AVE Schedule Inspection by calling: 510-238-3444

Parcel No: 009 074001901

For SL; X; and CGS permits see **SPECIAL NOTE** below

District:

**Project Description:** Destroy three existing monitoring wells in right-of-way. MW-10 on San Pablo Ave; MW-9 & MW-11 on 35th Street. Separate excavation permit required for each street.  
Set up PWA PRE-CON prior to start work: 510-238-3651.  
Note: Only one well on San Pablo has PTS permit record:  
Encroach onto San Pablo Avenue with one monitoring well. recorded 12-4-2002; doc no. 2002-564266.

**Related Permits:** ENMIO2250

	<u>Name</u>	<u>Applicant</u>	<u>Address</u>	<u>Phone</u>	<u>License #</u>
<b>Owner:</b>	EQUILON			0	
	ENTERPRISES LLC				
<b>Contractor-Employee:</b>		X			

**PERMIT DETAILS:** Building/Public Infrastructure/Excavation/NA

**General Information**

Excavation Type: Private Party	Special Paving Detail Required:	Tree Removal Involved:
Date Street Last Resurfaced:		Holiday Restriction (Nov 1 - Jan 1):
Worker's Compensation Company Name:		Limited Operation Area (7AM-9AM) And (4PM-6PM):
Worker's Compensation Policy #:		

**Key Dates**

Approximate Start Date:  
Approximate End Date:

**TOTAL FEES TO BE PAID AT ISSUANCE: \$436.05**

Application Fee	\$71.00	Excavation - Private Party Type	\$309.00	Records Management Fee	\$36.10
Technology Enhancement Fee	\$19.95				

Plans Checked By \_\_\_\_\_ Date \_\_\_\_\_ Finalized By \_\_\_\_\_ Date \_\_\_\_\_  
 Permit Issued By  Date 3.20.14

**SPECIAL NOTE**

- For SL; X; and CGS permits Call PWA INSPECTION prior to start: 510-238-3651 or visit 4th FLOOR.
- SL and X permits valid 90 days; CGS permits valid 30 days

JOB SITE

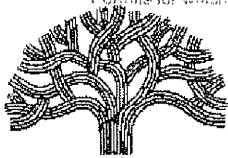

**CITY OF OAKLAND**

250 FRANK H. OGAWA PLAZA ▪ 2ND FLOOR ▪ OAKLAND, CA 94612

Department of Planning and Building  
www.oaklandnet.com

PH: 510-238-6402  
FAX: 510-238-2959  
TDD: 510-238-3254

Permit No: X1400656 Excavation Filed Date: 3/20/2014

Job Site: 3420 SAN PABLO AVE Schedule Inspection by calling: 510-238-3444

Parcel No: 009 074001901

For SL; X; and CGS permits see **SPECIAL NOTE** below

District:

**Project Description:** Destroy three existing monitoring wells in right-of-way. MW-10 on San Pablo Ave; MW-9 & MW-11 on 35th Street. Separate excavation permit required for each street.  
Set up PWA PRE-CON prior to start work: 510-238-3651.  
Note: Only one well on San Pablo has PTS permit record:  
Encroach onto San Pablo Avenue with one monitoring well. recorded 12-4-2002; doc no. 2002-564266.

Related Permits: X1400655

	<u>Name</u>	<u>Applicant</u>	<u>Address</u>	<u>Phone</u>	<u>License #</u>
Owner:	EQUILON ENTERPRISES LLC		,	0	
Contractor- Employee:		X	,		

**PERMIT DETAILS:** Building/Public Infrastructure/Excavation/NA

**General Information**

Excavation Type: Private Party	Special Paving Detail Required:	Tree Removal Involved:
Date Street Last Resurfaced:		Holiday Restriction (Nov 1 - Jan 1):
Worker's Compensation Company Name:		Limited Operation Area (7AM-9AM) And (4PM-6PM):
Worker's Compensation Policy #:		

**Key Dates**

Approximate Start Date:  
Approximate End Date:

**TOTAL FEES TO BE PAID AT ISSUANCE: \$436.05**

Application Fee	\$71.00	Excavation - Private Party Type	\$309.00	Records Management Fee	\$36.10
Technology Enhancement Fee	\$19.95				

Plans Checked By \_\_\_\_\_ Date \_\_\_\_\_ Finalized By \_\_\_\_\_ Date \_\_\_\_\_

Permit Issued By  Date 3/20/14

**SPECIAL NOTE**

- For SL; X; and CGS permits Call PWA INSPECTION prior to start: 510-238-3651 or visit 4th FLOOR.
- SL and X permits valid 90 days; CGS permits valid 30 days

Applications for which no permit is issued within 180 days shall expire by limitation. No refund more than 180 days after expiration or final.  
 Permits for which no major inspection has been approved within 180 days shall expire by limitation. No refund more than 180 days after expiration or final.

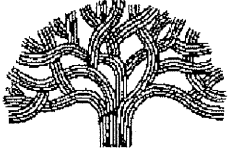

**CITY OF OAKLAND**

**250 FRANK H. OGAWA PLAZA • 2ND FLOOR • OAKLAND, CA 94612**

Department of Planning and Building  
 www.oaklandnet.com

PH: 510-238-6402  
 FAX: 510-238-2959  
 TDD: 510-238-3254

**Permit No:** OB1400160      **Obstruction**      **Filed Date:** 3/20/2014  
**Job Site:** 3420 SAN PABLO AVE      **Schedule Inspection by calling:** 510-238-3444  
**Parcel No:** 009 074001901  
**District:**  
**Project Description:** Reserve parking on both San Pablo Ave (75') & on 35th Street (50'). Also divert 300' of traffic lanes on both San Pablo Ave & 35th Street per TSD 14-0051. Total: 675' (two parking spaces NO FEE per X1400655/-0656).

Destroy three existing monitoring wells in right-of-way. MW-10 on San Pablo Ave; MW-9 & MW-11 on 35th Street. Separate excavation permit required for each street.  
 Set up PWA PRE-CON prior to start work: 510-238-3651.  
 Note: Only one well on San Pablo has PTS permit record:  
 Encroach onto San Pablo Avenue with one monitoring well, recorded 12-4-2002; doc no. 2002-564266.

**Related Permits:** X1400656

	<u>Name</u>	<u>Applicant</u>	<u>Address</u>	<u>Phone</u>	<u>License #</u>
<b>Owner:</b>	EQUILON			0	
	ENTERPRISES LLC				
<b>Contractor- Employee:</b>		X			

<b>PERMIT DETAILS: Building/Public Use/Activity/Obstructions</b>					
<b>Work Information</b>					
Start Date:	03/25/2014	Obstruction Permit Type:	Short Term (Max 14 Days)		
End Date:	03/25/2014	Number of Meters (Metered Area):			
		Length Of Obstruction (Unmetered Area):	675		
<b>TOTAL FEES TO BE PAID AT ISSUANCE: \$615.92</b>					
Application Fee	\$71.00	Records Management Fee:	\$50.99	Short Term Permits	\$465.75
Technology Enhancement Fee	\$28.18				

Plans Checked By \_\_\_\_\_ Date \_\_\_\_\_ Finalized By \_\_\_\_\_ Date \_\_\_\_\_  
 Permit Issued By [Signature] Date 3.20.14

**CITY OF OAKLAND**

ADDRESS:  
DIST:



# CITY OF OAKLAND

## PERMIT TO EXCAVATE IN STREETS OR OTHER WORK AS SPECIFIED

LOCATION OF WORK: 5420 BETWEEN \_\_\_\_\_ AND \_\_\_\_\_  
(Street or Address) (Street/Ave.) (Specify)

PERMISSION TO EXCAVATE IN THE PUBLIC RIGHT-OF-WAY IS HEREBY GRANTED TO:

APPLICANT \_\_\_\_\_

ADDRESS \_\_\_\_\_ PHONE #: 510-450-4000

TYPE OF WORK: GAS \_\_\_\_\_ ELECTRIC \_\_\_\_\_ WATER \_\_\_\_\_ TELEPHONE \_\_\_\_\_ CABLE TV \_\_\_\_\_ SEWER \_\_\_\_\_ OTHER \_\_\_\_\_  
(Specify)

NATURE OF WORK: \_\_\_\_\_

I hereby affirm that I am exempt from the Contractor's License Law for the following reason (Sec. 7031.5, Business and Professions Code: Any city or county which requires a permit to construct, alter, improve, demolish, or repair any structure, prior to its issuance, also requires the applicant for such permit to file a signed statement that he is licensed pursuant to the provisions of the Contractor's License Law Chapter 9 (commencing with Sec. 7000) of Division 3 of the Business and Professions Code, or that he is exempt therefrom and the basis for the alleged exemption. Any violation of Section 7031.5 by any applicant for a permit subjects the applicant to a civil penalty of not more than \$500):

I, as owner of the property, or my employees with wages as their sole compensation, will do the work, and the structure is not intended or offered for sale (Sec. 70044, Business and Professions Code: The Contractor's License Law does not apply to an owner of property who builds or improves thereon, and who does such work himself or through his own employees, provided that such improvements are not intended or offered for sale. If, however, the building or improvement is sold within one year of completion, the owner-builder will have the burden of proving that he did not build or improve for the purpose of sale).

I, as owner of the property, am exempt from the sale requirements of the above due to: (1) I am improving my principal place of residence or appurtenances thereto, (2) the work will be performed prior to sale, (3) I have resided in the residence for the 12 months prior to completion of the work, and (4) I have not claimed exemption in this subdivision on more than two structures more than once during any three-year period. (Sec. 7044, Business and Professions Code).

I, as owner of the property, am exclusively contracting with licensed contractors to construct the project (Sec. 7044, Business and Professions Code: The Contractor's License Law does not apply to an owner of property who builds or improves thereon, and who contracts for such projects with a contractor(s) licensed pursuant to the Contractor's License Law).

I am exempt under Sec. \_\_\_\_\_, B&P.C. for this reason \_\_\_\_\_

Signature \_\_\_\_\_ Date \_\_\_\_\_

PERMIT VOID 90 DAYS FROM DATE OF ISSUE UNLESS EXTENSION GRANTED BY DIRECTOR OF PUBLIC WORKS.

Approximate Starting Date DATE 8/17/93

Approximate Completion Date DATE 8/17/93

HOLIDAY RESTRICTION (1 NOV - 1 JAN) YES \_\_\_\_\_ NO

LIMITED OPERATION AREA (7AM - 9AM / 4PM - 6PM) YES \_\_\_\_\_ NO

DATE STREET LAST RESURFACED DATE 7/1/92

SPECIAL PAVING DETAIL REQUIRED YES  NO \_\_\_\_\_

24-HOUR EMERGENCY PHONE NUMBER \_\_\_\_\_ PERMIT NOT VALID WITHOUT 24 HOUR NUMBER.

Telephone 238-3651 Forty-eight (48) HOURS BEFORE ACTUAL CONSTRUCTION.

### ATTENTION

State law requires that contractor/owner call Underground Service Alert two working days before excavating to have below-ground utilities located. This permit is not valid unless applicant has secured an inquiry identification number issued by Underground Service Alert.

Call Toll Free: 800-642-2444 USA ID Number \_\_\_\_\_

This permit issued pursuant to all provisions of Chapter 6, Article 2 of the Oakland Municipal Code.

This permit is granted upon the express condition that the permittee shall be responsible for all claims and liabilities arising out of work performed under the permit or arising out of permittee's failure to perform the obligations with respect to street maintenance. The permittee shall, and by acceptance of the permit agrees to defend, indemnify, save and hold harmless the City, its officers and employees, from and against any and all suits, claims or actions brought by any person for or on account of any bodily injuries, disease or illness or damage to persons and/or property sustained or arising in the construction of the work performed under the permit or in consequence of permittee's failure to perform the obligations with respect to street maintenance.

### CONTRACTOR

I hereby affirm that I am licensed under provisions of Chapter 9 (commencing with Section 7000) of Division 3 of the Business and Professions Code, and my license is in full force and effect.

LICENSE # AND CLASS \_\_\_\_\_ CITY BUSINESS TAX # \_\_\_\_\_

X \_\_\_\_\_ Date 7/16/93  
Signature of Contractor Owner or Agent

Agent for  Contractor  Owner

I hereby affirm that I have a certificate of consent to self-insure, or a certificate of Workers' Compensation Insurance, or a certified copy thereof (Sec. 3800, Lab C).

Policy # \_\_\_\_\_ Company Name \_\_\_\_\_

Certified copy is hereby furnished.  
 Certified copy is filed with the city building inspection dept.

Signature \_\_\_\_\_ Date 7/16/93

(This section need not be completed if the permit is for one hundred dollars (\$100) or less.)

I certify that in the performance of the work for which this permit is issued, I shall not employ any person in any manner so as to become subject to the Workers' Compensation Laws of California.

Signature \_\_\_\_\_ Date \_\_\_\_\_

NOTICE TO APPLICANT. If, after making this Certificate of Exemption, you should become subject to the Workers' Compensation provisions of the Labor Code, you must forthwith comply with such provisions or this permit shall be deemed revoked.

No. 01/01/93  
22  
Y2113  
11/11/93

**INSPECTION COSTS FOR UTILITY COMPANIES & ADDITIONAL INSPECTION HOURS WILL BE CHARGED IN CONFORMANCE WITH THE MASTER FEE SCHEDULE.**

### OFFICIAL USE ONLY UTILITY COMPANY REPORT

Supervisor \_\_\_\_\_  
Completion Date \_\_\_\_\_

### CITY INSPECTOR'S REPORT

BACKFILL \_\_\_\_\_ PAVING \_\_\_\_\_

Initials \_\_\_\_\_

Hours \_\_\_\_\_

Date \_\_\_\_\_

Concrete \_\_\_\_\_

Asphalt \_\_\_\_\_

Sidewalk \_\_\_\_\_

Size of Cut: Sq. Ft. \_\_\_\_\_ Inches \_\_\_\_\_

Paved by \_\_\_\_\_ Type \_\_\_\_\_

Bill No. \_\_\_\_\_

Charges Backfill \_\_\_\_\_

Paving \_\_\_\_\_

Paving Insp. \_\_\_\_\_

Traffic Striping Replaced \_\_\_\_\_ Date \_\_\_\_\_

**APPROVED** Engineering Services \_\_\_\_\_ Date 7/16/93

Planning \_\_\_\_\_ Date \_\_\_\_\_

Field Services \_\_\_\_\_ Date \_\_\_\_\_

Construction \_\_\_\_\_ Date \_\_\_\_\_

Traffic Engineering \_\_\_\_\_ Date \_\_\_\_\_

Electrical Engineering \_\_\_\_\_ Date \_\_\_\_\_

DIRECTOR OF PUBLIC WORKS

APPROVED BY: \_\_\_\_\_

DATE: 7/16/93

EXTENSION GRANTED BY: \_\_\_\_\_

DATE: \_\_\_\_\_

OWNER/BUILDER

WORKER'S COMPENSATION