



**CONESTOGA-ROVERS
& ASSOCIATES**

5900 Hollis Street, Suite A
Emeryville, California 94608
Telephone: (510) 420-0700 Fax: (510) 420-9170
www.CRAworld.com

TRANSMITTAL

DATE: February 8, 2012 REFERENCE NO.: 240554
PROJECT NAME: 3420 San Pablo Avenue, Oakland
TO: Jerry Wickham
Alameda County Environmental Health
1131 Harbor Bay Parkway, Suite 250
Alameda, CA 94502-6577

RECEIVED

3:52 pm, Feb 15, 2012
Alameda County
Environmental Health

Please find enclosed: Draft Final
 Originals Other
 Prints

Sent via: Mail Same Day Courier
 Overnight Courier Other GeoTracker and Alameda County FTP

QUANTITY	DESCRIPTION
1	Subsurface Investigation Report

As Requested For Review and Comment
 For Your Use _____

COMMENTS:
If you have any questions regarding the contents of this document, please call Peter Schaefer at (510) 420-3319.

Copy to: Denis Brown, Shell Oil Products US (electronic copy)
Shahriar Almasi, Portola Valley Shell (property owner), 965 Laurel Glen Drive, Palo Alto, CA 94304

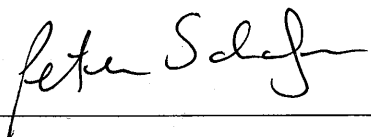
Completed by: Peter Schaefer Signed: 

Filing: **Correspondence File**



Jerry Wickham
Alameda County Environmental Health
1131 Harbor Bay Parkway, Suite 250
Alameda, California 94502-6577

Denis L. Brown
Shell Oil Products US
HSE – Environmental Services
20945 S. Wilmington Ave.
Carson, CA 90810-1039
Tel (707) 865 0251
Fax (707) 865 2542
Email denis.l.brown@shell.com

Re: Former Shell Service Station
3420 San Pablo Avenue
Oakland, California
SAP Code 139619
Incident No. 98995748
ACEH Case No. RO0000006

Dear Mr. Wickham:

The attached document is provided for your review and comment. Upon information and belief, I declare, under penalty of perjury, that the information contained in the attached document is true and correct.

If you have any questions or concerns, please call me at (707) 865-0251.

Sincerely,

A handwritten signature in cursive script, appearing to read "Denis L. Brown", is written over a horizontal line.

Denis L. Brown
Senior Program Manager



SUBSURFACE INVESTIGATION REPORT

**FORMER SHELL SERVICE STATION
3420 SAN PABLO AVENUE
OAKLAND, CALIFORNIA**

**SAP CODE 139619
INCIDENT NO. 98995748
AGENCY NO. RO0000006**

**FEBRUARY 8, 2012
REF. NO. 240554 (12)**
This report is printed on recycled paper.

**Prepared by:
Conestoga-Rovers
& Associates**

5900 Hollis Street, Suite A
Emeryville, California
U.S.A. 94608

Office: (510) 420-0700
Fax: (510) 420-9170

web: <http://www.CRAworld.com>

TABLE OF CONTENTS

	<u>Page</u>
EXECUTIVE SUMMARY	i
1.0 INTRODUCTION.....	1
2.0 INVESTIGATION RESULTS	1
2.1 PERMIT	1
2.2 DRILLING DATE.....	1
2.3 DRILLING COMPANY	1
2.4 CRA PERSONNEL.....	2
2.5 DRILLING METHOD.....	2
2.6 NUMBER OF BORINGS	2
2.7 BORING DEPTHS.....	2
2.8 WASTE DISPOSAL.....	2
3.0 FINDINGS	2
3.1 SOIL	2
4.0 CONCLUSIONS	3
5.0 RECOMMENDATIONS.....	3

LIST OF FIGURES
(Following Text)

- FIGURE 1 VICINITY MAP
FIGURE 2 SOIL CONCENTRATION MAP

LIST OF TABLES
(Following Text)

- TABLE 1 HISTORICAL SOIL ANALYTICAL DATA

LIST OF APPENDICES

- APPENDIX A PERMIT
APPENDIX B BORING LOGS
APPENDIX C CERTIFIED ANALYTICAL REPORT

EXECUTIVE SUMMARY

- CRA drilled six soil borings (SB-7 through SB-12) during this investigation to evaluate soil conditions in the area of previous soil borings SB-1, SB-2, and SB-3 and soil sample P-7.
- All TPHg and BTEX detections were below RWQCB ESLs for soil where groundwater is not a drinking water source, with the exception of the TPHg (180 mg/kg) in boring SB-12 at 5 fbg which equals the RWQCB ESL.
- Soil samples from soil borings SB-7 through SB-12 adequately delineate the previous TPHg and BTEX soil impacts to RWQCB ESLs.
- All lead detections were below the RWQCB ESL, with the exception of 990 mg/kg lead in SB-10 at 2 fbg.
- Soil samples from soil borings SB-1, SB-7, SB-8, SB-9, SB-11, and SB-12 adequately delineate lead impacts in the area of soil sample P-7 to below the RWQCB ESL.
- We recommend three additional soil borings south and east of SB-10 to further delineate lead impacts in shallow soils.

1.0 INTRODUCTION

Conestoga-Rovers & Associates (CRA) prepared this report on behalf of Equilon Enterprises LLC dba Shell Oil Products US (Shell) to document the recent subsurface investigation at this site. The purpose of the investigation was to evaluate soil conditions in the area of previous soil borings SB-1, SB-2, and SB-3 and soil sample P-7. CRA followed the scope of work and procedures presented in our September 27, 2011 *Subsurface Investigation Work Plan* (work plan), which was approved in Alameda County Environmental Health's (ACEH's) October 31, 2011 letter.

Per CRA's September 21, 2011 telephone conversation with ACEH, we will postpone proposing the soil vapor investigation requested in ACEH's July 25, 2011 letter pending refinement of the State Water Resources Control Board's low-threat underground storage tank closure policy.

The subject site is a former Shell service station located at the southeast corner of the San Pablo Avenue and 35th Street intersection in a mixed commercial and residential neighborhood of Oakland, California (Figure 1). Shell sold the station and property in March 2005. The site is currently an operating third-party service station (Figure 2).

A summary of previous work performed at the site and additional background information is presented in our work plan and is not repeated herein.

2.0 INVESTIGATION RESULTS

2.1 PERMIT

CRA obtained a drilling permit from Alameda County Public Works Agency (Appendix A).

2.2 DRILLING DATE

January 16, 2012.

2.3 DRILLING COMPANY

Vapor Tech Services.

2.4 CRA PERSONNEL

Environmental scientist Cristina Arganbright directed the drilling activities under the supervision of California Professional Geologist Peter Schaefer.

2.5 DRILLING METHOD

Water-knife.

2.6 NUMBER OF BORINGS

Six soil borings (SB-7 through SB-12) were drilled during this investigation.

The boring specifications and soil types encountered are described on the boring logs contained in Appendix B. The boring locations are shown on Figure 2.

2.7 BORING DEPTHS

5.5 feet below grade (fbg).

2.8 WASTE DISPOSAL

Sludge generated during field activities was temporarily stored on site in two 55-gallon drums, sampled, and profiled for disposal. Waste disposal analytical data and confirmation documentation is pending and will be provided by CRA upon request.

3.0 FINDINGS

3.1 SOIL

The soil chemical analytical data are summarized in Table 1, and total petroleum hydrocarbons as gasoline (TPHg), benzene, and total lead analytical results are presented on Figure 2. The laboratory analytical report is presented in Appendix C.

4.0 CONCLUSIONS

All TPHg and benzene, toluene, ethylbenzene, and total xylenes (BTEX) detections were below San Francisco Bay Regional Water Quality Control Board (RWQCB) environmental screening levels¹ (ESLs) for soil where groundwater is not a drinking water source, with the exception of the TPHg (180 milligrams per kilogram [mg/kg]) in boring SB-12 at 5 fbg which equals the RWQCB ESL.

Soil samples from soil borings SB-7 through SB-12 adequately delineate TPHg and BTEX soil impacts noted at 2 fbg in SB-2 and at 5 fbg in SB-3 to RWQCB ESLs. We note that soil impacts detected in soil boring SB-1 at 8 fbg are likely associated with groundwater impacts.

All lead detections were below the RWQCB ESL, with the exception of 990 mg/kg lead in SB-10 at 2 fbg.

Soil samples from soil borings SB-1, SB-7, SB-8, SB-9, SB-11, and SB-12 adequately delineate lead impacts in the area of soil sample P-7 to below the RWQCB ESL.

5.0 RECOMMENDATIONS

CRA recommends three additional soil borings south and east of SB-10 to further delineate lead impacts in shallow soils. The proposed boring locations are shown in Figure 2, and we propose to follow the procedures detailed in our September 27, 2011 work plan, with the exception that the soil samples will be analyzed for lead only. In addition, we recommend continued groundwater monitoring to further assess the stability of the groundwater plume.

¹ *Screening for Environmental Concerns at Sites With Contaminated Soil and Groundwater, California Regional Water Quality Control Board, Interim Final - November 2007 [Revised May 2008]*

All of Which is Respectfully Submitted,
CONESTOGA-ROVERS & ASSOCIATES

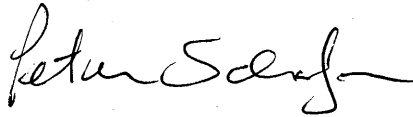

Peter Schaefer, CEG, CHG

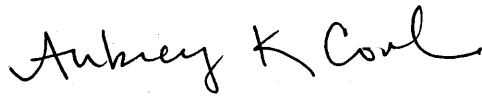

Aubrey K. Cool, PG



FIGURES

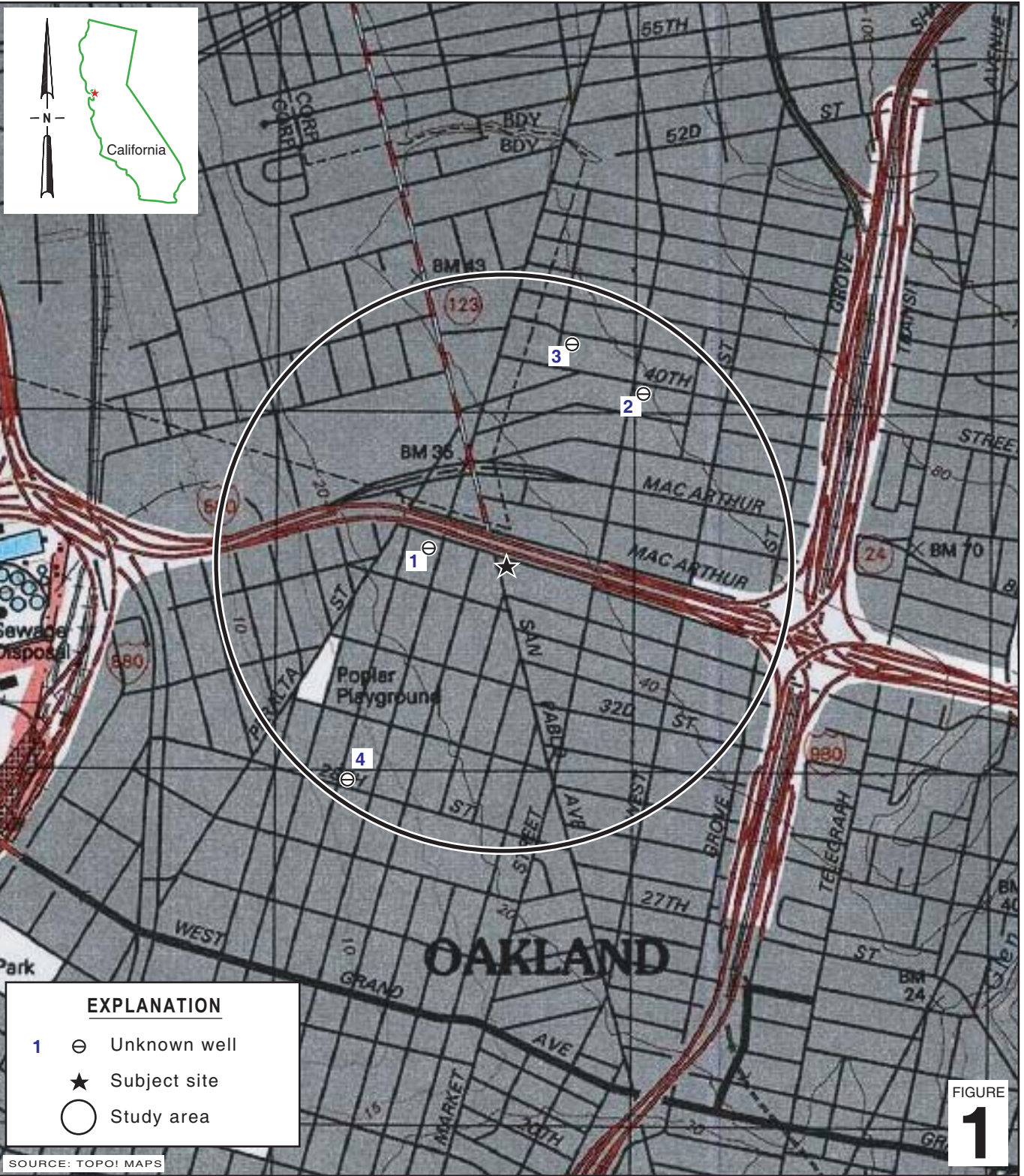

I:\Shell\6-chars\2405--\240554-Oakland 3420 San Pablo\240554-FIGURES\240554 VICINITY.A1

Former Shell Service Station
 3420 San Pablo Avenue
 Oakland, California



**CONESTOGA-ROVERS
 & ASSOCIATES**

Vicinity Map

Sample ID	Sample Date	Sample Depth	TPHg	Benzene	Total Lead
SB-10-1'	01/16/2012	1	0.12	0.017	990
SB-10-2'	01/16/2012	2	0.67	0.0036	140
SB-10-5'	01/16/2012	5	3.1	0.0016	8.7

Sample ID	Sample Date	Sample Depth	TPHg	Benzene	Total Lead
SB-1-2	10/04/2006	2	<1.0	0.011	620
SB-1-5	10/04/2006	5	6.9	0.0066	140
SB-1-8	10/04/2006	8	46,000	<25	250

Sample ID	Sample Date	Sample Depth	TPHg	Benzene	Total Lead
SB-9-1'	01/16/2012	1	0.12	0.0025	97
SB-9-2'	01/16/2012	2	<0.083	0.0048	720
SB-9-5'	01/16/2012	5	<0.20	<0.0010	7.7

Sample ID	Sample Date	Sample Depth	TPHg	Benzene	Total Lead
SB-8-1'	01/16/2012	1	<0.085	0.0023	160
SB-8-2'	01/16/2012	2	<0.096	0.0044	250
SB-8-5'	01/16/2012	5	1.7	<0.00098	4.9

Sample ID	Sample Date	Sample Depth	TPHg	Benzene	Total Lead
P-7-2.0	10/04/2006	2	4.5	0.040	2,000

Sample ID	Sample Date	Sample Depth	TPHg	Benzene	Total Lead
SB-3-2	10/04/2006	2	4.7	0.058	58
SB-3-5	10/04/2006	5	11,000	<25	<20
SB-3-8	10/04/2006	8	27	<0.12	<20

Sample ID	Sample Date	Sample Depth	TPHg	Benzene	Total Lead
SB-7-1'	01/16/2012	1	<0.099	0.0020	79
SB-7-2'	01/16/2012	2	<0.12	0.0023	340
SB-7-5'	01/16/2012	5	<0.20	<0.00099	5.2

Sample ID	Sample Date	Sample Depth	TPHg	Benzene	Total Lead
SB-12-1'	01/16/2012	1	0.20	0.031	60
SB-12-2'	01/16/2012	2	2.8	0.20	200
SB-12-5'	01/16/2012	5	180	0.22	4.8

Sample ID	Sample Date	Sample Depth	TPHg	Benzene	Total Lead
SB-2-2	10/04/2006	2	12,000	74	180
SB-2-5	10/04/2006	5	1.8	<0.0050	<20
SB-2-8	10/04/2006	8	160	<0.12	<20

Sample ID	Sample Date	Sample Depth	TPHg	Benzene	Total Lead
SB-11-1'	01/16/2012	1	0.72	0.065	260
SB-11-2'	01/16/2012	2	1.7	0.16	200
SB-11-5'	01/16/2012	5	2.9	0.10	6.1

EXPLANATION

- Proposed soil boring location
- SB-7 Soil boring location (CRA, 2012)
- MW-1 Monitoring well location (Shell)
- MW-3 Destroyed monitoring well location
- MW-1 Monitoring well location (Thrifty)
- RW-1R Recovery well location (Thrifty)
- Storm drain line (STM)
- Sanitary Sewer line (SAN)
- Water line (W)
- Overhead electrical line (OE)
- Electrical line (E)
- Storm drain catch basin
- Fire hydrant (FH)
- Flow direction indicator
- Miscellaneous utility vault, as labeled
- SB-1 Soil boring location (Cambria, 2006)
- B-1 Soil boring location (ENSCO, 1988)
- P-1 Soil sample location (Cambria, 1997)
- B-1 Soil boring location (Thrifty)
- B-1 Soil boring location (Thrifty, 1987)
- SB1 Soil boring location (Thrifty, 1986)

Sample ID	Sample Date	Sample Depth	TPHg	Benzene	Total Lead
SB-1-2	10/04/2006	2	<1.0	0.011	620
SB-1-5	10/04/2006	5	6.9	0.0066	140
SB-1-8	10/04/2006	8	46,000	<25	250

Notes:
Soil sample ID, date, depth in feet below grade, and concentrations in milligrams per kilogram
TPHg = Total petroleum hydrocarbons as gasoline
<X = Not detected at reporting limit X
Results in **BOLD** equal or exceed ESL

I:\Shell\6-chars\2405-1\240554-Oakland 3420 San Pablo\240554-FIGURES\240554 SITE PLAN.DWG

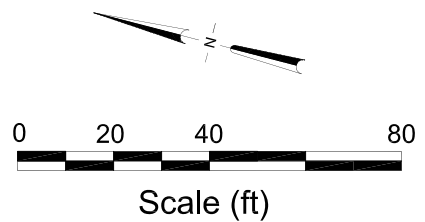
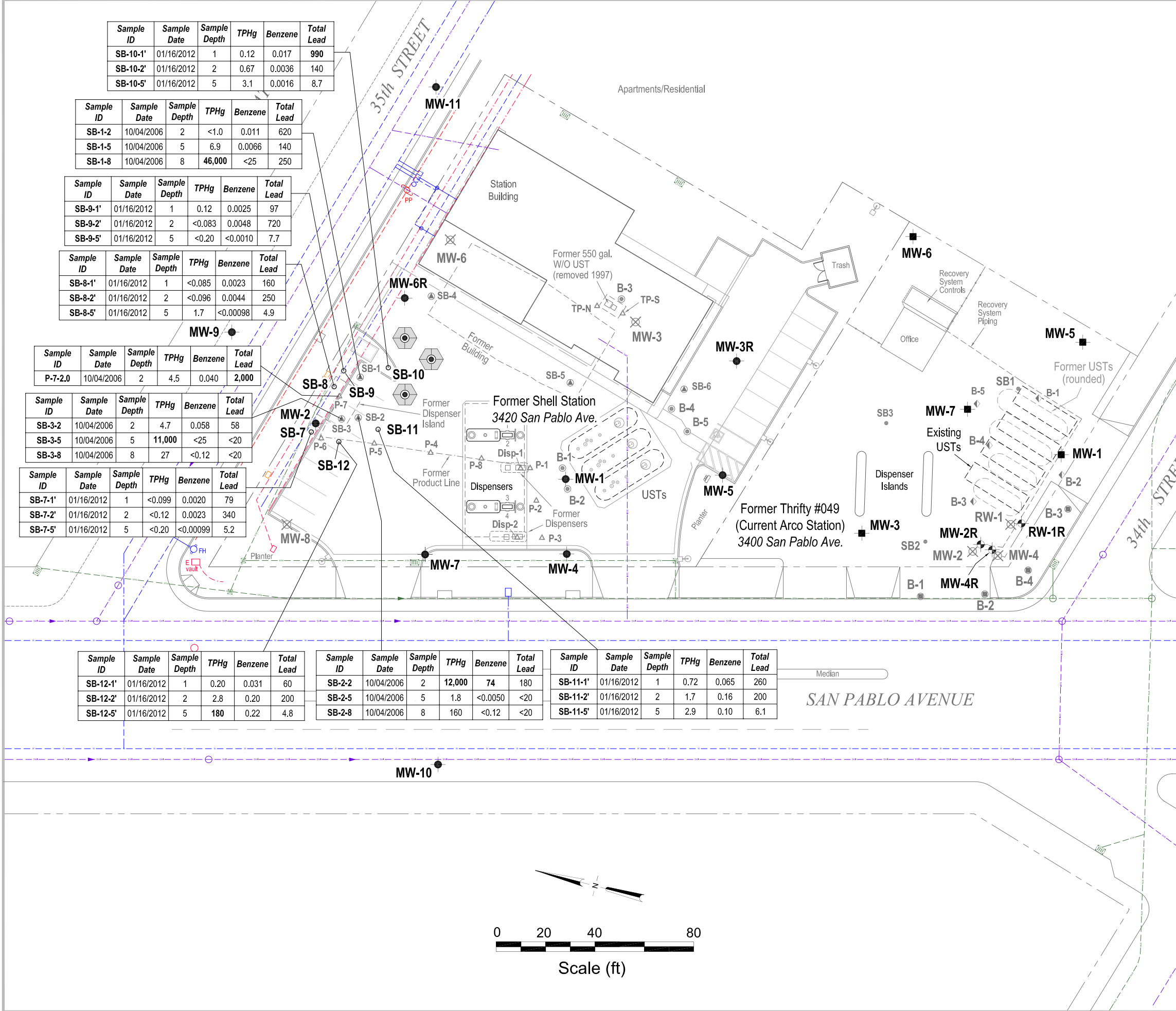

FIGURE
2

TABLE

**HISTORICAL SOIL ANALYTICAL DATA
FORMER SHELL SERVICE STATION
3420 SAN PABLO AVENUE, OAKLAND, CALIFORNIA**

<i>Sample ID</i>	<i>Date</i>	<i>Depth (fbg)</i>	<i>TPHg (mg/kg)</i>	<i>B (mg/kg)</i>	<i>T (mg/kg)</i>	<i>E (mg/kg)</i>	<i>X (mg/kg)</i>	<i>MTBE (mg/kg)</i>	<i>Total Lead (mg/kg)</i>
B-1	8/8/1988	5 - 5.5	1,400	1.9	42	43	120	---	---
B-1	8/8/1988	9.5 - 10	80	---	---	---	---	---	---
B-1	8/8/1988	15 - 15.5	<5.0	---	---	---	---	---	---
B-1	8/8/1988	20 - 20.5	<5.0	---	---	---	---	---	---
B-2	8/8/1988	5 - 5.5	550	1.5	16	35	33	---	---
B-2	8/8/1988	10 - 10.5	580	0.7	3.3	7.8	48	---	---
B-3	8/8/1988	5, 10, and 15	<5.0	---	---	---	---	---	---
B-4	8/8/1988	5, 10, and 15	<5.0	---	---	---	---	---	---
B-5	8/8/1988	5, 10, and 15	<5.0	---	---	---	---	---	---
MW-1	4/10/1989	5.5 - 6	850	1.2	14	19	100	---	4
MW-1	4/10/1989	10.5 - 11	80	<0.05	1.9	1.9	16	---	3
MW-2	4/10/1989	10.5 - 11	70	0.4	1.5	1.7	1.5	---	8
MW-3	4/10/1989	10.5 - 11	<0.2	<0.002	0.010	0.008	0.069	---	3
MW-4	4/10/1989	10.5 - 11	<0.2	<0.002	0.005	0.004	0.031	---	2
MW-5	1/19/1990	5.5 - 6	5.0	<0.05	<0.1	<0.1	<0.1	---	---
MW-6	1/19/1990	5.5 - 6	<1.0	<0.05	<0.1	<0.1	<0.1	---	---
MW-7	1/19/1990	5.5 - 6	14	0.078	<0.1	0.21	<0.1	---	---
MW-8	1/18/1990	5.5 - 6	<1.0	<0.05	<0.1	<0.1	<0.1	---	---
MW-9	1/18/1990	10.5 - 11	6.1	<0.05	<0.1	0.39	0.14	---	---
MW-10	10/23/1991	5	1.4	0.015	0.006	0.010	0.008	---	---
MW-10	10/23/1991	10	1.8	0.06	<0.0050	0.027	0.0070	---	---
MW-11	10/23/1991	5	<1.0	<0.0050	<0.0050	<0.0050	<0.0050	---	---
MW-11	10/23/1991	10	<1.0	<0.0050	<0.0050	<0.0050	<0.0050	---	---
Disp-1-2.5	6/26/1997	2.5	8.4	0.054	0.046	0.0094	0.21	1.6	5.8
Disp-2-2.0	6/26/1997	2	51	0.075	1.6	0.38	1.6	7.9	9.6
TP-N-7	6/26/1997	7	<1.0	<0.0050	<0.0050	<0.0050	<0.0050	<0.025	<5.0
TP-S-7	6/26/1997	7	<1.0	<0.0050	<0.0050	<0.0050	<0.0050	<0.025	6.4
P-1-2.5	6/26/1997	2.5	39	0.13	0.051	0.012	0.032	0.82	7.4
P-2-2.5	6/26/1997	2.5	17	0.035	0.079	0.063	0.11	0.33	7.4
P-3-2.5	6/26/1997	2.5	16	0.028	0.059	0.019	0.026	0.092	6.9
P-4-4.0	6/26/1997	4	19	0.041	0.053	<0.010	0.078	<0.050	7.4
P-5-4.0	6/26/1997	4	3.1	0.016	0.0054	<0.0050	0.018	0.028	7.4
P-6-2.5	6/26/1997	2.5	<1.0	<0.0050	<0.0050	<0.0050	<0.0050	<0.025	33

**HISTORICAL SOIL ANALYTICAL DATA
FORMER SHELL SERVICE STATION
3420 SAN PABLO AVENUE, OAKLAND, CALIFORNIA**

<i>Sample ID</i>	<i>Date</i>	<i>Depth (fbg)</i>	<i>TPHg (mg/kg)</i>	<i>B (mg/kg)</i>	<i>T (mg/kg)</i>	<i>E (mg/kg)</i>	<i>X (mg/kg)</i>	<i>MTBE (mg/kg)</i>	<i>Total Lead (mg/kg)</i>
B-1	8/8/1988	5 - 5.5	1,400	1.9	42	43	120	---	---
B-1	8/8/1988	9.5 - 10	80	---	---	---	---	---	---
B-1	8/8/1988	15 - 15.5	<5.0	---	---	---	---	---	---
B-1	8/8/1988	20 - 20.5	<5.0	---	---	---	---	---	---
B-2	8/8/1988	5 - 5.5	550	1.5	16	35	33	---	---
B-2	8/8/1988	10 - 10.5	580	0.7	3.3	7.8	48	---	---
B-3	8/8/1988	5, 10, and 15	<5.0	---	---	---	---	---	---
B-4	8/8/1988	5, 10, and 15	<5.0	---	---	---	---	---	---
B-5	8/8/1988	5, 10, and 15	<5.0	---	---	---	---	---	---
MW-1	4/10/1989	5.5 - 6	850	1.2	14	19	100	---	4
MW-1	4/10/1989	10.5 - 11	80	<0.05	1.9	1.9	16	---	3
MW-2	4/10/1989	10.5 - 11	70	0.4	1.5	1.7	1.5	---	8
MW-3	4/10/1989	10.5 - 11	<0.2	<0.002	0.010	0.008	0.069	---	3
MW-4	4/10/1989	10.5 - 11	<0.2	<0.002	0.005	0.004	0.031	---	2
MW-5	1/19/1990	5.5 - 6	5.0	<0.05	<0.1	<0.1	<0.1	---	---
MW-6	1/19/1990	5.5 - 6	<1.0	<0.05	<0.1	<0.1	<0.1	---	---
MW-7	1/19/1990	5.5 - 6	14	0.078	<0.1	0.21	<0.1	---	---
MW-8	1/18/1990	5.5 - 6	<1.0	<0.05	<0.1	<0.1	<0.1	---	---
MW-9	1/18/1990	10.5 - 11	6.1	<0.05	<0.1	0.39	0.14	---	---
MW-10	10/23/1991	5	1.4	0.015	0.006	0.010	0.008	---	---
MW-10	10/23/1991	10	1.8	0.06	<0.0050	0.027	0.0070	---	---
MW-11	10/23/1991	5	<1.0	<0.0050	<0.0050	<0.0050	<0.0050	---	---
MW-11	10/23/1991	10	<1.0	<0.0050	<0.0050	<0.0050	<0.0050	---	---
Disp-1-2.5	6/26/1997	2.5	8.4	0.054	0.046	0.0094	0.21	1.6	5.8
Disp-2-2.0	6/26/1997	2	51	0.075	1.6	0.38	1.6	7.9	9.6
TP-N-7	6/26/1997	7	<1.0	<0.0050	<0.0050	<0.0050	<0.0050	<0.025	<5.0
TP-S-7	6/26/1997	7	<1.0	<0.0050	<0.0050	<0.0050	<0.0050	<0.025	6.4
P-1-2.5	6/26/1997	2.5	39	0.13	0.051	0.012	0.032	0.82	7.4
P-2-2.5	6/26/1997	2.5	17	0.035	0.079	0.063	0.11	0.33	7.4
P-3-2.5	6/26/1997	2.5	16	0.028	0.059	0.019	0.026	0.092	6.9
P-4-4.0	6/26/1997	4	19	0.041	0.053	<0.010	0.078	<0.050	7.4
P-5-4.0	6/26/1997	4	3.1	0.016	0.0054	<0.0050	0.018	0.028	7.4
P-6-2.5	6/26/1997	2.5	<1.0	<0.0050	<0.0050	<0.0050	<0.0050	<0.025	33

**HISTORICAL SOIL ANALYTICAL DATA
FORMER SHELL SERVICE STATION
3420 SAN PABLO AVENUE, OAKLAND, CALIFORNIA**

<i>Sample ID</i>	<i>Date</i>	<i>Depth (fbg)</i>	<i>TPHg (mg/kg)</i>	<i>B (mg/kg)</i>	<i>T (mg/kg)</i>	<i>E (mg/kg)</i>	<i>X (mg/kg)</i>	<i>MTBE (mg/kg)</i>	<i>Total Lead (mg/kg)</i>
P-7-2.0	6/26/1997	2	4.5	0.040	0.0097	0.0095	0.053	<0.025	2,000
P-8-2.5	6/26/1997	2.5	120	<0.12	0.43	0.33	0.42	<0.62	8.2
SB-1-2	10/4/2006	2	<1.0	0.011	<0.0050	0.0058	0.017	0.0096	620
SB-1-5	10/4/2006	5	6.9	0.0066	<0.0050	<0.0050	<0.010	<0.0050	140
SB-1-8	10/4/2006	8	46,000	<25	<25	<25	<50	<25	250
SB-2-2	10/4/2006	2	12,000	74	<25	<25	82	<25	180
SB-2-5	10/4/2006	5	1.8	<0.0050	<0.0050	<0.0050	<0.010	<0.0050	<20
SB-2-8	10/4/2006	8	160	<0.12	<0.12	2.2	1.3	<0.12	<20
SB-3-2	10/4/2006	2	4.7	0.058	0.0075	0.018	0.079	0.15	58
SB-3-5	10/4/2006	5	11,000	<25	<25	<25	<50	<25	<20
SB-3-8	10/4/2006	8	27	<0.12	<0.12	<0.12	<0.25	<0.12	<20
SB-4-4.5	10/4/2006	4.5	<1.0	<0.0050	<0.0050	<0.0050	<0.010	<0.0050	<5
SB-5-4.5	10/4/2006	4.5	2.9	<0.0050	<0.0050	<0.0050	<0.010	0.059	<5
SB-6-4.5	10/4/2006	4.5	7.2	0.012	0.017	0.018	0.16	<0.0050	29
SB-7-1'	1/16/2012	1	<0.099	0.0020	<0.0020	<0.0020	<0.0040	<0.0050	79
SB-7-2'	1/16/2012	2	<0.12	0.0023	<0.0023	<0.0023	<0.0046	0.0058	340
SB-7-5'	1/16/2012	5	<0.20	<0.00099	<0.00099	<0.00099	<0.0020	<0.0020	5.2
SB-8-1'	1/16/2012	1	<0.085	0.0023	<0.0017	<0.0017	<0.0034	<0.0043	160
SB-8-2'	1/16/2012	2	<0.096	0.0044	<0.0019	<0.0019	<0.0039	<0.0048	250
SB-8-5'	1/16/2012	5	1.7	<0.00098	<0.00098	<0.00098	<0.0020	<0.0020	4.9
SB-9-1'	1/16/2012	1	0.12	0.0025	0.0023	<0.0018	<0.0036	<0.0045	97
SB-9-2'	1/16/2012	2	<0.083	0.0048	<0.0017	<0.0017	<0.0033	<0.0042	720
SB-9-5'	1/16/2012	5	<0.20	<0.0010	<0.0010	<0.0010	<0.0020	<0.0020	7.7
SB-10-1'	1/16/2012	1	0.12	0.017	0.0028	<0.0022	<0.0044	<0.0056	990
SB-10-2'	1/16/2012	2	0.67	0.0036	<0.0019	<0.0019	<0.0039	<0.0048	140
SB-10-5'	1/16/2012	5	3.1	0.0016	<0.0010	<0.0010	<0.0020	<0.0020	8.7
SB-11-1'	1/16/2012	1	0.72	0.065	0.0070	0.0071	0.022	0.012	260
SB-11-2'	1/16/2012	2	1.7	0.16	0.0070	0.019	0.049	0.021	200
SB-11-5'	1/16/2012	5	2.9	0.10	0.0010	0.042	0.0074	0.030	6.1
SB-12-1'	1/16/2012	1	0.20	0.031	0.0041	0.0040	0.015	0.0061	60
SB-12-2'	1/16/2012	2	2.8	0.20	0.011	0.025	0.097	0.029	200
SB-12-5'	1/16/2012	5	180	0.22	<0.050	1.6	<0.10	<0.10	4.8

<i>Shallow Soil (≤10 fbg) ESL^a:</i>	180	0.27	9.3	4.7	11	8.4	750
<i>Deep Soil (>10 fbg) ESL^a:</i>	180	2.0	9.3	4.7	11	8.4	750

**HISTORICAL SOIL ANALYTICAL DATA
FORMER SHELL SERVICE STATION
3420 SAN PABLO AVENUE, OAKLAND, CALIFORNIA**

<i>Sample ID</i>	<i>Date</i>	<i>Depth</i> <i>(fbg)</i>	<i>TPHg</i> <i>(mg/kg)</i>	<i>B</i> <i>(mg/kg)</i>	<i>T</i> <i>(mg/kg)</i>	<i>E</i> <i>(mg/kg)</i>	<i>X</i> <i>(mg/kg)</i>	<i>MTBE</i> <i>(mg/kg)</i>	<i>Total Lead</i> <i>(mg/kg)</i>
------------------	-------------	------------------------------	-------------------------------	----------------------------	----------------------------	----------------------------	----------------------------	-------------------------------	-------------------------------------

Notes:

TPHg = Total petroleum hydrocarbons as gasoline analyzed by EPA Method 8260B; prior to June 26, 1997, analyzed by EPA Method 8015M

BTEX = Benzene, toluene, ethylbenzene, and total xylenes analyzed by EPA Method 8260B; prior to June 26, 1997, analyzed by EPA Method 8020

MTBE = Methyl tertiary-butyl ether analyzed by EPA Method 8260B; prior to June 26, 1997, analyzed by EPA Method 8020

Total lead analysis by EPA 6010B; prior to April 11, 1989 analyzed by EPA Method 7420

fbg = Feet below grade

mg/kg = Milligrams per kilogram

<x = Not detected at reporting limit x

--- = Not analyzed

ESL = Environmental screening level

Results in **bold** equal or exceed applicable ESL

a = San Francisco Bay Regional Water Quality Control Board commercial/industrial ESL for soil where groundwater is not a source of drinking water (Tables B and D of *Screening for Environmental Concerns at Sites With Contaminated Soil and Groundwater*, California Regional Water Quality Control Board, Interim Final - November 2007 [Revised May 2008]).

APPENDIX A

PERMIT

Alameda County Public Works Agency - Water Resources Well Permit

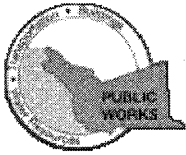

399 Elmhurst Street
Hayward, CA 94544-1395
Telephone: (510)670-6633 Fax:(510)782-1939

Application Approved on: 12/28/2011 By jamesy

Permit Numbers: W2011-0786
Permits Valid from 01/17/2012 to 01/17/2012

Application Id: 1324580769962
Site Location: 3420 San Pablo Ave, Oakland

City of Project Site:Oakland

Project Start Date: 01/17/2012
Assigned Inspector: Contact Steve Miller at (510) 670-5517 or stevem@acpwa.org

Completion Date:01/17/2012

Applicant: Conestoga-Rovers and Associates - Cristina
Arganbright
19449 Riverside Drive, Sonoma, CA 95476
Property Owner: Portolla Valley Shell
965 Laural Glen Drive, Palo Alto, CA 94304
Client: Shell Oil Products US
20945 S Wilmington Ave, Carson, CA 90815

Phone: 707-933-2377

Phone: --

Phone: --

Receipt Number: WR2011-0385 Total Due: \$265.00
Total Amount Paid: \$265.00
Payer Name : Conestoga-Rovers and Associates Paid By: CHECK PAID IN FULL

Works Requesting Permits:

Borehole(s) for Investigation-Contamination Study - 6 Boreholes
Driller: Vapor Tech Services - Lic #: 916085 - Method: other

Work Total: \$265.00

Specifications

Permit Number	Issued Dt	Expire Dt	# Boreholes	Hole Diam	Max Depth
W2011-0786	12/28/2011	04/16/2012	6	2.00 in.	5.00 ft

Specific Work Permit Conditions

1. Backfill bore hole by tremie with cement grout or cement grout/sand mixture. Upper two-three feet replaced in kind or with compacted cuttings. All cuttings remaining or unused shall be containerized and hauled off site. The containers shall be clearly labeled to the ownership of the container and labeled hazardous or non-hazardous.
2. Boreholes shall not be left open for a period of more than 24 hours. All boreholes left open more than 24 hours will need approval from Alameda County Public Works Agency, Water Resources Section. All boreholes shall be backfilled according to permit destruction requirements and all concrete material and asphalt material shall be to Caltrans Spec or County/City Codes. No borehole(s) shall be left in a manner to act as a conduit at any time.
3. Permittee shall assume entire responsibility for all activities and uses under this permit and shall indemnify, defend and save the Alameda County Public Works Agency, its officers, agents, and employees free and harmless from any and all expense, cost, liability in connection with or resulting from the exercise of this Permit including, but not limited to, properly damage, personal injury and wrongful death.
4. Prior to any drilling activities, it shall be the applicant's responsibility to contact and coordinate an Underground Service Alert (USA), obtain encroachment permit(s), excavation permit(s) or any other permits or agreements required for that Federal, State, County or City, and follow all City or County Ordinances. No work shall begin until all the permits and requirements have been approved or obtained. It shall also be the applicants responsibilities to provide to the Cities

Alameda County Public Works Agency - Water Resources Well Permit

or to Alameda County an Traffic Safety Plan for any lane closures or detours planned. No work shall begin until all the permits and requirements have been approved or obtained.

5. Applicant shall contact Steve Miller for an inspection time at (510) 670-5517 or email to stevem@acpwa.org at least five (5) working days prior to starting, once the permit has been approved. Confirm the scheduled date(s) at least 24 hours prior to drilling.

6. Copy of approved drilling permit must be on site at all times. Failure to present or show proof of the approved permit application on site shall result in a fine of \$500.00.

7. Permit is valid only for the purpose specified herein. No changes in construction procedures, as described on this permit application. Boreholes shall not be converted to monitoring wells, without a permit application process.

APPENDIX B
BORING LOGS



Conestoga - Rovers & Associates
 5900 Hollis Street, Suite A
 Emeryville, CA 94608
 Telephone: 510-420-0700
 Fax: 510-420-9170

BORING / WELL LOG

CLIENT NAME	Shell Oil Products US	BORING/WELL NAME	SB-7
JOB/SITE NAME	Former Shell Service Station	DRILLING STARTED	16-Jan-12
LOCATION	3420 San Pablo Avenue, Oakland, Ca	DRILLING COMPLETED	16-Jan-12
PROJECT NUMBER	240554	WELL DEVELOPMENT DATE (YIELD)	NA
DRILLER	Vapor Tech Services	GROUND SURFACE ELEVATION	NA
DRILLING METHOD	Water-knife	TOP OF CASING ELEVATION	NA
BORING DIAMETER	4"	SCREENED INTERVALS	NA
LOGGED BY	C. Arganbright	DEPTH TO WATER (First Encountered)	NA
REVIEWED BY	P. Schaefer PG 5612	DEPTH TO WATER (Static)	NA
REMARKS			

PID (ppm)	BLOW COUNTS	SAMPLE ID	EXTENT DEPTH (fbg)	U.S.C.S.	GRAPHIC LOG	LITHOLOGIC DESCRIPTION	CONTACT DEPTH (fbg)	WELL DIAGRAM
						Sod	0.3	
3.0		SB-7-1'				Silty SAND (SM) ; grayish green (10Y 4/2); dry; 30% silt, 70% fine to coarse sand.		
2.3		SB-7-2'		SM		@ 2' - 20% silt, 70% fine to coarse sand, 10% coarse gravel.		
						SILT (ML) ; very dark gray (10YR 3/1); dry; 10% clay, 85% silt, 5% coarse sand; low plasticity.	3.0	← Portland Type III
2.2		SB-7-5'	5	ML			5.5	
								Bottom of Boring @ 5.5 fbg

WELL LOG (PID) I:\SHELL\6-CHARS\2405-1240554-12443F7-1240554-3420_SAN_PABLO.GPJ_DEFAULT.GDT 2/7/12



Conestoga - Rovers & Associates
 5900 Hollis Street, Suite A
 Emeryville, CA 94608
 Telephone: 510-420-0700
 Fax: 510-420-9170

BORING / WELL LOG

CLIENT NAME	Shell Oil Products US	BORING/WELL NAME	SB-8
JOB/SITE NAME	Former Shell Service Station	DRILLING STARTED	16-Jan-12
LOCATION	3420 San Pablo Avenue, Oakland, Ca	DRILLING COMPLETED	16-Jan-12
PROJECT NUMBER	240554	WELL DEVELOPMENT DATE (YIELD)	NA
DRILLER	Vapor Tech Services	GROUND SURFACE ELEVATION	NA
DRILLING METHOD	Water-knife	TOP OF CASING ELEVATION	NA
BORING DIAMETER	4"	SCREENED INTERVALS	NA
LOGGED BY	C. Arganbright	DEPTH TO WATER (First Encountered)	NA
REVIEWED BY	P. Schaefer PG 5612	DEPTH TO WATER (Static)	NA
REMARKS			

WELL LOG (PID) I:\SHELL\6-CHARS\2405-1240554-1244937-1240554-3420_SAN_PABLO.GPJ DEFAULT.GDT 2/7/12

PID (ppm)	BLOW COUNTS	SAMPLE ID	EXTENT	DEPTH (fbg)	U.S.C.S.	GRAPHIC LOG	LITHOLOGIC DESCRIPTION	CONTACT DEPTH (fbg)	WELL DIAGRAM
1.8		SB-8-1'					Sod	0.3	
1.6		SB-8-2'			SW SM		SAND with Silt (SW-SM) ; dark yellowish brown (10YR 3/4); dry; 10% silt, 90% fine to medium sand.		
1.8		SB-8-5'		5	ML		SILT (ML) ; dark greenish gray (10GY 3/1); 5% clay, 85% silt, 10% fine sand; low plasticity.	4.0	
								5.5	Bottom of Boring @ 5.5 fbg



Conestoga - Rovers & Associates
 5900 Hollis Street, Suite A
 Emeryville, CA 94608
 Telephone: 510-420-0700
 Fax: 510-420-9170

BORING / WELL LOG

CLIENT NAME	Shell Oil Products US	BORING/WELL NAME	SB-9
JOB/SITE NAME	Former Shell Service Station	DRILLING STARTED	16-Jan-12
LOCATION	3420 San Pablo Avenue, Oakland, Ca	DRILLING COMPLETED	16-Jan-12
PROJECT NUMBER	240554	WELL DEVELOPMENT DATE (YIELD)	NA
DRILLER	Vapor Tech Services	GROUND SURFACE ELEVATION	NA
DRILLING METHOD	Water-knife	TOP OF CASING ELEVATION	NA
BORING DIAMETER	4"	SCREENED INTERVALS	NA
LOGGED BY	C. Arganbright	DEPTH TO WATER (First Encountered)	NA
REVIEWED BY	P. Schaefer PG 5612	DEPTH TO WATER (Static)	NA
REMARKS			

WELL LOG (PID) I:\SHELL16-CHARS\2405-1240554-12443F7-1240554-3420_SAN_PABLO.GPJ_DEFAULT.GDT 2/7/12

PID (ppm)	BLOW COUNTS	SAMPLE ID	EXTENT DEPTH (fbg)	U.S.C.S.	GRAPHIC LOG	LITHOLOGIC DESCRIPTION	CONTACT DEPTH (fbg)	WELL DIAGRAM
1.8		SB-9-1'				Sod	0.3	
1.6		SB-9-2'		SW SM		SAND with Silt (SW-SM) ; dark yellowish brown (10YR 3/4); dry; 10% silt, 85% fine to medium sand, 5% coarse gravel.		
1.5		SB-9-5'	5	ML		SILT (ML) ; greenish black (10Y 2.5/1); dry; 15% clay, 80% silt, 5% coarse gravel; low plasticity.	4.0	
							5.5	Bottom of Boring @ 5.5 fbg



Conestoga - Rovers & Associates
 5900 Hollis Street, Suite A
 Emeryville, CA 94608
 Telephone: 510-420-0700
 Fax: 510-420-9170

BORING / WELL LOG

CLIENT NAME	Shell Oil Products US	BORING/WELL NAME	SB-10
JOB/SITE NAME	Former Shell Service Station	DRILLING STARTED	16-Jan-12
LOCATION	3420 San Pablo Avenue, Oakland, Ca	DRILLING COMPLETED	16-Jan-12
PROJECT NUMBER	240554	WELL DEVELOPMENT DATE (YIELD)	NA
DRILLER	Vapor Tech Services	GROUND SURFACE ELEVATION	NA
DRILLING METHOD	Water-knife	TOP OF CASING ELEVATION	NA
BORING DIAMETER	4"	SCREENED INTERVALS	NA
LOGGED BY	C. Arganbright	DEPTH TO WATER (First Encountered)	NA
REVIEWED BY	P. Schaefer PG 5612	DEPTH TO WATER (Static)	NA
REMARKS			

WELL LOG (PID) I:\SHELL\6-CHARS\2405-1240554-12443F7-1240554-3420_SAN_PABLO.GPJ DEFAULT.GDT 2/7/12

PID (ppm)	BLOW COUNTS	SAMPLE ID	EXTENT	DEPTH (fbg)	U.S.C.S.	GRAPHIC LOG	LITHOLOGIC DESCRIPTION	CONTACT DEPTH (fbg)	WELL DIAGRAM
							Topsoil	0.3	
0.6		SB-10 -1'			SM		Silty SAND with Gravel (SM) ; dark grayish brown (10YR 4/2); dry; 20% silt, 65% fine to medium sand, 15% coarse gravel.	2.0	
0.8		SB-10 -2'			ML		SILT (ML) ; black (10YR 2/1); dry; 5% clay, 85% silt, 10% medium sand; low plasticity.		
5.9		SB-10 -5'		5			@ 5 - 10% clay, 85% silt, 5% coarse gravel.	5.5	Bottom of Boring @ 5.5 fbg



Conestoga - Rovers & Associates
 5900 Hollis Street, Suite A
 Emeryville, CA 94608
 Telephone: 510-420-0700
 Fax: 510-420-9170

BORING / WELL LOG

CLIENT NAME	Shell Oil Products US	BORING/WELL NAME	SB-11
JOB/SITE NAME	Former Shell Service Station	DRILLING STARTED	16-Jan-12
LOCATION	3420 San Pablo Avenue, Oakland, Ca	DRILLING COMPLETED	16-Jan-12
PROJECT NUMBER	240554	WELL DEVELOPMENT DATE (YIELD)	NA
DRILLER	Vapor Tech Services	GROUND SURFACE ELEVATION	NA
DRILLING METHOD	Water-knife	TOP OF CASING ELEVATION	NA
BORING DIAMETER	4"	SCREENED INTERVALS	NA
LOGGED BY	C. Arganbright	DEPTH TO WATER (First Encountered)	NA
REVIEWED BY	P. Schaefer PG 5612	DEPTH TO WATER (Static)	NA
REMARKS			

PID (ppm)	BLOW COUNTS	SAMPLE ID	EXTENT DEPTH (fbg)	U.S.C.S.	GRAPHIC LOG	LITHOLOGIC DESCRIPTION	CONTACT DEPTH (fbg)	WELL DIAGRAM
						ASPHALT	1.0	<p>Portland Type III</p>
0.1		SB-11 -1'				SILT with Sand (ML) ; black (7.5YR 2.5/1); dry; 5% clay, 75% silt, 15% fine sand, 5% fine gravel with asphalt chunks; low plasticity.		
0.1		SB-11 -2'		ML		@ 3' - SILT (ML) ; black (5Y 2.5/2); 20% clay, 80% silt.		
3.7		SB-11 -5'	5				5.5	Bottom of Boring @ 5.5 fbg

WELL LOG (PID) I:\SHELL\B-CHARS\2405-1240554-12443F7-1240554-3420_SAN_PABLO.GPJ_DEFAULT.GDT 2/7/12



Conestoga - Rovers & Associates
 5900 Hollis Street, Suite A
 Emeryville, CA 94608
 Telephone: 510-420-0700
 Fax: 510-420-9170

BORING / WELL LOG

CLIENT NAME	Shell Oil Products US	BORING/WELL NAME	SB-12
JOB/SITE NAME	Former Shell Service Station	DRILLING STARTED	16-Jan-12
LOCATION	3420 San Pablo Avenue, Oakland, Ca	DRILLING COMPLETED	16-Jan-12
PROJECT NUMBER	240554	WELL DEVELOPMENT DATE (YIELD)	NA
DRILLER	Vapor Tech Services	GROUND SURFACE ELEVATION	NA
DRILLING METHOD	Water-knife	TOP OF CASING ELEVATION	NA
BORING DIAMETER	4"	SCREENED INTERVALS	NA
LOGGED BY	C. Arganbright	DEPTH TO WATER (First Encountered)	NA
REVIEWED BY	P. Schaefer PG 5612	DEPTH TO WATER (Static)	NA
REMARKS			

PID (ppm)	BLOW COUNTS	SAMPLE ID	EXTENT DEPTH (fbg)	U.S.C.S.	GRAPHIC LOG	LITHOLOGIC DESCRIPTION	CONTACT DEPTH (fbg)	WELL DIAGRAM
						<u>ASPHALT</u>		
2.4		SB-12 -1'				<u>Silty GRAVEL with Sand (GM)</u> ; black (7.5YR 2.5/1); dry; 45 % silt, 20% fine to medium sand, 35% coarse gravel with asphalt chunks.	0.8	
1.4		SB-12 -2'			GM	<u>Gravelly SILT with Sand (ML)</u> ; black (2.5Y 2.5/1); dry; 5% clay, 45% silt, 20% fine sand, 30% coarse gravel; low plasticity.	2.0	
								← Portland Type III
103.2		SB-12 -5'	5		ML	@ 5' - <u>SILT (ML)</u> ; 20% clay, 80% silt.	5.5	
								Bottom of Boring @ 5.5 fbg

WELL LOG (PID) I:\SHELL\6-CHARS\2405-1240554-3420_SAN_PABLO.GPJ DEFAULT.GDT 2/7/12

APPENDIX C

CERTIFIED ANALYTICAL REPORT

LABORATORY REPORT

Prepared For: Conestoga-Rovers & Associates - Emeryville Shell
5900 Hollis St., Suite A
Emeryville, CA 94608
Attention: Peter Schaefer

Project: 3420 San Pablo Ave., Oakland, CA

Sampled: 01/16/12
Received: 01/18/12
Issued: 01/31/12 19:18

NELAP #01108CA California ELAP#2706 CSDLAC #10256 AZ #AZ0671 NV #CA01531

The results listed within this Laboratory Report pertain only to the samples tested in the laboratory. The analyses contained in this report were performed in accordance with the applicable certifications as noted. All soil samples are reported on a wet weight basis unless otherwise noted in the report. This Laboratory Report is confidential and is intended for the sole use of TestAmerica and its client. This report shall not be reproduced, except in full, without written permission from TestAmerica. The Chain(s) of Custody, 6 pages, are included and are an integral part of this report.

This entire report was reviewed and approved for release.

SAMPLE CROSS REFERENCE

LABORATORY ID	CLIENT ID	MATRIX
IVA1728-01	SB-7-1'	Soil
IVA1728-02	SB-7-2'	Soil
IVA1728-03	SB-8-1'	Soil
IVA1728-04	SB-8-2'	Soil
IVA1728-05	SB-9-1'	Soil
IVA1728-06	SB-9-2'	Soil
IVA1728-07	SB-10-1"	Soil
IVA1728-08	SB-10-2'	Soil
IVA1728-09	SB-11-1'	Soil
IVA1728-10	SB-11-2'	Soil
IVA1728-11	SB-12-1'	Soil
IVA1728-12	SB-12-2'	Soil
IVA1728-13	SB-7-5'	Soil
IVA1728-14	SB-8-5'	Soil
IVA1728-15	SB-9-5'	Soil
IVA1728-16	SB-10-5'	Soil
IVA1728-17	SB-11-5'	Soil
IVA1728-18	SB-12-5'	Soil

Reviewed By:



TestAmerica Irvine

Philip Sanelle
Project Manager

Conestoga-Rovers & Associates - Emeryville Shell
5900 Hollis St., Suite A
Emeryville, CA 94608
Attention: Peter Schaefer

Project ID: 3420 San Pablo Ave., Oakland, CA

Report Number: IVA1728

Sampled: 01/16/12

Received: 01/18/12

VOLATILE FUEL HYDROCARBONS BY GC/MS (CA LUFT)

Analyte	Method	Batch	Reporting Limit	Sample Result	Dilution Factor	Date Extracted	Date Analyzed	Data Qualifiers
Sample ID: IVA1728-13 (SB-7-5' - Soil)								
Reporting Units: mg/kg								
Volatile Fuel Hydrocarbons (C4-C12)	TPH by GC/MS	12A2730	0.20	ND	0.994	1/23/2012	1/23/2012	
Surrogate: Dibromofluoromethane (80-125%)				110 %				
Surrogate: Toluene-d8 (80-120%)				85 %				
Surrogate: 4-Bromofluorobenzene (80-120%)				107 %				
Sample ID: IVA1728-14 (SB-8-5' - Soil)								
Reporting Units: mg/kg								
Volatile Fuel Hydrocarbons (C4-C12)	TPH by GC/MS	12A2634	0.20	1.7	0.984	1/21/2012	1/21/2012	
Surrogate: Dibromofluoromethane (80-125%)				100 %				
Surrogate: Toluene-d8 (80-120%)				104 %				
Surrogate: 4-Bromofluorobenzene (80-120%)				109 %				
Sample ID: IVA1728-15 (SB-9-5' - Soil)								
Reporting Units: mg/kg								
Volatile Fuel Hydrocarbons (C4-C12)	TPH by GC/MS	12A2634	0.20	ND	1	1/21/2012	1/22/2012	
Surrogate: Dibromofluoromethane (80-125%)				105 %				
Surrogate: Toluene-d8 (80-120%)				96 %				
Surrogate: 4-Bromofluorobenzene (80-120%)				105 %				
Sample ID: IVA1728-16 (SB-10-5' - Soil)								
Reporting Units: mg/kg								
Volatile Fuel Hydrocarbons (C4-C12)	TPH by GC/MS	12A2634	0.20	3.1	0.998	1/21/2012	1/22/2012	
Surrogate: Dibromofluoromethane (80-125%)				106 %				
Surrogate: Toluene-d8 (80-120%)				106 %				
Surrogate: 4-Bromofluorobenzene (80-120%)				108 %				
Sample ID: IVA1728-17 (SB-11-5' - Soil)								
Reporting Units: mg/kg								
Volatile Fuel Hydrocarbons (C4-C12)	TPH by GC/MS	12A2634	0.20	2.9	0.984	1/21/2012	1/22/2012	
Surrogate: Dibromofluoromethane (80-125%)				100 %				
Surrogate: Toluene-d8 (80-120%)				105 %				
Surrogate: 4-Bromofluorobenzene (80-120%)				107 %				
Sample ID: IVA1728-18 (SB-12-5' - Soil)								
Reporting Units: mg/kg								
Volatile Fuel Hydrocarbons (C4-C12)	TPH by GC/MS	12A2760	10	180	99.7	1/23/2012	1/24/2012	
Surrogate: Dibromofluoromethane (55-140%)				101 %				
Surrogate: Toluene-d8 (60-140%)				107 %				
Surrogate: 4-Bromofluorobenzene (65-140%)				115 %				

TestAmerica Irvine

Philip Sanelle
Project Manager

Conestoga-Rovers & Associates - Emeryville Shell
5900 Hollis St., Suite A
Emeryville, CA 94608
Attention: Peter Schaefer

Project ID: 3420 San Pablo Ave., Oakland, CA

Report Number: IVA1728

Sampled: 01/16/12

Received: 01/18/12

VOLATILE FUEL HYDROCARBONS BY GC/MS (EPA 5035/CA LUFT)

Analyte	Method	Batch	Reporting Limit	Sample Result	Dilution Factor	Date Extracted	Date Analyzed	Data Qualifiers
Sample ID: IVA1728-01 (SB-7-1' - Soil)								
Reporting Units: mg/kg								
Volatile Fuel Hydrocarbons (C4-C12)	TPH by GC/MS	12A2621	0.099	ND	0.992	1/21/2012	1/21/2012	
Surrogate: Dibromofluoromethane (80-135%)				109 %				
Surrogate: Toluene-d8 (80-120%)				98 %				
Surrogate: 4-Bromofluorobenzene (75-120%)				94 %				
Sample ID: IVA1728-02 (SB-7-2' - Soil)								
Reporting Units: mg/kg								
Volatile Fuel Hydrocarbons (C4-C12)	TPH by GC/MS	12A2621	0.12	ND	1.16	1/21/2012	1/21/2012	
Surrogate: Dibromofluoromethane (80-135%)				103 %				
Surrogate: Toluene-d8 (80-120%)				98 %				
Surrogate: 4-Bromofluorobenzene (75-120%)				92 %				
Sample ID: IVA1728-03 (SB-8-1' - Soil)								
Reporting Units: mg/kg								
Volatile Fuel Hydrocarbons (C4-C12)	TPH by GC/MS	12A2621	0.085	ND	0.85	1/21/2012	1/21/2012	
Surrogate: Dibromofluoromethane (80-135%)				107 %				
Surrogate: Toluene-d8 (80-120%)				100 %				
Surrogate: 4-Bromofluorobenzene (75-120%)				100 %				
Sample ID: IVA1728-04 (SB-8-2' - Soil)								
Reporting Units: mg/kg								
Volatile Fuel Hydrocarbons (C4-C12)	TPH by GC/MS	12A3008	0.096	ND	0.963	1/25/2012	1/25/2012	
Surrogate: Dibromofluoromethane (80-135%)				105 %				
Surrogate: Toluene-d8 (80-120%)				100 %				
Surrogate: 4-Bromofluorobenzene (75-120%)				87 %				
Sample ID: IVA1728-05 (SB-9-1' - Soil)								
Reporting Units: mg/kg								
Volatile Fuel Hydrocarbons (C4-C12)	TPH by GC/MS	12A2621	0.091	0.12	0.907	1/21/2012	1/21/2012	
Surrogate: Dibromofluoromethane (80-135%)				109 %				
Surrogate: Toluene-d8 (80-120%)				98 %				
Surrogate: 4-Bromofluorobenzene (75-120%)				97 %				
Sample ID: IVA1728-06 (SB-9-2' - Soil)								
Reporting Units: mg/kg								
Volatile Fuel Hydrocarbons (C4-C12)	TPH by GC/MS	12A3008	0.083	ND	0.835	1/25/2012	1/25/2012	
Surrogate: Dibromofluoromethane (80-135%)				107 %				
Surrogate: Toluene-d8 (80-120%)				100 %				
Surrogate: 4-Bromofluorobenzene (75-120%)				87 %				

TestAmerica Irvine

Philip Sanelle
Project Manager

Conestoga-Rovers & Associates - Emeryville Shell
5900 Hollis St., Suite A
Emeryville, CA 94608
Attention: Peter Schaefer

Project ID: 3420 San Pablo Ave., Oakland, CA

Report Number: IVA1728

Sampled: 01/16/12
Received: 01/18/12

VOLATILE FUEL HYDROCARBONS BY GC/MS (EPA 5035/CA LUFT)

Analyte	Method	Batch	Reporting Limit	Sample Result	Dilution Factor	Date Extracted	Date Analyzed	Data Qualifiers
Sample ID: IVA1728-07 (SB-10-1" - Soil)								
Reporting Units: mg/kg								
Volatile Fuel Hydrocarbons (C4-C12)	TPH by GC/MS	12A2621	0.11	0.12	1.11	1/21/2012	1/21/2012	
Surrogate: Dibromofluoromethane (80-135%)				111 %				
Surrogate: Toluene-d8 (80-120%)				97 %				
Surrogate: 4-Bromofluorobenzene (75-120%)				89 %				
Sample ID: IVA1728-08 (SB-10-2' - Soil)								
Reporting Units: mg/kg								
Volatile Fuel Hydrocarbons (C4-C12)	TPH by GC/MS	12A2621	0.097	0.67	0.965	1/21/2012	1/21/2012	
Surrogate: Dibromofluoromethane (80-135%)				110 %				
Surrogate: Toluene-d8 (80-120%)				96 %				
Surrogate: 4-Bromofluorobenzene (75-120%)				83 %				
Sample ID: IVA1728-09 (SB-11-1' - Soil)								
Reporting Units: mg/kg								
Volatile Fuel Hydrocarbons (C4-C12)	TPH by GC/MS	12A2621	0.089	0.72	0.894	1/21/2012	1/21/2012	
Surrogate: Dibromofluoromethane (80-135%)				110 %				
Surrogate: Toluene-d8 (80-120%)				98 %				
Surrogate: 4-Bromofluorobenzene (75-120%)				97 %				
Sample ID: IVA1728-10 (SB-11-2' - Soil)								
Reporting Units: mg/kg								
Volatile Fuel Hydrocarbons (C4-C12)	TPH by GC/MS	12A3008	0.060	1.7	0.595	1/25/2012	1/25/2012	
Surrogate: Dibromofluoromethane (80-135%)				112 %				
Surrogate: Toluene-d8 (80-120%)				103 %				
Surrogate: 4-Bromofluorobenzene (75-120%)				95 %				
Sample ID: IVA1728-11 (SB-12-1' - Soil)								
Reporting Units: mg/kg								
Volatile Fuel Hydrocarbons (C4-C12)	TPH by GC/MS	12A2621	0.10	0.20	1.02	1/21/2012	1/21/2012	
Surrogate: Dibromofluoromethane (80-135%)				122 %				
Surrogate: Toluene-d8 (80-120%)				86 %				
Surrogate: 4-Bromofluorobenzene (75-120%)				80 %				
Sample ID: IVA1728-12 (SB-12-2' - Soil)								
Reporting Units: mg/kg								
Volatile Fuel Hydrocarbons (C4-C12)	TPH by GC/MS	12A2621	0.13	2.8	1.33	1/21/2012	1/21/2012	
Surrogate: Dibromofluoromethane (80-135%)				108 %				
Surrogate: Toluene-d8 (80-120%)				100 %				
Surrogate: 4-Bromofluorobenzene (75-120%)				94 %				

TestAmerica Irvine

Philip Sanelle
Project Manager

Conestoga-Rovers & Associates - Emeryville Shell
 5900 Hollis St., Suite A
 Emeryville, CA 94608
 Attention: Peter Schaefer

Project ID: 3420 San Pablo Ave., Oakland, CA

Report Number: IVA1728

Sampled: 01/16/12
 Received: 01/18/12

VOLATILE ORGANICS by GC/MS (EPA 5030B/8260B)

Analyte	Method	Batch	Reporting Limit	Sample Result	Dilution Factor	Date Extracted	Date Analyzed	Data Qualifiers
Sample ID: IVA1728-13 (SB-7-5' - Soil)								
Reporting Units: mg/kg								
Benzene	EPA 8260B	12A2730	0.00099	ND	0.994	1/23/2012	1/23/2012	
Ethylbenzene	EPA 8260B	12A2730	0.00099	ND	0.994	1/23/2012	1/23/2012	
Toluene	EPA 8260B	12A2730	0.00099	ND	0.994	1/23/2012	1/23/2012	
Xylenes, Total	EPA 8260B	12A2730	0.0020	ND	0.994	1/23/2012	1/23/2012	
Methyl-tert-butyl Ether (MTBE)	EPA 8260B	12A2730	0.0020	ND	0.994	1/23/2012	1/23/2012	
Surrogate: 4-Bromofluorobenzene (80-120%)								107 %
Surrogate: Dibromofluoromethane (80-125%)								110 %
Surrogate: Toluene-d8 (80-120%)								85 %
Sample ID: IVA1728-14 (SB-8-5' - Soil)								
Reporting Units: mg/kg								
Benzene	EPA 8260B	12A2634	0.00098	ND	0.984	1/21/2012	1/21/2012	
Ethylbenzene	EPA 8260B	12A2634	0.00098	ND	0.984	1/21/2012	1/21/2012	
Toluene	EPA 8260B	12A2634	0.00098	ND	0.984	1/21/2012	1/21/2012	
Xylenes, Total	EPA 8260B	12A2634	0.0020	ND	0.984	1/21/2012	1/21/2012	
Methyl-tert-butyl Ether (MTBE)	EPA 8260B	12A2634	0.0020	ND	0.984	1/21/2012	1/21/2012	
Surrogate: 4-Bromofluorobenzene (80-120%)								109 %
Surrogate: Dibromofluoromethane (80-125%)								100 %
Surrogate: Toluene-d8 (80-120%)								104 %
Sample ID: IVA1728-15 (SB-9-5' - Soil)								
Reporting Units: mg/kg								
Benzene	EPA 8260B	12A2634	0.0010	ND	1	1/21/2012	1/22/2012	
Ethylbenzene	EPA 8260B	12A2634	0.0010	ND	1	1/21/2012	1/22/2012	
Toluene	EPA 8260B	12A2634	0.0010	ND	1	1/21/2012	1/22/2012	
Xylenes, Total	EPA 8260B	12A2634	0.0020	ND	1	1/21/2012	1/22/2012	
Methyl-tert-butyl Ether (MTBE)	EPA 8260B	12A2634	0.0020	ND	1	1/21/2012	1/22/2012	
Surrogate: 4-Bromofluorobenzene (80-120%)								105 %
Surrogate: Dibromofluoromethane (80-125%)								105 %
Surrogate: Toluene-d8 (80-120%)								96 %

TestAmerica Irvine

Philip Sanelle
 Project Manager

The results pertain only to the samples tested in the laboratory. This report shall not be reproduced, except in full, without written permission from TestAmerica.

Conestoga-Rovers & Associates - Emeryville Shell
 5900 Hollis St., Suite A
 Emeryville, CA 94608
 Attention: Peter Schaefer

Project ID: 3420 San Pablo Ave., Oakland, CA

Report Number: IVA1728

Sampled: 01/16/12
 Received: 01/18/12

VOLATILE ORGANICS by GC/MS (EPA 5030B/8260B)

Analyte	Method	Batch	Reporting Limit	Sample Result	Dilution Factor	Date Extracted	Date Analyzed	Data Qualifiers
Sample ID: IVA1728-16 (SB-10-5' - Soil)								
Reporting Units: mg/kg								
Benzene	EPA 8260B	12A2634	0.0010	0.0016	0.998	1/21/2012	1/22/2012	
Ethylbenzene	EPA 8260B	12A2634	0.0010	ND	0.998	1/21/2012	1/22/2012	
Toluene	EPA 8260B	12A2634	0.0010	ND	0.998	1/21/2012	1/22/2012	
Xylenes, Total	EPA 8260B	12A2634	0.0020	ND	0.998	1/21/2012	1/22/2012	
Methyl-tert-butyl Ether (MTBE)	EPA 8260B	12A2634	0.0020	ND	0.998	1/21/2012	1/22/2012	
Surrogate: 4-Bromofluorobenzene (80-120%)				108 %				
Surrogate: Dibromofluoromethane (80-125%)				106 %				
Surrogate: Toluene-d8 (80-120%)				106 %				
Sample ID: IVA1728-17 (SB-11-5' - Soil)								
Reporting Units: mg/kg								
Benzene	EPA 8260B	12A2634	0.00098	0.10	0.984	1/21/2012	1/22/2012	
Ethylbenzene	EPA 8260B	12A2634	0.00098	0.042	0.984	1/21/2012	1/22/2012	
Toluene	EPA 8260B	12A2634	0.00098	0.0010	0.984	1/21/2012	1/22/2012	
Xylenes, Total	EPA 8260B	12A2634	0.0020	0.0074	0.984	1/21/2012	1/22/2012	
Methyl-tert-butyl Ether (MTBE)	EPA 8260B	12A2634	0.0020	0.030	0.984	1/21/2012	1/22/2012	
Surrogate: 4-Bromofluorobenzene (80-120%)				107 %				
Surrogate: Dibromofluoromethane (80-125%)				100 %				
Surrogate: Toluene-d8 (80-120%)				105 %				
Sample ID: IVA1728-18 (SB-12-5' - Soil)								
Reporting Units: mg/kg								
Benzene	EPA 8260B	12A2760	0.050	0.22	99.7	1/23/2012	1/24/2012	
Ethylbenzene	EPA 8260B	12A2760	0.050	1.6	99.7	1/23/2012	1/24/2012	
Toluene	EPA 8260B	12A2760	0.050	ND	99.7	1/23/2012	1/24/2012	
Xylenes, Total	EPA 8260B	12A2760	0.10	ND	99.7	1/23/2012	1/24/2012	
Methyl-tert-butyl Ether (MTBE)	EPA 8260B	12A2760	0.10	ND	99.7	1/23/2012	1/24/2012	
Surrogate: 4-Bromofluorobenzene (65-140%)				115 %				
Surrogate: Dibromofluoromethane (55-140%)				101 %				
Surrogate: Toluene-d8 (60-140%)				107 %				

TestAmerica Irvine

Philip Sanelle
 Project Manager

The results pertain only to the samples tested in the laboratory. This report shall not be reproduced, except in full, without written permission from TestAmerica.

Conestoga-Rovers & Associates - Emeryville Shell
 5900 Hollis St., Suite A
 Emeryville, CA 94608
 Attention: Peter Schaefer

Project ID: 3420 San Pablo Ave., Oakland, CA

Report Number: IVA1728

Sampled: 01/16/12
 Received: 01/18/12

BTEX/OXYGENATES by GC/MS (EPA 5035/8260B)

Analyte	Method	Batch	Reporting Limit	Sample Result	Dilution Factor	Date Extracted	Date Analyzed	Data Qualifiers
Sample ID: IVA1728-01 (SB-7-1' - Soil)								
Reporting Units: mg/kg								
Benzene	EPA 8260B	12A2621	0.0020	0.0020	0.992	1/21/2012	1/21/2012	
Ethylbenzene	EPA 8260B	12A2621	0.0020	ND	0.992	1/21/2012	1/21/2012	
Toluene	EPA 8260B	12A2621	0.0020	ND	0.992	1/21/2012	1/21/2012	
Xylenes, Total	EPA 8260B	12A2621	0.0040	ND	0.992	1/21/2012	1/21/2012	
Methyl-tert-butyl Ether (MTBE)	EPA 8260B	12A2621	0.0050	ND	0.992	1/21/2012	1/21/2012	
Surrogate: 4-Bromofluorobenzene (75-120%)				94 %				
Surrogate: Dibromofluoromethane (80-135%)				109 %				
Surrogate: Toluene-d8 (80-120%)				98 %				
Sample ID: IVA1728-02 (SB-7-2' - Soil)								
Reporting Units: mg/kg								
Benzene	EPA 8260B	12A2621	0.0023	0.0023	1.16	1/21/2012	1/21/2012	
Ethylbenzene	EPA 8260B	12A2621	0.0023	ND	1.16	1/21/2012	1/21/2012	
Toluene	EPA 8260B	12A2621	0.0023	ND	1.16	1/21/2012	1/21/2012	
Xylenes, Total	EPA 8260B	12A2621	0.0046	ND	1.16	1/21/2012	1/21/2012	
Methyl-tert-butyl Ether (MTBE)	EPA 8260B	12A2621	0.0058	ND	1.16	1/21/2012	1/21/2012	
Surrogate: 4-Bromofluorobenzene (75-120%)				92 %				
Surrogate: Dibromofluoromethane (80-135%)				103 %				
Surrogate: Toluene-d8 (80-120%)				98 %				
Sample ID: IVA1728-03 (SB-8-1' - Soil)								
Reporting Units: mg/kg								
Benzene	EPA 8260B	12A2621	0.0017	0.0023	0.85	1/21/2012	1/21/2012	
Ethylbenzene	EPA 8260B	12A2621	0.0017	ND	0.85	1/21/2012	1/21/2012	
Toluene	EPA 8260B	12A2621	0.0017	ND	0.85	1/21/2012	1/21/2012	
Xylenes, Total	EPA 8260B	12A2621	0.0034	ND	0.85	1/21/2012	1/21/2012	
Methyl-tert-butyl Ether (MTBE)	EPA 8260B	12A2621	0.0043	ND	0.85	1/21/2012	1/21/2012	
Surrogate: 4-Bromofluorobenzene (75-120%)				100 %				
Surrogate: Dibromofluoromethane (80-135%)				107 %				
Surrogate: Toluene-d8 (80-120%)				100 %				

TestAmerica Irvine

Philip Sanelle
 Project Manager

Conestoga-Rovers & Associates - Emeryville Shell
5900 Hollis St., Suite A
Emeryville, CA 94608
Attention: Peter Schaefer

Project ID: 3420 San Pablo Ave., Oakland, CA

Report Number: IVA1728

Sampled: 01/16/12
Received: 01/18/12

BTEX/OXYGENATES by GC/MS (EPA 5035/8260B)

Analyte	Method	Batch	Reporting Limit	Sample Result	Dilution Factor	Date Extracted	Date Analyzed	Data Qualifiers
Sample ID: IVA1728-04 (SB-8-2' - Soil)								
Reporting Units: mg/kg								
Benzene	EPA 8260B	12A3008	0.0019	0.0044	0.963	1/25/2012	1/25/2012	
Ethylbenzene	EPA 8260B	12A3008	0.0019	ND	0.963	1/25/2012	1/25/2012	
Toluene	EPA 8260B	12A3008	0.0019	ND	0.963	1/25/2012	1/25/2012	
Xylenes, Total	EPA 8260B	12A3008	0.0039	ND	0.963	1/25/2012	1/25/2012	
Methyl-tert-butyl Ether (MTBE)	EPA 8260B	12A3008	0.0048	ND	0.963	1/25/2012	1/25/2012	
Surrogate: 4-Bromofluorobenzene (75-120%)				87 %				
Surrogate: Dibromofluoromethane (80-135%)				105 %				
Surrogate: Toluene-d8 (80-120%)				100 %				
Sample ID: IVA1728-05 (SB-9-1' - Soil)								
Reporting Units: mg/kg								
Benzene	EPA 8260B	12A2621	0.0018	0.0025	0.907	1/21/2012	1/21/2012	
Ethylbenzene	EPA 8260B	12A2621	0.0018	ND	0.907	1/21/2012	1/21/2012	
Toluene	EPA 8260B	12A2621	0.0018	0.0023	0.907	1/21/2012	1/21/2012	
Xylenes, Total	EPA 8260B	12A2621	0.0036	ND	0.907	1/21/2012	1/21/2012	
Methyl-tert-butyl Ether (MTBE)	EPA 8260B	12A2621	0.0045	ND	0.907	1/21/2012	1/21/2012	
Surrogate: 4-Bromofluorobenzene (75-120%)				97 %				
Surrogate: Dibromofluoromethane (80-135%)				109 %				
Surrogate: Toluene-d8 (80-120%)				98 %				
Sample ID: IVA1728-06 (SB-9-2' - Soil)								
Reporting Units: mg/kg								
Benzene	EPA 8260B	12A3008	0.0017	0.0048	0.835	1/25/2012	1/25/2012	
Ethylbenzene	EPA 8260B	12A3008	0.0017	ND	0.835	1/25/2012	1/25/2012	
Toluene	EPA 8260B	12A3008	0.0017	ND	0.835	1/25/2012	1/25/2012	
Xylenes, Total	EPA 8260B	12A3008	0.0033	ND	0.835	1/25/2012	1/25/2012	
Methyl-tert-butyl Ether (MTBE)	EPA 8260B	12A3008	0.0042	ND	0.835	1/25/2012	1/25/2012	
Surrogate: 4-Bromofluorobenzene (75-120%)				87 %				
Surrogate: Dibromofluoromethane (80-135%)				107 %				
Surrogate: Toluene-d8 (80-120%)				100 %				

TestAmerica Irvine

Philip Sanelle
Project Manager

The results pertain only to the samples tested in the laboratory. This report shall not be reproduced, except in full, without written permission from TestAmerica.

IVA1728 <Page 8 of 27>

Conestoga-Rovers & Associates - Emeryville Shell
5900 Hollis St., Suite A
Emeryville, CA 94608
Attention: Peter Schaefer

Project ID: 3420 San Pablo Ave., Oakland, CA

Report Number: IVA1728

Sampled: 01/16/12
Received: 01/18/12

BTEX/OXYGENATES by GC/MS (EPA 5035/8260B)

Analyte	Method	Batch	Reporting Limit	Sample Result	Dilution Factor	Date Extracted	Date Analyzed	Data Qualifiers
Sample ID: IVA1728-07 (SB-10-1" - Soil)								
Reporting Units: mg/kg								
Benzene	EPA 8260B	12A2621	0.0022	0.017	1.11	1/21/2012	1/21/2012	
Ethylbenzene	EPA 8260B	12A2621	0.0022	ND	1.11	1/21/2012	1/21/2012	
Toluene	EPA 8260B	12A2621	0.0022	0.0028	1.11	1/21/2012	1/21/2012	
Xylenes, Total	EPA 8260B	12A2621	0.0044	ND	1.11	1/21/2012	1/21/2012	
Methyl-tert-butyl Ether (MTBE)	EPA 8260B	12A2621	0.0056	ND	1.11	1/21/2012	1/21/2012	
Surrogate: 4-Bromofluorobenzene (75-120%)				89 %				
Surrogate: Dibromofluoromethane (80-135%)				111 %				
Surrogate: Toluene-d8 (80-120%)				97 %				
Sample ID: IVA1728-08 (SB-10-2' - Soil)								
Reporting Units: mg/kg								
Benzene	EPA 8260B	12A2621	0.0019	0.0036	0.965	1/21/2012	1/21/2012	
Ethylbenzene	EPA 8260B	12A2621	0.0019	ND	0.965	1/21/2012	1/21/2012	
Toluene	EPA 8260B	12A2621	0.0019	ND	0.965	1/21/2012	1/21/2012	
Xylenes, Total	EPA 8260B	12A2621	0.0039	ND	0.965	1/21/2012	1/21/2012	
Methyl-tert-butyl Ether (MTBE)	EPA 8260B	12A2621	0.0048	ND	0.965	1/21/2012	1/21/2012	
Surrogate: 4-Bromofluorobenzene (75-120%)				83 %				
Surrogate: Dibromofluoromethane (80-135%)				110 %				
Surrogate: Toluene-d8 (80-120%)				96 %				
Sample ID: IVA1728-09 (SB-11-1' - Soil)								
Reporting Units: mg/kg								
Benzene	EPA 8260B	12A2621	0.0018	0.065	0.894	1/21/2012	1/21/2012	
Ethylbenzene	EPA 8260B	12A2621	0.0018	0.0071	0.894	1/21/2012	1/21/2012	
Toluene	EPA 8260B	12A2621	0.0018	0.0070	0.894	1/21/2012	1/21/2012	
Xylenes, Total	EPA 8260B	12A2621	0.0036	0.022	0.894	1/21/2012	1/21/2012	
Methyl-tert-butyl Ether (MTBE)	EPA 8260B	12A2621	0.0045	0.012	0.894	1/21/2012	1/21/2012	
Surrogate: 4-Bromofluorobenzene (75-120%)				97 %				
Surrogate: Dibromofluoromethane (80-135%)				110 %				
Surrogate: Toluene-d8 (80-120%)				98 %				

TestAmerica Irvine

Philip Sanelle
Project Manager

The results pertain only to the samples tested in the laboratory. This report shall not be reproduced, except in full, without written permission from TestAmerica.

Conestoga-Rovers & Associates - Emeryville Shell
5900 Hollis St., Suite A
Emeryville, CA 94608
Attention: Peter Schaefer

Project ID: 3420 San Pablo Ave., Oakland, CA

Report Number: IVA1728

Sampled: 01/16/12
Received: 01/18/12

BTEX/OXYGENATES by GC/MS (EPA 5035/8260B)

Analyte	Method	Batch	Reporting Limit	Sample Result	Dilution Factor	Date Extracted	Date Analyzed	Data Qualifiers
Sample ID: IVA1728-10 (SB-11-2' - Soil)								
Reporting Units: mg/kg								
Benzene	EPA 8260B	12A3008	0.0012	0.16	0.595	1/25/2012	1/25/2012	
Ethylbenzene	EPA 8260B	12A3008	0.0012	0.019	0.595	1/25/2012	1/25/2012	
Toluene	EPA 8260B	12A3008	0.0012	0.0070	0.595	1/25/2012	1/25/2012	
Xylenes, Total	EPA 8260B	12A3008	0.0024	0.049	0.595	1/25/2012	1/25/2012	
Methyl-tert-butyl Ether (MTBE)	EPA 8260B	12A3008	0.0030	0.021	0.595	1/25/2012	1/25/2012	
Surrogate: 4-Bromofluorobenzene (75-120%)				95 %				
Surrogate: Dibromofluoromethane (80-135%)				112 %				
Surrogate: Toluene-d8 (80-120%)				103 %				
Sample ID: IVA1728-11 (SB-12-1' - Soil)								
Reporting Units: mg/kg								
Benzene	EPA 8260B	12A2621	0.0020	0.031	1.02	1/21/2012	1/21/2012	
Ethylbenzene	EPA 8260B	12A2621	0.0020	0.0040	1.02	1/21/2012	1/21/2012	
Toluene	EPA 8260B	12A2621	0.0020	0.0041	1.02	1/21/2012	1/21/2012	
Xylenes, Total	EPA 8260B	12A2621	0.0041	0.015	1.02	1/21/2012	1/21/2012	
Methyl-tert-butyl Ether (MTBE)	EPA 8260B	12A2621	0.0051	0.0061	1.02	1/21/2012	1/21/2012	
Surrogate: 4-Bromofluorobenzene (75-120%)				80 %				
Surrogate: Dibromofluoromethane (80-135%)				122 %				
Surrogate: Toluene-d8 (80-120%)				86 %				
Sample ID: IVA1728-12 (SB-12-2' - Soil)								
Reporting Units: mg/kg								
Benzene	EPA 8260B	12A2621	0.0027	0.20	1.33	1/21/2012	1/21/2012	
Ethylbenzene	EPA 8260B	12A2621	0.0027	0.025	1.33	1/21/2012	1/21/2012	
Toluene	EPA 8260B	12A2621	0.0027	0.011	1.33	1/21/2012	1/21/2012	
Xylenes, Total	EPA 8260B	12A2621	0.0053	0.097	1.33	1/21/2012	1/21/2012	
Methyl-tert-butyl Ether (MTBE)	EPA 8260B	12A2621	0.0066	0.029	1.33	1/21/2012	1/21/2012	
Surrogate: 4-Bromofluorobenzene (75-120%)				94 %				
Surrogate: Dibromofluoromethane (80-135%)				108 %				
Surrogate: Toluene-d8 (80-120%)				100 %				

TestAmerica Irvine

Philip Sanelle
Project Manager

The results pertain only to the samples tested in the laboratory. This report shall not be reproduced, except in full, without written permission from TestAmerica.

IVA1728 <Page 10 of 27>

Conestoga-Rovers & Associates - Emeryville Shell
 5900 Hollis St., Suite A
 Emeryville, CA 94608
 Attention: Peter Schaefer

Project ID: 3420 San Pablo Ave., Oakland, CA

Report Number: IVA1728

Sampled: 01/16/12
 Received: 01/18/12

METALS

Analyte	Method	Batch	Reporting Limit	Sample Result	Dilution Factor	Date Extracted	Date Analyzed	Data Qualifiers
Sample ID: IVA1728-01 (SB-7-1' - Soil)								
Reporting Units: mg/kg								
Lead	EPA 6010B	12A2690	2.0	79	0.985	1/22/2012	1/23/2012	M2
Sample ID: IVA1728-02 (SB-7-2' - Soil)								
Reporting Units: mg/kg								
Lead	EPA 6010B	12A2690	2.0	340	0.99	1/22/2012	1/23/2012	
Sample ID: IVA1728-03 (SB-8-1' - Soil)								
Reporting Units: mg/kg								
Lead	EPA 6010B	12A2690	2.0	160	1.01	1/22/2012	1/23/2012	
Sample ID: IVA1728-04 (SB-8-2' - Soil)								
Reporting Units: mg/kg								
Lead	EPA 6010B	12A2690	2.0	250	0.98	1/22/2012	1/23/2012	
Sample ID: IVA1728-05 (SB-9-1' - Soil)								
Reporting Units: mg/kg								
Lead	EPA 6010B	12A2690	2.0	97	0.98	1/22/2012	1/23/2012	
Sample ID: IVA1728-06 (SB-9-2' - Soil)								
Reporting Units: mg/kg								
Lead	EPA 6010B	12A2690	2.0	720	1.01	1/22/2012	1/23/2012	
Sample ID: IVA1728-07 (SB-10-1" - Soil)								
Reporting Units: mg/kg								
Lead	EPA 6010B	12A2690	2.0	990	0.995	1/22/2012	1/23/2012	
Sample ID: IVA1728-08 (SB-10-2' - Soil)								
Reporting Units: mg/kg								
Lead	EPA 6010B	12A2690	2.0	140	0.99	1/22/2012	1/23/2012	
Sample ID: IVA1728-09 (SB-11-1' - Soil)								
Reporting Units: mg/kg								
Lead	EPA 6010B	12A2690	2.0	260	1.01	1/22/2012	1/23/2012	
Sample ID: IVA1728-10 (SB-11-2' - Soil)								
Reporting Units: mg/kg								
Lead	EPA 6010B	12A2690	2.0	200	0.995	1/22/2012	1/23/2012	

TestAmerica Irvine

Philip Sanelle
 Project Manager

Conestoga-Rovers & Associates - Emeryville Shell
 5900 Hollis St., Suite A
 Emeryville, CA 94608
 Attention: Peter Schaefer

Project ID: 3420 San Pablo Ave., Oakland, CA

Report Number: IVA1728

Sampled: 01/16/12
 Received: 01/18/12

METALS

Analyte	Method	Batch	Reporting Limit	Sample Result	Dilution Factor	Date Extracted	Date Analyzed	Data Qualifiers
Sample ID: IVA1728-11 (SB-12-1' - Soil)								
Reporting Units: mg/kg								
Lead	EPA 6010B	12A2690	2.0	60	1.01	1/22/2012	1/23/2012	
Sample ID: IVA1728-12 (SB-12-2' - Soil)								
Reporting Units: mg/kg								
Lead	EPA 6010B	12A2690	2.0	200	0.995	1/22/2012	1/23/2012	
Sample ID: IVA1728-13 (SB-7-5' - Soil)								
Reporting Units: mg/kg								
Lead	EPA 6010B	12A2690	2.0	5.2	0.985	1/22/2012	1/23/2012	
Sample ID: IVA1728-14 (SB-8-5' - Soil)								
Reporting Units: mg/kg								
Lead	EPA 6010B	12A2690	2.0	4.9	1.02	1/22/2012	1/23/2012	
Sample ID: IVA1728-15 (SB-9-5' - Soil)								
Reporting Units: mg/kg								
Lead	EPA 6010B	12A2690	2.0	7.7	0.995	1/22/2012	1/23/2012	
Sample ID: IVA1728-16 (SB-10-5' - Soil)								
Reporting Units: mg/kg								
Lead	EPA 6010B	12A2690	2.0	8.7	0.99	1/22/2012	1/23/2012	
Sample ID: IVA1728-17 (SB-11-5' - Soil)								
Reporting Units: mg/kg								
Lead	EPA 6010B	12A2690	2.0	6.1	0.995	1/22/2012	1/23/2012	
Sample ID: IVA1728-18 (SB-12-5' - Soil)								
Reporting Units: mg/kg								
Lead	EPA 6010B	12A2690	2.0	4.8	1	1/22/2012	1/23/2012	

TestAmerica Irvine

Philip Sanelle
 Project Manager

Conestoga-Rovers & Associates - Emeryville Shell
 5900 Hollis St., Suite A
 Emeryville, CA 94608
 Attention: Peter Schaefer

Project ID: 3420 San Pablo Ave., Oakland, CA

Report Number: IVA1728

Sampled: 01/16/12
 Received: 01/18/12

METHOD BLANK/QC DATA

VOLATILE FUEL HYDROCARBONS BY GC/MS (CA LUFT)

Analyte	Result	Reporting Limit	Units	Spike Level	Source Result	%REC	%REC Limits	RPD	RPD Limit	Data Qualifiers
Batch: 12A2634 Extracted: 01/21/12										
Blank Analyzed: 01/21/2012 (12A2634-BLK1)										
Volatile Fuel Hydrocarbons (C4-C12)	ND	0.20	mg/kg							
Surrogate: Dibromofluoromethane	0.0504		mg/kg	0.0500		101	80-125			
Surrogate: Toluene-d8	0.0512		mg/kg	0.0500		102	80-120			
Surrogate: 4-Bromofluorobenzene	0.0528		mg/kg	0.0500		106	80-120			
LCS Analyzed: 01/21/2012 (12A2634-BS2)										
Volatile Fuel Hydrocarbons (C4-C12)	1.07	0.20	mg/kg	1.00		107	60-135			
Surrogate: Dibromofluoromethane	0.0501		mg/kg	0.0500		100	80-125			
Surrogate: Toluene-d8	0.0523		mg/kg	0.0500		105	80-120			
Surrogate: 4-Bromofluorobenzene	0.0530		mg/kg	0.0500		106	80-120			
Matrix Spike Analyzed: 01/21/2012 (12A2634-MS1)					Source: IVA1728-14					
Volatile Fuel Hydrocarbons (C4-C12)	5.92	0.20	mg/kg	3.44	1.75	121	50-140			
Surrogate: Dibromofluoromethane	0.0505		mg/kg	0.0498		101	80-125			
Surrogate: Toluene-d8	0.0525		mg/kg	0.0498		105	80-120			
Surrogate: 4-Bromofluorobenzene	0.0551		mg/kg	0.0498		111	80-120			
Matrix Spike Dup Analyzed: 01/21/2012 (12A2634-MSD1)					Source: IVA1728-14					
Volatile Fuel Hydrocarbons (C4-C12)	5.10	0.20	mg/kg	3.41	1.75	98	50-140	15	25	
Surrogate: Dibromofluoromethane	0.0497		mg/kg	0.0494		101	80-125			
Surrogate: Toluene-d8	0.0520		mg/kg	0.0494		105	80-120			
Surrogate: 4-Bromofluorobenzene	0.0543		mg/kg	0.0494		110	80-120			
Batch: 12A2730 Extracted: 01/23/12										
Blank Analyzed: 01/23/2012 (12A2730-BLK1)										
Volatile Fuel Hydrocarbons (C4-C12)	ND	0.20	mg/kg							
Surrogate: Dibromofluoromethane	0.0491		mg/kg	0.0500		98	80-125			
Surrogate: Toluene-d8	0.0516		mg/kg	0.0500		103	80-120			
Surrogate: 4-Bromofluorobenzene	0.0495		mg/kg	0.0500		99	80-120			

TestAmerica Irvine

Philip Sanelle
 Project Manager

Conestoga-Rovers & Associates - Emeryville Shell
5900 Hollis St., Suite A
Emeryville, CA 94608
Attention: Peter Schaefer

Project ID: 3420 San Pablo Ave., Oakland, CA

Report Number: IVA1728

Sampled: 01/16/12
Received: 01/18/12

METHOD BLANK/QC DATA

VOLATILE FUEL HYDROCARBONS BY GC/MS (CA LUFT)

Analyte	Result	Reporting Limit	Units	Spike Level	Source Result	%REC	%REC Limits	RPD	RPD Limit	Data Qualifiers
Batch: 12A2730 Extracted: 01/23/12										
LCS Analyzed: 01/23/2012 (12A2730-BS2)										
Volatile Fuel Hydrocarbons (C4-C12)	0.984	0.20	mg/kg	1.00		98	60-135			
Surrogate: Dibromofluoromethane	0.0518		mg/kg	0.0500		104	80-125			
Surrogate: Toluene-d8	0.0514		mg/kg	0.0500		103	80-120			
Surrogate: 4-Bromofluorobenzene	0.0530		mg/kg	0.0500		106	80-120			
Matrix Spike Analyzed: 01/23/2012 (12A2730-MS1)										
					Source: IVA1736-01					MCP
Volatile Fuel Hydrocarbons (C4-C12)	3.11	0.20	mg/kg	3.45	ND	90	50-140			
Surrogate: Dibromofluoromethane	0.0321		mg/kg	0.0500		64	80-125			Z
Surrogate: Toluene-d8	0.0521		mg/kg	0.0500		104	80-120			
Surrogate: 4-Bromofluorobenzene	0.0526		mg/kg	0.0500		105	80-120			
Batch: 12A2760 Extracted: 01/23/12										
Blank Analyzed: 01/24/2012 (12A2760-BLK1)										
Volatile Fuel Hydrocarbons (C4-C12)	ND	10	mg/kg							
Surrogate: Dibromofluoromethane	2.48		mg/kg	2.50		99	55-140			
Surrogate: Toluene-d8	2.66		mg/kg	2.50		107	60-140			
Surrogate: 4-Bromofluorobenzene	2.66		mg/kg	2.50		106	65-140			
LCS Analyzed: 01/24/2012 (12A2760-BS2)										
Volatile Fuel Hydrocarbons (C4-C12)	56.0	10	mg/kg	50.0		112	60-130			
Surrogate: Dibromofluoromethane	2.55		mg/kg	2.50		102	55-140			
Surrogate: Toluene-d8	2.78		mg/kg	2.50		111	60-140			
Surrogate: 4-Bromofluorobenzene	2.86		mg/kg	2.50		115	65-140			
LCS Dup Analyzed: 01/24/2012 (12A2760-BSD2)										
Volatile Fuel Hydrocarbons (C4-C12)	55.4	10	mg/kg	50.0		111	60-130	1	25	
Surrogate: Dibromofluoromethane	2.46		mg/kg	2.50		98	55-140			
Surrogate: Toluene-d8	2.70		mg/kg	2.50		108	60-140			
Surrogate: 4-Bromofluorobenzene	2.76		mg/kg	2.50		110	65-140			

TestAmerica Irvine

Philip Sanelle
Project Manager

Conestoga-Rovers & Associates - Emeryville Shell
 5900 Hollis St., Suite A
 Emeryville, CA 94608
 Attention: Peter Schaefer

Project ID: 3420 San Pablo Ave., Oakland, CA

Report Number: IVA1728

Sampled: 01/16/12
 Received: 01/18/12

METHOD BLANK/QC DATA

VOLATILE FUEL HYDROCARBONS BY GC/MS (CA LUFT)

Analyte	Result	Reporting Limit	Units	Spike Level	Source Result	%REC	%REC Limits	RPD	RPD Limit	Data Qualifiers
Batch: 12A2760 Extracted: 01/23/12										
Matrix Spike Analyzed: 01/24/2012 (12A2760-MS1)					Source: IVA1728-18					
Volatile Fuel Hydrocarbons (C4-C12)	290	10	mg/kg	162	176	70	55-140			
Surrogate: Dibromofluoromethane	2.56		mg/kg	2.50		103	55-140			
Surrogate: Toluene-d8	2.70		mg/kg	2.50		108	60-140			
Surrogate: 4-Bromofluorobenzene	2.87		mg/kg	2.50		115	65-140			
Matrix Spike Dup Analyzed: 01/24/2012 (12A2760-MSD1)					Source: IVA1728-18					
Volatile Fuel Hydrocarbons (C4-C12)	278	10	mg/kg	162	176	63	55-140	4	25	
Surrogate: Dibromofluoromethane	2.48		mg/kg	2.50		99	55-140			
Surrogate: Toluene-d8	2.70		mg/kg	2.50		108	60-140			
Surrogate: 4-Bromofluorobenzene	2.73		mg/kg	2.50		109	65-140			

TestAmerica Irvine

Philip Sanelle
 Project Manager

Conestoga-Rovers & Associates - Emeryville Shell
 5900 Hollis St., Suite A
 Emeryville, CA 94608
 Attention: Peter Schaefer

Project ID: 3420 San Pablo Ave., Oakland, CA

Report Number: IVA1728

Sampled: 01/16/12
 Received: 01/18/12

METHOD BLANK/QC DATA

VOLATILE FUEL HYDROCARBONS BY GC/MS (EPA 5035/CA LUFT)

Analyte	Result	Reporting Limit	Units	Spike Level	Source Result	%REC %REC	Limits	RPD	RPD Limit	Data Qualifiers
Batch: 12A2621 Extracted: 01/21/12										
Blank Analyzed: 01/21/2012 (12A2621-BLK1)										
Volatile Fuel Hydrocarbons (C4-C12)	ND	0.10	mg/kg							
Surrogate: Dibromofluoromethane	0.0522		mg/kg	0.0500		104	80-135			
Surrogate: Toluene-d8	0.0518		mg/kg	0.0500		104	80-120			
Surrogate: 4-Bromofluorobenzene	0.0522		mg/kg	0.0500		104	75-120			
MNRI										
LCS Analyzed: 01/21/2012 (12A2621-BS2)										
Volatile Fuel Hydrocarbons (C4-C12)	0.993	0.10	mg/kg	1.00		99	55-135			
Surrogate: Dibromofluoromethane	0.0532		mg/kg	0.0500		106	80-135			
Surrogate: Toluene-d8	0.0515		mg/kg	0.0500		103	80-120			
Surrogate: 4-Bromofluorobenzene	0.0535		mg/kg	0.0500		107	75-120			
LCS Dup Analyzed: 01/21/2012 (12A2621-BSD2)										
Volatile Fuel Hydrocarbons (C4-C12)	0.938	0.10	mg/kg	1.00		94	55-135	6	20	
Surrogate: Dibromofluoromethane	0.0499		mg/kg	0.0500		100	80-135			
Surrogate: Toluene-d8	0.0507		mg/kg	0.0500		101	80-120			
Surrogate: 4-Bromofluorobenzene	0.0522		mg/kg	0.0500		104	75-120			
Batch: 12A3008 Extracted: 01/25/12										
Blank Analyzed: 01/25/2012 (12A3008-BLK1)										
Volatile Fuel Hydrocarbons (C4-C12)	ND	0.10	mg/kg							
Surrogate: Dibromofluoromethane	0.0537		mg/kg	0.0500		107	80-135			
Surrogate: Toluene-d8	0.0524		mg/kg	0.0500		105	80-120			
Surrogate: 4-Bromofluorobenzene	0.0532		mg/kg	0.0500		106	75-120			
LCS Analyzed: 01/25/2012 (12A3008-BS2)										
Volatile Fuel Hydrocarbons (C4-C12)	0.948	0.10	mg/kg	1.00		95	55-135			
Surrogate: Dibromofluoromethane	0.0536		mg/kg	0.0500		107	80-135			
Surrogate: Toluene-d8	0.0531		mg/kg	0.0500		106	80-120			
Surrogate: 4-Bromofluorobenzene	0.0538		mg/kg	0.0500		108	75-120			

TestAmerica Irvine

Philip Sanelle
 Project Manager

Conestoga-Rovers & Associates - Emeryville Shell
5900 Hollis St., Suite A
Emeryville, CA 94608
Attention: Peter Schaefer

Project ID: 3420 San Pablo Ave., Oakland, CA

Report Number: IVA1728

Sampled: 01/16/12
Received: 01/18/12

METHOD BLANK/QC DATA

VOLATILE FUEL HYDROCARBONS BY GC/MS (EPA 5035/CA LUFT)

Analyte	Result	Reporting Limit	Units	Spike Level	Source Result	%REC	Limit	RPD	RPD Limit	Data Qualifiers
Batch: 12A3008 Extracted: 01/25/12										
LCS Dup Analyzed: 01/25/2012 (12A3008-BSD2)										
Volatile Fuel Hydrocarbons (C4-C12)	0.986	0.10	mg/kg	1.00		99	55-135	4	20	
Surrogate: Dibromofluoromethane	0.0545		mg/kg	0.0500		109	80-135			
Surrogate: Toluene-d8	0.0522		mg/kg	0.0500		104	80-120			
Surrogate: 4-Bromofluorobenzene	0.0525		mg/kg	0.0500		105	75-120			

TestAmerica Irvine

Philip Sanelle
Project Manager

The results pertain only to the samples tested in the laboratory. This report shall not be reproduced, except in full, without written permission from TestAmerica.

IVA1728 <Page 17 of 27>

Conestoga-Rovers & Associates - Emeryville Shell
 5900 Hollis St., Suite A
 Emeryville, CA 94608
 Attention: Peter Schaefer

Project ID: 3420 San Pablo Ave., Oakland, CA

Report Number: IVA1728

Sampled: 01/16/12

Received: 01/18/12

METHOD BLANK/QC DATA

VOLATILE ORGANICS by GC/MS (EPA 5030B/8260B)

Analyte	Result	Reporting Limit	Units	Spike Level	Source Result	%REC	%REC Limits	RPD	RPD Limit	Data Qualifiers
Batch: 12A2634 Extracted: 01/21/12										
Blank Analyzed: 01/21/2012 (12A2634-BLK1)										
Benzene	ND	0.0010	mg/kg							
Ethylbenzene	ND	0.0010	mg/kg							
Toluene	ND	0.0010	mg/kg							
m,p-Xylenes	ND	0.0020	mg/kg							
o-Xylene	ND	0.0010	mg/kg							
Xylenes, Total	ND	0.0020	mg/kg							
Methyl-tert-butyl Ether (MTBE)	ND	0.0020	mg/kg							
Surrogate: 4-Bromofluorobenzene	0.0528		mg/kg	0.0500		106	80-120			
Surrogate: Dibromofluoromethane	0.0504		mg/kg	0.0500		101	80-125			
Surrogate: Toluene-d8	0.0512		mg/kg	0.0500		102	80-120			
LCS Analyzed: 01/21/2012 (12A2634-BS1)										
Benzene	0.0449	0.0010	mg/kg	0.0500		90	65-120			
Ethylbenzene	0.0482	0.0010	mg/kg	0.0500		96	70-125			
Toluene	0.0460	0.0010	mg/kg	0.0500		92	70-125			
m,p-Xylenes	0.0963	0.0020	mg/kg	0.100		96	70-125			
o-Xylene	0.0487	0.0010	mg/kg	0.0500		97	70-125			
Xylenes, Total	0.145	0.0020	mg/kg	0.150		97	70-125			
Methyl-tert-butyl Ether (MTBE)	0.0463	0.0020	mg/kg	0.0500		93	60-140			
Surrogate: 4-Bromofluorobenzene	0.0529		mg/kg	0.0500		106	80-120			
Surrogate: Dibromofluoromethane	0.0510		mg/kg	0.0500		102	80-125			
Surrogate: Toluene-d8	0.0533		mg/kg	0.0500		107	80-120			
Matrix Spike Analyzed: 01/21/2012 (12A2634-MS1)										
Source: IVA1728-14										
Benzene	0.0516	0.0010	mg/kg	0.0498	ND	104	65-130			
Ethylbenzene	0.0568	0.0010	mg/kg	0.0498	ND	114	70-135			
Toluene	0.0535	0.0010	mg/kg	0.0498	ND	107	70-130			
m,p-Xylenes	0.114	0.0020	mg/kg	0.0996	ND	114	70-130			
o-Xylene	0.0575	0.0010	mg/kg	0.0498	ND	115	65-130			
Xylenes, Total	0.171	0.0020	mg/kg	0.149	ND	115	70-125			
Methyl-tert-butyl Ether (MTBE)	0.0567	0.0020	mg/kg	0.0498	ND	114	55-155			
Surrogate: 4-Bromofluorobenzene	0.0551		mg/kg	0.0498		111	80-120			
Surrogate: Dibromofluoromethane	0.0505		mg/kg	0.0498		101	80-125			
Surrogate: Toluene-d8	0.0525		mg/kg	0.0498		105	80-120			

TestAmerica Irvine

Philip Sanelle
 Project Manager

Conestoga-Rovers & Associates - Emeryville Shell
5900 Hollis St., Suite A
Emeryville, CA 94608
Attention: Peter Schaefer

Project ID: 3420 San Pablo Ave., Oakland, CA

Report Number: IVA1728

Sampled: 01/16/12

Received: 01/18/12

METHOD BLANK/QC DATA

VOLATILE ORGANICS by GC/MS (EPA 5030B/8260B)

Analyte	Result	Reporting Limit	Units	Spike Level	Source Result	%REC	%REC Limits	RPD	RPD Limit	Data Qualifiers
Batch: 12A2634 Extracted: 01/21/12										
Matrix Spike Dup Analyzed: 01/21/2012 (12A2634-MSD1)					Source: IVA1728-14					
Benzene	0.0494	0.00099	mg/kg	0.0494	ND	100	65-130	4	20	
Ethylbenzene	0.0541	0.00099	mg/kg	0.0494	ND	109	70-135	5	25	
Toluene	0.0497	0.00099	mg/kg	0.0494	ND	101	70-130	7	20	
m,p-Xylenes	0.107	0.0020	mg/kg	0.0988	ND	109	70-130	6	25	
o-Xylene	0.0552	0.00099	mg/kg	0.0494	ND	112	65-130	4	25	
Xylenes, Total	0.163	0.0020	mg/kg	0.148	ND	110	70-125	5	25	
Methyl-tert-butyl Ether (MTBE)	0.0535	0.0020	mg/kg	0.0494	ND	108	55-155	6	35	
Surrogate: 4-Bromofluorobenzene	0.0543		mg/kg	0.0494		110	80-120			
Surrogate: Dibromofluoromethane	0.0497		mg/kg	0.0494		101	80-125			
Surrogate: Toluene-d8	0.0520		mg/kg	0.0494		105	80-120			

Batch: 12A2730 Extracted: 01/23/12

Blank Analyzed: 01/23/2012 (12A2730-BLK1)

Benzene	ND	0.0010	mg/kg							
Ethylbenzene	ND	0.0010	mg/kg							
Toluene	ND	0.0010	mg/kg							
m,p-Xylenes	ND	0.0020	mg/kg							
o-Xylene	ND	0.0010	mg/kg							
Xylenes, Total	ND	0.0020	mg/kg							
Methyl-tert-butyl Ether (MTBE)	ND	0.0020	mg/kg							
Surrogate: 4-Bromofluorobenzene	0.0495		mg/kg	0.0500		99	80-120			
Surrogate: Dibromofluoromethane	0.0491		mg/kg	0.0500		98	80-125			
Surrogate: Toluene-d8	0.0516		mg/kg	0.0500		103	80-120			

LCS Analyzed: 01/23/2012 (12A2730-BS1)

Benzene	0.0480	0.0010	mg/kg	0.0500		96	65-120			
Ethylbenzene	0.0478	0.0010	mg/kg	0.0500		96	70-125			
Toluene	0.0496	0.0010	mg/kg	0.0500		99	70-125			
m,p-Xylenes	0.0963	0.0020	mg/kg	0.100		96	70-125			
o-Xylene	0.0482	0.0010	mg/kg	0.0500		96	70-125			
Xylenes, Total	0.145	0.0020	mg/kg	0.150		96	70-125			
Methyl-tert-butyl Ether (MTBE)	0.0484	0.0020	mg/kg	0.0500		97	60-140			
Surrogate: 4-Bromofluorobenzene	0.0534		mg/kg	0.0500		107	80-120			
Surrogate: Dibromofluoromethane	0.0502		mg/kg	0.0500		100	80-125			
Surrogate: Toluene-d8	0.0530		mg/kg	0.0500		106	80-120			

TestAmerica Irvine

Philip Sanelle
Project Manager

The results pertain only to the samples tested in the laboratory. This report shall not be reproduced, except in full, without written permission from TestAmerica.

Conestoga-Rovers & Associates - Emeryville Shell
5900 Hollis St., Suite A
Emeryville, CA 94608
Attention: Peter Schaefer

Project ID: 3420 San Pablo Ave., Oakland, CA

Report Number: IVA1728

Sampled: 01/16/12
Received: 01/18/12

METHOD BLANK/QC DATA

VOLATILE ORGANICS by GC/MS (EPA 5030B/8260B)

Analyte	Result	Reporting Limit	Units	Spike Level	Source Result	%REC	%REC Limits	RPD	RPD Limit	Data Qualifiers
Batch: 12A2730 Extracted: 01/23/12										
Matrix Spike Analyzed: 01/23/2012 (12A2730-MS1)						Source: IVA1736-01				
Benzene	0.0594	0.0010	mg/kg	0.0500	ND	119	65-130			
Ethylbenzene	0.0570	0.0010	mg/kg	0.0500	ND	114	70-135			
Toluene	0.0599	0.0010	mg/kg	0.0500	ND	120	70-130			
m,p-Xylenes	0.114	0.0020	mg/kg	0.100	ND	114	70-130			
o-Xylene	0.0573	0.0010	mg/kg	0.0500	ND	115	65-130			
Xylenes, Total	0.172	0.0020	mg/kg	0.150	ND	114	70-125			
Methyl-tert-butyl Ether (MTBE)	0.0749	0.0020	mg/kg	0.0500	ND	150	55-155			
Surrogate: 4-Bromofluorobenzene	0.0526		mg/kg	0.0500		105	80-120			
Surrogate: Dibromofluoromethane	0.0321		mg/kg	0.0500		64	80-125			Z
Surrogate: Toluene-d8	0.0521		mg/kg	0.0500		104	80-120			

Batch: 12A2760 Extracted: 01/23/12

Blank Analyzed: 01/24/2012 (12A2760-BLK1)

Benzene	ND	0.050	mg/kg							
Ethylbenzene	ND	0.050	mg/kg							
Toluene	ND	0.050	mg/kg							
m,p-Xylenes	ND	0.10	mg/kg							
o-Xylene	ND	0.050	mg/kg							
Xylenes, Total	ND	0.10	mg/kg							
Methyl-tert-butyl Ether (MTBE)	ND	0.10	mg/kg							
Surrogate: 4-Bromofluorobenzene	2.66		mg/kg	2.50		106	65-140			
Surrogate: Dibromofluoromethane	2.48		mg/kg	2.50		99	55-140			
Surrogate: Toluene-d8	2.66		mg/kg	2.50		107	60-140			

LCS Analyzed: 01/24/2012 (12A2760-BS1)

Benzene	2.45	0.050	mg/kg	2.50		98	65-120			
Ethylbenzene	2.66	0.050	mg/kg	2.50		106	80-120			
Toluene	2.47	0.050	mg/kg	2.50		99	80-120			
m,p-Xylenes	5.32	0.10	mg/kg	5.00		106	70-125			
o-Xylene	2.71	0.050	mg/kg	2.50		108	70-125			
Xylenes, Total	8.02	0.10	mg/kg	7.50		107	70-125			
Methyl-tert-butyl Ether (MTBE)	2.43	0.10	mg/kg	2.50		97	55-145			
Surrogate: 4-Bromofluorobenzene	2.68		mg/kg	2.50		107	65-140			
Surrogate: Dibromofluoromethane	2.50		mg/kg	2.50		100	55-140			
Surrogate: Toluene-d8	2.68		mg/kg	2.50		107	60-140			

TestAmerica Irvine

Philip Sanelle
Project Manager

Conestoga-Rovers & Associates - Emeryville Shell
5900 Hollis St., Suite A
Emeryville, CA 94608
Attention: Peter Schaefer

Project ID: 3420 San Pablo Ave., Oakland, CA

Report Number: IVA1728

Sampled: 01/16/12
Received: 01/18/12

METHOD BLANK/QC DATA

VOLATILE ORGANICS by GC/MS (EPA 5030B/8260B)

Analyte	Result	Reporting Limit	Units	Spike Level	Source Result	%REC	%REC Limits	RPD	RPD Limit	Data Qualifiers
Batch: 12A2760 Extracted: 01/23/12										
LCS Dup Analyzed: 01/24/2012 (12A2760-BSD1)										
Benzene	2.51	0.050	mg/kg	2.50		101	65-120	2	20	
Ethylbenzene	2.82	0.050	mg/kg	2.50		113	80-120	6	20	
Toluene	2.52	0.050	mg/kg	2.50		101	80-120	2	20	
m,p-Xylenes	5.66	0.10	mg/kg	5.00		113	70-125	6	20	
o-Xylene	2.86	0.050	mg/kg	2.50		114	70-125	5	20	
Xylenes, Total	8.52	0.10	mg/kg	7.50		114	70-125	6	20	
Methyl-tert-butyl Ether (MTBE)	2.33	0.10	mg/kg	2.50		93	55-145	4	25	
Surrogate: 4-Bromofluorobenzene	2.86		mg/kg	2.50		114	65-140			
Surrogate: Dibromofluoromethane	2.60		mg/kg	2.50		104	55-140			
Surrogate: Toluene-d8	2.80		mg/kg	2.50		112	60-140			
Matrix Spike Analyzed: 01/24/2012 (12A2760-MS1)										
					Source: IVA1728-18					
Benzene	2.58	0.050	mg/kg	2.50	0.222	94	55-140			
Ethylbenzene	4.13	0.050	mg/kg	2.50	1.61	101	50-150			
Toluene	2.48	0.050	mg/kg	2.50	ND	99	55-140			
m,p-Xylenes	5.44	0.10	mg/kg	5.00	ND	109	60-145			
o-Xylene	2.72	0.050	mg/kg	2.50	ND	109	55-145			
Xylenes, Total	8.16	0.10	mg/kg	7.50	ND	109	55-145			
Methyl-tert-butyl Ether (MTBE)	2.37	0.10	mg/kg	2.50	ND	95	55-155			
Surrogate: 4-Bromofluorobenzene	2.87		mg/kg	2.50		115	65-140			
Surrogate: Dibromofluoromethane	2.56		mg/kg	2.50		103	55-140			
Surrogate: Toluene-d8	2.70		mg/kg	2.50		108	60-140			
Matrix Spike Dup Analyzed: 01/24/2012 (12A2760-MSD1)										
					Source: IVA1728-18					
Benzene	2.58	0.050	mg/kg	2.50	0.222	94	55-140	0.08	25	
Ethylbenzene	4.00	0.050	mg/kg	2.50	1.61	96	50-150	3	25	
Toluene	2.52	0.050	mg/kg	2.50	ND	101	55-140	1	25	
m,p-Xylenes	5.49	0.10	mg/kg	5.00	ND	110	60-145	1	25	
o-Xylene	2.74	0.050	mg/kg	2.50	ND	110	55-145	0.9	25	
Xylenes, Total	8.24	0.10	mg/kg	7.50	ND	110	55-145	1	25	
Methyl-tert-butyl Ether (MTBE)	2.19	0.10	mg/kg	2.50	ND	88	55-155	8	30	
Surrogate: 4-Bromofluorobenzene	2.73		mg/kg	2.50		109	65-140			
Surrogate: Dibromofluoromethane	2.48		mg/kg	2.50		99	55-140			
Surrogate: Toluene-d8	2.70		mg/kg	2.50		108	60-140			

TestAmerica Irvine

Philip Sanelle
Project Manager

Conestoga-Rovers & Associates - Emeryville Shell
5900 Hollis St., Suite A
Emeryville, CA 94608
Attention: Peter Schaefer

Project ID: 3420 San Pablo Ave., Oakland, CA

Report Number: IVA1728

Sampled: 01/16/12

Received: 01/18/12

METHOD BLANK/QC DATA

BTEX/OXYGENATES by GC/MS (EPA 5035/8260B)

Analyte	Result	Reporting Limit	Units	Spike Level	Source Result	%REC %REC	Limits RPD	RPD Limit	Data Qualifiers
Batch: 12A2621 Extracted: 01/21/12									
Blank Analyzed: 01/21/2012 (12A2621-BLK1)									
Benzene	ND	0.0020	mg/kg						
Ethylbenzene	ND	0.0020	mg/kg						
Toluene	ND	0.0020	mg/kg						
m,p-Xylenes	ND	0.0020	mg/kg						
o-Xylene	ND	0.0020	mg/kg						
Xylenes, Total	ND	0.0040	mg/kg						
Di-isopropyl Ether (DIPE)	ND	0.0050	mg/kg						
Ethyl tert-Butyl Ether (ETBE)	ND	0.0050	mg/kg						
Methyl-tert-butyl Ether (MTBE)	ND	0.0050	mg/kg						
tert-Amyl Methyl Ether (TAME)	ND	0.0050	mg/kg						
tert-Butanol (TBA)	ND	0.050	mg/kg						
Ethanol	ND	0.30	mg/kg						
Surrogate: 4-Bromofluorobenzene	0.0522		mg/kg	0.0500		104	75-120		
Surrogate: Dibromofluoromethane	0.0522		mg/kg	0.0500		104	80-135		
Surrogate: Toluene-d8	0.0518		mg/kg	0.0500		104	80-120		
LCS Analyzed: 01/21/2012 (12A2621-BS1)									
Benzene	0.0440	0.0020	mg/kg	0.0500		88	65-120		MNR1
Ethylbenzene	0.0434	0.0020	mg/kg	0.0500		87	70-120		
Toluene	0.0458	0.0020	mg/kg	0.0500		92	70-120		
m,p-Xylenes	0.0878	0.0020	mg/kg	0.100		88	65-120		
o-Xylene	0.0442	0.0020	mg/kg	0.0500		88	70-125		
Xylenes, Total	0.132	0.0040	mg/kg	0.150		88	65-120		
Di-isopropyl Ether (DIPE)	0.0524	0.0050	mg/kg	0.0500		105	75-140		
Ethyl tert-Butyl Ether (ETBE)	0.0578	0.0050	mg/kg	0.0500		116	70-150		
Methyl-tert-butyl Ether (MTBE)	0.0586	0.0050	mg/kg	0.0500		117	75-150		
tert-Amyl Methyl Ether (TAME)	0.0613	0.0050	mg/kg	0.0500		123	75-150		
tert-Butanol (TBA)	0.231	0.050	mg/kg	0.250		92	70-125		
Ethanol	0.272	0.30	mg/kg	0.500		54	35-160		
Surrogate: 4-Bromofluorobenzene	0.0531		mg/kg	0.0500		106	75-120		
Surrogate: Dibromofluoromethane	0.0529		mg/kg	0.0500		106	80-135		
Surrogate: Toluene-d8	0.0506		mg/kg	0.0500		101	80-120		

TestAmerica Irvine

Philip Sanelle
Project Manager

The results pertain only to the samples tested in the laboratory. This report shall not be reproduced, except in full, without written permission from TestAmerica.

Conestoga-Rovers & Associates - Emeryville Shell
 5900 Hollis St., Suite A
 Emeryville, CA 94608
 Attention: Peter Schaefer

Project ID: 3420 San Pablo Ave., Oakland, CA

Report Number: IVA1728

Sampled: 01/16/12
 Received: 01/18/12

METHOD BLANK/QC DATA

BTEX/OXYGENATES by GC/MS (EPA 5035/8260B)

Analyte	Result	Reporting Limit	Units	Spike Level	Source Result	%REC %REC	Limits	RPD	RPD Limit	Data Qualifiers
Batch: 12A2621 Extracted: 01/21/12										
LCS Dup Analyzed: 01/21/2012 (12A2621-BSD1)										
Benzene	0.0445	0.0020	mg/kg	0.0500		89	65-120	1	20	
Ethylbenzene	0.0442	0.0020	mg/kg	0.0500		88	70-120	2	20	
Toluene	0.0462	0.0020	mg/kg	0.0500		92	70-120	1	20	
m,p-Xylenes	0.0886	0.0020	mg/kg	0.100		89	65-120	0.9	20	
o-Xylene	0.0466	0.0020	mg/kg	0.0500		93	70-125	5	20	
Xylenes, Total	0.135	0.0040	mg/kg	0.150		90	65-120	2	20	
Di-isopropyl Ether (DIPE)	0.0539	0.0050	mg/kg	0.0500		108	75-140	3	20	
Ethyl tert-Butyl Ether (ETBE)	0.0578	0.0050	mg/kg	0.0500		116	70-150	0	20	
Methyl-tert-butyl Ether (MTBE)	0.0593	0.0050	mg/kg	0.0500		119	75-150	1	20	
tert-Amyl Methyl Ether (TAME)	0.0606	0.0050	mg/kg	0.0500		121	75-150	1	20	
tert-Butanol (TBA)	0.246	0.050	mg/kg	0.250		99	70-125	6	20	
Ethanol	0.279	0.30	mg/kg	0.500		56	35-160	2	30	
Surrogate: 4-Bromofluorobenzene	0.0519		mg/kg	0.0500		104	75-120			
Surrogate: Dibromofluoromethane	0.0517		mg/kg	0.0500		103	80-135			
Surrogate: Toluene-d8	0.0509		mg/kg	0.0500		102	80-120			

Batch: 12A3008 Extracted: 01/25/12

Blank Analyzed: 01/25/2012 (12A3008-BLK1)

Benzene	ND	0.0020	mg/kg							
Ethylbenzene	ND	0.0020	mg/kg							
Toluene	ND	0.0020	mg/kg							
m,p-Xylenes	ND	0.0020	mg/kg							
o-Xylene	ND	0.0020	mg/kg							
Xylenes, Total	ND	0.0040	mg/kg							
Di-isopropyl Ether (DIPE)	ND	0.0050	mg/kg							
Ethyl tert-Butyl Ether (ETBE)	ND	0.0050	mg/kg							
Methyl-tert-butyl Ether (MTBE)	ND	0.0050	mg/kg							
tert-Amyl Methyl Ether (TAME)	ND	0.0050	mg/kg							
tert-Butanol (TBA)	ND	0.050	mg/kg							
Ethanol	ND	0.30	mg/kg							
Surrogate: 4-Bromofluorobenzene	0.0532		mg/kg	0.0500		106	75-120			
Surrogate: Dibromofluoromethane	0.0537		mg/kg	0.0500		107	80-135			
Surrogate: Toluene-d8	0.0524		mg/kg	0.0500		105	80-120			

TestAmerica Irvine

Philip Sanelle
 Project Manager

Conestoga-Rovers & Associates - Emeryville Shell
5900 Hollis St., Suite A
Emeryville, CA 94608
Attention: Peter Schaefer

Project ID: 3420 San Pablo Ave., Oakland, CA

Report Number: IVA1728

Sampled: 01/16/12

Received: 01/18/12

METHOD BLANK/OC DATA

BTEX/OXYGENATES by GC/MS (EPA 5035/8260B)

Analyte	Result	Reporting Limit	Units	Spike Level	Source Result	%REC %REC	Limits	RPD	RPD Limit	Data Qualifiers
Batch: 12A3008 Extracted: 01/25/12										
LCS Analyzed: 01/25/2012 (12A3008-BS1)										
Benzene	0.0477	0.0020	mg/kg	0.0500		95	65-120			
Ethylbenzene	0.0462	0.0020	mg/kg	0.0500		92	70-120			
Toluene	0.0481	0.0020	mg/kg	0.0500		96	70-120			
m,p-Xylenes	0.0915	0.0020	mg/kg	0.100		92	65-120			
o-Xylene	0.0469	0.0020	mg/kg	0.0500		94	70-125			
Xylenes, Total	0.138	0.0040	mg/kg	0.150		92	65-120			
Di-isopropyl Ether (DIPE)	0.0542	0.0050	mg/kg	0.0500		108	75-140			
Ethyl tert-Butyl Ether (ETBE)	0.0543	0.0050	mg/kg	0.0500		109	70-150			
Methyl-tert-butyl Ether (MTBE)	0.0605	0.0050	mg/kg	0.0500		121	75-150			
tert-Amyl Methyl Ether (TAME)	0.0617	0.0050	mg/kg	0.0500		123	75-150			
tert-Butanol (TBA)	0.228	0.050	mg/kg	0.250		91	70-125			
Ethanol	0.342	0.30	mg/kg	0.500		68	35-160			
Surrogate: 4-Bromofluorobenzene	0.0555		mg/kg	0.0500		111	75-120			
Surrogate: Dibromofluoromethane	0.0553		mg/kg	0.0500		111	80-135			
Surrogate: Toluene-d8	0.0532		mg/kg	0.0500		106	80-120			
LCS Dup Analyzed: 01/25/2012 (12A3008-BSD1)										
Benzene	0.0463	0.0020	mg/kg	0.0500		93	65-120	3		20
Ethylbenzene	0.0444	0.0020	mg/kg	0.0500		89	70-120	4		20
Toluene	0.0481	0.0020	mg/kg	0.0500		96	70-120	0.04		20
m,p-Xylenes	0.0883	0.0020	mg/kg	0.100		88	65-120	4		20
o-Xylene	0.0456	0.0020	mg/kg	0.0500		91	70-125	3		20
Xylenes, Total	0.134	0.0040	mg/kg	0.150		89	65-120	3		20
Di-isopropyl Ether (DIPE)	0.0527	0.0050	mg/kg	0.0500		105	75-140	3		20
Ethyl tert-Butyl Ether (ETBE)	0.0536	0.0050	mg/kg	0.0500		107	70-150	1		20
Methyl-tert-butyl Ether (MTBE)	0.0601	0.0050	mg/kg	0.0500		120	75-150	0.7		20
tert-Amyl Methyl Ether (TAME)	0.0611	0.0050	mg/kg	0.0500		122	75-150	1		20
tert-Butanol (TBA)	0.219	0.050	mg/kg	0.250		88	70-125	4		20
Ethanol	0.322	0.30	mg/kg	0.500		64	35-160	6		30
Surrogate: 4-Bromofluorobenzene	0.0541		mg/kg	0.0500		108	75-120			
Surrogate: Dibromofluoromethane	0.0545		mg/kg	0.0500		109	80-135			
Surrogate: Toluene-d8	0.0524		mg/kg	0.0500		105	80-120			

TestAmerica Irvine

Philip Sanelle
Project Manager

Conestoga-Rovers & Associates - Emeryville Shell
 5900 Hollis St., Suite A
 Emeryville, CA 94608
 Attention: Peter Schaefer

Project ID: 3420 San Pablo Ave., Oakland, CA

Report Number: IVA1728

Sampled: 01/16/12

Received: 01/18/12

METHOD BLANK/QC DATA

METALS

Analyte	Result	Reporting Limit	Units	Spike Level	Source Result	%REC	%REC Limits	RPD	RPD Limit	Data Qualifiers
Batch: 12A2690 Extracted: 01/22/12										
Blank Analyzed: 01/23/2012 (12A2690-BLK1)										
Lead	ND	2.0	mg/kg							
LCS Analyzed: 01/23/2012 (12A2690-BS1)										
Lead	48.5	2.0	mg/kg	50.8		96	80-120			
Matrix Spike Analyzed: 01/23/2012 (12A2690-MS1)										
Lead	103	2.0	mg/kg	50.3	78.8	49	75-125			M2
Matrix Spike Dup Analyzed: 01/23/2012 (12A2690-MSD1)										
Lead	105	2.0	mg/kg	49.3	78.8	53	75-125	1	20	M2

TestAmerica Irvine

Philip Sanelle
 Project Manager

Conestoga-Rovers & Associates - Emeryville Shell
5900 Hollis St., Suite A
Emeryville, CA 94608
Attention: Peter Schaefer

Project ID: 3420 San Pablo Ave., Oakland, CA

Report Number: IVA1728

Sampled: 01/16/12

Received: 01/18/12

DATA QUALIFIERS AND DEFINITIONS

- M2** The MS and/or MSD were below the acceptance limits due to sample matrix interference. See Blank Spike (LCS).
- MCP** No results were reported for the MS and/or MSD due to a clogged autosampler port. Batch was accepted based on Blank Spike (LCS) recoveries.
- MNR1** There was no MS/MSD analyzed with this batch due to insufficient sample volume. See Blank Spike/Blank Spike Duplicate.
- Z** Due to sample matrix effects, the surrogate recovery was below the acceptance limits.
- ND** Analyte NOT DETECTED at or above the reporting limit or MDL, if MDL is specified.
- RPD** Relative Percent Difference

ADDITIONAL COMMENTS

For Volatile Fuel Hydrocarbons (C4-C12):

Volatile Fuel Hydrocarbons (C4-C12) are quantitated against a gasoline standard. Quantitation begins immediately before TBA-d9.

TestAmerica Irvine

Philip Sanelle
Project Manager

Conestoga-Rovers & Associates - Emeryville Shell
5900 Hollis St., Suite A
Emeryville, CA 94608
Attention: Peter Schaefer

Project ID: 3420 San Pablo Ave., Oakland, CA

Report Number: IVA1728

Sampled: 01/16/12

Received: 01/18/12

Certification Summary

TestAmerica Irvine

Method	Matrix	Nelac	California
EPA 6010B	Soil	X	X
EPA 8260B	Soil	X	X
TPH by GC/MS	Soil	X	X

Nevada and NELAP provide analyte specific accreditations. Analyte specific information for TestAmerica may be obtained by contacting the laboratory or visiting our website at www.testamericainc.com

TestAmerica Irvine

Philip Sanelle
Project Manager

1011010101



Shell Oil Products Chain Of Custody Record

LAB (LOCATION)

- CALSCIENCE ()
- SPL ()
- XENCO ()
- TEST AMERICA ()
- OTHER ()

Please Check Appropriate Box:

<input type="checkbox"/> ENV. SERVICES	<input type="checkbox"/> MOTIVA RETAIL	<input type="checkbox"/> SHELL RETAIL
<input type="checkbox"/> MOTIVA SD&CM	<input checked="" type="checkbox"/> CONSULTANT	<input type="checkbox"/> LUBES
<input type="checkbox"/> SHELL PIPELINE	<input type="checkbox"/> OTHER	

Print Bill To Contact Name: Peter Schaefer 240554

INCIDENT # (ENV SERVICES): _____

PO #: _____ **SAP #:** _____

DATE: 1/16/12 **PAGE:** 1 of 6

SAMPLING COMPANY: Conestoga-Rovers & Associates

LOG CODE: CRAW

ADDRESS: 5900 Hollis Street, Suite A, Emeryville, CA 94608

PROJECT CONTACT (Hardcopy or PDF Report to): Peter Schaefer

TELEPHONE: 510-420-3319 **FAX:** 510-420-9170 **E-MAIL:** pschaefer@croworld.com

TURNAROUND TIME (CALENDAR DAYS):
 STANDARD (14 DAY) 5 DAYS 3 DAYS 2 DAYS 24 HOURS RESULTS NEEDED ON WEEKEND

LA - RWQCB REPORT FORMAT UST AGENCY:

SITE ADDRESS: Street and City: 3420 San Pablo Ave, Oakland

State: Ca **GLOBAL ID NO.:** T0600101253

EOF DELIVERABLE TO (Name, Company, Office Location): Brenda Carter **PHONE NO.:** 510-420-3343 **E-MAIL:** shell.em.ef@croworld.com

CONSULTANT PROJECT NO.: 240554-95-11.02

SAMPLER NAME(S) (Print): Cristina Arganbright

LAB USE ONLY: JVA 1728

SPECIAL INSTRUCTIONS OR NOTES:

Copy of final report to Shell.Lab.Billing@croworld.com

SHELL CONTRACT RATE APPLIES
 STATE REIMBURSEMENT RATE APPLIES
 EDD NOT NEEDED
 RECEIPT VERIFICATION REQUESTED

REQUESTED ANALYSIS

LAB USE ONLY	Field Sample Identification	SAMPLING		MATRIX	PRESERVATIVE					NO. OF CONT.	ANALYSIS											TEMPERATURE ON RECEIPT C (CS) 5.2	Container PID Readings or Laboratory Notes					
		DATE	TIME		HCL	HNO3	H2SO4	NONE	NaHSO4		TPH -GRO, Purgeable (8260B)	TPH -DRO, Extractable (8015M)	TPH (8015M)	BTEX (8260B)	BTEX + MTBE (8260B)	BTEX + MTBE + TBA (8260B)	BTEX + 5 OXYs (MTBE, TBA, DIPE, TAME, ETBE) 8260B	Full VOC list (8260B)	Single Compound: (8260B)	1,2-DCA (8260B)	EDB (8260B)			Ethanol (8260B)	Methanol (8015M)			
	SB-7-1'	1/16	1101	SUI 1							X																	
	SB-7-2'	1/16	1113	SUI 1							X																	
	SB-8-1'	1/16	1157									X																
	SB-8-2'	1/16	1157									X																
	SB-9-1'	1/16	1148									X																
	SB-9-2'	1/16	1207									X																
	SB-10-1'	1/16	1331									X																
	SB-10-2'	1/16	1345									X																
	SB-12-1'	1/16	1012									X																
	SB-12-2'	1/16	1031									X																

Relinquished by (Signature): <i>[Signature]</i>	Received by (Signature): Emeryville office	Date: 1/16/12	Time: 1600
Relinquished by (Signature): <i>[Signature]</i>	Received by (Signature): <i>[Signature]</i>	Date: 1/16/12	Time: 16:00
Relinquished by (Signature): <i>[Signature]</i> 1-17-12 18:00	Received by (Signature): <i>[Signature]</i>	Date: 1/18/12	Time: 10:00

LAB (LOCATION)

- CALSCIENCE ()
- SPL ()
- XENCO ()
- TEST AMERICA ()
- OTHER ()



Shell Oil Products Chain Of Custody Record

Please Check Appropriate Box:

<input type="checkbox"/> ENV. SERVICES	<input type="checkbox"/> MOTIVA RETAIL	<input type="checkbox"/> SHELL RETAIL
<input type="checkbox"/> MOTIVA SD&CM	<input checked="" type="checkbox"/> CONSULTANT	<input type="checkbox"/> LUBES
<input type="checkbox"/> SHELL PIPELINE	<input type="checkbox"/> OTHER _____	

Print Bill To Contact Name: Peter Schaefer 240554

INCIDENT # (ENV SERVICES) _____

PO # _____ **SAP #** _____

CHECK IF NO INCIDENT # APPLIES

DATE: 1/16/12
PAGE: 2 of 6

SAMPLING COMPANY: Conestoga-Rovers & Associates

LOG CODE: CRAW

ADDRESS: 5900 Hollis Street, Suite A, Emeryville, CA 94608

PROJECT CONTACT (Hardcopy or PDF Report): Peter Schaefer

TELEPHONE: 510-420-3319 FAX: 510-420-9170 E-MAIL: pschaefer@croworld.com

SITE ADDRESS: Street and City: 3420 San Pablo Ave, Oakland, Ca

GLOBAL ID NO.: T0600101253

EDF DELIVERABLE TO (Name, Company, Office Location): Brenda Carter

PHONE NO.: 510-420-3343

E-MAIL: shell.em.ef@croworld.com

CONSULTANT PROJECT NO.: 240554-95-11.02

SAMPLER NAME(S) (Print): Cristina Arganbright

LAB USE ONLY: ZVA1728

TURNAROUND TIME (CALENDAR DAYS):

STANDARD (14 DAY) 5 DAYS 3 DAYS 2 DAYS 24 HOURS ON WEEKEND

RESULTS NEEDED

LA - RWQCB REPORT FORMAT UST AGENCY:

REQUESTED ANALYSIS

SPECIAL INSTRUCTIONS OR NOTES :

Copy of final report to Shell.Lab.Billing@croworld.com

SHELL CONTRACT RATE APPLIES

STATE REIMBURSEMENT RATE APPLIES

EDD NOT NEEDED

RECEIPT VERIFICATION REQUESTED

LAB USE ONLY	Field Sample Identification	SAMPLING		MATRIX	PRESERVATIVE					NO. OF CONT.	REQUESTED ANALYSIS												TEMPERATURE ON RECEIPT		
		DATE	TIME		HCL	HNO3	H2SO4	NONE	NaHSO4		TPH -GRO, Purgeable (8260B)	TPH -DRO, Extractable (8016M)	TPHg (8016M)	BTEX (8260B)	BTEX + MTBE (8260B)	BTEX + MTBE + TBA (8260B)	BTEX + 6 OXY's (MTBE, TBA, DIPE, TAME, ETBE) 8260B	Full VOC list (8260B)	Single Compound: (8260B)	1,2-DCA (8260B)	EDB (8260B)	Ethanol (8260B)		Methanol (8016M)	
	SB-11-1'	1/16	0840	Soil					X	X															59
	SB-11-2'	1/16	0943						X	X															
	SB-12-1'	1/16	1012						X	X															
	SB-12-2'	1/16	1031						X	X															

Relinquished by: (Signature)	Received by: (Signature)	Date:	Time:
<i>[Signature]</i>	Emeryville Office	1/16/12	1600
Relinquished by: (Signature)	Received by: (Signature)	Date:	Time:
<i>[Signature]</i>	<i>[Signature]</i>	1-16-12	16:00
Relinquished by: (Signature)	Received by: (Signature)	Date:	Time:
<i>[Signature]</i> 1-17-12 18:00	<i>[Signature]</i>	1/18/12	10:00

LAB (LOCATION)

- CALSCIENCE ()
- SPL ()
- XENCO ()
- TEST AMERICA ()
- OTHER ()



Shell Oil Products Chain Of Custody Record

Please Check Appropriate Box:

<input type="checkbox"/> ENV. SERVICES	<input type="checkbox"/> MOTIVA RETAIL	<input type="checkbox"/> SHELL RETAIL
<input type="checkbox"/> MOTIVA SD&CM	<input checked="" type="checkbox"/> CONSULTANT	<input type="checkbox"/> LUBES
<input type="checkbox"/> SHELL PIPELINE	<input type="checkbox"/> OTHER _____	

Print Bill To Contact Name:
Peter Schaefer 240554

PO # _____

INCIDENT # (ENV SERVICES) _____

SAP # _____

CHECK IF NO INCIDENT # APPLIES

DATE: **11/16/12**

PAGE: **3** of **6**

SAMPLING COMPANY: **Conestoga-Rovers & Associates** LOG CODE: **CRAW**

ADDRESS: **19449 Riverside Drive, Suite 230, Sonoma, CA 95478** **5900 Hollis St., Emeryville CA 94608**

PROJECT CONTACT (hardcopy or PDF Report to): **Peter Schaefer**

TELEPHONE: **510-420-3319** FAX: **510-420-9170** EMAIL: **pschaefer@creworld.com**

TURNAROUND TIME (CALENDAR DAYS):
 STANDARD (14 DAY) 5 DAYS 3 DAYS 2 DAYS 24 HOURS RESULTS NEEDED ON WEEKEND

LA - RWQCB REPORT FORMAT UST AGENCY:

SPECIAL INSTRUCTIONS OR NOTES :
 Copy of final report to Shell.Lab.Billing@creworld.com

SHELL CONTRACT RATE APPLIES
 STATE REIMBURSEMENT RATE APPLIES
 EDD NOT NEEDED
 RECEIPT VERIFICATION REQUESTED

SITE ADDRESS: Street and City: **3420 San Pablo Ave., Oakland CA** State: **CA** GLOBAL ID NO.: **70600101253**

EDF DELIVERABLE TO (Name, Company, Office Location): **Brenda Carter** PHONE NO.: **510-420-3343** E-MAIL: **shell.em.ef@creworld.com** CONSULTANT PROJECT NO.: **240554-95-11.02**

Fellow Ballard, CRA, Sonoma: **707-935-4669** sonomaedf@creworld.com

SAMPLER NAME(S) (Print): **Cristina Arganbrijo** LAB USE ONLY: **IVA1728**

REQUESTED ANALYSIS

LAB USE ONLY	Field Sample Identification	SAMPLING		MATRX	PRESERVATIVE					Methanol CH ₃ OH OTHER	NO. OF CONT.	REQUESTED ANALYSIS													TEMPERATURE ON RECEIPT °C 59.5	Container PID Readings or Laboratory Notes	
		DATE	TIME		HCL	HNO3	H2SO4	NONE	TPH -GRO, Purgeable (8260B)			TPH -DRO, Extractable (8015M)	TPHg (8015M)	BTEX (8260B)	BTEX + MTBE (8260B)	BTEX + MTBE + TBA (8260B)	BTEX + 5 OXYs (MTBE, TBA, DIPE, TAME, ETBE) 8260B	Full VOC list (8260B)	Single Compound: (8260B)	1,2-DCA (8260B)	EDB (8260B)	Ethanol (8260B)	Methanol (8015M)				
	SB-7-1'	4/19	1101	SOV1						X	1	X															
	SB-7-2'	4/16	1113							X	1	X															
	SB-8-1'	4/16	1137							X	1	X															
	SB-8-2'	4/16	1157							X	1	X															
	SB-9-1'	4/16	1148							X	1	X															
	SB-9-2'	4/16	1207							X	1	X															
	SB-10-1'	4/16	133							X	1	X															
	SB-10-2'	4/16	1348							X	1	X															
	SB-11-1'	4/16	1340							X	1	X															
	SB-11-2'	4/16	1343							X	1	X															

Relinquished by (Signature): <i>[Signature]</i>	Received by (Signature): Emeryville office	Date: 4/16/12	Time: 16:00
Relinquished by (Signature): <i>[Signature]</i>	Received by (Signature): Devalb Nayak	Date: 1-17-12	Time: 16:00
Relinquished by (Signature): Devalb Nayak	Received by (Signature): NuBank	Date: 1/18/12	Time: 10:00

403 Jars



Shell Oil Products Chain Of Custody Record

LAB (LOCATION)

- CALSCIENCE ()
- SPL ()
- XENCO ()
- TEST AMERICA ()
- OTHER ()

Please Check Appropriate Box:			Print Bill To Contact Name:			INCIDENT # (ENV SERVICES)			<input type="checkbox"/> CHECK IF NO INCIDENT # APPLIES		
<input type="checkbox"/> ENV. SERVICES	<input type="checkbox"/> MOTIVA RETAIL	<input type="checkbox"/> SHELL RETAIL	Peter Schaefer 240554						DATE: 1/16/12		
<input type="checkbox"/> MOTIVA SDACH	<input checked="" type="checkbox"/> CONSULTANT	<input type="checkbox"/> LUBES	PO #			SAP #			PAGE: 4 of 6		
<input type="checkbox"/> SHELL PIPELINE	<input type="checkbox"/> OTHER										

SAMPLING COMPANY: Conestoga-Rovers & Associates		LOG CODE: CRAW	SITE ADDRESS: Street and City 3420 San Pablo Ave, Oakland		State Ca	GLOBAL ID NO.: T0600101253
ADDRESS: 5900 Hollis Street, Suite A, Emeryville, CA 94608			EDF DELIVERABLE TO (Name, Company, Office Location): Brenda Carter		PHONE NO.: 510-420-3343	E-MAIL: shell.em.ef@craworld.com
PROJECT CONTACT (Hardcopy or PDF Report to): Peter Schaefer			SAMPLER NAME(S) (Print): Cristina Arganbright		CONSULTANT PROJECT NO.: 240554-95-11.02	
TELEPHONE: 510-420-3319	FAX: 510-420-9170	E-MAIL: pschaefer@craworld.com	LAB USE ONLY EVA 1728			

TURNAROUND TIME (CALENDAR DAYS):
 STANDARD (14 DAY)
 5 DAYS
 3 DAYS
 2 DAYS
 24 HOURS
 RESULTS NEEDED ON WEEKEND

LA - RWQCB REPORT FORMAT
 UST AGENCY:

REQUESTED ANALYSIS

SPECIAL INSTRUCTIONS OR NOTES :
 Copy of final report to Shell.Lab.Billing@craworld.com

SHELL CONTRACT RATE APPLIES
 STATE REIMBURSEMENT RATE APPLIES
 EDD NOT NEEDED
 RECEIPT VERIFICATION REQUESTED

LAB USE ONLY	Field Sample Identification	SAMPLING		MATRIX	PRESERVATIVE					NO. OF CONT.	TPH -GRO, Purgeable (8260B)	TPH -DRO, Extractable (8015M)	TPHg (8016M)	BTEX (8260B)	BTEX + MTBE (8260B)	BTEX + MTBE + TBA (8260B)	BTEX + 6 OXYs (MTBE, TBA, DIPE, TAME, ETBE) 8260B	Full VOC list (8260B)	Single Compound: (8260B)	1,2-DCA (8260B)	EDB (8260B)	Ethanol (8260B)	Methanol (8015M)	Lead (8010B)	TEMPERATURE ON RECEIPT °C	Container PID Readings or Laboratory Notes
		DATE	TIME		HCL	HNO3	H2SO4	NONE	NaHSO4																	
	SB-7-1'	1/16	1101	Soil																				X		
	SB7-2'	1/16	1113	Soil																				X		
	SB-8-1'	1/16	1137																					X		
	SB-8-2'	1/16	1157																					X		
	SB-9-1'	1/16	1148																					X		
	SB-9-2'	1/16	1207																					X		
	SB-10-1'	1/16	183																					X		
	SB-10-2'	1/16	1318																					X		
	SB-11-1'	1/16	0849																					X		
	SB-11-2'	1/16	0943																					X		

Relinquished by (Signature): <i>[Signature]</i>	Received by (Signature): <i>Emeryville Office</i>	Date: 1/16/12	Time: 1600
Relinquished by (Signature): <i>[Signature]</i>	Received by (Signature): <i>Geoff Taylor</i>	Date: 1-17-12	Time: 16:00
Relinquished by (Signature): <i>Geoff Taylor</i>	Received by (Signature): <i>Vu Bander</i>	Date: 1/18/12	Time: 10:00

403 Jars



Shell Oil Products Chain Of Custody Record

- LAB (LOCATION)
- CALSCIENCE ()
 - SPL ()
 - XENCO ()
 - TEST AMERICA ()
 - OTHER ()

Please Check Appropriate Box:

<input type="checkbox"/> ENV. SERVICES	<input type="checkbox"/> MOTIVA RETAIL	<input type="checkbox"/> SHELL RETAIL
<input type="checkbox"/> MOTIVA SD&CH	<input checked="" type="checkbox"/> CONSULTANT	<input type="checkbox"/> LUBES
<input type="checkbox"/> SHELL PIPELINE	<input type="checkbox"/> OTHER _____	

Print Bill To Contact Name: Peter Schaefer 240554

INCIDENT # (ENV SERVICES)

PO #

SAP #

CHECK IF NO INCIDENT # APPLIES

DATE: 1/16/12

PAGE: 5 of 6

SAMPLING COMPANY: **Conestoga-Rovers & Associates**

LOG CODE: **CRAW**

ADDRESS: **5900 Hollis Street, Suite A, Emeryville, CA 94608**

PROJECT CONTACT (Hardcopy or PDF Report to): **Peter Schaefer**

TELEPHONE: **510-420-3319** FAX: **510-420-9170** E-MAIL: **pschaefer@croworld.com**

SITE ADDRESS: Street and City: **3420 San Pablo Ave, Oakland**

State: **Ca** GLOBAL ID NO.: **T0600101253**

EDF DELIVERABLE TO (Name, Company, Office Location): **Brenda Carter** PHONE NO.: **510-420-3343** E-MAIL: **shell.em.eri@croworld.com** CONSULTANT PROJECT NO.: **240554-95-11.02**

SAMPLER NAME(S) (Print): **Cristina Arganbright**

LAB USE ONLY: **IVA 1798**

TURNAROUND TIME (CALENDAR DAYS):

STANDARD (14 DAY) 5 DAYS 3 DAYS 2 DAYS 24 HOURS RESULTS NEEDED ON WEEKEND

LA - RWQCB REPORT FORMAT UST AGENCY:

SPECIAL INSTRUCTIONS OR NOTES :
Copy of final report to Shell.Lab.Billing@croworld.com

SHELL CONTRACT RATE APPLIES
 STATE REIMBURSEMENT RATE APPLIES
 EDD NOT NEEDED
 RECEIPT VERIFICATION REQUESTED

REQUESTED ANALYSIS

TPH -GRO, Purgeable (8260B)	TPH -DRO, Extractable (8015M)	TPHg (8015M)	BTEX (8260B)	BTEX + MTBE (8260B)	BTEX + MTBE + TBA (8260B)	BTEX + 6 OXYs (MTBE, TBA, DIPE, TAME, ETBE) 8260B	Full VOC list (8260B)	Single Compound: (8260B)	1,2-DCA (8260B)	EDB (8260B)	Ethanol (8260B)	Methanol (8015M)	Lead (8010B)	TEMPERATURE ON RECEIPT 5.2
-----------------------------	-------------------------------	--------------	--------------	---------------------	---------------------------	---	-----------------------	--------------------------	-----------------	-------------	-----------------	------------------	--------------	-------------------------------

LAB USE ONLY	Field Sample Identification	SAMPLING		MATRIX	PRESERVATIVE					NO. OF CONT.	REQUESTED ANALYSIS													Container PID Readings or Laboratory Notes			
		DATE	TIME		HCL	HNO3	H2SO4	NONE	NaHSO4		TPH -GRO, Purgeable (8260B)	TPH -DRO, Extractable (8015M)	TPHg (8015M)	BTEX (8260B)	BTEX + MTBE (8260B)	BTEX + MTBE + TBA (8260B)	BTEX + 6 OXYs (MTBE, TBA, DIPE, TAME, ETBE) 8260B	Full VOC list (8260B)	Single Compound: (8260B)	1,2-DCA (8260B)	EDB (8260B)	Ethanol (8260B)	Methanol (8015M)		Lead (8010B)		
	SB-12-1'	1/14/12	5:00																								
	SB-12-2	1/16/12	3:00																								

Relinquished by: (Signature) <i>[Signature]</i>	Received by: (Signature) <i>Emeryville office</i>	Date: 1/16/12	Time: 16:00
Relinquished by: (Signature) <i>Hans Cab</i>	Received by: (Signature) <i>Leah Taylor</i>	Date: 1-17-12	Time: 16:00
Relinquished by: (Signature) <i>Leah Taylor</i>	Received by: (Signature) <i>V Bank</i>	Date: 1/18/12	Time: 10:00

