



RECEIVED

3:54 pm, Sep 06, 2011

Alameda County
Environmental Health

Olivia Skance
Team Lead
Marketing Business Unit

**Chevron Environmental
Management Company**
6101 Bollinger Canyon Road
San Ramon, CA 94583
Tel (925) 790-6521

August 30, 2011

Alameda County Environmental Health
1131 Harbor Bay Parkway, Suite 250
Alameda, CA 94502-6577

Re: Chevron Facility # 9-1583

Address: 5509 Martin Luther King Jr. Way, Oakland, California

I have reviewed the attached report titled Second Semi-Annual 2011 Groundwater Monitoring Report and dated August 30, 2011.

I agree with the conclusions and recommendations presented in the referenced report. The information in this report is accurate to the best of my knowledge and all local Agency/Regional Board guidelines have been followed. This report was prepared by Conestoga-Rovers & Associates, upon whose assistance and advice I have relied.

This letter is submitted pursuant to the requirements of California Water Code Section 13267(b)(1) and the regulating implementation entitled Appendix A pertaining thereto.

I declare under penalty of perjury that the foregoing is true and correct.

Sincerely,

Olivia Skance
Project Manager

Enclosure: Report



**CONESTOGA-ROVERS
& ASSOCIATES**

10969 Trade Center Drive
Rancho Cordova, California 95670
Telephone: (916) 889-8900 Fax: (916) 889-8999
<http://www.craworld.com>

August 30, 2011

Reference No. 611960

Mr. Mark Detterman, P.G., C.E.G.
Alameda County Environmental Health (ACEH)
1131 Harbor Bay Parkway, Suite 250
Alameda, California 94502-6577

Re: Second Semi-Annual 2011 Groundwater Monitoring Report
Former Chevron Service Station 9-1583
5509 Martin Luther King Jr. Way
Oakland, California
Case No. RO0000002

Dear Mr. Detterman:

Conestoga-Rovers & Associates (CRA) is submitting the attached *Groundwater Monitoring and Sampling Report* (report) on behalf of Chevron Environmental Management Company (Chevron) for the site referenced above. The report (prepared by Gettler-Ryan Inc. and dated August 4, 2011) presents the results of the second semi-annual 2011 monitoring event. Wells MW-7 and MW-8 are sampled semi-annually during the first and third quarters, and wells MW-1 through MW-6 are sampled annually during the first quarter. Also attached are Figure 1 (Vicinity Map) showing the site location, and Figure 2 (Concentration Map) presenting the second semi-annual 2011 analytical results along with a rose diagram. The monitoring results during 2011 are summarized below.

During 2011, petroleum hydrocarbon concentrations in the site wells were similar to or less than those observed during 2010, and overall decreasing trends are evident. Total petroleum hydrocarbons as gasoline (TPHg) were not detected in MW-1 through MW-7 during 2011, and have not been detected in these wells for at least several years. Low concentrations of TPHg (up to 200 micrograms per liter [$\mu\text{g/L}$]) were detected in MW-8 during 2011; the TPHg concentrations in this well continue to steadily decrease and have significantly decreased since the start of monitoring. Benzene, toluene, ethylbenzene, and xylenes (BTEX) were not detected in any of the wells during 2011, and also have not been detected for at least several years. Low concentrations of methyl tertiary butyl ether (MTBE) (up to 5 $\mu\text{g/L}$) were detected in MW-1, MW-3, MW-7, and MW-8 during 2011. The MTBE concentrations in these wells continue to decrease and have significantly decreased over the years. TPH as motor oil (TPHmo) was detected in wells MW-7 (up to 2,300 $\mu\text{g/L}$) and MW-8 (56 $\mu\text{g/L}$; third quarter event only) during 2011. The detected TPHmo concentrations were within the range of historical fluctuations. Although fluctuations occur, the TPHmo concentrations in these wells have remained relatively stable.

Equal
Employment Opportunity
Employer



**CONESTOGA-ROVERS
& ASSOCIATES**

August 30, 2011

Reference No. 611960

- 2 -

Based on the analytical results, the plume appears stable and decreasing in size. Concentrations continue to decrease overall. Elevated concentrations of TPHmo remain in MW-7; however, TPHmo typically exhibits low toxicity and mobility in the environment and is not a significant concern. It is our opinion that this site is a good candidate for low-risk case closure. As such, no further monitoring and sampling is recommended. We plan to submit a formal case closure request for this site during third quarter.

Please contact James Kiernan at (916) 889-8917 if you have any questions or require additional information.

Sincerely,

CONESTOGA-ROVERS & ASSOCIATES



James P. Kiernan, P.E.

JK/aa/10

Encl.

Figure 1 Vicinity Map
Figure 2 Concentration Map

Attachment A Groundwater Monitoring and Sampling Report

cc: Ms. Olivia Skance, Chevron (electronic copy only)
 Evelyn Schlichting Trust c/o Mr. Ben Shimek, Petroleum Sales, Inc.

FIGURES

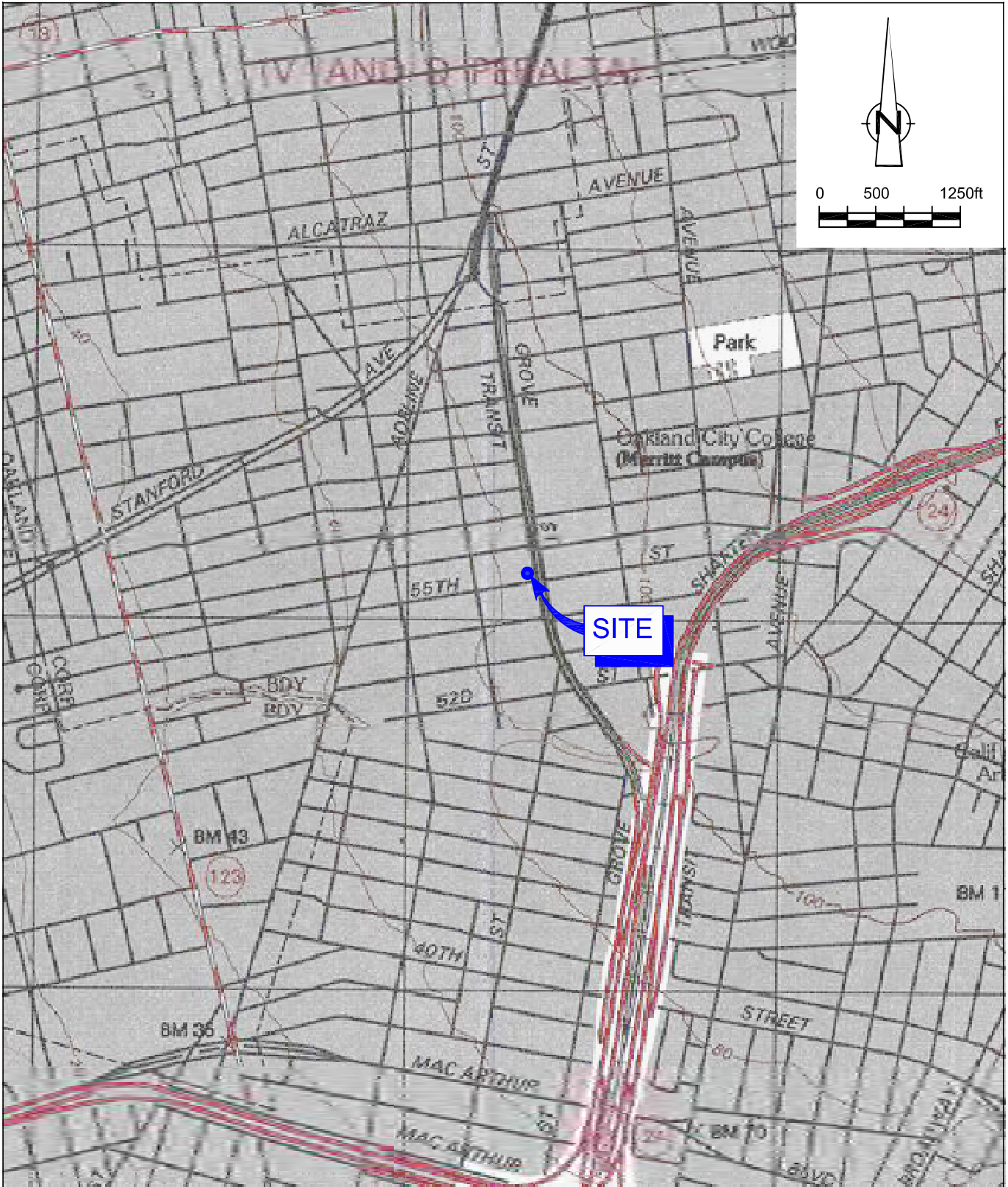

SOURCE: TOPO! MAPS.

Figure 1
 VICINITY MAP
 FORMER CHEVRON SERVICE STATION 9-1583
 5509 MARTIN LUTHER KING JR. WAY
 Oakland, California



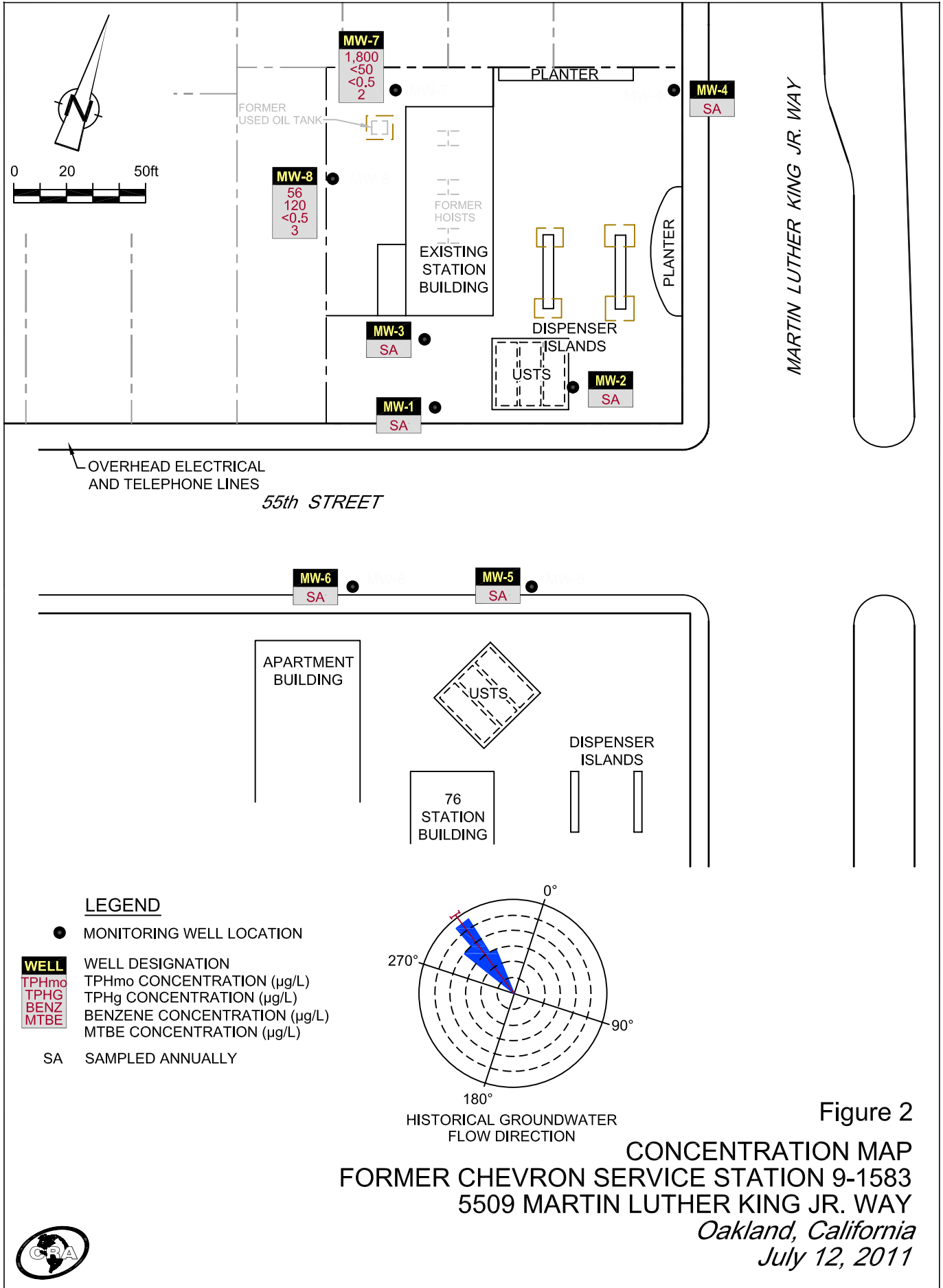

Figure 2
CONCENTRATION MAP
FORMER CHEVRON SERVICE STATION 9-1583
5509 MARTIN LUTHER KING JR. WAY
Oakland, California
July 12, 2011



ATTACHMENT A

GROUNDWATER MONITORING AND SAMPLING REPORT



GETTLER-RYAN INC.



August 4, 2011
G-R Job #386506

Ms. Olivia Skance
Chevron Environmental Management Company
6101 Bollinger Canyon Road
San Ramon, CA 94583

RE: Second Semi-Annual Event of July 12, 2011
Groundwater Monitoring & Sampling Report
Former Chevron Service Station #9-1583
5509 Martin Luther King Way
Oakland, California

Dear Ms. Skance:

This report documents the most recent groundwater monitoring and sampling event performed by Gettler-Ryan Inc. (G-R) at the referenced site. All field work was conducted in accordance with G-R Standard Operating Procedure - Groundwater Sampling (attached).

Static groundwater levels were measured and the wells were checked for the presence of separate-phase hydrocarbons. Static water level data, groundwater elevations, and separate-phase hydrocarbon thickness (if any) are presented in the attached Table 1. A Potentiometric Map is included as Figure 1.

Groundwater samples were collected from the monitoring wells and submitted to a state certified laboratory for analyses. The field data sheets for this event are attached. Analytical results are presented in the table(s) listed below. The chain of custody document and laboratory analytical report are also attached. All groundwater and decontamination water generated during sampling activities was removed from the site, per the Standard Operating Procedure

Please call if you have any questions or comments regarding this report. Thank you.

Sincerely,

Deanna L. Harding
Project Coordinator

Douglas J. Lee
Senior Geologist, P.G. No. 6882

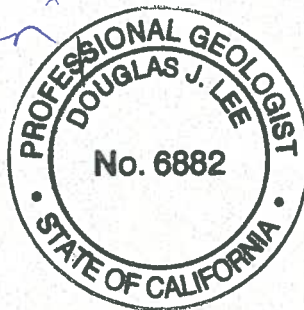
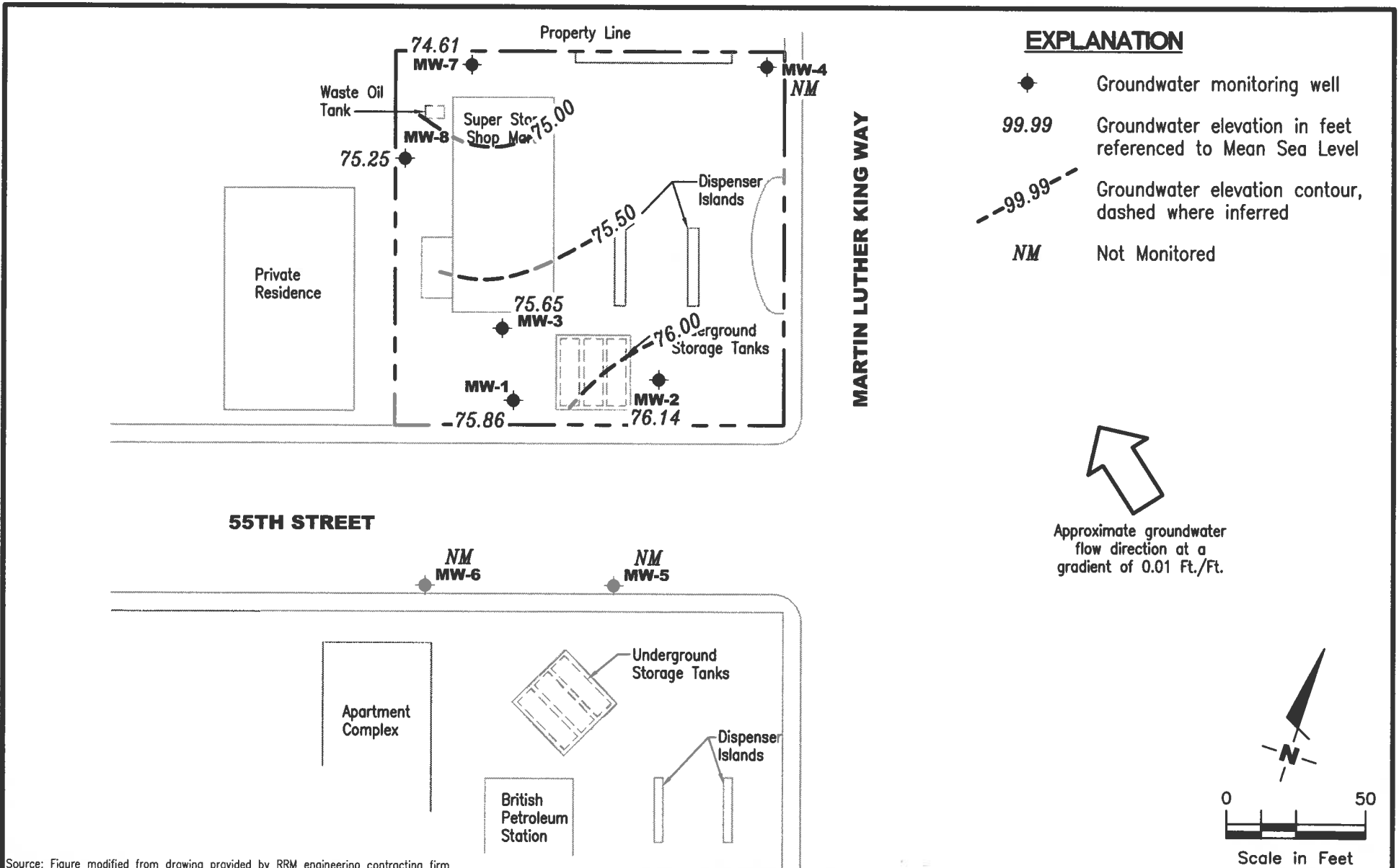

Figure 1: Potentiometric Map
Table 1: Groundwater Monitoring Data and Analytical Results
Table 2: Groundwater Analytical Results - Oxygenate Compounds
Attachments: Standard Operating Procedure - Groundwater Sampling
Field Data Sheets
Chain of Custody Document and Laboratory Analytical Reports



EXPLANATION

- ◆ Groundwater monitoring well
- 99.99 Groundwater elevation in feet referenced to Mean Sea Level
- - - 99.99 - - - Groundwater elevation contour, dashed where inferred
- NM Not Monitored

Approximate groundwater flow direction at a gradient of 0.01 Ft./Ft.

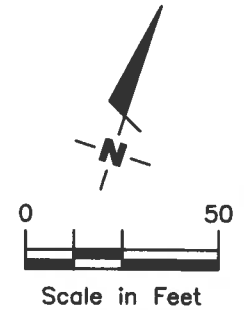

Source: Figure modified from drawing provided by RRM engineering contracting firm.

GETTLER - RYAN INC.
 6747 Sierra Court, Suite J
 Dublin, CA 94568 (925) 551-7555

POTENTIOMETRIC MAP
 Former Chevron Service Station #9-1583
 5509 Martin Luther King Way
 Oakland, California

FIGURE
1

PROJECT NUMBER 386506	REVIEWED BY	DATE July 12, 2011	REVISED DATE
---------------------------------	-------------	-----------------------	--------------

Table 1
Groundwater Monitoring Data and Analytical Results
Former Chevron Service Station #9-1583
5509 Martin Luther King Way
Oakland, California

WELL ID/ DATE	TOC (ft)	GWE (msl)	DTW (ft)	SPHT (ft)	TPH-DRO (µg/L)	TPH-MO (µg/L)	TPH-GRO (µg/L)	B (µg/L)	T (µg/L)	E (µg/L)	X (µg/L)	MTBE (µg/L)	TOG (µg/L)
MW-1													
12/22/83	81.97	71.72	10.25	--	--	--	--	--	--	--	--	--	--
12/30/83	81.97	72.80	9.17	--	--	--	--	--	--	--	--	--	--
03/12/90	81.97	71.89	10.08	--	--	--	50,000	3,000	7,300	1,900	18,000	--	--
03/25/90	82.42	71.51	10.46	--	--	--	--	--	--	--	--	--	--
10/18/90	82.42	--	--	--	--	--	--	--	--	--	--	--	--
10/31/90	82.42	--	--	--	--	--	--	--	--	--	--	--	--
11/16/90	82.42	70.84	11.58	--	--	--	--	--	--	--	--	--	--
02/08/91	82.42	72.31	10.11	--	--	--	100,000	4,200	8,400	16,000	2,600	--	--
05/08/91	82.42	71.97	10.45	--	--	--	31,000	200	66	670	2,000	--	--
08/12/91	82.42	71.19	11.23	--	--	--	17,000	81	7.2	270	710	--	--
11/07/91	82.42	71.72	10.70	--	--	--	7,100	24	6.0	130	170	--	--
02/05/92	82.42	72.05	10.37	--	--	--	110,000	8,900	14,000	2,700	12,000	--	--
05/13/92	82.42	71.84	10.58	--	--	--	19,000	450	85	480	870	--	--
07/17/92	82.42	71.37	11.05	--	--	--	8,500	170	<10	360	600	--	--
10/05/92	82.42	71.01	11.41	--	--	--	22,000	4,300	5,100	570	2,900	--	--
11/11/92	82.42	--	--	--	--	--	--	--	--	--	--	--	--
11/17/92	82.42	--	--	--	--	--	--	--	--	--	--	--	--
11/24/92	82.42	--	--	--	--	--	--	--	--	--	--	--	--
12/01/92	82.42	--	--	--	--	--	--	--	--	--	--	--	--
12/29/92	82.42	--	--	--	--	--	--	--	--	--	--	--	--
01/05/93	82.42	--	--	--	--	--	--	--	--	--	--	--	--
01/08/93	82.42	74.31	8.11	--	--	--	14,000,000	12,000	79,000	270,000	1,300,000	--	--
02/02/93	82.42	--	--	--	--	--	--	--	--	--	--	--	--
04/14/93	82.42	72.57	9.85	--	--	--	48,000	670	1,100	1,600	6,300	--	--
08/06/93	82.42	71.59	10.83	--	--	--	44,000	660	990	1,600	6,100	--	--
10/21/93	82.42	71.52	10.90	--	--	--	18,000	270	460	1,300	4,700	--	--
01/05/94	82.42	72.09	10.33	--	--	--	22,000	160	160	630	2,300	--	--
04/08/94	82.42	72.24	10.18	--	--	--	21,000	37	110	570	1,400	--	--
07/06/94	82.42	71.78	10.64	--	--	--	28,000	210	100	540	1,200	--	--
08/04/94	82.42	71.91	10.51	--	--	--	--	--	--	--	--	--	--
10/05/94	82.42	71.51	10.91	--	--	--	120,000	39	22	320	900	--	--
01/18/95	82.42	73.80	8.62	--	--	--	12,000	<20	<20	130	160	--	--
04/07/95	82.42	72.89	9.53	--	--	--	2,500	<2.5	<2.5	71	38	--	--
07/06/95	82.42	72.03	10.39	--	--	--	5,700	<0.5	<0.5	110	110	--	--
10/11/95	82.42	70.54	11.88	--	--	--	2,700	13	<5.0	13	5.7	650	--
01/17/96	82.42	73.14	9.28	--	--	--	4,200	12	<5.0	43	24	300	--

Table 1
Groundwater Monitoring Data and Analytical Results
Former Chevron Service Station #9-1583
5509 Martin Luther King Way
Oakland, California

WELL ID/ DATE	TOC (ft.)	GWE (msl)	DTW (ft.)	SPHT (ft.)	TPH-DRO (µg/L)	TPH-MO (µg/L)	TPH-GRO (µg/L)	B (µg/L)	T (µg/L)	E (µg/L)	X (µg/L)	MTBE (µg/L)	TOG (µg/L)
MW-1 (cont)													
04/05/96	82.42	72.82	9.60	--	--	--	1,300	<1.2	<1.2	7.6	2.8	220	--
07/23/96	82.42	72.19	10.23	--	--	--	700	<1.0	<1.0	7.0	4.8	240	--
10/02/96	82.42	71.67	10.75	--	--	--	1,700	<2.5	9.8	10	13	610	--
01/23/97	82.42	74.75	7.67	--	--	--	1,300	21	<10	<10	<10	2,700	--
04/01/97	82.42	72.22	10.20	--	--	--	670	<2.0	<2.0	4.1	3.6	1,200	--
07/09/97	82.42	72.12	10.30	--	--	--	460	<1.0	<1.0	<1.0	<1.0	440	--
10/07/97	82.42	71.73	10.69	--	--	--	1,100	8.5	<2.0	<2.0	2.0	250	--
01/22/98	82.42	74.20	8.22	--	--	--	460	1.4	5.8	<0.5	<0.5	150	--
04/02/98	82.42	72.89	9.53	--	--	--	220	2.5	1.2	<1.0	1.9	260	--
07/02/98	82.42	72.08	10.34	--	--	--	270	<0.5	0.82	<0.5	<0.5	140	--
10/02/98	82.42	71.70	10.72	--	--	--	170	1.3	<0.5	<0.5	<1.5	320	--
01/18/99	82.42	72.87	9.55	--	--	--	416	<2.5	<2.5	<2.5	<2.5	316/295 ²	--
07/22/99	82.42	71.61	10.81	--	--	--	186	<0.5	3.94	1.46	2.37	63.7	--
01/17/00	82.42	72.21	10.21	--	--	--	248	1.6	<0.5	<0.5	<0.5	41.0	--
07/05/00	82.42	72.12	10.30	0.00	--	--	76 ³	<0.50	<0.50	<0.50	0.79	69	--
01/15/01	82.42	73.01	9.41	0.00	--	--	66.6	<0.500	<0.500	<0.500	0.585	22.5	--
07/03/01	82.42	72.13	10.29	0.00	--	--	<50	<0.50	<0.50	<0.50	<0.50	8.8	--
02/28/02	82.42	72.74	9.68	0.00	--	--	58	<0.50	<0.50	<0.50	<1.5	21	--
07/08/02	82.42	72.14	10.28	0.00	--	--	<50	<0.50	<0.50	<0.50	<1.5	23	--
01/01/03	82.42	74.28	8.14	0.00	--	--	<50	<0.50	<0.50	<0.50	<1.5	15	--
07/14/03 ⁸	82.42	72.12	10.30	0.00	--	--	<50	<0.5	<0.5	<0.5	<0.5	5	--
01/12/04 ⁸	82.42	73.40	9.02	0.00	--	--	<50	<0.5	<0.5	<0.5	<0.5	61	--
07/27/04 ⁸	82.42	72.10	10.32	0.00	--	--	<50	<0.5	<0.5	<0.5	<0.5	54	--
01/25/05 ⁸	82.42	74.24	8.18	0.00	--	--	<50	<0.5	<0.5	<0.5	<0.5	5	--
07/26/05 ⁸	82.42	72.40	10.02	0.00	--	--	<50	<0.5	<0.5	<0.5	<0.5	25	--
01/24/06 ⁸	82.42	74.22	8.20	0.00	--	--	<50	<0.5	<0.5	<0.5	<0.5	25	--
07/25/06 ⁸	82.42	72.30	10.12	0.00	--	--	<50	<0.5	<0.5	<0.5	<0.5	14	--
01/23/07 ⁸	82.42	72.57	9.85	0.00	--	--	<50	<0.5	<0.5	<0.5	<0.5	17	--
07/24/07 ⁸	82.42	70.59	11.83	0.00	--	--	<50	<0.5	<0.5	<0.5	<0.5	7	--
01/22/08 ⁸	82.42	73.12	9.30	0.00	--	--	<50	<0.5	<0.5	<0.5	<0.5	8	--
07/22/08 ⁸	82.42	71.69	10.73	0.00	--	--	<50	<0.5	<0.5	<0.5	<0.5	<0.5	--
01/13/09 ⁸	82.42	72.41	10.01	0.00	--	--	<50	<0.5	<0.5	<0.5	<0.5	2	--
07/14/09	82.42	71.52	10.90	0.00	SAMPLED ANNUALLY		--	--	--	--	--	--	--
01/12/10 ⁸	85.41	76.70	8.71	0.00	--	--	<50	<0.5	<0.5	<0.5	<0.5	15	--

Table 1
Groundwater Monitoring Data and Analytical Results
Former Chevron Service Station #9-1583
5509 Martin Luther King Way
Oakland, California

WELL ID/ DATE	TOC (ft.)	GWE (msl)	DTW (ft.)	SPHT (ft.)	TPH-DRO (µg/L)	TPH-MO (µg/L)	TPH-GRO (µg/L)	B (µg/L)	T (µg/L)	E (µg/L)	X (µg/L)	MTBE (µg/L)	TOG (µg/L)
MW-1 (cont)													
07/13/10	85.41	75.09	10.32	0.00	SAMPLED ANNUALLY			--	--	--	--	--	--
01/25/11 ⁸	85.41	77.03	8.38	0.00	--	--	<50	<0.5	<0.5	<0.5	<0.5	5	--
07/12/11	85.41	75.86	9.55	0.00	SAMPLED ANNUALLY			--	--	--	--	--	--
MW-2													
12/22/83	83.48	72.98	10.50	--	--	--	--	--	--	--	--	--	--
12/30/83	83.48	73.56	9.92	--	--	--	--	--	--	--	--	--	--
03/12/90	83.48	72.46	11.02	--	--	--	800	400	22	18	55	--	--
03/25/90	83.48	72.15	11.33	--	--	--	--	--	--	--	--	--	--
10/18/90	83.48	71.17	12.31	--	--	--	--	--	--	--	--	--	--
10/31/90	83.48	--	--	--	--	--	--	--	--	--	--	--	--
11/16/90	83.48	--	--	--	--	--	--	--	--	--	--	--	--
02/08/91	83.48	72.43	11.05	--	--	--	4,600	820	440	720	210	--	--
05/08/91	83.48	72.12	11.36	--	--	--	<50	5.0	<0.5	<0.5	<0.5	--	--
08/12/91	83.48	71.51	11.97	--	--	--	<50	<0.5	<0.5	<0.5	<0.5	--	--
11/07/91	83.48	71.98	11.50	--	--	--	<50	<0.5	<0.5	<0.5	<0.5	--	--
02/05/92	83.48	72.29	11.19	--	--	--	1,700	390	170	60	200	--	--
05/13/92	83.48	71.99	11.49	--	--	--	74	9.3	<0.5	<0.5	<0.5	--	--
07/17/92	83.48	71.63	11.85	--	--	--	<50	2.0	<0.5	<0.5	<0.5	--	--
10/05/92	83.48	71.48	12.00	--	--	--	3,500	1,200	530	86	220	--	--
11/11/92	83.48	--	--	--	--	--	--	--	--	--	--	--	--
11/17/92	83.48	--	--	--	--	--	--	--	--	--	--	--	--
11/24/92	83.48	--	--	--	--	--	--	--	--	--	--	--	--
12/01/92	83.48	--	--	--	--	--	--	--	--	--	--	--	--
12/29/92	83.48	--	--	--	--	--	--	--	--	--	--	--	--
01/05/93	83.48	--	--	--	--	--	--	--	--	--	--	--	--
01/08/93	83.48	74.65	8.83	--	--	--	390	140	0.8	7.7	26	--	--
02/02/93	83.48	--	--	--	--	--	--	--	--	--	--	--	--
04/14/93	83.48	72.69	10.79	--	--	--	<50	5.0	<0.5	<0.5	<0.5	--	--
08/06/93	83.48	71.77	11.71	--	--	--	<50	1.0	<0.5	<0.5	<0.5	--	--
10/21/93	83.48	71.74	11.74	--	--	--	<50	1.0	<0.5	9.0	<0.5	--	--
01/05/94	83.48	72.30	11.18	--	--	--	<50	0.7	<0.5	<0.5	0.9	--	--
04/08/94	83.48	72.42	11.06	--	--	--	<50	<0.5	<0.5	<0.5	<0.5	--	--
07/06/94	83.48	71.80	11.68	--	--	--	<50	<0.5	<0.5	<0.5	<0.5	--	--
08/04/94	83.48	72.29	11.19	--	--	--	--	--	--	--	--	--	--

Table 1
Groundwater Monitoring Data and Analytical Results
Former Chevron Service Station #9-1583
5509 Martin Luther King Way
Oakland, California

WELL ID/ DATE	TOC (ft.)	GWE (msl)	DTW (ft.)	SPHT (ft.)	TPH-DRO (µg/L)	TPH-MO (µg/L)	TPH-GRO (µg/L)	B (µg/L)	T (µg/L)	E (µg/L)	X (µg/L)	MTBE (µg/L)	TOG (µg/L)
MW-2 (cont)													
10/05/94	83.48	71.79	11.69	--	--	--	<50	<0.5	<0.5	<0.5	<0.5	--	--
01/18/95	83.48	74.26	9.22	--	--	--	<50	<0.5	<0.5	<0.5	<0.5	--	--
04/07/95	83.48	73.62	9.86	--	--	--	<50	<0.5	<0.5	<0.5	<0.5	--	--
07/06/95	83.48	72.74	10.74	--	--	--	<50	<0.5	<0.5	<0.5	<0.5	--	--
10/11/95	83.48	72.26	11.22	--	--	--	<50	<0.5	<0.5	<0.5	<0.5	<2.5	--
01/17/96	83.48	73.74	9.74	--	--	--	<50	<0.5	<0.5	<0.5	<0.5	<2.5	--
04/05/96	83.48	73.52	9.96	--	--	--	<50	<0.5	<0.5	<0.5	<0.5	<2.5	--
07/23/96	83.48	72.57	10.91	--	--	--	<50	<0.5	<0.5	<0.5	<0.5	<2.5	--
10/02/96	83.48	72.41	11.07	--	--	--	<50	<0.5	<0.5	<0.5	<0.5	<2.5	--
01/23/97	83.48	75.18	8.30	--	--	--	<50	<0.5	<0.5	<0.5	<0.5	3.4	--
04/01/97	83.48	72.90	10.58	--	--	--	<50	<0.5	<0.5	<0.5	<0.5	<2.5	--
07/09/97	83.48	72.58	10.90	--	--	--	<50	<0.5	<0.5	<0.5	<0.5	<2.5	--
10/07/97	83.48	72.52	10.96	--	--	--	<50	<0.5	<0.5	<0.5	<0.5	<2.5	--
01/22/98	83.48	74.73	8.75	--	--	--	<50	<0.5	<0.5	<0.5	<0.5	<2.5	--
04/02/98	83.48	73.66	9.82	--	--	--	89	3.0	5.4	4.1	21	<2.5	--
07/02/98	83.48	72.74	10.74	--	--	--	<50	<0.5	<0.5	<0.5	<0.5	<2.5	--
10/02/98	83.48	72.43	11.05	--	--	--	<50	<0.5	<0.5	<0.5	<1.5	<2.5	--
01/18/99	83.48	73.09	10.39	--	--	--	<50	<0.5	<0.5	<0.5	<0.5	<2.0	--
07/22/99	83.48	72.61	10.87	--	--	--	<50	<0.5	<0.5	<0.5	<0.5	<2.0	--
01/17/00	83.48	72.89	10.59	--	--	--	<50	<0.5	<0.5	<0.5	<0.5	<2.5	--
07/05/00	83.48	72.84	10.64	0.00	--	--	<50	<0.50	<0.50	<0.50	<0.50	<2.5	--
01/15/01	83.48	73.77	9.71	0.00	--	--	555 ⁶	<0.500	<0.500	<0.500	<0.500	<2.50	--
07/03/01	83.48	73.02	10.46	0.00	--	--	<50	<0.50	<0.50	<0.50	<0.50	<2.5	--
02/28/02	83.48	73.49	9.99	0.00	--	--	<50	<0.50	<0.50	<0.50	<1.5	<2.5	--
07/08/02	83.48	72.98	10.50	0.00	--	--	<50	<0.50	<0.50	<0.50	<1.5	<2.5	--
01/01/03	83.48	75.33	8.15	0.00	--	--	<50	<0.50	<0.50	<0.50	<1.5	<2.5	--
07/14/03 ⁸	83.48	72.96	10.52	0.00	--	--	<50	<0.5	<0.5	<0.5	<0.5	<0.5	--
01/12/04 ⁸	83.48	74.31	9.17	0.00	--	--	<50	<0.5	<0.5	<0.5	<0.5	<0.5	--
07/27/04 ⁸	83.48	72.85	10.63	0.00	--	--	<50	<0.5	<0.5	<0.5	<0.5	<0.5	--
01/25/05 ⁸	83.48	74.36	9.12	0.00	--	--	<50	<0.5	<0.5	<0.5	<0.5	<0.5	--
07/26/05 ⁸	83.48	73.56	9.92	0.00	--	--	<50	<0.5	<0.5	<0.5	<0.5	<0.5	--
01/24/06 ⁸	83.48	74.33	9.15	0.00	--	--	<50	<0.5	<0.5	<0.5	<0.5	<0.5	--
07/25/06 ⁸	83.48	73.03	10.45	0.00	--	--	<50	<0.5	<0.5	<0.5	<0.5	<0.5	--
01/23/07 ⁸	83.48	73.37	10.11	0.00	--	--	<50	<0.5	<0.5	<0.5	<0.5	<0.5	--
07/24/07 ⁸	83.48	72.90	10.58	0.00	--	--	<50	<0.5	<0.5	<0.5	<0.5	<0.5	--
01/22/08 ⁸	83.48	73.85	9.63	0.00	--	--	<50	<0.5	<0.5	<0.5	<0.5	<0.5	--

Table 1
Groundwater Monitoring Data and Analytical Results
Former Chevron Service Station #9-1583
5509 Martin Luther King Way
Oakland, California

WELL ID/ DATE	TOC (ft.)	GWE (msl)	BTW (ft.)	SPHT (ft.)	TPH-DRO (µg/L)	TPH-MO (µg/L)	TPH-GRO (µg/L)	B (µg/L)	T (µg/L)	E (µg/L)	X (µg/L)	MTBE (µg/L)	TOG (µg/L)
MW-2 (cont)													
07/22/08 ^B	83.48	73.08	10.40	0.00	--	--	<50	<0.5	<0.5	<0.5	<0.5	2	--
01/13/09 ^B	83.48	73.10	10.38	0.00	--	--	<50	<0.5	<0.5	<0.5	<0.5	<0.5	--
07/14/09	83.48	72.93	10.55	0.00	SAMPLED ANNUALLY			--	--	--	--	--	--
01/12/10 ^B	86.04	76.38	9.66	0.00	--	--	<50	<0.5	<0.5	<0.5	<0.5	<0.5	--
07/13/10	86.04	76.09	9.95	0.00	SAMPLED ANNUALLY			--	--	--	--	--	--
01/25/11 ^B	86.04	76.68	9.36	0.00	--	--	<50	<0.5	<0.5	<0.5	<0.5	<0.5	--
07/12/11	86.04	76.14	9.90	0.00	SAMPLED ANNUALLY			--	--	--	--	--	--
MW-3													
12/22/83	84.36	72.78	11.58	--	--	--	--	--	--	--	--	--	--
12/30/83	84.36	73.19	11.17	--	--	--	--	--	--	--	--	--	--
03/12/90	84.36	72.22	12.14	--	--	--	47,000	1,000	9,900	1,700	9,800	--	--
03/25/90	84.38	71.81	12.55	--	--	--	--	--	--	--	--	--	--
10/18/90	84.38	--	--	--	--	--	--	--	--	--	--	--	--
10/31/90	84.38	--	--	--	--	--	--	--	--	--	--	--	--
11/16/90	84.38	70.76	13.62	--	--	--	--	--	--	--	--	--	--
02/08/91	84.38	72.20	12.18	--	--	--	58,000	4,900	5,200	9,500	2,000	--	--
05/08/91	84.38	71.86	12.52	--	--	--	50,000	2,100	1,400	2,000	9,400	--	--
08/12/91	84.38	71.11	13.27	--	--	--	15,000	1,300	160	920	1,900	--	--
11/07/91	84.38	71.57	12.81	--	--	--	26,000	1,000	310	1,900	5,900	--	--
02/05/92	84.38	71.91	12.47	--	--	--	35,000	2,800	1,300	1,500	4,700	--	--
05/13/92	84.38	71.76	12.62	--	--	--	47,000	1,500	1,200	1,100	4,800	--	--
07/17/92	84.38	71.25	13.13	--	--	--	15,000	120	11	88	140	--	--
10/05/92	84.38	70.95	13.62	0.24	--	--	--	--	--	--	--	--	--
11/11/92	84.38	71.63	12.89	0.17	--	--	--	--	--	--	--	--	--
11/17/92	84.38	71.54	12.89	0.06	--	--	--	--	--	--	--	--	--
11/24/92	84.38	71.56	12.86	0.05	--	--	--	--	--	--	--	--	--
12/01/92	84.38	71.48	12.92	0.03	--	--	--	--	--	--	--	--	--
12/29/92	84.38	73.14	11.24	Sheen	--	--	--	--	--	--	--	--	--
01/05/93	84.38	73.23	11.15	Sheen	--	--	--	--	--	--	--	--	--
01/08/93	84.38	74.28	10.10	--	--	--	250,000	5,000	17,000	5,500	28,000	--	--
02/02/93	84.38	--	--	--	--	--	--	--	--	--	--	--	--
04/14/93	84.38	72.48	11.91	0.01	--	--	--	--	--	--	--	--	--
08/06/93	84.38	71.49	12.90	0.01	--	--	150,000	3,800	6,600	3,700	17,000	--	--
10/21/93	84.38	71.41	12.97	--	--	--	22,000	2,300	1,700	1,400	5,100	--	--

Table 1
Groundwater Monitoring Data and Analytical Results
Former Chevron Service Station #9-1583
5509 Martin Luther King Way
Oakland, California

WELL ID/ DATE	TOC (ft.)	GWE (msl)	DTW (ft.)	SPHT (ft.)	TPH-DRO (µg/L)	TPH-MO (µg/L)	TPH-GRO (µg/L)	B (µg/L)	T (µg/L)	E (µg/L)	X (µg/L)	MTBE (µg/L)	TOG (µg/L)
MW-3 (cont)													
01/05/94	84.38	71.96	12.42	--	--	--	37,000	1,600	1,100	1,300	6,500	--	--
04/08/94	84.38	72.51	11.87	--	--	--	16,000	250	310	500	2,500	--	--
07/06/94	84.38	71.64	12.74	--	--	--	43,000	660	320	1,900	6,400	--	--
08/04/94	84.38	71.71	12.67	--	--	--	--	--	--	--	--	--	--
10/05/94	84.38	71.43	12.95	--	--	--	12,000	280	90	480	370	--	--
01/18/95	84.38	73.72	10.66	--	--	--	20,000	200	230	700	3,500	--	--
04/07/95	84.38	72.84	11.54	--	--	--	22,000	120	120	810	4,400	--	--
07/06/95	84.38	71.99	12.39	--	--	--	15,000	110	<50	630	2,100	--	--
10/11/95	84.38	72.07	12.31	--	--	--	8,600	24	<10	360	560	1,100	--
01/17/96	84.38	73.68	10.70	--	--	--	9,300	<50	<50	230	1,100	2,300	--
04/05/96	84.38	73.35	11.03	--	--	--	8,700	16	<10	110	650	990	--
07/23/96	84.38	72.38	12.00	--	--	--	5,400	20	<5.0	190	480	2,300	--
10/02/96	84.38	72.20	12.18	--	--	--	6,200	43	<20	130	140	2,800	--
01/23/97	84.38	75.12	9.26	--	--	--	5,600	<5.0	<5.0	39	160	550	--
04/01/97	84.38	72.75	11.63	--	--	--	6,900	17	<10	150	330	3,900	--
07/09/97	84.38	72.38	12.00	--	--	--	5,300	31	<5.0	100	180	2,300	--
10/07/97	84.38	72.27	12.11	--	--	--	2,400	15	<2.0	30	15	900	--
01/22/98	84.38	74.73	9.65	--	--	--	3,200	2.5	7.9	70	220	660	--
04/02/98	84.38	73.49	10.89	--	--	--	1,300	14	9.7	25	63	430	--
07/02/98	84.38	72.69	11.69	--	--	--	750	6.9	<5.0	18	9.1	370	--
10/02/98	84.38	72.23	12.15	--	--	--	1,400	5.3	0.73	18	6.6	900	--
01/18/99	84.38	74.05	10.33	--	--	--	1,270	<1.0	<1.0	7.95	<1.0	100/99.7 ²	--
07/22/99	84.38	72.08	12.30	--	--	--	2,240	<1.0	<1.0	29.4	13.7	189	--
01/17/00	84.38	72.78	11.60	--	--	--	848	6.72	2.53	5.02	2.49	90	--
07/05/00	84.38	72.67	11.71	0.00	--	--	90 ³	5.3	<0.50	0.70	<0.50	770	--
01/15/01	84.38	73.93	10.45	0.00	--	--	206	<0.500	<0.500	<0.500	1.09	4.04	--
07/03/01	84.38	72.62	11.76	0.00	--	--	<50	0.53	<0.50	<0.50	1.1	20	--
02/28/02	84.38	73.29	11.09	0.00	--	--	170	<1.0	<1.0	<1.0	1.6	45	--
07/08/02	84.38	71.38	13.00	0.00	--	--	430	0.60	<0.50	0.79	<1.5	42	--
01/01/03	84.38	74.89	9.49	0.00	--	--	140	<0.50	<0.50	<0.50	<1.5	6.1	--
07/14/03 ⁸	84.38	71.36	13.02	0.00	--	--	<50	<0.5	<0.5	<0.5	<0.5	43	--
01/12/04 ⁸	84.38	74.00	10.38	0.00	--	--	<50	<0.5	<0.5	<0.5	<0.5	2	--
07/27/04 ⁸	84.38	72.60	11.78	0.00	--	--	<50	<0.5	<0.5	<0.5	<0.5	41	--
01/25/05 ⁸	84.38	73.96	10.42	0.00	--	--	<50	<0.5	<0.5	<0.5	<0.5	27	--
07/26/05 ⁸	84.38	72.17	12.21	0.00	--	--	<50	<0.5	<0.5	<0.5	<0.5	12	--
01/24/06 ⁸	84.38	73.99	10.39	0.00	--	--	<50	<0.5	<0.5	<0.5	<0.5	0.8	--

Table 1
Groundwater Monitoring Data and Analytical Results
Former Chevron Service Station #9-1583
5509 Martin Luther King Way
Oakland, California

WELL ID/ DATE	TOC (ft.)	GWE (msl)	DTW (ft.)	SPHT (ft.)	TPH-DRO (µg/L)	TPH-MO (µg/L)	TPH-GRO (µg/L)	B (µg/L)	T (µg/L)	E (µg/L)	X (µg/L)	MTBE (µg/L)	TOG (µg/L)
MW-3 (cont)													
07/25/06 ^B	84.38	72.76	11.62	0.00	--	--	<50	<0.5	<0.5	<0.5	<0.5	23	--
01/23/07 ^B	84.38	73.44	10.94	0.00	--	--	130	<0.5	<0.5	<0.5	<0.5	2	--
07/24/07 ^B	84.38	74.10	10.28	0.00	--	--	210	<0.5	<0.5	<0.5	<0.5	20	--
01/22/08 ^B	84.38	73.83	10.55	0.00	--	--	<50	<0.5	<0.5	<0.5	<0.5	<0.5	--
07/22/08 ^B	84.38	72.40	11.98	0.00	--	--	<50	<0.5	<0.5	<0.5	<0.5	7	--
01/13/09 ^B	84.38	72.82	11.56	0.00	--	--	<50	<0.5	<0.5	<0.5	<0.5	10	--
07/14/09	84.38	72.25	12.13	0.00	SAMPLED ANNUALLY		--	--	--	--	--	--	--
01/12/10 ^B	86.80	75.93	10.87	0.00	--	--	<50	<0.5	<0.5	<0.5	<0.5	14	--
07/13/10	86.80	75.37	11.43	0.00	SAMPLED ANNUALLY		--	--	--	--	--	--	--
01/25/11 ^B	86.80	76.19	10.61	0.00	--	--	<50	<0.5	<0.5	<0.5	<0.5	4	--
07/12/11	86.80	75.65	11.15	0.00	SAMPLED ANNUALLY		--	--	--	--	--	--	--
MW-4													
10/18/90	84.25	68.50	15.75	--	--	--	--	--	--	--	--	--	--
10/31/90	84.25	70.35	13.90	--	--	--	<50	<0.5	<0.5	<0.5	1.0	--	--
11/16/90	84.25	70.00	14.25	--	--	--	--	--	--	--	--	--	--
02/08/91	84.25	71.93	12.32	--	--	--	60	17	2.0	12	<0.5	--	--
05/08/91	84.25	72.02	12.23	--	--	--	65	<0.5	<0.5	<0.5	<0.5	--	--
08/12/91	84.25	70.32	13.93	--	--	--	<50	<0.5	<0.5	<0.5	<0.5	--	--
11/07/91	84.25	70.83	13.42	--	--	--	<50	<0.5	<0.5	<0.5	<0.5	--	--
02/05/92	84.25	71.42	12.83	--	--	--	<50	<0.5	<0.5	<0.5	<0.5	--	--
05/13/92	84.25	70.97	13.28	--	--	--	<50	<0.5	<0.5	<0.5	<0.5	--	--
07/17/92	84.25	70.27	13.98	--	--	--	<50	<0.5	<0.5	<0.5	<0.5	--	--
10/05/92	84.25	70.02	14.23	--	--	--	<50	<0.5	<0.5	<0.5	<0.5	--	--
11/11/92	84.25	--	--	--	--	--	--	--	--	--	--	--	--
11/17/92	84.25	--	--	--	--	--	--	--	--	--	--	--	--
11/24/92	84.25	--	--	--	--	--	--	--	--	--	--	--	--
12/01/92	84.25	--	--	--	--	--	--	--	--	--	--	--	--
12/29/92	84.25	--	--	--	--	--	--	--	--	--	--	--	--
01/05/93	84.25	--	--	--	--	--	--	--	--	--	--	--	--
01/08/93	84.25	74.09	10.16	--	--	--	<50	<0.5	<0.5	<0.5	<0.5	--	--
02/02/93	84.25	--	--	--	--	--	--	--	--	--	--	--	--
04/14/93	84.25	72.21	12.04	--	--	--	<50	<0.5	<0.5	<0.5	<0.5	--	--
08/06/93	84.25	70.34	13.91	--	--	--	<50	<0.5	<0.5	<0.5	<0.5	--	--
10/21/93	84.25	70.26	13.99	--	--	--	<50	<0.5	<0.5	<0.5	1.0	--	--

Table 1
Groundwater Monitoring Data and Analytical Results
Former Chevron Service Station #9-1583
5509 Martin Luther King Way
Oakland, California

WELL ID/ DATE	TOC (ft.)	GWE (msl)	DTW (ft.)	SPHT (ft.)	TPH-DRO (µg/L)	TPH-MO (µg/L)	TPH-GRO (µg/L)	B (µg/L)	T (µg/L)	E (µg/L)	X (µg/L)	MTBE (µg/L)	TOC (µg/L)	
MW-4 (cont)														
01/05/94	84.25	71.30	12.95	--	--	--	<50	<0.5	<0.5	<0.5	<0.5	--	--	
04/08/94	84.25	71.31	12.94	--	--	--	<50	<0.5	<0.5	<0.5	<0.5	--	--	
07/06/94	84.25	70.57	13.68	--	--	--	<50	<0.5	<0.5	<0.5	<0.5	--	--	
08/04/94	84.25	70.71	13.54	--	--	--	--	--	--	--	--	--	--	
10/05/94	84.25	70.65	13.60	--	--	--	<50	<0.5	<0.5	<0.5	<0.5	--	--	
01/18/95	84.25	74.77	9.48	--	--	--	<50	<0.5	<0.5	<0.5	<0.5	--	--	
04/07/95	84.25	72.70	11.55	--	--	--	<50	<0.5	<0.5	<0.5	<0.5	--	--	
07/06/95	84.25	71.25	13.00	--	--	--	<50	<0.5	<0.5	<0.5	<0.5	--	--	
10/11/95	84.25	70.27	13.98	--	--	--	<50	<0.5	<0.5	<0.5	<0.5	<2.5	--	
01/17/96	84.25	73.17	11.08	--	--	--	<50	<0.5	<0.5	<0.5	<0.5	<2.5	--	
04/05/96	84.25	72.65	11.60	--	--	--	<50	<0.5	<0.5	<0.5	<0.5	<2.5	--	
07/23/96	84.25	70.86	13.39	--	--	--	<50	<0.5	<0.5	<0.5	<0.5	<2.5	--	
10/02/96	84.25	70.27	13.98	--	--	--	<50	<0.5	<0.5	<0.5	<0.5	<2.5	--	
01/23/97	84.25	74.72	9.53	--	--	--	<50	<0.5	<0.5	<0.5	<0.5	<2.5	--	
04/01/97	84.25	71.68	12.57	--	--	--	<50	<0.5	<0.5	<0.5	<0.5	<2.5	--	
07/09/97	84.25	70.64	13.61	--	--	--	<50	<0.5	<0.5	<0.5	<0.5	<2.5	--	
10/07/97	84.25	70.51	13.74	--	--	--	<50	<0.5	<0.5	<0.5	<0.5	<2.5	--	
01/22/98	84.25	74.90	9.35	--	--	--	<50	<0.5	<0.5	<0.5	<0.5	<2.5	--	
04/02/98	84.25	73.00	11.25	--	--	--	<50	<0.5	<0.5	<0.5	<0.5	<2.5	--	
07/02/98	84.25	71.84	12.41	--	--	--	<50	<0.5	<0.5	<0.5	<0.5	<2.5	--	
10/02/98	84.25	71.00	13.25	--	--	--	<50	<0.5	<0.5	<0.5	<1.5	<2.5	--	
01/18/99	84.25	72.65	11.60	--	--	--	<50	<0.5	<0.5	<0.5	<0.5	<2.0	--	
07/22/99	84.25	70.70	13.55	--	--	--	<50	<0.5	<0.5	<0.5	<0.5	<2.0	--	
01/17/00	84.25	71.32	12.93	--	--	--	<50	<0.50	<0.50	<0.50	<0.50	<2.5	--	
07/05/00	84.25	MONITORED/SAMPLED ANNUALLY				--	--	--	--	--	--	--	--	--
01/15/01	84.25	72.73	11.52	0.00	--	--	<50.0	<0.500	<0.500	<0.500	<0.500	<2.50	--	
07/03/01	84.25	71.30	12.95	0.00	--	--	--	--	--	--	--	--	--	
02/28/02	84.25	72.54	11.71	0.00	--	--	<50	<0.50	<0.50	<0.50	<1.5	<2.5	--	
07/08/02	84.24	MONITORED/SAMPLED ANNUALLY				--	--	--	--	--	--	--	--	--
01/01/03	84.24	INACCESSIBLE - VEHICLE PARKED OVER WELL				--	--	--	--	--	--	--	--	--
07/14/03	84.24	MONITORED/SAMPLED ANNUALLY				--	--	--	--	--	--	--	--	--
01/12/04 ⁸	84.24	73.23	11.01	0.00	--	--	<50	<0.5	<0.5	<0.5	<0.5	<0.5	--	
01/25/05 ⁸	84.24	73.28	10.96	0.00	--	--	<50	<0.5	<0.5	<0.5	<0.5	<0.5	--	
07/26/05	84.24	MONITORED/SAMPLED ANNUALLY				--	--	--	--	--	--	--	--	--
01/24/06 ⁸	84.24	73.36	10.88	0.00	--	--	<50	<0.5	<0.5	<0.5	<0.5	<0.5	--	
07/25/06	84.24	MONITORED/SAMPLED ANNUALLY				--	--	--	--	--	--	--	--	--

Table 1
Groundwater Monitoring Data and Analytical Results
Former Chevron Service Station #9-1583
5509 Martin Luther King Way
Oakland, California

WELL ID/ DATE	TOC (ft.)	GWE (msl)	DTW (ft.)	SPHT (ft.)	TPH-DRO (µg/L)	TPH-MO (µg/L)	TPH-GRO (µg/L)	B (µg/L)	T (µg/L)	E (µg/L)	X (µg/L)	MTBE (µg/L)	TOG (µg/L)
MW-4 (cont)													
01/23/07 ^B	84.24	71.85	12.39	0.00	--	--	<50	<0.5	<0.5	<0.5	<0.5	<0.5	--
07/24/07	84.24	MONITORED/SAMPLED ANNUALLY											
01/22/08 ^B	84.24	72.77	11.47	0.00	--	--	<50	<0.5	<0.5	<0.5	<0.5	<0.5	--
07/22/08	84.24	MONITORED/SAMPLED ANNUALLY											
01/13/09 ^B	84.24	71.56	12.68	0.00	--	--	<50	<0.5	<0.5	<0.5	<0.5	<0.5	--
07/14/09	84.24	MONITORED/SAMPLED ANNUALLY											
01/12/10 ^B	87.29	76.14	11.15	0.00	--	--	<50	<0.5	<0.5	<0.5	<0.5	<0.5	--
07/13/10	87.29	MONITORED/SAMPLED ANNUALLY											
01/25/11 ^B	87.29	76.21	11.08	0.00	--	--	<50	<0.5	<0.5	<0.5	<0.5	<0.5	--
07/12/11	87.29	MONITORED/SAMPLED ANNUALLY											
MW-5													
10/18/90	81.95	71.17	10.78	--	--	--	--	--	--	--	--	--	--
10/31/90	81.95	71.32	10.63	--	--	--	110	<0.5	<0.5	<0.5	<0.5	--	--
11/16/90	81.95	71.27	10.68	--	--	--	--	--	--	--	--	--	--
02/08/91	81.95	72.78	9.17	--	--	--	<50	<0.5	<0.5	<0.5	<0.5	--	--
05/08/91	81.95	73.27	8.68	--	--	--	<50	<0.5	<0.5	<0.5	<0.5	--	--
08/12/91	81.95	71.62	10.33	--	--	--	<50	<0.5	<0.5	<0.5	<0.5	--	--
11/07/91	81.95	72.19	9.76	--	--	--	<50	<0.5	<0.5	<0.5	<0.5	--	--
02/05/92	81.95	72.48	9.47	--	--	--	69	<0.5	<0.5	<0.5	<0.5	--	--
05/13/92	81.95	72.25	9.70	--	--	--	74	<0.5	<0.5	<0.5	<0.5	--	--
07/17/92	81.95	71.74	10.21	--	--	--	880	2.6	<1.2	4.6	11	--	--
10/05/92	81.95	71.34	10.61	--	--	--	120	<0.5	<0.5	0.6	4.9	--	--
11/11/92	81.95	--	--	--	--	--	--	--	--	--	--	--	--
11/17/92	81.95	--	--	--	--	--	--	--	--	--	--	--	--
11/24/92	81.95	--	--	--	--	--	--	--	--	--	--	--	--
12/01/92	81.95	--	--	--	--	--	--	--	--	--	--	--	--
12/29/92	81.95	--	--	--	--	--	--	--	--	--	--	--	--
01/05/93	81.95	--	--	--	--	--	--	--	--	--	--	--	--
01/08/93	81.95	74.61	7.34	--	--	--	61	<0.5	<0.5	<0.5	<0.5	--	--
02/02/93	81.95	--	--	--	--	--	--	--	--	--	--	--	--
04/14/93	81.95	--	--	--	--	--	--	--	--	--	--	--	--
08/06/93	81.95	71.99	9.96	--	--	--	<50	<0.5	<0.5	<0.5	<0.5	--	--
10/21/93	81.95	71.89	10.06	--	--	--	<50	<0.5	<0.5	2.0	4.0	--	--

Table 1
Groundwater Monitoring Data and Analytical Results
Former Chevron Service Station #9-1583
5509 Martin Luther King Way
Oakland, California

WELL ID/ DATE	TOC (ft.)	GWE (msl)	DTW (ft.)	SPHT (ft.)	TPH-DRO (µg/L)	TPH-MO (µg/L)	TPH-GRO (µg/L)	B (µg/L)	T (µg/L)	E (µg/L)	X (µg/L)	MTBE (µg/L)	TOG (µg/L)	
MW-5 (cont)														
01/05/94	81.95	72.52	9.43	--	--	--	<50	<0.5	<0.5	<0.5	<0.5	--	--	
04/08/94	81.95	72.56	9.39	--	--	--	<50	<0.5	<0.5	<0.5	<0.5	--	--	
07/06/94	81.95	72.19	9.76	--	--	--	<50	0.6	<0.5	<0.5	<0.5	--	--	
08/04/94	81.95	72.13	9.82	--	--	--	--	--	--	--	--	--	--	
10/05/94	81.95	71.89	10.06	--	--	--	<50	<0.5	<0.5	<0.5	<0.5	--	--	
01/18/95	81.95	INACCESSIBLE		--	--	--	--	--	--	--	--	--	--	
04/07/95	81.95	73.31	8.64	--	--	--	<50	<0.5	<0.5	<0.5	<0.5	--	--	
07/06/95	81.95	72.52	9.43	--	--	--	<50	<0.5	<0.5	<0.5	<0.5	--	--	
10/11/95	81.95	72.12	9.83	--	--	--	<50	<0.5	<0.5	<0.5	<0.5	<2.5	--	
01/17/96	81.95	73.63	8.32	--	--	--	<50	<0.5	<0.5	<0.5	<0.5	<2.5	--	
04/05/96	81.95	73.23	8.72	--	--	--	<50	<0.5	<0.5	<0.5	<0.5	<2.5	--	
07/23/96	81.95	72.25	9.70	--	--	--	<50	<0.5	<0.5	<0.5	<0.5	<2.5	--	
10/02/96	81.95	72.06	9.89	--	--	--	<50	<0.5	<0.5	<0.5	<0.5	<2.5	--	
01/23/97	81.95	74.72	7.23	--	--	--	<50	<0.5	<0.5	<0.5	<0.5	<2.5	--	
04/01/97	81.95	INACCESSIBLE		--	--	--	--	--	--	--	--	--	--	
07/09/97	81.95	72.27	9.68	--	--	--	<50	<0.5	<0.5	<0.5	<0.5	<2.5	--	
10/07/97	81.95	72.14	9.81	--	--	--	<50	<0.5	<0.5	<0.5	<0.5	<2.5	--	
01/22/98	81.95	74.80	7.15	--	--	--	<50	<0.5	<0.5	<0.5	<0.5	<2.5	--	
04/02/98	81.95	INACCESSIBLE		--	--	--	--	--	--	--	--	--	--	
07/02/98	81.95	72.43	9.52	--	--	--	<50	<0.5	<0.5	<0.5	<0.5	<2.5	--	
10/02/98	81.95	72.14	9.81	--	--	--	<50	<0.5	<0.5	<0.5	<1.5	<2.5	--	
01/18/99	81.95	73.11	8.84	--	--	--	<50	<0.5	<0.5	<0.5	<0.5	<2.0	--	
07/22/99	81.95	72.01	9.94	--	--	--	<50	<0.5	<0.5	<0.5	<0.5	<2.0	--	
01/17/00	81.95	72.70	9.25	--	--	--	<50	<0.5	<0.5	<0.5	<0.5	<2.5	--	
07/05/00	81.95	MONITORED/SAMPLED ANNUALLY				--	--	--	--	--	--	--	--	--
01/15/01	81.95	73.41	8.54	0.00	--	--	423 ⁶	<0.500	<0.500	<0.500	<0.500	<2.50	--	
07/03/01	81.95	72.62	9.33	0.00	--	--	--	--	--	--	--	--	--	
02/28/02	81.95	73.24	8.71	0.00	--	--	270	<0.50	<0.50	<0.50	<1.5	<2.5	--	
07/08/02	81.95	MONITORED/SAMPLED ANNUALLY				--	--	--	--	--	--	--	--	--
01/01/03	81.95	INACCESSIBLE - VEHICLE PARKED OVER WELL				--	--	--	--	--	--	--	--	--
07/14/03	81.95	MONITORED/SAMPLED ANNUALLY				--	--	--	--	--	--	--	--	--
01/12/04 ⁸	81.95	73.91	8.04	0.00	--	--	<50	<0.5	<0.5	<0.5	<0.5	<0.5	--	
01/25/05 ⁸	81.95	73.94	8.01	0.00	--	--	<50	<0.5	<0.5	<0.5	<0.5	<0.5	--	
07/26/05	81.95	MONITORED/SAMPLED ANNUALLY				--	--	--	--	--	--	--	--	--
01/24/06 ⁸	81.95	73.89	8.06	0.00	--	--	<50	<0.5	<0.5	<0.5	<0.5	<0.5	--	

Table 1
Groundwater Monitoring Data and Analytical Results
Former Chevron Service Station #9-1583
5509 Martin Luther King Way
Oakland, California

WELL ID/ DATE	TOC (ft.)	GWE (msl)	DTW (ft.)	SPHT (ft.)	TPH-DRO (µg/L)	TPH-MO (µg/L)	TPH-GRO (µg/L)	B (µg/L)	T (µg/L)	E (µg/L)	X (µg/L)	MTBE (µg/L)	TOG (µg/L)
MW-5 (cont)													
07/25/06	81.95	MONITORED/SAMPLED ANNUALLY			--	--	--	--	--	--	--	--	--
01/23/07	81.95	INACCESSIBLE - VEHICLE PARKED OVER WELL			--	--	--	--	--	--	--	--	--
07/24/07	81.95	MONITORED/SAMPLED ANNUALLY			--	--	--	--	--	--	--	--	--
01/22/08 ⁸	81.95	73.50	8.45	0.00	--	--	<50	<0.5	<0.5	<0.5	<0.5	<0.5	--
07/22/08	81.95	MONITORED/SAMPLED ANNUALLY			--	--	--	--	--	--	--	--	--
01/13/09 ⁸	81.95	71.69	10.26	0.00	--	--	<50	<0.5	<0.5	<0.5	<0.5	<0.5	--
07/14/09	81.95	MONITORED/SAMPLED ANNUALLY			--	--	--	--	--	--	--	--	--
01/12/10 ⁸	84.93	76.45	8.48	0.00	--	--	<50	<0.5	<0.5	<0.5	<0.5	<0.5	--
07/13/10	84.93	MONITORED/SAMPLED ANNUALLY			--	--	--	--	--	--	--	--	--
01/25/11 ⁸	84.93	76.69	8.24	0.00	--	--	<50	<0.5	<0.5	<0.5	<0.5	<0.5	--
07/12/11	84.93	MONITORED/SAMPLED ANNUALLY			--	--	--	--	--	--	--	--	--
MW-6													
10/18/90	80.60	70.81	9.79	--	--	--	--	--	--	--	--	--	--
10/31/90	80.60	70.91	9.69	--	--	--	<50	<0.5	<0.5	<0.5	3.0	--	--
11/16/90	80.60	70.86	9.74	--	--	--	--	--	--	--	--	--	--
02/08/91	80.60	--	--	--	--	--	--	--	--	--	--	--	--
05/08/91	80.60	71.06	9.54	--	--	--	56	<0.5	<0.5	<0.5	<0.5	--	--
08/12/91	80.60	71.10	9.50	--	--	--	<50	<0.5	<0.5	<0.5	<0.5	--	--
11/07/91	80.60	71.71	8.89	--	--	--	<50	<0.5	<0.5	<0.5	<0.5	--	--
02/05/92	80.60	72.01	8.59	--	--	--	<50	<0.5	<0.5	<0.5	<0.5	--	--
05/13/92	80.60	--	--	--	--	--	--	--	--	--	--	--	--
07/17/92	80.60	--	--	--	--	--	--	--	--	--	--	--	--
10/05/92	80.60	--	--	--	--	--	--	--	--	--	--	--	--
11/11/92	80.60	--	--	--	--	--	--	--	--	--	--	--	--
11/17/92	80.60	--	--	--	--	--	--	--	--	--	--	--	--
11/24/92	80.60	--	--	--	--	--	--	--	--	--	--	--	--
12/01/92	80.60	--	--	--	--	--	--	--	--	--	--	--	--
12/29/92	80.60	--	--	--	--	--	--	--	--	--	--	--	--
01/05/93	80.60	--	--	--	--	--	--	--	--	--	--	--	--
01/08/93	80.60	--	--	--	--	--	--	--	--	--	--	--	--
02/02/93	80.60	72.89	7.71	--	--	--	<50	2.1	<0.5	<0.5	2.2	--	--
04/14/93	80.60	72.41	8.19	--	--	--	<50	1.0	<0.5	<0.5	<0.5	--	--
08/06/93	80.60	71.52	9.08	--	--	--	<50	<0.5	<0.5	<0.5	<0.5	--	--
10/21/93	80.60	71.46	9.14	--	--	--	<50	<0.5	<0.5	<0.5	<0.5	--	--

Table 1
Groundwater Monitoring Data and Analytical Results
Former Chevron Service Station #9-1583
5509 Martin Luther King Way
Oakland, California

WELL ID/ DATE	TOC (ft.)	GWE (msl)	DTW (ft.)	SPHT (ft.)	TPH-DRO (µg/L)	TPH-MO (µg/L)	TPH-GRO (µg/L)	B (µg/L)	T (µg/L)	E (µg/L)	X (µg/L)	MTBE (µg/L)	TOG (µg/L)
MW-6 (cont)													
01/05/94	80.60	72.06	8.54	--	--	--	<50	4.0	<0.5	<0.5	<0.5	--	--
04/08/94	80.60	--	--	--	--	--	--	--	--	--	--	--	--
07/06/94	80.60	INACCESSIBLE		--	--	--	--	--	--	--	--	--	--
08/04/94	80.60	71.66	8.94	--	--	--	<50	<0.5	<0.5	<0.5	<0.5	--	--
10/05/94	80.60	INACCESSIBLE		--	--	--	--	--	--	--	--	--	--
01/18/95	80.60	73.50	7.10	--	--	--	<50	0.69	<0.5	<0.5	0.57	--	--
04/07/95	80.60	72.77	7.83	--	--	--	<50	1.8	<0.5	<0.5	<0.5	--	--
07/06/95	80.60	72.03	8.57	--	--	--	<50	<0.5	<0.5	<0.5	<0.5	--	--
10/11/95	80.60	71.54	9.06	--	--	--	<125	<1.2	<1.2	<1.2	<1.2	540	--
01/17/96	80.60	73.20	7.40	--	--	--	<50	<0.5	<0.5	<0.5	<0.5	180	--
04/05/96	80.60	72.70	7.90	--	--	--	<125	1.4	<1.2	<1.2	<1.2	700	--
07/23/96	80.60	71.86	8.74	--	--	--	<500	<5.0	<5.0	<5.0	<5.0	540	--
10/02/96	80.60	71.62	8.98	--	--	--	<100	<1.0	<1.0	<1.0	1.8	910	--
01/23/97	80.60	INACCESSIBLE		--	--	--	--	--	--	--	--	--	--
04/01/97	80.60	72.22	8.38	--	--	--	<250	<2.5	<2.5	<2.5	<2.5	640	--
07/09/97	80.60	INACCESSIBLE		--	--	--	--	--	--	--	--	--	--
10/07/97	80.60	71.71	8.89	--	--	--	<50	<0.5	<0.5	<0.5	<0.5	640	--
01/22/98	80.60	73.90	6.70	--	--	--	<50	<0.5	<0.5	<0.5	<0.5	200	--
04/02/98	80.60	72.79	7.81	--	--	--	<250	<2.5	<2.5	<2.5	<2.5	480	--
07/02/98	80.60	71.62	8.98	--	--	--	<50	<0.5	<0.5	<0.5	<0.5	420	--
10/02/98	80.60	71.68	8.92	--	--	--	<50	<0.5	<0.5	<0.5	<1.5	270	--
01/18/99	80.60	INACCESSIBLE		--	--	--	--	--	--	--	--	--	--
07/22/99	80.60	INACCESSIBLE		--	--	--	--	--	--	--	--	--	--
01/17/00	80.60	INACCESSIBLE		--	--	--	--	--	--	--	--	--	--
07/05/00	80.60	MONITORED/SAMPLED ANNUALLY				--	--	--	--	--	--	--	--
01/15/01	80.60	INACCESSIBLE - CAR PARKED OVER WELL				--	--	--	--	--	--	--	--
07/03/01	80.60	INACCESSIBLE - CAR PARKED OVER WELL				--	--	--	--	--	--	--	--
02/28/02	80.60	72.70	7.90	0.00	--	--	<50	<0.50	<0.50	<0.50	<1.5	55	--
07/08/02	80.60	MONITORED/SAMPLED ANNUALLY				--	--	--	--	--	--	--	--
01/01/03	80.60	INACCESSIBLE - VEHICLE PARKED OVER WELL				--	--	--	--	--	--	--	--
07/14/03	80.60	MONITORED/SAMPLED ANNUALLY				--	--	--	--	--	--	--	--
01/12/04 ⁸	80.60	73.23	7.37	0.00	--	--	<50	<0.5	<0.5	<0.5	<0.5	25	--
01/25/05 ⁸	80.60	73.17	7.43	0.00	--	--	<50	<0.5	<0.5	<0.5	<0.5	3	--
07/26/05	80.60	MONITORED/SAMPLED ANNUALLY				--	--	--	--	--	--	--	--
01/24/06 ⁸	80.60	73.20	7.40	0.00	--	--	<50	<0.5	<0.5	<0.5	<0.5	<0.5	--
07/25/06	80.60	MONITORED/SAMPLED ANNUALLY				--	--	--	--	--	--	--	--

Table 1
Groundwater Monitoring Data and Analytical Results
Former Chevron Service Station #9-1583
5509 Martin Luther King Way
Oakland, California

WELL ID/ DATE	TOC (ft.)	GWE (msl)	DTW (ft.)	SPHT (ft.)	TPH-DRO (µg/L)	TPH-MO (µg/L)	TPH-GRO (µg/L)	B (µg/L)	T (µg/L)	E (µg/L)	X (µg/L)	MTBE (µg/L)	TOG (µg/L)
MW-6 (cont)													
01/23/07 ^B	80.60	72.53	8.07	0.00	--	--	<50	<0.5	<0.5	<0.5	<0.5	8	--
07/24/07	80.60	MONITORED/SAMPLED ANNUALLY			--	--	--	--	--	--	--	--	--
01/22/08 ^B	80.60	73.07	7.53	0.00	--	--	<50	<0.5	<0.5	1	2	4	--
07/22/08	80.60	MONITORED/SAMPLED ANNUALLY			--	--	--	--	--	--	--	--	--
01/13/09 ^B	80.60	70.73	9.87	0.00	--	--	<50	<0.5	<0.5	<0.5	<0.5	6	--
07/14/09	80.60	MONITORED/SAMPLED ANNUALLY			--	--	--	--	--	--	--	--	--
01/12/10 ^B	83.63	75.71	7.92	0.00	--	--	<50	<0.5	<0.5	<0.5	<0.5	<0.5	--
07/13/10	83.63	MONITORED/SAMPLED ANNUALLY			--	--	--	--	--	--	--	--	--
01/25/11 ^B	83.63	76.05	7.58	0.00	--	--	<50	<0.5	<0.5	<0.5	<0.5	<0.5	--
07/12/11	83.63	MONITORED/SAMPLED ANNUALLY			--	--	--	--	--	--	--	--	--
MW-7													
03/08/94	86.36	74.99	11.37	--	<10	4,100	1,200	440	31	73	200	--	--
07/06/94	86.36	--	--	--	--	--	--	--	--	--	--	--	--
08/04/94	86.36	73.86	12.50	--	--	--	120	15	<0.5	3.8	1.8	--	--
10/05/94	86.36	73.99	12.37	--	--	--	150	1.2	<0.5	1.2	1.7	--	--
01/18/95	86.36	74.82	11.54	--	--	--	260	11	<1.0	17	6.8	--	--
04/07/95	86.36	75.63	10.73	--	--	--	230	<0.5	<0.5	25	0.93	--	--
07/06/95	86.36	74.36	12.00	--	--	--	320	<1.0	<1.0	<1.0	<1.0	--	6,900
10/11/95	86.36	73.56	12.80	--	--	2,300 ¹	<50	<0.5	<0.5	<0.5	<0.5	120	--
01/17/96	86.36	75.90	10.46	--	--	1,700	<50	<0.5	<0.5	<0.5	<0.5	460	--
04/05/96	86.36	76.56	9.80	--	--	590	130	<0.5	<0.5	<0.5	<0.5	120	--
07/23/96	86.36	74.57	11.79	--	--	820	<500	<5.0	<5.0	<5.0	<0.5	1,200	--
10/02/96	86.36	73.10	13.26	--	--	1,500	<100	<1.0	<1.0	<1.0	<1.0	360	--
01/23/97	86.36	77.64	8.72	--	--	<500	<100	<1.0	<1.0	<1.0	<1.0	490	--
04/01/97	86.36	75.09	11.27	--	--	1,600	<250	<2.5	<2.5	<2.5	<2.5	1,200	--
07/09/97	86.36	73.92	12.44	--	--	5,700	<250	5.9	<2.5	<2.5	<2.5	1,200	--
10/07/97	86.36	73.44	12.92	--	--	<500	<50	<0.5	<0.5	<0.5	<0.5	240	--
01/22/98	86.36	75.14	11.22	--	--	<500	<50	<0.5	<0.5	<0.5	<0.5	400	--
04/02/98	86.36	75.67	10.69	--	--	<500	56	<0.5	<0.5	<0.5	<0.5	290	--
07/02/98	86.36	75.94	10.42	--	--	<500	<50	<0.5	<0.5	<0.5	<0.5	380	--
10/02/98	86.36	74.14	12.22	--	--	1,700	<50	<0.5	<0.5	<0.5	<1.5	660	--
01/18/99	86.36	75.36	11.00	--	--	543	<100	<1.0	<1.0	<1.0	<1.0	281/296 ²	--
07/22/99	86.36	74.06	12.30	--	--	--	<50	<0.5	<0.5	<0.5	<0.5	155	--
01/17/00	86.36	75.84	10.52	--	256 ¹	1,040	<50	<0.5	<0.5	<0.5	<0.5	104	--

Table 1
Groundwater Monitoring Data and Analytical Results
Former Chevron Service Station #9-1583
5509 Martin Luther King Way
Oakland, California

WELL ID/ DATE	TOC (ft)	GWE (mst)	DTW (ft.)	SPHT (ft.)	TPH-DRO (µg/L)	TPH-MO (µg/L)	TPH-GRO (µg/L)	B (µg/L)	T (µg/L)	E (µg/L)	X (µg/L)	MTBE (µg/L)	TOG (µg/L)
MW-7 (cont)													
07/05/00	86.36	74.23	12.13	0.00	--	1,400 ⁴	<50	<0.50	<0.50	<0.50	<0.50	110	--
01/15/01	86.36	75.23	11.13	0.00	--	2,700	<50.0	<0.500	<0.500	<0.500	<0.500	84.3	--
07/03/01	86.36	74.47	11.89	0.00	--	760 ⁷	<50	<0.50	<0.50	<0.50	<0.50	27	--
02/28/02	86.36	75.26	11.10	0.00	--	<1,000	<50	<0.50	<0.50	<0.50	<1.5	66	--
07/08/02	86.36	74.05	12.31	0.00	--	1,400	<50	<0.50	<0.50	<0.50	<1.5	49	--
01/01/03	86.36	76.65	9.71	0.00	--	1,300	<50	<0.50	<0.50	<0.50	<1.5	35	--
07/14/03 ⁸	86.36	74.01	12.35	0.00	--	130	<50	<0.5	<0.5	<0.5	<0.5	20	--
01/12/04 ⁸	86.36	75.66	10.70	0.00	--	250	<50	<0.5	<0.5	<0.5	<0.5	27	--
07/27/04 ⁸	86.36	74.08	12.28	0.00	--	730	<50	<0.5	<0.5	<0.5	<0.5	44	--
01/25/05 ⁸	86.36	75.56	10.80	0.00	--	980	<50	<0.5	<0.5	<0.5	<0.5	34	--
07/26/05 ⁸	86.36	73.69	12.67	0.00	--	1,100	<50	<0.5	<0.5	<0.5	<0.5	19	--
01/24/06 ⁸	86.36	75.60	10.76	0.00	--	230	<50	<0.5	<0.5	<0.5	<0.5	18	--
07/25/06 ⁸	86.36	74.17	12.19	0.00	--	160	<50	<0.5	<0.5	<0.5	<0.5	19	--
01/23/07 ⁸	86.36	74.60	11.76	0.00	--	2,100	<50	<0.5	<0.5	<0.5	<0.5	15	--
07/24/07 ⁸	86.36	73.91	12.45	0.00	--	3,100	<50	<0.5	<0.5	<0.5	<0.5	24	--
01/22/08 ⁸	86.36	75.36	11.00	0.00	--	4,400	<50	<0.5	<0.5	<0.5	<0.5	12	--
07/22/08 ⁸	86.36	73.38	12.98	0.00	--	200	<50	<0.5	<0.5	<0.5	<0.5	25	--
01/13/09 ⁸	86.36	73.85	12.51	0.00	--	1,400	<50	<0.5	<0.5	<0.5	<0.5	7	--
07/14/09 ⁸	86.36	73.18	13.18	0.00	--	1,000	<50	<0.5	<0.5	<0.5	<0.5	10	--
01/12/10 ⁸	86.36	75.01	11.35	0.00	--	1,500	<50	<0.5	<0.5	<0.5	<0.5	5	--
07/13/10 ⁸	86.36	73.72	12.64	0.00	--	1,100	<50	<0.5	<0.5	<0.5	<0.5	4	--
01/25/11 ⁸	86.36	75.30	11.06	0.00	--	2,300	<50	<0.5	<0.5	<0.5	<0.5	2	--
07/12/11 ⁸	86.36	74.61	11.75	0.00	--	1,800	<50	<0.5	<0.5	<0.5	<0.5	2	--
MW-8													
03/08/94	85.93	75.06	10.87	--	<10	<100	28,000	2,900	1,300	1,200	6,800	--	--
07/06/94	85.93	--	--	--	--	--	--	--	--	--	--	--	--
08/04/94	85.93	73.77	12.16	--	--	--	22,000	3,000	260	870	4,400	--	--
10/05/94	85.93	72.71	13.22	--	--	--	12,000	1,800	34	4.6	890	--	--
01/18/95	85.93	75.51	10.42	--	--	--	19,000	1,000	65	1,100	3,500	--	--
04/07/95	85.93	75.48	10.45	--	--	--	14,000	310	<25	720	1,700	--	--
07/06/95	85.93	74.30	11.63	--	--	--	19,000	280	<50	1,200	2,600	--	--
10/11/95	85.93	73.51	12.42	--	--	--	6,100	140	5.5	320	280	1,200	--
01/17/96	85.93	75.95	9.98	--	--	<500	12,000	86	<20	590	1,400	1,100	--
04/05/96	85.93	75.60	10.33	--	--	<500	7,500	180	23	410	480	560	--

Table 1
Groundwater Monitoring Data and Analytical Results
Former Chevron Service Station #9-1583
5509 Martin Luther King Way
Oakland, California

WELL ID/ DATE	TOC (ft.)	GWE (msl)	DTW (ft.)	SPHT (ft.)	TPH-DRO (µg/L)	TPH-MO (µg/L)	TPH-GRO (µg/L)	B (µg/L)	T (µg/L)	E (µg/L)	X (µg/L)	MTBE (µg/L)	TOG (µg/L)
MW-8 (cont)													
07/23/96	85.93	74.56	11.37	--	--	<500	3,800	47	<5.0	350	84	1,800	--
10/02/96	85.93	73.90	12.03	--	--	<500	4,400	65	<5.0	140	28	1,500	--
01/23/97	85.93	77.73	8.20	--	--	<500	3,800	36	5.9	140	36	910	--
04/01/97	85.93	75.80	10.13	--	--	<500	6,100	43	<20	380	76	1,800	--
07/09/97	85.93	73.77	12.16	--	--	<500	7,300	48	<25	120	<25	2,400	--
10/07/97	85.93	73.77	12.16	--	--	<500	3,100	<10	<10	67	<10	1,400	--
01/22/98	85.93	75.83	10.10	--	--	<500	1,900	5.5	8.3	120	17	780	--
04/02/98	85.93	75.55	10.38	--	--	<500	2,900	43	19	110	<10	800	--
07/02/98	85.93	74.78	11.15	--	--	<500	5,000	31	<10	120	15	780	--
10/02/98	85.93	74.03	11.90	--	--	1,200 ¹	2,200	6.5	<0.5	21	2.6	140	--
01/18/99	85.93	75.12	10.81	--	554	<250	2,870	<5.0	<5.0	9.02	<5.0	476/478 ²	--
07/22/99	85.93	74.38	11.55	--	--	--	2,190	<1.0	<1.0	3.51	1.61	228	--
01/17/00	85.93	75.06	10.87	--	955 ¹	<500	1,220	1.3	1.56	1.56	1.87	344	--
07/05/00	85.93	74.55	11.38	0.00	--	260 ⁵	1,900 ³	15	6.6	<5.0	<5.0	170	--
01/15/01	85.93	75.59	10.34	0.00	--	<250	2,820	<1.00	<1.00	5.13	3.90	110	--
07/03/01	85.93	74.77	11.16	0.00	--	<250	1,900 ³	6.0	<5.0	<5.0	<5.0	46	--
02/28/02	85.93	75.26	10.67	0.00	--	<1,000	1,500	4.6	<2.0	0.80	2.2	56	--
07/08/02	85.93	74.30	11.63	0.00	--	<400	2,500	4.2	0.85	0.68	2.5	46	--
01/01/03	85.93	76.01	9.92	0.00	--	<400	1,300	2.1	0.66	1.1	2.1	45	--
07/14/03 ⁸	85.93	74.27	11.66	0.00	--	160	1,900	<0.5	<0.5	<0.5	<0.5	58	--
01/12/04 ⁸	85.93	75.92	10.01	0.00	--	<40	1,400	<0.5	<0.5	<0.5	<0.5	110	--
07/27/04 ⁸	85.93	74.33	11.60	0.00	--	<40	1,100	<0.5	<0.5	<0.5	<0.5	89	--
01/25/05 ⁸	85.93	75.96	9.97	0.00	--	130	900	<0.5	<0.5	<0.5	<0.5	52	--
07/26/05 ⁸	85.93	74.08	11.85	0.00	--	99	580	<0.5	<0.5	<0.5	<0.5	23	--
01/24/06 ⁸	85.93	76.06	9.87	0.00	--	69	620	<0.5	<0.5	<0.5	<0.5	31	--
07/25/06 ⁸	85.93	74.77	11.16	0.00	--	<40	420	<0.5	<0.5	<0.5	<0.5	20	--
01/23/07 ⁸	85.93	74.78	11.15	0.00	--	200	710	<0.5	<0.5	<0.5	<0.5	26	--
07/24/07 ⁸	85.93	74.15	11.78	0.00	--	730	560	<0.5	<0.5	<0.5	<0.5	30	--
01/22/08 ⁸	85.93	75.59	10.34	0.00	--	500	520	<0.5	<0.5	<0.5	<0.5	27	--
07/22/08 ⁸	85.93	73.86	12.07	0.00	--	90	330	<0.5	<0.5	<0.5	<0.5	21	--
01/13/09 ⁸	85.93	74.35	11.58	0.00	--	62	360	<0.5	<0.5	<0.5	<0.5	14	--
07/14/09 ⁸	85.93	73.68	12.25	0.00	--	90	500	<0.5	<0.5	<0.5	<0.5	10	--
01/12/10 ⁸	85.95	75.50	10.45	0.00	--	100	370	<0.5	<0.5	<0.5	<0.5	8	--
07/13/10 ⁸	85.95	74.33	11.62	0.00	--	73	260	<0.5	<0.5	<0.5	<0.5	6	--
01/25/11 ⁸	85.95	75.88	10.07	0.00	--	<40	200	<0.5	<0.5	<0.5	<0.5	4	--
07/12/11 ⁸	85.95	75.25	10.70	0.00	--	56	120	<0.5	<0.5	<0.5	<0.5	3	--

Table 1
Groundwater Monitoring Data and Analytical Results
Former Chevron Service Station #9-1583
5509 Martin Luther King Way
Oakland, California

WELL ID/ DATE	TOC (ft.)	GWE (msl)	DTW (ft.)	SPHT (ft.)	TPH-DRO (µg/L)	TPH-MO (µg/L)	TPH-GRO (µg/L)	B (µg/L)	T (µg/L)	E (µg/L)	X (µg/L)	MTBE (µg/L)	TOG (µg/L)
TRIP BLANK													
03/12/90	--	--	--	--	--	--	<50	<0.3	<0.3	<0.3	<0.6	--	--
02/08/91	--	--	--	--	--	--	<50	<0.5	<0.5	<0.5	<0.5	--	--
05/08/91	--	--	--	--	--	--	<50	<0.5	<0.5	<0.5	<0.5	--	--
08/12/91	--	--	--	--	--	--	<50	<0.5	<0.5	<0.5	<0.5	--	--
11/07/91	--	--	--	--	--	--	<50	<0.5	<0.5	<0.5	<0.5	--	--
02/05/92	--	--	--	--	--	--	<50	<0.5	<0.5	<0.5	<0.5	--	--
05/13/92	--	--	--	--	--	--	<50	<0.5	<0.5	<0.5	<0.5	--	--
07/17/92	--	--	--	--	--	--	<50	<0.5	<0.5	<0.5	<0.5	--	--
10/05/92	--	--	--	--	--	--	<50	<0.5	<0.5	<0.5	<0.5	--	--
11/11/92	--	--	--	--	--	--	--	--	--	--	--	--	--
11/17/92	--	--	--	--	--	--	--	--	--	--	--	--	--
11/29/92	--	--	--	--	--	--	--	--	--	--	--	--	--
12/01/92	--	--	--	--	--	--	--	--	--	--	--	--	--
12/29/92	--	--	--	--	--	--	--	--	--	--	--	--	--
01/05/93	--	--	--	--	--	--	--	--	--	--	--	--	--
01/08/93	--	--	--	--	--	--	<50	<0.5	<0.5	<0.5	<0.5	--	--
02/02/93	--	--	--	--	--	--	--	--	--	--	--	--	--
04/14/93	--	--	--	--	--	--	<50	<0.5	<0.5	<0.5	<0.5	--	--
08/06/93	--	--	--	--	--	--	<50	<0.5	<0.5	<0.5	<0.5	--	--
10/21/93	--	--	--	--	--	--	<50	<0.5	<0.5	<0.5	<0.5	--	--
01/05/94	--	--	--	--	--	--	<50	<0.5	<0.5	<0.5	<0.5	--	--
04/08/94	--	--	--	--	--	--	<50	<0.5	<0.5	<0.5	<0.5	--	--
07/06/94	--	--	--	--	--	--	<50	<0.5	<0.5	<0.5	<0.5	--	--
08/04/94	--	--	--	--	--	--	<50	<0.5	<0.5	<0.5	<0.5	--	--
10/05/94	--	--	--	--	--	--	<50	<0.5	<0.5	<0.5	<0.5	--	--
01/18/95	--	--	--	--	--	--	<50	<0.5	<0.5	<0.5	<0.5	--	--
04/07/95	--	--	--	--	--	--	<50	<0.5	<0.5	<0.5	<0.5	--	--
07/06/95	--	--	--	--	--	--	<50	<0.5	<0.5	<0.5	<0.5	--	--
10/11/95	--	--	--	--	--	--	<50	<0.5	<0.5	<0.5	<0.5	<2.5	--
01/17/96	--	--	--	--	--	--	<50	<0.5	<0.5	<0.5	<0.5	--	--
04/05/96	--	--	--	--	--	--	<50	<0.5	<0.5	<0.5	<0.5	<2.5	--
07/23/96	--	--	--	--	--	--	<50	<0.5	<0.5	<0.5	<0.5	<2.5	--
10/02/96	--	--	--	--	--	--	<50	<0.5	<0.5	<0.5	<0.5	--	--
01/23/97	--	--	--	--	--	--	<50	<0.5	<0.5	<0.5	<0.5	<2.5	--
04/01/97	--	--	--	--	--	--	<50	<0.5	<0.5	<0.5	<0.5	<2.5	--
07/09/97	--	--	--	--	--	--	<50	<0.5	<0.5	<0.5	<0.5	<2.5	--

Table 1
Groundwater Monitoring Data and Analytical Results
Former Chevron Service Station #9-1583
5509 Martin Luther King Way
Oakland, California

WELL ID/ DATE	TOC (ft.)	GWE (msl)	DTW (ft.)	SPHT (ft.)	TPH-DRO (µg/L)	TPH-MO (µg/L)	TPH-GRO (µg/L)	B (µg/L)	T (µg/L)	E (µg/L)	X (µg/L)	MTBE (µg/L)	TOG (µg/L)
TRIP BLANK (cont)													
10/07/97	--	--	--	--	--	--	<50	<0.5	<0.5	<0.5	<0.5	<2.5	--
01/22/98	--	--	--	--	--	--	<50	<0.5	<0.5	<0.5	<0.5	<2.5	--
04/02/98	--	--	--	--	--	--	<50	<0.5	<0.5	<0.5	<0.5	<2.5	--
07/02/98	--	--	--	--	--	--	<50	<0.5	<0.5	<0.5	<0.5	<2.5	--
10/02/98	--	--	--	--	--	--	<50	<0.5	<0.5	<0.5	<1.5	<2.5	--
01/18/99	--	--	--	--	--	--	<50	<0.5	<0.5	<0.5	<0.5	<2.0	--
07/05/00	--	--	--	--	--	--	<50	<0.50	<0.50	<0.50	<0.50	<2.5	--
01/15/01	--	--	--	--	--	--	<50.0	<0.500	<0.500	<0.500	<0.500	<2.50	--
07/03/01	--	--	--	--	--	--	<50	<0.50	<0.50	<0.50	<0.50	<2.5	--
QA													
02/28/02	--	--	--	--	--	--	<50	<0.50	<0.50	<0.50	<1.5	<2.5	--
07/08/02	--	--	--	--	--	--	<50	<0.50	<0.50	<0.50	<1.5	<2.5	--
01/01/03	--	--	--	--	--	--	<50	<0.50	<0.50	<0.50	<1.5	<2.5	--
07/14/03 ⁸	--	--	--	--	--	--	<50	<0.5	<0.5	<0.5	<0.5	<0.5	--
01/12/04 ⁸	--	--	--	--	--	--	<50	<0.5	<0.5	<0.5	<0.5	<0.5	--
07/27/04 ⁸	--	--	--	--	--	--	<50	<0.5	<0.5	<0.5	<0.5	<0.5	--
01/25/05 ⁸	--	--	--	--	--	--	<50	<0.5	<0.5	<0.5	<0.5	<0.5	--
07/26/05 ⁸	--	--	--	--	--	--	<50	<0.5	<0.5	<0.5	<0.5	<0.5	--
01/24/06 ⁸	--	--	--	--	--	--	<50	<0.5	<0.5	<0.5	<0.5	<0.5	--
07/25/06 ⁸	--	--	--	--	--	--	<50	<0.5	<0.5	<0.5	<0.5	<0.5	--
01/23/07 ⁸	--	--	--	--	--	--	<50	<0.5	<0.5	<0.5	<0.5	<0.5	--
07/24/07 ⁸	--	--	--	--	--	--	<50	<0.5	<0.5	<0.5	<0.5	<0.5	--
01/22/08 ⁸	--	--	--	--	--	--	<50	<0.5	<0.5	<0.5	<0.5	<0.5	--
07/22/08 ⁸	--	--	--	--	--	--	<50	<0.5	<0.5	<0.5	<0.5	<0.5	--
01/13/09 ⁸	--	--	--	--	--	--	<50	<0.5	<0.5	<0.5	<0.5	<0.5	--
07/14/09 ⁸	--	--	--	--	--	--	<50	<0.5	<0.5	<0.5	<0.5	<0.5	--
DESTROYED													

Table 1
Groundwater Monitoring Data and Analytical Results
Former Chevron Service Station #9-1583
5509 Martin Luther King Way
Oakland, California

EXPLANATIONS:

Groundwater monitoring data and laboratory analytical results prior to July 5, 2000, were compiled from reports prepared by Blaine Tech Services, Inc.

TOC = Top of Casing
(ft.) = Feet

GWE = Groundwater Elevation
(msl) = Mean sea level

DTW = Depth to Water

SPHT = Separate Phase Hydrocarbon Thickness

TPH = Total Petroleum Hydrocarbons

DRO = Diesel Range Organics

MO = Motor Oil

GRO = Gasoline Range Organics

B = Benzene

T = Toluene

E = Ethylbenzene

X = Xylenes

MTBE = Methyl Tertiary Butyl Ether

TOG = Total Oil & Grease

(µg/L) = Micrograms per liter

-- = Not Measured/Not Analyzed

QA = Quality Assurance/Trip Blank

* TOC elevations were surveyed on October 27, 2009, by Virgil Chavez Land Surveying. The benchmark for this survey was a cut square on top of easterly curb of Broadway, opposite 5718 Broadway. Benchmark Elevation = 180.06 feet. Vertical Datum is NGVD 29 from GPS observations.

¹ Laboratory report indicates an unidentified hydrocarbon.

² Confirmation run.

³ Laboratory report indicates gasoline C6-C12.

⁴ Laboratory report indicates motor oil C16-C36.

⁵ Laboratory report indicates unidentified hydrocarbons C9-C24.

⁶ Laboratory report indicates hydrocarbon pattern is present in the requested fuel quantitation range but does not resemble the pattern of the requested fuel. The pattern more closely resembles that of a heavier fuel.

⁷ Laboratory report indicates unidentified hydrocarbons >C16.

⁸ BTEX and MTBE by EPA Method 8260.

Table 2
Groundwater Analytical Results - Oxygenate Compounds
Former Chevron Service Station #9-1583
5509 Martin Luther King Way
Oakland, California

WELL ID	DATE	ETHANOL (µg/L)	TBA (µg/L)	MTBE (µg/L)	DIPE (µg/L)	ETBE (µg/L)	TAME (µg/L)
MW-1	07/14/03	<50	--	5	--	--	--
	01/12/04	<50	--	61	--	--	--
	07/27/04	<50	--	54	--	--	--
	01/25/05	<50	--	5	--	--	--
	07/26/05	<50	--	25	--	--	--
	01/24/06	<50	--	25	--	--	--
	07/25/06	<50	--	14	--	--	--
	01/23/07	<50	--	17	--	--	--
	07/24/07	<50	--	7	--	--	--
	01/22/08	<50	--	8	--	--	--
	07/22/08	<50	--	<0.5	--	--	--
	01/13/09	<50	--	2	--	--	--
	01/12/10	--	--	15	--	--	--
	01/25/11	--	--	5	--	--	--
MW-2	07/14/03	<50	--	<0.5	--	--	--
	01/12/04	<50	--	<0.5	--	--	--
	07/27/04	<50	--	<0.5	--	--	--
	01/25/05	<50	--	<0.5	--	--	--
	07/26/05	<50	--	<0.5	--	--	--
	01/24/06	<50	--	<0.5	--	--	--
	07/25/06	<50	--	<0.5	--	--	--
	01/23/07	<50	--	<0.5	--	--	--
	07/24/07	<50	--	<0.5	--	--	--
	01/22/08	<50	--	<0.5	--	--	--
	07/22/08	<50	--	2	--	--	--
	01/13/09	<50	--	<0.5	--	--	--
	01/12/10	--	--	<0.5	--	--	--
	01/25/11	--	--	<0.5	--	--	--
MW-3	07/14/03	<50	--	43	--	--	--
	01/12/04	<50	--	2	--	--	--
	07/27/04	<50	--	41	--	--	--
	01/25/05	<50	--	27	--	--	--
	07/26/05	<50	--	12	--	--	--

Table 2
Groundwater Analytical Results - Oxygenate Compounds
Former Chevron Service Station #9-1583
5509 Martin Luther King Way
Oakland, California

WELL ID	DATE	ETHANOL (µg/L)	TBA (µg/L)	MTBE (µg/L)	DIPE (µg/L)	ETBE (µg/L)	TAME (µg/L)
MW-3 (cont)	01/24/06	<50	--	0.8	--	--	--
	07/25/06	<50	--	23	--	--	--
	01/23/07	<50	--	2	--	--	--
	07/24/07	<50	--	20	--	--	--
	01/22/08	<50	--	<0.5	--	--	--
	07/22/08	<50	--	7	--	--	--
	01/13/09	<50	--	10	--	--	--
	01/12/10	--	--	14	--	--	--
	01/25/11	--	--	4	--	--	--
MW-4	07/14/03	SAMPLED ANNUALLY		--	--	--	--
	01/12/04	<50	--	<0.5	--	--	--
	01/25/05	<50	--	<0.5	--	--	--
	01/24/06	<50	--	<0.5	--	--	--
	01/23/07	<50	--	<0.5	--	--	--
	01/22/08	<50	--	<0.5	--	--	--
	01/13/09	<50	--	<0.5	--	--	--
	01/12/10	--	--	<0.5	--	--	--
	01/25/11	--	--	<0.5	--	--	--
MW-5	07/14/03	SAMPLED ANNUALLY		--	--	--	--
	01/12/04	<50	--	<0.5	--	--	--
	01/25/05	<50	--	<0.5	--	--	--
	01/24/06	<50	--	<0.5	--	--	--
	01/23/07	INACCESSIBLE - VEHICLE PARKED OVER WELL		--	--	--	--
	01/22/08	<50	--	<0.5	--	--	--
	01/13/09	<50	--	<0.5	--	--	--
	01/12/10	--	--	<0.5	--	--	--
	01/25/11	--	--	<0.5	--	--	--
MW-6	07/14/03	SAMPLED ANNUALLY		--	--	--	--
	01/12/04	<50	--	25	--	--	--
	01/25/05	<50	--	3	--	--	--
	01/24/06	<50	--	<0.5	--	--	--

Table 2
Groundwater Analytical Results - Oxygenate Compounds
Former Chevron Service Station #9-1583
5509 Martin Luther King Way
Oakland, California

WELL ID	DATE	ETHANOL (µg/L)	TBA (µg/L)	MTBE (µg/L)	DIPE (µg/L)	ETBE (µg/L)	TAME (µg/L)
MW-6 (cont)	01/23/07	<50	--	8	--	--	--
	01/22/08	<50	--	4	--	--	--
	01/13/09	<50	--	6	--	--	--
	01/12/10	--	--	<0.5	--	--	--
	01/25/11	--	--	<0.5	--	--	--
MW-7	07/14/03	<50	--	20	--	--	--
	01/12/04	<50	--	27	--	--	--
	07/27/04	<50	--	44	--	--	--
	01/25/05	<50	--	34	--	--	--
	07/26/05	<50	--	19	--	--	--
	01/24/06	<50	--	18	--	--	--
	07/25/06	<50	--	19	--	--	--
	01/23/07	<50	--	15	--	--	--
	07/24/07	<50	--	24	--	--	--
	01/22/08	<50	--	12	--	--	--
	07/22/08	<50	--	25	--	--	--
	01/13/09	<50	--	7	--	--	--
	07/14/09	--	--	10	--	--	--
	01/12/10	--	--	5	--	--	--
	07/13/10	--	--	4	--	--	--
01/25/11	--	--	2	--	--	--	
07/12/11	--	--	2	--	--	--	
MW-8	07/14/03	<50	--	58	--	--	--
	01/12/04	<50	--	110	--	--	--
	07/27/04	<50	--	89	--	--	--
	01/25/05	<50	--	52	--	--	--
	07/26/05	<50	--	23	--	--	--
	01/24/06	<50	--	31	--	--	--
	07/25/06	<50	--	20	--	--	--
	01/23/07	<50	--	26	--	--	--
	07/24/07	<50	--	30	--	--	--
	01/22/08	<50	--	27	--	--	--
07/22/08	<50	--	21	--	--	--	

Table 2
Groundwater Analytical Results - Oxygenate Compounds
Former Chevron Service Station #9-1583
5509 Martin Luther King Way
Oakland, California

WELL ID	DATE	ETHANOL <i>(µg/L)</i>	TBA <i>(µg/L)</i>	MTBE <i>(µg/L)</i>	DIPE <i>(µg/L)</i>	ETBE <i>(µg/L)</i>	TAME <i>(µg/L)</i>
MW-8 (cont)	01/13/09	<50	--	14	--	--	--
	07/14/09	--	--	10	--	--	--
	01/12/10	--	--	8	--	--	--
	07/13/10	--	--	6	--	--	--
	01/25/11	--	--	4	--	--	--
	07/12/11	--	--	3	--	--	--

Table 2
Groundwater Analytical Results - Oxygenate Compounds
Former Chevron Service Station #9-1583
5509 Martin Luther King Way
Oakland, California

EXPLANATIONS:

TBA = t-Butyl alcohol
MTBE = Methyl Tertiary Butyl Ether
DIPE = di-Isopropyl ether
ETBE = Ethyl t-butyl ether

TAME = t-Amyl methyl ether
($\mu\text{g/L}$) = Micrograms per liter
-- = Not Analyzed

ANALYTICAL METHODS:

EPA Method 8260 for Oxygenate Compounds

STANDARD OPERATING PROCEDURE - GROUNDWATER SAMPLING

Gettler-Ryan Inc. (GR) field personnel adhere to the following procedures for the collection and handling of groundwater samples prior to analysis by the analytical laboratory. All work is performed in accordance with the GR Health & Safety Plan and all client-specific programs. The scope of work and type of analysis to be performed is determined prior to commencing field work.

Prior to sampling, the presence or absence of free-phase hydrocarbons is determined using an interface probe. Product thickness, if present, is measured to the nearest 0.01 foot and is noted in the field notes. In addition, all depth to water level measurements are collected with a static water level indicator and are also recorded in the field notes, prior to purging and sampling any wells.

After water levels are collected and prior to sampling, if purging is to occur, each well is purged a minimum of three well casing volumes of water using pre-cleaned pumps (stack, peristaltic or Grundfos), or disposable bailers. Temperature, pH and electrical conductivity are measured a minimum of three times during the purging (additional parameters such as dissolved oxygen, oxidation reduction potential, turbidity may also be measured, depending on specific scope of work.). Purging continues until these parameters stabilize.

Groundwater samples are collected using disposable bailers. The water samples are transferred from the bailer into appropriate containers. Pre-preserved containers, supplied by analytical laboratories, are used. When pre-preserved containers are not available, the laboratory is instructed to preserve the sample as appropriate. Duplicate samples are collected for the laboratory to use in maintaining quality assurance/quality control standards, as directed by the scope of work. The samples are labeled to include the job number, sample identification, collection date and time, analysis, preservation (if any), and the sample collector's initials. The water samples are placed in a cooler, maintained at 4°C for transport to the laboratory. Once collected in the field, all samples are maintained under chain of custody until delivered to the laboratory.

The chain of custody document includes the job number, type of preservation, if any, analysis requested, sample identification, date and time collected, and the sample collector's name. The chain of custody is signed and dated (including time of transfer) by each person who receives or surrenders the samples, beginning with the field personnel and ending with the laboratory personnel.

As requested by Chevron Environmental Management Company, the purge water and decontamination water generated during sampling activities is transported by IWM to Chemical Waste Management located in Kettleman Hills, California.



GETTLER - RYAN INC.

WELL MONITORING/SAMPLING FIELD DATA SHEET

Client/Facility#: Chevron #9-1583
 Site Address: 5509 Martin Luther King Way
 City: Oakland, CA

Job Number: 386506
 Event Date: 7/12/11 (inclusive)
 Sampler: HAIG K

Well ID: MW-1
 Well Diameter: 2 1/3 in.
 Total Depth: 19.43 ft.
 Depth to Water: 9.55 ft.
10.18 xVF _____ = _____ x3 case volume = Estimated Purge Volume: N/A gal.

Date Monitored: 7/12/11

Volume	3/4" = 0.02	1" = 0.04	2" = 0.17	3" = 0.38
Factor (VF)	4" = 0.66	5" = 1.02	6" = 1.50	12" = 5.80

Check if water column is less than 0.50 ft.

Depth to Water w/ 80% Recharge [(Height of Water Column x 0.20) + DTW]: N/A

Purge Equipment:

- Disposable Bailer _____
- Stainless Steel Bailer _____
- Stack Pump _____
- Suction Pump _____
- Grundfos _____
- Peristaltic Pump _____
- QED Bladder Pump _____
- Other: _____

Sampling Equipment:

- Disposable Bailer _____
- Pressure Bailer _____
- Discrete Bailer _____
- Peristaltic Pump _____
- QED Bladder Pump _____
- Other: _____

M / O

Time Started: _____	(2400 hrs)
Time Completed: _____	(2400 hrs)
Depth to Product: _____	ft
Depth to Water: _____	ft
Hydrocarbon Thickness: _____	ft
Visual Confirmation/Description: _____	
Skimmer / Absorbant Sock (circle one)	
Amt Removed from Skimmer: _____	gal
Amt Removed from Well: _____	gal
Water Removed: _____	
Product Transferred to: _____	

Start Time (purge): _____
 Sample Time/Date: N/A
 Approx. Flow Rate: _____ gpm.
 Did well de-water? _____ If yes, Time: _____

Weather Conditions: CLOUDY
 Water Color: _____ Odor: Y / N
 Sediment Description: _____
 Volume: _____ gal. DTW @ Sampling: N/A

Time (2400 hr.)	Volume (gal.)	pH	Conductivity (µmhos/cm - µS)	Temperature (C / F)	D.O. (mg/L)	ORP (mV)
_____	_____	_____	_____	_____	_____	_____
_____	_____	_____	_____	_____	_____	_____
_____	_____	_____	_____	_____	_____	_____
_____	_____	_____	_____	_____	_____	_____

LABORATORY INFORMATION

SAMPLE ID	(#) CONTAINER	REFRIG.	PRESERV. TYPE	LABORATORY	ANALYSES
MW-	x voa vial	YES	HCL	LANCASTER	TPH-GRO(8015)/BTEX+MTBE(8260)
	x 1 liter ambers	YES	NP	LANCASTER	TPH-MO (8015)

COMMENTS: M / O

Add/Replaced Lock: _____ Add/Replaced Plug: _____ Add/Replaced Bolt: _____



GETTLER - RYAN INC.

WELL MONITORING/SAMPLING FIELD DATA SHEET

Client/Facility#: Chevron #9-1583 Job Number: 386506
 Site Address: 5509 Martin Luther King Way Event Date: 7/12/11 (inclusive)
 City: Oakland, CA Sampler: HAIG K

Well ID: MW-2
 Well Diameter: 21(3) in.
 Total Depth: 18.85 ft.
 Depth to Water: 9.90 ft.
8.95 xVF _____ = _____ x3 case volume = Estimated Purge Volume: N/A gal.

Date Monitored: 7/12/11

Volume	3/4" = 0.02	1" = 0.04	2" = 0.17	3" = 0.38
Factor (VF)	4" = 0.66	5" = 1.02	6" = 1.50	12" = 5.80

Check if water column is less than 0.50 ft.

Depth to Water w/ 80% Recharge [(Height of Water Column x 0.20) + DTW]: N/A

Purge Equipment:

- Disposable Bailer _____
- Stainless Steel Bailer _____
- Stack Pump _____
- Suction Pump _____
- Grundfos _____
- Peristaltic Pump _____
- QED Bladder Pump _____
- Other: _____

Sampling Equipment:

- Disposable Bailer _____
- Pressure Bailer _____
- Discrete Bailer _____
- Peristaltic Pump _____
- QED Bladder Pump _____
- Other: _____

M / O

Time Started: _____ (2400 hrs)
Time Completed: _____ (2400 hrs)
Depth to Product: _____ ft
Depth to Water: _____ ft
Hydrocarbon Thickness: _____ ft
Visual Confirmation/Description: <u>Ø</u>
Skimmer / Absorbant Sock (circle one)
Amt Removed from Skimmer: _____ gal
Amt Removed from Well: _____ gal
Water Removed: _____ gal
Product Transferred to: _____

Start Time (purge): _____ Weather Conditions: cloudy
 Sample Time/Date: N/A Water Color: _____ Odor: Y / N
 Approx. Flow Rate: _____ gpm. Sediment Description: _____
 Did well de-water? _____ If yes, Time: _____ Volume: _____ gal. DTW @ Sampling: N/A

Time (2400 hr.)	Volume (gal.)	pH	Conductivity (µmhos/cm - µS)	Temperature (C / F)	D.O. (mg/L)	ORP (mV)
_____	_____	_____	_____	_____	_____	_____
_____	_____	_____	_____	_____	_____	_____
_____	_____	_____	_____	_____	_____	_____
_____	_____	_____	_____	_____	_____	_____

LABORATORY INFORMATION

SAMPLE ID	(#) CONTAINER	REFRIG.	PRESERV. TYPE	LABORATORY	ANALYSES
MW-	x voa vial	YES	HCL	LANCASTER	TPH-GRO(8015)/BTEX+MTBE(8260)
	x 1 liter ambers	YES	NP	LANCASTER	TPH MO (8015)

COMMENTS: M / O

Add/Replaced Lock: _____ Add/Replaced Plug: _____ Add/Replaced Bolt: _____



GETTLER-RYAN INC.

WELL MONITORING/SAMPLING FIELD DATA SHEET

Client/Facility#: Chevron #9-1583
 Site Address: 5509 Martin Luther King Way
 City: Oakland, CA

Job Number: 386506
 Event Date: 7/12/11 (inclusive)
 Sampler: HAIG K

Well ID: MW-3
 Well Diameter: 2 1/3 in.
 Total Depth: 19.48 ft.
 Depth to Water: 11.15 ft.
8.33 xVF _____ = _____ x3 case volume = Estimated Purge Volume: N/A gal.

Date Monitored: 7/12/11

Volume	3/4"= 0.02	1"= 0.04	2"= 0.17	3"= 0.38
Factor (VF)	4"= 0.66	5"= 1.02	6"= 1.50	12"= 5.80

Check if water column is less than 0.50 ft.

Depth to Water w/ 80% Recharge [(Height of Water Column x 0.20) + DTW]: N/A

Purge Equipment:

- Disposable Bailer _____
- Stainless Steel Bailer _____
- Stack Pump _____
- Suction Pump _____
- Grundfos _____
- Peristaltic Pump _____
- QED Bladder Pump _____
- Other: _____

Sampling Equipment:

- Disposable Bailer _____
- Pressure Bailer _____
- Discrete Bailer _____
- Peristaltic Pump _____
- QED Bladder Pump _____
- Other: _____

M / O

Time Started:	_____ (2400 hrs)
Time Completed:	_____ (2400 hrs)
Depth to Product:	_____ ft
Depth to Water:	_____ ft
Hydrocarbon Thickness:	_____ ft
Visual Confirmation/Description:	<u>✓</u>
Skimmer / Absorbant Sock (circle one)	
Amt Removed from Skimmer:	_____ gal
Amt Removed from Well:	_____ gal
Water Removed:	_____ gal
Product Transferred to:	_____

Start Time (purge): _____
 Sample Time/Date: N/A
 Approx. Flow Rate: _____ gpm.
 Did well de-water? _____ If yes, Time: _____

Weather Conditions: CLOUDY
 Water Color: _____ Odor: Y / N
 Sediment Description: _____
 Volume: _____ gal. DTW @ Sampling: N/A

Time (2400 hr.)	Volume (gal.)	pH	Conductivity (µmhos/cm - µS)	Temperature (C / F)	D.O. (mg/L)	ORP (mV)

LABORATORY INFORMATION

SAMPLE ID	(#) CONTAINER	REFRIG.	PRESERV. TYPE	LABORATORY	ANALYSES
MW-	x voa vial	YES	HCL	LANCASTER	TPH-GRO(8015)/BTEX+MTBE(8260)
	x 1 liter ambers	YES	NP	LANCASTER	TPH-MO (8015)

COMMENTS: M / O

Add/Replaced Lock: _____ Add/Replaced Plug: _____ Add/Replaced Bolt: _____



GETTLER-RYAN INC.

WELL MONITORING/SAMPLING FIELD DATA SHEET

Client/Facility#: Chevron #9-1583
 Site Address: 5509 Martin Luther King Way
 City: Oakland, CA

Job Number: 386506
 Event Date: 7/12/11 (inclusive)
 Sampler: HAIG K.

Well ID: MW-7
 Well Diameter: 2.3 in.
 Total Depth: 19.46 ft.
 Depth to Water: 11.75 ft.

Date Monitored: 7/12/11

Volume Factor (VF)	3/4" = 0.02	1" = 0.04	2" = 0.17	3" = 0.38
	4" = 0.66	5" = 1.02	6" = 1.50	12" = 5.80

Check if water column is less than 0.50 ft.

Depth to Water w/ 80% Recharge [(Height of Water Column x 0.20) + DTW]: 13.29
 xVF 0.17 = 1.31 x3 case volume = Estimated Purge Volume: 4 gal.

Purge Equipment:

Disposable Bailer
 Stainless Steel Bailer _____
 Stack Pump _____
 Suction Pump _____
 Grundfos _____
 Peristaltic Pump _____
 QED Bladder Pump _____
 Other: _____

Sampling Equipment:

Disposable Bailer
 Pressure Bailer _____
 Discrete Bailer _____
 Peristaltic Pump _____
 QED Bladder Pump _____
 Other: _____

Time Started: _____ (2400 hrs)
 Time Completed: _____ (2400 hrs)
 Depth to Product: _____ ft
 Depth to Water: _____ ft
 Hydrocarbon Thickness: 0 ft
 Visual Confirmation/Description: _____
 Skimmer / Absorbant Sock (circle one)
 Amt Removed from Skimmer: _____ gal
 Amt Removed from Well: _____ gal
 Water Removed: _____
 Product Transferred to: _____

Start Time (purge): 0905
 Sample Time/Date: 0925 7/12/11
 Approx. Flow Rate: _____ gpm.
 Did well de-water? No If yes, Time: _____ Volume: _____ gal. DTW @ Sampling: 12.62

Weather Conditions: CLOUDY
 Water Color: CLOUDY Odor: YN MODERATE
 Sediment Description: SILT

Time (2400 hr.)	Volume (gal.)	pH	Conductivity (µmhos/cm - DS)	Temperature (C / F)	D.O. (mg/L)	ORP (mV)
<u>0910</u>	<u>1.5</u>	<u>7.35</u>	<u>346</u>	<u>16.9</u>		
<u>0913</u>	<u>3</u>	<u>7.31</u>	<u>350</u>	<u>17.0</u>		
<u>0916</u>	<u>4</u>	<u>7.28</u>	<u>352</u>	<u>17.0</u>		

LABORATORY INFORMATION

SAMPLE ID	(#) CONTAINER	REFRIG.	PRESERV. TYPE	LABORATORY	ANALYSES
MW-7	6 x voa vial	YES	HCL	LANCASTER	TPH-GRO(8015)/BTEX+MTBE(8260)
	2 x 1 liter ambers	YES	NP	LANCASTER	TPH-MO (8015)

COMMENTS: _____

Add/Replaced Lock: _____ Add/Replaced Plug: _____ Add/Replaced Bolt: _____



GETTLER-RYAN INC.

WELL MONITORING/SAMPLING FIELD DATA SHEET

Client/Facility#: Chevron #9-1583
 Site Address: 5509 Martin Luther King Way
 City: Oakland, CA

Job Number: 386506
 Event Date: 7/12/11 (inclusive)
 Sampler: HAIG K.

Well ID: MW-8
 Well Diameter: (2) 3 in.
 Total Depth: 17.12 ft.
 Depth to Water: 10.70 ft.
6.42 xVF 0.17 = 1

Date Monitored: 7/12/11

Volume	3/4"= 0.02	1"= 0.04	2"= 0.17	3"= 0.38
Factor (VF)	4"= 0.66	5"= 1.02	6"= 1.50	12"= 5.80

Check if water column is less than 0.50 ft.
 Depth to Water w/ 80% Recharge [(Height of Water Column x 0.20) + DTW]: 11.98
 x3 case volume = Estimated Purge Volume: 3 gal.

Purge Equipment:
 Disposable Bailer ✓
 Stainless Steel Bailer _____
 Stack Pump _____
 Suction Pump _____
 Grundfos _____
 Peristaltic Pump _____
 QED Bladder Pump _____
 Other: _____

Sampling Equipment:
 Disposable Bailer ✓
 Pressure Bailer _____
 Discrete Bailer _____
 Peristaltic Pump _____
 QED Bladder Pump _____
 Other: _____

Time Started: _____ (2400 hrs)
 Time Completed: _____ (2400 hrs)
 Depth to Product: _____ ft
 Depth to Water: _____ ft
 Hydrocarbon Thickness: Ø ft
 Visual Confirmation/Description: _____
 Skimmer / Absorbant Sock (circle one)
 Amt Removed from Skimmer: _____ gal
 Amt Removed from Well: _____ gal
 Water Removed: _____
 Product Transferred to: _____

Start Time (purge): 0947 Weather Conditions: CLOUDY
 Sample Time/Date: 1010 / 7/12/11 Water Color: CLEAR Odor: Ø N MODERATE
 Approx. Flow Rate: _____ gpm. Sediment Description: _____
 Did well de-water? NO If yes, Time: _____ Volume: _____ gal. DTW @ Sampling: 11.36

Time (2400 hr.)	Volume (gal.)	pH	Conductivity (µmhos/cm - DS)	Temperature (C / F)	D.O (mg/L)	ORP (mV)
<u>0951</u>	<u>1</u>	<u>7.18</u>	<u>388</u>	<u>17.2</u>		
<u>0954</u>	<u>2</u>	<u>7.16</u>	<u>394</u>	<u>17.3</u>		
<u>0957</u>	<u>3</u>	<u>7.13</u>	<u>392</u>	<u>17.5</u>		

LABORATORY INFORMATION

SAMPLE ID	(#) CONTAINER	REFRIG.	PRESERV. TYPE	LABORATORY	ANALYSES
MW-8	6 x voa vial	YES	HCL	LANCASTER	TPH-GRO(8015)/BTEX+MTBE(8260)
	2 x 1 liter ambers	YES	NP	LANCASTER	TPH-MO (8015)

COMMENTS: _____

Add/Replaced Lock: _____ Add/Replaced Plug: _____ Add/Replaced Bolt: _____

Chevron California Region Analysis Request/Chain of Custody



071211-02

For Lancaster Laboratories use only

Acct. #: 12099 Sample # 6342309-10 Group #: 007708

CRA MTI Project #: 61H-1960

1255943

Facility #: <u>SS#9-1583 G-R#386506 Global ID#T0600T00348</u> Site Address: <u>5509 MARTIN LUTHER KING WAY, OAKLAND, CA</u> Chevron PM: <u>MTI</u> Lead Consultant: <u>CRAKJ Kiernan</u> Consultant/Office: <u>G-R, Inc., 6747 Sierra Court, Suite J, Dublin, CA 94568</u> Consultant Prj. Mgr.: <u>Deanna L. Harding (deanna@grinc.com)</u> Consultant Phone #: <u>925-551-7555</u> Fax #: <u>925-551-7899</u> Sampler: <u>HAIG KEVORK</u>			Matrix <input type="checkbox"/> Potable <input type="checkbox"/> NPDES <input type="checkbox"/> Water <input type="checkbox"/> Oil <input type="checkbox"/> Air		Analyses Requested Preservation Codes Preservation Codes H = HCl T = Thiosulfate N = HNO ₃ B = NaOH S = H ₂ SO ₄ O = Other <input type="checkbox"/> J value reporting needed <input checked="" type="checkbox"/> Must meet lowest detection limits possible for 8260 compounds 8021 MTBE Confirmation <input type="checkbox"/> Confirm highest hit by 8260 <input type="checkbox"/> Confirm all hits by 8260 <input type="checkbox"/> Run ___ oxy's on highest hit <input type="checkbox"/> Run ___ oxy's on all hits																		
Sample Identification	Date Collected	Time Collected	Grab	Composite	Soil	Water	Oil	Air	Total Number of Containers	BTEX + MTBE 8260	8021	TPH 8015 MOD GRO	TPH 8015 MOD DRO	Silica Gel Cleanup	8260 full scan	Oxygenates	Total Lead	Method	Dissolved Lead	Method			
<u>MW-7</u>	<u>7/12/11</u>	<u>0925</u>	<input checked="" type="checkbox"/>			<input checked="" type="checkbox"/>			<u>800</u>	<input checked="" type="checkbox"/>	<input checked="" type="checkbox"/>	<input checked="" type="checkbox"/>								<u>TPH-MO(8015)</u>			
<u>MW-8</u>	<u>7/12/11</u>	<u>1010</u>	<input checked="" type="checkbox"/>			<input checked="" type="checkbox"/>			<u>800</u>	<input checked="" type="checkbox"/>	<input checked="" type="checkbox"/>	<input checked="" type="checkbox"/>								<u>TPH-MO(8015)</u>			
Comments / Remarks																							
Turnaround Time Requested (TAT) (please circle) <input checked="" type="checkbox"/> STD TAT 24 hour 72 hour 48 hour 4 day 5 day						Relinquished by: <u>[Signature]</u> Date: <u>7/12/11</u> Time: <u>1130</u> Received by: <u>[Signature]</u> Date: <u>12 JUL 11</u> Time: <u>1130</u>						Relinquished by: <u>[Signature]</u> Date: <u>12 JUL 11</u> Time: <u>1630</u> Received by: <u>FEDEX</u> Date: _____ Time: _____						Relinquished by Commercial Carrier: UPS <input checked="" type="checkbox"/> FedEx <input checked="" type="checkbox"/> Other _____ Received by: <u>[Signature]</u> Date: <u>7/13/11</u> Time: <u>0950</u>					
Data Package Options (please circle if required) <u>EDF/EDD</u> QC Summary Type I - Full Type VI (Raw Data) <input type="checkbox"/> Coelt Deliverable not needed WIP (RWQCB) Disk						Temperature Upon Receipt <u>23.3</u> °C Custody Seals Intact? <input checked="" type="checkbox"/> Yes <input type="checkbox"/> No																	

ANALYTICAL RESULTS

Prepared by:

Lancaster Laboratories
2425 New Holland Pike
Lancaster, PA 17605-2425

Prepared for:

Chevron c/o CRA
Suite 107
10969 Trade Center Dr
Rancho Cordova CA 95670

July 21, 2011

Project: 91583

Submittal Date: 07/13/2011

Group Number: 1255943

PO Number: 91583

Release Number: MTI

State of Sample Origin: CA

RECEIVED

JUL 22 2011

GETTLER-RYAN INC.
GENERAL CONTRACTORS

Client Sample Description

MW-7-W-110712 Grab Water
MW-8-W-110712 Grab Water

Lancaster Labs (LLI) #

6342309
6342310

The specific methodologies used in obtaining the enclosed analytical results are indicated on the Laboratory Sample Analysis Record.

ELECTRONIC Gettler-Ryan, Inc.
COPY TO
ELECTRONIC Chevron c/o CRA
COPY TO
ELECTRONIC Chevron
COPY TO

Attn: Rachelle Munoz

Attn: Report Contact

Attn: Anna Avina



Analysis Report

2425 New Holland Pike, PO Box 12425, Lancaster, PA 17605-2425 • 717-656-2300 Fax: 717-656-2681 • www.lancasterlabs.com

Questions? Contact your Client Services Representative
Jill M Parker at (717) 656-2300 Ext. 1241

Respectfully Submitted,

A handwritten signature in cursive script that reads "Valeria L. Tomayko".

Valeria L. Tomayko
Principal Specialist

Sample Description: MW-7-W-110712 Grab Water
**Facility# 91583 Job# 386506 MTI# 61H-1960 GRD
5509 Martin Luther-Oakland T0600100348 MW-7**
LLI Sample # WW 6342309
LLI Group # 1255943
Account # 12099
Project Name: 91583

Collected: 07/12/2011 09:25 by HK

Chevron c/o CRA

Suite 107

Submitted: 07/13/2011 09:50

10969 Trade Center Dr

Reported: 07/21/2011 16:51

Rancho Cordova CA 95670

15837

CAT No.	Analysis Name	CAS Number	As Received Result	As Received Method Detection Limit	Dilution Factor
GC/MS Volatiles SW-846 8260B ug/l					
10943	Benzene	71-43-2	N.D.	0.5	1
10943	Ethylbenzene	100-41-4	N.D.	0.5	1
10943	Methyl Tertiary Butyl Ether	1634-04-4	2	0.5	1
10943	Toluene	108-88-3	N.D.	0.5	1
10943	Xylene (Total)	1330-20-7	N.D.	0.5	1
GC Volatiles SW-846 8015B ug/l					
01728	TPH-GRO N. CA water C6-C12	n.a.	N.D.	50	1
GC Extractable TPH SW-846 8015B modified ug/l					
02500	Total TPH	n.a.	1,800	39	1
02500	TPH Motor Oil C16-C36	n.a.	1,800	39	1

TPH quantitation is based on peak area comparison of the sample pattern to that of a hydrocarbon component mix calibration in a range that includes C8 (n-octane) through C40 (n-tetracontane) normal hydrocarbons.

General Sample Comments

State of California Lab Certification No. 2501

Trip blank vials were not received by the laboratory for this sample group.

All QC is compliant unless otherwise noted. Please refer to the Quality Control Summary for overall QC performance data and associated samples.

Laboratory Sample Analysis Record

CAT No.	Analysis Name	Method	Trial#	Batch#	Analysis		Analyst	Dilution Factor
					Date	Time		
10943	BTEX/MTBE 8260 Water	SW-846 8260B	1	F111992AA	07/18/2011	05:55	Anita M Dale	1
01163	GC/MS VOA Water Prep	SW-846 5030B	1	F111992AA	07/18/2011	05:55	Anita M Dale	1
01728	TPH-GRO N. CA water C6-C12	SW-846 8015B	1	11199A07A	07/18/2011	11:12	Laura M Krieger	1
01146	GC VOA Water Prep	SW-846 5030B	1	11199A07A	07/18/2011	11:12	Laura M Krieger	1
02500	TPH Fuels by GC (Waters)	SW-846 8015B modified	1	111970002A	07/18/2011	21:58	Heather E Williams	1
11191	TPH Fuels Waters Extraction	SW-846 3510C	1	111970002A	07/17/2011	11:30	Kathryn I DeHaven	1

Sample Description: MW-8-W-110712 Grab Water
**Facility# 91583 Job# 386506 MTI# 61H-1960 GRD
5509 Martin Luther-Oakland T0600100348 MW-8**
LLI Sample # WW 6342310
LLI Group # 1255943
Account # 12099
Project Name: 91583

Collected: 07/12/2011 10:10 by HK

Chevron c/o CRA

Suite 107

Submitted: 07/13/2011 09:50

10969 Trade Center Dr

Reported: 07/21/2011 16:51

Rancho Cordova CA 95670

15838

CAT No.	Analysis Name	CAS Number	As Received Result	As Received Method Detection Limit	Dilution Factor
GC/MS Volatiles SW-846 8260B ug/1					
10943	Benzene	71-43-2	N.D.	0.5	1
10943	Ethylbenzene	100-41-4	N.D.	0.5	1
10943	Methyl Tertiary Butyl Ether	1634-04-4	3	0.5	1
10943	Toluene	108-88-3	N.D.	0.5	1
10943	Xylene (Total)	1330-20-7	N.D.	0.5	1
GC Volatiles SW-846 8015B ug/1					
01728	TPH-GRO N. CA water C6-C12	n.a.	120	50	1
GC Extractable TPH SW-846 8015B modified ug/1					
02500	Total TPH	n.a.	56	38	1
02500	TPH Motor Oil C16-C36	n.a.	56	38	1

TPH quantitation is based on peak area comparison of the sample pattern to that of a hydrocarbon component mix calibration in a range that includes C8 (n-octane) through C40 (n-tetracontane) normal hydrocarbons.

General Sample Comments

State of California Lab Certification No. 2501

Trip blank vials were not received by the laboratory for this sample group.

All QC is compliant unless otherwise noted. Please refer to the Quality Control Summary for overall QC performance data and associated samples.

Laboratory Sample Analysis Record

CAT No.	Analysis Name	Method	Trial#	Batch#	Analysis Date and Time	Analyst	Dilution Factor
10943	BTEX/MTBE 8260 Water	SW-846 8260B	1	F111992AA	07/18/2011 06:16	Anita M Dale	1
01163	GC/MS VOA Water Prep	SW-846 5030B	1	F111992AA	07/18/2011 06:16	Anita M Dale	1
01728	TPH-GRO N. CA water C6-C12	SW-846 8015B	1	11199A07A	07/18/2011 11:38	Laura M Krieger	1
01146	GC VOA Water Prep	SW-846 5030B	1	11199A07A	07/18/2011 11:38	Laura M Krieger	1
02500	TPH Fuels by GC (Waters)	SW-846 8015B modified	1	111970002A	07/18/2011 22:23	Heather E Williams	1
11191	TPH Fuels Waters Extraction	SW-846 3510C	1	111970002A	07/17/2011 11:30	Kathryn I DeHaven	1

Quality Control Summary

Client Name: Chevron c/o CRA
Reported: 07/21/11 at 04:51 PM

Group Number: 1255943

Matrix QC may not be reported if site-specific QC samples were not submitted. In these situations, to demonstrate precision and accuracy at a batch level, a LCS/LCSD was performed, unless otherwise specified in the method.

Laboratory Compliance Quality Control

<u>Analysis Name</u>	<u>Blank Result</u>	<u>Blank MDL</u>	<u>Report Units</u>	<u>LCS %REC</u>	<u>LCSD %REC</u>	<u>LCS/LCSD Limits</u>	<u>RPD</u>	<u>RPD Max</u>
Batch number: F111992AA	Sample number(s): 6342309-6342310							
Benzene	N.D.	0.5	ug/l	94		79-120		
Ethylbenzene	N.D.	0.5	ug/l	90		79-120		
Methyl Tertiary Butyl Ether	N.D.	0.5	ug/l	84		76-120		
Toluene	N.D.	0.5	ug/l	90		79-120		
Xylene (Total)	N.D.	0.5	ug/l	89		80-120		
Batch number: 11199A07A	Sample number(s): 6342309-6342310							
TPH-GRO N. CA water C6-C12	N.D.	50.	ug/l	118	109	75-135	8	30
Batch number: 111970002A	Sample number(s): 6342309-6342310							
Total TPH	N.D.	40.	ug/l	95	104	60-120	9	20
TPH Motor Oil C16-C36	N.D.	40.	ug/l					

Sample Matrix Quality Control

Unspiked (UNSPK) = the sample used in conjunction with the matrix spike
Background (BKG) = the sample used in conjunction with the duplicate

<u>Analysis Name</u>	<u>MS %REC</u>	<u>MSD %REC</u>	<u>MS/MSD Limits</u>	<u>RPD</u>	<u>RPD MAX</u>	<u>BKG Conc</u>	<u>DUP Conc</u>	<u>DUP RPD</u>	<u>Dup RPD Max</u>
Batch number: F111992AA	Sample number(s): 6342309-6342310 UNSPK: 6342310								
Benzene	96	96	80-126	0	30				
Ethylbenzene	96	95	71-134	1	30				
Methyl Tertiary Butyl Ether	85	85	72-126	0	30				
Toluene	92	92	80-125	0	30				
Xylene (Total)	92	92	79-125	0	30				

Surrogate Quality Control

Surrogate recoveries which are outside of the QC window are confirmed unless attributed to dilution or otherwise noted on the Analysis Report.

Analysis Name: UST VOCs by 8260B - Water
Batch number: F111992AA

	Dibromofluoromethane	1,2-Dichloroethane-d4	Toluene-d8	4-Bromofluorobenzene
6342309	97	103	97	91
6342310	98	102	98	96
Blank	99	102	98	92

*- Outside of specification

- (1) The result for one or both determinations was less than five times the LOQ.
- (2) The unspiked result was more than four times the spike added.

Quality Control Summary

Client Name: Chevron c/o CRA
Reported: 07/21/11 at 04:51 PM

Group Number: 1255943

Surrogate Quality Control

LCS	97	104	97	97
MS	97	105	98	101
MSD	98	103	97	99

Limits: 80-116 77-113 80-113 78-113

Analysis Name: TPH-GRO N. CA water C6-C12
Batch number: 11199A07A
Trifluorotoluene-F

6342309	100
6342310	99
Blank	102
LCS	113
LCSD	109

Limits: 63-135

Analysis Name: TPH Fuels by GC (Waters)
Batch number: 111970002A
Chlorobenzene Orthoterphenyl

6342309	87	87
6342310	116	104
Blank	96	103
LCS	116	109
LCSD	103	118

Limits: 28-152 52-131

*- Outside of specification

- (1) The result for one or both determinations was less than five times the LOQ.
- (2) The unspiked result was more than four times the spike added.

Explanation of Symbols and Abbreviations

The following defines common symbols and abbreviations used in reporting technical data:

RL	Reporting Limit	BMQL	Below Minimum Quantitation Level
N.D.	none detected	MPN	Most Probable Number
TNTC	Too Numerous To Count	CP Units	cobalt-chloroplatinate units
IU	International Units	NTU	nephelometric turbidity units
umhos/cm	micromhos/cm	ng	nanogram(s)
C	degrees Celsius	F	degrees Fahrenheit
meq	milliequivalents	lb.	pound(s)
g	gram(s)	kg	kilogram(s)
ug	microgram(s)	mg	milligram(s)
ml	milliliter(s)	l	liter(s)
m3	cubic meter(s)	ul	microliter(s)
<	less than - The number following the sign is the <u>limit of quantitation</u> , the smallest amount of analyte which can be reliably determined using this specific test.		
>	greater than		
J	estimated value – The result is \geq the Method Detection Limit (MDL) and $<$ the Limit of Quantitation (LOQ).		
ppm	parts per million - One ppm is equivalent to one milligram per kilogram (mg/kg), or one gram per million grams. For aqueous liquids, ppm is usually taken to be equivalent to milligrams per liter (mg/l), because one liter of water has a weight very close to a kilogram. For gases or vapors, one ppm is equivalent to one microliter of gas per liter of gas.		
ppb	parts per billion		
Dry weight basis	Results printed under this heading have been adjusted for moisture content. This increases the analyte weight concentration to approximate the value present in a similar sample without moisture. All other results are reported on an as-received basis.		

U.S. EPA CLP Data Qualifiers:

Organic Qualifiers		Inorganic Qualifiers	
A	TIC is a possible aldol-condensation product	B	Value is $<$ CRDL, but \geq IDL
B	Analyte was also detected in the blank	E	Estimated due to interference
C	Pesticide result confirmed by GC/MS	M	Duplicate injection precision not met
D	Compound quantitated on a diluted sample	N	Spike sample not within control limits
E	Concentration exceeds the calibration range of the instrument	S	Method of standard additions (MSA) used for calculation
N	Presumptive evidence of a compound (TICs only)	U	Compound was not detected
P	Concentration difference between primary and confirmation columns $>$ 25%	W	Post digestion spike out of control limits
U	Compound was not detected	*	Duplicate analysis not within control limits
X,Y,Z	Defined in case narrative	+	Correlation coefficient for MSA $<$ 0.995

Analytical test results meet all requirements of NELAC unless otherwise noted under the individual analysis.

Measurement uncertainty values, as applicable, are available upon request.

Tests results relate only to the sample tested. Clients should be aware that a critical step in a chemical or microbiological analysis is the collection of the sample. Unless the sample analyzed is truly representative of the bulk of material involved, the test results will be meaningless. If you have questions regarding the proper techniques of collecting samples, please contact us. We cannot be held responsible for sample integrity, however, unless sampling has been performed by a member of our staff. This report shall not be reproduced except in full, without the written approval of the laboratory.

WARRANTY AND LIMITS OF LIABILITY - In accepting analytical work, we warrant the accuracy of test results for the sample as submitted. THE FOREGOING EXPRESS WARRANTY IS EXCLUSIVE AND IS GIVEN IN LIEU OF ALL OTHER WARRANTIES, EXPRESSED OR IMPLIED. WE DISCLAIM ANY OTHER WARRANTIES, EXPRESSED OR IMPLIED, INCLUDING A WARRANTY OF FITNESS FOR PARTICULAR PURPOSE AND WARRANTY OF MERCHANTABILITY. IN NO EVENT SHALL LANCASTER LABORATORIES BE LIABLE FOR INDIRECT, SPECIAL, CONSEQUENTIAL, OR INCIDENTAL DAMAGES INCLUDING, BUT NOT LIMITED TO, DAMAGES FOR LOSS OF PROFIT OR GOODWILL REGARDLESS OF (A) THE NEGLIGENCE (EITHER SOLE OR CONCURRENT) OF LANCASTER LABORATORIES AND (B) WHETHER LANCASTER LABORATORIES HAS BEEN INFORMED OF THE POSSIBILITY OF SUCH DAMAGES. We accept no legal responsibility for the purposes for which the client uses the test results. No purchase order or other order for work shall be accepted by Lancaster Laboratories which includes any conditions that vary from the Standard Terms and Conditions, and Lancaster hereby objects to any conflicting terms contained in any acceptance or order submitted by client.