

# ASSESSOR'S MAP 32

Code Area No. 17-001

2031 Scale: 1"=100'

POTTERS ADDITION TO VALLEY VIEW (Bk. 25 Pg. 20)  
 BROOKLYN LAND CO. (Bk. 5 Pg. 20)  
 EAST FRUITVALE TR. (Bk. 12 Pg. 25)  
 VALLEY VIEW TR. (Bk. 23 Pg. 44)  
 FAIRVIEW HEIGHTS (Bk. 24 Pg. 7)  
 FREMONT TR. (Bk. 26 Pg. 14)  
 P.M. 9695 308/51-52  
 P.M. 9234 308/37-38

Drawn: 4-17-70 J.H.N. Revised: 3-10-89 R.M.  
 8-16-88 P.B.  
 4-2-90 J.C.R.  
 11-10-95 C.C.  
 01-22-08 C.C.

Formerly: Bk. 31- Bks. 2002, 2004, 2022, 2023, 2024, 2029 B Pgs. 2003

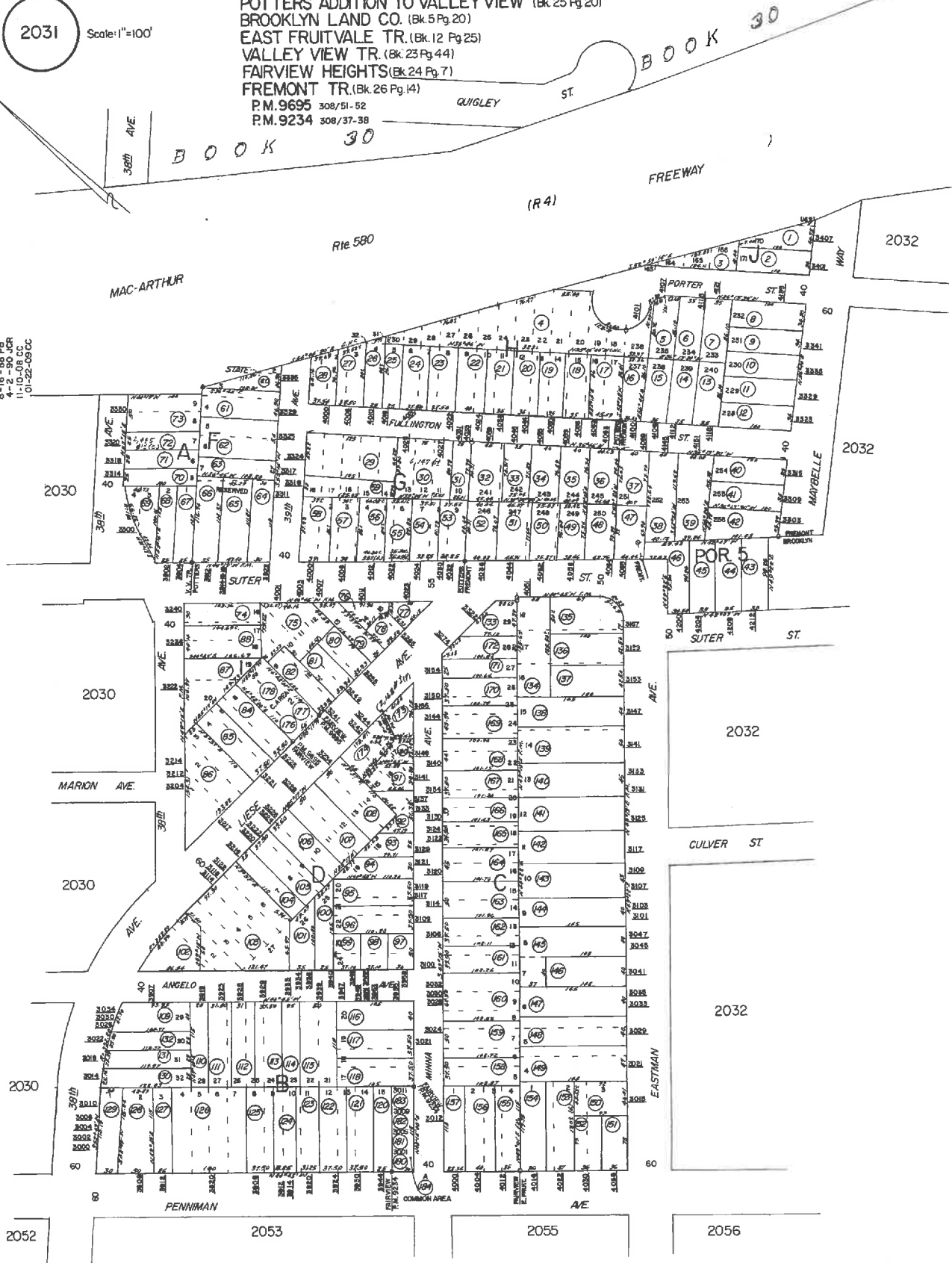



COUNTY OF ALAMEDA  
**Assessor's Office**  
**Property Value System**

[Help](#)

[New Query](#)

[History](#)

[Value](#)

[Transfer](#)

[Map](#)

[Glossary](#)

Parcel Number: **32-2031-126** Inactive: **N** Lien Date: **01/01/2016** Owner: **LAU KUEN C & KWAN SAR P**  
 Property Address: **3820 PENNIMAN AVE, OAKLAND, CA 94619-1759**

| Mailing Name              |                             | Historical Mailing Address                  | Document Date | Document Number | Value From Trans Tax | Parcel Count | Use                  |
|---------------------------|-----------------------------|---|---------------|-----------------|----------------------|--------------|----------------------|
| LAU KUEN C & KWAN SAR P   | <a href="#">List Owners</a> | 3701 LAKESHORE AVE , OAKLAND, CA 94610-1726 | 06/12/1989    | 1989-156256     | \$195,000            | 1            | <a href="#">4100</a> |
| BIRCH SHARON K            | <a href="#">List Owners</a> | 7373 SKYLINE BLVD , OAKLAND, CA 94611-1121  | 10/10/1986    | 1986-249693     |                      | 1            | <a href="#">4100</a> |
| MCCURDY JON & SHARON K    | <a href="#">List Owners</a> | 7373 SKYLINE BLVD , OAKLAND, CA 94611-1121  | 08/25/1981    | 1981-144216     | \$155,500            | 1            | <a href="#">4100</a> |
| LITTLEPAGE JAMES & YVONNE | <a href="#">List Owners</a> | 3820 PENNIMAN AVE , OAKLAND, CA 94619-1759  | 09/19/1978    | 1978-180936     | \$41,000             | 1            | <a href="#">4100</a> |
| MACDONALD JOHN A + L      | <a href="#">List Owners</a> | 3820 PENNIMAN AVE , OAKLAND, CA 94619-1759  | 03/01/1969    | TRAN-32560      |                      | 1            | <a href="#">4100</a> |

All information on this site is to be assumed accurate for property assessment purposes only, and is based upon the Assessor's knowledge of each property. Caution is advised for use other than its intended purpose.

The Alameda County Intranet site is best viewed in Internet Explorer Version 5.5 or later.  
 Click [here](#) for more information regarding supported browsers.

Copyright © 2001 Alameda County