

ALAMEDA COUNTY
DEPARTMENT OF ENVIRONMENTAL HEALTH
1131 HARBOR BAY PARKWAY
ALAMEDA, CA 94502-6577
PHONE (510) 567-6700

CC 8323
AN 349079
IN 197079

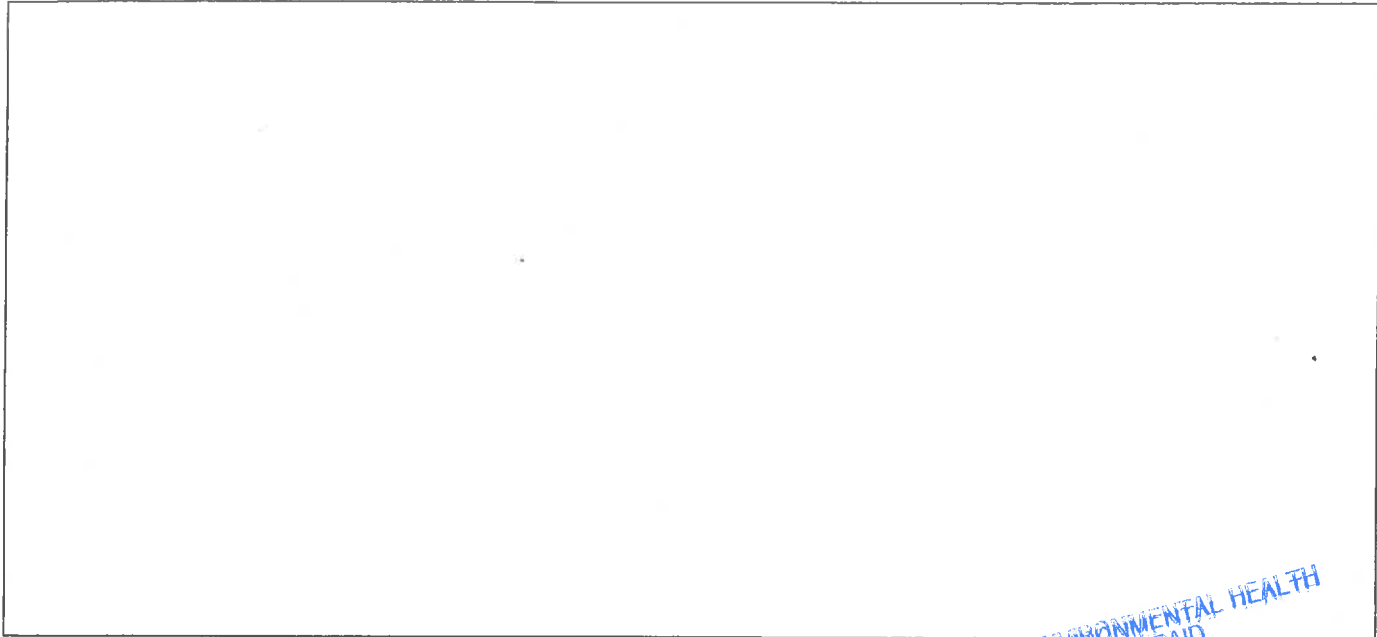

ENVIRONMENTAL HEALTH
PAID

UNDERGROUND STORAGE TANK CLOSURE PLAN
*** Complete closure plan according to instructions *** NOV 17 2015

- Name of Business Madison Park
Business Owner or Contact Person (PRINT) Bob Huff
- Site Address 3900 Adeline Street
City, State Emeryville Zip 94608 Phone (510)452-2944
- Mailing Address 155 Grand Ave., Suite 1025
City, State Oakland, CA Zip 94612 Phone (510)452-2944
- Property Owner Madison Park
Business Name (if applicable) Madison Park
Address 155 Grand Ave., Suite 1025
City, State Oakland, CA Zip 94612 Phone (510)452-2944
- Generator name under which tank will be manifested
Madison Park
EPA I.D. No. under which tank(s) will be manifested CAC002837870



IN0197079

**Alameda County
Department of Environmental Health**

1131 Harbor Bay Parkway - Alameda, CA 94502 - (510) 567-6858
Website: www.acgov.org/aceh

PAYMENT RECEIPT

Invoice No.: IN0197079
Account No.: AR0349079

RECEIPT #: RP0057681
Print Date: 11/17/2015
Payment Type: CHECK

Invoice Date	Program/Element	Description	Amount
11/17/15	4124	UST SYSTEM CLOSURE	\$ 1,678.00
11/17/15	9999	PAYMENT (CREDIT)	\$ -1,678.00
INVOICE BALANCE DUE:			\$ <u>0.00</u>

To insure an available fund balance, a 14-calendar-day hold will be placed on all checks prior to issuing a permit.

Health permit fees are non-refundable and are non-transferrable to new owners or new locations. In addition, there will be no proration of health permit fees.

Payer's Name: CK 8323 P & D ENVIRONMENTAL
Receipt Issued By: BRYANT, FORREST

Issued Date: 11/17/2015

SITE SAFETY PLAN

A. GENERAL INFORMATIONSITE: 3900 Adeline StreetLOCATION: 3900 Adeline Street, Emeryville, CA 94608PLAN PREPARED BY: Jay Miller DATE: 11/17/2015PLAN APPROVED BY: Paul M. King DATE: 11/17/2015PROPOSED DATE OF INVESTIGATION: TBDBACKGROUND REVIEW: Complete: Preliminary: XDOCUMENTATION/SUMMARY: OVERALL HAZARD: Serious: Moderate:
Low: X Unknown: XB. SITE/WASTE CHARACTERISTICSWASTE TYPE(S): Liquid: X Solid: X Sludge: X Gas: CHARACTERISTIC(S): Corrosive: Ignitable: X Radioactive:
Volatile: X Toxic: X Reactive: Unknown: X Other (Name):

FACILITY DESCRIPTION:

Principle Disposal Method (Type and Location): Liquid has already been pumped from UST and stored in drums. Excavated soil to be placed in a bin on site, pending analytical results. UST to be loaded onto a hazardous waste hauler vehicle and removed to a facility to be cleaned and destroyed, or will be cleaned at the site and removed from the site as scrap metal with the rineseate removed as hazardous waste.

Unusual Features (Power Lines, Terrain, Utilities, Etc.) Power and telephone lines on south side of street. EBMUD water mains traverse over the UST. Other utilities as noted by USA markings.

STATUS: Active: X Inactive: Unknown: HISTORY (Agency Action, Complaints, Injuries, Etc.): None

C. HAZARD EVALUATION

PARAMETER: TLV IDLH LEL HEALTH
 (ppm) (ppm) (%) skin eyes inge inha

See attached MSDS and ATSDR ToxFAQs Sheets for fuel oil.

SPECIAL PRECAUTIONS AND COMMENTS:

Wear eye protection and gloves. Ask smokers to extinguish cigarettes promptly.
No Smoking! WEAR SAFETY GLASSES AND GLOVES WHEN HANDLING DRY
ICE. DO NOT STAND BENEATH UST WHEN UST IS LIFTED OUT OF THE
GROUND OR LOADED ONTO THE TRUCK. NO PERSONNEL PERMITTED IN UST
PIT THAT IS DEEPER THAN 5 FEET DEEP WITHOUT APPROVED SHORING,
SLOPING OR BENCHING OF PIT WALLS. FENCE OR BARRIER TO BE PLACED
AROUND UST PIT AFTER UST REMOVAL UNTIL UST PIT IS BACKFILLED.

D. SITE SAFETY WORKPLAN

DOCUMENTATION: All site workers shall provide documentation that they have received the appropriate OSHA approved training and participate in appropriate medical surveillance in accordance with 29 CFR 1910.120.

PERIMETER ESTABLISHMENT: Map/Sketch Attached: X Site Secured: X

Perimeter Identified: X Zone(s) of Contamination Identified:

See attached Site Plan.

PERSONAL PROTECTION:

Level of Protection: A: B: C: D: X

Modifications: Be prepared for Level C (organic vapors) if necessary

Surveillance Equipment and Materials:

Instrument	Action Level
PID	300 ppm

SITE PROCEDURES: Excavate UST, inert UST atmosphere using dry ice. Verify UST atmosphere is less than 10% LEL and less than 10% oxygen. Collect soil samples, and collect groundwater sample if groundwater is present in excavation.

DECONTAMINATION PROCEDURES:

Personal: Soap and water wash, clean water rinse.

Equipment: Decontaminate with Alconox, clean water rinse, or steam clean.

FIRST AID: In Command Post at the site.

WORK LIMITATIONS (Time of Day, Weather, Heat/Cold Stress): 7:00 AM to 6:00 PM.

INVESTIGATION-DERIVED MATERIAL DISPOSAL: To be stockpiled at site pending appropriate disposal.

TEAM COMPOSITION:

Team Member	Responsibility
Paul King	Observation and sample collection
Michael Deschenes	Observation and sample collection
Jay Miller	Observation and sample collection

E. EMERGENCY INFORMATION

LOCAL RESOURCES:

Ambulance: 911
 (Summit Medical Center)
 Hospital: (510) 655-4 (Main number)
 370 Hawthorne Ave, Oakland, CA 94609
 Poison Control Center: 911
 Police: 911
 Fire Department: 911
 Explosives Unit: 911
 Agency Contact: None

SITE RESOURCES:

Water Supply: Yes
 Telephone: None
 Radio: None
 Other: None

EMERGENCY CONTACT:

Name: Sergio Marquee Phone Number: (916) 597-8610

EMERGENCY ROUTES: (Give road or other directions; attach map)

Hospital: See attached map.

SITE SKETCH: (Work Zones, Command Post, Etc.) See attached Site Sketch.

Truck at the site is the command post.

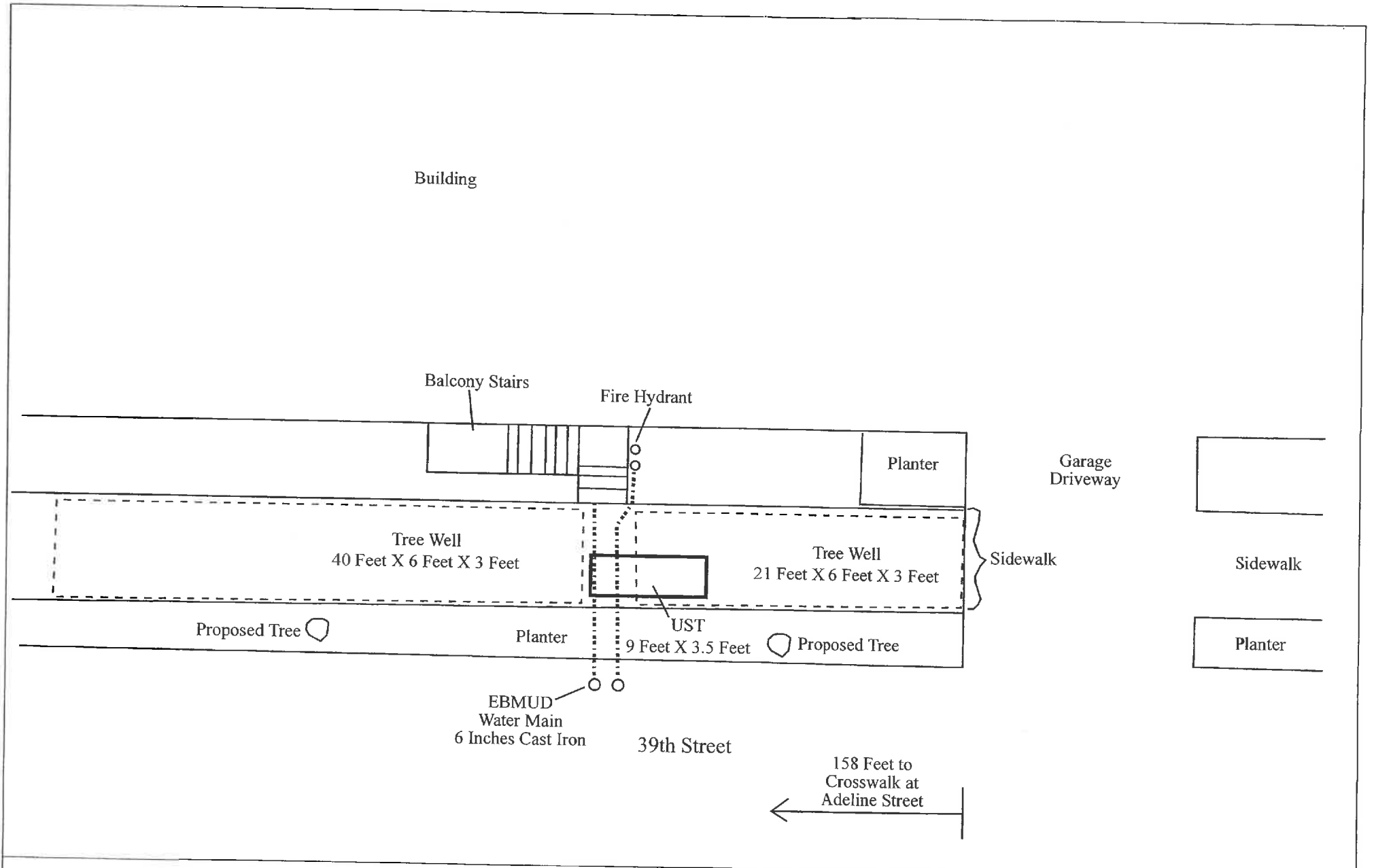
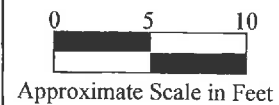

Figure
Site Plan Detail
3900 Adeline Street
Emeryville, California

Base Map from:
P&D Environmental using a steel tape and a rolatape,
November 17, 2015

P&D Environmental, Inc.
55 Santa Clara Ave., Suite 240
Oakland, CA 94610



YOUR TRIP TO:

Summit Medical Center, 370 Hawthorne Ave, Oakland, CA 94609



5 MIN | 1.4 MI

Trip time based on traffic conditions as of 6:55 PM on November 16, 2015. Current Traffic: Heavy

 Start out going **south** on **Adeline St** toward **39th St**.

Then 0.05 miles

 Turn **slight left** onto **San Pablo Ave/CA-123**.
San Pablo Ave is just past 39th St.

Retro at Home is on the corner.

If you are on Adeline St and reach W MacArthur Blvd you've gone a little too far.

Then 0.03 miles

 Take the 1st **left** onto **W MacArthur Blvd**.
Lanesplitter Pub & Pizza is on the corner.

If you are on San Pablo Ave and reach 37th St you've gone a little too far.

Then 0.78 miles

 Turn **right** onto **Telegraph Ave**.
Telegraph Ave is just past 37th St.

Lucky Florists is on the right.

If you reach Latimer Pl you've gone about 0.1 miles too far.

Then 0.35 miles

 Turn **left** onto **Hawthorne Ave**.
Hawthorne Ave is just past 33rd St.

If you reach 32nd St you've gone a little too far.

Then 0.17 miles

 Summit Medical Center, **370 HAWTHORNE AVE** is on the **left**.
Your destination is just past Summit St.

If you reach Webster St you've gone a little too far.

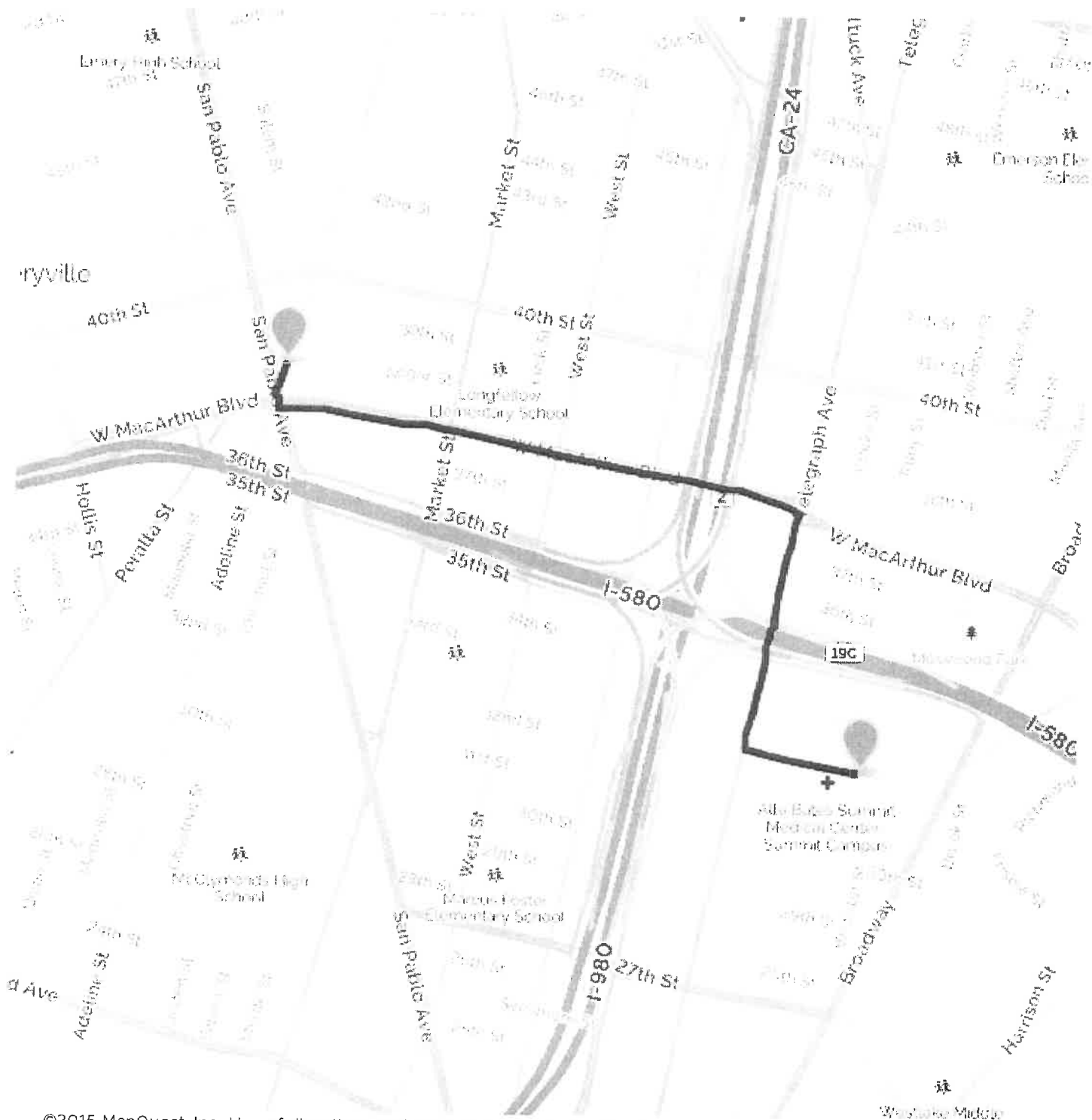

©2015 MapQuest, Inc. Use of directions and maps is subject to the MapQuest Terms of Use. We make no guarantee of the accuracy of their content, road conditions or route usability. You assume all risk of use. View Terms of Use (<http://hello.mapquest.com/terms-of-use>).

COUNTY OF ALAMEDA UNDERGROUND TANK SYSTEM CLOSURE INSPECTION REPORT

For Use By the County of Alameda, Environmental Health

SR0028988

Facility Name: Madison Park Contractor's name: P&D Associates/Patriot Environmental Services
 Address: 3900 Adeline Street City: Emeryville Zip: 94608

Project Contact: Paul King Phone No.: 510-658-6916

Tank ID No.	1				
Size	575 GALLONS				
Construction Material	steel				
Single/Double Wall	SW				
Backfill Type	native				
Oxygen <10%	11%				
LEL <10%	4%				
Tank Condition	3.5 x 9 ' tank with one hole in the side approx. 3/4 inch diameter and halfway down. Second hole in bottom and at the end near the seam.				
Soil/Groundwater Condition	Soil next to and immediately below tank appeared black but was brown and no odor at 9 feet. No groundwater encountered.				
Soil Sample Depth	9 ft bgs				
Number and Description of Soil/Groundwater Samples (Indicate Sample Locations on Site Plan.)	T-1-9.0 soil sample collected from tank pit center. PID = 0.0 Top 3 feet of overburden placed in container and analyzed.		Discolored soil from below top 3 feet will be sampled and analyzed for disposal.		

Disposition of Tank Contents: ECI **Piping:** Rinsed/Tested/Capped. **Rinsate:** Shipped on Manifest.
Tank & Piping Transport: Shipped on Manifest; Transporter Name Same as on Application.
Sampling: Evidence Tape; Chain of Custody; Samples Refrigerated; Piping Samples Taken Yes, No (If no, explain why in Comments.)
Soil: Soil Stored on Bermed Plastic & Covered; Soil Returned to Excavation. **Site Plan:** Attached.

Comments/Special Conditions: No piping observed. Bonnie Terra on-site to approve tank removal. Patriot performing work and PD & Associates. Tank believed to have held heating oil.

Inspector: Barbara Jakub Agency: ACDEH Date: 11/25/15 Start Time: 1:00 Stop Time: 2:30

Signature of Contractor/Authorized Agent: _____ Date: _____ Page _____ of _____