

**WEST**  
**ASSOCIATES**  
ENVIRONMENTAL ENGINEERS, INC

July 21, 1999

Alameda County Health Care Services Agency  
Department of Environmental Health  
1131 Harbor Bay Parkway, Suite 250  
Alameda, CA 94502-6577  
Attn: Mr. Larry Seto

**SUBJECT: RESULTS OF ADDITIONAL SITE CHARACTERIZATION,  
WEYERHAEUSER PAPER COMPANY, ALAMEDA CORRUGATED BOX FACILITY,  
1801 HIBBARD STR., STID 1202**

Dear Mr. Seto,

As you requested in your recent correspondence, West & Associates Environmental Engineers, Inc. has conducted further characterization of contaminated soil left in place under the main plant building at the Weyerhaeuser Paper Company, Alameda Corrugated Box Facility.

On July 16, 1999 two soil borings, B-9 and B-10, were drilled on the south side of the building foundation near SB-1 and SB-2. The locations of borings B-9 and B-10 are presented on the attached site diagram. Soil boring logs along with soil and groundwater laboratory chemical analysis results are also attached. We hope this information assists you in your efforts to close the site.

If you have any questions please contact me at (707) 451-1360.

Sincerely,

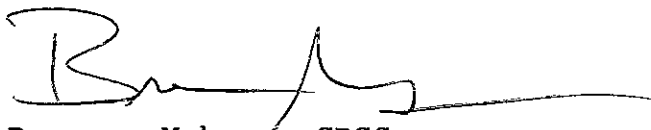

Brennan Mahoney CPSS  
Project Manager  
West & Associates Environmental Engineers, Inc.

ENVIRONMENTAL  
PROTECTION  
99 JUL 23 PM 4:00

Attached: Site Diagram  
Soil Boring Logs  
Laboratory Analytical Results

cc: James E. McCourt, Weyerhaeuser Office of the Environment, Tacoma





**EXCEL CHEM  
ENVIRONMENTAL LABS**

500 Giuseppe Court, Suite 9  
Roseville, CA 95678  
Phone#: (916) 773-3664 Fax#: (916) 773-4784



ANALYSIS REPORT

Attention: Brian West  
West & Associates  
P.O. Box 5891  
Vacaville, CA 95696  
Project: Weyerhaeuser, Alameda  
Method: EPA 8015m/8020/602

Date Sampled: 07/16/99  
Date Received: 07/19/99  
BTEX/TPHg Analyzed: 07/19/20/99  
Matrix: Soil/ Water  
Units: mg/kg (soil)  
          µg/l (water)

Client Sample I.D.	B9-8		B10-8		B-9		B-10	
LAB. NO	S0799209		S0799210		W0799211		W0799212	
ANALYTE	R/L	Results	R/L	Results	R/L	Results	R/L	Results
TPH as Gasoline	8.34	11.5	1.00	1.96	50	392	200	4520

ND = Not detected. Compound(s) may be present at concentrations below the reporting limit.  
R/L = Reporting Limit

  
Laboratory Representative

07/20/99  
Date Reported

# EXCELICHEM ENVIRONMENTAL LABS

500 Giuseppe Court, Suite 9  
Roseville, CA 95678  
Phone#: (916) 773-3664 Fax#: (916) 773-4784

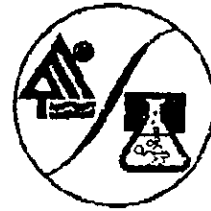

## ANALYSIS REPORT

Attention: Brian West  
West & Associates  
P.O. Box 5891  
Vacaville, CA 95696  
Project: Weyerhaeuser, Alameda  
Method: EPA 8240.624 by 8260

Date Sampled: 07/16/99  
Date Received: 07/19/99  
Date Analyzed: 07/19/99  
Matrix: Soil/ Water  
Units: mg/kg (soil)  
          µg/L (water)

Client Sample I.D.	B9-8		B10-8		B-9		B-10	
	R/L	Results	R/L	Results	R/L	Results	R/L	Results
LAB. NO.	S0799209		S0799210		W0799211		W0799212	
Dichlorodifluoromethane	0.005	ND	0.005	ND	0.5	ND	0.5	ND
Chloromethane	0.005	ND	0.005	ND	0.5	ND	0.5	ND
Vinyl Chloride	0.005	ND	0.005	ND	0.5	ND	0.5	ND
Bromomethane	0.005	ND	0.005	ND	0.5	ND	0.5	ND
Chloroethane	0.005	ND	0.005	ND	0.5	ND	0.5	ND
Trichlorofluoromethane	0.005	ND	0.005	ND	0.5	ND	0.5	ND
Acetone	0.005	ND	0.005	ND	0.5	ND	0.5	ND
1,1-Dichloroethene	0.005	ND	0.005	ND	0.5	0.6	0.5	ND
Methylene Chloride	0.015	ND	0.015	ND	5.0	ND	5.0	ND
Carbon disulfide	0.005	ND	0.005	ND	0.5	ND	0.5	ND
Trans-1,2-Dichloroethene	0.005	ND	0.005	ND	0.5	ND	0.5	ND
1,1-Dichloroethane	0.005	ND	0.005	ND	0.5	34.7	0.5	6.1
Chloroform	0.005	ND	0.005	ND	0.5	ND	0.5	ND
1,2-Dichloroethane	0.005	ND	0.005	ND	0.5	3.2	0.5	ND
Iodomethane	0.005	ND	0.005	ND	0.5	ND	0.5	ND
Dibromochloromethane	0.005	ND	0.005	ND	0.5	ND	0.5	ND
1,1,1-Trichloroethane	0.005	ND	0.005	ND	0.5	ND	0.5	ND
Carbon tetrachloride	0.005	ND	0.005	ND	0.5	ND	0.5	ND
Benzene	0.005	0.005	0.005	ND	0.5	3.8	0.5	13.7
Trichloroethene	0.005	ND	0.005	ND	0.5	2.2	0.5	ND
1,2-Dichloropropane	0.005	ND	0.005	ND	0.5	ND	0.5	ND
2-Butanone	0.005	ND	0.005	ND	0.5	ND	0.5	ND
Bromodichloromethane	0.005	ND	0.005	ND	0.5	ND	0.5	ND
Cis-1,3-dichloropropene	0.005	ND	0.005	ND	0.5	ND	0.5	ND
Trans-1,3-dichloropropene	0.005	ND	0.005	ND	0.5	ND	0.5	ND
1,1,2-Trichloroethane	0.005	ND	0.005	ND	0.5	1.7	0.5	ND
Toluene	0.005	ND	0.005	ND	0.5	ND	0.5	3.8
Tetrachloroethene	0.005	ND	0.005	ND	0.5	ND	0.5	ND
Chlorobenzene	0.005	ND	0.005	ND	0.5	ND	0.5	ND
Ethylbenzene	0.005	0.071	0.005	0.049	0.5	1.2	0.5	22.3
M+P-xylene	0.005	0.009	0.005	ND	0.5	ND	0.5	3.0

EXCELICHEM ENVIRONMENTAL LABS IS CERTIFIED BY THE STATE OF CALIFORNIA  
DEPARTMENT OF HEALTH SERVICES AS A HAZARDOUS WASTE TESTING LABORATORY  
(Certification No. 2119)

**EXCEL CHEM  
ENVIRONMENTAL LABS**

500 Giuseppe Court, Suite 9  
Roseville, CA 95678  
Phone#: (916) 773-3664 Fax#: (916) 773-4784



ANALYSIS REPORT

Attention: Brian West  
West & Associates  
P.O. Box 5851  
Vacaville, CA 95696  
Project: Weyerhaeuser, Alameda  
Method: EPA 8240/624 by 8260

Date Sampled: 07/16/99  
Date Received: 07/19/99  
Date Analyzed: 07/19/99  
Matrix: Soil/ Water  
Units: mg/kg (soil)  
µg/L (water)

Client Sample I.D.	B9-8		B10-8		B-9		B-10	
LAB. NO.	S0799209		S0799210		W0799211		W0799212	
ANALYTE	R/L	Results	R/L	Results	R/L	Results	R/L	Results
O-xylene	0.005	ND	0.005	ND	0.5	ND	0.5	ND
Styrene	0.005	ND	0.005	ND	0.5	ND	0.5	ND
Bromofonn	0.005	ND	0.005	ND	0.5	ND	0.5	ND
1,1,2,2-Tetrachloroethane	0.005	ND	0.005	ND	0.5	ND	0.5	ND
1,3-Dichlorobenzene	0.005	ND	0.005	ND	0.5	ND	0.5	ND
1,4-Dichlorobenzene	0.005	ND	0.005	ND	0.5	ND	0.5	ND
1,2-Dichlorobenzene	0.005	ND	0.005	ND	0.5	ND	0.5	ND
<b>SURROGATE %RECOVERY</b>								
Dibromofluoromethane	106		94		111		104	
Toluene-d8	98		96		96		97	
4-Bromofluorobenzene	99		96		89		94	

QA/QC %RECOVERY (SOIL)			
	LCS	LCSD	Date Analyzed
1,1-Dichloroethene	101	101	07/19/99
Benzene	99	97	07/19/99
Trichloroethene	99	102	07/19/99
Toluene	94	93	07/19/99
Chlorobenzene	96	94	07/19/99

QA/QC %RECOVERY (WATER)			
	LCS	LCSD	Date Analyzed
1,1-Dichloroethene	100	97	07/16/99
Benzene	99	94	07/16/99
Trichloroethene	93	97	07/16/99
Toluene	92	90	07/16/99
Chlorobenzene	95	94	07/16/99

ND = Not detected. Compound(s) may be present at concentrations below the reporting limit.  
R/L - Reporting Limit

  
Laboratory Representative

07/20/99  
Date Reported

WA 7/20

**Excelchem Environmental Labs**  
 500 Giuseppe Court, Suite 9  
 Roseville, CA 95678  
 (916) 773-3664

**CHAIN-OF-CUSTODY RECORD AND ANALYSIS REQUEST**

**Project Manager:** Brian West  
**Phone #:** 707-451-1360

**ANALYSIS REQUEST**

**TAT**

**Company/Address:** PO Box 5891, Vacaville 95696  
**FAX #:** 707-447-0631

**Project Number:** P.O.#: Project Name: Weyerhaeuser, Alameda

**Project Location:** 1801 Hibbard, Str., Alameda  
**Sampler Signature:**

Sample ID	Sampling		Container		Method Preserved				Matrix	
	DATE	TIME	VOA	SLEEVE	HCl	HNO3	ICE	NONE	WATER	SOIL
B9-8	7/16	AM		X						X
B10-8	7/16	AM		X						X
B-9	7/16	AM	4		X	X			X	
B-10	7/16	AM	4		X	X			X	

BTEX (602/8020)	BTEX/TPH as Gasoline (602/8020/6C16)	TPH as Diesel (8015)	TPH as Oil (8015)	Total Oil & Grease (5520 B/E, F)	Total Oil & Grease (15520 B/E, F, C)	96 - Hour Fish Bioassay	EPA 801/8010	EPA 602/8020	EPA 615/8150	EPA 608/8080 - Pesticides	EPA 608/8080-PCBs	EPA 624/8240	EPA 625/8270	ORGANIC LEAD	Reactivity, Corrosivity, Ignitibility	CAM - 17 Metals	EPA - Priority Pollutant Metals	LEAD (7420/7421/259.2)	Cd, Cr, Pb, Zn, Ni	RUSH - See Remarks	RUSH SERVICE (12 hr) or (24 hr)	EXPEDITED SERVICE (48 hr) or (1 wk)	STANDARD SERVICE (2wk)
X	50	199	209									X								X			
X			210									X								X			
X	100	799	211									X								X			
X			212									X								X			

Relinquished by: *Brian West* Date Time: 7-19-99 07:00  
 Received by: *Willie Guit*

Remarks: Results by 7/20/99  
 5:00 PM

Relinquished by: Date Time: Received by:

Relinquished by: *7/19/99 08:05* Date Time: Received by Laboratory: *Janeice Sanders*

Bill To:

**LEDGEND**

- ▲ Soil Boring
- ⊕ Monitoring Well
- Pit Sidewall or Bottom

**MAIN PLANT BUILDING**

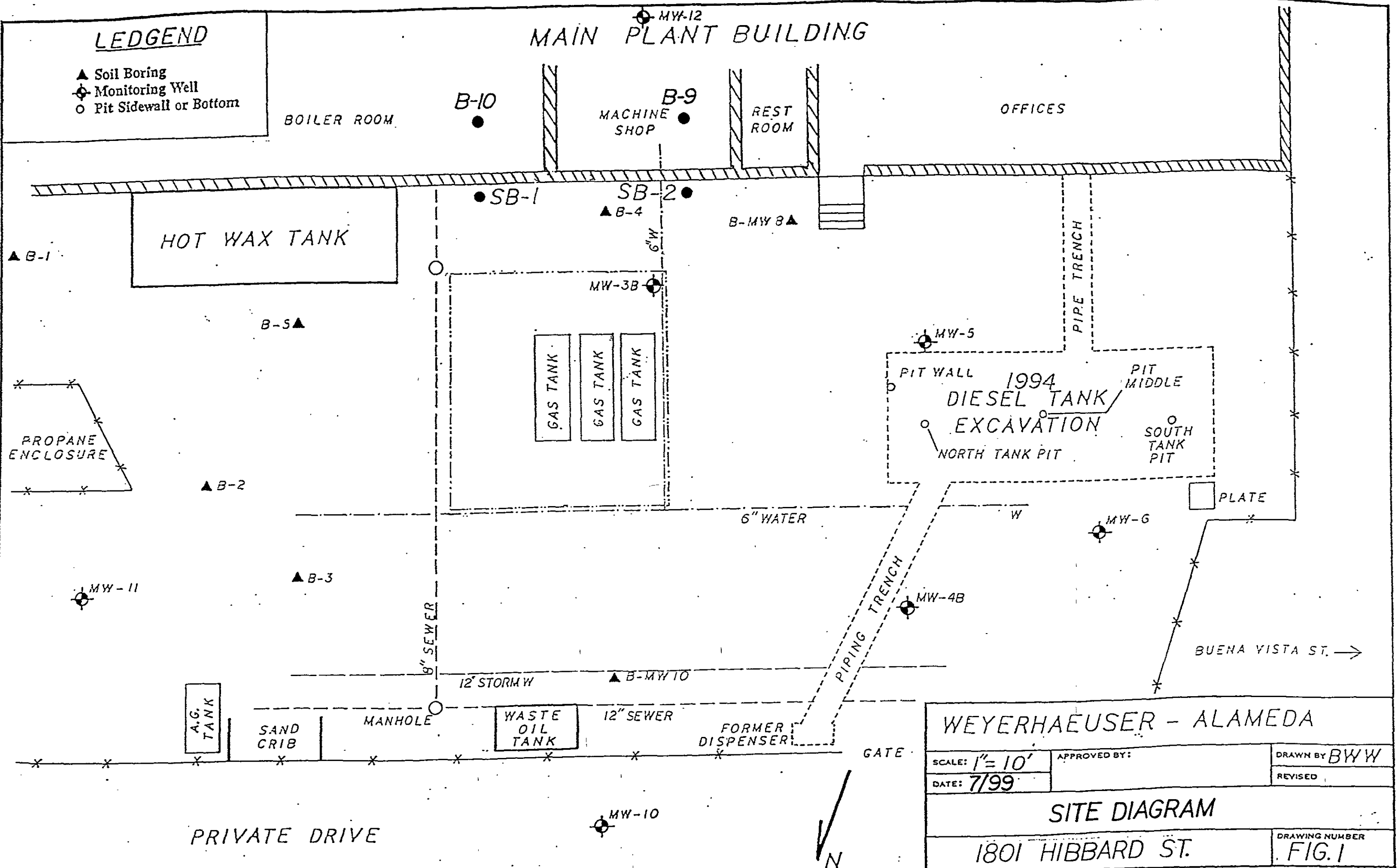

**WEYERHAEUSER - ALAMEDA**

SCALE: 1" = 10'  
 DATE: 7/99  
 APPROVED BY:  
 DRAWN BY: BWV  
 REVISED:

**SITE DIAGRAM**

1801 HIBBARD ST.

DRAWING NUMBER  
**FIG. 1**