



901 Broadway, Suite 101
Oakland, CA 94612-3023
Tel. 510.740.5800
Fax. 510.663.3315

October 15, 1999
Project 791669

Mrs. Eva Chu
Alameda County Health Care Services Agency
Department of Environmental Health
1131 Harbor Bay Parkway, 2nd Floor
Alameda, California 94502

Re: ARCO Service Station No. 6041, Located at 7249 Village Parkway, Dublin, California

Dear Mrs. Chu:

On behalf of ARCO Products Company (ARCO), Pinnacle Environmental Solutions, a member of The IT Group (Pinnacle), is providing this letter report detailing activities presented in Pinnacle's Workplan dated May 17, 1999.

Pinnacle performed the following:

1. Changed sampling intervals for monitoring wells MW-1 through MW-3 to semi-annually (1st and 3rd quarters).
2. Repaired well boxes for monitoring wells MW-4 and MW-6. The old well boxes were removed with a jackhammer and new G-5 Christy well boxes were installed to be slightly above grade. All other well boxes remain in good condition and slightly above grade.
3. Prepared a geologic cross-section across ARCO Service Station No. 6041 and the British Petroleum Station located on the southeast corner of Amador Valley Boulevard and Village Parkway. A site plan and geologic cross-section are presented as Figures 1 and 2, respectively. The trenches do not appear to be inundated by groundwater, and therefore, do not represent a viable conduit for transport of dissolved hydrocarbon constituents.
4. Obtained underground utility as-built drawings from the City of Dublin and the Dublin-San Ramon Services District. These as-builts included locations for sanitary sewer, water main, and storm drain lines located off-site. Underground utility locations are provided on Figure 1 and are included on the cross section (Figure 2).

15:11 PM 81 100 66

NOTIFICATION
TELEPHONE UNIT

Mrs. Eva Chu
October 15, 1999
Page 2

Project 791669

If you have any questions about the work performed herein, please contact Glen VanderVeen at (510) 740-5807.

Sincerely,

Pinnacle

Mark Christian
Staff Geologist

Glen VanderVeen
Project Manager

Attachments: Figure 1 Site Plan
 Figure 2 Geologic Cross Section

cc: Mr. Paul Supple, Arco Products Company

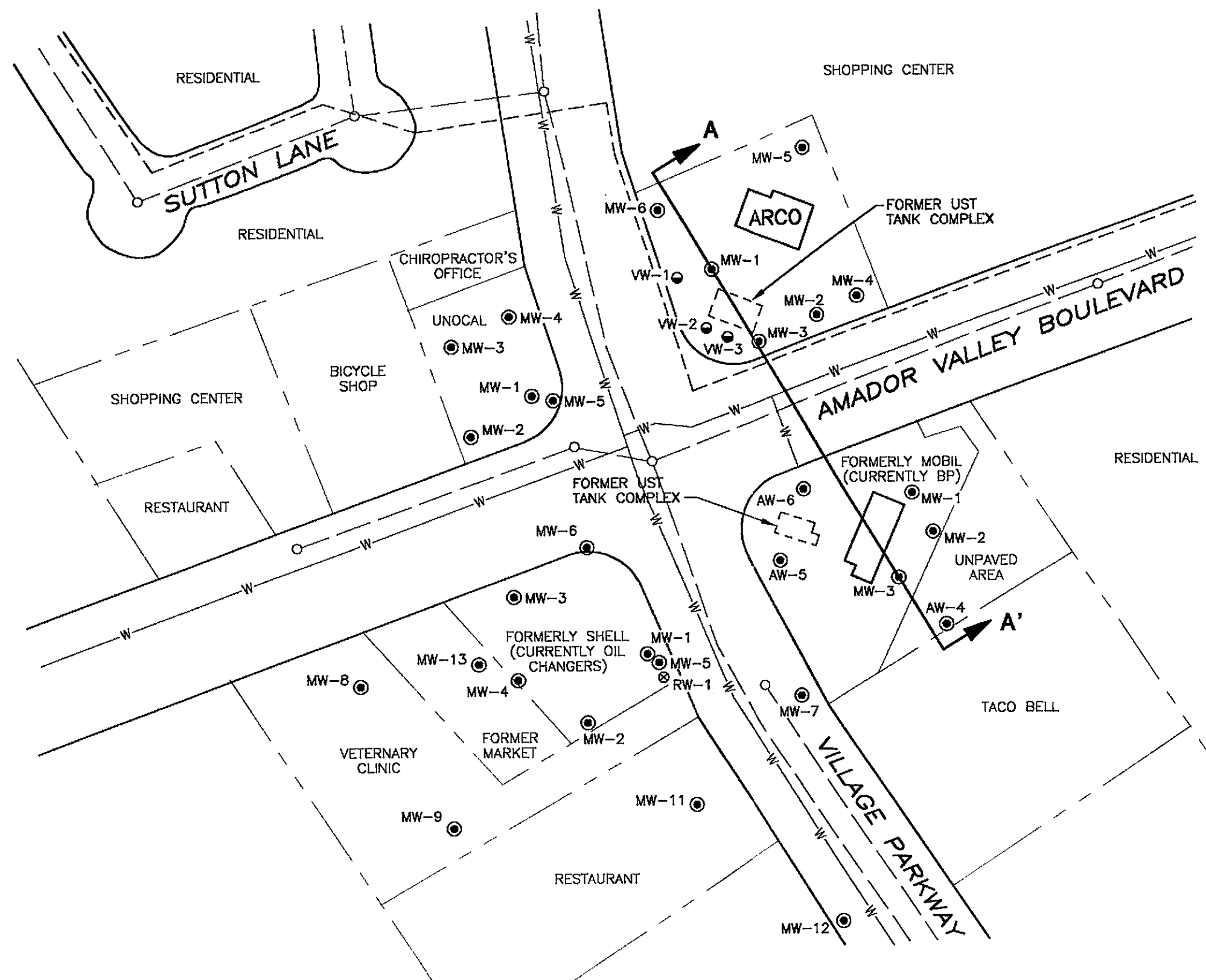

EXPLANATION	
	Groundwater monitoring well
	Vapor extraction well
	Recovery well
	Storm drain
	Sanitary sewer
	Water line
	Line of cross section



ARCO PRODUCTS COMPANY
 SERVICE STATION 6041

FIGURE 1
 SITE PLAN

7249 VILLAGE PARKWAY
 DUBLIN, CALIFORNIA

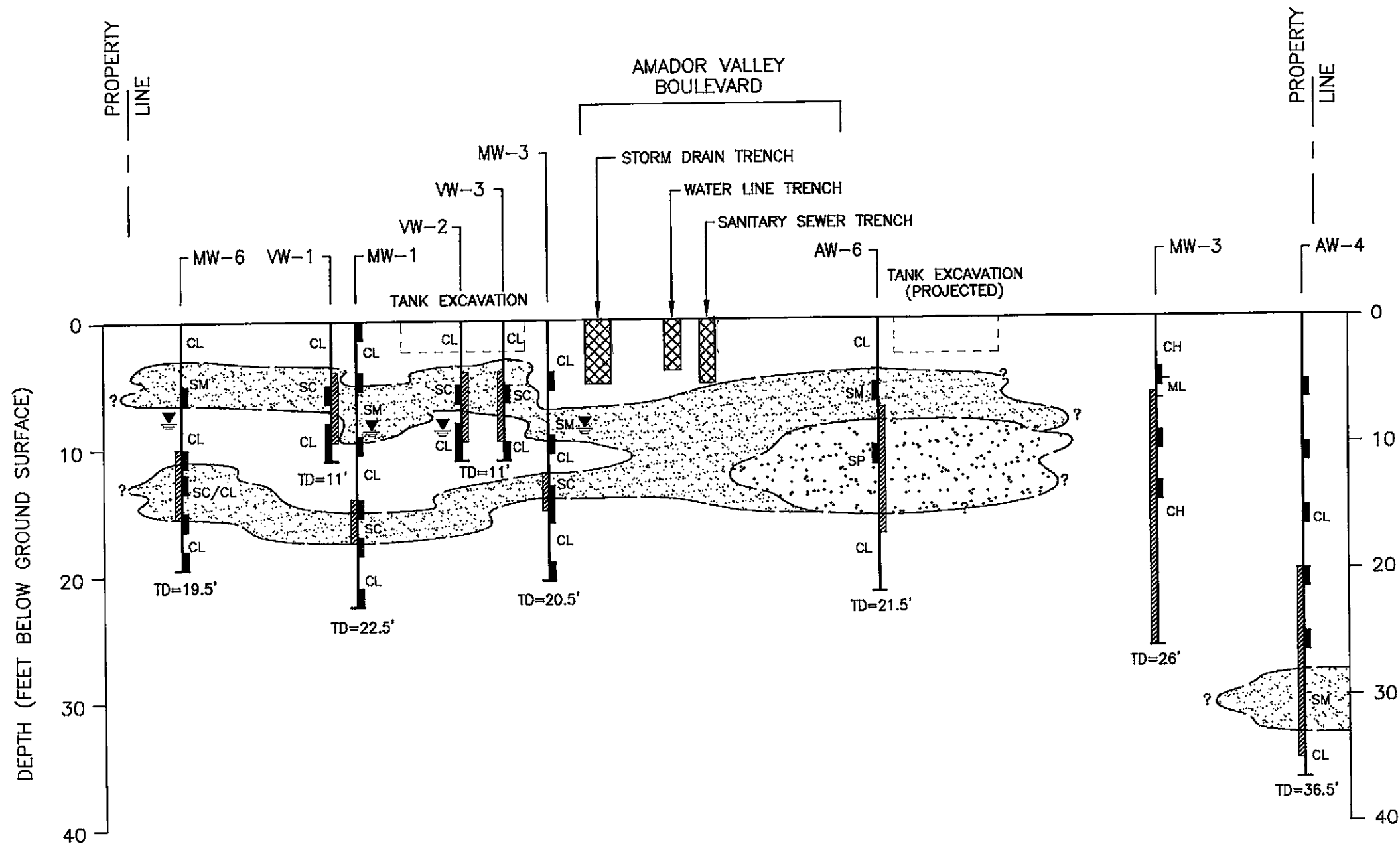

EXPLANATION

- CLAY AND SILT (CL, CH, ML)
- SAND WITH FINES (SC, SM)
- SAND (SP)
- Lithologic contact
- Boring/well designation
- Bore hole
- Sample interval
- Screened interval
- Static water level
- Total depth (feet)

NOTE: Depth to water measurements as of 2-17-99. Recent groundwater monitoring data was not available for all wells.

SCALE
 0 50 100 FEET
 (HORIZONTAL)



ARCO PRODUCTS COMPANY
 SERVICE STATION 6041

FIGURE 2
 CROSS SECTION A-A'

7249 VILLAGE PARKWAY
 DUBLIN, CALIFORNIA