

Detterman, Mark, Env. Health

From: Kevin Briggs [Kevin.Briggs@hayward-ca.gov]
Sent: Monday, June 20, 2011 4:42 PM
To: Detterman, Mark, Env. Health
Cc: Hector Leuterio
Subject: RE: Site plan for potential conflict regarding 238 Corridor improvement.

Mark,

The City has a major project along the former State Route 238 through Hayward. We're demolishing and reconstructing this median on Foothill. The existing well will be in the #1 (far left) lane under the new lane configuration. There is room in the new median for this well if you would like to relocate it. Let us know what option that you select.

Thanks,

Kevin
510.583.4760

From: Detterman, Mark, Env. Health [<mailto:Mark.Detterman@acgov.org>]
Sent: Monday, June 20, 2011 4:07 PM
To: Kevin Briggs
Subject: FW: Site plan for potential conflict regarding 238 Corridor improvement.

Kevin,

I'm in the Alameda County LOP group overseeing environmental investigations. I just received this email in regards to well MW-10 on Foothill Blvd, in the central median. Will the median be totally eliminated? (Will the well need to be destroyed or could it remain in a new median?). What do you mean by "relocated"? It's probably not a critical well, but I'm just looking at options.

Thanks,

Mark Detterman
Senior Hazardous Materials Specialist, PG, CEG
Alameda County Environmental Health
1131 Harbor Bay Parkway
Alameda, CA 94502
Direct: 510.567.6876
Fax: 510.337.9335
Email: mark.detterman@acgov.org

PDF copies of case files can be downloaded at:

<http://www.acgov.org/aceh/lop/ust.htm>

From: Lee, Nathan [<mailto:nlee@craworld.com>]
Sent: Monday, June 20, 2011 3:59 PM
To: Detterman, Mark, Env. Health
Cc: Patten, David R.
Subject: FW: Site plan for potential conflict regarding 238 Corridor improvement.

Mark,

See below for email from the City of Hayward request to destroy MW-10.

Nathan Lee, P.G.

Conestoga-Rovers & Associates (CRA)

5900 Hollis Street, Suite A
Emeryville, CA 94608

Phone: 510.420.3333

Fax: 510.420.9170

Cell: 510.385.2499

Email: nlee@CRAworld.com

From: Kevin Briggs [<mailto:Kevin.Briggs@hayward-ca.gov>]

Sent: Monday, June 20, 2011 2:02 PM

To: Patterson, Sequoia; Lee, Nathan

Cc: Hector Leuterio

Subject: RE: Site plan for potential conflict regarding 238 Corridor improvement.

Sequoia,

To follow up our prior discussion on this well, the contractor has informed me that they would like the well relocated during July. Let me know when you will be able to schedule the work and if you need anything more from us in order to accomplish the work.

Kevin Briggs

510.583.4760

From: Patterson, Sequoia [<mailto:spatterson@croworld.com>]

Sent: Monday, February 28, 2011 4:33 PM

To: Kevin Briggs

Cc: Lee, Nathan

Subject: Site plan for potential conflict regarding 238 Corridor improvement.

Hello Kevin,

Here is the site plan for our site located at 21995 Foothill Boulevard. The well that may be in conflict is designated well MW-10, and is located at the top of the site plan. It is in the middle median of Foothill Boulevard.

Please let us know if this is in conflict with your planned improvement work. And if it is could you also provide us with a time frame when you think you will be working on that section?

Thanks for helping out with this.

Sequoia Patterson

Conestoga-Rovers & Associates (CRA)

5900 Hollis Street Suite A
Emeryville, CA 94608

Phone: 510.420.3305

Fax: 510.420.9170

Cell: 510.385.0085

Email: spatterson@CRAworld.com

www.CRAworld.com

Think before you print 

Perform every task the safe way, the right way, every time!



This communication and any accompanying document(s) are confidential and are intended for the sole use of the addressee. If you are not the intended recipient, please notify me at the telephone number shown above or by return e-mail and delete this e-mail and any copies. You are advised that any disclosure, copying, distribution, or the taking of any action in reliance upon the communication without consent is strictly prohibited. Thank you.

NOTES:

1. SEE SHEET U-1 FOR GENERAL NOTES.
2. RELOCATE EXISTING BOXES TO BACK OF NEW CURB.

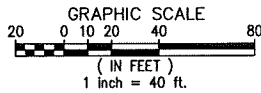
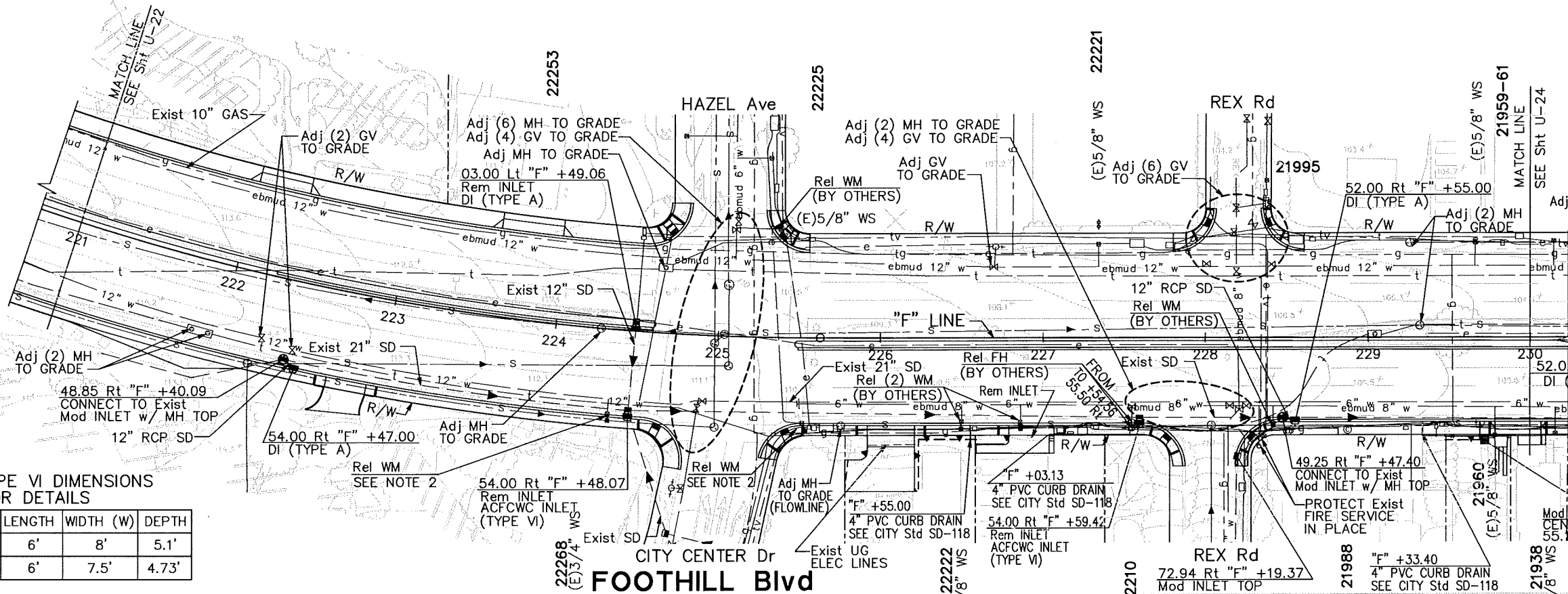

ACFCWC INLET TYPE VI DIMENSIONS
SEE Sht UD-3 FOR DETAILS

STATION & OFFSET	LENGTH	WIDTH (W)	DEPTH
"F" 224+48.07 54.00 Rt	6'	8'	5.1'
"F" 227+59.42 54.00 Rt	6'	7.5'	4.73'

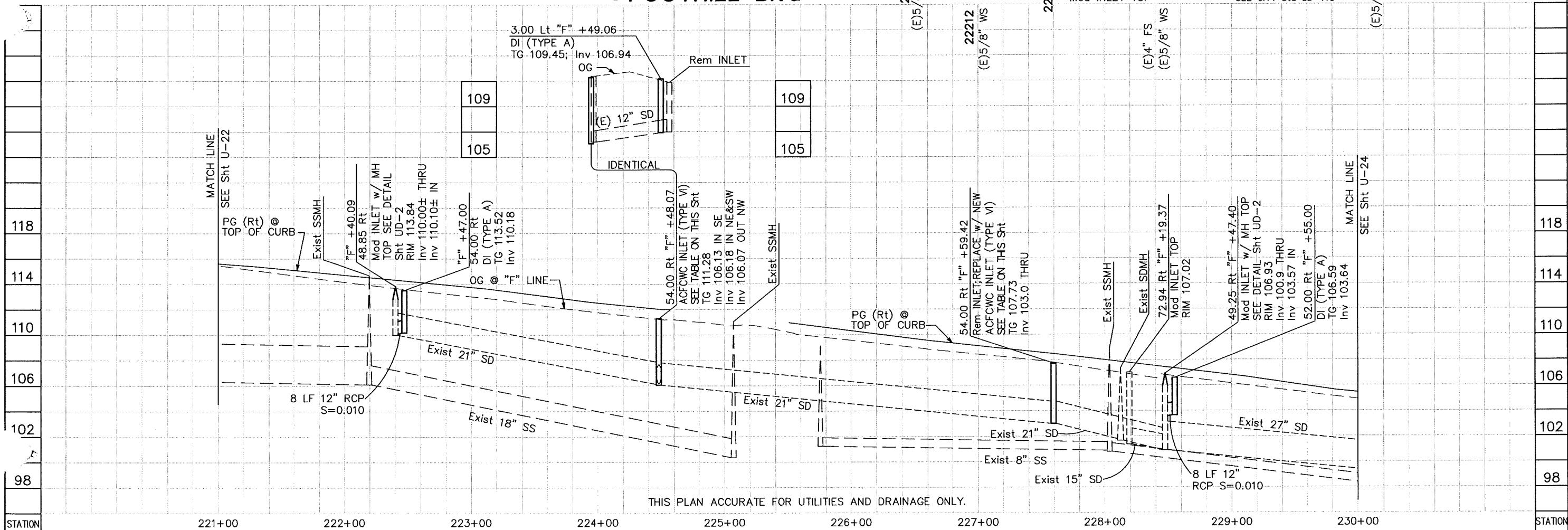

THIS PLAN ACCURATE FOR UTILITIES AND DRAINAGE ONLY.

ROUTE 238 CORRIDOR IMPROVEMENT PROJECT
UTILITY/DRAINAGE PLAN
FOOTHILL BOULEVARD
Sta. 221+00 to Sta. 230+00

CITY OF HAYWARD
DEPARTMENT OF PUBLIC WORKS
ENGINEERING DIVISION

DESIGNED BY: R. A. BAUMAN
CHECKED BY: MORAD FAKHRAI
APPROVED BY: MORAD FAKHRAI
DATE: 4-20-10
PROJ. NO.: 5117

SCALE: 1"=40' H
1"=4' V
SHEET NO. 703
TOTAL SHEETS 703
FILE NO.: E-1935
U-23

PROFESSIONAL ENGINEER
DAVID E. MELIS
No. 54383
Exp. 12/31/11
CIVIL
STATE OF CALIFORNIA

David E. Melis
DAVID E. MELIS
R.C.E. 54383
DATE 4-20-10

MARK THOMAS & COMPANY, INC.
Providing Engineering, Surveying, and Planning Services
5000 Hopwood Road, Suite 315
Pleasanton, CA 94588 925/417-8000