

K0-366



2000 Crow Canyon Place  
Suite 400  
San Ramon, CA 94583

Phone: (925) 277-2305  
Fax: (925) 277-2361

Environmental Department

September 30, 2003

Re: Tosco (Unocal) Service Station #3292  
15008 East 14<sup>th</sup> Street  
San Leandro, California

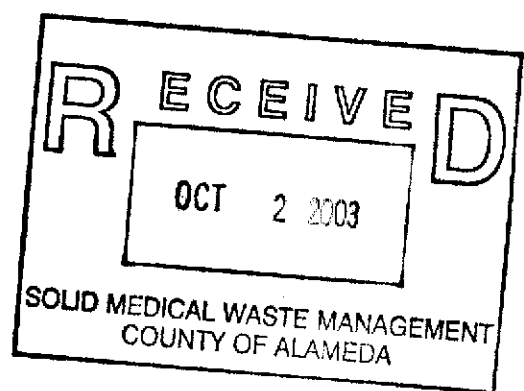

" I declare under penalty of perjury, that to the best of my knowledge at the present time, that the information and/or recommendations contained in the attached proposal or report is true and correct"

*David B. DeWitt*  
David B. DeWitt  
Site Manager  
ConocoPhillips



# GETTLER-RYAN INC.

## TRANSMITTAL

September 15, 2003  
G-R #180105

TO: Mr. David B. De Witt  
ConocoPhillips  
76 Broadway Avenue  
Sacramento, California 95818

CC: Mr. David Vossler  
Gettler-Ryan Inc.  
Petaluma, California

FROM: Deanna L. Harding  
Project Coordinator  
Gettler-Ryan Inc.  
6747 Sierra Court, Suite J  
Dublin, California 94568

RE: **Tosco (Unocal) Service Station  
#3292  
15008 East 14th Street  
San Leandro, California**

WE HAVE ENCLOSED THE FOLLOWING:

COPIES	DATED	DESCRIPTION
1	September 15, 2003	Groundwater Monitoring and Sampling Report Third Quarter - Event of August 11, 2003

### COMMENTS:

This report is being sent to you for your review/comment, prior to being distributed on your behalf. If no comments are received by **September 29, 2003**, this report will be distributed to the following:

cc: Ms. Eva Chu, Alameda County Health Care Services, 1131 Harbor Bay Parkway Alameda, CA 94501

Enclosure

trans/3292-dbd



# GETTLER - RYAN INC.

September 15, 2003  
G-R Job #180105

Mr. David B. De Witt  
ConocoPhillips  
76 Broadway Avenue  
Sacramento, California 95818

**RE: Third Quarter Event of August 11, 2003**  
Groundwater Monitoring & Sampling Report  
Tosco (Unocal) Service Station #3292  
15008 East 14th Street  
San Leandro, California

Dear Mr. De Witt:

This report documents the most recent groundwater monitoring and sampling event performed by Gettler-Ryan Inc. (G-R) at the referenced site. All field work was conducted in accordance with G-R Standard Operating Procedure - Groundwater Sampling (attached).

Static groundwater levels were measured and all wells were checked for the presence of separate-phase hydrocarbons. Separate-phase hydrocarbons were not present in the wells. Static water level data and groundwater elevations for the referenced site are summarized in Table 1 and Dissolved Oxygen Concentrations are summarized in Table 2. Joint Groundwater Monitoring Data from previous events are summarized in Tables 4 and 5. A Potentiometric Map is included as Figure 1.

Groundwater samples were collected from the monitoring wells and submitted to a state certified laboratory for analyses. The field data sheets for this event are attached. Analytical results are presented in the table(s) listed below. A Concentration Map is included as Figure 2. The chain of custody document and laboratory analytical report are also attached.

Sincerely,

Deanna L. Harding  
Project Coordinator

Robert C. Mallory  
Registered Geologist No. 7285

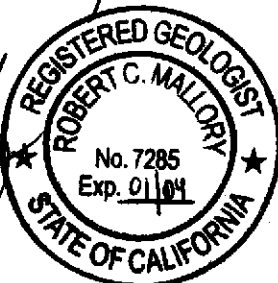

- Figure 1: Potentiometric Map
- Figure 2: Concentration Map
- Table 1: Groundwater Monitoring Data and Analytical Results
- Table 2: Dissolved Oxygen Concentrations
- Table 3: Groundwater Analytical Results - Oxygenate Compounds
- Table 4: Joint Groundwater Monitoring Data - Former Mobil Facility
- Table 5: Joint Groundwater Monitoring Data - Chevron Facility #9-2013
- Attachments: Standard Operating Procedure - Groundwater Sampling  
Field Data Sheets  
Chain of Custody Document and Laboratory Analytical Reports

3292.qml

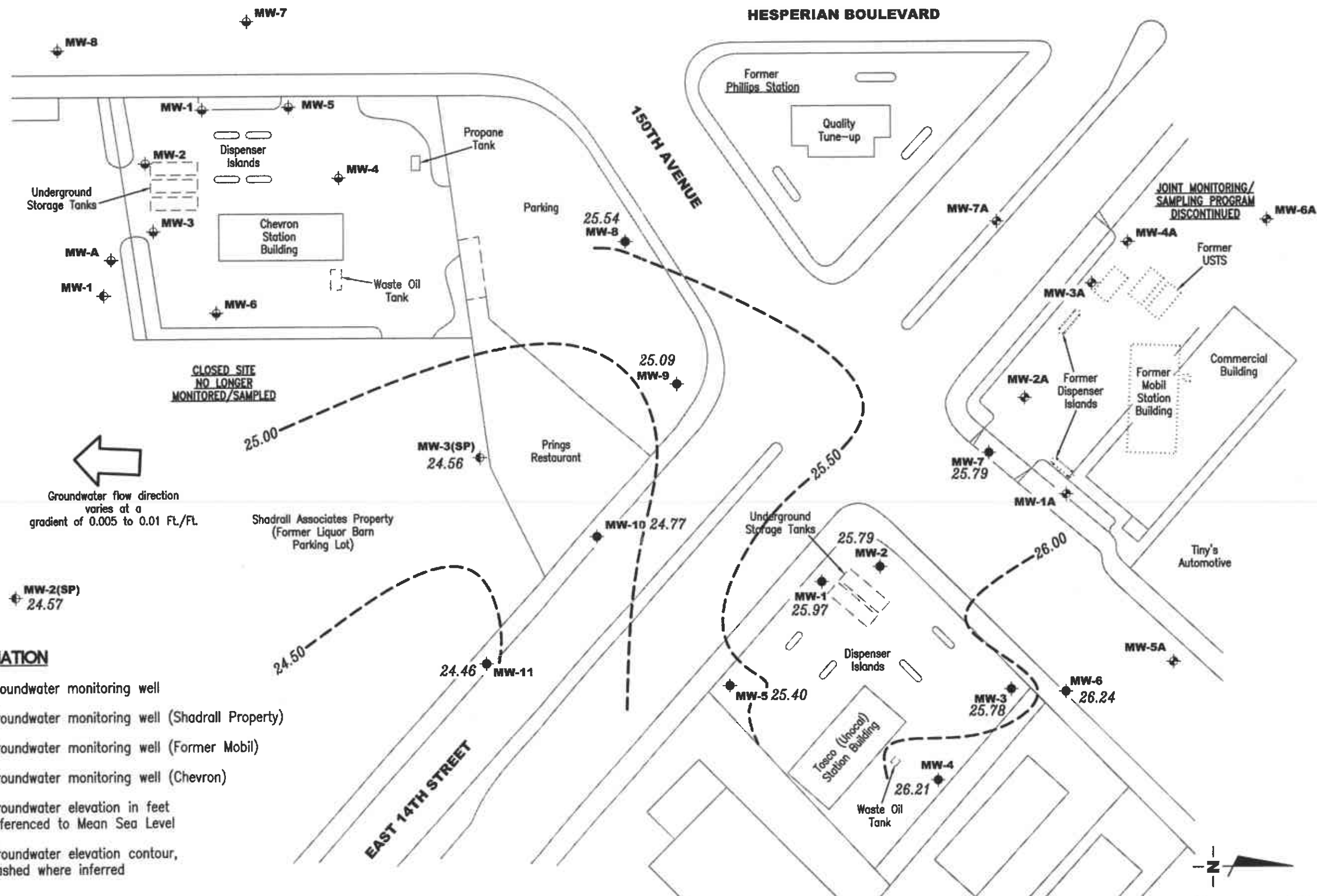

Groundwater flow direction varies at a gradient of 0.005 to 0.01 Ft./Ft.

CLOSED SITE  
NO LONGER  
MONITORED/SAMPLED

**EXPLANATION**

- ◆ Groundwater monitoring well
- ◆ Groundwater monitoring well (Shadrall Property)
- ◆ Groundwater monitoring well (Former Mobil)
- ◆ Groundwater monitoring well (Chevron)
- 99.99 Groundwater elevation in feet referenced to Mean Sea Level
- 99.99- Groundwater elevation contour, dashed where inferred

**POTENTIOMETRIC MAP**  
Tosco (Unocal) Service Station #3292  
15008 East 14th Street  
San Leandro, California

**GETTLER - RYAN INC.**  
6747 Sierra Ct., Suite J  
Dublin, CA 94568  
(925) 551-7555

DATE August 11, 2003  
REVISED DATE

REVIEWED BY  
JOB NUMBER 180105  
FILE NAME: P:\ENVIRO\CONDO\PHILLIPS-10560\3292\003-3292.DWG | Layout tab: P01

Source: Figure Modified From Drawing Provided MPDS Services, Inc.

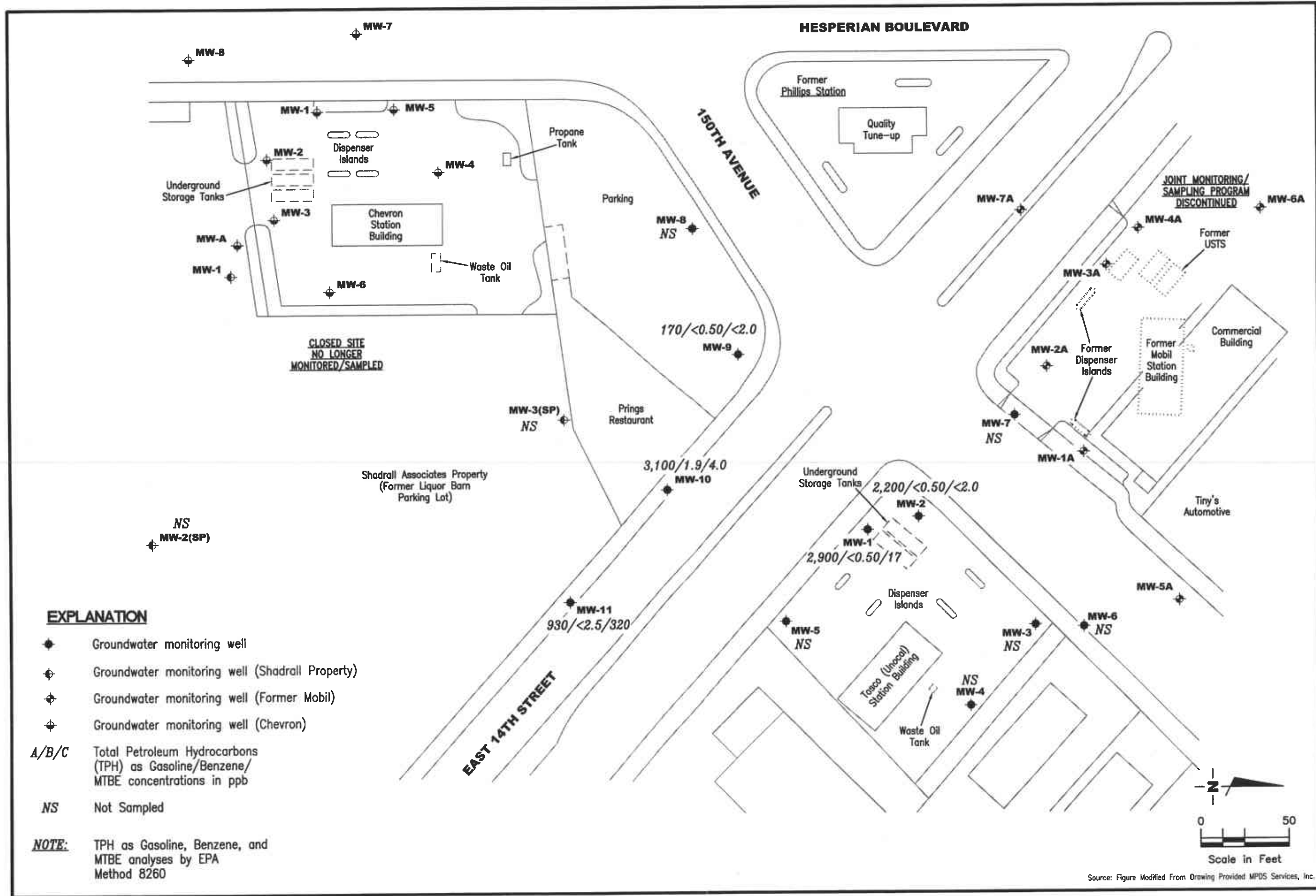

**CONCENTRATION MAP**  
 Tosco (Unocal) Service Station #3292  
 15008 East 14th Street  
 San Leandro, California

**GETTLER - RYAN INC.**  
 6747 Sierra Ct., Suite J  
 Dublin, CA 94568  
 (925) 551-7555

REVISED DATE

DATE August 11, 2003

REVIEWED BY

JOB NUMBER 180105

FILE NAME: P:\ENVIRO\COMINGPHILLIPS-10500\003-3292.DWG | Layout Tab: Con3

Source: Figure Modified From Drawing Provided MPDS Services, Inc.

**Table 1**  
**Groundwater Monitoring Data and Analytical Results**  
 Tosco (Unocal) Service Station #3292  
 15008 East 14th Street  
 San Leandro, California

WELL ID/ TOC*(ft.)	DATE	DTW (ft.)	S.I. (ft.bgs)	GWE (msl)	TPH-G (ppb)	B (ppb)	T (ppb)	E (ppb)	X (ppb)	MTBE (ppb)	
MW-1	05/04/91	--	7.0-19.0	--	31,000	74	20	920	1,500	--	
	09/19/91	--		--	26,000	130	16	1,300	1,800	--	
	12/18/91	--		--	17,000	160	20	1,400	1,600	--	
	03/17/92	--		--	23,000	320	19	1,000	940	--	
	05/19/92	--		--	29,000	650	370	1,100	1,200	--	
	08/20/92	--		--	18,000	230	22	640	950	--	
36.72	09/16/92	13.67		23.05	--	--	--	--	--	--	
	10/12/92	14.07		22.65	--	--	--	--	--	--	
	11/10/92	13.96		22.76	18,000	220	ND	690	830	--	
	12/10/92	13.15		23.57	--	--	--	--	--	--	
	01/15/93	10.02		26.70	--	--	--	--	--	--	
	02/20/93	9.01		27.71	19,000	190	ND	880	620	--	
	03/18/93	9.48		27.24	--	--	--	--	--	--	
	04/20/93	9.15		27.57	--	--	--	--	--	--	
	05/21/93	9.80		26.92	27,000	150	200	1,200	950	--	
	06/22/93	10.33		26.39	--	--	--	--	--	--	
	07/23/93	10.79		25.93	--	--	--	--	--	--	
	08/23/93	11.27		25.45	24,000	160	110	840	810	--	
	36.37	09/24/93	11.35		25.02	--	--	--	--	--	--
		11/23/93	11.84		24.53	18,000	210	63	900	620	--
02/24/94		9.45		26.92	18,000	74	30	940	480	--	
05/25/94 <sup>3</sup>		10.45		25.92	6,400	72	ND	170	67	--	
08/23/94		11.98		24.39	24,000	130	57	970	320	--	
11/23/94		11.17		25.20	23,000	180	44	970	270	--	
02/03/95		8.01		28.36	20,000	77	17	950	390	--	
05/10/95		8.51		27.86	16,000	230	27	880	630	--	
08/02/95		10.00		26.37	18,000	190	ND	860	590	--	
11/02/95		11.11		25.26	--	--	--	--	--	--	
11/20/95 <sup>4</sup>		11.19		25.18	20,000	180	ND	960	450	970	
02/08/96		7.74		28.63	15,000	43	16	940	410	5,200	
05/08/96		8.50		27.87	16,000	37	16	930	410	1,600	
08/09/96	9.72		26.65	2,300	25	ND	77	39	1,200		
11/07/96	10.74		25.63	38,000	140	ND	1,900	5,600	ND		

**Table 1**  
**Groundwater Monitoring Data and Analytical Results**  
 Tosco (Unocal) Service Station #3292  
 15008 East 14th Street  
 San Leandro, California

WELL ID/ TOC*(ft.)	DATE	DTW (ft.)	S.I. (ft.bgs)	GWE (msl)	TPH-G (ppb)	B (ppb)	T (ppb)	E (ppb)	X (ppb)	MTBE (ppb)
MW-1	02/10-11/97	7.92	7.0-19.0	28.45	7,300	91	ND	170	68	1,700
	(cont)	05/07/97		9.24	27.13	11,000	120	ND	470	110
36.34	08/05/97	10.20	26.17	530 <sup>1</sup>	5.9	ND	5.6	ND	ND	430
	11/04/97	10.71	25.66	4,100	50	7.0	64	14	97	
	02/12/98	6.27	30.10	8,500	160	ND <sup>7</sup>	550	ND <sup>7</sup>	1,900	
	05/15/98	7.62	28.72	5,600	57	ND <sup>7</sup>	290	ND <sup>7</sup>	1,500	
	08/12/98	8.85	27.49	ND <sup>7</sup>	ND <sup>7</sup>	ND <sup>7</sup>	ND <sup>7</sup>	ND <sup>7</sup>	5,800	
	11/12/98	9.71	26.63	ND <sup>7</sup>	16	ND <sup>7</sup>	ND <sup>7</sup>	ND <sup>7</sup>	12,000/13,000 <sup>12</sup>	
	03/01/99	7.85	28.49	5,700	43	ND <sup>7</sup>	320	ND <sup>7</sup>	5,000/9,600 <sup>12</sup>	
	05/12/99	8.70	27.64	ND <sup>7</sup>	36	ND <sup>7</sup>	ND <sup>7</sup>	ND <sup>7</sup>	12,000/21,000 <sup>12</sup>	
	08/11/99	9.81	26.53	ND <sup>7</sup>	ND <sup>7</sup>	ND <sup>7</sup>	ND <sup>7</sup>	ND <sup>7</sup>	5,760/8,650 <sup>12</sup>	
	11/04/99	10.72	25.62	1,640 <sup>11</sup>	11.0	ND <sup>7</sup>	ND <sup>7</sup>	ND <sup>7</sup>	3,330/3,630 <sup>18</sup>	
	02/29/00	7.31	29.03	195 <sup>19</sup>	ND	ND	ND	ND	580/657 <sup>20</sup>	
	05/08/00	8.27	28.07	9,010 <sup>17</sup>	60.5	ND <sup>7</sup>	402	ND <sup>7</sup>	2,260/1,780 <sup>12</sup>	
	08/08/00	9.85	26.49	2,060 <sup>17</sup>	34.8	ND <sup>7</sup>	38.7	ND <sup>7</sup>	1,710/1,990 <sup>18</sup>	
	11/06/00	10.05	26.29	2,300 <sup>11</sup>	19.3	ND <sup>7</sup>	4.37	ND <sup>7</sup>	592	
	02/07/01	9.64	26.70	2,700 <sup>17</sup>	25	ND <sup>7</sup>	38	ND <sup>7</sup>	1,500/840 <sup>12</sup>	
	05/09/01	9.81	26.53	5,550 <sup>11</sup>	42.7	ND <sup>7</sup>	48.4	ND <sup>7</sup>	605/431 <sup>18</sup>	
	08/24/01	11.21	25.13	15,000 <sup>11</sup>	130	<20	170	<20	820	
	11/16/01	11.49	24.85	8,900 <sup>11</sup>	65	<10	46	<10	640/490 <sup>12</sup>	
	02/21/02	8.93	27.41	7,400 <sup>11</sup>	73	<10	100	<10	400/170 <sup>12</sup>	
	05/10/02	9.82	26.52	6,000 <sup>11</sup>	67	6.7	58	<5.0	<50	
08/26/02 <sup>21</sup>	11.03	25.31	9,200	<10	<10	62	<20	120		
11/07/02 <sup>21</sup>	11.53	24.81	2,200 <sup>22</sup>	<2.5	<2.5	4.6	<5.0	20		
02/14/03 <sup>21</sup>	9.03	27.31	4,300	<2.5	<2.5	23	<5.0	35		
05/12/03 <sup>21</sup>	8.61	27.73	5,000 <sup>22</sup>	<0.50	0.50	13	<1.0	32		
<b>08/11/03<sup>21</sup></b>	<b>10.37</b>	<b>25.97</b>	<b>2,900<sup>22</sup></b>	<b>&lt;0.50</b>	<b>&lt;0.50</b>	<b>4.4</b>	<b>&lt;1.0</b>	<b>17</b>		
MW-2	05/04/91	--	7.0-19.5	--	19,000	6.6	1.4	460	630	--
	09/19/91	--		--	19,000	100	6.8	790	310	--
	12/18/91	--		--	10,000	110	5.1	420	96	--
	03/17/92	--		--	16,000	110	ND	730	220	--

**Table 1**  
**Groundwater Monitoring Data and Analytical Results**  
 Tosco (Unocal) Service Station #3292  
 15008 East 14th Street  
 San Leandro, California

WELL ID/ TOC*(ft.)	DATE	DTW (ft.)	S.L. (ft.bgs)	GWE (msl)	TPH-G (ppb)	B (ppb)	T (ppb)	E (ppb)	X (ppb)	MTBE (ppb)
MW-2	05/19/92	--	7.0-19.5	--	17,000	140	87	680	170	--
(cont)	08/20/92	--		--	13,000	52	ND	660	70	--
36.89	09/16/92	13.80		23.09	--	--	--	--	--	--
	10/12/92	14.19		22.70	--	--	--	--	--	--
	11/10/92	14.06		22.83	11,000	36	7.2	570	45	--
	12/10/92	13.21		23.68	--	--	--	--	--	--
	01/15/93	10.12		26.77	--	--	--	--	--	--
	02/20/93	9.07		27.82	1,500	2.9	3.8	9.1	ND	--
	03/18/93	9.55		27.34	--	--	--	--	--	--
	04/20/93	9.19		27.70	--	--	--	--	--	--
	05/21/93	9.84		27.05	9,500	37	ND	470	62	--
	06/22/93	10.37		26.52	--	--	--	--	--	--
	07/23/93	10.83		26.06	--	--	--	--	--	--
	08/23/93	11.30		25.59	15,000	110	ND	590	64	--
36.34	09/24/93	11.14		25.20	--	--	--	--	--	--
	11/23/93	11.69		24.65	11,000	80	10	480	20	--
	02/24/94 <sup>5</sup>	9.27		27.07	11,000	44	ND	580	32	--
	05/25/94	10.30		26.04	11,000	50	ND	400	22	--
	08/23/94	11.82		24.52	12,000	45	10	360	20	--
	11/23/94	10.97		25.37	15,000	61	24	440	ND	--
	02/03/95	7.87		28.47	9,700	5.7	ND	250	10	--
	05/10/95	8.38		27.96	7,500	56	4.7	310	33	--
	08/02/95	9.36		26.98	8,200	53	22	220	25	--
	11/02/95	10.95		25.39	5,000	56	4.5	170	7.7	110
	02/08/96	7.52		28.82	7,200	ND	ND	170	ND	ND
	05/08/96	8.21		28.13	8,400	5.6	9.0	170	10	130
	08/09/96	9.54		26.80	3,100	24	ND	80	ND	64
	11/07/96	10.69		25.65	36,000	140	ND	1,900	5,600	ND
	02/10-11/97	7.75		28.59	4,600	27	ND	53	ND	ND
	05/07/97	9.14		27.20	5,300	61	ND	78	20	180
	08/05/97	10.23		26.11	3,100	35	ND	13	ND	58



**Table 1**  
**Groundwater Monitoring Data and Analytical Results**  
 Tosco (Unocal) Service Station #3292  
 15008 East 14th Street  
 San Leandro, California

WELL ID/ TOC*(ft.)	DATE	DTW (ft.)	S.I. (ft.bgs)	GWE (msl)	TPH-G (ppb)	B (ppb)	T (ppb)	E (ppb)	X (ppb)	MTBE (ppb)
MW-2	11/04/97	10.65	7.0-19.5	25.69	1,200	16	ND	11	25	53
(cont)	02/12/98	6.20		30.14	630	12	ND <sup>7</sup>	7.3	ND <sup>7</sup>	48
36.30	05/15/98	7.50		28.80	3,600	19	ND <sup>7</sup>	33	ND <sup>7</sup>	72
	08/12/98	8.82		27.48	3,100	44	6.1	15	5.7	270
	11/12/98	9.60		26.70	3,200 <sup>13</sup>	44	ND <sup>7</sup>	15	ND <sup>7</sup>	180
	03/01/99	7.81		28.49	3,600	45	6.2	7.5	ND <sup>7</sup>	570
	05/12/99	8.65		27.65	3,100	65	ND <sup>7</sup>	15	17	450
	08/11/99	9.95		26.35	3,260	33.6	ND <sup>7</sup>	ND <sup>7</sup>	ND <sup>7</sup>	154
	11/04/99	10.78		25.52	3,160 <sup>11</sup>	38.9	7.10	ND <sup>7</sup>	ND <sup>7</sup>	120
	02/29/00	7.44		28.86	3,770 <sup>11</sup>	13.5	ND <sup>7</sup>	12.0	ND <sup>7</sup>	105
	05/08/00	8.42		27.88	3,840 <sup>11</sup>	ND <sup>7</sup>	ND <sup>7</sup>	9.54	ND <sup>7</sup>	ND <sup>7</sup>
	08/08/00	9.66		26.64	3,080 <sup>11</sup>	40.8	ND <sup>7</sup>	ND <sup>7</sup>	ND <sup>7</sup>	149
	11/06/00	9.79		26.51	2,510 <sup>11</sup>	38.8	4.42	ND <sup>7</sup>	ND <sup>7</sup>	82.6
	02/07/01	9.43		26.87	9,300 <sup>19</sup>	140	120	71	140	790
	05/09/01	9.65		26.65	3,300 <sup>11</sup>	37.9	ND <sup>7</sup>	ND <sup>7</sup>	ND <sup>7</sup>	120
	08/24/01	11.06		25.24	3,100 <sup>19</sup>	<5.0	<5.0	<5.0	<5.0	<50
	11/16/01	11.19		25.11	2,200 <sup>11</sup>	28	<5.0	<5.0	<5.0	76
	02/21/02	8.73		27.57	2,700 <sup>11</sup>	33	<5.0	<5.0	<5.0	100
	05/10/02	9.71		26.59	2,300 <sup>11</sup>	30	<5.0	<5.0	<5.0	<50
	08/26/02 <sup>21</sup>	10.88		25.42	4,400	<5.0	<5.0	<5.0	<10	<20
	11/07/02 <sup>21</sup>	11.16		25.14	1,100 <sup>22</sup>	<2.5	<2.5	<2.5	<5.0	<10
	02/14/03 <sup>21</sup>	8.91		27.39	1,800 <sup>22</sup>	<0.50	<0.50	<0.50	<1.0	<2.0
	05/12/03 <sup>21</sup>	8.73		27.57	2,900 <sup>22</sup>	<0.50	<0.50	0.89	<1.0	<2.0
	<b>08/11/03<sup>21</sup></b>	<b>10.51</b>		<b>25.79</b>	<b>2,200<sup>22</sup></b>	<b>&lt;0.50</b>	<b>&lt;0.50</b>	<b>&lt;0.50</b>	<b>&lt;1.0</b>	<b>&lt;2.0</b>
MW-3	05/04/91	--	7.0-22.5	--	9,100	2.0	ND	55	180	--
	09/19/91	--		--	7,600	ND	13	190	170	--
	12/18/91	--		--	5,900	54	6.4	110	64	--
	03/17/92	--		--	5,800	66	7.5	100	58	--
	05/19/92	--		--	3,400	25	3.6	66	41	--
	08/20/92	--		--	4,500	58	ND	65	35	--
36.84	09/16/92	13.74		23.10	--	--	--	--	--	--

**Table 1**  
**Groundwater Monitoring Data and Analytical Results**  
 Tosco (Unocal) Service Station #3292  
 15008 East 14th Street  
 San Leandro, California

WELL ID/ TOC* (ft.)	DATE	DTW (ft.)	S.I. (ft. bgs)	GWE (msl)	TPH-G (ppb)	B (ppb)	T (ppb)	E (ppb)	X (ppb)	MTBE (ppb)
MW-3	10/12/92	14.13	7.0-22.5	22.71	--	--	--	--	--	--
(cont)	11/10/92	14.03		22.81	3,400	37	ND	85	34	--
	12/10/92	13.15		23.69	--	--	--	--	--	--
	01/15/93	10.07		26.77	--	--	--	--	--	--
	02/20/93	9.02		27.82	1,600	12	18	8.9	12	--
	03/18/93	9.50		27.34	--	--	--	--	--	--
	04/20/93	9.02		27.82	--	--	--	--	--	--
	05/21/93	9.70		27.14	2,600	42	ND	43	15	--
	06/22/93	10.28		26.56	--	--	--	--	--	--
	07/23/93	10.74		26.10	--	--	--	--	--	--
	08/23/93	11.24		25.60	2,900	25	ND	50	18	--
36.42	09/24/93	11.20		25.22	--	--	--	--	--	--
	11/23/93	11.78		24.64	2,300	34	ND	24	5.6	--
	02/24/94	9.21		27.21	3,400	46	ND	53	11	--
	05/25/94	10.34		26.08	1,400	20	ND	ND	ND	--
	08/23/94	11.88		24.54	2,900	37	49	14	2.9	--
	11/23/94	10.98		25.44	3,200	48	ND	22	ND	--
	02/03/95	7.82		28.60	780	13	ND	2.1	ND	--
	05/10/95	8.38		28.04	1,300	ND	ND	ND	ND	--
	08/02/95	9.49		26.93	1,500	6.3	ND	16	2.1	--
	11/02/95	11.00		25.42	1,100	5.2	2.1	7.4	0.5	15
	02/08/96	7.41		29.01	450	ND	ND	ND	ND	ND
	05/08/96	8.20		28.22	590	ND	11	10	ND	ND
	08/09/96	9.53		26.89	ND	ND	ND	ND	ND	ND
	11/07/96	10.96		25.46	140	1.2	ND	ND	ND	5.6
	02/10-11/97	7.71		28.71	89	1.8	ND	ND	ND	ND
	05/07/97	9.17		27.25	52 <sup>2</sup>	ND	ND	ND	5.1	5.1
	08/05/97	10.27		26.15	ND	ND	ND	ND	ND	ND
	11/04/97	10.83		25.59	93	1.8	ND	ND	ND	6.2
	02/12/98	6.00		30.42	56	0.59	ND	ND	ND	2.7
36.42	05/15/98	7.42		29.00	130 <sup>8</sup>	0.68	ND	ND	0.63	10
	08/12/98	8.84		27.58	50	ND	ND	ND	ND	ND
	11/12/98	9.57		26.85	60 <sup>13</sup>	ND	ND	ND	ND	3.8

**Table 1**  
**Groundwater Monitoring Data and Analytical Results**  
 Tosco (Unocal) Service Station #3292  
 15008 East 14th Street  
 San Leandro, California

WELL ID/ TOC* (ft.)	DATE	DTW (ft.)	S.I. (ft.bgs)	GWE (msl)	TPH-G (ppb)	B (ppb)	T (ppb)	E (ppb)	X (ppb)	MTBE (ppb)	
MW-3 (cont)	03/01/99	8.74	7.0-22.5	27.68	66	ND	ND	ND	ND	3.2	
	05/12/99	8.92		27.50	ND	ND	ND	ND	ND	ND	
	08/11/99	10.18		26.24	ND	ND	ND	ND	ND	ND	
	11/04/99	11.06		25.36	ND	ND	ND	ND	ND	ND	
	02/29/00	NOT MONITORED/SAMPLED		--	--	--	--	--	--	--	
	08/08/00	10.03		26.39	--	--	--	--	--	--	
	11/06/00	10.10		26.32	--	--	--	--	--	--	
	02/07/01	9.81		26.61	--	--	--	--	--	--	
	05/09/01	9.58		26.84	--	--	--	--	--	--	
	08/24/01	11.12		25.30	--	--	--	--	--	--	
	11/16/01	10.84		25.58	--	--	--	--	--	--	
	02/21/02	8.68		27.74	--	--	--	--	--	--	
	05/10/02	9.71		26.71	--	--	--	--	--	--	
	08/26/02	10.85		25.57	--	--	--	--	--	--	
	11/07/02	10.89		25.53	--	--	--	--	--	--	
	02/14/03	8.72		27.70	--	--	--	--	--	--	
	05/12/03	8.25		28.17	--	--	--	--	--	--	
	<b>08/11/03</b>	<b>10.64</b>		<b>25.78</b>	--	--	--	--	--	--	
	MW-4	05/04/91	--	7.0-19.5	--	6,300	ND	ND	2.8	61	--
		09/19/91	--		--	1,800	0.83	ND	54	46	--
12/18/91		--		--	2,500	28	2.5	54	22	--	
03/17/92		--		--	1,800	3.7	1.4	90	21	--	
05/19/92		--		--	2,000	20	3.5	42	8.3	--	
08/20/92		--		--	1,000	15	ND	11	3.0	--	
37.40		09/16/92	14.31		23.09	--	--	--	--	--	
		10/12/92	14.72		22.68	--	--	--	--	--	
		11/10/92	14.57		22.83	690	9.1	ND	16	2.8	
		12/10/92	13.67		23.73	--	--	--	--	--	
		01/15/93	10.62		26.78	--	--	--	--	--	
		02/20/93	9.59		27.81	2,400	40	2.1	33	ND	
		03/18/93	9.97		27.43	--	--	--	--	--	

**Table 1**  
**Groundwater Monitoring Data and Analytical Results**  
 Tosco (Unocal) Service Station #3292  
 15008 East 14th Street  
 San Leandro, California

WELL ID/ TOC* (ft.)	DATE	DTW (ft.)	S.I. (ft.bgs)	GWE (msl)	TPH-G (ppb)	B (ppb)	T (ppb)	E (ppb)	X (ppb)	MTBE (ppb)
MW-4	04/20/93	9.67	7.0-19.5	27.73	--	--	--	--	--	--
(cont)	05/21/93	10.32		27.08	1,900	31	ND	20	4.5	--
	06/22/93	10.91		26.49	--	--	--	--	--	--
	07/23/93	11.38		26.02	--	--	--	--	--	--
	08/23/93	11.86		25.54	1,200	5.0	ND	16	ND	--
37.04	09/24/93	11.85		25.19	--	--	--	--	--	--
	11/23/93	12.44		24.60	720	10	ND	8.7	ND	--
	02/24/94	9.89		27.15	1,300	8.9	ND	20	ND	--
	05/25/94	11.02		26.02	1,700	22	ND	4.5	ND	--
	08/23/94	12.57		24.47	690	9.2	1.3	7.1	1.9	--
	11/23/94	11.65		25.39	420	5.0	1.1	4.2	1.2	--
	02/03/95	8.52		28.52	620	6.4	ND	9.3	ND	--
	05/10/95	9.97		27.07	280	2.8	ND	2.7	2.4	--
	08/02/95	10.18		26.86	290	3.6	ND	2.8	ND	--
	11/02/95	11.67		25.37	42,000	390	210	2,800	6,300	270
	02/08/96	8.15		28.89	130	2.1	ND	1.5	0.69	ND
	05/08/96	INACCESSIBLE		--	--	--	--	--	--	--
	08/09/96	10.24		26.80	ND	ND	ND	ND	ND	ND
	11/07/96	11.58		25.46	ND	ND	ND	ND	ND	ND
	02/10-11/97	8.45		28.59	ND	ND	ND	ND	ND	ND
	05/07/97	9.85		27.19	ND	ND	ND	ND	ND	ND
	08/05/97	11.04		26.00	50	0.76	ND	ND	ND	ND
	11/04/97	11.46		25.58	ND	ND	ND	ND	ND	ND
	02/12/98	5.75		31.29	ND	ND	ND	ND	ND	ND
37.04	05/15/98	7.28		29.76	ND	ND	ND	ND	ND	ND
	08/12/98	9.85		27.19	ND	ND	ND	ND	ND	ND
	11/12/98	10.28		26.76	ND	ND	ND	ND	ND	ND
	03/01/99	8.51		28.53	ND	ND	ND	ND	ND	ND
	05/12/99	9.32		27.72	ND	ND	ND	ND	ND	ND
	08/11/99	10.65		26.39	ND	ND	ND	ND	ND	ND
	11/04/99	11.48		25.56	ND	ND	ND	ND	ND	ND
	02/29/00	NOT MONITORED/SAMPLED		--	--	--	--	--	--	--
	08/08/00	10.67		26.37	--	--	--	--	--	--

**Table 1**  
**Groundwater Monitoring Data and Analytical Results**  
 Tosco (Unocal) Service Station #3292  
 15008 East 14th Street  
 San Leandro, California

WELL ID/ TOC* (ft.)	DATE	DTW (ft.)	S.L. (ft.bgs)	GWE (msl)	TPH-G (ppb)	B (ppb)	T (ppb)	E (ppb)	X (ppb)	MTBE (ppb)
MW-4	11/06/00	10.56	7.0-19.5	26.48	--	--	--	--	--	--
(cont)	02/07/01	10.40		26.64	--	--	--	--	--	--
	05/09/01	9.16		27.88	--	--	--	--	--	--
	08/24/01	11.80		25.24	--	--	--	--	--	--
	11/16/01	10.46		26.58	--	--	--	--	--	--
	02/21/02	9.37		27.67	--	--	--	--	--	--
	05/10/02	10.41		26.63	--	--	--	--	--	--
	08/26/02	11.55		25.49	--	--	--	--	--	--
	11/07/02	10.44		26.60	--	--	--	--	--	--
	02/14/03	9.28		27.76	--	--	--	--	--	--
	05/12/03	8.69		28.35	--	--	--	--	--	--
	<b>08/11/03</b>	<b>10.83</b>		<b>26.21</b>	--	--	--	--	--	--
<b>MW-5</b>	05/04/91	--	7.0-22.5	--	69,000	1,400	2,500	3,500	15,000	--
	09/19/91	--		--	57,000	1,600	2,700	5,200	20,000	--
	12/18/91	--		--	31,000	1,600	3,100	4,800	19,000	--
	03/17/92	--		--	81,000	850	1,600	4,800	18,000	--
	05/19/92	--		--	84,000	760	1,500	4,000	17,000	--
	08/20/92	--		--	58,000	660	1,700	4,200	19,000	--
36.40	09/16/92	13.37		23.03	--	--	--	--	--	--
	10/12/92	13.75		22.65	--	--	--	--	--	--
	11/10/92	13.68		22.72	57,000	800	1,800	4,400	18,000	--
	12/10/92	12.58		23.82	--	--	--	--	--	--
	01/15/93	9.71		26.69	--	--	--	--	--	--
	02/20/93	8.69		27.71	17,000	75	ND	1,000	620	--
	03/18/93	9.16		27.24	--	--	--	--	--	--
	04/20/93	8.88		27.52	--	--	--	--	--	--
	05/21/93	9.56		26.84	55,000	ND	160	3,500	12,000	--
	06/22/93	10.05		26.35	--	--	--	--	--	--
	07/23/93	10.53		25.87	--	--	--	--	--	--
	08/23/93	10.98		25.42	61,000	340	380	3,600	14,000	--
35.94	09/24/93	10.94		25.00	--	--	--	--	--	--

**Table 1**  
**Groundwater Monitoring Data and Analytical Results**  
 Tosco (Unocal) Service Station #3292  
 15008 East 14th Street  
 San Leandro, California

WELL ID/ TOC*(ft.)	DATE	DTW (ft.)	S.I. (ft.bgs)	GWE (msl)	TPH-G (ppb)	B (ppb)	T (ppb)	E (ppb)	X (ppb)	MTBE (ppb)
MW-5	11/23/93	11.45	7.0-22.5	24.49	46,000	290	310	4,100	15,000	--
(cont)	02/24/94	9.02		26.92	57,000	140	400	4,400	16,000	--
	05/25/94	10.03		25.91	53,000	ND	ND	4,000	14,000	--
	08/23/94	11.57		24.37	61,000	360	380	4,800	17,000	--
	11/23/94	10.71		25.23	46,000	230	260	3,900	14,000	--
	02/03/95	7.69		28.25	56,000	140	330	3,500	13,000	--
	05/10/95	8.20		27.74	27,000	160	170	2,200	5,200	--
	08/02/95	9.23		26.71	65,000	260	300	3,500	12,000	--
	11/02/95	10.70		25.24	240	0.76	ND	1.1	ND	ND
	02/08/96	7.36		28.58	54,000	210	150	3,400	12,000	170
	05/08/96	8.25		27.69	52,000	170	200	3,600	11,000	170
	08/09/96	9.37		26.57	25,000	54	16	1,700	4,700	ND
	11/07/96	10.65		25.29	2,100	42	ND	9.3	ND	2,300
	02/10-11/97	7.63		28.31	15,000	46	29	1,400	4,100	ND
	05/07/97	8.98		26.96	38,000	120	ND	2,000	5,100	380
	08/05/97	11.08		24.86	310	1.0	ND	17	40	ND
	11/04/97	10.72		25.22	20,000	ND	ND	1,500	2,800	280
	02/12/98	6.08		29.86	33,000	120	ND <sup>7</sup>	1,700	3,800	ND <sup>7</sup>
35.92	05/15/98	7.40		28.52	30,000	ND <sup>7</sup>	ND <sup>7</sup>	2,200	4,900	ND <sup>7</sup>
	08/12/98	8.69		27.23	24,000	100	ND <sup>7</sup>	ND <sup>7</sup>	3,400	1,000
	11/12/98	9.48		26.44	13,000 <sup>13</sup>	65	ND <sup>7</sup>	1,100	1,400	780
	03/01/99	7.54		28.38	29,000	75	ND <sup>7</sup>	2,000	4,100	690
	05/12/99	8.48		27.44	19,000	110	ND <sup>7</sup>	990	1,900	330
	08/11/99	9.74		26.18	24,300	ND <sup>7</sup>	ND <sup>7</sup>	1,540	1,740	ND <sup>7</sup>
	11/04/99	10.56		25.36	19,500 <sup>17</sup>	37.1	ND <sup>7</sup>	1,300	1,030	ND <sup>7</sup>
	02/29/00	7.19		28.73	SAMPLED SEMI-ANNUALLY		--	--	--	--
	05/08/00	8.23		27.69	25,700 <sup>11</sup>	37.6	ND <sup>7</sup>	2,020	3,500	ND <sup>7</sup>
	08/08/00	9.51		26.41	--	--	--	--	--	--
	11/06/00	10.04		25.88	14,100 <sup>11</sup>	37.1	ND <sup>7</sup>	1,250	497	ND <sup>7</sup>
	02/07/01	9.23		26.69	--	--	--	--	--	--
	05/09/01	9.44		26.48	15,600 <sup>11</sup>	ND <sup>7</sup>	ND <sup>7</sup>	1,290	476	ND <sup>7</sup>
	08/24/01	10.75		25.17	SAMPLED SEMI-ANNUALLY		--	--	--	--
	11/16/01	10.93		24.99	15,000 <sup>11</sup>	40	<25	1,100	54	<250

**Table 1**  
**Groundwater Monitoring Data and Analytical Results**  
 Tosco (Unocal) Service Station #3292  
 15008 East 14th Street  
 San Leandro, California

WELL ID/ TOC*(ft.)	DATE	DTW (ft.)	S.I. (ft.bgs)	GWE (msl)	TPH-G (ppb)	B (ppb)	T (ppb)	E (ppb)	X (ppb)	MTBE (ppb)
MW-5	02/21/02	8.52	7.0-22.5	27.40	--	--	--	--	--	--
(cont)	05/10/02	9.47		26.45	23,000 <sup>11</sup>	86	<25	1,500	450	<250
	08/26/02	10.60		25.32	SAMPLED SEMI-ANNUALLY		--	--	--	--
	11/07/02 <sup>21</sup>	10.83		25.09	8,000 <sup>22</sup>	<2.5	<2.5	650	<5.0	<10
	02/14/03	8.70		27.22	SAMPLED SEMI-ANNUALLY		--	--	--	--
	05/12/03 <sup>21</sup>	8.62		27.30	10,000 <sup>22</sup>	<25	<25	1,200	<50	<100
	<b>08/11/03</b>	<b>10.52</b>		<b>25.40</b>	<b>SAMPLED SEMI-ANNUALLY</b>		--	--	--	--
<b>MW-6</b>	05/19/92	--	8.0-20.0	--	1,300	2.0	2.1	ND	2.7	--
	08/20/92	--		--	280	8.4	ND	0.51	0.84	--
36.03	09/16/92	12.91		23.12	--	--	--	--	--	--
	10/12/92	13.28		22.75	--	--	--	--	--	--
	11/10/92	13.18		22.85	490	7.0	1.2	1.7	ND	--
	12/10/92	12.33		23.70	--	--	--	--	--	--
	01/15/93	9.25		26.78	--	--	--	--	--	--
	02/20/93	8.24		27.79	2,400	43	ND	33	2.0	--
	03/18/93	8.74		27.29	--	--	--	--	--	--
	04/20/93	8.12		27.91	--	--	--	--	--	--
	05/21/93	8.83		27.20	940	18	1.0	7.1	2.7	--
	06/22/93	9.38		26.65	--	--	--	--	--	--
	07/23/93	9.87		26.16	--	--	--	--	--	--
	08/23/93	10.35		25.68	1,000	9.4	2.3	5.0	2.3	--
35.67	09/24/93	10.34		25.33	--	--	--	--	--	--
	11/23/93	10.96		24.71	520	ND	1.7	1.9	0.82	--
	02/24/94 <sup>5</sup>	8.39		27.28	810	12	ND	2.6	0.77	--
	05/25/94	9.55		26.12	500	11	ND	ND	0.73	--
	08/23/94	10.97		24.70	570	8.8	2.5	3.2	2.6	--
	11/23/94	10.21		25.46	460	6.4	1.1	1.9	1.1	--
	02/03/95	6.99		28.68	660	4.8	13	1.4	ND	--
	05/10/95	7.53		28.14	470	ND	0.65	1.4	0.67	--
	08/02/95	8.68		26.99	360	3.2	ND	1.6	ND	--
	11/02/95	10.20		25.47	470	ND	0.92	0.89	0.58	5.5

**Table 1**  
**Groundwater Monitoring Data and Analytical Results**  
 Tosco (Unocal) Service Station #3292  
 15008 East 14th Street  
 San Leandro, California

WELL ID/ TOC*(ft.)	DATE	DTW (ft.)	S.I. (ft.bgs)	GWE (msl)	TPH-G (ppb)	B (ppb)	T (ppb)	E (ppb)	X (ppb)	MTBE (ppb)
MW-6	02/08/96	6.66	8.0-20.0	29.01	450	3.1	ND	1.1	0.68	ND
(cont)	05/08/96	7.40		28.27	ND	ND	ND	ND	ND	ND
	08/09/96	8.72		26.95	ND	ND	ND	ND	ND	ND
	11/07/96	10.12		25.55	ND	ND	ND	ND	ND	ND
	02/10-11/97	6.88		28.79	ND	ND	ND	ND	ND	ND
	05/07/97	8.32		27.35	ND	ND	1.1	ND	ND	ND
	08/05/97	9.64		26.03	55	0.79	ND	ND	ND	ND
	11/04/97	10.30		25.37	ND	ND	ND	ND	ND	ND
	02/12/98	5.10		30.57	ND	ND	ND	ND	ND	ND
35.68	05/15/98	6.61		29.07	ND	ND	ND	ND	ND	ND
	08/12/98	8.02		27.66	ND	ND	ND	ND	ND	ND
	11/12/98	8.74		26.94	ND	ND	ND	ND	ND	ND
	03/01/99	7.22		28.46	ND	ND	ND	ND	ND	ND
	05/12/99	8.05		27.63	ND	ND	ND	ND	ND	ND
	08/11/99	9.53		26.15	ND	ND	ND	ND	ND	ND
	11/04/99	10.44		25.24	ND	ND	ND	ND	ND	ND
	02/29/00	NOT MONITORED/SAMPLED		--	--	--	--	--	--	--
	08/08/00	9.16		26.52	--	--	--	--	--	--
	11/06/00	9.28		26.40	--	--	--	--	--	--
	02/07/01	9.18		26.50	--	--	--	--	--	--
	05/09/01	8.76		26.92	--	--	--	--	--	--
	08/24/01	10.33		25.35	--	--	--	--	--	--
	11/16/01	9.97		25.71	--	--	--	--	--	--
	02/21/02	7.86		27.82	--	--	--	--	--	--
	05/10/02	8.93		26.75	--	--	--	--	--	--
	08/26/02	10.09		25.59	--	--	--	--	--	--
	11/07/02	9.93		25.75	--	--	--	--	--	--
	02/14/03	7.90		27.78	--	--	--	--	--	--
	05/12/03	7.51		28.17	--	--	--	--	--	--
	08/11/03	9.44		26.24	--	--	--	--	--	--



**Table 1**  
**Groundwater Monitoring Data and Analytical Results**  
 Tosco (Unocal) Service Station #3292  
 15008 East 14th Street  
 San Leandro, California

WELL ID/ TOC*(ft.)	DATE	DTW (ft.)	S.I. (ft.bgs)	GWE (mst)	TPH-G (ppb)	B (ppb)	T (ppb)	E (ppb)	X (ppb)	MTBE (ppb)
MW-7	05/19/92	--	11.0-21.5	--	17,000	540	90	1,200	1,900	--
	08/20/92	--		--	13,000	460	54	ND	3,100	--
36.40	09/16/92	13.23		23.17	--	--	--	--	--	--
	10/12/92	13.65		22.75	--	--	--	--	--	--
	11/10/92	13.54		22.86	1,800	74	ND	230	350	--
	12/10/92	12.52		23.88	--	--	--	--	--	--
	01/15/93	9.59		26.81	--	--	--	--	--	--
	02/20/93	8.55		27.85	1,800	37	4.6	11	7.7	--
	03/18/93	8.98		27.42	--	--	--	--	--	--
	04/20/93	8.52		27.88	--	--	--	--	--	--
	05/21/93	9.16		27.24	22,000	330	37	2,100	2,900	--
	06/22/93	9.66		26.74	--	--	--	--	--	--
36.09	07/23/93	10.15		26.25	--	--	--	--	--	--
	08/23/93	10.65		25.75	33,000	360	ND	2,500	4,300	--
	09/24/93	10.77		25.32	--	--	--	--	--	--
	11/23/93	11.28		24.81	19,000	310	30	2,500	2,300	--
	02/24/94 <sup>5</sup>	8.95		27.14	16,000	220	19	2,400	3,200	--
	05/25/94	10.00		26.09	14,000	200	ND	1,500	1,800	--
	08/23/94	11.43		24.66	19,000	210	50	2,000	2,800	--
	11/23/94	10.69		25.40	10,000	220	ND	1,000	730	--
	02/03/95	7.49		28.60	26,000	170	ND	2,300	3,700	--
	05/10/95	7.88		28.21	1,300	13	1.5	170	230	--
	08/02/95	9.02		27.07	15,000	200	ND	2,200	2,000	--
	11/02/95	10.55		25.54	18,000	190	9.4	2,100	2,200	72
	02/08/96	7.13		28.96	19,000	150	ND	2,100	3,000	ND
	05/08/96	7.11		28.98	13,000	130	18	1,900	1,600	85
	08/09/96	9.07		27.02	11,000	67	ND	1,700	1,800	ND
11/07/96	10.76		25.33	32,000	160	ND	3,300	8,400	570	
02/10-11/97	7.22		28.87	7,100	55	ND	ND	620	ND	
05/07/97	8.47		27.62	6,000	74	ND	560	330	250	
08/05/97	10.25		25.84	5,000	66	ND	420	240	ND	

**Table 1**  
**Groundwater Monitoring Data and Analytical Results**  
 Tosco (Unocal) Service Station #3292  
 15008 East 14th Street  
 San Leandro, California

WELL ID/ TOC* (ft.)	DATE	DTW (ft.)	S.I. (ft.bgs)	GWE (msl)	TPH-G (ppb)	B (ppb)	T (ppb)	E (ppb)	X (ppb)	MTBE (ppb)
MW-7	11/04/97	10.69	11.0-21.5	25.40	20,000	67	ND	2,300	4,300	430
(cont)	02/12/98	5.02		31.07	5,500	95	ND <sup>7</sup>	150	110	ND <sup>7</sup>
36.06	05/15/98	6.98		29.08	1,300	ND <sup>7</sup>	ND <sup>7</sup>	69	64	88
	08/12/98	8.42		27.64	1,400	12	2.3	67	ND <sup>7</sup>	30
	11/12/98	9.10		26.96	6,300 <sup>13</sup>	63	ND <sup>7</sup>	230	100	ND <sup>7</sup>
	03/01/99	7.14		28.92	1,000	24	ND <sup>7</sup>	23	26	39
	05/12/99	8.07		27.99	4,700	79	ND <sup>7</sup>	120	210	210
	08/11/99	9.44		26.62	4,700 <sup>17</sup>	61.6	ND <sup>7</sup>	58.2	23.6	187
	11/04/99	10.38		25.68	5,980 <sup>11</sup>	56.3	ND <sup>7</sup>	44.5	21.2	194
	02/29/00	7.06		29.00	SAMPLED SEMI-ANNUALLY		--	--	--	--
	05/08/00	8.15		27.91	6,600 <sup>11</sup>	80.0	ND <sup>7</sup>	99.6	66.5	ND <sup>7</sup>
	08/08/00	9.21		26.85	--	--	--	--	--	--
	11/06/00	9.77		26.29	6,030 <sup>11</sup>	56.3	ND <sup>7</sup>	156	63.1	281
	02/07/01	9.02		27.04	--	--	--	--	--	--
	05/09/01	9.38		26.68	7,460 <sup>11</sup>	45.0	ND <sup>7</sup>	186	94.4	ND <sup>7</sup>
	08/24/01	10.73		25.33	SAMPLED SEMI-ANNUALLY		--	--	--	--
	11/16/01	10.97		25.09	8,000 <sup>11</sup>	50	<10	61	18	<100
	02/21/02	8.60		27.46	--	--	--	--	--	--
	05/10/02	9.28		26.78	7,100 <sup>11</sup>	<5.0	<5.0	140	63	<50
	08/26/02	10.40		25.66	SAMPLED SEMI-ANNUALLY		--	--	--	--
	11/07/02 <sup>21</sup>	10.95		25.11	3,400 <sup>22</sup>	3.1	<0.50	25	7.8	<2.0
	02/14/03	8.82		27.24	SAMPLED SEMI-ANNUALLY		--	--	--	--
	05/12/03 <sup>21</sup>	8.46		27.60	4,900	3.7	0.74	130	47	<2.0
	<b>08/11/03</b>	<b>10.27</b>		<b>25.79</b>	<b>SAMPLED SEMI-ANNUALLY</b>		<b>--</b>	<b>--</b>	<b>--</b>	<b>--</b>
MW-8	05/19/92	--	8.0-19.0	--	5,300	28	3.3	2.6	2.1	--
	08/20/92	--		--	3,500 <sup>1</sup>	67	11	ND	ND	--
37.14	09/16/92	14.13		23.01	--	--	--	--	--	--
	10/12/92	14.51		22.63	--	--	--	--	--	--
	11/10/92	14.46		22.68	1,800	20	ND	ND	ND	--
	12/10/92	13.51		23.63	--	--	--	--	--	--
	01/15/93	10.50		26.64	--	--	--	--	--	--

**Table 1**  
**Groundwater Monitoring Data and Analytical Results**  
 Tosco (Unocal) Service Station #3292  
 15008 East 14th Street  
 San Leandro, California

WELL ID/ TOC* (ft.)	DATE	DTW (ft.)	S.I. (ft.bgs)	GWE (msl)	TPH-G (ppb)	B (ppb)	T (ppb)	E (ppb)	X (ppb)	MTBE (ppb)
MW-8	02/20/93	9.50	8.0-19.0	27.64	2,200	32	ND	42	5.0	--
(cont)	03/18/93	9.89		27.25	--	--	--	--	--	--
	04/20/93	9.91		27.23	--	--	--	--	--	--
	05/21/93	10.40		26.74	2,500	44	ND	ND	ND	--
	06/22/93	10.86		26.28	--	--	--	--	--	--
	07/23/93	11.29		25.85	--	--	--	--	--	--
	08/23/93	11.76		25.38	280 <sup>1</sup>	49	4.5	ND	ND	--
36.89	09/24/93	12.00		24.89	--	--	--	--	--	--
	11/23/93	12.38		24.51	1,800	ND	3.4	ND	ND	--
	02/24/94	10.44		26.45	1,200	10	2.3	ND	3.2	--
	05/25/94	11.12		25.77	14,000	29	ND	ND	ND	--
	08/23/94	12.61		24.28	3,200	46	18	2.0	7.2	--
	11/23/94	11.98		24.91	1,700	34	ND	ND	3.1	--
	02/03/95	9.16		27.73	800	6.1	ND	ND	ND	--
	05/10/95	9.35		27.54	1,400	15	1.5	0.65	0.84	--
	08/02/95	10.40		26.49	690	8.3	1.9	ND	ND	--
	11/02/95	11.80		25.09	1,200	ND	1.9	0.56	ND	6.4
	02/08/96	8.98		27.91	--	--	--	--	--	--
	02/14/96 <sup>6</sup>	9.24		27.65	650	9.0	1.2	ND	0.52	ND
	05/08/96	9.46		27.43	1,200	0.7	35	2.2	3.0	ND
	08/09/96	10.47		26.42	350	ND	12	0.81	0.95	ND
	11/07/96	11.71		25.18	1,000	23	ND	ND	ND	ND
	02/10-11/97	8.84		28.05	630	13	ND	ND	8.1	ND
	05/07/97	10.12		26.77	1,200 <sup>1</sup>	26	3.4	ND	20	20
	08/05/97	11.26		25.63	590 <sup>1</sup>	9.8	ND	ND	ND	ND
	11/04/97	11.58		25.31	640	14	1.9	5.7	11	ND
	02/12/98	7.34		29.55	770 <sup>8</sup>	20	3.0	ND <sup>7</sup>	ND <sup>7</sup>	ND <sup>7</sup>
36.87	05/15/98	8.67		28.20	840 <sup>8</sup>	10	ND <sup>7</sup>	ND <sup>7</sup>	3.1	ND <sup>7</sup>
	08/12/98	9.78		27.09	240 <sup>10</sup>	0.75	ND	ND	ND	ND
	11/12/98	10.62		26.25	300	14	2.0	ND <sup>7</sup>	ND <sup>7</sup>	ND <sup>7</sup>
	03/01/99	9.02		27.85	1,100	22	4.6	2.1	4.9	12
	05/12/99	9.65		27.22	650	17	ND <sup>7</sup>	ND <sup>7</sup>	ND <sup>7</sup>	ND <sup>7</sup>
	08/11/99	10.85		26.02	168	6.68	ND	0.544	ND	ND

**Table 1**  
**Groundwater Monitoring Data and Analytical Results**  
 Tosco (Unocal) Service Station #3292  
 15008 East 14th Street  
 San Leandro, California

WELL ID/ TOC*(ft.)	DATE	DTW (ft.)	S.I. (ft.bgs)	GWE (msl)	TPH-G (ppb)	B (ppb)	T (ppb)	E (ppb)	X (ppb)	MTBE (ppb)
MW-8	11/04/99	11.72	8.0-19.0	25.15	1,010 <sup>11</sup>	15.8	2.28	ND <sup>7</sup>	ND <sup>7</sup>	16.2
(cont)	02/29/00	8.25		28.62	SAMPLED SEMI-ANNUALLY		--	--	--	--
	05/08/00	9.21		27.66	199 <sup>19</sup>	6.26	ND	ND	ND	ND
	08/08/00	10.35		26.52	--	--	--	--	--	--
	11/06/00	10.76		26.11	797 <sup>19</sup>	ND <sup>7</sup>	ND <sup>7</sup>	ND <sup>7</sup>	ND <sup>7</sup>	ND <sup>7</sup>
	02/07/01	10.16		26.71	--	--	--	--	--	--
	05/09/01	10.62		26.25	695 <sup>19</sup>	ND <sup>7</sup>	ND <sup>7</sup>	ND <sup>7</sup>	ND <sup>7</sup>	ND <sup>7</sup>
	08/24/01	11.97		24.90	SAMPLED SEMI-ANNUALLY		--	--	--	--
	11/16/01	12.27		24.60	1,000 <sup>19</sup>	<2.0	<2.0	<2.0	<2.0	<2.0
	02/21/02	10.03		26.84	--	--	--	--	--	--
	05/10/02	10.63		26.24	400 <sup>19</sup>	<0.50	0.78	<0.50	<0.50	<5.0
	08/26/02	11.80		25.07	SAMPLED SEMI-ANNUALLY		--	--	--	--
	11/07/02 <sup>21</sup>	11.97		24.90	200 <sup>22</sup>	<0.50	<0.50	<0.50	<1.0	5.0
	02/14/03	9.97		26.90	SAMPLED SEMI-ANNUALLY		--	--	--	--
	05/12/03 <sup>21</sup>	9.58		27.29	730 <sup>22</sup>	<0.50	<0.50	<0.50	<1.0	<2.0
	08/11/03	11.33		25.54	SAMPLED SEMI-ANNUALLY		--	--	--	--
<b>MW-9</b>	05/19/92	--	8.0-19.0	--	8,100	11	ND	25	5.8	--
	08/20/92	--		--	3,800 <sup>1</sup>	37	ND	ND	ND	--
36.92	09/16/92	13.90		23.02	--	--	--	--	--	--
	10/12/92	14.28		22.64	--	--	--	--	--	--
	11/10/92	14.22		22.70	4,200	ND	ND	21	23	--
	12/10/92	13.40		23.52	--	--	--	--	--	--
	01/15/93	10.24		26.68	--	--	--	--	--	--
	02/20/93	9.22		27.70	2,300	47	ND	32	ND	--
	03/18/93	9.55		27.37	--	--	--	--	--	--
	04/20/93	9.62		27.30	--	--	--	--	--	--
	05/21/93	10.16		26.76	3,200	32	ND	8.1	ND	--
	06/22/93	10.62		26.30	--	--	--	--	--	--
	07/23/93	11.07		25.85	--	--	--	--	--	--
	08/23/93	11.54		25.38	3,000	29	ND	ND	ND	--
36.29	09/24/93	11.18		25.11	--	--	--	--	--	--

**Table 1**  
**Groundwater Monitoring Data and Analytical Results**  
 Tosco (Unocal) Service Station #3292  
 15008 East 14th Street  
 San Leandro, California

WELL ID/ TOC*(ft.)	DATE	DTW (ft.)	S.L. (ft.bgs)	GWE (msl)	TPH-G (ppb)	B (ppb)	T (ppb)	E (ppb)	X (ppb)	MTBE (ppb)
MW-9	11/23/93	11.80	8.0-19.0	24.49	2,500	23	2.1	ND	ND	--
(cont)	02/24/94	9.74		26.55	2,900	35	ND	ND	ND	--
	05/25/94	10.48		25.81	ND	ND	ND	ND	ND	--
	08/23/94	11.99		24.30	2,800	28	32	ND	ND	--
	11/23/94	11.31		24.98	2,000	24	2.2	2.2	2.5	--
	02/03/95	8.45		27.84	2,100	26	2.5	ND	ND	--
	05/10/95	8.70		27.59	1,700	0.81	2.2	1.0	1.4	--
	08/02/95	9.75		26.54	1,900	26	6.6	ND	3.9	--
	11/02/95	11.16		25.13	1,600	ND	1.3	ND	ND	11
	02/08/96	8.15		28.14	1,900	ND	ND	ND	ND	ND
	05/08/96	8.75		27.54	1,700	1.9	22	1.7	2.7	ND
	08/09/96	9.84		26.45	200	ND	4.5	ND	0.58	ND
	11/07/96	11.10		25.19	920	24	ND	ND	ND	ND
	02/10-11/97	8.15		28.14	580	14	2.4	ND	ND	16
	05/07/97	9.45		26.84	810	11	3.9	1.7	9.9	13
	08/05/97	10.70		25.59	850 <sup>1</sup>	21	ND	ND	ND	33
	11/04/97	11.05		25.24	730	11	ND	5.1	11	ND
	02/12/98	6.60		29.69	820 <sup>8</sup>	23	3.2	ND <sup>7</sup>	ND <sup>7</sup>	18
36.27	05/15/98	8.01		28.26	390	5.5	1.2	ND	13	13
	08/12/98	9.18		27.09	780	14	ND	0.52	ND	12
	11/12/98	9.91		26.36	180	6.3	ND	ND	0.62	8.1
	03/01/99	8.34		27.93	790 <sup>8</sup>	24	ND	ND	1.7	32
	05/12/99	9.04		27.23	930 <sup>16</sup>	13	2.2	1.2	1.5	10
	08/11/99	10.25		26.02	1,120	19.7	ND <sup>7</sup>	ND <sup>7</sup>	ND <sup>7</sup>	ND <sup>7</sup>
	11/04/99	11.10		25.17	756 <sup>11</sup>	14.2	1.94	ND <sup>7</sup>	ND <sup>7</sup>	22.8
	02/29/00	8.12		28.15	955 <sup>19</sup>	22.9	ND <sup>7</sup>	ND <sup>7</sup>	ND <sup>7</sup>	ND <sup>7</sup>
	05/08/00	9.09		27.18	895 <sup>19</sup>	ND <sup>7</sup>	ND <sup>7</sup>	ND <sup>7</sup>	ND <sup>7</sup>	ND <sup>7</sup>
	08/08/00	10.08		26.19	630 <sup>11</sup>	18.2	ND <sup>7</sup>	ND <sup>7</sup>	ND <sup>7</sup>	ND <sup>7</sup>
	11/06/00	10.52		25.75	712 <sup>19</sup>	ND <sup>7</sup>	ND <sup>7</sup>	ND <sup>7</sup>	ND <sup>7</sup>	ND <sup>7</sup>
	02/07/01	9.78		26.49	750 <sup>17</sup>	ND <sup>7</sup>	ND <sup>7</sup>	ND <sup>7</sup>	ND <sup>7</sup>	66
	05/09/01	9.98		26.29	704 <sup>19</sup>	ND <sup>7</sup>	ND <sup>7</sup>	ND <sup>7</sup>	ND <sup>7</sup>	ND <sup>7</sup>
	08/24/01	11.34		24.93	770 <sup>19</sup>	<1.2	<1.2	<1.2	<1.2	<12
	11/16/01	11.63		24.64	540 <sup>19</sup>	<1.0	<1.0	<1.0	<1.0	<10

**Table 1**  
**Groundwater Monitoring Data and Analytical Results**  
 Tosco (Unocal) Service Station #3292  
 15008 East 14th Street  
 San Leandro, California

WELL ID/ TOC* (ft.)	DATE	DTW (ft.)	S.I. (ft.bgs)	GWE (msl)	TPH-G (ppb)	B (ppb)	T (ppb)	E (ppb)	X (ppb)	MTBE (ppb)
MW-9	02/21/02	9.35	8.0-19.0	26.92	380 <sup>19</sup>	<0.50	<0.50	<0.50	<0.50	<5.0
(cont)	05/10/02	10.00		26.27	300 <sup>19</sup>	<0.50	0.67	<0.50	<0.50	<5.0
	08/26/02 <sup>21</sup>	11.17		25.10	680	<0.50	<0.50	<0.50	<1.0	<2.0
	11/07/02 <sup>21</sup>	11.56		24.71	250 <sup>22</sup>	<0.50	<0.50	<0.50	<1.0	<2.0
	02/14/03 <sup>21</sup>	9.41		26.86	460 <sup>22</sup>	<0.50	<0.50	<0.50	<1.0	<2.0
	05/12/03 <sup>21</sup>	9.22		27.05	720	<0.50	<0.50	<0.50	<1.0	<2.0
	08/11/03 <sup>21</sup>	11.18		25.09	170 <sup>22</sup>	<0.50	<0.50	<0.50	<1.0	<2.0
<b>MW-10</b>	08/20/92	--	8.0-20.0	--	15,000	230	ND	1,000	350	--
36.26	09/16/92	13.28		22.98	--	--	--	--	--	--
	10/12/92	13.67		22.59	--	--	--	--	--	--
	11/10/92	13.59		22.67	15,000	300	42	3,500	330	--
	12/10/92	12.53		23.73	--	--	--	--	--	--
	01/15/93	9.60		26.66	--	--	--	--	--	--
	02/20/93	8.57		27.69	17,000	74	ND	1,000	620	--
	03/18/93	9.03		27.23	--	--	--	--	--	--
	04/20/93	9.09		27.17	--	--	--	--	--	--
	05/21/93	9.63		26.63	23,000	250	ND	3,000	240	--
	06/22/93	10.12		26.14	--	--	--	--	--	--
	07/23/93	10.54		25.72	--	--	--	--	--	--
	08/23/93	10.99		25.27	20,000	230	13	3,200	140	--
36.04	09/24/93	11.17		24.87	--	--	--	--	--	--
	11/23/93	11.67		24.37	18,000	300	10	2,800	110	--
	02/24/94	9.57		26.47	15,000	330	19	2,000	83	--
	05/25/94	10.32		25.72	14,000	240	ND	230	62	--
	08/23/94	11.81		24.23	16,000	250	41	1,800	74	--
	11/23/94	11.10		24.94	16,000	260	ND	1,600	49	--
	02/03/95	8.32		27.72	17,000	310	ND	1,500	93	--
	05/10/95	8.70		27.34	12,000	260	16	1,200	54	--
	08/02/95	9.55		26.49	8,900	240	ND	780	40	--
	11/02/95	11.03		25.01	9,300	190	ND	470	1.7	110
	02/08/96	8.05		27.99	9,700	170	ND	440	ND	ND

**Table 1**  
**Groundwater Monitoring Data and Analytical Results**  
 Tosco (Unocal) Service Station #3292  
 15008 East 14th Street  
 San Leandro, California

WELL ID/ TOC*(ft.)	DATE	DTW (ft.)	S.I. (ft.bgs)	GWE (msl)	TPH-G (ppb)	B (ppb)	T (ppb)	E (ppb)	X (ppb)	MTBE (ppb)
MW-10	05/08/96	8.70	8.0-20.0	27.34	7,100	100	ND	240	ND	43
(cont)	08/09/96	9.76		26.28	4,400	59	7.5	110	6.5	73
	11/07/96	10.92		25.12	6,300	65	ND	110	ND	130
	02/10-11/97	8.10		27.94	6,800	91	ND	100	ND	210
	05/07/97	9.28		26.76	4,800	76	ND	50	ND	160
	08/05/97	10.51		25.53	4,200	52	ND	40	ND	81
	11/04/97	11.02		25.02	4,500	49	ND	63	ND	84
	02/12/98	6.85		29.19	6,200	98	ND <sup>7</sup>	91	ND <sup>7</sup>	420
36.02	05/15/98	8.05		27.97	7,200	84	ND <sup>7</sup>	84	ND <sup>7</sup>	260
	08/12/98	9.27		26.75	7,500	6.9	11	47	ND <sup>7</sup>	130
	11/12/98	10.03		25.99	4,200 <sup>13</sup>	23	ND <sup>7</sup>	24	ND <sup>7</sup>	130
	03/01/99	8.56		27.46	5,900 <sup>8</sup>	37	ND <sup>7</sup>	50	26	300
	05/12/99	8.92		27.10	7,400 <sup>16</sup>	37	ND <sup>7</sup>	32	ND <sup>7</sup>	170
	08/11/99	10.10		25.92	5,060	38.1	ND <sup>7</sup>	12.9	ND <sup>7</sup>	75.5
	11/04/99	11.03		24.99	6,190 <sup>11</sup>	76.7	8.01	13.4	ND <sup>7</sup>	234
	02/29/00	9.67		26.35	7,120 <sup>11</sup>	27.8	ND <sup>7</sup>	24.7	ND <sup>7</sup>	208
	05/08/00	10.54		25.48	5,830 <sup>11</sup>	51.7	10.6	24.7	24.8	142
	08/08/00	10.92		25.10	5,010 <sup>11</sup>	50.6	ND <sup>7</sup>	13.9	ND <sup>7</sup>	113
	11/06/00	11.34		24.68	6,260 <sup>11</sup>	47.9	ND <sup>7</sup>	12.5	ND <sup>7</sup>	118
	02/07/01	10.75		25.27	4,800 <sup>17</sup>	56	10	ND <sup>7</sup>	ND <sup>7</sup>	780
	05/09/01	9.84		26.18	6,810 <sup>11</sup>	52.4	ND <sup>7</sup>	ND <sup>7</sup>	ND <sup>7</sup>	161
	08/24/01	11.16		24.86	5,600 <sup>11</sup>	56	<10	<10	<10	<100
	11/16/01	11.38		24.64	5,600 <sup>11</sup>	49	<10	<10	<10	190
	02/21/02	9.20		26.82	5,000 <sup>11</sup>	38	<5.0	8.5	<5.0	140
	05/10/02	9.87		26.15	5,300 <sup>11</sup>	57	6.3	8.2	<5.0	<50
	08/26/02 <sup>21</sup>	11.02		25.00	7,000	<5.0	<5.0	5.4	<10	<20
	11/07/02 <sup>21</sup>	11.32		24.70	3,500 <sup>22</sup>	<2.5	<2.5	<2.5	<5.0	<10
	02/14/03 <sup>21</sup>	9.36		26.66	5,200 <sup>22</sup>	<5.0	<5.0	<5.0	<10	<20
	05/12/03 <sup>21</sup>	9.12		26.90	4,300	2.6	0.56	2.9	<1.0	4.8
	08/11/03 <sup>21</sup>	11.25		24.77	3,100	1.9	<0.50	1.0	1.0	4.0

**Table 1**  
**Groundwater Monitoring Data and Analytical Results**  
 Tosco (Unocal) Service Station #3292  
 15008 East 14th Street  
 San Leandro, California

WELL ID/ TOC* (ft.)	DATE	DTW (ft.)	S.I. (ft.bgs)	GWE (msl)	TPH-G (ppb)	B (ppb)	T (ppb)	E (ppb)	X (ppb)	MTBE (ppb)
MW-11	08/20/92	--	7.0-19.0	--	4,600 <sup>1</sup>	62	ND	ND	54	--
35.83	09/16/92	12.93		22.90	--	--	--	--	--	--
	10/12/92	13.30		22.53	--	--	--	--	--	--
	11/10/92	13.20		22.63	5,800	130	ND	260	42	--
	12/10/92	12.24		23.59	--	--	--	--	--	--
	01/15/93	9.23		26.60	--	--	--	--	--	--
	02/20/93	8.20		27.63	18,000	76	ND	1,000	630	--
	03/18/93	8.77		27.06	--	--	--	--	--	--
	04/20/93	8.86		26.97	--	--	--	--	--	--
	05/21/93	9.40		26.43	7,100	64	ND	340	120	--
	06/22/93	9.87		25.96	--	--	--	--	--	--
	07/23/93	10.29		25.54	--	--	--	--	--	--
	08/23/93	10.73		25.10	5,400	68	ND	230	43	--
35.50	09/24/93	10.83		24.67	--	--	--	--	--	--
	11/23/93	11.28		24.22	3,400	105	ND	120	43	--
	02/24/94	9.20		26.30	4,600	170	ND	140	36	--
	05/25/94	9.94		25.56	1,400	49	ND	26	ND	--
	08/23/94	11.39		24.11	7,300	250	13	150	42	--
	11/23/94	10.67		24.83	5,800	250	10	120	22	--
	02/03/95	8.02		27.48	4,400	110	ND	150	37	--
	05/10/95	8.36		27.14	4,200	120	ND	170	38	--
	08/02/95	9.31		26.19	4,200	110	ND	110	22	--
	11/02/95	10.85		24.65	6,100	150	ND	78	6.8	6,200
	02/08/96	7.76		27.74	--	--	--	--	--	--
	02/14/96 <sup>6</sup>	8.18		27.32	3,100	60	ND	98	ND	4,000
	05/08/96	8.50		27.00	3,500	<del>120</del>	ND	-160	ND	6,400
	08/09/96	9.46		26.04	1,100	42	ND	15	ND	4,300
	11/07/96	10.58		24.92	2,900	57	ND	13	ND	3,400
	02/10-11/97	7.88		27.62	600	9.5	ND	ND	ND	3,100
	05/07/97	9.07		26.43	1,900	45	ND	31	ND	2,400
	08/05/97	10.23		25.27	2,100	35	ND	24	ND	1,800



**Table 1**  
**Groundwater Monitoring Data and Analytical Results**  
 Tosco (Unocal) Service Station #3292  
 15008 East 14th Street  
 San Leandro, California

WELL ID/ TOC* (ft.)	DATE	DTW (ft.)	S.I. (ft.bgs)	GWE (msl)	TPH-G (ppb)	B (ppb)	T (ppb)	E (ppb)	X (ppb)	MTBE (ppb)
MW-11	11/04/97	10.51	7.0-19.0	24.99	98	1.6	ND	ND	ND	ND
(cont)	02/12/98	6.59		28.91	670	12	ND <sup>7</sup>	ND <sup>7</sup>	ND <sup>7</sup>	1,400
35.50	05/15/98	7.73		27.77	1,200 <sup>9</sup>	7.9	ND <sup>7</sup>	30	ND <sup>7</sup>	1,600
	08/12/98	8.85		26.65	1,600 <sup>11</sup>	ND <sup>7</sup>	ND <sup>7</sup>	ND <sup>7</sup>	ND <sup>7</sup>	2,000
	11/12/98	9.52		25.98	1,700 <sup>13</sup>	9.3	ND <sup>7</sup>	ND <sup>7</sup>	ND <sup>7</sup>	1,700
	03/01/99	8.00		27.50	530	4.9	ND <sup>7</sup>	ND <sup>7</sup>	ND <sup>7</sup>	870
	05/12/99	8.64		26.86	900	6.6	ND <sup>7</sup>	ND <sup>7</sup>	ND <sup>7</sup>	840
	08/11/99	9.92		25.58	1,660	5.52	ND <sup>7</sup>	ND <sup>7</sup>	ND <sup>7</sup>	764
	11/04/99	10.88		24.62	2,600 <sup>11</sup>	8.71	ND <sup>7</sup>	2.76	ND <sup>7</sup>	1,490
	02/29/00	7.56		27.94	420 <sup>19</sup>	ND	ND	ND	ND	1,010
	05/08/00	8.50		27.00	513 <sup>11</sup>	3.56	ND <sup>7</sup>	1.11	ND <sup>7</sup>	1,320
	08/08/00	9.39		26.11	960 <sup>11</sup>	10.0	1.28	ND <sup>7</sup>	ND <sup>7</sup>	1,600
	11/06/00	9.81		25.69	3,000 <sup>11</sup>	17.7	ND <sup>7</sup>	ND <sup>7</sup>	ND <sup>7</sup>	1,280/1,360 <sup>12</sup>
	02/07/01	9.16		26.34	1,600 <sup>17</sup>	ND <sup>7</sup>	ND <sup>7</sup>	ND <sup>7</sup>	ND <sup>7</sup>	590
	05/09/01	9.51		25.99	1,010 <sup>11</sup>	11.4	ND <sup>7</sup>	1.24	ND <sup>7</sup>	586
	08/29/01	10.78		24.72	3,100 <sup>11</sup>	23	<5.0	<5.0	<5.0	840/870 <sup>12</sup>
	11/16/01	10.95		24.55	1,000 <sup>11</sup>	9.2	<2.0	<2.0	<2.0	600
	02/21/02	8.85		26.65	1,100 <sup>11</sup>	7.4	<2.5	<2.5	<2.5	270
	05/10/02	9.51		25.99	910 <sup>11</sup>	7.4	1.4	2.8	<12	330/270 <sup>18</sup>
	08/26/02 <sup>21</sup>	10.62		24.88	1,900	<0.50	<0.50	0.87	<1.0	170
	11/07/02 <sup>21</sup>	10.77		24.73	550 <sup>22</sup>	<2.5	<2.5	<2.5	<5.0	330
	02/14/03 <sup>21</sup>	8.97		26.53	2,600	1.8	0.51	1.7	<1.0	<2.0
	05/12/03 <sup>21</sup>	8.90		26.60	<250	<2.5	<2.5	<2.5	<5.0	290
	08/11/03 <sup>21</sup>	11.04		24.46	930 <sup>22</sup>	<2.5	<2.5	<2.5	<5.0	320
<b>MW-2 (SP)</b>										
35.44	05/08/96	9.12	11.0-21.0	26.32	540	0.68	21	1.0	1.7	ND
	08/09/96	9.98		25.46	170	ND	7.8	ND	ND	ND
	11/07/96	10.98		24.46	430	8.9	1.5	ND	ND	10
	02/10-11/97	8.63		26.81	230 <sup>2</sup>	4.6	1.0	ND	ND	10
	05/07/97	9.58		25.86	ND	ND	ND	ND	ND	14
	08/05/97	10.62		24.82	360	5.5	50	ND	ND	ND

**Table 1**  
**Groundwater Monitoring Data and Analytical Results**  
 Tosco (Unocal) Service Station #3292  
 15008 East 14th Street  
 San Leandro, California

WELL ID/ TOC*(ft.)	DATE	DTW (ft.)	S.I. (ft.bgs)	GWE (msl)	TPH-G (ppb)	B (ppb)	T (ppb)	E (ppb)	X (ppb)	MTBE (ppb)	
MW-2 (SP)	11/04/97	11.06	11.0-21.0	24.38	280	2.9	13	ND	0.54	ND	
(cont)	02/12/98	7.71		27.73	440 <sup>8</sup>	10	1.6	ND	0.69	13	
	05/15/98	8.50		26.94	540 <sup>8</sup>	10	1.1	ND	1.1	15	
	08/12/98	9.43		26.01	ND	ND	ND	ND	ND	ND	
	11/12/98	9.98		25.46	300 <sup>14</sup>	6.1	ND <sup>7</sup>	ND <sup>7</sup>	4.0	ND <sup>7</sup>	
	03/01/99	8.70		26.74	57	ND	ND	ND	ND	4.5	
	05/12/99	9.45		25.99	ND	ND	ND	ND	ND	5.0	
	08/11/99	10.08		25.36	337	ND	ND	ND	ND	12.4	
	11/04/99	10.91		24.53	317 <sup>11</sup>	8.31	ND	ND	ND	7.81	
	02/29/00	8.04		27.40	SAMPLED SEMI-ANNUALLY			--	--	--	--
	05/08/00	9.10		26.34	131 <sup>19</sup>	ND	ND	ND	ND	ND/4.83 <sup>12</sup>	
	08/08/00	9.91		25.53	--	--	--	--	--	--	
	11/06/00	10.20		25.24	183 <sup>19</sup>	ND	ND	ND	ND	ND	
	02/07/01	9.70		25.74	--	--	--	--	--	--	
	05/09/01	9.98		25.46	ND	ND	ND	ND	ND	ND	
	08/24/01	11.15		24.29	SAMPLED SEMI-ANNUALLY			--	--	--	
	11/16/01	11.31		24.13	250 <sup>19</sup>	<0.50	<0.50	<0.50	<0.50	<5.0	
	02/21/02	9.55		25.89	--	--	--	--	--	--	
	05/10/02	10.01		25.43	180 <sup>19</sup>	<0.50	<0.50	<0.50	0.71	10	
	08/26/02	11.03		24.41	SAMPLED SEMI-ANNUALLY			--	--	--	
	11/07/02 <sup>21</sup>	11.12		24.32	<50	<0.50	<0.50	<0.50	<1.0	5.4	
	02/14/03	9.60		25.84	SAMPLED SEMI-ANNUALLY			--	--	--	
	05/12/03 <sup>21</sup>	9.21		26.23	<50	<0.50	<0.50	<0.50	<1.0	8.4	
	<b>08/11/03</b>	<b>10.87</b>		<b>24.57</b>	SAMPLED SEMI-ANNUALLY			--	--	--	
MW-3 (SP)											
35.81	05/08/96	8.73	11.0-21.0	27.08	4,700	7.9	36	13	4.0	42	
	08/09/96	9.73		26.08	2,000	ND	14	7.6	ND	ND	
	11/07/96	10.88		24.93	1,800	29	ND	ND	ND	40	
	02/10-11/97	8.16		27.65	3,500	70	14	ND	ND	150	
	05/07/97	9.35		26.46	3,100	48	ND	ND	ND	110	
	08/05/97	10.44		25.37	3,200	43	5.7	ND	ND	61	

**Table 1**  
**Groundwater Monitoring Data and Analytical Results**  
 Tosco (Unocal) Service Station #3292  
 15008 East 14th Street  
 San Leandro, California

WELL ID/ TOC* (ft.)	DATE	DTW (ft.)	S.I. (ft.bgs)	GWE (msl)	TPH-G (ppb)	B (ppb)	T (ppb)	E (ppb)	X (ppb)	MTBE (ppb)
MW-3 (SP)	11/04/97	10.90	11.0-21.0	24.91	2,600	34	ND	ND	ND	53
(cont)	02/12/98	6.77		29.04	3,200	62	ND <sup>7</sup>	ND <sup>7</sup>	ND <sup>7</sup>	100
35.82	05/15/98	8.02		27.80	ND	ND	ND	ND	ND	2.5
	08/12/98	9.11		26.71	110	ND	4.1	ND	ND <sup>7</sup>	ND
	11/12/98	9.81		26.01	1,800 <sup>15</sup>	37	2.8	ND <sup>7</sup>	ND <sup>7</sup>	55
	03/01/99	8.27		27.55	2,900 <sup>8</sup>	12	3.6	ND <sup>7</sup>	ND <sup>7</sup>	110
	05/12/99	8.92		26.90	4,100 <sup>16</sup>	34	ND <sup>7</sup>	ND <sup>7</sup>	ND <sup>7</sup>	45
	08/11/99	9.59		26.23	3,220	22.8	ND <sup>7</sup>	ND <sup>7</sup>	ND <sup>7</sup>	50.8
	11/04/99	10.86		24.96	2,460 <sup>11</sup>	26.6	ND <sup>7</sup>	ND <sup>7</sup>	ND <sup>7</sup>	52.1
	02/29/00	7.92		27.90	SAMPLED SEMI-ANNUALLY		--	--	--	--
	05/08/00	9.07		26.75	1,080 <sup>19</sup>	ND <sup>7</sup>	ND <sup>7</sup>	ND <sup>7</sup>	ND <sup>7</sup>	<sup>7</sup> ND/ND <sup>12</sup>
	08/08/00	9.86		25.96	--	--	--	--	--	--
	11/06/00	10.12		25.70	3,100 <sup>11</sup>	35.0	ND <sup>7</sup>	ND <sup>7</sup>	ND <sup>7</sup>	95.7
	02/07/01	9.65		26.17	--	--	--	--	--	--
	05/09/01	9.79		26.03	3,350 <sup>11</sup>	34.0	ND <sup>7</sup>	ND <sup>7</sup>	ND <sup>7</sup>	ND <sup>7</sup>
	08/24/01	11.09		24.73	SAMPLED SEMI-ANNUALLY		--	--	--	--
	11/16/01	11.29		24.53	3,300 <sup>11</sup>	47	<10	<10	<10	<100
	02/21/02	9.19		26.63	--	--	--	--	--	--
	05/10/02	9.84		25.98	4,700 <sup>11</sup>	55	<5.0	<5.0	<5.0	140
	08/26/02	10.95		24.87	SAMPLED SEMI-ANNUALLY		--	--	--	--
	11/07/02 <sup>21</sup>	11.33		24.49	2,600 <sup>22</sup>	<5.0	<5.0	<5.0	<10	<20
	02/14/03	9.92		25.90	SAMPLED SEMI-ANNUALLY		--	--	--	--
	05/12/03 <sup>21</sup>	9.74		26.08	420 <sup>22</sup>	<0.50	<0.50	<0.50	<1.0	<2.0
	<b>08/11/03</b>	<b>11.26</b>		<b>24.56</b>	SAMPLED SEMI-ANNUALLY		--	--	--	--
<b>Trip Blank</b>										
TB-LB	02/12/98	--	--	--	ND	ND	ND	ND	ND	ND
	05/15/98	--	--	--	ND	ND	ND	ND	ND	ND
	08/12/98	--	--	--	ND	ND	ND	ND	ND	ND
	11/12/98	--	--	--	ND	ND	0.68	ND	0.51	ND
	03/01/99	--	--	--	ND	ND	ND	ND	ND	ND
	05/12/99	--	--	--	ND	ND	ND	ND	ND	ND

**Table 1**  
**Groundwater Monitoring Data and Analytical Results**  
 Tosco (Unocal) Service Station #3292  
 15008 East 14th Street  
 San Leandro, California

WELL ID/ TOC* (ft.)	DATE	DTW (ft.)	S.I. (ft.bgs)	GWE (msl)	TPH-G (ppb)	B (ppb)	T (ppb)	E (ppb)	X (ppb)	MTBE (ppb)
TB-LB (cont)	08/11/99	--	--	--	ND	ND	ND	ND	ND	ND
	11/04/99	--	--	--	ND	ND	ND	ND	ND	ND
	02/29/00	--	--	--	ND	ND	ND	ND	ND	ND
	05/08/00	--	--	--	ND	ND	ND	ND	ND	ND
	08/08/00	--	--	--	ND	ND	ND	ND	ND	ND
	11/06/00	--	--	--	ND	ND	ND	ND	ND	ND
	02/07/01	--	--	--	ND	ND	ND	ND	ND	ND
	05/09/01	--	--	--	ND	ND	ND	ND	ND	ND
	08/24/01	--	--	--	<50	<0.50	<0.50	<0.50	<0.50	<5.0
	11/16/01	--	--	--	<50	<0.50	<0.50	<0.50	<0.50	<5.0
	02/21/02	--	--	--	<50	<0.50	<0.50	<0.50	<0.50	<5.0
	05/10/02	--	--	--	<50	<0.50	<0.50	<0.50	<0.50	<5.0
	08/26/02 <sup>21</sup>	--	--	--	<50	<0.50	<0.50	<0.50	<1.0	<2.0
	QA	11/07/02 <sup>21</sup>	--	--	--	<50	<0.50	0.58	<0.50	<1.0
02/14/03 <sup>21</sup>		--	--	--	<50	<0.50	5.6 <sup>23</sup>	0.80 <sup>23</sup>	3.9 <sup>23</sup>	<2.0
05/12/03 <sup>21</sup>		--	--	--	<50	<0.50	<0.50	<0.50	<1.0	<2.0
08/11/03 <sup>21</sup>		--	--	--	<50	<0.50	<0.50	<0.50	<1.0	<2.0

**Table 1**  
**Groundwater Monitoring Data and Analytical Results**  
 Tosco (Unocal) Service Station #3292  
 15008 East 14th Street  
 San Leandro, California

**EXPLANATIONS:**

Groundwater monitoring data and laboratory analytical results prior to February 12, 1998, were compiled from reports prepared by MPDS Services, Inc.

TOC = Top of Casing (ft.) = Feet	TPH-G = Total Petroleum Hydrocarbons as Gasoline B = Benzene	ND = Not Detected -- = Not Measured/Not Analyzed
DTW = Depth to Water	T = Toluene	(SP) = Shadrall Property wells
S.I. = Screen Interval	E = Ethylbenzene	QA = Quality Assurance/Trip Blank
(ft.bgs) = Feet Below Ground Surface	X = Xylenes	
GWE = Groundwater Elevation	MTBE = Methyl tertiary butyl ether	
(msl) = Mean sea level	(ppb) = Parts per billion	

- \* TOC elevations are relative to msl, per a Benchmark located at the northwest corner of East 14th Street and 150th Avenue, (Elevation = 36.88 feet, msl).  
 TOC elevations for MW-2 (SP) and MW-3 (SP) are relative to msl, per Chevron monitoring well MW-6 used as a benchmark, (Elevation = 36.92 feet, msl).  
 East 14th Street and 150th Avenue, (Benchmark Elevation = 36.883 feet, msl). Prior to September 24, 1993, DTW measurements were taken from the top of the well covers.
- <sup>1</sup> Laboratory report indicates the hydrocarbons detected appeared to be a gasoline and non-gasoline mixture.
- <sup>2</sup> Laboratory report indicates the hydrocarbons detected did not appear to be gasoline.
- <sup>3</sup> The analytical results of the groundwater were inconsistent with the previous analytical results for this well. The laboratory re-analyzed the sample past hold time; therefore the results may be biased low.
- <sup>4</sup> The monitoring well was re-sampled on November 20, 1995. The vial containing the water sample collected from this well on November 2, 1995, was inadvertently broken by the laboratory.
- <sup>5</sup> All EPA Method 8010 constituents were ND.
- <sup>6</sup> The monitoring wells MW-8 and MW-11 were re-sampled on February 14, 1996. The vials containing the water samples collected from the wells on February 8, 1996, were inadvertently broken by the laboratory.
- <sup>7</sup> Detection limit raised. Refer to analytical reports.
- <sup>8</sup> Laboratory report indicates gasoline and unidentified hydrocarbons <C7.
- <sup>9</sup> Laboratory report indicates gasoline and discrete peaks C6-C12.
- <sup>10</sup> Laboratory report indicates gasoline and unidentified hydrocarbons C6-C8.
- <sup>11</sup> Laboratory report indicates weathered gasoline C6-C12.
- <sup>12</sup> MTBE by EPA Method 8260.
- <sup>13</sup> Laboratory report indicates unidentified hydrocarbons >C8.
- <sup>14</sup> Laboratory report indicates unidentified hydrocarbons >C6.
- <sup>15</sup> Laboratory report indicates weathered gas and unidentified hydrocarbons >C6.
- <sup>16</sup> Laboratory report indicates gasoline and unidentified hydrocarbons <C6.
- <sup>17</sup> Laboratory report indicates gasoline C6-C12.

**Table 1**  
**Groundwater Monitoring Data and Analytical Results**  
Tosco (Unocal) Service Station #3292  
15008 East 14th Street  
San Leandro, California

---

**EXPLANATIONS:** (cont)

- <sup>18</sup> MTBE by EPA Method 8260 analyzed past EPA recommended holding time.
- <sup>19</sup> Laboratory report indicates unidentified hydrocarbons C6-C12.
- <sup>20</sup> MTBE by EPA Method 8260 analyzed one day past the EPA recommended holding time; sample was inadvertently chosen for MTBE confirmation instead of MW-11.
- <sup>21</sup> TPH-G, BTEX and MTBE by EPA Method 8260.
- <sup>22</sup> Laboratory report indicates hydrocarbon pattern is present in the requested fuel quantitation range but does not resemble the pattern of the requested fuel.
- <sup>23</sup> Laboratory report indicates BTEX compounds were found in the QA sample at levels significantly greater than the reporting limits. Because many of the samples themselves were clean for these compounds, it is not likely that this contamination was introduced during transportation.

**Table 2**  
**Dissolved Oxygen Concentrations**  
Tosco (Unocal) Service Station #3292  
15008 East 14th Street  
San Leandro, California

WELL ID	DATE	@ Laboratory (mg/L)	Before Purging (mg/L) ♦	After Purging (mg/L) ♦
MW-1	11/02/95	1.80	2.83	--
	02/08/96	--	2.58	--
	05/08/96	--	--	1.92
	08/09/96	--	2.14	--
	11/07/96	--	2.11	2.18
	02/11/97	--	--	2.05
	08/05/97	--	--	1.88
	11/04/97	--	--	2.67
	02/12/98	--	2.38	--
	05/15/98	--	2.12	--
	08/12/98	--	1.77	--
	11/12/98	--	1.55	--
	03/01/99	--	1.77	--
	05/12/99	--	1.86	--
	08/11/99	--	1.93	--
	11/04/99	--	2.10	--
	02/29/00	--	2.88	--
	05/08/00	--	3.11	--
	08/08/00	--	3.27	--
	11/06/00	--	3.67	--
	02/07/01	--	3.62	--
	05/09/01	--	3.29	--
	08/24/01	--	1.97	--
	11/16/01	--	2.56	--
	02/21/02	--	1.84	--
	05/10/02	--	0.70	--
	08/26/02	--	0.90	--
	11/07/02	--	1.84	--
	02/14/03	--	2.21	--
05/12/03	--	2.01	--	
<b>08/11/03</b>	--	--	<b>1.12</b>	--
MW-2	11/02/95	2.30	2.80	--
	02/08/96	--	2.21	--
	05/08/96	--	--	3.89
	08/09/96	--	3.36	--
	11/07/96	--	1.96	1.98
	02/11/97	--	--	2.12
	08/05/97	--	--	2.38
	11/04/97	--	--	2.18
	02/12/98	--	2.04	--
	05/15/98	--	2.33	--
	08/12/98	--	2.50	--
	11/12/98	--	1.90	--
	03/01/99	--	1.82	--

**Table 2**  
**Dissolved Oxygen Concentrations**  
 Tosco (Unocal) Service Station #3292  
 15008 East 14th Street  
 San Leandro, California

WELL ID	DATE	@ Laboratory (mg/L)	Before Purging (mg/L) ♦	After Purging (mg/L) ♦
MW-2	05/12/99	--	2.32	--
(cont)	08/11/99	--	1.98	--
	11/04/99	--	1.90	--
	02/29/00	--	2.41	--
	05/08/00	--	2.14	--
	08/08/00	--	2.57	--
	11/06/00	--	1.94	--
	02/07/01	--	2.49	--
	05/09/01	--	2.66	--
	08/24/01	--	2.11	--
	11/16/01	--	2.34	--
	02/21/02	--	1.90	--
	05/10/02	--	0.80	--
	08/26/02	--	1.00	--
	11/07/02	--	1.13	--
	02/14/03	--	1.27	--
	05/12/03	--	2.18	--
	08/11/03	--	1.37	--
MW-3	11/02/95	2.20	4.98	--
	02/08/96	--	2.78	--
	05/08/96	--	--	3.73
	08/09/96	--	3.29	--
	11/07/96	--	3.15	3.98
	02/10/97	--	--	3.59
	08/05/97	--	--	2.86
	11/04/97	--	--	2.95
	02/12/98	--	3.12	--
	05/15/98	--	3.97	--
	08/12/98	--	4.21	--
	03/01/99	--	4.56	--
	03/01/99	--	5.19	--
	05/12/99	--	3.87	--
	08/11/99	--	4.10	--
	11/04/99	--	4.41	--
MW-4	11/02/95	3.00	7.91	--
	02/08/96	--	2.66	--
	05/08/96	--	--	--
	08/09/96	--	2.92	--
	11/07/96	--	4.32	4.38
	02/10/97	--	--	3.87
	08/05/97	--	--	5.12
	11/04/97	--	--	3.98



**Table 2**  
**Dissolved Oxygen Concentrations**  
 Tosco (Unocal) Service Station #3292  
 15008 East 14th Street  
 San Leandro, California

WELL ID	DATE	@ Laboratory (mg/L)	Before Purging (mg/L) ♦	After Purging (mg/L) ♦
MW-4	02/12/98	--	4.88	--
(cont)	05/15/98	--	5.13	--
	08/12/98	--	5.62	--
	11/12/98	--	5.76	--
	03/01/99	--	5.55	--
	05/12/99	--	5.64	--
	08/11/99	--	5.36	--
	11/04/99	--	4.95	--
MW-5	11/02/95	3.00	2.30	--
	02/08/96	--	2.35	--
	05/08/96	--	--	1.29
	08/09/96	--	2.19	--
	11/07/96	--	1.84	1.82
	02/10/97	--	--	2.07
	08/05/97	--	--	2.36
	11/04/97	--	--	1.99
	02/12/98	--	1.79	--
	05/15/98	--	1.66	--
	08/12/98	--	1.71	--
	11/12/98	--	1.81	--
	03/01/99	--	1.67	--
	05/12/99	--	1.73	--
	08/11/99	--	1.83	--
	11/04/99	--	1.77	--
	02/29/00	--	2.23	--
	05/08/00	--	2.58	--
	08/08/00	--	2.19	--
	11/06/00	--	1.85	--
	02/07/01	--	2.36	--
	05/09/01	--	2.18	--
	08/24/01	--	1.28	--
	11/16/01	--	1.89	--
	02/21/02	--	1.45	--
	05/10/02	--	0.50	--
	08/26/02	--	0.60	--
	11/07/02	--	1.04	--
	02/14/03	--	1.41	--
	05/12/03	--	1.69	--
	<b>08/11/03</b>	--	<b>0.97</b>	--
MW-6	11/02/95	3.80	4.55	--
	02/08/96	--	3.77	--
	05/08/96	--	--	3.40

**Table 2**  
**Dissolved Oxygen Concentrations**  
Tosco (Unocal) Service Station #3292  
15008 East 14th Street  
San Leandro, California

WELL ID	DATE	@ Laboratory (mg/L)	Before Purging (mg/L) ♦	After Purging (mg/L) ♦
MW-6	08/09/96	--	3.53	--
(cont)	11/07/96	--	3.99	4.06
	02/10/97	--	--	3.85
	08/05/97	--	--	5.37
	11/04/97	--	--	3.67
	02/12/98	--	4.05	--
	05/15/98	--	5.28	--
	08/12/98	--	4.96	--
	11/12/98	--	5.36	--
	03/01/99	--	4.97	--
	05/12/99	--	5.47	--
	08/11/99	--	5.19	--
	11/04/99	--	5.38	--
MW-7	11/02/95	--	--	--
	02/08/96	--	2.67	--
	05/08/96	--	--	2.20
	08/09/96	--	2.37	--
	11/07/96	--	2.22	2.28
	02/11/97	--	--	2.33
	08/05/97	--	--	2.69
	11/04/97	--	--	2.82
	02/12/98	--	3.24	--
	05/15/98	--	2.95	--
	08/12/98	--	3.19	--
	11/12/98	--	2.04	--
	03/01/99	--	2.64	--
	05/12/99	--	3.05	--
	08/11/99	--	2.69	--
	11/04/99	--	2.47	--
	02/29/00	--	2.31	--
	05/08/00	--	2.16	--
	08/08/00	--	1.88	--
	11/06/00	--	1.96	--
	02/07/01	--	2.08	--
	05/09/01	--	1.81	--
	08/24/01	--	1.53	--
	11/16/01	--	1.92	--
	02/21/02	--	1.79	--
	05/10/02	--	0.70	--
	08/26/02	--	0.80	--
	11/07/02	--	1.26	--
	02/14/03	--	1.16	--
	05/12/03	--	1.84	--
	08/11/03	--	1.21	--

**Table 2**  
**Dissolved Oxygen Concentrations**  
Tosco (Unocal) Service Station #3292  
15008 East 14th Street  
San Leandro, California

WELL ID	DATE	@ Laboratory (mg/L)	Before Purging (mg/L) ♦	After Purging (mg/L) ♦
MW-8	11/02/95	--	--	--
	02/08/96	--	3.85	--
	05/08/96	--	--	2.09
	08/09/96	--	2.56	--
	11/07/96	--	1.67	1.84
	02/10/97	--	--	2.10
	08/05/97	--	--	3.04
	11/04/97	--	--	2.11
	02/12/98	--	1.98	--
	05/15/98	--	2.44	--
	08/12/98	--	2.83	--
	11/12/98	--	3.16	--
	03/01/99	--	2.81	--
	05/12/99	--	2.74	--
	08/11/99	--	3.04	--
	11/04/99	--	3.41	--
	02/29/00	--	3.77	--
	05/08/00	--	3.97	--
	08/08/00	--	3.59	--
	11/06/00	--	3.71	--
	02/07/01	--	3.19	--
	05/09/01	--	3.59	--
	08/24/01	--	2.67	--
	11/16/01	--	2.64	--
	02/21/02	--	2.88	--
	05/10/02	--	0.70	--
	08/26/02	--	1.00	--
	11/07/02	--	1.74	--
	02/14/03	--	1.88	--
	05/12/03	--	2.16	--
08/11/03	--	1.89	--	
MW-9	11/02/95	--	--	--
	02/08/96	--	3.62	--
	05/08/96	--	--	2.20
	08/09/96	--	2.51	--
	11/07/96	--	2.06	2.02
	02/10/97	--	--	1.96
	08/05/97	--	--	2.57
	11/04/97	--	--	2.60
	02/12/98	--	2.27	--
	05/15/98	--	2.62	--
	08/12/98	--	1.90	--
	11/12/98	--	1.38	--
	03/01/99	--	1.78	--

**Table 2**  
**Dissolved Oxygen Concentrations**  
 Tosco (Unocal) Service Station #3292  
 15008 East 14th Street  
 San Leandro, California

WELL ID	DATE	@ Laboratory (mg/L)	Before Purging (mg/L) ♦	After Purging (mg/L) ♦
MW-9	05/12/99	--	2.26	--
(cont)	08/11/99	--	2.42	--
	11/04/99	--	2.71	--
	02/29/00	--	3.05	--
	05/08/00	--	3.77	--
	08/08/00	--	3.39	--
	11/06/00	--	4.06	--
	02/07/01	--	3.46	--
	05/09/01	--	4.33	--
	08/24/01	--	2.36	--
	11/16/01	--	2.48	--
	02/21/02	--	2.80	--
	05/10/02	--	0.60	--
	08/26/02	--	0.80	--
	11/07/02	--	1.32	--
	02/14/03	--	2.17	--
	05/12/03	--	1.94	--
	<b>08/11/03</b>	--	<b>1.72</b>	--
MW-10	11/02/95	3.10	3.96	--
	02/08/96	--	2.88	--
	05/08/96	--	--	2.71
	08/09/96	--	2.63	--
	11/07/96	--	1.81	1.84
	02/10/97	--	--	2.03
	08/05/97	--	--	2.78
	11/04/97	--	--	2.11
	02/12/98	--	2.63	--
	05/15/98	--	2.24	--
	08/12/98	--	2.43	--
	11/12/98	--	2.66	--
	03/01/99	--	3.11	--
	05/12/99	--	2.77	--
	08/11/99	--	3.21	--
	11/04/99	--	3.12	--
	02/29/00	--	2.97	--
	05/08/00	--	2.63	--
	08/08/00	--	2.73	--
	11/06/00	--	3.10	--
	02/07/01	--	3.05	--
	05/09/01	--	3.38	--
	08/24/01	--	1.74	--
	11/16/01	--	2.27	--
	02/21/02	--	2.07	--
	05/10/02	--	0.60	--

**Table 2**  
**Dissolved Oxygen Concentrations**  
 Tosco (Unocal) Service Station #3292  
 15008 East 14th Street  
 San Leandro, California

WELL ID	DATE	@ Laboratory (mg/L)	Before Purging (mg/L) ♦	After Purging (mg/L) ♦
MW-10	08/26/02	--	0.90	--
(cont)	11/07/02	--	0.97	--
	02/14/03	--	1.36	--
	05/12/03	--	1.84	--
	<b>08/11/03</b>	--	<b>0.47</b>	--
MW-11	11/02/95	2.60	3.55	--
	02/08/96	--	2.19	--
	05/08/96	--	--	2.06
	08/09/96	--	2.11	--
	11/07/96	--	2.35	2.36
	02/10/97	--	--	2.18
	08/05/97	--	--	3.19
	11/04/97	--	--	2.01
	02/12/98	--	2.44	--
	05/15/98	--	1.80	--
	08/12/98	--	2.05	--
	11/12/98	--	1.67	--
	03/01/99	--	2.03	--
	05/12/99	--	2.14	--
	08/11/99	--	2.66	--
	11/04/99	--	2.60	--
	02/29/00	--	2.47	--
	05/08/00	--	2.70	--
	08/08/00	--	2.22	--
	11/06/00	--	3.16	--
	02/07/01	--	2.56	--
	05/09/01	--	2.82	--
	08/24/01	--	2.40	--
	11/16/01	--	2.17	--
	02/21/02	--	2.72	--
	05/10/02	--	0.50	--
	08/26/02	--	0.70	--
	11/07/02	--	1.17	--
	02/14/03	--	1.08	--
	05/12/03	--	1.48	--
	<b>08/11/03</b>	--	<b>1.16</b>	--
MW-2 (SP) <sup>1</sup>	11/07/96	--	2.85	2.80
	02/11/97	--	--	2.73
	08/05/97	--	--	3.99
	11/04/97	--	--	3.06
	02/12/98	--	3.11	--
	05/15/98	--	3.97	--

**Table 2**  
**Dissolved Oxygen Concentrations**  
 Tosco (Unocal) Service Station #3292  
 15008 East 14th Street  
 San Leandro, California

WELL ID	DATE	@ Laboratory (mg/L)	Before Purging (mg/L) ♦	After Purging (mg/L) ♦
MW-2 (SP) <sup>1</sup>	08/12/98	--	3.62	--
(cont)	11/12/98	--	4.19	--
	03/01/99	--	4.56	--
	05/12/99	--	3.92	--
	08/11/99	--	4.19	--
	11/04/99	--	3.85	--
	02/29/00	--	3.21	--
	05/08/00	--	3.96	--
	08/08/00	--	3.55	--
	11/06/00	--	4.11	--
	02/07/01	--	3.80	--
	05/09/01	--	3.95	--
	08/24/01	--	3.81	--
	11/16/01	--	4.05	--
	02/21/02	--	3.70	--
	05/10/02	--	0.70	--
	08/26/02	--	1.10	--
	11/07/02	--	1.21	--
	02/14/03	--	1.35	--
	05/12/03	--	2.62	--
	<b>08/11/03</b>	--	<b>2.04</b>	--
MW-3 (SP) <sup>1</sup>	11/07/96	--	2.41	2.40
	02/11/97	--	--	2.55
	08/05/97	--	--	3.74
	11/04/97	--	--	2.95
	02/12/98	--	3.17	--
	05/15/98	--	4.06	--
	08/12/98	--	3.98	--
	11/12/98	--	3.39	--
	03/01/99	--	3.08	--
	05/12/99	--	2.77	--
	08/11/99	--	2.84	--
	11/04/99	--	2.43	--
	02/29/00	--	2.72	--
	05/08/00	--	2.22	--
	08/08/00	--	2.76	--
	11/06/00	--	2.59	--
	02/07/01	--	2.61	--
	05/09/01	--	2.36	--
	08/24/01	--	1.98	--
	11/16/01	--	2.29	--
	02/21/02	--	2.10	--
	05/10/02	--	0.60	--
	08/26/02	--	0.80	--

**Table 2**  
**Dissolved Oxygen Concentrations**  
 Tosco (Unocal) Service Station #3292  
 15008 East 14th Street  
 San Leandro, California

WELL ID	DATE	@ Laboratory (mg/L)	Before Purging (mg/L) ♦	After Purging (mg/L) ♦
MW-3 (SP) <sup>1</sup>	11/07/02	--	1.10	--
(cont)	02/14/03	--	0.96	--
	05/12/03	--	1.55	--
	08/11/03	--	1.33	--

**Table 2**  
**Dissolved Oxygen Concentrations**  
Tosco (Unocal) Service Station #3292  
15008 East 14th Street  
San Leandro, California

---

**EXPLANATIONS:**

Dissolved oxygen concentrations prior to February 12, 1998, were compiled from reports prepared by MPDS Services, Inc.

(mg/L) = Milligrams per liter

-- = Not Measured/Not Analyzed

(SP) = Shadrall Property wells

◆ Measurements taken in field.

† Wells located on Shadrall Property.



**Table 3**  
**Groundwater Analytical Results - Oxygenate Compounds**  
 Tosco (Unocal) Service Station #3292  
 15008 East 14th Street  
 San Leandro, California

WELL ID	DATE	ETHANOL (ppb)	TBA (ppb)	MTBE (ppb)	DIPE (ppb)	ETBE (ppb)	TAME (ppb)	1,2-DCA (ppb)	EDB (ppb)
MW-1	05/08/00	ND <sup>1</sup>	ND <sup>1</sup>	1,780	ND <sup>1</sup>	ND <sup>1</sup>	ND <sup>1</sup>	ND <sup>1</sup>	ND <sup>1</sup>
	08/08/00	--	--	1,990 <sup>2</sup>	--	--	--	--	--
	02/07/01	--	--	840	--	--	--	--	--
	05/09/01 <sup>2</sup>	ND <sup>1</sup>	ND <sup>1</sup>	431	ND <sup>1</sup>	ND <sup>1</sup>	ND <sup>1</sup>	ND <sup>1</sup>	ND <sup>1</sup>
	11/16/01	<2,500	380	490	<5.0	<5.0	<5.0	<5.0	<5.0
	02/21/02	<1,200	<50	170	<2.5	<2.5	<2.5	<2.5	<2.5
	08/26/02	--	--	120	--	--	--	--	--
	11/07/02	<2,500	<500	20	<10	<10	<10	<10	<10
	02/14/03	<2,500	<500	35	<10	<10	<10	<10	<10
	05/12/03	--	--	32	--	--	--	--	--
	08/11/03	<500	--	17	--	--	--	--	--
MW-2	08/26/02	--	--	<20	--	--	--	--	--
	11/07/02	<2,500	<500	<10	<10	<10	<10	<10	<10
	02/14/03	--	--	<2.0	--	--	--	--	--
	05/12/03	--	--	<2.0	--	--	--	--	--
	08/11/03	<500	--	<2.0	--	--	--	--	--
MW-5	11/07/02	<2,500	<500	<10	<10	<10	<10	<10	<10
	02/14/03	SAMPLED SEMI-ANNUALLY		--	--	--	--	--	--
	05/12/03	--	--	<100	--	--	--	--	--
MW-7	11/07/02	<500	<100	<2.0	<2.0	<2.0	<2.0	<2.0	<2.0
	02/14/03	SAMPLED SEMI-ANNUALLY		--	--	--	--	--	--
	05/12/03	--	--	<2.0	--	--	--	--	--

**Table 3**  
**Groundwater Analytical Results - Oxygenate Compounds**  
 Tosco (Unocal) Service Station #3292  
 15008 East 14th Street  
 San Leandro, California

WELL ID	DATE	ETHANOL (ppb)	TBA (ppb)	MTBE (ppb)	DIPE (ppb)	ETBE (ppb)	TAME (ppb)	1,2-DCA (ppb)	EDB (ppb)
MW-8	11/07/02	<500	<100	5.0	<2.0	<2.0	<2.0	<2.0	<2.0
	02/14/03	SAMPLED SEMI-ANNUALLY		--	--	--	--	--	--
	05/12/03	--	--	<2.0	--	--	--	--	--
MW-9	08/26/02	--	--	<2.0	--	--	--	--	--
	11/07/02	<500	<100	<2.0	<2.0	<2.0	<2.0	<2.0	<2.0
	02/14/03	--	--	<2.0	--	--	--	--	--
	05/12/03	--	--	<2.0	--	--	--	--	--
	08/11/03	<500	--	<2.0	--	--	--	--	--
MW-10	08/26/02	--	--	<20	--	--	--	--	--
	11/07/02	<2,500	<500	<10	<10	<10	<10	<10	<10
	02/14/03	--	--	<20	--	--	--	--	--
	05/12/03	--	--	4.8	--	--	--	--	--
	08/11/03	<500	--	4.0	--	--	--	--	--
MW-11	08/24/01	<5,000	<500	870	<10	<10	<10	<10	<10
	05/10/02 <sup>2</sup>	<1,000	<200	270	<4.0	<4.0	<4.0	<4.0	<4.0
	08/26/02	<500	<100	170	<2.0	<2.0	<2.0	<2.0	<2.0
	11/07/02	<2,500	<500	330	<10	<10	<10	<10	<10
	02/14/03	--	--	<2.0	--	--	--	--	--
	05/12/03	<2,500	<500	290	<10	<10	<10	<10	<10
	08/11/03	<2,500	<500	320	<10	<10	<10	<10	<10

**Table 3**  
**Groundwater Analytical Results - Oxygenate Compounds**  
 Tosco (Unocal) Service Station #3292  
 15008 East 14th Street  
 San Leandro, California

WELL ID	DATE	ETHANOL (ppb)	TBA (ppb)	MTBE (ppb)	DIPE (ppb)	ETBE (ppb)	TAME (ppb)	1,2-DCA (ppb)	EDB (ppb)
MW-2 (SP)	05/08/00	ND	ND	4.83	ND	ND	ND	ND	ND
	11/07/02	<500	<100	5.4	<2.0	<2.0	<2.0	<2.0	<2.0
	02/14/03	SAMPLED SEMI-ANNUALLY		--	--	--	--	--	--
	05/12/03	--	--	8.4	--	--	--	--	--
MW-3 (SP)	05/08/00	ND	ND	ND	ND	ND	ND	ND	ND
	11/07/02	<5,000	<1,000	<20	<20	<20	<20	<20	<20
	02/14/03	SAMPLED SEMI-ANNUALLY		--	--	--	--	--	--
	05/12/03	--	--	<2.0	--	--	--	--	--

**Table 3**  
**Groundwater Analytical Results - Oxygenate Compounds**  
Tosco (Unocal) Service Station #3292  
15008 East 14th Street  
San Leandro, California

---

**EXPLANATIONS:**

TBA = Tertiary butyl alcohol

MTBE = Methyl tertiary butyl ether

DIPE = Di-isopropyl ether

ETBE = Ethyl tertiary butyl ether

TAME = Tertiary amyl methyl ether

1,2-DCA = 1,2-Dichloroethane

EDB = Ethylene Dibromide/1,2-Dibromoethane

(ppb) = Parts per billion

-- = Not Analyzed

ND = Not Detected

<sup>1</sup> Raised detection limit. Refer to analytical reports.

<sup>2</sup> Laboratory report indicates sample was analyzed outside of the EPA recommended holding time.

**ANALYTICAL METHOD:**

EPA Method 8260 for Oxygenate Compounds

**Table 4**  
**Joint Groundwater Monitoring Data**  
Former Mobil Facility #04-FGN  
14994 East 14th Street  
San Leandro, California

WELL ID/ TOC* (ft.)	DATE	DTW (ft.)	GWE (msl)
MW-1A 36.63	02/12/98	5.52	31.11
	08/12/98	8.80	27.83
MW-2A 36.62	02/12/98	5.59	31.03
	08/12/98	8.85	27.77
MW-3A 36.93	02/12/98	5.72	31.21
	08/12/98	9.05	27.88
MW-4A 37.18	02/12/98	5.90	31.28
	08/12/98	9.21	27.97
MW-5A 35.91	02/12/98	5.32	30.59
	08/12/98	8.19	27.72
MW-6A 37.10	02/12/98	5.52	31.58
	08/12/98	8.91	28.19
MW-7A 37.39	02/12/98	6.55	30.84
	08/12/98	9.65	27.74

**EXPLANATIONS:**

Groundwater monitoring data provided by Alton Geoscience. Site monitored on a semi-annual basis.

TOC = Top of Casing

(ft.) = Feet

DTW = Depth to Water

GWE = Groundwater Elevation

(msl) = Mean sea level

\* TOC elevations have been surveyed relative to msl.

**Table 5**  
**Joint Groundwater Monitoring Data**  
Chevron Facility #9-2013  
15002 Hesperian Boulevard  
San Leandro, California

<b>WELL ID/ TOC*</b>	<b>DATE</b>	<b>DTW (ft.)</b>	<b>GWE (msl)</b>
<b>MW-1</b> 35.77	11/04/97	11.35	24.42
	05/15/98	8.11	27.66
	08/12/98	9.35	26.42
<b>MW-2</b> 35.00	11/04/97	10.70	24.30
	05/15/98	7.63	27.37
	08/12/98	8.75	26.25
<b>MW-3</b> 36.17	11/04/97	11.75	24.42
	05/15/98	8.75	27.42
	08/12/98	9.85	26.32
<b>MW-4</b> 36.05	11/04/97	11.47	24.58
	05/15/98	8.27	27.78
	08/12/98	9.40	26.65
<b>MW-5</b> 35.65	11/04/97	11.17	24.48
	05/15/98	7.92	27.73
	08/12/98	9.05	26.60
<b>MW-6</b> 36.92	11/04/97	12.42	24.50
	05/15/98	9.45	27.47
	08/12/98	10.60	26.32
<b>MW-7</b> 35.71	11/04/97	11.01	24.70
	05/15/98	8.11	27.60
	08/12/98	9.25	26.46
<b>MW-8</b> 35.28	11/04/97	10.63	24.65
	05/15/98	7.98	27.30
	08/12/98	9.00	26.28
<b>MW-A</b>	11/04/97	11.45	--
	05/15/98	8.51	--
	08/12/98	9.60	--

**Table 5**  
**Joint Groundwater Monitoring Data**  
Chevron Facility #9-2013  
15002 Hesperian Boulevard  
San Leandro, California

---

**EXPLANATIONS:**

Groundwater monitoring data provided by Blaine Tech Services, Inc. Site monitored on a semi-annual basis.

TOC = Top of Casing

(ft.) = Feet

DTW = Depth to Water

GWE = Groundwater Elevation

(msl) = Mean sea level

-- = Not Available

## STANDARD OPERATING PROCEDURE - GROUNDWATER SAMPLING

Gettler-Ryan Inc. field personnel adhere to the following procedures for the collection and handling of groundwater samples prior to analysis by the analytical laboratory. Prior to sample collection, the type of analysis to be performed is determined. Loss prevention of volatile compounds is controlled and sample preservation for subsequent analysis is maintained.

Prior to sampling, the presence or absence of free-phase hydrocarbons is determined using an interface probe. Product thickness, if present, is measured to the nearest 0.01 foot and is noted in the field notes. In addition, all depth to water level measurements are collected with a static water level indicator and are also recorded in the field notes, prior to purging and sampling any wells.

After water levels are collected and prior to sampling, temperature, pH and electrical conductivity are measured. If purging is to occur, each well is purged a minimum of three well casing volumes of water using pre-cleaned pumps (stack, suction, Grundfos), or disposable bailers. The measurements are taken a minimum of three times during the purging. Purging continues until these parameters stabilize.

Groundwater samples are collected using disposable bailers. The water samples are transferred from the bailer into appropriate containers. Pre-preserved containers, supplied by analytical laboratories, are used when possible. When pre-preserved containers are not available, the laboratory is instructed to preserve the sample as appropriate. Duplicate samples are collected for the laboratory to use in maintaining quality assurance/quality control standards. The samples are labeled to include the job number, sample identification, collection date and time, analysis, preservation (if any), and the sample collector's initials. The water samples are placed in a cooler, maintained at 4°C for transport to the laboratory. Once collected in the field, all samples are maintained under chain of custody until delivered to the laboratory.

The chain of custody document includes the job number, type of preservation, if any, analysis requested, sample identification, date and time collected, and the sample collector's name. The chain of custody is signed and dated (including time of transfer) by each person who receives or surrenders the samples, beginning with the field personnel and ending with the laboratory personnel.

A laboratory supplied trip blank accompanies each sampling set and is labeled as QA. For sampling sets greater than 20 samples, 5% trip blanks are included. The trip blank is analyzed for some or all of the same compounds as the groundwater samples.

As requested by ConocoPhillips Company, the purge water and decontamination water generated during sampling activities is transported to ConocoPhillips - San Francisco Refinery, located in Rodeo, California.





# GETTLER-RYAN INC.

## WELL MONITORING/SAMPLING FIELD DATA SHEET

Client/Facility #: ConocoPhillips #3292 Job Number: 180105  
 Site Address: 15008 East 14Th Street Event Date: 8-11-03 (inclusive)  
 City: San Leandro, CA Sampler: Joc

Well ID: MW-1  
 Well Diameter: 2 in.  
 Total Depth: 18.92 ft.  
 Depth to Water: 10.37 ft.  
8.55 x VF 0.17 = 1.45 x3 (case volume) = Estimated Purge Volume: 4.5 gal.

Date Monitored: 8-11-03 Well Condition: o.k.

Volume	3/4" = 0.02	1" = 0.04	2" = 0.17	3" = 0.38
Factor (VF)	4" = 0.66	5" = 1.02	6" = 1.50	12" = 5.80

Purge Equipment:  
 Disposable Bailer   
 Stainless Steel Bailer \_\_\_\_\_  
 Stack Pump \_\_\_\_\_  
 Suction Pump \_\_\_\_\_  
 Grundfos \_\_\_\_\_  
 Other: \_\_\_\_\_

Sampling Equipment:  
 Disposable Bailer   
 Pressure Bailer \_\_\_\_\_  
 Discrete Bailer \_\_\_\_\_  
 Other: \_\_\_\_\_

Time Started: \_\_\_\_\_ (2400 hrs)  
 Time Bailed: \_\_\_\_\_ (2400 hrs)  
 Depth to Product: \_\_\_\_\_ ft  
 Depth to Water: \_\_\_\_\_ ft  
 Hydrocarbon Thickness: 0 ft  
 Visual Confirmation/Description: \_\_\_\_\_  
 Skimmer / Absorbant Sock (circle one)  
 Amt Removed from Skimmer: \_\_\_\_\_ gal  
 Amt Removed from Well: \_\_\_\_\_ gal  
 Product Transferred to: \_\_\_\_\_

Start Time (purge): 0902 Weather Conditions: clear  
 Sample Time/Date: 0925 18-11-03 Water Color: clear Odor: yes  
 Purging Flow Rate: 0.5 gpm. Sediment Description: \_\_\_\_\_  
 Did well de-water? \_\_\_\_\_ If yes, Time: \_\_\_\_\_ Volume: \_\_\_\_\_ gal.

Time (2400 hr.)	Volume (gal.)	pH	Conductivity (u mhos/cm)	Temperature (C/E)	D.O. (mg/L)	ORP (mV)
<u>0910</u>	<u>1.5</u>	<u>6.76</u>	<u>1.51</u>	<u>64.3</u>	<u>1.12</u>	
<u>0914</u>	<u>3</u>	<u>6.87</u>	<u>1.46</u>	<u>63.7</u>		
<u>0918</u>	<u>4.5</u>	<u>6.90</u>	<u>1.42</u>	<u>63.6</u>		

### LABORATORY INFORMATION

SAMPLE ID	(#) CONTAINER	REFRIG.	PRESERV. TYPE	LABORATORY	ANALYSES
<u>MW-1</u>	<u>3 x vial</u>	<u>YES</u>	<u>HCL</u>	<u>STL Pleasanton</u>	<u>TPH-G/BTEX/MTBE/ETHANOL(8260)</u>

COMMENTS: \_\_\_\_\_

Add/Replaced Lock: \_\_\_\_\_ Add/Replaced Plug: \_\_\_\_\_ Size: \_\_\_\_\_



# GETTLER-RYAN INC.

## WELL MONITORING/SAMPLING FIELD DATA SHEET

Client/Facility #: ConocoPhillips #3292 Job Number: 180105  
 Site Address: 15008 East 14Th Street Event Date: 8-11-03 (inclusive)  
 City: San Leandro, CA Sampler: Soe

Well ID: MW-2 Date Monitored: 8-11-03 Well Condition: o.k

Well Diameter: 2 in.

Total Depth: 19.14 ft.

Depth to Water: 10.51 ft.

Volume	3/4" = 0.02	1" = 0.04	2" = 0.17	3" = 0.38
Factor (VF)	4" = 0.66	5" = 1.02	6" = 1.50	12" = 5.80

8.63 x VF 0.17 = 1.47 x3 (case volume) = Estimated Purge Volume: 4.5 gal.

Purge Equipment:  
 Disposable Bailer   
 Stainless Steel Bailer \_\_\_\_\_  
 Stack Pump \_\_\_\_\_  
 Suction Pump \_\_\_\_\_  
 Grundfos \_\_\_\_\_  
 Other: \_\_\_\_\_

Sampling Equipment:  
 Disposable Bailer   
 Pressure Bailer \_\_\_\_\_  
 Discrete Bailer \_\_\_\_\_  
 Other: \_\_\_\_\_

Time Started: \_\_\_\_\_ (2400 hrs)  
 Time Bailed: \_\_\_\_\_ (2400 hrs)  
 Depth to Product: \_\_\_\_\_ ft  
 Depth to Water: \_\_\_\_\_ ft  
 Hydrocarbon Thickness: 0 ft  
 Visual Confirmation/Description: \_\_\_\_\_  
 Skimmer / Absorbant Sock (circle one)  
 Amt Removed from Skimmer: \_\_\_\_\_ gal  
 Amt Removed from Well: \_\_\_\_\_ gal  
 Product Transferred to: \_\_\_\_\_

Start Time (purge): 0745 Weather Conditions: clear  
 Sample Time/Date: 0815 18-11-03 Water Color: clear Odor: yes  
 Purging Flow Rate: 0.5 gpm. Sediment Description: \_\_\_\_\_  
 Did well de-water? \_\_\_\_\_ If yes, Time: \_\_\_\_\_ Volume: \_\_\_\_\_ gal.

Time (2400 hr.)	Volume (gal.)	pH	Conductivity (u mhos/cm)	Temperature (CIE)	D.O. (mg/L)	ORP (mV)
<u>0754</u>	<u>1.5</u>	<u>7.07</u>	<u>3.04</u>	<u>65.0</u>	<u>1.37</u>	
<u>0759</u>	<u>3</u>	<u>6.90</u>	<u>2.68</u>	<u>64.7</u>		
<u>0803</u>	<u>4.5</u>	<u>6.95</u>	<u>2.71</u>	<u>64.2</u>		

### LABORATORY INFORMATION

SAMPLE ID	(#) CONTAINER	REFRIG.	PRESERV. TYPE	LABORATORY	ANALYSES
<u>MW-2</u>	<u>3 x vva vial</u>	<u>YES</u>	<u>HCL</u>	<u>STL Pleasanton</u>	<u>TPH-G/BTEX/MTBE/ETHANOL(8260)</u>

COMMENTS: \_\_\_\_\_  
 \_\_\_\_\_  
 \_\_\_\_\_

Add/Replaced Lock: \_\_\_\_\_ Add/Replaced Plug: \_\_\_\_\_ Size: \_\_\_\_\_



# GETTLER-RYAN INC.

## WELL MONITORING/SAMPLING FIELD DATA SHEET

Client/Facility #: ConocoPhillips #3292 Job Number: 180105  
 Site Address: 15008 East 14Th Street Event Date: 8-11-03 (inclusive)  
 City: San Leandro, CA Sampler: Joe

Well ID: MW-3 Date Monitored: 8-11-03 Well Condition: o.k.  
 Well Diameter: 2 in.  
 Total Depth: 22.14 ft.  
 Depth to Water: 10.64 ft.

Volume	3/4"= 0.02	1"= 0.04	2"= 0.17	3"= 0.38
Factor (VF)	4"= 0.66	5"= 1.02	6"= 1.50	12"= 5.80

xVF 0.66 = \_\_\_\_\_ x3 (case volume) = Estimated Purge Volume: \_\_\_\_\_ gal.

<b>Purge Equipment:</b>	<b>Sampling Equipment:</b>	<b>Time Started:</b> _____ (2400 hrs)
Disposable Bailer _____	Disposable Bailer _____	Time Bailed: _____ (2400 hrs)
Stainless Steel Bailer _____	Pressure Bailer _____	Depth to Product: _____ ft
Stack Pump _____	Discrete Bailer _____	Depth to Water: _____ ft
Suction Pump _____	Other: _____	Hydrocarbon Thickness: <u>0</u> ft
Grundfos _____		Visual Confirmation/Description: _____
Other: _____		Skimmer / Absorbant Sock (circle one)
		Amt Removed from Skimmer: _____ gal
		Amt Removed from Well: _____ gal
		Product Transferred to: _____

Start Time (purge): \_\_\_\_\_ Weather Conditions: \_\_\_\_\_  
 Sample Time/Date: 1 Water Color: \_\_\_\_\_ Odor: \_\_\_\_\_  
 Purging Flow Rate: \_\_\_\_\_ gpm. Sediment Description: \_\_\_\_\_  
 Did well de-water? \_\_\_\_\_ If yes, Time: \_\_\_\_\_ Volume: \_\_\_\_\_ gal.

Time (2400 hr.)	Volume (gal.)	pH	Conductivity (umhos/cm)	Temperature (C/F)	D.O. (mg/L)	ORP (mV)
_____	_____	_____	_____	_____	_____	_____
_____	_____	_____	_____	_____	_____	_____
_____	_____	_____	_____	_____	_____	_____
_____	_____	_____	_____	_____	_____	_____
_____	_____	_____	_____	_____	_____	_____

### LABORATORY INFORMATION

SAMPLE ID	(#) CONTAINER	REFRIG.	PRESERV. TYPE	LABORATORY	ANALYSES
MW-	x voa vial	YES	HCL	STL Pleasanton	TPH-G/BTEX/MTBE/ETHANOL(8260)

COMMENTS: M. on 14

Add/Replaced Lock: \_\_\_\_\_ Add/Replaced Plug: \_\_\_\_\_ Size: \_\_\_\_\_



# GETTLER - RYAN INC.

## WELL MONITORING/SAMPLING FIELD DATA SHEET

Client/Facility #: ConocoPhillips #3292 Job Number: 180105  
 Site Address: 15008 East 14Th Street Event Date: 8-11-03 (inclusive)  
 City: San Leandro, CA Sampler: Soc

Well ID: MW-4 Date Monitored: 8-11-03 Well Condition: o/c  
 Well Diameter: 2 in.  
 Total Depth: 19.56 ft.  
 Depth to Water: 10.83 ft.  
 xVF = \_\_\_\_\_ x3 (case volume) = Estimated Purge Volume: \_\_\_\_\_ gal.

Volume	3/4"= 0.02	1"= 0.04	2"= 0.17	3"= 0.38
Factor (VF)	4"= 0.66	5"= 1.02	6"= 1.50	12"= 5.80

**Purge Equipment:**  
 Disposable Bailer \_\_\_\_\_  
 Stainless Steel Bailer \_\_\_\_\_  
 Stack Pump \_\_\_\_\_  
 Suction Pump \_\_\_\_\_  
 Grundfos \_\_\_\_\_  
 Other: \_\_\_\_\_

**Sampling Equipment:**  
 Disposable Bailer \_\_\_\_\_  
 Pressure Bailer \_\_\_\_\_  
 Discrete Bailer \_\_\_\_\_  
 Other: \_\_\_\_\_

Time Started: \_\_\_\_\_ (2400 hrs)  
 Time Bailed: \_\_\_\_\_ (2400 hrs)  
 Depth to Product: \_\_\_\_\_ ft  
 Depth to Water: \_\_\_\_\_ ft  
 Hydrocarbon Thickness: 0 ft  
 Visual Confirmation/Description: \_\_\_\_\_  
 Skimmer / Absorbent Sock (circle one)  
 Amt Removed from Skimmer: \_\_\_\_\_ gal  
 Amt Removed from Well: \_\_\_\_\_ gal  
 Product Transferred to: \_\_\_\_\_

Start Time (purge): \_\_\_\_\_ Weather Conditions: \_\_\_\_\_  
 Sample Time/Date: 1 Water Color: \_\_\_\_\_ Odor: \_\_\_\_\_  
 Purging Flow Rate: \_\_\_\_\_ gpm. Sediment Description: \_\_\_\_\_  
 Did well de-water? \_\_\_\_\_ If yes, Time: \_\_\_\_\_ Volume: \_\_\_\_\_ gal.

Time (2400 hr.)	Volume (gal.)	pH	Conductivity (umhos/cm)	Temperature (C/F)	D.O. (mg/L)	ORP (mV)

### LABORATORY INFORMATION

SAMPLE ID	(#) CONTAINER	REFRIG.	PRESERV. TYPE	LABORATORY	ANALYSES
MW-	x voa vial	YES	HCL	STL Pleasanton	TPH-G/BTEX/MTBE/ETHANOL(8260)

COMMENTS: m. only - (100)

Add/Replaced Lock: \_\_\_\_\_ Add/Replaced Plug: \_\_\_\_\_ Size: \_\_\_\_\_



# GETTLER - RYAN INC.

## WELL MONITORING/SAMPLING FIELD DATA SHEET

Client/Facility #: ConocoPhillips #3292 Job Number: 180105  
 Site Address: 15008 East 14Th Street Event Date: 8-11-03 (inclusive)  
 City: San Leandro, CA Sampler: See

Well ID: MW-5  
 Well Diameter: 2 in.  
 Total Depth: 92.13 ft.  
 Depth to Water: 10.52 ft.

Date Monitored: 8-11-03 Well Condition: o.k.

Volume	3/4"= 0.02	1"= 0.04	2"= 0.17	3"= 0.38
Factor (VF)	4"= 0.66	5"= 1.02	6"= 1.50	12"= 5.80

xVF \_\_\_\_\_ = \_\_\_\_\_ x3 (case volume) = Estimated Purge Volume: \_\_\_\_\_ gal.

### Purge Equipment:

Disposable Bailer \_\_\_\_\_  
 Stainless Steel Bailer \_\_\_\_\_  
 Stack Pump \_\_\_\_\_  
 Suction Pump \_\_\_\_\_  
 Grundfos \_\_\_\_\_  
 Other: \_\_\_\_\_

### Sampling Equipment:

Disposable Bailer   
 Pressure Bailer \_\_\_\_\_  
 Discrete Bailer \_\_\_\_\_  
 Other: \_\_\_\_\_

Time Started: \_\_\_\_\_ (2400 hrs)  
 Time Bailed: \_\_\_\_\_ (2400 hrs)  
 Depth to Product: \_\_\_\_\_ ft  
 Depth to Water: \_\_\_\_\_ ft  
 Hydrocarbon Thickness: 0 ft  
 Visual Confirmation/Description: \_\_\_\_\_  
 Skimmer / Absorbant Sock (circle one)  
 Amt Removed from Skimmer: \_\_\_\_\_ gal  
 Amt Removed from Well: \_\_\_\_\_ gal  
 Product Transferred to: \_\_\_\_\_

Start Time (purge): \_\_\_\_\_ Weather Conditions: \_\_\_\_\_  
 Sample Time/Date: 1 Water Color: \_\_\_\_\_ Odor: \_\_\_\_\_  
 Purging Flow Rate: \_\_\_\_\_ gpm. Sediment Description: \_\_\_\_\_  
 Did well de-water? \_\_\_\_\_ If yes, Time: \_\_\_\_\_ Volume: \_\_\_\_\_ gal.

Time (2400 hr.)	Volume (gal.)	pH	Conductivity (u mhos/cm)	Temperature (C/F)	D.O. (mg/L)	ORP (mV)
					<u>0.97</u>	

### LABORATORY INFORMATION

SAMPLE ID	(#) CONTAINER	REFRIG.	PRESERV. TYPE	LABORATORY	ANALYSES
MW-	x voa vial	YES	HCL	STL Pleasanton	TPH-G/BTEX/MTBE/ETHANOL(8260)

COMMENTS: n. only

Add/Replaced Lock: \_\_\_\_\_ Add/Replaced Plug: \_\_\_\_\_ Size: \_\_\_\_\_



# GETTLER-RYAN INC.

## WELL MONITORING/SAMPLING FIELD DATA SHEET

Client/Facility #: ConocoPhillips #3292 Job Number: 180105  
 Site Address: 15008 East 14Th Street Event Date: 8-11-03 (inclusive)  
 City: San Leandro, CA Sampler: Joe

Well ID: MW-6 Date Monitored: 8-11-03 Well Condition: o.k  
 Well Diameter: 2 in.  
 Total Depth: 20.15 ft.  
 Depth to Water: 9.44 ft.

Volume	3/4"= 0.02	1"= 0.04	2"= 0.17	3"= 0.38
Factor (VF)	4"= 0.66	5"= 1.02	6"= 1.50	12"= 5.80

xVF \_\_\_\_\_ = \_\_\_\_\_ x3 (case volume) = Estimated Purge Volume: \_\_\_\_\_ gal.

### Purge Equipment:

Disposable Bailer \_\_\_\_\_  
 Stainless Steel Bailer \_\_\_\_\_  
 Stack Pump \_\_\_\_\_  
 Suction Pump \_\_\_\_\_  
 Grundfos \_\_\_\_\_  
 Other: \_\_\_\_\_

### Sampling Equipment:

Disposable Bailer \_\_\_\_\_  
 Pressure Bailer \_\_\_\_\_  
 Discrete Bailer \_\_\_\_\_  
 Other: \_\_\_\_\_

Time Started: \_\_\_\_\_ (2400 hrs)  
 Time Bailed: \_\_\_\_\_ (2400 hrs)  
 Depth to Product: \_\_\_\_\_ ft  
 Depth to Water: \_\_\_\_\_ ft  
 Hydrocarbon Thickness: 0 ft  
 Visual Confirmation/Description: \_\_\_\_\_  
 Skimmer / Absorbent Sock (circle one)  
 Amt Removed from Skimmer: \_\_\_\_\_ gal  
 Amt Removed from Well: \_\_\_\_\_ gal  
 Product Transferred to: \_\_\_\_\_

Start Time (purge): \_\_\_\_\_ Weather Conditions: \_\_\_\_\_  
 Sample Time/Date: 1 Water Color: \_\_\_\_\_ Odor: \_\_\_\_\_  
 Purging Flow Rate: \_\_\_\_\_ gpm. Sediment Description: \_\_\_\_\_  
 Did well de-water? \_\_\_\_\_ If yes, Time: \_\_\_\_\_ Volume: \_\_\_\_\_ gal.

Time (2400 hr.)	Volume (gal.)	pH	Conductivity (u mhos/cm)	Temperature (C/F)	D.O. (mg/L)	ORP (mV)
_____	_____	_____	_____	_____	_____	_____
_____	_____	_____	_____	_____	_____	_____
_____	_____	_____	_____	_____	_____	_____
_____	_____	_____	_____	_____	_____	_____
_____	_____	_____	_____	_____	_____	_____

### LABORATORY INFORMATION

SAMPLE ID	(#) CONTAINER	REFRIG.	PRESERV. TYPE	LABORATORY	ANALYSES
MW-	x voa vial	YES	HCL	STL Pleasanton	TPH-G/BTEX/MTBE/ETHANOL(8260)

COMMENTS: vw only ~~10/10~~

Add/Replaced Lock: \_\_\_\_\_ Add/Replaced Plug: \_\_\_\_\_ Size: \_\_\_\_\_



# GETTLER-RYAN INC.

## WELL MONITORING/SAMPLING FIELD DATA SHEET

Client/Facility #: ConocoPhillips #3292 Job Number: 180105  
 Site Address: 15008 East 14Th Street Event Date: 8-11-03 (inclusive)  
 City: San Leandro, CA Sampler: SOE

Well ID: MW-7 Date Monitored: 8-11-03 Well Condition: O.I.C.  
 Well Diameter: 2 in.  
 Total Depth: 21.25 ft.  
 Depth to Water: 10.27 ft.

Volume Factor (VF)	3/4"= 0.02	1"= 0.04	2"= 0.17	3"= 0.38
	4"= 0.66	5"= 1.02	6"= 1.50	12"= 5.80

xVF \_\_\_\_\_ = \_\_\_\_\_ x3 (case volume) = Estimated Purge Volume: \_\_\_\_\_ gal.

<b>Purge Equipment:</b>	<b>Sampling Equipment:</b>	<b>Time Started:</b> _____ (2400 hrs)
Disposable Bailer _____	Disposable Bailer _____	<b>Time Bailed:</b> _____ (2400 hrs)
Stainless Steel Bailer _____	Pressure Bailer _____	<b>Depth to Product:</b> _____ ft
Stack Pump _____	Discrete Bailer _____	<b>Depth to Water:</b> _____ ft
Suction Pump _____	Other: _____	<b>Hydrocarbon Thickness:</b> <u>0</u> ft
Grundfos _____		<b>Visual Confirmation/Description:</b> _____
Other: _____		<b>Skimmer / Absorbant Sock (circle one)</b>
		<b>Amt Removed from Skimmer:</b> _____ gal
		<b>Amt Removed from Well:</b> _____ gal
		<b>Product Transferred to:</b> _____

Start Time (purge): \_\_\_\_\_ Weather Conditions: \_\_\_\_\_  
 Sample Time/Date: 1 Water Color: \_\_\_\_\_ Odor: \_\_\_\_\_  
 Purging Flow Rate: \_\_\_\_\_ gpm. Sediment Description: \_\_\_\_\_  
 Did well de-water? \_\_\_\_\_ If yes, Time: \_\_\_\_\_ Volume: \_\_\_\_\_ gal.

Time (2400 hr.)	Volume (gal.)	pH	Conductivity (µmhos/cm)	Temperature (C/F)	D.O. (mg/L)	ORP (mV)
					<u>1.21</u>	

### LABORATORY INFORMATION

SAMPLE ID	(#) CONTAINER	REFRIG.	PRESERV. TYPE	LABORATORY	ANALYSES
MW-	x voa vial	YES	HCL	STL Pleasanton	TPH-G/BTEX/MTBE/ETHANOL(8260)

COMMENTS: m-only + DO

Add/Replaced Lock: \_\_\_\_\_ Add/Replaced Plug: \_\_\_\_\_ Size: \_\_\_\_\_



# GETTLER - RYAN INC.

## WELL MONITORING/SAMPLING FIELD DATA SHEET

Client/Facility #: ConocoPhillips #3292  
 Site Address: 15008 East 14Th Street  
 City: San Leandro, CA

Job Number: 180105  
 Event Date: 8-11-03 (inclusive)  
 Sampler: Joc

Well ID: MW-8  
 Well Diameter: 2 in.  
 Total Depth: 19.10 ft.  
 Depth to Water: 11.33 ft.

Date Monitored: 8-11-03 Well Condition: o-k

Volume	3/4"= 0.02	1"= 0.04	2"= 0.17	3"= 0.38
Factor (VF)	4"= 0.66	5"= 1.02	6"= 1.50	12"= 5.80

xVF \_\_\_\_\_ = \_\_\_\_\_ x3 (case volume) = Estimated Purge Volume: \_\_\_\_\_ gal.

### Purge Equipment:

Disposable Bailer \_\_\_\_\_  
 Stainless Steel Bailer \_\_\_\_\_  
 Stack Pump \_\_\_\_\_  
 Suction Pump \_\_\_\_\_  
 Grundfos \_\_\_\_\_  
 Other: \_\_\_\_\_

### Sampling Equipment:

Disposable Bailer \_\_\_\_\_  
 Pressure Bailer \_\_\_\_\_  
 Discrete Bailer \_\_\_\_\_  
 Other: \_\_\_\_\_

Time Started: \_\_\_\_\_ (2400 hrs)  
 Time Bailed: \_\_\_\_\_ (2400 hrs)  
 Depth to Product: \_\_\_\_\_ ft  
 Depth to Water: \_\_\_\_\_ ft  
 Hydrocarbon Thickness: 0 ft  
 Visual Confirmation/Description: \_\_\_\_\_  
 Skimmer / Absorbant Sock (circle one)  
 Amt Removed from Skimmer: \_\_\_\_\_ gal  
 Amt Removed from Well: \_\_\_\_\_ gal  
 Product Transferred to: \_\_\_\_\_

Start Time (purge): \_\_\_\_\_ Weather Conditions: \_\_\_\_\_  
 Sample Time/Date: 1 Water Color: \_\_\_\_\_ Odor: \_\_\_\_\_  
 Purging Flow Rate: \_\_\_\_\_ gpm. Sediment Description: \_\_\_\_\_  
 Did well de-water? \_\_\_\_\_ If yes, Time: \_\_\_\_\_ Volume: \_\_\_\_\_ gal.

Time (2400 hr.)	Volume (gal.)	pH	Conductivity (u mhos/cm)	Temperature (C/F)	D.O. (mg/L)	ORP (mV)
					<u>1.89</u>	

### LABORATORY INFORMATION

SAMPLE ID	(#) CONTAINER	REFRIG.	PRESERV. TYPE	LABORATORY	ANALYSES
MW-	x voa vial	YES	HCL	STL Pleasanton	TPH-G/BTEX/MTBE/ETHANOL(8260)

COMMENTS: m. only + DO

Add/Replaced Lock: \_\_\_\_\_

Add/Replaced Plug: \_\_\_\_\_ Size: \_\_\_\_\_





# GETTLER - RYAN INC.

## WELL MONITORING/SAMPLING FIELD DATA SHEET

Client/Facility #: ConocoPhillips #3292 Job Number: 180105  
 Site Address: 15008 East 14Th Street Event Date: 8-11-03 (inclusive)  
 City: San Leandro, CA Sampler: Soe

Well ID: MW-9 Date Monitored: 8-11-03 Well Condition: o.k.  
 Well Diameter: 2 in.  
 Total Depth: 19.12 ft.  
 Depth to Water: 11.18 ft.  
7.94 xVF 0.17 = 1.35 x3 (case volume) = Estimated Purge Volume: 4 gal.

Volume	3/4" = 0.02	1" = 0.04	2" = 0.17	3" = 0.38
Factor (VF)	4" = 0.66	5" = 1.02	6" = 1.50	12" = 5.80

Purge Equipment:  
 Disposable Bailer   
 Stainless Steel Bailer \_\_\_\_\_  
 Stack Pump \_\_\_\_\_  
 Suction Pump \_\_\_\_\_  
 Grundfos \_\_\_\_\_  
 Other: \_\_\_\_\_

Sampling Equipment:  
 Disposable Bailer   
 Pressure Bailer \_\_\_\_\_  
 Discrete Bailer \_\_\_\_\_  
 Other: \_\_\_\_\_

Time Started: \_\_\_\_\_ (2400 hrs)  
 Time Bailed: \_\_\_\_\_ (2400 hrs)  
 Depth to Product: \_\_\_\_\_ ft  
 Depth to Water: \_\_\_\_\_ ft  
 Hydrocarbon Thickness: 0 ft  
 Visual Confirmation/Description: \_\_\_\_\_  
 Skimmer / Absorbant Sock (circle one)  
 Amt Removed from Skimmer: \_\_\_\_\_ gal  
 Amt Removed from Well: \_\_\_\_\_ gal  
 Product Transferred to: \_\_\_\_\_

Start Time (purge): 0633 Weather Conditions: clear  
 Sample Time/Date: 0658 / 8-11-03 Water Color: clear Odor: yes  
 Purging Flow Rate: 6.5 gpm. Sediment Description: \_\_\_\_\_  
 Did well de-water? \_\_\_\_\_ If yes, Time: \_\_\_\_\_ Volume: \_\_\_\_\_ gal.

Time (2400 hr.)	Volume (gal.)	pH	Conductivity (u mhos/cm)	Temperature (C/F)	D.O. (mg/L)	ORP (mV)
<u>0640</u>	<u>1</u>	<u>6.57</u>	<u>231</u>	<u>63.7</u>	<u>1.72</u>	
<u>0643</u>	<u>2.5</u>	<u>6.56</u>	<u>236</u>	<u>63.5</u>		
<u>0649</u>	<u>4</u>	<u>6.62</u>	<u>218</u>	<u>63.6</u>		

### LABORATORY INFORMATION

SAMPLE ID	(#) CONTAINER	REFRIG.	PRESERV. TYPE	LABORATORY	ANALYSES
<u>MW-9</u>	<u>3 x voa vial</u>	<u>YES</u>	<u>HCL</u>	<u>STL Pleasanton</u>	<u>TPH-G/BTEX/MTBE/ETHANOL(8260)</u>

COMMENTS: \_\_\_\_\_

Add/Replaced Lock: \_\_\_\_\_ Add/Replaced Plug: \_\_\_\_\_ Size: \_\_\_\_\_



# GETTLER-RYAN INC.

## WELL MONITORING/SAMPLING FIELD DATA SHEET

Client/Facility #: ConocoPhillips #3292 Job Number: 180105  
 Site Address: 15008 East 14Th Street Event Date: 8-11-03 (inclusive)  
 City: San Leandro, CA Sampler: JSL

Well ID: MW-10 Date Monitored: 8-11-03 Well Condition: o.k.

Well Diameter: 2 in.

Total Depth: 19.93 ft.

Depth to Water: 11.25 ft.

Volume	3/4"= 0.02	1"= 0.04	2"= 0.17	3"= 0.38
Factor (VF)	4"= 0.66	5"= 1.02	6"= 1.50	12"= 5.80

8.68 xVF 0.17 = 1.48 x3 (case volume) = Estimated Purge Volume: 4.5 gal.

### Purge Equipment:

Disposable Bailer   
 Stainless Steel Bailer \_\_\_\_\_  
 Stack Pump \_\_\_\_\_  
 Suction Pump \_\_\_\_\_  
 Grundfos \_\_\_\_\_  
 Other: \_\_\_\_\_

### Sampling Equipment:

Disposable Bailer   
 Pressure Bailer \_\_\_\_\_  
 Discrete Bailer \_\_\_\_\_  
 Other: \_\_\_\_\_

Time Started: \_\_\_\_\_ (2400 hrs)  
 Time Bailed: \_\_\_\_\_ (2400 hrs)  
 Depth to Product: \_\_\_\_\_ ft  
 Depth to Water: \_\_\_\_\_ ft  
 Hydrocarbon Thickness: 0 ft  
 Visual Confirmation/Description: \_\_\_\_\_  
 Skimmer / Absorbant Sock (circle one)  
 Amt Removed from Skimmer: \_\_\_\_\_ gal  
 Amt Removed from Well: \_\_\_\_\_ gal  
 Product Transferred to: \_\_\_\_\_

Start Time (purge): 0830 Weather Conditions: clear  
 Sample Time/Date: 0853 18-11-03 Water Color: clear Odor: yes  
 Purging Flow Rate: 0.5 gpm. Sediment Description: \_\_\_\_\_  
 Did well de-water? \_\_\_\_\_ If yes, Time: \_\_\_\_\_ Volume: \_\_\_\_\_ gal.

Time (2400 hr.)	Volume (gal.)	pH	Conductivity (umhos/cm)	Temperature (C/F)	D.O. (mg/L)	ORP (mV)
<u>0836</u>	<u>1.5</u>	<u>7.10</u>	<u>1.27</u>	<u>63.3</u>	<u>0.47</u>	
<u>0840</u>	<u>3</u>	<u>6.98</u>	<u>1.89</u>	<u>63.4</u>		
<u>0844</u>	<u>4.5</u>	<u>6.52</u>	<u>0.92</u>	<u>63.7</u>		

### LABORATORY INFORMATION

SAMPLE ID	(#) CONTAINER	REFRIG.	PRESERV. TYPE	LABORATORY	ANALYSES
<u>MW-10</u>	<u>3 x vva vial</u>	<u>YES</u>	<u>HCL</u>	<u>STL Pleasanton</u>	<u>TPH-G/BTEX/MTBE/ETHANOL(8260)</u>

### COMMENTS:

Add/Replaced Lock: \_\_\_\_\_ Add/Replaced Plug: \_\_\_\_\_ Size: \_\_\_\_\_



# GETTLER-RYAN INC.

## WELL MONITORING/SAMPLING FIELD DATA SHEET

Client/Facility #: ConocoPhillips #3292 Job Number: 180105  
 Site Address: 15008 East 14Th Street Event Date: 8-11-03 (inclusive)  
 City: San Leandro, CA Sampler: SoC

Well ID: MW-11 Date Monitored: 8-11-03 Well Condition: OK  
 Well Diameter: 2 in.  
 Total Depth: 19.02 ft.  
 Depth to Water: 11.04 ft.  
7.98 xVF 0.17 = 1.36 x3 (case volume) = Estimated Purge Volume: 4.5 gal.

Volume Factor (VF)	3/4" = 0.02	1" = 0.04	2" = 0.17	3" = 0.38
	4" = 0.66	5" = 1.02	6" = 1.50	12" = 5.80

**Purge Equipment:**  
 Disposable Bailer   
 Stainless Steel Bailer \_\_\_\_\_  
 Stack Pump \_\_\_\_\_  
 Suction Pump \_\_\_\_\_  
 Grundfos \_\_\_\_\_  
 Other: \_\_\_\_\_

**Sampling Equipment:**  
 Disposable Bailer   
 Pressure Bailer \_\_\_\_\_  
 Discrete Bailer \_\_\_\_\_  
 Other: \_\_\_\_\_

Time Started: \_\_\_\_\_ (2400 hrs)  
 Time Bailed: \_\_\_\_\_ (2400 hrs)  
 Depth to Product: \_\_\_\_\_ ft  
 Depth to Water: \_\_\_\_\_ ft  
 Hydrocarbon Thickness: 0 ft  
 Visual Confirmation/Description: \_\_\_\_\_  
 Skimmer / Absorbant Sock (circle one)  
 Amt Removed from Skimmer: \_\_\_\_\_ gal  
 Amt Removed from Well: \_\_\_\_\_ gal  
 Product Transferred to: \_\_\_\_\_

Start Time (purge): 0710 Weather Conditions: clear  
 Sample Time/Date: 0735 18-11-03 Water Color: clear Odor: yes  
 Purging Flow Rate: 0.5 gpm. Sediment Description: \_\_\_\_\_  
 Did well de-water? \_\_\_\_\_ If yes, Time: \_\_\_\_\_ Volume: \_\_\_\_\_ gal.

Time (2400 hr.)	Volume (gal.)	pH	Conductivity (u mhos/cm) x 10 <sup>3</sup>	Temperature (C/F)	D.O. (mg/L)	ORP (mV)
<u>0718</u>	<u>1.5</u>	<u>6.77</u>	<u>2.97</u>	<u>65.2</u>	<u>1.16</u>	
<u>0721</u>	<u>3</u>	<u>6.83</u>	<u>3.10</u>	<u>65.1</u>		
<u>0725</u>	<u>4.5</u>	<u>6.92</u>	<u>3.85</u>	<u>65.7</u>		

### LABORATORY INFORMATION

SAMPLE ID	(#) CONTAINER	REFRIG.	PRESERV. TYPE	LABORATORY	ANALYSES
<u>MW-11</u>	<u>3</u> x vov vial	<u>YES</u>	<u>HCL</u>	<u>STL Pleasanton</u>	<u>TPH-G/BTEX/MTBE/ETHANOL(8260)</u>

COMMENTS: \_\_\_\_\_  
 \_\_\_\_\_  
 \_\_\_\_\_

Add/Replaced Lock: \_\_\_\_\_ Add/Replaced Plug: \_\_\_\_\_ Size: \_\_\_\_\_



# GETTLER-RYAN INC.

## WELL MONITORING/SAMPLING FIELD DATA SHEET

Client/Facility #: ConocoPhillips #3292 Job Number: 180105  
 Site Address: 15008 East 14Th Street Event Date: 8-11-03 (inclusive)  
 City: San Leandro, CA Sampler: Soe

Well ID: MW-2(SP) Date Monitored: 8-11-03 Well Condition: o.k.  
 Well Diameter: 2 in.  
 Total Depth: 20.85 ft.  
 Depth to Water: 10.87 ft.

Volume	3/4"= 0.02	1"= 0.04	2"= 0.17	3"= 0.38
Factor (VF)	4"= 0.66	5"= 1.02	6"= 1.50	12"= 5.80

xVF \_\_\_\_\_ = \_\_\_\_\_ x3 (case volume) = Estimated Purge Volume: \_\_\_\_\_ gal.

### Purge Equipment:

Disposable Bailer \_\_\_\_\_  
 Stainless Steel Bailer \_\_\_\_\_  
 Stack Pump \_\_\_\_\_  
 Suction Pump \_\_\_\_\_  
 Grundfos \_\_\_\_\_  
 Other: \_\_\_\_\_

### Sampling Equipment:

Disposable Bailer \_\_\_\_\_  
 Pressure Bailer \_\_\_\_\_  
 Discrete Bailer \_\_\_\_\_  
 Other: \_\_\_\_\_

Time Started: \_\_\_\_\_ (2400 hrs)  
 Time Bailed: \_\_\_\_\_ (2400 hrs)  
 Depth to Product: \_\_\_\_\_ ft  
 Depth to Water: \_\_\_\_\_ ft  
 Hydrocarbon Thickness: \_\_\_\_\_ ft  
 Visual Confirmation/Description: \_\_\_\_\_  
 Skimmer / Absorbant Sock (circle one)  
 Amt Removed from Skimmer: \_\_\_\_\_ gal  
 Amt Removed from Well: \_\_\_\_\_ gal  
 Product Transferred to: \_\_\_\_\_

Start Time (purge): \_\_\_\_\_ Weather Conditions: \_\_\_\_\_  
 Sample Time/Date: 1 Water Color: \_\_\_\_\_ Odor: \_\_\_\_\_  
 Purging Flow Rate: \_\_\_\_\_ gpm. Sediment Description: \_\_\_\_\_  
 Did well de-water? \_\_\_\_\_ If yes, Time: \_\_\_\_\_ Volume: \_\_\_\_\_ gal.

Time (2400 hr.)	Volume (gal)	pH	Conductivity (u mhos/cm)	Temperature (C/F)	D.O. (mg/L)	ORP (mV)
					<u>2.04</u>	

### LABORATORY INFORMATION

SAMPLE ID	(#) CONTAINER	REFRIG.	PRESERV. TYPE	LABORATORY	ANALYSES
MW-	x vob vial	YES	HCL	STL Pleasanton	TPH-G/BTEX/MTBE/ETHANOL(8260)

COMMENTS: M-only + DO

Add/Replaced Lock: \_\_\_\_\_ Add/Replaced Plug: \_\_\_\_\_ Size: \_\_\_\_\_



# GETTLER-RYAN INC.

## WELL MONITORING/SAMPLING FIELD DATA SHEET

Client/Facility #: ConocoPhillips #3292 Job Number: 180105  
 Site Address: 15008 East 14Th Street Event Date: 8-11-03 (inclusive)  
 City: San Leandro, CA Sampler: Joe

Well ID: MW-3 (SP) Date Monitored: 8-11-03 Well Condition: OK  
 Well Diameter: 2 in.  
 Total Depth: 20.74 ft.  
 Depth to Water: 11.26 ft.

Volume	3/4"= 0.02	1"= 0.04	2"= 0.17	3"= 0.38
Factor (VF)	4"= 0.66	5"= 1.02	6"= 1.50	12"= 5.80

xVF \_\_\_\_\_ = \_\_\_\_\_ x3 (case volume) = Estimated Purge Volume: \_\_\_\_\_ gal.

**Purge Equipment:**  
 Disposable Bailer \_\_\_\_\_  
 Stainless Steel Bailer \_\_\_\_\_  
 Stack Pump \_\_\_\_\_  
 Suction Pump \_\_\_\_\_  
 Grundfos \_\_\_\_\_  
 Other: \_\_\_\_\_

**Sampling Equipment:**  
 Disposable Bailer \_\_\_\_\_  
 Pressure Bailer \_\_\_\_\_  
 Discrete Bailer \_\_\_\_\_  
 Other: \_\_\_\_\_

Time Started: \_\_\_\_\_ (2400 hrs)  
 Time Bailed: \_\_\_\_\_ (2400 hrs)  
 Depth to Product: \_\_\_\_\_ ft  
 Depth to Water: \_\_\_\_\_ ft  
 Hydrocarbon Thickness: 0 ft  
 Visual Confirmation/Description:  
 Skimmer / Absorbant Sock (circle one)  
 Amt Removed from Skimmer: \_\_\_\_\_ gal  
 Amt Removed from Well: \_\_\_\_\_ gal  
 Product Transferred to: \_\_\_\_\_

Start Time (purge): \_\_\_\_\_ Weather Conditions: \_\_\_\_\_  
 Sample Time/Date: / Water Color: \_\_\_\_\_ Odor: \_\_\_\_\_  
 Purging Flow Rate: \_\_\_\_\_ gpm. Sediment Description: \_\_\_\_\_  
 Did well de-water? \_\_\_\_\_ If yes, Time: \_\_\_\_\_ Volume: \_\_\_\_\_ gal.

Time (2400 hr.)	Volume (gal.)	pH	Conductivity (u mhos/cm)	Temperature (C/F)	D.O. (mg/L)	ORP (mV)
					<u>1.33</u>	

### LABORATORY INFORMATION

SAMPLE ID	(#) CONTAINER	REFRIG.	PRESERV. TYPE	LABORATORY	ANALYSES
MW-	x vov vial	YES	HCL	STL Pleasanton	TPH-G/BTEX/MTBE/ETHANOL(8260)

COMMENTS: M-only + DO

Add/Replaced Lock: \_\_\_\_\_ Add/Replaced Plug: \_\_\_\_\_ Size: \_\_\_\_\_

2003-08-0388

76708 Gettler-Ryan Inc., Chain-of-Custody

Toeco Corp./  
Phillips 66 Co.  
2000 Crow Canyon Place  
Suite 400  
San Ramon, CA 94583

Facility Number #3292  
Facility Address 15008 EAST 14TH STREET, SAN LEANDRO, CA  
Global ID 1138 Project 150105.80  
Client Contact MR. DAVID B. DEWITT  
Phone 916-558-7666

Laboratory Name STL - PLEASANTON, CA  
Consultant GETTLER-RYAN, INC. DEANNA L. HARDING  
Address 6747 SIERRA CT., SUITE J, DUBLIN CA 94568  
Phone (925) 551-7555 Fax (925) 551-7899  
Samples Collected by

SAMPLE ID	Number of Containers Matrix	S = Soil A = Air W = Water C = Charcoal	Sample Preservation	Date/Time (2400 Hrs)	TPH-GAS/BTEX/MTBE EPA 8015/8021B	TPH-DIESEL EPA 8015	TPH-DIESEL w/Silica gel EPA 8015	TPH-GAS EPA 8015	TPH-GAS/BTEX/MTBE EPA 8260	OXYGENATES EPA 8260	METHANOL EPA 8015	TOTAL OIL & GREASE EPA 5520	METALS Cd, Cr, Pb, Zn, Ni	NITRATE/SULFATE/ALKALINITY EPA 300 SERIES	HMOC'S (8010) EPA 8021B	YOC'S (8240) EPA 8290	SVOC'S EPA 8270	Etanol (8260)	Remarks	
QA	1	W	HCl	8-11-03					✓										4.4	
MW-1	3	"	"	8 0925					✓											Run 8 Oxy's by 8260 on highest 8260 MTBE hit.
MW-2	3	"	"	8 0815					✓											
MW-9	3	"	"	8 0658					✓											
MW-10	3	"	"	8 0853					✓											
MW-11	2	"	"	8 0735					✓											

- OXYGENATES 8260
- 1 - MTBE
  - 2 - TBA
  - 3 - TAME
  - 4 - DIPE
  - 5 - ETBE
  - 6 - 1,2-DCA
  - 7 - EDB
  - 8 - ETHANOL

Relinquished By (Signature) <i>[Signature]</i>	Organization C-2	Date/Time 1140 8-11-03	Received By (Signature) <i>[Signature]</i>	Organization G-R	Date/Time 1140 8/11/03	iced <input checked="" type="checkbox"/> Y/N	Turn Around Time (Circle Choice) 24 Hrs. 48 Hrs. 72 Hrs. 5 Days 10 Days <u>As Contracted</u>
Relinquished By (Signature) <i>[Signature]</i>	Organization G-R	Date/Time 613 8/11/03	Received By (Signature) <i>[Signature]</i>	Organization STC	Date/Time 435 8/16/03	iced <input checked="" type="checkbox"/> Y/N	
Relinquished By (Signature) <i>[Signature]</i>	Organization STC	Date/Time 333 8/16/03	Received For Laboratory By (Signature) <i>[Signature]</i>		Date/Time 08/12/03 1600	iced <input type="checkbox"/> Y/N	

FILE NAME: P:\DWG\Y-CHANGES\03\STP-COC.DWG | Layout Tab: Model

**Gettler Ryan**

August 28, 2003

6747 Sierra Court Suite J  
Dublin, CA 94568

Attn.: Deanna Harding

Project#: 180105.80

Project: Conoco #3292

Site: 15008 East 14th St., San Leandro

Dear Ms. Harding,

Attached is our report for your samples received on 08/12/2003 16:00

This report has been reviewed and approved for release. Reproduction of this report is permitted only in its entirety.

Please note that any unused portion of the samples will be discarded after 09/26/2003 unless you have requested otherwise.

We appreciate the opportunity to be of service to you. If you have any questions, please call me at (925) 484-1919.

You can also contact me via email. My email address is: [tgranicher@stl-inc.com](mailto:tgranicher@stl-inc.com)

Sincerely,



Tod Granicher  
Project Manager

Severn Trent Laboratories, Inc.

STL San Francisco \* 1220 Quarry Lane, Pleasanton, CA 94566

Tel 925 484 1919 Fax 925 484 1096 \* [www.stl-inc.com](http://www.stl-inc.com) \* CA DHS ELAP# 2496

**Gas/BTEX Fuel Oxygenates by 8260B**

Gettler Ryan

Attn.: Deanna Harding

6747 Sierra Court Suite J

Dublin, CA 94568

Phone: (925) 551-7444 Fax: (925) 551-7899

Project: 180105.80

Conoco #3292

Received: 08/12/2003 16:00

Site: 15008 East 14th St., San Leandro

**Samples Reported**

Sample Name	Date Sampled	Matrix	Lab #
QA	08/11/2003	Water	1
MW-1	08/11/2003 09:25	Water	2
MW-2	08/11/2003 08:15	Water	3
MW-9	08/11/2003 06:58	Water	4
MW-10	08/11/2003 08:53	Water	5
MW-11	08/11/2003 07:35	Water	6

Severn Trent Laboratories, Inc.

STL San Francisco \* 1220 Quarry Lane, Pleasanton, CA 94566

Tel 925 484 1919 Fax 925 484 1096 \* www.stl-inc.com \* CA DHS ELAP# 2496

08/25/2003 16:38

Page 1 of 10





**Gas/BTEX Fuel Oxygenates by 8260B**

Gettler Ryan

Attn.: Deanna Harding

6747 Sierra Court Suite J

Dublin, CA 94568

Phone: (925) 551-7444 Fax: (925) 551-7899

Project: 180105.80

Conoco #3292

Received: 08/12/2003 16:00

Site: 15008 East 14th St., San Leandro

Prep(s):	5030B	Test(s):	8260FAB
Sample ID:	MW-1	Lab ID:	2003-08-0388 - 2
Sampled:	08/11/2003 09:25	Extracted:	8/24/2003 14:24
Matrix:	Water	QC Batch#:	2003/08/24-01.64

Compound	Conc.	RL	Unit	Dilution	Analyzed	Flag
Gasoline	2900	50	ug/L	1.00	08/24/2003 14:24	g
Benzene	ND	0.50	ug/L	1.00	08/24/2003 14:24	
Toluene	ND	0.50	ug/L	1.00	08/24/2003 14:24	
Ethylbenzene	4.4	0.50	ug/L	1.00	08/24/2003 14:24	
Total xylenes	ND	1.0	ug/L	1.00	08/24/2003 14:24	
Methyl tert-butyl ether (MTBE)	17	2.0	ug/L	1.00	08/24/2003 14:24	
Ethanol	ND	500	ug/L	1.00	08/24/2003 14:24	
<b>Surrogates(s)</b>						
1,2-Dichloroethane-d4	98.7	76-114	%	1.00	08/24/2003 14:24	
Toluene-d8	96.9	88-110	%	1.00	08/24/2003 14:24	



**Gas/BTEX Fuel Oxygenates by 8260B**

Gettler Ryan  
Attn.: Deanna Harding

6747 Sierra Court Suite J  
Dublin, CA 94568  
Phone: (925) 551-7444 Fax: (925) 551-7899

Project: 180105.80  
Conoco #3292

Received: 08/12/2003 16:00

Site: 15008 East 14th St., San Leandro

Prep(s): 5030B Test(s): 8260FAB  
Sample ID: MW-9 Lab ID: 2003-08-0388 - 4  
Sampled: 08/11/2003 06:58 Extracted: 8/24/2003 15:08  
Matrix: Water QC Batch#: 2003/08/24-01.64

Compound	Conc.	RL	Unit	Dilution	Analyzed	Flag
Gasoline	170	50	ug/L	1.00	08/24/2003 15:08	g
Benzene	ND	0.50	ug/L	1.00	08/24/2003 15:08	
Toluene	ND	0.50	ug/L	1.00	08/24/2003 15:08	
Ethylbenzene	ND	0.50	ug/L	1.00	08/24/2003 15:08	
Total xylenes	ND	1.0	ug/L	1.00	08/24/2003 15:08	
Methyl tert-butyl ether (MTBE)	ND	2.0	ug/L	1.00	08/24/2003 15:08	
Ethanol	ND	500	ug/L	1.00	08/24/2003 15:08	
<b>Surrogates(s)</b>						
1,2-Dichloroethane-d4	98.8	76-114	%	1.00	08/24/2003 15:08	
Toluene-d8	96.0	88-110	%	1.00	08/24/2003 15:08	

**Gas/BTEX Fuel Oxygenates by 8260B**

Gettler Ryan

Attn.: Deanna Harding

6747 Sierra Court Suite J

Dublin, CA 94568

Phone: (925) 551-7444 Fax: (925) 551-7899

Project: 180105.80

Conoco #3292

Received: 08/12/2003 16:00

Site: 15008 East 14th St., San Leandro

Prep(s): 5030B	Test(s): 8260FAB
Sample ID: MW-10	Lab ID: 2003-08-0388 - 5
Sampled: 08/11/2003 08:53	Extracted: 8/24/2003 15:30
Matrix: Water	QC Batch#: 2003/08/24-01.64

Compound	Conc.	RL	Unit	Dilution	Analyzed	Flag
Gasoline	3100	50	ug/L	1.00	08/24/2003 15:30	
Benzene	1.9	0.50	ug/L	1.00	08/24/2003 15:30	
Toluene	ND	0.50	ug/L	1.00	08/24/2003 15:30	
Ethylbenzene	1.0	0.50	ug/L	1.00	08/24/2003 15:30	
Total xylenes	1.0	1.0	ug/L	1.00	08/24/2003 15:30	
Methyl tert-butyl ether (MTBE)	4.0	2.0	ug/L	1.00	08/24/2003 15:30	
Ethanol	ND	500	ug/L	1.00	08/24/2003 15:30	
<b>Surrogates(s)</b>						
1,2-Dichloroethane-d4	98.1	76-114	%	1.00	08/24/2003 15:30	
Toluene-d8	98.3	88-110	%	1.00	08/24/2003 15:30	

**Gas/BTEX Fuel Oxygenates by 8260B**

Gettler Ryan

Attn.: Deanna Harding

6747 Sierra Court Suite J

Dublin, CA 94568

Phone: (925) 551-7444 Fax: (925) 551-7899

Project: 180105.80

Conoco #3292

Received: 08/12/2003 16:00

Site: 15008 East 14th St., San Leandro

Prep(s): 5030B	Test(s): 8260FAB
Sample ID: MW-11	Lab ID: 2003-08-0388 - 6
Sampled: 08/11/2003 07:35	Extracted: 8/24/2003 15:52
Matrix: Water	QC Batch#: 2003/08/24-01.64
Analysis Flag: o ( See Legend and Note Section )	

Compound	Conc.	RL	Unit	Dilution	Analyzed	Flag
Gasoline	930	250	ug/L	5.00	08/24/2003 15:52	g
Benzene	ND	2.5	ug/L	5.00	08/24/2003 15:52	
Toluene	ND	2.5	ug/L	5.00	08/24/2003 15:52	
Ethylbenzene	ND	2.5	ug/L	5.00	08/24/2003 15:52	
Total xylenes	ND	5.0	ug/L	5.00	08/24/2003 15:52	
tert-Butyl alcohol (TBA)	ND	500	ug/L	5.00	08/24/2003 15:52	
Methyl tert-butyl ether (MTBE)	320	10	ug/L	5.00	08/24/2003 15:52	
Di-isopropyl Ether (DIPE)	ND	10	ug/L	5.00	08/24/2003 15:52	
Ethyl tert-butyl ether (ETBE)	ND	10	ug/L	5.00	08/24/2003 15:52	
tert-Amyl methyl ether (TAME)	ND	10	ug/L	5.00	08/24/2003 15:52	
1,2-DCA	ND	10	ug/L	5.00	08/24/2003 15:52	
EDB	ND	10	ug/L	5.00	08/24/2003 15:52	
Ethanol	ND	2500	ug/L	5.00	08/24/2003 15:52	
<b>Surrogates(s)</b>						
1,2-Dichloroethane-d4	105.7	76-114	%	5.00	08/24/2003 15:52	
Toluene-d8	99.9	88-110	%	5.00	08/24/2003 15:52	

**Gas/BTEX Fuel Oxygenates by 8260B**

Gettler Ryan

Attn.: Deanna Harding

6747 Sierra Court Suite J

Dublin, CA 94568

Phone: (925) 551-7444 Fax: (925) 551-7899

Project: 180105.80

Conoco #3292

Received: 08/12/2003 16:00

Site: 15008 East 14th St., San Leandro

**Batch QC Report**

Prep(s): 5030B

Method Blank

MB: 2003/08/24-01.64-044

Water

Test(s): 8260FAB

QC Batch # 2003/08/24-01.64

Date Extracted: 08/24/2003 10:44

Compound	Conc.	RL	Unit	Analyzed	Flag
Gasoline	ND	50	ug/L	08/24/2003 10:44	
Benzene	ND	0.5	ug/L	08/24/2003 10:44	
Toluene	ND	0.5	ug/L	08/24/2003 10:44	
Ethylbenzene	ND	0.5	ug/L	08/24/2003 10:44	
Total xylenes	ND	1.0	ug/L	08/24/2003 10:44	
tert-Butyl alcohol (TBA)	ND	100	ug/L	08/24/2003 10:44	
Methyl tert-butyl ether (MTBE)	ND	2.0	ug/L	08/24/2003 10:44	
Di-isopropyl Ether (DIPE)	ND	2.0	ug/L	08/24/2003 10:44	
Ethyl tert-butyl ether (ETBE)	ND	2.0	ug/L	08/24/2003 10:44	
tert-Amyl methyl ether (TAME)	ND	2.0	ug/L	08/24/2003 10:44	
1,2-DCA	ND	2.0	ug/L	08/24/2003 10:44	
EDB	ND	2.0	ug/L	08/24/2003 10:44	
Ethanol	ND	500	ug/L	08/24/2003 10:44	
<b>Surrogates(s)</b>					
1,2-Dichloroethane-d4	96.0	76-114	%	08/24/2003 10:44	
Toluene-d8	97.4	88-110	%	08/24/2003 10:44	

**Gas/BTEX Fuel Oxygenates by 8260B**

Gettler Ryan  
Attn.: Deanna Harding

6747 Sierra Court Suite J  
Dublin, CA 94568  
Phone: (925) 551-7444 Fax: (925) 551-7899

Project: 180105.80  
Conoco #3292

Received: 08/12/2003 16:00

Site: 15008 East 14th St., San Leandro

**Batch QC Report**

Prep(s): 5030B

Test(s): 8260FAB

**Laboratory Control Spike**

**Water**

**QC Batch # 2003/08/24-01.64**

LCS 2003/08/24-01.64-000

Extracted: 08/24/2003

Analyzed: 08/24/2003 10:00

LCSD 2003/08/24-01.64-022

Extracted: 08/24/2003

Analyzed: 08/24/2003 10:22

Compound	Conc. ug/L		Exp.Conc.	Recovery %		RPD	Ctrl.Limits %		Flags	
	LCS	LCSD		LCS	LCSD		%	Rec.	RPD	LCS
Benzene	21.7	21.2	25.0	86.8	84.8	2.3	69-129	20		
Toluene	21.9	21.9	25.0	87.6	87.6	0.0	70-130	20		
Methyl tert-butyl ether (MTBE)	20.9	21.6	25.0	83.6	86.4	3.3	65-165	20		
<b>Surrogates(s)</b>										
1,2-Dichloroethane-d4	474	481	500	94.8	96.2		76-114			
Toluene-d8	511	491	500	102.2	98.2		88-110			



**Gas/BTEX Fuel Oxygenates by 8260B**

Gettler Ryan

Attn.: Deanna Harding

6747 Sierra Court Suite J

Dublin, CA 94568

Phone: (925) 551-7444 Fax: (925) 551-7899

Project: 180105.80

Conoco #3292

Received: 08/12/2003 16:00

Site: 15008 East 14th St., San Leandro

---

**Legend and Notes**

---

**Analysis Flag**

o

Reporting limits were raised due to high level of analyte present in the sample.

**Result Flag**

g

Hydrocarbon reported in the gasoline range does not match our gasoline standard.