

#3688

JUN 15 2001

June 6, 2001

Mr. Barney M. Chan  
Hazardous Materials Specialist  
Alameda County Health Care Services  
Environmental Health Services  
Environmental Protection (LOP)  
1131 Harbor Bay Parkway, Suite 250  
Alameda, CA 94502-6577

Strange gradient -  
ridge?

**RE: QUARTERLY MONITORING REPORT  
FORMER WESTERN STUCCO PRODUCTS  
5115 EAST EIGHTH STREET, OAKLAND, CALIFORNIA  
EBA Project No. 00-805 (31)**

Dear Mr. Chan:

On May 3, 2001, EBA WASTECHNOLOGIES (EBA) collected groundwater samples and recorded groundwater level measurements from groundwater monitoring wells located at 5115 East Eighth Street in Oakland, California. Quarterly sampling of the on-site monitoring wells was requested by the Alameda County Health Care Services Agency (ACHCSA) in a letter dated March 23, 2001. As stipulated in a previous letter dated October 31, 2000, from ACHCSA, the on-site observation well (OW-1) was not sampled during this quarterly sampling event.

may need to sample prior to consider for closure.

On May 3, 2001, depth to groundwater from top of casing in monitoring wells MW-1 through MW-3 and observation well OW-1 was measured at 5.43 feet, 3.25 feet, 3.94 feet, and 3.98 feet respectively. Groundwater elevation data is summarized in Table 1. Groundwater measurements recorded on this date indicate a groundwater flow direction ranging from northwest to east. However, groundwater at the project site is believed to flow to the southwest towards the San Leandro Bay. ~~Water levels in the monitoring wells are believed to be influenced by the fine-grained material encountered in the soil borings during monitoring well installation. This could account for the anomalous groundwater flow direction observed at the site on this date. During the February 28, 2001 site visit, groundwater flow direction was calculated to range from southwest to northwest.~~ EBA will closely scrutinize groundwater flow directions recorded during future sampling events to attempt to discern the true groundwater flow direction at the project site.

Groundwater pH, electrical conductivity, and temperature were monitored during well purging. The wells were considered adequately purged when the water quality parameters had stabilized and a minimum of three well volumes were purged, or the wells were purged dry. Groundwater sampling logs recording sampling procedures and measurements are attached.

Water samples were collected from each monitoring well with a single sample disposable bailer fitted with a bottom-emptying device to minimize water degassing. Properly labeled, laboratory supplied, sterile sample containers were used for sample collection. The water samples were logged on a chain-of-custody form and placed in an ice chest. The refrigerated samples were picked up by a courier from Alpha Analytical, a California State-certified laboratory, for chemical analytical testing. The laboratory report and chain-of-custody form are included with this report.

All monitoring well groundwater samples were analyzed for total petroleum hydrocarbons as gasoline (TPHg) and TPH as diesel (TPHd) using Environmental Protection Agency (EPA) Method 8015M, and benzene, toluene, ethylbenzene, total xylenes (BTEX), and MtBE using EPA Method 8020. The results of these analyses are summarized in Table 2.

The next sampling event is tentatively scheduled for August, 2001. Purge water is stored on-site in properly labeled 55-gallon DOT 17H drums pending disposal.

If you should have any questions regarding this report, please do not hesitate to contact EBA at (707) 544-0784.

Sincerely,  
**EBA WASTECHNOLOGIES**

*Reviewed by*

  
Eriksen Phenix  
Environmental Technician

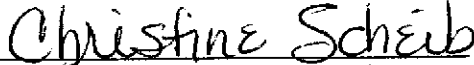
  
Christine Scheib, R.E.A. #06901  
Senior Environmental Specialist

*Supervised by*

  
Duane Butler, P.E., R.E.A. #01999  
President C.E. #13357

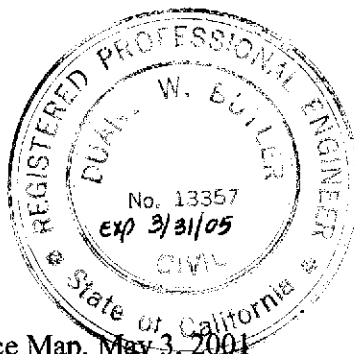

EP/mc

Attach: Figure 1: Potentiometric Surface Map, May 3, 2001  
Table 1: Monitoring Well Survey and Water Level Data  
Table 2: Groundwater Sample Analytical Results  
Field Data Sheets  
Certificate of Analyses and Chain-of-Custody Record

cc: Mr. Lewis Winchell, Sacramento Stucco  
Mr. Al Avendano, 3228 Hyde Street, Oakland, CA 94601  
SFB-RWQCB

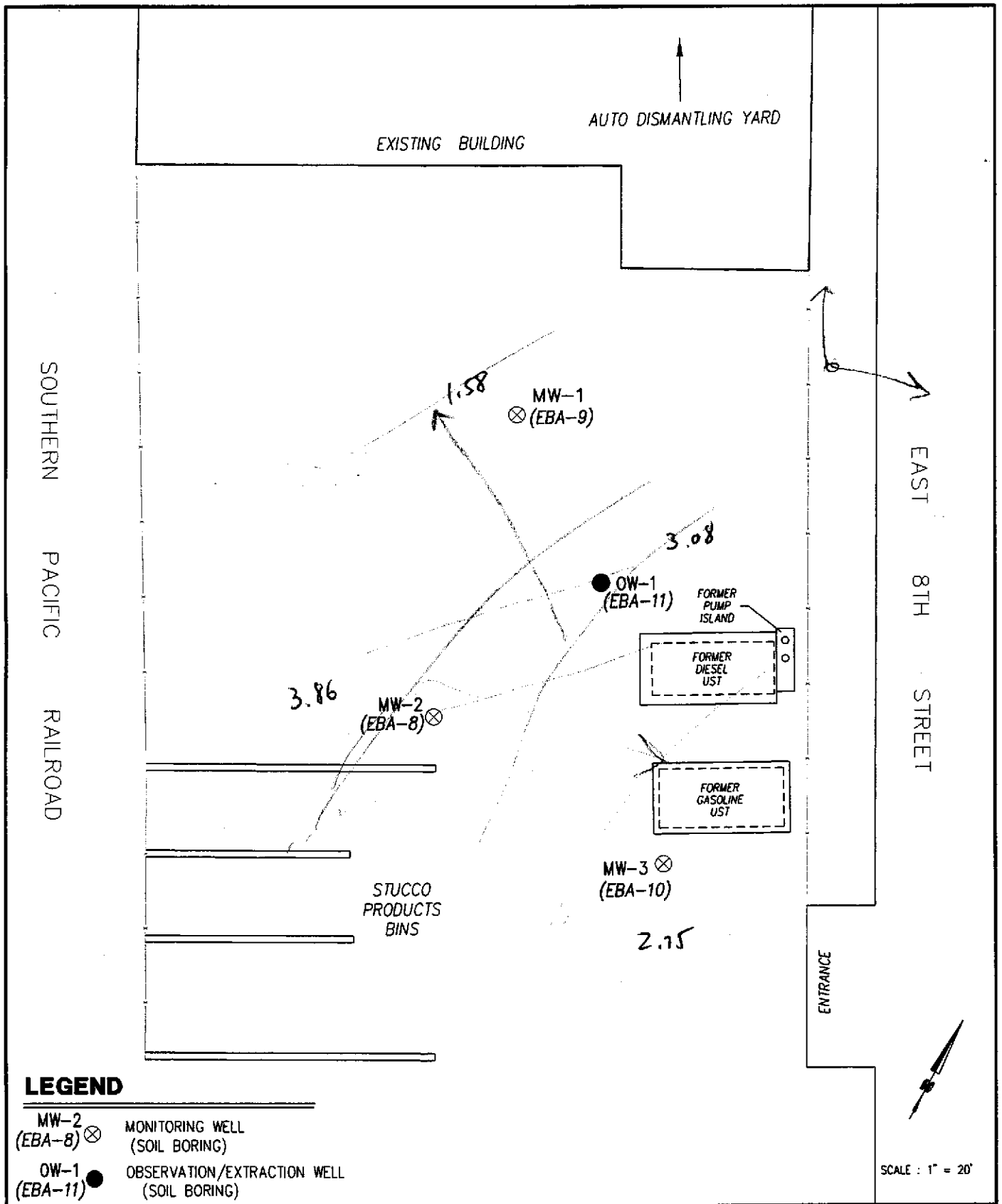

WESTERN STUCCO PRODUCTS  
 5115 EAST 8TH STREET  
 OAKLAND, CALIFORNIA  
**SITE PLAN**

FIGURE  
**1**  
 MARCH 2001  
 Q:\00-805  
 SURVEY.DWG

**TABLE 1. MONITORING WELL SURVEY AND WATER LEVEL DATA**  
**Former Western Stucco Facility**  
**5115 East 8<sup>th</sup> Street, Oakland, CA**

Monitoring Well I.D.	Well Depth (ft.)	Screen Interval (ft.)	TOC Elevation (ft.)	Depth to Groundwater from TOC (ft.)	Groundwater Elevation (ft. MSL)	Date
MW-1	19.60	5 - 19.60	7.01	13.49	-6.48	2/5/01
				16.51	-9.50	2/6/01
				9.30	-2.29	2/20/01 (1050)
				8.05	-1.04	2/20/01 (1605)
				6.45	0.56	2/28/01
				5.43	1.58	5/3/01
MW-2	18.40	5 - 18.40	7.11	4.21	2.90	2/5/01
				6.61	0.50	2/6/01
				3.95	3.16	2/20/01 (1050)
				3.12	3.99	2/20/01 (1605)
				3.01	4.10	2/28/01
				3.25	3.86	5/3/01
MW-3	19.75	5 - 19.75	6.69	9.04	-2.35	2/5/01
				14.70	-8.01	2/6/01
				3.15	3.54	2/20/01 (1050)
				3.05	3.64	2/20/01 (1605)
				2.42	4.27	2/28/01
				3.94	2.75	5/3/01
OW-1	20	5 - 20	7.06	2.37	4.69	2/28/01
				3.98	3.08	5/3/01

ft. MSL = Feet relative to mean sea level

**TABLE 2. GROUNDWATER SAMPLE ANALYTICAL RESULTS**  
**Former Western Stucco Facility**  
**5115 East 8<sup>th</sup> Street, Oakland, CA**

SAMPLE ID	DATE	TPH-g µg/L	TPH-d µg/L	Benzene µg/L	Toluene µg/L	Ethyl Benzene µg/L	Total Xylenes µg/L	MTBE µg/L
MW-1	2/6/01	950	260	ND	ND	ND	ND	ND
	5/3/01	450	490	ND	ND	ND	ND	ND
MW-2	2/6/01	2600	530	1.1	0.43	0.87	1.7	ND
	5/3/01	2400	530	ND	ND	ND	ND	ND
MW-3	2/6/01	340	250	ND	ND	ND	ND	ND
	5/3/01	260	420	ND	ND	ND	ND	ND
OW-1	2/28/01	2400	8200	ND	ND	ND	ND	ND

TPH-g = Total Petroleum Hydrocarbons as gasoline

TPH-d = Total Petroleum Hydrocarbons as diesel

ND = Not Detected above reporting limit

SEE LABORATORY REPORT FOR REPORTING LIMITS

Project No. 00-805		Well No: MW-1			
Project Location: 5115 East Eighth Street, Oakland		Well Depth from TOC: 19.60'			
Date: 5/3/01		Well Diameter: 2"			
Time: 1030		Product Level from TOC: None			
Recorded by: E. Phenix		Water Level from TOC: 5.43			
Purge Time (duration): 5 min.		Screened Interval: 5' - 19.60'			
		Well Elevation (TOC): 7.01'			
<b>WEATHER</b>					
Wind: 10-20 mph		Precip. in last 5 days: 0"			
<b>VOLUME OF WATER TO BE REMOVED BEFORE SAMPLING</b>					
( 19.60 - 5.43 ) x ( 0.08333 ) <sup>2</sup> x 3.14 x 7.48 = 2.30 gallons in one well volume					
( Well Depth - Water Level ) { Well radius (ft) }					
6.89 gallons in 3 well volumes		2.8 gallons removed			
<b>CALIBRATION</b>					
Parameter	Time	Calibration	Before Sampling	Time	After Sampling
pH:					
EC:					
<b>FIELD MEASUREMENTS</b>					
Time	pH	EC x1000	Temp °C	Gallons Removed	Appearance
1114	6.84	1112	21.1	0	Clear - no odor
1115	6.83	1205	20.3	1	Clear
1116	6.83	1212	19.8	2	Clear
1119	6.83	1227	19.5	2.8	Slightly Cloudy
-----	DRY	AFTER	2.8 GALLONS	REMOVED	-----
Water Level After Purging: 19.60 ft. (TOC)			80% of Original Water Level: 8.26 ft. (TOC)		
Water Level Before Sampling: 15.80 ft. (TOC)					
APPEARANCE OF SAMPLE: Clear				Time: 1500	
Bailer:	Type: disposable		GPM:		
Submersible:	Type:		GPM:		
Dedicated:	Type:		GPM:		
DECONTAMINATION METHOD: TSP, and disposable bailers					
SAMPLE ANALYSIS: TPH <sub>2</sub> /BTEX/TPHd/MtBE					
LABORATORY: Alpha Analytical					

EBA Wastechologies, 825 Sonoma Ave. Santa Rosa CA

Project No. 00-805		Well No: MW-2			
Project Location: 5115 East Eighth Street, Oakland		Well Depth from TOC: 18.40'			
Date: 5/3/01		Well Diameter: 2"			
Time: 1030		Product Level from TOC: None			
Recorded by: E. Phenix		Water Level from TOC: 3.25			
Purge Time (duration): 7 min.		Screened Interval: 5'-18.40'			
		Well Elevation (TOC): 7.11'			
<b>WEATHER</b>					
Wind: 10-20 mph		Precip. in last 5 days: 0"			
<b>VOLUME OF WATER TO BE REMOVED BEFORE SAMPLING</b>					
$(18.40 - 3.25) \times (0.08333)^2 \times 3.14 \times 7.48 = 2.46$ gallons in one well volume					
(Well Depth - Water Level)		(Well radius (ft))			
7.37		3			
gallons in 3 well volumes		4.2 gallons removed			
<b>CALIBRATION</b>					
Parameter	Time	Calibration	Before Sampling	Time	After Sampling
pH:					
EC:					
<b>FIELD MEASUREMENTS</b>					
Time	pH	EC x1000	Temp °C	Gallons Removed	Appearance
1133	7.27	319	20.5	0	Slightly Cloudy
1134	7.16	326	19.7	1	Silty, black
1136	7.12	333	19.2	2	Silty, black
1138	7.07	360	19.0	3	Slightly silty, gray
1140	7.02	404	18.7	4	Slightly silty, gray
-----	DRY	AFTER	4.2 GALLONS	REMOVED	-----
Water Level After Purging: 18.40 ft. (TOC)				80% of Original Water Level: 6.28 ft. (TOC)	
Water Level Before Sampling: 13.72 ft. (TOC)					
APPEARANCE OF SAMPLE: Clear				Time: 1520	
Bailer:	Type: disposable		GPM:		
Submersible:	Type:		GPM:		
Dedicated:	Type:		GPM:		
DECONTAMINATION METHOD: TSP. and disposable bailers					
SAMPLE ANALYSIS: TPHg/BTEX/TPHd/MtBE					
LABORATORY: Alpha Analytical					

EBA Wastechologies, 825 Sonoma Ave. Santa Rosa, CA

Project No. 00-805		Well No: MW-3			
Project Location: 5115 East Eighth Street, Oakland		Well Depth from TOC: 19.75'			
Date: 5/3/01		Well Diameter: 2"			
Time: 1030		Product Level from TOC: None			
Recorded by: E. Phenix		Water Level from TOC: 3.94			
Purge Time (duration): 5 min.		Screened Interval: 5' - 19.75'			
		Well Elevation (TOC): 6.69'			
<b>WEATHER</b>					
Wind: 10-20 mph		Precip. in last 5 days: 0"			
<b>VOLUME OF WATER TO BE REMOVED BEFORE SAMPLING</b>					
( 19.75 - 3.94 ) x ( 0.08333 ) <sup>2</sup> x 3.14 x 7.48 = 2.56 gallons in one well volume					
( Well Depth - Water Level ) ( Well radius (ft) )					
7.69 gallons in 3 well volumes		3 gallons removed			
<b>CALIBRATION</b>					
Parameter	Time	Calibration	Before Sampling	Time	After Sampling
pH:					
EC:					
<b>FIELD MEASUREMENTS</b>					
Time	pH	EC x1000	Temp °C	Gallons Removed	Appearance
1058	6.60	1038	21.4	0	Clear
1100	6.76	1061	20.1	2	Clear
1103	6.79	1015	19.6	3	Slightly Cloudy
-----	DRY	AFTER	3 GALLONS	REMOVED	-----
Water Level After Purging: 19.75 ft. (TOC)			80% of Original Water Level: 7.10 ft. (TOC)		
Water Level Before Sampling: 16.73 ft. (TOC)					
APPEARANCE OF SAMPLE: Clear					Time: 1445
Bailer:	Type: disposable		GPM:		
Submersible:	Type:		GPM:		
Dedicated:	Type:		GPM:		
DECONTAMINATION METHOD: TSP. and disposable bailers					
SAMPLE ANALYSIS: TPH <sub>g</sub> /BTEX/TPH <sub>d</sub> /MIBE					
LABORATORY: Alpha Analytical					

EBA Wastechologies, 825 Sonoma Ave, Santa Rosa CA





Alpha Analytical Laboratories Inc.

860 Waugh Lane, H-1, Ukiah, California 95482

e-mail: [clientservices@alpha-labs.com](mailto:clientservices@alpha-labs.com) • Phone: (707) 468-0401 • Fax: (707) 468-5267

17 May 2001

EBA Wastechologies  
Attn: Christine Scheib  
825 Sonoma Ave. Suite C  
Santa Rosa CA, 95404  
RE: Western Stucco  
Work Order: A105092

Enclosed are the results of analyses for samples received by the laboratory on 05/04/01 12:15. If you have any questions concerning this report, please feel free to contact me.

Sincerely,

*Sheri Speaks*

Sheri L. Speaks  
Project Manager



Alpha

Alpha Analytical Laboratories Inc.

860 Waugh Lane, H-1, Ukiah, California 95482

e-mail: clientservices@alpha-labs.com • Phone: (707) 468-0401 • Fax: (707) 468-5267

**CHEMICAL EXAMINATION REPORT**

Page 1 of 9

EBA Wastechнологies  
825 Sonoma Ave. Suite C  
Santa Rosa CA, 95404  
Attn: Christine Scheib

Report Date: 05/17/01 12:24  
Project No: 00-805  
Project ID: Western Stucco

<u>Order Number</u>	<u>Receipt Date/Time</u>	<u>Client Code</u>	<u>Client PO/Reference</u>
A105092	05/04/2001 12:15	EBA	

**ANALYTICAL REPORT FOR SAMPLES**

Sample ID	Laboratory ID	Matrix	Date Sampled	Date Received
MW-1	A105092-01	Water	05/03/01 15:00	05/04/01 12:15
MW-2	A105092-02	Water	05/03/01 15:20	05/04/01 12:15
MW-3	A105092-03	Water	05/03/01 14:45	05/04/01 12:15
Trip Blank	A105092-04	Water	05/03/01 08:00	05/04/01 12:15

*Sheri Speaks*

Sheri L. Speaks  
Project Manager

5/17/01



Alpha Analytical Laboratories Inc.

860 Waugh Lane, H-1, Ukiah, California 95482

e-mail: clientservices@alpha-labs.com • Phone: (707) 468-0401 • Fax: (707) 468-5267

CHEMICAL EXAMINATION REPORT

EBA Wastechologies  
825 Sonoma Ave. Suite C  
Santa Rosa CA, 95404  
Attn: Christine Scheib

Report Date: 05/17/01 12:24  
Project No: 00-805  
Project ID: Western Stucco

Order Number: A105092      Receipt Date/Time: 05/04/2001 12:15      Client Code: EBA      Client PO/Reference:

Alpha Analytical Laboratories, Inc.

METHOD	BATCH	PREPARED	ANALYZED	DILUTION	RESULT	PQL	NOTE
<b>MW-1 (A105092-01)</b>		<b>Sample Type: Water</b>			<b>Sampled: 05/03/01 15:00</b>		
<b>TPH as Diesel by EPA Method 8015 Modified</b>							
TPH as Diesel	EPA 8015DRO	AE11504	05/15/01	05/16/01	1	490 ug/l	50
Surrogate: 1,4-Bromofluorobenzene	"	"	"	"		68.0 %	25-132
<b>TPH as Gasoline by GCFID/5030 and MBTXE by 8020</b>							
TPH as Gasoline	8015GRO/8020	AE11106	05/10/01	05/10/01	1	450 ug/l	50
Benzene	"	"	"	"	"	ND "	0.30
Toluene	"	"	"	"	"	ND "	0.30
Ethylbenzene	"	"	"	"	"	ND "	0.70 R-01
Xylenes (total)	"	"	"	"	"	ND "	1.9 R-01
Methyl tert-butyl ether	"	"	"	"	"	ND "	1.0
Surrogate: 1,4-Bromofluorobenzene	"	"	"	"		120 %	48-155
<b>MW-2 (A105092-02)</b>		<b>Sample Type: Water</b>			<b>Sampled: 05/03/01 15:20</b>		
<b>TPH as Diesel by EPA Method 8015 Modified</b>							
TPH as Diesel	EPA 8015DRO	AE11504	05/15/01	05/16/01	1	530 ug/l	50
Surrogate: 1,4-Bromofluorobenzene	"	"	"	"		71.2 %	25-132
<b>TPH as Gasoline by GCFID/5030 and MBTXE by 8020</b>							
TPH as Gasoline	8015GRO/8020	AE11707	05/14/01	05/14/01	1	2400 ug/l	50
Benzene	"	"	"	"	4	ND "	1.2 R-01
Toluene	"	"	"	"	1	ND "	4.8 R-01
Ethylbenzene	"	"	"	"	"	ND "	1.7 R-01
Xylenes (total)	"	"	"	"	"	ND "	3.6 R-01
Methyl tert-butyl ether	"	"	"	"	9	ND "	9.0 R-01
Surrogate: 1,4-Bromofluorobenzene	"	"	"	"		73.2 %	48-155
<b>MW-3 (A105092-03)</b>		<b>Sample Type: Water</b>			<b>Sampled: 05/03/01 14:45</b>		
<b>TPH as Diesel by EPA Method 8015 Modified</b>							
TPH as Diesel	EPA 8015DRO	AE11504	05/15/01	05/16/01	1	420 ug/l	50
Surrogate: 1,4-Bromofluorobenzene	"	"	"	"		58.8 %	25-132

Sheri Speaks

Sheri L. Speaks  
Project Manager

5/17/01



Alpha Analytical Laboratories Inc.

860 Waugh Lane, H-1, Ukiah, California 95482

e-mail: clientservices@alpha-labs.com • Phone: (707) 468-0401 • Fax: (707) 468-5267

**CHEMICAL EXAMINATION REPORT**

Page 3 of 9

EBA Wastechologies  
825 Sonoma Ave. Suite C  
Santa Rosa CA, 95404  
Attn: Christine Scheib

Report Date: 05/17/01 12:24  
Project No: 00-805  
Project ID: Western Stucco

<u>Order Number</u>	<u>Receipt Date/Time</u>	<u>Client Code</u>	<u>Client PO/Reference</u>
A105092	05/04/2001 12:15	EBA	

**Alpha Analytical Laboratories, Inc.**

METHOD	BATCH	PREPARED	ANALYZED	DILUTION	RESULT	PQL	NOTE
<b>MW-3 (A105092-03)</b>		<b>Sample Type: Water</b>			<b>Sampled: 05/03/01 14:45</b>		
<b>TPH as Gasoline by GCFID/5030 and MBTXE by 8020</b>							
TPH as Gasoline	8015GRO/8020	AE11707	05/14/01	05/14/01	1	260 ug/l	50
Benzene	"	"	"	"	"	ND "	0.30
Toluene	"	"	"	"	"	ND "	0.30
Ethylbenzene	"	"	"	"	"	ND "	0.53 R-01
Xylenes (total)	"	"	"	"	"	ND "	0.90 R-01
Methyl tert-butyl ether	"	"	"	"	"	ND "	1.6 R-01
<i>Surrogate: 1,4-Bromofluorobenzene</i>	"	"	"	"		108 %	48-155

<b>Trip Blank (A105092-04)</b>		<b>Sample Type: Water</b>			<b>Sampled: 05/03/01 08:00</b>		
<b>TPH as Gasoline by GCFID/5030</b>							
TPH as Gasoline	EPA 8015GRO	AE11707	05/14/01	05/14/01	1	ND ug/l	50
<i>Surrogate: 1,4-Bromofluorobenzene</i>	"	"	"	"		131 %	48-155

*Sheri Speaks*

Sheri L. Speaks  
Project Manager

5/17/01



Alpha Analytical Laboratories Inc.

860 Waugh Lane, H-1, Ukiah, California 95482

e-mail: clientservices@alpha-labs.com • Phone: (707) 468-0401 • Fax: (707) 468-5267

**CHEMICAL EXAMINATION REPORT**

Page 4 of 9

EBA Wastechologies  
825 Sonoma Ave. Suite C  
Santa Rosa CA, 95404  
Attn: Christine Scheib

Report Date: 05/17/01 12:24  
Project No: 00-805  
Project ID: Western Stucco

Order Number  
A105092

Receipt Date/Time  
05/04/2001 12:15

Client Code  
EBA

Client PO/Reference

**TPH as Diesel by EPA Method 8015 Modified - Quality Control**

Analyte(s)	Result	PQL	Units	Spike Level	Source Result	%REC	%REC Limits	RPD	RPD Limit	Flag
<b>Batch AE11504 - EPA 3510B Water</b>										
<b>Blank (AE11504-BLK1)</b>				Prepared & Analyzed: 05/15/01						
TPH as Diesel	ND	50	ug/l							
Surrogate: 1,4-Bromofluorobenzene	341		"	500		68.2	25-132			
<b>LCS (AE11504-BS1)</b>				Prepared & Analyzed: 05/15/01						
TPH as Diesel	1860	50	ug/l	2130		87.3	70-130			
Surrogate: 1,4-Bromofluorobenzene	319		"	500		63.8	25-132			
<b>LCS Dup (AE11504-BSD1)</b>				Prepared & Analyzed: 05/15/01						
TPH as Diesel	2030	50	ug/l	2130		95.3	70-130	8.74	20	
Surrogate: 1,4-Bromofluorobenzene	345		"	500		69.0	25-132			

*Sheri Speaks*

Sheri L. Speaks  
Project Manager

5/17/01



# Alpha

Alpha Analytical Laboratories Inc.

860 Waugh Lane, H-1, Ukiah, California 95482

e-mail: clientservices@alpha-labs.com • Phone: (707) 468-0401 • Fax: (707) 468-5267

## CHEMICAL EXAMINATION REPORT

Page 5 of 9

EBA Wastechнологies  
825 Sonoma Ave. Suite C  
Santa Rosa CA, 95404  
Attn: Christine Scheib

Report Date: 05/17/01 12:24  
Project No: 00-805  
Project ID: Western Stucco

Order Number  
A105092

Receipt Date/Time  
05/04/2001 12:15

Client Code  
EBA

Client PO/Reference

### TPH as Gasoline by GCFID/5030 - Quality Control

Analyte(s)	Result	PQL	Units	Spike Level	Source Result	%REC	%REC Limits	RPD	RPD Limit	Flag
<b>Batch AE11707 - EPA 5030 Water GC</b>										
<b>Blank (AE11707-BLK1)</b>										
Prepared & Analyzed: 05/14/01										
TPH as Gasoline	ND	50	ug/l							
Surrogate: 1,4-Bromofluorobenzene	22.6		"	23.1		97.8	48-155			
<b>LCS (AE11707-BS2)</b>										
Prepared & Analyzed: 05/14/01										
TPH as Gasoline	ND	50	ug/l	40.1		111	65-124			
Surrogate: 1,4-Bromofluorobenzene	20.3		"	23.1		87.9	48-155			
<b>LCS Dup (AE11707-BSD2)</b>										
Prepared & Analyzed: 05/14/01										
TPH as Gasoline	ND	50	ug/l	40.1		109	65-124	2.27	14	
Surrogate: 1,4-Bromofluorobenzene	20.3		"	23.1		87.9	48-155			

*Sheri Speaks*

Sheri L. Speaks  
Project Manager

5/17/01



Alpha Analytical Laboratories Inc.

860 Waugh Lane, H-1, Ukiah, California 95482

e-mail: clientservices@alpha-labs.com • Phone: (707) 468-0401 • Fax: (707) 468-5267

**CHEMICAL EXAMINATION REPORT**

Page 6 of 9

EBA Wastechologies  
825 Sonoma Ave. Suite C  
Santa Rosa CA, 95404  
Attn: Christine Scheib

Report Date: 05/17/01 12:24  
Project No: 00-805  
Project ID: Western Stucco

<u>Order Number</u> A105092	<u>Receipt Date/Time</u> 05/04/2001 12:15	<u>Client Code</u> EBA	<u>Client PO/Reference</u>
--------------------------------	--	---------------------------	----------------------------

**TPH as Gasoline by GCFID/5030 and MBTXE by 8020 - Quality Control**

Analyte(s)	Result	PQL	Units	Spike Level	Source Result	%REC %REC	%REC Limits	RPD	RPD Limit	Flag
<b>Batch AE11106 - EPA 5030 Water GC</b>										
<b>Blank (AE11106-BLK1)</b> Prepared & Analyzed: 05/10/01										
TPH as Gasoline	ND	50	ug/l							
Benzene	ND	0.30	"							
Toluene	ND	0.30	"							
Ethylbenzene	ND	0.50	"							
Xylenes (total)	ND	0.50	"							
Methyl tert-butyl ether	ND	1.0	"							
Surrogate: 1,4-Bromofluorobenzene	23.8		"	23.1		103	48-155			
<b>LCS (AE11106-BS1)</b> Prepared & Analyzed: 05/10/01										
Benzene	4.71	0.30	ug/l	5.00		94.2	70-127			
Toluene	4.80	0.30	"	5.00		96.0	80-115			
Ethylbenzene	4.74	0.50	"	5.00		94.8	75-115			
Xylenes (total)	14.4	0.50	"	15.0		96.0	75-115			
Methyl tert-butyl ether	4.67	1.0	"	5.00		93.4	55-122			
Surrogate: 1,4-Bromofluorobenzene	21.4		"	20.0		107	48-155			
<b>LCS (AE11106-BS2)</b> Prepared & Analyzed: 05/10/01										
TPH as Gasoline	ND	50	ug/l	40.1		105	65-124			
Surrogate: 1,4-Bromofluorobenzene	20.9		"	20.0		104	48-155			
<b>LCS Dup (AE11106-BSD1)</b> Prepared & Analyzed: 05/10/01										
Benzene	4.55	0.30	ug/l	5.00		91.0	70-127	3.46	16	
Toluene	4.73	0.30	"	5.00		94.6	80-115	1.47	14	
Ethylbenzene	4.66	0.50	"	5.00		93.2	75-115	1.70	13	
Xylenes (total)	14.1	0.50	"	15.0		94.0	75-115	2.11	15	
Methyl tert-butyl ether	4.61	1.0	"	5.00		92.2	55-122	1.29	13	
Surrogate: 1,4-Bromofluorobenzene	21.0		"	20.0		105	48-155			

*Sheri Speaks*

Sheri L. Speaks  
Project Manager

5/17/01



# Alpha

Alpha Analytical Laboratories Inc.

860 Waugh Lane, H-1, Ukiah, California 95482

e-mail: clientservices@alpha-labs.com • Phone: (707) 468-0401 • Fax: (707) 468-5267

## CHEMICAL EXAMINATION REPORT

EBA Wastechologies  
825 Sonoma Ave. Suite C  
Santa Rosa CA, 95404  
Attn: Christine Scheib

Report Date: 05/17/01 12:24  
Project No: 00-805  
Project ID: Western Stucco

<u>Order Number</u> A105092	<u>Receipt Date/Time</u> 05/04/2001 12:15	<u>Client Code</u> EBA	<u>Client PO/Reference</u>
--------------------------------	--	---------------------------	----------------------------

### TPH as Gasoline by GCFID/5030 and MBTXE by 8020 - Quality Control

Analyte(s)	Result	PQL	Units	Spike Level	Source Result	%REC	%REC Limits	RPD	RPD Limit	Flag
<b>Batch AE11106 - EPA 5030 Water GC</b>										
Prepared & Analyzed: 05/10/01										
LCS Dup (AE11106-BSD2)										
TPH as Gasoline	ND	50	ug/l	40.1		103	65-124	1.68	14	
Surrogate: 1,4-Bromofluorobenzene	20.8		"	20.0		104	48-155			
<b>Batch AE11707 - EPA 5030 Water GC</b>										
Prepared & Analyzed: 05/14/01										
<b>Blank (AE11707-BLK1)</b>										
TPH as Gasoline	ND	50	ug/l							
Benzene	ND	0.30	"							
Toluene	ND	0.30	"							
Ethylbenzene	ND	0.50	"							
Xylenes (total)	ND	0.50	"							
Methyl tert-butyl ether	ND	1.0	"							
Surrogate: 1,4-Bromofluorobenzene	22.6		"	23.1		97.8	48-155			
Prepared & Analyzed: 05/14/01										
<b>LCS (AE11707-BS1)</b>										
Benzene	4.65	0.30	ug/l	5.00		93.0	70-127			
Toluene	4.82	0.30	"	5.00		96.4	80-115			
Ethylbenzene	4.80	0.50	"	5.00		96.0	75-115			
Xylenes (total)	14.4	0.50	"	15.0		96.0	75-115			
Methyl tert-butyl ether	4.80	1.0	"	5.00		96.0	55-122			
Surrogate: 1,4-Bromofluorobenzene	21.5		"	23.1		93.1	48-155			
Prepared & Analyzed: 05/14/01										
<b>LCS (AE11707-BS2)</b>										
TPH as Gasoline	ND	50	ug/l	40.1		111	65-124			
Surrogate: 1,4-Bromofluorobenzene	20.3		"	23.1		87.9	48-155			
Prepared & Analyzed: 05/14/01										
<b>LCS Dup (AE11707-BSD1)</b>										
Benzene	4.53	0.30	ug/l	5.00		90.6	70-127	2.61	16	
Toluene	4.69	0.30	"	5.00		93.8	80-115	2.73	14	
Ethylbenzene	4.62	0.50	"	5.00		92.4	75-115	3.82	13	

*Sheri Speaks*

Sheri L. Speaks  
Project Manager





Alpha Analytical Laboratories Inc.

860 Waugh Lane, H-1, Ukiah, California 95482

e-mail: clientservices@alpha-labs.com • Phone: (707) 468-0401 • Fax: (707) 468-5267

**CHEMICAL EXAMINATION REPORT**

Page 8 of 9

EBA Wastechologies  
825 Sonoma Ave. Suite C  
Santa Rosa CA, 95404  
Attn: Christine Scheib

Report Date: 05/17/01 12:24  
Project No: 00-805  
Project ID: Western Stucco

<u>Order Number</u> A105092	<u>Receipt Date/Time</u> 05/04/2001 12:15	<u>Client Code</u> EBA	<u>Client PO/Reference</u>
--------------------------------	--	---------------------------	----------------------------

**TPH as Gasoline by GCFID/5030 and MBTXE by 8020 - Quality Control**

Analyte(s)	Result	PQL	Units	Spike Level	Source Result	%REC	%REC Limits	RPD	RPD Limit	Flag
<b>Batch AE11707 - EPA 5030 Water GC</b>										
<b>LCS Dup (AE11707-BSD1)</b>				Prepared & Analyzed: 05/14/01						
Xylenes (total)	14.0	0.50	"	15.0		93.3	75-115	2.82	15	
Methyl tert-butyl ether	4.79	1.0	"	5.00		95.8	55-122	0.209	13	
Surrogate: 1,4-Bromofluorobenzene	21.0		"	23.1		90.9	48-155			
<b>LCS Dup (AE11707-BSD2)</b>				Prepared & Analyzed: 05/14/01						
TPH as Gasoline	ND	50	ug/l	40.1		109	65-124	2.27	14	
Surrogate: 1,4-Bromofluorobenzene	20.3		"	23.1		87.9	48-155			

*Sheri Speaks*

Sheri L. Speaks  
Project Manager

5/17/01



Alpha

Alpha Analytical Laboratories Inc.

860 Waugh Lane, H-1, Ukiah, California 95482

e-mail: clientservices@alpha-labs.com • Phone: (707) 468-0401 • Fax: (707) 468-5267

**CHEMICAL EXAMINATION REPORT**

Page 9 of 9

EBA Wastechнологies  
825 Sonoma Ave. Suite C  
Santa Rosa CA, 95404  
Attn: Christine Scheib

Report Date: 05/17/01 12:24  
Project No: 00-805  
Project ID: Western Stucco

Order Number  
A105092

Receipt Date/Time  
05/04/2001 12:15

Client Code  
EBA

Client PO/Reference

**Notes and Definitions**

- R-01 The Reporting Limit for this analyte has been raised to account for matrix interference.
- DET Analyte DETECTED
- ND Analyte NOT DETECTED at or above the reporting limit
- NR Not Reported
- dry Sample results reported on a dry weight basis
- RPD Relative Percent Difference
- PQL Practical Quantitation Limit



# WORK ORDER CHAIN OF CUSTODY RECORD

Alpha Analytical Laboratories Inc. • 860 Waugh Lane, H-1, Ukiah, CA 95482 • (707) 468-0401 • FAX (707) 468-5267

DATE 5/3/01 PAGE 1 OF 1

CLIENT'S NAME <b>EBA Wastechologies</b>				PROJECT MANAGER <b>Christine Scheib</b>				ANALYSES		SAMPLE CONDITION ON RECEIPT:			
STREET ADDRESS <b>825 Sonoma Ave Santa Rosa CA 95401</b>				PHONE NUMBER <b>(707) 544-0784</b>								COLD/ICED? <b>Yes</b>	
PROJECT NAME <b>Western Stucco</b>				FAX NUMBER <b>(707) 544-0866</b>								BUBBLES OR AIR SPACE? <b>Yes</b>	
CONTRACT/PURCHASE ORDER/QUOTE NUMBER <b>00-805</b>				SITE CONTACT <b>Al Avendano</b>								WERE SAMPLES PRESERVED? <b>Not Used</b>	
SIGNATURE OF PERSON AUTHORIZING WORK UNDER TERMS STATED ON REVERSE SIDE OF THIS FORM. <b>Erik Pheix</b>						SAMPLED BY <b>E. Pheix</b>		EXPLAIN IRREGULARITIES BELOW					

SAMPLE NUMBER/IDENTIFICATION	DATE	TIME	LAB SAMPLE NUMBER	SAMPLE TYPE					NO. OF CONTS.								
				LIQ	AIR	SOLID	COMP	GRAB		TPH9	TPH4	BTX	MTBE				
MW-1	5/3/01	1500	A105092-1	X					5	X	X	X	X		}	Bubbles in some VOA's were unavoidable	
MW-2	↓	1520	-2	X					5	X	X	X	X				
MW-3	↓	1445	-3	X					5	X	X	X	X				
Trip Blank	↓	0800	-4	X					1	X							
													* Please confirm MTBE hits with Method 8260				

RELINQUISHED BY: <b>Erik Pheix</b>			RECEIVED BY: <b>R. Ornefeld</b>			DATE: <b>5/4/01</b>	TIME: <b>10:00</b>	TURN AROUND TIME REQUESTED	
RELINQUISHED BY: <b>R. Ornefeld</b>			RECEIVED BY: <b>Shari Sparks</b>			DATE: <b>5/4/01</b>	TIME: <b>12:15</b>		Normal
METHOD OF SHIPMENT			AUTHORIZED BY:			SAMPLE CONTROL OFFICER			
SPECIAL INSTRUCTIONS						SAMPLE DESPOSITION:			
DRIVING TIME						1. STORAGE TIME REQUESTED _____ DAYS (SAMPLES WILL BE STORED FOR 30 DAYS WITHOUT ADDITIONAL CHARGES; THEREAFTER STORAGE CHARGES WILL BE BILLED AT THE PUBLISHED RATES.)			
SITE TIME						2. SAMPLE TO BE RETURNED TO CLIENT? <input type="checkbox"/> YES <input type="checkbox"/> NO			
TOTAL TIME						HAZARDOUS MATERIALS ARE THE PROPERTY OF THE CLIENT. THE CLIENT IS RESPONSIBLE FOR PROPER DISPOSAL OF HAZARDOUS WASTES. CLIENTS NOT PICKING UP HAZARDOUS WASTES MAY BE ASSESSED AN APPROPRIATE FEE.			