

RECEIVED

By Alameda County Environmental Health at 2:25 pm, Jul 29, 2013

Atlantic Richfield Company

Shannon Couch
Operations Project Manager

PO Box 1257
San Ramon, CA 94583
Phone: (925) 275-3804
Fax: (925) 275-3815
E-Mail: shannon.couch@bp.com

July 9, 2013

Re: Second Quarter 2013 Status Report
Atlantic Richfield Company Service Station #601
712 Lewelling Boulevard, San Leandro, California
ACEH Case #RO0000309

"I declare, that to the best of my knowledge at the present time, that the information and/or recommendations contained in the attached document are true and correct.

Submitted by,

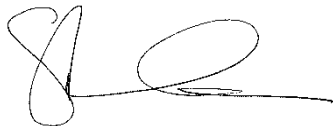

Shannon Couch
Operations Project Manager

Attachment

July 9, 2013

Project No. 06-88-605

Atlantic Richfield Company
P.O. Box 1257
San Ramon, CA 94583
Submitted via ENFOS

Attn.: Ms. Shannon Couch

Re: Second Quarter 2013 Status Report, Atlantic Richfield Company Station #601,
712 Lewelling Boulevard, San Leandro, Alameda County, California;
ACEH Case #RO0000309

Dear Ms. Couch:

Attached is the *Second Quarter 2013 Status Report* for Atlantic Richfield Company Station #601 located at 712 Lewelling Boulevard, San Leandro, California (Site). This report presents a summary of current developments at the Site through the Second Quarter of 2013. Should you have questions regarding the work performed or results obtained, please do not hesitate to contact us at (707) 455-7290.

Sincerely,
BROADBENT & ASSOCIATES, INC.

James Ramos, EIT
Senior Staff Engineer

Kristene Tidwell, P.G., C.Hg.
Senior Geologist

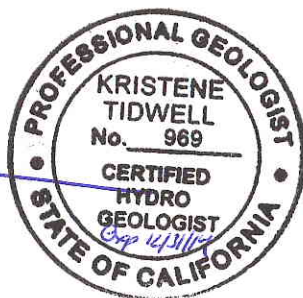

enclosures

cc: Ms. Dilan Roe, Alameda County Environmental Health (submitted via ACEH ftp site)
Mr. Karl Busche, City of San Leandro (Submitted via GeoTracker)
Electronic copy uploaded to GeoTracker

**SECOND QUARTER 2013
STATUS REPORT
STATION #601, SAN LEANDRO, CALIFORNIA**

Broadbent & Associates, Inc. (Broadbent) is pleased to present this *Second Quarter 2013 Status Report* on behalf of Atlantic Richfield Company (a BP affiliated company) for Station #601 located in San Leandro, Alameda County, California. Monitoring activities at the site were performed in accordance with the reporting requirements issued by the Alameda County Environmental Health (ACEH). Details of work performed, discussion of results, and recommendations are provided below.

Facility Name / Address:	Station #601 / 712 Lewelling Boulevard, San Leandro, California
Client Project Manager / Title:	Ms. Shannon Couch, Remediation Management Project Manager
Broadbent Contact:	Kristene Tidwell, P.G., C.Hg., (707) 455-7290
Broadbent Project No.:	06-88-605
Primary Regulatory Agency / ID No.:	Alameda County Environmental Health (ACEH)/ Case #RO0000309
Current phase of project:	Monitoring
List of Acronyms / Abbreviations:	See end of report text for list of acronyms/abbreviations used in report.

WORK PERFORMED THIS QUARTER (Second Quarter 2013):

1. Submitted *First Quarter 2013 Monitoring Report* on April 25, 2013 (Q3 GWM Report).
2. No environmental field activities were conducted for Second Quarter 2013.

WORK SCHEDULED FOR NEXT QUARTER (Third Quarter 2013):

1. Submit *Second Quarter 2013 Status Report* (contained herein).
2. Conduct Third Quarter 2013 groundwater monitoring and sampling event.

GROUNDWATER MONITORING PLAN SUMMARY:

Groundwater level gauging:	MW-1 through MW-3, and MW-8 through MW-19	(1Q & 3Q)
Groundwater sample collection:	MW-1, MW-3, MW-10, MW-16, MW-17, and MW-18 MW-2, MW-8, MW-9, MW-14, MW- 15, and MW-19	(1Q & 3Q) (3Q)
Biodegradation indicator parameter monitoring:	None	

QUARTERLY RESULTS SUMMARY:

LNAPL

LNAPL observed this quarter:	N/A	(yes/no)
LNAPL recovered this quarter:	N/A	(gal)
Cumulative LNAPL recovered:	N/A	(gal)

Groundwater Elevation and Gradient:

Depth to groundwater:	N/A	(ft below TOC)
Gradient direction:	N/A	(compass direction)
Gradient magnitude:	N/A	(ft/ft)
Average change in elevation:	N/A	(ft since last measurement)

Laboratory Analytical Data

Summary:

No environmental field activities were conducted during Second Quarter 2013.

DISCUSSION:

No environmental field activities were conducted by Broadbent & Associates at the Site during the Second Quarter of 2013. The most recent groundwater monitoring and sampling occurred during the Third Quarter of 2013, the results of which are contained within the Q3 GWM Report. Currently, the Site is being evaluated for site closure under the Low Threat UST Closure Policy that was recently put in place by the State Water Resources Control Board. For immediate reference, a site location map is presented as Drawing 1 and a groundwater elevation and analytical summary map from the most recent first quarter sampling event 7 is presented as Drawing 2.

LIMITATIONS:

The findings presented in this report are based upon observations of field personnel, points investigated, results of laboratory tests performed by TestAmerica Laboratories, Inc. (Irvine, California), and our understanding of ACEH requirements. Our services were performed in accordance with the generally accepted standard of practice at the time this report was written. No other warranty, expressed or implied was made. This report has been prepared for the exclusive use of the Atlantic Richfield Company. It is possible that variations in soil or groundwater conditions could exist beyond points explored in this investigation. Also, changes in site conditions could occur in the future due to variations in rainfall, temperature, regional water usage, or other factors.

ATTACHMENTS:

Drawing 1: Site Location Map

Drawing 2: Groundwater Elevation Contours and Analytical Summary Map, January 31, 2013.

LIST OF COMMONLY USED ACRONYMS/ABBREVIATIONS:

ACEH:	Alameda County Environmental Health	ft/ft:	feet per foot
Broadbent:	Broadbent & Associates, Inc.	gal:	Gallons
BTEX:	Benzene, Toluene, Ethylbenzene, Total Xylenes	GRO:	Gasoline-Range Organics
1,2-DCA:	1,2-Dichloroethane	LNAPL:	Light Non-Aqueous Phase Liquid
DIPE:	Di-Isopropyl Ether	MTBE:	Methyl Tertiary Butyl Ether
DO:	Dissolved Oxygen	NO ₃ :	Nitrate as Nitrogen
DRO:	Diesel-Range Organics	ppb:	parts per billion
EDB:	1,2-Dibromomethane	SO ₄ :	Sulfate
Eh:	Oxidation Reduction Potential	TAME:	Tert-Amyl Methyl Ether
EPA:	Environmental Protection Agency	TBA:	Tertiary Butyl Ether
ETBE:	Ethyl Tertiary Butyl Ether	TOC:	Top of Casing
Fe ²⁺ :	Ferrous Iron	µg/L:	micrograms per liter

DRAWINGS

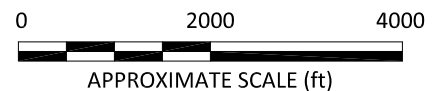
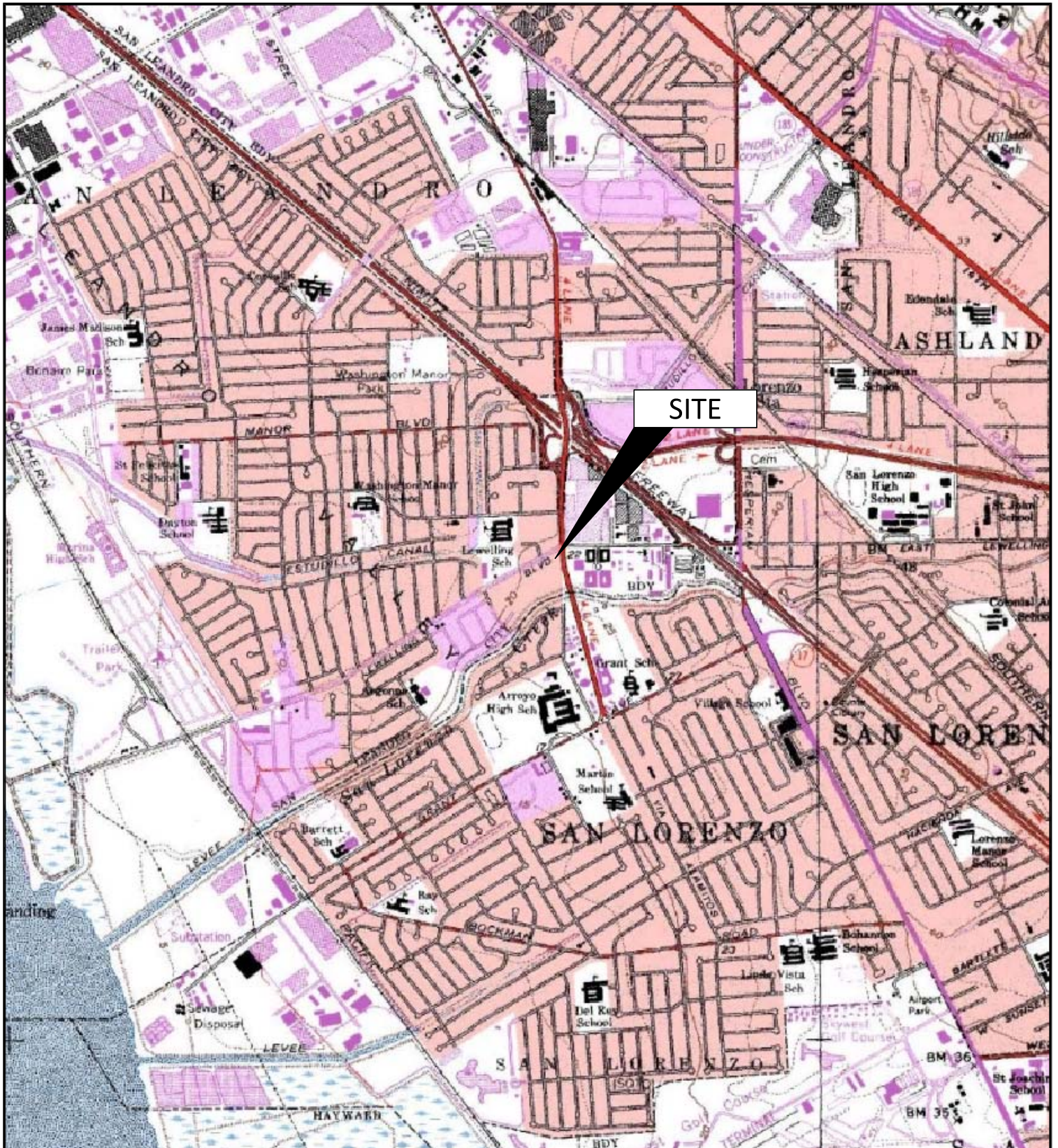

IMAGE SOURCE: USGS



1324 Mangrove Ave., Suite 212
Chico, California 95626

Project No.: 06-88-605 Date: 3/5/2013

Station #601
712 Lewelling Boulevard
San Leandro, California

Site Location Map

Drawing

1

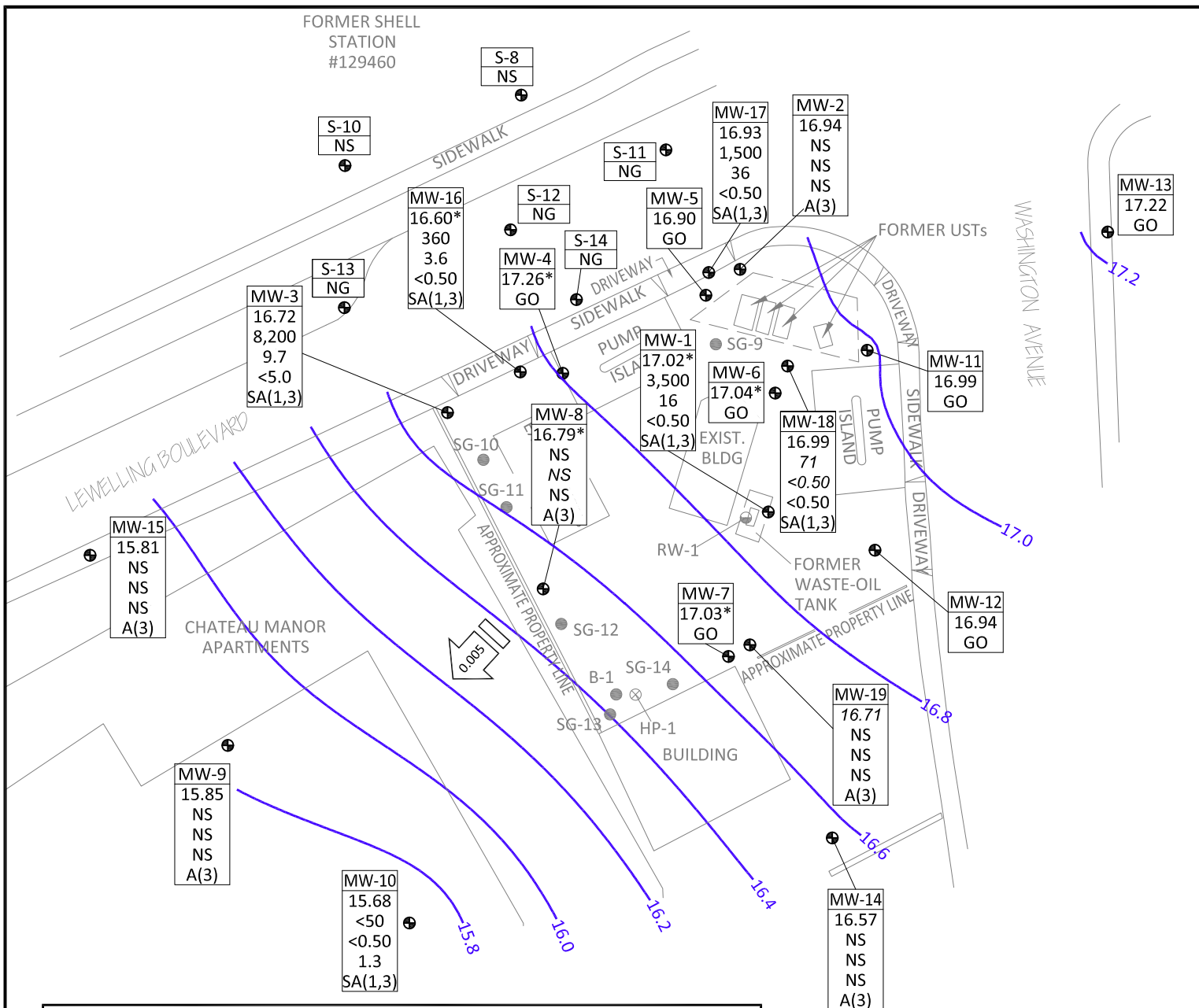

NOTE: SITE MAP ADAPTED FROM DELTA ENVIRONMENTAL FIGURES. SITE DIMENSIONS AND FACILITY LOCATIONS NOT VERIFIED.



Project No.: 06-88-605 Date: 3/5/2013

Station #601
712 Lewelling Boulevard
San Leandro, California

Groundwater Elevation Contours
and Analytical Summary Map
January 31, 2013

Drawing

2