

# Atlantic Richfield Company

**Chuck Carmel**  
Environmental Business Manager

**RECEIVED**

9:58 am, Jan 06, 2011

Alameda County  
Environmental Health

PO Box 1257  
San Ramon, CA 94583  
Phone: (925) 275-3803  
Fax: (925) 275-3815  
E-Mail: charles.carmel@bp.com

January 5, 2011

Re: Fourth Quarter 2010 Semi-Annual Groundwater Monitoring Report  
Atlantic Richfield Company Service Station #601  
712 Lewelling Boulevard, San Leandro, California  
ACEH Case #RO0000309

"I declare, that to the best of my knowledge at the present time, that the information and/or recommendations contained in the attached document are true and correct.

Submitted by,



Chuck Carmel  
Environmental Business Manager

Attachment

Broadbent & Associates, Inc.  
875 Cotting Ln., Suite G  
Vacaville, CA 95688  
(707) 455-7290 Tel  
(707) 455-7295 Fax



January 5, 2011

Project No. 06-88-605

Atlantic Richfield Company  
P.O. Box 1257  
San Ramon, CA 94583  
Submitted via ENFOS

Attn.: Mr. Chuck Carmel

Re: Fourth Quarter 2010 Status Report, Atlantic Richfield Company Station #601  
712 Lewelling Boulevard, San Leandro, Alameda County, California;  
ACEH Case #RO0000309

Dear Mr. Carmel:

Attached is the *Fourth Quarter 2010 Status Report* for Atlantic Richfield Company (a BP affiliated company) Station #601 located at 712 Lewelling Boulevard, San Leandro, California (Site). This report presents a summary of current developments at the Site through the Fourth Quarter of 2010.

Should you have questions regarding the work performed or results obtained, please do not hesitate to contact us at (707) 455-7290.

Sincerely,

BROADBENT & ASSOCIATES, INC.

A handwritten signature in blue ink that reads 'Thomas A. Sparrowe'.

Thomas A. Sparrowe, P.G.  
Senior Geologist



Enclosure

cc: Mr. Paresh Khatri, Alameda County Environmental Health (Submitted via ACEH ftp site)  
Mr. Karl Busche, City of San Leandro (Submitted via GeoTracker)  
Electronic copy uploaded to GeoTracker

## STATION #601 QUARTERLY STATUS REPORT

Facility: #601	Address:	712 Lewelling Boulevard, San Leandro, California
Environmental Business Manager:		Mr. Chuck Carmel
Consulting Co./Contact Persons:		Broadbent & Associates, Inc.(BAI)/Tom Sparrowe (707) 455-7290
Consultant Project No.:		06-88-605
Primary Agency/Regulatory ID No.:		Alameda County Environmental Health (ACEH) ACEH Case #RO0000309

### WORK PERFORMED THIS QUARTER (Fourth Quarter 2010):

1. Prepared and submitted a *Third Quarter 2010 Semi-Annual Groundwater Monitoring Report* (BAI, 10/5/2010).
2. Prepared and submitted an *Additional Soil and Groundwater Investigation Work Plan* (BAI, 10/19/10).

### WORK PROPOSED FOR NEXT QUARTER (First Quarter 2011):

1. Prepare and submit *Fourth Quarter 2010 Status Report* (contained herein).
2. Conduct First Quarter 2011 semi-annual groundwater monitoring/sampling event.
3. Prepare and submit *First Quarter 2011 Groundwater Monitoring and Sampling Report*.

### RESULTS SUMMARY:

Current phase of project:	<b>Groundwater Monitoring/Sampling/Feasibility Studies</b>
Frequency of groundwater monitoring:	<b>Semi-Annually (1Q &amp; 3Q): Wells MW-1 through MW-3 and MW-8 through MW-19</b>
Frequency of groundwater sampling:	<b>Semi-Annually (1Q &amp; 3Q): MW-1, MW-3, MW-10, MW-16, MW-17 and MW-18 Annually (3Q): MW-2, MW-8, MW-9, MW-14, MW-15 and MW-19</b>
Is free product (FP) present on-site:	<b>No</b>
FP recovered this quarter:	<b>NA</b>
Cumulative FP recovered:	<b>3.45 gallons (Well MW-1)</b>
Current remediation techniques:	<b>NA</b>
Depth to ground water (below TOC):	<b>NA</b>
General groundwater flow direction:	<b>NA</b>
Approximate hydraulic gradient:	<b>NA</b>

### DISCUSSION:

No environmental field work was conducted by Broadbent & Associates at the Site during the Fourth Quarter of 2010. The most recent groundwater monitoring/sampling occurred during the Third Quarter of 2010, the results of which are contained within the *Third Quarter 2010 Semi-Annual Groundwater Monitoring Report* (BAI, 10/05/10). For reference, a site location map is provided as Drawing 1 and a groundwater elevation and analytical summary map, dated July 22, 2010, is provided as Drawing 2.

On November 19, 2010, BP and BAI submitted an *Additional Soil and Groundwater Investigation Work Plan* to ACEH. At this time, BP and BAI are awaiting correspondence from ACEH approving the work plan.

**ATTACHMENTS:**

- Drawing 1.      Site Location Map, Station #601, 712 Lewelling Boulevard, San Leandro, California
- Drawing 2.      Groundwater Elevation Contours and Analytical Summary Map, July 22, 2010, Station  
#601, 712 Lewelling Boulevard, San Leandro, California

## **DRAWINGS**



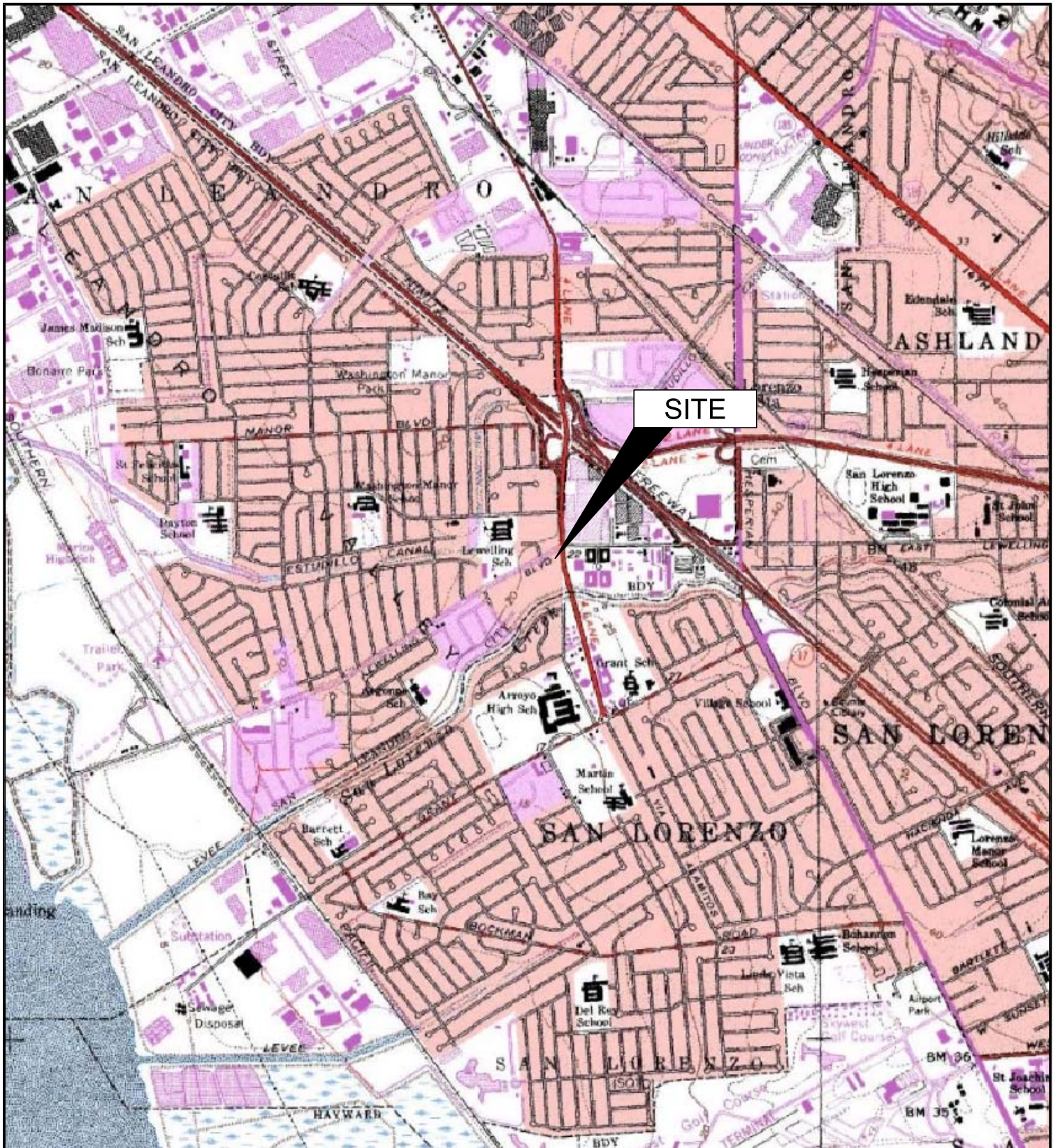

0 2000 4000  
 APPROXIMATE SCALE (ft)

IMAGE SOURCE: USGS



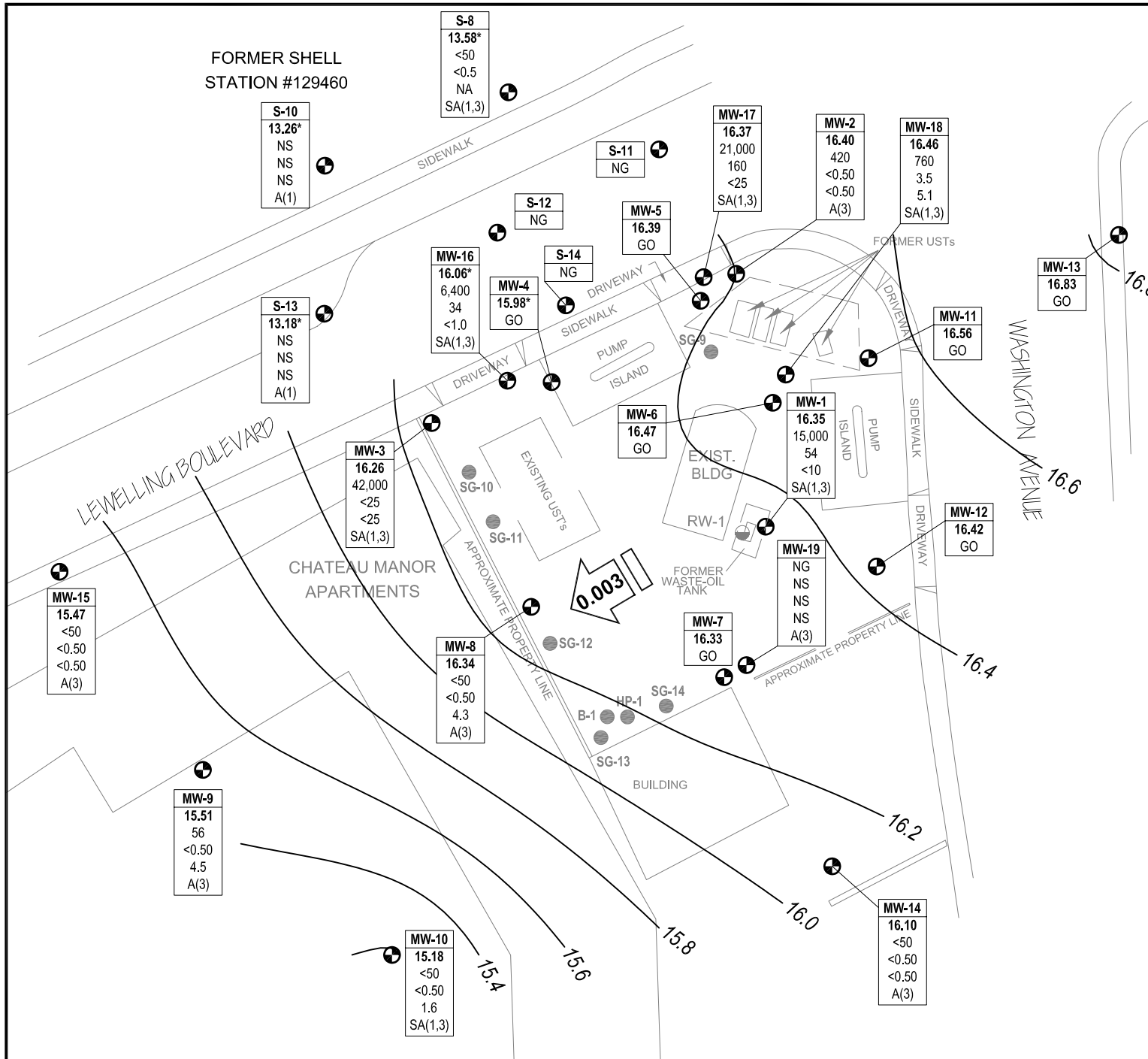

NOTE: SITE MAP ADAPTED FROM DELTA ENVIRONMENTAL FIGURES. SITE DIMENSIONS AND FACILITY LOCATIONS NOT VERIFIED.

**BROADBENT & ASSOCIATES, INC.**

ENGINEERING, WATER RESOURCES & ENVIRONMENTAL  
1324 Mangrove Ave. Suite 212, Chico, California

Project No.: 06-88-605 Date: 9/20/2010

Station #601  
712 Lewelling Boulevard  
San Leandro, California

Groundwater Elevation Contours  
and Analytical Summary Map  
July 22, 2010

Drawing

2