

# Atlantic Richfield Company

**RECEIVED**

By Alameda County Environmental Health at 10:58 am, Aug 01, 2014

**Chuck Carmel**

Remediation Management Project Manager

PO Box 1257  
San Ramon, CA 94583  
Phone: (925) 275-3804  
Fax: (925) 275-3815  
E-Mail: chuck.carmel@bp.com

July 30, 2014

Re: Second Quarter 2014 Status Report  
Atlantic Richfield Company Service Station #601  
712 Lewelling Boulevard, San Leandro, California  
ACEH Case #RO0000309

"I declare, that to the best of my knowledge at the present time, that the information and/or recommendations contained in the attached document are true and correct.

Submitted by,



Chuck Carmel

Remediation Management Project Manager

Attachment



**BROADBENT**

4820 Business Center Drive, Suite 110  
Fairfield, CA 94534  
[T] 707-455-7290 [F] 707-863-9046  
broadbentinc.com

***Creating Solutions. Building Trust.***

July 30, 2014

Project No. 06-88-605

Atlantic Richfield Company  
P.O. Box 1257  
San Ramon, CA 94583  
Submitted via ENFOS

Attn.: Mr. Chuck Carmel

Re: Second Quarter 2014 Status Report, Atlantic Richfield Company Station No. 601,  
712 Lewelling Boulevard, San Leandro, Alameda County, California;  
ACEH Case #RO0000309

Dear Mr. Carmel:

Attached is the *Second Quarter 2014 Status Report* for Atlantic Richfield Company Station No. 601 located at 712 Lewelling Boulevard, San Leandro, California (Site). This report presents a summary of current developments at the Site through the Second Quarter of 2014. Should you have questions regarding the work performed or results obtained, please do not hesitate to contact us at (707) 455-7290.

Sincerely,  
BROADBENT & ASSOCIATES, INC.

Kristene Tidwell, P.G., C.H.G.  
Senior Hydrogeologist

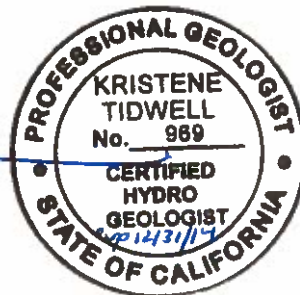

enclosures

cc: Mr. Jerry Wickham, Alameda County Environmental Health (submitted via ACEH ftp site)  
Mr. Karl Busche, City of San Leandro (Submitted via GeoTracker)  
Electronic copy uploaded to GeoTracker

**SECOND QUARTER 2014  
STATUS REPORT  
STATION No. 601, SAN LEANDRO, CALIFORNIA**

Broadbent & Associates, Inc. (Broadbent) is pleased to present this *Second Quarter 2014 Status Report* on behalf of Atlantic Richfield Company (a BP affiliated company) for Station No. 601 located in San Leandro, Alameda County, California (Site). Monitoring activities at the site were performed in accordance with the reporting requirements issued by the Alameda County Environmental Health (ACEH). Details of work performed, discussion of results, and recommendations are provided below.

Facility Name / Address:	Station No. 601 / 712 Lewelling Boulevard, San Leandro, California
Client Project Manager / Title:	Mr. Chuck Carmel, Remediation Management Project Manager
Broadbent Contact:	Kristene Tidwell, P.G., C.Hg., (707) 455-7290
Broadbent Project No.:	06-88-605
Primary Regulatory Agency / ID No.:	Alameda County Environmental Health (ACEH)/ Case #RO0000309
Current phase of project:	Monitoring
List of Acronyms / Abbreviations:	See end of report text for list of acronyms/abbreviations used in report.

**WORK PERFORMED THIS QUARTER (Second Quarter 2014):**

1. Submitted *First Quarter 2014 Monitoring Report* on April 30, 2014 (Q3 GWM Report).
2. Carried out soil vapor investigation as approved by the ACEH on April 22, 2014.
3. No environmental field activities were conducted for Second Quarter 2014.

**WORK SCHEDULED FOR NEXT QUARTER (Third Quarter 2014):**

1. Submit *Second Quarter 2014 Status Report* (contained herein).
2. Conduct Third Quarter 2014 groundwater monitoring and sampling event.

**GROUNDWATER MONITORING PLAN SUMMARY:**

Groundwater level gauging:	MW-1 through MW-3, and MW-8 through MW-19	(1Q & 3Q)
Groundwater sample collection:	MW-1, MW-3, MW-10, MW-16, MW-17, and MW-18	(1Q & 3Q)
	MW-2, MW-8, MW-9, MW-14, MW-15, and MW-19	(3Q)
Biodegradation indicator parameter monitoring:	None	

**QUARTERLY RESULTS SUMMARY:**

**LNAPL**

LNAPL observed this quarter:	N/A	(yes/no)
LNAPL recovered this quarter:	N/A	(gal)
Cumulative LNAPL recovered:	N/A	(gal)

**Groundwater Elevation and Gradient:**

Depth to groundwater:	N/A	(ft below TOC)
Gradient direction:	N/A	(compass direction)
Gradient magnitude:	N/A	(ft/ft)
Average change in elevation:	N/A	(ft since last measurement)

## Laboratory Analytical Data

### Summary:

No environmental field activities were conducted during Second Quarter 2014.

---

## DISCUSSION:

The most recent groundwater monitoring and sampling occurred during the First Quarter of 2014, the results of which are contained within the Q1 GWM Report. Additional soil vapor investigation was conducted April 22, 2014 in accordance with work plan, Additional Soil Vapor Sampling requested by the ACEH on February 12, 2014 and approved by the ACEH on February 20, 2014. A Case Closure Request Addendum was recently submitted and currently groundwater monitoring is suspended for this Site per ACEH approval.

A site location map is presented as Drawing 1 and a groundwater elevation and analytical summary map from the most recent first quarter sampling event is presented as Drawing 2.

## LIMITATIONS:

The findings presented in this report are based upon observations of field personnel, points investigated, results of laboratory tests performed by TestAmerica Laboratories, Inc. (Irvine, California), and our understanding of ACEH requirements. Our services were performed in accordance with the generally accepted standard of practice at the time this report was written. No other warranty, expressed or implied was made. This report has been prepared for the exclusive use of the Atlantic Richfield Company. It is possible that variations in soil or groundwater conditions could exist beyond points explored in this investigation. Also, changes in site conditions could occur in the future due to variations in rainfall, temperature, regional water usage, or other factors.

## ATTACHMENTS:

Drawing 1: Site Location Map

Drawing 2: Groundwater Elevation Contours and Analytical Summary Map, January 28, 2014.

## LIST OF COMMONLY USED ACRONYMS/ABBREVIATIONS:

ACEH:	Alameda County Environmental Health	ft/ft:	feet per foot
Broadbent:	Broadbent & Associates, Inc.	gal:	Gallons
BTEX:	Benzene, Toluene, Ethylbenzene, Total Xylenes	GRO:	Gasoline-Range Organics
1,2-DCA:	1,2-Dichloroethane	LNAPL:	Light Non-Aqueous Phase Liquid
DIPE:	Di-Isopropyl Ether	MTBE:	Methyl Tertiary Butyl Ether
DO:	Dissolved Oxygen	NO <sub>3</sub> :	Nitrate as Nitrogen
DRO:	Diesel-Range Organics	ppb:	parts per billion
EDB:	1,2-Dibromomethane	SO <sub>4</sub> :	Sulfate
Eh:	Oxidation Reduction Potential	TAME:	Tert-Amyl Methyl Ether
EPA:	Environmental Protection Agency	TBA:	Tertiary Butyl Ether
ETBE:	Ethyl Tertiary Butyl Ether	TOC:	Top of Casing
Fe <sup>2+</sup> :	Ferrous Iron	µg/L:	micrograms per liter

## **DRAWINGS**



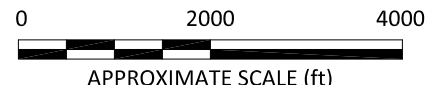
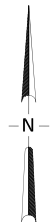
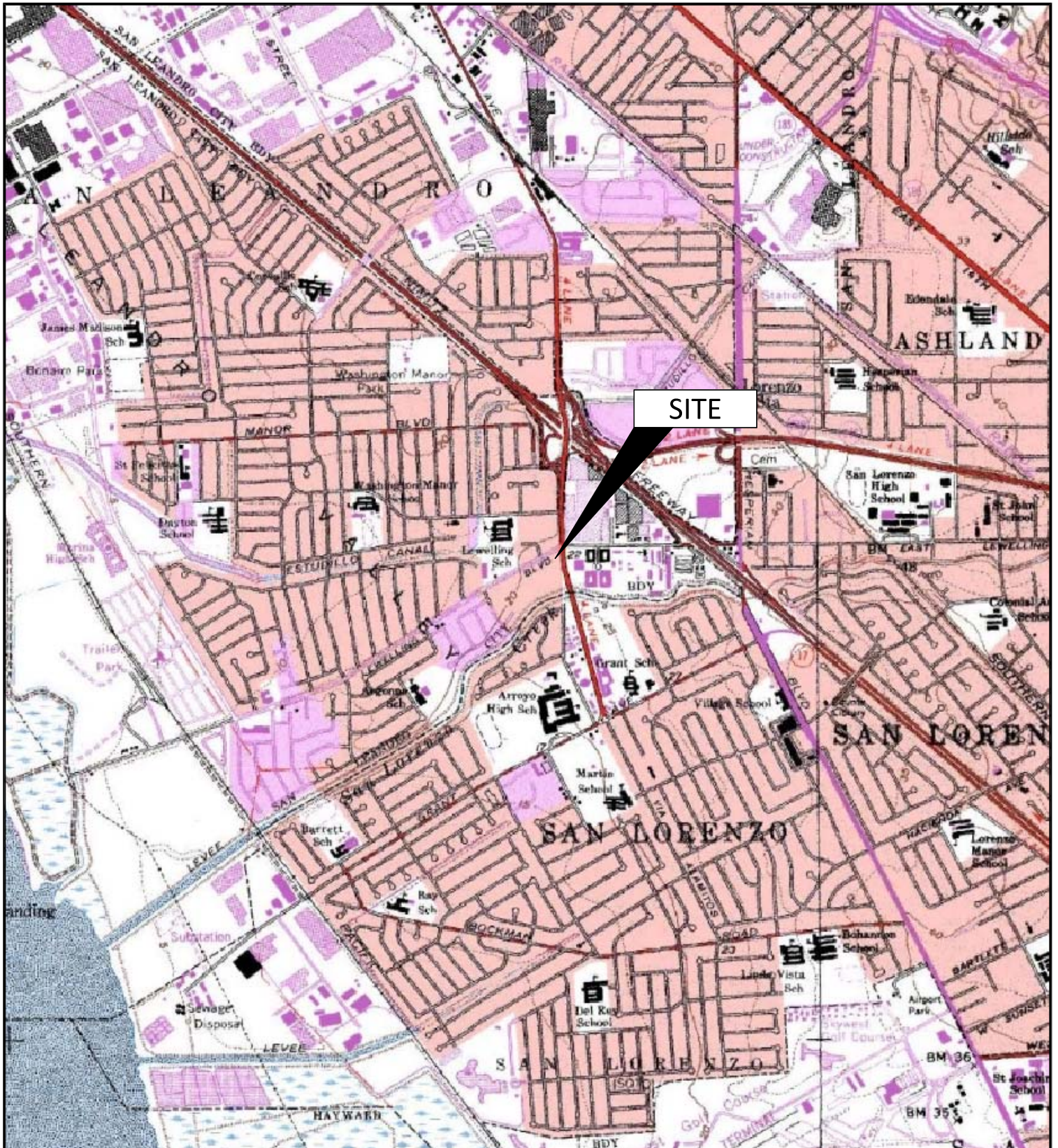

IMAGE SOURCE: USGS



1324 Mangrove Ave., Suite 212  
Chico, California 95626  
Project No.: 06-88-605 Date: 3/5/2013

Station #601  
712 Lewelling Boulevard  
San Leandro, California

Site Location Map

Drawing

1



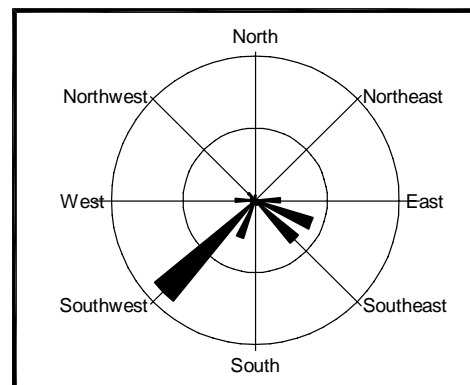
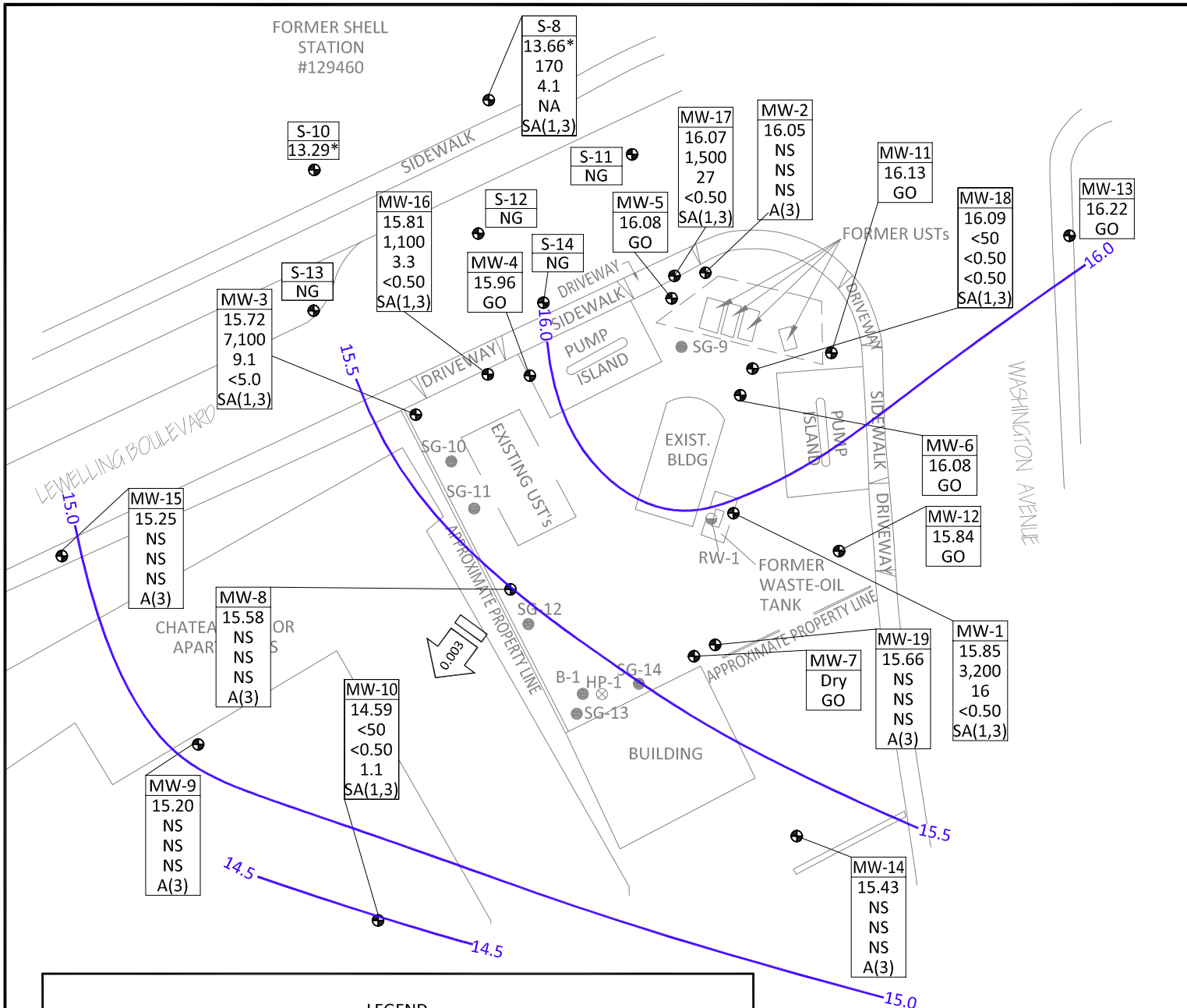

NOTE: SITE MAP ADAPTED FROM DELTA ENVIRONMENTAL FIGURES. SITE DIMENSIONS AND FACILITY LOCATIONS NOT VERIFIED.



Project No.: 06-88-605 Date: 2/26/2014

Station No 601  
712 Levee Boulevard  
San Leandro, California

Groundwater Elevation Contours  
and Analytical Summary Map  
January 28, 2014

Drawing

2