

6920 Koll Center Parkway
Suite 216
Pleasanton, CA 94566
925.426.2600
Fax 925.426.0106



October 19, 2001

Ms. Betty Graham
REGIONAL WATER QUALITY CONTROL BOARD
1515 Clay Street, Suite 1400
Oakland, California 94612

Clayton Project No. 70-00509.00

Subject: Third Quarter 2001 Groundwater Monitoring Report at 5050, 5051, and
5200 Coliseum Way and 750-50th Avenue, Oakland, California.
SLIC No. 01S0422 (BG)

Dear Ms. Graham:

Enclosed please find Clayton Group Services, Inc.'s (Clayton's) *Third Quarter 2001 Groundwater Monitoring Report at 5050, 5051, and 5200 Coliseum Way and 750-50th Avenue, Oakland, California*. This report presents the results of Clayton's quarterly monitoring conducted in August 2001 at the subject property.

Clayton, under penalty of perjury as an authorized representative of Oakland 5051, LLC, presents this report as true and correct to the best of our knowledge. If you have any questions or comments, please call me at (925) 426-2686.

Sincerely,

A handwritten signature in black ink, appearing to read "Dwight R. Hoenig", is written over a faint, larger version of the same signature.

Dwight R. Hoenig
Vice President, Western Regional Director
Environmental Services
San Francisco Regional Office

DRH/daa

cc: Matthew Robinson - Environmental Operations, Inc.
Tim Colvig - Wulfsberg Reese & Sykes
Barney Chan - Alameda County Health Care Services
William Wick - Crosby, Heafey, Roach, and May

6920 Koll Center Parkway
Suite 216
Pleasanton, CA 94566
925.426.2600
Fax 925.426.0106



**Third Quarter 2001
Groundwater Monitoring Report
at
5050, 5051, and 5200 Coliseum Way, and
750-50th Street
Oakland, California**

**For
5050 Coliseum, LLC, and
Oakland 5051, LLC
Clayton Project No. 70-00509.00.300**

October 19, 2001

<u>Section</u>	<u>Page</u>
1.0 INTRODUCTION	1
2.0 SITE SETTING	1
3.0 FIELD ACTIVITIES	2
3.1. DEPTH TO WATER MEASUREMENTS	2
3.2. MONITORING WELL SAMPLES	2
4.0 LABORATORY ANALYSES	2
5.0 SITE HYDROLOGY	3
6.0 GROUNDWATER ANALYTICAL RESULTS	3
6.1. PETROLEUM HYDROCARBONS	3
6.2. METALS	4
7.0 LIMITATIONS	5

Tables

- 1 Quarterly Monitoring/Sampling Schedule
- 2 Groundwater Elevation Data
- 3 Petroleum Hydrocarbons Detected in Groundwater
- 4 Metals, Total Dissolved Solids, pH, and Chloride Detected in Groundwater

Figures

- 1 Site Location Map
- 2 Potentiometric Surface Map
- 3 Concentrations of Arsenic in Groundwater
- 4 Concentrations of Barium in Groundwater
- 5 Concentrations of Cadmium in Groundwater
- 6 Concentrations of Zinc in Groundwater

1.0 INTRODUCTION

Clayton Group Services, Inc. (Clayton), performed quarterly groundwater monitoring activities at the Coliseum Way Properties located at 5050, 5051, and 5200 Coliseum Way and 750-50th Avenue in Oakland, California (Figure 1 and Figure 2). The California Regional Water Quality Control Board - San Francisco Bay region (RWQCB), has requested that groundwater monitoring be performed at the subject properties to monitor the fate of petroleum hydrocarbons and metal ions.

The third quarter 2001 monitoring event included collecting depth to water measurements from 22 groundwater-monitoring wells and groundwater samples from 12 wells. Field measurements and groundwater monitoring well sampling were carried out on August 30, 2001. This report presents groundwater measurements recorded in the field and the results of laboratory analyses performed on groundwater samples collected for the third quarter 2001 monitoring event.

2.0 SITE SETTING

The 5050 and 5200 properties are located about 600 feet east of Interstate 880 and the 5051 property is located about 75 feet east of Interstate 880, in Oakland, California. The properties are bordered by stormwater drainage channels that flow into the San Leandro Bay, located approximately one-half mile to the west (Figure 1). The 5050 and 5200 properties encompass approximately 10 acres and the 5051 property is approximately 4.4 acres of relatively flat ground approximately 7 to 15 feet above mean sea level (amsl). Regionally, groundwater flows from the Oakland Hills west towards San Leandro Bay.

The subject properties and surrounding area have a long history of industrial usage. The 5050 property (which also includes the 750-50th Avenue property) is the location of former lead smelting operations (1879-1903), acids manufacturing (1903-1917), various chemical operations (1917-1926), lithopone manufacturing (1926-1963), vacant or razed property (1963-1974), and truck maintenance operations (1974 to the present). The 5051 property and the mini-storage facility at 5200 property were also part of the former lithopone manufacturing facility.

Tidally-influenced stormwater drainage channels border each of the subject properties (Figure 2). An open and unlined channel parallels the southeast property boundary of the 5051 and 5200 properties. Two subsurface culverts, the Courtland Creek Culvert and the Second Line G Culvert, parallel the northwest property boundaries of the 5050 property and the 750-50th Avenue property. The two culverts merge into an open concrete-lined channel south of the intersection of Coliseum Way and 50th Avenue. The drainage channel is open and concrete-lined along the northwestern perimeter of the 5051 property, and is open and unlined along the southwestern perimeter of the property, prior to flowing under Interstate 880.

3.0 FIELD ACTIVITIES

The following discussion outlines field activities used to obtain depth to water measurements, monitoring well samples, and other field data. Groundwater samples were collected from 12 monitoring wells (CW-1, CW-2, CW-6, CW-7, CW-12, CW-13, LF-5, LF-11, LF-12, MWA-1, MW-4, and MW-5). The sampling schedule is presented in Table I.

3.1. DEPTH TO WATER MEASUREMENTS

Depth to water measurements were obtained from 22 wells selected for monitoring of the Coliseum Way Properties on August 30, 2001 prior to well purging and sampling activities. The accessible wells were opened and allowed to stabilize prior to measuring the depth to water. Measurements were obtained in a timely manner in order to minimize tidal effects. The depth to water in each monitoring well was measured with a water level indicator meter from the top of the monitoring well casing to the free water surface. The depth to water measurement was used to determine the groundwater elevation at each monitoring well location, and also to determine the groundwater purge volume for each monitoring well. The depth to water measurements were recorded onto groundwater sampling data sheets that was used to calculate the groundwater elevations presented in Table 2.

3.2. MONITORING WELL SAMPLES

The monitoring wells selected for sampling were purged of approximately four well casing volumes of groundwater until the water quality parameters pH, temperature, and specific conductivity had stabilized. A peristaltic pump with new tubing was used to collect a groundwater sample from each select monitoring well. Groundwater samples were collected in appropriate laboratory-supplied containers. The containers were sealed, labeled with identifying information, entered onto a formal chain-of-custody document, and placed in a chilled ice-chest for transportation to the laboratory. The water quality parameters were recorded on the groundwater sampling data sheets.

4.0 LABORATORY ANALYSES

Groundwater samples were collected from 12 monitoring wells and submitted to Curtis & Tompkins, Ltd. Analytical Laboratory located in Berkeley, California, a State of California certified laboratory, for analyses. The groundwater samples were analyzed by the following United States Environmental Protection Agency (USEPA) methods:

- EPA Methods 6010 and 7470 for California Assessment Manual (CAM-17) Total Metals, Laboratory Filtered and Preserved
- EPA Methods 160.1 for Total Dissolved Solids (TDS)
- EPA Method 8015 modified for Total Petroleum Hydrocarbons as Gasoline (TPH-G) MW-4, MWA-1, CW-2, CW-6, and CW-7 only.

- EPA Method 8020 for Benzene, Toluene, Ethylbenzene, and Xylenes (BTEX) for MW-4, MWA-1, CW-2, CW-6, and CW-7 only.
- EPA Method 8015 modified for Total Petroleum Hydrocarbons as Diesel (TPH-D) and Motor Oil (TPH-O) for LF-11, MWA-1, CW-2, CW-6, and CW-7 only.

Clayton reviewed the analytical results submitted by Curtis & Tompkins, Ltd., a state certified laboratory. Field quality control (QC) sample results and selected laboratory QC data were evaluated to assess the acceptability of the analytical data. All samples were analyzed within the EPA recommended holding times. Surrogate spike and matrix spike recovery results were within the laboratory, or EPA established limits. The field and laboratory QC results indicate that the analytical data are of acceptable quality.

5.0 SITE HYDROLOGY

The groundwater elevation at each monitored well location was determined by subtracting the depth to water measured in each monitoring well from its surveyed top of casing elevation. The groundwater elevations in the 5050, 5051 and 5200 Coliseum Way monitoring well network ranged from a low of 2.30 feet below mean sea level (-2.30 feet bmsl) in monitoring well MW-4 to a high of 6.46 feet above msl (6.46 feet amsl) in monitoring well CW-4. The general property groundwater flow direction is to the west at a hydraulic gradient of 0.011 feet per foot (ft/ft) as measured between wells LF-11 and LF-5. The average groundwater elevation was approximately 0.62 feet lower than the average elevation recorded on June 11, 2001. The subject property groundwater flow direction has flow components to the southwest and south at the 5051 and 5200 properties, which is apparently a result of drainage to the surrounding ditches. A potentiometric surface map was prepared from the August 30, 2001 groundwater elevation data and is presented as Figure 2.

6.0 GROUNDWATER ANALYTICAL RESULTS

The sampling schedule and analytical program for this monitoring event is presented in Table 1. The following discussion presents a summary of the laboratory analytical results.

6.1. PETROLEUM HYDROCARBONS

Six groundwater samples were submitted for petroleum hydrocarbon analyses (CW-2, CW-6, CW-7, LF-11, MWA-1, and MW-4). TPH-G results were below the laboratory-reporting limit of 0.05 milligrams per liter (mg/L) for four samples (MW-4, CW-2, CW-6, and CW-7) of the five samples analyzed. Only sample MWA-1 had detectable TPH-G at a concentration of 0.17 mg/L. BTEX results were below the laboratory reporting limit of 0.0005 mg/L for all five samples analyzed.

Five groundwater samples (LF-11, MWA-1, CW-2, CW-6, and CW-7) were analyzed for TPH-D and TPH-O. Only one sample CW-2 had detectable TPH-D at a concentration of 0.066 mg/L and only sample CW-7 had detectable TPH-O at a concentration of 0.410

mg/L. A summary of petroleum hydrocarbons detected in groundwater is presented in Table 3.

6.2. METALS

Twelve groundwater samples were submitted for metals analyses. Fifteen of the seventeen CAM 17 metal analytes were detected above laboratory reporting limits during this monitoring event. Antimony and silver were the only metals not detected in one or more samples. The highest concentration and corresponding monitoring well location for each detected metal ion are listed below:

Arsenic	to 2.7 mg/L	(CW-2)
Barium	to 510 mg/L	(CW-6)
Beryllium	to 0.041 mg/L	(LF-11)
Cadmium	to 73 mg/L	(LF-11)
Chromium	to 0.017 mg/L	(LF-11)
Cobalt	to 3.1 mg/L	(LF-5)
Copper	to 2.7 mg/L	(LF-11)
Lead	to 1.1 mg/L	(MWA-1)
Mercury	to 0.00027 mg/L	(LF-12)
Molybdenum	to 0.029 mg/L	(CW-7)
Nickel	to 12 mg/L	(LF-11)
Selenium	to 0.088 mg/L	(LF-5)
Thallium	to 0.36 mg/L	(LF-5)
Vanadium	to 0.01 mg/L	(CW-7)
Zinc	to 25,000 mg/L	(LF-11)

Total Dissolved Solids (TDS) ranged in concentration from 800 mg/L in monitoring well CW-7 to 77,000 mg/L in monitoring well LF-11. Field measurements of groundwater pH levels ranged from 3.75 in monitoring well LF-11 to 9.37 in monitoring well CW-7.

A summary of metals, total dissolved solids (TDS), and pH detected in groundwater is presented in Table 4. Isoconcentration maps for arsenic, barium, cadmium, and zinc in groundwater are presented in Figures 3, 4, 5, and 6, respectively.

7.0 LIMITATIONS

The information and opinions rendered in this report was prepared on behalf of 5050 Coliseum LLC and Oakland 5051 LLC. The information and opinions included in this report were given in response to a specific scope of work and should be considered and implemented only in light of that particular scope of work. The services provided by Clayton in completing this project have been provided in a manner consistent with the normal standards of the profession. No other warranty, expressed or implied, is made.

This report prepared by:

Mark Williams
Project Environmental Consultant

This report reviewed by:

Donald A. Ashton, R.G., REA
Senior Geologist

This report reviewed by:

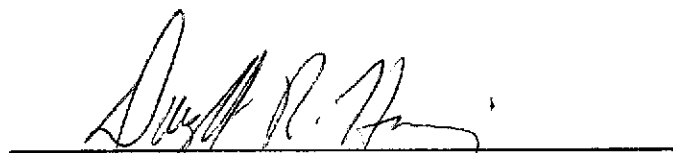
Dwight R. Hoenig
Vice President, Western Regional Director
Environmental Services
San Francisco Regional Office

October 19, 2001

Clayton Project No. 70-00509.00

TABLE 1
Quarterly Monitoring/Sampling Schedule
Coliseum Way Properties, Oakland, CA
Clayton Project No. 70-00509.00.300

SITE	WELL	TPH-g/BTEX	TPH-d/o	CAM-17	TDS	GW Elevation
5050	LF-2					1
	LF-5			1	1	1
	LF-6					1
	LF-11		1	1	1	1
	LF-12			1	1	1
	LF-13					1
	LF-17					1
	CW-13				1	1
5051	MWA-1	1	1	1	1	1
	MWA-2					1
	MWA-3					1
	MW-4	1		1	1	1
	MW-5			1	1	1
	CW-8					1
	CW-9					1
ACPWA-W	CW-10					1
	CW-12			1	1	1
5200	CW-1			1	1	1
	CW-2	1	1	1	1	1
	CW-4					1
ACPWA-E	CW-6	1	1	1	1	1
	CW-7	1	1	1	1	1
TOTALS	22	5	5	12	12	22

TPH-g/BTEX = Total Petroleum Hydrocarbons as Gasoline / Benzene, Toluene, Ethylbenzene, & Xylenes

TPH-d/o = Total Petroleum Hydrocarbons as Diesel and Motor Oil

CAM-17 = California Assessment Manual 17 Metals

TDS = Total Dissolved Solids

GW Elevation = Groundwater Elevation in Feet Above Mean Sea Level

TABLE 2
Groundwater Elevation Data
5050, 5051 & 5200 Coliseum Way

Site	Monitoring Well	Measurement Date	Top of Casing Elevation (ft, msl)	Depth to Groundwater (ft)	Groundwater Elevation (ft, msl)	Change from Previous Measurement (ft)
5050	LF-2	07-Nov-91	9.84	7.26	2.58	
		26-Oct-92		6.28	3.56	0.98
		04-Mar-92		5.14	4.70	1.14
		14-Apr-93		4.95	4.89	0.19
		24-May-93		5.09	4.75	-0.14
		14-Jun-93		5.21	4.63	-0.12
		30-Jul-93		5.38	4.46	-0.17
		31-Aug-93		5.57	4.27	-0.19
		27-Sep-93		5.70	4.14	-0.13
		25-Oct-93		5.80	4.04	-0.10
		02-Nov-93		5.86	3.98	-0.06
		08-Dec-93		6.21	3.63	-0.35
		28-Jan-94		6.12	3.72	0.09
		15-Feb-94		6.07	3.77	0.05
		24-May-94		5.65	4.19	0.42
		21-Sep-94		6.00	3.84	-0.35
		19-Dec-94		5.91	3.93	0.09
		13-Mar-95		4.30	5.54	1.61
		07-Jun-95		4.36	5.48	-0.06
		05-Sep-95		5.12	4.72	-0.76
		18-Dec-95		5.56	4.28	-0.44
		19-Aug-97		5.28	4.56	0.28
		10-Dec-97		5.35	4.49	-0.07
		23-Mar-98		3.98	5.86	1.37
		17-Jun-98		4.13	5.71	-0.15
		30-Sep-98		5.00	4.84	-0.87
		03-Dec-98		5.16	4.68	-0.16
		23-Feb-99		3.84	6.00	1.32
		26-May-99		4.34	5.50	-0.50
		15-Sep-99		5.14	4.70	-0.80
		06-Dec-99		5.52	4.32	-0.38
		29-Mar-00		4.08	5.76	1.44
14-Dec-00	5.64	4.20	-1.56			
27-Mar-01	4.56	5.28	1.08			
11-Jun-01	4.94	4.90	-0.38			
30-Aug-01	5.40	4.44	-0.46			

TABLE 2
Groundwater Elevation Data
5050, 5051 & 5200 Coliseum Way

Site	Monitoring Well	Measurement Date	Top of Casing Elevation (ft, msl)	Depth to Groundwater (ft)	Groundwater Elevation (ft, msl)	Change from Previous Measurement (ft)	
5050	LF-5	07-Nov-91	8.03	7.34	0.69		
		26-Oct-92		7.05	0.98	0.29	
		04-Mar-92		6.05	1.98	1.00	
		14-Apr-93		6.25	1.78	-0.20	
		24-May-93		6.61	1.42	-0.36	
		14-Jun-93		6.97	1.06	-0.36	
		30-Jul-93		6.72	1.31	0.25	
		31-Aug-93		6.84	1.19	-0.12	
		27-Sep-93		7.10	0.93	-0.26	
		25-Oct-93		7.11	0.92	-0.01	
		02-Nov-93		7.04	0.99	0.07	
		08-Dec-93		7.27	0.76	-0.23	
		28-Jan-94		6.82	1.21	0.45	
		15-Feb-94		6.85	1.18	-0.03	
		24-May-94		6.76	1.27	0.09	
		21-Sep-94		7.05	0.98	-0.29	
		19-Dec-94		6.48	1.55	0.57	
		13-Mar-95		5.25	2.78	1.23	
		07-Jun-95		5.98	2.05	-0.73	
		05-Sep-95		6.42	1.61	-0.44	
		18-Dec-95		5.87	2.16	0.55	
		19-Aug-97		5.95	2.08	-0.08	
		10-Dec-97		5.20	2.83	0.75	
		23-Mar-98		4.72	3.31	0.48	
		17-Jun-98		5.29	2.74	-0.57	
		30-Sep-98		8.03	6.10	1.93	-0.81
		03-Dec-98			6.03	2.00	0.07
		23-Feb-99			4.43	3.60	1.60
		26-May-99			5.86	2.17	-1.43
		15-Sep-99			6.24	1.79	-0.38
		06-Dec-99			6.54	1.49	-0.30
		26-Mar-00			4.84	3.19	1.70
		14-Dec-00			6.08	1.95	-1.24
		27-Mar-01			4.98	3.05	1.10
11-Jun-01			5.45	2.58	-0.47		
30-Aug-01			5.96	2.07	-0.51		

TABLE 2
Groundwater Elevation Data
5050, 5051 & 5200 Coliseum Way

Site	Monitoring Well	Measurement Date	Top of Casing Elevation (ft, msl)	Depth to Groundwater (ft)	Groundwater Elevation (ft, msl)	Change from Previous Measurement (ft)
5050	LF-6	07-Nov-91	11.59	8.59	3.00	
		26-Oct-92		8.82	2.77	-0.23
		04-Mar-92		5.79	5.80	3.03
		14-Apr-93		5.41	6.18	0.38
		24-May-93		6.05	5.54	-0.64
		14-Jun-93		6.29	5.30	-0.24
		30-Jul-93		6.83	4.76	-0.54
		31-Aug-93		7.27	4.32	-0.44
		27-Sep-93		7.61	3.98	-0.34
		25-Oct-93		7.79	3.80	-0.18
		02-Nov-93		8.07	3.52	-0.28
		08-Dec-93		7.34	4.25	0.73
		28-Jan-94		6.37	5.22	0.97
		15-Feb-94		5.98	5.61	0.39
		24-May-94		6.14	5.45	-0.16
		21-Sep-94		7.39	4.20	-1.25
		19-Dec-94		6.12	5.47	1.27
		13-Mar-95		4.98	6.61	1.14
		07-Jun-95		5.03	6.56	-0.05
		05-Sep-95		6.23	5.36	-1.20
		18-Dec-95		5.71	5.88	0.52
		23-Mar-98		4.10	7.49	1.61
		17-Jun-98		4.82	6.77	-0.72
		30-Sep-98		6.04	5.55	-1.22
		03-Dec-98		5.42	6.17	0.62
		23-Feb-99		4.63	6.96	0.79
		26-May-99		5.16	6.43	-0.53
		15-Sep-99		6.21	5.38	-1.05
		06-Dec-99		6.48	5.11	-0.27
		29-Mar-00		4.86	6.73	1.62
14-Dec-00		6.55	5.04	-1.69		
27-Mar-01		5.26	6.33	1.29		
11-Jun-01		5.88	5.71	-0.62		
30-Aug-01		6.59	5.00	-0.71		

TABLE 2
Groundwater Elevation Data
5050, 5051 & 5200 Coliseum Way

Site	Monitoring Well	Measurement Date	Top of Casing Elevation (ft, msl)	Depth to Groundwater (ft)		Groundwater Elevation (ft, msl)	Change from Previous Measurement (ft)		
5050	LF-11	02-Nov-93	9.07	11.68		-2.61			
		08-Dec-93		5.35		3.72	6.33		
		28-Jan-94		5.27		3.80	0.08		
		15-Feb-94		5.04		4.03	0.23		
		24-May-94		4.20		4.87	0.84		
		21-Sep-94		4.70		4.37	-0.50		
		19-Dec-94		4.72		4.35	-0.02		
		13-Mar-95		3.27		5.80	1.45		
		07-Jun-95		3.75		5.32	-0.48		
		05-Sep-95		3.70		5.37	0.05		
		18-Dec-95		4.20		4.87	-0.50		
		19-Aug-97		3.60		5.47	0.60		
		10-Dec-97		3.10		3.10	1	5.97	0.50
		23-Mar-98		0.00		0.00	**	9.07	3.10
		17-Jun-98		1.60		1.60		7.47	-1.60
		30-Sep-98	8.96		3.16	A	5.80	-1.67	
		03-Dec-98	4.44		4.44		4.52	-1.28	
		23-Feb-99	2.57		2.57		6.39	1.87	
		26-May-99	2.52		2.52		6.44	0.05	
		15-Sep-99	3.50		3.50		5.46	-0.98	
		06-Dec-99	4.18		4.18		4.78	-0.68	
		29-Mar-00	2.16		2.16		6.80	2.02	
		14-Dec-00	3.91		3.91		5.05	-1.75	
		27-Mar-01	2.62		2.62		6.34	1.29	
		11-Jun-01	2.06		2.06		6.90	0.56	
		30-Aug-01	3.74		3.74		5.22	-1.68	

TABLE 2
Groundwater Elevation Data
5050, 5051 & 5200 Coliseum Way

Site	Monitoring Well	Measurement Date	Top of Casing Elevation (ft, msl)	Depth to Groundwater (ft)	Groundwater Elevation (ft, msl)	Change from Previous Measurement (ft)	
5050	LF-12	02-Nov-93	8.70	7.87	0.83		
		08-Dec-93		7.90	0.80	-0.03	
		28-Jan-94		7.46	1.24	0.44	
		15-Feb-94		7.66	1.04	-0.20	
		24-May-94		--	--	--	
		21-Sep-94			7.80	0.90	
		19-Dec-94			7.32	1.38	0.48
		13-Mar-95			6.00	2.70	1.32
		07-Jun-95			7.40	1.30	-1.40
		05-Sep-95			7.45	1.25	-0.05
		18-Dec-95			6.71	1.99	0.74
		19-Aug-97			6.89	1.81	-0.18
		10-Dec-97			5.97	2.73	0.92
		23-Mar-98			5.15	3.55	0.82
		17-Jun-98			6.64	2.06	-1.49
		30-Sep-98			7.18	1.52	-0.54
		03-Dec-98			6.42	2.28	0.76
		23-Feb-99			5.80	2.90	0.62
		26-May-99			6.80	1.90	-1.00
		15-Sep-99			7.22	1.48	-0.42
		06-Dec-99			7.36	1.34	-0.14
		29-Mar-00			6.08	2.62	1.28
		14-Dec-00			6.92	1.78	-0.84
27-Mar-01			6.08	2.62	0.84		
11-Jun-01			6.51	2.19	-0.43		
30-Aug-01			6.94	1.76	-0.43		

TABLE 2
Groundwater Elevation Data
5050, 5051 & 5200 Coliseum Way

Site	Monitoring Well	Measurement Date	Top of Casing Elevation (ft, msl)	Depth to Groundwater (ft)	Groundwater Elevation (ft, msl)	Change from Previous Measurement (ft)
5050	LF-13	08-Dec-93	9.75	5.94	3.81	
		28-Jan-94		4.94	4.81	1.00
		15-Feb-94		4.84	4.91	0.10
		24-May-94		4.81	4.94	0.03
		21-Sep-94		6.32	3.43	-1.51
		19-Dec-94		4.67	5.08	1.65
		13-Mar-95		3.22	6.53	1.45
		07-Jun-95		3.32	6.43	-0.10
		05-Sep-95		3.90	5.85	-0.58
		18-Dec-95		4.13	5.62	-0.23
		20-Aug-97		4.00	5.75	0.13
		10-Dec-97		3.67	6.08	0.33
		23-Mar-98		2.21	7.54	1.46
		17-Jun-98		2.52	7.23	-0.31
		30-Sep-98		3.75	6.00	-1.23
		03-Dec-98		3.98	5.77	-0.23
		23-Feb-99		3.18	6.57	0.80
		26-May-99		3.15	6.60	0.03
		15-Sep-99		3.98	5.77	-0.83
		06-Dec-99		4.76	4.99	-0.78
		29-Mar-00		2.88	6.87	1.88
		14-Dec-00		4.55	5.20	-1.67
		27-Mar-01		3.40	6.35	1.15
		11-Jun-01		2.78	6.97	0.62
30-Aug-01	4.22	5.53	-1.44			

TABLE 2
Groundwater Elevation Data
5050, 5051 & 5200 Coliseum Way

Site	Monitoring Well	Measurement Date	Top of Casing Elevation (ft, msl)	Depth to Groundwater (ft)	Groundwater Elevation (ft, msl)	Change from Previous Measurement (ft)
5050	LF-17	08-Dec-93	9.71	6.72	2.99	
		28-Jan-94		5.86	3.85	0.86
		15-Feb-94		5.87	3.84	-0.01
		24-May-94		6.00	3.71	-0.13
		21-Sep-94		6.88	2.83	-0.88
		19-Dec-94		5.45	4.26	1.43
		13-Mar-95		4.68	5.03	0.77
		07-Jun-95		6.52	3.19	-1.84
		05-Sep-95		7.02	2.69	-0.50
		18-Dec-95		5.11	4.60	1.91
		23-Mar-98		5.00	4.71	0.11
		17-Jun-98		5.36	4.35	-0.36
		30-Sep-98		6.00	3.71	-0.64
		03-Dec-98		4.60	5.11	1.40
		23-Feb-99		4.40	5.31	0.20
		26-May-99		5.42	4.29	-1.02
		15-Sep-99		6.09	3.62	-0.67
		06-Dec-99		5.74	3.97	0.35
		29-Mar-00		6.20	3.51	-0.46
		14-Dec-00		6.30	3.41	-0.10
27-Mar-01	6.14	3.57	0.16			
11-Jun-01	6.45	3.26	-0.31			
30-Aug-01	6.76	2.95	-0.31			

TABLE 2
Groundwater Elevation Data
5050, 5051 & 5200 Coliseum Way

Site	Monitoring Well	Measurement Date	Top of Casing Elevation (ft, msl)	Depth to Groundwater (ft)	Groundwater Elevation (ft, msl)	Change from Previous Measurement (ft)
5051	MWA-1	19-Dec-95 ⁽¹⁾	9.27	9.70	-0.43	
		19-Dec-95 ⁽²⁾		9.64	-0.37	0.06
		10-Dec-96 ⁽¹⁾		9.27	0.00	0.37
		10-Dec-96 ⁽²⁾		9.64	-0.37	-0.37
		13-Dec-96		9.25	0.02	0.39
		23-Mar-98		7.10	2.17	2.15
		17-Jun-98		8.64	0.63	-1.54
		30-Sep-98		10.09	-0.82	-1.45
		03-Dec-98		9.36	-0.09	0.73
		23-Feb-99		7.16	2.11	2.20
		26-May-99		9.08	0.19	-1.92
		15-Sep-99		10.59	-1.32	-1.51
		06-Dec-99		10.96	-1.69	-0.37
		29-Mar-00		8.91	0.36	2.05
		14-Dec-00		10.78	-1.51	-1.87
		27-Mar-01		8.66	0.61	2.12
		11-Jun-01		9.73	-0.46	-1.07
30-Aug-01	10.46	-1.19	-0.73			
5051	MWA-2	19-Dec-95 ⁽¹⁾	7.79	3.95	3.84	
		19-Dec-95 ⁽²⁾		3.95	3.84	0.00
		10-Dec-96 ⁽¹⁾		3.27	4.52	0.68
		10-Dec-96 ⁽²⁾		6.20	1.59	-2.93
		13-Dec-96		6.00	1.79	0.20
		23-Mar-98		3.24	4.55	2.76
		17-Jun-98		4.22	3.57	-0.98
		30-Sep-98		6.78	1.01	-2.56
		03-Dec-98		5.69	2.10	1.09
		23-Feb-99		1.79	6.00	3.90
		26-May-99		4.95	2.84	-3.16
		15-Sep-99		6.76	1.03	-1.81
		06-Dec-99		6.98	0.81	-0.22
		29-Mar-00		3.56	4.23	3.42
		14-Dec-00		6.90	0.89	-3.34
		27-Mar-01		4.16	3.63	2.74
		11-Jun-01		5.80	1.99	-1.64
30-Aug-01	7.02	0.77	-1.22			

TABLE 2
Groundwater Elevation Data
5050, 5051 & 5200 Coliseum Way

Site	Monitoring Well	Measurement Date	Top of Casing Elevation (ft, msl)	Depth to Groundwater (ft)	Groundwater Elevation (ft, msl)	Change from Previous Measurement (ft)
5051	MWA-3	19-Dec-95 ⁽¹⁾	10.50	8.23	2.27	
		19-Dec-95 ⁽²⁾		8.22	2.28	
		10-Dec-96 ⁽¹⁾		7.67	2.83	
		10-Dec-96 ⁽²⁾		8.19	2.31	
		13-Dec-96		7.94	2.56	0.25
		23-Mar-98		6.36	4.14	1.58
		17-Jun-98		7.56	2.94	-1.20
		30-Sep-98		8.93	1.57	-1.37
		03-Dec-98		8.70	1.80	0.23
		23-Feb-99		5.10	5.40	3.60
		26-May-99		7.59	2.91	-2.49
		15-Sep-99		9.07	1.43	-1.48
		06-Dec-99		10.84	-0.34	-1.77
		29-Mar-00		6.41	4.09	4.43
		14-Dec-00		9.48	1.02	-3.07
		27-Mar-01		5.88	4.62	3.60
		11-Jun-01		8.25	2.25	-2.37
30-Aug-01	9.18	1.32	-0.93			

TABLE 2
Groundwater Elevation Data
5050, 5051 & 5200 Coliseum Way

Site	Monitoring Well	Measurement Date	Top of Casing Elevation (ft, msl)	Depth to Groundwater (ft)	Groundwater Elevation (ft, msl)	Change from Previous Measurement (ft)
5051	MW-4	19-Dec-95 ⁽¹⁾	10.27	9.95	0.32	
		19-Dec-95 ⁽²⁾		11.45	-1.18	
		10-Dec-96 ⁽¹⁾		9.22	1.05	
		10-Dec-96 ⁽²⁾		10.68	-0.41	
		13-Dec-96		10.00	0.27	0.68
		23-Mar-98		9.89	0.38	0.11
		17-Jun-98		10.62	-0.35	-0.73
		30-Sep-98		12.00	-1.73	-1.38
		03-Dec-98		11.05	-0.78	0.95
		23-Feb-99		10.15	0.12	0.90
		26-May-99		11.37	-1.10	-1.22
		15-Sep-99		12.59	-2.32	-1.22
		06-Dec-99		11.66	-1.39	0.93
		29-Mar-00		10.90	-0.63	0.76
		14-Dec-00		12.10	-1.83	-1.20
		27-Mar-01		11.38	-1.11	0.72
		11-Jun-01		11.86	-1.59	-0.48
30-Aug-01	12.57	-2.30	-0.71			
5051	MW-5	19-Dec-95 ⁽¹⁾	9.45	8.51	0.94	
		19-Dec-95 ⁽²⁾		8.49	0.96	0.02
		10-Dec-96 ⁽¹⁾		8.16	1.29	0.33
		10-Dec-96 ⁽²⁾		8.62	0.83	-0.46
		13-Dec-96		8.50	0.95	0.12
		23-Mar-98		7.91	1.54	0.59
		17-Jun-98		8.28	1.17	-0.37
		30-Sep-98		8.70	0.75	-0.42
		03-Dec-98		8.87	0.58	-0.17
		23-Feb-99		7.71	1.74	1.16
		26-May-99		8.30	1.15	-0.59
		15-Sep-99		8.94	0.51	-0.64
		06-Dec-99		9.30	0.15	-0.36
		29-Mar-00		8.25	1.20	1.05
		12-Jan-01		8.50	0.95	-0.25
		27-Mar-01		8.10	1.35	0.40
		11-Jun-01		8.70	0.75	-0.60
30-Aug-01	9.20	0.25	-0.50			

TABLE 2
Groundwater Elevation Data
5050, 5051 & 5200 Coliseum Way

Site	Monitoring Well	Measurement Date	Top of Casing Elevation (ft, msl)	Depth to Groundwater (ft)	Groundwater Elevation (ft, msl)	Change from Previous Measurement (ft)
5200	CW-1	30-Sep-96	14.11	9.22	4.89	
		19-Aug-97		9.39	4.72	-0.17
		10-Dec-97		8.66	5.45	0.73
		23-Mar-98		7.55	6.56	1.11
		17-Jun-98		8.15	5.96	-0.60
		30-Sep-98		9.01	5.10	-0.86
		03-Dec-98		9.08	5.03	-0.07
		23-Feb-99		8.11	6.00	0.97
		26-May-99		8.37	5.74	-0.26
		15-Sep-99		9.20	4.91	-0.83
		06-Dec-99		9.38	4.73	-0.18
		29-Mar-00		8.91	5.20	0.47
		14-Dec-00		9.29	4.82	-0.38
		27-Mar-01		8.32	5.79	0.97
		11-Jun-01		8.70	5.41	-0.38
30-Aug-01	9.24	4.87	-0.54			
5200	CW-2	30-Sep-96	14.88	9.50	5.38	
		19-Aug-97		9.65	5.23	-0.15
		10-Dec-97		9.30	5.58	0.35
		23-Mar-98		7.79	7.09	1.51
		17-Jun-98		8.43	6.45	-0.64
		30-Sep-98		9.24	5.64	-0.81
		03-Dec-98		9.61	5.27	-0.37
		23-Feb-99		8.69	6.19	0.92
		26-May-99		8.70	6.18	-0.01
		15-Sep-99		9.48	5.40	-0.78
		06-Dec-99		9.88	5.00	-0.40
		29-Mar-00		8.34	6.54	1.54
		14-Dec-00		9.77	5.11	-1.43
		27-Mar-01		8.90	5.98	0.87
		11-Jun-01		9.10	5.78	-0.20
30-Aug-01	9.61	5.27	-0.51			

TABLE 2
Groundwater Elevation Data
5050, 5051 & 5200 Coliseum Way

Site	Monitoring Well	Measurement Date	Top of Casing Elevation (ft, msl)	Depth to Groundwater (ft)		Groundwater Elevation (ft, msl)	Change from Previous Measurement (ft)
5200	CW-4	30-Sep-96	14.76	8.08		6.68	
		19-Aug-97		8.92	2	5.84	-0.84
		10-Dec-97		8.06	4	6.70	0.86
		23-Mar-98		6.08		8.68	1.98
		17-Jun-98		6.98		7.78	-0.90
		30-Sep-98		7.90		6.86	-0.92
		03-Dec-98		8.25		6.51	-0.35
		23-Feb-99		6.92		7.84	1.33
		26-May-99		7.18		7.58	-0.26
		15-Sep-99		8.10		6.66	-0.92
		06-Dec-99		8.52		6.24	-0.42
		29-Mar-00		6.78		7.98	1.74
		14-Dec-00		8.51		6.25	-1.73
		27-Mar-01		7.38		7.38	1.13
		11-Jun-01		7.75		7.01	-0.37
30-Aug-01	8.30		6.46	-0.55			

TABLE 2
Groundwater Elevation Data
5050, 5051 & 5200 Coliseum Way

Site	Monitoring Well	Measurement Date	Top of Casing Elevation (ft, msl)	Depth to Groundwater (ft)		Groundwater Elevation (ft, msl)	Change from Previous Measurement (ft)
5200	CW-6	30-Sep-98	13.20	8.97	B	4.23	
		03-Dec-98		8.74		4.46	0.23
		23-Feb-99		7.70		5.50	1.04
		26-May-99		8.19		5.01	-0.49
		15-Sep-99		9.12		4.08	-0.93
		06-Dec-99		9.32		3.88	-0.20
		29-Mar-00		7.73		5.47	1.59
		14-Dec-00		9.24		3.96	-1.51
		27-Mar-01		8.12		5.08	1.12
		11-Jun-01		8.56		4.64	-0.44
		30-Aug-01		9.12		4.08	-0.56
5200	CW-7	30-Sep-98	11.86	7.61	B	4.25	
		03-Dec-98		7.35		4.51	0.26
		23-Feb-99		6.43		5.43	0.92
		26-May-99		6.87		4.99	-0.44
		15-Sep-99		7.76		4.10	-0.89
		06-Dec-99		7.96		3.90	-0.20
		29-Mar-00		6.47		5.39	1.49
		14-Dec-00		7.82		4.04	-1.35
		27-Mar-01		6.84		5.02	0.98
		11-Jun-01		7.20		4.66	-0.36
		30-Aug-01		7.76		4.10	-0.56

TABLE 2
Groundwater Elevation Data
5050, 5051 & 5200 Coliseum Way

Site	Monitoring Well	Measurement Date	Top of Casing Elevation (ft, msl)	Depth to Groundwater (ft)		Groundwater Elevation (ft, msl)	Change from Previous Measurement (ft)
5200	CW-8	30-Sep-98	9.24	5.41	B	3.83	
		03-Dec-98		5.05		4.19	0.36
		23-Feb-99		4.18		5.06	0.87
		26-May-99		4.82		4.42	-0.64
		15-Sep-99		5.55		3.69	-0.73
		06-Dec-99		5.64		3.60	-0.09
		29-Mar-00		4.59		4.65	1.05
		14-Dec-00		5.59		3.65	-1.00
		27-Mar-01		4.62		4.62	0.97
		11-Jun-01		4.91		4.33	-0.29
		30-Aug-01	5.41	3.83	-0.50		
5200	CW-9	30-Sep-98	10.35	11.42	B	-1.07	
		03-Dec-98		11.11		-0.76	0.31
		23-Feb-99		11.43		-1.08	-0.32
		26-May-99		11.29		-0.94	0.14
		15-Sep-99		11.39		-1.04	-0.10
		06-Dec-99		11.90		-1.55	-0.51
		29-Mar-00		11.37		-1.02	0.53
		14-Dec-00		11.32		-0.97	0.05
		27-Mar-01		11.36		-1.01	-0.04
		11-Jun-01		11.18		-0.83	0.18
		30-Aug-01	11.16	-0.81	0.02		

TABLE 2
Groundwater Elevation Data
5050, 5051 & 5200 Coliseum Way

Site	Monitoring Well	Measurement Date	Top of Casing Elevation (ft, msl)	Depth to Groundwater (ft)		Groundwater Elevation (ft, msl)	Change from Previous Measurement (ft)
5200	CW-10	30-Sep-98	8.33	7.18	B	1.15	
		03-Dec-98		5.79		2.54	1.39
		23-Feb-99		7.46		0.87	-1.67
		26-May-99		7.45		0.88	0.01
		15-Sep-99		8.04		0.29	-0.59
		06-Dec-99		6.29		2.04	1.75
		29-Mar-00		6.66		1.67	-0.37
		14-Dec-00		6.68		1.65	-0.02
		27-Mar-01		well inaccessible			
		11-Jun-01		7.44		0.89	-0.76
		30-Aug-01		7.90		0.43	-0.46
		5200		CW-12		30-Sep-98	7.84
03-Dec-98	6.02		1.82		0.77		
23-Feb-99	5.93		1.91		0.09		
26-May-99	6.84		1.00		-0.91		
15-Sep-99	7.01		0.83		-0.17		
06-Dec-99	6.99		0.85		0.02		
29-Mar-00	7.56		0.28		-0.57		
14-Dec-00	6.87		0.97		0.69		
27-Mar-01	6.74		1.10		0.13		
11-Jun-01	6.65		1.19		0.09		
30-Aug-01	6.74		1.10		-0.09		

TABLE 2
Groundwater Elevation Data
5050, 5051 & 5200 Coliseum Way

Site	Monitoring Well	Measurement Date	Top of Casing Elevation (ft, msl)	Depth to Groundwater (ft)		Groundwater Elevation (ft, msl)	Change from Previous Measurement (ft)
5200	CW-13	30-Sep-98	7.47	6.27	B	1.20	
		03-Dec-98		5.58		1.89	0.69
		23-Feb-99		4.87		2.60	0.71
		26-May-99		6.08		1.39	-1.21
		15-Sep-99		6.39		1.08	-0.31
		Dec 6 1999		6.49		0.98	-0.10
		29-Mar-00		5.22		2.25	1.27
		14-Dec-00		6.00		1.47	-0.78
		27-Mar-01		5.24		2.23	0.76
		11-Jun-01		5.63		1.84	-0.39
		30-Aug-01		5.98		1.49	-0.35

Notes: All measurements are with reference to top of PVC casing of each well.

-- = Not Measured

** approximately 0.10 feet of free product encountered in well casing.

1 = Sheen

2 = Sheen and Petroleum Odor

3 = Sulfur Odor

4 = Sheen and Sulfur Odor

a = Field error in numbering wells, CW-3 and CW-5 reversed

⁽¹⁾ = High Tide Measurement

⁽²⁾ = Low Tide Measurement

A = Well covered repaired and TOC resurveyed (10/12/98)

B = TOC resurveyed (10/12/98) - MW-6 discrepancy confirmed 12-3-98

TABLE 3
Petroleum Hydrocarbons Detected in Groundwater
5050, 5051 & 5200 Coliseum Way
(Concentrations Reported in Milligrams per Liter [mg/L])

Sample ID	Date Sampled	TEPH	TPH-D	TPH-O	TPH-G	Benzene	Ethyl-Benzene	Toluene	Total Xylenes
		MCL	--	--	--	--	0.001	0.7	1
LF-11	28-Oct-93	-	<0.05	-	<0.1	-	-	-	-
LF-11	19-Dec-97	9.5	<2	9.0	<0.05	0.0004	<0.0003	0.0004	<0.0004
LF-11	25-Mar-98	-	<0.05	<0.2	-	-	-	-	-
LF-11	17-Jun-98	-	<0.09	0.7	-	-	-	-	-
LF-11	09-Sep-98	0.8	<0.2rl	0.8	-	-	-	-	-
LF-11	10-Dec-98	0.58	<0.09	0.6	-	-	-	-	-
LF-11	24-Feb-99	0.08rl	<0.06rl	<0.2rl	-	-	-	-	-
LF-11	28-May-99	-	<0.05	<0.25	-	-	-	-	-
LF-11	17-Sep-99	-	<0.05	<0.5	-	-	-	-	-
LF-11	07-Dec-99	-	<1.0	<0.5	-	-	-	-	-
LF-11	15-Dec-00	-	<0.05	<0.3	-	-	-	-	-
LF-11	27-Mar-01	-	<0.05	<0.3	-	-	-	-	-
LF-11	11-Jun-01	-	0.11	<0.3	-	-	-	-	-
LF-11	30-Aug-01	-	<0.05	<0.3	-	-	-	-	-

TABLE 3
Petroleum Hydrocarbons Detected in Groundwater
5050, 5051 & 5200 Coliseum Way
(Concentrations Reported in Milligrams per Liter [mg/L])

Sample ID	Date Sampled	TEPH	TPH-D	TPH-O	TPH-G	Benzene	Ethyl-Benzene	Toluene	Total Xylenes
		MCL	--	--	--	0.001	0.7	1	10
MWA-1	27-Apr-98	-	< 0.08	< 0.2	0.14	0.0009	< 0.0003	0.0004	< 0.0004
MWA-1	19-Jun-98	-	< 0.2	< 0.2	0.13	0.0008	< 0.0003	0.0003	< 0.0004
MWA-1	11-Sep-98	0.38	< 0.4	< 0.2	0.25	0.0011	< 0.0003	0.001	< 0.0004
MWA-1	09-Dec-98	0.66	< 0.4	0.4	0.27	0.0014	0.0029	0.0007	0.0156
MWA-1	25-Feb-99	-	0.940	0.46	0.09	0.001	< 0.0003	0.0004	< 0.0004
MWA-1	27-May-99	-	0.087	< 0.25	0.31	0.001	< 0.0005	< 0.0005	0.0018
MWA-1	16-Sep-99	-	< 0.05	< 0.5	0.11	< 0.0005	< 0.0005	< 0.0005	< 0.0005
MWA-1	07-Dec-99	-	< 1.0	< 0.5	1.4	< 0.001	< 0.001	< 0.001	< 0.003
MWA-1	29-Mar-00	-	-	-	0.29	< 0.001	< 0.001	< 0.001	< 0.003
MWA-1	15-Dec-00	-	< 0.05	< 0.3	0.91	0.00087	< 0.0005	< 0.0005	< 0.0005
MWA-1	27-Mar-01	-	< 0.05	< 0.3	0.54	0.0017	< 0.0005	< 0.0005	< 0.0005
MWA-1	11-Jun-01	-	0.066	< 0.3	0.5	0.00059	< 0.0005	< 0.0005	< 0.0005
MWA-1	30-Aug-01	-	< 0.05	< 0.3	0.17	< 0.0005	< 0.0005	< 0.0005	< 0.0005
MW-4	25-Feb-99	-	-	-	< 0.05	< 0.0004	< 0.0003	< 0.0003	< 0.0004
MW-4	23-Sep-99	-	-	-	< 0.05	< 0.0005	< 0.0005	< 0.0005	< 0.0005
MW-4	07-Dec-99	-	-	-	0.13	< 0.001	< 0.001	< 0.001	< 0.003
MW-4	29-Mar-00	-	-	-	< 0.05	< 0.001	< 0.001	< 0.001	< 0.003
MW-4	15-Dec-00	-	-	-	< 0.05	< 0.0005	< 0.0005	< 0.0005	< 0.0005
MW-4	27-Mar-01	-	-	-	< 0.05	< 0.0005	< 0.0005	< 0.0005	< 0.0005
MW-4	11-Jun-01	-	-	-	< 0.05	< 0.0005	< 0.0005	< 0.0005	< 0.0005
MW-4	30-Aug-01	-	-	-	< 0.05	< 0.0005	< 0.0005	< 0.0005	< 0.0005

TABLE 3
Petroleum Hydrocarbons Detected in Groundwater
5050, 5051 & 5200 Coliseum Way
(Concentrations Reported in Milligrams per Liter [mg/L])

Sample ID	Date Sampled	TEPH	TPH-D	TPH-O	TPH-G	Benzene	Ethyl-Benzene	Toluene	Total Xylenes
		MCL	--	--	--	0.001	0.7	1	10
CW-2	19-Aug-97	0.57	< 0.4	0.4	< 0.05	0.0008	< 0.0003	< 0.0003	0.0004
CW-2	11-Dec-97	1.1	< 0.3	0.8	< 0.05	0.0008	< 0.0003	< 0.0003	< 0.0004
CW-2	25-Mar-98	-	< 0.3	< 0.2	< 0.05	0.0006	< 0.0003	< 0.0003	< 0.0004
CW-2	19-Jun-98	-	< 0.2	< 0.2	< 0.05	0.0005	< 0.0003	< 0.0003	< 0.0004
CW-2	10-Sep-98	0.12	< 0.08	< 0.2	< 0.05	0.0005	< 0.0003	< 0.0003	< 0.0004
CW-2	04-Dec-98	1.10	< 0.6	0.7	< 0.05	0.0008	< 0.0003	0.0004	0.0004
CW-2	24-Feb-99	0.510	< 0.3	< 0.4	< 0.05	0.0007	< 0.0003	< 0.0003	< 0.0004
CW-2	27-May-99	-	0.13	< 0.25	< 0.05	< 0.0005	< 0.0005	< 0.0005	< 0.0005
CW-2	16-Sep-99	-	0.074	< 0.5	< 0.05	< 0.0005	< 0.0005	< 0.0005	< 0.0005
CW-2	10-Dec-99	-	< 1.0	< 0.5	< 0.05	< 0.001	< 0.001	< 0.001	< 0.003
CW-2	15-Dec-00	-	< 0.05	< 0.3	< 0.05	< 0.0005	< 0.0005	< 0.0005	< 0.0005
CW-2	27-Mar-01	-	0.055	< 0.3	< 0.05	< 0.0005	< 0.0005	< 0.0005	< 0.0005
CW-2	11-Jun-01	-	0.19	< 0.3	< 0.05	< 0.0005	< 0.0005	< 0.0005	< 0.0005
CW-2	30-Aug-01	-	0.066	< 0.3	< 0.05	< 0.0005	< 0.0005	< 0.0005	< 0.0005
CW-6	04-Dec-98	0.59	< 0.4	0.4	< 0.05	< 0.0004	< 0.0003	< 0.0003	< 0.0004
CW-6	24-Feb-99	< 0.05	< 0.05	< 0.2	< 0.05	< 0.0004	< 0.0003	< 0.0003	< 0.0004
CW-6	27-May-99	-	0.088	< 0.25	< 0.05	< 0.0005	< 0.0005	< 0.0005	< 0.0005
CW-6	16-Sep-99	-	0.059	< 0.5	< 0.05	< 0.0005	< 0.0005	< 0.0005	< 0.0005
CW-6	10-Dec-99	-	< 1.0	< 0.5	< 0.05	< 0.001	< 0.001	< 0.001	< 0.003
CW-6	15-Dec-00	-	< 0.05	< 0.3	< 0.05	< 0.0005	< 0.0005	< 0.0005	< 0.0005
CW-6	27-Mar-01	-	< 0.05	< 0.3	< 0.05	< 0.0005	< 0.0005	< 0.0005	< 0.0005
CW-6	11-Jun-01	-	0.43	< 0.3	< 0.05	< 0.0005	< 0.0005	< 0.0005	< 0.0005
CW-6	30-Aug-01	-	< 0.05	< 0.3	< 0.05	< 0.0005	< 0.0005	< 0.0005	< 0.0005

TABLE 3
Petroleum Hydrocarbons Detected in Groundwater
5050, 5051 & 5200 Coliseum Way
(Concentrations Reported in Milligrams per Liter [mg/L])

Sample ID	Date Sampled	TEPH	TPH-D	TPH-O	TPH-G	Benzene	Ethyl-Benzene	Toluene	Total Xylenes
		MCL	--	--	--	0.001	0.7	1	10
CW-7-D3	29-Sep-98	-	< 0.05	< 0.5	-	-	-	-	-
CW-7-D4	29-Sep-98	-	-	-	< 0.05	< 0.0005	< 0.0005	< 0.0005	< 0.0005
CW-7	04-Dec-98	0.47	< 0.4	0.3	< 0.05	< 0.0004	< 0.0003	< 0.0003	< 0.0004
CW-7	24-Feb-99	0.11	< 0.08	< 0.2	< 0.05	< 0.0004	< 0.0003	< 0.0003	< 0.0004
CW-7	27-May-99	-	0.17	< 0.25	< 0.05	< 0.0005	< 0.0005	< 0.0005	< 0.0005
CW-7	16-Sep-99	-	< 0.05	< 0.5	< 0.05	< 0.0005	< 0.0005	< 0.0005	< 0.0005
CW-7	10-Dec-99	-	1.0	< 0.5	< 0.05	< 0.001	< 0.001	< 0.001	< 0.003
CW-7	15-Dec-00	-	<0.05	<0.3	<0.05	<0.0005	<0.0005	<0.0005	<0.0005
CW-7	27-Mar-01	-	<0.05	<0.3	<0.05	<0.0005	<0.0005	<0.0005	<0.0005
CW-7	11-Jun-01	-	0.14	<0.3	<0.05	<0.0005	<0.0005	<0.0005	<0.0005
CW-7	30-Aug-01	-	<0.05	0.41	<0.05	<0.0005	<0.0005	<0.0005	<0.0005

Notes:

TEPH = Total Extractable Petroleum Hydrocarbons

TPH-D = Total Petroleum Hydrocarbons as Diesel

TPH-O = Total Petroleum Hydrocarbons as Motor Oil

TPH-G = Total Petroleum Hydrocarbons as Gasoline

MCL = Maximum Contaminant Levels for Drinking Water (CCR Title 22, Sections 64431 and 64444)

"-" = Not established

"<" = Analytes not detected at reporting limit

"-" = Not analyzed

(dup) = Duplicate Sample Collected by LFR

* = Field error resulted in switched well numbers (CW-3 & CW-5)

rl = TPH laboratory surrogate recovery low due to use of silica gel cleanup, standard is not adjusted for use of silica gel

TABLE 4
Metals, Total Dissolved Solids, pH and Chloride Detected in Groundwater
5050, 5051 5200 Coliseum Way
Concentrations in Milligrams per Liter (mg/L)

Site	Monitoring Well	Sample Date	Antimony (Sb)	Arsenic (As)	Barium (Ba)	Beryllium (Be)	Cadmium (Cd)	Chromium (Cr)	Cobalt (Co)	Copper (Cu)	Lead (Pb)	Mercury (Hg)
		MCL	0.006	0.05	1	0.004	0.005	0.05	--	1.3 ⁺	0.015 ⁺⁺	0.002
5050	LF-5	4-Nov-91	< 0.02	< 0.002	0.018	< 0.001	0.049	< 0.01	0.03	< 0.005	< 0.005	0.0004
5050	LF-5	27-Oct-92	< 0.02	0.005	< 0.05	< 0.002	0.24	< 0.01	1.4	< 0.01	< 0.04	< 0.0003
5050	LF-5	4-Mar-93	< 0.02	< 0.005	< 0.05	< 0.002	0.21	< 0.01	1.1	< 0.01	< 0.04	< 0.0003
5050	LF-5	25-May-93	< 0.02	< 0.002	< 0.05	< 0.002	0.17	< 0.01	0.84	< 0.01	< 0.04	< 0.0003
5050	LF-5	31-Aug-93	< 0.02	0.02	< 0.05	< 0.002	0.25	< 0.01	1.3	< 0.01	< 0.04	< 0.0003
5050	LF-5	26-Oct-93	< 0.02	0.052	< 0.05	< 0.002	0.28	< 0.01	1.4	0.01	0.07	< 0.0003
5050	LF-5	16-Feb-94	< 0.02	< 0.02	< 0.05	< 0.002	0.16	< 0.01	0.95	< 0.01	< 0.04	< 0.0002
5050	LF-5	24-May-94	< 0.005	< 0.005	0.01	< 0.0005	0.14	< 0.002	0.71	< 0.002	< 0.01	< 0.0002
5050	LF-5	21-Sep-94	< 0.005	< 0.01	0.01	< 0.0005	0.17	0.003	0.81	0.003	< 0.01	< 0.0002
5050	LF-5	19-Dec-94	< 0.005	< 0.01	0.01	< 0.0005	0.25	0.003	1.2	0.004	< 0.008	< 0.0002
5050	LF-5	14-Mar-95	< 0.004	< 0.02	0.013	< 0.0005	0.11	0.004	0.61	0.003	< 0.01	< 0.0002
5050	LF-5	7-Jun-95	< 0.004	< 0.01	0.015	< 0.0005	0.31	0.006	1.5	0.005	< 0.02	< 0.0002
5050	LF-5	7-Sep-95	< 0.004	< 0.005	0.014	< 0.0005	0.31	0.006	1.5	0.005	< 0.01	< 0.0002
5050	LF-5	18-Dec-95	< 0.004	< 0.005	0.017	< 0.0005	0.2	0.004	0.99	0.002	< 0.005	< 0.0002
5050	LF-5	20-Aug-97	< 0.03	0.06	0.02	< 0.005	0.26	0.01	1.3	< 0.01	< 0.05	< 0.0005
5050	LF-5	11-Dec-97	< 0.03	0.06	0.21	< 0.005	0.24	< 0.01	1.1	< 0.01	< 0.05	< 0.0005
5050	LF-5	25-Mar-98	< 0.03	< 0.05	0.05	< 0.005	0.062	< 0.01	0.21	< 0.03	< 0.05	< 0.0005
5050	LF-5	18-Jun-98	< 0.03	0.12	0.26	< 0.005	1.2	0.06	6.5	0.02	< 0.05	< 0.0005
5050	LF-5	9-Sep-98	< 0.03	< 0.05	0.08	< 0.005	0.19	< 0.01	0.76	< 0.01	< 0.05	< 0.0005
5050	LF-5	9-Dec-98	< 0.03	< 0.05	0.08	< 0.005	0.3	0.01	1.1	< 0.01	< 0.05	< 0.0005
5050	LF-5	23-Feb-99	< 0.03	0.07	0.02	0.008	0.09	< 0.01	0.33	0.02	< 0.05	< 0.0005
5050	LF-5	27-May-99	< 0.05	< 0.005	< 0.05	< 0.004	0.23	< 0.005	0.8	< 0.05	< 0.005	< 0.0008
5050	LF-5	23-Sep-99	< 0.03	< 0.05	0.01	< 0.005	0.21	0.01	0.8	< 0.01	< 0.05	< 0.0002
5050	LF-5	15-Dec-99	< 0.03	< 0.05	0.04	< 0.005	0.3	0.058	1.4	< 0.01	< 0.05	< 0.0002
5050	LF-5	29-Mar-00	< 0.03	< 0.05	< 0.01	0.014	0.5	0.041	2.5	< 0.01	< 0.05	< 0.0002
5050	LF-5	15-Dec-00	< 0.06	< 0.005	0.012	< 0.002	0.27	< 0.01	1.3	< 0.01	0.0095	< 0.0002
5050	LF-5	27-Mar-01	< 0.06	< 0.005	< 0.01	< 0.002	0.34	< 0.01	1.6	< 0.01	0.0087	< 0.0002
5050	LF-5	11-Jun-01	< 0.06	0.008	0.013	< 0.002	0.83	0.012	4.1	< 0.01	0.027	< 0.0002
5050	LF-5	30-Aug-01	< 0.06	0.0071	0.014	< 0.002	0.72	0.011	3.1	< 0.01	0.025	< 0.0002

TABLE 4
Metals, Total Dissolved Solids, pH and Chloride Detected in Groundwater
5050, 5051 5200 Coliseum Way
 Concentrations in Milligrams per Liter (mg/L)

Site	Monitoring Well	Sample Date	Molybdenum (Mo)	Nickel (Ni)	Selenium (Se)	Silver (Ag)	Thallium (Tl)	Vanadium (V)	Zinc (Zn)	TDS	pH (SU)	Chloride
		MCL	--	0.10	0.05	0.1 ⁺	0.002	--	5			
5050	LF-5	4-Nov-91	< 0.01	0.23	< 0.004	0.004	< 0.1	< 0.005	11	9,100	-	-
5050	LF-5	27-Oct-92	< 0.01	5.4	0.017	0.022	< 0.1	< 0.005	35	-	-	-
5050	LF-5	4-Mar-93	< 0.01	5	< 0.01	0.021	< 0.1	< 0.005	36	-	-	-
5050	LF-5	25-May-93	< 0.01	3.2	< 0.004	0.01	0.2	< 0.005	23	-	-	-
5050	LF-5	31-Aug-93	< 0.01	4.6	< 0.02	0.013	0.2	< 0.005	38	-	-	-
5050	LF-5	26-Oct-93	< 0.01	5.3	< 0.04	0.011	0.3	0.01	51	-	6.07	-
5050	LF-5	16-Feb-94	< 0.01	3.3	< 0.04	0.009	0.1	< 0.005	28	-	6.20	-
5050	LF-5	24-May-94	< 0.002	2.4	< 0.01	0.008	0.09	0.002	23	-	-	-
5050	LF-5	21-Sep-94	< 0.002	2.5	< 0.02	0.006	0.03	< 0.001	25	-	-	-
5050	LF-5	19-Dec-94	< 0.002	3.8	0.02	0.007	0.08	< 0.001	58	-	-	-
5050	LF-5	14-Mar-95	< 0.002	2.6	< 0.04	0.004	0.06	0.003	25	-	-	-
5050	LF-5	7-Jun-95	< 0.002	5	< 0.02	0.006	0.05	0.001	76	-	-	-
5050	LF-5	7-Sep-95	< 0.002	4.8	< 0.004	0.004	0.04	< 0.001	38	-	-	-
5050	LF-5	18-Dec-95	< 0.002	3.1	< 0.01	0.003	0.12	0.003	47	-	6.35	-
5050	LF-5	20-Aug-97	< 0.01	4	< 0.05	< 0.01	< 0.05	< 0.01	52	-	5.79	-
5050	LF-5	11-Dec-97	< 0.01	3.2	< 0.05	< 0.01	< 0.05	< 0.01	44	-	6.23	-
5050	LF-5	25-Mar-98	< 0.01	0.74	< 0.07	< 0.01	< 0.05	< 0.01	16	5,600	5.87	-
5050	LF-5	18-Jun-98	< 0.01	18	< 0.07	0.03	0.43	< 0.01	300	21,000	6.19	-
5050	LF-5	9-Sep-98	< 0.01	2.4	< 0.07	< 0.01	< 0.05	< 0.01	36	7,800	6.22	-
5050	LF-5	9-Dec-98	< 0.01	3.7	< 0.07	0.01	< 0.05	< 0.01	50	12,000	6.11	-
5050	LF-5	23-Feb-99	< 0.01	1.1	< 0.07	< 0.01	< 0.05	< 0.01	20	6,800	6.41	-
5050	LF-5	27-May-99	< 0.05	2.4	< 0.005	< 0.01	< 0.005	< 0.05	52	6,100	6.21	-
5050	LF-5	23-Sep-99	< 0.01	2.5	< 0.07	< 0.01	< 0.05	< 0.01	35	9,000	6.03	-
5050	LF-5	15-Dec-99	< 0.01	3.8	< 0.07	< 0.01	< 0.05	< 0.01	52	12,000	5.57	-
5050	LF-5	29-Mar-00	< 0.01	7	< 0.07	< 0.01	< 0.05	< 0.01	110	14,000	5.1	-
5050	LF-5	15-Dec-00	< 0.02	3.7	0.037	< 0.005	0.15	< 0.01	63	11,900	6.06	-
5050	LF-5	27-Mar-01	< 0.02	4.3	0.028	< 0.005	0.16	< 0.01	120	14,300	6.95	-
5050	LF-5	11-Jun-01	< 0.02	11	0.1	< 0.005	0.43	< 0.01	240	20,600	6.65	-
5050	LF-5	30-Aug-01	< 0.02	8.9	0.088	< 0.005	0.36	< 0.01	170	16,500	6.24	-

TABLE 4
Metals, Total Dissolved Solids, pH and Chloride Detected in Groundwater
5050, 5051 5200 Coliseum Way
 Concentrations in Milligrams per Liter (mg/L)

Site	Monitoring Well	Sample Date	Antimony (Sb)	Arsenic (As)	Barium (Ba)	Beryllium (Be)	Cadmium (Cd)	Chromium (Cr)	Cobalt (Co)	Copper (Cu)	Lead (Pb)	Mercury (Hg)
		MCL	0.006	0.05	1	0.004	0.005	0.05	--	1.3 ⁺	0.015 ⁺⁺	0.002
5050	LF-11	28-Oct-93	< 0.02	0.07	0.1	< 0.002	120	< 0.01	5.9	3	6	< 0.0003
5050	LF-11	18-Feb-94	< 2	< 0.02	< 5	< 0.2	140	< 1	8.4	4	< 4	< 0.0002
5050	LF-111 (Dup)	18-Feb-94	< 2	< 0.2	< 5	< 0.2	140	< 1	9.4	4	< 4	< 0.0002
5050	LF-11	23-Sep-94	< 2	< 0.2	< 0.01	0.2	130	< 1	7.1	5	0.41	< 0.0002
5050	LF-11	15-Mar-95	< 2	< 0.01	< 1	< 0.2	91	< 1	4.9	3	0.08	< 0.0002
5050	LF-11	8-Jun-95	< 20	< 0.02	< 1	< 3	99	< 10	< 5	< 10	0.09	< 0.0002
5050	LF-11	7-Sep-95	< 2	< 0.01	< 1	< 0.2	120	< 1	6.5	5	0.04	< 0.0002
5050	LF-11	18-Dec-95	< 20	0.31	< 1	< 3	110	< 10	6.0	< 10	0.021	< 0.0002
5050	LF-11	20-Aug-97	< 0.03	0.19	0.02	0.06	75	0.04	3.9	3.3	< 0.05	< 0.0005
5050	LF-11	19-Dec-97	< 0.03	0.16	< 0.01	0.062	72	< 0.01	3.6	3.2	< 0.05	< 0.0005
5050	LF-11	25-Mar-98	< 0.03	< 0.05	< 0.01	< 0.005	36	< 0.01	< 0.01	< 0.03	< 0.05	< 0.0005
5050	LF-11	17-Jun-98	< 0.03	0.11	0.14	0.034	46	0.03	2.5	1.9	< 0.05	< 0.0005
5050	LF-11	9-Sep-98	< 0.03	0.08	0.12	0.04	43	< 0.01	2.1	2.0	< 0.05	< 0.0005
5050	LF-11	10-Dec-98	< 0.03	0.1	0.1	0.035	51	0.03	2.3	2.2	< 0.05	< 0.0005
5050	LF-11	24-Feb-99	< 0.03	< 0.05	0.02	0.018	48	< 0.01	0.79	0.9	< 0.05	< 0.0005
5050	LF-11	28-May-99	< 0.05	< 0.005	< 0.05	0.048	68	0.013	2.8	1.9	< 0.01	< 0.0008
5050	LF-11	17-Sep-99	< 0.03	< 0.05	0.02	0.05	46	0.03	2.7	2.7	< 0.05	0.0005
5050	LF-11	7-Dec-99	< 0.03	0.13	< 0.01	0.087	92	0.12	4.3	3.6	< 0.05	0.0005
5050	LF-11	29-Mar-00	< 0.03	< 0.05	< 0.01	0.038	37	0.029	1.8	1.5	< 0.05	< 0.0002
5050	LF-11	15-Dec-00	< 0.06	0.045	0.013	0.044	84	0.012	2.7	3.0	0.088	< 0.0002
5050	LF-11	27-Mar-01	< 0.06	0.035	0.011	0.043	83	0.013	2.7	3.2	0.065	< 0.0002
5050	LF-11	11-Jun-01	< 0.06	0.056	0.013	0.045	86	0.024	2.8	2.7	0.084	< 0.0002
5050	LF-11	30-Aug-01	< 0.06	0.034	0.013	0.041	73	0.017	2.7	2.7	0.23	< 0.0002

TABLE 4
Metals, Total Dissolved Solids, pH and Chloride Detected in Groundwater
5050, 5051 5200 Coliseum Way
 Concentrations in Milligrams per Liter (mg/L)

Site	Monitoring Well	Sample Date	Molybdenum (Mo)	Nickel (Ni)	Selenium (Se)	Silver (Ag)	Thallium (Tl)	Vanadium (V)	Zinc (Zn)	TDS	pH (SU)	Chloride
		MCL	--	0.10	0.05	0.1 ⁺	0.002	--	5			
5050	LF-11	28-Oct-93	< 0.01	28	< 0.04	< 0.005	< 0.1	2.0	47,000	170,000	4.72	-
5050	LF-11	18-Feb-94	< 1	37	< 0.02	< 0.5	< 10	< 0.5	44,000	-	4.14	-
5050	LF-111 (Dup)	18-Feb-94	< 1	40	< 0.02	< 0.5	< 10	< 0.5	46,000	-	4.14	-
5050	LF-11	23-Sep-94	< 1	32	< 0.04	0.5	< 10	< 0.5	33,000	-	-	-
5050	LF-11	15-Mar-95	< 1	22	< 0.02	< 0.5	< 5	< 0.5	37,000	-	-	-
5050	LF-11	8-Jun-95	< 10	21	< 0.04	< 5	< 50	< 5	37,000	-	-	-
5050	LF-11	7-Sep-95	< 1	26	< 0.02	< 0.5	< 5	< 0.5	37,000	-	-	-
5050	LF-11	18-Dec-95	< 10	25	< 0.08	< 5	< 50	< 5	37,000	-	3.73	-
5050	LF-11	20-Aug-97	< 0.01	16.	0.16	< 0.01	0.12	< 0.01	30,000	-	3.49	-
5050	LF-11	19-Dec-97	< 0.01	13.	< 0.05	< 0.01	< 0.05	< 0.01	31,000	-	3.91	-
5050	LF-11	25-Mar-98	< 0.01	5.1	< 0.07	< 0.01	< 0.05	< 0.01	13,000	54,000	3.83	-
5050	LF-11	17-Jun-98	< 0.01	12	0.1	< 0.01	0.22	< 0.01	18,000	58,000	4.89	-
5050	LF-11	9-Sep-98	< 0.01	9.8	0.13	< 0.01	< 0.05	< 0.01	17,000	51,000	5.34	-
5050	LF-11	10-Dec-98	< 0.01	9.8	< 0.07	< 0.01	< 0.05	< 0.01	18,000	66,000	3.77	-
5050	LF-11	24-Feb-99	< 0.01	4.2	< 0.07	< 0.01	< 0.05	< 0.01	8,600	57,000	3.77	-
5050	LF-11	28-May-99	< 0.05	14	< 0.005	< 0.01	< 0.02	< 0.05	23,000	98,000	3.39	-
5050	LF-11	17-Sep-99	0.02	17	< 0.07	< 0.01	< 0.05	< 0.01	7,000	67,000	3.72	-
5050	LF-11	7-Dec-99	0.19	20	< 0.07	< 0.01	< 0.05	< 0.01	2,000	89,000	3.49	-
5050	LF-11	29-Mar-00	0.073	8.2	0.07	< 0.01	< 0.05	< 0.01	1,400	38,000	4.3	-
5050	LF-11	15-Dec-00	< 0.02	12	0.068	< 0.005	0.33	< 0.01	26,000	103,000	4.29	-
5050	LF-11	27-Mar-01	< 0.02	11	0.044	< 0.005	0.27	< 0.01	28,000	94,500	4.63	-
5050	LF-11	11-Jun-01	< 0.02	13	0.077	< 0.005	0.32	< 0.01	24,000	89,800	4.16	-
5050	LF-11	30-Aug-01	< 0.02	12	0.077	< 0.005	0.35	< 0.01	25,000	77,000	3.75	-

TABLE 4
Metals, Total Dissolved Solids, pH and Chloride Detected in Groundwater
5050, 5051 5200 Coliseum Way
 Concentrations in Milligrams per Liter (mg/L)

Site	Monitoring Well	Sample Date	Antimony	Arsenic	Barium	Beryllium	Cadmium	Chromium	Cobalt	Copper	Lead	Mercury
			(Sb)	(As)	(Ba)	(Be)	(Cd)	(Cr)	(Co)	(Cu)	(Pb)	(Hg)
		MCL	0.006	0.05	1	0.004	0.005	0.05	--	1.3 ⁺	0.015 ⁺⁺	0.002
5050	LF-12	1-Nov-93	< 0.2	0.022	< 0.5	< 0.02	3.7	< 0.1	2.7	0.9	< 0.4	< 0.0003
5050	LF-12	17-Feb-94	< 0.2	0.004	< 0.5	< 0.02	2.9	< 0.1	1.9	0.7	< 0.4	< 0.0002
5050	LF-12	24-May-94	< 0.3	0.008	< 0.05	< 0.02	3.6	< 0.1	2.4	1.0	0.049	< 0.0002
5050	LF-12	22-Sep-94	< 0.2	< 0.005	< 0.05	0.02	3.4	< 0.1	2.2	1.1	0.02	< 0.0002
5050	LF-12	19-Dec-94	< 0.2	< 0.005	< 0.5	0.02	3.5	< 0.1	2.3	1.1	0.01	< 0.0002
5050	LF-12	15-Mar-95	< 0.2	< 0.002	< 0.1	0.02	3	< 0.1	2	1	< 0.005	< 0.0002
5050	LF-12	7-Jun-95	< 0.2	< 0.005	< 0.1	0.03	3.3	< 0.1	2.1	1.2	< 0.005	< 0.0002
5050	LF-12	6-Sep-95	< 0.2	< 0.005	< 0.1	0.02	3.2	< 0.1	2.2	1.3	0.01	< 0.0002
5050	LF-12	18-Dec-95	< 0.2	< 0.002	< 0.1	< 0.03	3.8	< 0.1	2.1	1.1	< 0.005	< 0.0002
5050	LF-12	20-Aug-97	< 0.03	0.05	0.03	0.015	2.4	< 0.01	1.6	1.3	< 0.05	< 0.0005
5050	LF-12	19-Dec-97	< 0.03	< 0.05	< 0.01	0.014	2.4	< 0.01	1.6	1.5	< 0.05	< 0.0005
5050	LF-12	25-Mar-98	< 0.03	< 0.05	< 0.01	< 0.005	1.1	< 0.01	0.4	1.1	< 0.05	< 0.0005
5050	LF-12	18-Jun-98	< 0.03	< 0.05	0.24	0.01	2.3	< 0.01	1.6	0.98	< 0.05	< 0.0005
5050	LF-12	9-Sep-98	< 0.03	< 0.05	0.11	0.013	2.0	< 0.01	1.3	1.7	< 0.05	< 0.0005
5050	LF-12-H	8-Oct-98	-	0.06	-	-	2.2	-	-	-	-	-
5050	LF-12-L	8-Oct-98	-	0.06	-	-	2.0	-	-	-	-	-
5050	LF-12	10-Dec-98	< 0.03	< 0.05	0.1	0.011	2.5	< 0.01	1.8	3.1	< 0.05	< 0.0005
5050	LF-12	23-Feb-99	< 0.3	< 0.5	< 0.1	< 0.05	1.9	< 0.1	1.4	1.1	< 0.5	< 0.0005
5050	LF-12	28-May-99	< 0.05	< 0.005	0.076	0.0092	2.5	< 0.005	1.5	0.59	< 0.005	< 0.0008
5050	LF-12	16-Sep-99	< 0.03	< 0.05	< 0.01	< 0.02	1.9	< 0.01	1.5	0.97	< 0.05	0.0002
5050	LF-12	7-Dec-99	< 0.03	< 0.05	< 0.01	< 0.005	2.4	< 0.01	1.8	0.94	< 0.05	0.00054
5050	LF-12	29-Mar-00	< 0.03	< 0.05	0.32	< 0.005	2.4	0.014	1.7	0.86	< 0.05	0.00093
5050	LF-12	15-Dec-00	< 0.06	< 0.005	0.01	0.012	1.5	< 0.01	1.2	0.73	0.012	0.0003
5050	LF-12	27-Mar-01	< 0.06	< 0.005	0.01	0.0075	1.8	< 0.01	1.1	0.72	0.014	< 0.0002
5050	LF-12	11-Jun-01	< 0.06	0.015	0.012	0.011	1.6	< 0.01	1.3	0.66	0.022	< 0.0002
5050	LF-12	30-Aug-01	< 0.06	0.01	0.013	0.012	1.6	< 0.01	1.3	0.69	0.033	0.00027

TABLE 4
Metals, Total Dissolved Solids, pH and Chloride Detected in Groundwater
5050, 5051 5200 Coliseum Way
Concentrations in Milligrams per Liter (mg/L)

Site	Monitoring Well	Sample Date	Molybdenum (Mo)	Nickel (Ni)	Selenium (Se)	Silver (Ag)	Thallium (Tl)	Vanadium (V)	Zinc (Zn)	TDS	pH (SU)	Chloride
		MCL	--	0.10	0.05	0.1 ⁺	0.002	--	5			
5050	LF-12	1-Nov-93	< 0.1	8.1	0.014	< 0.05	< 1	< 0.05	3,400	17,000	4.56	-
5050	LF-12	17-Feb-94	< 0.1	5.9	0.014	< 0.05	< 1	< 0.05	2,700	-	4.68	-
5050	LF-12	24-May-94	< 0.1	7.1	0.017	< 0.05	< 1	< 0.05	3,100	-	-	-
5050	LF-12	22-Sep-94	< 0.1	6.7	0.02	< 0.05	< 1	< 0.05	3,100	-	-	-
5050	LF-12	19-Dec-94	< 0.1	6.9	0.03	< 0.05	< 1	< 0.05	3,200	-	-	-
5050	LF-12	15-Mar-95	< 0.1	6.7	0.019	< 0.05	< 0.5	< 0.05	2,600	-	-	-
5050	LF-12	7-Jun-95	< 0.1	6.6	0.04	< 0.05	< 0.5	< 0.05	2,900	-	7.59	-
5050	LF-12	6-Sep-95	< 0.1	6.4	< 0.01	< 0.05	< 0.5	< 0.05	2,900	-	-	-
5050	LF-12	18-Dec-95	< 0.1	6.6	0.055	< 0.05	< 0.5	< 0.05	3,000	-	4.08	-
5050	LF-12	20-Aug-97	< 0.01	4.7	0.12	< 0.01	0.05	0.03	2,200	-	3.58	-
5050	LF-12	19-Dec-97	< 0.01	4.4	< 0.05	< 0.01	< 0.05	0.02	2,600	-	4.49	-
5050	LF-12	25-Mar-98	< 0.01	1.9	< 0.07	< 0.01	< 0.05	< 0.01	1,200	7,100	4.00	-
5050	LF-12	18-Jun-98	< 0.01	4.6	0.11	< 0.01	0.14	0.01	2,500	12,000	4.02	-
5050	LF-12	9-Sep-98	< 0.01	4.1	0.13	< 0.01	< 0.05	< 0.01	2,100	12,000	4.85	-
5050	LF-12-H	8-Oct-98	-	-	-	-	-	-	2,400	11,000	3.30	590
5050	LF-12-L	8-Oct-98	-	-	-	-	-	-	1,700	10,000	3.50	820
5050	LF-12	10-Dec-98	< 0.01	4.8	0.1	< 0.01	< 0.05	0.01	2,800	13,000	3.87	-
5050	LF-12	23-Feb-99	< 0.1	3.9	< 0.7	< 0.1	< 0.5	< 0.1	2,000	11,000	3.68	-
5050	LF-12	28-May-99	< 0.05	4.6	0.017	< 0.01	< 0.005	< 0.05	2,100	11,000	4.93	-
5050	LF-12	16-Sep-99	< 0.01	5	< 0.07	< 0.01	< 0.05	< 0.01	870	11,000	4.18	-
5050	LF-12	7-Dec-99	< 0.01	4.9	< 0.07	0.096	< 0.05	< 0.01	1,200	13,000	3.88	-
5050	LF-12	29-Mar-00	0.021	4.6	0.097	< 0.01	< 0.05	< 0.01	890	13,000	4.2	-
5050	LF-12	15-Dec-00	< 0.02	3.5	0.071	< 0.005	0.1	0.011	2,100	12,300	4.66	-
5050	LF-12	27-Mar-01	< 0.02	3.2	0.058	< 0.005	0.084	< 0.01	1,700	10,800	4.91	-
5050	LF-12	11-Jun-01	< 0.02	3.7	0.045	< 0.005	0.099	< 0.01	5,500	10,200	4.45	-
5050	LF-12	30-Aug-01	< 0.02	3.8	0.055	< 0.005	0.11	< 0.01	1,800	10,300	4.13	-

TABLE 4
Metals, Total Dissolved Solids, pH and Chloride Detected in Groundwater
5050, 5051 5200 Coliseum Way
 Concentrations in Milligrams per Liter (mg/L)

Site	Monitoring Well	Sample Date	Antimony (Sb)	Arsenic (As)	Barium (Ba)	Beryllium (Be)	Cadmium (Cd)	Chromium (Cr)	Cobalt (Co)	Copper (Cu)	Lead (Pb)	Mercury (Hg)
		MCL	0.006	0.05	1	0.004	0.005	0.05	--	1.3 ⁺	0.015 ⁺⁺	0.002
5051	MWA-1	2-Jun-95	< 0.2	< 0.02	0.01	< 0.02	2.7	< 0.1	< 0.05	0.57	< 0.4	< 0.002
5051	MWA-1	12-Dec-95	< 0.2	0.011	< 0.1	< 0.02	2.8	< 0.1	0.11	1	0.6	0.0003
5051	MWA-1	13-Dec-96	< 0.02	0.01	0.01	< 0.002	3.1	< 0.01	0.14	1.4	1	< 0.0002
5051	MWA-1	13-Dec-96 (D)	< 0.02	0.011	0.02	< 0.002	3.1	< 0.01	0.17	1.5	1.1	< 0.0002
5051	MWA-1	27-Apr-98	< 0.03	< 0.05	0.2	< 0.005	4.2	0.01	0.01	1.1	1.3	< 0.0005
5051	MWA-1	19-Jun-98	< 0.03	< 0.05	0.22	< 0.005	3.4	< 0.01	0.02	0.88	0.81	< 0.0005
5051	MWA-1	11-Sep-98	< 0.03	< 0.05	0.06	< 0.005	3.5	< 0.01	0.03	1.3	0.84	< 0.0005
5051	MWA-1	9-Dec-98	< 0.03	0.05	0.09	< 0.005	3.5	< 0.01	0.03	1.3	0.94	< 0.0005
5051	MWA-1	25-Feb-99	< 0.03	< 0.05	0.03	< 0.005	3.3	< 0.01	0.02	1.0	0.67	< 0.0005
5051	MWA-1	27-May-99	< 0.05	< 0.005	< 0.05	< 0.004	4.2	< 0.005	< 0.05	0.91	1.2	< 0.0008
5051	MWA-1	16-Sep-99	< 0.03	< 0.05	< 0.01	< 0.009	3.1	< 0.01	0.04	1.3	1.3	< 0.0002
5051	MWA-1	7-Dec-99	< 0.03	< 0.05	< 0.01	< 0.005	3.6	< 0.010	0.14	1.2	1.4	0.0012
5051	MWA-1	29-Mar-00	< 0.03	< 0.05	0.024	0.007	3.8	< 0.010	< 0.01	0.78	0.87	0.00027
5051	MWA-1	15-Jan-01	< 0.06	< 0.005	< 0.01	< 0.002	2.5	< 0.015	< 0.02	0.8	0.75	< 0.0002
5051	MWA-1	27-Mar-01	< 0.06	< 0.005	< 0.01	< 0.002	2.4	< 0.01	< 0.02	0.74	0.68	0.00033
5051	MWA-1	11-Jun-01	< 0.06	0.0077	0.015	< 0.002	2.3	< 0.01	0.023	0.72	0.71	< 0.0002
5051	MWA-1	30-Aug-01	< 0.06	< 0.005	0.11	< 0.002	2.2	< 0.01	0.033	0.99	1.1	< 0.0002
5051	MW-4	11-Dec-95	< 0.2	0.005	< 0.1	< 0.2	< 0.05	< 0.1	1.2	< 0.1	< 0.4	< 0.0002
5051	MW-4	13-Dec-96	< 0.2	0.013	0.1	< 0.02	0.38	< 0.01	< 0.05	< 0.01	< 0.4	< 0.0002
5051	MW-4	27-Apr-98	< 0.03	< 0.05	< 0.01	< 0.005	0.28	0.02	0.04	< 0.01	< 0.05	< 0.0005
5051	MW-4	19-Jun-98	< 0.03	< 0.05	0.14	< 0.005	0.28	0.02	0.04	< 0.01	< 0.05	< 0.0005
5051	MW-4	11-Sep-98	< 0.03	< 0.05	0.08	0.005	0.25	0.02	0.05	0.08	< 0.05	< 0.0005
5051	MW-4	9-Dec-98	< 0.03	0.06	0.12	< 0.005	0.34	0.02	0.05	0.01	< 0.05	< 0.0005
5051	MW-4	25-Feb-99	< 0.03	< 0.05	0.05	< 0.005	0.28	0.01	0.03	0.02	< 0.05	< 0.0005
5051	MW-4	27-May-99	< 0.05	< 0.005	< 0.05	< 0.004	0.31	< 0.005	< 0.05	< 0.05	< 0.005	< 0.0008
5051	MW-4	16-Sep-99	< 0.03	< 0.05	< 0.01	< 0.009	0.17	0.02	< 0.01	< 0.01	< 0.05	< 0.0002
5051	MW-4	7-Dec-99	< 0.03	< 0.05	< 0.01	< 0.005	0.24	< 0.01	0.13	< 0.01	< 0.05	< 0.0002
5051	MW-4	29-Mar-00	< 0.03	< 0.05	0.14	< 0.005	0.13	0.038	0.035	< 0.01	< 0.05	< 0.0002
5051	MW-4	15-Jan-01	< 0.06	< 0.005	< 0.01	< 0.002	0.17	0.039	0.059	0.021	0.029	< 0.0002
5051	MW-4	27-Mar-01	< 0.06	< 0.005	< 0.01	< 0.002	0.19	< 0.01	0.03	0.011	0.016	< 0.0002
5051	MW-4	11-Jun-01	< 0.06	< 0.005	0.014	< 0.002	0.17	0.013	0.04	0.033	0.035	< 0.0002
5051	MW-4	30-Aug-01	< 0.06	< 0.005	0.077	< 0.002	0.13	< 0.01	0.052	0.035	0.029	< 0.0002

TABLE 4
Metals, Total Dissolved Solids, pH and Chloride Detected in Groundwater
5050, 5051 5200 Coliseum Way
 Concentrations in Milligrams per Liter (mg/L)

Site	Monitoring Well	Sample Date	Molybdenum (Mo)	Nickel (Ni)	Selenium (Se)	Silver (Ag)	Thallium (Tl)	Vanadium (V)	Zinc (Zn)	TDS	pH (SU)	Chloride
		MCL	--	0.10	0.05	0.1 ⁺	0.002	--	5			
5051	MWA-1	2-Jun-95	< 0.1	0.9	< 0.04	< 0.05	< 0.05	< 0.05	990	NA	NA	-
5051	MWA-1	12-Dec-95	< 0.1	1.2	0.013	< 0.05	< 500	< 0.05	1,000	NA	NA	-
5051	MWA-1	13-Dec-96	0.03	0.97	< 0.004	0.008	< 0.05	< 0.005	990	7,400	5.60	-
5051	MWA-1	13-Dec-96 (D)	0.03	1.1	< 0.004	0.01	< 0.05	< 0.005	970	7,500	5.60	-
5051	MWA-1	27-Apr-98	< 0.01	0.48	< 0.07	< 0.01	< 0.05	< 0.01	90	5,100	5.80	-
5051	MWA-1	19-Jun-98	< 0.01	0.55	< 0.07	< 0.01	0.07	< 0.01	820	5,400	5.70	-
5051	MWA-1	11-Sep-98	< 0.01	0.64	0.09	< 0.01	< 0.05	< 0.01	1,800	6,600	6.21	-
5051	MWA-1	9-Dec-98	< 0.01	0.81	< 0.07	< 0.01	< 0.05	< 0.01	1,000	6,500	6.15	-
5051	MWA-1	25-Feb-99	< 0.01	0.56	< 0.07	< 0.01	< 0.05	< 0.01	620	110	7.16	-
5051	MWA-1	27-May-99	< 0.05	0.69	< 0.005	< 0.01	< 0.005	< 0.05	950	5,500	5.98	-
5051	MWA-1	16-Sep-99	< 0.01	0.79	< 0.07	< 0.01	< 0.05	< 0.01	700	6,300	6.11	-
5051	MWA-1	7-Dec-99	< 0.01	0.88	< 0.07	0.067	< 0.05	< 0.01	700	7,300	5.25	-
5051	MWA-1	29-Mar-00	< 0.01	0.37	< 0.07	< 0.01	< 0.05	< 0.01	550	4,500	8.07	-
5051	MWA-1	15-Jan-01	< 0.02	0.64	0.024	0.006	0.14	< 0.01	810	5,740	5.86	-
5051	MWA-1	27-Mar-01	< 0.02	0.41	0.014	< 0.005	0.077	< 0.01	660	4,830	6.67	-
5051	MWA-1	11-Jun-01	< 0.02	0.54	0.024	< 0.005	0.11	< 0.01	620	5,410	6.22	-
5051	MWA-1	30-Aug-01	< 0.02	0.61	0.03	< 0.005	0.13	< 0.01	800	5,790	5.81	-
5051	MW-4	11-Dec-95	< 0.1	3	< 0.02	< 0.05	< 500	< 0.05	430	NA	NA	-
5051	MW-4	13-Dec-96	< 0.01	1	< 0.004	< 0.05	< 0.5	< 0.05	660	7,100	5.50	-
5051	MW-4	27-Apr-98	< 0.01	0.96	< 0.07	< 0.01	< 0.05	< 0.01	670	6,800	6.21	-
5051	MW-4	19-Jun-98	< 0.01	1	< 0.07	< 0.01	< 0.05	< 0.01	1,000	6,800	5.64	-
5051	MW-4	11-Sep-98	< 0.01	0.89	< 0.07	< 0.01	< 0.05	< 0.01	1,400	7,800	5.98	-
5051	MW-4	9-Dec-98	< 0.01	1.1	< 0.07	< 0.01	< 0.05	< 0.01	680	7,300	5.59	-
5051	MW-4	25-Feb-99	< 0.01	0.76	0.08	< 0.01	< 0.05	< 0.01	450	6,000	7.12	-
5051	MW-4	27-May-99	< 0.05	1.1	< 0.005	< 0.01	< 0.005	< 0.05	730	7,200	5.83	-
5051	MW-4	16-Sep-99	< 0.01	1.2	< 0.07	< 0.01	< 0.05	< 0.01	550	7,300	5.51	-
5051	MW-4	7-Dec-99	< 0.01	1	< 0.07	< 0.01	< 0.05	< 0.01	520	7,700	5.01	-
5051	MW-4	29-Mar-00	< 0.01	0.91	0.078	< 0.01	< 0.05	< 0.01	480	7,500	7.42	-
5051	MW-4	15-Jan-01	< 0.02	0.94	0.06	0.014	0.28	< 0.01	600	6,970	5.47	-
5051	MW-4	27-Mar-01	< 0.02	0.65	0.029	< 0.01	0.016	< 0.01	440	5,900	6.42	-
5051	MW-4	11-Jun-01	< 0.02	0.78	0.058	0.0056	0.23	< 0.01	88	6,910	5.92	-
5051	MW-4	30-Aug-01	< 0.02	0.86	0.068	< 0.005	0.28	< 0.01	570	6,960	5.05	-

TABLE 4
Metals, Total Dissolved Solids, pH and Chloride Detected in Groundwater
5050, 5051 5200 Coliseum Way
Concentrations in Milligrams per Liter (mg/L)

Site	Monitoring Well	Sample Date	Antimony (Sb)	Arsenic (As)	Barium (Ba)	Beryllium (Be)	Cadmium (Cd)	Chromium (Cr)	Cobalt (Co)	Copper (Cu)	Lead (Pb)	Mercury (Hg)
		MCL	0.006	0.05	1	0.004	0.005	0.05	--	1.3 ⁺	0.015 ⁺⁺	0.002
5051	MW-5	11-Dec-95	< 0.02	0.009	0.21	< 0.002	< 0.005	< 0.01	< 0.005	< 0.01	< 0.04	< 0.0002
5051	MW-5	13-Dec-96	< 0.02	0.005	0.73	< 0.02	< 0.005	< 0.01	< 0.005	< 0.01	< 0.04	< 0.0002
5051	MW-5	27-Apr-98	< 0.03	< 0.05	< 0.01	< 0.005	< 0.005	< 0.01	< 0.01	< 0.01	< 0.05	< 0.0005
5051	MW-5	19-Jun-98	< 0.03	< 0.05	0.57	< 0.005	< 0.005	< 0.01	< 0.01	< 0.01	< 0.05	< 0.0005
5051	MW-5	11-Sep-98	< 0.03	< 0.05	0.47	< 0.005	< 0.005	< 0.01	< 0.01	< 0.01	< 0.05	< 0.0005
5051	MW-5	9-Dec-98	< 0.03	< 0.05	0.83	< 0.005	< 0.005	< 0.01	< 0.01	< 0.01	< 0.05	< 0.0005
5051	MW-5	25-Feb-99	< 0.03	< 0.05	0.58	< 0.005	< 0.005	< 0.01	< 0.01	< 0.01	< 0.05	< 0.0005
5051	MW-5	27-May-99	< 0.05	< 0.005	0.33	< 0.004	< 0.005	< 0.005	< 0.05	< 0.05	< 0.005	< 0.0008
5051	MW-5	23-Sep-99	< 0.03	< 0.05	0.18	< 0.005	< 0.005	< 0.01	< 0.01	< 0.01	< 0.05	< 0.0002
5051	MW-5	10-Dec-99	< 0.03	< 0.05	1.1	< 0.005	< 0.005	< 0.01	< 0.01	< 0.01	< 0.05	< 0.0002
5051	MW-5	29-Mar-00	< 0.03	< 0.05	0.88	< 0.005	< 0.005	< 0.01	< 0.01	< 0.01	< 0.05	< 0.0002
5051	MW-5	12-Jan-01	< 0.06	0.0078	1.2	< 0.002	< 0.005	< 0.01	< 0.02	< 0.01	< 0.003	< 0.0002
5051	MW-5	27-Mar-01	< 0.06	< 0.005	0.65	< 0.002	< 0.005	< 0.01	< 0.02	< 0.01	< 0.003	< 0.0002
5051	MW-5	11-Jun-01	< 0.06	0.0073	0.84	< 0.002	< 0.005	< 0.01	< 0.02	< 0.01	< 0.003	< 0.0002
5051	MW-5	30-Aug-01	< 0.06	0.013	1.1	< 0.002	< 0.005	< 0.01	< 0.02	< 0.01	< 0.003	< 0.0002
5200	CW-1	1-Oct-96	< 0.03	0.52	2.5	< 0.005	< 0.005	< 0.01	< 0.01	< 0.01	< 0.05	< 0.0005
5200	CW-1	19-Aug-97	< 0.03	0.56	90	< 0.005	< 0.005	< 0.01	0.08	< 0.01	< 0.05	< 0.0005
5200	CW-1	11-Dec-97	< 0.03	0.56	70	< 0.005	< 0.005	< 0.01	0.06	< 0.01	< 0.05	< 0.0005
5200	CW-1	25-Mar-98	< 0.03	0.43	80	< 0.005	< 0.005	0.13	0.07	< 0.01	< 0.05	< 0.0005
5200	CW-1	19-Jun-98	< 0.03	0.18	3.6	< 0.005	< 0.005	< 0.01	< 0.01	< 0.01	< 0.05	< 0.0005
5200	CW-1	10-Sep-98	< 0.03	0.19	0.79	< 0.005	< 0.005	0.03	0.01	< 0.01	< 0.05	< 0.0005
5200	CW-1	4-Dec-98	< 0.03	0.16	6.7	< 0.005	< 0.005	< 0.01	< 0.01	< 0.01	< 0.05	< 0.0005
5200	CW-1	24-Feb-99	< 0.03	0.17	2.4	< 0.005	< 0.005	< 0.01	< 0.01	< 0.01	< 0.05	< 0.0005
5200	CW-1	27-May-99	< 0.05	0.26	0.27	< 0.004	0.0056	< 0.005	< 0.05	< 0.05	< 0.005	< 0.0008
5200	CW-1	17-Sep-99	< 0.03	0.11	13	< 0.009	< 0.005	< 0.01	< 0.01	< 0.01	< 0.05	< 0.0002
5200	CW-1	13-Dec-99	< 0.03	0.089	38	< 0.005	< 0.005	< 0.01	< 0.01	< 0.01	< 0.05	< 0.0002
5200	CW-1	29-Mar-00	< 0.03	0.2	0.85	< 0.005	< 0.005	< 0.01	0.022	< 0.01	< 0.05	< 0.0002
5200	CW-1	15-Dec-00	< 0.06	0.17	0.082	< 0.002	< 0.005	< 0.01	< 0.02	< 0.01	< 0.003	< 0.0002
5200	CW-1	27-Mar-01	< 0.06	0.22	0.23	< 0.002	0.0091	< 0.01	0.036	< 0.01	< 0.003	< 0.0002
5200	CW-1	11-Jun-01	< 0.06	0.29	0.1	< 0.002	0.0089	< 0.01	0.032	< 0.01	< 0.003	< 0.0002
5200	CW-1	30-Aug-01	< 0.06	0.2	0.14	< 0.002	0.013	< 0.01	< 0.02	< 0.01	< 0.003	< 0.0002

TABLE 4
Metals, Total Dissolved Solids, pH and Chloride Detected in Groundwater
5050, 5051 5200 Coliseum Way
 Concentrations in Milligrams per Liter (mg/L)

Site	Monitoring Well	Sample Date	Molybdenum (Mo)	Nickel (Ni)	Selenium (Se)	Silver (Ag)	Thallium (Tl)	Vanadium (V)	Zinc (Zn)	TDS	pH (SU)	Chloride
		MCL	--	0.10	0.05	0.1 ⁺	0.002	--	5			
5051	MW-5	11-Dec-95	< 0.01	< 0.01	< 4	< 0.005	< 0.05	< 0.005	0.02	NA	NA	-
5051	MW-5	13-Dec-96	< 0.01	< 0.01	< 0.004	< 0.005	< 0.05	< 0.005	0.17	3,600	7.20	-
5051	MW-5	27-Apr-98	< 0.01	< 0.02	< 0.07	< 0.01	< 0.05	< 0.01	< 0.01	2,800	7.37	-
5051	MW-5	19-Jun-98	< 0.01	< 0.02	< 0.07	< 0.01	< 0.05	< 0.01	0.92	2,800	6.89	-
5051	MW-5	11-Sep-98	< 0.01	< 0.02	0.07	< 0.01	< 0.05	< 0.01	0.17	2,800	6.99	-
5051	MW-5	9-Dec-98	< 0.01	< 0.02	< 0.07	< 0.01	< 0.05	< 0.01	0.08	3,000	6.99	-
5051	MW-5	25-Feb-99	< 0.01	< 0.02	< 0.07	< 0.01	< 0.05	< 0.01	0.16	2,600	7.28	-
5051	MW-5	27-May-99	< 0.05	< 0.05	< 0.005	< 0.01	< 0.005	< 0.05	0.055	2,200	7.33	-
5051	MW-5	23-Sep-99	< 0.01	< 0.02	< 0.07	< 0.01	< 0.05	< 0.01	0.02	2,600	6.99	-
5051	MW-5	10-Dec-99	0.01	0.032	< 0.07	< 0.01	< 0.05	< 0.01	0.065	3,100	6.56	-
5051	MW-5	29-Mar-00	< 0.01	< 0.02	< 0.07	< 0.01	< 0.05	< 0.01	0.061	2,500	7.46	-
5051	MW-5	12-Jan-01	< 0.02	< 0.02	< 0.005	< 0.005	< 0.005	< 0.01	0.027	4,420	7.32	-
5051	MW-5	27-Mar-01	< 0.02	< 0.02	< 0.005	< 0.005	< 0.005	< 0.01	2.6	2,950	6.8	-
5051	MW-5	11-Jun-01	< 0.02	< 0.02	< 0.005	< 0.005	< 0.005	< 0.01	0.350	2,630	7.69	-
5051	MW-5	30-Aug-01	< 0.02	< 0.02	0.016	< 0.005	< 0.005	< 0.01	0.022	2,800	7.26	-
5200	CW-1	1-Oct-96	0.02	< 0.02	< 0.05	< 0.01	< 0.05	0.08	0.01	-	8.40	-
5200	CW-1	19-Aug-97	0.02	< 0.02	< 0.05	< 0.01	< 0.05	0.1	< 0.01	-	8.15	-
5200	CW-1	11-Dec-97	0.01	< 0.02	< 0.05	< 0.01	< 0.05	0.04	1.3	-	7.67	-
5200	CW-1	25-Mar-98	0.02	0.39	< 0.07	< 0.01	< 0.05	< 0.01	1.3	1,000	7.61	-
5200	CW-1	19-Jun-98	0.03	0.03	< 0.07	< 0.01	< 0.05	< 0.01	7.9	1,700	6.95	-
5200	CW-1	10-Sep-98	0.02	< 0.02	< 0.07	< 0.01	< 0.05	< 0.01	15	1,500	6.70	-
5200	CW-1	4-Dec-98	0.02	< 0.02	< 0.07	< 0.01	< 0.05	< 0.01	2.3	1,200	6.79	-
5200	CW-1	24-Feb-99	0.04	< 0.02	< 0.07	< 0.01	< 0.05	< 0.01	1.3	1,500	6.93	-
5200	CW-1	27-May-99	< 0.05	0.08	< 0.005	< 0.01	< 0.001	< 0.05	58	1,600	6.86	-
5200	CW-1	17-Sep-99	0.02	0.03	< 0.07	< 0.01	< 0.05	< 0.01	8.7	1,000	8.40	-
5200	CW-1	13-Dec-99	0.02	0.033	< 0.07	< 0.01	< 0.05	0.015	1.5	1,100	5.85	-
5200	CW-1	29-Mar-00	< 0.01	0.039	< 0.07	< 0.01	< 0.05	< 0.01	52	1,700	7.55	-
5200	CW-1	15-Dec-00	< 0.02	< 0.02	< 0.005	< 0.005	< 0.005	< 0.01	15	1,900	7.37	-
5200	CW-1	27-Mar-01	< 0.02	0.077	< 0.005	< 0.005	0.0074	< 0.01	78	2,030	7.64	-
5200	CW-1	11-Jun-01	< 0.02	0.061	< 0.005	< 0.005	0.0063	< 0.01	69	1,810	7.31	-
5200	CW-1	30-Aug-01	< 0.02	0.021	0.0058	< 0.005	< 0.005	< 0.01	22	1,850	7.16	-

TABLE 4
Metals, Total Dissolved Solids, pH and Chloride Detected in Groundwater
5050, 5051 5200 Coliseum Way
Concentrations in Milligrams per Liter (mg/L)

Site	Monitoring Well	Sample Date	Antimony (Sb)	Arsenic (As)	Barium (Ba)	Beryllium (Be)	Cadmium (Cd)	Chromium (Cr)	Cobalt (Co)	Copper (Cu)	Lead (Pb)	Mercury (Hg)
		MCL	0.006	0.05	1	0.004	0.005	0.05	--	1.3 ⁺	0.015 ⁺⁺	0.002
5200	CW-2	1-Oct-96	< 0.03	3.5	220	< 0.005	< 0.005	< 0.01	0.2	< 0.01	< 0.05	< 0.0005
5200	CW-2	19-Aug-97	< 0.03	2.6	220	< 0.005	< 0.005	< 0.01	0.2	< 0.01	< 0.05	< 0.0005
5200	CW-2	11-Dec-97	< 0.03	3.6	150	< 0.005	< 0.005	< 0.01	0.14	< 0.01	< 0.05	< 0.0005
5200	CW-2	25-Mar-98	< 0.03	1.8	230	< 0.005	< 0.005	0.13	0.07	0.01	< 0.05	< 0.0005
5200	CW-2	19-Jun-98	< 0.03	2.1	170	< 0.005	< 0.005	< 0.01	0.13	< 0.01	< 0.05	< 0.0005
5200	CW-2	10-Sep-98	< 0.03	2.9	190	< 0.005	< 0.005	< 0.01	0.12	< 0.01	< 0.05	< 0.0005
5200	CW-2	4-Dec-98	< 0.03	2.0	250	< 0.005	< 0.005	< 0.01	0.12	< 0.01	< 0.05	< 0.0005
5200	CW-2	24-Feb-99	< 0.03	2.5	17	< 0.005	< 0.005	< 0.01	< 0.01	< 0.01	< 0.05	< 0.0005
5200	CW-2	27-May-99	< 0.05	2.7	150	< 0.004	< 0.005	< 0.005	< 0.05	< 0.05	0.0051	< 0.0008
5200	CW-2	16-Sep-99	< 0.03	1.5	160	< 0.009	< 0.005	< 0.01	< 0.01	< 0.01	< 0.05	< 0.0002
5200	CW-2	10-Dec-99	< 0.03	1.3	220	< 0.005	< 0.005	< 0.01	< 0.01	< 0.01	< 0.05	< 0.0002
5200	CW-2	29-Mar-00	< 0.03	1.6	210	< 0.005	< 0.005	< 0.01	< 0.01	< 0.01	< 0.050	< 0.0002
5200	CW-2	15-Dec-00	< 0.06	1.1	170	< 0.002	< 0.05	< 0.01	< 0.02	< 0.01	< 0.003	< 0.0002
5200	CW-2	27-Mar-01	< 0.06	2.5	150	< 0.002	< 0.005	< 0.01	< 0.02	< 0.01	< 0.003	< 0.0002
5200	CW-2	11-Jun-01	< 0.06	2.8	790	< 0.002	< 0.005	< 0.01	< 0.02	< 0.01	< 0.003	< 0.0002
5200	CW-2	30-Aug-01	< 0.06	2.7	110	< 0.002	0.005	< 0.01	< 0.02	< 0.01	< 0.003	< 0.0002
ACPWA-E	CW-6	29-Sep-98	< 0.03	0.13	470	< 0.005	0.1	< 0.01	0.34	< 0.01	< 0.05	< 0.0005
ACPWA-E	CW-6-H	8-Oct-98	-	0.33	610	-	0.2	-	-	-	-	-
ACPWA-E	CW-6-L	8-Oct-98	-	0.09	460	-	0.11	-	-	-	-	-
ACPWA-E	CW-6	4-Dec-98	< 0.03	0.19	610	< 0.005	0.14	< 0.01	0.42	< 0.01	< 0.05	< 0.0005
ACPWA-E	CW-6	24-Feb-99	< 0.03	0.13	550	0.005	0.11	< 0.01	< 0.01	< 0.01	< 0.05	< 0.0005
ACPWA-E	CW-6	27-May-99	< 0.05	0.054	600	< 0.004	0.17	< 0.005	0.10	< 0.05	0.005	< 0.0008
ACPWA-E	CW-6	16-Sep-99	< 0.03	0.09	800	< 0.009	0.092	< 0.01	< 0.01	< 0.01	< 0.05	< 0.0002
ACPWA-E	CW-6	10-Dec-99	< 0.03	0.06	640	< 0.005	0.056	< 0.01	0.022	< 0.01	< 0.05	< 0.0002
ACPWA-E	CW-6	29-Mar-00	< 0.03	0.14	440	< 0.005	0.1	< 0.01	< 0.01	< 0.01	< 0.05	< 0.0002
ACPWA-E	CW-6	15-Dec-00	< 0.06	0.19	500	< 0.02	0.062	< 0.01	< 0.02	< 0.01	< 0.003	< 0.0002
ACPWA-E	CW-6	27-Mar-01	< 0.06	0.13	300	< 0.002	0.046	< 0.01	< 0.02	< 0.01	< 0.003	< 0.0002
ACPWA-E	CW-6	11-Jun-01	< 0.06	0.14	160	< 0.002	0.044	< 0.01	< 0.02	< 0.01	< 0.003	< 0.0002
ACPWA-E	CW-6	30-Aug-01	< 0.06	0.23	510	< 0.002	0.034	< 0.01	< 0.02	< 0.01	< 0.003	< 0.0002

TABLE 4
Metals, Total Dissolved Solids, pH and Chloride Detected in Groundwater
5050, 5051 5200 Coliseum Way
Concentrations in Milligrams per Liter (mg/L)

Site	Monitoring Well	Sample Date	Molybdenum (Mo)	Nickel (Ni)	Selenium (Se)	Silver (Ag)	Thallium (Tl)	Vanadium (V)	Zinc (Zn)	TDS	pH (SU)	Chloride
		MCL	--	0.10	0.05	0.1 ⁺	0.002	--	5			
5200	CW-2	1-Oct-96	< 0.01	< 0.02	< 0.05	< 0.01	< 0.05	< 0.01	0.06	-	6.80	-
5200	CW-2	19-Aug-97	< 0.01	< 0.02	< 0.05	< 0.01	< 0.05	< 0.01	< 0.01	-	7.60	-
5200	CW-2	11-Dec-97	< 0.01	< 0.02	< 0.05	< 0.01	< 0.05	< 0.01	0.05	-	7.30	-
5200	CW-2	25-Mar-98	< 0.01	1.4	< 0.07	< 0.01	< 0.05	0.02	0.07	900	8.61	-
5200	CW-2	19-Jun-98	0.05	< 0.02	< 0.07	< 0.01	< 0.05	< 0.01	0.08	930	6.88	-
5200	CW-2	10-Sep-98	< 0.01	< 0.02	< 0.07	< 0.01	< 0.05	< 0.01	< 0.01	1,200	6.81	-
5200	CW-2	4-Dec-98	< 0.01	< 0.02	< 0.07	< 0.01	< 0.05	< 0.01	0.03	1,300	7.06	-
5200	CW-2	24-Feb-99	< 0.01	< 0.02	< 0.07	< 0.01	< 0.05	< 0.01	0.02	900	7.08	-
5200	CW-2	27-May-99	< 0.05	< 0.05	< 0.005	< 0.01	< 0.001	< 0.05	0.055	880	7.53	-
5200	CW-2	16-Sep-99	< 0.01	< 0.02	< 0.07	< 0.01	< 0.05	< 0.01	< 0.01	1,000	7.31	-
5200	CW-2	10-Dec-99	< 0.01	0.03	< 0.07	< 0.01	< 0.05	0.01	0.01	1,200	8.44	-
5200	CW-2	29-Mar-00	< 0.01	< 0.02	< 0.07	< 0.01	< 0.05	< 0.01	< 0.01	960	7.3	-
5200	CW-2	15-Dec-00	< 0.02	< 0.02	< 0.05	< 0.05	< 0.05	< 0.01	0.46	1,250	7.52	-
5200	CW-2	27-Mar-01	< 0.02	< 0.02	< 0.05	< 0.005	0.0051	< 0.01	0.37	1,120	8.46	-
5200	CW-2	11-Jun-01	< 0.02	< 0.02	< 0.05	< 0.005	0.0052	< 0.01	0.74	1,020	7.96	-
5200	CW-2	30-Aug-01	< 0.02	< 0.02	0.0073	< 0.005	< 0.005	< 0.01	3.5	1,050	7.33	-
ACPWA-E	CW-6	29-Sep-98	< 0.01	0.26	< 0.07	< 0.01	< 0.05	0.02	15	3,900	6.71	-
ACPWA-E	CW-6-H	8-Oct-98	-	-	-	-	-	-	33	4,300	6.60	1,700
ACPWA-E	CW-6-L	8-Oct-98	-	-	-	-	-	-	15	4,100	6.70	1,300
ACPWA-E	CW-6	4-Dec-98	< 0.01	0.42	< 0.07	< 0.01	< 0.05	< 0.01	21	3,300	7.30	-
ACPWA-E	CW-6	24-Feb-99	0.02	0.37	< 0.07	< 0.01	< 0.05	< 0.01	19	3,000	6.99	-
ACPWA-E	CW-6	27-May-99	< 0.05	0.41	< 0.005	< 0.01	< 0.001	< 0.05	28	3,400	6.87	-
ACPWA-E	CW-6	16-Sep-99	0.02	0.41	< 0.07	< 0.05	< 0.05	0.03	16	3,700	7.73	-
ACPWA-E	CW-6	10-Dec-99	0.02	0.25	< 0.07	< 0.01	< 0.05	0.019	9.8	3,300	6.97	-
ACPWA-E	CW-6	29-Mar-00	< 0.01	0.3	< 0.07	< 0.01	< 0.05	< 0.01	25	2,400	8.39	-
ACPWA-E	CW-6	15-Dec-00	< 0.02	0.21	< 0.005	< 0.005	< 0.05	< 0.01	8.5	2,600	7.04	-
ACPWA-E	CW-6	27-Mar-01	< 0.02	0.19	< 0.005	< 0.005	0.0097	< 0.01	12	2,200	8.15	-
ACPWA-E	CW-6	11-Jun-01	< 0.02	0.21	< 0.005	< 0.005	0.014	< 0.01	20	2,260	7.63	-
ACPWA-E	CW-6	30-Aug-01	< 0.02	0.21	0.008	< 0.005	< 0.005	< 0.01	10	2,430	7.18	-

TABLE 4
Metals, Total Dissolved Solids, pH and Chloride Detected in Groundwater
5050, 5051 5200 Coliseum Way
 Concentrations in Milligrams per Liter (mg/L)

Site	Monitoring Well	Sample Date	Antimony	Arsenic	Barium	Beryllium	Cadmium	Chromium	Cobalt	Copper	Lead	Mercury
			(Sb)	(As)	(Ba)	(Be)	(Cd)	(Cr)	(Co)	(Cu)	(Pb)	(Hg)
MCL			0.006	0.05	1	0.004	0.005	0.05	--	1.3 ⁺	0.015 ⁺⁺	0.002
ACPWA-E	CW-7	29-Sep-98	< 0.03	< 0.05	140	< 0.005	< 0.005	< 0.01	0.08	< 0.01	< 0.05	< 0.0005
ACPWA-E	CW-7-D1	29-Sep-98	< 0.005	0.04	140	< 0.005	0.0024	< 0.005	0.0052	0.0091	0.015	< 0.0005
ACPWA-E	CW-7-D2	29-Sep-98	-	-	-	-	-	-	-	-	-	-
ACPWA-E	CW-7-H	8-Oct-98	-	0.07	167	-	< 0.005	-	-	-	-	-
ACPWA-E	CW-7-L	8-Oct-98	-	< 0.05	120	-	< 0.005	-	-	-	-	-
ACPWA-E	CW-7	4-Dec-98	< 0.03	< 0.05	190	< 0.005	< 0.005	< 0.01	0.09	< 0.01	< 0.05	< 0.0005
ACPWA-E	CW-7	24-Feb-99	< 0.03	0.05	210	< 0.005	< 0.005	< 0.01	< 0.01	< 0.01	< 0.05	< 0.0005
ACPWA-E	CW-7	27-May-99	< 0.05	0.019	54	< 0.004	< 0.005	< 0.005	< 0.05	< 0.05	< 0.005	< 0.0008
ACPWA-E	CW-7	16-Sep-99	< 0.03	0.08	200	< 0.009	< 0.005	< 0.01	< 0.01	< 0.01	< 0.05	< 0.0002
ACPWA-E	CW-7	10-Dec-99	< 0.03	< 0.05	210	< 0.005	< 0.005	< 0.01	< 0.01	< 0.01	< 0.05	< 0.0002
ACPWA-E	CW-7	29-Mar-00	< 0.03	0.057	200	< 0.005	< 0.005	< 0.01	< 0.01	0.016	< 0.05	< 0.0002
ACPWA-E	CW-7	15-Dec-00	< 0.06	0.023	210	< 0.002	< 0.005	< 0.01	< 0.02	< 0.01	< 0.003	< 0.0002
ACPWA-E	CW-7	27-Mar-01	< 0.06	0.041	140	< 0.002	< 0.005	< 0.01	< 0.02	< 0.01	< 0.003	< 0.0002
ACPWA-E	CW-7	11-Jun-01	< 0.06	0.028	160	< 0.002	< 0.005	< 0.01	< 0.02	< 0.01	< 0.003	< 0.0002
ACPWA-E	CW-7	30-Aug-01	< 0.06	0.035	84	< 0.002	< 0.005	< 0.01	< 0.02	< 0.01	< 0.003	< 0.0002
ACPWA-W	CW-12	29-Sep-98	< 0.03	< 0.05	0.2	< 0.005	< 0.005	< 0.01	< 0.01	< 0.01	< 0.05	< 0.0005
ACPWA-W	CW-12-H	8-Oct-98	-	< 0.05	-	-	< 0.005	-	-	-	-	-
ACPWA-W	CW-12-L	8-Oct-98	-	< 0.05	-	-	< 0.005	-	-	-	-	-
ACPWA-W	CW-12	8-Dec-98	< 0.03	< 0.05	0.22	< 0.005	< 0.005	0.01	< 0.01	0.01	< 0.05	< 0.0005
ACPWA-W	CW-12	23-Feb-99	< 0.03	< 0.05	0.05	< 0.005	< 0.005	< 0.01	< 0.01	0.02	< 0.05	< 0.0005
ACPWA-W	CW-12	27-May-99	< 0.05	< 0.005	0.11	< 0.004	< 0.005	< 0.005	< 0.05	< 0.05	< 0.005	< 0.0008
ACPWA-W	CW-12	23-Sep-99	< 0.03	< 0.05	0.7	< 0.005	< 0.005	< 0.01	< 0.01	< 0.01	< 0.05	< 0.0002
ACPWA-W	CW-12	10-Dec-99	< 0.03	< 0.05	0.13	< 0.005	< 0.005	< 0.01	< 0.01	< 0.01	< 0.05	< 0.0002
ACPWA-W	CW-12	29-Mar-00	< 0.03	< 0.05	0.053	< 0.005	< 0.005	< 0.01	< 0.01	< 0.01	< 0.05	< 0.0002
ACPWA-W	CW-12	15-Dec-00	< 0.06	< 0.005	0.055	< 0.002	< 0.005	< 0.01	< 0.02	< 0.01	< 0.003	< 0.0002
ACPWA-W	CW-12	27-Mar-01	< 0.06	< 0.005	0.045	< 0.002	< 0.005	< 0.01	< 0.02	< 0.01	< 0.003	< 0.0002
ACPWA-W	CW-12	11-Jun-01	< 0.06	< 0.005	0.077	< 0.002	< 0.005	< 0.01	< 0.02	< 0.01	< 0.003	< 0.0002
ACPWA-W	CW-12	30-Aug-01	< 0.06	< 0.005	0.18	< 0.002	< 0.005	< 0.01	< 0.02	< 0.01	< 0.003	< 0.0002

TABLE 4
Metals, Total Dissolved Solids, pH and Chloride Detected in Groundwater
5050, 5051 5200 Coliseum Way
Concentrations in Milligrams per Liter (mg/L)

Site	Monitoring Well	Sample Date	Molybdenum (Mo)	Nickel (Ni)	Selenium (Se)	Silver (Ag)	Thallium (Tl)	Vanadium (V)	Zinc (Zn)	TDS	pH (SU)	Chloride
		MCL	--	0.10	0.05	0.1 ⁺	0.002	--	5			
ACPWA-E	CW-7	29-Sep-98	0.02	< 0.02	< 0.07	< 0.01	< 0.05	0.02	0.02	820	9.79	-
ACPWA-E	CW-7-D1	29-Sep-98	0.029	0.0089	< 0.005	< 0.005	< 0.005	0.031	0.2	-	-	-
ACPWA-E	CW-7-D2	29-Sep-98	-	-	-	-	-	-	-	770	-	-
ACPWA-E	CW-7-H	8-Oct-98	-	-	-	-	-	-	0.08	860	10.70	860
ACPWA-E	CW-7-L	8-Oct-98	-	-	-	-	-	-	0.28	880	10.50	880
ACPWA-E	CW-7	4-Dec-98	0.02	< 0.02	< 0.07	< 0.01	< 0.05	0.02	0.01	800	9.72	-
ACPWA-E	CW-7	24-Feb-99	0.02	< 0.02	< 0.07	< 0.01	< 0.05	0.01	0.03	710	8.31	-
ACPWA-E	CW-7	27-May-99	< 0.05	< 0.05	< 0.005	< 0.01	< 0.001	< 0.05	< 0.05	2,500	8.87	-
ACPWA-E	CW-7	16-Sep-99	0.03	< 0.02	< 0.07	< 0.01	< 0.05	< 0.01	< 0.01	870	8.46	-
ACPWA-E	CW-7	10-Dec-99	0.033	0.026	< 0.07	< 0.01	< 0.05	0.017	< 0.01	870	7.72	-
ACPWA-E	CW-7	29-Mar-00	0.01	< 0.02	< 0.07	< 0.01	< 0.05	< 0.01	< 0.01	840	8.29	-
ACPWA-E	CW-7	15-Dec-00	0.027	< 0.02	< 0.005	< 0.005	< 0.005	< 0.01	< 0.02	890	10.48	-
ACPWA-E	CW-7	27-Mar-01	0.03	< 0.02	< 0.005	< 0.005	< 0.005	< 0.01	0.2	780	11.54	-
ACPWA-E	CW-7	11-Jun-01	0.021	< 0.02	< 0.005	< 0.005	< 0.005	< 0.01	< 0.02	810	10.3	-
ACPWA-E	CW-7	30-Aug-01	0.029	< 0.02	< 0.005	< 0.005	< 0.005	0.01	< 0.02	800	9.37	-
ACPWA-W	CW-12	29-Sep-98	< 0.01	< 0.02	< 0.07	< 0.01	< 0.05	< 0.01	0.03	12,000	7.95	-
ACPWA-W	CW-12-H	8-Oct-98	-	-	-	-	-	-	1.8	13,000	7.80	5,900
ACPWA-W	CW-12-L	8-Oct-98	-	-	-	-	-	-	2.1	13,000	7.70	5,400
ACPWA-W	CW-12	8-Dec-98	< 0.01	< 0.02	< 0.07	< 0.01	< 0.05	< 0.01	0.05	13,000	7.53	-
ACPWA-W	CW-12	23-Feb-99	< 0.01	< 0.02	< 0.07	< 0.01	< 0.05	< 0.01	0.06	1,400	7.50	-
ACPWA-W	CW-12	27-May-99	< 0.05	< 0.05	< 0.005	< 0.01	< 0.005	< 0.05	0.056	2,500	8.10	-
ACPWA-W	CW-12	23-Sep-99	< 0.01	< 0.02	< 0.07	< 0.01	< 0.05	< 0.01	0.01	6,300	7.26	-
ACPWA-W	CW-12	10-Dec-99	< 0.01	0.042	< 0.07	< 0.01	< 0.05	< 0.01	0.44	17,000	6.03	-
ACPWA-W	CW-12	29-Mar-00	< 0.01	< 0.02	< 0.07	< 0.01	< 0.05	< 0.01	< 0.01	14,000	5.77	-
ACPWA-W	CW-12	15-Dec-00	< 0.02	< 0.02	0.0051	< 0.005	< 0.005	< 0.01	0.28	16,600	7.46	-
ACPWA-W	CW-12	27-Mar-01	< 0.02	< 0.02	< 0.005	< 0.005	< 0.005	< 0.01	0.89	2,620	8.24	-
ACPWA-W	CW-12	11-Jun-01	< 0.02	< 0.02	< 0.005	< 0.005	< 0.005	< 0.01	0.12	6,550	7.60	-
ACPWA-W	CW-12	30-Aug-01	< 0.02	< 0.02	< 0.005	< 0.005	< 0.005	< 0.01	0.035	19,700	7.64	-

TABLE 4
Metals, Total Dissolved Solids, pH and Chloride Detected in Groundwater
5050, 5051 5200 Coliseum Way
 Concentrations in Milligrams per Liter (mg/L)

Site	Monitoring Well	Sample Date	Antimony (Sb)	Arsenic (As)	Barium (Ba)	Beryllium (Be)	Cadmium (Cd)	Chromium (Cr)	Cobalt (Co)	Copper (Cu)	Lead (Pb)	Mercury (Hg)
		MCL	0.006	0.05	1	0.004	0.005	0.05	--	1.3 ⁺	0.015 ⁺⁺	0.002
5050	CW-13	11-Sep-98	< 0.03	0.09	0.11	< 0.005	1.4	< 0.01	1.4	< 0.01	< 0.05	< 0.0005
5050	CW-13-H	8-Oct-98	-	< 0.05	-	-	1.2	-	-	-	-	-
5050	CW-13-L	8-Oct-98	-	< 0.05	-	-	1.2	-	-	-	-	-
5050	CW-13	8-Dec-98	< 0.03	< 0.05	0.12	< 0.005	1.0	0.02	0.77	0.02	< 0.05	< 0.0005
5050	CW-13	23-Feb-99	< 0.03	< 0.05	0.05	< 0.005	0.05	< 0.01	0.01	0.03	< 0.05	< 0.0005
5050	CW-13	27-May-99	< 0.05	< 0.005	< 0.05	< 0.004	0.99	< 0.005	0.77	< 0.05	< 0.005	< 0.0008
5050	CW-13	16-Sep-99	< 0.03	< 0.05	< 0.01	< 0.009	1.1	< 0.01	0.85	< 0.01	< 0.05	< 0.0002
5050	CW-13	10-Dec-99	0.038	< 0.05	0.23	< 0.005	1.3	0.034	1.1	0.017	< 0.05	< 0.0002
5050	CW-13	15-Dec-00	< 0.06	< 0.005	0.013	0.0022	0.72	< 0.01	0.68	0.036	0.0053	< 0.0002
5050	CW-13	27-Mar-01	< 0.06	< 0.005	0.012	< 0.002	0.46	< 0.01	0.46	0.027	0.0034	< 0.0002
5050	CW-13	11-Jun-01	< 0.06	< 0.005	0.012	0.0028	0.82	< 0.01	0.83	0.07	0.0076	< 0.0002
5050	CW-13	30-Aug-01	< 0.06	< 0.005	0.023	0.0026	0.81	< 0.01	0.72	0.067	0.0087	< 0.0002

TABLE 4
Metals, Total Dissolved Solids, pH and Chloride Detected in Groundwater
5050, 5051 5200 Coliseum Way
 Concentrations in Milligrams per Liter (mg/L)

Site	Monitoring Well	Sample Date	Molybdenum (Mo)	Nickel (Ni)	Selenium (Se)	Silver (Ag)	Thallium (Tl)	Vanadium (V)	Zinc (Zn)	TDS	pH (SU)	Chloride
	MCL		--	0.10	0.05	0.1 ⁺	0.002	--	5			
5050	CW-13	11-Sep-98	< 0.01	2.8	< 0.07	< 0.01	< 0.05	< 0.01	1,900	8,600	5.66	-
5050	CW-13-H	8-Oct-98	-	-	-	-	-	-	1,300	9,300	5.60	1,100
5050	CW-13-L	8-Oct-98	-	-	-	-	-	-	1,200	9,100	5.60	920
5050	CW-13	8-Dec-98	< 0.01	2.2	< 0.07	< 0.01	< 0.05	< 0.01	990	7,600	7.64	-
5050	CW-13	23-Feb-99	< 0.01	0.12	< 0.07	< 0.01	< 0.05	< 0.01	40	1,400	6.71	-
5050	CW-13	27-May-99	< 0.05	2.3	< 0.005	< 0.01	< 0.005	< 0.05	1,000	5,300	6.30	-
5050	CW-13	16-Sep-99	< 0.01	2.8	< 0.07	< 0.01	< 0.05	< 0.01	770	8,300	5.98	-
5050	CW-13	10-Dec-99	0.012	3.1	< 0.07	< 0.01	< 0.05	< 0.01	280	8,800	7.00	-
5050	CW-13	15-Dec-00	< 0.02	1.9	0.02	< 0.005	0.069	< 0.01	920	7,420	6.16	-
5050	CW-13	27-Mar-01	< 0.02	1.2	0.019	< 0.005	0.042	< 0.01	520	5,840	6.08	-
5050	CW-13	11-Jun-01	< 0.02	2.2	0.028	< 0.005	0.081	< 0.01	860	7,070	6.35	-
5050	CW-13	30-Aug-01	< 0.02	2.1	0.024	< 0.005	0.081	< 0.01	990	7,530	5.66	-

FOOTNOTES:

- (Sb) = Chemical Symbol for Metal (eg. Antimony)
- TDS = Total dissolved solids
- MCL = Maximum Contaminant Levels for Drinking Water (CCR Title 22, Sections 64431 and 64444)
- = Not established
- ⁺ = Secondary Drinking Water Standard
- ⁺⁺ = Lead level established by the Federal Copper and Lead Rule for public drinking water suppliers
- (SU) = Standard Units for pH, typically reported from field data, some are laboratory analysis
- * = Sample date reported as 1992 in tables by LFR (Date corrected to 1991 by Clayton)
- (1) = Labeling error in the field or laboratory may account for anomalous data reported for wells MW-2 and MW-3 (LFR)

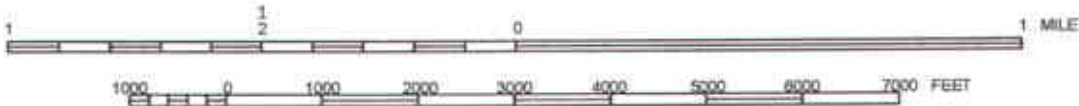
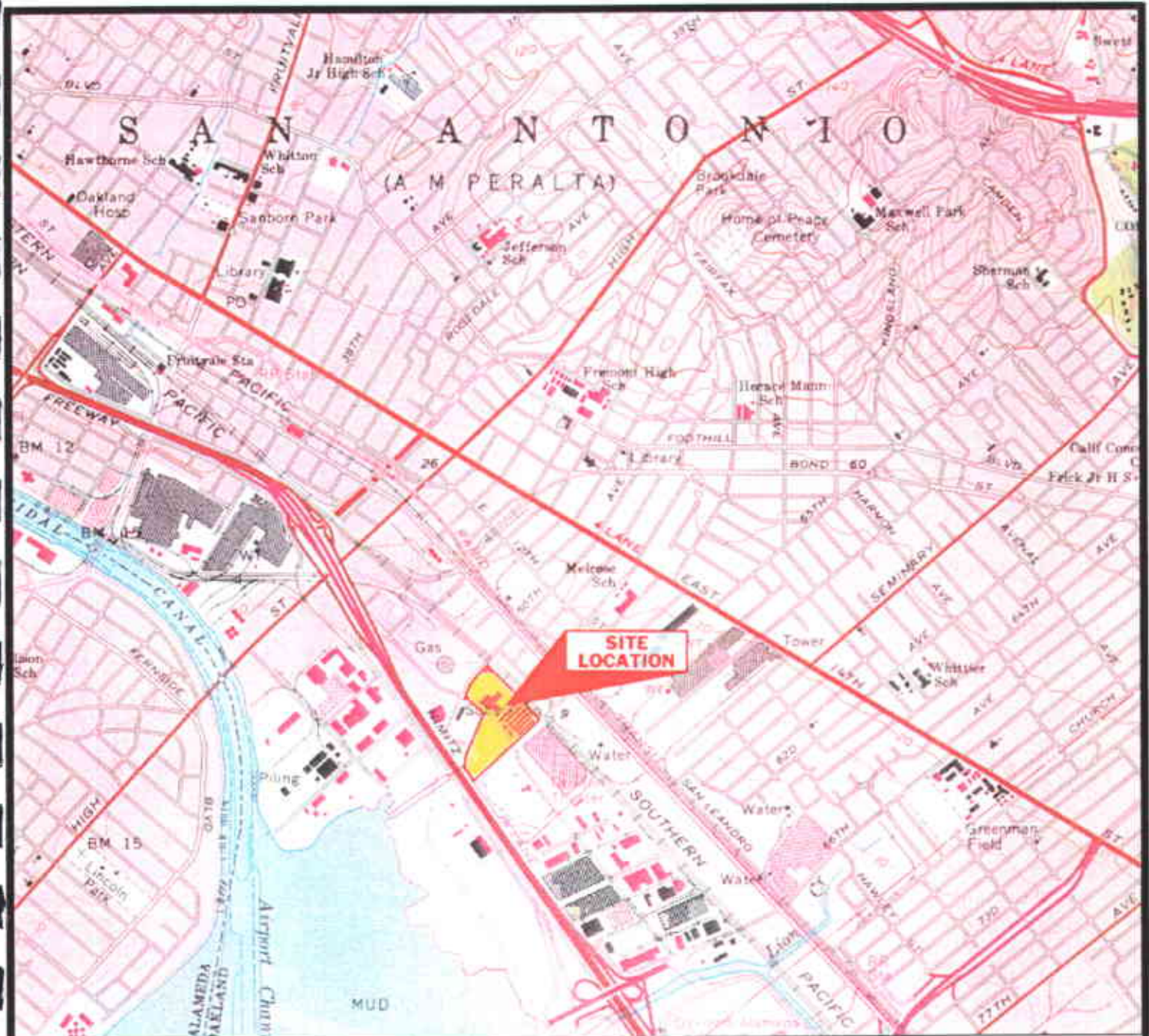

Portion of 7.5-Minute Oakland East, California
 Quadrangle Map
 United States Department of the Interior
 Geological Survey
 1959 Photorevised 1980





SITE LOCATION MAP
 Coliseum Way Properties
 Oakland, California
 Clayton Project No. 70-00509.00.300

Figure
1

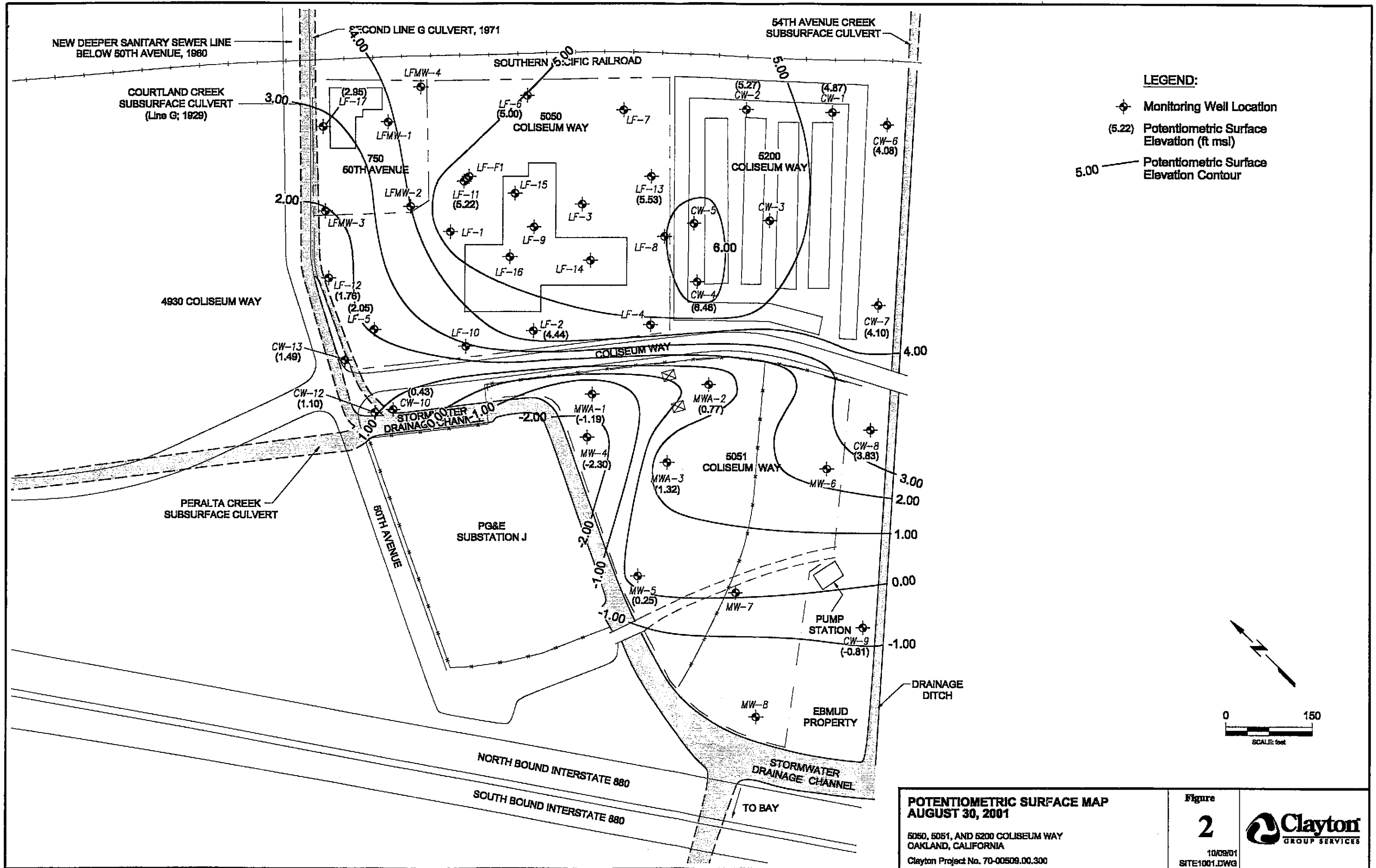



LEGEND:

-  Monitoring Well Location
-  (5.22) Potentiometric Surface Elevation (ft msl)
-  5.00 Potentiometric Surface Elevation Contour

**POTENTIOMETRIC SURFACE MAP
AUGUST 30, 2001**

5050, 5051, AND 5200 COLISEUM WAY
OAKLAND, CALIFORNIA
Clayton Project No. 70-00509.00.300

Figure
2
10/09/01
SITE1001.DWG



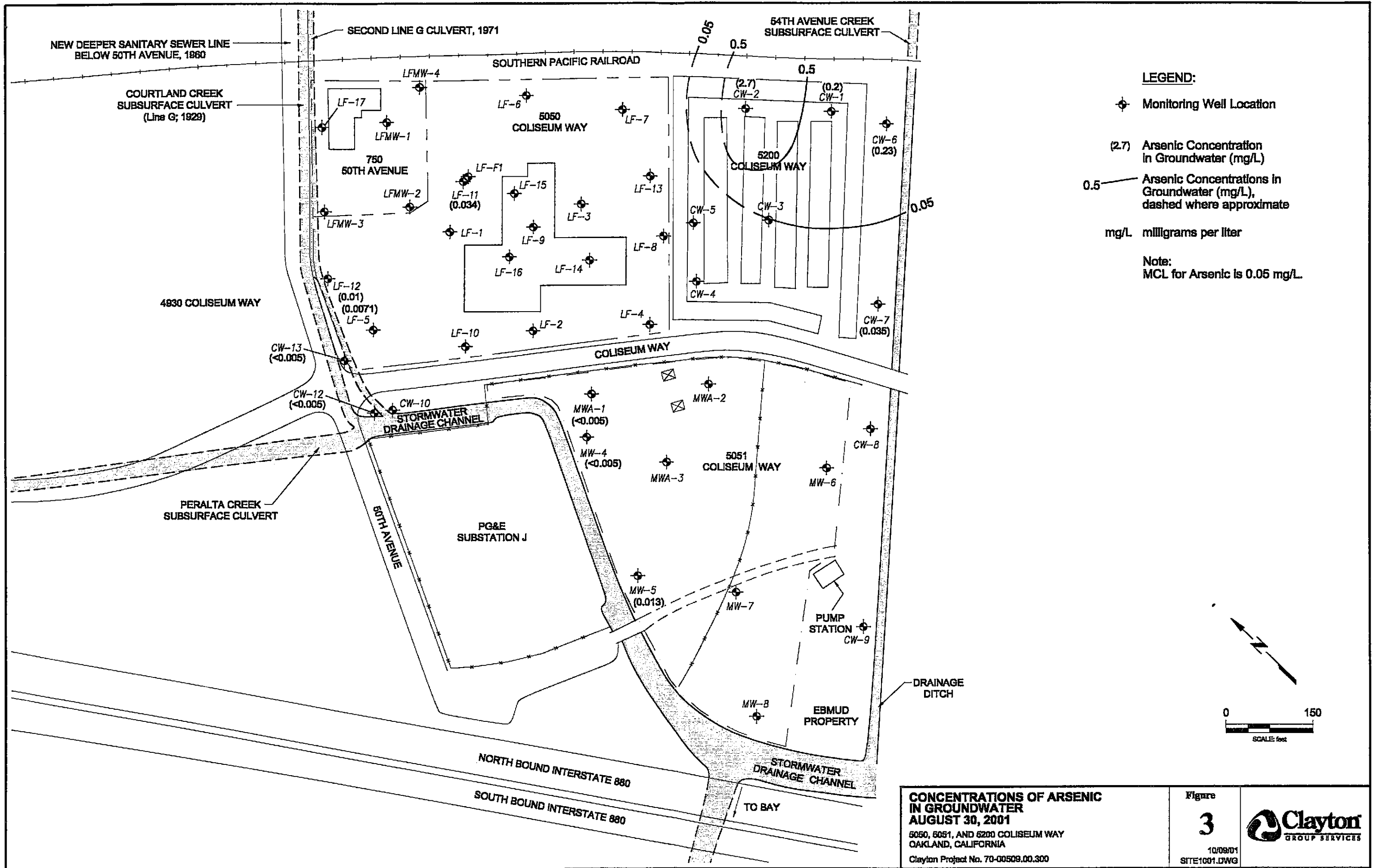

**CONCENTRATIONS OF ARSENIC
IN GROUNDWATER
AUGUST 30, 2001**
5050, 5051, AND 5200 COLISEUM WAY
OAKLAND, CALIFORNIA
Clayton Project No. 70-00509.00.300

Figure
3
10/08/01
SITE1001.DWG



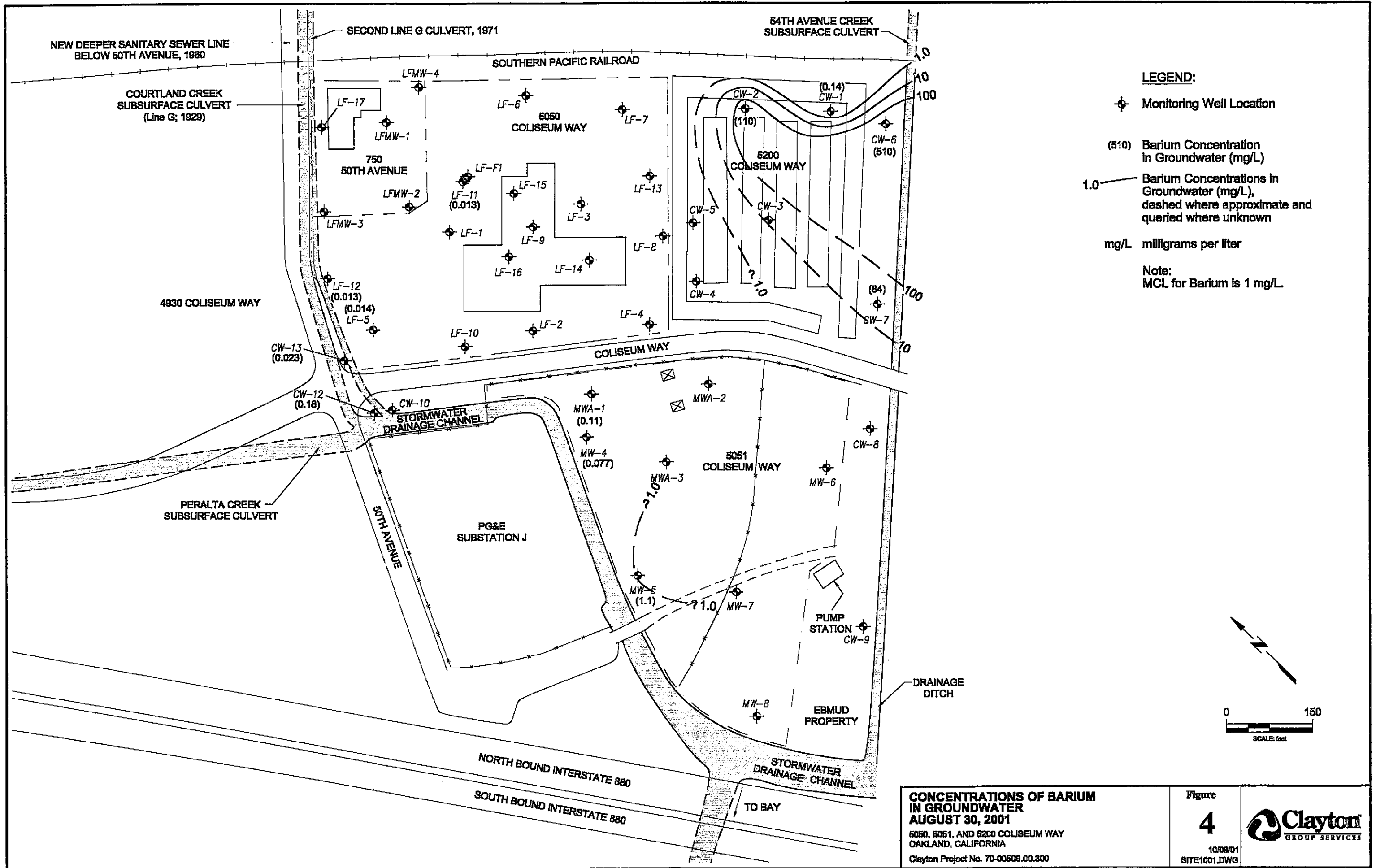

CONCENTRATIONS OF BARIUM IN GROUNDWATER AUGUST 30, 2001
 5050, 5051, AND 5200 COLISEUM WAY
 OAKLAND, CALIFORNIA
 Clayton Project No. 70-00509.00.300

Figure
4
 10/08/01
 SITE1001.DWG



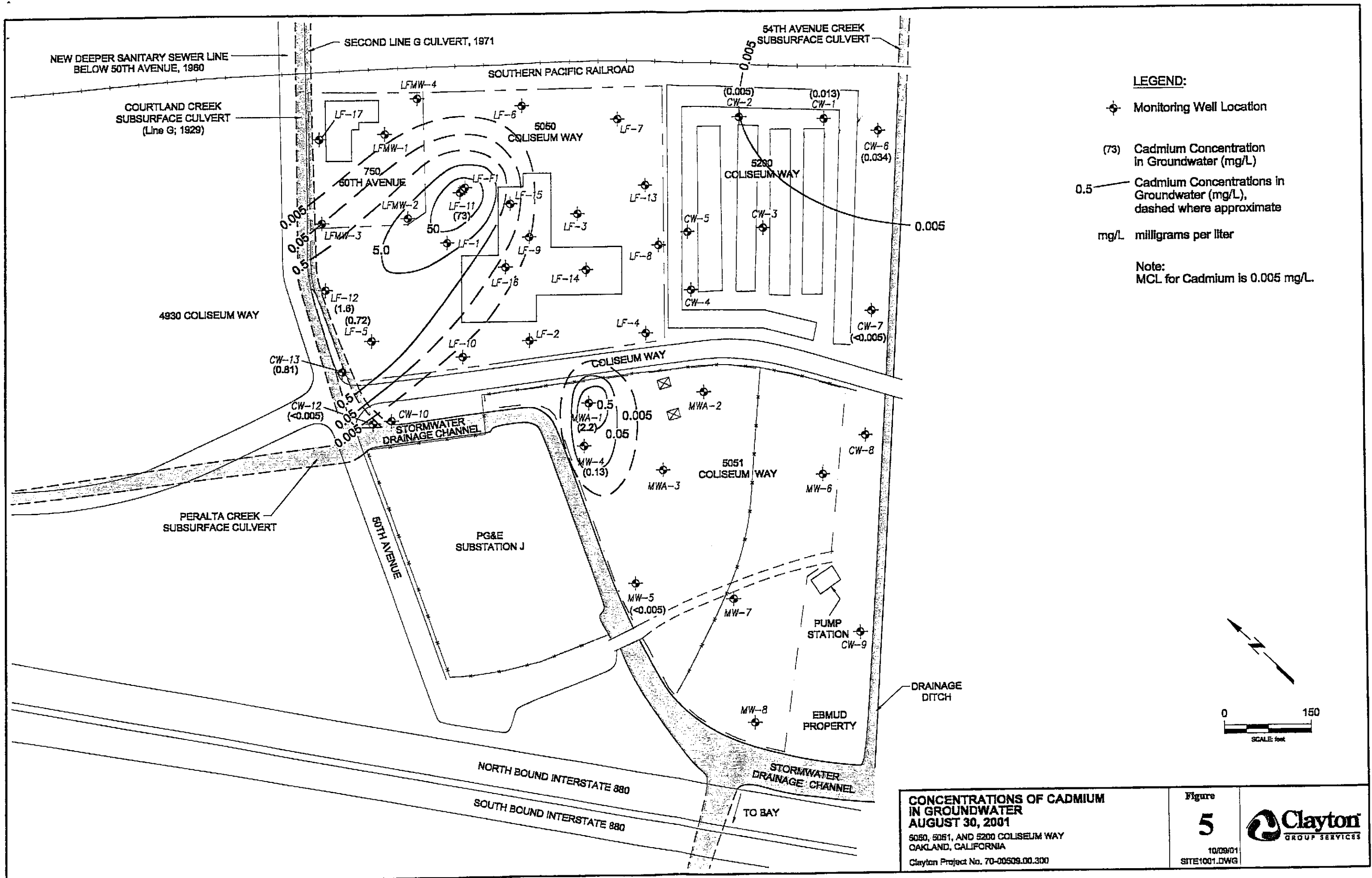

CONCENTRATIONS OF CADMIUM IN GROUNDWATER AUGUST 30, 2001
 5050, 5051, AND 5200 COLISEUM WAY
 OAKLAND, CALIFORNIA
 Clayton Project No. 70-00509.00.300

Figure
5
 10/09/01
 SITE1001.DWG

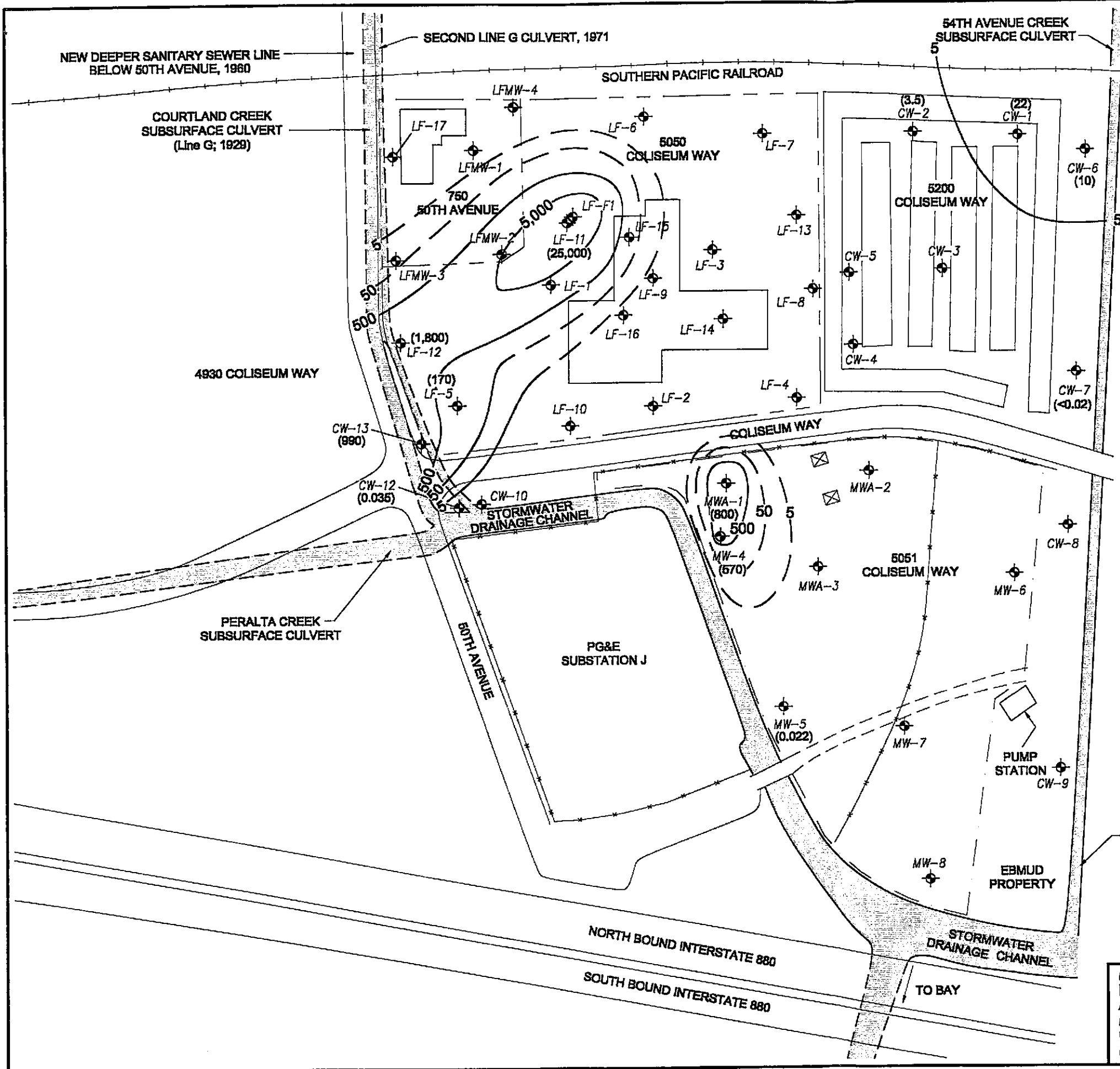

LEGEND:

- ⊕ Monitoring Well Location
- (170) Zinc Concentration in Groundwater (mg/L)
- 5 — Zinc Concentrations in Groundwater (mg/L), dashed where approximate
- mg/L milligrams per liter
- Note: MCL for Zinc is 5 mg/L.

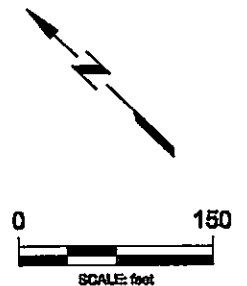

CONCENTRATIONS OF ZINC IN GROUNDWATER AUGUST 30, 2001
 5050, 5051, AND 5200 COLISEUM WAY
 OAKLAND, CALIFORNIA
 Clayton Project No. 70-00509.00.300

Figure
6
 10/09/01
 SITE1001.DWG

