



COUNTY OF ALAMEDA
Assessor's Office

[Help](#)

[New Query](#)

Property Value System

[History](#)

[Value](#)

[Transfer](#)

[Map](#)

[Glossary](#)

Parcel Number: **8-647-28-4** Inactive: **N** Lien Date: **01/01/2015** Owner: **KENNEDY THOMAS E & KENNEDY CRAIG S TR**

Property Address: **585 22ND ST, OAKLAND, CA 94612**

Mailing Name		Historical Mailing Address	Document Date	Document Number	Value From Trans Tax	Parcel Count	Use
KENNEDY THOMAS E & KENNEDY CRAIG S TR	List Owners	753 PALOMINO CT , WALNUT CREEK, CA 94596-6616	10/28/2004	2004-484324		1	8300
KENNEDY THOMAS E & CRAIG S c/o CRAIG KENNEDY	List Owners	753 PALOMINO CT , WALNUT CREEK, CA 94596-6616	01/24/2000	2000-19685		1	8300
KENNEDY MARION H TR c/o CRAIG KENNEDY	List Owners	753 PALOMINO CT , WALNUT CREEK, CA 94596-6616	10/31/1998	TRAN-5758		1	8300
KENNEDY MARION H TR c/o CRAIG KENNEDY	List Owners	753 PALOMINO CT , WALNUT CREEK, CA 94596-6616	09/15/1980	1980-159184		1	8300
KENNEDY MARION H TR	List Owners	585 22ND ST , OAKLAND, CA 94612-1613	09/15/1980	1980-159183		1	8300
KENNEDY MARION H & EARL B ESTATE OF	List Owners	585 22ND ST , OAKLAND, CA 94612-1613	09/12/1979	1979-181934		1	8300
KENNEDY EARL B INC	List Owners	585 22ND ST , OAKLAND, CA 94612-1613	01/12/1967	AZ-3558		1	8300

All information on this site is to be assumed accurate for property assessment purposes only, and is based upon the Assessor's knowledge of each property. Caution is advised for use other than its intended purpose.

The Alameda County Intranet site is best viewed in Internet Explorer Version 5.5 or later.
Click [here](#) for more information regarding supported browsers.

ASSESSOR'S MAP 8

Code Area Nos. 17-001 17-022

647
2003-4
1

Corrected Map of the Jones Tract. (Bk. 4 Pg. 4)

Scale 1 in = 40 ft

648

Page 1

P.M. 8131 274/56-57

Rev. B-63 R.G.
3-19-79 M.G.
6-17-81
8-18-04 LL

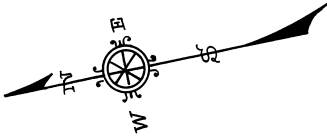

659

645

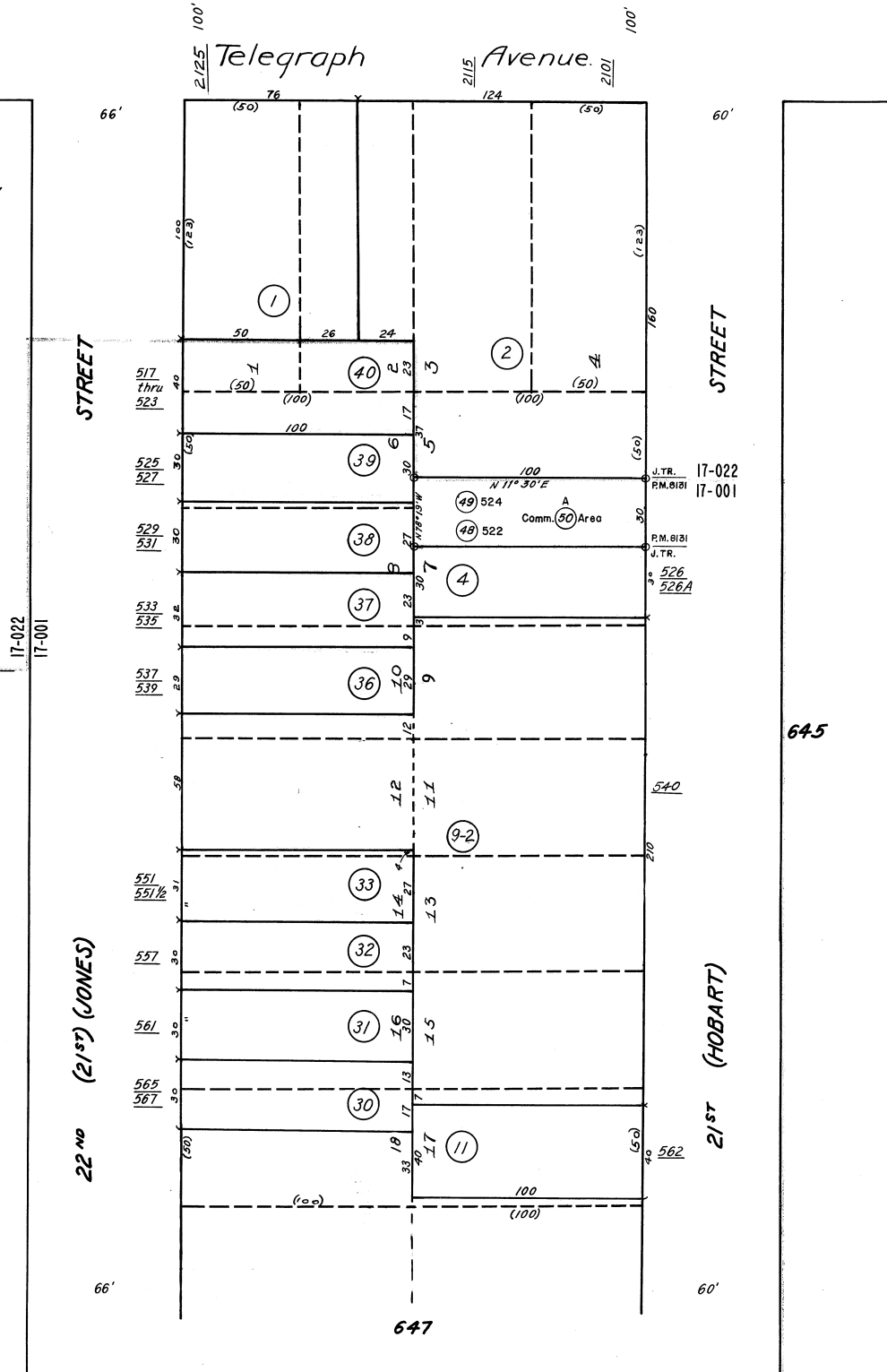

647