

Wickham, Jerry, Env. Health

From: Jonathan Sanders <jsanders@aeiconsultants.com>
Sent: Sunday, December 06, 2015 10:04 PM
To: Wickham, Jerry, Env. Health
Cc: Trent Weise; Jeremy Smith
Subject: Soil Vapor Investigation for 2744 East Eleventh Street
Attachments: Fig 5, Proposed Soil Vapor Sample Locations.pdf

Jerry,

I wanted to take the time to inform you of the planned soil vapor investigation at the above mentioned Lucasey Manufacturing facility (Voluntary Remedial Action Case No. RO0003183). This work is being conducted as a follow up to soil vapor investigation completed on November 6th which identified tetrachloroethylene (PCE) on-site as a chemical of concern warranting additional investigation. The additional soil vapor investigation is currently scheduled to take place on December 16th and 17th and will include the collection of soil vapor samples at seventeen (17) locations within the footprint of the on-site manufacturing building as depicted in the attached figure. These additional soil vapor samples will be collected from temporary soil vapor probes installed at depth of five feet below ground surface and will be analyzed for PCE *via* USEPA Testing Method TO-15. A work plan for the December 16th and 17th investigation and the Report of Findings from the November 6th investigation will be forthcoming in the near future. If you have any questions please do not hesitate to contact myself or Jeremy Smith (cc'd on this email).

Thank you.

Jonathan Sanders
Project Engineer
AEI Consultants
2500 Camino Diablo
Walnut Creek, CA 94597
T: (925) 746-6009
C: (281) 250-5856

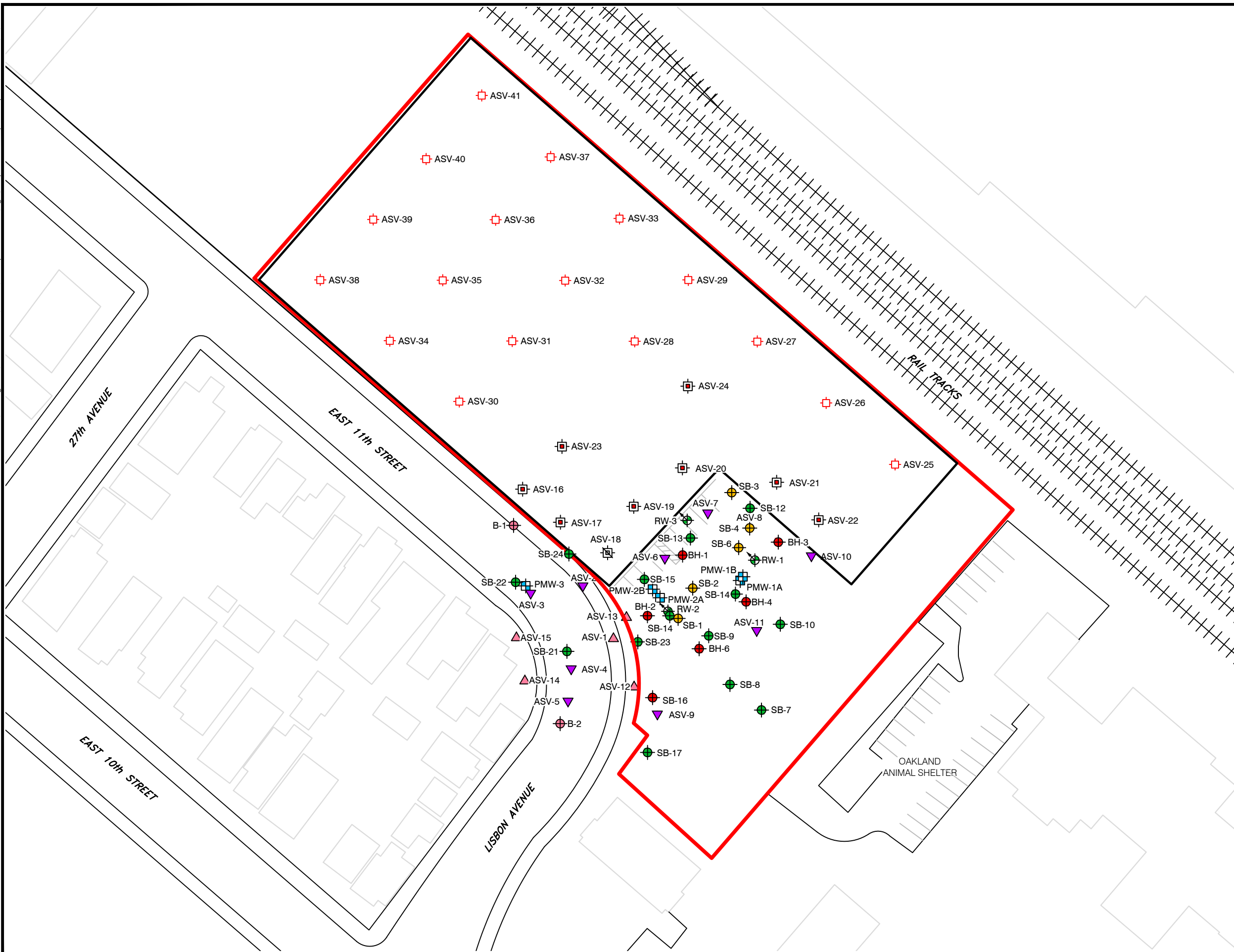

LEGEND

- Proposed Soil Vapor Sample Location
- ASV-24 Soil Vapor Sample Location (AEI 11/2015)
- ASV-18 Not Completed Soil Vapor Sample Location (AEI 11/2015)
- RW-3 Product Recovery Well (Clearwater)
- PMW-3 Product Monitoring Well (ERM)
- SB-24 Soil Boring (Clearwater)
- SB-6 Soil Boring (Terra Firma)
- SB-14 Soil Boring (AEI)
- B-2 Soil Boring (ERM 2010)
- ASV-11 Soil Vapor Sample Location (ERM, 2009)
- ASV-15 Soil Vapor Sample Location (ERM, 2010)

NOTE:
 Base Map Sources:
 ERM, Exhibit 1, 03/2011
 Google Earth, Image Date 5/11/2015

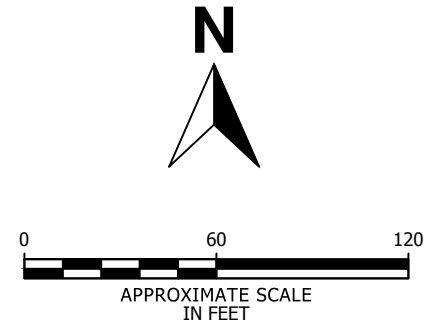

AEI Consultants
 San Jose, California

**PROPOSED SOIL VAPOR
 SAMPLE LOCATIONS**

2744 East 11th Street
 Oakland, California

FIGURE 5
 Project No. 345989