

September 4, 2015

Mark Detterman
Senior Hazardous Materials Specialist, PG, CEG
Alameda County Environmental Health
1131 Harbor Bay Parkway
Alameda, CA 94502

RE: 1315 Court Street, Alameda CA

Dear Mr. Detterman:

"I do hereby declare under penalty of perjury under the laws of the State of California, that I am authorized to attest to the veracity of the information contained in the report described herein, and to the best of my knowledge the information, conclusions and recommendations presented in this attached report are true and correct. If you have any questions or comments regarding this report, please do not hesitate to contact Dwight Hoenig of Turner/Maclane Inc. at 510-881-8811.

Sincerely,



Paul D. Meuser

Dwight Hoenig, President

September 3, 2015

Mark Detterman
Alameda County Department of Environmental Health
1131 Harbor Bay Parkway,
Alameda Ca. 94502

Subject: Mercury Investigation; 1315 Court St. Alameda California

Dear Mr. Detterman:

This letter report provides the results of the mercury soil sampling and soil vapor investigation conducted at the residential property of Mr. Paul Meuser located at 1315 Court Street in Alameda.

1.0 Background:

On January 21, 2014, Mr. Meuser contacted the California Emergency Management Agency and the National Response Center to report a finding of elemental mercury, in soil, at the rear of his home at the Subject address. The Alameda County Department of Environmental Health (ACDEH) was contacted and, in turn, contacted the Department of Toxic Substances Control (DTSC). Ultimately, on January 29, 2014, the DTSC emergency response contractor, Parc Specialty, arrived on-site to conduct an initial evaluation and limited cleanup of an elemental Mercury release. (The residence and spill release area are shown on Figure 1.)

According to information provided by the ACDEH, Parc Specialty evaluated the spill site using a hand held Mercury Vapor Analyzer and completed a removal action consisting of the manual excavation and off-site disposal of approximately two, 55 gallon drums of soil and debris. However, based on residual Mercury vapor detections and visual observations, some amount of elemental mercury remains on site.

As a result, the ACDEH requested that Mr. Meuser undertake a further investigation and initiate potential soil remediation as described in California Health and Safety Code §101480. A workplan to complete a combination Soil Vapor Survey with confirmatory Soil Sampling was drafted by Turner/Maclane Environmental Consulting and submitted to ACDEH on May 6, 2015. The workplan was approved for implementation by the ACDEH on May 11, 2015.

2.0 Applicable Cleanup Criteria:

Historically, environmental screening levels (ESLs) for Mercury were established by the California Office of Environmental Health Hazard Assessment, also known as OEHHA. More recently, the San

Dwight Hoenig, President

Francisco Regional Water Quality Control Board (RWQCB) has published updated Environmental Screening Levels (ESLs) for mercury which establishes the *contaminant concentration screening levels* for various exposure pathways such as direct contact, ingestion, or inhalation of particulates or vapors. Contaminant concentrations below these screening levels are not considered to represent a significant threat to human health.

As specified in the approval letter from ACDEH, two specific ESL values are considered relevant to a mercury release at a residential property:

- a. **Soil Screening Number;** measured in milligrams of mercury per kilogram of soil or ‘total mercury’. This value is established to assess risks associated with ingestion, inhalation of particulates, and dermal absorption. The current ESL value established for Mercury in residential settings is 6.7 mg/kg. The approved EPA Method for analysis of elemental Mercury in soil is Method 7471A.
- b. **Soil Gas Screening Number;** measured in micrograms/cubic meter of air. This number reflects the concentration of mercury vapor present in pore spaces within the soil matrix *beneath residential structures* which is not considered to present a health threat. The current ESL screening value for residential soil vapor is 16 ug/m³.

The soil vapor readings taken at the time the initial removal action was completed reported soil vapor concentrations exceeded EPA and California State Action Levels.

3.0 Investigation Methodology:

The purpose of the proposed investigation was to define the vertical and lateral extent of elemental mercury contamination which exceeds the health based screening levels. The major elements of the investigation included the following Tasks:

- a. **Establish a grid of temporary vapor monitoring points:**

The primary purpose of conducting the soil vapor assessment was to effectively scan the area to determine the lateral extent of mercury contamination. The survey included installation of a total sixty-nine (69) shallow vapor borings. Sixty-five of the borings were installed on the Meuser property. The other four borings were installed on the neighboring properties, on opposite sides of a concrete block wall and adjacent to the area on the subject property evidencing the highest mercury impacts. As shown on Figure 2, the boring spacing in the immediate vicinity of the spill was no greater than 15 inches on center. The borings throughout the remainder of the yard were located on 2.5 ft. centers. The boring locations were marked with landscaping flags and recorded on field maps.

b. Surface Seals:

Each boring was capped with a retrievable one inch cork, placed at a shallow depth, allowing the air within the bore holes to equilibrate for a period of 24 hours prior to taking vapor readings.

c. Vapor Reading Instrumentation:

Borehole vapor sampling was implemented using a calibrated “Jerome J 505 Mercury Vapor Analyzer” provided by the manufacturer (Arizona Instruments).

Following a 24 hour equilibration period, each borehole was opened and scanned with the vapor analyzer. The readings were individually recorded at each location. The borings were backfilled with native soil following vapor analysis.

d. Confirmation Soil Sampling:

To calibrate the readings provided by the Mercury Vapor analysis, and to further define the concentration and extent of Mercury impacts a series of eleven depth discrete soil samples was collected for analysis by a California certified laboratory.

4.0 Results**a. Soil Vapor Analysis**

The soil vapor screening was conducted in accordance with the work plan on June 2nd and 3rd, 2015. The recorded instrument readings ranged from a low of 0.10 ug/m³ to a maximum instrument reading of 500+ ug/m³, with the highest readings obtained in the immediate vicinity of the mercury soil excavation at the north corner of the 1315 Court Street property.

During the vapor screening an additional reading of 500+ ug/m³ was reported in a nearby boring (i-11) approximately 2 ft. south of the soil excavation sample. Soil sampling at this location did not confirm the presence of high concentrations of mercury. It is possible that the anomalous readings were caused by an accumulation of dust and sediment on the instrument intake filter. The filter was subsequently cleaned and the instrument provided normal responses for the remainder of the sampling session.

b. Soil Sampling

Two rounds of soil samples were collected and analyzed during this investigation. An initial set of 4 screening samples were collected on June 2nd, 2015. The purpose of these samples was:

- To determine the relative range of total mercury concentrations across the entire area of investigation, and,
- To provide an indication of the responsiveness of the Mercury vapor instrument relative to total mercury present in soil.

Soil analytical results are included in Table 1 and are shown graphically on Figure 3.

Table 1: Results of Soil Vapor and Soil Sampling Conducted June 2nd.

Sample ID	Location	Depth	Reported Soil Concentration	Recorded Vapor Concentration
South Corner	A-1	6-12 inches	0.52 mg/kg	3.29 ug/m ³
Center	D-5	6-12 in.	0.39 mg/kg	0.53 ug/m ³
North (6 ft. in from corner)	H-10	6-12 in.	0.35 mg/kg	8.52 ug/m ³
Excavation Bottom	K-13	12-18 in.	33 mg/kg	500+ug/m ³

At the completion of the vapor screening on June 3rd, a second set of soil samples were collected at multiple depths on the subject property and neighboring properties. Additional samples from multiple depths were collected near the location of the initial removal action to further define the depth of soil impacts in that area.

Table 2: SAMPLING Conducted June 3rd.

Sample ID	Location	Depth	Reported Soil Concentration	Recorded Vapor Concentration
2908 18-24	2908 Jackson St	18-24 inches	0.32 mg/kg	0.57 ug/m ³ *
2908 30-36	2908 Jackson St.	30-36 inches	0.0095 mg/kg	
1317 18-24	1317 Court St.	18-24 inches	0.12 mg/kg	1.53 ug/m ³ *
1317 30-36	1317 Court St.	30-36 inches	0.008 mg/kg	
I-12 18-21	1315 Court St.	18-21 inches	0.092 mg/kg	68.74 ug/m ³ *
I-12 24-30	1315 Court	24-30	0.0091 mg/kg	

	Street	inches	
1-12 36-42	1315 Court Street	36-42 inches	Non-Detect

***Single vapor readings were collected at each borehole
(Copies of the Certified Analytical Results are provided in Appendix 1 of this report)**

e. Field Observations and Block Wall Sampling:

Based on initial mercury vapor readings, and laboratory analysis of soil samples, the location of the Mercury release appeared to be a surficial release to soil in the far north corner of the 1315 Court Street property. However, while conducting soil sampling at 1317 Court Street, additional observations of disseminated and pooled mercury were observed near the corner of the common cinder block wall on that property . Similar to the observations made at 1315 Court Street, the mercury observations on this property were present in shallow soils *above the elevation of the concrete footing*, confirming that the release postdated the construction of the wall.

To follow up on this observation, additional Mercury vapor readings were collected from the individual block openings *at the top of the cinder block wall*. The readings from the individual cinder blocks are recorded as the “W-1” through “W-15” and are shown on Figure 3.

5.0 Analysis:

Analysis of the soil vapor data and the soil data suggested that a single mercury release took place near the north corner of the 1315 Court Street property. However the observations of liquid Mercury on the opposite side of the wall suggest that the wall itself could be the source of the release.

The vapor readings collected from the openings at the top of the wall indicate an anomalous value of 12.51 ug/m³ recorded from the block opening at location W-9, with diminishing readings recorded from the block openings to the west of W-9.

Based on all of the data and field observations, it appears that the mechanism of release was an intentional discharge of liquid mercury into top of the cinderblock wall. The observed pattern of mercury, both disseminated and as small ‘blebs’ on both sides of the wall is consistent with this mechanism of release.

6.0 Proposed Remedial Actions:

The need for a limited soil removal action is indicated by both the observation of liquid mercury, and the confirmation soil sample indicating mercury levels above the ESL value. The proposed remedial action would include the following tasks:

Dwight Hoenig, President

- ✚ Retain a qualified, licensed hazardous waste removal contractor.
- ✚ Develop a site specific Health and Safety Plan
- ✚ Site Mobilization
- ✚ Demolition and removal of approximately 15 linear feet of cinder block wall and footings.
Note: Prior to demolition the lowest course of cinder block will be drilled and tapped to allow for drainage and capture of liquid mercury, if present, in the block wall)
- ✚ Concrete blocks and debris to be placed in a covered DOT approved hazardous waste bin awaiting profiling and transport to a properly permitted offsite disposal facility.
- ✚ Manual excavation of soil impacted with visible concentrations of liquid mercury. Excavated soil would be placed in closed steel drums awaiting profiling and offsite disposal at an approved hazardous waste disposal facility.
- ✚ Excavation of additional soil above ESL values to be placed in a roll off bin awaiting analysis and offsite disposal.
- ✚ Screening of the excavation will be facilitated with the use of a calibrated mercury vapor meter which will guide the need for further excavation.
- ✚ Additional excavation and soil sampling will be undertaken until the invert soils are demonstrated to be below the prescribed residential ESL value of 6.7 mg/kg.
- ✚ Backfilling with clean soil and reconstruction of fencing.

Upon completion of these tasks Turner/Maclane will prepare a Removal Action Completion Report documenting the removal activities and including copies of all waste manifests.

We look forward to discussing this report with you at your earliest convenience.

Sincerely,



Dwight Hoenig
President, Turner/Maclane, Inc.



Mark Knox P.E.
(C 33194, Exp. 6/30/2016)



Figures

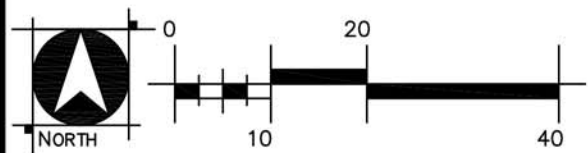
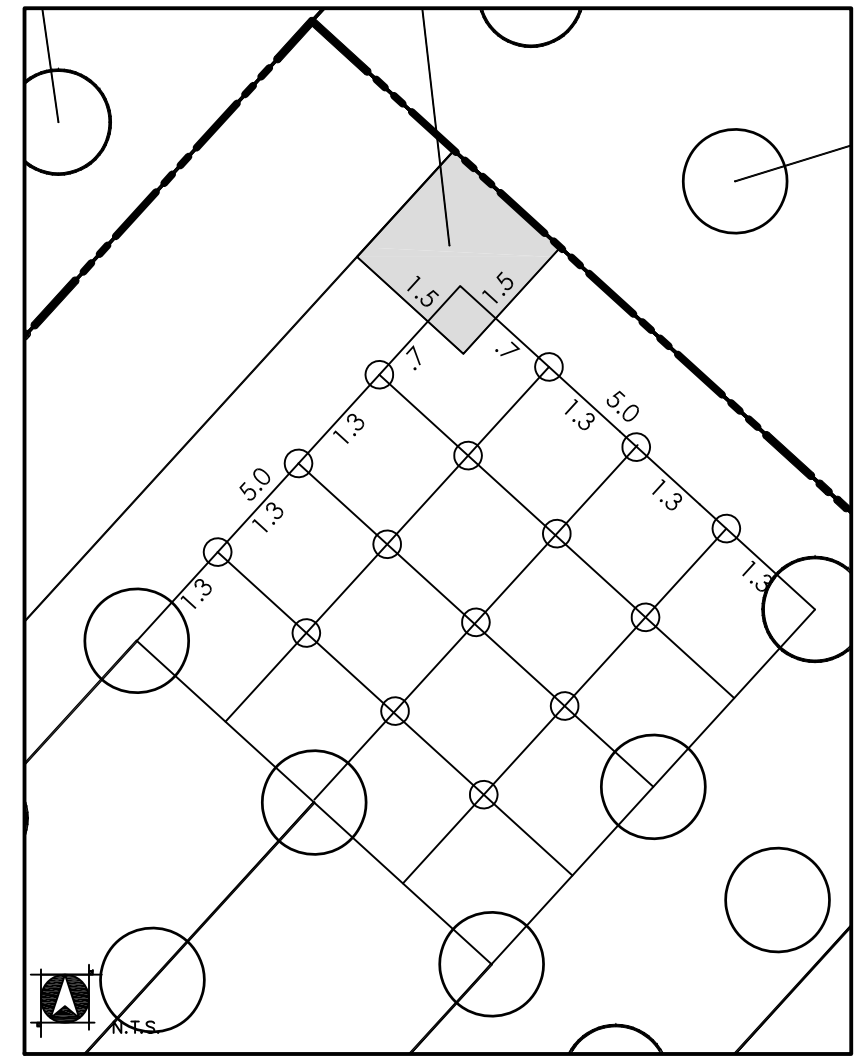
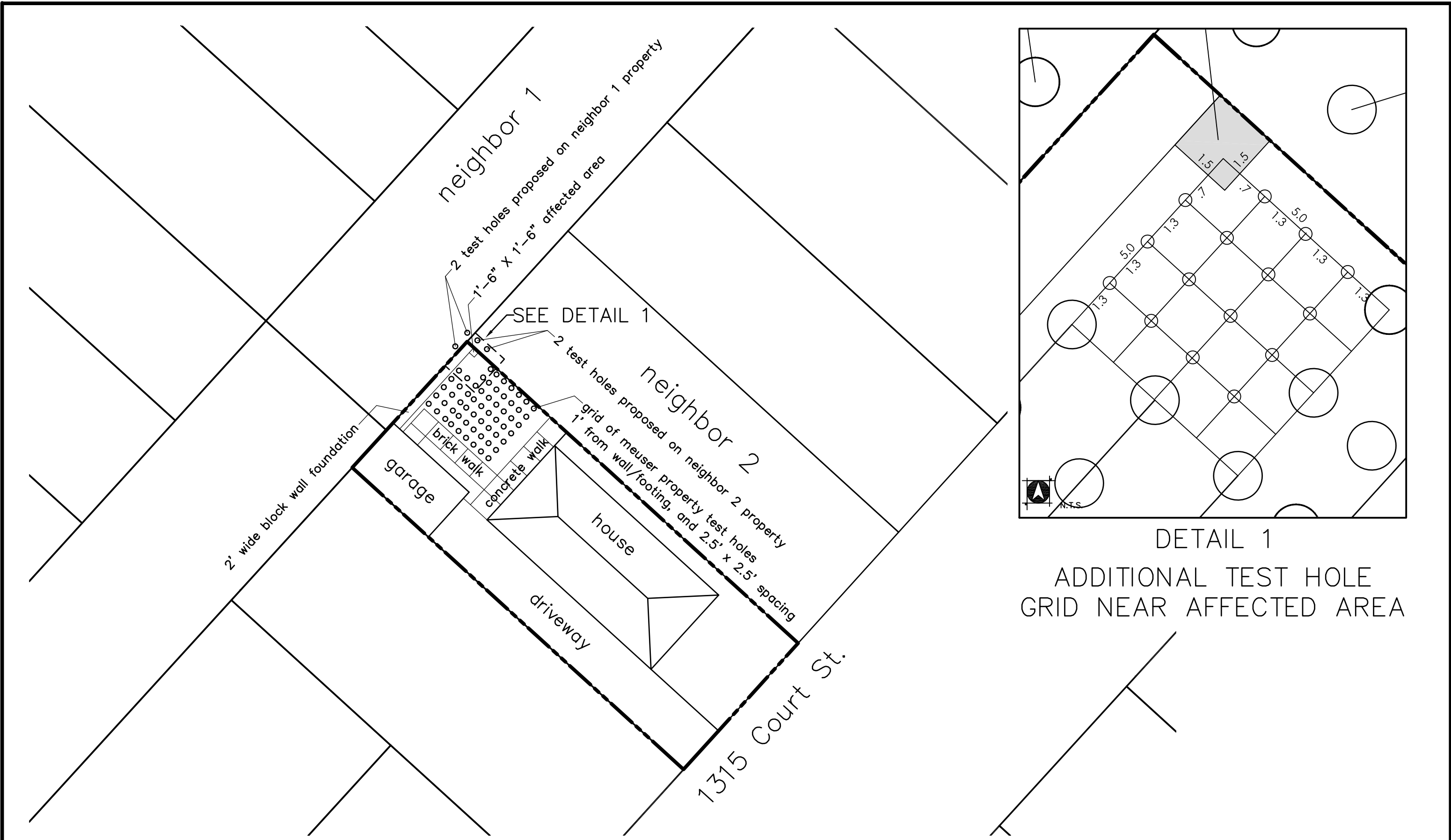

FIGURE #1
SITE LOCATION; 1315 COURT STREET



DETAIL 1
 ADDITIONAL TEST HOLE
 GRID NEAR AFFECTED AREA

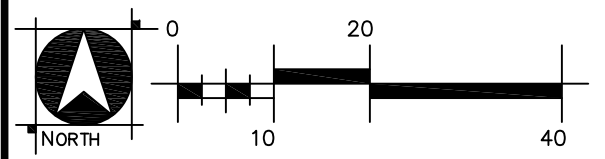

FIGURE #2
 MERCURY VAPOR SAMPLING LOCATIONS

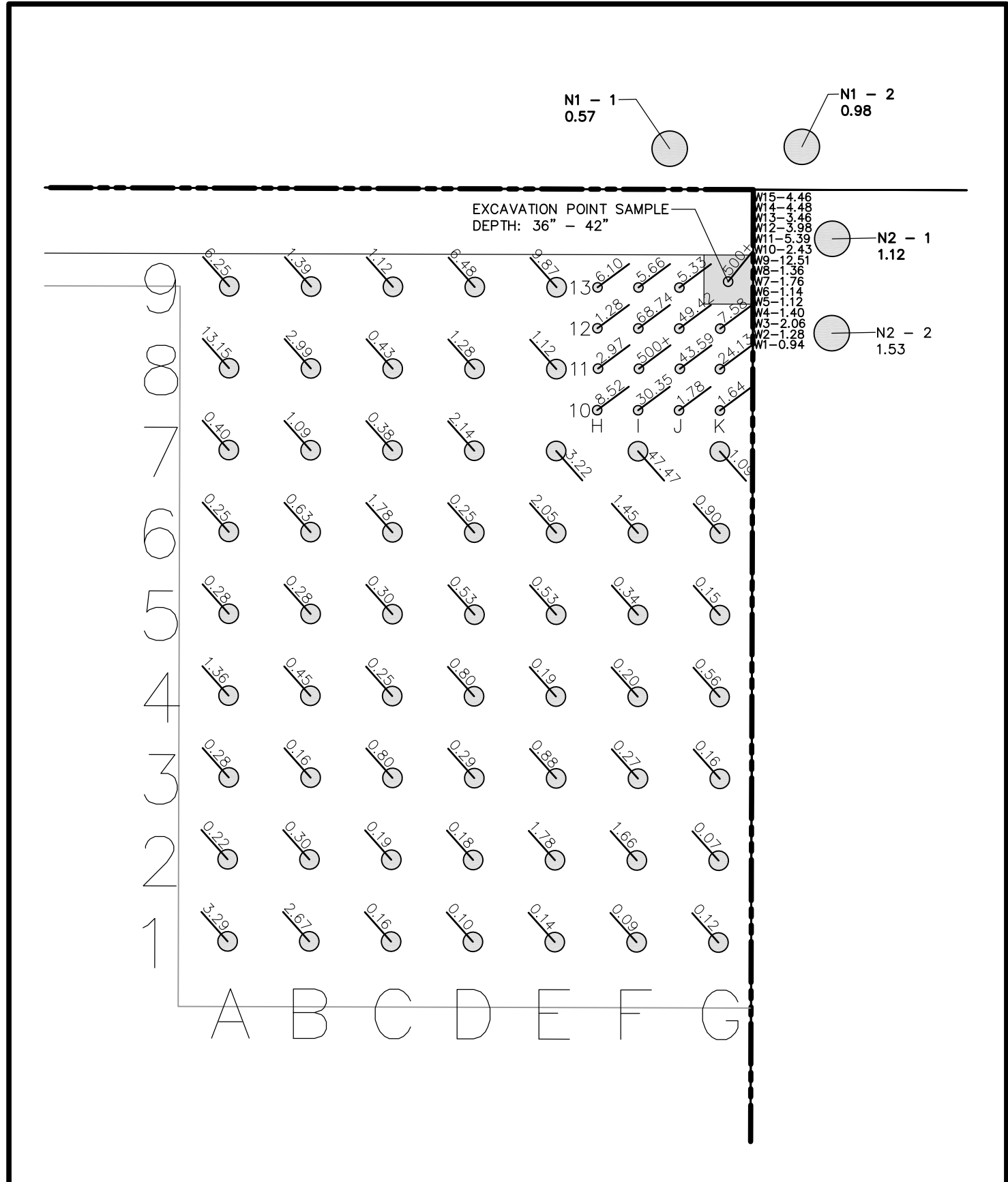
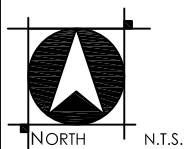
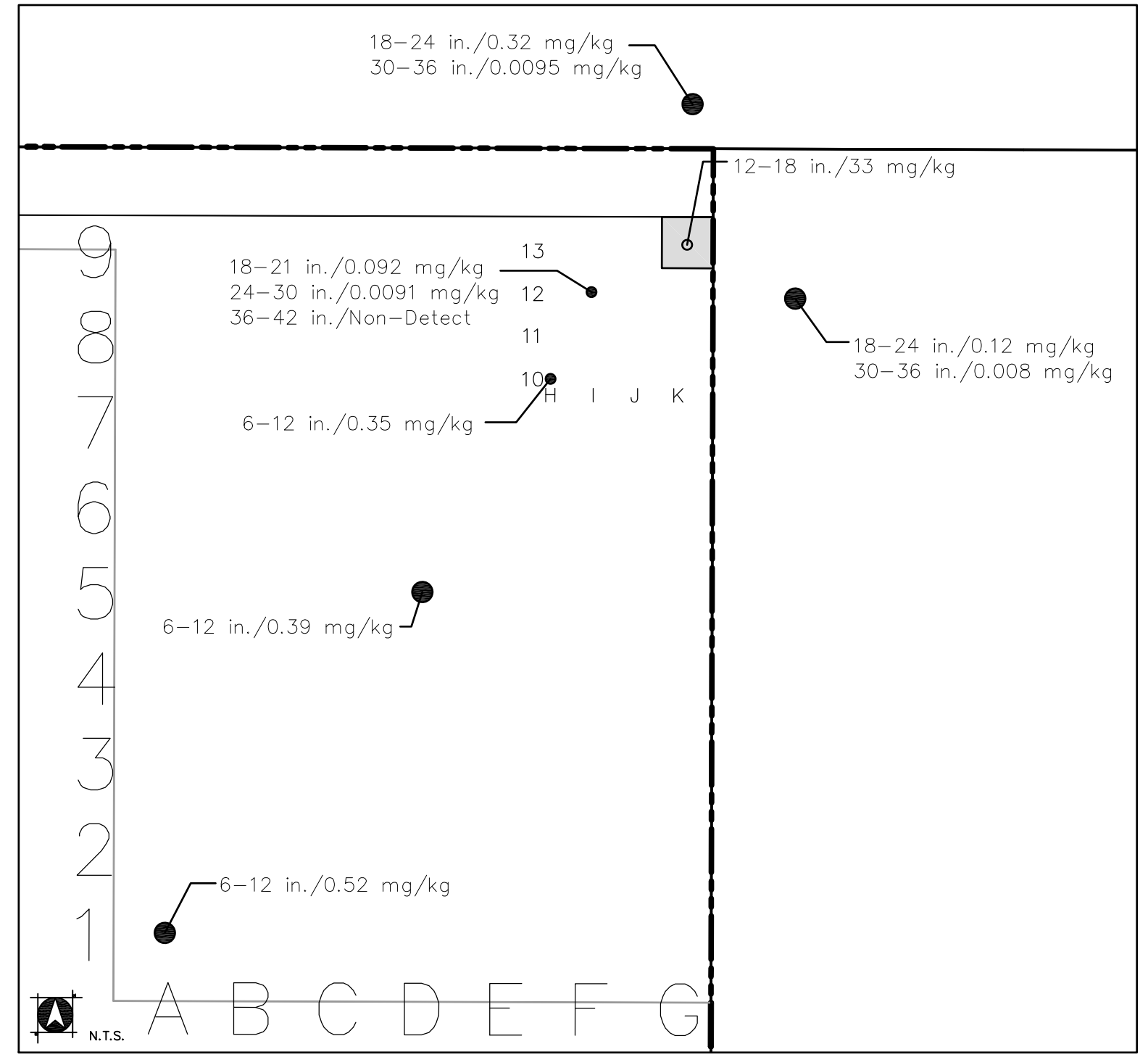
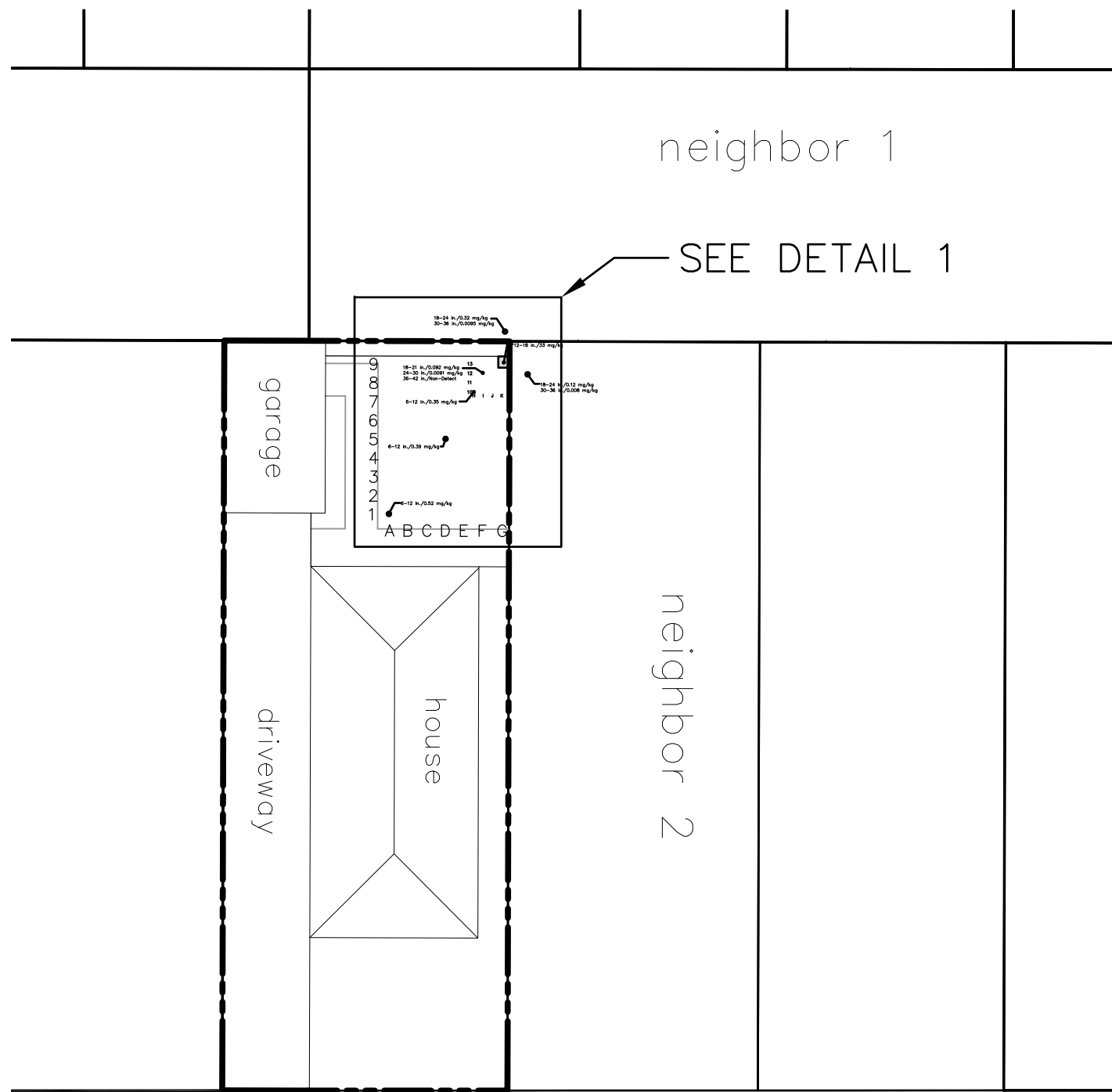

FIGURE #3

FIELD MERCURY VAPOR READINGS





DETAIL 1

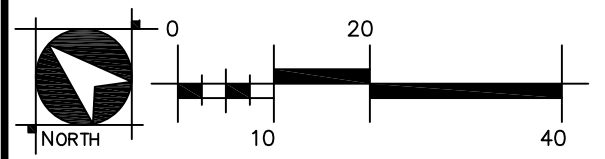

FIGURE #4
SOIL SAMPLING
JUNE 2 & 3, 2015
(PLEASE SEE TABLE 1 AND TABLE 2)

Appendix #1
Certified Analytical Results

TestAmerica

THE LEADER IN ENVIRONMENTAL TESTING

ANALYTICAL REPORT

TestAmerica Laboratories, Inc.
TestAmerica Pleasanton
1220 Quarry Lane
Pleasanton, CA 94566
Tel: (925)484-1919

TestAmerica Job ID: 720-65158-1
Client Project/Site: Meuser- Court St.

For:
Turner Maclane Inc.
63 Via Pico Plaza
#227
San Clemente, California 92672

Attn: Dwight Hoenig



Authorized for release by:
6/3/2015 11:19:54 AM

Micah Smith, Project Manager II
(925)484-1919
micah.smith@testamericainc.com

LINKS

Review your project
results through
TotalAccess

Have a Question?



Visit us at:
www.testamericainc.com

This report has been electronically signed and authorized by the signatory. Electronic signature is intended to be the legally binding equivalent of a traditionally handwritten signature.

Results relate only to the items tested and the sample(s) as received by the laboratory.

- 1
- 2
- 3
- 4
- 5
- 6
- 7
- 8
- 9
- 10
- 11
- 12
- 13
- 14



Table of Contents

Cover Page	1
Table of Contents	2
Definitions/Glossary	3
Case Narrative	4
Detection Summary	5
Client Sample Results	6
QC Sample Results	7
QC Association Summary	8
Lab Chronicle	9
Certification Summary	10
Method Summary	11
Sample Summary	12
Chain of Custody	13
Receipt Checklists	14

Definitions/Glossary

Client: Turner Maclane Inc.
Project/Site: Meuser- Court St.

TestAmerica Job ID: 720-65158-1

Glossary

Abbreviation	These commonly used abbreviations may or may not be present in this report.
α	Listed under the "D" column to designate that the result is reported on a dry weight basis
%R	Percent Recovery
CFL	Contains Free Liquid
CNF	Contains no Free Liquid
DER	Duplicate error ratio (normalized absolute difference)
Dil Fac	Dilution Factor
DL, RA, RE, IN	Indicates a Dilution, Re-analysis, Re-extraction, or additional Initial metals/anion analysis of the sample
DLC	Decision level concentration
MDA	Minimum detectable activity
EDL	Estimated Detection Limit
MDC	Minimum detectable concentration
MDL	Method Detection Limit
ML	Minimum Level (Dioxin)
NC	Not Calculated
ND	Not detected at the reporting limit (or MDL or EDL if shown)
PQL	Practical Quantitation Limit
QC	Quality Control
RER	Relative error ratio
RL	Reporting Limit or Requested Limit (Radiochemistry)
RPD	Relative Percent Difference, a measure of the relative difference between two points
TEF	Toxicity Equivalent Factor (Dioxin)
TEQ	Toxicity Equivalent Quotient (Dioxin)

Case Narrative

Client: Turner Maclane Inc.
Project/Site: Meuser- Court St.

TestAmerica Job ID: 720-65158-1

Job ID: 720-65158-1

Laboratory: TestAmerica Pleasanton

Narrative

Job Narrative
720-65158-1

Comments

No additional comments.

Receipt

The samples were received on 6/2/2015 12:30 PM; the samples arrived in good condition, properly preserved and, where required, on ice. The temperature of the cooler at receipt was 4.6° C.

Metals

No analytical or quality issues were noted, other than those described in the Definitions/Glossary page.

- 1
- 2
- 3
- 4
- 5
- 6
- 7
- 8
- 9
- 10
- 11
- 12
- 13
- 14

Detection Summary

Client: Turner Maclane Inc.
Project/Site: Meuser- Court St.

TestAmerica Job ID: 720-65158-1

Client Sample ID: EXCAVATION BOTTOM

Lab Sample ID: 720-65158-1

Analyte	Result	Qualifier	RL	MDL	Unit	Dil Fac	D	Method	Prep Type
Mercury	33		0.85		mg/Kg	100		7471A	Total/NA

Client Sample ID: NORTH 6 FT OFF

Lab Sample ID: 720-65158-2

Analyte	Result	Qualifier	RL	MDL	Unit	Dil Fac	D	Method	Prep Type
Mercury	0.35		0.0097		mg/Kg	1		7471A	Total/NA

Client Sample ID: CENTER

Lab Sample ID: 720-65158-3

Analyte	Result	Qualifier	RL	MDL	Unit	Dil Fac	D	Method	Prep Type
Mercury	0.39		0.0097		mg/Kg	1		7471A	Total/NA

Client Sample ID: SOUTH CORNER

Lab Sample ID: 720-65158-4

Analyte	Result	Qualifier	RL	MDL	Unit	Dil Fac	D	Method	Prep Type
Mercury	0.52		0.0088		mg/Kg	1		7471A	Total/NA

This Detection Summary does not include radiochemical test results.

TestAmerica Pleasanton

Client Sample Results

Client: Turner Maclane Inc.
Project/Site: Meuser- Court St.

TestAmerica Job ID: 720-65158-1

Method: 7471A - Mercury (CVAA)

Client Sample ID: EXCAVATION BOTTOM

Date Collected: 06/02/15 10:50

Date Received: 06/02/15 12:30

Lab Sample ID: 720-65158-1

Matrix: Solid

Analyte	Result	Qualifier	RL	MDL	Unit	D	Prepared	Analyzed	Dil Fac
Mercury	33		0.85		mg/Kg		06/02/15 12:41	06/02/15 20:22	100

Client Sample ID: NORTH 6 FT OFF

Date Collected: 06/02/15 10:40

Date Received: 06/02/15 12:30

Lab Sample ID: 720-65158-2

Matrix: Solid

Analyte	Result	Qualifier	RL	MDL	Unit	D	Prepared	Analyzed	Dil Fac
Mercury	0.35		0.0097		mg/Kg		06/02/15 12:41	06/02/15 20:24	1

Client Sample ID: CENTER

Date Collected: 06/02/15 10:30

Date Received: 06/02/15 12:30

Lab Sample ID: 720-65158-3

Matrix: Solid

Analyte	Result	Qualifier	RL	MDL	Unit	D	Prepared	Analyzed	Dil Fac
Mercury	0.39		0.0097		mg/Kg		06/02/15 12:41	06/02/15 19:55	1

Client Sample ID: SOUTH CORNER

Date Collected: 06/02/15 10:25

Date Received: 06/02/15 12:30

Lab Sample ID: 720-65158-4

Matrix: Solid

Analyte	Result	Qualifier	RL	MDL	Unit	D	Prepared	Analyzed	Dil Fac
Mercury	0.52		0.0088		mg/Kg		06/02/15 12:41	06/02/15 19:57	1

QC Sample Results

Client: Turner Maclane Inc.
Project/Site: Meuser- Court St.

TestAmerica Job ID: 720-65158-1

Method: 7471A - Mercury (CVAA)

Lab Sample ID: MB 720-182844/1-A
Matrix: Solid
Analysis Batch: 182884

Client Sample ID: Method Blank
Prep Type: Total/NA
Prep Batch: 182844

Analyte	MB Result	MB Qualifier	RL	MDL	Unit	D	Prepared	Analyzed	Dil Fac
Mercury	ND		0.010		mg/Kg		06/02/15 12:41	06/02/15 18:52	1

Lab Sample ID: LCS 720-182844/2-A
Matrix: Solid
Analysis Batch: 182884

Client Sample ID: Lab Control Sample
Prep Type: Total/NA
Prep Batch: 182844

Analyte	Spike Added	LCS Result	LCS Qualifier	Unit	D	%Rec	Limits
Mercury	0.833	0.763		mg/Kg		92	80 - 120

Lab Sample ID: LCSD 720-182844/3-A
Matrix: Solid
Analysis Batch: 182884

Client Sample ID: Lab Control Sample Dup
Prep Type: Total/NA
Prep Batch: 182844

Analyte	Spike Added	LCSD Result	LCSD Qualifier	Unit	D	%Rec	Limits	RPD	Limit
Mercury	0.833	0.762		mg/Kg		91	80 - 120	0	20

QC Association Summary

Client: Turner Maclane Inc.
Project/Site: Meuser- Court St.

TestAmerica Job ID: 720-65158-1

Metals

Prep Batch: 182844

Lab Sample ID	Client Sample ID	Prep Type	Matrix	Method	Prep Batch
720-65158-1	EXCAVATION BOTTOM	Total/NA	Solid	7471A	
720-65158-2	NORTH 6 FT OFF	Total/NA	Solid	7471A	
720-65158-3	CENTER	Total/NA	Solid	7471A	
720-65158-4	SOUTH CORNER	Total/NA	Solid	7471A	
LCS 720-182844/2-A	Lab Control Sample	Total/NA	Solid	7471A	
LCSD 720-182844/3-A	Lab Control Sample Dup	Total/NA	Solid	7471A	
MB 720-182844/1-A	Method Blank	Total/NA	Solid	7471A	

Analysis Batch: 182884

Lab Sample ID	Client Sample ID	Prep Type	Matrix	Method	Prep Batch
720-65158-1	EXCAVATION BOTTOM	Total/NA	Solid	7471A	182844
720-65158-2	NORTH 6 FT OFF	Total/NA	Solid	7471A	182844
720-65158-3	CENTER	Total/NA	Solid	7471A	182844
720-65158-4	SOUTH CORNER	Total/NA	Solid	7471A	182844
LCS 720-182844/2-A	Lab Control Sample	Total/NA	Solid	7471A	182844
LCSD 720-182844/3-A	Lab Control Sample Dup	Total/NA	Solid	7471A	182844
MB 720-182844/1-A	Method Blank	Total/NA	Solid	7471A	182844

Lab Chronicle

Client: Turner Maclane Inc.
Project/Site: Meuser- Court St.

TestAmerica Job ID: 720-65158-1

Client Sample ID: EXCAVATION BOTTOM

Date Collected: 06/02/15 10:50

Date Received: 06/02/15 12:30

Lab Sample ID: 720-65158-1

Matrix: Solid

Prep Type	Batch Type	Batch Method	Run	Dilution Factor	Batch Number	Prepared or Analyzed	Analyst	Lab
Total/NA	Prep	7471A			182844	06/02/15 12:41	SLK	TAL PLS
Total/NA	Analysis	7471A		100	182884	06/02/15 20:22	SLK	TAL PLS

Client Sample ID: NORTH 6 FT OFF

Date Collected: 06/02/15 10:40

Date Received: 06/02/15 12:30

Lab Sample ID: 720-65158-2

Matrix: Solid

Prep Type	Batch Type	Batch Method	Run	Dilution Factor	Batch Number	Prepared or Analyzed	Analyst	Lab
Total/NA	Prep	7471A			182844	06/02/15 12:41	SLK	TAL PLS
Total/NA	Analysis	7471A		1	182884	06/02/15 20:24	SLK	TAL PLS

Client Sample ID: CENTER

Date Collected: 06/02/15 10:30

Date Received: 06/02/15 12:30

Lab Sample ID: 720-65158-3

Matrix: Solid

Prep Type	Batch Type	Batch Method	Run	Dilution Factor	Batch Number	Prepared or Analyzed	Analyst	Lab
Total/NA	Prep	7471A			182844	06/02/15 12:41	SLK	TAL PLS
Total/NA	Analysis	7471A		1	182884	06/02/15 19:55	SLK	TAL PLS

Client Sample ID: SOUTH CORNER

Date Collected: 06/02/15 10:25

Date Received: 06/02/15 12:30

Lab Sample ID: 720-65158-4

Matrix: Solid

Prep Type	Batch Type	Batch Method	Run	Dilution Factor	Batch Number	Prepared or Analyzed	Analyst	Lab
Total/NA	Prep	7471A			182844	06/02/15 12:41	SLK	TAL PLS
Total/NA	Analysis	7471A		1	182884	06/02/15 19:57	SLK	TAL PLS

Laboratory References:

TAL PLS = TestAmerica Pleasanton, 1220 Quarry Lane, Pleasanton, CA 94566, TEL (925)484-1919

Certification Summary

Client: Turner Maclane Inc.
Project/Site: Meuser- Court St.

TestAmerica Job ID: 720-65158-1

Laboratory: TestAmerica Pleasanton

Unless otherwise noted, all analytes for this laboratory were covered under each certification below.

Authority	Program	EPA Region	Certification ID	Expiration Date
California	State Program	9	2496	01-31-16

Analysis Method	Prep Method	Matrix	Analyte
-----------------	-------------	--------	---------

- 1
- 2
- 3
- 4
- 5
- 6
- 7
- 8
- 9
- 10
- 11
- 12
- 13
- 14

Method Summary

Client: Turner Maclane Inc.
Project/Site: Meuser- Court St.

TestAmerica Job ID: 720-65158-1

Method	Method Description	Protocol	Laboratory
7471A	Mercury (CVAA)	SW846	TAL PLS

Protocol References:

SW846 = "Test Methods For Evaluating Solid Waste, Physical/Chemical Methods", Third Edition, November 1986 And Its Updates.

Laboratory References:

TAL PLS = TestAmerica Pleasanton, 1220 Quarry Lane, Pleasanton, CA 94566, TEL (925)484-1919

- 1
- 2
- 3
- 4
- 5
- 6
- 7
- 8
- 9
- 10
- 11
- 12
- 13
- 14

Sample Summary

Client: Turner Maclane Inc.
Project/Site: Meuser- Court St.

TestAmerica Job ID: 720-65158-1

Lab Sample ID	Client Sample ID	Matrix	Collected	Received
720-65158-1	EXCAVATION BOTTOM	Solid	06/02/15 10:50	06/02/15 12:30
720-65158-2	NORTH 6 FT OFF	Solid	06/02/15 10:40	06/02/15 12:30
720-65158-3	CENTER	Solid	06/02/15 10:30	06/02/15 12:30
720-65158-4	SOUTH CORNER	Solid	06/02/15 10:25	06/02/15 12:30

- 1
- 2
- 3
- 4
- 5
- 6
- 7
- 8
- 9
- 10
- 11
- 12
- 13
- 14

TestAmerica

THE LEADER IN ENVIRONMENTAL TESTING

TESTAMERICA Pleasanton Chain of Custody
 1220 Quarry Lane • Pleasanton CA 94566-4756
 Phone: (925) 484-1919

720-65158

Reference #: 161518
 Date _____ Page _____ of _____

Report To

Analysis Request

Attn: DuRlt Henry
 Company: Turner Machine
 Address: 3511 Le Mesa Dr. Hayward
 Email: DuRlt@TurnerMachine.com
 Bill To: Same
 Attn: Same
 Sampled By: D. Henry
 Phone: _____

Volatile Organics GC/MS (VOCs)
 EPA 8260B
 HVOCS by EPA 8260B
 EPA 8260B: Gas BTEX
 5 Oxygenates DCA, EOB Ethanol
 TEPH EPA 8015B Silica Gel
 Diesel Motor Oil Other _____
 SemiVolatile Organics GC/MS
 EPA 8270C
 PNA/PAH's by 8270C
 8270C SIM
 Oil and Grease Petroleum
 (EPA 1664/9071) Total
 Pesticides EPA 8081
 PCBs EPA 8082
 CAM17 Metals
 (EPA 6010/7470/7471)
 Metals: 6010B 200.7
 Lead LUFT RCRA Other: _____
 Metals: 6020 200.8
 (ICP-MS): _____
 W.E.T (STLC)
 W.E.T (DI) TCLP
 Hex. Chrom by EPA 7196
 or EPA 7199
 pH 9040
 SM4500
 Spec. Cond. Alkalinity
 TSS SS TDS
 Anions: Cl SO₄ NO₃ F
 Br NO₂ PO₄
 Perchlorate by EPA 314.0
 COD EPA 410.4 SM5220D
 Turbidity

PUSH

Sample ID	Date	Time	Mat	Preserv	
Excavator Bottom	6/2	10:50	S	-	
North - 6ft off	6/2	10:40	S	-	
Center	6/2	10:30	S	-	
South corner	6/2	70:25	S	-	

Project Info

Sample Receipt

Project Name: # _____
 Head Space: _____
 PO#: _____
 Temp: 4.6°C

1) Relinquished by: DuRlt Henry Time: 12:50
 Signature: _____
 Printed Name: DuRlt Henry Date: 6/2
 Company: Turner Machine

Credit Card Y/N: _____
 If yes, please call with payment information ASAP

2) Relinquished by: _____
 Signature: _____
 Printed Name: _____
 Company: _____
 Barcode: 
 720-65158 Chain of Custody

3) Relinquished by: _____
 Signature: _____
 Printed Name: _____
 Company: _____

1) Received by: Mark Miller Time: 12:30
 Signature: _____
 Printed Name: Mark Miller Date: 6-2-15
 Company: _____

Report: Routine Level 3 Level 4 EDD EDF
 Special Instructions / Comments: _____
 Global ID: _____

2) Received by: _____
 Signature: _____
 Printed Name: _____
 Date: _____
 Company: _____

See Terms and Conditions on reverse

3) Received by: _____
 Signature: _____
 Printed Name: _____
 Date: _____
 Company: _____

Login Sample Receipt Checklist

Client: Turner Maclane Inc.

Job Number: 720-65158-1

Login Number: 65158

List Number: 1

Creator: Mullen, Joan

List Source: TestAmerica Pleasanton

Question	Answer	Comment
Radioactivity wasn't checked or is <=/ background as measured by a survey meter.	N/A	
The cooler's custody seal, if present, is intact.	N/A	
Sample custody seals, if present, are intact.	N/A	
The cooler or samples do not appear to have been compromised or tampered with.	True	
Samples were received on ice.	True	
Cooler Temperature is acceptable.	True	
Cooler Temperature is recorded.	True	
COC is present.	True	
COC is filled out in ink and legible.	True	
COC is filled out with all pertinent information.	True	
Is the Field Sampler's name present on COC?	True	
There are no discrepancies between the containers received and the COC.	True	
Samples are received within Holding Time.	True	
Sample containers have legible labels.	True	
Containers are not broken or leaking.	True	
Sample collection date/times are provided.	True	
Appropriate sample containers are used.	True	
Sample bottles are completely filled.	True	
Sample Preservation Verified.	N/A	
There is sufficient vol. for all requested analyses, incl. any requested MS/MSDs	True	
Containers requiring zero headspace have no headspace or bubble is <6mm (1/4").	True	
Multiphasic samples are not present.	True	
Samples do not require splitting or compositing.	True	
Residual Chlorine Checked.	N/A	

TestAmerica

THE LEADER IN ENVIRONMENTAL TESTING

ANALYTICAL REPORT

TestAmerica Laboratories, Inc.
TestAmerica Pleasanton
1220 Quarry Lane
Pleasanton, CA 94566
Tel: (925)484-1919

TestAmerica Job ID: 720-65252-1
Client Project/Site: Meuser Residence

For:
Turner Maclane Inc.
63 Via Pico Plaza
#227
San Clemente, California 92672

Attn: Dwight Hoenig



Authorized for release by:
6/12/2015 10:41:29 AM

Micah Smith, Project Manager II
(925)484-1919
micah.smith@testamericainc.com

LINKS

Review your project
results through
TotalAccess

Have a Question?



Visit us at:
www.testamericainc.com

This report has been electronically signed and authorized by the signatory. Electronic signature is intended to be the legally binding equivalent of a traditionally handwritten signature.

Results relate only to the items tested and the sample(s) as received by the laboratory.

- 1
- 2
- 3
- 4
- 5
- 6
- 7
- 8
- 9
- 10
- 11
- 12
- 13
- 14



Table of Contents

Cover Page	1
Table of Contents	2
Definitions/Glossary	3
Case Narrative	4
Detection Summary	5
Client Sample Results	6
QC Sample Results	7
QC Association Summary	9
Lab Chronicle	10
Certification Summary	12
Method Summary	13
Sample Summary	14
Chain of Custody	15
Receipt Checklists	16

Definitions/Glossary

Client: Turner Maclane Inc.
Project/Site: Meuser Residence

TestAmerica Job ID: 720-65252-1

Qualifiers

Metals

Qualifier	Qualifier Description
F1	MS and/or MSD Recovery is outside acceptance limits.
F2	MS/MSD RPD exceeds control limits

Glossary

Abbreviation	These commonly used abbreviations may or may not be present in this report.
α	Listed under the "D" column to designate that the result is reported on a dry weight basis
%R	Percent Recovery
CFL	Contains Free Liquid
CNF	Contains no Free Liquid
DER	Duplicate error ratio (normalized absolute difference)
Dil Fac	Dilution Factor
DL, RA, RE, IN	Indicates a Dilution, Re-analysis, Re-extraction, or additional Initial metals/anion analysis of the sample
DLC	Decision level concentration
MDA	Minimum detectable activity
EDL	Estimated Detection Limit
MDC	Minimum detectable concentration
MDL	Method Detection Limit
ML	Minimum Level (Dioxin)
NC	Not Calculated
ND	Not detected at the reporting limit (or MDL or EDL if shown)
PQL	Practical Quantitation Limit
QC	Quality Control
RER	Relative error ratio
RL	Reporting Limit or Requested Limit (Radiochemistry)
RPD	Relative Percent Difference, a measure of the relative difference between two points
TEF	Toxicity Equivalent Factor (Dioxin)
TEQ	Toxicity Equivalent Quotient (Dioxin)

Case Narrative

Client: Turner Maclane Inc.
Project/Site: Meuser Residence

TestAmerica Job ID: 720-65252-1

Job ID: 720-65252-1

Laboratory: TestAmerica Pleasanton

Narrative

Job Narrative 720-65252-1

Comments

No additional comments.

Receipt

The samples were received on 6/4/2015 1:30 PM; the samples arrived in good condition, properly preserved and, where required, on ice. The temperature of the cooler at receipt was 5.0° C.

Metals

Method(s) 7471A: The matrix spike / matrix spike duplicate (MS/MSD) recoveries for preparation batch 720-183292 and analytical batch 720-183489 were outside control limits. Sample matrix interference and/or non-homogeneity are suspected because the associated laboratory control sample (LCS) recovery was within acceptance limits.

Method(s) 7471A: The matrix spike / matrix spike duplicate / sample duplicate (MS/MSD/DUP) precision for preparation batch 720-183292 and analytical batch 720-183489 was outside control limits. Sample matrix interference and/or non-homogeneity are suspected because the associated laboratory control sample / laboratory control sample duplicate (LCS/LCSD) precision was within acceptance limits.

No additional analytical or quality issues were noted, other than those described above or in the Definitions/Glossary page.

Detection Summary

Client: Turner Maclane Inc.
Project/Site: Meuser Residence

TestAmerica Job ID: 720-65252-1

Client Sample ID: 2908-30-36

Lab Sample ID: 720-65252-1

Analyte	Result	Qualifier	RL	MDL	Unit	Dil Fac	D	Method	Prep Type
Mercury	0.28		0.0095		mg/Kg	1		7471A	Total/NA

Client Sample ID: 2908-18-24

Lab Sample ID: 720-65252-2

Analyte	Result	Qualifier	RL	MDL	Unit	Dil Fac	D	Method	Prep Type
Mercury	0.32		0.010		mg/Kg	1		7471A	Total/NA

Client Sample ID: 1317-18-24

Lab Sample ID: 720-65252-3

Analyte	Result	Qualifier	RL	MDL	Unit	Dil Fac	D	Method	Prep Type
Mercury	0.12		0.0092		mg/Kg	1		7471A	Total/NA

Client Sample ID: 1317-30-36

Lab Sample ID: 720-65252-4

Analyte	Result	Qualifier	RL	MDL	Unit	Dil Fac	D	Method	Prep Type
Mercury	0.93	F1 F2	0.0088		mg/Kg	1		7471A	Total/NA

Client Sample ID: EXCAVATION 36-42

Lab Sample ID: 720-65252-5

Analyte	Result	Qualifier	RL	MDL	Unit	Dil Fac	D	Method	Prep Type
Mercury	22		0.94		mg/Kg	100		7471A	Total/NA

Client Sample ID: I-12-24-30

Lab Sample ID: 720-65252-6

Analyte	Result	Qualifier	RL	MDL	Unit	Dil Fac	D	Method	Prep Type
Mercury	0.023		0.0091		mg/Kg	1		7471A	Total/NA

Client Sample ID: I-12-21-18

Lab Sample ID: 720-65252-7

Analyte	Result	Qualifier	RL	MDL	Unit	Dil Fac	D	Method	Prep Type
Mercury	0.58		0.0092		mg/Kg	1		7471A	Total/NA

Client Sample ID: I-12-36-42

Lab Sample ID: 720-65252-8

No Detections.

This Detection Summary does not include radiochemical test results.

TestAmerica Pleasanton

Client Sample Results

Client: Turner Maclane Inc.
Project/Site: Meuser Residence

TestAmerica Job ID: 720-65252-1

Method: 7471A - Mercury (CVAA)

Client Sample ID: 2908-30-36
Date Collected: 06/03/15 06:48
Date Received: 06/04/15 13:30

Lab Sample ID: 720-65252-1
Matrix: Solid

Analyte	Result	Qualifier	RL	MDL	Unit	D	Prepared	Analyzed	Dil Fac
Mercury	0.28		0.0095		mg/Kg		06/08/15 21:27	06/09/15 16:12	1

Client Sample ID: 2908-18-24
Date Collected: 06/03/15 06:41
Date Received: 06/04/15 13:30

Lab Sample ID: 720-65252-2
Matrix: Solid

Analyte	Result	Qualifier	RL	MDL	Unit	D	Prepared	Analyzed	Dil Fac
Mercury	0.32		0.010		mg/Kg		06/08/15 21:27	06/09/15 16:14	1

Client Sample ID: 1317-18-24
Date Collected: 06/03/15 06:25
Date Received: 06/04/15 13:30

Lab Sample ID: 720-65252-3
Matrix: Solid

Analyte	Result	Qualifier	RL	MDL	Unit	D	Prepared	Analyzed	Dil Fac
Mercury	0.12		0.0092		mg/Kg		06/08/15 21:27	06/09/15 16:17	1

Client Sample ID: 1317-30-36
Date Collected: 06/03/15 06:40
Date Received: 06/04/15 13:30

Lab Sample ID: 720-65252-4
Matrix: Solid

Analyte	Result	Qualifier	RL	MDL	Unit	D	Prepared	Analyzed	Dil Fac
Mercury	0.93	F1 F2	0.0088		mg/Kg		06/09/15 15:28	06/11/15 19:33	1

Client Sample ID: EXCAVATION 36-42
Date Collected: 06/03/15 06:00
Date Received: 06/04/15 13:30

Lab Sample ID: 720-65252-5
Matrix: Solid

Analyte	Result	Qualifier	RL	MDL	Unit	D	Prepared	Analyzed	Dil Fac
Mercury	22		0.94		mg/Kg		06/09/15 15:28	06/11/15 21:01	100

Client Sample ID: I-12-24-30
Date Collected: 06/03/15 05:08
Date Received: 06/04/15 13:30

Lab Sample ID: 720-65252-6
Matrix: Solid

Analyte	Result	Qualifier	RL	MDL	Unit	D	Prepared	Analyzed	Dil Fac
Mercury	0.023		0.0091		mg/Kg		06/09/15 15:28	06/11/15 21:04	1

Client Sample ID: I-12-21-18
Date Collected: 06/03/15 05:01
Date Received: 06/04/15 13:30

Lab Sample ID: 720-65252-7
Matrix: Solid

Analyte	Result	Qualifier	RL	MDL	Unit	D	Prepared	Analyzed	Dil Fac
Mercury	0.58		0.0092		mg/Kg		06/09/15 15:28	06/11/15 19:41	1

Client Sample ID: I-12-36-42
Date Collected: 06/03/15 05:15
Date Received: 06/04/15 13:30

Lab Sample ID: 720-65252-8
Matrix: Solid

Analyte	Result	Qualifier	RL	MDL	Unit	D	Prepared	Analyzed	Dil Fac
Mercury	ND		0.0090		mg/Kg		06/09/15 15:28	06/11/15 19:44	1

TestAmerica Pleasanton

QC Sample Results

Client: Turner Maclane Inc.
Project/Site: Meuser Residence

TestAmerica Job ID: 720-65252-1

Method: 7471A - Mercury (CVAA)

Lab Sample ID: MB 720-183236/1-A
Matrix: Solid
Analysis Batch: 183310

Client Sample ID: Method Blank
Prep Type: Total/NA
Prep Batch: 183236

Analyte	MB Result	MB Qualifier	RL	MDL	Unit	D	Prepared	Analyzed	Dil Fac
Mercury	ND		0.010		mg/Kg		06/08/15 21:27	06/09/15 18:34	1

Lab Sample ID: LCS 720-183236/2-A
Matrix: Solid
Analysis Batch: 183300

Client Sample ID: Lab Control Sample
Prep Type: Total/NA
Prep Batch: 183236

Analyte	Spike Added	LCS Result	LCS Qualifier	Unit	D	%Rec	Limits
Mercury	0.833	0.833		mg/Kg		100	80 - 120

Lab Sample ID: LCSD 720-183236/3-A
Matrix: Solid
Analysis Batch: 183300

Client Sample ID: Lab Control Sample Dup
Prep Type: Total/NA
Prep Batch: 183236

Analyte	Spike Added	LCSD Result	LCSD Qualifier	Unit	D	%Rec	Limits	RPD	Limit
Mercury	0.833	0.798		mg/Kg		96	80 - 120	4	20

Lab Sample ID: MB 720-183292/1-A
Matrix: Solid
Analysis Batch: 183489

Client Sample ID: Method Blank
Prep Type: Total/NA
Prep Batch: 183292

Analyte	MB Result	MB Qualifier	RL	MDL	Unit	D	Prepared	Analyzed	Dil Fac
Mercury	ND		0.010		mg/Kg		06/09/15 15:28	06/11/15 19:15	1

Lab Sample ID: LCS 720-183292/2-A
Matrix: Solid
Analysis Batch: 183489

Client Sample ID: Lab Control Sample
Prep Type: Total/NA
Prep Batch: 183292

Analyte	Spike Added	LCS Result	LCS Qualifier	Unit	D	%Rec	Limits
Mercury	0.833	0.731		mg/Kg		88	80 - 120

Lab Sample ID: LCSD 720-183292/3-A
Matrix: Solid
Analysis Batch: 183489

Client Sample ID: Lab Control Sample Dup
Prep Type: Total/NA
Prep Batch: 183292

Analyte	Spike Added	LCSD Result	LCSD Qualifier	Unit	D	%Rec	Limits	RPD	Limit
Mercury	0.833	0.732		mg/Kg		88	80 - 120	0	20

Lab Sample ID: 720-65252-4 MS
Matrix: Solid
Analysis Batch: 183489

Client Sample ID: 1317-30-36
Prep Type: Total/NA
Prep Batch: 183292

Analyte	Sample Result	Sample Qualifier	Spike Added	MS Result	MS Qualifier	Unit	D	%Rec	Limits
Mercury	0.93	F1 F2	0.794	2.63	F1	mg/Kg		214	75 - 125

Lab Sample ID: 720-65252-4 MSD
Matrix: Solid
Analysis Batch: 183489

Client Sample ID: 1317-30-36
Prep Type: Total/NA
Prep Batch: 183292

Analyte	Sample Result	Sample Qualifier	Spike Added	MSD Result	MSD Qualifier	Unit	D	%Rec	Limits	RPD	Limit
Mercury	0.93	F1 F2	0.769	1.85	F2	mg/Kg		120	75 - 125	35	20

TestAmerica Pleasanton

QC Sample Results

Client: Turner Maclane Inc.
Project/Site: Meuser Residence

TestAmerica Job ID: 720-65252-1

- 1
- 2
- 3
- 4
- 5
- 6
- 7
- 8
- 9
- 10
- 11
- 12
- 13
- 14

QC Association Summary

Client: Turner Maclane Inc.
Project/Site: Meuser Residence

TestAmerica Job ID: 720-65252-1

Metals

Prep Batch: 183236

Lab Sample ID	Client Sample ID	Prep Type	Matrix	Method	Prep Batch
720-65252-1	2908-30-36	Total/NA	Solid	7471A	
720-65252-2	2908-18-24	Total/NA	Solid	7471A	
720-65252-3	1317-18-24	Total/NA	Solid	7471A	
LCS 720-183236/2-A	Lab Control Sample	Total/NA	Solid	7471A	
LCSD 720-183236/3-A	Lab Control Sample Dup	Total/NA	Solid	7471A	
MB 720-183236/1-A	Method Blank	Total/NA	Solid	7471A	

Prep Batch: 183292

Lab Sample ID	Client Sample ID	Prep Type	Matrix	Method	Prep Batch
720-65252-4	1317-30-36	Total/NA	Solid	7471A	
720-65252-4 MS	1317-30-36	Total/NA	Solid	7471A	
720-65252-4 MSD	1317-30-36	Total/NA	Solid	7471A	
720-65252-5	EXCAVATION 36-42	Total/NA	Solid	7471A	
720-65252-6	I-12-24-30	Total/NA	Solid	7471A	
720-65252-7	I-12-21-18	Total/NA	Solid	7471A	
720-65252-8	I-12-36-42	Total/NA	Solid	7471A	
LCS 720-183292/2-A	Lab Control Sample	Total/NA	Solid	7471A	
LCSD 720-183292/3-A	Lab Control Sample Dup	Total/NA	Solid	7471A	
MB 720-183292/1-A	Method Blank	Total/NA	Solid	7471A	

Analysis Batch: 183300

Lab Sample ID	Client Sample ID	Prep Type	Matrix	Method	Prep Batch
720-65252-1	2908-30-36	Total/NA	Solid	7471A	183236
720-65252-2	2908-18-24	Total/NA	Solid	7471A	183236
720-65252-3	1317-18-24	Total/NA	Solid	7471A	183236
LCS 720-183236/2-A	Lab Control Sample	Total/NA	Solid	7471A	183236
LCSD 720-183236/3-A	Lab Control Sample Dup	Total/NA	Solid	7471A	183236

Analysis Batch: 183310

Lab Sample ID	Client Sample ID	Prep Type	Matrix	Method	Prep Batch
MB 720-183236/1-A	Method Blank	Total/NA	Solid	7471A	183236

Analysis Batch: 183489

Lab Sample ID	Client Sample ID	Prep Type	Matrix	Method	Prep Batch
720-65252-4	1317-30-36	Total/NA	Solid	7471A	183292
720-65252-4 MS	1317-30-36	Total/NA	Solid	7471A	183292
720-65252-4 MSD	1317-30-36	Total/NA	Solid	7471A	183292
720-65252-5	EXCAVATION 36-42	Total/NA	Solid	7471A	183292
720-65252-6	I-12-24-30	Total/NA	Solid	7471A	183292
720-65252-7	I-12-21-18	Total/NA	Solid	7471A	183292
720-65252-8	I-12-36-42	Total/NA	Solid	7471A	183292
LCS 720-183292/2-A	Lab Control Sample	Total/NA	Solid	7471A	183292
LCSD 720-183292/3-A	Lab Control Sample Dup	Total/NA	Solid	7471A	183292
MB 720-183292/1-A	Method Blank	Total/NA	Solid	7471A	183292

TestAmerica Pleasanton

Lab Chronicle

Client: Turner Maclane Inc.
Project/Site: Meuser Residence

TestAmerica Job ID: 720-65252-1

Client Sample ID: 2908-30-36

Date Collected: 06/03/15 06:48

Date Received: 06/04/15 13:30

Lab Sample ID: 720-65252-1

Matrix: Solid

Prep Type	Batch Type	Batch Method	Run	Dilution Factor	Batch Number	Prepared or Analyzed	Analyst	Lab
Total/NA	Prep	7471A			183236	06/08/15 21:27	ECT	TAL PLS
Total/NA	Analysis	7471A		1	183300	06/09/15 16:12	CAM	TAL PLS

Client Sample ID: 2908-18-24

Date Collected: 06/03/15 06:41

Date Received: 06/04/15 13:30

Lab Sample ID: 720-65252-2

Matrix: Solid

Prep Type	Batch Type	Batch Method	Run	Dilution Factor	Batch Number	Prepared or Analyzed	Analyst	Lab
Total/NA	Prep	7471A			183236	06/08/15 21:27	ECT	TAL PLS
Total/NA	Analysis	7471A		1	183300	06/09/15 16:14	CAM	TAL PLS

Client Sample ID: 1317-18-24

Date Collected: 06/03/15 06:25

Date Received: 06/04/15 13:30

Lab Sample ID: 720-65252-3

Matrix: Solid

Prep Type	Batch Type	Batch Method	Run	Dilution Factor	Batch Number	Prepared or Analyzed	Analyst	Lab
Total/NA	Prep	7471A			183236	06/08/15 21:27	ECT	TAL PLS
Total/NA	Analysis	7471A		1	183300	06/09/15 16:17	CAM	TAL PLS

Client Sample ID: 1317-30-36

Date Collected: 06/03/15 06:40

Date Received: 06/04/15 13:30

Lab Sample ID: 720-65252-4

Matrix: Solid

Prep Type	Batch Type	Batch Method	Run	Dilution Factor	Batch Number	Prepared or Analyzed	Analyst	Lab
Total/NA	Prep	7471A			183292	06/09/15 15:28	ECT	TAL PLS
Total/NA	Analysis	7471A		1	183489	06/11/15 19:33	SLK	TAL PLS

Client Sample ID: EXCAVATION 36-42

Date Collected: 06/03/15 06:00

Date Received: 06/04/15 13:30

Lab Sample ID: 720-65252-5

Matrix: Solid

Prep Type	Batch Type	Batch Method	Run	Dilution Factor	Batch Number	Prepared or Analyzed	Analyst	Lab
Total/NA	Prep	7471A			183292	06/09/15 15:28	ECT	TAL PLS
Total/NA	Analysis	7471A		100	183489	06/11/15 21:01	SLK	TAL PLS

Client Sample ID: I-12-24-30

Date Collected: 06/03/15 05:08

Date Received: 06/04/15 13:30

Lab Sample ID: 720-65252-6

Matrix: Solid

Prep Type	Batch Type	Batch Method	Run	Dilution Factor	Batch Number	Prepared or Analyzed	Analyst	Lab
Total/NA	Prep	7471A			183292	06/09/15 15:28	ECT	TAL PLS
Total/NA	Analysis	7471A		1	183489	06/11/15 21:04	SLK	TAL PLS

TestAmerica Pleasanton

Lab Chronicle

Client: Turner Maclane Inc.
Project/Site: Meuser Residence

TestAmerica Job ID: 720-65252-1

Client Sample ID: I-12-21-18

Date Collected: 06/03/15 05:01

Date Received: 06/04/15 13:30

Lab Sample ID: 720-65252-7

Matrix: Solid

Prep Type	Batch Type	Batch Method	Run	Dilution Factor	Batch Number	Prepared or Analyzed	Analyst	Lab
Total/NA	Prep	7471A			183292	06/09/15 15:28	ECT	TAL PLS
Total/NA	Analysis	7471A		1	183489	06/11/15 19:41	SLK	TAL PLS

Client Sample ID: I-12-36-42

Date Collected: 06/03/15 05:15

Date Received: 06/04/15 13:30

Lab Sample ID: 720-65252-8

Matrix: Solid

Prep Type	Batch Type	Batch Method	Run	Dilution Factor	Batch Number	Prepared or Analyzed	Analyst	Lab
Total/NA	Prep	7471A			183292	06/09/15 15:28	ECT	TAL PLS
Total/NA	Analysis	7471A		1	183489	06/11/15 19:44	SLK	TAL PLS

Laboratory References:

TAL PLS = TestAmerica Pleasanton, 1220 Quarry Lane, Pleasanton, CA 94566, TEL (925)484-1919

Certification Summary

Client: Turner Maclane Inc.
Project/Site: Meuser Residence

TestAmerica Job ID: 720-65252-1

Laboratory: TestAmerica Pleasanton

Unless otherwise noted, all analytes for this laboratory were covered under each certification below.

Authority	Program	EPA Region	Certification ID	Expiration Date
California	State Program	9	2496	01-31-16

Analysis Method	Prep Method	Matrix	Analyte
-----------------	-------------	--------	---------

- 1
- 2
- 3
- 4
- 5
- 6
- 7
- 8
- 9
- 10
- 11
- 12
- 13
- 14

Method Summary

Client: Turner Maclane Inc.
Project/Site: Meuser Residence

TestAmerica Job ID: 720-65252-1

Method	Method Description	Protocol	Laboratory
7471A	Mercury (CVAA)	SW846	TAL PLS

Protocol References:

SW846 = "Test Methods For Evaluating Solid Waste, Physical/Chemical Methods", Third Edition, November 1986 And Its Updates.

Laboratory References:

TAL PLS = TestAmerica Pleasanton, 1220 Quarry Lane, Pleasanton, CA 94566, TEL (925)484-1919

- 1
- 2
- 3
- 4
- 5
- 6
- 7
- 8
- 9
- 10
- 11
- 12
- 13
- 14

Sample Summary

Client: Turner Maclane Inc.
Project/Site: Meuser Residence

TestAmerica Job ID: 720-65252-1

Lab Sample ID	Client Sample ID	Matrix	Collected	Received
720-65252-1	2908-30-36	Solid	06/03/15 06:48	06/04/15 13:30
720-65252-2	2908-18-24	Solid	06/03/15 06:41	06/04/15 13:30
720-65252-3	1317-18-24	Solid	06/03/15 06:25	06/04/15 13:30
720-65252-4	1317-30-36	Solid	06/03/15 06:40	06/04/15 13:30
720-65252-5	EXCAVATION 36-42	Solid	06/03/15 06:00	06/04/15 13:30
720-65252-6	I-12-24-30	Solid	06/03/15 05:08	06/04/15 13:30
720-65252-7	I-12-21-18	Solid	06/03/15 05:01	06/04/15 13:30
720-65252-8	I-12-36-42	Solid	06/03/15 05:15	06/04/15 13:30



TestAmerica

THE ENVIRONMENTAL TESTING

190-15852

TESTAMERICA Pleasanton Chain of Custody
 1220 Quarry Lane • Pleasanton CA 94566-4756
 Phone: (925) 484-1919 • Fax: (925) 600-8002

Reference #: 1101597

Date _____ Page _____ of _____

6/12/2015

Report To

Analysis Request

Attn: Dwight Hoernig
 Company: Turner Machine
 Address: 3511 L. Hwy Dr - Hayward
 Email: Dwight@turner-machine.com
 Bill To: Same
 Sampled By: D Hoernig
 Phone: 510-881-8811

Sample ID	Date	Time	Mat	Preserv	Volatile Organics GC/MS (VOCs) <input type="checkbox"/> EPA 8260B	HVOCs by <input type="checkbox"/> EPA 8260B	EPA 8260B: <input type="checkbox"/> Gas <input type="checkbox"/> BTEX <input type="checkbox"/> 5 Oxygenates <input type="checkbox"/> DCA, EDB <input type="checkbox"/> Ethanol	TEPH EPA 8015B <input type="checkbox"/> Silica Gel <input type="checkbox"/> Diesel <input type="checkbox"/> Motor Oil <input type="checkbox"/> Other	SemiVolatile Organics GC/MS <input type="checkbox"/> EPA 8270C	PNA/PAH's by <input type="checkbox"/> 8270C <input type="checkbox"/> 8270C SIM	Oil and Grease <input type="checkbox"/> Petroleum (EPA 1664/9071) <input type="checkbox"/> Total	Pesticides <input type="checkbox"/> EPA 8081 PCBs <input type="checkbox"/> EPA 8082	CAM17 Metals (EPA 6010/7470/7471)	Metals: <input type="checkbox"/> 6010B <input type="checkbox"/> 200.7 <input type="checkbox"/> Lead <input type="checkbox"/> Cu <input type="checkbox"/> Ni <input type="checkbox"/> Cr <input type="checkbox"/> Mn Other: _____	Metals: <input type="checkbox"/> 6020 <input type="checkbox"/> 200.8 (ICP-MS): _____	<input type="checkbox"/> W.E.T (STLC) <input type="checkbox"/> W.E.T (DI) <input type="checkbox"/> TCLP	Hex. Chrom by <input type="checkbox"/> EPA 7196 <input type="checkbox"/> or EPA 7199	pH <input type="checkbox"/> 9040 <input type="checkbox"/> SM4500	<input type="checkbox"/> Spec. Cond. <input type="checkbox"/> Alkalinity <input type="checkbox"/> TSS <input type="checkbox"/> SS <input type="checkbox"/> TDS	Anions: <input type="checkbox"/> Cl <input type="checkbox"/> SO ₄ <input type="checkbox"/> NO ₃ <input type="checkbox"/> F <input type="checkbox"/> Br <input type="checkbox"/> NO ₂ <input type="checkbox"/> PO ₄	<input type="checkbox"/> Perchlorate by EPA 314.0	COD <input type="checkbox"/> EPA 410.4 <input type="checkbox"/> SM5220D <input type="checkbox"/> Turbidity	Hg-Total	Number of Containers			
2908-30-36	6/3	6:48	S	-																							
2908-18-24	6/3	6:41	S	-																							
1317-18-24	6/3	6:25	S	-																							
1317-30-36	6/3	6:40	S	-																							
Excavation 36-42	6/3	6:00	S	-																							
I-12-24-30	6/3	5:08	S	-																							
I-12-12-18	6/3	5:01	S	-																							
I-12-36-42	6/3	5:15	S	-																							



Project Info

Sample Receipt

Project Name/ #: Meuser Residence
 # of Containers: 8
 Head Space:
 Temp: 5.0°C
 Credit Card VIN:
 If yes, please call with payment information ASAP

1) Relinquished by: [Signature] Time: 1:30 Date: 6/11/15
 Signature: Dwight Hoernig
 Printed Name: Dwight Hoernig
 Date: 6/11/15
 Company: Turner Machine

2) Relinquished by: _____
 Signature: _____
 Printed Name: _____
 Date: _____
 Company: _____

3) Relinquished by: _____
 Signature: _____
 Printed Name: _____
 Date: _____
 Company: _____

T	A	Day	Day	Day	Day	Day	Other:
10	5	4	3	2	1		

Received by: [Signature] Time: 6:41 Date: 6/11/15
 Signature: [Signature]
 Printed Name: [Signature]
 Date: 6/11/15
 Company: TRP

Report: Routine Level 3 Level 4 EDD EDF
 Special Instructions / Comments: Global ID _____

See Terms and Conditions on reverse

Login Sample Receipt Checklist

Client: Turner Maclane Inc.

Job Number: 720-65252-1

Login Number: 65252

List Number: 1

Creator: Gonzales, Justinn

List Source: TestAmerica Pleasanton

Question	Answer	Comment
Radioactivity wasn't checked or is \leq background as measured by a survey meter.	N/A	
The cooler's custody seal, if present, is intact.	N/A	
Sample custody seals, if present, are intact.	N/A	
The cooler or samples do not appear to have been compromised or tampered with.	True	
Samples were received on ice.	True	
Cooler Temperature is acceptable.	True	
Cooler Temperature is recorded.	True	
COC is present.	True	
COC is filled out in ink and legible.	True	
COC is filled out with all pertinent information.	True	
Is the Field Sampler's name present on COC?	True	
There are no discrepancies between the containers received and the COC.	True	
Samples are received within Holding Time.	True	
Sample containers have legible labels.	True	
Containers are not broken or leaking.	True	
Sample collection date/times are provided.	True	
Appropriate sample containers are used.	True	
Sample bottles are completely filled.	True	
Sample Preservation Verified.	N/A	
There is sufficient vol. for all requested analyses, incl. any requested MS/MSDs	True	
Containers requiring zero headspace have no headspace or bubble is <math><6\text{mm}</math> (1/4").	True	
Multiphasic samples are not present.	True	
Samples do not require splitting or compositing.	True	
Residual Chlorine Checked.	N/A	