

## Nowell, Keith, Env. Health

---

**From:** Nowell, Keith, Env. Health  
**Sent:** Friday, October 02, 2015 2:54 PM  
**To:** 'Forrest Cook'  
**Cc:** Mona Hsieh; Roe, Dilan, Env. Health  
**Subject:** RE: Updated Site Map and Photos - 3101 35th Ave., Oakland, CA

Forrest,

Good work. Your revised boring locations are acceptable to ACEH. Please proceed with the investigation.

I have no idea what the plate is covering. It may be a sump drain cover. Our resident service station expert is out of the office today. I'll try to get his feedback. Please pop the cover on you next site visit for a look-see and get back to me. Due to its location adjacent to one of the potential hoists, boring location DP-6 should also evaluate the any impacts associated with the covered structure.

Should you have any questions regarding this correspondence or your case, please call me at (510) 567-6764 or send an electronic mail message at [keith.nowell@acgov.org](mailto:keith.nowell@acgov.org)

Regards,  
Keith Nowell

**From:** Forrest Cook [mailto:cook.forrest@gmail.com]  
**Sent:** Friday, October 02, 2015 1:52 PM  
**To:** Nowell, Keith, Env. Health <Keith.Nowell@acgov.org>  
**Subject:** Updated Site Map and Photos - 3101 35th Ave., Oakland, CA

Good Afternoon Keith,

We were finally able to clear of the area of this site where a suspected hoist was formerly identified as part of a Phase I. I found two patches of concrete which, almost with out a doubt, were former hoists. Additionally, adjacent to one of the hoists was a strange metal lid of some sort set into the concrete (see the attached pictures). I honestly, have never encountered something like this before. Any ideas what it might be?

Regardless, at your request, we will do three additional borings in the locations shown on the new revised map (attached Figure 5).

Let me know what you think.

Thanks,

Forrest Cook, PG  
Owner/Principal Scientist

**ALMAR ENVIRONMENTAL**

831.420.7923  
407 Almar Avenue  
Santa Cruz, CA 95060

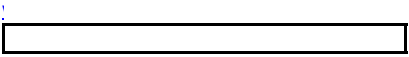

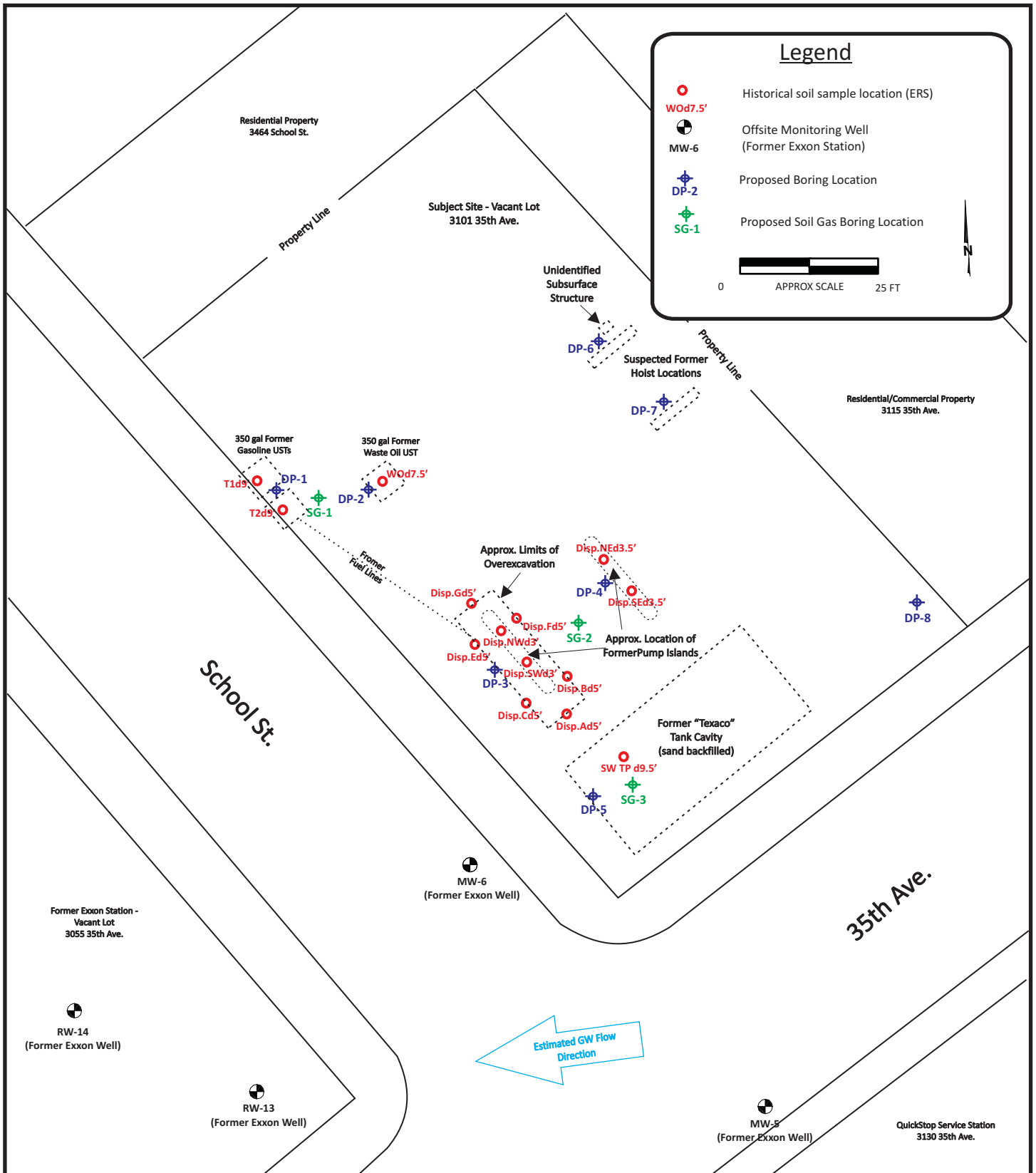

3101 35th AVENUE  
OAKLAND, CALIFORNIA

DETAILED SITE MAP  
SHOWING PROPOSED BORING LOCATIONS

FIGURE

5





GLOBE