



DEPARTMENT OF ENVIRONMENTAL HEALTH
LOCAL OVERSIGHT PROGRAM (LOP)
For Hazardous Materials Releases
1131 HARBOR BAY PARKWAY, SUITE 250
ALAMEDA, CA 94502
(510) 567-6700
FAX (510) 337-9335

ACTIVITY RECORD

RO #: RO0003148

DATE: October 26, 2017

TIME: 1:00 pm

<input type="checkbox"/>	Meeting	HAZ MAT SPECIALIST:	<u>Paresh Khatri / Keith Nowell</u>
<input checked="" type="checkbox"/>	Site Visit/Inspection	Work Location:	<u>1131 Harbor Bay Pkwy, Alameda</u>
<input type="checkbox"/>	Telephone Conversation	Conferee('s):	<u>Frank Hamed</u>
<input type="checkbox"/>	Document Review		<u>Ed Hemmat (RP)</u>
<input type="checkbox"/>	Peer Review	Phone #	<u></u>

SITE NAME & ADDRESS: 1501 Martin Luther King Jr. Way, Oakland

TOPIC: Site meeting to discuss sampling locations

SUMMARY:

Keith Nowell and Paresh Khatri met with Ed Hemmat, Responsible Party and Frank Hamed, consultant at the site at 1:00 PM to discuss the possible sampling locations to complete site characterization, based on ACDEH's last correspondence. Two wells existing wells are located within the building. However, one well was constructed as a sparging/injection well, so it will not provide the necessary data.

Four borings are currently proposed at the site, two located on the sidewalk in front of the building, the other two located on the sidewalk in the former excavation footprint. Additionally, a soil vapor sample is proposed inside the building, in what is currently the lunch room for staff.

Mr. Hamed stated that they would comply with the directive requirements, but wanted to illustrate the current site constraints as the structure is currently occupied. Mr. Hamed did propose a boring half-way between the former UST excavation pit and the existing well STVW-4.

ACDEH will consider all the site constraints and review the proposal and will issue a directive letter.



ACTIVITY RECORD

Site Map

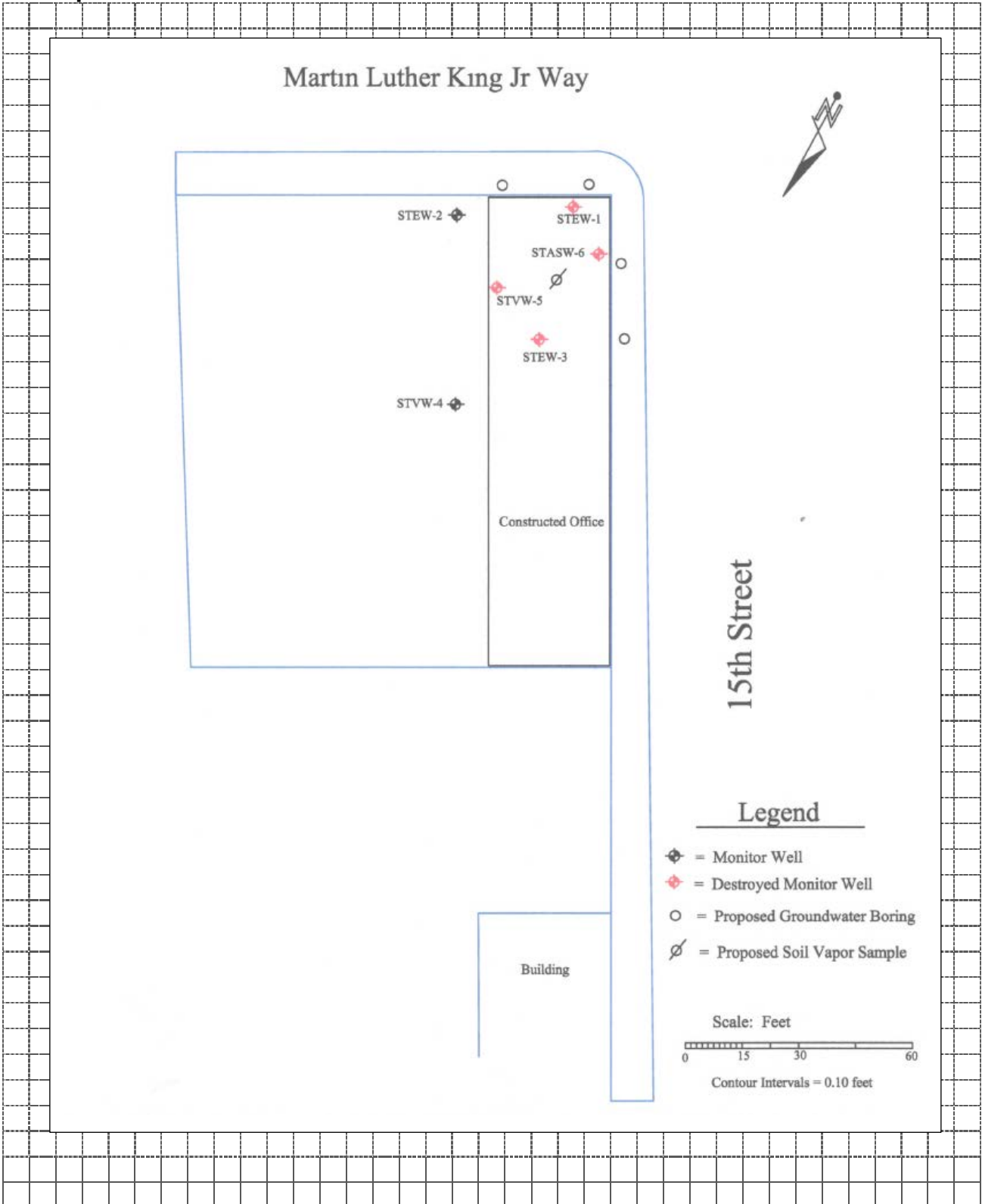

Photo Log

RO #: RO0003148

Name: EMBL LLC Tank

Address: 1501 Martin Luther King Jr. Blvd, OAK



DEPARTMENT OF ENVIRONMENTAL HEALTH
LOCAL OVERSIGHT PROGRAM (LOP)
For Hazardous Materials Releases
1131 HARBOR BAY PARKWAY, SUITE 250
ALAMEDA, CA 94502
(510) 567-6700
FAX (510) 337-9335

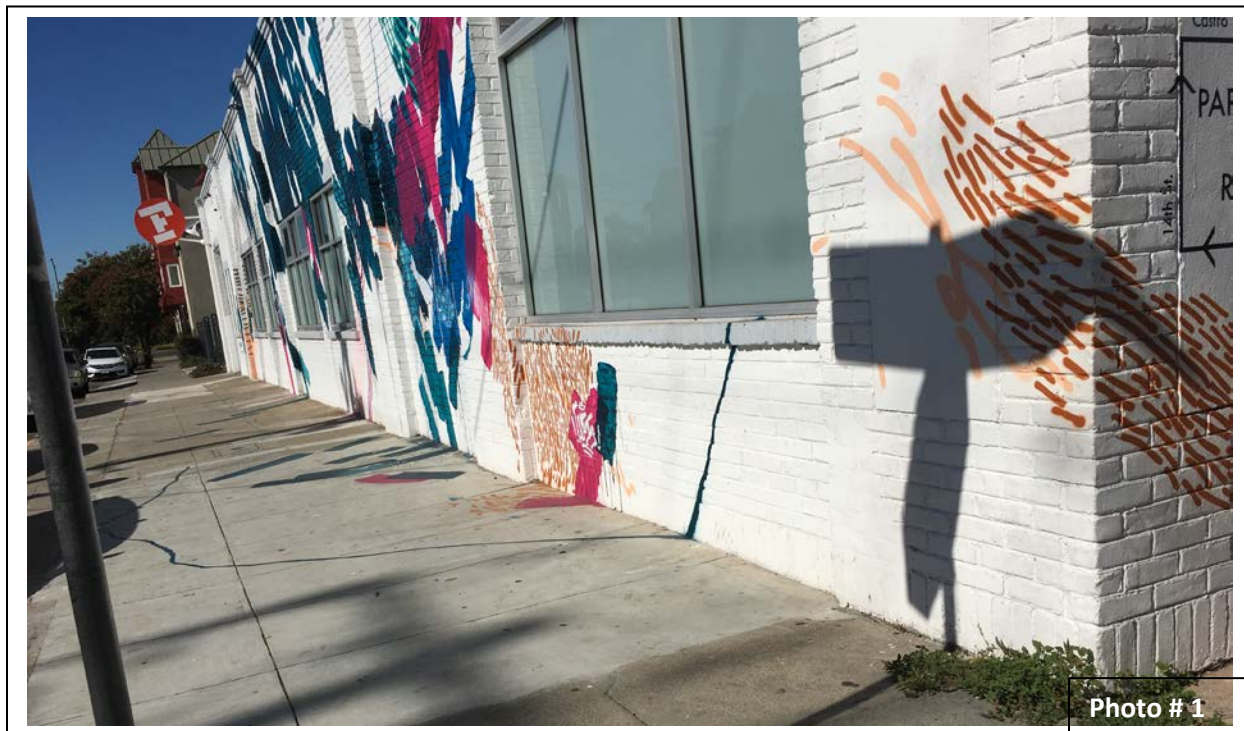

Photo Taken by: Paresh Khatri	Insp. Rtp #:	Date: 10/26/2017
Description: Location of former UST excavation		

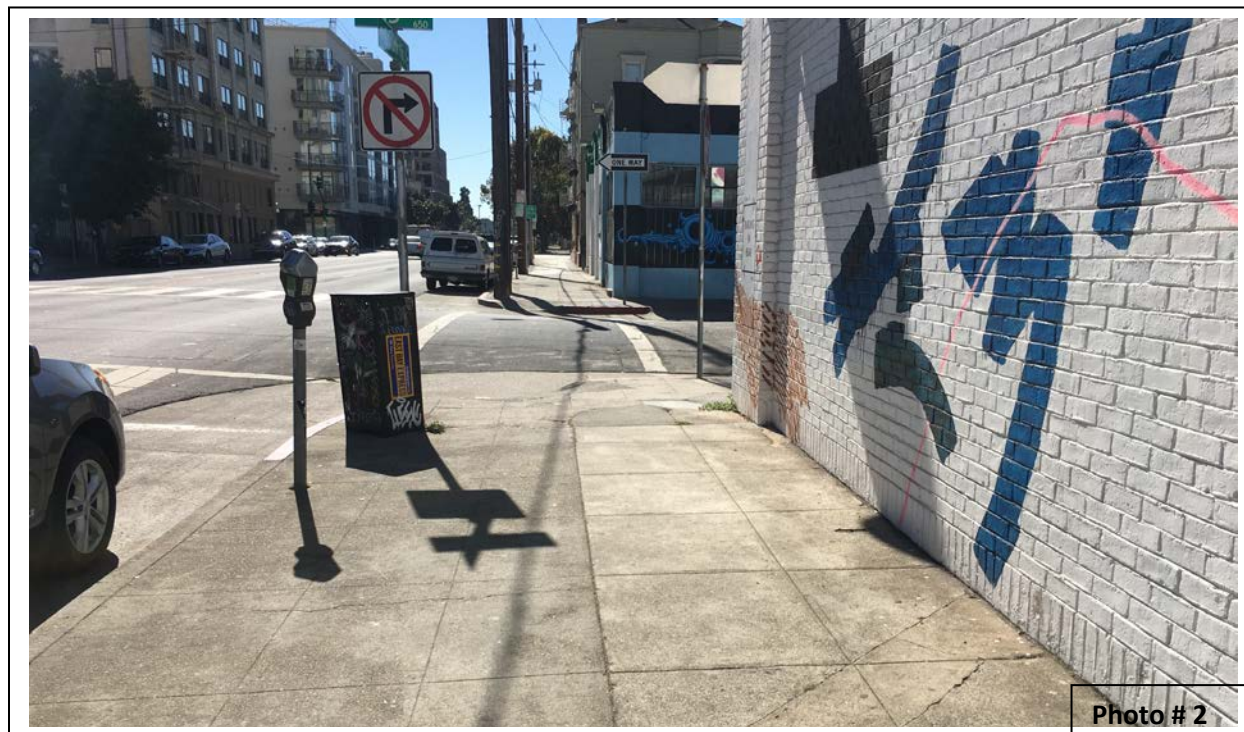

Photo Taken by: Paresh Khatri	Insp. Rtp #:	Date: 10/26/2017
Description: Inferred up-gradient corner (former UST was located around the building corner)		

Photo Log

RO #: RO0003148

Name: EMBL LLC Tank

Address: 1501 Martin Luther King Jr. Blvd, OAK



DEPARTMENT OF ENVIRONMENTAL HEALTH
LOCAL OVERSIGHT PROGRAM (LOP)
For Hazardous Materials Releases
1131 HARBOR BAY PARKWAY, SUITE 250
ALAMEDA, CA 94502
(510) 567-6700
FAX (510) 337-9335



Photo # 3

Photo Taken by: Paresh Khatri	Insp. Rtp #:	Date: 10/26/2017
Description: Inside room/wall closest to former UST located under the sidewalk		



Photo # 4

Photo Taken by: Paresh Khatri	Insp. Rtp #:	Date: 10/26/2017
Description: Existing MW STEW-2 located just inside the front entrance		

Photo Log

RO #: RO0003148

Name: EMBL LLC Tank

Address: 1501 Martin Luther King Jr. Blvd, OAK



DEPARTMENT OF ENVIRONMENTAL HEALTH
LOCAL OVERSIGHT PROGRAM (LOP)
For Hazardous Materials Releases
1131 HARBOR BAY PARKWAY, SUITE 250
ALAMEDA, CA 94502
(510) 567-6700
FAX (510) 337-9335



Photo # 5

Photo Taken by: Paresh Khatri	Insp. Rtp #:	Date: 10/26/2017
Description: Close up of existing MW STEW-2		



Photo # 6

Photo Taken by: Paresh Khatri	Insp. Rtp #:	Date: 10/26/2017
Description: Facing south towards entrance (former UST located near the right corner of the building)		

Photo Log

RO #: RO0003148

Name: EMBL LLC Tank

Address: 1501 Martin Luther King Jr. Blvd, OAK



DEPARTMENT OF ENVIRONMENTAL HEALTH
LOCAL OVERSIGHT PROGRAM (LOP)
For Hazardous Materials Releases
1131 HARBOR BAY PARKWAY, SUITE 250
ALAMEDA, CA 94502
(510) 567-6700
FAX (510) 337-9335



Photo # 7

Photo Taken by: Paresh Khatri	Insp. Rtp #:	Date: 10/26/2017
Description: Facing the corner where former UST was located (outside the building)		



Photo # 8

Photo Taken by: Paresh Khatri	Insp. Rtp #:	Date: 10/26/2017
Description: Possible location of MW STVW-4 underneath isle		