

RECEIVED

By Alameda County Environmental Health at 2:19 pm, Jan 06, 2014

December 20, 2013

Ms. Dilan Roe
Hazardous Materials Specialist
Alameda County Environmental Health
1131 Harbor Bay Parkway, Suite 250
Alameda, CA 94501-6577

Subject: Certification of Mailing of Fact Sheet
Crown Chevrolet Cadillac Isuzu
7544 Dublin Boulevard and 6707 Golden Gate Drive
Dublin, California
Site Cleanup Program Case No. RO0003130

Dear Ms. Roe:

Enclosed please find a certification of mailing of a fact sheet for the Crown Chevrolet South Parcel site at 6707 Golden Gate Drive, in Dublin, California (Site Cleanup Program Case No. RO0003130, GeoTracker Global ID T10000005449). This fact sheet was prepared and mailed by AMEC Environment & Infrastructure, Inc. (AMEC), on behalf of Crown Chevrolet Cadillac Isuzu.

I declare under penalty of perjury that the information and/or recommendations contained in the attached document or report is true and correct to the best of my knowledge.

Please contact me at (925) 984-1426 or Avery Patton of AMEC at 510-663-4154 if you have any questions regarding this Fact Sheet.

Sincerely yours,



Terri Costello
Betty J. Woolverton Trust

Attachment: Certification of Mailing

cc: Tondria Hendrix, Zurich North American Insurance
Thomas L. Vormbrock, Rimkus Consulting Group, Inc.
Avery Patton, AMEC Environment & Infrastructure, Inc.

CERTIFICATION OF MAILING

SITE NAME: Crown Chevrolet South Parcel
6707 Golden Gate Drive, Dublin, California 94568

SITE CLEANUP PROGRAM CASE NO.: RO0003130

GEOTRACKER GLOBAL ID: T10000005449

I certify that I mailed on December 20, 2013 a copy of the attached Fact Sheet on Environmental Assessment by first class mail upon the person(s) on the attached mailing list (or by electronic mail to those listed with electronic mail addresses), by depositing a true copy thereof, securely enclosed in a postpaid wrapper, in the Post Office box at 2101 Webster Street, 1st Floor in the City of Oakland, California, which box is under the exclusive care and custody of the United States Post Office.

Signature 

Date 12/20/13



December 20, 2013

PUBLIC NOTIFICATION OF POTENTIAL CASE CLOSURE

Site Name: Crown Chevrolet South Parcel
Site Address: 6707 Golden Gate Drive, Dublin, CA 94568
Site Cleanup Program No: RO0003130
Geotracker Global ID: T10000005449

Summary – This fact sheet has been prepared to inform community members and other interested stakeholders of the potential case closure for the Crown Chevrolet South Parcel (site), Site Cleanup Program Case No. RO0003130, located at 6707 Golden Gate Drive in Dublin, California (Figure 1). The site was formerly part of Site Cleanup Program Case No. RO0003014, for the former Crown Chevrolet property, which consisted of two legal parcels: the South Parcel located at 6707 Golden Gate Drive (site) and the North Parcel located at 7544 Dublin Boulevard (Figure 2). Site redevelopment is currently planned, in which the North Parcel would be mixed-use development (residential and retail) and the South Parcel would be affordable housing. To allow for redevelopment of the South Parcel and because there are no significant environmental impacts within the South Parcel, Alameda County Environmental Health (ACEH) opened a new Site Cleanup Case (RO0003130) to decouple the South Parcel from the North Parcel.

North Parcel was developed with showrooms, service areas, and auto body shops. The South Parcel remained undeveloped; some grading activities occurred around 1965 and the lot is currently paved. Since that time, it has only been used for car and truck parking and the lot is now vacant.

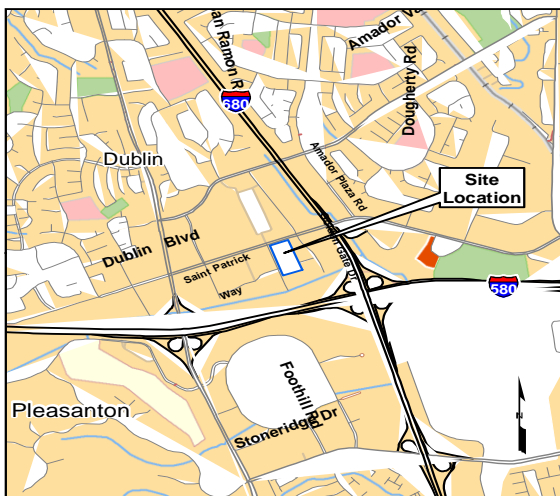

Figure 1 0 0.25 Miles

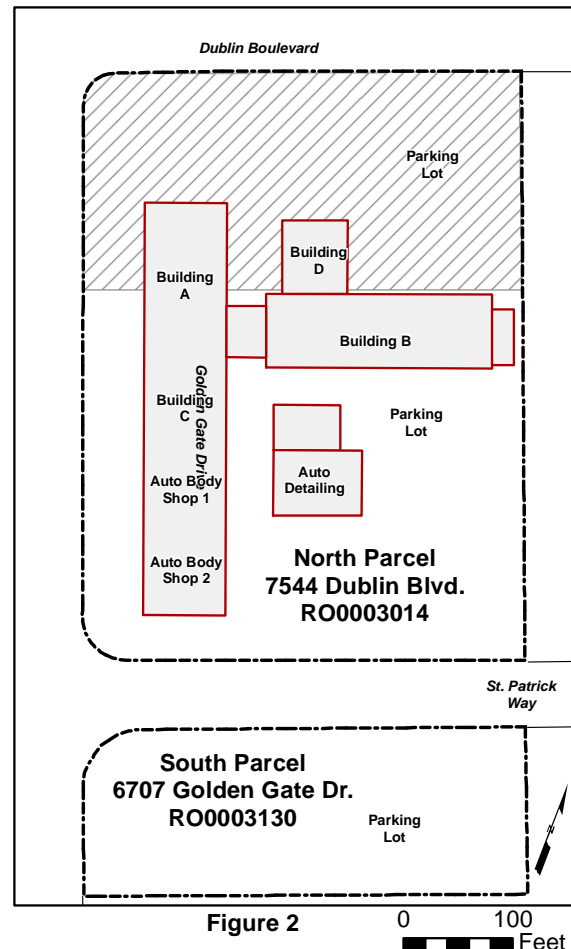

Figure 2 0 100 Feet

Site Background – Crown Chevrolet was a car dealership that operated from 1968 to 2013. The

Environmental Impacts – Volatile organic compounds (VOCs), primarily PCE (typically used in dry-cleaning operations as well as in solvents for parts and brake cleaning and other industrial applications), have been detected in



soil, groundwater and/or soil vapor in the North Parcel at concentrations greater than applicable regulatory agency screening levels. VOCs are present in shallow groundwater and soil vapor throughout the northern portion of the North Parcel (hatched area of Figure 2). Investigations performed in 2012 indicate that the primary source of source of PCE is from shallow groundwater migrating beneath the site from an unknown source located upgradient (or west) of the site.

Low concentrations (below screening levels) of PCE have also been detected in soil vapor in the northwestern corner of the South Parcel. Since the South Parcel has historically only been used for vehicle parking, the source of the PCE in soil vapor is hypothesized to be from migration of soil gas along utility trenches located in Golden Gate Drive. No PCE was detected in soil vapor from the eastern portion of the South Parcel, nor in groundwater.

In February 2013 a Phase I Environmental Site Assessment was completed for the South Parcel. Based on the review of available historical records, no Recognized Environmental Conditions were identified for the parcel.

Case Closure – Site Cleanup Case RO0003130 has been evaluated for closure, taking into

consideration the potential threats to human health, safety, and the environment. It does not appear that the low concentrations of PCE in soil vapor in one corner of the South Parcel will present a risk to human health when the property is redeveloped for residential use. Therefore, ACEH is considering potential closure of the Site Cleanup Case RO0003130.

Next Step – The public is invited to review and comment on the proposed closure of the Site Cleanup Case. The entire case file for both Site Cleanup Program Cases RO0003014 and RO0003130 is contained in the electronic database and can be viewed over the internet on the ACEH website (<http://www.acgov.org/aceh/lop/ust.htm>) or on the State of California Water Resources Control Board Geotracker website (<http://geotracker.swrcb.ca.gov>).

Please send written comments regarding the proposed case closure to Dilan Roe at the address below. All written comments received by **January 20, 2014**, will be forwarded to the Responsible Party, and will be considered and responded to prior to a final determination on the proposed case closure.

For additional information, please contact:

Dilan Roe
Site Cleanup Program Manager
Alameda County Environmental Health
1131 Harbor Bay Parkway Suite 250
Alameda, CA 94502
Phone: 510-567-6767
Email: dilan.roe@acgov.org

Avery Whitmarsh
Environmental Consultant
AMEC Environment & Infrastructure, Inc.
2101 Webster St., Floor 12
Oakland, CA 94618
Phone: 510-663-4100
Email: avery.patton@amec.com

TABLE 1

OCCUPANT CONTACTS WITHIN 200 FEET OF SITE

Crown Chevrolet
 7544 Dublin Boulevard and 6707 Golden Gate Drive
 Dublin, California

Name	Company	Address	City	State	Zip
Owner/Occupant	Edge Motorworks	6443 Golden Gate Dr	Dublin	CA	94568-2905
Owner/Occupant	Nemexus	6690 Amador Plaza Rd # 105	Dublin	CA	94568-2949
Gordon Gu	Aoc Technologies	6690 Amador Plaza Rd # 110	Dublin	CA	94568-2949
William A Barron	William A Barron Co	6690 Amador Plaza Rd # 220	Dublin	CA	94568-2949
Owner/Occupant	Matchpoint Solutions	6690 Amador Plaza Rd # 225	Dublin	CA	94568-2949
Lou Westgate	VPSI Inc	6690 Amador Plaza Rd # 230	Dublin	CA	94568-2954
Owner/Occupant	Central Alarm Svc	6690 Amador Plaza Rd # 235	Dublin	CA	94568-2952
Mark Mora	Golf Mart	6694 Amador Plaza Rd	Dublin	CA	94568-2996
Richard Rifkin	New Home Alliance Group	6694 Amador Plaza Rd	Dublin	CA	94568-2996
Leila Douglass	Douglass Designs	6694 Amador Plaza Rd # A	Dublin	CA	94568-2996
Sheryl Doyle	Plumbers	6694 Amador Plaza Rd # A	Dublin	CA	94568-2996
Mike Hartshorn	Euro Surfaces	6694 Amador Plaza Rd # A1	Dublin	CA	94568-2996
Michelle Storace	Home Remodelers Contracting	6694 Amador Plaza Rd # P	Dublin	CA	94568-2996
Michael Vickers	Jennifer Convertibles	6698 Amador Plaza Rd	Dublin	CA	94568-2941
Nancy Carpenello	Amador Plaza Dental Care	6698 Amador Plaza Rd # A	Dublin	CA	94568-2943
Katie Park	Blossom's Formal Dress	6700 Amador Plaza Rd	Dublin	CA	94568-2932
Michael Dictor	Creative Energy Corp	6700 Amador Plaza Rd	Dublin	CA	94568-2932
Shawn Hatami	Chrysler Jeep Dodge Stoneridge	6701 Amador Plaza Rd	Dublin	CA	94568-2933
Matt Zaheri	Stoneridge Chrysler Jeep Dodge	6701 Amador Plaza Rd	Dublin	CA	94568-2933
Jason Carter	Big 5 Sporting Goods	6750 Amador Plaza Rd	Dublin	CA	94568-2932
Owner/Occupant	Debut Hair Design	6766 Amador Plaza Rd	Dublin	CA	94568-2932
Owner/Occupant	Marianne Keith	6780 Amador Plaza Rd	Dublin	CA	94568-2932
Owner/Occupant	Toys R US	6850 Amador Plaza Rd	Dublin	CA	94568-2934
Jun Yong	A Plus Cleaners	6851 Amador Plaza Rd	Dublin	CA	94568-2940
Sucheta Deora	Postal Annex Number 457 Inc	6851 Amador Plaza Rd	Dublin	CA	94568-2940
Owner/Occupant	Panda Express	6851 Amador Plaza Rd # 101	Dublin	CA	94568-2951
Kevin Ho	K & C Ho LLC	6851 Amador Plaza Rd # 102	Dublin	CA	94568-2951
Owner/Occupant	Supercuts	6851 Amador Plaza Rd # 103	Dublin	CA	94568-2951
Long Hau	Happiness Nails & Spa	6851 Amador Plaza Rd # 104	Dublin	CA	94568-2940
Jon Mendoza	Nextel Retail	6851 Amador Plaza Rd # 104a	Dublin	CA	94568-2951
Sara Pang	Dublin Dental Care	6851 Amador Plaza Rd # 104b	Dublin	CA	94568-2957
Steve Crowe	Carrows Restaurant	7505 Dublin Blvd	Dublin	CA	94568-2901

TABLE 1

OCCUPANT CONTACTS WITHIN 200 FEET OF SITE

Crown Chevrolet
7544 Dublin Boulevard and 6707 Golden Gate Drive
Dublin, California

Name	Company	Address	City	State	Zip
Lori Murphy	Bank of the West	7533 Dublin Blvd	Dublin	CA	94568-2901
Owner/Occupant	Crown Gm Parts Warehouse	7544 Dublin Blvd	Dublin	CA	94568-2902
Jennifer Hurst	Tri Valley Collision Ctr	7544 Dublin Blvd	Dublin	CA	94568-2902
Jalon Jacobsen	Bassett Furniture Direct	7575 Dublin Blvd	Dublin	CA	94568-2901
Owner/Occupant	Chase	7600 Dublin Blvd # 101	Dublin	CA	94568-2944
Owner/Occupant	Bay Breeze Dental	7600 Dublin Blvd # 150	Dublin	CA	94568-2911
Owner/Occupant	Cornerstone Environmental	7600 Dublin Blvd # 200	Dublin	CA	94568-2944
Owner/Occupant	First National Home Loans	7600 Dublin Blvd # 200	Dublin	CA	94568-2944
Dean Wilson	Employment Research Svc	7600 Dublin Blvd # 220	Dublin	CA	94568-2944
Owner/Occupant	Steven S Falls	7600 Dublin Blvd # 220	Dublin	CA	94568-2944
Brian Cereghino	IPAC Inc	7600 Dublin Blvd # 240	Dublin	CA	94568-2908
Owner/Occupant	Hilti Inc	7600 Dublin Blvd # 275	Dublin	CA	94568-2911
Jason Franco	JVFCConsulting Llc	7600 Dublin Blvd # 290	Dublin	CA	94568-2911

TABLE 2

OWNER CONTACTS WITHIN 200 FEET OF SITE

Crown Chevrolet
 7544 Dublin Boulevard and 6707 Golden Gate Drive
 Dublin, California

Name	Company	Address1	Address2	City	State	ZIP	Site Address
Owner/Occupant	Chabot Las Positas Comm College Dist	5020 Franklin Dr		Pleasanton	CA	94588	7600 Dublin Blvd
Terri Costello	Terri Costello	571 Hartz Ave		Danville	CA	94526	7544 Amador Plaza Rd
Owner/Occupant	Safeway	5981 Stoneridge Mall Rd		Pleasanton	CA	94588	6851 Amador Plaza Rd
Owner/Occupant	Enea Plaza/Pier 1 Imports	301 Commerce St	Suite 600	Fort Worth	TX	76102	6700 Amador Plaza Rd
Owner/Occupant	Enea Properties Co, LLC	190 Hartz Ave	Suite 260	Danville	CA	94526	6698 Amador Plaza Rd
Owner/Occupant	St Michael Investments	190 Hartz Ave	Suite 260	Danville	CA	94526	6694 Amador Plaza Rd
Owner/Occupant	Burlington Coat Factory Realty of Dublin Inc	1830 Route 130N		Burlington	NJ	08016	7575 Dublin Blvd
George Hites	George Hites	5601 Arnold Rd	#101	Dublin	CA	94568	6690 Amador Plaza Rd
Owner/Occupant	Enea Plaza	6701 Amador Plaza Rd		Dublin	CA	94568	6701 Amador Plaza Rd
Owner/Occupant	State of California	P O Box 23440		Oakland	CA	94623	6701 Amador Plaza Rd
Owner/Occupant	PK II DUBLIN RETAIL CENTER	3333 NEW HYDE PARK RD	#100	N HYDE PARK	NY	11042	
Owner/Occupant	RANDALLS FOOD & DRUGS LP	1371 OAKLAND BLVD	#200	ALNUT CREEK	CA	94596	
Owner/Occupant	AMB DUBLIN LLC	60 STATE ST	#1200	Boston	MA	02109	
Owner/Occupant	ESSEX PORTFOLIO LP	925 EAST MEADOW DR		Palo Alto	CA	94303	
Owner/Occupant	NUNBERG BARBARA	370 FAIR OAKS ST		San Francisco	CA	94110	
Owner/Occupant	PFRS DUBLIN CORP	100 RIVER PL	#300	Detroit	MI	48207	

TABLE 3

STAKEHOLDER CONTACTS

Crown Chevrolet
7544 Dublin Boulevard and 6707 Golden Gate Drive
Dublin, California

Name	Title	Organization	Address	City	State	Zip Code	Email
State and Federal Elected Officials							
Lori Hancock	Senator	District 9, California State Senate	1515 Clay Street, Suite 2202	Dublin	CA	94612	
Mary Hayashi	Assembly Member	District 18, California State Assembly	22320 Foothill Boulevard, Suite 540	Hayward	CA	94541	
Jerry McNearney	Congressman	California's 11 th District, U.S. Congress	5776 Stoneridge Mall Road, #175	Pleasanton	CA	94588	
County of Alameda							
Scott Haggerty	District 1 Supervisor	Alameda County Board of Supervisors	1221 Oak Street, Suite 536	Oakland	CA	94612	
Richard Valle	District 2 Supervisor	Alameda County Board of Supervisors	1221 Oak Street, Suite 536	Oakland	CA	94612	
Wilma Chan	District 3 Supervisor	Alameda County Board of Supervisors	1221 Oak Street, Suite 536	Oakland	CA	94612	
Nathan Miley	District 4 Supervisor/Vice President	Alameda County Board of Supervisors	1221 Oak Street, Suite 536	Oakland	CA	94612	
Keith Carson	District 5 Supervisor	Alameda County Board of Supervisors	1221 Oak Street, Suite 536	Oakland	CA	94612	
Crystal Hishida Graff	Clerk of the Board	County of Alameda	1221 Oak Street, Room 536	Oakland	CA	94612	
Susan Muranishi	County Administrator	County of Alameda	1221 Oak Street, Room 555	Oakland	CA	94612	
Daniel Woldesenbet	Public Works Agency Director and County Engineer	County of Alameda	399 Elmhurst Street	Hayward	CA	94544	info@acpwa.org
Ron Browder	Environmental Health Director	County of Alameda	1131 Harbor Bay Parkway	Alameda	CA	6577	Ronald.browder@acgov.org
Sheldon Gilbert	Fire Chief	County of Alameda	835 East 14 th Street, Suite 200	San Leandro	CA	94577	rdoyle@ebparks.org
Stephen Hill		SFRWQCB	1515 Clay Street, Suite 1400	Oakland	CA	94612	SHill@waterboards.ca.gov
Michelle L. Starratt	Assistant Housing Director	Alameda County Community Development Agency	224 W. Winton Avenue, Room 108	Hayward	CA	94544-1215	michelle.starratt@acgov.org
City of Dublin							
Gregory Shreeve Sr.	Building Official	City of Dublin	100 Civic Drive Plaza	Dublin	CA	94568	
Chris Foss	Assistant City Manager	City of Dublin	100 Civic Drive Plaza	Dublin	CA	94568	chris.foss@ci.dublin.ca.us
Linda Smith	Economic Development Director/ Public Information Officer	City of Dublin	100 Civic Drive Plaza	Dublin	CA	94568	
Tim Sbranti	Mayor	City of Dublin	100 Civic Plaza	Dublin	CA	94568	tim.sbranti@ci.dublin.ca.us
Kevin Hart	Vice Mayor	City of Dublin	100 Civic Plaza	Dublin	CA	94568	kevin.hart@dublin.ca.gov
Don Biddle	Councilmember	City of Dublin	100 Civic Plaza	Dublin	CA	94568	don.biddle@ci.dublin.ca.us
Kasie Hildenbrand	Councilmember	City of Dublin	100 Civic Plaza	Dublin	CA	94568	kasie.hildenbrand@dublin.ca.gov
Eric Swalwell	Councilmember	City of Dublin	100 Civic Plaza	Dublin	CA	94568	eric.swalwell@dublin.ca.gov
Caroline Soto	City Clerk	City of Dublin	100 Civic Plaza	Dublin	CA	94568	city.clerk@dublin.ca.gov
Joni Pattillo	City Manager	City of Dublin	100 Civic Plaza	Dublin	CA	94568	city.manager@dublin.ca.gov
Gary Huisingh	Director, Public Works	City of Dublin	100 Civic Plaza	Dublin	CA	94568	public.works@ci.dublin.ca.us
Jeff Baker	Planning Manager, Community Development Department	City of Dublin	100 Civic Plaza	Dublin	CA	94568	Jeff.baker@ci.dublin.ca.us
Jeri Ram	Director, Community Development Department	City of Dublin	100 Civic Plaza	Dublin	CA	94568	Jeri.ram@ci.dublin.ca.us
Sheldon Gilbert	Fire Chief	Alameda County Fire Department	835 E 14 th Street, Suite 200	San Leandro	CA	94577	
Bonnie Terra	Fire Marshal	Alameda County Fire Department	835 E 14 th Street, Suite 200	San Leandro	CA	94577	
Chuck Tyler	Chairman of the Board	Dublin Chamber of Commerce	7080 Donlon Way	Dublin	CA	94568	info2@dublinchamberofcommerce.org

TABLE 3

STAKEHOLDER CONTACTS

Crown Chevrolet
7544 Dublin Boulevard and 6707 Golden Gate Drive
Dublin, California

Name	Title	Organization	Address	City	State	Zip Code	Email
Nancy Feeley	President/CEO	Dublin Chamber of Commerce	7080 Donlon Way	Dublin	CA	94568	info2@dublinchamberofcommerce.org
Stephen Hanke	Superintendent	Dublin Unified School District	7471 Larkdale Avenue	Dublin	CA	94568	HankeStephen@dublinusd.org
Valerie Williams	Assistant Superintendent	Dublin Unified School District	7471 Larkdale Avenue	Dublin	CA	94568	WilliamsValerie@dublinusd.org
Local Contacts							
		Epic Care	6380 Clark Avenue	Dublin	CA	94568	
	Administrative Office	Fountainhead Montessori	6665 Amador Plaza Road, #200	Dublin	CA	94568	info@fms.org
Polly Pagnini	Contact	Tots University	7890 Oxbow Lane	Dublin	CA	94568	
Arianna Macias	Director	Bright Horizons at Dublin	7035 Dublin Boulevard	Dublin	CA	94568	
Lori Carrillo	Center Director	KinderCare Learning Center	11925 Amador Valley Court	Dublin	CA	94568	
Candi Llano	Director, Children and Youth Ministry	Resurrection Lutheran Preschool	7557 Amador Valley Boulevard	Dublin	CA	94568	resluth@pacbell.net
		Montessori Plus	7238 San Ramon Road	Dublin	CA	94568	
		American Baptist Home of the West	6120 Stoneridge Mall Road, 3 rd Floor	Pleasanton	CA	94588	info@abhow.com
Faye Blackman	Senior Project Developer	Eden Housing, Inc.	22645 Grand Street	Hayward	CA	94541	
Linda Mandolini	Executive Director	Eden Housing	22645 Grand Street	Hayward	CA	94541	
Media							
Autumn Johnson	Contributor/Editor	Dublin Patch					autumn.johnson@patch.com
Robert Jordan	Pleasanton, Dublin and Education Reporter	Contra Costa Times	2460 Shadelands Drive	Walnut Creek	CA	94598	rjordan@bayareanewsgroup.com
Paul Thissen	Pleasanton, Dublin, San Ramon, Livermore, Livermore Schools and Las Positas Community College District Reporter	Contra Costa Times	2460 Shadelands Drive	Walnut Creek	CA	94598	pthissen@bayareanewsgroup.com