

RECEIVED

By Alameda County Environmental Health 1:19 pm, Apr 07, 2017

PERJURY STATEMENT

**Subject: 1395 MacArthur Boulevard, San Leandro, California
Remedial Status Report – First Quarter 2017**

I certify, under penalty of law, that I have personally examined and am familiar with the information submitted in this document and all attachments, and that, based on my inquiry of those individuals immediately responsible for obtaining the information, I believe the information is true, accurate, and complete. I am aware that there are significant penalties for submitting false information, including the possibility of fine and imprisonment.



4-4-17

Mr. Sayed Hussain, agent for
ESC PARTNERS, L. P. and
Mr. William Matthew Brooks
4725 Thornton Avenue
Fremont, CA, 94536

Remedial Status Report – First Quarter 2017
SWISS VALLEY CLEANERS
1395 MacArthur Boulevard, San Leandro, California

30 March 2017
AGE-Project No. 12-2461

PREPARED FOR:

Mr. William Matthew Brooks
ARDENBROOK

PREPARED BY:

AdvancedGeo
Environmental



An Employee-Owned Company

Environmental • Compliance • Industrial Hygiene • Geotechnical

Phone: 800-511-9300

Fax: 888-445-8786

www.advgeoenv.com

“Working in Partnership with People, Business and the Environment”

Remediation Status Report - First Quarter 2017
SWISS VALLEY CLEANERS
1395 MacArthur Boulevard, San Leandro, California

30 March 2107
AGE-Project No. 12-2461

AdvancedGeo
Environmental



An Employee-Owned Company

Environmental • Compliance • Industrial Hygiene • Geotechnical

Phone: 800-511-9300

Fax: 888-445-8786

www.advgeoenv.com

"Working in Partnership with People, Business and the Environment"

PREPARED BY:

Daniel J. Villanueva
Senior Project Geologist

PROJECT MANAGER:

Daniel J. Villanueva
Senior Project Geologist

REVIEWED BY:

William R. Little
Senior Project Geologist
California Professional Geologist No. 7473

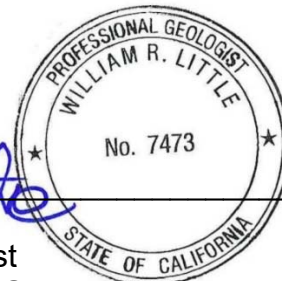

Remediation Status Report – First Quarter 2017
SWISS VALLEY CLEANERS
1395 MacArthur Boulevard, San Leandro, California

<u>SECTION</u>	<u>PAGE</u>
1.0. INTRODUCTION.....	1
2.0. REMEDIAL OPERATION PROCEDURES	1
3.0. REMEDIAL OPERATION FINDINGS	2
4.0. CONCLUSIONS.....	3
5.0. RECOMMENDATIONS.....	3
6.0. LIMITATIONS	4

FIGURES

Figure 1 – *Location Map*

Figure 2 – *Soil-Vapor Well Locations & Trenching Locations*

TABLES

Table 1 – *Well Construction Details*

Table 2 – *SVE Field Parameters*

Table 3 – *Analytical Results of Vapor Samples*

APPENDICES

Appendix A – *Laboratory Analytical Data*

Appendix B – *Soil-Vapor Extracted Volume-Mass Calculations*

Appendix C – *Trend Graph*

Remediation Status Report – First Quarter 2017
SWISS VALLEY CLEANERS
1395 MacArthur Boulevard, San Leandro, California

1.0. INTRODUCTION

At the request of Mr. William Mathew Brooks of Ardenbrook, Inc., Advanced GeoEnvironmental, Inc. (AGE) has prepared this, *Remediation Status Report – First Quarter 2017*, for the Swiss Valley Cleaners site located at 1395 MacArthur Boulevard, San Leandro, California (site). This report documents remedial operation and maintenance of the soil-vapor extraction during the First Quarter 2017. The location of the site is illustrated in Figure 1. A plot plan of the site, SVE wells and trenching locations are illustrated in Figure 2. Well construction details are included as Table 1.

On 11 November 2016, the SVE system began operation under Bay Area Air Quality Management District (BAAQMD) permit application number 28042, plant number 23608. SVE commenced on 11 November 2016 utilizing well network VW-1 through VW-21.

2.0. REMEDIAL OPERATION PROCEDURES

Remedial piping is routed to a moisture knockout vessel and two 1,000-pound granular activated carbon (GAC) vessels and then to a positive displacement blower capable of producing 150 standard cubic feet per minute (scfm). Sampling ports have been installed upstream of the vacuum blower inlet to recover influent soil-vapor stream samples, and downstream of the GAC vessels to recover effluent vapor stream samples to monitor the efficiency of contaminant destruction.

The SVE system was typically monitored on a weekly basis and sampled on a monthly basis. During startup activities the remedial system was monitored daily for the first week of operation.

In order to monitor efficiency of the SVE petroleum vapor recovery system, the following steps were taken: 1) a Magnehelic® vacuum gauge and Dwyer® DS-200 differential pressure sensor were installed before the blower so that the total air flow rate was monitored; the flow rate was determined from the measured differential pressure and the piping diameter using a nomograph; 2) SVE air flow of the influent and effluent streams were monitored routinely for the presence of organic vapor using a Rae® Systems MiniRae3000 organic vapor meter (OVM) equipped with a photo ionization detector (PID-10.6 eV lamp); and 3) influent and effluent vapor flow vapor stream samples were collected from sampling ports installed upstream (influent) of the SVE blower and downstream (effluent) of the carbon treatment system and submitted for laboratory analysis as required by the BAAQMD Permit to Operate (PTO).

Numerous operational parameters are recorded or displayed on the system, including: operational and cumulative system hours (SVE); air temperature after the blower; vacuum generated by the blower; flow of SVE vapor stream; influent OVM readings taken before and after the blower, at each of the carbon vessels, and effluent readings downstream of the carbon treatment system. Table 2 lists each of the parameters measured evaluate system performance and trends.

Additionally, the SVE well network consists of twenty-one shallow screened SVE wells (VW-1 through VW-21) screened from 2 feet to 7 feet bsg. Each well is fitted with a ball valve to allow individual well adjustments. During this operational period all wells were utilized for SVE remediation (Table 2).

During this operational period influent and effluent vapor samples were collected on 19 January, 21 February and 15 March 2017. Samples were collected using a vacuum pump and lung box into Tedlar bags. Samples were submitted to a California Department of Public Health certified laboratory for analysis of full-scan Volatile Organic Compounds (VOCs). Analytical results are included as Appendix A.

3.0. REMEDIAL OPERATION FINDINGS

Data collected during startup and the first quarter 2017 operation and monitoring events as well as vapor stream sampling was used to determine the efficiency and effectiveness of the on-site remedial SVE system. The following is a summary of findings from the first quarter 2017 operational period.

As of 22 March 2017, the SVE system has been in operation for 2,668.5 hours (equivalent to 112 days). During the first quarter 2017 (27 December and 15 March), the system operated for 1,737.2 hours

The SVE system flow ranged from 168 standard cubic feet per min (scfm) to 200 scfm. System vacuum has been regulated between 6 inches of water to 15 inches of water during the quarter. PID system influent readings were collected from sampling ports before (influent) and after (effluent) the blower during this quarter. Influent readings ranged from 1.3 parts per million by volume (ppmv) to 8 ppmv. Effluent readings were measured at 0.0 ppmv. SVE system parameters are summarized in Table 2.

Influent and effluent vapor samples were collected on 19 January, 21 February and 15 March 2017. Tetrachloroethene (PCE) was detected in three influent samples at concentrations ranging from 2,000 micrograms per cubic meter ($\mu\text{g}/\text{m}^3$) and 8,900 $\mu\text{g}/\text{m}^3$. Constituents of concern were not reported above laboratory reporting limits in any of the effluent samples collected during the first quarter 2017.

No other analytes of concern were reported above laboratory detection limits in the samples collected during the fourth quarter 2016 operational period. SVE influent and effluent samples collected this quarter are summarized in Table 3. The laboratory reports

(McC Campbell Analytical Work Order Nos. 1701740, 1701A14 and 1703750), QA/QC report and chain of custody form are included in Appendix A. The laboratory electronic deliverable format files were QA/QC checked and uploaded to the State Water Board GeoTracker site under confirmation numbers 2423194587, 7729179084 and 7804847419.

MASS REMOVAL

Between 15 December 2016 and 15 March 2017 the SVE unit operated a total of 1,685.1 hours, for the estimation of contaminate mass removal (Table 2). The average analytical results of the influent SVE flow samples, average influent flow rates and the operational periods (i.e. between sampling events) were used to calculate the approximate mass of extracted PCE during this period. During the first quarter 2017, approximately 4.6 pounds of PCE were removed from the soil vapor at the site using SVE remediation. Mass and volume calculations are included in Appendix B.

4.0. CONCLUSIONS

Based upon the data presented in this report, AGE concludes:

- SVE remediation generally operated without down-time during the first quarter 2017 (Table 2);
- PCE was detected at low concentrations in all three influent samples during the first quarter 2017 remediation period. Influent concentrations now appear to be reaching asymptotic levels (see trend graph in Appendix C) and rebound testing should now be considered. Additionally, indoor air concentrations should be evaluated within and in adjacent suites while the system is non-operational to gauge “current” concentrations.
- The total system flow and vacuum observed during the first quarter 2017 is adequate to remove the chlorinated hydrocarbon mass present at the site; and
- Between 15 December 2016 and 15 March 2017, approximately 4.6 pounds of PCE were removed from the shallow subsurface (Appendix B).
- Field measurements of influent sampling and from individual soil-vapor wells indicate that a sufficient PCE mass was removed as a result of SVE operations conducted at the site during the first quarter 2017.

5.0. RECOMMENDATIONS

Based on the findings of the environmental activities performed to date at the site, AGE recommends suspension of operation of the SVE system starting in April 2017. The suspension time will be used to evaluate rebound of PCE impact to the subsurface and indoor air.

6.0. LIMITATIONS

Our professional services were performed using that degree of care and skill ordinarily exercised by environmental consultants practicing in this or similar localities. Findings were based upon analytical results provided by an independent laboratory. Evaluation of the geologic/hydrogeologic conditions at the site for the purpose of this investigation was made from a limited number of available data points (soil-vapor samples) and subsurface conditions may vary away from these data points. No other warranty, expressed or implied, is made as to the professional interpretations, opinions, and recommendations contained in this report.

FIGURES

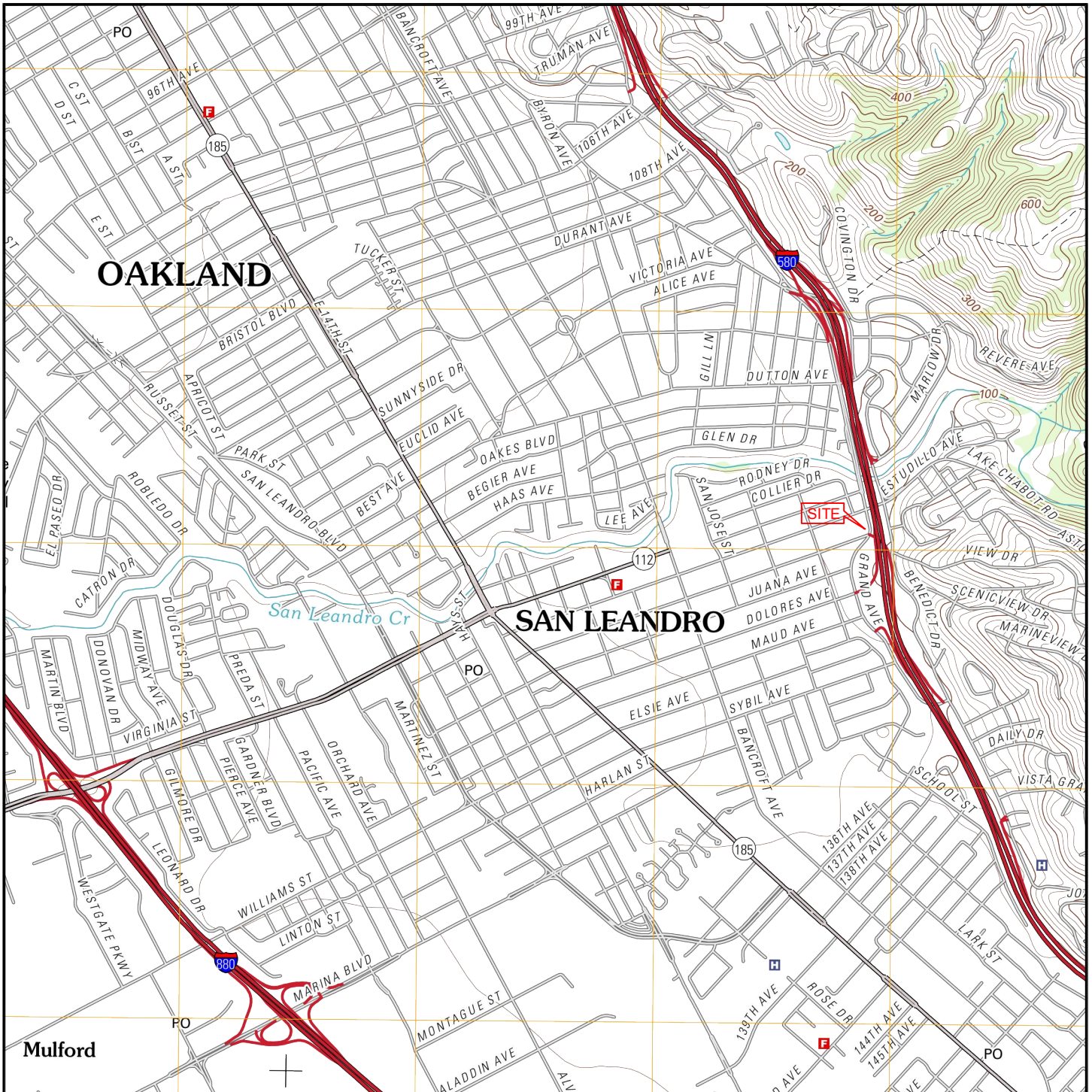

SAN LEANDRO QUADRANGLE, CALIFORNIA
 7.5 MINUTE SERIES (U.S. GEOLOGICAL SURVEY)

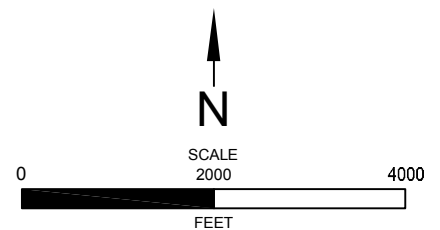

LOCATION MAP
 SWISS VALLEY CLEANERS
 1395 MacArthur Boulevard
 SAN LEANDRO, CALIFORNIA



Advanced
GeoEnvironmental, Inc.
 www.advgeoenv.com

PROJECT NO. AGE-NC-12-2461	FILE: LOCATION	FIGURE:
DATE: 21 MAY, 2013	DRAWN BY: MAC	1

LEGEND

- B60 ○ SOIL BORING LOCATIONS AND DESIGNATIONS
- VW-4 ⊕ SOIL-VAPOR EXTRACTION WELL LOCATION
- SS-1 ⊕ SUB-SLAB VAPOR WELL LOCATION
- ◇ SURFACE DRAIN/SEWER CLEANOUT LOCATION
- SEWER LINE LOCATION
- WATER LINE LOCATION
- CURRENT DRY CLEANING BUILDING
- HISTORICAL DRY CLEANING BUILDING
- ◇ SURFACE DRAIN/SEWER CLEANOUT LOCATION
- - - PROPOSED OR COMPLETED TRENCHING LOCATIONS

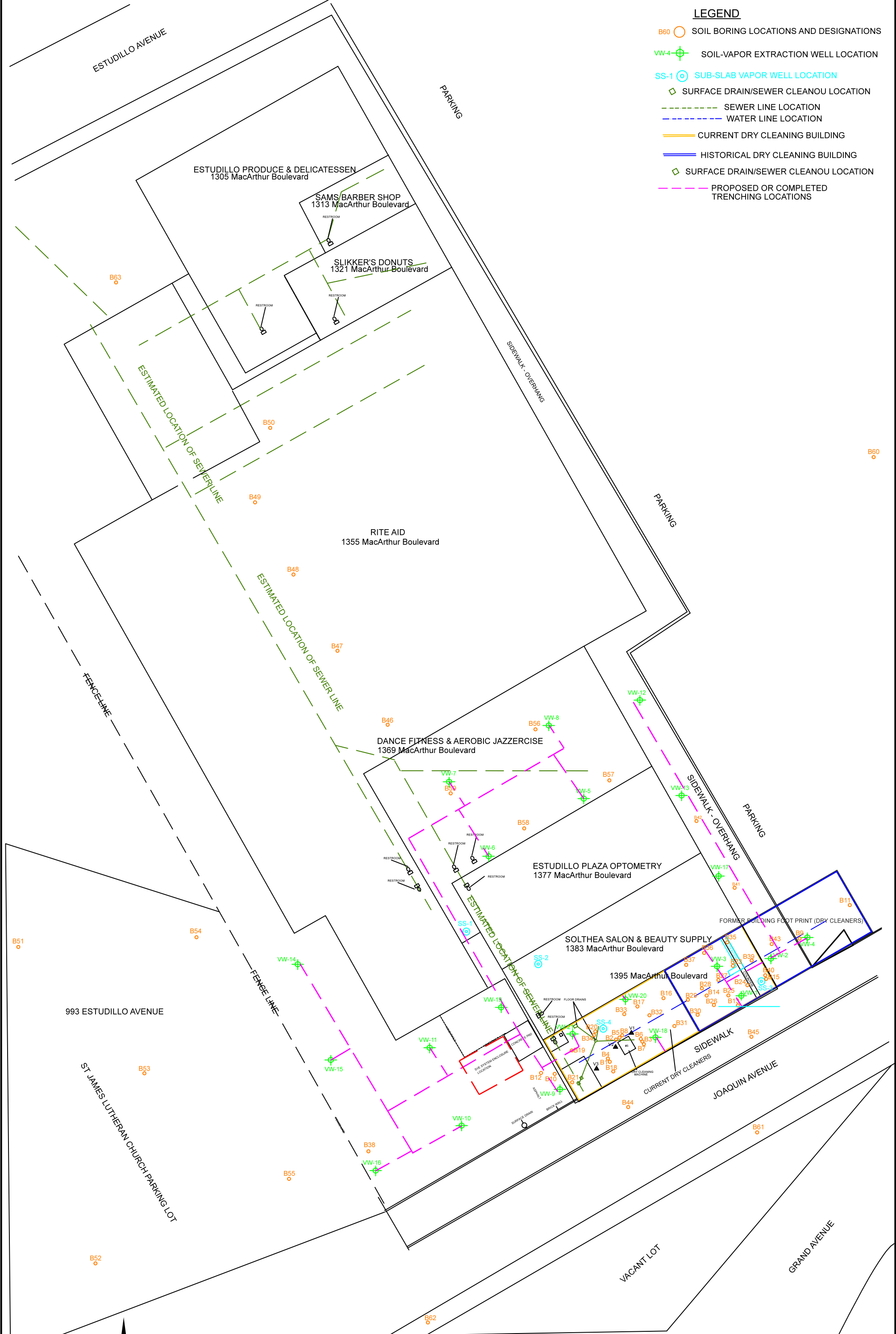

SOIL-VAPOR WELLS & TRENCHING LOCATIONS
SWISS VALLEY CLEANERS
1395 MACARTHUR BOULEVARD
SAN LEANDRO, CALIFORNIA

 Advanced GeoEnvironmental, Inc. www.advgeoenv.com		FIGURE:
PROJECT NO. AGE 12-2461	FILE: FILE	2
DATE: JANUARY 2017	DRAWN BY: MAC	

TABLES

TABLE 1
WELL CONSTRUCTION DETAILS
Swiss Valley Cleaners
1395 MacArthur Boulevard, San Leandro, California

Well ID	Installation Date	Borehole Diameter (inch)	Total Drilled Depth (feet bsg)	Total Well Depth (feet bsg)	Casing Elevation (ft MSL)	Well Casing Material	Slot Size (inch)	Screen Interval (feet)	Filter Pack Interval (feet bsg)	Bentonite Interval (feet bsg)	Grout Interval (feet bsg)	Well Location
VW-1	08-21-2014	7	7	7	NM	PVC	0.020	2 to 7	2 to 7	0.5 to 2	none	1395 MacArthur (Swiss Valley Cleaners)
VW-2	08-21-2014	7	7	7	NM	PVC	0.020	2 to 7	2 to 7	0.5 to 2	none	Front of Facility
VW-3	08-22-2014	7	7	7	NM	PVC	0.020	2 to 7	2 to 7	0.5 to 2	none	1395 MacArthur (Swiss Valley Cleaners)
VW-4	08-22-2014	7	7	7	NM	PVC	0.020	2 to 7	2 to 7	0.5 to 2	none	Front of Facility
VW-5	05-08-2015	7	7	7	NM	PVC	0.020	2 to 7	2 to 7	0.5 to 2	none	1369 MacArthur (Former Jazzercise)
VW-6	05-08-2015	7	7	7	NM	PVC	0.020	2 to 7	2 to 7	0.5 to 2	none	1369 MacArthur (Former Jazzercise)
VW-7	05-08-2015	7	7	7	NM	PVC	0.020	2 to 7	2 to 7	0.5 to 2	none	1369 MacArthur (Former Jazzercise)
VW-8	05-08-2015	7	7	7	NM	PVC	0.020	2 to 7	2 to 7	0.5 to 2	none	1369 MacArthur (Former Jazzercise)
VW-9	08-25-2015	7	7	7	NM	PVC	0.020	2 to 7	2 to 7	0.5 to 2	none	Rear of Facility
VW-10	08-25-2015	7	7	7	NM	PVC	0.020	2 to 7	2 to 7	0.5 to 2	none	Rear of Facility
VW-11	08-25-2015	7	7	7	NM	PVC	0.020	2 to 7	2 to 7	0.5 to 2	none	Rear of Facility
VW-12	08-25-2015	7	7	7	NM	PVC	0.020	2 to 7	2 to 7	0.5 to 2	none	Front of Facility
VW-13	08-25-2015	7	7	7	NM	PVC	0.020	2 to 7	2 to 7	0.5 to 2	none	Front of Facility
VW-14	08-26-2015	7	7	7	NM	PVC	0.020	2 to 7	2 to 7	0.5 to 2	none	Rear of Facility
VW-15	08-26-2015	7	7	7	NM	PVC	0.020	2 to 7	2 to 7	0.5 to 2	none	Rear of Facility
VW-16	08-26-2015	7	7	7	NM	PVC	0.020	2 to 7	2 to 7	0.5 to 2	none	Rear of Facility
VW-17	08-26-2015	7	7	7	NM	PVC	0.020	2 to 7	2 to 7	0.5 to 2	none	Front of Facility
VW-18	08-26-2015	7	7	7	NM	PVC	0.020	2 to 7	2 to 7	0.5 to 2	none	1395 MacArthur (Swiss Valley Cleaners)
VW-19	08-26-2015	7	7	7	NM	PVC	0.020	2 to 7	2 to 7	0.5 to 2	none	Rear of Facility
VW-20	08-27-2015	7	7	7	NM	PVC	0.020	2 to 7	2 to 7	0.5 to 2	none	1395 MacArthur (Swiss Valley Cleaners)
VW-21	08-27-2015	7	7	7	NM	PVC	0.020	2 to 7	2 to 7	0.5 to 2	none	1395 MacArthur (Swiss Valley Cleaners)

Notes:

bsg: below surface grade

NM: Not measured

TABLE 2
SVE FIELD PARAMETERS
 Swiss Valley Cleaners
 1395 MacArthur Boulevard, San Leandro, California

Date	Time	System Hours	Flow (IOW in 3" Pipe)	Flow (SCFM)	Vacuum (IOW)	Influent PID (ppm)	Effluent PID (ppm)	Wells Operational	Total Air Temp (F°)	Total Air Pressure (IOW)
11/11/2016	10:00	22835.8	1.6	164	7.6	16	0	VW-1 through VW-21	121	24
11/14/2016	13:30	22910.5	1.75	170	8.0	4	0	VW-1 through VW-21	123	23
11/15/2016	13:40	22934.4	1.8	172	8.7	10	0	VW-1 through VW-21	120	24
11/16/2016	13:05	22957.8	1.8	172	9.4	10	0	VW-1 through VW-21	120	24
11/17/2016	12:10	22981.0	1.8	172	9.8	11	0	VW-1 through VW-21	118	24
11/22/2016	12:10	23100.9	1.8	172	9.8	8	0	VW-1 through VW-21	118	24
12/1/2016	10:40	23315.5	1.8	172	9.8	9	0	VW-1 through VW-21	116	24
12/6/2016	10:25	23435.9	1.8	172	9.8	8	0	VW-1 through VW-21	112	23
12/15/2016	11:00	23651.9	1.8	172	9.8	5.1	0	VW-1 through VW-21	114	23
12/20/2016	9:10	23767.1	-	-	-	-	-	-	-	-
12/27/2016	11:40	23767.1	1.6	164	-	5.4	0	VW-1 through VW-21	-	25
1/5/2017	9:30	23982.0	1.7	168	14	5	0	VW-1 through VW-21	114	26
1/10/2017	15:50	24101.8	1.75	170	15	4	0	VW-1 through VW-21	112	25
1/19/2017	10:10	24114.0	2.1	185	13	8	0	VW-1 through VW-21	112	28
2/1/2017	10:35	24426.4	2.4	200	12	1.3	0	VW-1 through VW-21	120	-
2/13/2017	12:15	24715.9	2.4	200	6	1.7	0	VW-1 through VW-21	120	-
2/21/2017	10:30	24906.2	2.4	200	6	1.5	0	VW-1 through VW-21	120	-
2/24/2017	11:17	24979.0	2.1	185	10	1.6	0	VW-1 through VW-21	115	28
3/1/2017	10:15	25097.5	2.1	185	10	1.6	0	VW-1 through VW-21	117	26
3/7/2017	11:15	25146.3	2.1	185	8	2.7	0	VW-1 through VW-21	112	25
3/15/2017	11:01	25337.0	2.1	185	8.4	1.1	0	VW-1 through VW-21	124	27
3/22/2017	10:20	25504.3	2.1	185	8	2.8	0	VW-1 through VW-21	116	26

Notes:

- IOW: Inches of Water
- SCFM: standard cubic feet per minute
- ppm: parts per million
- F°: Degrees Fahrenheit

TABLE 3
SVE PILOT TEST SOIL VAPOR ANALYTICAL DATA
 Swiss Valley Cleaners
 1395 MacArthur Boulevard, San Leandro, California

Sample ID	Date	EPA 8260B					
		Tetrachloroethene (PCE)	Trichloroethene (TCE)	1,1- Dichloroethene (1,1-DCE)	Trans 1,2- Dichloroethene (Trans 1,2-DCE)	Cis 1,2- Dichloroethene (Cis 1,2-DCE)	Vinyl Chloride (VC)
Influent/Vapor	11-11-2016	20,000	<250	<250	<250	<250	<250
	11-14-2016	13,000	<1,000	<1,000	<1,000	<1,000	<1,000
	11-15-2016	5,000	<1,000	<1,000	<1,000	<1,000	<1,000
	11-16-2016	6,000	<1,000	<1,000	<1,000	<1,000	<1,000
	11-17-2016	<1,000	<1,000	<1,000	<1,000	<1,000	<1,000
	12-15-2016	3,400	<250	<250	<250	<250	<250
	01-19-2017	8,900	<250	<250	<250	<250	<250
	02-21-2017	2,100	<250	<250	<250	<250	<250
03-15-2017	2,000	<250	<250	<250	<250	<250	
Effluent	11-11-2016	<250	<250	<250	<250	<250	<250
	11-14-2016	<1,000	<1,000	<1,000	<1,000	<1,000	<1,000
	11-15-2016	<1,000	<1,000	<1,000	<1,000	<1,000	<1,000
	11-16-2016	<1,000	<1,000	<1,000	<1,000	<1,000	<1,000
	11-17-2016	<1,000	<1,000	<1,000	<1,000	<1,000	<1,000
	12-15-2016	<250	<250	<250	<250	<250	<250
	01-19-2017	<250	<250	<250	<250	<250	<250
	02-21-2017	<250	<250	<250	<250	<250	<250
	03-15-2017	<250	<250	<250	<250	<250	<250

Notes:

All sample concentrations reported in micrograms per cubic meter

<: Indicates constituents were not detected at a concentration greater than the reporting limit shown.

NA: Not analyzed.

APPENDIX A



McC Campbell Analytical, Inc.

"When Quality Counts"

Analytical Report

WorkOrder: 1701740

Report Created for: Advanced GeoEnvironmental, Inc.

837 Shaw Road
Stockton, CA 95215

Project Contact: Daniel Villanueva

Project P.O.:

Project Name: Swiss Valley Cleaners

Project Received: 01/19/2017

Analytical Report reviewed & approved for release on 01/23/2017 by:

Angela Rydelius,
Laboratory Manager

The report shall not be reproduced except in full, without the written approval of the laboratory. The analytical results relate only to the items tested. Results reported conform to the most current NELAP standards, where applicable, unless otherwise stated in the case narrative.





Glossary of Terms & Qualifier Definitions

Client: Advanced GeoEnvironmental, Inc.
Project: Swiss Valley Cleaners
WorkOrder: 1701740

Glossary Abbreviation

%D	Serial Dilution Percent Difference
95% Interval	95% Confident Interval
DF	Dilution Factor
DI WET	(DISTLC) Waste Extraction Test using DI water
DISS	Dissolved (direct analysis of 0.45 µm filtered and acidified water sample)
DLT	Dilution Test (Serial Dilution)
DUP	Duplicate
EDL	Estimated Detection Limit
ITEF	International Toxicity Equivalence Factor
LCS	Laboratory Control Sample
MB	Method Blank
MB % Rec	% Recovery of Surrogate in Method Blank, if applicable
MDL	Method Detection Limit
ML	Minimum Level of Quantitation
MS	Matrix Spike
MSD	Matrix Spike Duplicate
N/A	Not Applicable
ND	Not detected at or above the indicated MDL or RL
NR	Data Not Reported due to matrix interference or insufficient sample amount.
PDS	Post Digestion Spike
PDSD	Post Digestion Spike Duplicate
PF	Prep Factor
RD	Relative Difference
RL	Reporting Limit (The RL is the lowest calibration standard in a multipoint calibration.)
RPD	Relative Percent Deviation
RRT	Relative Retention Time
SPK Val	Spike Value
SPKRef Val	Spike Reference Value
SPLP	Synthetic Precipitation Leachate Procedure
ST	Sorbent Tube
TCLP	Toxicity Characteristic Leachate Procedure
TEQ	Toxicity Equivalents
WET (STLC)	Waste Extraction Test (Soluble Threshold Limit Concentration)

Analytical Qualifiers

H samples were analyzed out of holding time



Analytical Report

Client: Advanced GeoEnvironmental, Inc.
Date Received: 1/19/17 12:45
Date Prepared: 1/19/17
Project: Swiss Valley Cleaners

WorkOrder: 1701740
Extraction Method: SW5030B
Analytical Method: SW8260B
Unit: µg/L

Volatile Organics

Client ID	Lab ID	Matrix	Date Collected	Instrument	Batch ID
Influent/Vapor	1701740-001A	Air	01/19/2017 11:25	GC18	132899

Analytes	Result	RL	DF	Date Analyzed
tert-Amyl methyl ether (TAME)	ND	0.25	1	01/19/2017 14:20
Benzene	ND	0.25	1	01/19/2017 14:20
Bromobenzene	ND	0.25	1	01/19/2017 14:20
Bromochloromethane	ND	0.25	1	01/19/2017 14:20
Bromodichloromethane	ND	0.25	1	01/19/2017 14:20
Bromoform	ND	0.25	1	01/19/2017 14:20
Bromomethane	ND	0.25	1	01/19/2017 14:20
t-Butyl alcohol (TBA)	ND	2.5	1	01/19/2017 14:20
n-Butyl benzene	ND	0.25	1	01/19/2017 14:20
sec-Butyl benzene	ND	0.25	1	01/19/2017 14:20
tert-Butyl benzene	ND	0.25	1	01/19/2017 14:20
Carbon Disulfide	ND	0.25	1	01/19/2017 14:20
Carbon Tetrachloride	ND	0.25	1	01/19/2017 14:20
Chlorobenzene	ND	0.25	1	01/19/2017 14:20
Chloroethane	ND	0.25	1	01/19/2017 14:20
Chloroform	ND	0.25	1	01/19/2017 14:20
Chloromethane	ND	0.25	1	01/19/2017 14:20
2-Chlorotoluene	ND	0.25	1	01/19/2017 14:20
4-Chlorotoluene	ND	0.25	1	01/19/2017 14:20
Dibromochloromethane	ND	0.25	1	01/19/2017 14:20
1,2-Dibromo-3-chloropropane	ND	0.25	1	01/19/2017 14:20
1,2-Dibromoethane (EDB)	ND	0.25	1	01/19/2017 14:20
Dibromomethane	ND	0.25	1	01/19/2017 14:20
1,2-Dichlorobenzene	ND	0.25	1	01/19/2017 14:20
1,3-Dichlorobenzene	ND	0.25	1	01/19/2017 14:20
1,4-Dichlorobenzene	ND	0.25	1	01/19/2017 14:20
Dichlorodifluoromethane	ND	0.25	1	01/19/2017 14:20
1,1-Dichloroethane	ND	0.25	1	01/19/2017 14:20
1,2-Dichloroethane (1,2-DCA)	ND	0.25	1	01/19/2017 14:20
1,1-Dichloroethene	ND	0.25	1	01/19/2017 14:20
cis-1,2-Dichloroethene	ND	0.25	1	01/19/2017 14:20
trans-1,2-Dichloroethene	ND	0.25	1	01/19/2017 14:20
1,2-Dichloropropane	ND	0.25	1	01/19/2017 14:20
1,3-Dichloropropane	ND	0.25	1	01/19/2017 14:20
2,2-Dichloropropane	ND	0.25	1	01/19/2017 14:20
1,1-Dichloropropene	ND	0.25	1	01/19/2017 14:20
cis-1,3-Dichloropropene	ND	0.25	1	01/19/2017 14:20

(Cont.)



Analytical Report

Client: Advanced GeoEnvironmental, Inc.
Date Received: 1/19/17 12:45
Date Prepared: 1/19/17
Project: Swiss Valley Cleaners

WorkOrder: 1701740
Extraction Method: SW5030B
Analytical Method: SW8260B
Unit: µg/L

Volatile Organics

Client ID	Lab ID	Matrix	Date Collected	Instrument	Batch ID
Influent/Vapor	1701740-001A	Air	01/19/2017 11:25	GC18	132899

Analytes	Result	RL	DF	Date Analyzed
trans-1,3-Dichloropropene	ND	0.25	1	01/19/2017 14:20
Diisopropyl ether (DIPE)	ND	0.25	1	01/19/2017 14:20
Ethylbenzene	ND	0.25	1	01/19/2017 14:20
Ethyl tert-butyl ether (ETBE)	ND	0.25	1	01/19/2017 14:20
Freon 113	ND	5.0	1	01/19/2017 14:20
Hexachlorobutadiene	ND	0.25	1	01/19/2017 14:20
Hexachloroethane	ND	0.25	1	01/19/2017 14:20
2-Hexanone	ND	0.25	1	01/19/2017 14:20
Isopropylbenzene	ND	0.25	1	01/19/2017 14:20
4-Isopropyl toluene	ND	0.25	1	01/19/2017 14:20
Methyl-t-butyl ether (MTBE)	ND	0.25	1	01/19/2017 14:20
Methylene chloride	ND	0.25	1	01/19/2017 14:20
n-Propyl benzene	ND	0.25	1	01/19/2017 14:20
Styrene	ND	0.25	1	01/19/2017 14:20
1,1,1,2-Tetrachloroethane	ND	0.25	1	01/19/2017 14:20
1,1,2,2-Tetrachloroethane	ND	0.25	1	01/19/2017 14:20
Tetrachloroethene	8.9	0.25	1	01/19/2017 14:20
Toluene	ND	0.25	1	01/19/2017 14:20
1,2,3-Trichlorobenzene	ND	0.25	1	01/19/2017 14:20
1,2,4-Trichlorobenzene	ND	0.25	1	01/19/2017 14:20
1,1,1-Trichloroethane	ND	0.25	1	01/19/2017 14:20
1,1,2-Trichloroethane	ND	0.25	1	01/19/2017 14:20
Trichloroethene	ND	0.25	1	01/19/2017 14:20
Trichlorofluoromethane	ND	0.25	1	01/19/2017 14:20
1,2,3-Trichloropropane	ND	0.25	1	01/19/2017 14:20
1,2,4-Trimethylbenzene	ND	0.25	1	01/19/2017 14:20
1,3,5-Trimethylbenzene	ND	0.25	1	01/19/2017 14:20
Vinyl Chloride	ND	0.25	1	01/19/2017 14:20
Xylenes, Total	ND	0.25	1	01/19/2017 14:20
Surrogates	REC (%)	Limits		
Dibromofluoromethane	104	70-130		01/19/2017 14:20
Toluene-d8	97	70-130		01/19/2017 14:20
4-BFB	90	70-130		01/19/2017 14:20

Analyst(s): JEM

(Cont.)

NELAP 4033ORELAP

 Angela Rydelius, Lab Manager



Analytical Report

Client: Advanced GeoEnvironmental, Inc.
Date Received: 1/19/17 12:45
Date Prepared: 1/19/17
Project: Swiss Valley Cleaners

WorkOrder: 1701740
Extraction Method: SW5030B
Analytical Method: SW8260B
Unit: µg/L

Volatile Organics

Client ID	Lab ID	Matrix	Date Collected	Instrument	Batch ID
Effluent/Vapor	1701740-002A	Air	01/19/2017 11:27	GC18	132899

Analytes	Result	Qualifiers	RL	DF	Date Analyzed
tert-Amyl methyl ether (TAME)	ND	H	0.25	1	01/19/2017 21:04
Benzene	ND	H	0.25	1	01/19/2017 21:04
Bromobenzene	ND	H	0.25	1	01/19/2017 21:04
Bromochloromethane	ND	H	0.25	1	01/19/2017 21:04
Bromodichloromethane	ND	H	0.25	1	01/19/2017 21:04
Bromoform	ND	H	0.25	1	01/19/2017 21:04
Bromomethane	ND	H	0.25	1	01/19/2017 21:04
t-Butyl alcohol (TBA)	ND	H	2.5	1	01/19/2017 21:04
n-Butyl benzene	ND	H	0.25	1	01/19/2017 21:04
sec-Butyl benzene	ND	H	0.25	1	01/19/2017 21:04
tert-Butyl benzene	ND	H	0.25	1	01/19/2017 21:04
Carbon Disulfide	ND	H	0.25	1	01/19/2017 21:04
Carbon Tetrachloride	ND	H	0.25	1	01/19/2017 21:04
Chlorobenzene	ND	H	0.25	1	01/19/2017 21:04
Chloroethane	ND	H	0.25	1	01/19/2017 21:04
Chloroform	ND	H	0.25	1	01/19/2017 21:04
Chloromethane	ND	H	0.25	1	01/19/2017 21:04
2-Chlorotoluene	ND	H	0.25	1	01/19/2017 21:04
4-Chlorotoluene	ND	H	0.25	1	01/19/2017 21:04
Dibromochloromethane	ND	H	0.25	1	01/19/2017 21:04
1,2-Dibromo-3-chloropropane	ND	H	0.25	1	01/19/2017 21:04
1,2-Dibromoethane (EDB)	ND	H	0.25	1	01/19/2017 21:04
Dibromomethane	ND	H	0.25	1	01/19/2017 21:04
1,2-Dichlorobenzene	ND	H	0.25	1	01/19/2017 21:04
1,3-Dichlorobenzene	ND	H	0.25	1	01/19/2017 21:04
1,4-Dichlorobenzene	ND	H	0.25	1	01/19/2017 21:04
Dichlorodifluoromethane	ND	H	0.25	1	01/19/2017 21:04
1,1-Dichloroethane	ND	H	0.25	1	01/19/2017 21:04
1,2-Dichloroethane (1,2-DCA)	ND	H	0.25	1	01/19/2017 21:04
1,1-Dichloroethene	ND	H	0.25	1	01/19/2017 21:04
cis-1,2-Dichloroethene	ND	H	0.25	1	01/19/2017 21:04
trans-1,2-Dichloroethene	ND	H	0.25	1	01/19/2017 21:04
1,2-Dichloropropane	ND	H	0.25	1	01/19/2017 21:04
1,3-Dichloropropane	ND	H	0.25	1	01/19/2017 21:04
2,2-Dichloropropane	ND	H	0.25	1	01/19/2017 21:04
1,1-Dichloropropene	ND	H	0.25	1	01/19/2017 21:04
cis-1,3-Dichloropropene	ND	H	0.25	1	01/19/2017 21:04

(Cont.)



Analytical Report

Client: Advanced GeoEnvironmental, Inc.
Date Received: 1/19/17 12:45
Date Prepared: 1/19/17
Project: Swiss Valley Cleaners

WorkOrder: 1701740
Extraction Method: SW5030B
Analytical Method: SW8260B
Unit: µg/L

Volatile Organics

Client ID	Lab ID	Matrix	Date Collected	Instrument	Batch ID
Effluent/Vapor	1701740-002A	Air	01/19/2017 11:27	GC18	132899

Analytes	Result	Qualifiers	RL	DF	Date Analyzed
trans-1,3-Dichloropropene	ND	H	0.25	1	01/19/2017 21:04
Diisopropyl ether (DIPE)	ND	H	0.25	1	01/19/2017 21:04
Ethylbenzene	ND	H	0.25	1	01/19/2017 21:04
Ethyl tert-butyl ether (ETBE)	ND	H	0.25	1	01/19/2017 21:04
Freon 113	ND	H	5.0	1	01/19/2017 21:04
Hexachlorobutadiene	ND	H	0.25	1	01/19/2017 21:04
Hexachloroethane	ND	H	0.25	1	01/19/2017 21:04
2-Hexanone	ND	H	0.25	1	01/19/2017 21:04
Isopropylbenzene	ND	H	0.25	1	01/19/2017 21:04
4-Isopropyl toluene	ND	H	0.25	1	01/19/2017 21:04
Methyl-t-butyl ether (MTBE)	ND	H	0.25	1	01/19/2017 21:04
Methylene chloride	ND	H	0.25	1	01/19/2017 21:04
n-Propyl benzene	ND	H	0.25	1	01/19/2017 21:04
Styrene	ND	H	0.25	1	01/19/2017 21:04
1,1,1,2-Tetrachloroethane	ND	H	0.25	1	01/19/2017 21:04
1,1,2,2-Tetrachloroethane	ND	H	0.25	1	01/19/2017 21:04
Tetrachloroethene	ND	H	0.25	1	01/19/2017 21:04
Toluene	ND	H	0.25	1	01/19/2017 21:04
1,2,3-Trichlorobenzene	ND	H	0.25	1	01/19/2017 21:04
1,2,4-Trichlorobenzene	ND	H	0.25	1	01/19/2017 21:04
1,1,1-Trichloroethane	ND	H	0.25	1	01/19/2017 21:04
1,1,2-Trichloroethane	ND	H	0.25	1	01/19/2017 21:04
Trichloroethene	ND	H	0.25	1	01/19/2017 21:04
Trichlorofluoromethane	ND	H	0.25	1	01/19/2017 21:04
1,2,3-Trichloropropane	ND	H	0.25	1	01/19/2017 21:04
1,2,4-Trimethylbenzene	ND	H	0.25	1	01/19/2017 21:04
1,3,5-Trimethylbenzene	ND	H	0.25	1	01/19/2017 21:04
Vinyl Chloride	ND	H	0.25	1	01/19/2017 21:04
Xylenes, Total	ND	H	0.25	1	01/19/2017 21:04
Surrogates	REC (%)	Qualifiers	Limits		
Dibromofluoromethane	104	H	70-130		01/19/2017 21:04
Toluene-d8	98	H	70-130		01/19/2017 21:04
4-BFB	93	H	70-130		01/19/2017 21:04

Analyst(s): JEM



Analytical Report

Client: Advanced GeoEnvironmental, Inc.
Date Received: 1/19/17 12:45
Date Prepared: 1/19/17
Project: Swiss Valley Cleaners

WorkOrder: 1701740
Extraction Method: SW5030B
Analytical Method: SW8260B
Unit: µg/m³

Volatile Organics by P&T and GC/MS (Basic Target List)

Client ID	Lab ID	Matrix	Date Collected	Instrument	Batch ID
Influent/Vapor	1701740-001A	Air	01/19/2017 11:25	GC18	132899

Analytes	Result	RL	DF	Date Analyzed
tert-Amyl methyl ether (TAME)	ND	250	1	01/19/2017 14:20
Benzene	ND	250	1	01/19/2017 14:20
Bromobenzene	ND	250	1	01/19/2017 14:20
Bromochloromethane	ND	250	1	01/19/2017 14:20
Bromodichloromethane	ND	250	1	01/19/2017 14:20
Bromoform	ND	250	1	01/19/2017 14:20
Bromomethane	ND	250	1	01/19/2017 14:20
t-Butyl alcohol (TBA)	ND	2500	1	01/19/2017 14:20
n-Butyl benzene	ND	250	1	01/19/2017 14:20
sec-Butyl benzene	ND	250	1	01/19/2017 14:20
tert-Butyl benzene	ND	250	1	01/19/2017 14:20
Carbon Disulfide	ND	250	1	01/19/2017 14:20
Carbon Tetrachloride	ND	250	1	01/19/2017 14:20
Chlorobenzene	ND	250	1	01/19/2017 14:20
Chloroethane	ND	250	1	01/19/2017 14:20
Chloroform	ND	250	1	01/19/2017 14:20
Chloromethane	ND	250	1	01/19/2017 14:20
2-Chlorotoluene	ND	250	1	01/19/2017 14:20
4-Chlorotoluene	ND	250	1	01/19/2017 14:20
Dibromochloromethane	ND	250	1	01/19/2017 14:20
1,2-Dibromo-3-chloropropane	ND	250	1	01/19/2017 14:20
1,2-Dibromoethane (EDB)	ND	250	1	01/19/2017 14:20
Dibromomethane	ND	250	1	01/19/2017 14:20
1,2-Dichlorobenzene	ND	250	1	01/19/2017 14:20
1,3-Dichlorobenzene	ND	250	1	01/19/2017 14:20
1,4-Dichlorobenzene	ND	250	1	01/19/2017 14:20
Dichlorodifluoromethane	ND	250	1	01/19/2017 14:20
1,1-Dichloroethane	ND	250	1	01/19/2017 14:20
1,2-Dichloroethane (1,2-DCA)	ND	250	1	01/19/2017 14:20
1,1-Dichloroethene	ND	250	1	01/19/2017 14:20
cis-1,2-Dichloroethene	ND	250	1	01/19/2017 14:20
trans-1,2-Dichloroethene	ND	250	1	01/19/2017 14:20
1,2-Dichloropropane	ND	250	1	01/19/2017 14:20
1,3-Dichloropropane	ND	250	1	01/19/2017 14:20
2,2-Dichloropropane	ND	250	1	01/19/2017 14:20
1,1-Dichloropropene	ND	250	1	01/19/2017 14:20
cis-1,3-Dichloropropene	ND	250	1	01/19/2017 14:20

(Cont.)



Analytical Report

Client: Advanced GeoEnvironmental, Inc.
Date Received: 1/19/17 12:45
Date Prepared: 1/19/17
Project: Swiss Valley Cleaners

WorkOrder: 1701740
Extraction Method: SW5030B
Analytical Method: SW8260B
Unit: µg/m³

Volatile Organics by P&T and GC/MS (Basic Target List)

Client ID	Lab ID	Matrix	Date Collected	Instrument	Batch ID
Influent/Vapor	1701740-001A	Air	01/19/2017 11:25	GC18	132899

Analytes	Result	RL	DF	Date Analyzed
trans-1,3-Dichloropropene	ND	250	1	01/19/2017 14:20
Diisopropyl ether (DIPE)	ND	250	1	01/19/2017 14:20
Ethylbenzene	ND	250	1	01/19/2017 14:20
Ethyl tert-butyl ether (ETBE)	ND	250	1	01/19/2017 14:20
Freon 113	ND	5000	1	01/19/2017 14:20
Hexachlorobutadiene	ND	250	1	01/19/2017 14:20
Hexachloroethane	ND	250	1	01/19/2017 14:20
2-Hexanone	ND	250	1	01/19/2017 14:20
Isopropylbenzene	ND	250	1	01/19/2017 14:20
4-Isopropyl toluene	ND	250	1	01/19/2017 14:20
Methyl-t-butyl ether (MTBE)	ND	250	1	01/19/2017 14:20
Methylene chloride	ND	250	1	01/19/2017 14:20
n-Propyl benzene	ND	250	1	01/19/2017 14:20
Styrene	ND	250	1	01/19/2017 14:20
1,1,1,2-Tetrachloroethane	ND	250	1	01/19/2017 14:20
1,1,2,2-Tetrachloroethane	ND	250	1	01/19/2017 14:20
Tetrachloroethene	8900	250	1	01/19/2017 14:20
Toluene	ND	250	1	01/19/2017 14:20
1,2,3-Trichlorobenzene	ND	250	1	01/19/2017 14:20
1,2,4-Trichlorobenzene	ND	250	1	01/19/2017 14:20
1,1,1-Trichloroethane	ND	250	1	01/19/2017 14:20
1,1,2-Trichloroethane	ND	250	1	01/19/2017 14:20
Trichloroethene	ND	250	1	01/19/2017 14:20
Trichlorofluoromethane	ND	250	1	01/19/2017 14:20
1,2,3-Trichloropropane	ND	250	1	01/19/2017 14:20
1,2,4-Trimethylbenzene	ND	250	1	01/19/2017 14:20
1,3,5-Trimethylbenzene	ND	250	1	01/19/2017 14:20
Vinyl Chloride	ND	250	1	01/19/2017 14:20
Xylenes, Total	ND	250	1	01/19/2017 14:20
Surrogates	REC (%)	Limits		
Dibromofluoromethane	104	70-130		01/19/2017 14:20
Toluene-d8	97	70-130		01/19/2017 14:20
4-BFB	90	70-130		01/19/2017 14:20

Analyst(s): JEM

(Cont.)

NELAP 4033ORELAP

 Angela Rydelius, Lab Manager



Analytical Report

Client: Advanced GeoEnvironmental, Inc.
Date Received: 1/19/17 12:45
Date Prepared: 1/19/17
Project: Swiss Valley Cleaners

WorkOrder: 1701740
Extraction Method: SW5030B
Analytical Method: SW8260B
Unit: µg/m³

Volatile Organics by P&T and GC/MS (Basic Target List)

Client ID	Lab ID	Matrix	Date Collected	Instrument	Batch ID
Effluent/Vapor	1701740-002A	Air	01/19/2017 11:27	GC18	132899
Analytes	Result	Qualifiers	RL	DF	Date Analyzed
tert-Amyl methyl ether (TAME)	ND	H	250	1	01/19/2017 21:04
Benzene	ND	H	250	1	01/19/2017 21:04
Bromobenzene	ND	H	250	1	01/19/2017 21:04
Bromochloromethane	ND	H	250	1	01/19/2017 21:04
Bromodichloromethane	ND	H	250	1	01/19/2017 21:04
Bromoform	ND	H	250	1	01/19/2017 21:04
Bromomethane	ND	H	250	1	01/19/2017 21:04
t-Butyl alcohol (TBA)	ND	H	2500	1	01/19/2017 21:04
n-Butyl benzene	ND	H	250	1	01/19/2017 21:04
sec-Butyl benzene	ND	H	250	1	01/19/2017 21:04
tert-Butyl benzene	ND	H	250	1	01/19/2017 21:04
Carbon Disulfide	ND	H	250	1	01/19/2017 21:04
Carbon Tetrachloride	ND	H	250	1	01/19/2017 21:04
Chlorobenzene	ND	H	250	1	01/19/2017 21:04
Chloroethane	ND	H	250	1	01/19/2017 21:04
Chloroform	ND	H	250	1	01/19/2017 21:04
Chloromethane	ND	H	250	1	01/19/2017 21:04
2-Chlorotoluene	ND	H	250	1	01/19/2017 21:04
4-Chlorotoluene	ND	H	250	1	01/19/2017 21:04
Dibromochloromethane	ND	H	250	1	01/19/2017 21:04
1,2-Dibromo-3-chloropropane	ND	H	250	1	01/19/2017 21:04
1,2-Dibromoethane (EDB)	ND	H	250	1	01/19/2017 21:04
Dibromomethane	ND	H	250	1	01/19/2017 21:04
1,2-Dichlorobenzene	ND	H	250	1	01/19/2017 21:04
1,3-Dichlorobenzene	ND	H	250	1	01/19/2017 21:04
1,4-Dichlorobenzene	ND	H	250	1	01/19/2017 21:04
Dichlorodifluoromethane	ND	H	250	1	01/19/2017 21:04
1,1-Dichloroethane	ND	H	250	1	01/19/2017 21:04
1,2-Dichloroethane (1,2-DCA)	ND	H	250	1	01/19/2017 21:04
1,1-Dichloroethene	ND	H	250	1	01/19/2017 21:04
cis-1,2-Dichloroethene	ND	H	250	1	01/19/2017 21:04
trans-1,2-Dichloroethene	ND	H	250	1	01/19/2017 21:04
1,2-Dichloropropane	ND	H	250	1	01/19/2017 21:04
1,3-Dichloropropane	ND	H	250	1	01/19/2017 21:04
2,2-Dichloropropane	ND	H	250	1	01/19/2017 21:04
1,1-Dichloropropene	ND	H	250	1	01/19/2017 21:04
cis-1,3-Dichloropropene	ND	H	250	1	01/19/2017 21:04

(Cont.)



Analytical Report

Client: Advanced GeoEnvironmental, Inc.
Date Received: 1/19/17 12:45
Date Prepared: 1/19/17
Project: Swiss Valley Cleaners

WorkOrder: 1701740
Extraction Method: SW5030B
Analytical Method: SW8260B
Unit: µg/m³

Volatile Organics by P&T and GC/MS (Basic Target List)

Client ID	Lab ID	Matrix	Date Collected	Instrument	Batch ID
Effluent/Vapor	1701740-002A	Air	01/19/2017 11:27	GC18	132899

Analytes	Result	Qualifiers	RL	DF	Date Analyzed
trans-1,3-Dichloropropene	ND	H	250	1	01/19/2017 21:04
Diisopropyl ether (DIPE)	ND	H	250	1	01/19/2017 21:04
Ethylbenzene	ND	H	250	1	01/19/2017 21:04
Ethyl tert-butyl ether (ETBE)	ND	H	250	1	01/19/2017 21:04
Freon 113	ND	H	5000	1	01/19/2017 21:04
Hexachlorobutadiene	ND	H	250	1	01/19/2017 21:04
Hexachloroethane	ND	H	250	1	01/19/2017 21:04
2-Hexanone	ND	H	250	1	01/19/2017 21:04
Isopropylbenzene	ND	H	250	1	01/19/2017 21:04
4-Isopropyl toluene	ND	H	250	1	01/19/2017 21:04
Methyl-t-butyl ether (MTBE)	ND	H	250	1	01/19/2017 21:04
Methylene chloride	ND	H	250	1	01/19/2017 21:04
n-Propyl benzene	ND	H	250	1	01/19/2017 21:04
Styrene	ND	H	250	1	01/19/2017 21:04
1,1,1,2-Tetrachloroethane	ND	H	250	1	01/19/2017 21:04
1,1,2,2-Tetrachloroethane	ND	H	250	1	01/19/2017 21:04
Tetrachloroethene	ND	H	250	1	01/19/2017 21:04
Toluene	ND	H	250	1	01/19/2017 21:04
1,2,3-Trichlorobenzene	ND	H	250	1	01/19/2017 21:04
1,2,4-Trichlorobenzene	ND	H	250	1	01/19/2017 21:04
1,1,1-Trichloroethane	ND	H	250	1	01/19/2017 21:04
1,1,2-Trichloroethane	ND	H	250	1	01/19/2017 21:04
Trichloroethene	ND	H	250	1	01/19/2017 21:04
Trichlorofluoromethane	ND	H	250	1	01/19/2017 21:04
1,2,3-Trichloropropane	ND	H	250	1	01/19/2017 21:04
1,2,4-Trimethylbenzene	ND	H	250	1	01/19/2017 21:04
1,3,5-Trimethylbenzene	ND	H	250	1	01/19/2017 21:04
Vinyl Chloride	ND	H	250	1	01/19/2017 21:04
Xylenes, Total	ND	H	250	1	01/19/2017 21:04
Surrogates	REC (%)	Qualifiers	Limits		
Dibromofluoromethane	104	H	70-130		01/19/2017 21:04
Toluene-d8	98	H	70-130		01/19/2017 21:04
4-BFB	93	H	70-130		01/19/2017 21:04

Analyst(s): JEM



Quality Control Report

Client: Advanced GeoEnvironmental, Inc.
Date Prepared: 1/19/17
Date Analyzed: 1/19/17
Instrument: GC18
Matrix: Air
Project: Swiss Valley Cleaners

WorkOrder: 1701740
BatchID: 132899
Extraction Method: SW5030B
Analytical Method: SW8260B
Unit: µg/L
Sample ID: MB/LCS/LCSD-132899

QC Summary Report for SW8260B

Analyte	MB Result	RL	SPK Val	MB SS %REC	MB SS Limits
tert-Amyl methyl ether (TAME)	ND	0.25	-	-	-
Benzene	ND	0.25	-	-	-
Bromobenzene	ND	0.25	-	-	-
Bromochloromethane	ND	0.25	-	-	-
Bromodichloromethane	ND	0.25	-	-	-
Bromoform	ND	0.25	-	-	-
Bromomethane	ND	0.25	-	-	-
t-Butyl alcohol (TBA)	ND	2.5	-	-	-
n-Butyl benzene	ND	0.25	-	-	-
sec-Butyl benzene	ND	0.25	-	-	-
tert-Butyl benzene	ND	0.25	-	-	-
Carbon Disulfide	ND	0.25	-	-	-
Carbon Tetrachloride	ND	0.25	-	-	-
Chlorobenzene	ND	0.25	-	-	-
Chloroethane	ND	0.25	-	-	-
Chloroform	ND	0.25	-	-	-
Chloromethane	ND	0.25	-	-	-
2-Chlorotoluene	ND	0.25	-	-	-
4-Chlorotoluene	ND	0.25	-	-	-
Dibromochloromethane	ND	0.25	-	-	-
1,2-Dibromo-3-chloropropane	ND	0.25	-	-	-
1,2-Dibromoethane (EDB)	ND	0.25	-	-	-
Dibromomethane	ND	0.25	-	-	-
1,2-Dichlorobenzene	ND	0.25	-	-	-
1,3-Dichlorobenzene	ND	0.25	-	-	-
1,4-Dichlorobenzene	ND	0.25	-	-	-
Dichlorodifluoromethane	ND	0.25	-	-	-
1,1-Dichloroethane	ND	0.25	-	-	-
1,2-Dichloroethane (1,2-DCA)	ND	0.25	-	-	-
1,1-Dichloroethene	ND	0.25	-	-	-
cis-1,2-Dichloroethene	ND	0.25	-	-	-
trans-1,2-Dichloroethene	ND	0.25	-	-	-
1,2-Dichloropropane	ND	0.25	-	-	-
1,3-Dichloropropane	ND	0.25	-	-	-
2,2-Dichloropropane	ND	0.25	-	-	-
1,1-Dichloropropene	ND	0.25	-	-	-
cis-1,3-Dichloropropene	ND	0.25	-	-	-
trans-1,3-Dichloropropene	ND	0.25	-	-	-
Diisopropyl ether (DIPE)	ND	0.25	-	-	-

(Cont.)

NELAP 4033ORELAP

 QA/QC Officer



Quality Control Report

Client: Advanced GeoEnvironmental, Inc.
Date Prepared: 1/19/17
Date Analyzed: 1/19/17
Instrument: GC18
Matrix: Air
Project: Swiss Valley Cleaners

WorkOrder: 1701740
BatchID: 132899
Extraction Method: SW5030B
Analytical Method: SW8260B
Unit: µg/L
Sample ID: MB/LCS/LCSD-132899

QC Summary Report for SW8260B

Analyte	MB Result	RL	SPK Val	MB SS %REC	MB SS Limits
Ethylbenzene	ND	0.25	-	-	-
Ethyl tert-butyl ether (ETBE)	ND	0.25	-	-	-
Freon 113	ND	5.0	-	-	-
Hexachlorobutadiene	ND	0.25	-	-	-
Hexachloroethane	ND	0.25	-	-	-
2-Hexanone	ND	0.25	-	-	-
Isopropylbenzene	ND	0.25	-	-	-
4-Isopropyl toluene	ND	0.25	-	-	-
Methyl-t-butyl ether (MTBE)	ND	0.25	-	-	-
Methylene chloride	ND	0.25	-	-	-
n-Propyl benzene	ND	0.25	-	-	-
Styrene	ND	0.25	-	-	-
1,1,1,2-Tetrachloroethane	ND	0.25	-	-	-
1,1,2,2-Tetrachloroethane	ND	0.25	-	-	-
Tetrachloroethene	ND	0.25	-	-	-
Toluene	ND	0.25	-	-	-
1,2,3-Trichlorobenzene	ND	0.25	-	-	-
1,2,4-Trichlorobenzene	ND	0.25	-	-	-
1,1,1-Trichloroethane	ND	0.25	-	-	-
1,1,2-Trichloroethane	ND	0.25	-	-	-
Trichloroethene	ND	0.25	-	-	-
Trichlorofluoromethane	ND	0.25	-	-	-
1,2,3-Trichloropropane	ND	0.25	-	-	-
1,2,4-Trimethylbenzene	ND	0.25	-	-	-
1,3,5-Trimethylbenzene	ND	0.25	-	-	-
Vinyl Chloride	ND	0.25	-	-	-
Xylenes, Total	ND	0.25	-	-	-
Surrogate Recovery					
Dibromofluoromethane	13.04		12.5	104	70-130
Toluene-d8	12.16		12.5	97	70-130
4-BFB	1.279		1.25	102	70-130



Quality Control Report

Client: Advanced GeoEnvironmental, Inc.
Date Prepared: 1/19/17
Date Analyzed: 1/19/17
Instrument: GC18
Matrix: Air
Project: Swiss Valley Cleaners

WorkOrder: 1701740
BatchID: 132899
Extraction Method: SW5030B
Analytical Method: SW8260B
Unit: µg/L
Sample ID: MB/LCS/LCSD-132899

QC Summary Report for SW8260B

Analyte	LCS Result	LCSD Result	SPK Val	LCS %REC	LCSD %REC	LCS/LCSD Limits	RPD	RPD Limit
tert-Amyl methyl ether (TAME)	4.78	4.85	5	96	97	56-133	1.45	30
Benzene	5.62	5.66	5	112	113	72-122	0.785	30
t-Butyl alcohol (TBA)	14.8	15.5	20	74	78	35-121	4.69	30
Chlorobenzene	4.67	4.72	5	93	94	69-112	1.08	30
1,2-Dibromoethane (EDB)	4.59	4.62	5	92	92	62-117	0	30
1,2-Dichloroethane (1,2-DCA)	5.18	5.22	5	103	104	61-126	0.810	30
1,1-Dichloroethene	4.49	4.50	5	90	90	67-122	0	30
Diisopropyl ether (DIPE)	5.80	5.84	5	116	117	61-131	0.709	30
Ethylbenzene	4.82	4.88	5	96	98	71-115	1.18	30
Ethyl tert-butyl ether (ETBE)	5.33	5.37	5	107	107	63-132	0	30
Methyl-t-butyl ether (MTBE)	5.18	5.21	5	104	104	63-127	0	30
Toluene	4.94	4.91	5	99	98	64-115	0.634	30
Trichloroethene	4.73	4.80	5	95	96	66-127	1.37	30
Xylenes, Total	14.3	14.6	15	95	97	53-131	2.05	30
Surrogate Recovery								
Dibromofluoromethane	13.3	13.3	12.5	106	106	83-124	0	30
Toluene-d8	12.4	12.2	12.5	99	97	80-120	1.70	30
4-BFB	1.18	1.26	1.25	95	101	70-129	6.48	30



Quality Control Report

Client: Advanced GeoEnvironmental, Inc.
Date Prepared: 1/19/17
Date Analyzed: 1/19/17
Instrument: GC18
Matrix: Air
Project: Swiss Valley Cleaners

WorkOrder: 1701740
BatchID: 132899
Extraction Method: SW5030B
Analytical Method: SW8260B
Unit: µg/L
Sample ID: MB/LCS/LCSD-132899

QC Summary Report for SW8260B

Analyte	MB Result	RL	SPK Val	MB SS %REC	MB SS Limits
tert-Amyl methyl ether (TAME)	ND	0.25	-	-	-
Benzene	ND	0.25	-	-	-
Bromobenzene	ND	0.25	-	-	-
Bromochloromethane	ND	0.25	-	-	-
Bromodichloromethane	ND	0.25	-	-	-
Bromoform	ND	0.25	-	-	-
Bromomethane	ND	0.25	-	-	-
t-Butyl alcohol (TBA)	ND	2.5	-	-	-
n-Butyl benzene	ND	0.25	-	-	-
sec-Butyl benzene	ND	0.25	-	-	-
tert-Butyl benzene	ND	0.25	-	-	-
Carbon Disulfide	ND	0.25	-	-	-
Carbon Tetrachloride	ND	0.25	-	-	-
Chlorobenzene	ND	0.25	-	-	-
Chloroethane	ND	0.25	-	-	-
Chloroform	ND	0.25	-	-	-
Chloromethane	ND	0.25	-	-	-
2-Chlorotoluene	ND	0.25	-	-	-
4-Chlorotoluene	ND	0.25	-	-	-
Dibromochloromethane	ND	0.25	-	-	-
1,2-Dibromo-3-chloropropane	ND	0.25	-	-	-
1,2-Dibromoethane (EDB)	ND	0.25	-	-	-
Dibromomethane	ND	0.25	-	-	-
1,2-Dichlorobenzene	ND	0.25	-	-	-
1,3-Dichlorobenzene	ND	0.25	-	-	-
1,4-Dichlorobenzene	ND	0.25	-	-	-
Dichlorodifluoromethane	ND	0.25	-	-	-
1,1-Dichloroethane	ND	0.25	-	-	-
1,2-Dichloroethane (1,2-DCA)	ND	0.25	-	-	-
1,1-Dichloroethene	ND	0.25	-	-	-
cis-1,2-Dichloroethene	ND	0.25	-	-	-
trans-1,2-Dichloroethene	ND	0.25	-	-	-
1,2-Dichloropropane	ND	0.25	-	-	-
1,3-Dichloropropane	ND	0.25	-	-	-
2,2-Dichloropropane	ND	0.25	-	-	-
1,1-Dichloropropene	ND	0.25	-	-	-
cis-1,3-Dichloropropene	ND	0.25	-	-	-
trans-1,3-Dichloropropene	ND	0.25	-	-	-
Diisopropyl ether (DIPE)	ND	0.25	-	-	-

(Cont.)

NELAP 4033ORELAP

QA/QC Officer



Quality Control Report

Client: Advanced GeoEnvironmental, Inc.
Date Prepared: 1/19/17
Date Analyzed: 1/19/17
Instrument: GC18
Matrix: Air
Project: Swiss Valley Cleaners

WorkOrder: 1701740
BatchID: 132899
Extraction Method: SW5030B
Analytical Method: SW8260B
Unit: µg/L
Sample ID: MB/LCS/LCSD-132899

QC Summary Report for SW8260B

Analyte	MB Result	RL	SPK Val	MB SS %REC	MB SS Limits
Ethylbenzene	ND	0.25	-	-	-
Ethyl tert-butyl ether (ETBE)	ND	0.25	-	-	-
Freon 113	ND	5.0	-	-	-
Hexachlorobutadiene	ND	0.25	-	-	-
Hexachloroethane	ND	0.25	-	-	-
2-Hexanone	ND	0.25	-	-	-
Isopropylbenzene	ND	0.25	-	-	-
4-Isopropyl toluene	ND	0.25	-	-	-
Methyl-t-butyl ether (MTBE)	ND	0.25	-	-	-
Methylene chloride	ND	0.25	-	-	-
n-Propyl benzene	ND	0.25	-	-	-
Styrene	ND	0.25	-	-	-
1,1,1,2-Tetrachloroethane	ND	0.25	-	-	-
1,1,2,2-Tetrachloroethane	ND	0.25	-	-	-
Tetrachloroethene	ND	0.25	-	-	-
Toluene	ND	0.25	-	-	-
1,2,3-Trichlorobenzene	ND	0.25	-	-	-
1,2,4-Trichlorobenzene	ND	0.25	-	-	-
1,1,1-Trichloroethane	ND	0.25	-	-	-
1,1,2-Trichloroethane	ND	0.25	-	-	-
Trichloroethene	ND	0.25	-	-	-
Trichlorofluoromethane	ND	0.25	-	-	-
1,2,3-Trichloropropane	ND	0.25	-	-	-
1,2,4-Trimethylbenzene	ND	0.25	-	-	-
1,3,5-Trimethylbenzene	ND	0.25	-	-	-
Vinyl Chloride	ND	0.25	-	-	-
Xylenes, Total	ND	0.25	-	-	-
Surrogate Recovery					
Dibromofluoromethane	13.04		12.5	104	70-130
Toluene-d8	12.16		12.5	97	70-130
4-BFB	1.279		1.25	102	70-130



Quality Control Report

Client: Advanced GeoEnvironmental, Inc.
Date Prepared: 1/19/17
Date Analyzed: 1/19/17
Instrument: GC18
Matrix: Air
Project: Swiss Valley Cleaners

WorkOrder: 1701740
BatchID: 132899
Extraction Method: SW5030B
Analytical Method: SW8260B
Unit: µg/L
Sample ID: MB/LCS/LCSD-132899

QC Summary Report for SW8260B

Analyte	LCS Result	LCSD Result	SPK Val	LCS %REC	LCSD %REC	LCS/LCSD Limits	RPD	RPD Limit
tert-Amyl methyl ether (TAME)	4.78	4.85	5	96	97	56-133	1.45	30
Benzene	5.62	5.66	5	112	113	72-122	0.785	30
t-Butyl alcohol (TBA)	14.8	15.5	20	74	78	35-121	4.69	30
Chlorobenzene	4.67	4.72	5	93	94	69-112	1.08	30
1,2-Dibromoethane (EDB)	4.59	4.62	5	92	92	62-117	0	30
1,2-Dichloroethane (1,2-DCA)	5.18	5.22	5	103	104	61-126	0.810	30
1,1-Dichloroethene	4.49	4.50	5	90	90	67-122	0	30
Diisopropyl ether (DIPE)	5.80	5.84	5	116	117	61-131	0.709	30
Ethyl tert-butyl ether (ETBE)	5.33	5.37	5	107	107	63-132	0	30
Methyl-t-butyl ether (MTBE)	5.18	5.21	5	104	104	63-127	0	30
Toluene	4.94	4.91	5	99	98	64-115	0.634	30
Trichloroethene	4.73	4.80	5	95	96	66-127	1.37	30
Xylenes, Total	14.3	14.6	15	95	97	53-131	2.05	30
Surrogate Recovery								
Dibromofluoromethane	13.3	13.3	12.5	106	106	83-124	0	30
Toluene-d8	12.4	12.2	12.5	99	97	80-120	1.70	30
4-BFB	1.18	1.26	1.25	95	101	70-129	6.48	30



1534 Willow Pass Rd
Pittsburg, CA 94565-1701
(925) 252-9262

CHAIN-OF-CUSTODY RECORD

WorkOrder: 1701740

ClientCode: AGES

WaterTrax
 WriteOn
 EDF
 Excel
 EQulS
 Email
 HardCopy
 ThirdParty
 J-flag

Report to:

Daniel Villanueva
Advanced GeoEnvironmental, Inc.
837 Shaw Road
Stockton, CA 95215
(209) 467-1006 FAX: (209) 467-1118

Email: dvillanueva@advgeoenv.com
cc/3rd Party:
PO:
ProjectNo: Swiss Valley Cleaners

Bill to:

Erica
Advanced GeoEnvironmental, Inc.
837 Shaw Road
Stockton, CA 95215
ap@advgeoenv.com

Requested TAT: 5 days;

Date Received: 01/19/2017

Date Logged: 01/19/2017

Lab ID	Client ID	Matrix	Collection Date	Hold	Requested Tests (See legend below)												
					1	2	3	4	5	6	7	8	9	10	11	12	
1701740-001	Influent/Vapor	Air	1/19/2017 11:25	<input type="checkbox"/>	A	A											
1701740-002	Effluent/Vapor	Air	1/19/2017 11:27	<input type="checkbox"/>	A	A											

Test Legend:

1	8260B_A	2	8260B_A(UG/M3)	3		4	
5		6		7		8	
9		10		11		12	

Prepared by: Maria Venegas

The following SampIDs: 001A, 002A contain testgroup 8260B_A.

Comments:

NOTE: Soil samples are discarded 60 days after results are reported unless other arrangements are made (Water samples are 30 days).
Hazardous samples will be returned to client or disposed of at client expense.



WORK ORDER SUMMARY

Client Name: ADVANCED GEOENVIRONMENTAL, INC.

Project: Swiss Valley Cleaners

Work Order: 1701740

Client Contact: Daniel Villanueva

QC Level: LEVEL 2

Contact's Email: dvillanueva@advgeoenv.com

Comments:

Date Logged: 1/19/2017

WaterTrax WriteOn EDF Excel Fax Email HardCopy ThirdParty J-flag

Lab ID	Client ID	Matrix	Test Name	Containers /Composites	Bottle & Preservative	De-chlorinated	Collection Date & Time	TAT	Sediment Content	Hold	SubOut
1701740-001A	Influent/Vapor	Air	VOCs by PT & GCMS	1	Tedlar	<input type="checkbox"/>	1/19/2017 11:25	5 days		<input type="checkbox"/>	
1701740-002A	Effluent/Vapor	Air	VOCs by PT & GCMS	1	Tedlar	<input type="checkbox"/>	1/19/2017 11:27	5 days		<input type="checkbox"/>	

NOTES: - STLC and TCLP extractions require 2 days to complete; therefore, all TATs begin after the extraction is completed (i.e., One-day TAT yields results in 3 days from sample submission).

- MAI assumes that all material present in the provided sampling container is considered part of the sample - MAI does not exclude any material from the sample prior to sample preparation unless requested in writing by the client.

1701740



Advanced GeoEnvironmental, Inc.

www.advgeoenv.com

CHAIN OF CUSTODY RECORD

- 837 Shaw Road, Stockton, California 95215 • Phone (209) 467-1006 • Fax (209) 467-1118
- 381 Thor Place, Brea, California 92821 • Phone (714) 529-0200 • Fax (714) 529-0203
- 2318 Fourth Street, Santa Rosa, California 95404 • Phone (707) 570-1418 • Fax (707) 570-1461
- 395 Del Monte Center, #111, Monterey, California 93940 • Phone (800) 511-9300 • Fax (831) 394-5979

Date: 1/19/17 Page 1 of 1

Analysis Required

S17015																				
	X																			

Project Name: Swiss Valley Cleaners Project Manager: Daniel Villanueva

Client: _____ Sampler (initials & signature): RV

Invoice to: AGE Client Lab Project No.: _____

Sample ID/Location/Description	Date	Time	Matrix	Number	Notes
<u>Influent/vapor</u>	<u>1/19/17</u>	<u>1125</u>	<u>A</u>	<u>1</u>	
<u>Effluent/vapor</u>	<u>1/19/17</u>	<u>1127</u>	<u>A</u>	<u>1</u>	

Relinquished by: Ruel Mart Date: 1/19/17 Time: 1245 Laboratory: McCampbell

Courier: Delivered (RV) Received by: _____ Date: _____ Time: _____

Relinquished by: _____ Date: _____ Time: _____ Received by: _____ Date: _____ Time: _____

Relinquished by: _____ Date: _____ Time: _____ Received by: Munoz Date: 1/19/17 Time: 1245

Requested Turn Around Time (circle): 24 hours 48 hours 72 hours 5 days (standard) Other: _____ Matrix Codes: A = Air W = Water S = Solid

Special Instructions to lab: _____ I hereby authorize the performance of the above indicated work.

Geotracker EDF to: geotracker@advgeoenv.com _____ Global ID: _____

Ruel Mart



Sample Receipt Checklist

Client Name: **Advanced GeoEnvironmental, Inc.**
 Project Name: **Swiss Valley Cleaners**
 WorkOrder No: **1701740** Matrix: Air
 Carrier: Client Drop-In

Date and Time Received **1/19/2017 12:45**
 Date Logged: **1/19/2017**
 Received by: **Maria Venegas**
 Logged by: **Maria Venegas**

Chain of Custody (COC) Information

Chain of custody present? Yes No
 Chain of custody signed when relinquished and received? Yes No
 Chain of custody agrees with sample labels? Yes No
 Sample IDs noted by Client on COC? Yes No
 Date and Time of collection noted by Client on COC? Yes No
 Sampler's name noted on COC? Yes No

Sample Receipt Information

Custody seals intact on shipping container/cooler? Yes No NA
 Shipping container/cooler in good condition? Yes No
 Samples in proper containers/bottles? Yes No
 Sample containers intact? Yes No
 Sufficient sample volume for indicated test? Yes No

Sample Preservation and Hold Time (HT) Information

All samples received within holding time? Yes No NA
 Sample/Temp Blank temperature Temp: NA
 Water - VOA vials have zero headspace / no bubbles? Yes No NA
 Sample labels checked for correct preservation? Yes No
 pH acceptable upon receipt (Metal: <2; 522: <4; 218.7: >8)? Yes No NA
 Samples Received on Ice? Yes No

UCMR3 Samples:

Total Chlorine tested and acceptable upon receipt for EPA 522? Yes No NA
 Free Chlorine tested and acceptable upon receipt for EPA 218.7, 300.1, 537, 539? Yes No NA

Comments:



McC Campbell Analytical, Inc.

"When Quality Counts"

Analytical Report

WorkOrder: 1702A14

Report Created for: Advanced GeoEnvironmental, Inc.

837 Shaw Road
Stockton, CA 95215

Project Contact: Daniel Villanueva

Project P.O.:

Project Name: Swiss Valley Cleaners

Project Received: 02/21/2017

Analytical Report reviewed & approved for release on 02/27/2017 by:

Angela Rydelius,
Laboratory Manager

The report shall not be reproduced except in full, without the written approval of the laboratory. The analytical results relate only to the items tested. Results reported conform to the most current NELAP standards, where applicable, unless otherwise stated in the case narrative.





Glossary of Terms & Qualifier Definitions

Client: Advanced GeoEnvironmental, Inc.
Project: Swiss Valley Cleaners
WorkOrder: 1702A14

Glossary Abbreviation

%D	Serial Dilution Percent Difference
95% Interval	95% Confident Interval
DF	Dilution Factor
DI WET	(DISTLC) Waste Extraction Test using DI water
DISS	Dissolved (direct analysis of 0.45 µm filtered and acidified water sample)
DLT	Dilution Test (Serial Dilution)
DUP	Duplicate
EDL	Estimated Detection Limit
ITEF	International Toxicity Equivalence Factor
LCS	Laboratory Control Sample
MB	Method Blank
MB % Rec	% Recovery of Surrogate in Method Blank, if applicable
MDL	Method Detection Limit
ML	Minimum Level of Quantitation
MS	Matrix Spike
MSD	Matrix Spike Duplicate
N/A	Not Applicable
ND	Not detected at or above the indicated MDL or RL
NR	Data Not Reported due to matrix interference or insufficient sample amount.
PDS	Post Digestion Spike
PDSD	Post Digestion Spike Duplicate
PF	Prep Factor
RD	Relative Difference
RL	Reporting Limit (The RL is the lowest calibration standard in a multipoint calibration.)
RPD	Relative Percent Deviation
RRT	Relative Retention Time
SPK Val	Spike Value
SPKRef Val	Spike Reference Value
SPLP	Synthetic Precipitation Leachate Procedure
ST	Sorbent Tube
TCLP	Toxicity Characteristic Leachate Procedure
TEQ	Toxicity Equivalents
WET (STLC)	Waste Extraction Test (Soluble Threshold Limit Concentration)

Analytical Qualifiers

H samples were analyzed out of holding time



Analytical Report

Client: Advanced GeoEnvironmental, Inc.
Date Received: 2/21/17 13:15
Date Prepared: 2/21/17
Project: Swiss Valley Cleaners

WorkOrder: 1702A14
Extraction Method: SW5030B
Analytical Method: SW8260B
Unit: µg/L

Volatile Organics

Client ID	Lab ID	Matrix	Date Collected	Instrument	Batch ID
Influent/Vapor	1702A14-001A	Air	02/21/2017 10:55	GC16	134526

Analytes	Result	Qualifiers	RL	DF	Date Analyzed
tert-Amyl methyl ether (TAME)	ND	H	0.25	1	02/21/2017 20:26
Benzene	ND	H	0.25	1	02/21/2017 20:26
Bromobenzene	ND	H	0.25	1	02/21/2017 20:26
Bromochloromethane	ND	H	0.25	1	02/21/2017 20:26
Bromodichloromethane	ND	H	0.25	1	02/21/2017 20:26
Bromoform	ND	H	0.25	1	02/21/2017 20:26
Bromomethane	ND	H	0.25	1	02/21/2017 20:26
t-Butyl alcohol (TBA)	ND	H	2.5	1	02/21/2017 20:26
n-Butyl benzene	ND	H	0.25	1	02/21/2017 20:26
sec-Butyl benzene	ND	H	0.25	1	02/21/2017 20:26
tert-Butyl benzene	ND	H	0.25	1	02/21/2017 20:26
Carbon Disulfide	ND	H	0.25	1	02/21/2017 20:26
Carbon Tetrachloride	ND	H	0.25	1	02/21/2017 20:26
Chlorobenzene	ND	H	0.25	1	02/21/2017 20:26
Chloroethane	ND	H	0.25	1	02/21/2017 20:26
Chloroform	ND	H	0.25	1	02/21/2017 20:26
Chloromethane	ND	H	0.25	1	02/21/2017 20:26
2-Chlorotoluene	ND	H	0.25	1	02/21/2017 20:26
4-Chlorotoluene	ND	H	0.25	1	02/21/2017 20:26
Dibromochloromethane	ND	H	0.25	1	02/21/2017 20:26
1,2-Dibromo-3-chloropropane	ND	H	0.25	1	02/21/2017 20:26
1,2-Dibromoethane (EDB)	ND	H	0.25	1	02/21/2017 20:26
Dibromomethane	ND	H	0.25	1	02/21/2017 20:26
1,2-Dichlorobenzene	ND	H	0.25	1	02/21/2017 20:26
1,3-Dichlorobenzene	ND	H	0.25	1	02/21/2017 20:26
1,4-Dichlorobenzene	ND	H	0.25	1	02/21/2017 20:26
Dichlorodifluoromethane	ND	H	0.25	1	02/21/2017 20:26
1,1-Dichloroethane	ND	H	0.25	1	02/21/2017 20:26
1,2-Dichloroethane (1,2-DCA)	ND	H	0.25	1	02/21/2017 20:26
1,1-Dichloroethene	ND	H	0.25	1	02/21/2017 20:26
cis-1,2-Dichloroethene	ND	H	0.25	1	02/21/2017 20:26
trans-1,2-Dichloroethene	ND	H	0.25	1	02/21/2017 20:26
1,2-Dichloropropane	ND	H	0.25	1	02/21/2017 20:26
1,3-Dichloropropane	ND	H	0.25	1	02/21/2017 20:26
2,2-Dichloropropane	ND	H	0.25	1	02/21/2017 20:26
1,1-Dichloropropene	ND	H	0.25	1	02/21/2017 20:26
cis-1,3-Dichloropropene	ND	H	0.25	1	02/21/2017 20:26

(Cont.)



Analytical Report

Client: Advanced GeoEnvironmental, Inc.
Date Received: 2/21/17 13:15
Date Prepared: 2/21/17
Project: Swiss Valley Cleaners

WorkOrder: 1702A14
Extraction Method: SW5030B
Analytical Method: SW8260B
Unit: µg/L

Volatile Organics

Client ID	Lab ID	Matrix	Date Collected	Instrument	Batch ID
Influent/Vapor	1702A14-001A	Air	02/21/2017 10:55	GC16	134526

Analytes	Result	Qualifiers	RL	DF	Date Analyzed
trans-1,3-Dichloropropene	ND	H	0.25	1	02/21/2017 20:26
Diisopropyl ether (DIPE)	ND	H	0.25	1	02/21/2017 20:26
Ethylbenzene	ND	H	0.25	1	02/21/2017 20:26
Ethyl tert-butyl ether (ETBE)	ND	H	0.25	1	02/21/2017 20:26
Freon 113	ND	H	5.0	1	02/21/2017 20:26
Hexachlorobutadiene	ND	H	0.25	1	02/21/2017 20:26
Hexachloroethane	ND	H	0.25	1	02/21/2017 20:26
2-Hexanone	ND	H	0.25	1	02/21/2017 20:26
Isopropylbenzene	ND	H	0.25	1	02/21/2017 20:26
4-Isopropyl toluene	ND	H	0.25	1	02/21/2017 20:26
Methyl-t-butyl ether (MTBE)	ND	H	0.25	1	02/21/2017 20:26
Methylene chloride	ND	H	0.25	1	02/21/2017 20:26
n-Propyl benzene	ND	H	0.25	1	02/21/2017 20:26
Styrene	ND	H	0.25	1	02/21/2017 20:26
1,1,1,2-Tetrachloroethane	ND	H	0.25	1	02/21/2017 20:26
1,1,2,2-Tetrachloroethane	ND	H	0.25	1	02/21/2017 20:26
Tetrachloroethene	2.1	H	0.25	1	02/21/2017 20:26
Toluene	ND	H	0.25	1	02/21/2017 20:26
1,2,3-Trichlorobenzene	ND	H	0.25	1	02/21/2017 20:26
1,2,4-Trichlorobenzene	ND	H	0.25	1	02/21/2017 20:26
1,1,1-Trichloroethane	ND	H	0.25	1	02/21/2017 20:26
1,1,2-Trichloroethane	ND	H	0.25	1	02/21/2017 20:26
Trichloroethene	ND	H	0.25	1	02/21/2017 20:26
Trichlorofluoromethane	ND	H	0.25	1	02/21/2017 20:26
1,2,3-Trichloropropane	ND	H	0.25	1	02/21/2017 20:26
1,2,4-Trimethylbenzene	ND	H	0.25	1	02/21/2017 20:26
1,3,5-Trimethylbenzene	ND	H	0.25	1	02/21/2017 20:26
Vinyl Chloride	ND	H	0.25	1	02/21/2017 20:26
Xylenes, Total	ND	H	0.25	1	02/21/2017 20:26
Surrogates	REC (%)	Qualifiers	Limits		
Dibromofluoromethane	96	H	70-130		02/21/2017 20:26
Toluene-d8	93	H	70-130		02/21/2017 20:26
4-BFB	100	H	70-130		02/21/2017 20:26

Analyst(s): JEM

(Cont.)



Analytical Report

Client: Advanced GeoEnvironmental, Inc.
Date Received: 2/21/17 13:15
Date Prepared: 2/21/17
Project: Swiss Valley Cleaners

WorkOrder: 1702A14
Extraction Method: SW5030B
Analytical Method: SW8260B
Unit: µg/L

Volatile Organics

Client ID	Lab ID	Matrix	Date Collected	Instrument	Batch ID
Effluent/Vapor	1702A14-002A	Air	02/21/2017 10:48	GC16	134526

Analytes	Result	Qualifiers	RL	DF	Date Analyzed
tert-Amyl methyl ether (TAME)	ND	H	0.25	1	02/21/2017 21:05
Benzene	ND	H	0.25	1	02/21/2017 21:05
Bromobenzene	ND	H	0.25	1	02/21/2017 21:05
Bromochloromethane	ND	H	0.25	1	02/21/2017 21:05
Bromodichloromethane	ND	H	0.25	1	02/21/2017 21:05
Bromoform	ND	H	0.25	1	02/21/2017 21:05
Bromomethane	ND	H	0.25	1	02/21/2017 21:05
t-Butyl alcohol (TBA)	ND	H	2.5	1	02/21/2017 21:05
n-Butyl benzene	ND	H	0.25	1	02/21/2017 21:05
sec-Butyl benzene	ND	H	0.25	1	02/21/2017 21:05
tert-Butyl benzene	ND	H	0.25	1	02/21/2017 21:05
Carbon Disulfide	ND	H	0.25	1	02/21/2017 21:05
Carbon Tetrachloride	ND	H	0.25	1	02/21/2017 21:05
Chlorobenzene	ND	H	0.25	1	02/21/2017 21:05
Chloroethane	ND	H	0.25	1	02/21/2017 21:05
Chloroform	ND	H	0.25	1	02/21/2017 21:05
Chloromethane	ND	H	0.25	1	02/21/2017 21:05
2-Chlorotoluene	ND	H	0.25	1	02/21/2017 21:05
4-Chlorotoluene	ND	H	0.25	1	02/21/2017 21:05
Dibromochloromethane	ND	H	0.25	1	02/21/2017 21:05
1,2-Dibromo-3-chloropropane	ND	H	0.25	1	02/21/2017 21:05
1,2-Dibromoethane (EDB)	ND	H	0.25	1	02/21/2017 21:05
Dibromomethane	ND	H	0.25	1	02/21/2017 21:05
1,2-Dichlorobenzene	ND	H	0.25	1	02/21/2017 21:05
1,3-Dichlorobenzene	ND	H	0.25	1	02/21/2017 21:05
1,4-Dichlorobenzene	ND	H	0.25	1	02/21/2017 21:05
Dichlorodifluoromethane	ND	H	0.25	1	02/21/2017 21:05
1,1-Dichloroethane	ND	H	0.25	1	02/21/2017 21:05
1,2-Dichloroethane (1,2-DCA)	ND	H	0.25	1	02/21/2017 21:05
1,1-Dichloroethene	ND	H	0.25	1	02/21/2017 21:05
cis-1,2-Dichloroethene	ND	H	0.25	1	02/21/2017 21:05
trans-1,2-Dichloroethene	ND	H	0.25	1	02/21/2017 21:05
1,2-Dichloropropane	ND	H	0.25	1	02/21/2017 21:05
1,3-Dichloropropane	ND	H	0.25	1	02/21/2017 21:05
2,2-Dichloropropane	ND	H	0.25	1	02/21/2017 21:05
1,1-Dichloropropene	ND	H	0.25	1	02/21/2017 21:05
cis-1,3-Dichloropropene	ND	H	0.25	1	02/21/2017 21:05

(Cont.)



Analytical Report

Client: Advanced GeoEnvironmental, Inc.
Date Received: 2/21/17 13:15
Date Prepared: 2/21/17
Project: Swiss Valley Cleaners

WorkOrder: 1702A14
Extraction Method: SW5030B
Analytical Method: SW8260B
Unit: µg/L

Volatile Organics

Client ID	Lab ID	Matrix	Date Collected	Instrument	Batch ID
Effluent/Vapor	1702A14-002A	Air	02/21/2017 10:48	GC16	134526

Analytes	Result	Qualifiers	RL	DF	Date Analyzed
trans-1,3-Dichloropropene	ND	H	0.25	1	02/21/2017 21:05
Diisopropyl ether (DIPE)	ND	H	0.25	1	02/21/2017 21:05
Ethylbenzene	ND	H	0.25	1	02/21/2017 21:05
Ethyl tert-butyl ether (ETBE)	ND	H	0.25	1	02/21/2017 21:05
Freon 113	ND	H	5.0	1	02/21/2017 21:05
Hexachlorobutadiene	ND	H	0.25	1	02/21/2017 21:05
Hexachloroethane	ND	H	0.25	1	02/21/2017 21:05
2-Hexanone	ND	H	0.25	1	02/21/2017 21:05
Isopropylbenzene	ND	H	0.25	1	02/21/2017 21:05
4-Isopropyl toluene	ND	H	0.25	1	02/21/2017 21:05
Methyl-t-butyl ether (MTBE)	ND	H	0.25	1	02/21/2017 21:05
Methylene chloride	ND	H	0.25	1	02/21/2017 21:05
n-Propyl benzene	ND	H	0.25	1	02/21/2017 21:05
Styrene	ND	H	0.25	1	02/21/2017 21:05
1,1,1,2-Tetrachloroethane	ND	H	0.25	1	02/21/2017 21:05
1,1,2,2-Tetrachloroethane	ND	H	0.25	1	02/21/2017 21:05
Tetrachloroethene	ND	H	0.25	1	02/21/2017 21:05
Toluene	ND	H	0.25	1	02/21/2017 21:05
1,2,3-Trichlorobenzene	ND	H	0.25	1	02/21/2017 21:05
1,2,4-Trichlorobenzene	ND	H	0.25	1	02/21/2017 21:05
1,1,1-Trichloroethane	ND	H	0.25	1	02/21/2017 21:05
1,1,2-Trichloroethane	ND	H	0.25	1	02/21/2017 21:05
Trichloroethene	ND	H	0.25	1	02/21/2017 21:05
Trichlorofluoromethane	ND	H	0.25	1	02/21/2017 21:05
1,2,3-Trichloropropane	ND	H	0.25	1	02/21/2017 21:05
1,2,4-Trimethylbenzene	ND	H	0.25	1	02/21/2017 21:05
1,3,5-Trimethylbenzene	ND	H	0.25	1	02/21/2017 21:05
Vinyl Chloride	ND	H	0.25	1	02/21/2017 21:05
Xylenes, Total	ND	H	0.25	1	02/21/2017 21:05
Surrogates	REC (%)	Qualifiers	Limits		
Dibromofluoromethane	96	H	70-130		02/21/2017 21:05
Toluene-d8	94	H	70-130		02/21/2017 21:05
4-BFB	96	H	70-130		02/21/2017 21:05

Analyst(s): JEM



Analytical Report

Client: Advanced GeoEnvironmental, Inc.
Date Received: 2/21/17 13:15
Date Prepared: 2/21/17
Project: Swiss Valley Cleaners

WorkOrder: 1702A14
Extraction Method: SW5030B
Analytical Method: SW8260B
Unit: µg/m³

Volatile Organics by P&T and GC/MS (Basic Target List)

Client ID	Lab ID	Matrix	Date Collected	Instrument	Batch ID
Influent/Vapor	1702A14-001A	Air	02/21/2017 10:55	GC16	134526

Analytes	Result	Qualifiers	RL	DF	Date Analyzed
tert-Amyl methyl ether (TAME)	ND	H	250	1	02/21/2017 20:26
Benzene	ND	H	250	1	02/21/2017 20:26
Bromobenzene	ND	H	250	1	02/21/2017 20:26
Bromochloromethane	ND	H	250	1	02/21/2017 20:26
Bromodichloromethane	ND	H	250	1	02/21/2017 20:26
Bromoform	ND	H	250	1	02/21/2017 20:26
Bromomethane	ND	H	250	1	02/21/2017 20:26
t-Butyl alcohol (TBA)	ND	H	2500	1	02/21/2017 20:26
n-Butyl benzene	ND	H	250	1	02/21/2017 20:26
sec-Butyl benzene	ND	H	250	1	02/21/2017 20:26
tert-Butyl benzene	ND	H	250	1	02/21/2017 20:26
Carbon Disulfide	ND	H	250	1	02/21/2017 20:26
Carbon Tetrachloride	ND	H	250	1	02/21/2017 20:26
Chlorobenzene	ND	H	250	1	02/21/2017 20:26
Chloroethane	ND	H	250	1	02/21/2017 20:26
Chloroform	ND	H	250	1	02/21/2017 20:26
Chloromethane	ND	H	250	1	02/21/2017 20:26
2-Chlorotoluene	ND	H	250	1	02/21/2017 20:26
4-Chlorotoluene	ND	H	250	1	02/21/2017 20:26
Dibromochloromethane	ND	H	250	1	02/21/2017 20:26
1,2-Dibromo-3-chloropropane	ND	H	250	1	02/21/2017 20:26
1,2-Dibromoethane (EDB)	ND	H	250	1	02/21/2017 20:26
Dibromomethane	ND	H	250	1	02/21/2017 20:26
1,2-Dichlorobenzene	ND	H	250	1	02/21/2017 20:26
1,3-Dichlorobenzene	ND	H	250	1	02/21/2017 20:26
1,4-Dichlorobenzene	ND	H	250	1	02/21/2017 20:26
Dichlorodifluoromethane	ND	H	250	1	02/21/2017 20:26
1,1-Dichloroethane	ND	H	250	1	02/21/2017 20:26
1,2-Dichloroethane (1,2-DCA)	ND	H	250	1	02/21/2017 20:26
1,1-Dichloroethene	ND	H	250	1	02/21/2017 20:26
cis-1,2-Dichloroethene	ND	H	250	1	02/21/2017 20:26
trans-1,2-Dichloroethene	ND	H	250	1	02/21/2017 20:26
1,2-Dichloropropane	ND	H	250	1	02/21/2017 20:26
1,3-Dichloropropane	ND	H	250	1	02/21/2017 20:26
2,2-Dichloropropane	ND	H	250	1	02/21/2017 20:26
1,1-Dichloropropene	ND	H	250	1	02/21/2017 20:26
cis-1,3-Dichloropropene	ND	H	250	1	02/21/2017 20:26

(Cont.)



Analytical Report

Client: Advanced GeoEnvironmental, Inc.
Date Received: 2/21/17 13:15
Date Prepared: 2/21/17
Project: Swiss Valley Cleaners

WorkOrder: 1702A14
Extraction Method: SW5030B
Analytical Method: SW8260B
Unit: µg/m³

Volatile Organics by P&T and GC/MS (Basic Target List)

Client ID	Lab ID	Matrix	Date Collected	Instrument	Batch ID
Influent/Vapor	1702A14-001A	Air	02/21/2017 10:55	GC16	134526

Analytes	Result	Qualifiers	RL	DF	Date Analyzed
trans-1,3-Dichloropropene	ND	H	250	1	02/21/2017 20:26
Diisopropyl ether (DIPE)	ND	H	250	1	02/21/2017 20:26
Ethylbenzene	ND	H	250	1	02/21/2017 20:26
Ethyl tert-butyl ether (ETBE)	ND	H	250	1	02/21/2017 20:26
Freon 113	ND	H	5000	1	02/21/2017 20:26
Hexachlorobutadiene	ND	H	250	1	02/21/2017 20:26
Hexachloroethane	ND	H	250	1	02/21/2017 20:26
2-Hexanone	ND	H	250	1	02/21/2017 20:26
Isopropylbenzene	ND	H	250	1	02/21/2017 20:26
4-Isopropyl toluene	ND	H	250	1	02/21/2017 20:26
Methyl-t-butyl ether (MTBE)	ND	H	250	1	02/21/2017 20:26
Methylene chloride	ND	H	250	1	02/21/2017 20:26
n-Propyl benzene	ND	H	250	1	02/21/2017 20:26
Styrene	ND	H	250	1	02/21/2017 20:26
1,1,1,2-Tetrachloroethane	ND	H	250	1	02/21/2017 20:26
1,1,2,2-Tetrachloroethane	ND	H	250	1	02/21/2017 20:26
Tetrachloroethene	2100	H	250	1	02/21/2017 20:26
Toluene	ND	H	250	1	02/21/2017 20:26
1,2,3-Trichlorobenzene	ND	H	250	1	02/21/2017 20:26
1,2,4-Trichlorobenzene	ND	H	250	1	02/21/2017 20:26
1,1,1-Trichloroethane	ND	H	250	1	02/21/2017 20:26
1,1,2-Trichloroethane	ND	H	250	1	02/21/2017 20:26
Trichloroethene	ND	H	250	1	02/21/2017 20:26
Trichlorofluoromethane	ND	H	250	1	02/21/2017 20:26
1,2,3-Trichloropropane	ND	H	250	1	02/21/2017 20:26
1,2,4-Trimethylbenzene	ND	H	250	1	02/21/2017 20:26
1,3,5-Trimethylbenzene	ND	H	250	1	02/21/2017 20:26
Vinyl Chloride	ND	H	250	1	02/21/2017 20:26
Xylenes, Total	ND	H	250	1	02/21/2017 20:26
Surrogates	REC (%)	Qualifiers	Limits		
Dibromofluoromethane	96	H	70-130		02/21/2017 20:26
Toluene-d8	93	H	70-130		02/21/2017 20:26
4-BFB	100	H	70-130		02/21/2017 20:26

Analyst(s): JEM

(Cont.)

NELAP 4033ORELAP

 Angela Rydelius, Lab Manager



Analytical Report

Client: Advanced GeoEnvironmental, Inc.
Date Received: 2/21/17 13:15
Date Prepared: 2/21/17
Project: Swiss Valley Cleaners

WorkOrder: 1702A14
Extraction Method: SW5030B
Analytical Method: SW8260B
Unit: µg/m³

Volatile Organics by P&T and GC/MS (Basic Target List)

Client ID	Lab ID	Matrix	Date Collected	Instrument	Batch ID
Effluent/Vapor	1702A14-002A	Air	02/21/2017 10:48	GC16	134526
Analytes	Result	Qualifiers	RL	DF	Date Analyzed
tert-Amyl methyl ether (TAME)	ND	H	250	1	02/21/2017 21:05
Benzene	ND	H	250	1	02/21/2017 21:05
Bromobenzene	ND	H	250	1	02/21/2017 21:05
Bromochloromethane	ND	H	250	1	02/21/2017 21:05
Bromodichloromethane	ND	H	250	1	02/21/2017 21:05
Bromoform	ND	H	250	1	02/21/2017 21:05
Bromomethane	ND	H	250	1	02/21/2017 21:05
t-Butyl alcohol (TBA)	ND	H	2500	1	02/21/2017 21:05
n-Butyl benzene	ND	H	250	1	02/21/2017 21:05
sec-Butyl benzene	ND	H	250	1	02/21/2017 21:05
tert-Butyl benzene	ND	H	250	1	02/21/2017 21:05
Carbon Disulfide	ND	H	250	1	02/21/2017 21:05
Carbon Tetrachloride	ND	H	250	1	02/21/2017 21:05
Chlorobenzene	ND	H	250	1	02/21/2017 21:05
Chloroethane	ND	H	250	1	02/21/2017 21:05
Chloroform	ND	H	250	1	02/21/2017 21:05
Chloromethane	ND	H	250	1	02/21/2017 21:05
2-Chlorotoluene	ND	H	250	1	02/21/2017 21:05
4-Chlorotoluene	ND	H	250	1	02/21/2017 21:05
Dibromochloromethane	ND	H	250	1	02/21/2017 21:05
1,2-Dibromo-3-chloropropane	ND	H	250	1	02/21/2017 21:05
1,2-Dibromoethane (EDB)	ND	H	250	1	02/21/2017 21:05
Dibromomethane	ND	H	250	1	02/21/2017 21:05
1,2-Dichlorobenzene	ND	H	250	1	02/21/2017 21:05
1,3-Dichlorobenzene	ND	H	250	1	02/21/2017 21:05
1,4-Dichlorobenzene	ND	H	250	1	02/21/2017 21:05
Dichlorodifluoromethane	ND	H	250	1	02/21/2017 21:05
1,1-Dichloroethane	ND	H	250	1	02/21/2017 21:05
1,2-Dichloroethane (1,2-DCA)	ND	H	250	1	02/21/2017 21:05
1,1-Dichloroethene	ND	H	250	1	02/21/2017 21:05
cis-1,2-Dichloroethene	ND	H	250	1	02/21/2017 21:05
trans-1,2-Dichloroethene	ND	H	250	1	02/21/2017 21:05
1,2-Dichloropropane	ND	H	250	1	02/21/2017 21:05
1,3-Dichloropropane	ND	H	250	1	02/21/2017 21:05
2,2-Dichloropropane	ND	H	250	1	02/21/2017 21:05
1,1-Dichloropropene	ND	H	250	1	02/21/2017 21:05
cis-1,3-Dichloropropene	ND	H	250	1	02/21/2017 21:05

(Cont.)



Analytical Report

Client: Advanced GeoEnvironmental, Inc.
Date Received: 2/21/17 13:15
Date Prepared: 2/21/17
Project: Swiss Valley Cleaners

WorkOrder: 1702A14
Extraction Method: SW5030B
Analytical Method: SW8260B
Unit: µg/m³

Volatile Organics by P&T and GC/MS (Basic Target List)

Client ID	Lab ID	Matrix	Date Collected	Instrument	Batch ID
Effluent/Vapor	1702A14-002A	Air	02/21/2017 10:48	GC16	134526

Analytes	Result	Qualifiers	RL	DF	Date Analyzed
trans-1,3-Dichloropropene	ND	H	250	1	02/21/2017 21:05
Diisopropyl ether (DIPE)	ND	H	250	1	02/21/2017 21:05
Ethylbenzene	ND	H	250	1	02/21/2017 21:05
Ethyl tert-butyl ether (ETBE)	ND	H	250	1	02/21/2017 21:05
Freon 113	ND	H	5000	1	02/21/2017 21:05
Hexachlorobutadiene	ND	H	250	1	02/21/2017 21:05
Hexachloroethane	ND	H	250	1	02/21/2017 21:05
2-Hexanone	ND	H	250	1	02/21/2017 21:05
Isopropylbenzene	ND	H	250	1	02/21/2017 21:05
4-Isopropyl toluene	ND	H	250	1	02/21/2017 21:05
Methyl-t-butyl ether (MTBE)	ND	H	250	1	02/21/2017 21:05
Methylene chloride	ND	H	250	1	02/21/2017 21:05
n-Propyl benzene	ND	H	250	1	02/21/2017 21:05
Styrene	ND	H	250	1	02/21/2017 21:05
1,1,1,2-Tetrachloroethane	ND	H	250	1	02/21/2017 21:05
1,1,2,2-Tetrachloroethane	ND	H	250	1	02/21/2017 21:05
Tetrachloroethene	ND	H	250	1	02/21/2017 21:05
Toluene	ND	H	250	1	02/21/2017 21:05
1,2,3-Trichlorobenzene	ND	H	250	1	02/21/2017 21:05
1,2,4-Trichlorobenzene	ND	H	250	1	02/21/2017 21:05
1,1,1-Trichloroethane	ND	H	250	1	02/21/2017 21:05
1,1,2-Trichloroethane	ND	H	250	1	02/21/2017 21:05
Trichloroethene	ND	H	250	1	02/21/2017 21:05
Trichlorofluoromethane	ND	H	250	1	02/21/2017 21:05
1,2,3-Trichloropropane	ND	H	250	1	02/21/2017 21:05
1,2,4-Trimethylbenzene	ND	H	250	1	02/21/2017 21:05
1,3,5-Trimethylbenzene	ND	H	250	1	02/21/2017 21:05
Vinyl Chloride	ND	H	250	1	02/21/2017 21:05
Xylenes, Total	ND	H	250	1	02/21/2017 21:05
Surrogates	REC (%)	Qualifiers	Limits		
Dibromofluoromethane	96	H	70-130		02/21/2017 21:05
Toluene-d8	94	H	70-130		02/21/2017 21:05
4-BFB	96	H	70-130		02/21/2017 21:05

Analyst(s): JEM



Quality Control Report

Client: Advanced GeoEnvironmental, Inc.
Date Prepared: 2/21/17
Date Analyzed: 2/21/17
Instrument: GC16
Matrix: Air
Project: Swiss Valley Cleaners

WorkOrder: 1702A14
BatchID: 134526
Extraction Method: SW5030B
Analytical Method: SW8260B
Unit: µg/L
Sample ID: MB/LCS/LCSD-134526

QC Summary Report for SW8260B

Analyte	MB Result	RL	SPK Val	MB SS %REC	MB SS Limits
tert-Amyl methyl ether (TAME)	ND	0.25	-	-	-
Benzene	ND	0.25	-	-	-
Bromobenzene	ND	0.25	-	-	-
Bromochloromethane	ND	0.25	-	-	-
Bromodichloromethane	ND	0.25	-	-	-
Bromoform	ND	0.25	-	-	-
Bromomethane	ND	0.25	-	-	-
t-Butyl alcohol (TBA)	ND	2.5	-	-	-
n-Butyl benzene	ND	0.25	-	-	-
sec-Butyl benzene	ND	0.25	-	-	-
tert-Butyl benzene	ND	0.25	-	-	-
Carbon Disulfide	ND	0.25	-	-	-
Carbon Tetrachloride	ND	0.25	-	-	-
Chlorobenzene	ND	0.25	-	-	-
Chloroethane	ND	0.25	-	-	-
Chloroform	ND	0.25	-	-	-
Chloromethane	ND	0.25	-	-	-
2-Chlorotoluene	ND	0.25	-	-	-
4-Chlorotoluene	ND	0.25	-	-	-
Dibromochloromethane	ND	0.25	-	-	-
1,2-Dibromo-3-chloropropane	ND	0.25	-	-	-
1,2-Dibromoethane (EDB)	ND	0.25	-	-	-
Dibromomethane	ND	0.25	-	-	-
1,2-Dichlorobenzene	ND	0.25	-	-	-
1,3-Dichlorobenzene	ND	0.25	-	-	-
1,4-Dichlorobenzene	ND	0.25	-	-	-
Dichlorodifluoromethane	ND	0.25	-	-	-
1,1-Dichloroethane	ND	0.25	-	-	-
1,2-Dichloroethane (1,2-DCA)	ND	0.25	-	-	-
1,1-Dichloroethene	ND	0.25	-	-	-
cis-1,2-Dichloroethene	ND	0.25	-	-	-
trans-1,2-Dichloroethene	ND	0.25	-	-	-
1,2-Dichloropropane	ND	0.25	-	-	-
1,3-Dichloropropane	ND	0.25	-	-	-
2,2-Dichloropropane	ND	0.25	-	-	-
1,1-Dichloropropene	ND	0.25	-	-	-
cis-1,3-Dichloropropene	ND	0.25	-	-	-
trans-1,3-Dichloropropene	ND	0.25	-	-	-
Diisopropyl ether (DIPE)	ND	0.25	-	-	-

(Cont.)

NELAP 4033ORELAP

QA/QC Officer



Quality Control Report

Client: Advanced GeoEnvironmental, Inc.
Date Prepared: 2/21/17
Date Analyzed: 2/21/17
Instrument: GC16
Matrix: Air
Project: Swiss Valley Cleaners

WorkOrder: 1702A14
BatchID: 134526
Extraction Method: SW5030B
Analytical Method: SW8260B
Unit: µg/L
Sample ID: MB/LCS/LCSD-134526

QC Summary Report for SW8260B

Analyte	MB Result	RL	SPK Val	MB SS %REC	MB SS Limits
Ethylbenzene	ND	0.25	-	-	-
Ethyl tert-butyl ether (ETBE)	ND	0.25	-	-	-
Freon 113	ND	5.0	-	-	-
Hexachlorobutadiene	ND	0.25	-	-	-
Hexachloroethane	ND	0.25	-	-	-
2-Hexanone	ND	0.25	-	-	-
Isopropylbenzene	ND	0.25	-	-	-
4-Isopropyl toluene	ND	0.25	-	-	-
Methyl-t-butyl ether (MTBE)	ND	0.25	-	-	-
Methylene chloride	ND	0.25	-	-	-
n-Propyl benzene	ND	0.25	-	-	-
Styrene	ND	0.25	-	-	-
1,1,1,2-Tetrachloroethane	ND	0.25	-	-	-
1,1,2,2-Tetrachloroethane	ND	0.25	-	-	-
Tetrachloroethene	ND	0.25	-	-	-
Toluene	ND	0.25	-	-	-
1,2,3-Trichlorobenzene	ND	0.25	-	-	-
1,2,4-Trichlorobenzene	ND	0.25	-	-	-
1,1,1-Trichloroethane	ND	0.25	-	-	-
1,1,2-Trichloroethane	ND	0.25	-	-	-
Trichloroethene	ND	0.25	-	-	-
Trichlorofluoromethane	ND	0.25	-	-	-
1,2,3-Trichloropropane	ND	0.25	-	-	-
1,2,4-Trimethylbenzene	ND	0.25	-	-	-
1,3,5-Trimethylbenzene	ND	0.25	-	-	-
Vinyl Chloride	ND	0.25	-	-	-
Xylenes, Total	ND	0.25	-	-	-
Surrogate Recovery					
Dibromofluoromethane	12.28		12.5	98	70-130
Toluene-d8	11.6		12.5	93	70-130
4-BFB	1.256		1.25	100	70-130



Quality Control Report

Client: Advanced GeoEnvironmental, Inc.
Date Prepared: 2/21/17
Date Analyzed: 2/21/17
Instrument: GC16
Matrix: Air
Project: Swiss Valley Cleaners

WorkOrder: 1702A14
BatchID: 134526
Extraction Method: SW5030B
Analytical Method: SW8260B
Unit: µg/L
Sample ID: MB/LCS/LCSD-134526

QC Summary Report for SW8260B

Analyte	LCS Result	LCSD Result	SPK Val	LCS %REC	LCSD %REC	LCS/LCSD Limits	RPD	RPD Limit
tert-Amyl methyl ether (TAME)	3.96	3.90	5	79	78	56-133	1.45	30
Benzene	4.20	4.13	5	84	83	72-122	1.85	30
t-Butyl alcohol (TBA)	13.5	13.2	20	67	66	35-121	1.72	30
Chlorobenzene	3.99	3.91	5	80	78	69-112	2.24	30
1,2-Dibromoethane (EDB)	4.04	3.91	5	81	78	62-117	3.43	30
1,2-Dichloroethane (1,2-DCA)	3.99	3.90	5	80	78	61-126	2.17	30
1,1-Dichloroethene	3.88	3.82	5	78	76	67-122	1.54	30
Diisopropyl ether (DIPE)	4.20	4.16	5	84	83	61-131	0.891	30
Ethylbenzene	4.03	3.96	5	81	79	71-115	1.88	30
Ethyl tert-butyl ether (ETBE)	4.15	4.10	5	83	82	63-132	1.30	30
Methyl-t-butyl ether (MTBE)	4.12	4.08	5	82	82	63-127	0	30
Toluene	4.07	4.00	5	81	80	64-115	1.79	30
Trichloroethene	4.31	4.21	5	86	84	66-127	2.32	30
Xylenes, Total	12.1	11.9	15	81	79	53-131	2.11	30
Surrogate Recovery								
Dibromofluoromethane	12.2	12.3	12.5	98	98	83-124	0	30
Toluene-d8	11.7	11.7	12.5	94	93	80-120	0.493	30
4-BFB	1.26	1.27	1.25	101	102	70-129	0.781	30



Quality Control Report

Client: Advanced GeoEnvironmental, Inc.
Date Prepared: 2/21/17
Date Analyzed: 2/21/17
Instrument: GC16
Matrix: Air
Project: Swiss Valley Cleaners

WorkOrder: 1702A14
BatchID: 134526
Extraction Method: SW5030B
Analytical Method: SW8260B
Unit: µg/m³
Sample ID: MB/LCS/LCSD-134526

QC Summary Report for SW8260B

Analyte	MB Result	RL	SPK Val	MB SS %REC	MB SS Limits
tert-Amyl methyl ether (TAME)	ND	250	-	-	-
Benzene	ND	250	-	-	-
Bromobenzene	ND	250	-	-	-
Bromochloromethane	ND	250	-	-	-
Bromodichloromethane	ND	250	-	-	-
Bromoform	ND	250	-	-	-
Bromomethane	ND	250	-	-	-
t-Butyl alcohol (TBA)	ND	2500	-	-	-
n-Butyl benzene	ND	250	-	-	-
sec-Butyl benzene	ND	250	-	-	-
tert-Butyl benzene	ND	250	-	-	-
Carbon Disulfide	ND	250	-	-	-
Carbon Tetrachloride	ND	250	-	-	-
Chlorobenzene	ND	250	-	-	-
Chloroethane	ND	250	-	-	-
Chloroform	ND	250	-	-	-
Chloromethane	ND	250	-	-	-
2-Chlorotoluene	ND	250	-	-	-
4-Chlorotoluene	ND	250	-	-	-
Dibromochloromethane	ND	250	-	-	-
1,2-Dibromo-3-chloropropane	ND	250	-	-	-
1,2-Dibromoethane (EDB)	ND	250	-	-	-
Dibromomethane	ND	250	-	-	-
1,2-Dichlorobenzene	ND	250	-	-	-
1,3-Dichlorobenzene	ND	250	-	-	-
1,4-Dichlorobenzene	ND	250	-	-	-
Dichlorodifluoromethane	ND	250	-	-	-
1,1-Dichloroethane	ND	250	-	-	-
1,2-Dichloroethane (1,2-DCA)	ND	250	-	-	-
1,1-Dichloroethene	ND	250	-	-	-
cis-1,2-Dichloroethene	ND	250	-	-	-
trans-1,2-Dichloroethene	ND	250	-	-	-
1,2-Dichloropropane	ND	250	-	-	-
1,3-Dichloropropane	ND	250	-	-	-
2,2-Dichloropropane	ND	250	-	-	-
1,1-Dichloropropene	ND	250	-	-	-
cis-1,3-Dichloropropene	ND	250	-	-	-
trans-1,3-Dichloropropene	ND	250	-	-	-
Diisopropyl ether (DIPE)	ND	250	-	-	-

(Cont.)

NELAP 4033ORELAP

QA/QC Officer



Quality Control Report

Client: Advanced GeoEnvironmental, Inc.
Date Prepared: 2/21/17
Date Analyzed: 2/21/17
Instrument: GC16
Matrix: Air
Project: Swiss Valley Cleaners

WorkOrder: 1702A14
BatchID: 134526
Extraction Method: SW5030B
Analytical Method: SW8260B
Unit: µg/m³
Sample ID: MB/LCS/LCSD-134526

QC Summary Report for SW8260B

Analyte	MB Result	RL	SPK Val	MB SS %REC	MB SS Limits
Ethylbenzene	ND	250	-	-	-
Ethyl tert-butyl ether (ETBE)	ND	250	-	-	-
Freon 113	ND	5000	-	-	-
Hexachlorobutadiene	ND	250	-	-	-
Hexachloroethane	ND	250	-	-	-
2-Hexanone	ND	250	-	-	-
Isopropylbenzene	ND	250	-	-	-
4-Isopropyl toluene	ND	250	-	-	-
Methyl-t-butyl ether (MTBE)	ND	250	-	-	-
Methylene chloride	ND	250	-	-	-
n-Propyl benzene	ND	250	-	-	-
Styrene	ND	250	-	-	-
1,1,1,2-Tetrachloroethane	ND	250	-	-	-
1,1,2,2-Tetrachloroethane	ND	250	-	-	-
Tetrachloroethene	ND	250	-	-	-
Toluene	ND	250	-	-	-
1,2,3-Trichlorobenzene	ND	250	-	-	-
1,2,4-Trichlorobenzene	ND	250	-	-	-
1,1,1-Trichloroethane	ND	250	-	-	-
1,1,2-Trichloroethane	ND	250	-	-	-
Trichloroethene	ND	250	-	-	-
Trichlorofluoromethane	ND	250	-	-	-
1,2,3-Trichloropropane	ND	250	-	-	-
1,2,4-Trimethylbenzene	ND	250	-	-	-
1,3,5-Trimethylbenzene	ND	250	-	-	-
Vinyl Chloride	ND	250	-	-	-
Xylenes, Total	ND	250	-	-	-
Surrogate Recovery					
Dibromofluoromethane	12280		12500	98	70-130
Toluene-d8	11600		12500	93	70-130
4-BFB	1256		1250	100	70-130



Quality Control Report

Client: Advanced GeoEnvironmental, Inc.
Date Prepared: 2/21/17
Date Analyzed: 2/21/17
Instrument: GC16
Matrix: Air
Project: Swiss Valley Cleaners

WorkOrder: 1702A14
BatchID: 134526
Extraction Method: SW5030B
Analytical Method: SW8260B
Unit: µg/m³
Sample ID: MB/LCS/LCSD-134526

QC Summary Report for SW8260B

Analyte	LCS Result	LCSD Result	SPK Val	LCS %REC	LCSD %REC	LCS/LCSD Limits	RPD	RPD Limit
tert-Amyl methyl ether (TAME)	3960	3900	5000	79	78	60-140	1.45	30
Benzene	4200	4130	5000	84	83	60-140	1.85	30
t-Butyl alcohol (TBA)	13,500	13,200	20000	67	66	60-140	1.72	30
Chlorobenzene	3990	3910	5000	80	78	60-140	2.24	30
1,2-Dibromoethane (EDB)	4040	3910	5000	81	78	60-140	3.43	30
1,2-Dichloroethane (1,2-DCA)	3990	3900	5000	80	78	60-140	2.17	30
1,1-Dichloroethene	3880	3820	5000	78	76	60-140	1.54	30
Diisopropyl ether (DIPE)	4200	4160	5000	84	83	60-140	0.891	30
Ethyl tert-butyl ether (ETBE)	4150	4100	5000	83	82	60-140	1.30	30
Methyl-t-butyl ether (MTBE)	4120	4080	5000	82	82	60-140	0	30
Toluene	4070	4000	5000	81	80	60-140	1.79	30
Trichloroethene	4310	4210	5000	86	84	60-140	2.32	30
Xylenes, Total	12,100	11,900	15000	81	79	60-140	2.11	30

Surrogate Recovery

Dibromofluoromethane	12,200	12,300	12500	98	98	60-140	0	30
Toluene-d8	11,700	11,700	12500	94	93	60-140	0.493	30
4-BFB	1260	1270	1250	101	102	60-140	0.781	30



1534 Willow Pass Rd
Pittsburg, CA 94565-1701
(925) 252-9262

CHAIN-OF-CUSTODY RECORD

WorkOrder: 1702A14

ClientCode: AGES

WaterTrax
 WriteOn
 EDF
 Excel
 EQulS
 Email
 HardCopy
 ThirdParty
 J-flag

Report to:

Daniel Villanueva
Advanced GeoEnvironmental, Inc.
837 Shaw Road
Stockton, CA 95215
(209) 467-1006 FAX: (209) 467-1118

Email: dvillanueva@advgeoenv.com
cc/3rd Party:
PO:
ProjectNo: Swiss Valley Cleaners

Bill to:

Erica
Advanced GeoEnvironmental, Inc.
837 Shaw Road
Stockton, CA 95215
ap@advgeoenv.com

Requested TAT: 5 days;

Date Received: 02/21/2017

Date Logged: 02/21/2017

Lab ID	Client ID	Matrix	Collection Date	Hold	Requested Tests (See legend below)												
					1	2	3	4	5	6	7	8	9	10	11	12	
1702A14-001	Influent/Vapor	Air	2/21/2017 10:55	<input type="checkbox"/>	A	A											
1702A14-002	Effluent/Vapor	Air	2/21/2017 10:48	<input type="checkbox"/>	A	A											

Test Legend:

1	8260B_A	2	8260B_A(UG/M3)	3		4	
5		6		7		8	
9		10		11		12	

Prepared by: Maria Venegas

The following SampIDs: 001A, 002A contain testgroup 8260B_A.

Comments:

NOTE: Soil samples are discarded 60 days after results are reported unless other arrangements are made (Water samples are 30 days).
Hazardous samples will be returned to client or disposed of at client expense.



WORK ORDER SUMMARY

Client Name: ADVANCED GEOENVIRONMENTAL, INC.

Project: Swiss Valley Cleaners

Work Order: 1702A14

Client Contact: Daniel Villanueva

QC Level: LEVEL 2

Contact's Email: dvillanueva@advgeoenv.com

Comments:

Date Logged: 2/21/2017

WaterTrax WriteOn EDF Excel Fax Email HardCopy ThirdParty J-flag

Lab ID	Client ID	Matrix	Test Name	Containers /Composites	Bottle & Preservative	De-chlorinated	Collection Date & Time	TAT	Sediment Content	Hold	SubOut
1702A14-001A	Influent/Vapor	Air	VOCs by PT & GCMS	1	Tedlar	<input type="checkbox"/>	2/21/2017 10:55	5 days		<input type="checkbox"/>	
1702A14-002A	Effluent/Vapor	Air	VOCs by PT & GCMS	1	Tedlar	<input type="checkbox"/>	2/21/2017 10:48	5 days		<input type="checkbox"/>	

NOTES: - STLC and TCLP extractions require 2 days to complete; therefore, all TATs begin after the extraction is completed (i.e., One-day TAT yields results in 3 days from sample submission).

- MAI assumes that all material present in the provided sampling container is considered part of the sample - MAI does not exclude any material from the sample prior to sample preparation unless requested in writing by the client.

1702A14



Advanced GeoEnvironmental, Inc.

www.advgeoenv.com

CHAIN OF CUSTODY RECORD

- 837 Shaw Road, Stockton, California 95215 • Phone (209) 467-1006 • Fax (209) 467-1118
- 381 Thor Place, Brea, California 92821 • Phone (714) 529-0200 • Fax (714) 529-0203
- 2318 Fourth Street, Santa Rosa, California 95404 • Phone (707) 570-1418 • Fax (707) 570-1461
- 395 Del Monte Center, #111, Monterey, California 93940 • Phone (800) 511-9300 • Fax (831) 394-5979

Date: 2-21-17 Page 1 of 1

Analysis Required

0926																				
8260																				
VOCs																				
5-																				
8260																				

Project Name <u>Swiss Valley Cleaners</u>	Project Manager <u>Daniel Villanueva</u>
Client	Sampler (initials & signature) <u>Keith Lindgren</u>
Invoice to: <input checked="" type="checkbox"/> AGE <input type="checkbox"/> Client	Lab Project No.:

Sample ID/Location/Description	Date	Time	Matrix	Number	Notes
<u>Influent/Vapor</u>	<u>2-21-17</u>	<u>1055</u>	<u>A</u>	<u>1</u>	
<u>Effluent/Vapor</u>	<u>"</u>	<u>1048</u>	<u>A</u>	<u>1</u>	

Relinquished by: <u>[Signature]</u>	Date: <u>2-21-17</u>	Time: <u>1315</u>	Laboratory: <u>McLampbell</u>	Date:	Time:
Courier: <u>Hand Deliver</u>	Received by:		Date:	Time:	
Relinquished by:	Date:	Time:	Received by:	Date:	Time:
Relinquished by:	Date:	Time:	Received by: <u>[Signature]</u>	Date: <u>2/21/17</u>	Time: <u>1315</u>

Requested Turn Around Time (circle): 24 hours 48 hours 72 hours 5 days (standard) Other: _____

Special Instructions to lab: _____

Matrix Codes: A = Air W = Water S = Solid

I hereby authorize the performance of the above indicated work.

[Signature]

Geotracker EDF to: geotracker@advgeoenv.com _____ Global ID: _____



Sample Receipt Checklist

Client Name: **Advanced GeoEnvironmental, Inc.**
 Project Name: **Swiss Valley Cleaners**
 WorkOrder No: **1702A14** Matrix: Air
 Carrier: Client Drop-In

Date and Time Received: **2/21/2017 13:15**
 Date Logged: **2/21/2017**
 Received by: **Maria Venegas**
 Logged by: **Maria Venegas**

Chain of Custody (COC) Information

Chain of custody present? Yes No
 Chain of custody signed when relinquished and received? Yes No
 Chain of custody agrees with sample labels? Yes No
 Sample IDs noted by Client on COC? Yes No
 Date and Time of collection noted by Client on COC? Yes No
 Sampler's name noted on COC? Yes No

Sample Receipt Information

Custody seals intact on shipping container/cooler? Yes No NA
 Shipping container/cooler in good condition? Yes No
 Samples in proper containers/bottles? Yes No
 Sample containers intact? Yes No
 Sufficient sample volume for indicated test? Yes No

Sample Preservation and Hold Time (HT) Information

All samples received within holding time? Yes No NA
 Sample/Temp Blank temperature Temp: NA
 Water - VOA vials have zero headspace / no bubbles? Yes No NA
 Sample labels checked for correct preservation? Yes No
 pH acceptable upon receipt (Metal: <2; 522: <4; 218.7: >8)? Yes No NA
 Samples Received on Ice? Yes No

UCMR3 Samples:

Total Chlorine tested and acceptable upon receipt for EPA 522? Yes No NA
 Free Chlorine tested and acceptable upon receipt for EPA 218.7, 300.1, 537, 539? Yes No NA

Comments:



McC Campbell Analytical, Inc.

"When Quality Counts"

Analytical Report

WorkOrder: 1703750

Report Created for: Advanced GeoEnvironmental, Inc.

837 Shaw Road
Stockton, CA 95215

Project Contact: Daniel Villanueva

Project P.O.:

Project Name: Swiss Valley Cleaners

Project Received: 03/15/2017

Analytical Report reviewed & approved for release on 03/21/2017 by:

Angela Rydelius,
Laboratory Manager

The report shall not be reproduced except in full, without the written approval of the laboratory. The analytical results relate only to the items tested. Results reported conform to the most current NELAP standards, where applicable, unless otherwise stated in the case narrative.





Glossary of Terms & Qualifier Definitions

Client: Advanced GeoEnvironmental, Inc.
Project: Swiss Valley Cleaners
WorkOrder: 1703750

Glossary Abbreviation

%D	Serial Dilution Percent Difference
95% Interval	95% Confident Interval
DF	Dilution Factor
DI WET	(DISTLC) Waste Extraction Test using DI water
DISS	Dissolved (direct analysis of 0.45 µm filtered and acidified water sample)
DLT	Dilution Test (Serial Dilution)
DUP	Duplicate
EDL	Estimated Detection Limit
ITEF	International Toxicity Equivalence Factor
LCS	Laboratory Control Sample
MB	Method Blank
MB % Rec	% Recovery of Surrogate in Method Blank, if applicable
MDL	Method Detection Limit
ML	Minimum Level of Quantitation
MS	Matrix Spike
MSD	Matrix Spike Duplicate
N/A	Not Applicable
ND	Not detected at or above the indicated MDL or RL
NR	Data Not Reported due to matrix interference or insufficient sample amount.
PDS	Post Digestion Spike
PDSD	Post Digestion Spike Duplicate
PF	Prep Factor
RD	Relative Difference
RL	Reporting Limit (The RL is the lowest calibration standard in a multipoint calibration.)
RPD	Relative Percent Deviation
RRT	Relative Retention Time
SPK Val	Spike Value
SPKRef Val	Spike Reference Value
SPLP	Synthetic Precipitation Leachate Procedure
ST	Sorbent Tube
TCLP	Toxicity Characteristic Leachate Procedure
TEQ	Toxicity Equivalents
WET (STLC)	Waste Extraction Test (Soluble Threshold Limit Concentration)

Analytical Qualifiers

H samples were analyzed out of holding time



Analytical Report

Client: Advanced GeoEnvironmental, Inc.
Date Received: 3/15/17 12:21
Date Prepared: 3/15/17
Project: Swiss Valley Cleaners

WorkOrder: 1703750
Extraction Method: SW5030B
Analytical Method: SW8260B
Unit: µg/m³

Volatile Organics by P&T and GC/MS (Basic Target List)

Client ID	Lab ID	Matrix	Date Collected	Instrument	Batch ID
Influent/Vapor	1703750-001A	Air	03/15/2017 11:20	GC16	135622

Analytes	Result	RL	DF	Date Analyzed
tert-Amyl methyl ether (TAME)	ND	250	1	03/15/2017 16:37
Benzene	ND	250	1	03/15/2017 16:37
Bromobenzene	ND	250	1	03/15/2017 16:37
Bromochloromethane	ND	250	1	03/15/2017 16:37
Bromodichloromethane	ND	250	1	03/15/2017 16:37
Bromoform	ND	250	1	03/15/2017 16:37
Bromomethane	ND	250	1	03/15/2017 16:37
t-Butyl alcohol (TBA)	ND	2500	1	03/15/2017 16:37
n-Butyl benzene	ND	250	1	03/15/2017 16:37
sec-Butyl benzene	ND	250	1	03/15/2017 16:37
tert-Butyl benzene	ND	250	1	03/15/2017 16:37
Carbon Disulfide	ND	250	1	03/15/2017 16:37
Carbon Tetrachloride	ND	250	1	03/15/2017 16:37
Chlorobenzene	ND	250	1	03/15/2017 16:37
Chloroethane	ND	250	1	03/15/2017 16:37
Chloroform	ND	250	1	03/15/2017 16:37
Chloromethane	ND	250	1	03/15/2017 16:37
2-Chlorotoluene	ND	250	1	03/15/2017 16:37
4-Chlorotoluene	ND	250	1	03/15/2017 16:37
Dibromochloromethane	ND	250	1	03/15/2017 16:37
1,2-Dibromo-3-chloropropane	ND	250	1	03/15/2017 16:37
1,2-Dibromoethane (EDB)	ND	250	1	03/15/2017 16:37
Dibromomethane	ND	250	1	03/15/2017 16:37
1,2-Dichlorobenzene	ND	250	1	03/15/2017 16:37
1,3-Dichlorobenzene	ND	250	1	03/15/2017 16:37
1,4-Dichlorobenzene	ND	250	1	03/15/2017 16:37
Dichlorodifluoromethane	ND	250	1	03/15/2017 16:37
1,1-Dichloroethane	ND	250	1	03/15/2017 16:37
1,2-Dichloroethane (1,2-DCA)	ND	250	1	03/15/2017 16:37
1,1-Dichloroethene	ND	250	1	03/15/2017 16:37
cis-1,2-Dichloroethene	ND	250	1	03/15/2017 16:37
trans-1,2-Dichloroethene	ND	250	1	03/15/2017 16:37
1,2-Dichloropropane	ND	250	1	03/15/2017 16:37
1,3-Dichloropropane	ND	250	1	03/15/2017 16:37
2,2-Dichloropropane	ND	250	1	03/15/2017 16:37
1,1-Dichloropropene	ND	250	1	03/15/2017 16:37
cis-1,3-Dichloropropene	ND	250	1	03/15/2017 16:37

(Cont.)



Analytical Report

Client: Advanced GeoEnvironmental, Inc.
Date Received: 3/15/17 12:21
Date Prepared: 3/15/17
Project: Swiss Valley Cleaners

WorkOrder: 1703750
Extraction Method: SW5030B
Analytical Method: SW8260B
Unit: µg/m³

Volatile Organics by P&T and GC/MS (Basic Target List)

Client ID	Lab ID	Matrix	Date Collected	Instrument	Batch ID
Influent/Vapor	1703750-001A	Air	03/15/2017 11:20	GC16	135622

Analytes	Result	RL	DF	Date Analyzed
trans-1,3-Dichloropropene	ND	250	1	03/15/2017 16:37
Diisopropyl ether (DIPE)	ND	250	1	03/15/2017 16:37
Ethylbenzene	ND	250	1	03/15/2017 16:37
Ethyl tert-butyl ether (ETBE)	ND	250	1	03/15/2017 16:37
Freon 113	ND	5000	1	03/15/2017 16:37
Hexachlorobutadiene	ND	250	1	03/15/2017 16:37
Hexachloroethane	ND	250	1	03/15/2017 16:37
2-Hexanone	ND	250	1	03/15/2017 16:37
Isopropylbenzene	ND	250	1	03/15/2017 16:37
4-Isopropyl toluene	ND	250	1	03/15/2017 16:37
Methyl-t-butyl ether (MTBE)	ND	250	1	03/15/2017 16:37
Methylene chloride	ND	250	1	03/15/2017 16:37
n-Propyl benzene	ND	250	1	03/15/2017 16:37
Styrene	ND	250	1	03/15/2017 16:37
1,1,1,2-Tetrachloroethane	ND	250	1	03/15/2017 16:37
1,1,2,2-Tetrachloroethane	ND	250	1	03/15/2017 16:37
Tetrachloroethene	2000	250	1	03/15/2017 16:37
Toluene	ND	250	1	03/15/2017 16:37
1,2,3-Trichlorobenzene	ND	250	1	03/15/2017 16:37
1,2,4-Trichlorobenzene	ND	250	1	03/15/2017 16:37
1,1,1-Trichloroethane	ND	250	1	03/15/2017 16:37
1,1,2-Trichloroethane	ND	250	1	03/15/2017 16:37
Trichloroethene	ND	250	1	03/15/2017 16:37
Trichlorofluoromethane	ND	250	1	03/15/2017 16:37
1,2,3-Trichloropropane	ND	250	1	03/15/2017 16:37
1,2,4-Trimethylbenzene	ND	250	1	03/15/2017 16:37
1,3,5-Trimethylbenzene	ND	250	1	03/15/2017 16:37
Vinyl Chloride	ND	250	1	03/15/2017 16:37
Xylenes, Total	ND	250	1	03/15/2017 16:37
Surrogates	REC (%)	Limits		
Dibromofluoromethane	98	70-130		03/15/2017 16:37
Toluene-d8	95	70-130		03/15/2017 16:37
4-BFB	92	70-130		03/15/2017 16:37

Analyst(s): KF

(Cont.)

NELAP 4033ORELAP

 Angela Rydelius, Lab Manager



Analytical Report

Client: Advanced GeoEnvironmental, Inc.
Date Received: 3/15/17 12:21
Date Prepared: 3/15/17
Project: Swiss Valley Cleaners

WorkOrder: 1703750
Extraction Method: SW5030B
Analytical Method: SW8260B
Unit: µg/m³

Volatile Organics by P&T and GC/MS (Basic Target List)

Client ID	Lab ID	Matrix	Date Collected	Instrument	Batch ID
Effluent/Vapor	1703750-002A	Air	03/15/2017 11:22	GC16	135622

Analytes	Result	Qualifiers	RL	DF	Date Analyzed
tert-Amyl methyl ether (TAME)	ND	H	250	1	03/15/2017 17:25
Benzene	ND	H	250	1	03/15/2017 17:25
Bromobenzene	ND	H	250	1	03/15/2017 17:25
Bromochloromethane	ND	H	250	1	03/15/2017 17:25
Bromodichloromethane	ND	H	250	1	03/15/2017 17:25
Bromoform	ND	H	250	1	03/15/2017 17:25
Bromomethane	ND	H	250	1	03/15/2017 17:25
t-Butyl alcohol (TBA)	ND	H	2500	1	03/15/2017 17:25
n-Butyl benzene	ND	H	250	1	03/15/2017 17:25
sec-Butyl benzene	ND	H	250	1	03/15/2017 17:25
tert-Butyl benzene	ND	H	250	1	03/15/2017 17:25
Carbon Disulfide	ND	H	250	1	03/15/2017 17:25
Carbon Tetrachloride	ND	H	250	1	03/15/2017 17:25
Chlorobenzene	ND	H	250	1	03/15/2017 17:25
Chloroethane	ND	H	250	1	03/15/2017 17:25
Chloroform	ND	H	250	1	03/15/2017 17:25
Chloromethane	ND	H	250	1	03/15/2017 17:25
2-Chlorotoluene	ND	H	250	1	03/15/2017 17:25
4-Chlorotoluene	ND	H	250	1	03/15/2017 17:25
Dibromochloromethane	ND	H	250	1	03/15/2017 17:25
1,2-Dibromo-3-chloropropane	ND	H	250	1	03/15/2017 17:25
1,2-Dibromoethane (EDB)	ND	H	250	1	03/15/2017 17:25
Dibromomethane	ND	H	250	1	03/15/2017 17:25
1,2-Dichlorobenzene	ND	H	250	1	03/15/2017 17:25
1,3-Dichlorobenzene	ND	H	250	1	03/15/2017 17:25
1,4-Dichlorobenzene	ND	H	250	1	03/15/2017 17:25
Dichlorodifluoromethane	ND	H	250	1	03/15/2017 17:25
1,1-Dichloroethane	ND	H	250	1	03/15/2017 17:25
1,2-Dichloroethane (1,2-DCA)	ND	H	250	1	03/15/2017 17:25
1,1-Dichloroethene	ND	H	250	1	03/15/2017 17:25
cis-1,2-Dichloroethene	ND	H	250	1	03/15/2017 17:25
trans-1,2-Dichloroethene	ND	H	250	1	03/15/2017 17:25
1,2-Dichloropropane	ND	H	250	1	03/15/2017 17:25
1,3-Dichloropropane	ND	H	250	1	03/15/2017 17:25
2,2-Dichloropropane	ND	H	250	1	03/15/2017 17:25
1,1-Dichloropropene	ND	H	250	1	03/15/2017 17:25
cis-1,3-Dichloropropene	ND	H	250	1	03/15/2017 17:25

(Cont.)



Analytical Report

Client: Advanced GeoEnvironmental, Inc.
Date Received: 3/15/17 12:21
Date Prepared: 3/15/17
Project: Swiss Valley Cleaners

WorkOrder: 1703750
Extraction Method: SW5030B
Analytical Method: SW8260B
Unit: µg/m³

Volatile Organics by P&T and GC/MS (Basic Target List)

Client ID	Lab ID	Matrix	Date Collected	Instrument	Batch ID
Effluent/Vapor	1703750-002A	Air	03/15/2017 11:22	GC16	135622

Analytes	Result	Qualifiers	RL	DF	Date Analyzed
trans-1,3-Dichloropropene	ND	H	250	1	03/15/2017 17:25
Diisopropyl ether (DIPE)	ND	H	250	1	03/15/2017 17:25
Ethylbenzene	ND	H	250	1	03/15/2017 17:25
Ethyl tert-butyl ether (ETBE)	ND	H	250	1	03/15/2017 17:25
Freon 113	ND	H	5000	1	03/15/2017 17:25
Hexachlorobutadiene	ND	H	250	1	03/15/2017 17:25
Hexachloroethane	ND	H	250	1	03/15/2017 17:25
2-Hexanone	ND	H	250	1	03/15/2017 17:25
Isopropylbenzene	ND	H	250	1	03/15/2017 17:25
4-Isopropyl toluene	ND	H	250	1	03/15/2017 17:25
Methyl-t-butyl ether (MTBE)	ND	H	250	1	03/15/2017 17:25
Methylene chloride	ND	H	250	1	03/15/2017 17:25
n-Propyl benzene	ND	H	250	1	03/15/2017 17:25
Styrene	ND	H	250	1	03/15/2017 17:25
1,1,1,2-Tetrachloroethane	ND	H	250	1	03/15/2017 17:25
1,1,2,2-Tetrachloroethane	ND	H	250	1	03/15/2017 17:25
Tetrachloroethene	ND	H	250	1	03/15/2017 17:25
Toluene	ND	H	250	1	03/15/2017 17:25
1,2,3-Trichlorobenzene	ND	H	250	1	03/15/2017 17:25
1,2,4-Trichlorobenzene	ND	H	250	1	03/15/2017 17:25
1,1,1-Trichloroethane	ND	H	250	1	03/15/2017 17:25
1,1,2-Trichloroethane	ND	H	250	1	03/15/2017 17:25
Trichloroethene	ND	H	250	1	03/15/2017 17:25
Trichlorofluoromethane	ND	H	250	1	03/15/2017 17:25
1,2,3-Trichloropropane	ND	H	250	1	03/15/2017 17:25
1,2,4-Trimethylbenzene	ND	H	250	1	03/15/2017 17:25
1,3,5-Trimethylbenzene	ND	H	250	1	03/15/2017 17:25
Vinyl Chloride	ND	H	250	1	03/15/2017 17:25
Xylenes, Total	ND	H	250	1	03/15/2017 17:25
Surrogates	REC (%)	Qualifiers	Limits		
Dibromofluoromethane	98	H	70-130		03/15/2017 17:25
Toluene-d8	94	H	70-130		03/15/2017 17:25
4-BFB	92	H	70-130		03/15/2017 17:25

Analyst(s): KF



Quality Control Report

Client: Advanced GeoEnvironmental, Inc.
Date Prepared: 3/15/17
Date Analyzed: 3/15/17
Instrument: GC16
Matrix: Air
Project: Swiss Valley Cleaners

WorkOrder: 1703750
BatchID: 135622
Extraction Method: SW5030B
Analytical Method: SW8260B
Unit: µg/m³
Sample ID: MB/LCS/LCSD-135622

QC Summary Report for SW8260B

Analyte	MB Result	RL	SPK Val	MB SS %REC	MB SS Limits
tert-Amyl methyl ether (TAME)	ND	250	-	-	-
Benzene	ND	250	-	-	-
Bromobenzene	ND	250	-	-	-
Bromochloromethane	ND	250	-	-	-
Bromodichloromethane	ND	250	-	-	-
Bromoform	ND	250	-	-	-
Bromomethane	ND	250	-	-	-
t-Butyl alcohol (TBA)	ND	2500	-	-	-
n-Butyl benzene	ND	250	-	-	-
sec-Butyl benzene	ND	250	-	-	-
tert-Butyl benzene	ND	250	-	-	-
Carbon Disulfide	ND	250	-	-	-
Carbon Tetrachloride	ND	250	-	-	-
Chlorobenzene	ND	250	-	-	-
Chloroethane	ND	250	-	-	-
Chloroform	ND	250	-	-	-
Chloromethane	ND	250	-	-	-
2-Chlorotoluene	ND	250	-	-	-
4-Chlorotoluene	ND	250	-	-	-
Dibromochloromethane	ND	250	-	-	-
1,2-Dibromo-3-chloropropane	ND	250	-	-	-
1,2-Dibromoethane (EDB)	ND	250	-	-	-
Dibromomethane	ND	250	-	-	-
1,2-Dichlorobenzene	ND	250	-	-	-
1,3-Dichlorobenzene	ND	250	-	-	-
1,4-Dichlorobenzene	ND	250	-	-	-
Dichlorodifluoromethane	ND	250	-	-	-
1,1-Dichloroethane	ND	250	-	-	-
1,2-Dichloroethane (1,2-DCA)	ND	250	-	-	-
1,1-Dichloroethene	ND	250	-	-	-
cis-1,2-Dichloroethene	ND	250	-	-	-
trans-1,2-Dichloroethene	ND	250	-	-	-
1,2-Dichloropropane	ND	250	-	-	-
1,3-Dichloropropane	ND	250	-	-	-
2,2-Dichloropropane	ND	250	-	-	-
1,1-Dichloropropene	ND	250	-	-	-
cis-1,3-Dichloropropene	ND	250	-	-	-
trans-1,3-Dichloropropene	ND	250	-	-	-
Diisopropyl ether (DIPE)	ND	250	-	-	-

(Cont.)

NELAP 4033ORELAP

 QA/QC Officer



Quality Control Report

Client: Advanced GeoEnvironmental, Inc.
Date Prepared: 3/15/17
Date Analyzed: 3/15/17
Instrument: GC16
Matrix: Air
Project: Swiss Valley Cleaners

WorkOrder: 1703750
BatchID: 135622
Extraction Method: SW5030B
Analytical Method: SW8260B
Unit: µg/m³
Sample ID: MB/LCS/LCSD-135622

QC Summary Report for SW8260B

Analyte	MB Result	RL	SPK Val	MB SS %REC	MB SS Limits
Ethylbenzene	ND	250	-	-	-
Ethyl tert-butyl ether (ETBE)	ND	250	-	-	-
Freon 113	ND	5000	-	-	-
Hexachlorobutadiene	ND	250	-	-	-
Hexachloroethane	ND	250	-	-	-
2-Hexanone	ND	250	-	-	-
Isopropylbenzene	ND	250	-	-	-
4-Isopropyl toluene	ND	250	-	-	-
Methyl-t-butyl ether (MTBE)	ND	250	-	-	-
Methylene chloride	ND	250	-	-	-
n-Propyl benzene	ND	250	-	-	-
Styrene	ND	250	-	-	-
1,1,1,2-Tetrachloroethane	ND	250	-	-	-
1,1,2,2-Tetrachloroethane	ND	250	-	-	-
Tetrachloroethene	ND	250	-	-	-
Toluene	ND	250	-	-	-
1,2,3-Trichlorobenzene	ND	250	-	-	-
1,2,4-Trichlorobenzene	ND	250	-	-	-
1,1,1-Trichloroethane	ND	250	-	-	-
1,1,2-Trichloroethane	ND	250	-	-	-
Trichloroethene	ND	250	-	-	-
Trichlorofluoromethane	ND	250	-	-	-
1,2,3-Trichloropropane	ND	250	-	-	-
1,2,4-Trimethylbenzene	ND	250	-	-	-
1,3,5-Trimethylbenzene	ND	250	-	-	-
Vinyl Chloride	ND	250	-	-	-
Xylenes, Total	ND	250	-	-	-

Surrogate Recovery

Dibromofluoromethane	12440		12500	100	70-130
Toluene-d8	11990		12500	96	70-130
4-BFB	1236		1250	99	70-130



Quality Control Report

Client: Advanced GeoEnvironmental, Inc.
Date Prepared: 3/15/17
Date Analyzed: 3/15/17
Instrument: GC16
Matrix: Air
Project: Swiss Valley Cleaners

WorkOrder: 1703750
BatchID: 135622
Extraction Method: SW5030B
Analytical Method: SW8260B
Unit: µg/m³
Sample ID: MB/LCS/LCSD-135622

QC Summary Report for SW8260B

Analyte	LCS Result	LCSD Result	SPK Val	LCS %REC	LCSD %REC	LCS/LCSD Limits	RPD	RPD Limit
tert-Amyl methyl ether (TAME)	4590	4650	5000	92	93	56-133	1.29	30
Benzene	5120	5180	5000	102	104	72-122	1.12	30
t-Butyl alcohol (TBA)	13,900	14,200	20000	69	71	35-121	2.28	30
Chlorobenzene	4740	4860	5000	95	97	69-112	2.41	30
1,2-Dibromoethane (EDB)	4700	4760	5000	94	95	62-117	1.25	30
1,2-Dichloroethane (1,2-DCA)	4680	4740	5000	94	95	61-126	1.16	30
1,1-Dichloroethene	4610	4670	5000	92	93	67-122	1.31	30
Diisopropyl ether (DIPE)	4980	5050	5000	100	101	61-131	1.48	30
Ethyl tert-butyl ether (ETBE)	4910	5020	5000	98	100	63-132	2.15	30
Methyl-t-butyl ether (MTBE)	5580	5640	5000	112	113	63-127	0.961	30
Toluene	4840	4960	5000	97	99	64-115	2.46	30
Trichloroethene	5020	5140	5000	100	103	66-127	2.32	30
Xylenes, Total	14,300	15,000	15000	96	100	53-131	4.35	30

Surrogate Recovery

Dibromofluoromethane	12,400	12,300	12500	99	99	83-124	0	30
Toluene-d8	11,900	11,900	12500	95	95	80-120	0	30
4-BFB	1210	1250	1250	97	100	70-129	3.19	30



1534 Willow Pass Rd
Pittsburg, CA 94565-1701
(925) 252-9262

CHAIN-OF-CUSTODY RECORD

WorkOrder: 1703750

ClientCode: AGES

WaterTrax
 WriteOn
 EDF
 Excel
 EQulS
 Email
 HardCopy
 ThirdParty
 J-flag

Report to:

Daniel Villanueva
Advanced GeoEnvironmental, Inc.
837 Shaw Road
Stockton, CA 95215
(209) 467-1006 FAX: (209) 467-1118

Email: dvillanueva@advgeoenv.com
cc/3rd Party:
PO:
ProjectNo: Swiss Valley Cleaners

Bill to:

Erica
Advanced GeoEnvironmental, Inc.
837 Shaw Road
Stockton, CA 95215
ap@advgeoenv.com

Requested TAT: 5 days;

Date Received: 03/15/2017

Date Logged: 03/15/2017

Lab ID	Client ID	Matrix	Collection Date	Hold	Requested Tests (See legend below)												
					1	2	3	4	5	6	7	8	9	10	11	12	
1703750-001	Influent/Vapor	Air	3/15/2017 11:20	<input type="checkbox"/>	A												
1703750-002	Effluent/Vapor	Air	3/15/2017 11:22	<input type="checkbox"/>	A												

Test Legend:

1	8260B_A(UG/M3)	2		3		4	
5		6		7		8	
9		10		11		12	

Prepared by: Jena Alfaro

The following SamplIDs: 001A, 002A contain testgroup 8260B_A.

Comments:

NOTE: Soil samples are discarded 60 days after results are reported unless other arrangements are made (Water samples are 30 days).
Hazardous samples will be returned to client or disposed of at client expense.



WORK ORDER SUMMARY

Client Name: ADVANCED GEOENVIRONMENTAL, INC.

Project: Swiss Valley Cleaners

Work Order: 1703750

Client Contact: Daniel Villanueva

QC Level: LEVEL 2

Contact's Email: dvillanueva@advgeoenv.com

Comments:

Date Logged: 3/15/2017

WaterTrax WriteOn EDF Excel Fax Email HardCopy ThirdParty J-flag

Lab ID	Client ID	Matrix	Test Name	Containers /Composites	Bottle & Preservative	De-chlorinated	Collection Date & Time	TAT	Sediment Content	Hold	SubOut
1703750-001A	Influent/Vapor	Air	VOCs by PT & GCMS	1	Tedlar	<input type="checkbox"/>	3/15/2017 11:20	5 days		<input type="checkbox"/>	
1703750-002A	Effluent/Vapor	Air	VOCs by PT & GCMS	1	Tedlar	<input type="checkbox"/>	3/15/2017 11:22	5 days		<input type="checkbox"/>	

NOTES: - STLC and TCLP extractions require 2 days to complete; therefore, all TATs begin after the extraction is completed (i.e., One-day TAT yields results in 3 days from sample submission).

- MAI assumes that all material present in the provided sampling container is considered part of the sample - MAI does not exclude any material from the sample prior to sample preparation unless requested in writing by the client.

1703750



Advanced GeoEnvironmental, Inc.

www.advgeoenv.com

CHAIN OF CUSTODY RECORD

- 837 Shaw Road, Stockton, California 95215 • Phone (209) 467-1006 • Fax (209) 467-1118
- 381 Thor Place, Brea, California 92821 • Phone (714) 529-0200 • Fax (714) 529-0203
- 2318 Fourth Street, Santa Rosa, California 95404 • Phone (707) 570-1418 • Fax (707) 570-1461
- 395 Del Monte Center, #111, Monterey, California 93940 • Phone (800) 511-9300 • Fax (831) 394-5979
-

Date: 3/15/17 Page 1 of 1

Analysis Required

XX VOC's 8260

Project Name: Swiss Valley Cleaners Project Manager: Daniel Villanueva

Client: _____ Sampler (initials & signature): Rm

Invoice to: AGE Client Lab Project No.: _____

Sample ID/Location/Description	Date	Time	Matrix	Number	Notes
<u>Influent / vapor</u>	<u>3/15/17</u>	<u>1120</u>	<u>A</u>	<u>1</u>	
<u>Effluent / vapor</u>	<u>3/15/17</u>	<u>1122</u>	<u>A</u>	<u>1</u>	

Relinquished by: Ruel Maest Date: 3/15/17 Time: 1222 Laboratory: McCampbell Labs

Courier: Delivered Rm Received by: _____ Date: _____ Time: _____

Relinquished by: _____ Date: _____ Time: _____ Received by: _____ Date: _____ Time: _____

Relinquished by: _____ Date: _____ Time: _____ Received by: Marcus Date: 3/15/17 Time: 1221

Requested Turn Around Time (circle): 24 hours 48 hours 72 hours 5 days (standard) Other: _____ Matrix Codes: A = Air W = Water S = Solid

Special Instructions to lab: _____ I hereby authorize the performance of the above indicated work.
Ruel Maest
Geotracker EDF to: geotracker@advgeoenv.com Global ID: _____



Sample Receipt Checklist

Client Name: **Advanced GeoEnvironmental, Inc.**
 Project Name: **Swiss Valley Cleaners**
 WorkOrder No: **1703750** Matrix: Air
 Carrier: Client Drop-In

Date and Time Received: **3/15/2017 12:21**
 Date Logged: **3/15/2017**
 Received by: Jena Alfaro
 Logged by: Jena Alfaro

Chain of Custody (COC) Information

Chain of custody present? Yes No
 Chain of custody signed when relinquished and received? Yes No
 Chain of custody agrees with sample labels? Yes No
 Sample IDs noted by Client on COC? Yes No
 Date and Time of collection noted by Client on COC? Yes No
 Sampler's name noted on COC? Yes No

Sample Receipt Information

Custody seals intact on shipping container/cooler? Yes No NA
 Shipping container/cooler in good condition? Yes No
 Samples in proper containers/bottles? Yes No
 Sample containers intact? Yes No
 Sufficient sample volume for indicated test? Yes No

Sample Preservation and Hold Time (HT) Information

All samples received within holding time? Yes No NA
 Sample/Temp Blank temperature Temp: NA
 Water - VOA vials have zero headspace / no bubbles? Yes No NA
 Sample labels checked for correct preservation? Yes No
 pH acceptable upon receipt (Metal: <2; 522: <4; 218.7: >8)? Yes No NA
 Samples Received on Ice? Yes No

UCMR3 Samples:

Total Chlorine tested and acceptable upon receipt for EPA 522? Yes No NA
 Free Chlorine tested and acceptable upon receipt for EPA 218.7, 300.1, 537, 539? Yes No NA

Comments:

APPENDIX B

APPENDIX B
MASS-VOLUME CALCULATIONS
 Swiss Valley Cleaners
 1395 MacArthur Boulevard
 San Leandro, California

$$M = C \times Q \times t$$

C = vapor concentration (kg/m³)

Q = extraction flow rate (m³/hr)

t = operational period (hrs)

To convert, multiply by: 0.000001

To convert, multiply by: 60 min/hr

and: 0.0283168 m³/ft³

$$M(\text{kg}) = (\text{Avg concentration})(0.000001) \times [\text{flow}(\text{ft}^3/\text{min})](60 \text{ min/hr})(0.0283168 \text{ m}^3/\text{ft}^3) \times \text{time}(\text{hrs})$$

Converting kg of M to lbs of M, multiply by: 2.2046 lbs/kg

Converting lbs of M to gal of M, multiply by: 0.074 gal/lb

Dates	Hours	Average Flow		PCE Concentration		PCE Extracted		
		scfm	m ³ /hr	µg/l	kg/m ³	kg	lbs	gallons
11/11/16 to 11/14/16	74.7	167	284	16.5	0.0000165	0.3497	0.7710	0.05705
11/14/16 to 11/15/16	23.9	171	291	9	0.000009	0.0625	0.1378	0.0102
11/15/16 to 11/16/16	23.4	171	291	6.5	0.0000065	0.0442	0.0974	0.0072
11/16/16 to 11/17/16	23.2	171	291	3.5	0.0000035	0.0236	0.0520	0.0038
11/17/16 to 12/15/16	670.9	171	291	2.2	0.0000022	0.4288	0.9454	0.0700
12/15/16 to 01/19/17	462.1	178.5	303	8.9	0.0000089	1.2473	2.7497	0.2035
01/19/17 to 02/21/17	792.2	192.5	327	2.1	0.0000021	0.5441	1.1995	0.0888
02/21/17 to 03/15/17	430.8	192.5	327	2.0	0.000002	0.2818	0.6212	0.0460
Total PCE removed:						2.9820	6.5741	0.4865

APPENDIX C

Influent PCE Vs. Time

