

## Detterman, Mark, Env. Health

---

**From:** Daniel Villanueva [dvillanueva@advgeoenv.com]  
**Sent:** Wednesday, December 23, 2015 1:19 PM  
**To:** Detterman, Mark, Env. Health  
**Subject:** RE: Email Followup  
**Attachments:** SVC Figure 8 Soil Vapor Well an.pdf; SVC Figure 8 Soil-Vapor Well De.pdf

Mark,

Attached is the site plan showing the well designations and the proposed trenching locations.

### Well breakdown and trenching locations:

VW-1, -2, -3, -4 and single common trench will be run down the center of the unit to connect the outer wells and the two wells on the inside wells. The piping will be run to the north wall in the trench then will be brought to the surface and run along the north wall to the outside of the unit. VW-1 will have a small trench running to the south wall where it will be brought to the surface and run along the south wall.

VW-18- A small trench will be run from the well to the wall then brought to the surface and run along the south wall.

VW-20 – A small trench will be run from the well to the north wall and then piping will be brought to the surface and run along the north wall.

VW-21 – A trench will be run from the well and then out the back of the facility. All piping will be run underground at this wells locations.

Wells in Jazzercise are all piped underground already.

All wells in the rear of the facility will be piped underground.

All wells in the front of the strip mall on the east side of the building (VW-12, VW-13 and VW-17) will be piped in short trenches to and then to the pillars where they will either meet up with the main trench near VW-2 or will be run up and over the building on the roof.

I have attached a cut view diagram of how each of the wells were installed. I planned on putting boring logs documenting the installs in the remediation system installation report. I am working on a well construction table right now and will be getting it over to you shortly.

Regards,

**Daniel Villanueva**

**Project Geologist**

**Advanced GeoEnvironmental, Inc.**

*Environmental • Industrial Hygiene • Geotechnical • Contracting*

**Phone: 800-511-9300**

**Fax: 888-445-8786**

[dvillanueva@advgeoenv.com](mailto:dvillanueva@advgeoenv.com)

[www.advgeoenv.com](http://www.advgeoenv.com)

This email/fax message is for the sole use of the intended recipient(s) and may contain confidential and privileged information. Any unauthorized review, use, disclosure or distribution of this email/fax is prohibited. If you are not the intended recipient, please contact the sender by email/fax and destroy all paper and electronic copies of the original message.

---

**From:** Detterman, Mark, Env. Health [<mailto:Mark.Detterman@acgov.org>]  
**Sent:** Wednesday, December 23, 2015 12:28 PM  
**To:** Daniel Villanueva  
**Subject:** Email Followup

Daniel,  
I've not received an email / PDF yet and wanted to check to make sure it had or had not been sent.

*Mark Detterman*  
*Senior Hazardous Materials Specialist, PG, CEG*  
*Alameda County Environmental Health*  
*1131 Harbor Bay Parkway*  
*Alameda, CA 94502*  
*Direct: 510.567.6876*  
*Fax: 510.337.9335*  
*Email: [mark.detterman@acgov.org](mailto:mark.detterman@acgov.org)*

*PDF copies of case files can be downloaded at:*

*<http://www.acgov.org/aceh/lop/ust.htm>*

**LEGEND**

- B60 SOIL BORING LOCATIONS AND DESIGNATIONS
- ⊕ VW-4 SOIL-VAPOR EXTRACTION WELL LOCATION
- ⊕ SS-1 SUB-SLAB VAPOR WELL LOCATION
- ◇ SURFACE DRAIN/SEWER CLEANOUT LOCATION
- SEWER LINE LOCATION
- WATER LINE LOCATION
- CURRENT DRY CLEANING BUILDING
- HISTORICAL DRY CLEANING BUILDING
- ◇ SURFACE DRAIN/SEWER CLEANOUT LOCATION
- PROPOSED OR COMPLETED TRENCHING LOCATIONS

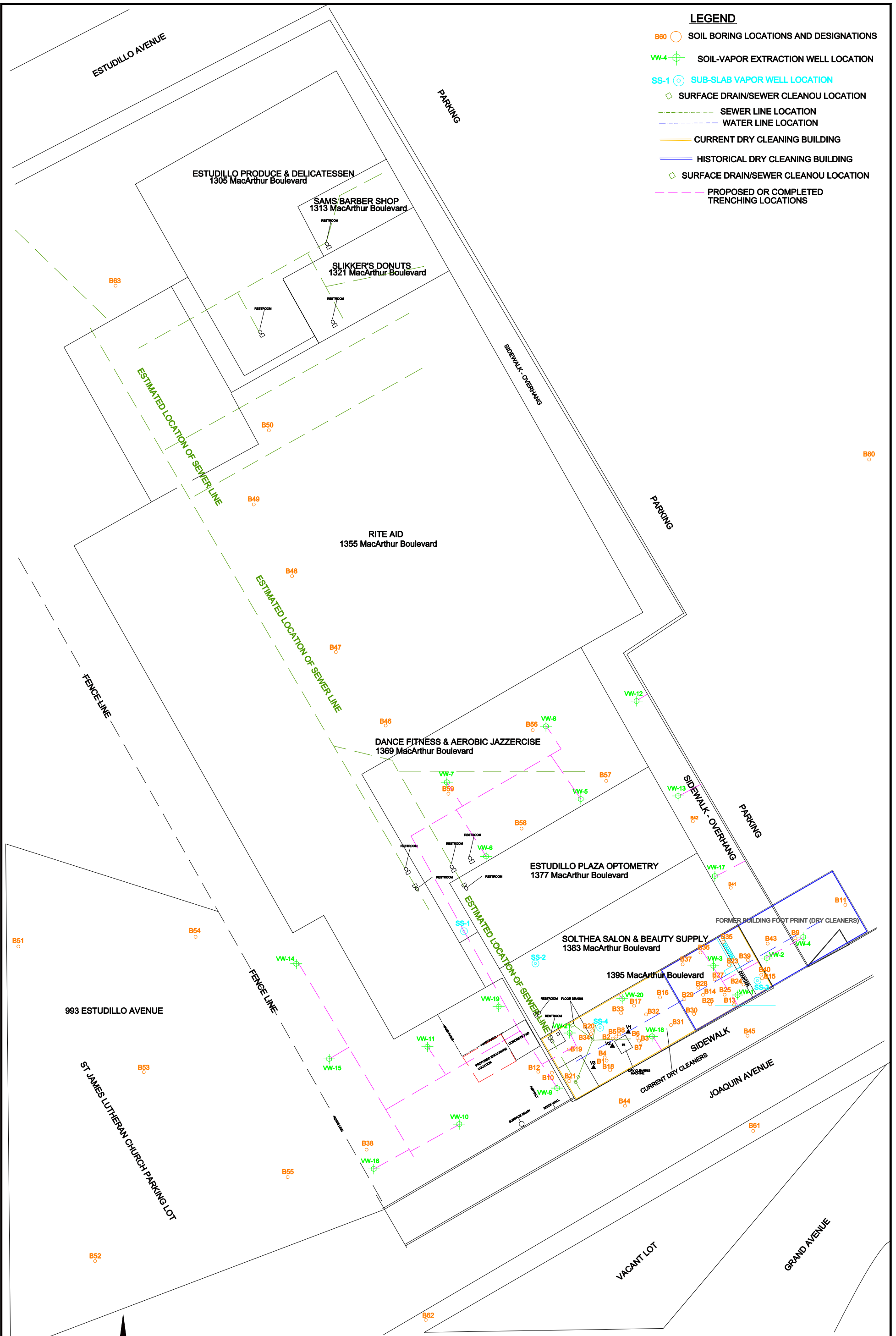

**SOIL VAPOR WELLS & TRENCHING LOCATIONS**  
**SWISS VALLEY CLEANERS**  
**1395 MACARUTHER BOULEVARD**  
**SAN LEANDRO, CALIFORNIA**



**Advanced**  
**GeoEnvironmental, Inc.**  
 www.advgeoenv.com

PROJECT NO. AGE 12-2461	FILE: FILE	FIGURE:
DATE: MAY 2014	DRAWN BY: MAC	<b>8</b>

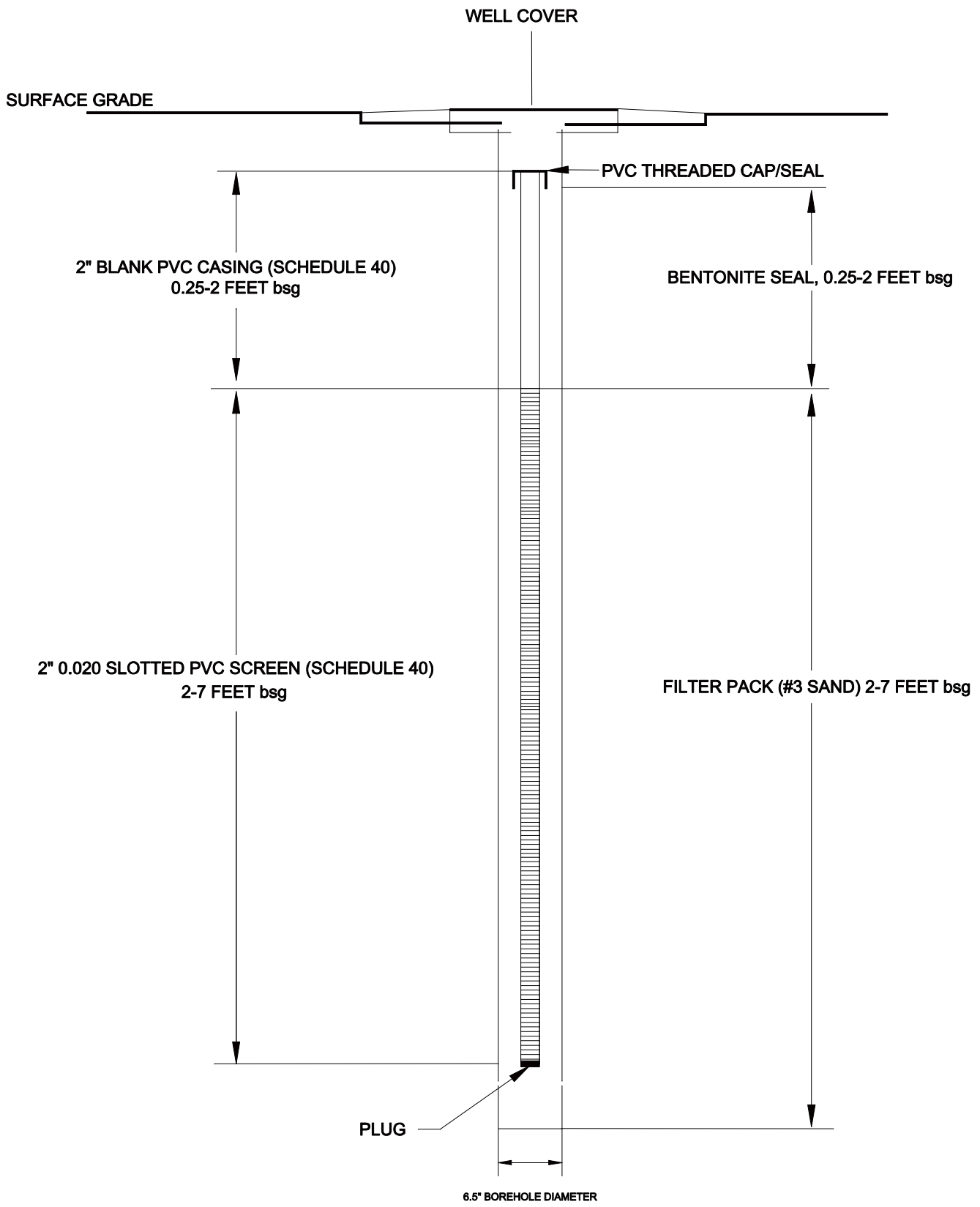

ALL DEPTHS RELATIVE TO SURFACE GRADE  
NOT TO SCALE

**PROPOSED SOIL VAPOR WELL**  
**SWISS VALLEY CLEANERS**  
 1395 MacArthur Boulevard  
 SAN LEANDRO, CALIFORNIA

**Advanced**  
 GeoEnvironmental, Inc.  
[www.advgeoenv.com](http://www.advgeoenv.com)

PROJECT NO. AGE-12-2461	FILE: ESL	FIGURE:
DATE: MAY 2014	DRAWN BY: MAC	<b>8</b>