

SCHEDULE "B"
 CURB, GUTTER, SIDEWALK AND DRIVEWAY IMPROVEMENTS

IMPROVEMENT NUMBER	DESCRIPTION	STATION	LEFT	RIGHT	F.S. ELEVATION
1	5' WIDE WALK	0 + 23.50	129.54		15.15
2	10' WIDE D.W.	1 + 24.00	129.54		15.17
3	5' WIDE WALK	1 + 45.00	129.54		15.18
4	10' WIDE D.W.	1 + 24.00	129.54		15.25
5	5' WIDE WALK	2 + 24.00	129.54		15.16
6	10' WIDE D.W.	2 + 24.00	129.54		14.55
7	15' WIDE D.W.	1 + 21.24	129.54		14.49
8	5' WIDE WALK	3 + 25.24	129.54		14.74
9	10' WIDE D.W.	3 + 25.24	129.54		15.24
10	11' WIDE WALK	4 + 28.24	129.54		14.76
11	10' WIDE D.W.	4 + 28.24	129.54		14.55
12	5' WIDE WALK	5 + 18.24	129.54		14.80
13	4' WIDE WALK	2 + 14.00	83.50		15.04
14	10' WIDE D.W.	0 + 14.00	20.50		14.20
15	5' WIDE WALK	3 + 14.00		15.50	15.30
16	10' WIDE D.W.	2 + 14.00		15.50	14.77
17	5' WIDE WALK	0 + 14.00		15.50	14.64
18	11' WIDE WALK	0 + 25.00		129.54	14.50
19	10' WIDE D.W.	1 + 25.00	129.54		15.51
20	5' WIDE WALK	1 + 45.00	129.54		15.33
21	11' WIDE D.W.	1 + 28.24	129.54		14.80
22	5' WIDE WALK	2 + 15.24	129.54		14.70
23	15' - 0" WIDE D.W.	2 + 02.50		129.54	15.54
24	5' WIDE WALK	1 + 15.24		129.54	14.58
25	10' WIDE D.W.	3 + 15.24	129.54		15.50
26	4' WIDE WALK	4 + 20.24	129.54		15.30
27	10' WIDE D.W.	4 + 13.24	129.54		15.30
28	5' WIDE WALK	5 + 20.24	129.54		15.23
29	4' WIDE WALK	5 + 23.24	83.53		15.77
30	10' WIDE D.W.	5 + 23.24		35.00	14.24
31	10' WIDE D.W.	5 + 23.24	2.00		14.58
32	4' WIDE WALK	5 + 23.24	12.50		14.43
33	10' WIDE D.W.	5 + 23.24	35.00		14.53
34	4' WIDE WALK	5 + 23.24	83.53		14.09

55

W

W

WALK

①	STANDARD 2015 SANDS	1 + 15.00 2 + 67.41	128.05
②	STANDARD 2015 SANDS	1 + 38.02 2 + 14.72	14.72
③	SW. C & S	1 + 10.74 2 + 40.74	14.70 14.61
④	SW. C & S	1 + 50.17 2 + 10.74	128.05 18.58
⑤	SW. C & S	1 + 11.37 2 + 14.00	113.00 14.00
⑥	C & S	1 + 37.57 2 + 43.00	128.05 15.10

Note: For Sanitary Sewer location
see separate Sewer Plan

RECEIVED
SEP 10 1980

ENGR. DEPT. - RM. 207
CITY OF ALAMEDA

B. OF E. <i>Richard Carter</i>	REV.	DATE	BY	DESCRIPTION
PAC. TEL. <i>E. Cooper</i>	APPROVED: <i>A.J. Bettles</i>			IMPROVEMENT PLAN TRACT 4270 ALAMEDA CALIFORNIA A. J. BETTLES CIVIL ENGINEER 427 BURK STREET OAKLAND, CA. 94610 (415) 444-0642 JOB NO. 801 SHEET 3 OF 7
P.G. & E. <i>Norman T. Gamm</i>	R.E. NO. 17205			
E.B.M.U.D. <i>W. Lam</i>	CHECKED:			
	DRAWN: J.P.			
	DESIGNED:			
CITY ENGR. <i>D. P. ...</i>	SCALE: 1" = 20'			
	DATE:			

18 AUG 1980

7640B-III

MATCH LINE

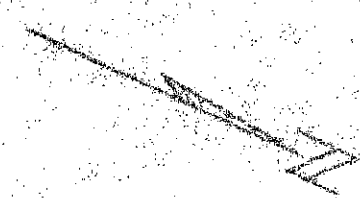

IMPROVEMENT PLAN
SCALE: 1"=20'

COURT
60' WIDE
STREET

2135.00
E WALK

1486.00
E D.W.

1443.00
E 10 TC

1445.00
E WALK

1437.37
E 10 TC

1426.00
E D.W.

0483.50
E WALK

6750 LF
E 50 TC

13 LEFT 63.50
E WALK

TRANSFORMER
EASEMENT

REPLACE EXIST. HYDRANT
WITH NEW TYPE 68 HYDRANT
ASSEMBLY

REMOVE EXIST. DRAIN PIPES

FOR CULVERT REMOVAL AND CORNER
RECONSTRUCTION SEE SHT. NO. 7

137.54

CENTRAL AVENUE

17

16

15

13

2135.00
147.70

1426.00

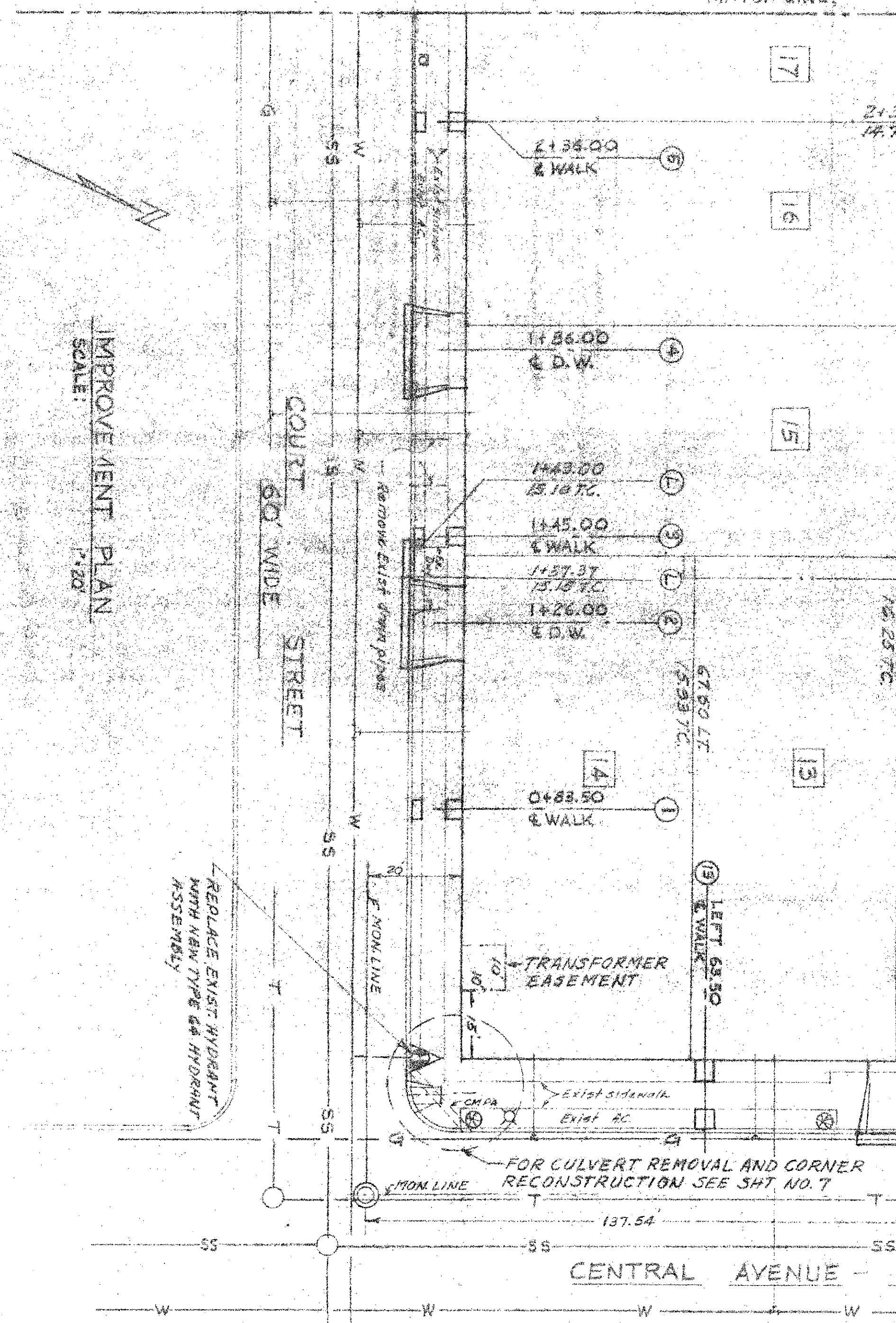

5 FT WIDE

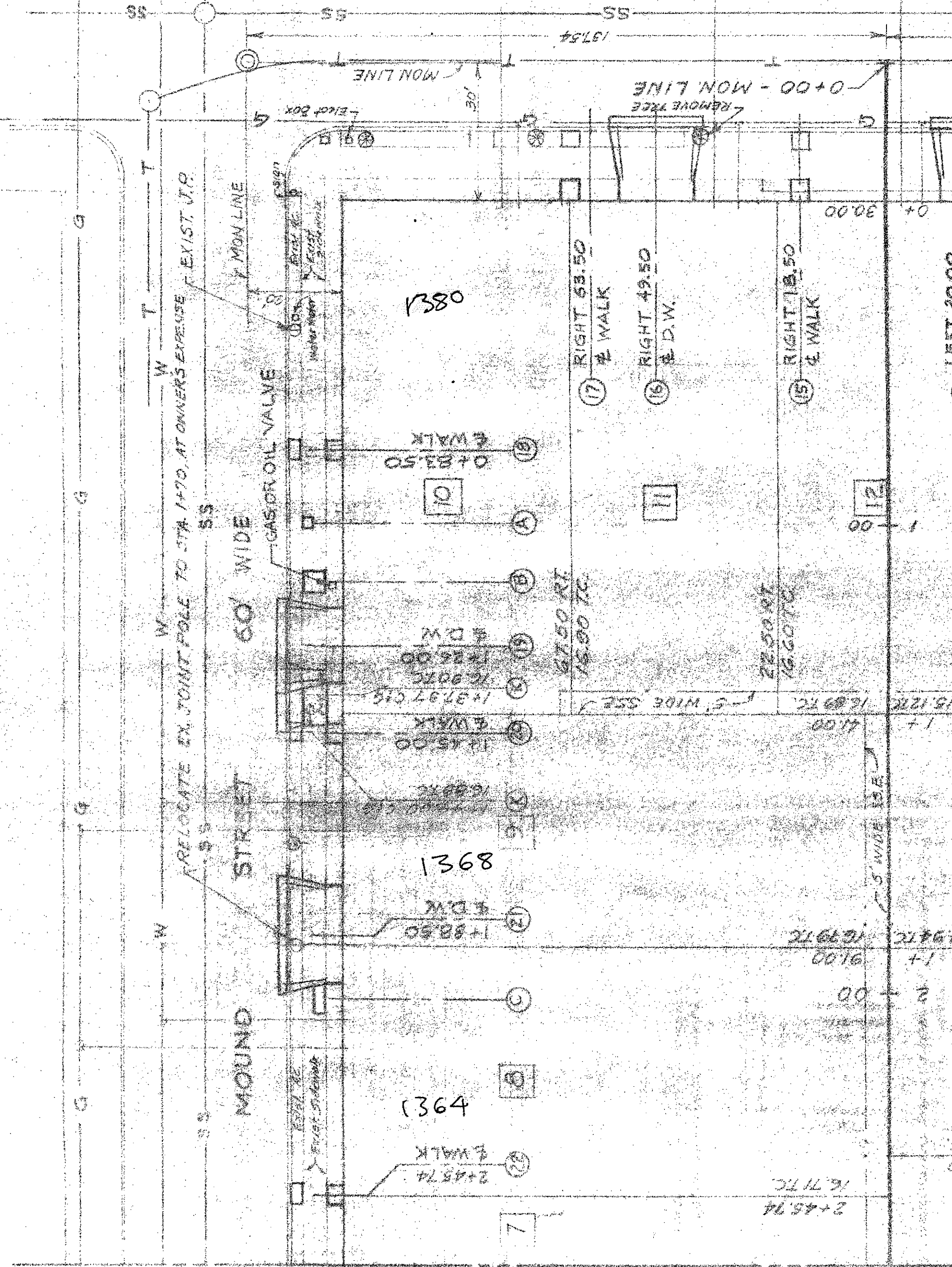

RELOCATE EX. JOINT POLE TO STA. 1+70, AT OWNER'S EXPENSE EXIST. J.P.

60' WIDE STREET

MOUND

1380

8931

1364

17 RIGHT 68.50
± WALK

16 RIGHT 49.50
± D.W.

15 RIGHT 18.50
± WALK

10 ± 81.50
± WALK

11 ± 45.00
± WALK
12 ± 16.97 TC
13 ± 16.00 TC
14 ± 16.00 TC
15 ± 16.00 TC
16 ± 16.00 TC
17 ± 16.00 TC

18 ± 88.50
± D.W.

19 ± 45.74
± WALK

67.50 RT
15.00 TC

22.50 RT
16.00 TC

15.12 TC
16.97 TC
41.00

14.94 TC
16.97 TC
91.00

16.71 TC
2+45.74

LEFT 20.00

5' WIDE USE

2+60