

*Phase I & II Site Assessments
Vapor Intrusion Assessments
Soil & Groundwater Sampling
Soil Corrosion Testing
Site Remediation
UST Removal & Oversight
Hazardous Waste Management
UST Cleanup Fund Assistance
SCAP Grant Fund Assistance*



May 30, 2018
WGE Project #2018110

Mr. Mark Detterman
Alameda County Health Care Services Agency
Environmental Health Services
Environmental Protection
1131 Harbor Bay Parkway, Suite 250
Alameda, CA 94502-6577

RE: Sub-Slab Vapor Pin Destruction

**SITE: Mulholland Residence
132 Guilford Road, Piedmont, California
ACDEH Fuel Leak Case No. RO0003070
Global ID #T10000002521**

Dear Mr. Detterman:

On behalf of the Leslie Mulholland Trust, Wheeler Group Environmental, LLC (Wheeler Group) submits this brief letter discussing the sub-slab vapor pin destruction activities at the residential property located at 132 Guilford Road in Piedmont, California (Site). In email correspondence dated April 17 and May 2, 2018, the Alameda County Department of Environmental Health (ACDEH) requested that the existing sub-slab vapor point (Field Point Name: SS1) located in the residence basement furnace room be destroyed as a condition for site closure for the ACDEH Fuel Leak Case No. RO0003070. The location of the former sub-slab vapor pin is shown in the attached revised Figure 3 – Site Plan.

On May 25, 2018, Wheeler Group personnel visited the Site and initially removed the stainless-steel vapor pin and silicone sleeve from the 5/8-inch diameter hole in the concrete floor slab using a threaded extraction handle provided by Cox-Colvin & Associates, Inc. Wheeler Group then cleaned the entire hole using a bottle brush, confirming that the hole was clear to the underlying sub-slab baserock material. Wheeler Group then completely filled the 5/8-inch diameter hole with DAP® Waterproof Concrete Filler/Sealant, filling any direct voids in the underlying baserock, and smoothed at the surface with a putty knife.

Wheeler Group Environmental, LLC
369-B Third Street, Suite #221, San Rafael, California 94901

Photographs of the Vapor Pin destruction activities are presented below.



Please contact us with any questions.

Respectfully Submitted,

Brent A. Wheeler

Brent A. Wheeler
Principal/Manager
Wheeler Group Environmental

Attachment: Revised Figure 3 – Site Plan

Distribution:

1. Addressee (Mark.Detterman@acgov.org)
2. Ms. Leslie Mulholland, Trustee (airleslie@hotmail.com)
3. Megan K. Walsh, Esq. (meganwalshesq@gmail.com)

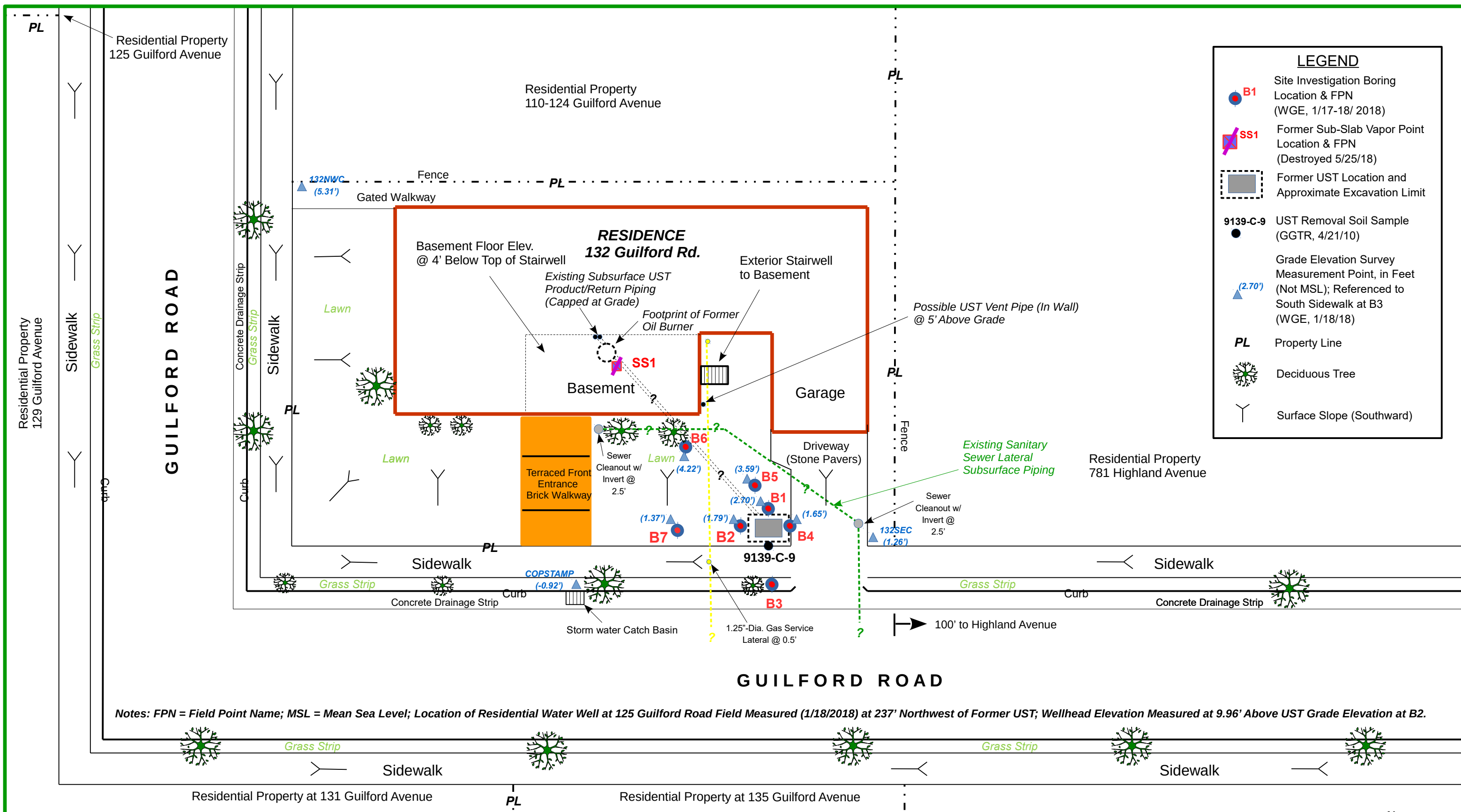

LEGEND

- B1 Site Investigation Boring Location & FPN (WGE, 1/17-18/2018)
- SS1 Former Sub-Slab Vapor Point Location & FPN (Destroyed 5/25/18)
- Former UST Location and Approximate Excavation Limit
- 9139-C-9 UST Removal Soil Sample (GGTR, 4/21/10)
- Grade Elevation Survey Measurement Point, in Feet (Not MSL); Referenced to South Sidewalk at B3 (WGE, 1/18/18)
- PL Property Line
- Deciduous Tree
- Surface Slope (Southward)

Notes: FPN = Field Point Name; MSL = Mean Sea Level; Location of Residential Water Well at 125 Guilford Road Field Measured (1/18/2018) at 237' Northwest of Former UST; Wellhead Elevation Measured at 9.96' Above UST Grade Elevation at B2.

WHEELER GROUP ENVIRONMENTAL, LLC
 369-B Third Street, Suite #221
 San Rafael, CA 94901
 P: (415) 686-8846
 E: bwheeler@wheelergroupernvironmental.com

SITE PLAN
Vapor Pin Destruction
 132 Guilford Road
 Piedmont, California

WGE Project No. 2017110
 Revision By: baw/05-18
 FN: 2017110_Fig3_SitePlan
Figure 3

Residential Property
 137 Guilford Avenue

Scale in Feet
 (1" = 15')