

UNDERGROUND STORAGE TANK REMOVAL REPORT

RECEIVED

9:49 am, May 15, 2009

Alameda County
Environmental Health



**EASTBOUND INTERSTATE 580
BETWEEN FIRST STREET AND VASCO ROAD
LIVERMORE, CALIFORNIA**

PREPARED FOR:
CALTRANS DISTRICT 4
111 GRAND AVENUE, 12TH FLOOR
OAKLAND, CA 94623

PREPARED BY:
GEOCON CONSULTANTS, INC.
6671 BRISA STREET
LIVERMORE, CALIFORNIA

GEOCON PROJECT NO. E8415-06-62
CALTRANS EA 04-290844



MAY 2009



Project No. E8415-06-62
May 11, 2009

Mr. Chris Bledsoe
Caltrans – District 4
111 Grand Avenue
Oakland, California 94623

Subject: UST REMOVAL REPORT
USTS LOCATED BENEATH EASTBOUND INTERSTATE 580 BETWEEN FIRST
STREET AND VASCO ROAD
LIVERMORE, CALIFORNIA
CONTRACT NO. 43A0199, EA 04-290844

Dear Mr. Bledsoe:

Geocon has prepared this *UST Removal Report* on behalf of Caltrans - District 4. The report contains details of field services and laboratory analytical results.

A copy of Caltrans' authorization letter to submit the report to the Alameda County Environmental Health Department is provided in Appendix E. Please contact the undersigned if you have any questions or comments.

Sincerely,

GEOCON CONSULTANTS, INC.

John Love, PG
Sr. Project Geologist

JWL:RWD



Richard Day, CEG, CHG
Regional Manager

- (3) Addressee
- (1) Jerry Wickham, Alameda County Environmental Health (electronic submittal)
- (1) Danielle Stefani, Livermore – Pleasanton Fire Department

TABLE OF CONTENTS

	<u>Page</u>
1.0 INTRODUCTION.....	1
1.1 Background.....	1
1.2 Scope of Services.....	2
2.0 UST REMOVAL	2
2.1 UST Removal and Soil Over-Excavation	2
2.1.1 Excavation Soil Sampling and Results	3
2.1.2 Stockpile Soil Sampling and Results	4
3.0 SOIL DISPOSAL.....	5
4.0 SUMMARY AND CONCLUSIONS.....	6

FIGURES

1. Vicinity Map
2. Excavation Sample Location Map

TABLES

1. UST Water Sample Results - TPHg, TPHd, TPHmo, and BTEX
2. UST Water Sample Results - VOCs and SVOCs
3. UST Water Sample Results - CAM 17 Metals
4. Soil Sample Results - TPHg, TPHd, TPHmo, and BTEX
5. Soil Sample Results - LUFT 5 Metals

APPENDICES

- A. Site Photographs
- B. Analytical Laboratory Data Sheets - UST Water Samples
- C. UST Destruction Certificate, UST Contents Hazardous Waste Manifest, and Non-Hazardous Waste Disposal Manifests and Landfill Weight Tickets
- D. Analytical Laboratory Data Sheets - UST Excavation and Stockpile Soil Sample Results
- E. Caltrans Authorization Letter

UST REMOVAL REPORT

1.0 INTRODUCTION

On behalf of California Department of Transportation (Caltrans) - District 4, we removed four underground storage tanks (USTs) and associated piping located beneath the future road surface of the Eastbound Interstate 580 widening project between First Street and Vasco Road in Livermore, CA (Figure 1). In addition to removing the four USTs we also over-excavated and arranged for the disposal of approximately 270 tons of petroleum hydrocarbon-impacted soil surrounding the tanks.

This report was prepared under Caltrans Contract No. 43A0199, Task Order No. 04-2007-62.

1.1 Background

On April 2, 2009, Caltrans notified Geocon that their contractor (De Silva Gates Construction) had discovered an UST beneath the existing shoulder area of Interstate 580 (south side of the highway) during the high occupancy vehicle (HOV) lane construction project. Upon inspection of the UST area later that day by Geocon personnel, it became apparent that at least two USTs were present, and that they were both filled with water. A photograph of the UST excavation upon our arrival on April 2, 2009, is shown as Photograph 1 in Appendix A.

The contents of the two USTs were sampled on April 2, 2009, and analyzed for total petroleum hydrocarbons as gasoline (TPHg), diesel (TPHd), and motor oil (TPHmo); benzene, toluene, ethylbenzene, and xylenes (BTEX); semi-volatile organic compounds (SVOCs), and volatile organic compounds (VOCs); and California Assessment Manual (CAM) 17 Metals. The analytical results of the water samples collected from two of the USTs are tabulated in Tables 1 through 3, and copies of the analytical laboratory data sheets are provided in Appendix B.

On April 3, 2009, Geocon mobilized to the site to remove the USTs. Prior to mobilizing to the site, permission to remove the tanks without first obtaining an UST removal permit was granted by the Livermore – Pleasanton Fire Department (LFPD). The permit would be obtained at a later date in order to facilitate the timely removal of the USTs so the Caltrans construction project could proceed without further delay.

On April 3, 2009, during the UST removal activities it was discovered that there were four USTs beneath the ground. One tank appeared to be approximately 600 gallons in capacity and the other three were estimated to be approximately 250 gallons in size. Photographs of the four USTs are provided as Photographs 2 and 3 in Appendix A.

1.2 Scope of Services

The general scope of services conducted in conjunction with this project consisted of the following:

- Remove and dispose water inside of the USTs;
- Remove, load, manifest, and transport USTs to a recycling facility;
- Over-excavate approximately 270 tons of petroleum hydrocarbon-impacted soil for offsite disposal;
- Collect confirmation soil samples beneath former USTs;
- Backfill excavation to within five-feet of ground surface with 3-inch-minus drain rock;
- Load, transport, and dispose soil at the Altamont Class II landfill in Livermore, California; and
- Prepare this report.

2.0 UST REMOVAL

2.1 UST Removal and Soil Over-Excavation

On April 3, 2009, four steel single-wall USTs were removed from the site under the direction of the LPFD. The tanks consisted of one 600-gallon and three 250-gallon USTs. The former contents of each tank is unknown, however analytical laboratory results of water samples collected from two of the USTs prior to removal, and confirmation soil samples collected from impacted soil surrounding the USTs, indicate they likely contained gasoline and diesel fuel.

A total 1,254 gallons of water with gasoline/diesel mix was pumped from the four USTs by NRC Environmental Services (NRC) prior to their removal from the ground. A copy of the hazardous waste disposal manifest generated by NRC is provided in Appendix C.

Several holes were observed in two of the tanks, and obvious petroleum odors and staining were noticed upon removal of the four USTs from the ground (see Photographs 5 and 6) . An attempt was made on April 3, 2009, to over-excavate the impacted soil surrounding the USTs with the same backhoe used to remove the tanks; however the depth of the impacts to soil exceeded the 12-foot reach of the backhoe and an excavator would be needed to further remove impacted soil below that depth.

The UST s were loaded into a truck and trailer provided by West Coast Equipment (see Photograph 7) and hauled to their facility in Turlock, California for recycling on April 3, 2009. A copy of the UST destruction certificate is provided in Appendix C.

An excavator was mobilized to the site the following day (April 4, 2009), and the depth of the excavation was extended to between 18 and 20 feet (the maximum reach of the excavator). Petroleum

hydrocarbon odors and some soil staining were still present at 20 feet (though noticeably less); however the stability of the excavation cavity was becoming a concern since the north wall of the excavation was only 10 feet from the edge of Interstate 580 freeway (see Photograph 4), and groundwater was seeping into the excavation at a depth of approximately 12 feet. As a result of these circumstances, the excavation was considered complete. The dimensions of the completed excavation measured approximately 24 feet long by 15 feet wide by 18 feet deep.

On April 3 and 4, 2009, Geocon excavated approximately 270 tons of petroleum-hydrocarbon impacted soil surrounding and underlying the former USTs. The soil was temporarily stockpiled on plastic sheeting and covered (see Photograph 9) pending profiling and eventual acceptance for disposal as non-hazardous waste at the Altamont Class II landfill in Livermore, California. Photographs of the excavation are provided in Appendix A.

On April 4, 2009, after the excavation was completed, approximately 270 tons of 3-inch-minus drain rock was placed in the excavation to a depth of approximately 3-feet below grade (see Photograph 10). The excavation was later completed and compacted by Caltrans' construction contractor.

2.1.1 Excavation Soil Sampling and Results

Six soil samples were collected from the completed excavation. One sample was collected at the bottom of the north, south, east, and west sidewalls at depths of approximately 19 feet, and two soil samples were collected from the bottom of the middle portion of the pit at depths of approximately 20 feet. The sample locations are shown on Figure 2.

Excavation soil samples were collected from the excavator bucket by driving a stainless steel sample tube into a freshly exposed surface of soil removed from selected areas of the excavation. Ms. Danielle Stefani with the LPPD selected the sample locations.

Upon collection, each sample tube was sealed on both ends with Teflon tape and plastic end caps, and then placed in a chest cooled with ice for transport to the analytical laboratory. The soil samples were delivered under chain-of-custody protocol to McCampbell Analytical, Inc., a State of California-certified laboratory located in Pittsburg, California.

Soil samples were analyzed for TPHg, TPHd, and TPHmo following EPA Test Method 8015B; BTEX following EPA Test Method 8021B; and Leaking Underground Storage Tank (LUFT) 5 metals cadmium, chromium, lead, nickel, and zinc following EPA Test Method 6010C.

Analytical results of the excavation soil samples indicate some residual impacts to soil remain in-place beneath the former USTs. The contaminants were identified by the laboratory as consisting of degraded

gasoline and diesel fuel. TPHmo was reported as non-detect in the six soil samples collected from the excavation.

The highest contaminant concentrations remaining in-place were reported in the soil samples collected along the base of the north sidewall at a depth of 19 feet, and the bottom of the excavation towards the east half of the pit at a depth of 20 feet. TPHg and TPHd were reported in the north sidewall sample at concentrations of 1,100 milligrams per kilogram (mg/kg) and 360 mg/kg, respectively; and the samples collected from the bottom of the excavation towards the east portion of the pit were reported at concentrations of 1,500 mg/kg (TPHg) and 700 mg/kg (TPHd). Benzene and toluene were reported as non-detect in these two samples, and ethylbenzene and xylenes were reported in both samples at concentrations ranging from 1.7 micrograms per kilogram (ug/kg) to 2.7 ug/kg.

TPHg, TPHd, TPHmo, and BTEX concentrations from the excavation soil samples are tabulated in Table 4 and LUFT 5 metals results are provided in Table 5. Copies of the analytical laboratory data sheets for the excavation soil samples are provided in Appendix D.

2.1.2 Stockpile Soil Sampling and Results

During the UST removal and over-excavation activities an attempt was made to separate petroleum hydrocarbon-impacted soil surrounding and underlying the USTs from soils overlying the tanks. As such, soils from both areas were stockpiled and sampled separately. One four-point composite soil sample was collected from the impacted soils stockpile, and one four-point composite sample was collected from the overburden soils stockpile.

Both stockpile soil samples were composited in the laboratory. The samples were analyzed for TPHg, TPHd, TPHmo, BTEX, and LUFT 5 metals following the same analytical methods mentioned in the Section 2.1.1.

The stockpile consisting of overburden soil was reported to contain TPHd and TPHmo at concentrations of 1.5 mg/kg and 14 mg/kg, respectively. TPHg and BTEX were reported as non-detect in this stockpile.

The stockpile containing presumably contaminated soil was reported to contain TPHg at a concentration of 390 mg/kg and TPHd at a concentration of 130 mg/kg. Ethylbenzene and xylenes were also reported in this sample at concentrations of 0.85 mg/kg and 1.2 mg/kg. TPHmo, benzene and toluene were reported as non-detect. Detected LUFT 5 metals were reported at background concentrations in both stockpile soil samples.

TPHg, TPHd, TPHmo, and BTEX concentrations from the stockpile soil samples are tabulated in Table 4 and LUFT 5 metals results are provided in Table 5. Copies of the analytical laboratory data sheets for the stockpile soil samples are provided in Appendix D.

3.0 SOIL DISPOSAL

Caltrans elected to dispose soils in the overburden stockpile along with the contaminated stockpile soils since the extra soil contained in the overburden stockpile was not needed onsite. On April 9, 2009, NRC loaded and transported 16 truck loads of soil totaling approximately 270 tons for disposal at the Altamont Landfill in Livermore, California.

Copies of the non-hazardous waste manifests and landfill weight tickets for each load are provided in Appendix C.

4.0 CONCLUSIONS AND RECOMMENDATIONS

Two USTs were unexpectedly discovered by Caltrans contractors on April 2, 2009, and two additional tanks were discovered on April 3, 2009, during UST removal activities. The USTs were likely part of a previously unidentified gasoline station.

The four USTs were removed on April 3, 2009, and approximately 270 tons of soil was over-excavated on April 3 and 4, 2009, and temporarily stockpiled onsite. On April 9, 2009, NRC loaded and transported the stockpiled soil to the Altamont Landfill for disposal.

The excavation was backfilled after completion on April 4, 2009, to within three-feet of ground surface using three-inch-minus drain rock. The excavation was later backfilled and compacted to grade by Caltrans' construction contractor.

Confirmation soil samples indicate that residual soil contamination remains in-place beneath the former tanks; however visual observations and confirmation soil sample results indicate the bulk of the impacted soil was removed during the over-excavation activities on April 3 and 4, 2009.

Groundwater was observed seeping into the excavation at a depth of approximately 12 feet during the soil remediation effort. A groundwater sample was not collected because a sufficient volume of water had not accumulated in the excavation before it was backfilled for safety reasons. Some impacts to shallow groundwater may exist beneath the former USTs; however it should be noted that leaking underground storage tank sites situated on the north (909 Bluebell Drive) and south (461 McGraw Avenue) sides of Interstate 580 (see Figure 1) report that the groundwater flow direction is towards the west-northwest, which means that contaminants originating beneath the former USTs would be expected to migrate beneath Interstate 580.

In conclusion, residual TPHg, TPHd, ethylbenzene, and xylenes remain in-place in soil (and possibly groundwater) beneath the former USTs. The location of the former USTs is soon to be situated beneath the number five lane of eastbound Interstate 580 (see Photographs 11 and 12). If impacts to groundwater have spread beyond the immediate vicinity of the former USTs then the bulk of the plume is likely situated beneath Interstate 580, rendering additional investigation and remediation impractical. Additional investigation is not recommended unless the Alameda County Environmental Health Department or Zone 7 officials consider this release to be an imminent threat to the drinking water supply.

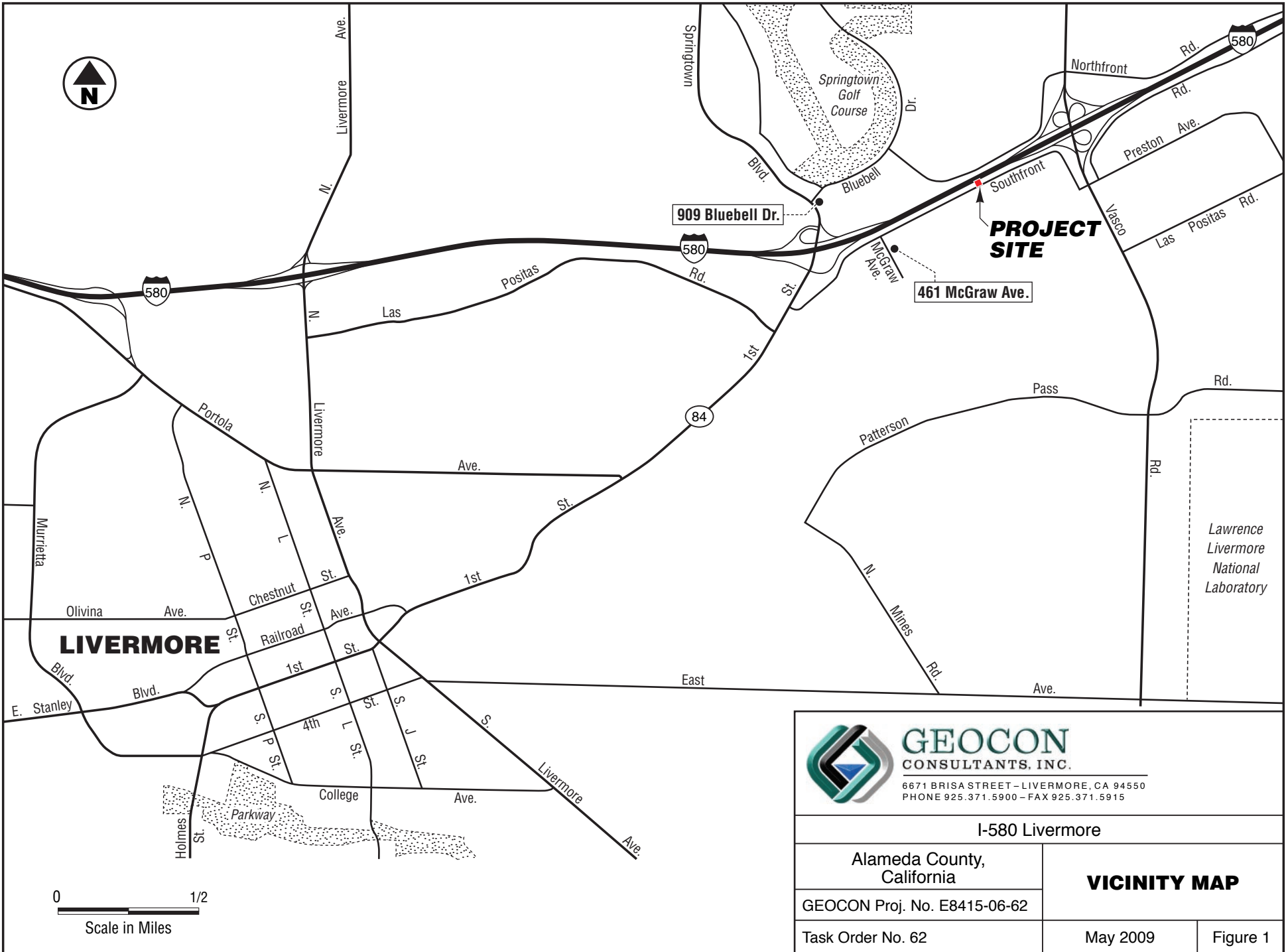

GEOCON
CONSULTANTS, INC.

6671 BRISA STREET - LIVERMORE, CA 94550
PHONE 925.371.5900 - FAX 925.371.5915

I-580 Livermore

Alameda County,
California

VICINITY MAP

GEOCON Proj. No. E8415-06-62

Task Order No. 62

May 2009

Figure 1



INTERSTATE 580

UST Excavation →

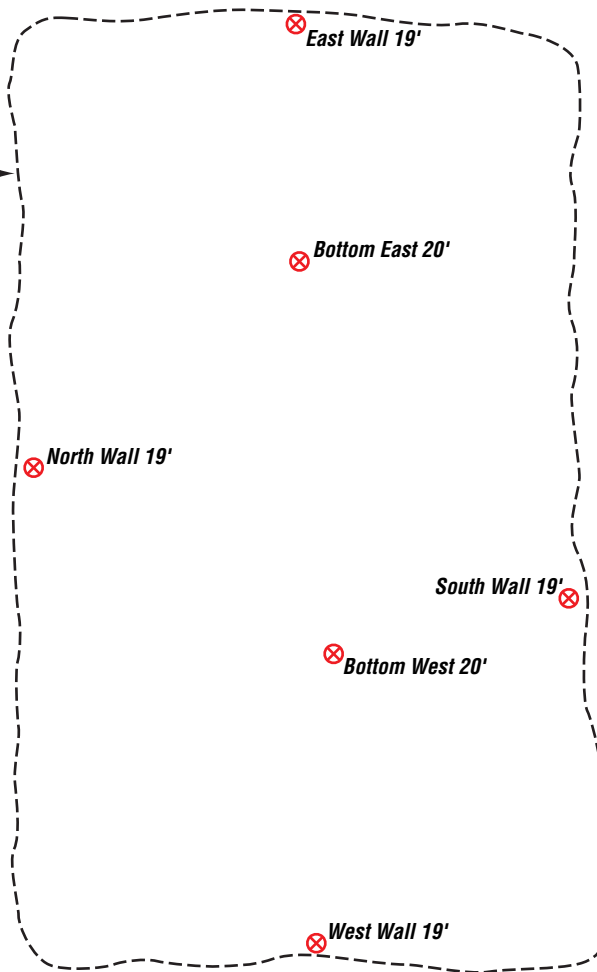

LEGEND:

⊗ Approximate Excavation Sample Location



GEOCON
CONSULTANTS, INC.

6671 BRISA STREET - LIVERMORE, CA 94550
PHONE 925.371.5900 - FAX 925.371.5915

I-580 Livermore

Alameda County,
California

**Excavation Sample
Location Map**

GEOCON Proj. No. E8415-06-62

Task Order No. 62

May 2009

Figure 2

Table 1
UST Water Sample Results
TPHg, TPHd, TPHmo, and BTEX
Caltrans - I-580
Livermore, California

Sample Location	Date	TPHg (ug/l)	TPHd (ug/l)	TPHmo (ug/l)	Benzene (ug/l)	Toluene (ug/l)	Ethylbenzene (ug/l)	Xylenes (ug/l)
UST #1	4/2/09	13,000	6,300	750	39	38	29	1,700
UST #2	4/2/09	860	3,300	850	<0.5	<0.5	<0.5	2.1

Notes-

ug/l - micrograms per liter

TPHg - Total petroleum hydrocarbons as gasoline

TPHd - Total petroleum hydrocarbons as diesel

TPHmo - Total petroleum hydrocarbons as motor oil

< - Not detected above stated laboratory reporting limit

Table 2
UST Water Sample Results
VOCs and SVOCs
Caltrans - I-580
Livermore, California

Analyte	Date	UST #1 (ug/l)	UST #2 (ug/l)
1,2,4-Trimethylbenzene	4/2/09	610	1.60
1,2-Dichloroethane	4/2/09	130	<1.0
1,3,5-Trimethylbenzene	4/2/09	260	0.96
4-Isopropyl toluene	4/2/09	120	0.78
Benzene	4/2/09	40	<1.0
Ethylbenzene	4/2/09	<25	0.72
Isophorone	4/2/09	<500	160
Naphthalene	4/2/09	92	<1.0
t-Butyl alcohol	4/2/09	<100	11
Toluene	4/2/09	29	<1.0
Xylenes	4/2/09	1,700	0.96
Other VOCs	4/2/09	ND	ND
Other SVOCs	4/2/09	ND	ND

notes-

ug/l - micrograms per liter

VOCs - volatile organic compounds

SVOCs - semi-volatile organic compounds

< - Not detected above stated laboratory reporting limit

ND - not detected

Table 3
UST Water Sample Results
CAM 17 Metals
Caltrans - I-580
Livermore, California

Analyte	Date	UST #1 (ug/l)	UST #2 (ug/l)
Antimony	4/2/2009	<0.5	<0.5
Arsenic	4/2/2009	2.2	12
Barium	4/2/2009	570	100
Beryllium	4/2/2009	<0.5	<0.5
Cadmium	4/2/2009	1.7	51
Chromium	4/2/2009	0.63	1.2
Cobalt	4/2/2009	0.72	2.2
Copper	4/2/2009	0.78	2.9
Lead	4/2/2009	3.3	20
Mercury	4/2/2009	0.025	<0.012
Molybdenum	4/2/2009	<0.5	<0.5
Nickel	4/2/2009	<0.5	3.7
Selenium	4/2/2009	<0.5	<0.5
Silver	4/2/2009	<0.19	<0.19
Thallium	4/2/2009	<0.5	<0.5
Vanadium	4/2/2009	<0.5	1.6
Zinc	4/2/2009	670	28,000

Notes -
ug/l - micrograms per liter
CAM 17 metals - California Assessment Manual 17 metals
< - Not detected above stated laboratory reporting limit

Table 4
Soil Sample Results
TPHg, TPHd, TPHmo, and BTEX
Caltrans - I-580
Livermore, California

Sample Location	Sample Depth (feet bgs)	Date	TPHg (mg/kg)	TPHd (mg/kg)	TPHmo (mg/kg)	Benzene (mg/kg)	Toluene (mg/kg)	Ethylbenzene (mg/kg)	Xylenes (mg/kg)
Excavation North Wall	19	4/4/09	1,000	360	<5.0	<1.0	<1.0	1.9	2.7
Excavation East Wall	19	4/4/09	19	22	<5.0	<0.025	<0.025	<0.025	<0.025
Excavation West Wall	19	4/4/09	<1.0	<1.0	<5.0	<0.005	<0.005	<0.005	<0.005
Excavation South Wall	19	4/4/09	11	17	<5.0	<0.025	<0.025	<0.025	<0.025
Excavation Bottom East	20	4/4/09	1,500	700	<50	<0.50	<0.50	1.7	2.5
Excavation Bottom West	20	4/4/09	99	29	<5.0	<0.050	<0.050	<0.050	<0.050
Stockpile - Impacted Soil	- -	4/4/09	390	130	<10	<0.050	<0.050	0.85	1.2
Stockpile - Overburden	- -	4/4/09	<1.0	1.5	14	<0.005	<0.005	<0.005	<0.005

Notes-

mg/kg - milligrams per kilogram

bgs - below ground surface

TPHg - Total petroleum hydrocarbons as gasoline

TPHd - Total petroleum hydrocarbons as diesel

TPHmo - Total petroleum hydrocarbons as motor oil

< - Not detected above stated laboratory reporting limit

Table 5
Soil Sample Results
LUFT 5 Metals
Caltrans - I580
Livermore, California

Sample Location	Sample Depth (feet bgs)	Date	Cadmium (mg/kg)	Chromium (mg/kg)	Lead (mg/kg)	Nickel (mg/kg)	Zinc mg/kg)
Excavation North Wall	19	4/4/09	<1.5	36	8.5	30	37
Excavation East Wall	19	4/4/09	<1.5	31	6.8	24	32
Excavation West Wall	19	4/4/09	<1.5	22	5.4	20	21
Excavation South Wall	19	4/4/09	<1.5	42	9.9	38	44
Excavation Bottom East	20	4/4/09	<1.5	35	7.8	29	34
Excavation Bottom West	20	4/4/09	<1.5	42	8.9	36	38
Stockpile - Impacted Soil	- -	4/4/09	<1.5	41	9.4	33	40
Stockpile - Overburden	- -	4/4/09	<1.5	49	23	46	70

Notes -
mg/kg - milligrams per kilogram
bgs - below ground surface
< - Not detected above stated laboratory reporting limit

APPENDIX

A



Photo 1 – UST area on April 2, 2009.



Photo 2 – Unearthed USTs on April 3, 2009.



Photo 3 – USTs prior to transporting offsite.

GEOCON

CONSULTANTS, INC.
2356 Research Drive, Livermore, California 94550
PHONE (925) 371-5900 – FAX (925) 371-5915



SITE PHOTOS 1, 2, & 3

Eastbound Interstate 580, West of Vasco Road
Livermore, California

E8415-06-62

May 2009



Photo 4 – Excavation relative to eastbound I-580.



Photo 5 – Soil staining (bluish green) beneath USTs.



Photo 6 – Stained (bluish green) stockpiled soil.

GEOCON

CONSULTANTS, INC.
2356 Research Drive, Livermore, California 94550
PHONE (925) 371-5900 – FAX (925) 371-5915



SITE PHOTOS 4, 5, & 6

Eastbound Interstate 580, West of Vasco Road
Livermore, California

E8415-06-62

May 2009



Photo 7 – USTs loaded on truck for recycling at West Coast Equipment.



Photo 8 – Excavation on April 4, 2009, using excavator.



Photo 9 – Stockpiled soil on April 4, 2009.

GEOCON

CONSULTANTS, INC.
2356 Research Drive, Livermore, California 94550
PHONE (925) 371-5900 – FAX (925) 371-5915



SITE PHOTOS 7, 8, & 9

Eastbound Interstate 580, West of Vasco Road
Livermore, California

E8415-06-62

May 2009



Photo 10 – Excavation after backfilling on April 4, 2009.



Photo 11 – Excavation area on April 21, 2009.



Photo 12 – Excavation area from Vasco Road Overcrossing. Excavation area is located to the left of the orange truck in the background.

GEOCON

CONSULTANTS, INC.
2356 Research Drive, Livermore, California 94550
PHONE (925) 371-5900 – FAX (925) 371-5915



SITE PHOTOS 10, 11, & 12

Eastbound Interstate 580, West of Vasco Road
Livermore, California

E8415-06-62

May 2009

APPENDIX



B



McC Campbell Analytical, Inc.

"When Quality Counts"

1534 Willow Pass Road, Pittsburg, CA 94565-1701
Web: www.mcccampbell.com E-mail: main@mcccampbell.com
Telephone: 877-252-9262 Fax: 925-252-9269

GEOCON Env. Consultants 6671 Brisa St Livermore, CA 94550	Client Project ID: #E8415-06-62	Date Sampled: 04/02/09
		Date Received: 04/02/09
	Client Contact: Rick Day	Date Reported: 04/03/09
	Client P.O.:	Date Completed: 04/03/09

WorkOrder: 0904068

April 03, 2009

Dear Rick:

Enclosed within are:

- 1) The results of the **2** analyzed samples from your project: **#E8415-06-62**,
- 2) A QC report for the above samples,
- 3) A copy of the chain of custody, and
- 4) An invoice for analytical services.

All analyses were completed satisfactorily and all QC samples were found to be within our control limits.

If you have any questions or concerns, please feel free to give me a call. Thank you for choosing

McC Campbell Analytical Laboratories for your analytical needs.

Best regards,

Angela Rydelius
Laboratory Manager
McC Campbell Analytical, Inc.



McCAMPBELL ANALYTICAL, INC.
 1534 WILLOW PASS ROAD
 PITTSBURG, CA 94565-1701
 Website: www.mccampbell.com Email: main@mccampbell.com
 Telephone: (877) 252-9262 Fax: (925) 252-9269

RUSH

CHAIN OF CUSTODY RECORD
 TURN AROUND TIME

RUSH

24 HR

48 HR

72 HR

5 DAY

GeoTracker EDF

PDF

Excel

Write On (DW)

Check if sample is effluent and "J" flag is required

090406E

Report To: Rick Day Bill To: SMK
 Company: Gecon
6671 Brisa St
Livermore, CA E-Mail: day@gecon.com
 Tele: (925) 371-5600 Fax: (925) 371-5915
 Project #: EB415-06-62 Project Name:
 Project Location: I-580 ~~UST~~ UST
 Sampler Signature: [Signature]

Analysis Request

Other

Comments

<input checked="" type="checkbox"/> BTEX & TPH as Gas (602 / 8021 + 8015) MTBE	<input checked="" type="checkbox"/> TPH as Diesel (8015) <u>+ TPH mo</u>	<input type="checkbox"/> Total Petroleum Oil & Grease (1664 / 5520 E/B&F)	<input type="checkbox"/> Total Petroleum Hydrocarbons (418.1)	<input type="checkbox"/> EPA 502.2 / 601 / 8010 / 8021 (HVOCs)	<input type="checkbox"/> MTBE / BTEX ONLY (EPA 602 / 8021)	<input type="checkbox"/> EPA 505/608 / 8081 (CI Pesticides)	<input type="checkbox"/> EPA 608 / 8082 PCB's ONLY; Aroclors / Congeners	<input type="checkbox"/> EPA 507 / 8141 (NP Pesticides)	<input type="checkbox"/> EPA 515 / 8151 (Acidic CI Herbicides)	<input type="checkbox"/> EPA 524.2 / 624 / 8280 (VOCs)	<input type="checkbox"/> EPA 525.2 / 625 / 8270 (SVOCs)	<input type="checkbox"/> EPA 8270 SIM / 8310 (PAHs / PNAs)	<input type="checkbox"/> CAM 17 Metals (200.7 / 200.8 / 6010 / 6020)	<input type="checkbox"/> LUFT 5 Metals (200.7 / 200.8 / 6010 / 6020)	<input type="checkbox"/> Lead (200.7 / 200.8 / 6010 / 6020)
---	--	---	---	--	--	---	--	---	--	--	---	--	--	--	---

Filter Samples for Metals analysis: Yes/No

SAMPLE ID	LOCATION/ Field Point Name	SAMPLING		# Containers	Type Containers	MATRIX					METHOD PRESERVED					
		Date	Time			Water	Soil	Air	Sludge	Other	ICE	HCL	HNO ₃	Other		
+ UST#1	↓	4/2/09	13:35	4	VOA	X					X	X				
				1	Poly	X					X					
				1	Ambr	X					X					
				1	↓	X					X					
+ UST#2	↓		13:45	4	VOA	X					X	X				
				1	Poly	X					X					
				1	Ambr	X					X					
				1	↓	X					X					

Relinquished By: [Signature] Date: 4/2 Time: 1630 Received By: [Signature]
 Relinquished By: _____ Date: _____ Time: _____ Received By: _____
 Relinquished By: _____ Date: _____ Time: _____ Received By: _____

COMMENTS:
 ICE/ 6.8E
 GOOD CONDITION
 HEAD SPACE ABSENT
 DECHLORINATED IN LAB
 APPROPRIATE CONTAINERS
 PRESERVED IN LAB
 VOAS O&G METALS OTHER
 PRESERVATION pH<2

McC Campbell Analytical, Inc.



1534 Willow Pass Rd
Pittsburg, CA 94565-1701
(925) 252-9262

CHAIN-OF-CUSTODY RECORD

WorkOrder: 0904068

ClientCode: GECL

WriteOn
 EDF
 Excel
 Fax
 Email
 HardCopy
 ThirdParty
 J-flag

Report to:		Bill to:	Requested TAT: 0 day
Rick Day	Email: day@geoconinc.com; Livermore@geoc	Accounts Payable	
GEOCON Env. Consultants	cc:	GEOCON Env. Consultants	<i>Date Received: 04/02/2009</i>
6671 Brisa St	PO:	6671 Brisa St	<i>Date Printed: 04/02/2009</i>
Livermore, CA 94550	ProjectNo: #E8415-06-62	Livermore, CA 94550	
(925) 371-5900 FAX 925-371-5915			

Lab ID	Client ID	Matrix	Collection Date	Hold	Requested Tests (See legend below)											
					1	2	3	4	5	6	7	8	9	10	11	12
0904068-001	UST #1	Water	4/2/2009 13:35	<input type="checkbox"/>	C	D	E	A	B							
0904068-002	UST #2	Water	4/2/2009 13:45	<input type="checkbox"/>	C	D	E	A	B							

Test Legend:

1	8260B_W	2	8270D_W	3	CAM17(T)MS_W	4	G-MBTEX_W	5	TPH(DMO)_W
6		7		8		9		10	
11		12							

Prepared by: Melissa Valles

Comments:

NOTE: Soil samples are discarded 60 days after results are reported unless other arrangements are made (Water samples are 30 days).
Hazardous samples will be returned to client or disposed of at client expense.



Sample Receipt Checklist

Client Name: **GEOCON Env. Consultants**

Date and Time Received: **4/2/09 4:33:30 PM**

Project Name: **#E8415-06-62**

Checklist completed and reviewed by: **Melissa Valles**

WorkOrder N°: **0904068** Matrix Water

Carrier: Client Drop-In

Chain of Custody (COC) Information

- Chain of custody present? Yes No
- Chain of custody signed when relinquished and received? Yes No
- Chain of custody agrees with sample labels? Yes No
- Sample IDs noted by Client on COC? Yes No
- Date and Time of collection noted by Client on COC? Yes No
- Sampler's name noted on COC? Yes No

Sample Receipt Information

- Custody seals intact on shipping container/cooler? Yes No NA
- Shipping container/cooler in good condition? Yes No
- Samples in proper containers/bottles? Yes No
- Sample containers intact? Yes No
- Sufficient sample volume for indicated test? Yes No

Sample Preservation and Hold Time (HT) Information

- All samples received within holding time? Yes No
- Container/Temp Blank temperature Cooler Temp: 6.8°C NA
- Water - VOA vials have zero headspace / no bubbles? Yes No No VOA vials submitted
- Sample labels checked for correct preservation? Yes No
- TTLC Metal - pH acceptable upon receipt (pH<2)? Yes No NA
- Samples Received on Ice? Yes No

(Ice Type: OTHERS)

* NOTE: If the "No" box is checked, see comments below.

Client contacted:

Date contacted:

Contacted by:

Comments: *Frozen Water Bottles



McC Campbell Analytical, Inc.

"When Quality Counts"

1534 Willow Pass Road, Pittsburg, CA 94565-1701
Web: www.mcccampbell.com E-mail: main@mcccampbell.com
Telephone: 877-252-9262 Fax: 925-252-9269

GEOCON Env. Consultants 6671 Brisa St Livermore, CA 94550	Client Project ID: #E8415-06-62	Date Sampled: 04/02/09
		Date Received: 04/02/09
	Client Contact: Rick Day	Date Extracted: 04/02/09
	Client P.O.:	Date Analyzed: 04/02/09

Volatile Organics by P&T and GC/MS (Basic Target List)*

Extraction Method: SW5030B

Analytical Method: SW8260B

Work Order: 0904068

Lab ID	0904068-001C
Client ID	UST #1
Matrix	Water

Compound	Concentration *	DF	Reporting Limit	Compound	Concentration *	DF	Reporting Limit
Acetone	ND<500	50	10	tert-Amyl methyl ether (TAME)	ND<25	50	0.5
Benzene	40	50	0.5	Bromobenzene	ND<25	50	0.5
Bromochloromethane	ND<25	50	0.5	Bromodichloromethane	ND<25	50	0.5
Bromoform	ND<25	50	0.5	Bromomethane	ND<25	50	0.5
2-Butanone (MEK)	ND<100	50	2.0	t-Butyl alcohol (TBA)	ND<100	50	2.0
n-Butyl benzene	ND<25	50	0.5	sec-Butyl benzene	ND<25	50	0.5
tert-Butyl benzene	ND<25	50	0.5	Carbon Disulfide	ND<25	50	0.5
Carbon Tetrachloride	ND<25	50	0.5	Chlorobenzene	ND<25	50	0.5
Chloroethane	ND<25	50	0.5	Chloroform	ND<25	50	0.5
Chloromethane	ND<25	50	0.5	2-Chlorotoluene	ND<25	50	0.5
4-Chlorotoluene	ND<25	50	0.5	Dibromochloromethane	ND<25	50	0.5
1,2-Dibromo-3-chloropropane	ND<10	50	0.2	1,2-Dibromoethane (EDB)	ND<25	50	0.5
Dibromomethane	ND<25	50	0.5	1,2-Dichlorobenzene	ND<25	50	0.5
1,3-Dichlorobenzene	ND<25	50	0.5	1,4-Dichlorobenzene	ND<25	50	0.5
Dichlorodifluoromethane	ND<25	50	0.5	1,1-Dichloroethane	ND<25	50	0.5
1,2-Dichloroethane (1,2-DCA)	130	50	0.5	1,1-Dichloroethene	ND<25	50	0.5
cis-1,2-Dichloroethene	ND<25	50	0.5	trans-1,2-Dichloroethene	ND<25	50	0.5
1,2-Dichloropropane	ND<25	50	0.5	1,3-Dichloropropane	ND<25	50	0.5
2,2-Dichloropropane	ND<25	50	0.5	1,1-Dichloropropene	ND<25	50	0.5
cis-1,3-Dichloropropene	ND<25	50	0.5	trans-1,3-Dichloropropene	ND<25	50	0.5
Diisopropyl ether (DIPE)	ND<25	50	0.5	Ethylbenzene	ND<25	50	0.5
Ethyl tert-butyl ether (ETBE)	ND<25	50	0.5	Freon 113	ND<500	50	10
Hexachlorobutadiene	ND<25	50	0.5	Hexachloroethane	ND<25	50	0.5
2-Hexanone	ND<25	50	0.5	Isopropylbenzene	ND<25	50	0.5
4-Isopropyl toluene	120	50	0.5	Methyl-t-butyl ether (MTBE)	ND<25	50	0.5
Methylene chloride	ND<25	50	0.5	4-Methyl-2-pentanone (MIBK)	ND<25	50	0.5
Naphthalene	92	50	0.5	n-Propyl benzene	ND<25	50	0.5
Styrene	ND<25	50	0.5	1,1,1,2-Tetrachloroethane	ND<25	50	0.5
1,1,1,2-Tetrachloroethane	ND<25	50	0.5	Tetrachloroethene	ND<25	50	0.5
Toluene	29	50	0.5	1,2,3-Trichlorobenzene	ND<25	50	0.5
1,2,4-Trichlorobenzene	ND<25	50	0.5	1,1,1-Trichloroethane	ND<25	50	0.5
1,1,2-Trichloroethane	ND<25	50	0.5	Trichloroethene	ND<25	50	0.5
Trichlorofluoromethane	ND<25	50	0.5	1,2,3-Trichloropropane	ND<25	50	0.5
1,2,4-Trimethylbenzene	610	50	0.5	1,3,5-Trimethylbenzene	260	50	0.5
Vinyl Chloride	ND<25	50	0.5	Xylenes	1700	50	0.5

Surrogate Recoveries (%)

%SS1:	78	%SS2:	87
%SS3:	84		

Comments:

* water and vapor samples are reported in µg/L, soil/sludge/solid samples in mg/kg, product/oil/non-aqueous liquid samples and all TCLP & SPLP extracts are reported in mg/L, wipe samples in µg/wipe.

ND means not detected above the reporting limit; N/A means analyte not applicable to this analysis.

surrogate diluted out of range or coelutes with another peak; &) low surrogate due to matrix interference.



McC Campbell Analytical, Inc.

"When Quality Counts"

1534 Willow Pass Road, Pittsburg, CA 94565-1701
Web: www.mcccampbell.com E-mail: main@mcccampbell.com
Telephone: 877-252-9262 Fax: 925-252-9269

GEOCON Env. Consultants 6671 Brisa St Livermore, CA 94550	Client Project ID: #E8415-06-62	Date Sampled: 04/02/09
		Date Received: 04/02/09
	Client Contact: Rick Day	Date Extracted: 04/02/09
	Client P.O.:	Date Analyzed: 04/02/09

Volatile Organics by P&T and GC/MS (Basic Target List)*

Extraction Method: SW5030B

Analytical Method: SW8260B

Work Order: 0904068

Lab ID	0904068-002C
Client ID	UST #2
Matrix	Water

Compound	Concentration *	DF	Reporting Limit	Compound	Concentration *	DF	Reporting Limit
Acetone	ND	1.0	10	tert-Amyl methyl ether (TAME)	ND	1.0	0.5
Benzene	ND	1.0	0.5	Bromobenzene	ND	1.0	0.5
Bromochloromethane	ND	1.0	0.5	Bromodichloromethane	ND	1.0	0.5
Bromoform	ND	1.0	0.5	Bromomethane	ND	1.0	0.5
2-Butanone (MEK)	ND	1.0	2.0	t-Butyl alcohol (TBA)	11	1.0	2.0
n-Butyl benzene	ND	1.0	0.5	sec-Butyl benzene	ND	1.0	0.5
tert-Butyl benzene	ND	1.0	0.5	Carbon Disulfide	ND	1.0	0.5
Carbon Tetrachloride	ND	1.0	0.5	Chlorobenzene	ND	1.0	0.5
Chloroethane	ND	1.0	0.5	Chloroform	ND	1.0	0.5
Chloromethane	ND	1.0	0.5	2-Chlorotoluene	ND	1.0	0.5
4-Chlorotoluene	ND	1.0	0.5	Dibromochloromethane	ND	1.0	0.5
1,2-Dibromo-3-chloropropane	ND	1.0	0.2	1,2-Dibromoethane (EDB)	ND	1.0	0.5
Dibromomethane	ND	1.0	0.5	1,2-Dichlorobenzene	ND	1.0	0.5
1,3-Dichlorobenzene	ND	1.0	0.5	1,4-Dichlorobenzene	ND	1.0	0.5
Dichlorodifluoromethane	ND	1.0	0.5	1,1-Dichloroethane	ND	1.0	0.5
1,2-Dichloroethane (1,2-DCA)	ND	1.0	0.5	1,1-Dichloroethene	ND	1.0	0.5
cis-1,2-Dichloroethene	ND	1.0	0.5	trans-1,2-Dichloroethene	ND	1.0	0.5
1,2-Dichloropropane	ND	1.0	0.5	1,3-Dichloropropane	ND	1.0	0.5
2,2-Dichloropropane	ND	1.0	0.5	1,1-Dichloropropene	ND	1.0	0.5
cis-1,3-Dichloropropene	ND	1.0	0.5	trans-1,3-Dichloropropene	ND	1.0	0.5
Diisopropyl ether (DIPE)	ND	1.0	0.5	Ethylbenzene	0.72	1.0	0.5
Ethyl tert-butyl ether (ETBE)	ND	1.0	0.5	Freon 113	ND	1.0	10
Hexachlorobutadiene	ND	1.0	0.5	Hexachloroethane	ND	1.0	0.5
2-Hexanone	ND	1.0	0.5	Isopropylbenzene	ND	1.0	0.5
4-Isopropyl toluene	0.78	1.0	0.5	Methyl-t-butyl ether (MTBE)	ND	1.0	0.5
Methylene chloride	ND	1.0	0.5	4-Methyl-2-pentanone (MIBK)	ND	1.0	0.5
Naphthalene	ND	1.0	0.5	n-Propyl benzene	ND	1.0	0.5
Styrene	ND	1.0	0.5	1,1,1,2-Tetrachloroethane	ND	1.0	0.5
1,1,2,2-Tetrachloroethane	ND	1.0	0.5	Tetrachloroethene	ND	1.0	0.5
Toluene	ND	1.0	0.5	1,2,3-Trichlorobenzene	ND	1.0	0.5
1,2,4-Trichlorobenzene	ND	1.0	0.5	1,1,1-Trichloroethane	ND	1.0	0.5
1,1,2-Trichloroethane	ND	1.0	0.5	Trichloroethene	ND	1.0	0.5
Trichlorofluoromethane	ND	1.0	0.5	1,2,3-Trichloropropane	ND	1.0	0.5
1,2,4-Trimethylbenzene	1.6	1.0	0.5	1,3,5-Trimethylbenzene	0.96	1.0	0.5
Vinyl Chloride	ND	1.0	0.5	Xylenes	0.96	1.0	0.5

Surrogate Recoveries (%)

%SS1:	79	%SS2:	95
%SS3:	97		

Comments:

* water and vapor samples are reported in µg/L, soil/sludge/solid samples in mg/kg, product/oil/non-aqueous liquid samples and all TCLP & SPLP extracts are reported in mg/L, wipe samples in µg/wipe.

ND means not detected above the reporting limit; N/A means analyte not applicable to this analysis.

surrogate diluted out of range or coelutes with another peak; &) low surrogate due to matrix interference.



McC Campbell Analytical, Inc.

"When Quality Counts"

1534 Willow Pass Road, Pittsburg, CA 94565-1701
Web: www.mcccampbell.com E-mail: main@mcccampbell.com
Telephone: 877-252-9262 Fax: 925-252-9269

GEOCON Env. Consultants 6671 Brisa St Livermore, CA 94550	Client Project ID: #E8415-06-62	Date Sampled: 04/02/09
		Date Received: 04/02/09
	Client Contact: Rick Day	Date Extracted: 04/02/09
	Client P.O.:	Date Analyzed: 04/03/09

Semi-Volatile Organics by GC/MS (Basic Target List)*

Extraction Method: SW3510C

Analytical Method: SW8270C

Work Order: 0904068

Lab ID	0904068-001D
Client ID	UST #1
Matrix	Water

Compound	Concentration *	DF	Reporting Limit	Compound	Concentration *	DF	Reporting Limit
Acenaphthene	ND<500	50	10	Acenaphthylene	ND<500	50	10
Acetochlor	ND<500	50	10	Anthracene	ND<500	50	10
Benidine	ND<2500	50	50	Benzoic Acid	ND<2500	50	50
Benzo(a)anthracene	ND<500	50	10	Benzo(b)fluoranthene	ND<500	50	10
Benzo(k)fluoranthene	ND<500	50	10	Benzo(g,h,i)perylene	ND<500	50	10
Benzo(a)pyrene	ND<500	50	10	Benzyl Alcohol	ND<2500	50	50
1,1-Biphenyl	ND<500	50	10	Bis (2-chloroethoxy) Methane	ND<500	50	10
Bis (2-chloroethyl) Ether	ND<500	50	10	Bis (2-chloroisopropyl) Ether	ND<500	50	10
Bis (2-ethylhexyl) Phthalate	ND<1000	50	20	4-Bromophenyl Phenyl Ether	ND<500	50	10
Butylbenzyl Phthalate	ND<500	50	10	4-Chloroaniline	ND<1000	50	20
4-Chloro-3-methylphenol	ND<500	50	10	2-Chloronaphthalene	ND<500	50	10
2-Chlorophenol	ND<500	50	10	4-Chlorophenyl Phenyl Ether	ND<500	50	10
Chrysene	ND<500	50	10	Dibenzo(a,h)anthracene	ND<500	50	10
Dibenzofuran	ND<500	50	10	Di-n-butyl Phthalate	ND<500	50	10
1,2-Dichlorobenzene	ND<500	50	10	1,3-Dichlorobenzene	ND<500	50	10
1,4-Dichlorobenzene	ND<500	50	10	3,3-Dichlorobenzidine	ND<1000	50	20
2,4-Dichlorophenol	ND<500	50	10	Diethyl Phthalate	ND<500	50	10
2,4-Dimethylphenol	ND<500	50	10	Dimethyl Phthalate	ND<500	50	10
4,6-Dinitro-2-methylphenol	ND<2500	50	50	2,4-Dinitrophenol	ND<2500	50	50
2,4-Dinitrotoluene	ND<500	50	10	2,6-Dinitrotoluene	ND<500	50	10
Di-n-octyl Phthalate	ND<500	50	10	1,2-Diphenylhydrazine	ND<500	50	10
Fluoranthene	ND<500	50	10	Fluorene	ND<500	50	10
Hexachlorobenzene	ND<500	50	10	Hexachlorobutadiene	ND<500	50	10
Hexachlorocyclopentadiene	ND<2500	50	50	Hexachloroethane	ND<500	50	10
Indeno (1,2,3-cd) pyrene	ND<500	50	10	Isophorone	ND<500	50	10
2-Methylnaphthalene	ND<500	50	10	2-Methylphenol (o-Cresol)	ND<500	50	10
3 &/or 4-Methylphenol (m,p-Cresol)	ND<500	50	10	Naphthalene	ND<500	50	10
2-Nitroaniline	ND<2500	50	50	3-Nitroaniline	ND<2500	50	50
4-Nitroaniline	ND<2500	50	50	Nitrobenzene	ND<500	50	10
2-Nitrophenol	ND<2500	50	50	4-Nitrophenol	ND<2500	50	50
N-Nitrosodiphenylamine	ND<500	50	10	N-Nitrosodi-n-propylamine	ND<500	50	10
Pentachlorophenol	ND<2500	50	50	Phenanthrene	ND<500	50	10
Phenol	ND<500	50	10	Pyrene	ND<500	50	10
1,2,4-Trichlorobenzene	ND<500	50	10	2,4,5-Trichlorophenol	ND<500	50	10
2,4,6-Trichlorophenol	ND<500	50	10				

Surrogate Recoveries (%)

%SS1:	83	%SS2:	102
%SS3:	85	%SS4:	101
%SS5:	117	%SS6:	---#

Comments: a3

* water samples in µg/L, soil/sludge/solid samples in mg/kg, wipe samples in µg/wipe, product/oil/non-aqueous liquid samples and all TCLP & SPLP extracts are reported in mg/L.

ND means not detected above the reporting limit; N/A means analyte not applicable to this analysis.

#) surrogate diluted out of range; &) low or no surrogate due to matrix interference.

a3) sample diluted due to high organic content.



McC Campbell Analytical, Inc.

"When Quality Counts"

1534 Willow Pass Road, Pittsburg, CA 94565-1701
Web: www.mcccampbell.com E-mail: main@mcccampbell.com
Telephone: 877-252-9262 Fax: 925-252-9269

GEOCON Env. Consultants 6671 Brisa St Livermore, CA 94550	Client Project ID: #E8415-06-62	Date Sampled: 04/02/09
		Date Received: 04/02/09
	Client Contact: Rick Day	Date Extracted: 04/02/09
	Client P.O.:	Date Analyzed: 04/03/09

Semi-Volatile Organics by GC/MS (Basic Target List)*

Extraction Method: SW3510C

Analytical Method: SW8270C

Work Order: 0904068

Lab ID	0904068-002D
Client ID	UST #2
Matrix	Water

Compound	Concentration *	DF	Reporting Limit	Compound	Concentration *	DF	Reporting Limit
Acenaphthene	ND<50	5.0	10	Acenaphthylene	ND<50	5.0	10
Acetochlor	ND<50	5.0	10	Anthracene	ND<50	5.0	10
Benidine	ND<250	5.0	50	Benzoic Acid	ND<250	5.0	50
Benzo(a)anthracene	ND<50	5.0	10	Benzo(b)fluoranthene	ND<50	5.0	10
Benzo(k)fluoranthene	ND<50	5.0	10	Benzo(g,h,i)perylene	ND<50	5.0	10
Benzo(a)pyrene	ND<50	5.0	10	Benzyl Alcohol	ND<250	5.0	50
1,1-Biphenyl	ND<50	5.0	10	Bis (2-chloroethoxy) Methane	ND<50	5.0	10
Bis (2-chloroethyl) Ether	ND<50	5.0	10	Bis (2-chloroisopropyl) Ether	ND<50	5.0	10
Bis (2-ethylhexyl) Phthalate	ND<100	5.0	20	4-Bromophenyl Phenyl Ether	ND<50	5.0	10
Butylbenzyl Phthalate	ND<50	5.0	10	4-Chloroaniline	ND<100	5.0	20
4-Chloro-3-methylphenol	ND<50	5.0	10	2-Chloronaphthalene	ND<50	5.0	10
2-Chlorophenol	ND<50	5.0	10	4-Chlorophenyl Phenyl Ether	ND<50	5.0	10
Chrysene	ND<50	5.0	10	Dibenzo(a,h)anthracene	ND<50	5.0	10
Dibenzofuran	ND<50	5.0	10	Di-n-butyl Phthalate	ND<50	5.0	10
1,2-Dichlorobenzene	ND<50	5.0	10	1,3-Dichlorobenzene	ND<50	5.0	10
1,4-Dichlorobenzene	ND<50	5.0	10	3,3-Dichlorobenzidine	ND<100	5.0	20
2,4-Dichlorophenol	ND<50	5.0	10	Diethyl Phthalate	ND<50	5.0	10
2,4-Dimethylphenol	ND<50	5.0	10	Dimethyl Phthalate	ND<50	5.0	10
4,6-Dinitro-2-methylphenol	ND<250	5.0	50	2,4-Dinitrophenol	ND<250	5.0	50
2,4-Dinitrotoluene	ND<50	5.0	10	2,6-Dinitrotoluene	ND<50	5.0	10
Di-n-octyl Phthalate	ND<50	5.0	10	1,2-Diphenylhydrazine	ND<50	5.0	10
Fluoranthene	ND<50	5.0	10	Fluorene	ND<50	5.0	10
Hexachlorobenzene	ND<50	5.0	10	Hexachlorobutadiene	ND<50	5.0	10
Hexachlorocyclopentadiene	ND<250	5.0	50	Hexachloroethane	ND<50	5.0	10
Indeno (1,2,3-cd) pyrene	ND<50	5.0	10	Isophorone	160	5.0	10
2-Methylnaphthalene	ND<50	5.0	10	2-Methylphenol (o-Cresol)	ND<50	5.0	10
3 &/or 4-Methylphenol (m,p-Cresol)	ND<50	5.0	10	Naphthalene	ND<50	5.0	10
2-Nitroaniline	ND<250	5.0	50	3-Nitroaniline	ND<250	5.0	50
4-Nitroaniline	ND<250	5.0	50	Nitrobenzene	ND<50	5.0	10
2-Nitrophenol	ND<250	5.0	50	4-Nitrophenol	ND<250	5.0	50
N-Nitrosodiphenylamine	ND<50	5.0	10	N-Nitrosodi-n-propylamine	ND<50	5.0	10
Pentachlorophenol	ND<250	5.0	50	Phenanthrene	ND<50	5.0	10
Phenol	ND<50	5.0	10	Pyrene	ND<50	5.0	10
1,2,4-Trichlorobenzene	ND<50	5.0	10	2,4,5-Trichlorophenol	ND<50	5.0	10
2,4,6-Trichlorophenol	ND<50	5.0	10				

Surrogate Recoveries (%)

%SS1:	97	%SS2:	104
%SS3:	89	%SS4:	94
%SS5:	113	%SS6:	106

Comments:

* water samples in µg/L, soil/sludge/solid samples in mg/kg, wipe samples in µg/wipe, product/oil/non-aqueous liquid samples and all TCLP & SPLP extracts are reported in mg/L.

ND means not detected above the reporting limit; N/A means analyte not applicable to this analysis.

#) surrogate diluted out of range; &) low or no surrogate due to matrix interference.

a3) sample diluted due to high organic content.



McC Campbell Analytical, Inc.

"When Quality Counts"

1534 Willow Pass Road, Pittsburg, CA 94565-1701
Web: www.mccampbell.com E-mail: main@mccampbell.com
Telephone: 877-252-9262 Fax: 925-252-9269

GEOCON Env. Consultants 6671 Brisa St Livermore, CA 94550	Client Project ID: #E8415-06-62	Date Sampled: 04/02/09
		Date Received 04/02/09
	Client Contact: Rick Day	Date Extracted 04/02/09
	Client P.O.:	Date Analyzed 04/03/09

CAM / CCR 17 Metals*

Lab ID	0904068-001E	0904068-002E			Reporting Limit for DF =1; ND means not detected above the reporting limit	
Client ID	UST #1	UST #2				
Matrix	W	W			S	W
Extraction Type	TOTAL	TOTAL			mg/kg	µg/L

ICP-MS Metals, Concentration*

Analytical Method: E200.8	Extraction Method: E200.8				Work Order: 0904068	
Dilution Factor	1	1			1	1
Antimony	ND	ND			NA	0.5
Arsenic	2.2	12			NA	0.5
Barium	570	100			NA	5.0
Beryllium	ND	ND			NA	0.5
Cadmium	1.7	51			NA	0.25
Chromium	0.63	1.2			NA	0.5
Cobalt	0.72	2.2			NA	0.5
Copper	0.78	2.9			NA	0.5
Lead	3.3	20			NA	0.5
Mercury	0.025	ND			NA	0.012
Molybdenum	ND	ND			NA	0.5
Nickel	ND	3.7			NA	0.5
Selenium	ND	ND			NA	0.5
Silver	ND	ND			NA	0.19
Thallium	ND	ND			NA	0.5
Vanadium	ND	1.6			NA	0.5
Zinc	670	28,000			NA	5.0
%SS:	110	109				

Comments						
-----------------	--	--	--	--	--	--

*water samples are reported in µg/L, product/oil/non-aqueous liquid samples and all TCLP / STLC / DISTLC / SPLP extracts are reported in mg/L, soil/sludge/solid samples in mg/kg, wipe samples in µg/wipe, filter samples in µg/filter.

means surrogate diluted out of range; ND means not detected above the reporting limit; N/A means not applicable to this sample or instrument.

TOTAL = acid digestion.

WET = Waste Extraction Test (STLC).

DI WET = Waste Extraction Test using de-ionized water.



QC SUMMARY REPORT FOR SW8260B

W.O. Sample Matrix: Water

QC Matrix: Water

BatchID: 42430

WorkOrder 0904068

EPA Method SW8260B	Extraction SW5030B								Spiked Sample ID: 0904045-013C			
	Analyte	Sample	Spiked	MS	MSD	MS-MSD	LCS	LCSD	LCS-LCSD	Acceptance Criteria (%)		
	µg/L	µg/L	% Rec.	% Rec.	% RPD	% Rec.	% Rec.	% RPD	MS / MSD	RPD	LCS/LCSD	RPD
tert-Amyl methyl ether (TAME)	ND	10	89.9	92.4	2.67	93.8	98.7	5.13	70 - 130	30	70 - 130	30
Benzene	ND	10	111	117	5.69	109	115	4.60	70 - 130	30	70 - 130	30
t-Butyl alcohol (TBA)	ND	50	75.1	76.6	1.99	72.3	79.9	9.89	70 - 130	30	70 - 130	30
Chlorobenzene	ND	10	96.5	102	5.25	106	107	1.25	70 - 130	30	70 - 130	30
1,2-Dibromoethane (EDB)	ND	10	102	105	2.78	108	111	2.96	70 - 130	30	70 - 130	30
1,2-Dichloroethane (1,2-DCA)	ND	10	95.5	98	2.61	101	106	4.67	70 - 130	30	70 - 130	30
1,1-Dichloroethene	ND	10	82.4	84.6	2.62	89.1	93.2	4.47	70 - 130	30	70 - 130	30
Diisopropyl ether (DIPE)	ND	10	99.8	104	3.93	94.8	96.7	2.03	70 - 130	30	70 - 130	30
Ethyl tert-butyl ether (ETBE)	ND	10	107	111	3.56	102	106	4.03	70 - 130	30	70 - 130	30
Methyl-t-butyl ether (MTBE)	ND	10	100	101	0.992	95.1	98.1	3.14	70 - 130	30	70 - 130	30
Toluene	ND	10	108	114	5.07	116	118	1.50	70 - 130	30	70 - 130	30
Trichloroethene	ND	10	115	118	2.64	126	128	1.42	70 - 130	30	70 - 130	30
%SS1:	76	25	75	76	0.431	75	75	0	70 - 130	30	70 - 130	30
%SS2:	90	25	90	90	0	105	103	1.46	70 - 130	30	70 - 130	30
%SS3:	78	2.5	78	78	0	88	88	0	70 - 130	30	70 - 130	30

All target compounds in the Method Blank of this extraction batch were ND less than the method RL with the following exceptions:
NONE

BATCH 42430 SUMMARY

Lab ID	Date Sampled	Date Extracted	Date Analyzed	Lab ID	Date Sampled	Date Extracted	Date Analyzed
0904068-001C	04/02/09 1:35 PM	04/02/09	04/02/09 6:04 PM	0904068-002C	04/02/09 1:45 PM	04/02/09	04/02/09 6:07 PM

MS = Matrix Spike; MSD = Matrix Spike Duplicate; LCS = Laboratory Control Sample; LCSD = Laboratory Control Sample Duplicate; RPD = Relative Percent Deviation.

% Recovery = 100 * (MS-Sample) / (Amount Spiked); RPD = 100 * (MS - MSD) / ((MS + MSD) / 2).

MS / MSD spike recoveries and / or %RPD may fall outside of laboratory acceptance criteria due to one or more of the following reasons: a) the sample is inhomogenous AND contains significant concentrations of analyte relative to the amount spiked, or b) the spiked sample's matrix interferes with the spike recovery.

N/A = not enough sample to perform matrix spike and matrix spike duplicate.

NR = analyte concentration in sample exceeds spike amount for soil matrix or exceeds 2x spike amount for water matrix or sample diluted due to high matrix or analyte content.

surrogate diluted out of range or coelutes with another peak; &) low surrogate due to matrix interference.

Laboratory extraction solvents such as methylene chloride and acetone may occasionally appear in the method blank at low levels.



QC SUMMARY REPORT FOR SW8270C

W.O. Sample Matrix: Water

QC Matrix: Water

BatchID: 42447

WorkOrder: 0904068

Analyte	EPA Method SW8270C Extraction SW3510C								Spiked Sample ID: N/A			
	Sample	Spiked	MS	MSD	MS-MSD	LCS	LCSD	LCS-LCSD	Acceptance Criteria (%)			
	µg/L	µg/L	% Rec.	% Rec.	% RPD	% Rec.	% Rec.	% RPD	MS / MSD	RPD	LCS/LCSD	RPD
Acenaphthene	N/A	50	N/A	N/A	N/A	85.4	90.7	6.05	N/A	N/A	30 - 130	20
4-Chloro-3-methylphenol	N/A	100	N/A	N/A	N/A	92.9	97	4.30	N/A	N/A	30 - 130	20
2-Chlorophenol	N/A	100	N/A	N/A	N/A	93.4	95.3	2.05	N/A	N/A	30 - 130	20
1,4-Dichlorobenzene	N/A	50	N/A	N/A	N/A	75.8	79.6	4.84	N/A	N/A	30 - 130	20
2,4-Dinitrotoluene	N/A	50	N/A	N/A	N/A	100	103	2.26	N/A	N/A	30 - 130	20
4-Nitrophenol	N/A	100	N/A	N/A	N/A	85.3	88.6	3.81	N/A	N/A	30 - 130	20
N-Nitrosodi-n-propylamine	N/A	50	N/A	N/A	N/A	126	124	1.37	N/A	N/A	30 - 130	20
Pentachlorophenol	N/A	100	N/A	N/A	N/A	66	69.8	5.56	N/A	N/A	30 - 130	20
Phenol	N/A	100	N/A	N/A	N/A	97.5	98.1	0.588	N/A	N/A	30 - 130	20
Pyrene	N/A	50	N/A	N/A	N/A	89.7	93.8	4.57	N/A	N/A	30 - 130	20
1,2,4-Trichlorobenzene	N/A	50	N/A	N/A	N/A	78.8	83.8	6.12	N/A	N/A	30 - 130	20
%SS1:	N/A	5000	N/A	N/A	N/A	79	81	3.08	N/A	N/A	30 - 130	20
%SS2:	N/A	5000	N/A	N/A	N/A	81	82	1.56	N/A	N/A	30 - 130	20
%SS3:	N/A	5000	N/A	N/A	N/A	77	80	3.69	N/A	N/A	30 - 130	20
%SS4:	N/A	5000	N/A	N/A	N/A	70	73	3.88	N/A	N/A	30 - 130	20
%SS5:	N/A	5000	N/A	N/A	N/A	79	82	3.50	N/A	N/A	30 - 130	20
%SS6:	N/A	5000	N/A	N/A	N/A	70	73	5.20	N/A	N/A	30 - 130	20

All target compounds in the Method Blank of this extraction batch were ND less than the method RL with the following exceptions:
NONE

BATCH 42447 SUMMARY

Lab ID	Date Sampled	Date Extracted	Date Analyzed	Lab ID	Date Sampled	Date Extracted	Date Analyzed
0904068-001D	04/02/09 1:35 PM	04/02/09	04/03/09 3:35 AM	0904068-002D	04/02/09 1:45 PM	04/02/09	04/03/09 2:24 AM

MS = Matrix Spike; MSD = Matrix Spike Duplicate; LCS = Laboratory Control Sample; LCSD = Laboratory Control Sample Duplicate; RPD = Relative Percent Deviation.

% Recovery = 100 * (MS-Sample) / (Amount Spiked); RPD = 100 * (MS - MSD) / ((MS + MSD) / 2).

MS / MSD spike recoveries and / or %RPD may fall outside of laboratory acceptance criteria due to one or more of the following reasons: a) the sample is inhomogenous AND contains significant concentrations of analyte relative to the amount spiked, or b) the spiked sample's matrix interferes with the spike recovery.

N/A = not enough sample to perform matrix spike and matrix spike duplicate.

NR = analyte concentration in sample exceeds spike amount for soil matrix or exceeds 2x spike amount for water matrix or sample diluted due to high matrix or analyte content.

Laboratory extraction solvents such as methylene chloride and acetone may occasionally appear in the method blank at low levels.



QC SUMMARY REPORT FOR E200.8

W.O. Sample Matrix: Water

QC Matrix: Water

BatchID: 42393

WorkOrder 0904068

Analyte	Extraction E200.8								Spiked Sample ID: 0903703-005A			
	Sample	Spiked	MS	MSD	MS-MSD	LCS	LCSD	LCS-LCSD	Acceptance Criteria (%)			
	µg/L	µg/L	% Rec.	% Rec.	% RPD	% Rec.	% Rec.	% RPD	MS / MSD	RPD	LCS/LCSD	RPD
Antimony	ND	10	98.4	101	2.89	98.8	103	3.95	70 - 130	20	85 - 115	20
Arsenic	1.3	10	96	101	4.38	99.2	102	2.33	70 - 130	20	85 - 115	20
Barium	42	100	90.3	94	2.75	91.5	94.5	3.25	70 - 130	20	85 - 115	20
Beryllium	ND	10	97.6	100	2.53	108	112	3.55	70 - 130	20	85 - 115	20
Cadmium	ND	10	96.4	98.7	2.33	100	104	3.44	70 - 130	20	85 - 115	20
Chromium	ND	10	97.5	101	3.23	98.4	101	2.59	70 - 130	20	85 - 115	20
Cobalt	ND	10	93	95.2	2.37	99.3	103	3.65	70 - 130	20	85 - 115	20
Copper	11	10	93.7	99.3	2.67	97.7	101	3.44	70 - 130	20	85 - 115	20
Lead	ND	10	100	102	1.56	100	104	3.81	70 - 130	20	85 - 115	20
Mercury	ND	0.25	115	117	2.00	108	106	2.02	70 - 130	20	85 - 115	20
Molybdenum	2.4	10	99.2	102	2.57	98.4	102	3.15	70 - 130	20	85 - 115	20
Nickel	1.0	10	93.4	99.1	5.36	97	99.4	2.47	70 - 130	20	85 - 115	20
Selenium	ND	10	98.1	103	4.38	104	106	1.71	70 - 130	20	85 - 115	20
Silver	ND	10	93.7	96.5	2.86	102	106	2.98	70 - 130	20	85 - 115	20
Thallium	ND	10	95	97.4	2.41	98.1	101	3.04	70 - 130	20	85 - 115	20
Vanadium	3.4	10	98.8	103	2.88	98.4	102	3.59	70 - 130	20	85 - 115	20
Zinc	ND	100	95.3	97.8	2.42	99.8	103	3.15	70 - 130	20	85 - 115	20
%SS:	101	750	100	103	2.47	104	106	2.12	70 - 130	20	70 - 130	20

All target compounds in the Method Blank of this extraction batch were ND less than the method RL with the following exceptions:
NONE

BATCH 42393 SUMMARY

Lab ID	Date Sampled	Date Extracted	Date Analyzed	Lab ID	Date Sampled	Date Extracted	Date Analyzed
0904068-001E	04/02/09 1:35 PM	04/02/09	04/03/09 1:50 PM	0904068-002E	04/02/09 1:45 PM	04/02/09	04/03/09 2:06 PM
0904068-002E	04/02/09 1:45 PM	04/02/09	04/03/09 2:55 PM				

MS = Matrix Spike; MSD = Matrix Spike Duplicate; LCS = Laboratory Control Sample; LCSD = Laboratory Control Sample Duplicate; RPD = Relative Percent Deviation.

% Recovery = 100 * (MS-Sample) / (Amount Spiked); RPD = 100 * (MS - MSD) / ((MS + MSD) / 2).

MS / MSD spike recoveries and / or %RPD may fall outside of laboratory acceptance criteria due to one or more of the following reasons: a) the sample is inhomogenous AND contains significant concentrations of analyte relative to the amount spiked, or b) the spiked sample's matrix interferes with the spike recovery.

N/A = not applicable to this method.

NR = matrix interference and/or analyte concentration in sample exceeds spike amount for soil matrix or exceeds 2x spike amount for water matrix or sample diluted due to high matrix or analyte content.



QC SUMMARY REPORT FOR SW8021B/8015Bm

W.O. Sample Matrix: Water

QC Matrix: Water

BatchID: 42443

WorkOrder: 0904068

EPA Method SW8021B/8015Bm		Extraction SW5030B							Spiked Sample ID: N/A			
Analyte	Sample	Spiked	MS	MSD	MS-MSD	LCS	LCSD	LCS-LCSD	Acceptance Criteria (%)			
	µg/L	µg/L	% Rec.	% Rec.	% RPD	% Rec.	% Rec.	% RPD	MS / MSD	RPD	LCS/LCSD	RPD
TPH(btex) [£]	N/A	60	N/A	N/A	N/A	95.6	112	15.7	N/A	N/A	70 - 130	20
MTBE	N/A	10	N/A	N/A	N/A	87.8	97.5	10.5	N/A	N/A	70 - 130	20
Benzene	N/A	10	N/A	N/A	N/A	98.3	99.6	1.31	N/A	N/A	70 - 130	20
Toluene	N/A	10	N/A	N/A	N/A	107	112	4.05	N/A	N/A	70 - 130	20
Ethylbenzene	N/A	10	N/A	N/A	N/A	105	107	1.62	N/A	N/A	70 - 130	20
Xylenes	N/A	30	N/A	N/A	N/A	113	118	4.50	N/A	N/A	70 - 130	20
%SS:	N/A	10	N/A	N/A	N/A	96	95	2.02	N/A	N/A	70 - 130	20

All target compounds in the Method Blank of this extraction batch were ND less than the method RL with the following exceptions:
NONE

BATCH 42443 SUMMARY

Lab ID	Date Sampled	Date Extracted	Date Analyzed	Lab ID	Date Sampled	Date Extracted	Date Analyzed
0904068-001A	04/02/09 1:35 PM	04/02/09	04/02/09 5:52 PM	0904068-002A	04/02/09 1:45 PM	04/02/09	04/02/09 6:23 PM

MS = Matrix Spike; MSD = Matrix Spike Duplicate; LCS = Laboratory Control Sample; LCSD = Laboratory Control Sample Duplicate; RPD = Relative Percent Deviation.

% Recovery = 100 * (MS-Sample) / (Amount Spiked); RPD = 100 * (MS - MSD) / ((MS + MSD) / 2).

MS / MSD spike recoveries and / or %RPD may fall outside of laboratory acceptance criteria due to one or more of the following reasons: a) the sample is inhomogenous AND contains significant concentrations of analyte relative to the amount spiked, or b) the spiked sample's matrix interferes with the spike recovery.

£ TPH(btex) = sum of BTEX areas from the FID.

cluttered chromatogram; sample peak coelutes with surrogate peak.

N/A = not enough sample to perform matrix spike and matrix spike duplicate.

NR = matrix interference and/or analyte concentration in sample exceeds spike amount for soil matrix or exceeds 2x spike amount for water matrix or sample diluted due to high matrix or analyte content, or inconsistency in sample containers.



QC SUMMARY REPORT FOR SW8015B

W.O. Sample Matrix: Water

QC Matrix: Water

BatchID: 42429

WorkOrder 0904068

EPA Method SW8015B		Extraction SW3510C							Spiked Sample ID: N/A			
Analyte	Sample	Spiked	MS	MSD	MS-MSD	LCS	LCSD	LCS-LCSD	Acceptance Criteria (%)			
	µg/L	µg/L	% Rec.	% Rec.	% RPD	% Rec.	% Rec.	% RPD	MS / MSD	RPD	LCS/LCSD	RPD
TPH-Diesel (C10-C23)	N/A	1000	N/A	N/A	N/A	102	101	0.556	N/A	N/A	70 - 130	30
%SS:	N/A	2500	N/A	N/A	N/A	107	106	1.10	N/A	N/A	70 - 130	30

All target compounds in the Method Blank of this extraction batch were ND less than the method RL with the following exceptions:
NONE

BATCH 42429 SUMMARY

Lab ID	Date Sampled	Date Extracted	Date Analyzed	Lab ID	Date Sampled	Date Extracted	Date Analyzed
0904068-001B	04/02/09 1:35 PM	04/02/09	04/02/09 5:25 PM	0904068-002B	04/02/09 1:45 PM	04/02/09	04/02/09 5:25 PM

MS = Matrix Spike; MSD = Matrix Spike Duplicate; LCS = Laboratory Control Sample; LCSD = Laboratory Control Sample Duplicate; RPD = Relative Percent Deviation.

% Recovery = $100 * (MS - Sample) / (Amount\ Spiked)$; RPD = $100 * (MS - MSD) / ((MS + MSD) / 2)$.

MS / MSD spike recoveries and / or %RPD may fall outside of laboratory acceptance criteria due to one or more of the following reasons: a) the sample is inhomogenous AND contains significant concentrations of analyte relative to the amount spiked, or b) the spiked sample's matrix interferes with the spike recovery.

N/A = not enough sample to perform matrix spike and matrix spike duplicate.

NR = analyte concentration in sample exceeds spike amount for soil matrix or exceeds 2x spike amount for water matrix or sample diluted due to high matrix or analyte content.

APPENDIX



C

WEST COAST EQUIPMENT

P.O. Box 2368
Turlock, CA 95381
General Contractors Lic.#391848

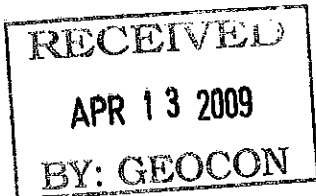

DESTRUCTION CERTIFICATION

This is to certify that the underground storage tank or tanks listed below have been destroyed per governing codes and regulations. Tanks were received empty of product and triple rinsed. If any residue remains in tanks it will be disposed of as hazardous waste.

TANK RECEIVED FROM:

TANK REMOVED FROM:

Geocon Consultants, Inc.
3160 Gold Valley Drive Suite # 800
Rancho Cordova, CA 95742
(916) 852-9118

Cal Trans District 4
111 Grand Ave. Floor #412
Oakland, CA 94623

Removal Site: E.B. Hwy. 580
Between: 1st St. & Vasco Rd.

TANK SIZE

RECEIVED DATE

3-250 Gallon Tanks (Scrap)
1- 600 Gallon Tank (Scrap)

4-3-09

WEST COAST EQUIPMENT

BY: 
Dolores Baptista, Controller

UNIFIED PROGRAM CONSOLIDATED FORM

HAZARDOUS WASTE

HAZARDOUS WASTE TANK CLOSURE CERTIFICATION

Page 1 of 2

I. FACILITY IDENTIFICATION

BUSINESS NAME (Same as FACILITY NAME or DBA - Doing Business As)		FACILITY ID#									
CALTRANS - DISTRICT 4											
TANK OWNER NAME											
Dept. of Transportation - District 4											
TANK OWNER ADDRESS											
111 Grand Avenue, Floor 12											
TANK OWNER CITY				STATE		ZIP CODE					
Oakland				CA		94623					

II. TANK CLOSURE INFORMATION

TANK INTERIOR ATMOSPHERE READINGS	Tank ID # (Attach additional copies of this page for more than three tanks)	Concentration of Flammable Vapor			Concentration of Oxygen		
		Top	Center	Bottom	Top	Center	Bottom
1	580-1	0%	0%	0%	5%	5%	5%
2	580-2	0%	0%	0%	5%	5%	5%
3	580-3	0%	0%	0%	6%	6%	6%

600-G
250-G
250-G

III. CERTIFICATION

On examination of the tank, I certify the tank is visually free from product, sludge, scale (thin, flaky residual of tank contents), residue and debris. I further certify that the information provided herein is true and accurate to the best of my knowledge. *Note: O₂ Content was higher during time of transport.*

SIGNATURE OF CERTIFIER <i>Robert M. Kimball</i>	STATUS OR AFFILIATION OF CERTIFYING PERSON Certifier is a representative of the CUPA, authorized agency, or LIA: <input type="checkbox"/> Yes <input type="checkbox"/> No Name of CUPA, authorized agency, or LIA: If certifier is other than CUPA / LIA check appropriate box below: <input type="checkbox"/> a. Certified Industrial Hygienist (CIH) <input type="checkbox"/> b. Certified Safety Professional (CSP) <input type="checkbox"/> c. Certified Marine Chemist (CMC) <input type="checkbox"/> d. Registered Environmental Health Specialist (REHS) <input type="checkbox"/> e. Professional Engineer (PE) <input type="checkbox"/> f. Class II Registered Environmental Assessor <input checked="" type="checkbox"/> g. Contractors' State License Board licensed contractor (with hazardous substance removal certification)
NAME OF CERTIFIER (Print) Robert M. Kimball	
TITLE OF CERTIFIER Contractor, RME HAR	
ADDRESS 3160 Gold Valley Drive #800	
CITY Rancho Cordova CA	
PHONE 916 852-9118	
DATE 4-3-09	CERTIFICATION TIME 13:30

TANK PREVIOUSLY HELD FLAMMABLE OR COMBUSTIBLE MATERIALS
(If yes, the tank interior atmosphere shall be re-checked with a combustible gas indicator prior to work being conducted on the tank.) Yes No

CERTIFIER'S TANK MANAGEMENT INSTRUCTIONS FOR SCRAP DEALER, DISPOSAL FACILITY, ETC:
*Dispose of Tanks by Recycling per Facilities Tank Destruction Policy & Procedures.
Submit Tank Destruction Certificate to Gecon*

A copy of this certificate shall accompany the tank to the recycling / disposal facility and be provided to the CUPA. If there is no CUPA, copies shall be submitted to the LIA and authorized agency; owner / operator of the tank system; removal contractor; and the recycling / disposal facility.

HAZARDOUS WASTE TANK CLOSURE CERTIFICATION

I. FACILITY IDENTIFICATION

BUSINESS NAME (Same as FACILITY NAME or DBA - Doing Business As) ³			FACILITY ID#									
CALTRANS - DISTRICT 4												
TANK OWNER NAME 740												
Dept of Transportation - District 4												
TANK OWNER ADDRESS 741												
111 Grand Avenue, Floor 12												
TANK OWNER CITY 742				STATE 743				ZIP CODE 744				
Oakland				CA				94625				

II. TANK CLOSURE INFORMATION

TANK INTERIOR ATMOSPHERE READINGS	Tank ID # (Attach additional copies of this page for more than three tanks)	Concentration of Flammable Vapor			Concentration of Oxygen		
		Top	Center	Bottom	Top	Center	Bottom
		746a	746b	746c	747a	747b	747c
1	580-4 745	0% 746a	0% 746b	0% 746c	4% 747a	4% 747b	4% 747c
2	748	749a	749b	749c	750a	750b	750c
3	751	752a	752b	752c	753a	753b	753c

250.6.

III. CERTIFICATION

On examination of the tank, I certify the tank is visually free from product, sludge, scale (thin, flaky residual of tank contents), rinseate and debris. I further certify that the information provided herein is true and accurate to the best of my knowledge.

Note: O₂ Concentration is higher during time of transport

SIGNATURE OF CERTIFIER		STATUS OR AFFILIATION OF CERTIFYING PERSON	
<i>Robert M. Kimball</i>		Certifier is a representative of the CUPA, authorized agency, or LIA: 760	
NAME OF CERTIFIER (Print) 754		<input type="checkbox"/> Yes <input type="checkbox"/> No	
Robert M. Kimball		Name of CUPA, authorized agency, or LIA: 761	
TITLE OF CERTIFIER 755		If certifier is other than CUPA / LIA check appropriate box below: 762	
Contractor - RME HAZ		<input type="checkbox"/> a. Certified Industrial Hygienist (CIH)	
ADDRESS 756		<input type="checkbox"/> b. Certified Safety Professional (CSP)	
3160 Gold Valley Drive, #800		<input type="checkbox"/> c. Certified Marine Chemist (CMC)	
CITY 757		<input type="checkbox"/> d. Registered Environmental Health Specialist (REHS)	
Rancho Cordova, CA 95742		<input type="checkbox"/> e. Professional Engineer (PE)	
PHONE 758		<input type="checkbox"/> f. Class II Registered Environmental Assessor	
916 852-9118		<input checked="" type="checkbox"/> g. Contractors' State License Board licensed contractor (with hazardous substance removal certification)	
DATE 759	CERTIFICATION TIME		
4-3-09	13:31		

TANK PREVIOUSLY HELD FLAMMABLE OR COMBUSTIBLE MATERIALS 763

(If yes, the tank interior atmosphere shall be re-checked with a combustible gas indicator prior to work being conducted on the tank.) Yes No

CERTIFIER'S TANK MANAGEMENT INSTRUCTIONS FOR SCRAP DEALER, DISPOSAL FACILITY, ETC: 764

Dispose of Tank by Recycling per Facilities Tank Destruction Policy & Procedures.
Submit Tank Destruction Certification to Geocom

A copy of this certificate shall accompany the tank to the recycling / disposal facility and be provided to the CUPA. If there is no CUPA, copies shall be submitted to the LIA and authorized agency; owner / operator of the tank system; removal contractor; and the recycling / disposal facility.

NON-HAZARDOUS WASTE MANIFEST	1. Generator ID Number CAS111111001	2. Page 1 of 1	3. Emergency Response Phone NRCES 510 749-1390	4. Waste Tracking Number 42012-01		
5. Generator's Name and Mailing Address DEPARTMENT OF TRANSPORTATION CALTRANS DISTRI 111 GRAND AVENUE FLOOR 14 OAKLAND CA 94623		Generator's Site Address (if different than mailing address) CALTRANS DISTRICT#4 LIVERMORE EAST BOUND HWY 580, BETWEEN N FIRST STREET, AND LIVERMORE CA				
Generator's Phone: 510 622-8750						
6. Transporter 1 Company Name CHAPMAN Trucking		U.S. EPA ID Number				
7. Transporter 2 Company Name		U.S. EPA ID Number				
8. Designated Facility Name and Site Address Waste Management - Altamont 10840 Altamont Road Livermore CA 94560		U.S. EPA ID Number CAD981382732				
Facility's Phone: 925 455-7300						
GENERATOR	9. Waste Shipping Name and Description	10. Containers		11. Total Quantity	12. Unit Wt./Vol.	NONE
		No.	Type			
	1. NON HAZARDOUS WASTE SOILD (SOIL WITH HYDROCARBONS) (PROFILE# 102242CA)	001	DT	20yds	Y	
	2.					
	3.					
4.						
13. Special Handling Instructions and Additional Information WEAR APPROPRIATE PERSONAL PROTECTIVE EQUIPMENT JOB#/PO#: 42012 CONSULTANT: GEOCON CONSULTANTS, INC. 6671 BRISA STREET, LIVERMORE, CA. NRCEES 1605 FERRY POINT ALAMEDA, CA. 94501 Lic # 3V87198						
14. GENERATOR'S CERTIFICATION: I certify the materials described above on this manifest are not subject to federal regulations for reporting proper disposal of Hazardous Waste.						
Generator's/Offoror's Printed/Typed Name Chris Bledsoe Caltrans		Signature <i>Chris Bledsoe</i>		Month 4	Day 9	Year 09
15. International Shipments <input type="checkbox"/> Import to U.S. <input type="checkbox"/> Export from U.S. Port of entry/exit: Date leaving U.S.:						
16. Transporter Acknowledgment of Receipt of Materials						
Transporter 1 Printed/Typed Name MATT Chapman		Signature <i>Matt Chapman</i>		Month 4	Day 9	Year 09
Transporter 2 Printed/Typed Name		Signature		Month	Day	Year
17. Discrepancy						
17a. Discrepancy Indication Space <input type="checkbox"/> Quantity <input type="checkbox"/> Type <input type="checkbox"/> Residue <input type="checkbox"/> Partial Rejection <input type="checkbox"/> Full Rejection						
Manifest Reference Number:						
17b. Alternate Facility (or Generator) U.S. EPA ID Number						
Facility's Phone:						
17c. Signature of Alternate Facility (or Generator) Month Day Year						
18. Designated Facility Owner or Operator. Certification of receipt of materials covered by the manifest except as noted in Item 17a						
Printed/Typed Name John Schaeffler		Signature <i>John Schaeffler</i>		Month 4	Day 9	Year 09



WEIGHMASTER-Altamont Landfill & RRF
 10840 Altamont Pass Road
 Livermore, CA, 94551
 Ph: (925)455-7300

Original
 Ticket# 043180

Customer Name NrcEnvironment Nrc Environment Carrier GEN Altamont Generic
 Ticket Date 04/09/2009 Vehicle# 3v07198
 Payment Type Credit Account Container
 Manual Ticket# CHAPMAN TRUCKING 1WT
 Billing # 0038257 License#

Manifest 42012 01
 PO
 Profile 102242CA (Class II Cover*NRCE5*Caltrans Dist#4*102242CA)
 Generator 164-CaltransDistrict4Livermore Caltrans District 4 - Livermore

Time	Scale	Deputy Weighmaster	Inbound	Gross	
In 04/09/2009 08:10:01	Scale 3 d P Ratio				66600 lb
Out 04/09/2009 08:10:01	P Ratio			Tare	31700 lb
				Net	34900 lb
				Tons	17.44

Comments

Product	LD%	Qty	UOM	Rate	Tax	Amount	Origin
1 02 Cover RGC-Tons- 100		17.44	Tons				Livermore
2 FUEL-Fuel Surchang 100			%				Livermore
3 Evf8-Env Fee 10 Lg 100		1	Load				Livermore

DRIVER: 

Weighmaster Certificate

Total Tax
 Total Ticket

THIS IS TO CERTIFY that the following described commodity was weighed, measured or counted by a weighmaster, whose signature is on this certificate, who is a recognized authority of accuracy, as prescribed by Chapter 7 (commencing with section 12700) of Division 5 of the California Business and Professions Code, administered by the Division of Measurement Standards of the California Department of Food and Agriculture.



GENERATOR

NON-HAZARDOUS WASTE MANIFEST

1. Generator ID Number
CAS111111001

2. Page 1 of
1

3. Emergency Response Phone
NRCS 510 749-1390

4. Waste Tracking Number
42012-02

5. Generator's Name and Mailing Address
**DEPARTMENT OF TRANSPORTATION CALTRANS DISTRI
111 GRAND AVENUE FLOOR 14
OAKLAND CA 94623**

ATT: JILL POLLOCK

Generator's Site Address (if different than mailing address)
**CALTRANS DISTRICT #4 LIVERMORE
EAST BOUND HWY 580, BETWEEN N FIRST STREET, AND
UNION BOULEVARD**

Generator's Phone: **510 622-8750**

6. Transporter 1 Company Name
WEST COAST TRANSPORT

U.S. EPA ID Number
CAR000171454

7. Transporter 2 Company Name

U.S. EPA ID Number

8. Designated Facility Name and Site Address
**Waste Management - Altamont
10840 Altamont Road
Livermore CA 94550**

U.S. EPA ID Number
CAD981382732

9. Waste Shipping Name and Description	10. Containers		11. Total Quantity	12. Unit Wt./Vol.	
	No.	Type			
1. NON HAZARDOUS WASTE SOILD (SOIL WITH HYDROCARBONS) (PROFILE# 102242CA)	001	DT	015	Y	NONE
2.					
3.					
4.					

13. Special Handling Instructions and Additional Information
**WEAR APPROPRIATE PERSONAL PROTECTIVE EQUIPMENT JOB#/PO#: 42012
CONSULTANT: GEOCON CONSULTANTS, INC. 6671 BRISA STREET, LIVERMORE, CA.
NRCS 1605 FERRY POINT ALAMEDA, CA. 94501**

LIC# 9020421

14. GENERATOR'S CERTIFICATION: I certify the materials described above on this manifest are not subject to federal regulations for reporting proper disposal of Hazardous Waste.

Generator's/Offoror's Printed/Typed Name
Chris Bledsoe Caltrans

Signature
Chris Bledsoe

Month Day Year
4 9 9

INT'L

15. International Shipments Import to U.S. Export from U.S. Port of entry/exit: _____ Date leaving U.S.: _____

TRANSPORTER

16. Transporter Acknowledgment of Receipt of Materials

Transporter 1 Printed/Typed Name
BOB RUENO

Signature
Bob Rueno

Month Day Year
4 9 09

Transporter 2 Printed/Typed Name

Signature

Month Day Year

DESIGNATED FACILITY

17. Discrepancy

17a. Discrepancy Indication Space Quantity Type Residue Partial Rejection Full Rejection

17b. Alternate Facility (or Generator) Manifest Reference Number: _____ U.S. EPA ID Number _____ Facility's Phone: _____

17c. Signature of Alternate Facility (or Generator) _____ Month Day Year _____

18. Designated Facility Owner or Operator: Certification of receipt of materials covered by the manifest except as noted in Item 17a

Printed/Typed Name _____ Signature _____ Month Day Year **4 9 09**



WEIGHMASTER-Altamont Landfill & RRF
 10840 Altamont Pass Road
 Livermore, CA, 94551
 Ph: (925) 455-7300

Original
 Ticket# 843103

Customer Name NrcEnvironment Nrc Environment Carrier GEN Altamont Generic
 Ticket Date 04/09/2009 Vehicle# 9d20421
 Payment Type Credit Account Container
 Manual Ticket# WEST COAST WC21WT
 Billing # 0038057 License#

Manifest 4201202
 PO
 Profile 102242CA (Class II Cover*NRCE5*Caltrans Dist#4*102242CA)
 Generator 164-CaltransDistrict4Livermore Caltrans District 4 - Livermore

Time	Scale	Deputy Weighmaster	Inbound	Gross	
In 04/09/2009 08:29:14	Scale 3 d P Ratto			Tare	70100 lb
Out 04/09/2009 08:29:14	P Ratto			Net	31700 lb
				Tons	38480 lb
					19.24

Comments

Product	LD%	Qty	UOM	Rate	Tax	Amount	Origin
1 C2 Cover RBC-Tons- 100		19.24	Tons				Livermore
2 FUEL-Fuel Surcharg 100			%				Livermore
3 Evf8-Env Fee \$8 Lg 100		1	Load				Livermore

DRIVER: 

Weighmaster Certificate

Total Tax
 Total Ticket

THIS IS TO CERTIFY that the following described commodity was weighed, measured or counted by a weighmaster, whose signature is on this certificate, who is a recognized authority of accuracy, as prescribed by Chapter 7 (commencing with section 12700) of Division 5 of the California Business and Professions Code, administered by the Division of Measurement Standards of the California Department of Food and Agriculture.



GENERATOR	NON-HAZARDOUS WASTE MANIFEST	1. Generator ID Number CAS111111001	2. Page 1 of 1	3. Emergency Response Phone NRCES 510 749-1390	4. Waste Tracking Number 42012-03
	5. Generator's Name and Mailing Address DEPARTMENT OF TRANSPORTATION CALTRANS DISTRI 111 GRAND AVENUE FLOOR 14 OAKLAND CA 94623		Generator's Site Address (if different than mailing address) CALTRANS DISTRICT#4 LIVERMORE EAST BOUND HWY 580, BETWEEN N FIRST STREET, AND LIVERMORE CA		
6. Transporter 1 Company Name C. JOAQUIN TRUCKING		Generator's Phone: 510 622-8750		U.S. EPA ID Number	
7. Transporter 2 Company Name				U.S. EPA ID Number	
8. Designated Facility Name and Site Address Waste Management - Altamont 10840 Altamont Road Livermore CA 94550		Facility's Phone: 925 455-7388		U.S. EPA ID Number CAD981382732	
9. Waste Shipping Name and Description		10. Containers		11. Total Quantity	12. Unit Wt./Vol.
		No.	Type		
1. NON HAZARDOUS WASTE SOILD (SOIL WITH HYDROCARBONS) (PROFILE# 102242CA)		001	DT	015	Y
2.					NONE
3.					
4.					
13. Special Handling Instructions and Additional Information WEAR APPROPRIATE PERSONAL PROTECTIVE EQUIPMENT JOB#/PO#: 42012 CONSULTANT: GEOCON CONSULTANTS, INC. 6671 BRISA STREET, LIVERMORE, CA. NRCES 1605 FERRY POINT ALAMEDA, CA. 94501					
14. GENERATOR'S CERTIFICATION: I certify the materials described above on this manifest are not subject to federal regulations for reporting proper disposal of Hazardous Waste.					
Generator's/Offoror's Printed/Typed Name Chris Bledsoe Caltrans		Signature <i>Chris Bledsoe</i>		Month 4	Day 9
15. International Shipments <input type="checkbox"/> Import to U.S. <input type="checkbox"/> Export from U.S.		Port of entry/exit:		Year 99	
Transporter Signature (for exports only):		Date leaving U.S.:			
TRANSPORTER	16. Transporter Acknowledgment of Receipt of Materials				
	Transporter 1 Printed/Typed Name CHRIS JOAQUIN	Signature <i>Chris Joaquin</i>		Month 4	Day 9
Transporter 2 Printed/Typed Name		Signature		Year 99	
DESIGNATED FACILITY	17. Discrepancy				
	17a. Discrepancy Indication Space <input type="checkbox"/> Quantity <input type="checkbox"/> Type <input type="checkbox"/> Residue <input type="checkbox"/> Partial Rejection <input type="checkbox"/> Full Rejection				
	Manifest Reference Number:				
17b. Alternate Facility (or Generator)				U.S. EPA ID Number	
Facility's Phone:					
17c. Signature of Alternate Facility (or Generator)				Month	Day
				Year	
18. Designated Facility Owner or Operator: Certification of receipt of materials covered by the manifest except as noted in Item 17a					
Printed/Typed Name		Signature		Month 4	Day 9
				Year 99	



WEIGHMASTER-Altamont Landfill & RRF
 10840 Altamont Pass Road
 Livermore, CA, 94551
 Ph: (925)455-7300

Original
 Ticket# 843195

Customer Name NrcEnvironment Nrc Environment Carrier GEN Altamont Generic
 Ticket Date 04/09/2009 Vehicle# 9d09160
 Payment Type Credit Account Container
 Manual Ticket# C JOAQUIN B03WT
 Billing # 0030257 License#

Manifest 42012-03
 PO
 Profile 102242CA (Class II Cover~NRCES~Caltrans Dist#4~102242CA)
 Generator 164-CaltransDistrict4Livermore Caltrans District 4 - Livermore

Time	Scale	Deputy Weighmaster	Inbound	Gross	
In 04/09/2009 08:50:53	Scale 3 d P Ratto			59000 lb	
Out 04/09/2009 08:50:53	P Ratto			Tare 31560 lb	
				Net 37440 lb	
				Tons 18.72	

Comments

Product	LD%	Qty	UOM	Rate	Tax	Amount	Origin
1 DE Cover RBC-Tons-	100	18.72	Tons				Livermore
2 FUEL-Fuel Surcharg	100		%				Livermore
3 EvfB-Env Fee \$6 Lg	100	1	Load				Livermore

DRIVER: 

Total Tax
 Total Ticket

Weighmaster Certificate

THIS IS TO CERTIFY that the following described commodity was weighed, measured or counted by a weighmaster, whose signature is on this certificate, who is a recognized authority of accuracy, as prescribed by Chapter 7 (commencing with section 12700) of Division 5 of the California Business and Professions Code, administered by the Division of Measurement Standards of the California Department of Food and Agriculture.

GENERATOR
 INT'L
 TRANSPORTER
 DESIGNATED FACILITY

NON-HAZARDOUS WASTE MANIFEST 1. Generator ID Number: **CAS111111001** 2. Page 1 of **1** 3. Emergency Response Phone: **NRCS 510 749-1390** 4. Waste Tracking Number: **42012-04**

5. Generator's Name and Mailing Address: **DEPARTMENT OF TRANSPORTATION CALTRANS DISTRICT #4 LIVERMORE**
111 GRAND AVENUE FLOOR 14 OAKLAND CA 94623
 Generator's Site Address (if different than mailing address): **CALTRANS DISTRICT #4 LIVERMORE EAST BOUND HWY 580, BETWEEN N FIRST STREET, AND LIVERMORE CA**
 Generator's Phone: **510 622-8750**

6. Transporter 1 Company Name: **Chapman Trucking** U.S. EPA ID Number:

7. Transporter 2 Company Name: U.S. EPA ID Number:

8. Designated Facility Name and Site Address: **Waste Management - Altamont**
10840 Altamont Road Livermore CA 94550
 Facility's Phone: **925 455-7300** U.S. EPA ID Number: **CAD981382732**

9. Waste Shipping Name and Description	10. Containers		11. Total Quantity	12. Unit Wt./Vol.	
	No.	Type			
1. NON HAZARDOUS WASTE SOILD (SOIL WITH HYDROCARBONS) (PROFILE# 102242CA)	001	DT	015	Y	NONE
2.					
3.					
4.					

13. Special Handling Instructions and Additional Information:
WEAR APPROPRIATE PERSONAL PROTECTIVE EQUIPMENT JOB#/PO#: 42012
CONSULTANT: GEOCON CONSULTANTS, INC. 6671 BRISA STREET, LIVERMORE, CA.
NRCS 1605 FERRY POINT ALAMEDA, CA. 94501
Lic. #3V87198

14. GENERATOR'S CERTIFICATION: I certify the materials described above on this manifest are not subject to federal regulations for reporting proper disposal of Hazardous Waste.
 Generator's/Offoror's Printed/Typed Name: **Chris Bledsoe Caltrans** Signature: **Chris Bledsoe** Month: **4** Day: **9** Year: **09**

15. International Shipments: Import to U.S. Export from U.S. Port of entry/exit: Date leaving U.S.:

16. Transporter Acknowledgment of Receipt of Materials
 Transporter 1 Printed/Typed Name: **Matt Chapman** Signature: **Matt Chapman** Month: **4** Day: **9** Year: **09**
 Transporter 2 Printed/Typed Name: Signature: Month: Day: Year:

17. Discrepancy
 17a. Discrepancy Indication Space: Quantity Type Residue Partial Rejection Full Rejection
 Manifest Reference Number:

17b. Alternate Facility (or Generator): U.S. EPA ID Number:

Facility's Phone: 17c. Signature of Alternate Facility (or Generator): Month: Day: Year:

18. Designated Facility Owner or Operator: Certification of receipt of materials covered by the manifest except as noted in Item 17a
 Printed/Typed Name: **John Schaeffer** Signature: **John Schaeffer** Month: **4** Day: **9** Year: **09**



WEIGHMASTER-Altamont Landfill & RRF
 10040 Altamont Pass Road
 Livermore, CA, 94551
 Ph: (925)455-7300

Original
 Ticket# 843212

Customer Name NrcEnvironment Nrc Environment Carrier GEN Altamont Generic
 Ticket Date 04/09/2009 Vehicle# 3v87198
 Payment Type Credit Account Container
 Manual Ticket# CHAPMAN TRUCKING IWT
 Billing # 0038257 License#

Manifest 4212 04
 PO 42012
 Profile 102242CA (Class II Cover~NRCE5~Caltrans Dist#4~102242CA)
 Generator 164-CaltransDistrict4Livermore Caltrans District 4 - Livermore

Time	Scale	Deputy Weighmaster	Inbound	Gross	
In 04/09/2009 09:31:53	Scale 3 d	J Schaeuffler			67140 lb
Out 04/09/2009 09:31:53		J Schaeuffler		Tare	31780 lb
				Net	35360 lb
				Tone	17.68

Comments

Product	LD%	Qty	UOM	Rate	Tax	Amount	Origin
1 C2 Cover RGC-Tons- 100		17.68	Tons				Livermore
2 FUEL-Fuel Surcharg 100			%				Livermore
3 Evf8-Env Fee \$8 Lg 100		1	Load				Livermore

DRIVER: _____

Weighmaster Certificate

Total Tax
 Total Ticket

THIS IS TO CERTIFY that the following described commodity was weighed, measured or counted by a weighmaster, whose signature is on this certificate, who is a recognized authority of accuracy, as prescribed by Chapter 7 (commencing with section 12700) of Division 5 of the California Business and Professions Code, administered by the Division of Measurement Standards of the California Department of Food and Agriculture.



GENERATOR

INT'L

TRANSPORTER

DESIGNATED FACILITY

NON-HAZARDOUS WASTE-MANIFEST	1. Generator ID Number CAS111111001	2. Page 1 of 1	3. Emergency Response Phone NRCES 510 749-1390	4. Waste Tracking Number 42012-05
------------------------------	---	--------------------------	--	---

5. Generator's Name and Mailing Address DEPARTMENT OF TRANSPORTATION CALTRANS DISTRICT #4 111 GRAND AVENUE FLOOR 14 OAKLAND CA 94623	At: JILL POLLOCK	Generator's Site Address (if different than mailing address) CALTRANS DISTRICT #4 LIVERMORE EAST BOUND HWY 580, BETWEEN N FIRST STREET, AND LIVERMORE CA
--	-------------------------	--

Generator's Phone: **510 622-8750**

6. Transporter 1 Company Name WEST COAST TRANSPORT	U.S. EPA ID Number CAR000171454
--	---

7. Transporter 2 Company Name	U.S. EPA ID Number
-------------------------------	--------------------

8. Designated Facility Name and Site Address Waste Management - Altamont 10840 Altamont Road Livermore CA 94560	U.S. EPA ID Number CAD981382732
---	---

9. Waste Shipping Name and Description	10. Containers		11. Total Quantity	12. Unit Wt./Vol.	
	No.	Type			
1. NON HAZARDOUS WASTE SOILD (SOIL WITH HYDROCARBONS) (PROFILE# 102242CA)	001	DT	015	Y	NONE
2.					
3.					
4.					

13. Special Handling Instructions and Additional Information
WEAR APPROPRIATE PERSONAL PROTECTIVE EQUIPMENT JOB#/PO#: 42012
CONSULTANT: GEOCON CONSULTANTS, INC. 6671 BRISA STREET, LIVERMORE, CA.
NRCES 1605 FERRY POINT ALAMEDA, CA. 94501
Lic# 9020421

14. GENERATOR'S CERTIFICATION: I certify the materials described above on this manifest are not subject to federal regulations for reporting proper disposal of Hazardous Waste.

Generator's/Officer's Printed/Typed Name Chris Bledsoe Caltrans	Signature ch Bledsoe	Month 4	Day 9	Year 9
---	--------------------------------	-------------------	-----------------	------------------

15. International Shipments Import to U.S. Export from U.S. Port of entry/exit: _____ Date leaving U.S.: _____

16. Transporter Acknowledgment of Receipt of Materials				
Transporter 1 Printed/Typed Name BOB SUENO	Signature Bob Sueno	Month 4	Day 9	Year 09
Transporter 2 Printed/Typed Name	Signature	Month	Day	Year

17. Discrepancy

17a. Discrepancy Indication Space Quantity Type Residue Partial Rejection Full Rejection

Manifest Reference Number: _____

17b. Alternate Facility (or Generator)	U.S. EPA ID Number
--	--------------------

Facility's Phone: _____

17c. Signature of Alternate Facility (or Generator)	Month	Day	Year
---	-------	-----	------

18. Designated Facility Owner or Operator: Certification of receipt of materials covered by the manifest except as noted in Item 17a	Printed/Typed Name John Schauffler	Signature John Schauffler	Month 4	Day 9	Year 09
--	--	-------------------------------------	-------------------	-----------------	-------------------



WEIGHMASTER-Altamont Landfill & RRF
 10840 Altamont Pass Road
 Livermore, CA, 94551
 Ph: (925) 455-7300

Original
 Ticket# 043217

Customer Name NrcEnvironment Nrc Environment Carrier GEN Altamont Generic
 Ticket Date 04/09/2009 Vehicle# 9020421
 Payment Type Credit Account Container
 Manual Ticket# WEST COAST WC21WT
 Billing # 0038257 License#

Manifest 42012 05
 PO
 Profile 1022420A (Class II Cover~NRCE5~Caltrans Dist#4~1022420A)
 Generator 164-CaltransDistrict4Livermore Caltrans District 4 - Livermore

Time	Scale	Deputy Weighmaster	Inbound	Gross	68200 lb
In 04/09/2009 09:48:31	Scale 3 d	J Schaeuffler		Tare	31700 lb
Out 04/09/2009 09:48:31		J Schaeuffler		Net	36500 lb
				Tons	18.29

Comments

Product	LD%	Qty	UOM	Rate	Tax	Amount	Origin
1 C2 Cover RBC-Tons-	100	18.29	Tons				Livermore
2 FUEL-Fuel Surcharg	100		%				Livermore
3 Evf8-Env Fee 48 Lg	100	1	Load				Livermore

DRIVER:

Total Tax
 Total Ticket

Weighmaster Certificate

THIS IS TO CERTIFY that the following described commodity was weighed, measured or counted by a weighmaster, whose signature is on this certificate, who is a recognized authority of accuracy, as prescribed by Chapter 7 (commencing with section 12700) of Division 5 of the California Business and Professions Code, administered by the Division of Measurement Standards of the California Department of Food and Agriculture.



NON-HAZARDOUS WASTE MANIFEST	1. Generator ID Number CAS111111001	2. Page 1 of 1	3. Emergency Response Phone NRCES 510 749-1390	4. Waste Tracking Number 42012-06			
5. Generator's Name and Mailing Address DEPARTMENT OF TRANSPORTATION CALTRANS DISTRICT #4 111 GRAND AVENUE FLOOR 14 OAKLAND CA 94623		Generator's Site Address (if different than mailing address) ATT: JILL POLLOCK CALTRANS DISTRICT #4 LIVERMORE EAST BOUND HWY 580, BETWEEN N FIRST STREET, AND LIVESTRONG BLVD LIVERMORE CA					
Generator's Phone: 510 622-8750							
6. Transporter 1 Company Name C. JOAQUIN TRUCKING			U.S. EPA ID Number				
7. Transporter 2 Company Name			U.S. EPA ID Number				
8. Designated Facility Name and Site Address Waste Management - Altamont 10940 Altamont Road Livermore CA 94550			U.S. EPA ID Number CAD981382732				
Facility's Phone: 925 455-7300							
GENERATOR	9. Waste Shipping Name and Description	10. Containers		11. Total Quantity	12. Unit Wt./Vol.		
		No.	Type				
	1. NON HAZARDOUS WASTE SOILD (SOIL WITH HYDROCARBONS) (PROFILE# 102242CA)	001	DT	015	Y		NONE
	2.						
	3.						
4.							
13. Special Handling Instructions and Additional Information WEAR APPROPRIATE PERSONAL PROTECTIVE EQUIPMENT JOB#/PO#: 42012 CONSULTANT: GEOCON CONSULTANTS, INC. 6671 BRISA STREET, LIVERMORE, CA. NRCES 1605 FERRY POINT ALAMEDA, CA. 94501							
14. GENERATOR'S CERTIFICATION: I certify the materials described above on this manifest are not subject to federal regulations for reporting proper disposal of Hazardous Waste.							
Generator's/Officer's Printed/Typed Name Chris Bedsee Caltrans			Signature <i>Chris Bedsee</i>		Month	Day	Year
					4	9	9
TRANSPORTER	15. International Shipments <input type="checkbox"/> Import to U.S. <input type="checkbox"/> Export from U.S. Port of entry/exit: _____ Date leaving U.S.: _____						
	16. Transporter Acknowledgment of Receipt of Materials						
Transporter 1 Printed/Typed Name CHRIS JOAQUIN			Signature <i>Chris Joaquin</i>		Month	Day	Year
					4	9	9
Transporter 2 Printed/Typed Name			Signature		Month	Day	Year
DESIGNATED FACILITY	17. Discrepancy						
	17a. Discrepancy Indication Space <input type="checkbox"/> Quantity <input type="checkbox"/> Type <input type="checkbox"/> Residue <input type="checkbox"/> Partial Rejection <input type="checkbox"/> Full Rejection						
	17b. Alternate Facility (or Generator)			Manifest Reference Number:			
	Facility's Phone:			U.S. EPA ID Number			
17c. Signature of Alternate Facility (or Generator)					Month	Day	Year
18. Designated Facility Owner or Operator: Certification of receipt of materials covered by the manifest except as noted in Item 17a							
Printed/Typed Name			Signature		Month	Day	Year
					4	9	09



WEIGHMASTER-Altamont Landfill & RRF
 10040 Altamont Pass Road
 Livermore, CA, 94551
 Ph: (925)455-7300

Original
 Ticket# 843204

Customer Name NrcEnvironment Nrc Environment Carrier GEN Altamont Generic
 Ticket Date 04/09/2009 Vehicle# 3d99160
 Payment Type Credit Account Container
 Manual Ticket# C JOAQUIN 803WT
 Billing # 0038257 License#

Manifest 42012-05
 PO
 Profile 1022420A (Class II Cover*NRCE5*Caltrans Dist#4*1022420A)
 Generator 164-CaltransDistrict4Livermore Caltrans District 4 - Livermore

Time	Scale	Deputy Weighmaster	Inbound	Gross	66700 lb
In 04/09/2009 10:06:51	Scale 3 d P Ratto			Tare	31560 lb
Out 04/09/2009 10:06:51	P Ratto			Net	35140 lb
				Tone	17.57

Comments

Product	LDX	Qty	UOM	Rate	Tax	Amount	Origin
1 C2 Cover RBC-Tons- 100		17.57	Tons				Livermore
2 FUEL-Fuel Surcharg 100			%				Livermore
3 EvfB-Env Fee 10 Lg 100		1	Load				Livermore

DRIVER: 

Total Tax
 Total Ticket

Weighmaster Certificate

THIS IS TO CERTIFY that the following described commodity was weighed, measured or counted by a weighmaster, whose signature is on this certificate, who is a recognized authority of accuracy, as prescribed by Chapter 7 (commencing with section 12700) of Division 5 of the California Business and Professions Code, administered by the Division of Measurement Standards of the California Department of Food and Agriculture.



NON-HAZARDOUS WASTE MANIFEST		1. Generator ID Number CAS111111001	2. Page 1 of 1	3. Emergency Response Phone NRCS 510 749-1390	4. Waste Tracking Number 42012-07
5. Generator's Name and Mailing Address DEPARTMENT OF TRANSPORTATION CALTRANS DISTRI 111 GRAND AVENUE FLOOR 14 OAKLAND CA 94623			Generator's Site Address (if different than mailing address) CALTRANS DISTRICT#4 LIVERMORE EAST BOUND HWY 580, BETWEEN N FIRST STREET, AND WASHINGTON CA		
Generator's Phone: 510 622-8750					
6. Transporter 1 Company Name Chapman Trucking			U.S. EPA ID Number		
7. Transporter 2 Company Name			U.S. EPA ID Number		
8. Designated Facility Name and Site Address Waste Management - Altamont 10840 Altamont Road Livermore CA 94560			U.S. EPA ID Number CAD981382732		
Facility's Phone: 925 455-7300					
9. Waste Shipping Name and Description		10. Containers		11. Total Quantity	12. Unit Wt./Vol.
		No.	Type		
1. NON HAZARDOUS WASTE SOILD (SOIL WITH HYDROCARBONS) (PROFILE# 102242CA)		001	DT	015	Y
2.					
3.					
4.					
13. Special Handling Instructions and Additional Information WEAR APPROPRIATE PERSONAL PROTECTIVE EQUIPMENT JOB#/PO#: 42012 CONSULTANT: GEOCON CONSULTANTS, INC. 6671 BRISA STREET, LIVERMORE, CA. NRCS 1605 FERRY POINT ALAMEDA, CA. 94501 Lic # 3V87198					
14. GENERATOR'S CERTIFICATION: I certify the materials described above on this manifest are not subject to federal regulations for reporting proper disposal of Hazardous Waste.					
Generator's/Offorer's Printed/Typed Name Chris Bledsae Cultran		Signature <i>Chris Bledsae</i>		Month 4	Day 9
				Year 9	
15. International Shipments <input type="checkbox"/> Import to U.S. <input type="checkbox"/> Export from U.S. Port of entry/exit: _____ Date leaving U.S.: _____					
16. Transporter Acknowledgment of Receipt of Materials					
Transporter 1 Printed/Typed Name MATT Chapman		Signature <i>Matt Chapman</i>		Month 4	Day 9
				Year 09	
Transporter 2 Printed/Typed Name		Signature		Month	Day
				Year	
17. Discrepancy					
17a. Discrepancy Indication Space <input type="checkbox"/> Quantity <input type="checkbox"/> Type <input type="checkbox"/> Residue <input type="checkbox"/> Partial Rejection <input type="checkbox"/> Full Rejection					
Manifest Reference Number: _____					
17b. Alternate Facility (or Generator)			U.S. EPA ID Number		
Facility's Phone: _____					
17c. Signature of Alternate Facility (or Generator)			Month Day Year		
18. Designated Facility Owner or Operator: Certification of receipt of materials covered by the manifest except as noted in Item 17a					
Printed/Typed Name John Schaertliew		Signature <i>John Schaertliew</i>		Month 4	Day 9
				Year 09	



WEIGHMASTER-Altamont Landfill & RRF
 10840 Altamont Pass Road
 Livermore, CA, 94551
 Ph: (925)455-7300

Original
 Ticket# 843241

Customer Name NrcEnvironment Nrc Environment Carrier GEN Altamont Generic
 Ticket Date 04/09/2009 Vehicle# 3v87198
 Payment Type Credit Account Container
 Manual Ticket# CHAPMAN TRUCKING 1WT
 Billing # 0030257 License#

Manifest 42012 07
 PO
 Profile 102242CA (Class II Cover "NRCE5" Caltrans Dist#4~102242CA)
 Generator 164-CaltransDistrict4Livermore Caltrans District 4 - Livermore

Time	Scale	Deputy Weighmaster	Inbound	Gross	66840 lb
In 04/09/2009 10:54:58	Scale 3 d P Ratio			Tare	31780 lb
Out 04/09/2009 10:54:58	P Ratio			Net	35060 lb
				Tons	17.53

Comments

Product	LD%	Qty	UOM	Rate	Tax	Amount	Origin
1 C2 Cover RBC-Tons-	100	17.53	Tons				Livermore
2 FUEL-Fuel Surcharg	100		%				Livermore
3 EvfB-Env Fee \$8 Lg	100	1	Load				Livermore

DRIVER: 

Weighmaster Certificate

THIS IS TO CERTIFY that the following described commodity was weighed, measured or counted by a weighmaster, whose signature is on this certificate, who is a recognized authority of accuracy, as prescribed by Chapter 7 (commencing with section 12700) of Division 5 of the California Business and Professions Code, administered by the Division of Measurement Standards of the California Department of Food and Agriculture.

Total Tax
 Total Ticket

NON-HAZARDOUS WASTE MANIFEST

1. Generator ID Number
CAS111111001

2. Page 1 of
1

3. Emergency Response Phone
NRCES 510 749-1390

4. Waste Tracking Number
42012-08

5. Generator's Name and Mailing Address
**DEPARTMENT OF TRANSPORTATION CALTRANS DISTRICT
111 GRAND AVENUE FLOOR 14
OAKLAND CA 94623**

ATT: JILL POLLOCK

Generator's Site Address (if different than mailing address)
**CALTRANS DISTRICT #4 LIVERMORE
EAST BOUND HWY 580, BETWEEN N FIRST STREET, AND
WEBB STREET
LIVERMORE CA**

Generator's Phone: **510 622-8750**

6. Transporter 1 Company Name
WESTCOAST CALTRANS PORT

U.S. EPA ID Number
CAR000171454

7. Transporter 2 Company Name

U.S. EPA ID Number

8. Designated Facility Name and Site Address
**Waste Management - Altamont
10840 Altamont Road
Livermore CA 94550**

U.S. EPA ID Number
CAD981382732

Facility's Phone: **925 455-7300**

9. Waste Shipping Name and Description	10. Containers		11. Total Quantity	12. Unit Wt./Vol.	
	No.	Type			
1. NON HAZARDOUS WASTE SOILD (SOIL WITH HYDROCARBONS) (PROFILE# 102242CA)	001	DT	015	Y	NONE
2.					
3.					
4.					

13. Special Handling Instructions and Additional Information
**WEAR APPROPRIATE PERSONAL PROTECTIVE EQUIPMENT JOB#/PO#: 42012
CONSULTANT: GEOCON CONSULTANTS, INC. 6671 BRISA STREET, LIVERMORE, CA.
NRCES 1605 FERRY POINT ALAMEDA, CA. 94501**

LIC#9D20421

14. GENERATOR'S CERTIFICATION: I certify the materials described above on this manifest are not subject to federal regulations for reporting proper disposal of Hazardous Waste.

Generator's/Officer's Printed/Typed Name: **Chris Blodson Caltrans** Signature: **Ch Blodson** Month: **4** Day: **9** Year: **9**

15. International Shipments Import to U.S. Export from U.S. Port of entry/exit: _____ Date leaving U.S.: _____

16. Transporter Acknowledgment of Receipt of Materials
Transporter 1 Printed/Typed Name: **BOB BUENO** Signature: **Bob Bueno** Month: **4** Day: **9** Year: **09**
Transporter 2 Printed/Typed Name: _____ Signature: _____ Month: _____ Day: _____ Year: _____

17. Discrepancy
17a. Discrepancy Indication Space Quantity Type Residue Partial Rejection Full Rejection

17b. Alternate Facility (or Generator) _____ U.S. EPA ID Number _____
Facility's Phone: _____

17c. Signature of Alternate Facility (or Generator) _____ Month: _____ Day: _____ Year: _____

18. Designated Facility Owner or Operator: Certification of receipt of materials covered by the manifest except as noted in Item 17a
Printed/Typed Name: **John Schaeffler** Signature: **John Schaeffler** Month: **4** Day: **09** Year: **09**

GENERATOR

INT'L

TRANSPORTER

DESIGNATED FACILITY



WEIGHMASTER-Altamont Landfill & RRF
 10040 Altamont Pass Road
 Livermore, CA, 94551
 Ph: (925)455-7300

Original
 Ticket# 843248

Customer Name NrcEnvironment Nrc Environment Carrier GEN Altamont Generic
 Ticket Date 04/09/2009 Vehicle# 9d20421
 Payment Type Credit Account Container
 Manual Ticket# WEST COAST WC21WT
 Billing # 0038257 License#

Manifest 42012 00
 PO
 Profile 102242CA (Class II Cover*NRCE5*Caltrans Dist#4*102242CA)
 Generator 164-CaltransDistrict4Livermore Caltrans District 4 - Livermore

Time	Scale	Deputy Weighmaster	Inbound	Gross	
In 04/09/2009 11:11:35	Scale 3 d	J Schaeuffler			62320 lb
Out 04/09/2009 11:11:35		J Schaeuffler		Tare	31700 lb
				Net	30620 lb
				Tons	15.31

Comments

Product	LD%	Qty	UOM	Rate	Tax	Amount	Origin
1 C2 Cover ROC-Tons-	100	15.31	Tons				Livermore
2 FUEL-Fuel Surcharg	100		%				Livermore
3 EvfB-Env Fee 18 Lg	100	1	Load				Livermore

DRIVER: 

Total Tax
 Total Ticket

Weighmaster Certificate

THIS IS TO CERTIFY that the following described commodity was weighed, measured or counted by a weighmaster, whose signature is on this certificate, who is a recognized authority of accuracy, as prescribed by Chapter 7 (commencing with section 12700) of Division 5 of the California Business and Professions Code, administered by the Division of Measurement Standards of the California Department of Food and Agriculture.



GENERATOR

INT'L

TRANSPORTER

DESIGNATED FACILITY

NON-HAZARDOUS WASTE MANIFEST 1. Generator ID Number CAS 111111001 2. Page 1 of 1 3. Emergency Response Phone NRCES 510 749-1390 4. Waste Tracking Number 42012-09

5. Generator's Name and Mailing Address DEPARTMENT OF TRANSPORTATION CALTRANS DISTRI 111 GRAND AVENUE FLOOR 14 OAKLAND CA 94623 AT: JILL POLLOCK
 Generator's Site Address (if different than mailing address) CALTRANS DISTRICT#4 LIVERMORE EAST BOUND HWY 580, BETWEEN N FIRST STREET, AND LIVERMORE CA

Generator's Phone: 510 622-8750 U.S. EPA ID Number

6. Transporter 1 Company Name C. JOAQUIN TRUCKING U.S. EPA ID Number

7. Transporter 2 Company Name U.S. EPA ID Number

8. Designated Facility Name and Site Address Waste Management - Altamont 10840 Altamont Road Livermore CA 94550 U.S. EPA ID Number
 Facility's Phone: 925 455-7300 CAD981382732

9. Waste Shipping Name and Description	10. Containers		11. Total Quantity	12. Unit Wt./Vol.	
	No.	Type			
1. NON HAZARDOUS WASTE SOILD (SOIL WITH HYDROCARBONS) (PROFILE# 102242CA)	001	DT	015	Y	NONE
2.					
3.					
4.					

13. Special Handling Instructions and Additional Information
 WEAR APPROPRIATE PERSONAL PROTECTIVE EQUIPMENT JOB#/PO#: 42012
 CONSULTANT: GEOCON CONSULTANTS, INC. 6671 BRISA STREET, LIVERMORE, CA.
 NRCES 1605 FERRY POINT ALAMEDA, CA. 94501

14. GENERATOR'S CERTIFICATION: I certify the materials described above on this manifest are not subject to federal regulations for reporting proper disposal of Hazardous Waste.

Generator's/Offor's Printed/Typed Name Chris Bledsoe Signature Ch Bledsoe Month 4 Day 9 Year 99

15. International Shipments Import to U.S. Export from U.S. Port of entry/exit: Date leaving U.S.:

16. Transporter Acknowledgment of Receipt of Materials

Transporter 1 Printed/Typed Name CHRIS JOAQUIN Signature Month 4 Day 9 Year 99
 Transporter 2 Printed/Typed Name Signature Month Day Year

17. Discrepancy 17a. Discrepancy Indication Space Quantity Type Residue Partial Rejection Full Rejection

Manifest Reference Number: U.S. EPA ID Number

17b. Alternate Facility (or Generator) Facility's Phone: U.S. EPA ID Number

17c. Signature of Alternate Facility (or Generator) Month Day Year

18. Designated Facility Owner or Operator: Certification of receipt of materials covered by the manifest except as noted in Item 17a

Printed/Typed Name Signature Month 4 Day 9 Year 99



WEIGHMASTER-Altamont Landfill & RRF
 10840 Altamont Pass Road
 Livermore, CA, 94551
 Ph: (925) 435-7300

Original
 Ticket# 843253

Customer Name NrcEnvironment Nrc Environment Carrier GEN Altamont Generic
 Ticket Date 04/09/2009 Vehicle# 9d99160
 Payment Type Credit Account Container
 Manual Ticket# C JOAQUIN 800UT
 Billing # 0038257 License#

Manifest -09
 PO
 Profile 102242CA (Class II Cover~NRCE5~Caltrans Dist#4~102242CA)
 Generator 164-CaltransDistrict4Livermore Caltrans District 4 - Livermore

Time	Scale	Deputy Weighmaster	Inbound	Gross	
In 04/09/2009 11:22:17	Scale 3 d P Ratto			64560 lb	
Out 04/09/2009 11:22:17	P. Ratto			Tare 31560 lb	
				Net 33000 lb	
				Tons 16.50	

Comments

Product	LD%	Qty	UDM	Rate	Tax	Amount	Origin
1 C2 Cover RBC-Tons- 100		16.50	Tons				Livermore
2 FUEL-Fuel Surcharg 100			%				Livermore
3 Evf8-Env Fee \$8 Lg 100		1	Load				Livermore

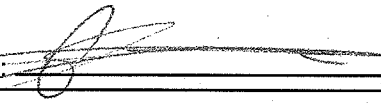
DRIVER: 

Total Tax
 Total Ticket

Weighmaster Certificate

THIS IS TO CERTIFY that the following described commodity was weighed, measured or counted by a weighmaster, whose signature is on this certificate, who is a recognized authority of accuracy, as prescribed by Chapter 7 (commencing with section 12700) of Division 5 of the California Business and Professions Code, administered by the Division of Measurement Standards of the California Department of Food and Agriculture.



NON-HAZARDOUS WASTE MANIFEST	1. Generator ID Number CAS111111001	2. Page 1 of 1	3. Emergency Response Phone NRCS 510 749-1390	4. Waste Tracking Number 42012-00
5. Generator's Name and Mailing Address DEPARTMENT OF TRANSPORTATION CALTRANS DISTRI 111 GRAND AVENUE FLOOR 14 OAKLAND CA 94623		Generator's Site Address (if different than mailing address) Att: JILL POLLOCK CALTRANS DISTRICT #4 LIVERMORE EAST BOUND HWY 580, BETWEEN N FIRST STREET, AND LIVERMORE CA		
6. Transporter 1 Company Name Chapman Trucking		U.S. EPA ID Number		
7. Transporter 2 Company Name		U.S. EPA ID Number		
8. Designated Facility Name and Site Address Waste Management - Altamont 10840 Altamont Road Livermore CA 94550		U.S. EPA ID Number CAD981382732		
9. Waste Shipping Name and Description		10. Containers		11. Total Quantity
		No.	Type	12. Unit Wt./Vol.
1. NON HAZARDOUS WASTE SOILD (SOIL WITH HYDROCARBONS) (PROFILE# 102242CA)		001	DT	015 Y
2.				
3.				
4.				
13. Special Handling Instructions and Additional Information WEAR APPROPRIATE PERSONAL PROTECTIVE EQUIPMENT JOB#/PO#: 42012 CONSULTANT: GEOCON CONSULTANTS, INC. 6671 BRISA STREET, LIVERMORE, CA. NRCS 1605 FERRY POINT ALAMEDA, CA. 94501 Lic # 3V87198				
14. GENERATOR'S CERTIFICATION: I certify the materials described above on this manifest are not subject to federal regulations for reporting proper disposal of Hazardous Waste.				
Generator's/Officer's Printed/Typed Name Chris Bledsoe		Signature Ch Bledsoe		Month Day Year 4 9 9
15. International Shipments <input type="checkbox"/> Import to U.S. <input type="checkbox"/> Export from U.S. Port of entry/exit: _____ Date leaving U.S.: _____				
16. Transporter Acknowledgment of Receipt of Materials				
Transporter 1 Printed/Typed Name Matt Chapman		Signature Matt Ch		Month Day Year 4 9 09
Transporter 2 Printed/Typed Name		Signature		Month Day Year
17. Discrepancy				
17a. Discrepancy Indication Space <input type="checkbox"/> Quantity <input type="checkbox"/> Type <input type="checkbox"/> Residue <input type="checkbox"/> Partial Rejection <input type="checkbox"/> Full Rejection				
Manifest Reference Number: _____				
17b. Alternate Facility (or Generator)				U.S. EPA ID Number
Facility's Phone: _____				
17c. Signature of Alternate Facility (or Generator)				Month Day Year
18. Designated Facility Owner or Operator: Certification of receipt of materials covered by the manifest except as noted in Item 17a				
Printed/Typed Name		Signature [Signature]		Month Day Year 4 9 09



WEIGHMASTER-Altamont Landfill & RDF
 10040 Altamont Pass Road
 Livermore, CA, 94551
 Ph: (925)455-7300

Original
 Ticket# 043295

Customer Name NrcEnvironment Nrc Environment Carrier GEN Altamont Generic
 Ticket Date 04/09/2009 Vehicle# 3v87198
 Payment Type Credit Account Container
 Manual Ticket# CHAPMAN TRUCKING 1WT
 Billing # 0038257 License#

Manifest 10
 PO
 Profile 102242CA (Class II Cover*NRCE5*Caltrans Dist#4*102242CA)
 Generator 164-CaltransDistrict4Livermore Caltrans District 4 - Livermore

Time	Scale	Deputy Weighmaster	Inbound	Gross	
In 04/09/2009 12:22:52	Scale 3 d P Ratio			58700 lb	
Out 04/09/2009 12:22:52	P Ratio			Tare 31780 lb	
				Net 26920 lb	
				Tons 13.46	

Comments

Product	LD%	Qty	UDM	Rate	Tax	Amount	Origin
1 C2 Cover RGC-Tons-	100	13.46	Tons				Livermore
2 FUEL-Fuel Surcharg	100		%				Livermore
3 Evf8-Env Fee \$8 Lg	100	1	Load				Livermore

DRIVER: 

Weighmaster Certificate

Total Tax
 Total Ticket

THIS IS TO CERTIFY that the following described commodity was weighed, measured or counted by a weighmaster, whose signature is on this certificate, who is a recognized authority of accuracy, as prescribed by Chapter 7 (commencing with section 12700) of Division 5 of the California Business and Professions Code, administered by the Division of Measurement Standards of the California Department of Food and Agriculture.



NON-HAZARDOUS WASTE MANIFEST 1. Generator ID Number CAS 111111001 2. Page 1 of 1 3. Emergency Response Phone NRCES 510 749-1390 4. Waste Tracking Number 42017-11

5. Generator's Name and Mailing Address: DEPARTMENT OF TRANSPORTATION CALTRANS DISTRICT #4, 111 GRAND AVENUE FLOOR 14, OAKLAND CA 94623. At: JILL POLLOCK. Generator's Site Address (if different than mailing address): CALTRANS DISTRICT #4 LIVERMORE, EAST BOUND HWY 580, BETWEEN N FIRST STREET, AND WASHINGTON ST, LIVERMORE CA.

Generator's Phone: 510 622-8750

6. Transporter 1 Company Name: WESTCOAST TRANSPORT. U.S. EPA ID Number: CAR000171454

7. Transporter 2 Company Name: [Blank]. U.S. EPA ID Number: [Blank]

8. Designated Facility Name and Site Address: Waste Management - Altamont, 10840 Altamont Road, Livermore CA 94550. U.S. EPA ID Number: CAD981382732. Facility's Phone: 925 455-7300

9. Waste Shipping Name and Description	10. Containers		11. Total Quantity	12. Unit Wt./Vol.	13. Additional Information
	No.	Type			
1. NON HAZARDOUS WASTE SOILD (SOIL WITH HYDROCARBONS) (PROFILE# 102242CA)	001	DT	015	Y	NONE
2.					
3.					
4.					

13. Special Handling Instructions and Additional Information: WEAR APPROPRIATE PERSONAL PROTECTIVE EQUIPMENT. JOB#/PO#: 42012. CONSULTANT: GEOCON CONSULTANTS, INC. 6671 BRISA STREET, LIVERMORE, CA. NRCES 1605 FERRY POINT ALAMEDA, CA. 94501. LIC# 9D20421

14. GENERATOR'S CERTIFICATION: I certify the materials described above on this manifest are not subject to federal regulations for reporting proper disposal of Hazardous Waste.

Generator's/Officer's Printed/Typed Name: Chris Bledsoe Caltrans. Signature: [Signature]. Month: 4, Day: 9, Year: 99

15. International Shipments: Import to U.S. Export from U.S. Port of entry/exit: [Blank]. Date leaving U.S.: [Blank]

16. Transporter Acknowledgment of Receipt of Materials. Transporter 1 Printed/Typed Name: BOB SUENO. Signature: [Signature]. Month: 4, Day: 9, Year: 08. Transporter 2 Printed/Typed Name: [Blank]. Signature: [Blank]. Month: [Blank], Day: [Blank], Year: [Blank]

17. Discrepancy. 17a. Discrepancy Indication Space: Quantity Type Residue Partial Rejection Full Rejection. Manifest Reference Number: [Blank]

17b. Alternate Facility (or Generator): [Blank]. U.S. EPA ID Number: [Blank]. Facility's Phone: [Blank]

17c. Signature of Alternate Facility (or Generator): [Blank]. Month: [Blank], Day: [Blank], Year: [Blank]

18. Designated Facility Owner or Operator. Certification of receipt of materials covered by the manifest except as noted in Item 17a. Printed/Typed Name: John Schaeffler. Signature: [Signature]. Month: 4, Day: 9, Year: 09



WEIGHMASTER-Altamont Landfill & RRF
 10840 Altamont Pass Road
 Livermore, CA, 94551
 Ph: (925)455-7300

Original
 Ticket# 843296

Customer Name NrcEnvironment Nrc Environment Carrier GEN Altamont Generic
 Ticket Date 04/09/2009 Vehicle# 9d20421
 Payment Type Credit Account Container
 Manual Ticket# WEST COAST WC21WT
 Billing # 0038257 License#

Manifest 42012 11
 PO
 Profile 102242CA (Class II Cover~NRCES~Caltrans Dist#4~102242CA)
 Generator 164-CaltransDistrict4Livermore Caltrans District 4 - Livermore

Time	Scale	Deputy Weighmaster	Inbound	Gross	60660 lb
In 04/09/2009 12:35:53	Scale1 In	J Schaeuffler		Tare	31700 lb
Out 04/09/2009 12:35:53		J Schaeuffler		Net	28960 lb
				Tons	14.48

Comments

Product	LD%	Qty	UOM	Rate	Tax	Amount	Origin
1 C2 Cover RGC-Tons- 100		14.48	Tons				Livermore
2 FUEL-Fuel Surcharg 100			%				Livermore
3 Evf8-Env Fee \$8 Lg 100		1	Load				Livermore

DRIVER:

Weighmaster Certificate

THIS IS TO CERTIFY that the following described commodity was weighed, measured or counted by a weighmaster, whose signature is on this certificate, who is a recognized authority of accuracy, as prescribed by Chapter 7 (commencing with section 12700) of Division 5 of the California Business and Professions Code, administered by the Division of Measurement Standards of the California Department of Food and Agriculture.



NON-HAZARDOUS WASTE MANIFEST	1. Generator ID Number CAS111111001	2. Page 1 of 1	3. Emergency Response Phone NRCS 510 749-1390	4. Waste Tracking Number 42012-12	
5. Generator's Name and Mailing Address DEPARTMENT OF TRANSPORTATION CALTRANS DISTRICT #4 LIVERMORE 111 GRAND AVENUE FLOOR 14 OAKLAND CA 94623		Generator's Site Address (if different than mailing address) CALTRANS DISTRICT #4 LIVERMORE EAST BOUND HWY 580, BETWEEN N FIRST STREET, AND LAWSON BLVD CA			
Generator's Phone: 510 622-8750					
6. Transporter 1 Company Name C. JOAQUIN TRUCKING			U.S. EPA ID Number		
7. Transporter 2 Company Name			U.S. EPA ID Number		
8. Designated Facility Name and Site Address Waste Management - Altamont 10840 Altamont Road Livermore CA 94550			U.S. EPA ID Number CAD981382732		
Facility's Phone: 925 455-7300					
9. Waste Shipping Name and Description	10. Containers		11. Total Quantity	12. Unit Wt./Vol.	NONE
	No.	Type			
1. NON HAZARDOUS WASTE SOILD (SOIL WITH HYDROCARBONS) (PROFILE# 102242CA)	001	DT	015	Y	
2.					
3.					
4.					
13. Special Handling Instructions and Additional Information WEAR APPROPRIATE PERSONAL PROTECTIVE EQUIPMENT JOB#/PO#: 42012 CONSULTANT: GEOCON CONSULTANTS, INC. 6671 BRISA STREET, LIVERMORE, CA. NRCS 1605 FERRY POINT ALAMEDA, CA. 94501					
14. GENERATOR'S CERTIFICATION: I certify the materials described above on this manifest are not subject to federal regulations for reporting proper disposal of Hazardous Waste.					
Generator's/Offor's Printed/Typed Name Chris Bledsoe			Signature <i>Chris Bledsoe</i>		Month Day Year 4 9 9
15. International Shipments <input type="checkbox"/> Import to U.S. <input type="checkbox"/> Export from U.S. Port of entry/exit: _____ Date leaving U.S.: _____					
16. Transporter Acknowledgment of Receipt of Materials					
Transporter 1 Printed/Typed Name CHRIS JOAQUIN			Signature <i>Chris Joaquin</i>		Month Day Year 4 9 9
Transporter 2 Printed/Typed Name			Signature		Month Day Year
17. Discrepancy					
17a. Discrepancy Indication Space <input type="checkbox"/> Quantity <input type="checkbox"/> Type <input type="checkbox"/> Residue <input type="checkbox"/> Partial Rejection <input type="checkbox"/> Full Rejection					
Manifest Reference Number: _____					
17b. Alternate Facility (or Generator)			U.S. EPA ID Number		
Facility's Phone: _____					
17c. Signature of Alternate Facility (or Generator)					Month Day Year
18. Designated Facility Owner or Operator: Certification of receipt of materials covered by the manifest except as noted in Item 17a					
Printed/Typed Name			Signature <i>[Signature]</i>		Month Day Year 4 9 09

GENERATOR

INT'L

TRANSPORTER

DESIGNATED FACILITY



WEIGHMASTER-Altamont Landfill & RRF
 10040 Altamont Pass Road
 Livermore, CA, 94551
 Ph: (925)455-7300

Original
 Ticket# 843301

Customer Name NrcEnvironment Nrc Environment Carrier GEN Altamont Generic
 Ticket Date 04/09/2009 Vehicle# 9d99160
 Payment Type Credit Account Container
 Manual Ticket# C JOAQUIN 803WT
 Billing # 0038257 License#

Manifest 12
 PO
 Profile 102242CA (Class II Cover*NRCES*Caltrans Dist#4*102242CA)
 Generator 164-CaltransDistrict4Livermore Caltrans District 4 - Livermore

Time	Scale	Deputy Weighmaster	Inbound	Gross	
In 04/09/2009 12:55:45	Scale 3 d P Ratio				65140 lb
Out 04/09/2009 12:55:45	P Ratio			Tare	31560 lb
				Net	33580 lb
				Tons	16.79

Comments

Product	LD%	Qty	UOM	Rate	Tax	Amount	Origin
1 C2 Cover RGC-Tons-	100	16.79	Tons				Livermore
2 FUEL-Fuel Surcharg	100		%				Livermore
3 Evf8-Env Fee 48 Lg	100	1	Load				Livermore

DRIVER: 

Weighmaster Certificate

Total Tax
 Total Ticket

THIS IS TO CERTIFY that the following described commodity was weighed, measured or counted by a weighmaster, whose signature is on this certificate, who is a recognized authority of accuracy, as prescribed by Chapter 7 (commencing with section 12700) of Division 5 of the California Business and Professions Code, administered by the Division of Measurement Standards of the California Department of Food and Agriculture.



GENERATOR

NON-HAZARDOUS WASTE MANIFEST

1. Generator ID Number

CAS111111001

2. Page 1 of 1

3. Emergency Response Phone

NRCS 510 749-1390

4. Waste Tracking Number

42012-13

5. Generator's Name and Mailing Address

DEPARTMENT OF TRANSPORTATION CALTRANS DISTRICT
111 GRAND AVENUE FLOOR 14
OAKLAND CA 94623

At: JILL POLLOCK

Generator's Site Address (if different than mailing address)

CALTRANS DISTRICT#4 LIVERMORE
EAST BOUND HWY 580, BETWEEN N FIRST STREET, AND
LIVERMORE CA

Generator's Phone: 510 622-8750

6. Transporter 1 Company Name

Chapman Trucking

U.S. EPA ID Number

7. Transporter 2 Company Name

U.S. EPA ID Number

8. Designated Facility Name and Site Address

Waste Management - Altamont
10840 Altamont Road
Livermore CA 94550

U.S. EPA ID Number

Facility's Phone: 925 455-7300

CAD981382732

9. Waste Shipping Name and Description

1. NON HAZARDOUS WASTE SOILD (SOIL WITH HYDROCARBONS) (PROFILE# 102242CA)

10. Containers

No.

Type

11. Total Quantity

12. Unit Wt./Vol.

001

DT

016

Y

NONE

13. Special Handling Instructions and Additional Information

WEAR APPROPRIATE PERSONAL PROTECTIVE EQUIPMENT JOB#/PO#: 42012
CONSULTANT: GEOCON CONSULTANTS, INC. 6671 BRISA STREET, LIVERMORE, CA.
NRCS 1605 FERRY POINT ALAMEDA, CA. 94501

Lic # 3V87198

14. GENERATOR'S CERTIFICATION: I certify the materials described above on this manifest are not subject to federal regulations for reporting proper disposal of Hazardous Waste.

Generator's/Officer's Printed/Typed Name

Chris Bledsoe Caltrans

Signature

Chris Bledsoe

Month Day Year

4 9 9

INT'L

15. International Shipments

Import to U.S.

Export from U.S.

Port of entry/exit:

Transporter Signature (for exports only):

Date leaving U.S.:

TRANSPORTER

16. Transporter Acknowledgment of Receipt of Materials

Transporter 1 Printed/Typed Name

Matt Chapman

Signature

Matt Chapman

Month Day Year

4 9 09

Transporter 2 Printed/Typed Name

Signature

Month Day Year

DESIGNATED FACILITY

17. Discrepancy

17a. Discrepancy Indication Space

Quantity

Type

Residue

Partial Rejection

Full Rejection

Manifest Reference Number:

17b. Alternate Facility (or Generator)

U.S. EPA ID Number

Facility's Phone:

17c. Signature of Alternate Facility (or Generator)

Month Day Year

18. Designated Facility Owner or Operator: Certification of receipt of materials covered by the manifest except as noted in Item 17a

Printed/Typed Name

Rm

Signature

Rm

Month Day Year

4 9 9



WEIGHMASTER-Altamont Landfill & RRF
 10040 Altamont Pass Road
 Livermore, CA, 94551
 Ph: (925)455-7300

Original
 Ticket# 843310

Customer Name NrcEnvironment Nrc Environment Carrier GEN Altamont Generic
 Ticket Date 04/09/2009 Vehicle# 3v87198
 Payment Type Credit Account Container
 Manual Ticket# CHAPMAN TRUCKING INT
 Billing # 0038257 License#

Manifest 01213
 PO
 Profile 102242CA (Class II Cover*NRCES*Caltrans Dist#4*102242CA)
 Generator 164-CaltransDistrict4Livermore Caltrans District 4 - Livermore

Time	Scale	Deputy Weighmaster	Inbound	Gross	
In 04/09/2009 13:30:20	Scale 3 d R Montoya			61980 lb	
Out 04/09/2009 13:30:20	R Montoya			Tare 31780 lb	
				Net 30200 lb	
				Tons 15.10	

Comments

Product	LD%	Qty	UCM	Rate	Tax	Amount	Origin
1 C2 Cover RBC-Tons- 100		15.10	Tons				Livermore
2 FUEL-Fuel Surcharg 100			%				Livermore
3 EvfB-Env Fee \$B Lg 100		1	Load				Livermore

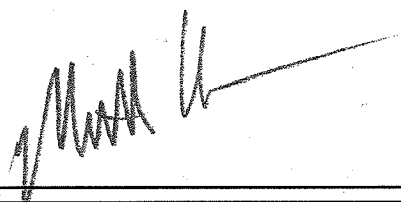
DRIVER: 

Weighmaster Certificate

Total Tax
 Total Ticket

THIS IS TO CERTIFY that the following described commodity was weighed, measured or counted by a weighmaster, whose signature is on this certificate, who is a recognized authority of accuracy, as prescribed by Chapter 7 (commencing with section 12700) of Division 5 of the California Business and Professions Code, administered by the Division of Measurement Standards of the California Department of Food and Agriculture.



NON-HAZARDOUS WASTE MANIFEST 1. Generator ID Number CAS111111001 2. Page 1 of 1 3. Emergency Response Phone NRCES 610 749-1390 4. Waste Tracking Number 42012-14

5. Generator's Name and Mailing Address DEPARTMENT OF TRANSPORTATION CALTRANS DISTRICT 111 GRAND AVENUE FLOOR 14 OAKLAND CA 94623 AT: JILL POLLOCK
 Generator's Site Address (if different than mailing address) CALTRANS DISTRICT #4 LIVERMORE EAST BOUND HWY 580, BETWEEN N FIRST STREET, AND LIVERMORE CA

Generator's Phone: 510 622-8750
 6. Transporter 1 Company Name WEST COAST TRANSPORT U.S. EPA ID Number CAR00011439

7. Transporter 2 Company Name U.S. EPA ID Number

8. Designated Facility Name and Site Address Waste Management - Altamont 10840 Altamont Road Livermore CA 94550 U.S. EPA ID Number CAD981382732
 Facility's Phone: 925 455-7300

9. Waste Shipping Name and Description	10. Containers		11. Total Quantity	12. Unit Wt./Vol.	
	No.	Type			
1. NON HAZARDOUS WASTE SOILD (SOIL WITH HYDROCARBONS) (PROFILE# 102242CA)	001	DT	015	Y	NONE
2.					
3.					
4.					

13. Special Handling Instructions and Additional Information
 WEAR APPROPRIATE PERSONAL PROTECTIVE EQUIPMENT JOB#/PO#: 42012
 CONSULTANT: GEOCON CONSULTANTS, INC. 6671 BRISA STREET, LIVERMORE, CA.
 NRCES 1605 FERRY POINT ALAMEDA, CA. 94501
 Lic# 9D20421

14. GENERATOR'S CERTIFICATION: I certify the materials described above on this manifest are not subject to federal regulations for reporting proper disposal of Hazardous Waste.

Generator's/Officer's Printed/Typed Name Chris Bledsoe Caltrans Signature ch Bledsoe Month 4 Day 9 Year 9

15. International Shipments Import to U.S. Export from U.S. Port of entry/exit: Date leaving U.S.:

16. Transporter Acknowledgment of Receipt of Materials

Transporter 1 Printed/Typed Name BOB BUENO Signature Bob Bueno Month 4 Day 9 Year 09
 Transporter 2 Printed/Typed Name Signature Month Day Year

17. Discrepancy
 17a. Discrepancy Indication Space Quantity Type Residue Partial Rejection Full Rejection
 Manifest Reference Number:

17b. Alternate Facility (or Generator) U.S. EPA ID Number
 Facility's Phone:

17c. Signature of Alternate Facility (or Generator) Month Day Year

18. Designated Facility Owner or Operator: Certification of receipt of materials covered by the manifest except as noted in Item 17a

Printed/Typed Name Signature Month Day Year
 Rm Rm 4 9 9

GENERATOR

INT'L

TRANSPORTER

DESIGNATED FACILITY



WEIGHMASTER-Altamont Landfill & RRF
 10040 Altamont Pass Road
 Livermore, CA, 94551
 Ph: (925)455-7300

Original
 Ticket# 843312

Customer Name NrcEnvironment Nrc Environment Carrier GEN Altamont Generic
 Ticket Date 04/09/2009 Vehicle# 9420421
 Payment Type Credit Account Container
 Manual Ticket# WEST COAST WC21WT
 Billing # 0038257 License#

Manifest 01214
 PO
 Profile 102242CA (Class II Cover~NRCES~Caltrans Dist#4~102242CA)
 Generator 164-CaltransDistrict4Livermore Caltrans District 4 - Livermore

Time	Scale	Deputy Weighmaster	Inbound	Gross	60260 lb
In 04/09/2009 13:52:41	Scale 3 d	R Montoya		Tare	31700 lb
Out 04/09/2009 13:52:41		R Montoya		Net	28560 lb
				Tons	14.28

Comments

Product	LD%	Qty	UOM	Rate	Tax	Amount	Origin
1 C2 Cover R6C-Tons-	100	14.28	Tons				Livermore
2 FUEL-Fuel Surcharg	100		%				Livermore
3 Evf0-Env Fee \$8 Lg	100	1	Load				Livermore

DRIVER: 

Weighmaster Certificate

THIS IS TO CERTIFY that the following described commodity was weighed, measured or counted by a weighmaster, whose signature is on this certificate, who is a recognized authority of accuracy, as prescribed by Chapter 7 (commencing with section 12700) of Division 5 of the California Business and Professions Code, administered by the Division of Measurement Standards of the California Department of Food and Agriculture.



NON-HAZARDOUS WASTE MANIFEST

1. Generator ID Number
CAS11111001

2. Page 1 of **1**

3. Emergency Response Phone
NRCES 510 749-1390

4. Waste Tracking Number
42012-15

5. Generator's Name and Mailing Address: **ATT: JILL POLLOCK**

Generator's Site Address (if different than mailing address):
**CALTRANS DISTRICT #4 LIVERMORE
EAST BOUND HWY 680, BETWEEN N FIRST STREET, AND
WYSONG RD CA**

**DEPARTMENT OF TRANSPORTATION CALTRANS DISTRI
111 GRAND AVENUE FLOOR 14
OAKLAND CA 94623**

Generator's Phone: **510 622-8750**

6. Transporter 1 Company Name
C. JOAQUIN TRUCKING

U.S. EPA ID Number

7. Transporter 2 Company Name

U.S. EPA ID Number

8. Designated Facility Name and Site Address
**Waste Management - Altamont
10840 Altamont Road
Livermore CA 94550**

U.S. EPA ID Number

Facility's Phone: **925 455-7300**

CAD981382732

9. Waste Shipping Name and Description

10. Containers

11. Total Quantity

12. Unit Wt./Vol.

No.

Type

NONE

1. **NON HAZARDOUS WASTE SOILD (SOIL WITH HYDROCARBONS) (PROFILE# 102242CA)**

001

DT

015

Y

2.

3.

4.

13. Special Handling Instructions and Additional Information

**WEAR APPROPRIATE PERSONAL PROTECTIVE EQUIPMENT JOB#/PO#: 42012
CONSULTANT: GEOCON CONSULTANTS, INC. 6671 BRISA STREET, LIVERMORE, CA.
NRCES 1605 FERRY POINT ALAMEDA, CA. 94501**

14. GENERATOR'S CERTIFICATION: I certify the materials described above on this manifest are not subject to federal regulations for reporting proper disposal of Hazardous Waste.

Generator's/Owner's Printed/Typed Name

Signature

Month Day Year

Chris Bledsoe Caltrans

ch Bledsoe

4 9 9

15. International Shipments Import to U.S. Export from U.S.

Port of entry/exit:

Transporter Signature (for exports only):

Date leaving U.S.:

16. Transporter Acknowledgment of Receipt of Materials

Transporter 1 Printed/Typed Name

Signature

Month Day Year

CHRIS JOAQUIN

[Signature]

4 9 09

Transporter 2 Printed/Typed Name

Signature

Month Day Year

17. Discrepancy

17a. Discrepancy Indication Space

Quantity

Type

Residue

Partial Rejection

Full Rejection

Manifest Reference Number:

17b. Alternate Facility (or Generator)

U.S. EPA ID Number

Facility's Phone:

17c. Signature of Alternate Facility (or Generator)

Month Day Year

18. Designated Facility Owner or Operator: Certification of receipt of materials covered by the manifest except as noted in Item 17a

Printed/Typed Name

Signature

Month Day Year

John Schaeffler

[Signature]

4 9 09



WEIGHMASTER-Altamont Landfill & RRF
 10040 Altamont Pass Road
 Livermore, CA, 94551
 Ph: (925) 455-7300

Original
 Ticket# 843324

Customer Name NrcEnvironment Nrc Environment Carrier GEN Altamont Generic
 Ticket Date 04/09/2009 Vehicle# 9d99160
 Payment Type Credit Account Container
 Manual Ticket# C JODQUIN B03WT
 Billing # 0038257 License#

Manifest 42012 15
 PO
 Profile 102242DA (Class II Cover~NRCE5~Caltrans Dist#4~102242DA)
 Generator 164-CaltransDistrict4Livermore Caltrans District 4 - Livermore

Time	Scale	Deputy Weighmaster	Inbound	Gross	
In 04/09/2009 14:20:37	Scale 3 d	J Schaeuffler		60500 lb	
Out 04/09/2009 14:20:37		J Schaeuffler		31560 lb	
				Net	28940 lb
				Tons	14.47

Comments

Product	LD%	Qty	UOM	Rate	Tax	Amount	Origin
1 C2 Cover R6C-Tons-	100	14.47	Tons				Livermore
2 FUEL-Fuel Surcharg	100		%				Livermore
3 Evf8-Env Fee \$8 Lg	100	1	Load				Livermore

DRIVER: 

Weighmaster Certificate

Total Tax
 Total Ticket: 

THIS IS TO CERTIFY that the following described commodity was weighed, measured or counted by a weighmaster, whose signature is on this certificate, who is a recognized authority of accuracy, as prescribed by Chapter 7 (commencing with section 12700) of Division 5 of the California Business and Professions Code, administered by the Division of Measurement Standards of the California Department of Food and Agriculture.

**NON-HAZARDOUS
WASTE MANIFEST**

1. Generator ID Number
CAS111111001

2. Page 1 of
1

3. Emergency Response Phone
NRCES 510 749-1390

4. Waste Tracking Number
42012-16

5. Generator's Name and Mailing Address
**DEPARTMENT OF TRANSPORTATION CALTRANS DISTRICT #4
111 GRAND AVENUE FLOOR 14
OAKLAND CA 94623**

Generator's Site Address (if different than mailing address)
**CALTRANS DISTRICT #4 LIVERMORE
EAST BOUND HWY 680, BETWEEN N FIRST STREET, AND
LIVERMORE CA**

Generator's Phone: **510 622-8750**

6. Transporter 1 Company Name
Chapman Trucking

U.S. EPA ID Number

7. Transporter 2 Company Name

U.S. EPA ID Number

8. Designated Facility Name and Site Address
**Waste Management - Altamont
10840 Altamont Road
Livermore CA 94550**

U.S. EPA ID Number

Facility's Phone: **925 455-7300**

CAD981382732

9. Waste Shipping Name and Description	10. Containers		11. Total Quantity	12. Unit Wt./Vol.	
	No.	Type			
1. NON HAZARDOUS WASTE SOILD (SOIL WITH HYDROCARBONS) (PROFILE# 102242CA)	001	DT	015	Y	NONE
2.					
3.					
4.					

13. Special Handling Instructions and Additional Information
**WEAR APPROPRIATE PERSONAL PROTECTIVE EQUIPMENT JOB#/PO#: 42012
CONSULTANT: GEOCON CONSULTANTS, INC. 6671 BRISA STREET, LIVERMORE, CA.
NRCES 1605 FERRY POINT ALAMEDA, CA. 94501**

Lic # 3V87198

14. GENERATOR'S CERTIFICATION: I certify the materials described above on this manifest are not subject to federal regulations for reporting proper disposal of Hazardous Waste.

Generator's/Offoror's Printed/Typed Name: **Chris Bledson Caltrans** Signature: **Chris Bledson** Month: **4** Day: **9** Year: **9**

15. International Shipments Import to U.S. Export from U.S. Port of entry/exit: _____ Date leaving U.S.: _____

16. Transporter Acknowledgment of Receipt of Materials
Transporter 1 Printed/Typed Name: **Matt Chapman** Signature: **Matt Chapman** Month: **4** Day: **9** Year: **9**
Transporter 2 Printed/Typed Name: _____ Signature: _____ Month: _____ Day: _____ Year: _____

17. Discrepancy
17a. Discrepancy Indication Space Quantity Type Residue Partial Rejection Full Rejection

Manifest Reference Number: _____

17b. Alternate Facility (or Generator) U.S. EPA ID Number

Facility's Phone: _____

17c. Signature of Alternate Facility (or Generator) Month: _____ Day: _____ Year: _____

18. Designated Facility Owner or Operator: Certification of receipt of materials covered by the manifest except as noted in Item 17a

Printed/Typed Name: **Rm** Signature: **Rm** Month: **4** Day: **9** Year: **9**



WEIGHMASTER-Altamont Landfill & RRF
 10840 Altamont Paze Road
 Livermore, CA, 94551
 Ph: (925) 455-7300

Original
 Ticket# 043340

Customer Name NrcEnvironment Nrc Environment Carrier GEN Altamont Generic
 Ticket Date 04/09/2009 Vehicle# 3v87198
 Payment Type Credit Account Container
 Manual Ticket# CHAPMAN TRUCKING 1WT
 Billing # 0038257 License#

Manifest 01216
 PO
 Profile 102242CA (Class II Cover*NRCE8*Caltrans Dist#4*102242CA)
 Generator 164-CaltransDistrict4Livermore Caltrans District 4 - Livermore

Time	Scale	Deputy Weighmaster	Inbound	Gross	79200 lb
In 04/09/2009 15:30:53	Scale 3 d R Montoya			Tare	31700 lb
Out 04/09/2009 15:30:53		R Montoya		Net	47420 lb
				Tons	23.71

Comments

Product	LDX	Qty	UDM	Rate	Tax	Amount	Origin
1 C2 Cover RRC-Tons-	100	23.71	Tons				Livermore
2 FUEL-Fuel Surcharg	100		%				Livermore
3 EvfB-Env Fee \$8 Lg	100	1	Load				Livermore

DRIVER: _____

Weighmaster Certificate

Total Tax
 Total Ticket

THIS IS TO CERTIFY that the following described commodity was weighed, measured or counted by a weighmaster, whose signature is on this certificate, who is a recognized authority of accuracy, as prescribed by Chapter 7 (commencing with section 12700) of Division 5 of the California Business and Professions Code, administered by the Division of Measurement Standards of the California Department of Food and Agriculture.



APPENDIX



D



McC Campbell Analytical, Inc.

"When Quality Counts"

1534 Willow Pass Road, Pittsburg, CA 94565-1701
Web: www.mcccampbell.com E-mail: main@mcccampbell.com
Telephone: 877-252-9262 Fax: 925-252-9269

GEOCON Env. Consultants 6671 Brisa St Livermore, CA 94550	Client Project ID: #E8415-06-62; Caltrans 580 @ Vasco	Date Sampled: 04/04/09
	Client Contact: John Love	Date Received: 04/06/09
	Client P.O.:	Date Reported: 04/07/09
		Date Completed: 04/07/09

WorkOrder: 0904121

April 07, 2009

Dear John:

Enclosed within are:

- 1) The results of the **8** analyzed samples from your project: **#E8415-06-62; Caltrans 580 @ Vasco**
- 2) A QC report for the above samples,
- 3) A copy of the chain of custody, and
- 4) An invoice for analytical services.

All analyses were completed satisfactorily and all QC samples were found to be within our control limits.

If you have any questions or concerns, please feel free to give me a call. Thank you for choosing

McC Campbell Analytical Laboratories for your analytical needs.

Best regards,

Angela Rydelius
Laboratory Manager
McC Campbell Analytical, Inc.

0904121



McCAMPBELL ANALYTICAL, INC.
 1534 WILLOW PASS ROAD
 PITTSBURG, CA 94565-1701
 Website: www.mccampbell.com Email: main@mccampbell.com
 Telephone: (877) 252-9262 Fax: (925) 252-9269

CHAIN OF CUSTODY RECORD
 TURN AROUND TIME RUSH 24 HR 48 HR 72 HR 5 DAY
 GeoTracker EDF PDF Excel Write On (DW)
 Check if sample is effluent and "J" flag is required

Report To: JOAN LOVE, CHRIS MERRITT Bill To: _____
 Company: GEACON
6671 BRISA ST E-Mail: MERRITT@GEACONINC.COM
LIVERMORE, CA 94550 LOVE@GEACONINC.COM
 Tele: (925) 371-5400 Fax: (925) 371-5415
 Project #: E-6415-06-62 Project Name: CAITRANS 550 @ JASCO
 Project Location: 540 EB @ JASCO RD
 Sampler Signature: CHRIS MERRITT / JOAN LOVE

SAMPLE ID	LOCATION/ Field Point Name	SAMPLING		# Containers	Type Containers	MATRIX					METHOD PRESERVED				Analysis Request	Other	Comments	
		Date	Time			Water	Soil	Air	Sludge	Other	ICE (Cl ₂)	HCL	HNO ₃	Other				
EXCAVATION NORTH 19'		4/4/09	1040	1	SSL	X					X							Filter Samples for Metals analysis: Yes / No
EXCAVATION EASTWALL 19'			1045	1							X							
EXCAVATION BOTTOM WEST 30'			1035	1							X							
EXCAVATION WEST 19'			1015	1							X							
EXCAVATION SOUTH 19'			1025	1							X							
EXCAVATION BOTTOM EAST 20'			0965	1							X							
IMPACTED 1	COMPOSITE 4-1		1220	1							X							
IMPACTED 2			1222	1							X							
IMPACTED 3			1225	1								X						
IMPACTED 4			1227	1								X						
OVERBURDEN 1	COMPOSITE 4-1		1232	1							X							
OVERBURDEN 2			1235	1							X							
OVERBURDEN 3			1237	1								X						
OVERBURDEN 4			1239	1								X						

Relinquished By: CHRIS MERRITT Date: 4-6-09 Time: 0825 Received By: [Signature]
 Relinquished By: _____ Date: _____ Time: _____ Received By: _____
 Relinquished By: _____ Date: _____ Time: _____ Received By: _____
 COMMENTS: ICE# 0.6
GOOD CONDITION
HEAD SPACE ABSENT
DECHLORINATED IN LAB
APPROPRIATE CONTAINERS
PRESERVED IN LAB
 VOAS O&G METALS OTHER
 PRESERVATION pH<2

McC Campbell Analytical, Inc.



1534 Willow Pass Rd
 Pittsburg, CA 94565-1701
 (925) 252-9262

CHAIN-OF-CUSTODY RECORD

WorkOrder: 0904121

ClientCode: GECL

WriteOn EDF Excel Fax Email HardCopy ThirdParty J-flag

Report to: John Love
 GEOCON Env. Consultants
 6671 Brisa St
 Livermore, CA 94550
 (925) 371-5900 FAX 925-371-5915

Email: love@geoconinc.com; Livermore@geoc

ProjectNo: #E8415-06-62; Caltrans 580 @ Vasco

Bill to: Accounts Payable
 GEOCON Env. Consultants
 6671 Brisa St
 Livermore, CA 94550

Requested TAT: **1 day**

Date Received: 04/06/2009
Date Printed: 04/06/2009

Lab ID	Client ID	Matrix	Collection Date	Hold	Requested Tests (See legend below)											
					1	2	3	4	5	6	7	8	9	10	11	12
0904121-001	Excavation North 19'	Soil	4/4/2009 10:40	<input type="checkbox"/>	A	A	A									
0904121-002	Excavation East Wall 19'	Soil	4/4/2009 10:45	<input type="checkbox"/>	A	A	A									
0904121-003	Excavation Bottom West 20'	Soil	4/4/2009 10:35	<input type="checkbox"/>	A	A	A									
0904121-004	Excavation West 19'	Soil	4/4/2009 10:15	<input type="checkbox"/>	A	A	A									
0904121-005	Excavation South 19'	Soil	4/4/2009 10:25	<input type="checkbox"/>	A	A	A									
0904121-006	Excavation Bottom East 20'	Soil	4/4/2009 9:55	<input type="checkbox"/>	A	A	A									
0904121-007	Impacted 1-4	Soil	4/4/2009	<input type="checkbox"/>	A	A	A									
0904121-008	Overburden 1-4	Soil	4/4/2009	<input type="checkbox"/>	A	A	A									

Test Legend:

1	G-MBTX_S	2	LUFT_S	3	TPH(DMO)_S	4		5	
6		7		8		9		10	
11		12							

Prepared by: Maria Venegas

Comments: 24hr Rush

NOTE: Soil samples are discarded 60 days after results are reported unless other arrangements are made (Water samples are 30 days).
 Hazardous samples will be returned to client or disposed of at client expense.



Sample Receipt Checklist

Client Name: **GEOCON Env. Consultants**

Date and Time Received: **04/06/09 8:58:21 AM**

Project Name: **#E8415-06-62; Caltrans 580 @ Vasco**

Checklist completed and reviewed by: **Maria Venegas**

WorkOrder N°: **0904121** Matrix Soil

Carrier: Client Drop-In

Chain of Custody (COC) Information

- Chain of custody present? Yes No
- Chain of custody signed when relinquished and received? Yes No
- Chain of custody agrees with sample labels? Yes No
- Sample IDs noted by Client on COC? Yes No
- Date and Time of collection noted by Client on COC? Yes No
- Sampler's name noted on COC? Yes No

Sample Receipt Information

- Custody seals intact on shipping container/cooler? Yes No NA
- Shipping container/cooler in good condition? Yes No
- Samples in proper containers/bottles? Yes No
- Sample containers intact? Yes No
- Sufficient sample volume for indicated test? Yes No

Sample Preservation and Hold Time (HT) Information

- All samples received within holding time? Yes No
- Container/Temp Blank temperature Cooler Temp: 0.6°C NA
- Water - VOA vials have zero headspace / no bubbles? Yes No No VOA vials submitted
- Sample labels checked for correct preservation? Yes No
- TTLC Metal - pH acceptable upon receipt (pH<2)? Yes No NA
- Samples Received on Ice? Yes No

(Ice Type: DRY ICE)

* NOTE: If the "No" box is checked, see comments below.

Client contacted:

Date contacted:

Contacted by:

Comments:



McC Campbell Analytical, Inc.

"When Quality Counts"

1534 Willow Pass Road, Pittsburg, CA 94565-1701
Web: www.mcccampbell.com E-mail: main@mcccampbell.com
Telephone: 877-252-9262 Fax: 925-252-9269

GEOCON Env. Consultants 6671 Brisa St Livermore, CA 94550	Client Project ID: #E8415-06-62; Caltrans 580 @ Vasco	Date Sampled: 04/04/09
	Client Contact: John Love	Date Received: 04/06/09
	Client P.O.:	Date Analyzed 04/06/09-04/07/09

Gasoline Range (C6-C12) Volatile Hydrocarbons as Gasoline with BTEX and MTBE*

Extraction method SW5030B

Analytical methods SW8021B/8015Bm

Work Order: 0904121

Lab ID	Client ID	Matrix	TPH(g)	MTBE	Benzene	Toluene	Ethylbenzene	Xylenes	DF	% SS
001A	Excavation North 19'	S	1000,d7,d9	---	ND<1.0	ND<1.0	1.9	2.7	200	---#
002A	Excavtion East Wall 19'	S	19,d7	---	ND<0.025	ND<0.025	ND<0.025	ND<0.025	5	95
003A	Excavation Bottom West 20'	S	99,d7,d9	---	ND<0.050	ND<0.050	ND<0.050	ND<0.050	10	83
004A	Excavation West 19'	S	ND	---	ND	ND	ND	ND	1	85
005A	Excavation South 19'	S	11,d7	---	ND<0.025	ND<0.025	ND<0.025	ND<0.025	5	93
006A	Excavation Bottom East 20'	S	1500,d7,d9	---	ND<0.50	ND<0.50	1.7	2.5	100	124
007A	Impacted 1-4	S	390,d7,d9	---	ND<0.050	ND<0.050	0.85	1.2	10	111
008A	Overburden 1-4	S	ND	---	ND	ND	ND	ND	1	90

Reporting Limit for DF =1; ND means not detected at or above the reporting limit	W	50	5.0	0.5	0.5	0.5	0.5	ug/L
	S	1.0	0.05	0.005	0.005	0.005	0.005	mg/Kg

* water and vapor samples and all TCLP & SPLP extracts are reported in µg/L, soil/sludge/solid samples in mg/kg, wipe samples in µg/wipe, product/oil/non-aqueous liquid samples in mg/L.

cluttered chromatogram; sample peak coelutes w/surrogate peak; low surrogate recovery due to matrix interference.

+The following descriptions of the TPH chromatogram are cursory in nature and McC Campbell Analytical is not responsible for their interpretation:

d7) strongly aged gasoline or diesel range compounds are significant in the TPH(g) chromatogram
d9) no recognizable pattern



McC Campbell Analytical, Inc.

"When Quality Counts"

1534 Willow Pass Road, Pittsburg, CA 94565-1701
Web: www.mcccampbell.com E-mail: main@mcccampbell.com
Telephone: 877-252-9262 Fax: 925-252-9269

GEOCON Env. Consultants 6671 Brisa St Livermore, CA 94550	Client Project ID: #E8415-06-62; Caltrans 580 @ Vasco	Date Sampled: 04/04/09
	Client Contact: John Love	Date Received: 04/06/09
	Client P.O.:	Date Extracted: 04/06/09
		Date Analyzed: 04/06/09

LUFT 5 Metals*

Extraction method: SW3050B

Analytical methods: 6010C

Work Order: 0904121

Lab ID	Client ID	Matrix	Extraction Type	Cadmium	Chromium	Lead	Nickel	Zinc	DF	% SS
001A	Excavation North 19'	S	TOTAL	ND	36	8.5	30	37	1	112
002A	Excavation East Wall 19'	S	TOTAL	ND	31	6.8	24	32	1	117
003A	Excavation Bottom West 20'	S	TOTAL	ND	42	8.9	36	38	1	116
004A	Excavation West 19'	S	TOTAL	ND	22	5.4	20	21	1	112
005A	Excavation South 19'	S	TOTAL	ND	42	9.9	38	44	1	115
006A	Excavation Bottom East 20'	S	TOTAL	ND	35	7.8	29	34	1	117
007A	Impacted 1-4	S	TOTAL	ND	41	9.4	33	40	1	111
008A	Overburden 1-4	S	TOTAL	ND	49	23	46	70	1	106

Reporting Limit for DF =1; ND means not detected at or above the reporting limit	W	TOTAL	NA	NA	NA	NA	NA	NA	NA
	S	TOTAL	1.5	1.5	5.0	1.5	5.0	mg/Kg	

*water samples are reported in µg/L, product/oil/non-aqueous liquid samples and all TCLP / STLC / DISTLC / SPLP extracts are reported in mg/L, soil/sludge/solid samples in mg/kg, wipe samples in µg/wipe, filter samples in µg/filter.

means surrogate diluted out of range; ND means not detected above the reporting limit; N/A means not applicable to this sample or instrument.

TOTAL = acid digestion.
WET = Waste Extraction Test (STLC).
DI WET = Waste Extraction Test using de-ionized water.



McC Campbell Analytical, Inc.

"When Quality Counts"

1534 Willow Pass Road, Pittsburg, CA 94565-1701
Web: www.mccampbell.com E-mail: main@mccampbell.com
Telephone: 877-252-9262 Fax: 925-252-9269

GEOCON Env. Consultants 6671 Brisa St Livermore, CA 94550	Client Project ID: #E8415-06-62; Caltrans 580 @ Vasco	Date Sampled: 04/04/09
	Client Contact: John Love	Date Received: 04/06/09
	Client P.O.:	Date Extracted: 04/06/09
		Date Analyzed: 04/06/09-04/07/09

Total Extractable Petroleum Hydrocarbons*

Extraction method: SW3550C

Analytical methods: SW8015B

Work Order: 0904121

Lab ID	Client ID	Matrix	TPH-Diesel (C10-C23)	TPH-Motor Oil (C18-C36)	DF	% SS
0904121-001A	Excavation North 19'	S	360,e11	ND	1	83
0904121-002A	Excavation East Wall 19'	S	22,e11	ND	1	95
0904121-003A	Excavation Bottom West 20'	S	29,e11	ND	1	91
0904121-004A	Excavation West 19'	S	ND	ND	1	98
0904121-005A	Excavation South 19'	S	17,e11	ND	1	97
0904121-006A	Excavation Bottom East 20'	S	700,e11	ND<50	10	99
0904121-007A	Impacted 1-4	S	130,e11	ND<10	2	97
0904121-008A	Overburden 1-4	S	1.5,e7,e2,e6	14	1	99

Reporting Limit for DF =1; ND means not detected at or above the reporting limit	W	NA	NA	ug/L
	S	1.0	5.0	mg/Kg

* water samples are reported in µg/L, wipe samples in µg/wipe, soil/solid/sludge samples in mg/kg, product/oil/non-aqueous liquid samples in mg/L, and all DISTLC / STLC / SPLP / TCLP extracts are reported in µg/L.

cluttered chromatogram resulting in coeluted surrogate and sample peaks, or; surrogate peak is on elevated baseline, or; surrogate has been diminished by dilution of original extract.

+The following descriptions of the TPH chromatogram are cursory in nature and McC Campbell Analytical is not responsible for their interpretation:

- e2) diesel range compounds are significant; no recognizable pattern
- e6) one to a few isolated peaks present in the THP(d/mo) chromatogram
- e7) oil range compounds are significant
- e11) stoddard solvent/mineral spirit (?)



QC SUMMARY REPORT FOR SW8021B/8015Bm

W.O. Sample Matrix: Soil

QC Matrix: Soil

BatchID: 42478

WorkOrder 0904121

Analyte	EPA Method SW8021B/8015Bm		Extraction SW5030B						Spiked Sample ID: 0904121-004A			
	Sample	Spiked	MS	MSD	MS-MSD	LCS	LCSD	LCS-LCSD	Acceptance Criteria (%)			
	mg/Kg	mg/Kg	% Rec.	% Rec.	% RPD	% Rec.	% Rec.	% RPD	MS / MSD	RPD	LCS/LCSD	RPD
TPH(btex) [£]	ND	0.60	112	107	3.87	104	101	3.41	70 - 130	20	70 - 130	20
MTBE	ND	0.10	99.9	87.1	13.7	94.1	92.1	2.17	70 - 130	20	70 - 130	20
Benzene	ND	0.10	102	98.4	3.12	106	106	0	70 - 130	20	70 - 130	20
Toluene	ND	0.10	122	111	9.33	120	118	1.89	70 - 130	20	70 - 130	20
Ethylbenzene	ND	0.10	112	111	1.31	117	113	3.57	70 - 130	20	70 - 130	20
Xylenes	ND	0.30	124	123	1.16	127	124	2.88	70 - 130	20	70 - 130	20
%SS:	85	0.10	100	96	3.71	105	102	2.75	70 - 130	20	70 - 130	20

All target compounds in the Method Blank of this extraction batch were ND less than the method RL with the following exceptions:
NONE

BATCH 42478 SUMMARY

Lab ID	Date Sampled	Date Extracted	Date Analyzed	Lab ID	Date Sampled	Date Extracted	Date Analyzed
0904121-001A	04/04/09 10:40 AM	04/06/09	04/06/09 6:57 PM	0904121-002A	04/04/09 10:45 AM	04/06/09	04/07/09 6:57 AM
0904121-003A	04/04/09 10:35 AM	04/06/09	04/07/09 8:48 AM	0904121-004A	04/04/09 10:15 AM	04/06/09	04/06/09 7:58 PM
0904121-005A	04/04/09 10:25 AM	04/06/09	04/06/09 8:59 PM	0904121-006A	04/04/09 9:55 AM	04/06/09	04/07/09 1:49 AM
0904121-007A	04/04/09	04/06/09	04/07/09 9:25 AM	0904121-008A	04/04/09	04/06/09	04/06/09 8:29 PM

MS = Matrix Spike; MSD = Matrix Spike Duplicate; LCS = Laboratory Control Sample; LCSD = Laboratory Control Sample Duplicate; RPD = Relative Percent Deviation.

% Recovery = 100 * (MS-Sample) / (Amount Spiked); RPD = 100 * (MS - MSD) / ((MS + MSD) / 2).

MS / MSD spike recoveries and / or %RPD may fall outside of laboratory acceptance criteria due to one or more of the following reasons: a) the sample is inhomogenous AND contains significant concentrations of analyte relative to the amount spiked, or b) the spiked sample's matrix interferes with the spike recovery.

£ TPH(btex) = sum of BTEX areas from the FID.

cluttered chromatogram; sample peak coelutes with surrogate peak.

N/A = not enough sample to perform matrix spike and matrix spike duplicate.

NR = matrix interference and/or analyte concentration in sample exceeds spike amount for soil matrix or exceeds 2x spike amount for water matrix or sample diluted due to high matrix or analyte content.



QC SUMMARY REPORT FOR 6010C

W.O. Sample Matrix: Soil

QC Matrix: Soil

WorkOrder: 0904121

EPA Method 6010C		Extraction SW3050B				BatchID: 42420			Spiked Sample ID 0904031-002A				
Analyte	Sample	Spiked	MS	MSD	MS-MSD	Spiked	LCS	LCSD	LCS-LCSD	Acceptance Criteria (%)			
	mg/Kg	mg/Kg	% Rec.	% Rec.	% RPD	mg/Kg	% Rec.	% Rec.	% RPD	MS / MSD	RPD	LCS/LCSD	RPD
Cadmium	3.8	50	106	107	0.831	10	96.6	91.7	5.21	75 - 125	20	75 - 125	20
Chromium	53	50	97.8	94.2	1.75	10	92.2	91.3	0.926	75 - 125	20	75 - 125	20
Lead	150	50	101	102	0.410	10	94.1	86.8	8.13	75 - 125	20	75 - 125	20
Nickel	51	50	97.9	94.8	1.56	10	95.7	94.2	1.61	75 - 125	20	75 - 125	20
Zinc	370	500	84.8	83.3	0.914	100	92	90	2.22	75 - 125	20	75 - 125	20
%SS:	115	250	109	121	10.5	250	103	101	1.47	70 - 130	20	70 - 130	20

All target compounds in the Method Blank of this extraction batch were ND less than the method RL with the following exceptions:
NONE

BATCH 42420 SUMMARY

Lab ID	Date Sampled	Date Extracted	Date Analyzed	Lab ID	Date Sampled	Date Extracted	Date Analyzed
0904121-001A	04/04/09 10:40 AM	04/06/09	04/06/09 8:18 PM	0904121-002A	04/04/09 10:45 AM	04/06/09	04/06/09 8:22 PM
0904121-003A	04/04/09 10:35 AM	04/06/09	04/06/09 8:25 PM	0904121-004A	04/04/09 10:15 AM	04/06/09	04/06/09 8:29 PM
0904121-007A	04/04/09	04/06/09	04/06/09 8:36 PM	0904121-008A	04/04/09	04/06/09	04/06/09 9:01 PM

MS = Matrix Spike; MSD = Matrix Spike Duplicate; LCS = Laboratory Control Sample; LCSD = Laboratory Control Sample Duplicate; RPD = Relative Percent Deviation.

% Recovery = 100 * (MS-Sample) / (Amount Spiked); RPD = 100 * (MS - MSD) / ((MS + MSD) / 2).

MS / MSD spike recoveries and / or %RPD may fall outside of laboratory acceptance criteria due to one or more of the following reasons: a) the sample is inhomogenous AND contains significant concentrations of analyte relative to the amount spiked, or b) the spiked sample's matrix interferes with the spike recovery.

N/A = not applicable to this method.

NR = analyte concentration in sample exceeds spike amount for soil matrix or exceeds 2x spike amount for water matrix or sample diluted due to high matrix or analyte content.



QC SUMMARY REPORT FOR 6010C

W.O. Sample Matrix: Soil

QC Matrix: Soil

WorkOrder: 0904121

EPA Method 6010C		Extraction SW3050B					BatchID: 42480			Spiked Sample ID 0904121-006A			
Analyte	Sample	Spiked	MS	MSD	MS-MSD	Spiked	LCS	LCSD	LCS-LCSD	Acceptance Criteria (%)			
	mg/Kg	mg/Kg	% Rec.	% Rec.	% RPD	mg/Kg	% Rec.	% Rec.	% RPD	MS / MSD	RPD	LCS/LCSD	RPD
Cadmium	ND	50	122	117	4.85	10	99.4	86.3	14.2	75 - 125	20	75 - 125	20
Chromium	35	50	116	99.9	8.87	10	105	98.3	6.85	75 - 125	20	75 - 125	20
Lead	7.8	50	102	105	2.35	10	103	89.9	13.1	75 - 125	20	75 - 125	20
Nickel	29	50	94.3	97.1	1.82	10	98.8	97.8	1.07	75 - 125	20	75 - 125	20
Zinc	34	500	93.9	89.5	4.41	100	103	99.9	3.25	75 - 125	20	75 - 125	20
%SS:	117	250	117	106	9.66	250	103	103	0	70 - 130	20	70 - 130	20

All target compounds in the Method Blank of this extraction batch were ND less than the method RL with the following exceptions:
NONE

BATCH 42480 SUMMARY

Lab ID	Date Sampled	Date Extracted	Date Analyzed	Lab ID	Date Sampled	Date Extracted	Date Analyzed
0904121-005A	04/04/09 10:25 AM	04/06/09	04/06/09 8:33 PM	0904121-006A	04/04/09 9:55 AM	04/06/09	04/06/09 8:51 PM

MS = Matrix Spike; MSD = Matrix Spike Duplicate; LCS = Laboratory Control Sample; LCSD = Laboratory Control Sample Duplicate; RPD = Relative Percent Deviation.

% Recovery = 100 * (MS-Sample) / (Amount Spiked); RPD = 100 * (MS - MSD) / ((MS + MSD) / 2).

MS / MSD spike recoveries and / or %RPD may fall outside of laboratory acceptance criteria due to one or more of the following reasons: a) the sample is inhomogenous AND contains significant concentrations of analyte relative to the amount spiked, or b) the spiked sample's matrix interferes with the spike recovery.

N/A = not applicable to this method.

NR = analyte concentration in sample exceeds spike amount for soil matrix or exceeds 2x spike amount for water matrix or sample diluted due to high matrix or analyte content.



QC SUMMARY REPORT FOR SW8015B

W.O. Sample Matrix: Soil

QC Matrix: Soil

BatchID: 42465

WorkOrder: 0904121

Analyte	Extraction SW3550C			Spiked Sample ID: 0904103-009A								
	Sample	Spiked	MS	MSD	MS-MSD	LCS	LCSD	LCS-LCSD	Acceptance Criteria (%)			
	mg/Kg	mg/Kg	% Rec.	% Rec.	% RPD	% Rec.	% Rec.	% RPD	MS / MSD	RPD	LCS/LCSD	RPD
TPH-Diesel (C10-C23)	210	20	NR	NR	NR	107	107	0	70 - 130	30	70 - 130	30
%SS:	94	50	86	90	4.49	101	100	0.799	70 - 130	30	70 - 130	30

All target compounds in the Method Blank of this extraction batch were ND less than the method RL with the following exceptions:
NONE

BATCH 42465 SUMMARY

Lab ID	Date Sampled	Date Extracted	Date Analyzed	Lab ID	Date Sampled	Date Extracted	Date Analyzed
0904121-001A	04/04/09 10:40 AM	04/06/09	04/06/09 2:51 PM	0904121-002A	04/04/09 10:45 AM	04/06/09	04/06/09 4:04 PM
0904121-003A	04/04/09 10:35 AM	04/06/09	04/06/09 5:18 PM	0904121-004A	04/04/09 10:15 AM	04/06/09	04/06/09 7:42 PM
0904121-007A	04/04/09	04/06/09	04/07/09 9:26 AM	0904121-008A	04/04/09	04/06/09	04/06/09 10:02 PM

MS = Matrix Spike; MSD = Matrix Spike Duplicate; LCS = Laboratory Control Sample; LCSD = Laboratory Control Sample Duplicate; RPD = Relative Percent Deviation.

% Recovery = 100 * (MS-Sample) / (Amount Spiked); RPD = 100 * (MS - MSD) / ((MS + MSD) / 2).

MS / MSD spike recoveries and / or %RPD may fall outside of laboratory acceptance criteria due to one or more of the following reasons: a) the sample is inhomogenous AND contains significant concentrations of analyte relative to the amount spiked, or b) the spiked sample's matrix interferes with the spike recovery.

N/A = not enough sample to perform matrix spike and matrix spike duplicate.

NR = analyte concentration in sample exceeds spike amount for soil matrix or exceeds 2x spike amount for water matrix or sample diluted due to high matrix or analyte content.



QC SUMMARY REPORT FOR SW8015B

W.O. Sample Matrix: Soil

QC Matrix: Soil

BatchID: 42479

WorkOrder: 0904121

EPA Method SW8015B		Extraction SW3550C							Spiked Sample ID: 0904121-006A			
Analyte	Sample	Spiked	MS	MSD	MS-MSD	LCS	LCSD	LCS-LCSD	Acceptance Criteria (%)			
	mg/Kg	mg/Kg	% Rec.	% Rec.	% RPD	% Rec.	% Rec.	% RPD	MS / MSD	RPD	LCS/LCSD	RPD
TPH-Diesel (C10-C23)	700	20	NR	NR	NR	86.6	85.8	0.822	70 - 130	30	70 - 130	30
%SS:	99	50	88	93	4.95	81	81	0	70 - 130	30	70 - 130	30

All target compounds in the Method Blank of this extraction batch were ND less than the method RL with the following exceptions:
NONE

BATCH 42479 SUMMARY

Lab ID	Date Sampled	Date Extracted	Date Analyzed	Lab ID	Date Sampled	Date Extracted	Date Analyzed
0904121-005A	04/04/09 10:25 AM	04/06/09	04/06/09 8:52 PM	0904121-006A	04/04/09 9:55 AM	04/06/09	04/07/09 9:26 AM

MS = Matrix Spike; MSD = Matrix Spike Duplicate; LCS = Laboratory Control Sample; LCSD = Laboratory Control Sample Duplicate; RPD = Relative Percent Deviation.

% Recovery = $100 * (MS - Sample) / (Amount Spiked)$; RPD = $100 * (MS - MSD) / ((MS + MSD) / 2)$.

MS / MSD spike recoveries and / or %RPD may fall outside of laboratory acceptance criteria due to one or more of the following reasons: a) the sample is inhomogenous AND contains significant concentrations of analyte relative to the amount spiked, or b) the spiked sample's matrix interferes with the spike recovery.

N/A = not enough sample to perform matrix spike and matrix spike duplicate.

NR = analyte concentration in sample exceeds spike amount for soil matrix or exceeds 2x spike amount for water matrix or sample diluted due to high matrix or analyte content.

APPENDIX

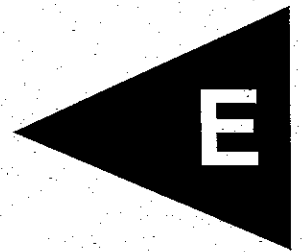

DEPARTMENT OF TRANSPORTATION

111 GRAND AVENUE
P. O. BOX 23660
OAKLAND, CA 94623-0660
PHONE (510) 286-5647
FAX (510) 286-5639



*Flex your power!
Be energy efficient!*

May 12, 2009

Mr. John Love
Sr. Project Geologist
Geocon Consultants, Inc.
6671 Brisa Street
Livermore, California
FAX: (925) 371-5915

Subject: Underground Storage Tank (UST) Removal Report for USTs located beneath Eastbound Interstate 580 between First Street and Vasco Road in Livermore, CA

Dear Mr. Love:

I have reviewed and approved the above referenced document. Please submit it to the Alameda County Environmental Health Department (ACEHD). Should the ACEHD require, I declare, under penalty of perjury, that to the best of my knowledge, the information contained in the attached report is true and correct.

If you have any questions, or need additional information please call me at (510) 622-0716.

Sincerely,

A handwritten signature in cursive script that reads "Chris Bledsoe".

Chris Bledsoe
Transportation Engineer
Office of Construction Environmental Engineering Support