

# Atlantic Richfield Company

**Chuck Carmel**  
Remediation Management Project Manager

**RECEIVED**

By Alameda County Environmental Health at 9:50 am, Aug 01, 2014

PO Box 1257  
San Ramon, CA 94583  
Phone: (925) 275-3804  
Fax: (925) 275-3815  
E-Mail: chuck.carmel@bp.com

July 30, 2014

Re: Second Quarter 2014 Status Report  
Former Richfield Oil Company Station No. 472  
6415 International Boulevard, Oakland, California  
ACEH Case #RO0002982

I declare that to the best of my knowledge at the present time, that the information and/or recommendations contained in the attached document are true and correct.

Submitted by,



Chuck Carmel  
Remediation Management Project Manager

Attachment



4820 Business Center Drive, Suite 110  
Fairfield, CA 94534  
[T] 707-455-7290 [F] 707-863-9046  
broadbentinc.com

*Creating Solutions. Building Trust.*

July 30, 2014

Project No. 09-88-601

Atlantic Richfield Company  
P.O. Box 1257  
San Ramon, CA 94583  
Submitted via ENFOS

Attn.: Mr. Chuck Carmel

Re: Second Quarter 2014 Status Report, Former Richfield Oil Company Station No. 472,  
6415 International Boulevard, Oakland, California; ACEH Case #RO0002982

Dear Mr. Carmel

Attached is the Second Quarter 2014 Status Report for Former Richfield Oil Company Station No. 472 located at 6415 International Boulevard, Oakland, California. This report presents a summary of current developments at the Site through the Second Quarter of 2014.

Should you have questions regarding this submittal, please do not hesitate to contact me at (707) 455-7290.

Sincerely,

BROADBENT & ASSOCIATES, INC.

A blue ink handwritten signature of Kristene Tidwell.

Kristene Tidwell, P.G., C.H.G.  
Senior Hydrogeologist

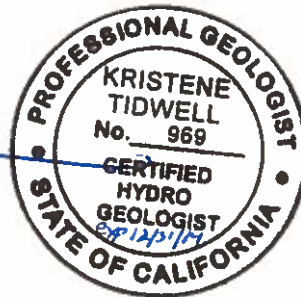

Enclosures

cc: Mr. Keith Nowell, Alameda County Environmental Health (submitted via ACEH ftp site)  
Mr. Mahmud Ghanem, 6207 International Boulevard, Oakland, California 94621  
Electronic copy uploaded to GeoTracker

**SECOND QUARTER 2014  
STATUS REPORT  
FORMER STATION No. 472, OAKLAND, CALIFORNIA**

Broadbent & Associates, Inc. (Broadbent) is pleased to present this *Second Quarter 2014 Status Report* on behalf of Atlantic Richfield Company (a BP affiliated company) for Former Richfield Oil Company Station No. 472 located in Oakland, Alameda County, California (Site). Quarterly reporting is being submitted to the Alameda County Environmental Health Services Agency (ACEH) consistent with their requirements under the legal authority of the California Regional Water Quality Control Board, as codified by California Code of Regulations Title 23, Section 2652(d). A summary description of current developments regarding the site is provided below.

Facility Name / Address:	Former Station No. 472 / 6415 International Boulevard, Oakland
Client Project Manager / Title:	Mr. Chuck Carmel / RM Operations Project Manager
Broadbent Contact:	Kristene Tidwell, P.G., C.Hg., (707) 455-7290
Broadbent Project No.:	09-88-601
Primary Regulatory Agency / ID No.:	ACEH, Case #RO0002982
Current phase of project:	Case Closure Evaluation
List of Acronyms / Abbreviations:	See end of report text for list of acronyms/abbreviations used in report.

**WORK PERFORMED THIS QUARTER (Second Quarter 2014)**

1. Submitted *First Quarter 2014 Status Report* on April 30, 2014.
2. Submitted an *Additional Well Survey Information and Case Closure Request Addendum* on May 1, 2014, as requested by the ACEH.
3. No environmental field work was conducted at Former Station No. 472 during the Second Quarter 2014.

**WORK SCHEDULED FOR NEXT QUARTER (Third Quarter 2014):**

1. Submit *Second Quarter 2014 Status Report* (contained herein).
2. Carryout well decommissioning activities upon approval of the *Additional Well Survey Information and Case Closure Request Addendum* by the ACEH.

**DISCUSSION:**

On May 1, 2014 Broadbent submitted an *Additional Well Survey Information and Case Closure Request Addendum*. This Well Survey Closure Addendum was prepared in response to a letter issued by the ACEH dated April 25, 2014 (ACEH Letter). This letter provided comments on the most recent Previous CCR Addendum, and which indicated that the Site would meet the criteria for case closure based on the Low threat Underground Storage Tank Case Closure Policy, provided additional well survey information was submitted. It is anticipated that comments and/or closure approval will be received during the third quarter 2014, upon approval of case closure request well decommissioning activities would be carried out.

**ATTACHMENT:**

- Drawing 1: Site Location Map  
Drawing 2: Groundwater Elevation and Analytical Summary Map, September 4, 2013

**LIST OF COMMONLY USED ACCRONYMS/ABBREVIATIONS:**

ACEH:	Alameda County Environmental Health	ft/ft:	feet per foot
ACPWA:	Alameda County Public Works Agency	gal:	Gallons
BTEX:	Benzene, Toluene, Ethylbenzene, Total Xylenes	GRO:	Gasoline-Range Organics
1,2-DCA:	1,2-Dichloroethane	LNAPL:	Light Non-Aqueous Phase Liquid
DIPE:	Di-Isopropyl Ether	MTBE:	Methyl Tertiary Butyl Ether
DO:	Dissolved Oxygen	NO <sub>3</sub> :	Nitrate as Nitrogen
DRO:	Diesel-Range Organics	ppb:	parts per billion
EDB:	1,2-Dibromomethane	SO <sub>4</sub> :	Sulfate
Eh:	Oxidation Reduction Potential	TAME:	Tert-Amyl Methyl Ether
EPA:	Environmental Protection Agency	TBA:	Tertiary Butyl Ether
ETBE:	Ethyl Tertiary Butyl Ether	TOC:	Top of Casing
Fe <sup>2+</sup> :	Ferrous Iron	µg/L:	micrograms per liter

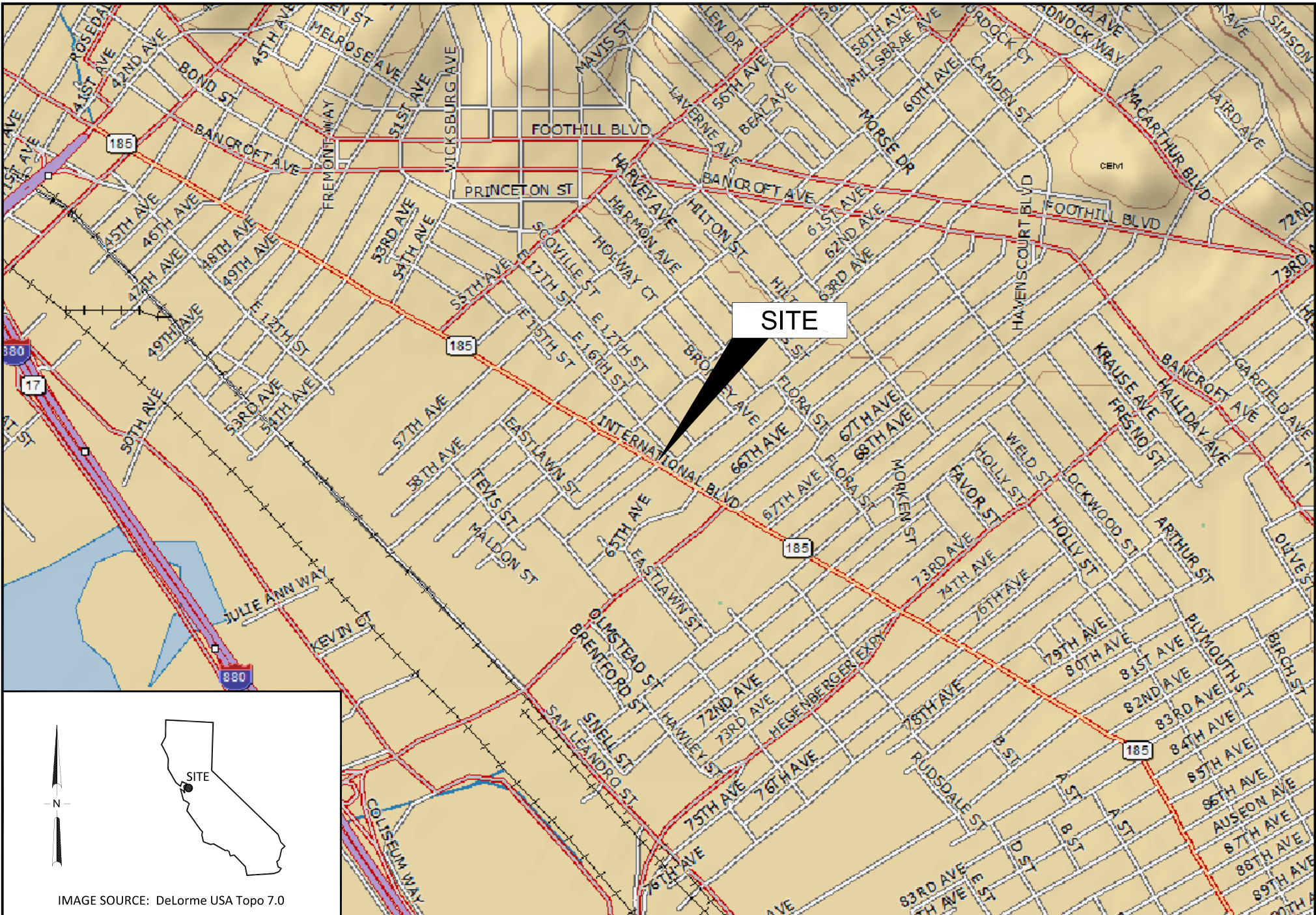

**SITE**

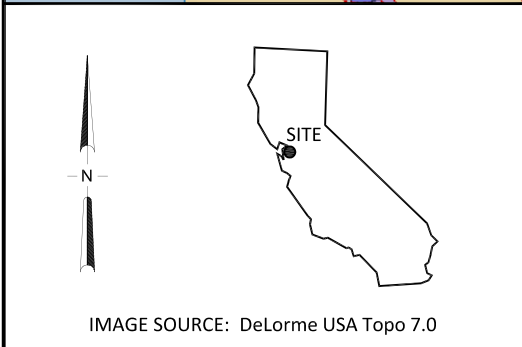
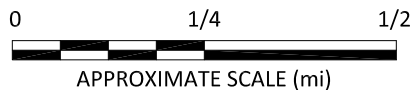

IMAGE SOURCE: DeLorme USA Topo 7.0



**BROADBENT**  
1370 Ridgewood Dr., Suite 5  
Chico, California 95973  
Project No.: 09-88-601 Date: 4/2/2013

Former Station #472  
6415 International Boulevard  
Oakland, California

Site Location Map

Drawing  
**1**

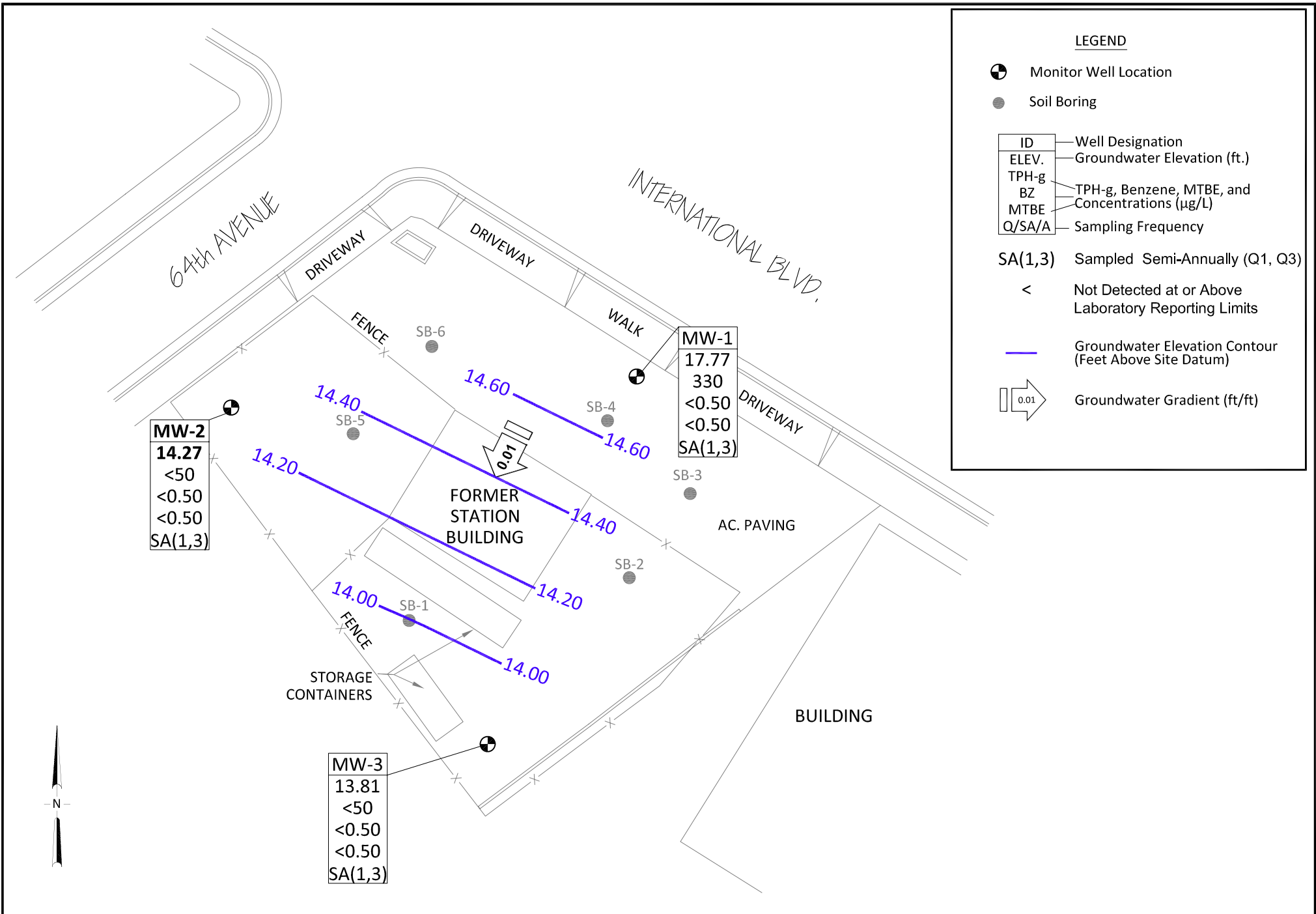

**MW-2**  
 14.27  
 <50  
 <0.50  
 <0.50  
 SA(1,3)

**MW-1**  
 17.77  
 330  
 <0.50  
 <0.50  
 SA(1,3)

**MW-3**  
 13.81  
 <50  
 <0.50  
 <0.50  
 SA(1,3)

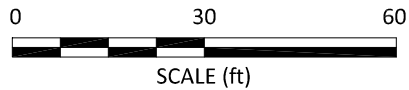

Project No.: 09-88-601 Date: 10/01/2013

ARCO Former Station No 472  
 6415 International Boulevard  
 Oakland, California

Groundwater Elevation and  
 Analytical Summary Map  
 September 4, 2013

Drawing

2