



ENVIRONMENTAL HEALTH SERVICES  
ENVIRONMENTAL PROTECTION  
1131 Harbor Bay Parkway, Suite 250  
Alameda, CA 94502-6577  
(510) 567-6700  
FAX (510) 337-9335

July 14, 2011

Denis Brown  
Shell Oil Products US  
20945 S. Wilmington Ave.  
Carson, CA 90810-1039

Allan A. and Beverly M. Sebanc Trs  
2805 Ralston Avenue  
Hillsborough, CA 94010-6547

C&H Development Company  
Address Unknown

Kenneth McCloskey, Trustee  
2805 Ralston Avenue  
Hillsborough, CA 94010-6547

Subject: Public Notification of Potential Case Closure for Fuel Leak Case No. RO0002971 and GeoTracker Global ID T0619714590, Shell, 2301-2307 Lincoln Avenue, Alameda, CA 94502

Dear Responsible Parties:

Alameda County Environmental Health (ACEH) is reviewing the fuel case file for the above referenced site for potential case closure. Public participation is a requirement for the Corrective Action Plan and case closure process. In order to notify potentially affected members of the public of the potential fuel leak case closure, we request that you distribute the attached Notification of Potential Case Closure to the addresses shown on attached mailing list **no later than July 21, 2011**. The Notification of Potential Case Closure requests that landowners or residents submit any comments or questions to ACEH regarding potential case closure by August 22, 2011. Following distribution by U.S. Mail to the attached mailing list, please submit written verification of the date that the Notification of Potential Case Closure was distributed. ACEH will consider all comments from the public prior to potential case closure.

#### **TECHNICAL REPORT REQUEST**

Please submit technical reports to Alameda County Environmental Health (Attention: Jerry Wickham), according to the following schedule:

- **July 25, 2011** – Verification that the Notification of Potential Case Closure was distributed to the attached mailing list

If you have any questions, please call me at (510) 567-6791 or send me an electronic mail message at [jerry.wickham@acgov.org](mailto:jerry.wickham@acgov.org).

Sincerely,

Jerry Wickham, California PG 3766, CEG 1177, and CHG 297  
Senior Hazardous Materials Specialist

Responsible Parties  
RO0002971  
July 14, 2011  
Page 2

Attachments: Public Notification of Potential Case Closure (for distribution)  
Mailing List  
Responsible Party(ies) Legal Requirements/Obligations

Enclosure: ACEH Electronic Report Upload (ftp) Instructions

cc: Leroy Griffin, Oakland Fire Department, 250 Frank H. Ogawa Plaza, Ste. 3341, Oakland, CA 94612-2032 2032 (*Sent via E-mail to: [lgriffin@oaklandnet.com](mailto:lgriffin@oaklandnet.com)*)

Peter Schaefer, Conestoga-Rovers & Associates, 5900 Hollis Street, Suite A  
Emeryville, CA 94608 (*Sent via E-mail to: [pschaefer@croworld.com](mailto:pschaefer@croworld.com)*)

Jake Torrens, AMEC Geomatrix, 2101 Webster Street, 12<sup>th</sup> Floor, Oakland, CA 94612-3066 (*Sent via E-mail to: [jake.torrens@amec.com](mailto:jake.torrens@amec.com)*)

Donna Drogos, ACEH (*Sent via E-mail to: [donna.drogos@acgov.org](mailto:donna.drogos@acgov.org)*)  
Jerry Wickham, ACEH (*Sent via E-mail to: [jerry.wickham@acgov.org](mailto:jerry.wickham@acgov.org)*)

GeoTracker, eFile



ENVIRONMENTAL HEALTH SERVICES  
ENVIRONMENTAL PROTECTION  
1131 Harbor Bay Parkway, Suite 250  
Alameda, CA 94502-6577  
(510) 567-6700  
FAX (510) 337-9335

**NOTIFICATION OF POTENTIAL CASE CLOSURE**  
**SHELL**  
**July 20, 2011**

**Site Location: 2301-2307 Lincoln Avenue, Alameda, CA 94501**  
**Fuel Leak Case RO0002971 and GeoTracker Global ID T0619714590**

**Summary** – This fact sheet has been prepared to inform community members and other interested parties of potential case closure for a fuel leak case at a former gasoline service station located at the corner of Lincoln Avenue and Oak Street in Alameda, California (see attached map on back). The site is currently a retail center and parking lot. Surrounding land use is mixed commercial and residential.

Historically, underground storage tanks (USTs) were present in both the western and eastern areas of the site. Both former UST areas are currently beneath the parking lot for the retail center. In July 1999, petroleum hydrocarbons were detected in soil and groundwater samples from six soil borings that were advanced in the western tank area. Various site investigation activities including soil, soil vapor, and groundwater sampling were conducted throughout the site between February 2007 and April 2011. The investigations indicated that residual petroleum hydrocarbons remained in soil and groundwater in the former eastern and western tank areas. Elevated concentrations of petroleum hydrocarbons were detected in soil vapor sample SVP-5, which was collected from the eastern tank area. To address residual petroleum hydrocarbons in the area around soil vapor sample SVP-5, impacted soil was excavated in March 2011 to depths ranging from 3 to 12 feet below ground surface (bgs). A smaller area near a former gasoline dispenser was excavated to a depth of 3 feet bgs to remove lead impacted soil.

A total of nine groundwater monitoring wells have been installed at the site. After initial sampling of three of the wells in August 2007, quarterly groundwater monitoring was conducted at the site from March 2009 to September 2010. The groundwater monitoring data indicate that a plume containing dissolved petroleum hydrocarbons appears to be stable and limited in extent. The plume is expected to biodegrade over time. Site investigation and cleanup activities have been completed and it does not appear that the fuel release presents a risk to human health for nearby residents or site workers. Therefore, ACEH is considering potential closure of the fuel leak case.

**Background** – The site operated as a gasoline service station from 1926 until 1982. Underground storage tanks were installed in the western area of the site in the 1920s and were associated with a service station that operated on the southwestern portion of the site. The original service station was demolished sometime between 1950 and 1965 and a service station that occupied the entire site was constructed. Additional USTs were installed within the eastern area of the site apparently in 1970. Seven USTs, product lines, and dispensers were reportedly removed from the site in 1982 when the site was redeveloped into a retail center.

**Next Step** – The public is invited to review and comment on the potential closure of the fuel leak case. The entire case file can be viewed over the Internet on the ACEH website (<http://www.acgov.org/aceh/lop/ust.htm>) or the State of California Water Resources Control Board Geotracker website (<http://geotracker.swrcb.ca.gov>). Please send written comments to Jerry Wickham at the address below; all comments will be forwarded to the responsible parties. **Comments received by August 22, 2011** will be considered and responded to prior to a final determination on the proposed case closure.

Additional information: Contact Jerry Wickham of the Alameda County Department of Environmental Health, 1131 Harbor Bay Parkway, Alameda, CA 94502 at 510-567-6791 or by email at [jerry.wickham@acgov.org](mailto:jerry.wickham@acgov.org)

**EXPLANATION**

- HC-CN • Hydrocarbon excavation soil sample location (CRA, 4/11)
  - PB-C ■ Lead excavation soil sample location (CRA, 4/11)
  - COMP-1 ◈ Soil boring location (CRA, 4/11)
  - MW-4 ⊗ Destroyed monitoring well location
  - SVP-5 ⊗ Destroyed soil vapor probe location
  - MW-1 ● Monitoring well location
  - B-6 ⊙ Soil boring location (CRA, 7/10)
  - SVP-1 ⊕ Soil vapor probe location (CRA, 2/09, 3/10, 4/11)
  - B-5 ○ Geoprobe boring location (CRA, 2/09)
  - EB-1 ⊕ Soil boring location (Geomatrix, 8/07)
  - SB-1 ⊙ Soil boring location (Basics Environmental, 7/99)
  - - - Electrical & Telecommunications line (E)
  - - - Telecommunications & Cable TV line (T)
  - - - Gas line (G)
  - - - Storm drain line (STM)
  - - - Sanitary sewer line (SAN)
  - - - Water line (W)
- Sources:**
1. Sanborn Fire Insurance Map, 1950
  2. Majors Civil Engineering, 1982

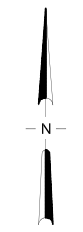
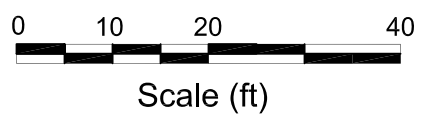
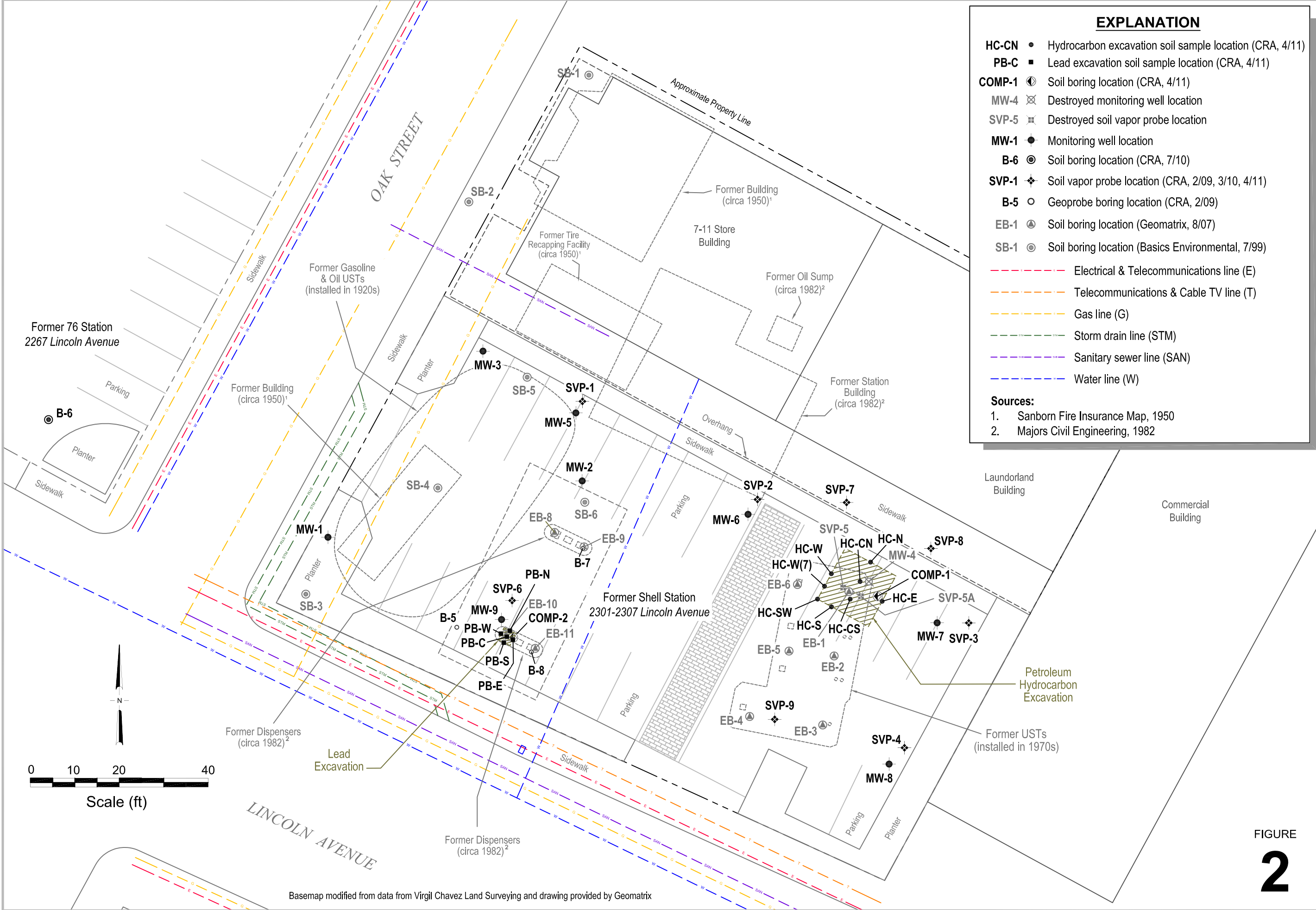

FIGURE  
**2**

Basemap modified from data from Virgil Chavez Land Surveying and drawing provided by Geomatrix

I:\Shell\6-chars\0602--060204-Alameda 2301-2307 Lincoln Ave\060204 FIGURES\060204 SITE PLAN.DWG

BOWEN JASON  
Parcel #: 71-220-21-9  
1621 OAK ST  
ALAMEDA CA 94501

CITY OF ALAMEDA  
Parcel #: 71-202-4  
2263 SANTA CLARA AVE  
ALAMEDA CA 94501

CITY OF ALAMEDA  
Parcel #: 71-219-28-2  
2263 SANTA CLARA AVE #310  
ALAMEDA CA 94501

CITY OF ALAMEDA  
Parcel #: 71-202-35-1  
2263 SANTA CLARA AVE  
ALAMEDA CA 94501

COATS DOROTHY G TRUST  
Parcel #: 71-201-10-3  
1312 FOUNTAIN ST  
ALAMEDA CA 94501

FRANKLIN DAVID  
Parcel #: 71-201-3  
73155 DESERT GREENS DR N  
PALM DESERT CA 92260

GALLARDO RONALD J &  
Parcel #: 71-220-21-3  
1615 OAK ST  
ALAMEDA CA 94501

GARCIA ALICIA K & ALICIA K  
Parcel #: 71-220-21-4  
2264 PACIFIC AVE  
ALAMEDA CA 94501

HOM JIMMY & DEBBIE L  
Parcel #: 71-202-5  
2322 LINCOLN AVE  
ALAMEDA CA 94501

HOWARD NORMAN A &  
Parcel #: 71-220-21-8  
1625 OAK ST  
ALAMEDA CA 94501

KWONG HOI L & ZHAO ANNIE  
Parcel #: 71-220-21-2  
1617 OAK ST  
ALAMEDA CA 94501

LECLAIR BERNITA L ETAL  
Parcel #: 71-201-2  
2306 PACIFIC AVE  
ALAMEDA CA 94501

MATINOG MARK D  
Parcel #: 71-201-5  
4096 PIEDMONT AVE #182  
OAKLAND CA 94611

MCCLOSKEY KENNETH D &  
Parcel #: 71-201-12-1  
2805 RALSTON AVE  
HILLSBOROUGH CA 94010

NIDEVER ISABELLE C &  
Parcel #: 71-201-4  
2 WHITEWATER  
IRVINE CA 92603

RESIDENT  
Parcel #: 71-201-12-1  
2305 LINCOLN AVE  
ALAMEDA CA 94501

RESIDENT  
Parcel #: 71-201-6  
2324 PACIFIC AVE  
ALAMEDA CA 94501

RESIDENT  
Parcel #: 71-220-27  
2261 LINCOLN AVE  
ALAMEDA CA 94501

RESIDENT  
Parcel #: 71-202-4  
2300 LINCOLN AVE  
ALAMEDA CA 94501

RESIDENT  
Parcel #: 71-201-4  
2314 PACIFIC AVE  
ALAMEDA CA 94501

RESIDENT  
Parcel #: 71-201-3  
2310 PACIFIC AVE  
ALAMEDA CA 94501

RESIDENT  
Parcel #: 71-201-13  
1616 OAK ST  
ALAMEDA CA 94501

RESIDENT  
Parcel #: 71-220-20  
2260 PACIFIC AVE  
ALAMEDA CA 94501

RESIDENT  
Parcel #: 71-201-1  
2304 PACIFIC AVE  
ALAMEDA CA 94501

RESIDENT  
Parcel #: 71-201-5  
2318 PACIFIC AVE  
ALAMEDA CA 94501

RESIDENT  
Parcel #: 71-201-11-1  
2315 LINCOLN AVE  
ALAMEDA CA 94501

RESIDENT  
Parcel #: 71-219-28-2  
1555 OAK ST  
ALAMEDA CA 94501

RESIDENT  
Parcel #: 71-201-10-3  
2319 LINCOLN AVE  
ALAMEDA CA 94501

RESIDENT  
Parcel #: 71-202-35-1  
2310 LINCOLN AVE  
ALAMEDA CA 94501

RESIDENT  
Parcel #: 71-202-5  
2320 LINCOLN AVE  
ALAMEDA CA 94501

ROBLES ROY & SAMBERG  
Parcel #: 71-220-21-7  
1619 OAK ST  
ALAMEDA CA 94501

ROSENBLUM KENT M &  
Parcel #: 71-201-1  
1406 CENTRAL AVE  
ALAMEDA CA 94501

SEID WING Y & WONG KATY S  
Parcel #: 71-220-26-1  
2267 LINCOLN AVE  
ALAMEDA CA 94501

SETO HOWARD J & PATRICIA  
Parcel #: 71-220-20  
746 PALMERA CT  
ALAMEDA CA 94501

SINO LP  
Parcel #: 71-201-6  
2211 MOSLEY AVE  
ALAMEDA CA 94501

SOCIETY OF ST VINCENT DE  
Parcel #: 71-201-11-1  
9235 SAN LEANDRO ST  
OAKLAND CA 94603

STRAIN LORRAINE A TR  
Parcel #: 71-201-13  
2431 SHORELINE DR  
NAPA CA 94558

WILTON LYNN T  
Parcel #: 71-220-27  
1221 WALNUT ST  
ALAMEDA CA 94501

## Attachment 1

### Responsible Party(ies) Legal Requirements / Obligations

#### REPORT REQUESTS

These reports are being requested pursuant to California Health and Safety Code Section 25296.10. 23 CCR Sections 2652 through 2654, and 2721 through 2728 outline the responsibilities of a responsible party in response to an unauthorized release from a petroleum UST system, and require your compliance with this request.

#### ELECTRONIC SUBMITTAL OF REPORTS

ACEH's Environmental Cleanup Oversight Programs (LOP and SLIC) require submission of reports in electronic form. The electronic copy replaces paper copies and is expected to be used for all public information requests, regulatory review, and compliance/enforcement activities. Instructions for submission of electronic documents to the Alameda County Environmental Cleanup Oversight Program FTP site are provided on the attached "Electronic Report Upload Instructions." Submission of reports to the Alameda County FTP site is an addition to existing requirements for electronic submittal of information to the State Water Resources Control Board (SWRCB) GeoTracker website. In September 2004, the SWRCB adopted regulations that require electronic submittal of information for all groundwater cleanup programs. For several years, responsible parties for cleanup of leaks from underground storage tanks (USTs) have been required to submit groundwater analytical data, surveyed locations of monitoring wells, and [other](#) data to the GeoTracker database over the Internet. Beginning July 1, 2005, these same reporting requirements were added to Spills, Leaks, Investigations, and Cleanup (SLIC) sites. Beginning July 1, 2005, electronic submittal of a complete copy of all reports for all sites is required in GeoTracker (in PDF format). Please visit the SWRCB website for more information on these requirements ([http://www.waterboards.ca.gov/water\\_issues/programs/ust/electronic\\_submittal/](http://www.waterboards.ca.gov/water_issues/programs/ust/electronic_submittal/)).

#### PERJURY STATEMENT

All work plans, technical reports, or technical documents submitted to ACEH must be accompanied by a cover letter from the responsible party that states, at a minimum, the following: "I declare, under penalty of perjury, that the information and/or recommendations contained in the attached document or report is true and correct to the best of my knowledge." This letter must be signed by an officer or legally authorized representative of your company. Please include a cover letter satisfying these requirements with all future reports and technical documents submitted for this fuel leak case.

#### PROFESSIONAL CERTIFICATION & CONCLUSIONS/RECOMMENDATIONS

The California Business and Professions Code (Sections 6735, 6835, and 7835.1) requires that work plans and technical or implementation reports containing geologic or engineering evaluations and/or judgments be performed under the direction of an appropriately registered or certified professional. For your submittal to be considered a valid technical report, you are to present site specific data, data interpretations, and recommendations prepared by an appropriately licensed professional and include the professional registration stamp, signature, and statement of professional certification. Please ensure all that all technical reports submitted for this fuel leak case meet this requirement.

#### UNDERGROUND STORAGE TANK CLEANUP FUND

Please note that delays in investigation, later reports, or enforcement actions may result in your becoming ineligible to receive grant money from the state's Underground Storage Tank Cleanup Fund (Senate Bill 2004) to reimburse you for the cost of cleanup.

#### AGENCY OVERSIGHT

If it appears as though significant delays are occurring or reports are not submitted as requested, we will consider referring your case to the Regional Board or other appropriate agency, including the County District Attorney, for possible enforcement actions. California Health and Safety Code, Section 25299.76 authorizes enforcement including administrative action or monetary penalties of up to \$10,000 per day for each day of violation.

<b>Alameda County Environmental Cleanup Oversight Programs (LOP and SLIC)</b>	<b>REVISION DATE:</b> July 20, 2010
	<b>ISSUE DATE:</b> July 5, 2005
	<b>PREVIOUS REVISIONS:</b> October 31, 2005; December 16, 2005; March 27, 2009; July 8, 2010
<b>SECTION:</b> Miscellaneous Administrative Topics & Procedures	<b>SUBJECT:</b> Electronic Report Upload (ftp) Instructions

The Alameda County Environmental Cleanup Oversight Programs (LOP and SLIC) require submission of all reports in electronic form to the county's ftp site. Paper copies of reports will no longer be accepted. The electronic copy replaces the paper copy and will be used for all public information requests, regulatory review, and compliance/enforcement activities.

## REQUIREMENTS

- **Please do not submit reports as attachments to electronic mail.**
- Entire report including cover letter must be submitted to the ftp site as **a single portable document format (PDF) with no password protection.**
- It is **preferable** that reports be converted to PDF format from their original format, (e.g., Microsoft Word) rather than scanned.
- **Signature pages and perjury statements must be included and have either original or electronic signature.**
- **Do not password protect the document.** Once indexed and inserted into the correct electronic case file, the document will be secured in compliance with the County's current security standards and a password. **Documents with password protection will not be accepted.**
- Each page in the PDF document should be rotated in the direction that will make it easiest to read on a computer monitor.
- Reports must be named and saved using the following naming convention:

RO#\_Report Name\_Year-Month-Date (e.g., RO#5555\_WorkPlan\_2005-06-14)

## Submission Instructions

- 1) Obtain User Name and Password
  - a) Contact the Alameda County Environmental Health Department to obtain a User Name and Password to upload files to the ftp site.
    - i) Send an e-mail to [deh.loptoxic@acgov.org](mailto:deh.loptoxic@acgov.org)
  - b) In the subject line of your request, be sure to include "**ftp PASSWORD REQUEST**" and in the body of your request, include the **Contact Information, Site Addresses,** and the **Case Numbers (RO# available in Geotracker) you will be posting for.**
- 2) Upload Files to the ftp Site
  - a) Using Internet Explorer (IE4+), go to <ftp://alcoftp1.acgov.org>
    - (i) Note: Netscape, Safari, and Firefox browsers will not open the FTP site as they are NOT being supported at this time.
  - b) Click on Page located on the Command bar on upper right side of window, and then scroll down to Open FTP Site in Windows Explorer.
  - c) Enter your User Name and Password. (Note: Both are Case Sensitive.)
  - d) Open "My Computer" on your computer and navigate to the file(s) you wish to upload to the ftp site.
  - e) With both "My Computer" and the ftp site open in separate windows, drag and drop the file(s) from "My Computer" to the ftp window.
- 3) Send E-mail Notifications to the Environmental Cleanup Oversight Programs
  - a) Send email to [deh.loptoxic@acgov.org](mailto:deh.loptoxic@acgov.org) notify us that you have placed a report on our ftp site.
  - b) Copy your Caseworker on the e-mail. Your Caseworker's e-mail address is the entire first name then a period and entire last name @acgov.org. (e.g., firstname.lastname@acgov.org)
  - c) The subject line of the e-mail must start with the RO# followed by **Report Upload.** (e.g., Subject: RO1234 Report Upload) If site is a new case without an RO#, use the street address instead.
  - d) If your document meets the above requirements and you follow the submission instructions, you will receive a notification by email indicating that your document was successfully uploaded to the ftp site.