



*Underground Contamination Investigations, Groundwater Consultants, Environmental Engineering*

October 13, 1997

Mr. Mike Bakaldin\Karl Busche  
San Leandro Fire Department  
Hazardous Materials Division  
835 East 14th Street  
San Leandro, California 94577

**TANK CLOSURE SUMMARY  
QUALITY TUNE-UP SHOP  
14901 E. 14TH STREET  
SAN LEANDRO, CA**

**Please consider this report a Final Tank Closure Report on the Quality Tune-Shop, located at 14901 East 14th Street, San Leandro, California.**

**On September 9, 1997, Applications for the removal of four (4) underground storage tanks were submitted to the San Leandro Fire Department, Hazardous Materials Division and The City of San Leandro Engineering and Transportation Department for approval. On September 12, 1997, approved permits were received from both San Leandro Agencies.**

**On September 15, 1997, John's Excavating, proceeded to uncover the underground storage tanks. There were a total of four underground storage tanks to be removed. 1.) Two (2) 10,000 gallon single wall steel tanks used to store automotive gasoline. 2.) One 5000 gallon single wall fiberglass tank used to store automotive gasoline and One (1) 500 gallon single wall steel tank used to store waste oil. By early afternoon September 15, 1997, all four tanks were uncovered emptied and ready to remove. On the morning of September 16, 1997, dry ice was introduced to all tanks, approximately 800 pounds of dry ice was used to inert all four tanks to be removed. At 11:30 A.M. the trucks from Erickson Co.**

arrived for transporting and disposal under manifest. Also at 11:30 A.M. Inspectors Karl Busche and Mike Bakaldin from the San Leandro Fire Department arrived to witness and inspect the tank removal and soil sampling procedures. A Gastech meter was used to confirm all tanks were at the appropriate LEL and Oxygen levels. At that time the two (2) 10,000 gallon tanks were removed one at a time and placed on the ground and inspected for any existing holes and possible deterioration of the steel. The tanks appeared to be in good condition with no visible holes. These two tanks were loaded on the trucks for transportation to the TSDF for salvage. Next the 5000 fiberglass tank was removed from the excavation and inspected for any holes or defects, none were found this tank was loaded for disposal. Last the 500 gallon tank was removed from the excavation and inspected for hole and rust. There appeared to be no holes in the waste oil tank. Copies of all Manifests are included in the Exhibit Section of this report.

The excavation was then cleared of excess soil and under the direction of Mr. Karl Busche, San Leandro Fire Department, Eight Discreet soil samples were taken from the tank excavation. The soil samples were taken from the side walls around the excavation at depths from 11 feet to 13 feet ( see site plan for sample locations) The samples were taken from the excavator bucket by pounding a 2" brass sample tube into the soil, the ends of the brass tubes were then covered with a Teflon material and a plastic cap was then place over each end of the tube. The samples were then placed on ice and transported to a DOHS Certified Laboratory for analysis. The spoils Pile , (the soil removed from the excavation prior to and after the tank removals) was also sampled to determine the proper disposal options or evaluate the option of the soil being used as part of the backfill material. There were Twelve (12) soil samples taken from the spoils pile, they were analyzed as three four point composite samples, these samples were also placed on ice for transportation to the laboratory for analysis. The spoils pile contained a estimated 280 cubic yards.

One soil sample was taken from the waste oil excavation and a four point composite sample of the waste oil spoils pile, as directed by Inspector Busche.

The soil samples were taken to Priority Environmental Labs for analysis: The Chain of Custody that accompanied the samples requested the following analysis: Samples from the gasoline excavation called for TPH, as gasoline, BTEX\MTBE. The waste oil sample analysis requested the following analysis: TEPH, Motor Oil, RCI, Five Luft Metals, Chlorinated Solvents by EPA Method 8010.

On Monday, September 22, 1997, a meeting with Mike Bakaldin, San Leandro Fire Department occurred at office of The San Leandro Fire Department, Hazardous Materials Division, to review the laboratory analysis of the soil samples taken during the tank removal. After reviewing the results of the laboratory

analysis it was agreed that any additional over-excavation would not be required based on the very low levels discovered in the excavation soil samples. The soil sample results of the spoils pile sampling were also reviewed in order to determine the proper disposition of the excavated soil. It was determined, based on the laboratory results the excavated soil ( approximately 300 cubic yards) could be used as backfill material along with imported engineered base rock from the Dumbarton Quarry. The laboratory analysis reports can be found in the exhibits section of this report.

Mr. Ray Silva, Engineering Inspector, was advised by telephone that backfilling of the excavation was going to start. The backfilling of the tank excavation took place on September 26, 1997. Compaction testing of the backfilling resulted in compaction of 95% . A copy of the compaction test results are included in the exhibit section of this report. The excavated area was restored with new asphalt the first Week of October and the project was completed.

Copies of all documents relating to this project can be found in the exhibit section.

This completes the summary of the tank closure performed at the Quality Tune-Up Shop, 14901 E. 14th Street, San Leandro, CA.

**LABORATORY ANALYSIS RESULTS**

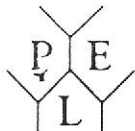

# PRIORITY ENVIRONMENTAL LABS

Precision Environmental Analytical Laboratory

September 19, 1997

PEL # 9709031

HAGEMAN - AGUIAR, INC.

Attn: Randal Wilson

Re: Eight soil samples for Gasoline/BTEX with MTBE analysis.

Project name: Quality - San Leandro

Date sampled: Sep 16, 1997

Date submitted: Sep 16, 1997

Date extracted: Sep 17-18, 1997

Date analyzed: Sep 17-18, 1997

**RESULTS:**

SAMPLE I.D.	Gasoline (mg/Kg)	MTBE (ug/Kg)	Benzene (ug/Kg)	Toluene (ug/Kg)	Ethyl Benzene (ug/Kg)	Total Xylene (ug/Kg)
Exc-B	34	N.D.	N.D.	N.D.	5.7	35
Exc-C	130	N.D.	59	39	71	240
Exc-D	N.D.	N.D.	N.D.	N.D.	N.D.	N.D.
Exc-E	N.D.	N.D.	N.D.	N.D.	N.D.	N.D.
Exc-F	N.D.	N.D.	N.D.	N.D.	N.D.	N.D.
Exc-G	N.D.	N.D.	N.D.	N.D.	N.D.	N.D.
Exc-H	N.D.	N.D.	N.D.	N.D.	N.D.	N.D.
Exc-J	N.D.	N.D.	N.D.	N.D.	N.D.	N.D.
Blank	N.D.	N.D.	N.D.	N.D.	N.D.	N.D.
Spiked Recovery	81.9%	---	83.7%	82.3%	90.7%	94.9%
Detection limit	1.0	5.0	5.0	5.0	5.0	5.0
Method of Analysis	5030/ 8015	8020	8020	8020	8020	8020

  
 David Duong  
 Laboratory Director





# PRIORITY ENVIRONMENTAL LABS

Precision Environmental Analytical Laboratory

September 19, 1997

PEL # 9709033

HAGEMAN - AGUIAR, INC.

Attn: Randal Wilson

Re: Three composited soil samples for Gasoline/BTEX with MTBE analysis.

Project name: Quality - San Leandro

Date sampled: Sep 15, 1997

Date submitted: Sep 16, 1997

Date extracted: Sep 17-18, 1997

Date analyzed: Sep 17-18, 1997

**RESULTS:**

SAMPLE I.D.	ESE (TABLE A) 100		3300		1500	
	Gasoline (mg/Kg)	MTBE (ug/Kg)	Benzene (ug/Kg)	Toluene (ug/Kg)	Ethyl Benzene (ug/Kg)	Total Xylene (ug/Kg)
Tanks-A, B, C, D	3.5	N.D.	N.D.	N.D.	N.D.	16
Tanks-E, F, G, H	N.D.	N.D.	N.D.	N.D.	N.D.	N.D.
Tanks-J, K, L, M	4.9	N.D.	N.D.	N.D.	8.5	12
Blank	N.D.	N.D.	N.D.	N.D.	N.D.	N.D.
Spiked Recovery	81.9%	---	83.7%	82.3%	90.7%	94.9%
Detection limit	1.0	5.0	5.0	5.0	5.0	5.0
Method of Analysis	5030/ 8015	8020	8020	8020	8020	8020

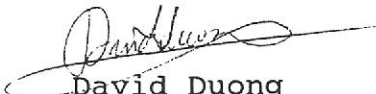
  
 David Duong  
 Laboratory Director

# PRIORITY ENVIRONMENTAL LABS

Chain of Custody

1764 Houret Ct. Milpitas, CA. 95035 Tel: 408-946-9636 Fax: 408-946-9663

DATE: 09/15/97 PAGE: 1 OF 1

PROJECT MGR.:				ANALYSIS REPORT										NUMBER OF CONTAINERS							
COMPANY: <u>Hageman - Aguiar</u>				PEL # 9709033 INV # 27933																	
ADDRESS:				TPH-Gasoline (EPA 5030.8015)	MTBE TPH-Gasoline(5030.8015) w/BTEX(EPA 602.8020)	TPH-Diesel (EPA 3510/3550.8015)	PURGEABLE AROMATICS BTEX (EPA 602.8020)	TOTAL OIL & GREASE (EPA 5520 C.D&F)	PESTICIDES/PCB (EPA 608.8080)	TOTAL RECOVERABLE HYDROCARBONS (EPA 418.1)	CHLORINATED HYDROCARBONS (EPA 601.8010)										
PHONE:																					
SIGNATURE: <u>Randal Wilson</u>																					
SAMPLE ID.	DATE	TIME	MATRIX																		
Tanks-A	09/15/97	16:00	Soil	<div style="display: flex; align-items: center;"> <div style="border-left: 2px solid black; border-right: 2px solid black; height: 100%; margin-right: 10px;"></div> <div style="font-size: 2em; margin-right: 10px;">}</div> <div style="text-align: center;">                     4 Point Composite Sample                 </div> </div>																	
Tanks-B	09/15/97	16:00	Soil																		
Tanks-C	09/15/97	16:00	Soil																		
Tanks-D	09/15/97	16:00	Soil																		
Tanks-E	09/15/97	16:00	Soil																		
Tanks-F	09/15/97	16:00	Soil																		
Tanks-G	09/15/97	16:00	Soil																		
Tanks-H	09/15/97	16:00	Soil																		
Tanks-J	09/15/97	16:00	Soil																		
Tanks-K	09/15/97	16:00	Soil																		
Tanks-L	09/15/97	16:00	Soil																		
Tanks-M	09/15/97	16:00	Soil																		
PROJECT INFORMATION				SAMPLE RECEIPT		RELINQUISHED BY:		RECEIVED BY:		RELINQUISHED BY:		RECEIVED BY:									
PROJECT NAME: <u>Quality San Leandro</u>				TOTAL # OF CONTAINERS <u>12</u>		SIGNATURE: <u>Randal Wilson</u>		SIGNATURE: <u>DAVID DUCRO</u>		SIGNATURE:		SIGNATURE:									
PROJECT NUMBER:				RECD. GOOD COND./COLD		Date: <u>09/16/97</u>		Date: <u>09/16/97</u>		Date:		Date:									
INSTRUCTIONS & COMMENTS:						Time: <u>16:35</u>		Time: <u>16:35</u>		Time:		Time:									
						COMPANY: <u>PEL</u>		COMPANY:		COMPANY:		COMPANY:									



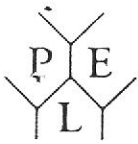

# PRIORITY ENVIRONMENTAL LABS

Precision Environmental Analytical Laboratory

September 18, 1997

PEL # 9709030

HAGEMAN\_AGUIAR, INC.

Attn: Randal Wilson

Re: One soil sample for Motor oil analysis.

Project name: Quality - San Leandro

Date sampled: Sep 16, 1997

Date submitted: Sep 16, 1997

Date extracted: Sep 16-17, 1997

Date analyzed: Sep 16-17, 1997

RESULTS:

SAMPLE I.D.	Motor Oil (mg/Kg)
W.O. Bottom	N.D.
Blank	N.D.
Detection limit	10
Method of Analysis	3550/8015

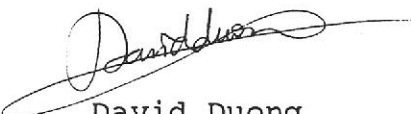
  
David Duong  
Laboratory Director



# PRIORITY ENVIRONMENTAL LABS

Precision Environmental Analytical Laboratory

September 22, 1997

PEL # 9709030

HAGEMAN - AGUIAR, INC.

Attn: Randal Wilson

Project name: Quality-San Leandro  
Sample I.D.: W.O Bottom

Date Sampled: Sep 16, 1997  
Date Analyzed: Sep 18-19, 1997

Date Submitted: Sep 16, 1997

Method of Analysis: EPA 8010

Detection limit: 5.0 ug/Kg

COMPOUND NAME	CONCENTRATION ( ug/Kg)	SPIKE RECOVERY (%)
Chloromethane	N.D.	-----
Vinyl Chloride	N.D.	-----
Bromomethane	N.D.	-----
Chloroethane	N.D.	-----
Trichlorofluoromethane	N.D.	-----
1,1-Dichloroethene	N.D.	-----
Methylene Chloride	N.D.	91.7
1,2-Dichloroethene (TOTAL)	N.D.	83.2
1,1-Dichloroethane	N.D.	-----
Chloroform	N.D.	-----
1,1,1-Trichloroethane	N.D.	89.9
Carbon Tetrachloride	N.D.	-----
1,2-Dichloroethane	N.D.	-----
Trichloroethene	N.D.	102.8
1,2-Dichloropropane	N.D.	-----
Bromodichloromethane	N.D.	-----
2-Chloroethylvinylether	N.D.	-----
Trans-1,3-Dichloropropene	N.D.	-----
Cis-1,3-Dichloropropene	N.D.	-----
1,1,2-Trichloroethane	N.D.	-----
Tetrachloroethene	N.D.	81.6
Dibromochloromethane	N.D.	-----
Chlorobenzene	N.D.	-----
Bromoform	N.D.	105.3
1,1,2,2-Tetrachloroethane	N.D.	-----
1,3-Dichlorobenzene	N.D.	-----
1,4-Dichlorobenzene	N.D.	-----
1,2-Dichlorobenzene	N.D.	-----

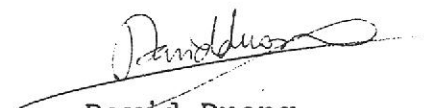

David Duong  
Laboratory Director



# PRIORITY ENVIRONMENTAL LABS

Precision Environmental Analytical Laboratory

September 22, 1997

PEL # 9709030

HAGEMAN - AGUIAR, INC.

Attn: Randal Wilson

Re: One soil sample for Cadmium, Chromium, Lead, Nickel, and Zinc analyses.

Project name: Quality - San Leandro

Date sampled: Sep 16, 1997

Date submitted: Sep 16, 1997

Date extracted: Sep 18-22, 1997

Date analyzed: Sep 18-22, 1997

## RESULTS:

SAMPLE I.D.	Cadmium (mg/Kg)	Chromium (mg/Kg)	Lead (mg/Kg)	Nickel (mg/Kg)	Zinc (mg/Kg)
W,O-Bottom	1.3	N.D.	3.1	61	10
Blank	N.D.	N.D.	N.D.	N.D.	N.D.
Detection limit	0.50	1.0	0.50	1.0	1.0
Method of Analysis	7130	7190	7420	7520	7950

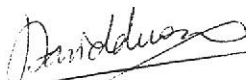
  
David Duong  
Laboratory Director

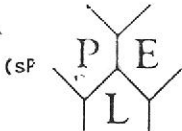

# PRIORITY ENVIRONMENTAL LABS

Precision Environmental Analytical Laboratory

September 20, 1997

PEL # 9709030

HAGEMAN - AGUIAR, INC.

Attn: Randal Wilson

Re: One soil sample for RCI analysis.

Project name: Quality - San Leandro

Date sampled: Sep 16, 1997

Date submitted: Sep 16, 1997

Date extracted: Sep 18-19, 1997

Date analyzed: Sep 18-19, 1997

RESULTS:

SAMPLE I.D.	REACTIVITY	CORROSIVITY	IGNITABILITY
W.O Bottom	NO	pH 5.0	NO
Blank	NO	pH 7.0	NO
Method of Analysis	Title 22, CCR 66261.23	Title 22, CCR 66261.22	Title 22, CCR 66261.21

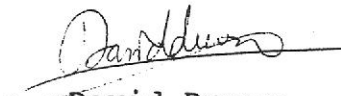
  
David Duong  
Laboratory Director

# PRIORITY ENVIRONMENTAL LABS

## Chain of Custody

1764 Houret Ct. Milpitas, CA. 95035 Tel: 408-946-9636 Fax: 408-946-9663

DATE: 09/16/97 PAGE: 1 OF 1

PROJECT MGR.: COMPANY: <i>Hageman - Aguiar</i> ADDRESS: PHONE: SIGNATURE: <i>Ronald Wilson</i>				ANALYSIS REPORT													
				TPH - Gasoline (EPA 50.30, 8015)	TPH - Gasoline (50.30, 8015) w/ BTEX (EPA 602, 8020)	TPH - Diesel (EPA 3510/3550, 8015)	PURGEABLE AROMATICS BTEX (EPA 602, 8020)	TOTAL OIL & GREASE (EPA 5520 C, D&F)	PESTICIDES/PCB (EPA 608, 8080)	TOTAL RECOVERABLE HYDROCARBONS (EPA 418.1)	CHLORINATED HYDROCARBONS (EPA 601, 8010)	TEPH Motor Oil	ACE	Solvents	PEL #	INV #	
SAMPLE ID.	DATE	TIME	MATRIX											9709030	27930		
<i>W.O. - BOTTOM</i>	<i>09/16/97</i>	<i>13:01</i>	<i>soil</i>							X	X	X	X		1		
												<i>Ronald Wilson 9/16/97 10:45</i>					
PROJECT INFORMATION				SAMPLE RECEIPT				RELINQUISHED BY:				RECEIVED BY: 1		RELINQUISHED BY: 2		RECEIVED BY: 2	
PROJECT NAME: <i>Quality - San Leandro</i>				TOTAL # OF CONTAINERS <i>1</i>				SIGNATURE: <i>Ronald Wilson</i>				SIGNATURE: <i>DAVID DUNE</i>		SIGNATURE:		SIGNATURE:	
PROJECT NUMBER:				RECD. GOOD COND./COLD				Date: <i>09/16/97 16:16</i>				Date: <i>09/16/97 16:16 pm</i>		Date:		Date:	
INSTRUCTIONS & COMMENTS:				COMPANY: <i>Hageman - Aguiar</i>				COMPANY: <i>PEL</i>				COMPANY:		COMPANY:			

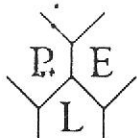

# PRIORITY ENVIRONMENTAL LABS

Precision Environmental Analytical Laboratory

September 18, 1997

PEL # 9709032

HAGEMAN\_AGUIAR, INC.

Attn: Randal Wilson

Re: One composited soil sample for Motor oil analysis.

Project name: Quality - San Leandro

Date sampled: Sep 15, 1997

Date submitted: Sep 16, 1997

Date extracted: Sep 16-17, 1997

Date analyzed: Sep 16-17, 1997

RESULTS:

*ESL(1766A) middle distillates  
100*

SAMPLE I.D.	Motor Oil (mg/Kg)
----------------	----------------------

W.O. - A & B	85
--------------	----

Blank	N.D.
-------	------

Detection limit	10
--------------------	----

Method of Analysis	3550/8015
-----------------------	-----------

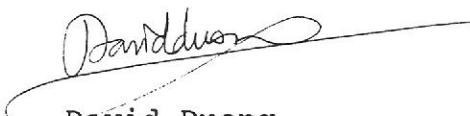
  
David Duong  
Laboratory Director

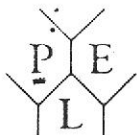

# PRIORITY ENVIRONMENTAL LABS

Precision Environmental Analytical Laboratory

September 22, 1997

PEL # 9709032

HAGEMAN - AGUIAR, INC.

Attn: Randal Wilson

Project name: Quality-San Leandro  
Sample I.D.: W.O- A&B\*

Date Sampled: Sep 15, 1997  
Date Analyzed: Sep 18-19, 1997

Date Submitted: Sep 16, 1997

Method of Analysis: EPA 8010

Detection limit: 5.0 ug/Kg

COMPOUND NAME	CONCENTRATION ( ug/Kg)	SPIKE RECOVERY (%)
Chloromethane	N.D.	-----
Vinyl Chloride	N.D.	-----
Bromomethane	N.D.	-----
Chloroethane	N.D.	-----
Trichlorofluoromethane	N.D.	-----
1,1-Dichloroethene	N.D.	-----
Methylene Chloride	N.D.	91.7
1,2-Dichloroethene (TOTAL)	N.D.	83.2
1,1-Dichloroethane	N.D.	-----
Chloroform	N.D.	-----
1,1,1-Trichloroethane	N.D.	89.9
Carbon Tetrachloride	N.D.	-----
1,2-Dichloroethane	N.D.	-----
Trichloroethene	N.D.	102.8
1,2-Dichloropropane	N.D.	-----
Bromodichloromethane	N.D.	-----
2-Chloroethylvinylether	N.D.	-----
Trans-1,3-Dichloropropene	N.D.	-----
Cis-1,3-Dichloropropene	N.D.	-----
1,1,2-Trichloroethane	N.D.	-----
Tetrachloroethene	N.D.	81.6
Dibromochloromethane	N.D.	-----
Chlorobenzene	N.D.	-----
Bromoform	N.D.	105.3
1,1,2,2-Tetrachloroethane	N.D.	-----
1,3-Dichlorobenzene	N.D.	-----
1,4-Dichlorobenzene	N.D.	-----
1,2-Dichlorobenzene	N.D.	-----

\*Composited soil sample.

David Duong  
Laboratory Director

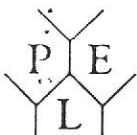

# PRIORITY ENVIRONMENTAL LABS

Precision Environmental Analytical Laboratory

September 22, 1997

PEL # 9709032

HAGEMAN - AGUIAR, INC.

Attn: Randal Wilson

Re: One composited soil sample for Cadmium, Chromium, Lead, Nickel, and Zinc analyses.

Project name: Quality - San Leandro

Date sampled: Sep 15, 1997

Date submitted: Sep 16, 1997

Date extracted: Sep 18-22, 1997

Date analyzed: Sep 18-22, 1997

## RESULTS:

SAMPLE I.D.	Cadmium (mg/Kg)	Chromium (mg/Kg)	Lead (mg/Kg)	Nickel (mg/Kg)	Zinc (mg/Kg)
W,O-A&B	2.0	2.5	4.8	110	18
Blank	N.D.	N.D.	N.D.	N.D.	N.D.
Detection limit	0.50	1.0	0.50	1.0	1.0
Method of Analysis	7130	7190	7420	7520	7950

David Duong  
Laboratory Director



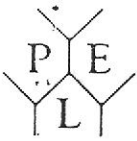

# PRIORITY ENVIRONMENTAL LABS

Precision Environmental Analytical Laboratory

September 20, 1997

PEL # 9709032

HAGEMAN - AGUIAR, INC.

Attn: Randal Wilson

Re: One composited soil sample for RCI analysis.

Project name: Quality - San Leandro

Date sampled: Sep 15, 1997

Date submitted: Sep 16, 1997

Date extracted: Sep 18-19, 1997

Date analyzed: Sep 18-19, 1997

RESULTS:

SAMPLE I.D.	REACTIVITY	CORROSIVITY	IGNITABILITY
W.O-A&B	NO	pH 5.2	NO
Blank	NO	pH 7.0	NO
Method of Analysis	Title 22, CCR 66261.23	Title 22, CCR 66261.22	Title 22, CCR 66261.21

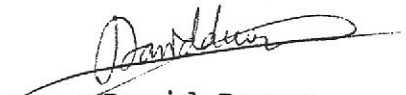
  
David Duong  
Laboratory Director



HESPERIAN BLVD

EAST 14th STREET

150th AVENUE

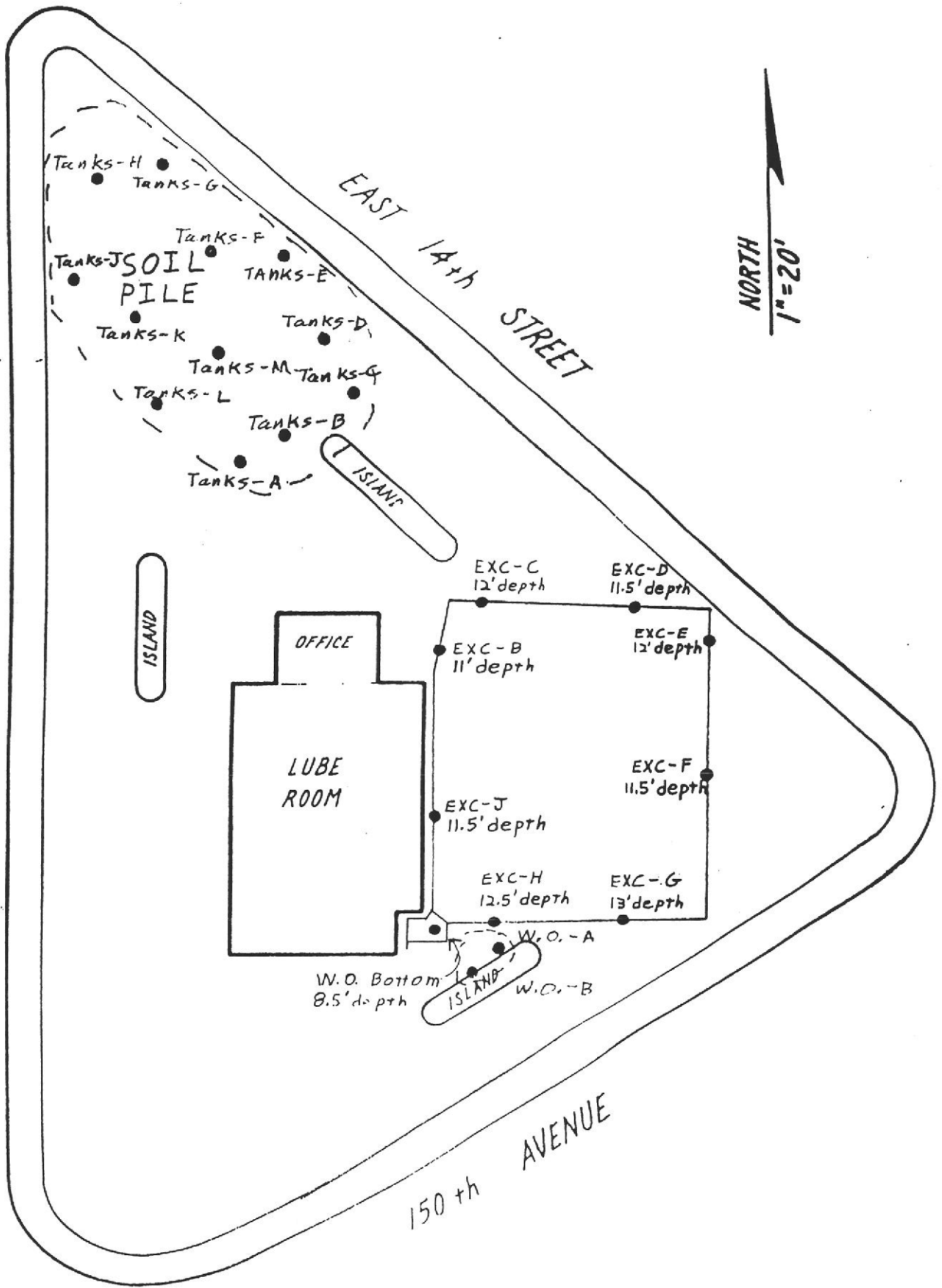

- Tanks-H
- Tanks-G
- Tanks-F
- Tanks-E
- Tanks-D
- Tanks-C
- Tanks-B
- Tanks-A
- Tanks-J
- Tanks-I
- Tanks-K
- Tanks-L
- Tanks-M
- Tanks-N

SOIL PILE

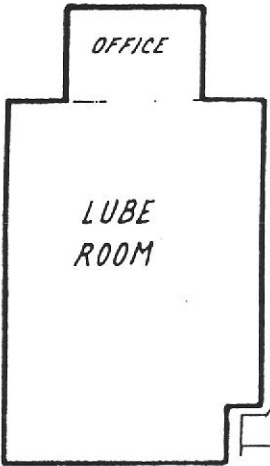

- EXC-C 12' depth
- EXC-D 11.5' depth
- EXC-E 12' depth
- EXC-F 11.5' depth
- EXC-G 13' depth
- EXC-H 12.5' depth
- EXC-J 11.5' depth
- EXC-B 11' depth

- W.O. Bottom 8.5' depth
- W.O.-A
- W.O.-B

ISLAND

ISLAND

ISLAND

**DOCUMENTS\MANIFESTS**

CITY OF SAN LEANDRO  
ENGINEERING AND TRANSPORTATION DEPARTMENT  
835 EAST 14th STREET  
SAN LEANDRO, CA 94577  
(510) 577-3428

**EXCAVATION/GRADING PERMIT**

**Permit Num.: EAG97019**

Project Address: 14901 E 14TH ST  
Assess. Parcel #: 077D149900100

Issued: 09/09/97  
To Expire: 10/14/97  
CN: 11247

Job Description: UNDERGROUND STORAGE TANK (5)  
REMOVAL AND ASPHALT PAVING

Applicant: DIANA PAGANO  
Address : 6912 BROADWAT TERRACE  
OAKLAND, CA 94611-1184  
Phone : (510) 547-0581

Owner : PAGANO DIANA M  
Address: 6912 BROADWAY TR  
OAKLAND CA 94611

Phone :

ENGINEER : GARY AGUIAR  
3732 MT. DIABLO BLVD.  
LAFAYETTE, CA94549  
CONTRACTOR : JOHN PAULSON  
1128 HALYARD DRIVE  
SANTA ROSA, CA 94501

Lic. E 34262 510 284-1661  
GARY AGUIAR  
Lic. C 361828 707 578-1184  
JOHN PAULSON

List of Resp'ble Engr's:  
DESIGN ENGINEER (A): GARY AGUIAR  
ENG'R FOR GRADING (B): GARY AGUIAR  
ENG'R FOR INSP/TEST (C): GARY AGUIAR

Anticipated Start Date : 09-15-97  
Anticipated Compl. Date: 09-20-97

Engineering Inspector : KEN HAMNER ✓  
Inspector's Phone No. : (510) 577-3304

Fee description	Units	Fee/Unit	Ext fee	Data
PLAN CHECK AND INSPECTION DEPOSIT				
HOURS REQ'D TO REVIEW (CN _____):	12.00	75.00	900.00	
PERMIT ISSUANCE FEE (ACC'T #3311):			50.00	
<b>TOTAL GRADING PERMIT FEES:</b>			<b>950.00</b>	

**RECEIVED**  
CITY OF SAN LEANDRO  
SEP 12 1997  
ENGR / TRANS

Total Payed: 950.00  
Credits : .00  
Adjustments: .00  
BALANCE DUE: .00

Applicant Signature: *[Signature]*  
Issued for City by : *[Signature]*

Date: SEP. 12, 1997  
Date: SEP 10, 1997

CITY OF SAN LEANDRO  
ENGINEERING AND TRANSPORTATION DEPARTMENT  
835 EAST 14th STREET  
SAN LEANDRO, CA 94577  
(510) 577-3428

EXCAVATION/GRADING PERMIT

Permit Num.: EAG97019

Project Address: 14901 E 14TH ST  
(Continued)

Issued: 09/09/97

Fee description	Units	Fee/Unit	Ext fee	Data
-----				
Desc/date      Act    Inspector      Comments				
CLEAR AND GRUB				** No Entries **
ROUGH GRADING				** No Entries **
COMPACTION				** No Entries **
EROSION CONTROL IN PLACE				** No Entries **
FINISH GRADING				** No Entries **
GRADING COMPLETED				** No Entries **

Comments:    SEE ATTACHED

**ENGINEERING AND TRANSPORTATION DEPARTMENT  
GRADING PERMIT NO. EAG97019  
14901 E. 14TH STREET**

Description of work:

Excavate, remove and dispose of five (5) underground storage tanks and backfill, compact and asphalt pave excavated area.

Prior to commencement of any work, the applicant shall comply with the following requirements and conditions:

1. Permittee shall comply to the attached "General Requirements Applicable for all Grading Work Unless Modified by the City Engineer".
2. Erosion and sediment control measures shall be completely in place prior to start of any work and shall be maintain throughout the course of the work, to the satisfaction of the City Engineer.
3. Provide fencing around the construction site and install filter fabric along the bottom three (3) feet of the fence. One (1) foot of the fabric shall be buried in the soil or hay bales can be placed on top of the fabric, adjacent to the fencing, to help keep the fabric in place and filter any runoff.
4. No loading and unloading of trucks is allowed on public streets during the construction operations. If trucks will be loaded on site on an unpaved area, a gravel construction driveway shall be built prior to the start of construction. Contractor shall prevent any dirt, mud, or debris from being tracked onto public streets from the grading and paving operations permitted hereunder.
5. All catch basins within the work area and the nearest off-site catch basin(s) shall be protected with either hay bales, filter fabric, silt sacks or other method as approved by the City Engineer, to prevent silt and debris from entering the on-site and off-site storm drain systems.
6. Water trucks shall be on-site at all times during the construction operations to eliminate dust from migrating off-site.
7. No grading work shall be done during the wet season (October 15 through April 15) unless specifically permitted in writing by the City Engineer.

General Requirements Applicable For All Grading Work Unless Modified By The City Engineer

The following shall apply to all grading work unless otherwise specified in the Soils Report and Grading Plan by the Applicant's Civil Engineer in Charge which has been approved by the City Engineer or his duly authorized representative:

- 1) Grading, erosion control, sedimentation and pollutant control work shall be done in accordance with plans hereinbefore described.
- 2) No grading work shall be done during the wet season (October 15th through April 15th inclusive) unless specifically permitted in writing by the City Engineer.
- 3) Temporary erosion and sedimentation control facilities shall be in place and operational prior to October 15th, and shall be diligently maintained to ensure effectiveness through April 15th.
- 4) The hours of grading operations shall be only between 7:00 a.m. to 6:00 p.m. (Monday-Saturday) unless otherwise specified by the City Engineer or his authorized representative. No grading shall be done on Sundays except if authorized by the City Engineer for reason of public safety.
- 5) No Clearing and grubbing shall take place on any site for which a Grading Permit is required prior to the issuance of valid Grading Permit.
- 6) Where a Tree Removal Permit is required, no tree removal shall take place if a Grading Permit is required until both permits have been granted.
- 7) No grading shall be approved on properties adjacent to the site being graded without the written permission of the adjacent property owner. Such written permission shall be notarized and acknowledged and presented to the City Engineer as part of the items required with the application for Grading Permit.
- 8) The rate of slope of the surface of permanent fill slopes shall not be steeper than two to one and the rate of slope of permanent cut slopes shall not be steeper than one and one-half to one, unless otherwise recommended in the Soils Report and approved in writing by the City Engineer.
- 9) Drainage facilities shall be provided to convey storm waters to a natural watercourse, swale or other drainage way, or to a public storm drainage system at locations and in a manner satisfactory to the City Engineer. Adequate measures shall be taken to control storm waters during grading operations. The quality of storm water from the site shall be as required in the "Storm Water Management and Discharge Control Program Ordinance." The current "Storm Water Quality Controls for New Developments in Santa Clara Valley and Alameda County," otherwise known as the Best Management Practices Manual, shall serve as a guide to achieving the required storm water quality.
- 10) Erosion control shall include planting of all graded areas to be left exposed to the elements in accordance with the planned maintenance of such areas.
- 11) No grading shall be done which will cause sloughing of materials from or onto adjoining property.
- 12) Permittee shall not dump, move or place any earth, sand, gravel, rock, stone or other excavated material or debris so as to cause the same to be deposited upon or to roll, flow or wash upon or over any public place or way, or upon or over the premises of another, without the express consent of the owner of such premises so affected.
- 13) Permittee shall not, when hauling any earth, sand, gravel, rock, stone, or other excavated material or debris over any public street, alley or other public place, allow such material to blow, spill, or by any other means be deposited over and upon such street, alley, or place or adjacent private property.
- 14) If due to a violation of items 12 and 13 of this section, any earth, sand, gravel, rock, stone or other excavated material or debris is caused to be deposited upon or to roll, flow or wash upon any public place or way, the Permittee shall cause the same to be removed from such public place or way within thirty-six (36) hours of said violation. In the event it is not so removed, the City Engineer shall cause such removal and the cost of such removal by the City Engineer shall be paid to the City by the Permittee who failed to so remove the material.
- 15) Permittee shall not excavate on land sufficiently close to the property line to endanger any adjoining public street, sidewalk, alley or other public property without supporting and protecting such public street, sidewalk, alley, or other public property from settling, cracking, or other damage which might result from such excavation. Should the nature of the excavation, in the opinion of the City Engineer, create a hazard to life unless adequately fenced, the Permittee shall construct such fences or guard rails to safeguard persons using the public street, sidewalk, alley or other public property as the City Engineer may require.
- 16) If at any stage of work on an excavation or fill the City Engineer determines by inspection that the nature of the formation is such that further work as authorized by an existing permit is likely to endanger any property or public way the City Engineer may require as a condition to allowing further work to be done that such reasonable safety precautions be taken as the City Engineer considers necessary to avoid such likelihood of danger. Such safety precautions may include, but shall not be limited to, specifying a flatter exposed slope construction of additional drainage facilities, berms, terracing, compaction or cribbing.
- 17) The use of explosives for any grading excavation application is expressly prohibited unless approve in writing by the City Engineer and Fire Marshall.
- 18) Prior to commencement of the work, Applicant shall obtain all other permits as required from other regulatory agencies. Such other agencies may include, but are not limited to, OSHA, Bay Area Air Quality Management District (BAAQMD).





HESPERIAN BLVD

QUALITY TUNE LIP  
14901 EAST 14TH STREET

EAST 14th STREET

150th AVENUE

LEGEND

- RECENT "GEOPROBE" LOCATION
- ⊗ PREVIOUS SOIL BORING

NORTH  
1" = 20'

AREA TO BE PAVED

2" ASPHALT OVER APPROXIMATELY  
1600 SQUARE FEET

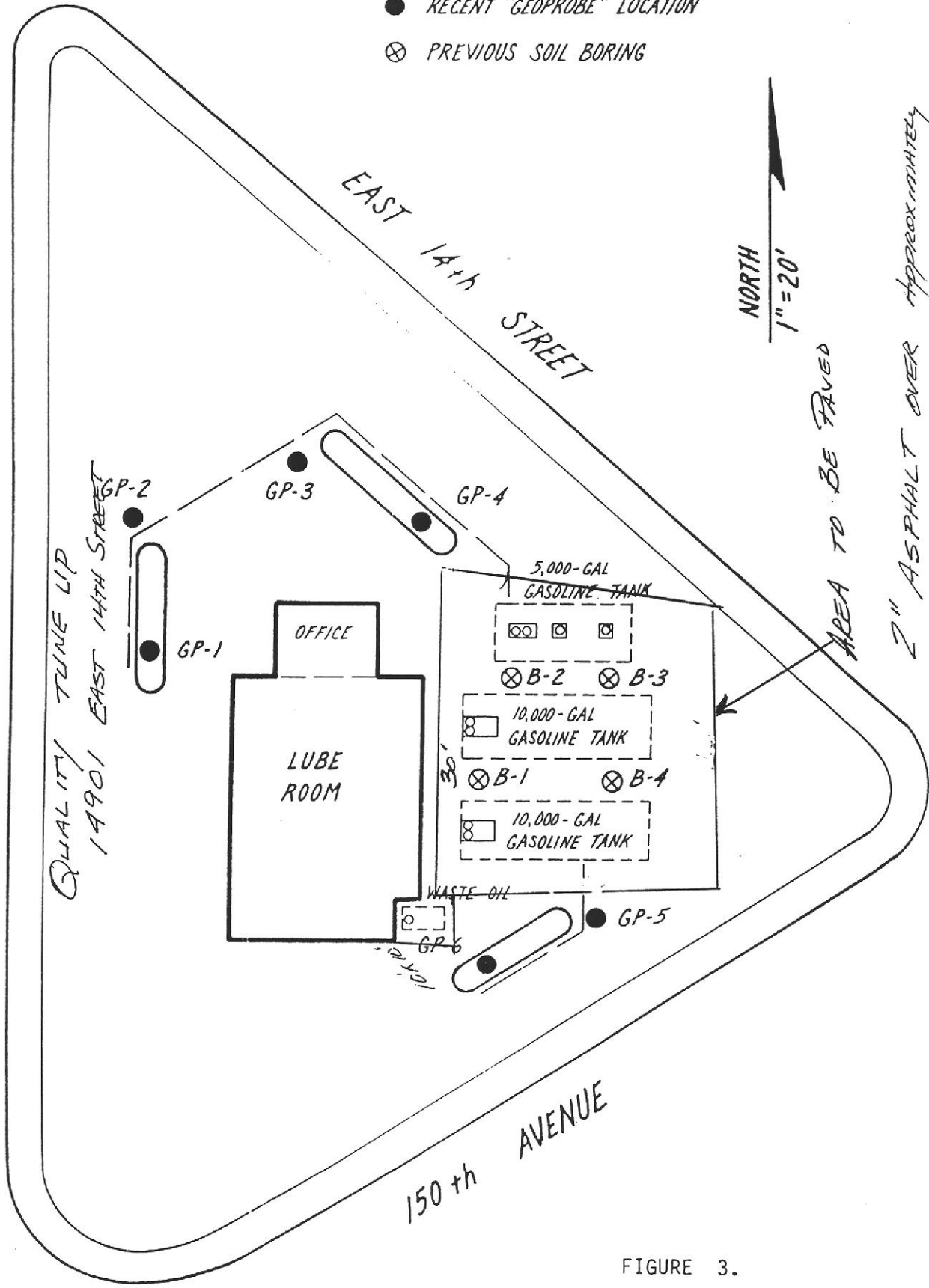

FIGURE 3.  
Boring Locations.



**BAY AREA AIR QUALITY  
MANAGEMENT DISTRICT**

339 ELLIS STREET  
SAN FRANCISCO, CALIFORNIA 94109  
(415) 771-6000

REGULATION 8, RULE 40  
Aeration of Contaminated Soil and  
Removal of Underground Storage Tanks

NOTIFICATION FORM

- Removal or Replacement of Tanks
- Excavation of Contaminated Soil

9-11-97

**SITE INFORMATION**

SITE ADDRESS 14901 E. 14<sup>th</sup> STREET  
 CITY, STATE, ZIP SAN LEANIDRO, CA 94577  
 OWNER NAME DIANA PAGANO  
 SPECIFIC LOCATION OF PROJECT N.W.C. E 14<sup>th</sup> ST AT HESPERIAN

TANK REMOVAL

CONTAMINATED SOIL EXCAVATION

SCHEDULED STARTUP DATE 9-15-97 SCHEDULED STARTUP DATE 9-16-97  
 VAPORS REMOVED BY: DATE CHANGE STOCKPILES WILL BE COVERED? YES X NO       
 WATER WASH ALTERNATIVE METHOD OF AERATION (DESCRIBE BELOW):  
 VAPOR FREEING (CO<sup>2</sup>)  
 VENTILATION  
 (MAY REQUIRE PERMIT)

**CONTRACTOR INFORMATION**

NAME JOHN'S EXCAVATING CONTACT JOHN PULSO  
 ADDRESS 1128 HAYWARD DRIVE PHONE (707) 578-1164  
 CITY, STATE, ZIP SANTA ROSA, CA 94521

**CONSULTANT INFORMATION  
(IF APPLICABLE)**

NAME HAGEMAN-AGUIAR CONTACT BRUCE HAGEMAN  
 ADDRESS 3732 MT. DIABLO BLVD PHONE (50) 264-1661  
 CITY, STATE, ZIP LAFAYETTE, CA 94549

**FOR OFFICE USE ONLY**

DATE RECEIVED \_\_\_\_\_ BY \_\_\_\_\_ (INIT.)  
 CC: INSPECTOR NO. \_\_\_\_\_ DATE \_\_\_\_\_ BY \_\_\_\_\_ (INIT.)  
 TELEPHONE UPDATE: CALLER \_\_\_\_\_ CHANGE MADE \_\_\_\_\_  
 BAAQMD N # \_\_\_\_\_

- o Soil aerations do not require a BAAQMD permit unless the project exceeds three months time or if an alternative method to spreading the soil for evaporation will be used.
- o Revisions to the information stated in this notice may be made by telephone.
- o If the project is delayed (for no more than five working days), you may notify the District by telephone of the new startup date.

**INSTRUCTIONS:**

Specific Location of Project: Indicate where the tank removal or soil excavation is taking place.

Examples: Northwest corner of Gas Station lot  
Pit D of South Excavation area  
Fuel storage area north of Auxiliary Road

Scheduled Startup Date: Indicate a correct and accurate startup date, not a prospective date. If this date is delayed (by no more than five working days) telephone the District at (415) 771-6000, extension 300, to report the new startup date.

Tank Removal: Indicate what type method will be used to remove vapors after tank is emptied of product. (Tanks must have all liquids and sludges removed to the extent possible before decommissioning.)

Soil Excavation: Indicate whether contaminated soil stockpile is covered. Indicate the average degree of contamination of the stockpile (samples taken from the pile, not from excavated hole). Indicate how many cubic yards are to be spread daily (see Table I in Section 8-40-301 for limitations). If an alternative method of aeration will be used (e.g., forced air), briefly describe.

Contractor Information: Indicate the name, address, appropriate contact person and phone number of the contractor performing and responsible for the tank removal and/or soil excavation.

Consultant Information: If applicable, indicate the name, address, appropriate contact person and phone number of any environmental consultant used.

Return this form to:

Bay Area Air Quality Management District  
939 Ellis Street  
San Francisco, CA 94109  
Attn: Enforcement Division

Reviewed By KB  
 Approval Date \_\_\_\_\_  
 Rejection Date \_\_\_\_\_

San Leandro Fire Department  
 Hazardous Materials Division  
 835 East 14th Street  
 San Leandro, CA 94577  
 (415) 577-3331

Rev 4/91  
 Date Received 9/09  
 Fees Paid 720.

UNDERGROUND STORAGE TANK CLOSURE PLAN/PERMIT

- Facility Name: QUALITY TUNE-UP Address: 14901 EAST 14<sup>th</sup> ST. S.L.  
 Contact Person: DIANNA PAGANO Phone No.: (510) 547-0581  
 Generator's U.S. EPA Number: CAC 001-151-216
- Contractor: JOHN PULSON License Type & No.: GEN "A" 361 628  
 Address: 1128 HALLYARD DRIVE, SANTA ROSA, CA, 94501  
 Contact Person: BRUCE HAGEMAN Phone No.: (510) 284-1661
- Sampling to be performed by: HAGEMAN-AGUIAR, INC. Phone No.: (510) 284-1661
- Laboratory services to be provided by: PRIORITY ENVIRONMENTAL LABS  
 DOHS Certificate No.: \_\_\_\_\_ Phone No.: \_\_\_\_\_
- Tank Hauler: ERICKSON ENVIRONMENTAL EPA ID No.: CHD 009466392  
 Address: 255 FARR BLVD, RICHMOND, CA Phone No.: (510) 235-1393  
 Destination of Tank(s): ERICKSON, INC. 255 FARR BLVD. RICHMOND, CA
- Method of inerting tank(s): DRY PIPE 30 LBS PER 1000 GAL CAPACITY
- Type of explosimeter or combustible gas meter to be provided: GASTECH
- Tanks to be removed:

	Size	Content	Material of Construction	Age	Sample Analysis Method
Tank 1	10,000	GASOLINE	<del>STEEL</del> 1/2" BOARDS	25+	TPH, GASOLINE (5030) BTXE, MTBE (8020)
Tank 2	10,000	GASOLINE	STEEL	25+	" " "
Tank 3	10,000	GASOLINE	STEEL	25+	" " "
Tank 4	500	WASTE OIL	STEEL	25+	" " "
Piping	2"	GASOLINE	STEEL UNWRAPPED	25+	TPH, GASOLINE (5030) BTXE, MTBE (8020)

I acknowledge receipt and agree to comply with the San Leandro Fire Department Underground Storage Tank Closure Requirements. I declare under penalty of perjury that the aforementioned information is true and correct, to the best of my knowledge.

Company Name: HAGEMAN-AGUIAR, INC. Address: 3732 MT. DIABLO BLVD. LAFAYETTE  
 Applicant's Signature [Signature] Date 8-22-97  
 Number of Tanks Removed 4 Inspector [Signature] Date 9/10/07

IN CASE OF EMERGENCY OR SPILL, CALL THE NATIONAL RESPONSE CENTER 1-800-424-8802; WITHIN CALIFORNIA, CALL 1-800-852-7550

UNIFORM HAZARDOUS WASTE MANIFEST		1. Generator's US EPA ID No.		Manifest Document No.		2. Page 1 of 1		Information in the shaded areas is not required by Federal law.			
3. Generator's Name and Mailing Address <i>Edrickson Inc. 2912 Blvd of Commerce, Richmond, CA 94801</i>				A. State Manifest Document Number <b>96415765</b>		B. State Generator's ID					
4. Generator's Phone <i>(510) 547-0581</i>				C. State Transporter's ID		D. Transporter's Phone <i>(204) 949-1181</i>					
5. Transporter 1 Company Name <i>Edrickson Inc.</i>		6. US EPA ID Number <i>CAD009466392</i>		E. State Transporter's ID		F. Transporter's Phone					
7. Transporter 2 Company Name		8. US EPA ID Number		G. State Facility's ID		H. Facility's Phone <i>(510) 235-1393</i>					
9. Designated Facility Name and Site Address <i>Edrickson, Inc. 255 Parr Blvd. Richmond, CA 94801</i>				10. US EPA ID Number <i>CAD009466392</i>							
11. US DOT Description (including Proper Shipping Name, Hazard Class, and ID Number)						12. Containers	13. Total Quantity	14. Unit Wt/Vol	I. Waste Number		
a. <i>NON-PCRA Hazardous Waste Solid Waste - Empty Storage Tank.</i>						No. <i>002</i>	Type <i>EM</i>	<i>105800</i>	P	State <i>512</i>	
b.										EPA/Other <i>NONE</i>	
c.										State	
d.										EPA/Other	
J. Additional Descriptions for Materials Listed Above <i>Qty. 2 Empty Storage Tank(s) # 20974 20975 Tank(s) have been inerted with 15 lbs. Dry Ice Per 1000 Gallon Capacity.</i>						K. Handling Codes for Wastes Listed Above					
						a.		b.			
						c.		d.			
15. Special Handling Instructions and Additional Information <i>Keep away from sources of ignition. Always wear hard hats when working around U.G.S.T.'s 24 Hr. Contact Name: Edrickson Phone: 1-800-852-0978</i>											
16. GENERATOR'S CERTIFICATION: I hereby declare that the contents of this consignment are fully and accurately described above by proper shipping name and are classified, packed, marked, and labeled, and are in all respects in proper condition for transport by highway according to applicable international and national government regulations.  If I am a large quantity generator, I certify that I have a program in place to reduce the volume and toxicity of waste generated to the degree I have determined to be economically practicable and that I have selected the practicable method of treatment, storage, or disposal currently available to me which minimizes the present and future threat to human health and the environment; OR, if I am a small quantity generator, I have made a good faith effort to minimize my waste generation and select the best waste management method that is available to me and that I can afford.											
Printed/Typed Name <i>[Signature]</i>				Signature <i>[Signature]</i>				Month	Day	Year	
								<i>09</i>	<i>16</i>	<i>97</i>	
17. Transporter 1 Acknowledgement of Receipt of Materials											
Printed/Typed Name <i>BRIAN L. MCKINLEY</i>				Signature <i>[Signature]</i>				Month	Day	Year	
								<i>09</i>	<i>16</i>	<i>97</i>	
18. Transporter 2 Acknowledgement of Receipt of Materials											
Printed/Typed Name				Signature				Month	Day	Year	
19. Discrepancy Indication Space											
20. Facility Owner or Operator Certification of receipt of hazardous materials covered by this manifest except as noted in Item 19.											
Printed/Typed Name				Signature				Month	Day	Year	

DO NOT WRITE BELOW THIS LINE.

50413144  
 IN CASE OF EMERGENCY OR SPILL, CALL THE NATIONAL RESPONSE CENTER 1-800-424-8802; WITHIN CALIFORNIA, CALL 1-800-852-7550

<b>UNIFORM HAZARDOUS WASTE MANIFEST</b>		1. Generator's US EPA ID No. CA0001151216	Manifest Document No. 15774	2. Page 1 1 of 1	Information in the shaded areas is not required by Federal law.	
3. Generator's Name and Mailing Address <i>D... ..</i>			A. State Manifest Document Number <b>96415744</b>		B. State Generator's ID	
4. Generator's Phone (510) 57-0541			C. State Transporter's ID		D. Transporter's Phone (510) 235-1993	
5. Transporter 1 Company Name <i>ELKSON</i>		6. US EPA ID Number CA0001946392		E. State Transporter's ID		F. Transporter's Phone
7. Transporter 2 Company Name		8. US EPA ID Number		G. State Facility's ID		H. Facility's Phone (510) 235-1393
9. Designated Facility Name and Site Address <i>ELKSON, INC. 255 Parr Blvd. Richmond, CA 94801</i>		10. US EPA ID Number CA0009466392		I. Waste Number Stat 512 EPA <i>TRINE</i>		State
11. US DOT Description (including Proper Shipping Name, Hazard Class, and ID Number)		12. Containers No. Type	13. Total Quantity	14. Unit Wt/Val	EPA/Other	
a. <i>NON-RCRA Hazardous Waste Solid Waste Empty Storage Tank.</i>		0 0 2 T P	<i>12-00</i> <del>15000</del>	P	State	
b.					EPA/Other	
c.					State	
d.					EPA/Other	
J. Additional Descriptions for Materials Listed Above <i>Qty. 2 Empty Storage Tank(s) # 2076, 2077 Tank(s) have been inerted with 15 lbs. Dry Ice Per 1000 Gallon Capacity.</i>			K. Handling Codes for Wastes Listed Above			
			a.		b.	
			c.		d.	
15. Special Handling Instructions and Additional Information <i>Keep away from sources of ignition. Always wear hardhats when working around U.G.S.T.'s 24 Hr. Contact Name: <i>ELKSON</i> Phone: <i>510-235-1993</i></i>						
16. GENERATOR'S CERTIFICATION: I hereby declare that the contents of this consignment are fully and accurately described above by proper shipping name and are classified, packed, marked, and labeled, and are in all respects in proper condition for transport by highway according to applicable international and national government regulations.  If I am a large quantity generator, I certify that I have a program in place to reduce the volume and toxicity of waste generated to the degree I have determined to be economically practicable and that I have selected the practicable method of treatment, storage, or disposal currently available to me which minimizes the present and future threat to human health and the environment; OR, if I am a small quantity generator, I have made a good faith effort to minimize my waste generation and select the best waste management method that is available to me and that I can afford.						
Printed/Typed Name		Signature		Month	Day	Year
<i>[Signature]</i>		<i>[Signature]</i>		11	16	97
17. Transporter 1 Acknowledgement of Receipt of Materials		Signature		Month	Day	Year
Printed/Typed Name		<i>[Signature]</i>		07	12	97
18. Transporter 2 Acknowledgement of Receipt of Materials		Signature		Month	Day	Year
Printed/Typed Name						
19. Discrepancy Indication Space						
20. Facility Owner or Operator Certification of receipt of hazardous materials covered by this manifest except as noted in Item 19.						
Printed/Typed Name		Signature		Month	Day	Year

DO NOT WRITE BELOW THIS LINE.

IN CASE OF EMERGENCY OR SPILL, CALL THE NATIONAL RESPONSE CENTER 1-800-424-8802; WITHIN CALIFORNIA, CALL 1-800-852-7550

<b>UNIFORM HAZARDOUS WASTE MANIFEST</b>		1. Generator's US EPA ID No. <b>CAG00115121617939</b>		Manifest Document No. <b>1 of 1</b>		2. Page 1 <b>1 of 1</b>		Information in the shaded areas is not required by Federal law.							
3. Generator's Name and Mailing Address <b>Bruce Hageman 3732 Mt Diablo Blvd Suite 37</b>						A. State Manifest Document Number <b>96740139</b>									
4. Generator's Phone (510) 284-1661 Lafayette, Ca 94549						B. State Generator's ID									
5. Transporter 1 Company Name <b>American Inc</b>				6. US EPA ID Number <b>NUD982358483</b>		C. State Transporter's ID									
7. Transporter 2 Company Name						D. Transporter's Phone <b>408-432-0333</b>									
8. US EPA ID Number						E. State Transporter's ID									
9. Designated Facility Name and Site Address <b>BC Stocking Distributors 7300 Chevron Way Dixon, Ca 95620</b>						10. US EPA ID Number <b>CAT080012602</b>									
11. US DOT Description (including Proper Shipping Name, Hazard Class, and ID Number)						12. Containers		13. Total Quantity		14. Unit Wt/Vol		1. Waste Number			
a. <b>Non RCRA Hazardous Waste Liquid (oil + water)</b> b. c. d.						No.		Type				State			
						00		TT		2350		G		2472	
														EPA/Other	
														State	
														EPA/Other	
J. Additional Descriptions for Materials Listed Above						K. Handling Codes for Wastes Listed Above									
a. <b>non DOT Regulated</b>						a. <b>14/01</b>		b.		c.		d.			
15. Special Handling Instructions and Additional Information <b>Wear Gloves Emergency Phone ER Guide 171 800-477-2105</b>						<b>Received at American Inc DBA Petroleum Recovery Inc Silene Springs, NU 89429</b>									
16. GENERATOR'S CERTIFICATION: I hereby declare that the contents of this consignment are fully and accurately described above by proper shipping name and are classified, packed, marked, and labeled, and are in all respects in proper condition for transport by highway according to applicable international and national government regulations.										If I am a large quantity generator, I certify that I have a program in place to reduce the volume and toxicity of waste generated to the degree I have determined to be economically practicable and that I have selected the practicable method of treatment, storage, or disposal currently available to me which minimizes the present and future threat to human health and the environment; OR, if I am a small quantity generator, I have made a good faith effort to minimize my waste generation and select the best waste management method that is available to me and that I can afford.					
Printed/Typed Name <b>John Baker for</b>				Signature <i>[Signature]</i>				Month Day Year <b>09/17/97</b>							
17. Transporter 1 Acknowledgement of Receipt of Materials				Signature <i>[Signature]</i>				Month Day Year <b>09/15/97</b>							
18. Transporter 2 Acknowledgement of Receipt of Materials				Signature				Month Day Year							
19. Discrepancy Indication Space <b>#3 1905 gal</b>															
20. Facility Owner or Operator Certification of receipt of hazardous materials covered by this manifest except as noted in Item 19.															
Printed/Typed Name <b>GEORGE E FADLEY</b>				Signature <i>[Signature]</i>				Month Day Year <b>09/17/97</b>							

DO NOT WRITE BELOW THIS LINE.

Yellow: TSDf SENDS THIS COPY TO GENERATOR WITHIN 30 DAYS.  
 (Generators who submit hazardous waste for transport out-of-state, produce completed copy of this copy and send to DTSC within 30 days.)





Testing Engineers, Inc.

Quality Assurance Services  
 Materials Consulting  
 Since 1954

PROJECT NO: 38319		TYPE OF INSPECTION		PLACE OF INSPECTION	
PROJECT NAME: John's Excavating, Misc. 14901 E 14th St. San Leandro		Nuclear Density		Jobsite	
		WORK REQUEST: H6126		ZONE:	
DATE:	9-26-97				
HOURS:	4				
INSPECTOR:	Glasser				

Company: Johns Excavating

Reported to: Mr. John Paulson

Feature: Tank Pit Backfill

Field Test Procedure: ASTM D2922 & D3017 Lab Test Procedure: ASTM D1557

MATERIAL DESCRIPTION	MOIST.	MAX. DENSITY	LAB REF.
1. Grey gravelly sand (Quarry fines Dumbarton)	7.0%	2.16 g/cc	Supplied Client

Location	FIELD	TEST	RESULTS			
			Curve	Field	Field	Rel. Pr
	Elev.	No.	Dens.	Moist.	Comp.	Sp
			g/cc	g/cc	%	
1. North end of pit	-4'FG*	1	2.06	7.8	95	9
2. West side of pit	-4'FG	1	2.05	6.8	95	9
3. South end of pit	-3'FG	1	2.06	7.3	95	9
4. East side of pit	-3'FG	1	2.05	7.3	95	9
5. West of center	-2'FG	1	2.06	6.3	95	9
6. East of center	-2'FG	1	2.05	6.8	95	9
7. North of center	FSG**	1	2.05	5.9	95	9
8. South of center	FSG	1	2.13	5.6	99	9

\* FG = Finish Grade  
 \*\* FSG = Finish Sub-grade

NOTE: Test results constitute the reporting of factual information derived from test(s) made by our laboratory following prescribed procedures. These test results should not be considered as an engineering opinion with respect thereto.

Reviewed by Terry R. Chiccino  
 Terry R. Chiccino, Soils/Asphalt  
 Field Operations Manager

1cc: Johns Excavating



Testing Engineers, Inc.

Quality Assurance Services  
 Materials Consulting  
 Since 1954

PROJECT NO: 38319		TYPE OF INSPECTION Nuclear Density		PLACE OF INSPECTION Jobsite	
PROJECT NAME: John's Excavating, Misc. 14901 E 14th St. San Leandro		WORK REQUEST: H6126		ZONE:	
DATE:	9-26-97				
HOURS:	4				
INSPECTOR:	Glasser				

Reported to: Mr. John Paulson  
 Feature: Tank Pit Backfill  
 Field Test Procedure: ASTM D2922 & D3017 Lab Test Procedure: ASTM D1557  
 Company: Johns Excavating

MATERIAL DESCRIPTION	MOIST.	MAX. DENSITY	LAB REF.
1. Grey gravelly sand (Quarry fines Dumbarton)	7.0%	2.16 g/cc	Supplied Client

Location	FIELD TEST Elev.	RESULTS Curve No.	Field	Field	Rel. Comp.	Pr
			Dens. g/cc	Moist. g/cc	%	Sp
1. North end of pit	-4'FG*	1	2.06	7.8	95	
2. West side of pit	-4'FG	1	2.05	6.8	95	
3. South end of pit	-3'FG	1	2.06	7.3	95	
4. East side of pit	-3'FG	1	2.05	7.3	95	
5. West of center	-2'FG	1	2.06	6.3	95	
6. East of center	-2'FG	1	2.05	6.8	95	
7. North of center	FSG**	1	2.05	5.9	95	
8. South of center	FSG	1	2.13	5.6	99	

\* FG = Finish Grade  
 \*\* FSG = Finish Sub-grade

NOTE: Test results constitute the reporting of factual information derived from test(s) made by our laboratory following prescribed procedures. These test results should not be considered as an engineering opinion with respect thereto.

Reviewed by

*Terry R. Chiccino*  
 Terry R. Chiccino, Soils/Asphalt  
 Field Operations Manager

STATE OF CALIFORNIA  
STATE WATER RESOURCES CONTROL BOARD  
**UNDERGROUND STORAGE TANK PERMIT APPLICATION - FORM A**



COMPLETE THIS FORM FOR EACH FACILITY/SITE

<b>MARK ONLY ONE ITEM</b>	<input type="checkbox"/> 1 NEW PERMIT	<input type="checkbox"/> 3 RENEWAL PERMIT	<input type="checkbox"/> 5 CHANGE OF INFORMATION	<input checked="" type="checkbox"/> 7 PERMANENTLY CLOSED SITE
	<input type="checkbox"/> 2 INTERIM PERMIT	<input type="checkbox"/> 4 AMENDED PERMIT	<input type="checkbox"/> 6 TEMPORARY SITE CLOSURE	

**I. FACILITY/SITE INFORMATION & ADDRESS - (MUST BE COMPLETED)**

DBA OR FACILITY NAME <b>QUALITY TUNE-UP</b>		NAME OF OPERATOR		
ADDRESS <b>14901 E. 14TH STREET</b>		NEAREST CROSS STREET <b>HESPERIAN</b>	PARCEL # (OPTIONAL)	
CITY NAME <b>SAN LEANDRO</b>		STATE <b>CA</b>	ZIP CODE <b>94577</b>	SITE PHONE # WITH AREA CODE
<input checked="" type="checkbox"/> BOX TO INDICATE <input type="checkbox"/> CORPORATION <input type="checkbox"/> INDIVIDUAL <input type="checkbox"/> PARTNERSHIP <input type="checkbox"/> LOCAL AGENCY DISTRICTS* <input type="checkbox"/> COUNTY AGENCY* <input type="checkbox"/> STATE AGENCY* <input type="checkbox"/> FEDERAL AGENCY*				
* If owner of UST is a public agency, complete the following: name of Supervisor of division, section, or office which operates the UST _____				
TYPE OF BUSINESS		IF INDIAN RESERVATION OR TRUST LANDS		# OF TANKS AT SITE
<input type="checkbox"/> 1 GAS STATION <input type="checkbox"/> 2 DISTRIBUTOR <input type="checkbox"/> 3 FARM <input type="checkbox"/> 4 PROCESSOR <input checked="" type="checkbox"/> 5 OTHER		<input type="checkbox"/>		<b>4</b>
E. P. A. L. D. # (optional)				

**EMERGENCY CONTACT PERSON (PRIMARY)**

**EMERGENCY CONTACT PERSON (SECONDARY) - optional**

DAYS: NAME (LAST, FIRST) <b>HAGGMAN BRUCE</b>		PHONE # WITH AREA CODE <b>(510) 284-1661</b>		DAYS: NAME (LAST, FIRST)		PHONE # WITH AREA CODE	
NIGHTS: NAME (LAST, FIRST) <b>HAGGMAN BRUCE</b>		PHONE # WITH AREA CODE <b>(510) 284-1661</b>		NIGHTS: NAME (LAST, FIRST)		PHONE # WITH AREA CODE	

**II. PROPERTY OWNER INFORMATION - (MUST BE COMPLETED)**

NAME <b>DIANA PAGANO</b>		CARE OF ADDRESS INFORMATION <b>6912 BROADWAY TERRACE, OAK.</b>		
MAILING OR STREET ADDRESS <b>6912 BROADWAY TERRACE</b>		<input checked="" type="checkbox"/> box to indicate <input type="checkbox"/> INDIVIDUAL <input type="checkbox"/> LOCAL AGENCY <input type="checkbox"/> STATE AGENCY <input type="checkbox"/> CORPORATION <input type="checkbox"/> PARTNERSHIP <input type="checkbox"/> COUNTY AGENCY <input type="checkbox"/> FEDERAL AGENCY		
CITY NAME <b>OAKLAND</b>		STATE <b>CA</b>	ZIP CODE <b>94611</b>	PHONE # WITH AREA CODE <b>(510) 547-0581</b>

**III. TANK OWNER INFORMATION - (MUST BE COMPLETED)**

NAME OF OWNER <b>DIANA PAGANO</b>		CARE OF ADDRESS INFORMATION		
MAILING OR STREET ADDRESS <b>6912 BROADWAY TERRACE</b>		<input checked="" type="checkbox"/> box to indicate <input type="checkbox"/> INDIVIDUAL <input type="checkbox"/> LOCAL AGENCY <input type="checkbox"/> STATE AGENCY <input type="checkbox"/> CORPORATION <input type="checkbox"/> PARTNERSHIP <input type="checkbox"/> COUNTY AGENCY <input type="checkbox"/> FEDERAL AGENCY		
CITY NAME <b>OAKLAND</b>		STATE <b>CA</b>	ZIP CODE <b>94611</b>	PHONE # WITH AREA CODE <b>(510) 547-0581</b>

**IV. BOARD OF EQUALIZATION UST STORAGE FEE ACCOUNT NUMBER - Call (916) 322-9669 if questions arise.**

TY (TK) HQ **44-** [ ] [ ] [ ] [ ] [ ] [ ] [ ] [ ]

**V. PETROLEUM UST FINANCIAL RESPONSIBILITY - (MUST BE COMPLETED) - IDENTIFY THE METHOD(S) USED**

<input checked="" type="checkbox"/> box to indicate	<input type="checkbox"/> 1 SELF-INSURED	<input type="checkbox"/> 2 GUARANTEE	<input type="checkbox"/> 3 INSURANCE	<input type="checkbox"/> 4 SURETY BOND
	<input type="checkbox"/> 5 LETTER OF CREDIT	<input type="checkbox"/> 6 EXEMPTION	<input type="checkbox"/> 99 OTHER	<b>UST FUND</b>

**VI. LEGAL NOTIFICATION AND BILLING ADDRESS** Legal notification and billing will be sent to the tank owner unless box I or II is checked.

CHECK ONE BOX INDICATING WHICH ABOVE ADDRESS SHOULD BE USED FOR LEGAL NOTIFICATIONS AND BILLING:    I.     II.     III.

THIS FORM HAS BEEN COMPLETED UNDER PENALTY OF PERJURY, AND TO THE BEST OF MY KNOWLEDGE, IS TRUE AND CORRECT

OWNER'S NAME (PRINTED & SIGNED) <b>DIANA PAGANO BY BRUCE HAGGMAN</b>	OWNER'S TITLE	DATE MONTH/DAY/YEAR <b>9/9/97</b>
---	---------------	--------------------------------------

**LOCAL AGENCY USE ONLY**

COUNTY # [ ] [ ]	JURISDICTION # [ ] [ ] [ ]	FACILITY # [ ] [ ] [ ] [ ] [ ] [ ]
LOCATION CODE - OPTIONAL	CENSUS TRACT # - OPTIONAL	SUPVISOR - DISTRICT CODE - OPTIONAL

THIS FORM MUST BE ACCOMPANIED BY AT LEAST (1) OR MORE PERMIT APPLICATION - FORM B, UNLESS THIS IS A CHANGE OF SITE INFORMATION ONLY.

OWNER MUST FILE THIS FORM WITH THE LOCAL AGENCY IMPLEMENTING THE UNDERGROUND STORAGE TANK REGULATIONS

STATE OF CALIFORNIA  
STATE WATER RESOURCES CONTROL BOARD  
**UNDERGROUND STORAGE TANK PERMIT APPLICATION - FORM A**



COMPLETE THIS FORM FOR EACH FACILITY/SITE

MARK ONLY ONE ITEM	<input type="checkbox"/> 1 NEW PERMIT	<input type="checkbox"/> 3 RENEWAL PERMIT	<input type="checkbox"/> 5 CHANGE OF INFORMATION	<input checked="" type="checkbox"/> 7 PERMANENTLY CLOSED SITE
	<input type="checkbox"/> 2 INTERIM PERMIT	<input type="checkbox"/> 4 AMENDED PERMIT	<input type="checkbox"/> 6 TEMPORARY SITE CLOSURE	

**I. FACILITY/SITE INFORMATION & ADDRESS - (MUST BE COMPLETED)**

DBA OR FACILITY NAME <i>QUALITY TUNE-UP</i>		NAME OF OPERATOR <i>FRANK JACIENTO</i>		
ADDRESS <i>14901 E. 14TH STREET</i>		NEAREST CROSS STREET <i>HESPERIAN</i>	PARCEL # (OPTIONAL) <i>510-276-0727</i>	
CITY NAME <i>SAN LEANDRO</i>		STATE <i>CA</i>	ZIP CODE <i>94577</i>	SITE PHONE # WITH AREA CODE
<input checked="" type="checkbox"/> BOX TO INDICATE <input type="checkbox"/> CORPORATION <input type="checkbox"/> INDIVIDUAL <input type="checkbox"/> PARTNERSHIP <input type="checkbox"/> LOCAL-AGENCY DISTRICTS* <input type="checkbox"/> COUNTY-AGENCY* <input type="checkbox"/> STATE-AGENCY* <input type="checkbox"/> FEDERAL-AGENCY*				
* If owner of UST is a public agency, complete the following: name of Supervisor of division, section, or office which operates the UST _____				
TYPE OF BUSINESS		<input type="checkbox"/> 1 GAS STATION	<input type="checkbox"/> 2 DISTRIBUTOR	<input type="checkbox"/> 3 FARM
		<input type="checkbox"/> 4 PROCESSOR	<input checked="" type="checkbox"/> 5 OTHER	<input type="checkbox"/> IF INDIAN RESERVATION OR TRUST LANDS
		# OF TANKS AT SITE <i>4</i>	E. P. A. I. D. # (optional)	

**EMERGENCY CONTACT PERSON (PRIMARY)**

**EMERGENCY CONTACT PERSON (SECONDARY) - optional**

DAYS: NAME (LAST, FIRST) <i>HAGEMAN BRUCE</i>	PHONE # WITH AREA CODE <i>(510) 284-1661</i>	DAYS: NAME (LAST, FIRST)	PHONE # WITH AREA CODE
NIGHTS: NAME (LAST, FIRST) <i>HAGEMAN BRUCE</i>	PHONE # WITH AREA CODE <i>(510) 284-1661</i>	NIGHTS: NAME (LAST, FIRST)	PHONE # WITH AREA CODE

**II. PROPERTY OWNER INFORMATION - (MUST BE COMPLETED)**

NAME <i>DIANA PAGANO</i>		CARE OF ADDRESS INFORMATION <i>6912 BROADWAY TERRACE, OAK.</i>		
MAILING OR STREET ADDRESS <i>6912 BROADWAY TERRACE</i>		<input checked="" type="checkbox"/> box to indicate <input type="checkbox"/> INDIVIDUAL <input type="checkbox"/> LOCAL-AGENCY <input type="checkbox"/> STATE-AGENCY <input type="checkbox"/> CORPORATION <input type="checkbox"/> PARTNERSHIP <input type="checkbox"/> COUNTY-AGENCY <input type="checkbox"/> FEDERAL-AGENCY		
CITY NAME <i>OAKLAND</i>		STATE <i>CA</i>	ZIP CODE <i>94611</i>	PHONE # WITH AREA CODE <i>(510) 547-0581</i>

**III. TANK OWNER INFORMATION - (MUST BE COMPLETED)**

NAME OF OWNER <i>DIANA PAGANO</i>		CARE OF ADDRESS INFORMATION		
MAILING OR STREET ADDRESS <i>6912 BROADWAY TERRACE</i>		<input checked="" type="checkbox"/> box to indicate <input type="checkbox"/> INDIVIDUAL <input type="checkbox"/> LOCAL-AGENCY <input type="checkbox"/> STATE-AGENCY <input type="checkbox"/> CORPORATION <input type="checkbox"/> PARTNERSHIP <input type="checkbox"/> COUNTY-AGENCY <input type="checkbox"/> FEDERAL-AGENCY		
CITY NAME <i>OAKLAND</i>		STATE <i>CA</i>	ZIP CODE <i>94611</i>	PHONE # WITH AREA CODE <i>(510) 547-0581</i>

**IV. BOARD OF EQUALIZATION UST STORAGE FEE ACCOUNT NUMBER - Call (916) 322-9669 if questions arise.**

TY (TK) HQ   -

**V. PETROLEUM UST FINANCIAL RESPONSIBILITY - (MUST BE COMPLETED) - IDENTIFY THE METHOD(S) USED**

<input checked="" type="checkbox"/> box to indicate	<input type="checkbox"/> 1 SELF-INSURED	<input type="checkbox"/> 2 GUARANTEE	<input type="checkbox"/> 3 INSURANCE	<input type="checkbox"/> 4 SURETY BOND
	<input type="checkbox"/> 5 LETTER OF CREDIT	<input type="checkbox"/> 6 EXEMPTION	<input type="checkbox"/> 99 OTHER	<i>UST FUND</i>

**VI. LEGAL NOTIFICATION AND BILLING ADDRESS** Legal notification and billing will be sent to the tank owner unless box I or II is checked.

CHECK ONE BOX INDICATING WHICH ABOVE ADDRESS SHOULD BE USED FOR LEGAL NOTIFICATIONS AND BILLING: I.  II.  III.

THIS FORM HAS BEEN COMPLETED UNDER PENALTY OF PERJURY, AND TO THE BEST OF MY KNOWLEDGE, IS TRUE AND CORRECT

OWNER'S NAME (PRINTED & SIGNED) <i>DIANA PAGANO BY BRUCE HEGEMAN</i>	OWNER'S TITLE	DATE MONTH/DAY/YEAR <i>9/9/97</i>
---	---------------	--------------------------------------

**LOCAL AGENCY USE ONLY**

COUNTY # <input type="text" value=""/> <input type="text" value=""/>	JURISDICTION # <input type="text" value=""/> <input type="text" value=""/> <input type="text" value=""/>	FACILITY # <input type="text" value=""/> <input type="text" value=""/> <input type="text" value=""/> <input type="text" value=""/> <input type="text" value=""/>
LOCATION CODE - OPTIONAL	CENSUS TRACT # - OPTIONAL	SUPVISOR - DISTRICT CODE - OPTIONAL

THIS FORM MUST BE ACCOMPANIED BY AT LEAST (1) OR MORE PERMIT APPLICATION - FORM B, UNLESS THIS IS A CHANGE OF SITE INFORMATION ONLY.

OWNER MUST FILE THIS FORM WITH THE LOCAL AGENCY IMPLEMENTING THE UNDERGROUND STORAGE TANK REGULATIONS