

ALAMEDA COUNTY
HEALTH CARE SERVICES

AGENCY
DAVID J. KEARS, Agency Director



7

ENVIRONMENTAL HEALTH SERVICES
ENVIRONMENTAL PROTECTION
1131 Harbor Bay Parkway, Suite 250
Alameda, CA 94502-6577
(510) 567-6700
FAX (510) 337-9335

October 6, 2006

Ms. Diana Pagano
6912 Broadway Terrace
Oakland, CA 94611-1924

Subject: Fuel Leak Case No. RO0002925, Quality Tune Up, 14901 East 14th Street, San Leandro, CA

Dear Ms. Pagano:

Alameda County Environmental Health Department (ACEH) staff has reviewed the reports titled, "Limited Phase II Environmental Site Assessment", and "Groundwater Monitoring Well Installation Work Plan" dated June 6, 2005 and November 18, 2005 and prepared on your behalf by Ninyo & Moore. Groundwater sampling conducted in June 2005 confirms the presence of dissolved petroleum hydrocarbon contamination in groundwater beneath the subject site. Grab groundwater samples tested up to 20,000 µg/L TPHg, 60,000 µg/L TPHd, <10 µg/L benzene and 5 µg/L MtBE, respectively. Soil boring NM-8 located downgradient of the former fuel dispenser island tested concentration up to 20,000 µg/L TPHg in groundwater. In addition, groundwater sampling conducted in December 1996 tested up to 210,000 µg/L TPHg and 200 µg/L benzene in the vicinity of the former fuel dispensers, indicating that an unauthorized release may have occurred on site.

Evaluation of groundwater elevation data at nearby UST sites indicates the hydraulic gradient in the vicinity of your site trends toward the southeast. ACEH is concerned that residual petroleum hydrocarbon contamination may be migrating off site toward the southeast, in the direction of 150th street. Furthermore, our review of the case file indicates that no offsite soil and groundwater characterization to delineate the extent of petroleum hydrocarbon contamination downgradient of the subject site has been completed. Consequently, prior to the installation of monitoring wells, ACEH requests that you provide a work plan detailing your proposal to characterize groundwater conditions downgradient of your site.

Based on ACEH staff review of the case file, we request that you address the following technical comments and prepare a work plan detailing work to be performed, and send us the reports described below. Please provide 72-hour advance written notification to this office (e-mail preferred to steven.plunkett@acgov.org) prior to the start of field activities.

TECHNICAL COMMENTS

1. **Contamination Plume Delineation.** The purpose of contaminant plume definition is to determine the three-dimensional extent of contamination (MTBE, petroleum products, and associated blending compounds and additives) in soil and groundwater from the unauthorized release at your site.

The three-dimensional extent of contamination in soil and groundwater at your site is undefined. The results of recent groundwater monitoring indicate the presence of elevated levels of dissolved phase petroleum products at your site.

Results from the most recent onsite soil and groundwater investigation conducted in June 2005 demonstrate that dissolved TPHg and TPHd in groundwater beneath your site may be migrating off site. There has been no soil or groundwater sampling downgradient of soil borings NM-7 or NM-8 to determine the lateral extent of hydrocarbon contamination. To determine the extent of dissolved petroleum hydrocarbon contamination an additional soil and groundwater investigation is required downgradient of your site. Please discuss in detail your plans to determine the extent of dissolved petroleum hydrocarbon contamination downgradient of your site in the work plan requested below.

2. **Groundwater Contaminant Plume Monitoring.** The purpose of groundwater contaminant plume monitoring is to determine the three-dimensional movement of the plume, the rate of plume growth, and the effectiveness of cleanup activities.

Once the extent of the plume is defined, we request that you install permanent monitoring wells and/or monitoring well clusters (screened at appropriate discrete depths with appropriate length of screen) and piezometers to monitor the three-dimensional movement of the plume. We request that you use detailed cross-sections, structural contours, isopachs, and rose diagrams for groundwater gradient to determine the appropriate locations and designs for monitoring wells/well clusters and piezometers that are needed to appropriately monitor the three-dimensional movement of the plume. To accurately evaluate your site, your monitoring wells/well clusters will need to be screened in the permeable zones with screen lengths that match the stratigraphic sequence. Generally, these screened intervals will not be greater than 10 feet in length. The number of piezometer/wells should be sufficient to evaluate all permeable zones. Include your proposal for the installation of wells/piezometers in the work plan requested below. We recommend that you submit your proposal for the installation of monitoring wells/well clusters and piezometers to ACEH for comment prior to installation. Report on the installation of wells/piezometers in the Soil and Groundwater Investigation Report (SWI) requested below.

3. **Proposed Monitoring Well Locations and Installation.** It appears the monitoring well locations as proposed in the monitoring well work plan are based on a hydraulic gradient that may not represent the actual groundwater gradient at the site. Review of groundwater elevation data at nearby UST sites indicates that the hydraulic gradient is toward the southeast. ACEH believes the proposed monitoring well network -in its current design- may be insufficient to adequately define the extent of contamination downgradient of soil borings NM-7 and NM-8. To determine the extent of dissolved petroleum hydrocarbon contamination an additional soil and groundwater investigation is required downgradient of your site, prior to the installation of groundwater monitoring wells.

ACEH suggests the use of monitoring wells designed with sand pack intervals of 2'-5' or less, as these wells will likely be representative of depth discrete groundwater conditions. Upon completion of the monitoring well installation ACEH request that you submit all well construction details, technical specifications and well lithologic logs in the report requested below. In addition, we request that a licensed professional surveyor survey the monitoring well location. Please present your rationale for well design and monitoring well locations in the SWI report requested below.

4. **Soil and Groundwater Sample Analysis.** All soil and groundwater samples collected during the SWI are to be analyzed for TPHg and TPHd by EPA Method 8015M or 8260, BTEX,

EDB, EDC, MtBE, TAME, ETBE, DIPE, TBA and EtOH by EPA Method 8260 and total lead. Please present the results from the soil and groundwater sampling in the SWI report requested below.

5. **Groundwater Monitoring.** We request that you monitor the groundwater contaminant plumes on a quarterly basis. Additional wells may be required to define the downgradient extent of the plume if it continues to migrate. ACEH requires that all monitoring wells be included in a groundwater-monitoring program. We request that Quarterly Reports contain all of the following: a discussion of the results of your plume monitoring, an evaluation of the stability of your plume and recommendations for the installation of additional wells if your evaluation indicates your plume is migrating, regular progress reports on the work at your site, inform the District of any problems with the work at your site, and a description of any additional work that may be needed. The groundwater samples are to be analyzed for TPHg and TPHd by EPA Method 8015M or 8260, BTEX, EDB, EDC, MtBE, TAME, ETBE, DIPE, TBA and EtOH by EPA Method 8260. Please present the results for the quarterly monitoring in the Quarterly Monitoring Reports requested below.

6. **Preferential Pathway Study**

The purpose of the preferential pathway study is to locate potential migration pathways and conduits and determine the probability of the NAPL and/or plume encountering preferential pathways or conduits that could spread contamination. Of particular concern is the identification of abandoned wells and improperly destroyed wells that can act as vertical conduits to deeper water bearing zones, pumping wells in the vicinity of your site and manmade conduits for shallow migration.

We request that you perform a preferential pathway study that details the potential migration pathways and potential conduits (wells, utilities, pipelines, etc.) for horizontal and vertical migration that may be present in the vicinity of the site. Discuss your analysis and interpretation of the results of the preferential pathway study (including the detailed well survey and utility survey requested below) and report your results in the Well Installation Report requested below. Include an evaluation of the probability of the dissolved phase and NAPL plumes for all constituents of concern encountering preferential pathways and conduits that could spread the contamination, particularly in the vertical direction to deeper aquifers. The results of your study shall contain all information required by 23 CCR, Section 2654(b).

- a) **Utility Survey**

An evaluation of all utility lines and trenches (including sewers, storm drains, pipelines, trench backfill, etc.) within and near the site and plume area(s) is required as part of your study. Submittal of map(s) and cross-sections showing the location and depth of all utility lines and trenches within and near the site and plume area(s) is required as part of your study.

- b) **Well Survey**

The preferential pathway study shall include a detailed well survey of all wells (monitoring and production wells: active, inactive, standby decommissioned (sealed with concrete), abandoned, (improperly decommissioned or lost); and dewatering and

cathodic protection wells) within a ½ mile radius of the subject site. The well survey should include well data from California Department of Water Resource well database and Alameda County Department of Public Works. As part of your detailed well survey, please perform a background study of the historical land uses of the site and properties in the vicinity of the site. Use the results of your background study to determine the existence or unrecorded/unknown (abandoned) wells, which can act as pathways for migration of contamination at and/or from your site. Please review historical maps such as Sanborn maps, aerial photos, etc., when performing the background study. Submittal of map(s) showing the location of all wells identified in your study, and the use of tables to report the data collected as part of your survey are required. Include appropriate photographic prints, in stereo pairs, of historic aerial photos used as part of the study. We also request that you list by date all aerial photographs available for the site from the aerial survey company or library you use during your study. Please refer to the Regional Board's guidance for identification, location, and evaluation of potential deep well conduits when conducting your preferential pathway study. Present the result from the preferential pathway study in the report requested below.

TECHNICAL REPORT REQUEST

Please submit technical reports to Alameda County Environmental Health (Attention: Mr. Steven Plunkett), according to the following schedule:

- **November 30, 2006** – Soil and Groundwater Investigation Work Plan and Preferential Pathway Study
- **February 30, 2007** – 1st Quarter 2007 Groundwater Monitoring Report
- **May 30, 2007** – 2nd Quarter 2007 Groundwater Monitoring Report
- **August 30, 2007** – 3rd Quarter 2007 Groundwater Monitoring Report
- **November 30, 2007** – 4th Quarter 2007 Groundwater Monitoring Report
- **90 Days After Completion of Soil and Groundwater Investigation** – Soil and Groundwater Investigation Report

These reports are being requested pursuant to California Health and Safety Code Section 25296.10. 23 CCR Sections 2652 through 2654, and 2721 through 2728 outline the responsibilities of a responsible party in response to an unauthorized release from a petroleum UST system, and require your compliance with this request.

ELECTRONIC SUBMITTAL OF REPORTS

The Alameda County Environmental Cleanup Oversight Programs (LOP and SLIC) require submission of all reports in electronic form to the county's ftp site. Paper copies of reports will no longer be accepted. The electronic copy replaces the paper copy and will be used for all public information requests, regulatory review, and compliance/enforcement activities. Instructions for submission of electronic documents to the Alameda County Environmental Cleanup Oversight Program ftp site are provided on the attached "Electronic Report Upload (ftp) Instructions." Please do not submit reports as attachments to electronic mail.

Submission of reports to the Alameda County ftp site is an addition to existing requirements for electronic submittal of information to the State Water Resources Control Board (SWRCB) Geotracker website. Submission of reports to the Geotracker website does not fulfill the requirement to submit documents to the Alameda County ftp site. In September 2004, the SWRCB adopted regulations that require electronic submittal of information for groundwater cleanup programs. For several years, responsible parties for cleanup of leaks from underground storage tanks (USTs) have been required to submit groundwater analytical data, surveyed locations of monitor wells, and other data to the Geotracker database over the Internet. Beginning July 1, 2005, electronic submittal of a complete copy of all necessary reports was required in Geotracker (in PDF format). Please visit the SWRCB website for more information on these requirements (http://www.swrcb.ca.gov/ust/cleanup/electronic_reporting).

PERJURY STATEMENT

All work plans, technical reports, or technical documents submitted to ACEH must be accompanied by a cover letter from the responsible party that states, at a minimum, the following: "I declare, under penalty of perjury, that the information and/or recommendations contained in the attached document or report is true and correct to the best of my knowledge." This letter must be signed by an officer or legally authorized representative of your company. Please include a cover letter satisfying these requirements with all future reports and technical documents submitted for this fuel leak case.

PROFESSIONAL CERTIFICATION & CONCLUSIONS/RECOMMENDATIONS

The California Business and Professions Code (Sections 6735, 6835, and 7835.1) requires that work plans and technical or implementation reports containing geologic or engineering evaluations and/or judgments be performed under the direction of an appropriately registered or certified professional. For your submittal to be considered a valid technical report, you are to present site specific data, data interpretations, and recommendations prepared by an appropriately licensed professional and include the professional registration stamp, signature, and statement of professional certification. Please ensure all that all technical reports submitted for this fuel leak case meet this requirement.

UNDERGROUND STORAGE TANK CLEANUP FUND

Please note that delays in investigation, later reports, or enforcement actions may result in your becoming ineligible to receive grant money from the state's Underground Storage Tank Cleanup Fund (Senate Bill 2004) to reimburse you for the cost of cleanup.

AGENCY OVERSIGHT

If it appears as though significant delays are occurring or reports are not submitted as requested, we will consider referring your case to the Regional Board or other appropriate agency, including the County District Attorney, for possible enforcement actions. California Health and Safety Code, Section 25299.76 authorizes enforcement including administrative action or monetary penalties of up to \$10,000 per day for each day of violation.

Should you have any questions, do not hesitate to call me at (510) 383-1767.

Diana Pagano
October 2, 2006
Page 6

Sincerely,



Steven Plunkett
Hazardous Materials Specialist

Enclosure: ACEH Electronic Report Upload (ftp) Instructions

Cc: Toyin Fawehinmi
City of San Leandro Engineering and Transportation Department
Civic Center, 835 East 14th Street
San Leandro, CA 94577

Karl Busche
City of San Leandro Environmental Service Division
Civic Center, 835 East 14th Street
San Leandro, CA 94577

Donna Drogos, ACEH
Steven Plunkett, ACEH
File

City of San Leandro
Civic Center, 835 E. 14th Street
San Leandro, California 94577

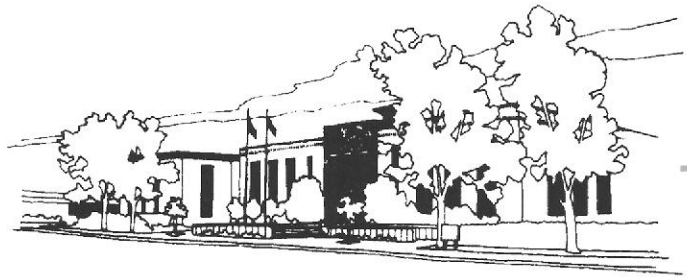

7202925

June 12, 2006

Donna L. Drogos, P.E.
LOP Program Manager
Alameda County Environmental Health
1131 Harbor Bay Parkway
Alameda, CA 94502

Dear Ms. Drogos:

14901 East 14th Street, San Leandro- Contaminated Site Change of Oversight

Enclosed please find copies of the case we previously discussed. Please copy me on all correspondence for this site. Thank you

If you have any questions about the case or if I can be of any help, please call me at (510) 577-3341.

Sincerely,

Karl Busche
Environmental Specialist
City of San Leandro-Environmental Services Division
kbusche@ci.san-leandro.ca.us

Cc: Toyin Fawehinmi, Engineering Dept.

Enclosure; case file

Shelia Young, Mayor

City Council:

Orval "OB" Badger;
Tony Santos;

Surlene G. Grant;
Joyce Starosciak;

Glenda Nardine;
Bill Stephens



From: John Wolfenden
To: RSchurman@ci.san-leandro.ca.us
Date: 6/14/05 4:39PM
Subject: RE: 14901 East 14th Street, San Leandro

We don't oversee fuel cases in San Leandro. If it's something the City can't handle then it goes to Alameda County Environmental Health.

>>> <RSchurman@ci.san-leandro.ca.us> 06/08/05 12:09PM >>>
John,

A little additional information. I downloaded the LUFT Report for the site and it is attached (copy & pasted into Word). The Regional Board Case Number is 01-2355. If you have any questions, feel free to contact me also.

Rod R. Schurman, P.E., Associate Engineer

City of San Leandro, Engineering & Transportation Dept., Capital
Improvements Division

Civic Center, 835 East 14th Street, 94577-3782

Direct 510.577.3412 * Fax 510.577.3294

From: Kris Larson [<mailto:klarson@ninyoandmoore.com>]
Sent: Wednesday, June 08, 2005 11:07 AM
To: Jwolfenden@waterboards.ca.gov
Cc: Dawn Ritzman; Schurman, Rodney
Subject: 14901 East 14th Street, San Leandro

John,

We have been working with the City of San Leandro on a LUST site that they are purchasing. The site address is 14901 East 14th Street, and it was formerly a gas station between 1948 to 1981. The business changed from a gas station to a Quality Tune up in 1981. The Quality Tune Up is currently occupying the property.

We recently conducted a Phase II evaluation on the site and found elevated concentrations of TPH-D and TPH-G in the groundwater in the areas and downgradient of the former USTs. I have attached a copy of the Phase II Report for review by the RWQCB and we would like to prepare a

workplan for the next phase of investigation. Please let me know how you think the City of San Leandro should proceed on this.

Regards,
Kristopher M. Larson
Senior Project Environmental Geologist
Ninyo & Moore
1956 Webster Street, Suite 400
Oakland, California 94610
Ph: 510-633-5640
Fax: 510-633-5646
<<401007002s 6-2005.pdf>>

From: <RSchurman@ci.san-leandro.ca.us>
To: <Jwolfenden@waterboards.ca.gov>
Date: 6/8/05 12:10PM
Subject: RE: 14901 East 14th Street, San Leandro

John,

A little additional information. I downloaded the LUFT Report for the site and it is attached (copy & pasted into Word). The Regional Board Case Number is 01-2355. If you have any questions, feel free to contact me also.

Rod R. Schurman, P.E., Associate Engineer

City of San Leandro, Engineering & Transportation Dept., Capital Improvements Division

Civic Center, 835 East 14th Street, 94577-3782

Direct 510.577.3412 * Fax 510.577.3294

From: Kris Larson [mailto:klarson@ninyoandmoore.com]
Sent: Wednesday, June 08, 2005 11:07 AM
To: Jwolfenden@waterboards.ca.gov
Cc: Dawn Ritzman; Schurman, Rodney
Subject: 14901 East 14th Street, San Leandro

John,

We have been working with the City of San Leandro on a LUST site that they are purchasing. The site address is 14901 East 14th Street, and it was formerly a gas station between 1948 to 1981. The business changed from a gas station to a Quality Tune up in 1981. The Quality Tune Up is currently occupying the property.

We recently conducted a Phase II evaluation on the site and found elevated concentrations of TPH-D and TPH-G in the groundwater in the areas and downgradient of the former USTs. I have attached a copy of the Phase II Report for review by the RWQCB and we would like to prepare a workplan for the next phase of investigation. Please let me know how you think the City of San Leandro should proceed on this.

Regards,

Kristopher M. Larson
Senior Project Environmental Geologist
Ninyo & Moore
1956 Webster Street, Suite 400
Oakland, California 94610
Ph: 510-633-5640
Fax: 510-633-5646
<<401007002s 6-2005.pdf>>

CC: <dritzman@ninyoandmoore.com>, <klarson@ninyoandmoore.com>,
<dpollart@ci.san-leandro.ca.us>

LEAKING UNDERGROUND FUEL TANK REPORT

QUALITY TUNE UP (SAN LEANDRO)

14901 14TH ST E
SAN LEANDRO, CA 94578

CASE STATUS: OPEN

[SHOW THIS SITE ON MAP](#)

[RETURN TO REPORT MAIN MENU](#)

REGIONAL BOARD - CASE #: 01-2355

SAN FRANCISCO BAY RWQCB (REGION 2) - (RDB)

CONTACT: ROGER BREWER - (510) 622-2300

LOCAL AGENCY (LEAD AGENCY) - CASE #: 01-2355

SAN LEANDRO, CITY OF - (KB)

CHOOSE A REPORT TO VIEW

SITE INFO:

- ◆ [REGULATORY HISTORY](#)
- ◆ [LOCATIONAL INFORMATION](#)
- ◆ [ANALYTICAL DATA](#)
- ◆ [ELECTRONIC ANALYTICAL DATA](#)
- ◆ [DEPTH TO WATER INFORMATION](#)
- ◆ [RISK MANAGEMENT](#)
- ◆ [LAND USE CONTROLS](#)

ELECTRONIC SUBMITTALS:

- ◆ ANALYTICAL DATA (NONE AVAILABLE)
- ◆ LOCATION DATA (NONE AVAILABLE)
- ◆ ELEVATION DATA (NONE AVAILABLE)
- ◆ DEPTH TO WATER DATA (NONE AVAILABLE)
- ◆ GEO MAP DATA (NONE AVAILABLE)
- ◆ GEO REPORT DATA (NONE AVAILABLE)
- ◆ GEO BORE DATA (NONE AVAILABLE)
- ◆ SITE DOCUMENTS (NONE AVAILABLE)

LEAK INFO:

- ◆ [DETAILED RELEASE INFORMATION](#)
- ◆ [REMEDIATION ON SITE](#)

CUF REIMBURSEMENT AMOUNT:

\$0

ADDITIONAL INFO:

- ◆ 0 FIELD POINTS FOR THIS LUFT SITE
- ◆ 0 PUBLIC WATER WELL(S) ESTIMATED TO BE NEARBY THIS LUFT SITE

REGULATORY HISTORY

QUALITY TUNE UP (SAN LEANDRO)

14901 14TH ST E
SAN LEANDRO, CA 94578

CASE STATUS: OPEN

[SHOW THIS SITE ON MAP](#)

[RETURN TO REPORT MAIN MENU](#)

REGIONAL BOARD - CASE #: 01-2355

SAN FRANCISCO BAY RWQCB (REGION 2) - (RDB)

CONTACT: ROGER BREWER - (510) 622-2300

LOCAL AGENCY (LEAD AGENCY) - CASE #: 01-2355

SAN LEANDRO, CITY OF - (KB)

REGULATORY HISTORY

BEGIN DATE

STATUS

| | |
|-----------|---------------------------------|
| 8/24/1998 | 1 - Leak Confirmation |
| 8/24/1998 | 5C - Pollution Characterization |
| 8/24/1998 | * Leak Discovery |
| 8/24/1998 | * System Entry |
| 8/24/1998 | * Leak Reported |
| 8/24/1998 | * Leak Stopped |
| 2/1/2001 | * Regulatory Review |

Locational Information

QUALITY TUNE UP (SAN LEANDRO)

14901 14TH ST E
SAN LEANDRO, CA 94578

CASE STATUS: OPEN

[SHOW THIS SITE ON MAP](#)

[RETURN TO REPORT MAIN MENU](#)

REGIONAL BOARD - CASE #: 01-2355

SAN FRANCISCO BAY RWQCB (REGION 2) - (RDB)
CONTACT: ROGER BREWER - (510) 622-2300

LOCAL AGENCY (LEAD AGENCY) - CASE #: 01-2355

SAN LEANDRO, CITY OF - (KB)

PHYSICAL LOCATION:

GLOBAL ID

T0600102165

LATITUDE

37.705956

LONGITUDE

-122.129582

GEOGRAPHIC DATA DETAILS:

DATUM

North American Datum 1983

SURVEY METHOD

Geocoded

PROJECTION

Geographic Projection

ESTIMATED ACCURACY

376.24 feet

SOURCE OF DATA

ETAK Geocoding Class 1 Block Match - Street Segment Exact Address Match

LUFT ANALYTICAL DATA REPORT

QUALITY TUNE UP (SAN LEANDRO)

14901 14TH ST E
SAN LEANDRO, CA 94578

CASE STATUS: OPEN

[SHOW THIS SITE ON MAP](#)

[RETURN TO REPORT MAIN MENU](#)

REGIONAL BOARD - CASE #: 01-2355

SAN FRANCISCO BAY RWQCB (REGION 2) - (RDB)
CONTACT: ROGER BREWER - (510) 622-2300

LOCAL AGENCY (LEAD AGENCY) - CASE #: 01-2355

SAN LEANDRO, CITY OF - (KB)

Note: You may select up to 6 chemicals.

[\(All Data\)](#) | [\(Most Recent\)](#) | [\(Maximum Concentrations\)](#)

| NAME | DATE | PARAMETER | MATRIX | QUALIFIER | RESULT | UNITS | PLOT |
|------------|----------|--------------------------------|--------|-----------|--------|-------|--------------------------|
| * MAINSITE | 2/1/2001 | METHYL-TERT-BUTYL-ETHER (MTBE) | S | < | 5 | ppm | <input type="checkbox"/> |
| * MAINSITE | 2/1/2001 | METHYL-TERT-BUTYL-ETHER (MTBE) | W | < | 5 | ppb | <input type="checkbox"/> |

* DENOTES A HISTORICAL VALUE

Risk Management

QUALITY TUNE UP (SAN LEANDRO)

14901 14TH ST E
SAN LEANDRO , CA 94578

CASE STATUS: OPEN
SHOW THIS SITE ON MAP

[RETURN TO REPORT MAIN MENU](#)

REGIONAL BOARD - CASE #: 01-2355

SAN FRANCISCO BAY RWQCB (REGION 2) - (RDB)
CONTACT: ROGER BREWER - (510) 622-2300

LOCAL AGENCY (LEAD AGENCY) - CASE #: 01-2355

SAN LEANDRO, CITY OF - (KB)

CASE TYPE

OTHER GROUNDWATER (NOT USED FOR DRINKING WATER)

BENEFICIAL USE

BASIN (CALCULATED)

ALAMEDA EAST BAY
(2-9.01E)

VULNERABILITY BASIS

MTBE THREAT CLASSIFICATION

MTBE THREAT DESCRIPTION

MTBE CLEANUP CLASSIFICATION

MTBE CLEANUP DESCRIPTION

DRINKING WELLS IMPACTED

IMPACTED DRINKING SOURCE DESCRIPTION

NEAREST SURFACE WATER BODY (CALCULATED)
NOT YET CALCULATED

DISTANCE TO SURFACE WATER (CALCULATED)
NOT YET CALCULATED

ECOLOGICAL RISK DESCRIPTION

RB RECORD FILE

PLUME/CONTAMINANT DESCRIPTION

SOIL DESCRIPTION

PRIORITY

CASE DESCRIPTION

NEW CASE PER CITY OF SAN LEANDRO UPDATE - 8/98.

Land Use Controls

QUALITY TUNE UP (SAN LEANDRO)
14901 14TH ST E
SAN LEANDRO, CA 94578
CASE STATUS: OPEN
[SHOW THIS SITE ON MAP](#)
[RETURN TO REPORT MAIN MENU](#)

REGIONAL BOARD - CASE #: 01-2355
SAN FRANCISCO BAY RWQCB (REGION 2) - (RDB)
CONTACT: ROGER BREWER - (510) 622-2300

LOCAL AGENCY (LEAD AGENCY) - CASE #: 01-2355
SAN LEANDRO, CITY OF - (KB)

FUTURE LAND USE REPORTED AT CLOSURE

CURRENT LAND USE

SITE MANAGEMENT REQUIREMENTS

SITE MANAGEMENT DESCRIPTION

BROWNFIELD (ABANDONED PROPERTY NOT REDEVELOPED DUE TO CONTAMINATION AND LIABILITY COST CONCERNS)

Detailed Release Information

QUALITY TUNE UP (SAN LEANDRO)
14901 14TH ST E
SAN LEANDRO, CA 94578
CASE STATUS: OPEN
[SHOW THIS SITE ON MAP](#)
[RETURN TO REPORT MAIN MENU](#)

REGIONAL BOARD - CASE #: 01-2355
SAN FRANCISCO BAY RWQCB (REGION 2) - (RDB)
CONTACT: ROGER BREWER - (510) 622-2300

LOCAL AGENCY (LEAD AGENCY) - CASE #: 01-2355
SAN LEANDRO, CITY OF - (KB)

CASE TYPE:

Other Groundwater (not used for drinking water)

ENFORCEMENT TYPE:

FUNDING:

F

HOW LEAK WAS DISCOVERED:

Tank Closure

METHOD USED TO STOP DISCHARGE:

INTERIM:

CAUSE OF LEAK:

Unknown

SOURCE OF LEAK:

Unknown

SUBSTANCES RELEASED:

| <u>Discharge Begin Date</u> | <u>Substance</u> | <u>Quantity</u> |
|-----------------------------|-----------------------|-----------------|
| UNKNOWN | Gasoline - Automotive | |

Remediation On Site

QUALITY TUNE UP (SAN LEANDRO)
14901 14TH ST E
SAN LEANDRO, CA 94578
CASE STATUS: OPEN
[SHOW THIS SITE ON MAP](#)
[RETURN TO REPORT MAIN MENU](#)

REGIONAL BOARD - CASE #: 01-2355
SAN FRANCISCO BAY RWQCB (REGION 2) - (RDB)
CONTACT: ROGER BREWER - (510) 622-2300

LOCAL AGENCY (LEAD AGENCY) - CASE #: 01-2355
SAN LEANDRO, CITY OF - (KB)

Start Date

Method

Phase

No Records Found!

Facility Name Quality Tune-UP Address 14901 E, 14th Date 9/16/97
 Inspector K. Busche Arrival Time 10:30 Departure Time 1:00
 Contact at Site Bruce Haggeman Company _____

| | Tank 1 | Tank 2 | Tank 3 | Tank 4 |
|-----------------|------------------|--------|--------|-----------|
| Tank Content | gas - fiberglass | gas | gas | waste oil |
| Tank Size (gal) | 10K | 10K | 10K | 500 |
| % LEL / % O2 | 0/18% | 0/18% | 0/18% | 0/21 |
| Lbs Dry Ice | 200 | 200 | 200 | 50 |
| Corrosion/Holes | N/N | N/N | N/N | |
| No. of Samples | 4 | 4 | 4 | 1 |
| Soil odor/color | 4/4 | N/N | 4/4 | N/N |

Piping: Supply _____ Vapor Return _____ Vent _____ Piping Removed: yes
 Piping Sampled: NO No. of samples: _____ Sample odor/color: _____

| Site Map | Sample Description |
|--------------|-----------------------------------|
| SEE Attached | #1 side wall samples see Attached |
| | #2 " " " |
| | #3 " " " |
| | #4 " " " |
| | #5 " " " |
| | #6 " " " |
| | #7 " " " |
| | #8 " " " |
| | #9 " " " |

Comments: water at approx 12 feet.

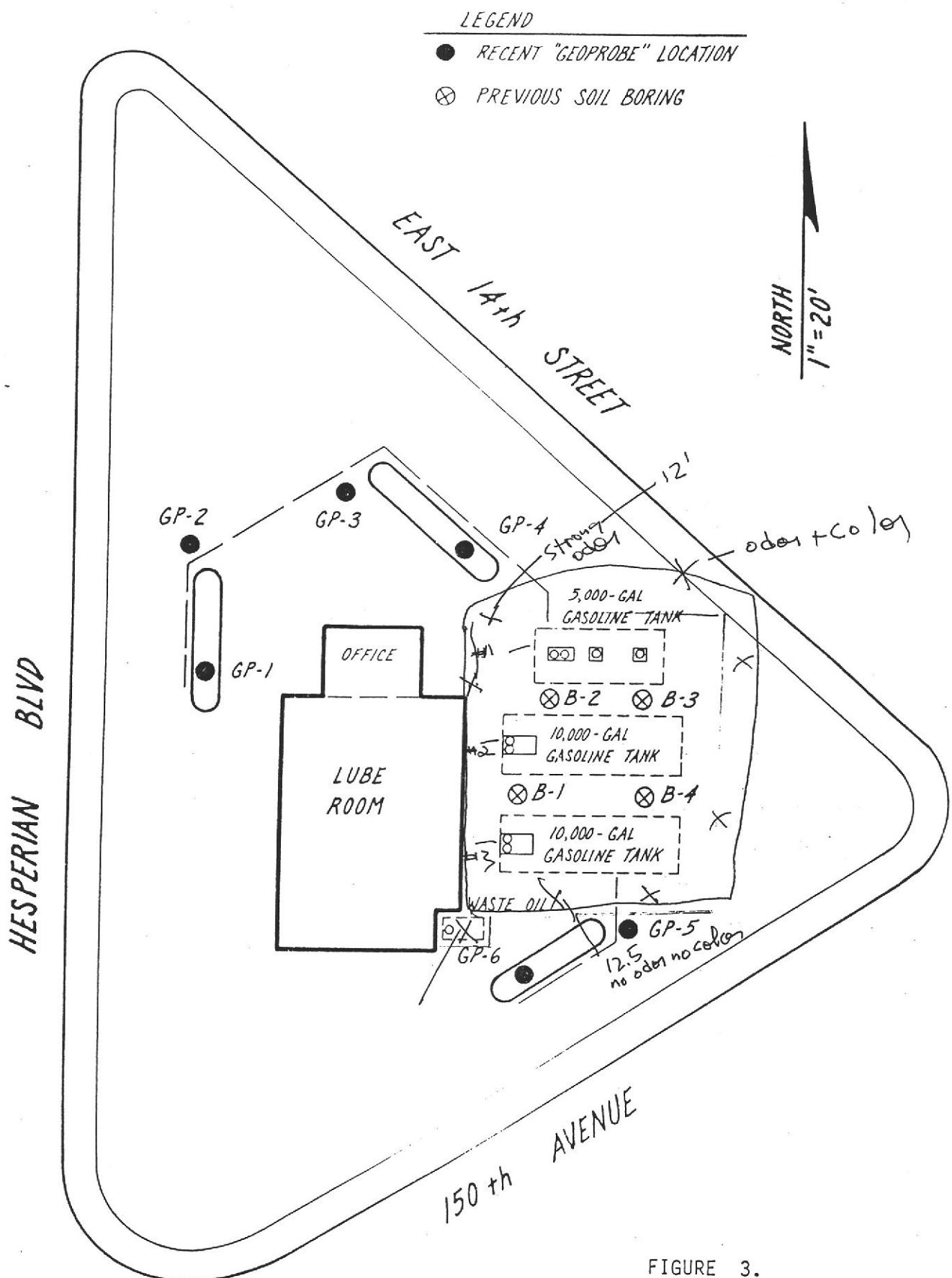

FIGURE 3.
Boring Locations.

Reviewed By KB

97112 sent copy to [unclear] 7-10
San Leandro Fire Department
Hazardous Materials Division
835 East 14th Street
San Leandro, CA 94577
(415) 577-3331

Rev 4/91

Approval Date _____

FIRE DEPARTMENT
Date Received 9/09

Rejection Date _____

SEP - 4 1997
Fees Paid 720.

UNDERGROUND STORAGE TANK CLOSURE PLAN/PERMIT

- Facility Name: QUALITY TUNE-UP Address: 14901 EAST 14th ST. S.L.
Contact Person: DIANNA PAGANO Phone No.: (510) 547-0581
Generator's U.S. EPA Number: CAC 001-151-216
- Contractor: JOHN PAULSON License Type & No.: GEN "A" 361 828
Address: 1128 HALYARD DRIVE, SANTA ROSA, CA, 94501
Contact Person: BRUCE HAGEMAN Phone No.: (510) 284-1661
- Sampling to be performed by: HAGEMAN-AGUIAR, INC. Phone No.: (510) 284-1661
- Laboratory services to be provided by: PRIORITY ENVIRONMENTAL LABS
DOHS Certificate No.: _____ Phone No.: _____
- Tank Hauler: ERICKSON ENVIRONMENTAL EPA ID No.: CAD 009466392
Address: 255 FARR BLVD, RICHMOND, CA Phone No.: (510) 235-1393
Destination of Tank(s): ERICKSON, INC. 255 FARR BLVD. RICHMOND, CA
- Method of inerting tank(s): DRY ICE 30 LBS PER 1000 GAL. CAPACITY
- Type of explosimeter or combustible gas meter to be provided: GASTECH
- Tanks to be removed:

| | Size | Content | Material of Construction | Age | Sample Analysis Method |
|--------|--------|-----------|--------------------------|-----|--|
| Tank 1 | 10,000 | GASOLINE | STEEL | 25+ | TPH, GASOLINE (5030) BTXE, MTBE (8026) |
| Tank 2 | 10,000 | GASOLINE | STEEL | 25+ | " " " |
| Tank 3 | 10,000 | GASOLINE | STEEL | 25+ | " " " |
| Tank 4 | 500 | WASTE OIL | STEEL | 25+ | " |
| Piping | 2" | GASOLINE | STEEL UNWRAPPED | 25+ | TPH, GASOLINE (5030) BTXE X MTBE (8026) |

I acknowledge receipt and agree to comply with the San Leandro Fire Department Underground Storage Tank Closure Requirements. I declare under penalty of perjury that the aforementioned information is true and correct, to the best of my knowledge.

Company Name: HAGEMAN - AGUIAR, INC. Address: 3732 MT. DIABLO BLVD. LAFAYETTE

Applicant's Signature [Signature] for Dianna Pagano Date 8-22-97

Number of Tanks Removed 4 Inspector [Signature] Date 9/16/97

STATE OF CALIFORNIA
STATE WATER RESOURCES CONTROL BOARD
UNDERGROUND STORAGE TANK PERMIT APPLICATION - FORM A



COMPLETE THIS FORM FOR EACH FACILITY/SITE

| | | | | |
|---------------------------|---|---|---|---|
| MARK ONLY ONE ITEM | <input type="checkbox"/> 1 NEW PERMIT | <input type="checkbox"/> 3 RENEWAL PERMIT | <input type="checkbox"/> 5 CHANGE OF INFORMATION | <input checked="" type="checkbox"/> 7 PERMANENTLY CLOSED SITE |
| | <input type="checkbox"/> 2 INTERIM PERMIT | <input type="checkbox"/> 4 AMENDED PERMIT | <input type="checkbox"/> 6 TEMPORARY SITE CLOSURE | |

I. FACILITY/SITE INFORMATION & ADDRESS - (MUST BE COMPLETED)

| | | | | |
|--|--|---|--------------------------|--|
| DBA OR FACILITY NAME <i>QUALITY TUNE-UP</i> | | NAME OF OPERATOR <i>FRANK FACIENTO</i> | | |
| ADDRESS <i>14901 E. 14th STREET</i> | | NEAREST CROSS STREET <i>HESPERIAN</i> | PARCEL # (OPTIONAL) | |
| CITY NAME <i>SAN LEANDRO</i> | | STATE <i>CA</i> | ZIP CODE <i>94577</i> | SITE PHONE # WITH AREA CODE <i>(510) 276-0727</i> |
| <input checked="" type="checkbox"/> BOX TO INDICATE <input type="checkbox"/> CORPORATION <input type="checkbox"/> INDIVIDUAL <input type="checkbox"/> PARTNERSHIP <input type="checkbox"/> LOCAL-AGENCY DISTRICTS* <input type="checkbox"/> COUNTY-AGENCY* <input type="checkbox"/> STATE-AGENCY* <input type="checkbox"/> FEDERAL-AGENCY* | | | | |
| * If owner of UST is a public agency, complete the following: name of Supervisor of division, section, or office which operates the UST _____ | | | | |
| TYPE OF BUSINESS | | IF INDIAN RESERVATION OR TRUST LANDS | | E. P. A. I. D. # (optional) |
| <input type="checkbox"/> 1 GAS STATION <input type="checkbox"/> 2 DISTRIBUTOR <input type="checkbox"/> 3 FARM <input type="checkbox"/> 4 PROCESSOR <input checked="" type="checkbox"/> 5 OTHER | | <input type="checkbox"/> IF INDIAN RESERVATION OR TRUST LANDS | | |
| | | # OF TANKS AT SITE <i>4</i> | | |

EMERGENCY CONTACT PERSON (PRIMARY)

EMERGENCY CONTACT PERSON (SECONDARY) - optional

| | | | | | | | |
|--|--|---|--|----------------------------|--|------------------------|--|
| DAYS: NAME (LAST, FIRST) <i>HAGEMAN BRUCE</i> | | PHONE # WITH AREA CODE <i>(510) 284-1661</i> | | DAYS: NAME (LAST, FIRST) | | PHONE # WITH AREA CODE | |
| NIGHTS: NAME (LAST, FIRST) <i>HAGEMAN BRUCE</i> | | PHONE # WITH AREA CODE <i>(510) 284-1661</i> | | NIGHTS: NAME (LAST, FIRST) | | PHONE # WITH AREA CODE | |

II. PROPERTY OWNER INFORMATION - (MUST BE COMPLETED)

| | | | | |
|---|--|---|--------------------------|---|
| NAME <i>DIANA PAGANO</i> | | CARE OF ADDRESS INFORMATION <i>6912 BROADWAY TERRACE, OAK.</i> | | |
| MAILING OR STREET ADDRESS <i>6912 BROADWAY TERRACE</i> | | <input checked="" type="checkbox"/> box to indicate <input type="checkbox"/> INDIVIDUAL <input type="checkbox"/> LOCAL-AGENCY <input type="checkbox"/> STATE-AGENCY <input type="checkbox"/> CORPORATION <input type="checkbox"/> PARTNERSHIP <input type="checkbox"/> COUNTY-AGENCY <input type="checkbox"/> FEDERAL-AGENCY | | |
| CITY NAME <i>OAKLAND</i> | | STATE <i>CA</i> | ZIP CODE <i>94611</i> | PHONE # WITH AREA CODE <i>(510) 547-0581</i> |

III. TANK OWNER INFORMATION - (MUST BE COMPLETED)

| | | | | |
|---|--|---|--------------------------|---|
| NAME OF OWNER <i>DIANA PAGANO</i> | | CARE OF ADDRESS INFORMATION | | |
| MAILING OR STREET ADDRESS <i>6912 BROADWAY TERRACE</i> | | <input checked="" type="checkbox"/> box to indicate <input type="checkbox"/> INDIVIDUAL <input type="checkbox"/> LOCAL-AGENCY <input type="checkbox"/> STATE-AGENCY <input type="checkbox"/> CORPORATION <input type="checkbox"/> PARTNERSHIP <input type="checkbox"/> COUNTY-AGENCY <input type="checkbox"/> FEDERAL-AGENCY | | |
| CITY NAME <i>OAKLAND</i> | | STATE <i>CA</i> | ZIP CODE <i>94611</i> | PHONE # WITH AREA CODE <i>(510) 547-0581</i> |

IV. BOARD OF EQUALIZATION UST STORAGE FEE ACCOUNT NUMBER - Call (916) 322-9669 if questions arise.

TY (TK) HQ -

V. PETROLEUM UST FINANCIAL RESPONSIBILITY - (MUST BE COMPLETED) - IDENTIFY THE METHOD(S) USED

| | | | | |
|---|---|--------------------------------------|--------------------------------------|--|
| <input checked="" type="checkbox"/> box to indicate | <input type="checkbox"/> 1 SELF-INSURED | <input type="checkbox"/> 2 GUARANTEE | <input type="checkbox"/> 3 INSURANCE | <input type="checkbox"/> 4 SURETY BOND |
| | <input type="checkbox"/> 5 LETTER OF CREDIT | <input type="checkbox"/> 6 EXEMPTION | <input type="checkbox"/> 99 OTHER | <i>UST FUND</i> |

VI. LEGAL NOTIFICATION AND BILLING ADDRESS Legal notification and billing will be sent to the tank owner unless box I or II is checked.

CHECK ONE BOX INDICATING WHICH ABOVE ADDRESS SHOULD BE USED FOR LEGAL NOTIFICATIONS AND BILLING: I. II. III.

THIS FORM HAS BEEN COMPLETED UNDER PENALTY OF PERJURY, AND TO THE BEST OF MY KNOWLEDGE, IS TRUE AND CORRECT

| | | |
|---|---------------|--------------------------------------|
| OWNER'S NAME (PRINTED & SIGNED) <i>DIANA PAGANO BY DIANA HEGAN</i> | OWNER'S TITLE | DATE MONTH/DAY/YEAR <i>9/9/97</i> |
|---|---------------|--------------------------------------|

LOCAL AGENCY USE ONLY

| | | |
|---|---|---|
| COUNTY # <input type="text" value=""/> <input type="text" value=""/> | JURISDICTION # <input type="text" value=""/> <input type="text" value=""/> <input type="text" value=""/> | FACILITY # <input type="text" value=""/> <input type="text" value=""/> <input type="text" value=""/> <input type="text" value=""/> <input type="text" value=""/> |
| LOCATION CODE - OPTIONAL | CENSUS TRACT # - OPTIONAL | SUPVISOR - DISTRICT CODE - OPTIONAL |

THIS FORM MUST BE ACCOMPANIED BY AT LEAST (1) OR MORE PERMIT APPLICATION - FORM B, UNLESS THIS IS A CHANGE OF SITE INFORMATION ONLY.

OWNER MUST FILE THIS FORM WITH THE LOCAL AGENCY IMPLEMENTING THE UNDERGROUND STORAGE TANK REGULATIONS

STATE OF CALIFORNIA
STATE WATER RESOURCES CONTROL BOARD
UNDERGROUND STORAGE TANK PERMIT APPLICATION - FORM B



COMPLETE A SEPARATE FORM FOR EACH TANK SYSTEM.

| | | | | |
|---------------------------|---|---|---|--|
| MARK ONLY ONE ITEM | <input type="checkbox"/> 1 NEW PERMIT | <input type="checkbox"/> 3 RENEWAL PERMIT | <input type="checkbox"/> 5 CHANGE OF INFORMATION | <input checked="" type="checkbox"/> 7 PERMANENTLY CLOSED ON SITE |
| | <input type="checkbox"/> 2 INTERIM PERMIT | <input type="checkbox"/> 4 AMENDED PERMIT | <input type="checkbox"/> 6 TEMPORARY TANK CLOSURE | <input type="checkbox"/> 8 TANK REMOVED |

DBA OR FACILITY NAME WHERE TANK IS INSTALLED: QUALITY TUNE-UP E. 14TH ST. SAN LEANDRO, CA

| | |
|--|---|
| I. TANK DESCRIPTION COMPLETE ALL ITEMS - SPECIFY IF UNKNOWN | |
| A. OWNER'S TANK I.D.# <u>UNKNOWN</u> | B. MANUFACTURED BY: <u>UNKNOWN</u> |
| C. DATE INSTALLED (MO/DAY/YEAR) <u>UNKNOWN</u> | D. TANK CAPACITY IN GALLONS: <u>5,000 GALLONS</u> |

| | | | |
|---|-------------------------------------|------------------------------------|---|
| II. TANK CONTENTS IF A-1 IS MARKED, COMPLETE ITEM C. | | | |
| A. <input checked="" type="checkbox"/> 1 MOTOR VEHICLE FUEL | <input type="checkbox"/> 4 OIL | <input type="checkbox"/> 1 PRODUCT | <input checked="" type="checkbox"/> 1a REGULAR UNLEADED |
| <input type="checkbox"/> 2 PETROLEUM | <input type="checkbox"/> 80 EMPTY | <input type="checkbox"/> 2 WASTE | <input type="checkbox"/> 1b PREMIUM UNLEADED |
| <input type="checkbox"/> 3 CHEMICAL PRODUCT | <input type="checkbox"/> 95 UNKNOWN | | <input type="checkbox"/> 2 LEADED |
| D. IF (A.1) IS NOT MARKED, ENTER NAME OF SUBSTANCE STORED | | C. A. S. #: | |

| | | | |
|--|--|---|--|
| III. TANK CONSTRUCTION MARK ONE ITEM ONLY IN BOXES A, B, AND C, AND ALL THAT APPLIES IN BOX D AND E | | | |
| A. TYPE OF SYSTEM | <input type="checkbox"/> 1 DOUBLE WALL | <input type="checkbox"/> 3 SINGLE WALL WITH EXTERIOR LINER | <input type="checkbox"/> 95 UNKNOWN |
| | <input checked="" type="checkbox"/> 2 SINGLE WALL | <input type="checkbox"/> 4 SECONDARY CONTAINMENT (VAULTED TANK) | <input type="checkbox"/> 99 OTHER |
| B. TANK MATERIAL (Primary Tank) | <input checked="" type="checkbox"/> 1 BARE STEEL | <input type="checkbox"/> 2 STAINLESS STEEL | <input type="checkbox"/> 3 FIBERGLASS |
| | <input type="checkbox"/> 5 CONCRETE | <input type="checkbox"/> 6 POLYVINYL CHLORIDE | <input type="checkbox"/> 7 ALUMINUM |
| | <input type="checkbox"/> 9 BRONZE | <input type="checkbox"/> 10 GALVANIZED STEEL | <input type="checkbox"/> 95 UNKNOWN |
| C. INTERIOR LINING | <input type="checkbox"/> 1 RUBBER LINED | <input type="checkbox"/> 2 ALKYD LINING | <input type="checkbox"/> 3 EPOXY LINING |
| | <input type="checkbox"/> 5 GLASS LINING | <input type="checkbox"/> 6 UNLINED | <input checked="" type="checkbox"/> 95 UNKNOWN |
| | IS LINING MATERIAL COMPATIBLE WITH 100% METHANOL? YES ___ NO ___ | | <input type="checkbox"/> 4 PHENOLIC LINING |
| D. CORROSION PROTECTION | <input type="checkbox"/> 1 POLYETHYLENE WRAP | <input type="checkbox"/> 2 COATING | <input type="checkbox"/> 3 VINYL WRAP |
| | <input type="checkbox"/> 5 CATHODIC PROTECTION | <input type="checkbox"/> 91 NONE | <input type="checkbox"/> 4 FIBERGLASS REINFORCED PLASTIC |
| | | <input type="checkbox"/> 95 UNKNOWN | <input type="checkbox"/> 99 OTHER |
| E. SPILL AND OVERFILL | SPILL CONTAINMENT INSTALLED (YEAR) <u>NONE</u> | | OVERFILL PREVENTION EQUIPMENT INSTALLED (YEAR) _____ |

| | | | |
|--|---|---|--|
| IV. PIPING INFORMATION CIRCLE A IF ABOVE GROUND OR U IF UNDERGROUND, BOTH IF APPLICABLE | | | |
| A. SYSTEM TYPE | A U 1 SUCTION | A U 2 PRESSURE | A U 3 GRAVITY |
| | A U 99 OTHER | | |
| B. CONSTRUCTION | A U 1 SINGLE WALL | A U 2 DOUBLE WALL | A U 3 LINED TRENCH |
| | A U 95 UNKNOWN | A U 99 OTHER | |
| C. MATERIAL AND CORROSION PROTECTION | A U 1 BARE STEEL | A U 2 STAINLESS STEEL | A U 3 POLYVINYL CHLORIDE (PVC) |
| | A U 4 FIBERGLASS PIPE | A U 5 ALUMINUM | A U 6 CONCRETE |
| | A U 7 STEEL W/ COATING | A U 8 100% METHANOL COMPATIBLE W/FRP | A U 9 GALVANIZED STEEL |
| | A U 10 CATHODIC PROTECTION | A U 95 UNKNOWN | A U 99 OTHER |
| D. LEAK DETECTION | <input type="checkbox"/> 1 AUTOMATIC LINE LEAK DETECTOR | <input type="checkbox"/> 2 LINE TIGHTNESS TESTING | <input type="checkbox"/> 3 INTERSTITIAL MONITORING |
| | | | <input type="checkbox"/> 99 OTHER <u>NONE</u> |

| | | | | |
|--|---|--|---|--|
| V. TANK LEAK DETECTION | | | | |
| <input checked="" type="checkbox"/> 1 VISUAL CHECK | <input type="checkbox"/> 2 INVENTORY RECONCILIATION | <input type="checkbox"/> 3 VADOZE MONITORING | <input type="checkbox"/> 4 AUTOMATIC TANK GAUGING | <input type="checkbox"/> 5 GROUND WATER MONITORING |
| <input type="checkbox"/> 6 TANK TESTING | <input type="checkbox"/> 7 INTERSTITIAL MONITORING | <input type="checkbox"/> 91 NONE | <input type="checkbox"/> 95 UNKNOWN | <input type="checkbox"/> 99 OTHER |

| | | |
|---|--|---|
| VI. TANK CLOSURE INFORMATION | | |
| 1. ESTIMATED DATE LAST USED (MO/DAY/YR) <u>1982</u> | 2. ESTIMATED QUANTITY OF SUBSTANCE REMAINING <u>10</u> GALLONS | 3. WAS TANK FILLED WITH INERT MATERIAL? YES <input type="checkbox"/> NO <input checked="" type="checkbox"/> |

THIS FORM HAS BEEN COMPLETED UNDER PENALTY OF PERJURY, AND TO THE BEST OF MY KNOWLEDGE, IS TRUE AND CORRECT

APPLICANT'S NAME (PRINTED & SIGNATURE) DANITA PAGANO
[Signature]

DATE 9/9/97

| | | | |
|--|-------------------------|------------------------|------------|
| LOCAL AGENCY USE ONLY THE STATE I.D. NUMBER IS COMPOSED OF THE FOUR NUMBERS BELOW | | | |
| STATE I.D.# | COUNTY # | JURISDICTION # | FACILITY # |
| | | | |
| PERMIT NUMBER | PERMIT APPROVED BY/DATE | PERMIT EXPIRATION DATE | |

THIS FORM MUST BE ACCOMPANIED BY A PERMIT APPLICATION - FORM A, UNLESS A CURRENT FORM A HAS BEEN FILED.
FILE THIS FORM WITH THE LOCAL AGENCY IMPLEMENTING THE UNDERGROUND STORAGE TANK REGULATIONS

STATE OF CALIFORNIA
STATE WATER RESOURCES CONTROL BOARD
UNDERGROUND STORAGE TANK PERMIT APPLICATION - FORM B



COMPLETE A SEPARATE FORM FOR EACH TANK SYSTEM.

| | | | | |
|--------------------|---|---|---|--|
| MARK ONLY ONE ITEM | <input type="checkbox"/> 1 NEW PERMIT | <input type="checkbox"/> 3 RENEWAL PERMIT | <input type="checkbox"/> 5 CHANGE OF INFORMATION | <input checked="" type="checkbox"/> 7 PERMANENTLY CLOSED ON SITE |
| | <input type="checkbox"/> 2 INTERIM PERMIT | <input type="checkbox"/> 4 AMENDED PERMIT | <input type="checkbox"/> 6 TEMPORARY TANK CLOSURE | <input type="checkbox"/> 8 TANK REMOVED |

DBA OR FACILITY NAME WHERE TANK IS INSTALLED: QUALITY TUNE-UP

I. TANK DESCRIPTION COMPLETE ALL ITEMS - SPECIFY IF UNKNOWN

| | |
|--|--|
| A. OWNER'S TANK I.D.# <u>UNKNOWN</u> | B. MANUFACTURED BY: <u>UNKNOWN</u> |
| C. DATE INSTALLED (MO/DAY/YEAR) <u>UNKNOWN</u> | D. TANK CAPACITY IN GALLONS: <u>10,000 GALLONS</u> |

II. TANK CONTENTS IF A-1 IS MARKED, COMPLETE ITEM C.

| | | | | | |
|---|-------------------------------------|---------------------------------------|---|-------------------------------------|---|
| A. <input checked="" type="checkbox"/> 1 MOTOR VEHICLE FUEL | <input type="checkbox"/> 4 OIL | B. <input type="checkbox"/> 1 PRODUCT | C. <input checked="" type="checkbox"/> a REGULAR UNLEADED | <input type="checkbox"/> 3 DIESEL | <input type="checkbox"/> 6 AVIATION GAS |
| <input type="checkbox"/> 2 PETROLEUM | <input type="checkbox"/> 80 EMPTY | <input type="checkbox"/> 2 WASTE | <input type="checkbox"/> 1b PREMIUM UNLEADED | <input type="checkbox"/> 4 GASAHOL | <input type="checkbox"/> 7 METHANOL |
| <input type="checkbox"/> 3 CHEMICAL PRODUCT | <input type="checkbox"/> 95 UNKNOWN | | <input type="checkbox"/> 2 LEADED | <input type="checkbox"/> 5 JET FUEL | <input type="checkbox"/> 99 OTHER (DESCRIBE IN ITEM D. BELOW) |
| D. IF (A.1) IS NOT MARKED, ENTER NAME OF SUBSTANCE STORED | | | | | C. A. S. #: |

III. TANK CONSTRUCTION MARK ONE ITEM ONLY IN BOXES A, B, AND C, AND ALL THAT APPLIES IN BOX D AND E

| | | | |
|---------------------------------|---|---|--|
| A. TYPE OF SYSTEM | <input type="checkbox"/> 1 DOUBLE WALL | <input type="checkbox"/> 3 SINGLE WALL WITH EXTERIOR LINER | <input type="checkbox"/> 95 UNKNOWN |
| | <input checked="" type="checkbox"/> 2 SINGLE WALL | <input type="checkbox"/> 4 SECONDARY CONTAINMENT (VAULTED TANK) | <input type="checkbox"/> 99 OTHER |
| B. TANK MATERIAL (Primary Tank) | <input checked="" type="checkbox"/> 1 BARE STEEL | <input type="checkbox"/> 2 STAINLESS STEEL | <input type="checkbox"/> 3 FIBERGLASS |
| | <input type="checkbox"/> 5 CONCRETE | <input type="checkbox"/> 6 POLYVINYL CHLORIDE | <input type="checkbox"/> 7 ALUMINUM |
| | <input type="checkbox"/> 9 BRONZE | <input type="checkbox"/> 10 GALVANIZED STEEL | <input type="checkbox"/> 95 UNKNOWN |
| | | | <input type="checkbox"/> 4 STEEL CLAD W/ FIBERGLASS REINFORCED PLASTIC |
| | | | <input type="checkbox"/> 8 100% METHANOL COMPATIBLE W/FRP |
| | | | <input type="checkbox"/> 99 OTHER |
| C. INTERIOR LINING | <input type="checkbox"/> 1 RUBBER LINED | <input type="checkbox"/> 2 ALKYD LINING | <input type="checkbox"/> 3 EPOXY LINING |
| | <input type="checkbox"/> 5 GLASS LINING | <input type="checkbox"/> 6 UNLINED | <input checked="" type="checkbox"/> 95 UNKNOWN |
| | | | <input type="checkbox"/> 4 PHENOLIC LINING |
| | | | <input type="checkbox"/> 99 OTHER |
| | IS LINING MATERIAL COMPATIBLE WITH 100% METHANOL ? YES ___ NO ___ | | |
| D. CORROSION PROTECTION | <input type="checkbox"/> 1 POLYETHYLENE WRAP | <input type="checkbox"/> 2 COATING | <input type="checkbox"/> 3 VINYL WRAP |
| | <input type="checkbox"/> 5 CATHODIC PROTECTION | <input checked="" type="checkbox"/> 91 NONE | <input type="checkbox"/> 4 FIBERGLASS REINFORCED PLASTIC |
| | | | <input type="checkbox"/> 95 UNKNOWN |
| | | | <input type="checkbox"/> 99 OTHER |
| E. SPILL AND OVERFILL | SPILL CONTAINMENT INSTALLED (YEAR) <u>NONE</u> | | OVERFILL PREVENTION EQUIPMENT INSTALLED (YEAR) <u>NONE</u> |

IV. PIPING INFORMATION CIRCLE A IF ABOVE GROUND OR U IF UNDERGROUND, BOTH IF APPLICABLE

| | | | | |
|--------------------------------------|---|---|--|---|
| A. SYSTEM TYPE | <u>A U</u> 1 SUCTION | <u>A U</u> 2 PRESSURE | <u>A U</u> 3 GRAVITY | <u>A U</u> 99 OTHER |
| B. CONSTRUCTION | <u>A U</u> 1 SINGLE WALL | <u>A U</u> 2 DOUBLE WALL | <u>A U</u> 3 LINED TRENCH | <u>A U</u> 95 UNKNOWN |
| | | | | <u>A U</u> 99 OTHER |
| C. MATERIAL AND CORROSION PROTECTION | <u>A U</u> 1 BARE STEEL | <u>A U</u> 2 STAINLESS STEEL | <u>A U</u> 3 POLYVINYL CHLORIDE (PVC) | <u>A U</u> 4 FIBERGLASS PIPE |
| | <u>A U</u> 5 ALUMINUM | <u>A U</u> 6 CONCRETE | <u>A U</u> 7 STEEL W/ COATING | <u>A U</u> 8 100% METHANOL COMPATIBLE W/FRP |
| | <u>A U</u> 9 GALVANIZED STEEL | <u>A U</u> 10 CATHODIC PROTECTION | <u>A U</u> 95 UNKNOWN | <u>A U</u> 99 OTHER |
| D. LEAK DETECTION | <input type="checkbox"/> 1 AUTOMATIC LINE LEAK DETECTOR | <input type="checkbox"/> 2 LINE TIGHTNESS TESTING | <input type="checkbox"/> 3 INTERSTITIAL MONITORING | <input type="checkbox"/> 99 OTHER <u>NEVER USED</u> |

V. TANK LEAK DETECTION

| | | | | |
|---|---|---|---|--|
| <input type="checkbox"/> 1 VISUAL CHECK | <input type="checkbox"/> 2 INVENTORY RECONCILIATION | <input checked="" type="checkbox"/> 3 VAPOZE MONITORING | <input type="checkbox"/> 4 AUTOMATIC TANK GAUGING | <input type="checkbox"/> 5 GROUND WATER MONITORING |
| <input type="checkbox"/> 6 TANK TESTING | <input type="checkbox"/> 7 INTERSTITIAL MONITORING | <input checked="" type="checkbox"/> 91 NONE | <input type="checkbox"/> 95 UNKNOWN | <input type="checkbox"/> 99 OTHER |

VI. TANK CLOSURE INFORMATION

| | | |
|---|--|--|
| 1. ESTIMATED DATE LAST USED (MO/DAY/YR) <u>1982</u> | 2. ESTIMATED QUANTITY OF SUBSTANCE REMAINING <u>10</u> GALLONS | 3. WAS TANK FILLED WITH INERT MATERIAL ? YES <input type="checkbox"/> NO <input checked="" type="checkbox"/> |
|---|--|--|

THIS FORM HAS BEEN COMPLETED UNDER PENALTY OF PERJURY, AND TO THE BEST OF MY KNOWLEDGE, IS TRUE AND CORRECT

| | |
|--|-----------------------|
| APPLICANT'S NAME (PRINTED & SIGNATURE) <u>DIANA PAGANO</u> <u>By BRUCE HAGEMAN</u> | DATE <u>9/9/97</u> |
|--|-----------------------|

LOCAL AGENCY USE ONLY THE STATE I.D. NUMBER IS COMPOSED OF THE FOUR NUMBERS BELOW

| | | | | |
|---------------|-------------------------|------------------------|------------|--------|
| STATE I.D.# | COUNTY # | JURISDICTION # | FACILITY # | TANK # |
| PERMIT NUMBER | PERMIT APPROVED BY/DATE | PERMIT EXPIRATION DATE | | |

THIS FORM MUST BE ACCOMPANIED BY A PERMIT APPLICATION - FORM A, UNLESS A CURRENT FORM A HAS BEEN FILED.
FILE THIS FORM WITH THE LOCAL AGENCY IMPLEMENTING THE UNDERGROUND STORAGE TANK REGULATIONS

STATE OF CALIFORNIA
STATE WATER RESOURCES CONTROL BOARD
UNDERGROUND STORAGE TANK PERMIT APPLICATION - FORM B



COMPLETE A SEPARATE FORM FOR EACH TANK SYSTEM.

| | | | | |
|--------------------|---|---|---|--|
| MARK ONLY ONE ITEM | <input type="checkbox"/> 1 NEW PERMIT | <input type="checkbox"/> 3 RENEWAL PERMIT | <input type="checkbox"/> 5 CHANGE OF INFORMATION | <input checked="" type="checkbox"/> 7 PERMANENTLY CLOSED ON SITE |
| | <input type="checkbox"/> 2 INTERIM PERMIT | <input type="checkbox"/> 4 AMENDED PERMIT | <input type="checkbox"/> 6 TEMPORARY TANK CLOSURE | <input type="checkbox"/> 8 TANK REMOVED |

DBA OR FACILITY NAME WHERE TANK IS INSTALLED: QUALITY TUNE-UP - E. 14TH ST. SAN LEANDRO

| | |
|---|--|
| I. TANK DESCRIPTION COMPLETE ALL ITEMS - SPECIFY IF UNKNOWN | |
| A. OWNER'S TANK I. D. # <u>UNKNOWN</u> | B. MANUFACTURED BY: <u>UNKNOWN</u> |
| C. DATE INSTALLED (MO/DAY/YEAR) <u>UNKNOWN</u> | D. TANK CAPACITY IN GALLONS: <u>10,000 GALLONS</u> |

| | | | |
|---|-------------------------------------|---------------------------------------|---|
| II. TANK CONTENTS IF A-1 IS MARKED, COMPLETE ITEM C. | | | |
| A. <input checked="" type="checkbox"/> 1 MOTOR VEHICLE FUEL | <input type="checkbox"/> 4 OIL | B. <input type="checkbox"/> 1 PRODUCT | C. <input type="checkbox"/> 1a REGULAR UNLEADED |
| <input type="checkbox"/> 2 PETROLEUM | <input type="checkbox"/> 80 EMPTY | <input type="checkbox"/> 2 WASTE | <input checked="" type="checkbox"/> 1b PREMIUM UNLEADED |
| <input type="checkbox"/> 3 CHEMICAL PRODUCT | <input type="checkbox"/> 95 UNKNOWN | | <input type="checkbox"/> 2 LEADED |
| | | | <input type="checkbox"/> 3 DIESEL |
| | | | <input type="checkbox"/> 4 GASAHOL |
| | | | <input type="checkbox"/> 5 JET FUEL |
| | | | <input type="checkbox"/> 6 AVIATION GAS |
| | | | <input type="checkbox"/> 7 METHANOL |
| | | | <input type="checkbox"/> 99 OTHER (DESCRIBE IN ITEM D. BELOW) |
| D. IF (A.1) IS NOT MARKED, ENTER NAME OF SUBSTANCE STORED | | | C. A. S. #: |

| | | | |
|---|--|---|--|
| III. TANK CONSTRUCTION MARK ONE ITEM ONLY IN BOXES A, B, AND C, AND ALL THAT APPLIES IN BOX D AND E | | | |
| A. TYPE OF SYSTEM | <input type="checkbox"/> 1 DOUBLE WALL | <input type="checkbox"/> 3 SINGLE WALL WITH EXTERIOR LINER | <input type="checkbox"/> 95 UNKNOWN |
| | <input checked="" type="checkbox"/> 2 SINGLE WALL | <input type="checkbox"/> 4 SECONDARY CONTAINMENT (VAULTED TANK) | <input type="checkbox"/> 99 OTHER |
| B. TANK MATERIAL (Primary Tank) | <input checked="" type="checkbox"/> 1 BARE STEEL | <input type="checkbox"/> 2 STAINLESS STEEL | <input type="checkbox"/> 3 FIBERGLASS |
| | <input type="checkbox"/> 5 CONCRETE | <input type="checkbox"/> 6 POLYVINYL CHLORIDE | <input type="checkbox"/> 7 ALUMINUM |
| | <input type="checkbox"/> 9 BRONZE | <input type="checkbox"/> 10 GALVANIZED STEEL | <input type="checkbox"/> 95 UNKNOWN |
| | | | <input type="checkbox"/> 99 OTHER |
| C. INTERIOR LINING | <input type="checkbox"/> 1 RUBBER LINED | <input type="checkbox"/> 2 ALKYD LINING | <input type="checkbox"/> 3 EPOXY LINING |
| | <input type="checkbox"/> 5 GLASS LINING | <input type="checkbox"/> 6 UNLINED | <input checked="" type="checkbox"/> 95 UNKNOWN |
| | | | <input type="checkbox"/> 4 PHENOLIC LINING |
| | | | <input type="checkbox"/> 99 OTHER |
| | IS LINING MATERIAL COMPATIBLE WITH 100% METHANOL? YES ___ NO ___ | | |
| D. CORROSION PROTECTION | <input type="checkbox"/> 1 POLYETHYLENE WRAP | <input checked="" type="checkbox"/> 2 COATING | <input type="checkbox"/> 3 VINYL WRAP |
| | <input type="checkbox"/> 5 CATHODIC PROTECTION | <input checked="" type="checkbox"/> 91 NONE | <input type="checkbox"/> 4 FIBERGLASS REINFORCED PLASTIC |
| | | | <input type="checkbox"/> 95 UNKNOWN |
| | | | <input type="checkbox"/> 99 OTHER |
| E. SPILL AND OVERFILL | SPILL CONTAINMENT INSTALLED (YEAR) _____ | | OVERFILL PREVENTION EQUIPMENT INSTALLED (YEAR) _____ |

| | | | |
|---|---|---|--|
| IV. PIPING INFORMATION CIRCLE A IF ABOVE GROUND OR U IF UNDERGROUND, BOTH IF APPLICABLE | | | |
| A. SYSTEM TYPE | A U 1 SUCTION | A U 2 PRESSURE | A U 3 GRAVITY |
| | | | A U 99 OTHER |
| B. CONSTRUCTION | A U 1 SINGLE WALL | A U 2 DOUBLE WALL | A U 3 LINED TRENCH |
| | | | A U 95 UNKNOWN |
| | | | A U 99 OTHER |
| C. MATERIAL AND CORROSION PROTECTION | A U 1 BARE STEEL | A U 2 STAINLESS STEEL | A U 3 POLYVINYL CHLORIDE (PVC) |
| | A U 5 ALUMINUM | A U 6 CONCRETE | A U 7 STEEL W/ COATING |
| | A U 9 GALVANIZED STEEL | A U 10 CATHODIC PROTECTION | A U 95 UNKNOWN |
| | | | A U 99 OTHER |
| D. LEAK DETECTION | <input type="checkbox"/> 1 AUTOMATIC LINE LEAK DETECTOR | <input type="checkbox"/> 2 LINE TIGHTNESS TESTING | <input type="checkbox"/> 3 INTERSTITIAL MONITORING |
| | | | <input type="checkbox"/> 99 OTHER <u>NONE</u> |

| | | | |
|--|---|--|---|
| V. TANK LEAK DETECTION | | | |
| <input checked="" type="checkbox"/> 1 VISUAL CHECK | <input type="checkbox"/> 2 INVENTORY RECONCILIATION | <input type="checkbox"/> 3 VADOZE MONITORING | <input type="checkbox"/> 4 AUTOMATIC TANK GAUGING |
| <input type="checkbox"/> 6 TANK TESTING | <input type="checkbox"/> 7 INTERSTITIAL MONITORING | <input type="checkbox"/> 91 NONE | <input type="checkbox"/> 95 UNKNOWN |
| | | | <input type="checkbox"/> 99 OTHER |

| | | |
|--|--|---|
| VI. TANK CLOSURE INFORMATION | | |
| 1. ESTIMATED DATE LAST USED (MO/DAY/YR) <u>1982</u> | 2. ESTIMATED QUANTITY OF SUBSTANCE REMAINING <u>10</u> GALLONS | 3. WAS TANK FILLED WITH INERT MATERIAL? YES <input type="checkbox"/> NO <input checked="" type="checkbox"/> |

THIS FORM HAS BEEN COMPLETED UNDER PENALTY OF PERJURY, AND TO THE BEST OF MY KNOWLEDGE, IS TRUE AND CORRECT

| | |
|--|-----------------------|
| APPLICANT'S NAME (PRINTED & SIGNATURE) <u>DIANA PAGANO</u> <u>By Bruce Arzuman</u> | DATE <u>9/9/97</u> |
|--|-----------------------|

| | | | |
|---|-------------------------|------------------------|------------|
| LOCAL AGENCY USE ONLY THE STATE I.D. NUMBER IS COMPOSED OF THE FOUR NUMBERS BELOW | | | |
| STATE I.D.# | COUNTY # | JURISDICTION # | FACILITY # |
| | | | TANK # |
| PERMIT NUMBER | PERMIT APPROVED BY/DATE | PERMIT EXPIRATION DATE | |

THIS FORM MUST BE ACCOMPANIED BY A PERMIT APPLICATION - FORM A, UNLESS A CURRENT FORM A HAS BEEN FILED.
FILE THIS FORM WITH THE LOCAL AGENCY IMPLEMENTING THE UNDERGROUND STORAGE TANK REGULATIONS

STATE OF CALIFORNIA
STATE WATER RESOURCES CONTROL BOARD
UNDERGROUND STORAGE TANK PERMIT APPLICATION - FORM B



COMPLETE A SEPARATE FORM FOR EACH TANK SYSTEM.

| | | | | |
|---------------------------|---|---|---|--|
| MARK ONLY ONE ITEM | <input type="checkbox"/> 1 NEW PERMIT | <input type="checkbox"/> 3 RENEWAL PERMIT | <input type="checkbox"/> 5 CHANGE OF INFORMATION | <input checked="" type="checkbox"/> 7 PERMANENTLY CLOSED ON SITE |
| | <input type="checkbox"/> 2 INTERIM PERMIT | <input type="checkbox"/> 4 AMENDED PERMIT | <input type="checkbox"/> 6 TEMPORARY TANK CLOSURE | <input type="checkbox"/> 8 TANK REMOVED |

DBA OR FACILITY NAME WHERE TANK IS INSTALLED: QUALITY TUNE-UP, E. 14th ST. SAN LEANDRO, CA

I. TANK DESCRIPTION COMPLETE ALL ITEMS - SPECIFY IF UNKNOWN

| | |
|--|---|
| A. OWNER'S TANK I. D. # <u>UNKNOWN</u> | B. MANUFACTURED BY: <u>UNKNOWN</u> |
| C. DATE INSTALLED (MO/DAY/YEAR) <u>UNKNOWN</u> | D. TANK CAPACITY IN GALLONS: <u>500 GALLONS</u> |

II. TANK CONTENTS IF A-1 IS MARKED, COMPLETE ITEM C.

| | | | | | |
|--|-------------------------------------|---|---|-------------------------------------|---|
| A. <input type="checkbox"/> 1 MOTOR VEHICLE FUEL | 4 OIL | B. <input type="checkbox"/> 1 PRODUCT | C. <input type="checkbox"/> 1a REGULAR UNLEADED | 3 DIESEL | 6 AVIATION GAS |
| <input type="checkbox"/> 2 PETROLEUM | <input type="checkbox"/> 80 EMPTY | <input checked="" type="checkbox"/> 2 WASTE | <input type="checkbox"/> 1b PREMIUM UNLEADED | <input type="checkbox"/> 4 GASAHOL | <input type="checkbox"/> 7 METHANOL |
| <input type="checkbox"/> 3 CHEMICAL PRODUCT | <input type="checkbox"/> 95 UNKNOWN | | <input type="checkbox"/> 2 LEADED | <input type="checkbox"/> 5 JET FUEL | <input type="checkbox"/> 99 OTHER (DESCRIBE IN ITEM D. BELOW) |

D. IF (A.1) IS NOT MARKED, ENTER NAME OF SUBSTANCE STORED WASTE OIL C. A. S. #:

III. TANK CONSTRUCTION MARK ONE ITEM ONLY IN BOXES A, B, AND C, AND ALL THAT APPLIES IN BOX D AND E

| | | | |
|-------------------|---|---|-------------------------------------|
| A. TYPE OF SYSTEM | <input type="checkbox"/> 1 DOUBLE WALL | <input type="checkbox"/> 3 SINGLE WALL WITH EXTERIOR LINER | <input type="checkbox"/> 95 UNKNOWN |
| | <input checked="" type="checkbox"/> 2 SINGLE WALL | <input type="checkbox"/> 4 SECONDARY CONTAINMENT (VAULTED TANK) | <input type="checkbox"/> 99 OTHER |

| | | | | |
|---------------------------------|--|---|---------------------------------------|--|
| B. TANK MATERIAL (Primary Tank) | <input checked="" type="checkbox"/> 1 BARE STEEL | <input type="checkbox"/> 2 STAINLESS STEEL | <input type="checkbox"/> 3 FIBERGLASS | <input type="checkbox"/> 4 STEEL CLAD W/ FIBERGLASS REINFORCED PLASTIC |
| | <input type="checkbox"/> 5 CONCRETE | <input type="checkbox"/> 6 POLYVINYL CHLORIDE | <input type="checkbox"/> 7 ALUMINUM | <input type="checkbox"/> 8 100% METHANOL COMPATIBLE W/FRP |
| | <input type="checkbox"/> 9 BRONZE | <input type="checkbox"/> 10 GALVANIZED STEEL | <input type="checkbox"/> 95 UNKNOWN | <input type="checkbox"/> 99 OTHER |

| | | | | |
|--------------------|---|---|--|--|
| C. INTERIOR LINING | <input type="checkbox"/> 1 RUBBER LINED | <input type="checkbox"/> 2 ALKYD LINING | <input type="checkbox"/> 3 EPOXY LINING | <input type="checkbox"/> 4 PHENOLIC LINING |
| | <input type="checkbox"/> 5 GLASS LINING | <input type="checkbox"/> 6 UNLINED | <input checked="" type="checkbox"/> 95 UNKNOWN | <input type="checkbox"/> 99 OTHER |

IS LINING MATERIAL COMPATIBLE WITH 100% METHANOL? YES ___ NO ___

| | | | | |
|-------------------------|--|---|---------------------------------------|--|
| D. CORROSION PROTECTION | <input type="checkbox"/> 1 POLYETHYLENE WRAP | <input type="checkbox"/> 2 COATING | <input type="checkbox"/> 3 VINYL WRAP | <input type="checkbox"/> 4 FIBERGLASS REINFORCED PLASTIC |
| | <input type="checkbox"/> 5 CATHODIC PROTECTION | <input checked="" type="checkbox"/> 91 NONE | <input type="checkbox"/> 95 UNKNOWN | <input type="checkbox"/> 99 OTHER |

E. SPILL AND OVERFILL SPILL CONTAINMENT INSTALLED (YEAR) _____ OVERFILL PREVENTION EQUIPMENT INSTALLED (YEAR) _____

IV. PIPING INFORMATION CIRCLE A IF ABOVE GROUND OR U IF UNDERGROUND, BOTH IF APPLICABLE

| | | | | | | | | | | | | |
|--------------------------------------|---|--|---|--|---|---|---|---|---|---|---|---------------------------------------|
| A. SYSTEM TYPE | <input checked="" type="checkbox"/> A U 1 SUCTION | <input type="checkbox"/> A U 2 PRESSURE | <input checked="" type="checkbox"/> A U 3 GRAVITY | <input type="checkbox"/> A U 99 OTHER | | | | | | | | |
| B. CONSTRUCTION | <input checked="" type="checkbox"/> A U 1 SINGLE WALL | <input type="checkbox"/> A U 2 DOUBLE WALL | <input type="checkbox"/> A U 3 LINED TRENCH | <input type="checkbox"/> A U 95 UNKNOWN | <input type="checkbox"/> A U 99 OTHER | | | | | | | |
| C. MATERIAL AND CORROSION PROTECTION | <input checked="" type="checkbox"/> A U 1 BARE STEEL | <input type="checkbox"/> A U 2 STAINLESS STEEL | <input type="checkbox"/> A U 3 POLYVINYL CHLORIDE (PVC) | <input type="checkbox"/> A U 4 FIBERGLASS PIPE | <input type="checkbox"/> A U 5 ALUMINUM | <input type="checkbox"/> A U 6 CONCRETE | <input type="checkbox"/> A U 7 STEEL W/ COATING | <input type="checkbox"/> A U 8 100% METHANOL COMPATIBLE W/FRP | <input type="checkbox"/> A U 9 GALVANIZED STEEL | <input type="checkbox"/> A U 10 CATHODIC PROTECTION | <input type="checkbox"/> A U 95 UNKNOWN | <input type="checkbox"/> A U 99 OTHER |

D. LEAK DETECTION 1 AUTOMATIC LINE LEAK DETECTOR 2 LINE TIGHTNESS TESTING 3 INTERSTITIAL MONITORING 99 OTHER NONE

V. TANK LEAK DETECTION

| | | | | |
|--|---|--|---|--|
| <input checked="" type="checkbox"/> 1 VISUAL CHECK | <input type="checkbox"/> 2 INVENTORY RECONCILIATION | <input type="checkbox"/> 3 VADOZE MONITORING | <input type="checkbox"/> 4 AUTOMATIC TANK GAUGING | <input type="checkbox"/> 5 GROUND WATER MONITORING |
| <input type="checkbox"/> 6 TANK TESTING | <input type="checkbox"/> 7 INTERSTITIAL MONITORING | <input type="checkbox"/> 91 NONE | <input type="checkbox"/> 95 UNKNOWN | <input type="checkbox"/> 99 OTHER |

VI. TANK CLOSURE INFORMATION

| | | |
|--|---|---|
| 1. ESTIMATED DATE LAST USED (MO/DAY/YR) <u>9/10/97</u> | 2. ESTIMATED QUANTITY OF SUBSTANCE REMAINING <u>0</u> GALLONS | 3. WAS TANK FILLED WITH INERT MATERIAL? YES <input type="checkbox"/> NO <input checked="" type="checkbox"/> |
|--|---|---|

THIS FORM HAS BEEN COMPLETED UNDER PENALTY OF PERJURY, AND TO THE BEST OF MY KNOWLEDGE, IS TRUE AND CORRECT

| | |
|--|--------------------|
| APPLICANT'S NAME (PRINTED & SIGNATURE) <u>DIANA PAGANO</u> <u>By Diana Pagano</u> | DATE <u>9/9/97</u> |
|--|--------------------|

LOCAL AGENCY USE ONLY THE STATE I.D. NUMBER IS COMPOSED OF THE FOUR NUMBERS BELOW

| | | | | |
|---------------|-------------------------|----------------|------------------------|--------|
| STATE I.D.# | COUNTY # | JURISDICTION # | FACILITY # | TANK # |
| PERMIT NUMBER | PERMIT APPROVED BY/DATE | | PERMIT EXPIRATION DATE | |

THIS FORM MUST BE ACCOMPANIED BY A PERMIT APPLICATION - FORM A, UNLESS A CURRENT FORM A HAS BEEN FILED.
FILE THIS FORM WITH THE LOCAL AGENCY IMPLEMENTING THE UNDERGROUND STORAGE TANK REGULATIONS

Underground Storage Tank Removal Supplemental Questionnaire

1. Is the removal part of a new subdivision? Yes () No ()

2. Is the site located within a 100-year or a 500-year Flood Zone as shown on the FEMA "Flood Insurance Rate Map" for San Leandro?
No () 100-year () 500-year ()

3. Estimated ground surface area to be excavated? _____

4. Yards of Cut: _____ Yards of Fill: _____ Total Yards Moved: _____

5. List public streets proposed to be traveled for export hauling: _____

6. Will the excavation be within 15 ft of a property line? Yes () No ()

7. Will the excavation be within 15 ft of a building? Yes () No ()

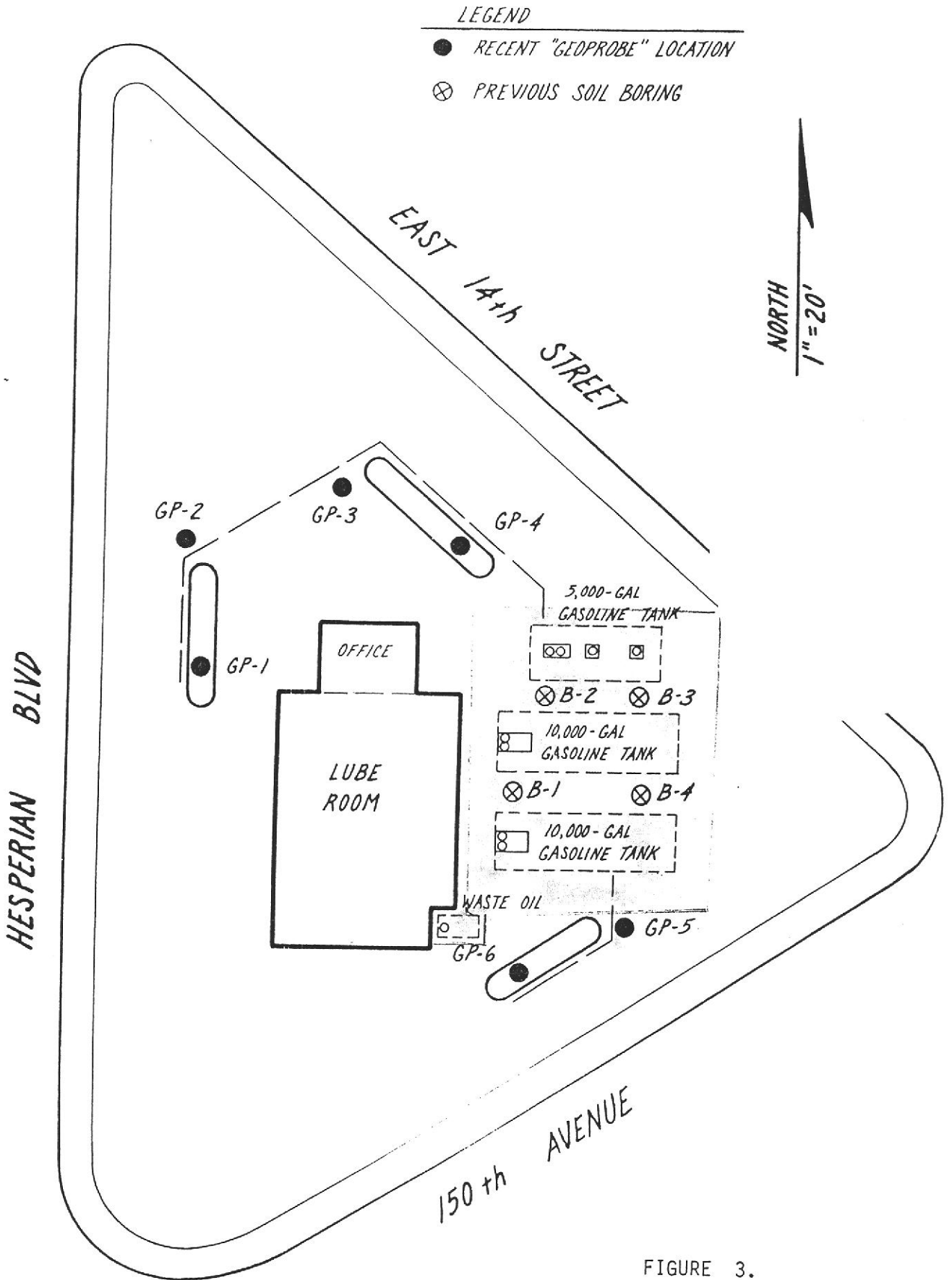

FIGURE 3.
Boring Locations.



State of California
CONTRACTORS STATE LICENSE BOARD
ACTIVE LICENSE



License No. 361828
Licensee Name JOHN POULSON

Exp. Date 12/31/98

License Class A HAZ

Expiration Date 07/31/98



AW

STATE OF CALIFORNIA
STATE AND CONSUMER SERVICES AGENCY CONTRACTORS STATE LICENSE BOARD



Building Quality



HAZARDOUS SUBSTANCES REMOVAL AND REMEDIAL ACTIONS CERTIFICATION

Pursuant to the provisions of Section 7058.7 of the Business and Professions Code, the Registrar of Contractors does hereby certify that the following qualifying person has successfully completed the hazardous substances removal and remedial actions examination.

Qualifier: JOHN EDWIN POULSON

License No.: 361828

Namestyle: JOHN POULSON



WITNESS my hand and official seal this
24th day of DECEMBER 1991

David R. Bellis
Registrar of Contractors

13L-36 (2/91)

This certification is the property of the Registrar of Contractors. It is not transferable, and shall be returned to the Registrar upon demand when suspended, revoked, or invalidated for any reason.

A 4327

CERTIFICATE OF TRAINING

JOHN PULLSON

HAS SUCCESSFULLY COMPLETED A TRAINING COURSE IN
HAZARDOUS WASTE OPERATIONS
8 HR. HAZARDOUS WASTE OPERATIONS/REFRESHER
29 CFR 1910.120 and 8 CCR 5192

MAY 1997
EXAM DATE

Craig Wright
COURSE INSTRUCTOR

COVENANT ENVIRONMENTAL
PO BOX 1006 LOTUS CA. 95651

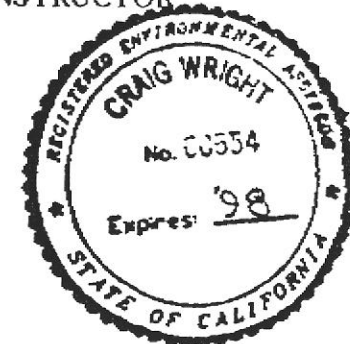

BUSINESS LICENSE CALCULATION FORM

ALL GROUPS Base fee

BUSINESS LICENSE

CITY OF SAN LEANDRO
835 EAST 14th STREET
SAN LEANDRO, CALIFORNIA 94577

FINANCE OFFICE
OFFICE HRS. MON-FRI 9:00-4:00
(510) 577-3381, 577-3378, 577-3468

BUSINESS NAME **HAGEMAN-AQUIAR, INC**
LOCATED AT **3732 MT. DIABLO BL 372**
TYPE OF BUSINESS **PROFESSIONALS**

PAID
CITY OF SAN LEANDRO
JULY 18 1996
FINANCE OFFICE
Expires Dec. 31 1996

MAIL ADDRESS

HAGEMAN-AQUIAR, INC
3732 MT. DIABLO BL 372
LAFAYETTE, CA 94549

| GROUP | BUSINESS LICENSE NUMBER |
|-------|-------------------------|
| IV | 17712 |

Diana Pagano
6912 Broadway Terrace
Oakland, Ca. 94611-1924

November 26, 1996

City of San Leandro
Civic Center
835 E. 14th Street
San Leandro, Ca. 94577

Attention: Mike Bakaldin
Hazardous Material Division

Gentlemen:

Per your letter of November 22, 1996 enclosed herewith is my deposit check #4343 dated November 26, 1996 in the amount of \$480.00 for the additional subsurface investigation at 14901 East 14th Street San Leandro, California.

Very truly yours,

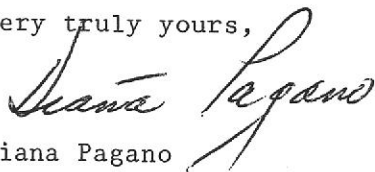

Diana Pagano

dp
encl.

**STATE
COMPENSATION
INSURANCE
FUND**

P.O. BOX 807, SAN FRANCISCO, CA 94101-0807

CERTIFICATE OF WORKERS' COMPENSATION INSURANCE

ISSUE DATE: 11-25-96

POLICY NUMBER: 0726288 - 96
CERTIFICATE EXPIRES: 11-25-97

CITY OF SAN LEANDRO
BLDG. INSPT. DEPT.
835 E. 14TH ST.
SAN LEANDRO CA 94577

This is to certify that we have issued a valid Workers' Compensation insurance policy in a form approved by the California Insurance Commissioner to the employer named below for the policy period indicated.

This policy is not subject to cancellation by the Fund except upon 10 days' advance written notice to the employer.

We will also give you 10 days' advance notice should this policy be cancelled prior to its normal expiration.

This certificate of insurance is not an insurance policy and does not amend, extend or alter the coverage afforded by the policies listed herein. Notwithstanding any requirement, term, or condition of any contract or other document with respect to which this certificate of insurance may be issued or may pertain, the insurance afforded by the policies described herein is subject to all the terms, exclusions and conditions of such policies.

Kenneth C. Bollier
PRESIDENT

EMPLOYER'S LIABILITY LIMIT INCLUDING DEFENSE COSTS: \$1,000,000.00 PER OCCURRENCE.

EMPLOYER

LEGAL NAME

HAGEMAN-AGUIAR, INC
SUITE 372
3732 MT. DIABLO BLVD.
LAFAYETTE CA 94549

HAGEMAN-AGUIAR, INC

City of San Leandro
Civic Center, 835 E. 14th Street
San Leandro, California 94577



November 22, 1996

Ms. Diana Pagano
6912 Broadway Terrace
Oakland, CA 94611

Dear Ms. Pagano:

Approval of Additional Subsurface Investigation Workplan for 14901 East 14th

The City of San Leandro's Hazardous Materials Division has reviewed Hageman-Aguiar's proposed workplan, dated November 4, 1996. The workplan is approved subject to the following conditions:

1. That this office be notified at least 48 hours prior to start of field work.
2. That at least one groundwater sample be collected from the area surrounding each former island.
3. That the soil sampling depths be specified and approved by this office.
4. That at each island one boring be punched through the former island and the second be punched immediately adjacent to a piping run.

The City of San Leandro's Hazardous Materials Division will oversee all remedial activities at your site. A check for \$480 must be submitted to this office to pay for staff time associated with review of reports and oversight of this project. Please make the check payable to the City of San Leandro Hazardous Materials Division. The deposit will be placed into an account from which money will be drawn at the rate of \$60 per hour for time spent on this project. At the end of this project all unused funds will be returned to you.

Financial assistance to pay for the cost of investigating, remediating, and monitoring your leaking underground storage tank site is available through the state underground storage tank cleanup fund. For more information on the fund and to obtain an application package please refer to the enclosed brochure.

If you have any questions, please call me at 577-3331.

Sincerely,

Michael Bakaldin
Hazardous Materials Coordinator

attachment

cc: Kevin Graves, SFBRWQCB
Gary Aguiar, Hageman-Aguiar

Ellen M. Corbett, Mayor

City Council:
Joanne M. Lothrop;

Gordon A. Galvan;
Julian P. Polvorosa;

Bob Glaze;
Shelia Young;

Garry A. Loeffler;

City of San Leandro
Civic Center, 835 E. 14th Street
San Leandro, California 94577

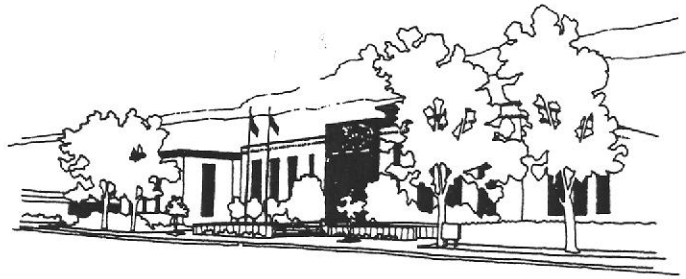

November 19, 1993

Ms. Diana Pagano
6912 Broadway Terrace
Oakland, CA 94611

Dear Ms. Pagano:

Underground Tank Closure at 14901 East 14th Street

After reviewing the data obtained during the recent soil investigation at your property at 14901 East 14th it appears that there is at least some soil and groundwater contamination underneath your property. Although it appears that closure in place is still a possibility I would like to discuss the closure with you prior to approving any workplan. I would also like to discuss the existing contamination problems surrounding your property and how they may affect your property.

By way of copy of this letter I am inviting Scott Seery of Alameda County to this meeting since he is actively working on the surrounding contamination problems. Also, I would encourage you to bring your consultants and Mr. Larry Armstrong to this meeting and I will forward them a copy of this letter.

Please let me know as soon as possible which of the following meeting dates will work for you so that we may set a firm meeting date:

December 7 10:00 a.m. or 2:00 p.m.
December 16 10:00 a.m. or 2:00 p.m.

The meeting will be held at the San Leandro Fire Department offices at 901 East 14th Street. Please call me at 577-3331 to confirm the meeting date and time.

Sincerely,

Michael Bakaldin
Hazardous Materials Coordinator
San Leandro Fire Department

cc: Scott Seery, Alameda County
 Larry Armstrong, Quality Tune-Up
 Gary Aguiar, Hageman-Aguiar

Dave Karp, Mayor

City Council: Ellen M. Corbett; John E. Faria; Howard W. Kerr;
 Kent W. Myers; Linda Perry; Julian P. Polvorosa; Mike Oliver, City Manager

Reviewed By _____

San Leandro Fire Department
Hazardous Materials Division

Rev 4/91

Approval Date _____

835 East 14th Street
San Leandro, CA 94577

Date Received 8/4/93

Rejection Date _____

(415) 577-3331

Fees Paid \$416

UNDERGROUND STORAGE TANK CLOSURE PLAN/PERMIT
ABANDONMENT IN PLACE

- Facility Name: QUALITY TUNE UP Address: 14901 E. 14TH ST.
SAN LEANDRO, CA
Contact Person: MS DIANA PAGANO Phone No.: _____
Generator's U.S. EPA Number: 921-632-642
- Contractor: HAGEMAN-AGUIAR INC License Type & No.: RCE 34262
Address: 3732 MT. DIABLO BLVD SUITE 372, LAFAYETTE, CA
Contact Person: BRUCE HAGEMAN Phone No.: (510) 284-1661
- Sampling to be performed by: HAGEMAN-AGUIAR, INC. Phone No.: (510) 284-1661
- Laboratory services to be provided by: PRIORITY ENVIRONMENTAL LAB
DOHS Certificate No.: _____ Phone No.: (408)-946-9636
- Tank Hauler: _____ EPA ID No.: _____
Address: _____ Phone No.: _____
Destination of Tank(s): _____
- Method of inerting tank(s): _____
- Type of explosimeter or combustible gas meter to be provided: _____
- Tanks to be removed:

| | Size | Content | Material of Construction | Age | Sample Analysis Method |
|--------|--------------|--------------------------|--------------------------|------------------|---------------------------------|
| Tank 1 | <u>8000</u> | <u>GASOLINE</u> | <u>STEEL</u> | <u>LINK BELL</u> | <u>5030/8015</u> <u>8020</u> |
| Tank 2 | <u>10000</u> | <u>UNLEADED GASOLINE</u> | <u>STEEL</u> | <u>LINK BELL</u> | <u>5030/8015</u> <u>8020</u> |
| Tank 3 | <u>10000</u> | <u>PREM UNLEADED</u> | <u>STEEL</u> | <u>LINK BELL</u> | <u>5030/8015</u> <u>8020</u> |
| Tank 4 | | | | | |
| Piping | | | | | |

I acknowledge receipt and agree to comply with the San Leandro Fire Department Underground Storage Tank Closure Requirements. I declare under penalty of perjury that the aforementioned information is true and correct, to the best of my knowledge.

Company Name: HAGEMAN-AGUIAR, INC. Address: 3732 MT. DIABLO BLVD.
STE 372
Applicant's Signature _____ Date 7-30-93

Number of Tanks Removed _____ Inspector _____ Date _____



Underground Contamination Investigations, Groundwater Consultants, Environmental Engineering

FIRE DEPARTMENT
AUG 16 1993
CITY OF SAN LEANDRO

July 30, 1993

Mr. Mike Bakaldin
Hazardous Materials Coordinator
San Leandro Fire Department
835 E. 14th Street
San Leandro, CA

Re: Ms. Diana Pagano
6912 Broadway Terrace
Oakland, CA 94611

Application for Abandonment
of Underground Storage Tanks
located at 14901 East 14th
San Leandro, CA

Dear Mr. Bakaldin:

Please find enclosed an application for Abandonment in Place for the underground storage tanks located at 14901 East 14th Street, San Leandro, CA.

This application is submitted for approval based on discussions Ms. Pagano and I had with you concerning this project.

Prior to the actual abandonment, we will do soil borings around and between the underground tanks and take soil samples for analysis of Total Petroleum Hydrocarbons, as gasoline. Based on the results of the soil analysis, the tank abandonment will be completed.

Should you have any questions concerning this project please call our office and I will be happy to discuss them with you.

Sincerely,
HAGEMAN-AGUIAR, INC.

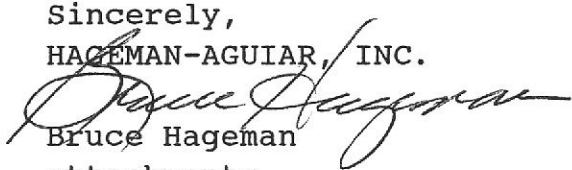
Bruce Hageman
attachments

City of San Leandro
Civic Center, 835 E. 14th Street
San Leandro, California 94577



May 25, 1993

Ms. Diana Pagano
6912 Broadway Terrace
Oakland, CA 94611

Dear Ms. Pagano:

Underground Storage Tanks at 14901 East 14th

A recent fire inspection at your property revealed the presence of at least one underground storage tank. A review of our records indicate the tanks have not been removed. Since 1983, California state law has required owners of underground storage tanks to register and permit their underground storage tanks. Our records indicate that your tanks have never been registered or permitted.

Since the tanks have never been permitted or monitored for leakage they are considered abandoned and must be removed from the ground under the oversight of the San Leandro Fire Department. An underground storage tank closure package, containing all pertinent forms and instructions is enclosed.

In the event the underground tanks have already been removed, please send the pertinent documentation to this office so that we may update our files. Once it has been determined that the underground tanks have been removed it would be advisable to remove any remaining vent pipes and former pump islands.

Please be advised that this a formal request for tank closure under California Health and Safety Code Section 25298. The tank closure permit application must be submitted to this office by July 31, 1993. If you have any questions, please call me at (510) 577-3331.

Sincerely,

Michael Bakaldin
Hazardous Materials Coordinator
San Leandro Fire Department

Enclosure

Dave Karp, Mayor



City Council: Ellen M. Corbett; John E. Faria; Howard W. Kerr;
Kent W. Myers; Linda Perry; Julian P. Polvorosa; Mike Oliver, City Manager