

## Wickham, Jerry, Env. Health

---

**From:** Silva, Brian <bsilva@craworld.com>  
**Sent:** Thursday, April 30, 2015 4:06 PM  
**To:** Wickham, Jerry, Env. Health  
**Cc:** MacLeod, Carryl G; Roe, Dilan, Env. Health  
**Subject:** RE: Mills Square Park, Livermore - RO0002908  
**Attachments:** 307233-2015.3(PRES004)-Figures.pdf

Jerry-

As promised, here is a quick recap of our meeting last week and the draft figures that were discussed. After the upcoming meeting next week, the figures can be refined and the new proposed park features can be added. Please let me know if I missed anything or if you have any questions or comments.

ACEH meeting notes - 4/22/15

Attendees:

Jerry Wickham – ACEH  
Dilan Roe – ACEH  
Carryl MacLeod – Chevron EMC  
Brian Silva – CRA

ACEH needs a well-defined plan that addresses how lead impacted soil at the site will be handled. ACEH needs a better defined schedule showing City of Livermore and Chevron's schedules and plans and any deliverables. Plan needs to address fate of excavated soils (inc. utility, footing, and landscaping excavations), lead impacts left in place, and any areas that may still need profiling (due to the variability of lead concentrations across the site).

Current Soil Management Plan is too general, needs the following:

- Define areas to be excavated and to what depth
- Soil handling and disposal procedures (inc. fate of any excavated soils)
- Dust suppression details
- For any Lead concentrations left in place include how it will be managed

Action Items:

- Prepare profile and plan view maps showing lead data and assumed excavation depths
- Meet with ACEH and City of Livermore to discuss scope of work and schedule

Thank you,

---

Brian Silva  
Conestoga-Rovers & Associates (CRA)  
10969 Trade Center Drive  
Suite 107  
Rancho Cordova, CA 95670

Phone: 916.889.8908  
Fax: 916.889.8999  
Cell: 916.919.0403

Email: [bsilva@CRAworld.com](mailto:bsilva@CRAworld.com)

[www.CRAworld.com](http://www.CRAworld.com)

Think before you print

Perform every task the safe way, the right way, every time!

-----Original Message-----

From: Wickham, Jerry, Env. Health [mailto:[jerry.wickham@acgov.org](mailto:jerry.wickham@acgov.org)]

Sent: Monday, April 20, 2015 2:21 PM

To: Silva, Brian

Cc: MacLeod, Carryl G

Subject: Re: Mills Square Park, Livermore - RO0002908

Brian,

I am available to meet Wednesday (4/22) afternoon at 1:30 pm.

Regards,

Jerry Wickham

Alameda County Environmental Health

Sent from my iPad

On Apr 20, 2015, at 11:20 AM, "Silva, Brian" <[bsilva@craworld.com](mailto:bsilva@craworld.com)<<mailto:bsilva@craworld.com>>> wrote:

Jerry-

Your voicemail said you were out of the office, so I am sending this e-mail to see if we (Chevron and CRA) can set up a meeting either tomorrow afternoon (4/21) or on Wednesday afternoon (4/22) to briefly discuss the site with you. Carryl MacLeod of Chevron will already be at your office on Wednesday for meetings in the AM so if possible we would ideally like to meet with you Wednesday after lunch. We would like to have this meeting prior to meeting with the City of Livermore and ACEH. Please let me know if either of these time will work for you.

Thanks,

\_\_\_\_\_  
Brian Silva

Conestoga-Rovers & Associates (CRA)

10969 Trade Center Drive

Suite 107

Rancho Cordova, CA 95670

Phone: 916.889.8908

Fax: 916.889.8999

Cell: 916.919.0403

Email: [bsilva@CRAworld.com](mailto:bsilva@CRAworld.com)<<mailto:bsilva@CRAworld.com>>

[www.CRAworld.com](http://www.CRAworld.com)<<http://www.CRAworld.com>>

Think before you print

Perform every task the safe way, the right way, every time!

\_\_\_\_\_  
CRA and GHD have merged! To learn more, visit [www.CRAworld.com/ghd](http://www.CRAworld.com/ghd)<<http://www.CRAworld.com/ghd>>

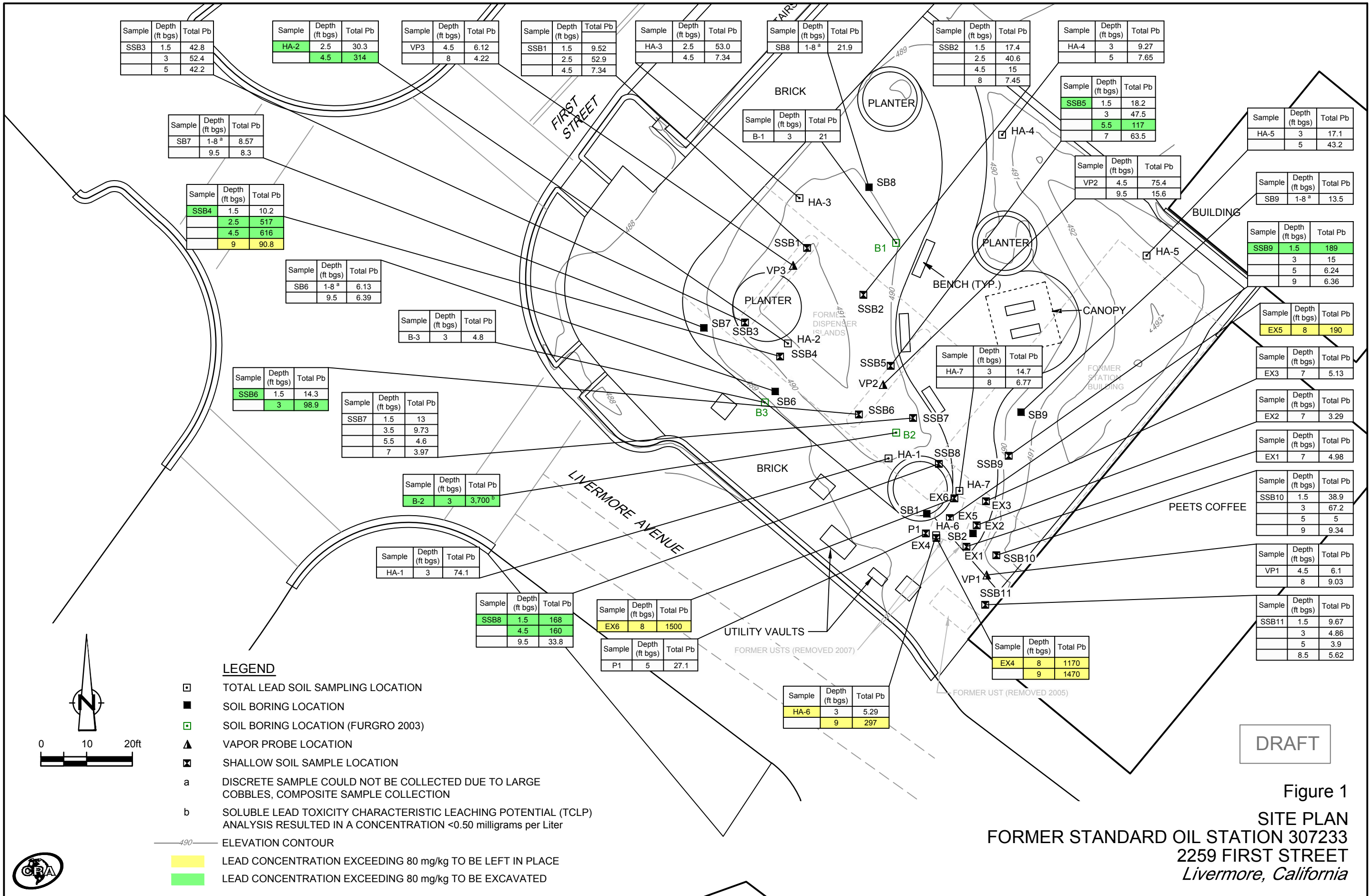

Sample	Depth (ft bgs)	Total Pb
SSB3	1.5	42.8
	3	52.4
	5	42.2

Sample	Depth (ft bgs)	Total Pb
HA-2	2.5	30.3
	4.5	314

Sample	Depth (ft bgs)	Total Pb
VP3	4.5	6.12
	8	4.22

Sample	Depth (ft bgs)	Total Pb
SSB1	1.5	9.52
	2.5	52.9
	4.5	7.34

Sample	Depth (ft bgs)	Total Pb
HA-3	2.5	53.0
	4.5	7.34

Sample	Depth (ft bgs)	Total Pb
SB8	1-8 <sup>a</sup>	21.9

Sample	Depth (ft bgs)	Total Pb
SSB2	1.5	17.4
	2.5	40.6
	4.5	15
	8	7.45

Sample	Depth (ft bgs)	Total Pb
HA-4	3	9.27
	5	7.65

Sample	Depth (ft bgs)	Total Pb
SSB5	1.5	18.2
	3	47.5
	5.5	117
	7	63.5

Sample	Depth (ft bgs)	Total Pb
HA-5	3	17.1
	5	43.2

Sample	Depth (ft bgs)	Total Pb
SB7	1-8 <sup>a</sup>	8.57
	9.5	8.3

Sample	Depth (ft bgs)	Total Pb
VP2	4.5	75.4
	9.5	15.6

Sample	Depth (ft bgs)	Total Pb
SB9	1-8 <sup>a</sup>	13.5

Sample	Depth (ft bgs)	Total Pb
SSB4	1.5	10.2
	2.5	517
	4.5	616
	9	90.8

Sample	Depth (ft bgs)	Total Pb
SSB9	1.5	189
	3	15
	5	6.24
	9	6.36

Sample	Depth (ft bgs)	Total Pb
SB6	1-8 <sup>a</sup>	6.13
	9.5	6.39

Sample	Depth (ft bgs)	Total Pb
B-3	3	4.8

Sample	Depth (ft bgs)	Total Pb
EX5	8	190

Sample	Depth (ft bgs)	Total Pb
SSB6	1.5	14.3
	3	98.9

Sample	Depth (ft bgs)	Total Pb
EX3	7	5.13

Sample	Depth (ft bgs)	Total Pb
SSB7	1.5	13
	3.5	9.73
	5.5	4.6
	7	3.97

Sample	Depth (ft bgs)	Total Pb
EX2	7	3.29

Sample	Depth (ft bgs)	Total Pb
B-2	3	3,700 <sup>b</sup>

Sample	Depth (ft bgs)	Total Pb
EX1	7	4.98

Sample	Depth (ft bgs)	Total Pb
HA-1	3	74.1

Sample	Depth (ft bgs)	Total Pb
SSB10	1.5	38.9
	3	67.2
	5	5
	9	9.34

Sample	Depth (ft bgs)	Total Pb
SSB8	1.5	168
	4.5	160
	9.5	33.8

Sample	Depth (ft bgs)	Total Pb
VP1	4.5	6.1
	8	9.03

Sample	Depth (ft bgs)	Total Pb
EX6	8	1500

Sample	Depth (ft bgs)	Total Pb
EX4	8	1170
	9	1470

Sample	Depth (ft bgs)	Total Pb
HA-6	3	5.29
	9	297

DRAFT

**LEGEND**

- TOTAL LEAD SOIL SAMPLING LOCATION
- SOIL BORING LOCATION
- ▣ SOIL BORING LOCATION (FURGRO 2003)
- ▲ VAPOR PROBE LOCATION
- ⊠ SHALLOW SOIL SAMPLE LOCATION
- a DISCRETE SAMPLE COULD NOT BE COLLECTED DUE TO LARGE COBBLES, COMPOSITE SAMPLE COLLECTION
- b SOLUBLE LEAD TOXICITY CHARACTERISTIC LEACHING POTENTIAL (TCLP) ANALYSIS RESULTED IN A CONCENTRATION <0.50 milligrams per Liter
- 490— ELEVATION CONTOUR
- LEAD CONCENTRATION EXCEEDING 80 mg/kg TO BE LEFT IN PLACE
- LEAD CONCENTRATION EXCEEDING 80 mg/kg TO BE EXCAVATED

Figure 1  
**SITE PLAN**  
**FORMER STANDARD OIL STATION 307233**  
**2259 FIRST STREET**  
*Livermore, California*



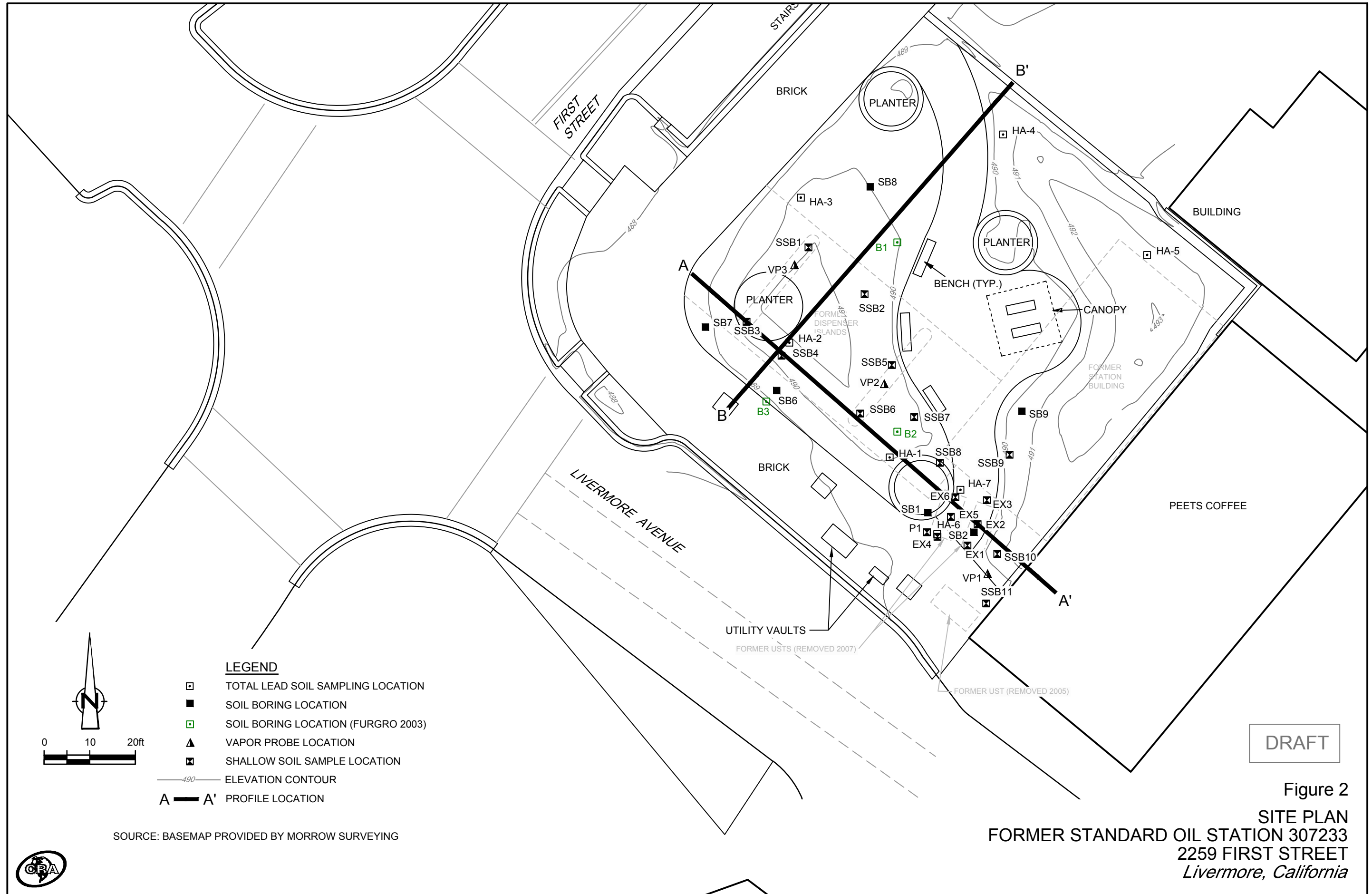

- LEGEND**
- TOTAL LEAD SOIL SAMPLING LOCATION
  - SOIL BORING LOCATION
  - (Green) SOIL BORING LOCATION (FURGR0 2003)
  - ▲ VAPOR PROBE LOCATION
  - ⊠ SHALLOW SOIL SAMPLE LOCATION
  - - - 490 - - - ELEVATION CONTOUR
  - A — A' PROFILE LOCATION

SOURCE: BASEMAP PROVIDED BY MORROW SURVEYING

DRAFT

Figure 2  
 SITE PLAN  
 FORMER STANDARD OIL STATION 307233  
 2259 FIRST STREET  
 Livermore, California



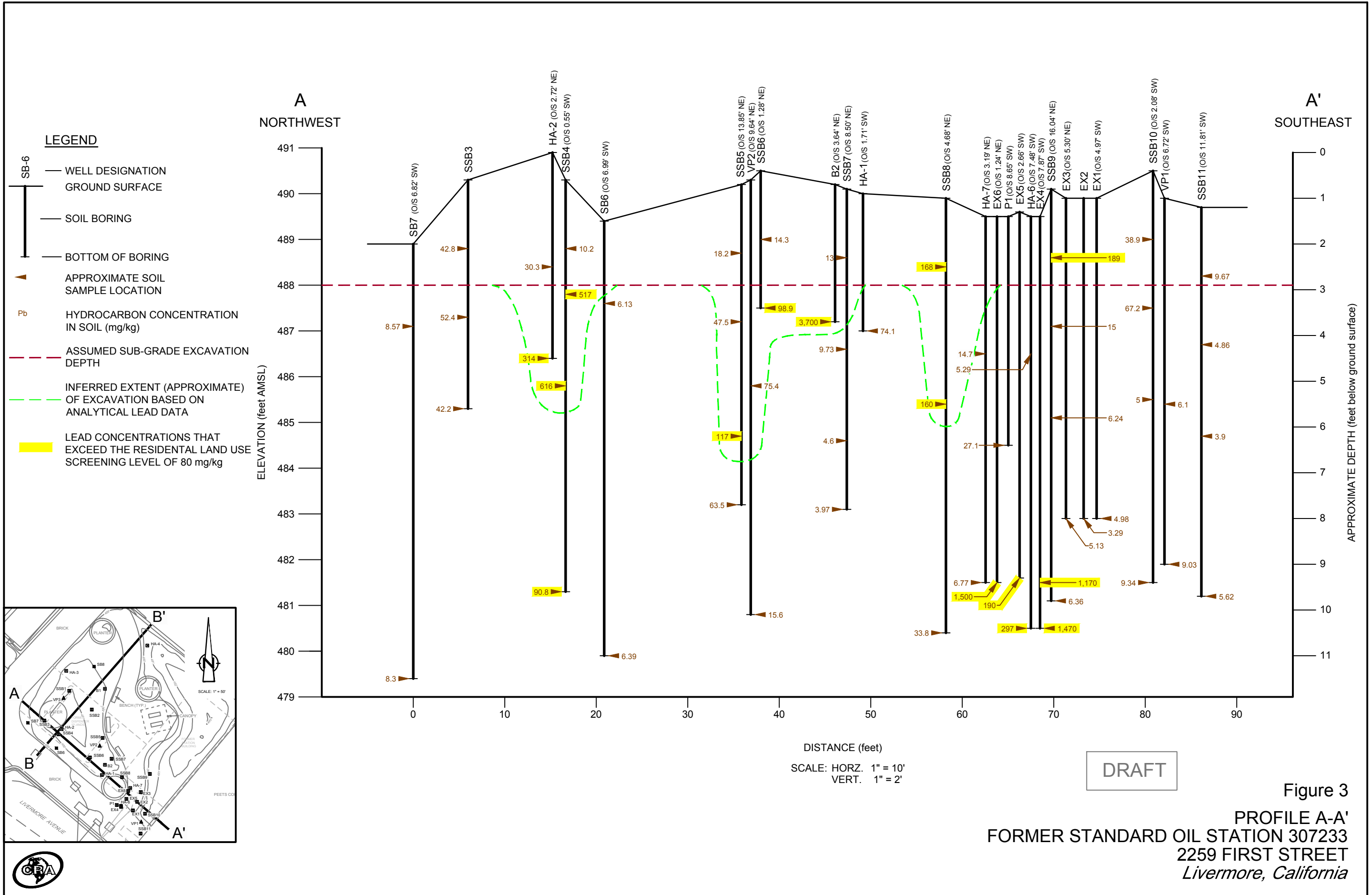

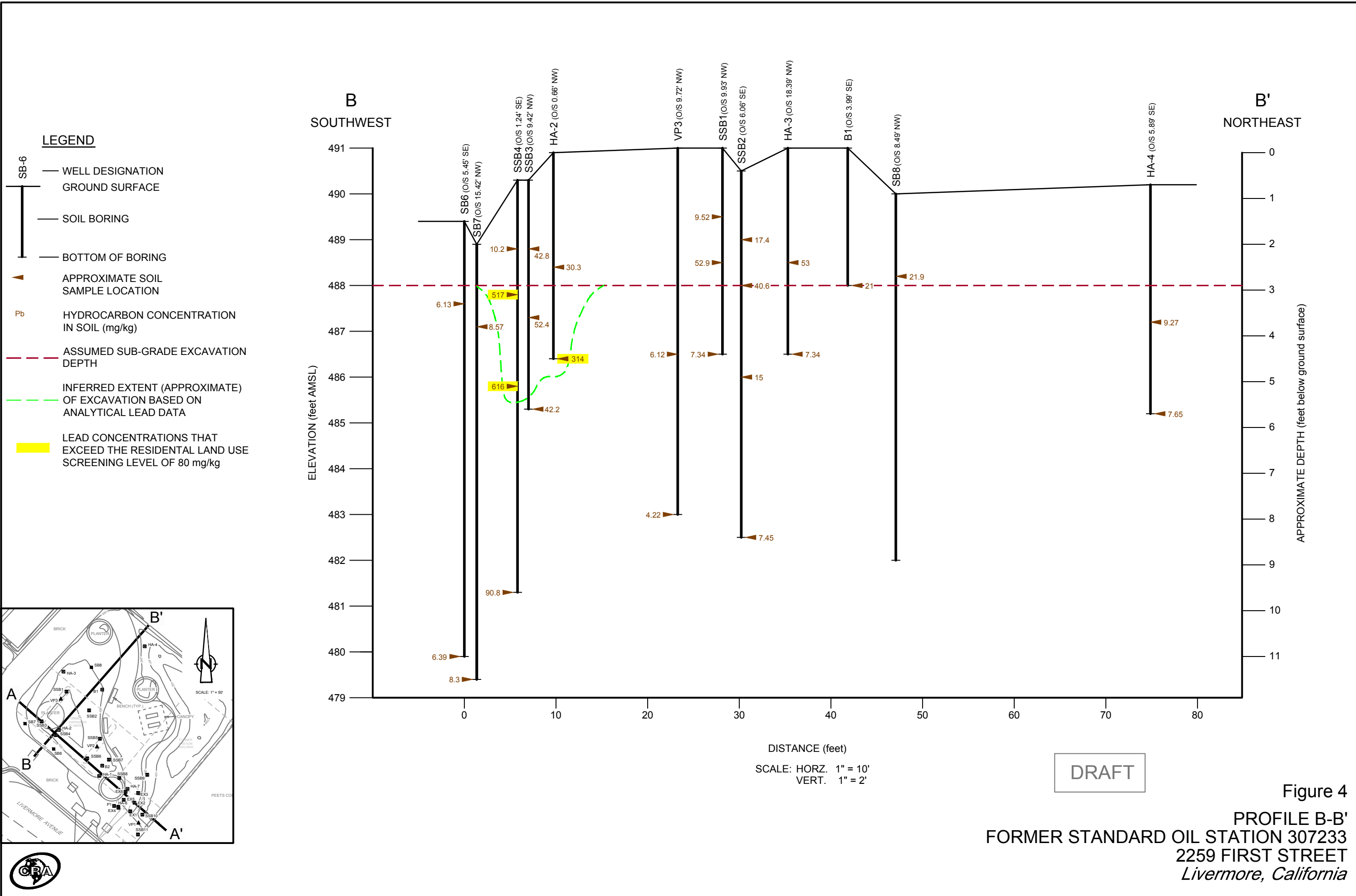

Figure 4  
 PROFILE B-B'  
 FORMER STANDARD OIL STATION 307233  
 2259 FIRST STREET  
 Livermore, California