



102880

Alameda County  
OCT 04 2005  
Environmental Health

## TANK CLOSURE REPORT

748 Lincoln Avenue  
Alameda, California  
Job No. 8657  
June 27, 2005

(AMENDED)  
OR 09/19/06  
(FIG 2 REPLACED)

Prepared For:

Robert G Bond  
865 Hallmark Drive  
Redding, California 96001-0185



*Tim Hallen*

Tim Hallen  
Registered Environmental Assessor 06237

TABLE OF CONTENTS

COVER SHEET

TABLE OF CONTENTS

1. SITE LOCATION	1
2. SITE HISTORY	1
3. TANK REMOVAL	1
4. TANK AND SOIL CONDITION	2
5. TANK REMOVAL SAMPLING	2
6. TANK REMOVAL SAMPLE RESULTS	2
7. SITE RESTORATION	3
8. FINDINGS / RECOMMENDATION	3

ATTACHMENTS

## 1. SITE LOCATION

The subject residential property is located at 748 Lincoln Avenue, between Concordia Street and Constitution Way in Alameda, California. Figure 1 attached shows the general site vicinity. The approximate location of the tank as well as nearby streets is shown on the attached Figure 2. Photographs of the tank removal activities are shown on the attached Figure 3.

## 2. SITE HISTORY

One underground, heating oil storage tank was located beneath the sidewalk along the Lincoln Avenue frontage of the property. The tank had a capacity of approximately 1,500 gallons, measuring about 10 feet long by 5 feet in diameter, and was constructed of steel. The fill port was located on the west end of the tank. The age of the tank is unknown but is believed to be between 60 and 80 years old. The owner had no knowledge of the tank nor is there any indication of previous site investigation activities.

## 3. TANK REMOVAL

In May 2005, Golden Gate Tank Removal, Inc. (GGTR) applied for and obtained permits from County of Alameda Department of Environmental Health, City of Alameda Fire Department and the City of Alameda Office of Planning and Building. Copies of the permits are attached. All site work was performed in accordance with state and local regulations.

On June 10, 2005, GGTR mobilized its equipment and began work on the project. The concrete sidewalk covering the tank was removed and disposed of at a local recycler. The overburden soil covering the tank was removed and placed in a covered stockpile adjacent to the tank excavation, in the parking lane of Lincoln Avenue. Measurements indicated the bottom of the tank to be 10 feet below the sidewalk elevation. The subsurface product piping extending between the top of the tank and the foundation of the exterior building structure was cut at each end, drained of any residual product, and removed from the excavation area. The subsurface piping remaining in place was filled with concrete and capped. There were no pipes found in the heating area.

As part of the removal operations, GGTR contracted Clearwater Environmental to pump the residual product from the tank and piping into a tanker truck. GGTR then cleaned the interior of the tank by pressure washing with 180-degree water under 3000-psi pressure. A non-toxic enzyme was used to break down thick oil deposits. After a third washing, Clearwater Environmental then removed the wash and rinse water from the tank and transported the Non-RCRA hazardous waste liquid (600 Gallons) under Uniform Waste Manifest No. 24316107 to the Alviso Independent Oil facility in Alviso, California. A copy of the liquid waste manifest is attached.

On June 15, 2005, upon the approval of Mr. Robert Weston of the Alameda County Health Department, GGTR removed the tank from the excavation. After a visual inspection, the tank was then loaded onto a flatbed truck and transported for disposal by Ecology Control Industries in Richmond, California. A copy of the Uniform Hazardous Waste Manifest No. 24528078 is attached.

#### 4. TANK AND SOIL CONDITION

The tank was found to be in poor condition with at least one visible hole. No soil discoloration was observed in the tank overburden soil or in the soil underlying the tank. No hydrocarbon odors were noted in the overburden soil or in the soil underlying the tank. The overburden soil was predominantly clay and sand. The soil underlying the tank was predominantly clay and sand.

#### 5. TANK REMOVAL SAMPLING

Immediately following tank removal activities, under the direction of Mr. Weston, GGTR collected one sample from beneath the end of the former tank. Soil sample 8657-E [11'6"] was collected from the east end of the tank excavation at approximately 11'6" below the sidewalk surface. Water sample 8657-WATER was collected from the center of the tank excavation at approximately 10 feet below the sidewalk surface. In addition, GGTR collected one four-point composite soil sample from the soil stockpile containing the overburden soil. The composite stockpile sample was labeled 8657-SP.

#### 6. TANK REMOVAL SAMPLE RESULTS

The tank excavation and stockpile composite soil samples were analyzed for Total Petroleum Hydrocarbons (TPH) as Diesel (TPH-D; EPA Method 8015M), Benzene, Toluene, Ethylbenzene and Total Xylenes (BTEX; EPA Methods 5030/8020F), and Methyl Tertiary-Butyl Ether (MTBE; EPA Methods 5030/8020F). Table 1, presented below, summarizes the analytical results for the tank removal samples. "ND" indicates Non-Detectable results. A copy of the laboratory certificate of analysis and chain of custody form is attached.

TABLE 1  
TANK REMOVAL SAMPLE RESULTS

SAMPLE I.D.	TPH-D (ppm)	Benzene (ppm)	Toluene (ppm)	Ethylbenzene (ppm)	Xylenes (ppm)	MTBE (ppm)
8657- SP (Overburden Stockpile)	ND	ND	ND	ND	ND	ND
8657-WATER (Water in Excavation)	9.1	ND	ND	ND	ND	ND
8657-E [11'6"] (East end of Excavation)	ND	ND	ND	ND	ND	ND

Note: ppm - parts per million [equivalent to milligrams per kilogram (mg/kg)]

## 7. SITE RESTORATION

By June 17, 2005, GGTR backfilled the excavation with the stockpiled overburden soil and clean imported soil. The excavation backfill soil was subsequently compacted and the concrete sidewalk was replaced in accordance with the City of Alameda Department of Public Work requirements.

## 8. FINDINGS / RECOMMENDATION

There were visible holes in the tank. There was no visual evidence of contamination in the soil underlying the tank. Groundwater was not noted during the tank removal or sampling activities. (The water sampled in the excavation appeared to be trapped rainwater). The analytical results from the State Certified Laboratory following the tank removal and remedial activities showed levels of total petroleum hydrocarbons as diesel and BTEX below the Action Level for residential heating oil tanks. Therefore, it is the recommendation of Golden Gate Tank Removal, Inc. that no further action is taken and the site is to be closed by the County of Alameda Department of Environmental Health

**ATTACHMENTS**

**VICINITY MAP, SITE PLAN, PHOTOGRAPHS  
ANALYTICAL REPORT, CHAIN OF CUSTODY FORM  
UST CLOSURE INSPECTION RECORDS  
CERTIFICATE OF TANK DISPOSAL  
TANK DISPOSAL MANIFEST  
LIQUID MANIFEST  
PERMITS**

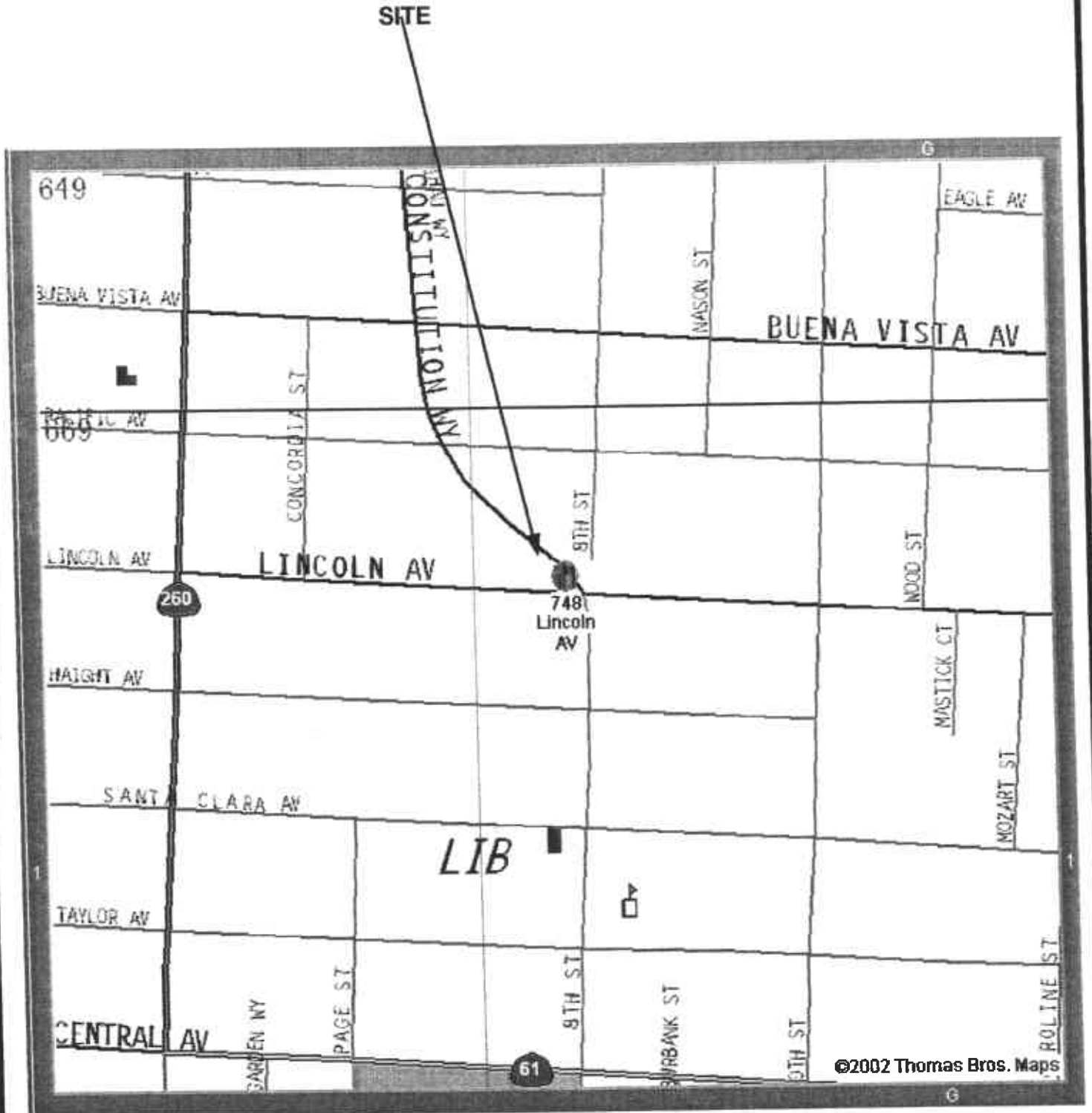

Golden Gate Tank Removal Inc  
 255 Shipley Street  
 San Francisco CA, 94107  
 415-512-1555 415-512-0964  
 GGTR Project No. 8657

Drawing By: SM

VICINITY MAP  
 748 LINCOLN AVE  
 ALAMEDA CA, 94501

JUNE, 2005

FIGURE 02

Notes: Figure 2 based upon GGTR's September 19, 2005 Site Reconnaissance:  
 UST removal samples shown are not to scale.

**LEGEND**

- ⊙ ⊙ UST Removal Soil/ Groundwater Sample (June 15, 2005)
- ↑ Estimated Groundwater Flow Direction
- ⊔ Approximate Limit of UST Excavation
- PL Property Line
- ⊠ Approximate Location of Sump Pump



**LINCOLN AVENUE**

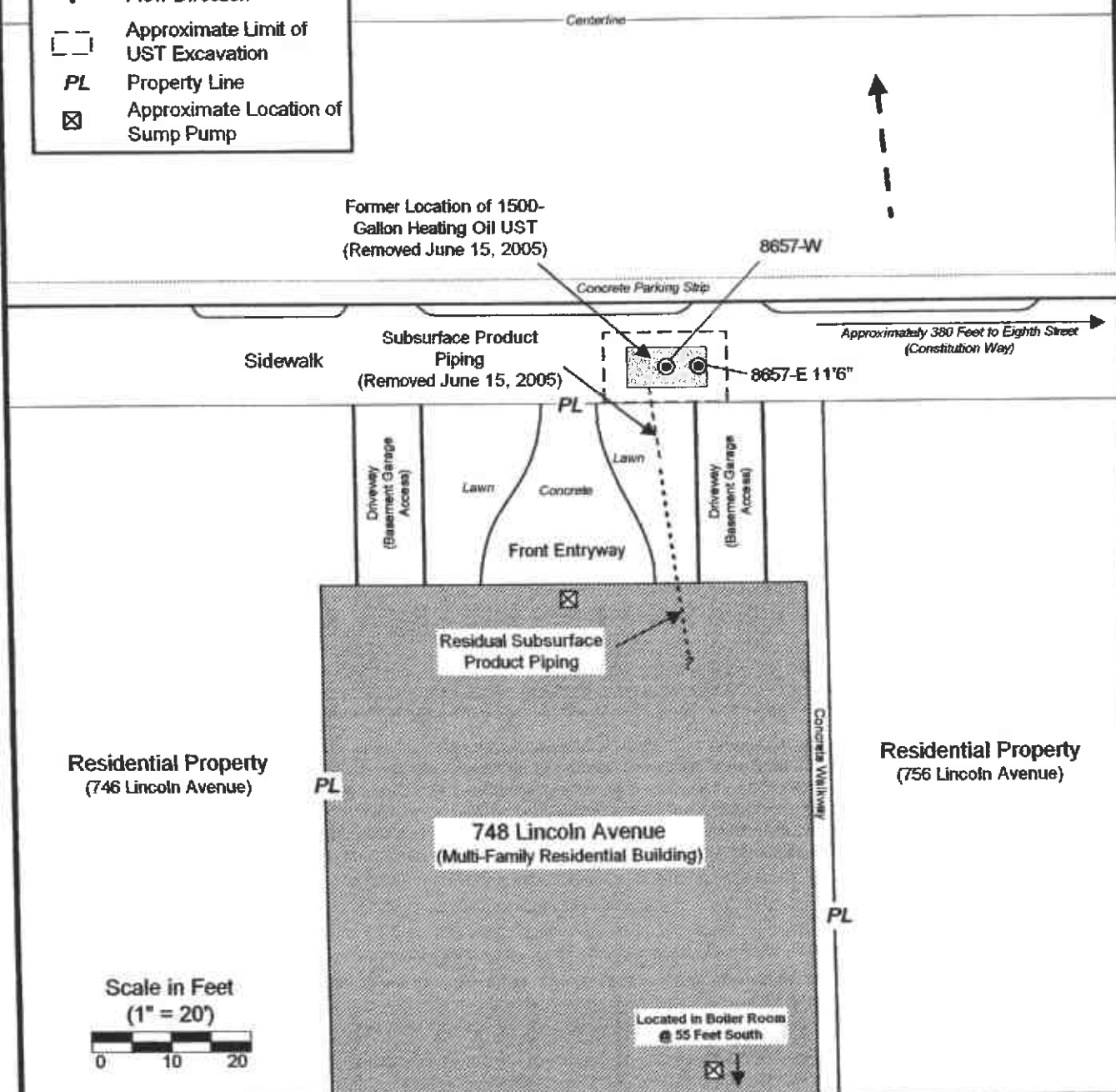

**GOLDEN GATE TANK REMOVAL, INC.**  
 255 Shipley Street  
 San Francisco, CA 94107  
 Ph (415) 512-1555 Fx (415) 512-1555

**SITE PLAN**  
 748 Lincoln Avenue  
 Alameda, California





**TANK IN EXCAVATION READY TO BE PULLED**



**TANK LOADED ON TRUCK READY TO BE TRANSPORTED**

**GOLDEN GATE TANK REMOVAL, INC.**  
255 Shipley Street  
San Francisco, CA 94107  
Ph (415) 512-1555 Fx (415) 512-0964

748 Lincoln Avenue  
Alameda, CA

GGTR Project No. 8657

Drawing By: th

May 2005

Figure 3

City of Oakland Fire Prevention Bureau

**SOIL/GROUND WATER SAMPLING DATA FORM**

Underground Storage Tank Site Address:

748 Lincoln Avenue - Job# 8657

Business Site Name:

Residential Building at 748 Lincoln Avenue, Alameda, CA 94501

Description Sample ID (Specify location; ie, tank, pipe, stockpile) and number	Sample Depth (Indicate depth of sample from grade)	Media (soil/water)	Date (Date Sample was collected)	Soil Type (specify if sand, clay, fill, etc.)	Laboratory Results, express in mg/kg unless otherwise specified											
					TPHg	TPHd	B	T	E	X	Lead	TOG	Cl HC	Other mtbc		
8657-SP Stockpile	--	soil	6/15/2005	sand, clay		ND	ND	ND	ND	ND						ND
8657-WATER Water from excavation	10 FEET	water	6/15/2005	sand, clay		9.1	ND	ND	ND	ND						ND
8657-E [11'6"] East end of tank excavation	11 FEET, 6 INCHES	soil	6/15/2005	sand, clay		ND	ND	ND	ND	ND						ND

9100 PPB

TPHg = Total Petroleum Hydrocarbons as Gasoline  
 BTEX = Benzene, Toluene, Ethylbenzene, Xylene  
 Cl HC = Chlorinated hydrocarbon compounds

TPHd = Total Petroleum Hydrocarbon as Diesel  
 TOG = Total Oil and Grease  
 Other = Semivolatile organic compounds, heavy metals, etc.

List additional analytical results and / or additional samples on a separate sheet

**Submit this form as part of the closure final report. Attach soil/ground water sampling location map.**

# Entech Analytical Labs, Inc.

3334 Victor Court • Santa Clara, CA 95054 • (408) 588-0200 • Fax (408) 588-0201

Salvador Mora  
Golden Gate Tank Removal  
255 Shipley Street  
San Francisco, CA 94107

Certificate ID: 43980 - 6/17/2005 5:10:17 PM

Order Number: 43980

Date Received: 6/16/2005 11:59:10 AM  
P.O. Number: 8657

Project Number: 8657

## Certificate of Analysis - Final Report

On June 16, 2005, samples were received under chain of custody for analysis.  
Entech analyzes samples "as received" unless otherwise noted. The following results are included:

Matrix

Test

Comments

Liquid

EPA 8260B - GC/MS  
TPH-Extractable

Solid

Composite  
EPA 8260B - GC/MS  
TPH-Extractable

Entech Analytical Labs, Inc. is certified for environmental analyses by the State of California (#2346).  
If you have any questions regarding this report, please call us at 408-588-0200 ext. 225.

Sincerely,



Laurie Glantz-Murphy  
Laboratory Director

# Entech Analytical Labs, Inc.

3334 Victor Court, Santa Clara, CA 95054

Phone: (408) 588-0200

Fax: (408) 588-0201

Golden Gate Tank Removal  
 255 Shipley Street  
 San Francisco, CA 94107  
 Attn: Salvador Mora

Project ID: 8657  
 Date Received: 6/16/2005  
 P.O. Number: 8657  
 Sample Collected by: client

## Certificate of Analysis - Data Report

Lab #: 43980-005    Sample ID: 8657-SP (A-D) Composite    Matrix: Solid    Sample Date: 6/15/2005    1:15 PM

EPA 3545 EPA 8015 MOD. (Extractable)									TPH-Extractable
Parameter	Result	Qual	DF	Detection Limit	Units	Prep Date	Prep Batch	Analysis Date	QC Batch
TPH as Diesel	ND		1	2.5	mg/Kg	6/16/2005	DS050616	6/17/2005	DS050616

Surrogate	Surrogate Recovery	Control Limits (%)
o-Terphenyl	74.0	41 - 137

Analyzed by: Jhsiang  
 Reviewed by: dba

EPA 5035A EPA 8260B									8260Petroleum
Parameter	Result	Qual	DF	Detection Limit	Units	Prep Date	Prep Batch	Analysis Date	QC Batch
Benzene	ND		50	250	µg/Kg	6/16/2005	PMS050616	6/17/2005	PMS050616
Toluene	ND		50	250	µg/Kg	6/16/2005	PMS050616	6/17/2005	PMS050616
Ethyl Benzene	ND		50	250	µg/Kg	6/16/2005	PMS050616	6/17/2005	PMS050616
Xylenes, Total	ND		50	500	µg/Kg	6/16/2005	PMS050616	6/17/2005	PMS050616
Methyl-t-butyl Ether	ND		50	250	µg/Kg	6/16/2005	PMS050616	6/17/2005	PMS050616
ter-Butyl Ethyl Ether	ND		50	250	µg/Kg	6/16/2005	PMS050616	6/17/2005	PMS050616

Surrogate	Surrogate Recovery	Control Limits (%)
4-Bromofluorobenzene	100	75 - 125
Dibromofluoromethane	87.3	75 - 125
Toluene-d8	104	75 - 125

Analyzed by: BDhabalia  
 Reviewed by: dba

\*\*\* Sample diluted due to sample composite.

# Entech Analytical Labs, Inc.

3334 Victor Court, Santa Clara, CA 95054

Phone: (408) 588-0200

Fax: (408) 588-0201

Golden Gate Tank Removal  
255 Shipley Street  
San Francisco, CA 94107  
Attn: Salvador Mora

Project ID: 8657  
Date Received: 6/16/2005  
P.O. Number: 8657  
Sample Collected by: client

## Certificate of Analysis - Data Report

Lab #: 43980-006 Sample ID: 8657-Water

Matrix: Liquid Sample Date: 6/15/2005 2:15 PM

EPA 3510C EPA 8015 MOD. (Extractable)								TPH-Extractable	
Parameter	Result	Qual	DF	Detection Limit	Units	Prep Date	Prep Batch	Analysis Date	QC Batch
TPH as Diesel	9100		10	500	µg/L	6/16/2005	DW050616	6/17/2005	DW050616

Surrogate	Surrogate Recovery	Control Limits (%)
o-Terphenyl	41.9	22 - 133

Analyzed by: Jhsiang  
Reviewed by: dba

EPA 5030B EPA 8260B EPA 624								8260Petroleum	
Parameter	Result	Qual	DF	Detection Limit	Units	Prep Date	Prep Batch	Analysis Date	QC Batch
Benzene	ND		2	1.0	µg/L	N/A	N/A	6/17/2005	WMS2050617
Toluene	ND		2	1.0	µg/L	N/A	N/A	6/17/2005	WMS2050617
Ethyl Benzene	ND		2	1.0	µg/L	N/A	N/A	6/17/2005	WMS2050617
Xylenes, Total	ND		2	1.0	µg/L	N/A	N/A	6/17/2005	WMS2050617
Methyl-1-butyl Ether	ND		2	2.0	µg/L	N/A	N/A	6/17/2005	WMS2050617
tert-Butyl Ethyl Ether	ND		2	10	µg/L	N/A	N/A	6/17/2005	WMS2050617

Surrogate	Surrogate Recovery	Control Limits (%)
4-Bromofluorobenzene	109	75 - 125
Dibromofluoromethane	99.0	75 - 125
Toluene-d8	109	75 - 125

Analyzed by: Tfulton  
Reviewed by: xbian

\*\*\* Sample diluted due to high concentrations of non-target hydrocarbons.

# Entech Analytical Labs, Inc.

3334 Victor Court, Santa Clara, CA 95054

Phone: (408) 588-0200

Fax: (408) 588-0201

Golden Gate Tank Removal  
255 Shipley Street  
San Francisco, CA 94107  
Attn: Salvador Mora

Project ID: 8657  
Date Received: 6/16/2005  
P.O. Number: 8657  
Sample Collected by: client

## Certificate of Analysis - Data Report

Lab #: 43980-007    Sample ID: 8657-E 11' 6"    Matrix: Solid    Sample Date: 6/15/2005    2:30 PM

EPA 3545 EPA 8015 MOD. (Extractable)									TPH-Extractable
Parameter	Result	Qual	DF	Detection Limit	Units	Prep Date	Prep Batch	Analysis Date	QC Batch
TPH as Diesel	ND		1	2.5	mg/Kg	6/16/2005	DS050616	6/16/2005	DS050616

Surrogate	Surrogate Recovery	Control Limits (%)
o-Terphenyl	70.0	41 - 137

Analyzed by: JHsiang  
Reviewed by: dba

EPA 5035A EPA 8260B									8260Petroleum
Parameter	Result	Qual	DF	Detection Limit	Units	Prep Date	Prep Batch	Analysis Date	QC Batch
Benzene	ND		50	250	µg/Kg	6/16/2005	PMS050616	6/17/2005	PMS050616
Toluene	ND		50	250	µg/Kg	6/16/2005	PMS050616	6/17/2005	PMS050616
Ethyl Benzene	ND		50	250	µg/Kg	6/16/2005	PMS050616	6/17/2005	PMS050616
Xylenes, Total	ND		50	500	µg/Kg	6/16/2005	PMS050616	6/17/2005	PMS050616
Methyl-t-butyl Ether	ND		50	250	µg/Kg	6/16/2005	PMS050616	6/17/2005	PMS050616
tert-Butyl Ethyl Ether	ND		50	250	µg/Kg	6/16/2005	PMS050616	6/17/2005	PMS050616

Surrogate	Surrogate Recovery	Control Limits (%)
4-Bromofluorobenzene	106	75 - 125
Dibromofluoromethane	84.4	75 - 125
Toluene-d8	109	75 - 125

Analyzed by: BDhabalia  
Reviewed by: dba

\*\*\* Dilution factor due to methanol extraction.

# Entech Analytical Labs, Inc.

3334 Victor Court , Santa Clara, CA 95054 Phone: (408) 588-0200 Fax: (408) 588-0201

Method Blank - Solid - EPA 8015 MOD. (Extractable) - TPH-Extractable

Validated by: dba - 06/16/05

QC/Prep Batch ID: DS050616

QC/Prep Date: 6/16/2005

Parameter	Result	DF	PQLR	Units
TPH as Diesel	ND	1	2.5	mg/Kg

Surrogate for Blank	% Recovery	Control Limits
o-Terphenyl	69.6	41 - 137

# Entech Analytical Labs, Inc.

3334 Victor Court , Santa Clara, CA 95054 Phone: (408) 588-0200 Fax: (408) 588-0201

Laboratory Control Sample / Duplicate - Solid - EPA 8015 MOD. (Extractable) - TPH-Extractable

QC/Prep Batch ID: DS050616

Reviewed by: dba - 06/16/05

QC/Prep Date: 6/16/2005

## LCS

Parameter	Method Blank	Spike Amt	SpikeResult	Units	% Recovery	Recovery Limits
TPH as Diesel	<2.5	50	45.8	mg/Kg	91.6	45 - 138
TPH as Motor Oil	<10	50	37.8	mg/Kg	75.6	45 - 138
Surrogate	% Recovery	Control Limits				
o-Terphenyl	76.2	41 - 137				

## LCSD

Parameter	Method Blank	Spike Amt	SpikeResult	Units	% Recovery	RPD	RPD Limits	Recovery Limits
TPH as Diesel	<2.5	50	44.0	mg/Kg	88.0	4.0	30.0	45 - 138
TPH as Motor Oil	<10	50	35.7	mg/Kg	71.4	5.7	30.0	45 - 138
Surrogate	% Recovery	Control Limits						
o-Terphenyl	73	41 - 137						



# Entech Analytical Labs, Inc.

3334 Victor Court , Santa Clara, CA 95054 Phone: (408) 588-0200 Fax: (408) 588-0201

Method Blank - Liquid - EPA 8015 MOD. (Extractable) - TPH-Extractable

QC/Prep Batch ID: DW050616

Validated by: dba - 06/17/05

QC/Prep Date: 6/16/2005

Parameter	Result	DF	PQLR	Units
TPH as Diesel	ND	1	50	µg/L

Surrogate for Blank	% Recovery	Control Limits
o-Terphenyl	50.3	22 - 133

# Entech Analytical Labs, Inc.

3334 Victor Court, Santa Clara, CA 95054 Phone: (408) 588-0200 Fax: (408) 588-0201

Laboratory Control Sample / Duplicate - Liquid - EPA 8015 MOD. (Extractable) - TPH-Extractable

QC/Prep Batch ID: DW050616

Reviewed by: dba - 06/17/05

QC/Prep Date: 6/16/2005

LCS						
Parameter	Method Blank	Spike Amt	SpikeResult	Units	% Recovery	Recovery Limits
TPH as Diesel	<50	1000	777	µg/L	77.7	40 - 138
TPH as Motor Oil	<200	1000	723	µg/L	72.3	40 - 138
Surrogate	% Recovery	Control Limits				
o-Terphenyl	50.9	22 - 133				

LCSD								
Parameter	Method Blank	Spike Amt	SpikeResult	Units	% Recovery	RPD	RPD Limits	Recovery Limits
TPH as Diesel	<50	1000	822	µg/L	82.2	5.6	25.0	40 - 138
TPH as Motor Oil	<200	1000	711	µg/L	71.1	1.7	25.0	40 - 138
Surrogate	% Recovery	Control Limits						
o-Terphenyl	50.9	22 - 133						

# Entech Analytical Labs, Inc.

3334 Victor Court, Santa Clara, CA 95054 Phone: (408) 588-0200 Fax: (408) 588-0201

Method Blank - Liquid - EPA 8260B - 8260Petroleum

QC Batch ID: WMS2050617

Validated by: xbian - 06/17/05

QC Batch Analysis Date: 6/17/2005

Parameter	Result	DF	PQLR	Units
Benzene	ND	1	0.50	µg/L
Ethyl Benzene	ND	1	0.50	µg/L
Methyl-t-butyl Ether	ND	1	1.0	µg/L
tert-Butyl Ethyl Ether	ND	1	5.0	µg/L
Toluene	ND	1	0.50	µg/L
Xylenes, Total	ND	1	0.50	µg/L

Surrogate for Blank	% Recovery	Control Limits
4-Bromofluorobenzene	110	75 - 125
Dibromofluoromethane	103	75 - 125
Toluene-d8	108	75 - 125

# Entech Analytical Labs, Inc.

3334 Victor Court , Santa Clara, CA 95054 Phone: (408) 588-0200 Fax: (408) 588-0201

Laboratory Control Sample / Duplicate - Liquid - EPA 8260B - 8260Petroleum

QC Batch ID: WMS2050617

Reviewed by: xbian - 06/17/05

QC Batch ID Analysis Date: 6/17/2005

## LCS

Parameter	Method Blank	Spike Amt	SpikeResult	Units	% Recovery	Recovery Limits
1,1-Dichloroethene	<0.50	20	18.2	µg/L	91.0	80 - 120
Benzene	<0.50	20	20.7	µg/L	103	80 - 120
Chlorobenzene	<0.50	20	20.6	µg/L	103	80 - 120
Methyl-t-butyl Ether	<1.0	20	22.9	µg/L	114	80 - 120
Toluene	<0.50	20	20.6	µg/L	103	80 - 120
Trichloroethene	<0.50	20	21.8	µg/L	109	80 - 120
Surrogate	% Recovery	Control Limits				
4-Bromofluorobenzene	114	75 - 125				
Dibromofluoromethane	108	75 - 125				
Toluene-d8	109	75 - 125				

## LCSD

Parameter	Method Blank	Spike Amt	SpikeResult	Units	% Recovery	RPD	RPD Limits	Recovery Limits
1,1-Dichloroethene	<0.50	20	17.4	µg/L	86.8	4.7	25.0	80 - 120
Benzene	<0.50	20	19.8	µg/L	99.0	4.4	25.0	80 - 120
Chlorobenzene	<0.50	20	20.2	µg/L	101	2.0	25.0	80 - 120
Methyl-t-butyl Ether	<1.0	20	21.4	µg/L	107	6.7	25.0	80 - 120
Toluene	<0.50	20	20.0	µg/L	99.9	3.1	25.0	80 - 120
Trichloroethene	<0.50	20	21.0	µg/L	105	3.7	25.0	80 - 120
Surrogate	% Recovery	Control Limits						
4-Bromofluorobenzene	109	75 - 125						
Dibromofluoromethane	106	75 - 125						
Toluene-d8	108	75 - 125						

# Entech Analytical Labs, Inc.

3334 Victor Court, Santa Clara, CA 95054 Phone: (408) 588-0200 Fax: (408) 588-0201

Laboratory Control Sample / Duplicate - Solid - EPA 8260B - 8260Petroleum

QC/Prep Batch ID: PMS050616

QC/Prep Date: 6/16/2005

## LCS1

Parameter	Method Blank	Spike Amt	SpikeResult	Units	% Recovery	RPD	RPD Limits	Recovery Limits
1,1-Dichloroethene	<5.0	2000	2230	µg/Kg	111	0.0		70 - 130
Benzene	<5.0	2000	2140	µg/Kg	107	0.0		70 - 130
Chlorobenzene	<5.0	2000	2190	µg/Kg	109	0.0		70 - 130
Methyl-t-butyl Ether	<5.0	2000	1720	µg/Kg	86.0	0.0		70 - 130
Toluene	<5.0	2000	2150	µg/Kg	107	0.0		70 - 130
Trichloroethene	<5.0	2000	2550	µg/Kg	127	0.0		70 - 130

Surrogate	% Recovery	Control Limits
4-Bromofluorobenzene	77.8	75 - 125
Dibromofluoromethane	91.6	75 - 125
Toluene-d8	80	75 - 125

## LCSD1

Parameter	Method Blank	Spike Amt	SpikeResult	Units	% Recovery	RPD	RPD Limits	Recovery Limits
1,1-Dichloroethene	<5.0	2000	2130	µg/Kg	107	4.3	30.0	70 - 130
Benzene	<5.0	2000	2090	µg/Kg	105	2.3	30.0	70 - 130
Chlorobenzene	<5.0	2000	2080	µg/Kg	104	4.7	30.0	70 - 130
Methyl-t-butyl Ether	<5.0	2000	1810	µg/Kg	90.6	5.3	30.0	70 - 130
Toluene	<5.0	2000	2030	µg/Kg	102	5.6	30.0	70 - 130
Trichloroethene	<5.0	2000	2510	µg/Kg	126	1.3	30.0	70 - 130

Surrogate	% Recovery	Control Limits
4-Bromofluorobenzene	76	75 - 125
Dibromofluoromethane	91.4	75 - 125
Toluene-d8	76.8	75 - 125

7:30-4:00 Ren 650-867-1476

# Entech Analytical Labs, Inc. Chain of Custody / Analysis Request

3334 Victor Court (408) 588-0200  
 Santa Clara, CA 95054 (408) 588-0201 - Fax

Attention to: <b>SALVADOR MORA</b>	Phone No.: <b>415-512-1555</b>	Purchase Order No.:	Invoice to: (if Different)	Phone:
Company Name: <b>GOLDEN GATE TANK REMOVAL</b>	Fax No.: <b>415-512-0964</b>	Project No.: <b>8657</b>	Company:	Quote No.:
Mailing Address: <b>255 SHIPLEY ST</b>	Email Address: <b>DATA@GGTR.COM</b>	Project Name:	Billing Address: (if Different)	State: Zip:
City: <b>SAN FRANCISCO</b>	State: <b>CA</b>	Zip Code: <b>94107</b>	Project Location: <b>748 LINCOLN AVE</b>	City:

Sampler: <b>S. Mora</b>	Field Org. Code:	Turn Around Time <input type="checkbox"/> Same Day <input type="checkbox"/> 2 Day <input type="checkbox"/> 4 Day <input type="checkbox"/> 10 Day <input checked="" type="checkbox"/> 1 Day <input type="checkbox"/> 3 Day <input type="checkbox"/> 5 Day	GC/MS Methods EPA 8260B BTEX X MTBE X TPH Gas Q, by 8260B 5 Oxygenates (MTBE, TBA, ETBA, DPE, TAME) Q Lead Solvents (L, 2, 2CA, & 2CB) Q, Estanol Q Base/Neutr/Acid Organics 8270C Q, PAH - 8270C Q, PAH - 8270C SIM Q TPH Extractable: Diesel X Motor Oil Q Other Q w/ S/Sol Cleanup Q Pesticides-8081 Q TPH as Gas/BTEX Q MTBE Q by 801SM/8020 Methanol by 801SM	GC Methods	General Chemistry
Global ID: <b>N/A</b>	Order ID: <b>N/A</b>	Sample		Anions: F, Cl, Br, SO4, NO3, NO2, PO4, U pH Q TSS Q SC Q TOC Q TPH Q O & G Q Metals: Copper Below Total Dissolved Solids Q STC Q TELP Q	Remarks

Client ID / Field Point	Lab. No.	Date	Time	Matrix	No. of Containers	Analysis Methods	Remarks
8657-SP		06-15-05	13:15	SO	1BT	X	43980-001, 002, 003, 004
8657-WATER		06-15-05	14:15	1120	1L	X	ASL
8657-WASTE		06-15-05	14:15	4,0	2UOA	X	007
8657-E [11'6"]		06-15-05	14:30	SO	1BT	X	

**1 DAY**

Relinquished by: <i>[Signature]</i>	Received by: <i>[Signature]</i>	Date: <b>6/15/05</b>	Time: <b>1016</b>
Relinquished by: <i>[Signature]</i>	Received by: <i>[Signature]</i>	Date: <b>6/16/05</b>	Time: <b>1133</b>
Relinquished by:	Received by:	Date:	Time:

Special Instructions or Comments

EDD Report  
 EDF Report  
 Plating  
 LUFT-5  
 RCRA-8  
 PPM-13  
 CAM-17

Metals:  
 Al, As, Sb, Ba, Be, Bi, B, Cd, Ce, Ca, Cr, Co, Cs, Cu, Fe, Pb, Mg, Mn,  
 Ga, Ge, Hg, In, Li, Mo, Ni, P, K, Si, Ag, Na, S, Se, Sr, Ta, Te, Tl, Sn, Ti, Zn, V, W, Zr

IN CASE OF EMERGENCY OR SPILL, CALL THE NATIONAL RESPONSE CENTER 1-800-424-8802. WITHIN CALIFORNIA, CALL 1-800-852-7550  
 GENERATOR

<b>UNIFORM HAZARDOUS WASTE MANIFEST</b>		1. Generator's US EPA ID No. <i>WA1160020421011211</i>		Manifest Document No. <i>6-1</i>		2. Page 1 of <i>1</i>		Information in the shaded areas is not required by Federal law.											
3. Generator's Name and Mailing Address <i>ROBERT G. BOARD 865 HALL AVENUE READING, PA. 19601-0195</i>						A. State Manifest Document Number <b>24316107</b>													
4. Generator's Phone <i>(610) 741-1000</i>						B. State Generator's ID													
5. Transporter 1 Company Name <i>CLEARWATER ENVIRONMENTAL</i>				6. US EPA ID Number <i>CA1000000703</i>		C. State Transporter's ID [Reserved]													
7. Transporter 2 Company Name						D. Transporter's Phone <i>(510) 476-1740</i>													
8. US EPA ID Number						E. State Transporter's ID [Reserved]													
9. Designated Facility Name and Site Address <i>ALVISO INDEPENDENT OIL 5002 ARCHER STREET ALVISO CA 95002</i>						F. Transporter's Phone													
10. US EPA ID Number <i>CA11000012143</i>						G. State Facility's ID													
11. US DOT Description (including Proper Shipping Name, Hazard Class, and ID Number)						12. Containers		13. Total Quantity		14. Unit Wt/Vol		I. Waste Number							
a. <i>( OIL &amp; WATER ) NON HAZARDOUS WASTE, LIQUID</i>						No.		Quantity		Unit		State							
												Type		Wt/Vol		EPA/Other			
												<i>0/0/1 TT</i>		<i>43600</i>		<i>G</i>		<i>223</i>	
																		<i>NONE</i>	
b.												State							
c.												EPA/Other							
d.												State							
												EPA/Other							
J. Additional Descriptions for Materials Listed Above <i>11A.</i>						K. Handling Codes for Wastes Listed Above													
						a.		b.		c.		d.							
15. Special Handling Instructions and Additional Information <i>WEAR PPE 24 HOUR EMERGENCY KIRK HAYWARD 510-476-1740 ERG #171 SITE: 74 1/2 LINCOLN AVE. ALAMEDA, CA.</i> <i>JOB# 8657 INV.# 120465 GOLDEN GATE TANK RENEWAL</i>																			
16. GENERATOR'S CERTIFICATION: I hereby declare that the contents of this consignment are fully and accurately described above by proper shipping name and are classified, packed, marked, and labeled, and are in all respects in proper condition for transport by highway according to applicable international and national government regulations.																			
If I am a large quantity generator, I certify that I have a program in place to reduce the volume and toxicity of waste generated to the degree I have determined to be economically practicable and that I have selected the practicable method of treatment, storage, or disposal currently available to me which minimizes the present and future threat to human health and the environment; OR, if I am a small quantity generator, I have made a good faith effort to minimize my waste generation and select the best waste management method that is available to me and that I can afford.																			
Printed/Typed Name <i>Keith P...</i>				Signature <i>[Signature]</i>				Month Day Year <i>01/01/95</i>											
17. Transporter 1 Acknowledgement of Receipt of Materials																			
Printed/Typed Name <i>MILL STONE</i>				Signature <i>[Signature]</i>				Month Day Year <i>01/01/95</i>											
18. Transporter 2 Acknowledgement of Receipt of Materials																			
Printed/Typed Name				Signature				Month Day Year											
19. Discrepancy Indication Space																			
20. Facility Owner or Operator Certification of receipt of hazardous materials covered by this manifest except as noted in Item 19.																			
Printed/Typed Name				Signature				Month Day Year											

DO NOT WRITE BELOW THIS LINE.



Ecology Control Industries

A FULL SERVICE ENVIRONMENTAL COMPANY

# TRANSPORTATION SERVICE ORDER

SERVICE ORDER #

297048

52T 1842

DATE: 6-15-05

CUSTOMER

Name: GOLDEN GATE TANK Job Location: ALAMEDA CA

Address (BILLING): \_\_\_\_\_ City: \_\_\_\_\_ Zip: \_\_\_\_\_

Ordered by: \_\_\_\_\_ Company: \_\_\_\_\_ P.O. #: \_\_\_\_\_

DRIVER

Name (PRINT): S. SPENCE Signed: \_\_\_\_\_

Truck #: 12051 Trailer #: \_\_\_\_\_ Size/Type: 24

SERVICES

Services performed: T+D 1500 GALLON TANK TO ELER FOR DISPOSAL

TIME

MANIFEST #:	DISPOSAL #:	Start: <u>11:15</u> AM	Stop: _____ AM	Gross Time: _____ Hrs.
# <u>24528078</u>	# _____	MEALS: Start _____ AM	Stop: _____ AM	Less: _____ Hrs.
#Loads: _____	Qty: _____	Other Time: _____	Add/Deduct	Total: _____ Hrs.
BBL: _____	Gal: <u>1500</u>	Tons: _____	Yards: _____	

SITE

Time In: _____	Time In: _____	Time In: _____	Stop Miles: _____
Time Out: _____	Time Out: _____	Time Out: _____	Start Miles: _____
			Miles Driven: _____

DESCRIPTION

	QTY.	U.O.M.	RATE	EXT.		QTY.	U.O.M.	RATE	EXT.
Vacuum Truck					Disposal				
End Dump					Washout				
Roll-off					Roper Pump				
Flat Bed					Bin Liner				
Tank Mover					Surcharge				
Driver Relief									
Subsistence									

Authorized & Approved by: [Signature] Title: P-7

TOTAL CHARGES: \$

If invoice is not paid within 30 days, interest shall commence accruing at 1.5% per month. Should suit be commenced to collect any portion of this invoice, Ecology Control Industries shall be entitled to any costs deemed reasonable by the court, including attorney fees.



**UNIFORM HAZARDOUS  
 WASTE MANIFEST**

1. Generator's US EPA ID No. Manifest Document No. 2. Page 1 Information in the shaded area is not required by Federal law

3. Generator's Name and Mailing Address  
 ROBERT G. BOYD  
 565 HALLMARK DRIVE RICHMOND CA  
 4. Generator's Phone (938) 241-1050 94001  
 5. Transporter 1 Company Name 6. US EPA ID Number  
 ECOLOGY CONTROL INDUSTRIES CAAD9821036173  
 7. Transporter 2 Company Name 8. US EPA ID Number  
 9. Designated Facility Name and Site Address 10. US EPA ID Number  
 ECOLOGY CONTROL INDUSTRIES  
 255 PARK BLVD  
 RICHMOND CA 94801  
 11. US DOT Description (including Proper Shipping Name, Hazard Class, and ID Number)  
 a. NON-FLAMMABLE HAZARDOUS WASTE: SAND  
 EMPTY STORAGE TANK  
 12. Containers No. Type 13. Total Quantity 14. Unit Wt/Vol 1. Waste Number  
 401 T P 01500 P State 512  
 EPA/Other NONE  
 b. State  
 EPA/Other  
 c. State  
 EPA/Other  
 d. State  
 EPA/Other  
 15. Additional Descriptions for Materials Listed Above  
 QTY 1 EMPTY STORAGE TANK # 32571  
 K. Handling Codes for Wastes Listed Above  
 a. b. c. d.  
 SITE ADDRESS 748 LINCOLN AVE  
 15. Special Handling Instructions and Additional Information  
 DANGER!!!  
 24 Hour Emergency phone: ECZ Dispatch SIC 235-1393  
 16. GENERATOR'S CERTIFICATION: I hereby declare that the contents of this consignment are fully and accurately described above by proper shipping name and are classified, packed, marked, and labeled, and are in all respects in proper condition for transport by highway according to applicable international and national government regulations.  
 If I am a large quantity generator, I certify that I have a program in place to reduce the volume and toxicity of waste generated to the degree I have determined to be economically practicable and that I have selected the practicable method of treatment, storage, or disposal currently available to me which minimizes the present and future threat to human health and the environment; OR, if I am a small quantity generator, I have made a good faith effort to minimize my waste generation and select the best waste management method that is available to me and that I can afford.  
 Printed/Typed Name Signature Month Day Year  
 Salvador M... 01/15/01  
 17. Transporter 1 Acknowledgement of Receipt of Materials  
 Printed/Typed Name Signature Month Day Year  
 SHION SPENCE 01/15/01  
 18. Transporter 2 Acknowledgement of Receipt of Materials  
 Printed/Typed Name Signature Month Day Year  
 19. Discrepancy Indication Space  
 20. Facility Owner or Operator Certification of receipt of hazardous materials covered by this manifest except as noted in Item 19.  
 Printed/Typed Name Signature Month Day Year

IN CASE OF EMERGENCY OR SPILL, CALL THE NATIONAL RESPONSE CENTER 1-800-424-8802; WITHIN CALIFORNIA, CALL 1-800-852-7550  
 GENERATOR

DO NOT WRITE BELOW THIS LINE.

ALAMEDA COUNTY HEALTH CARE SERVICES AGENCY  
 ENVIRONMENTAL HEALTH SERVICES  
 1131 HARBOR BAY PARKWAY, RM 250  
 ALAMEDA, CA 94502-6577  
 PHONE # 510/567-6700

**ACCEPTED**

Underground Storage Tank Closure Permit Application  
 Alameda County Division of Hazardous Materials  
 1131 Harbor Bay Parkway, Suite 250  
 Alameda, CA 94502-6577

These closure plans have been received and found to be acceptable and essentially meet the requirements of State and Local Health Laws. Changes to your closure plans indicated by the Department are to secure compliance with State and local laws. The project proposed herein is now released for issuance of any required building permits for construction.

One copy of the accepted plans must be on the job and available to all contractors and craftsmen involved with the removal.  
 Any change or addition of these plans and specifications must be submitted to the Fire Department and to the Fire and Building Inspections Department in duplicate if such changes meet the requirements of State and local laws. Notify the Department at least 72 hours prior to the following required inspections:

- Removal of Tanks and Piping
- Sampling
- Final Inspection

Issuance of a permit to operate. In permanent tank closure, is dependent on compliance with accepted plans and all applicable laws and regulations.

**THERE IS A FINANCIAL PENALTY FOR NOT COMPLETING THESE INSPECTIONS**

Contact @ permit

Accepted June 7, 2005  
 ROBERT WESTON (510) 567-6781  
*Site safety plan to be on-site at all times!*

**UNDERGROUND TANK CLOSURE PLAN**

\* \* \* Complete plan according to attached instructions \* \* \*

1. Name of Business Golden Gate Tank Removal, Inc.  
 Business Owner or Contact Person (PRINT) Salvador Mora
2. Site Address 748 Lincoln Avenue  
 city Alameda zip 94501 Phone (530)241-1050
3. Mailing Address 255 Shipley Street  
 city San Francisco zip 94107 Phone (415) 512-1555
4. Property Owner Robert Bond  
 Business Name (if applicable) Monterey Apartments  
 Address 865 Hallmark Drive  
 city, state Redding CA zip 96001
5. Generator name under which tank will be manifested  
Robert Bond  
 EPA ID# under which tank will be manifested CAC 002581869

**CITY OF ALAMEDA**

2263 SANTA CLARA AVENUE, ROOM 190  
ALAMEDA, CA 94501

(510) 747-6800  
FAX (510) 747-6804

**Fire Permit: F05-0070**

Applicant Information

GOLDEN GATE TANK  
REMOVAL  
225 SHIPLEY STREET  
SAN FRANCISCO, CA 94107  
415-512-1555

Contractor Information

GOLDEN GATE TANK REMOVAL  
225 SHIPLEY STREET  
SAN FRANCISCO, CA 94107  
415-512-1555

Owner Information

BOND ROBERT G & CAROLYN  
A AND TENNEY JOYCE E TR  
865 HALLMARK DR  
REDDING, CA 96001-0185

Project Information

Status: **APPLIED**

Applied: 06/08/2005

Issued:

Type: Fire Permit

Finalized:

Category: NA

Sub-Type: NA

Parcel Number: 073-0419-047-00

Valuation: \$10,000.00

Job Address: 748 LINCOLN AVE

Work Description: **REMOVAL OF UNDERGROUND HEATING OIL TANK**

**INSPECTIONS**

Building: (510) 747-6830 (7:30-9:30 AM)      Electrical: (510) 747-6830 (7:30-9:30 AM)  
Plumbing & Mechanical: (510) 747-6830 (7:30-9:30 AM)      Fire: (510) 337-2120  
Design Review: (510) 747-6850

<u>ITEM #</u>	<u>FEE DESCRIPTION</u>	<u>ACCOUNT CODE</u>	<u>UNITS</u>	<u>FEE AMOUNT</u>	<u>PAID</u>
250	250-PERMIT FILING FEE (per activity)	4520-37450 (1050)	1	\$39.00	\$39.00
530	530-Fire inspection (free form)	3220-37260 (6200)	250	\$250.00	\$250.00
620	620-Records Management Fee (each)	469409-37900 (1464)	20	\$68.00	\$68.00
965	965-Community Planning Fee (Enter 1)	4120-33064 (8765)	1	\$30.00	\$30.00
2999	Technology Fee	4520-33063 (1051)	1	\$14.45	\$14.45

**Total Fees: \$401.45**

<u>RECEIPT #</u>	<u>PAYMENT METHOD</u>	<u>CHECK #</u>	<u>COMMENTS/PAYEE</u>	<u>RECEIPT DATE</u>	<u>RECEIPT AMT</u>
422044	Check	16921	GOLDEN GATE TANK REMOVAL	06/08/2005	\$401.45
<b>Total Payments:</b>					<b>\$401.45</b>
<b>Balance Due:</b>					<b>\$0.00</b>

## RIGHT OF WAY PERMIT: EX05-0113

**Applicant Information**

GOLDEN GATE TANK REMOVAL  
225 SHIPLEY STREET  
SAN FRANCISCO, CA 94107  
415-512-1555

**Contractor Information**

GOLDEN GATE TANK REMOVAL  
225 SHIPLEY STREET  
SAN FRANCISCO, CA 94107  
415-512-1555

**Owner Information**

BOND ROBERT G & CAROLYN A AND  
TENNEY JOYCE E TR  
865 HALLMARK DR  
REDDING, CA 96001-0185

**Project Information**

Status: ISSUED	Applied: 06/14/2005	Issued: 06/14/2005
Type: Right-of-Way Permit	Finalized:	Expires: 06/13/2006
Category: NA		
Sub-Type: NA		
Parcel Number: 073-0419-047-00		Valuation: \$93.23
Job Address: 748 LINCOLN AVE, ALAMEDA, CA 94501		
Work Description: EXCAVATION IN PUBLIC R-O-W; REMOVAL OF UNDERGROUND HEATING OIL TANK		

**INSPECTIONS**

Building: (510) 748-4564 (7:30-9:30 AM)	Electrical: (510) 748-4634 (7:30-9:30 AM)
Plumbing & Mechanical: (510) 748-4563 (7:30-9:30 AM)	Fire: (510) 749-5885
	Design Review: (510) 748-4554

ITEM #	FEE DESCRIPTION	ACCOUNT CODE	UNITS	FEE AMOUNT	PAID
250	250-Filing Fee (per activity)	4520-37450 (1050)	1	\$39.00	\$39.00
833	833-Right of Way Permit Fee	4225-37190 (6321)	52	\$52.00	\$52.00
965	965-Community Planning Fee (Enter 1)	4120-33064 (8765)	1	\$0.28	\$0.28
2999	Technology Fee (enter 1 required)	4520-33063 (1051)	1	\$1.95	\$1.95
				<b>Total Fees:</b>	<b>\$93.23</b>

RECEIPT #	PAYMENT METHOD	COMMENTS/PAYEE	RECEIPT DATE	RECEIPT AMT
422185	Check	GOLDEN GATE TANK REMOVAL	06/14/2005	\$93.23
			<b>Total Payments:</b>	<b>\$93.23</b>
<b>Balance Due:</b>				<b>\$0.00</b>

**\*\* See application for additional requirements \*\***

**INSPECTIONS**

(510) 749-5840

Note: All construction within the public right of way must have barricades with flashers for night time protection.

This is to certify that the above work has been completed to my satisfaction and approval.

\_\_\_\_\_  
Date

\_\_\_\_\_  
Inspector

**CONCRETE PERMIT: C05-0073**

Applicant Information

GOLDEN GATE TANK REMOVAL  
225 SHIPLEY STREET  
SAN FRANCISCO, CA 94107  
415-512-1555

Contractor Information

GOLDEN GATE TANK REMOVAL  
225 SHIPLEY STREET  
SAN FRANCISCO, CA 94107  
415-512-1555

Owner Information

BOND ROBERT G & CAROLYN A AND  
TENNEY JOYCE E TR  
865 HALLMARK DR  
REDDING, CA 96001-0185

Project Information

Status: ISSUED  
Type: Concrete Permit  
Category: NA  
Sub-Type: NA

Applied: 06/14/2005  
Finaled:

Issued: 06/14/2005  
Expires: 06/13/2006

Parcel Number: 073-0419-047-00

Valuation: \$95.84

Job Address: 748 LINCOLN AVE, ALAMEDA, CA 94501

Work Description: CONCRETE REPAIR IN REGARDS TO EXCAVATION IN PUBLIC R-O-W; REMOVAL OF UNDERGROUND HEATING OIL TANK

**INSPECTIONS**

Building: (510) 748-4564 (7:30-9:30 AM)  
Plumbing & Mechanical: (510) 748-4563 (7:30-9:30 AM)

Electrical: (510) 748-4634 (7:30-9:30 AM)  
Fire: (510) 749-5885  
Design Review: (510) 748-4554

ITEM #	FEE DESCRIPTION	ACCOUNT CODE	UNITS	FEE AMOUNT	PAID
250	250-Filing Fee (per activity)	4520-37450 (1050)	1	\$39.00	\$39.00
834	834-Concrete Permit Fee	4215-37190 (6321)	1	\$52.00	\$52.00
965	965-Community Planning Fee (Enter 1)	4120-33064 (8765)	1	\$0.29	\$0.29
2999	Technology Fee (enter 1 required)	4520-33063 (1051)	1	\$4.55	\$4.55
				<b>Total Fees:</b>	<b>\$95.84</b>

RECEIPT #	PAYMENT METHOD	COMMENTS/PAYEE	RECEIPT DATE	RECEIPT AMT
422186	Check	GOLDEN GATE TANK REMOVAL	06/14/2005	\$95.84
			<b>Total Payments:</b>	<b>\$95.84</b>
			<b>Balance Due:</b>	<b>\$0.00</b>

(510) 749-5840

**INSPECTIONS**

Call 48 hours in advance to schedule inspection of forms and upon completion.

1. ALL TRENCH WORK MUST BE INSPECTED PRIOR TO BACKFILL.
2. FORMS MUST BE INSPECTED PRIOR TO CONCRETE POUR.
3. CONTRACTOR'S "NAME AND DATE" SHALL BE IMPRESSED IN ALL CONCRETE WORK.

NOTE: All construction within the public right of way must have barricades with flashers for night time protection.

This is to certify that the above work has been completed to my satisfaction and approval.

\_\_\_\_\_  
Date

\_\_\_\_\_  
Inspector

Permit #:  
F05-0070

CITY OF ALAMEDA  
2263 SANTA CLARA AVENUE, ROOM 190  
ALAMEDA, CA 94501

Inspection Card

Address: 748 LINCOLN AVE

ISSUED: 06/14/2005  
VALUATION: \$10,000.00

Owner: BOND ROBERT G & CAROLYN A AND TENNEY JOYCE E TR, 865 HALLMARK DR, REDDING, CA 96001-0185

Contractor: GOLDEN GATE TANK REMOVAL, 225 SHIPLEY STREET, SAN FRANCISCO, CA 94107, 415-512-1555

Work Description: REMOVAL OF UNDERGROUND HEATING OIL TANK

Foundations:	Sheetrock / Interior Lath:
Ground Plumbing:	(Required before taping or plastering)
Rough Electric:	Exterior Lath:
Rough Plumbing:	(Required before Stucco)
Rough Heating & Ventilation:	DESIGN REVIEW: (YES) _____ (NO) _____ BY _____
Sub Floor:	Final
Frame:	Gas Test:
Insulation	Kelly Test:
Certificate	Sewer Repair / Replacement:
** Comments **	Final - Electric:
	Final - Fire Department: 6-15-05
	Final Plumbing:
	Final Heating & Ventilation:
	Final - Building:

Do not occupy structure until Certification of Occupancy has been issued. For Certificate of Occupancy to be issued, a copy of the inspection card with all Finals needs to be filed with the Permit Center, Room 190, City Hall, Alameda, CA

**\*\*SMOKE ALARMS REQUIRED—CBC Section 310.9.1.2\*\***

"When the valuation of an addition, alteration, or repair to a Group R Occupancy exceeds \$1,000 and a permit is required, or when one or more sleeping rooms are added or created in existing Group R Occupancies, smoke alarms shall be installed in accordance with Sections 310.9.1.3, 310.9.1.4 and section 310.9.1.5 ....."

INSPECTIONS (SAME DAY) - CALL 7:30-9:30 A.M. ONLY  
Building: (510) 747-6830  
Plumbing & Mechanical: (510) 747-6830  
Electrical: (510) 747-6830

INSPECTIONS (MUST BE SCHEDULED)  
Fire: (510) 337-2120  
Design Review: (510) 747-6850