

# ASSESSOR'S MAP 30

Code Area Nos. 17-001

WR

CALAVERAS TERRACE (Bk 3 Pg 57)  
MELROSE ACRES (Bk. 6 Pg 46)  
ROSE PARK TRACT (Bk. 23 Pg 13)

1982

Scale: 1"=100'

Drawn: 3-20-70 H.N. Revised: 1-25-77 R.M.  
1-25-80 B.V.  
2-04-83 C.S.L.  
5-17-00 P.B.  
4-14-03 L.L.

1972

1971

1975

1935

1976

1981

1981

Formerly: Bks. 1969, 1970, 1973, 1974 & Ch. 31, Dec 1985.

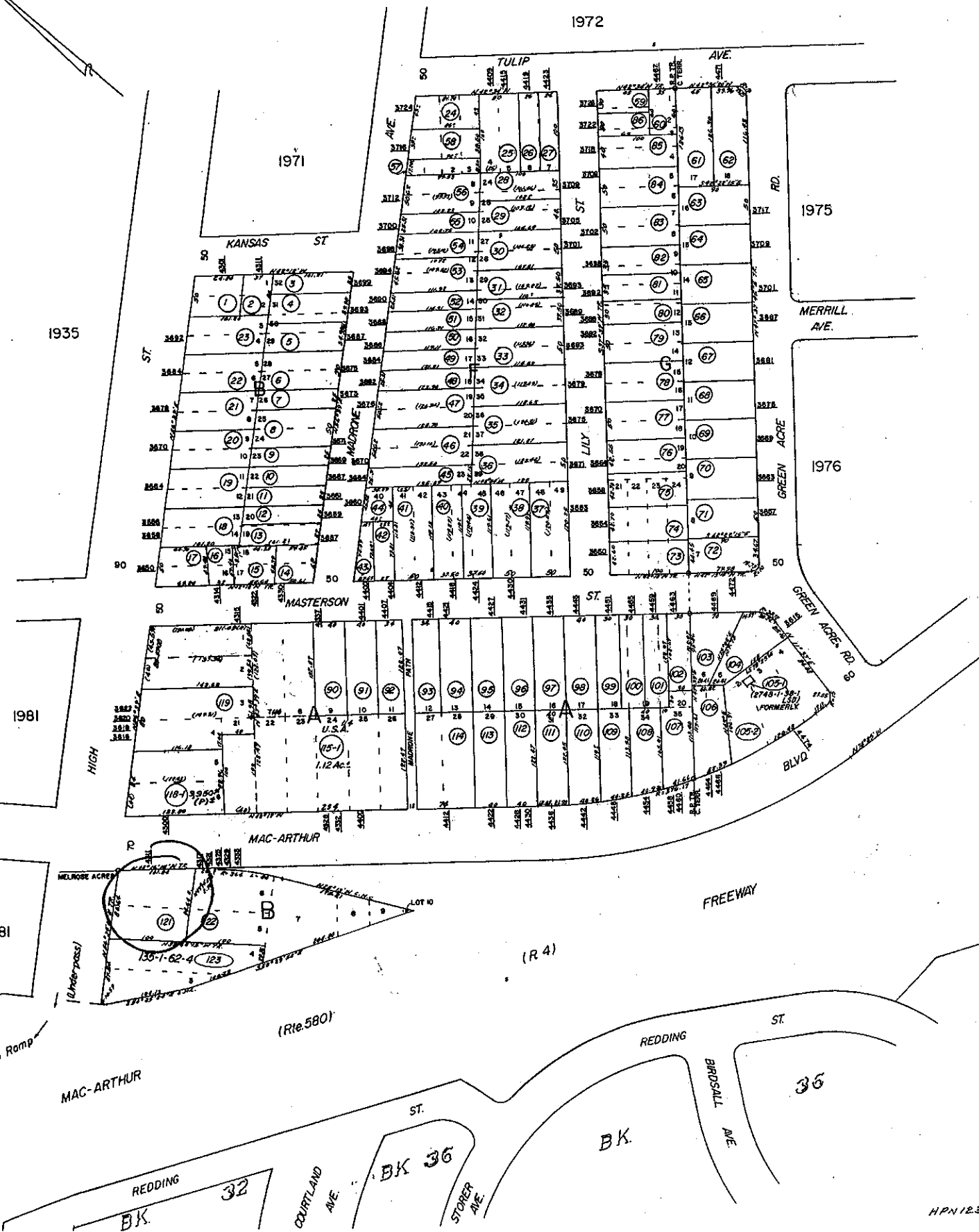

**Property Detail**

Alameda, CA RON THOMSEN, ASSESSOR

Parcel # (APN): 030 -1982-121-00

Use Description:

Parcel Status:

Owner Name: HAHN &amp; KANG EQUITY I LP

Mailing Address: 80 GRAND AVE OAKLAND CA 94612

Situs Address: 4311 MACARTHUR BLVD OAKLAND CA 94619-2701 C005

Legal

Description:

**ASSESSMENT**

Total Value: \$220,800

Use Code: 300

Zoning:

Land Value: \$220,800

Tax Rate Area: 17001

Census Tract: 4079.00/3

Impr Value:

Year Assd: 2004

Improve Type:

Other Value:

Property Tax:

Price/SqFt:

% Improved

Delinquent Yr

Exempt Amt:

HO Exempt?: N

**SALES HISTORY**

	<u>Sale 1</u>	<u>Sale 2</u>	<u>Sale 3</u>	<u>Transfer</u>
Recording Date:	12/26/2003	07/11/2000		08/12/2004
Recorded Doc #:	03 740943	00 999999		2004368766
Recorded Doc Type:				
Transfer Amount:				
Sale 1 Seller (Grantor):				
1st Trst Dd Amt:	Code1:	2nd Trst Dd Amt:	Code2:	

**PROPERTY CHARACTERISTICS**

Lot Acres: 0.210	Year Built:	Fireplace:
Lot SqFt: 9,200	Effective Yr:	A/C:
Bldg/Liv Area:	Total Rooms:	Heating:
Units:	Bedrooms:	Pool:
Buildings:	Baths (Full):	Park Type:
Stories:	Baths (Half):	Spaces:
Style:	Garage SqFt:	Site Inffnce:
Construct:		Timber Preserve:
Quality:		Ag Preserve:
Building Class:		
Condition:		
Other Rooms:		



COUNTY OF ALAMEDA  
**Assessor's Office**

**Property Value System**

**History**

**Value**

**Transfer**

**New Query**

Parcel Number: 30-1982-121 Inactive: N Lien Date: 01/01/2006 Owner: HAHN & KANG EQUITY I LP  
 Property Address: 4311 MACARTHUR BLVD , OAKLAND, CA 94619-2701

Mailing Name	Historical Mailing Address	Document Date	Document Number	Value From Trans Tax	Parcel Count	Use
HAHN & KANG EQUITY I LP	80 GRAND AVE , OAKLAND, CA 94612-3725	08/12/2004	2004-368766		<u>2</u>	<u>3000</u>
HAHN DEVELOPMENT LLC	64 HICKORY CT , DANVILLE, CA 94506-4527	12/26/2003	2003-740943		<u>2</u>	<u>3000</u>
ROBERTS GLENN E TR c/o GLENN ROBERTS	1030 CIRCLE CREEK DR , LAFAYETTE, CA 94549-3263	12/26/2003	2003-740941		<u>2</u>	<u>3000</u>
ROBERTS RUTH C TR c/o GLENN ROBERTS	1030 CIRCLE CREEK DR , LAFAYETTE, CA 94549-3263	07/11/2000	TRAN-32366		<u>1</u>	<u>3000</u>
ROBERTS RUTH C TR	2612 HOP RANCH RD , UNION CITY, CA 94587-3134	01/07/1997	1997-4153		<u>2</u>	<u>3000</u>
UNITED CALIFORNIA BANK TRUSTEE c/o RE TAX & ASSMTS A 92	PO BOX 9900 , CALABASAS, CA 91372	03/18/1976	1976-40580		<u>2</u>	<u>3000</u>
ROBERTS RUTH C	4311 MACARTHUR BLVD , OAKLAND, CA 94619-2701	01/30/1976	1976-14517		<u>2</u>	<u>3000</u>
ROBERTS CLIFFORD E + RUTH C	4311 MACARTHUR BLVD , OAKLAND, CA 94619-2701	02/28/1966	AY-26214		<u>2</u>	<u>3000</u>

All information on this site is to be assumed accurate for property assessment purposes only, and is based upon the Assessor's knowledge of each property. Caution is advised for use other than its intended purpose.

The Alameda County Intranet site is best viewed in Internet Explorer Version 5.5 or later.  
 Click [here](#) for more information regarding supported browsers.

Copyright © 2001 Alameda County