



**BUREAU
VERITAS**

RO 2874
needs AP
requested 8/12/06

Alameda County
AUG 15 2006
Environmental Health

August 14, 2006

Jerry Wickham
Hazardous Materials Specialist
Alameda County Environmental Health
1131 Harbor Bay Parkway, Suite 250
Alameda, California 94502-6577

Clayton Project No. 331040-004583.03

Subject: Remedial Action Workplan
SLIC Case No. RO0002874, GE/Imatron/Caral Manufacturing
578 Cleveland Avenue, Albany, California

Dear Mr. Wickham:

Clayton Group Services, Inc., (Clayton) a Bureau Veritas company, has prepared this Remedial Workplan on behalf of GE Healthcare (GE) for the subject facility in response to your July 7, 2006 letter.

Background

The Facility location is identified in Figure 1. In February and May 2006, Clayton collected soil samples onsite at depths of 1, 3 and 6 feet below grade surface (bgs) for borings SB-1 through SB-17 identified on Figure 2. Based on the sample results, Alameda County requested that GE conduct remedial action and confirmation sampling west of the warehouse. Clayton, GE, and Alameda County met at your offices on August 3, 2006 to discuss the scope of the remedial action, which is presented in this Workplan.

Scope of Work

Clayton proposes to excavate soil along the west side of the warehouse building to a depth of 3 feet bgs in the area shown in Figure 3. The overall dimensions of the excavation are estimated to be approximately 100 feet long x 10 feet wide x 3 feet deep for an estimated removal of 3,000 cubic feet or 111 cubic yards. We intend to use a limited access rig that is on tracks to address some of the physical site restrictions listed below.

The excavated soil will be stockpiled in the parking lot on visqueen pending offsite disposal. Based on the existing data, the soil is non-hazardous and will be disposed at an appropriate non-hazardous waste landfill facility. The excavation will be backfilled with clean soil from a quarry.

As previously reported, metals concentrations for the deeper samples from 3 and 6 feet bgs were lower than concentrations for the shallow 1 foot bgs samples. Therefore, confirmation samples should not be

Clayton Group Services, Inc.

A Bureau Veritas Company
6920 Koll Center Parkway, Suite 216
Pleasanton, CA 94566

Main: (925) 426-2600
Fax: (925) 426-0106
www.us.bureauveritas.com



Mr. Jerry Wickham
Alameda County Environmental Health
August 14, 2006

Page 2
Project No. 33104-004583.03

necessary after excavating the upper three feet of soil west of the warehouse. We propose to use the existing data for the 3 and 6 feet bgs samples as confirmation sample data.

Physical Site Restrictions

Below is a summary of physical site restrictions that Clayton will address during the Remedial Action.

1. The excavation area is not easily accessible from the possible access points: the street and parking lot on the east side of the warehouse are five to six feet higher in elevation; a gate and trees close to the northwest end of the building prevent equipment access from the North Yard; and railroad tracks to the west are in active use and within a railroad easement. Equipment will access the site from the parking lot on the east side of the warehouse.
2. Truck and loader size is limited by the 10-foot width of the area available for turning equipment at the southwest corner of the building.
3. Based on the underground utility survey we performed in February 2006, a buried electrical line runs to a pole next to the west side of the warehouse between soil borings SB-14 and SB-15 (Figure 3). We will hand excavate around the buried line but may have to leave a small area of soil in place around the pole to prevent impacting the structural footing of the pole and to avoid electrical shock hazards.

Remedial Action Report

After the field activities are completed, Clayton will document the Remedial Action and offsite disposal of soil, and submit the report to Alameda County for final approval and closure of the SLIC case.

Closing

Please review the Workplan and call me at (925) 426-2681 or Mr. Richard Rinck of GE at (650) 827-7729 if you have any questions.

Sincerely,

Michael Zimmerman, P.E., R.E.A.
Senior Project Manager
Environmental Services

Enclosures

cc: Richard Rinck, GE Healthcare, 389 Oyster Point Blvd. Suite 8, South San Francisco, California 94080

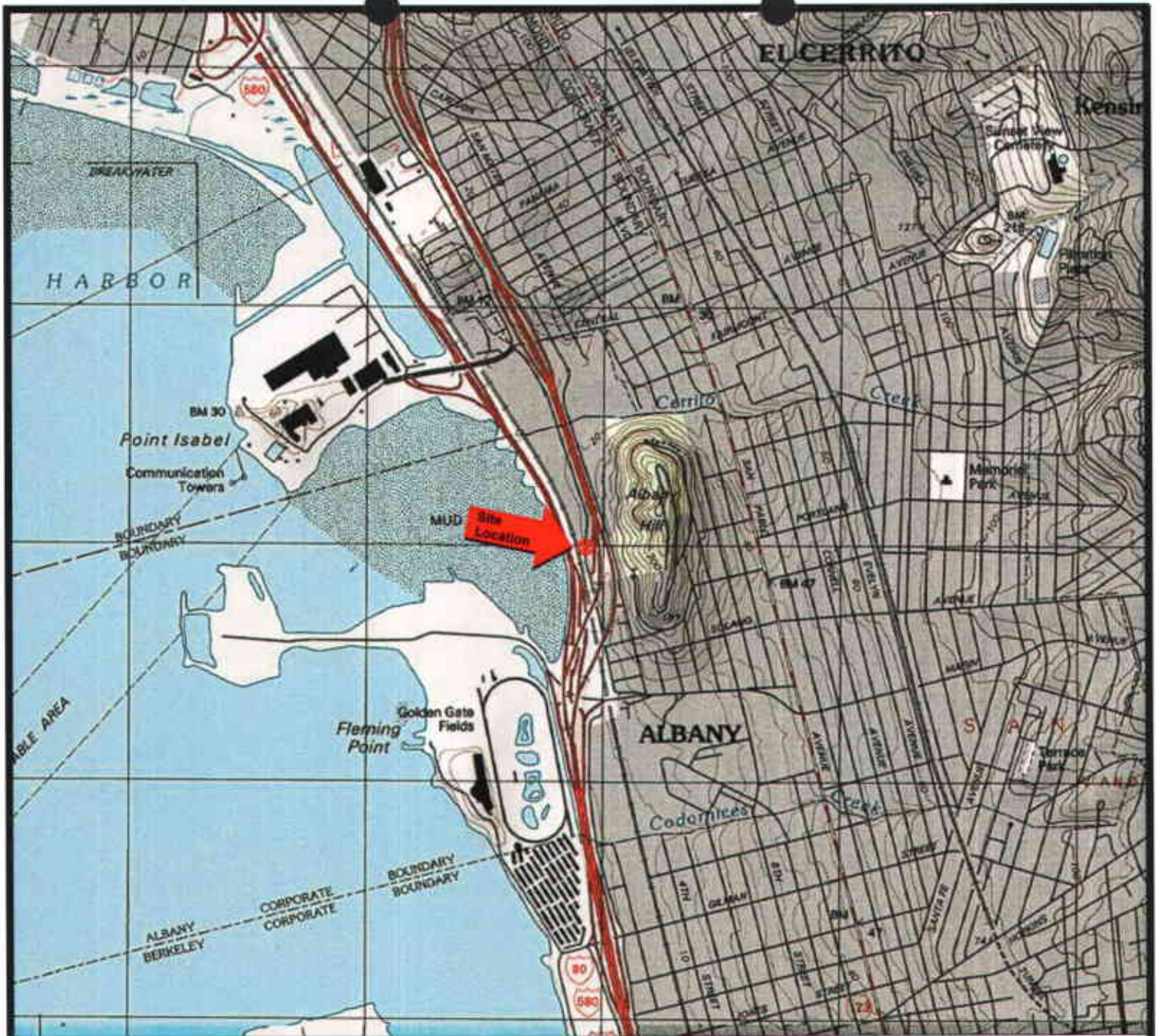

Map Source: TOPO! © 2000 National Geographic Holdings

Note: Boundaries and Location Information is Approximate



Portion of the 7.5-Minute Series Richmond, California
 Quadrangle Topographic Map (Datum: NAD 27)
 United States Department of the Interior
 Geological Survey
 1995 Photorevised from 1993



SITE LOCATION MAP
 GE Healthcare
 Carol Division
 578 Cleveland Avenue
 Albany, California
 Clayton Project No. 70-04583.02



Figure
 1

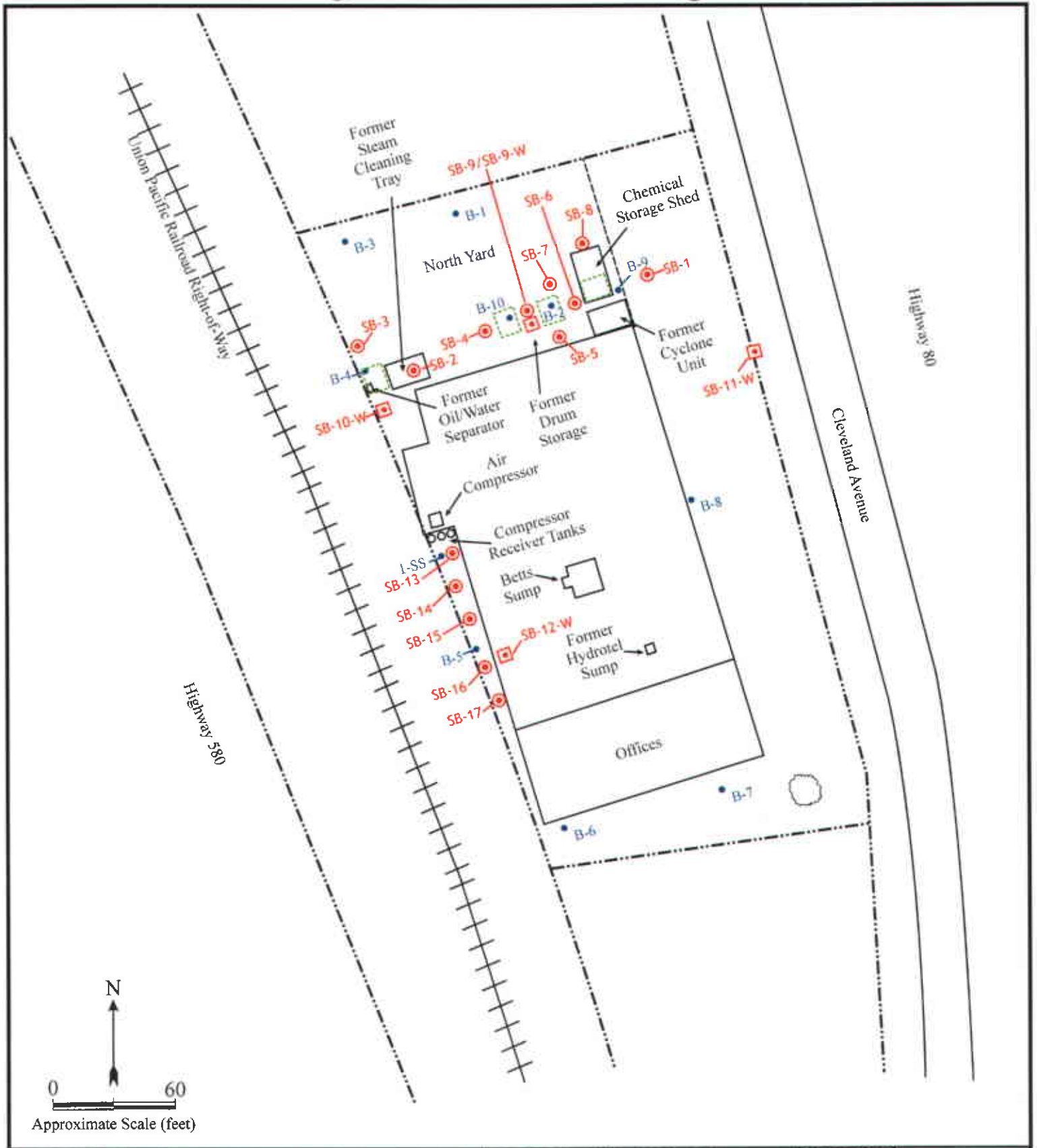

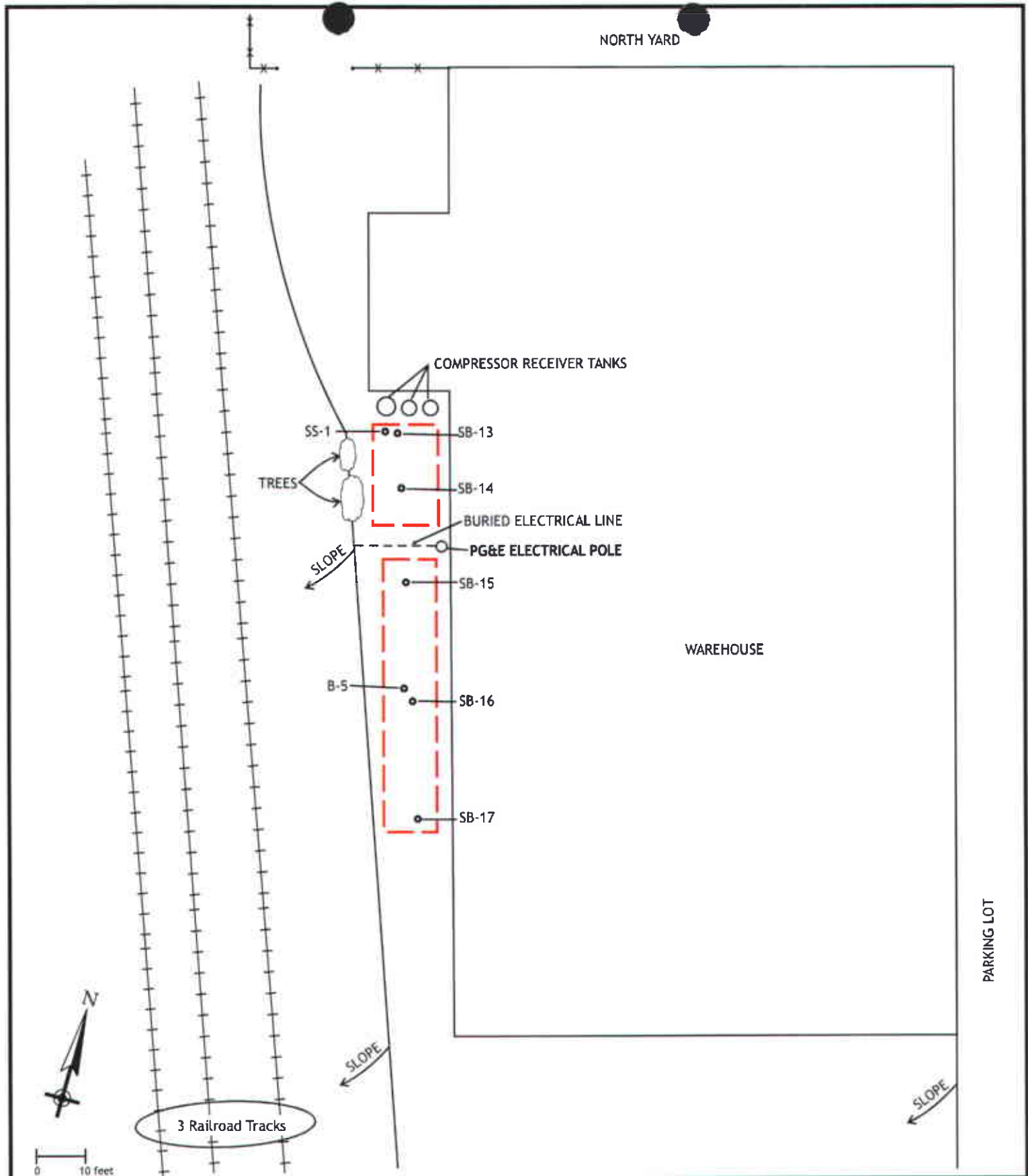

LEGEND	FACILITY SITE PLAN	FIGURE	
<ul style="list-style-type: none"> --- Approximate Property Line • Boring Completed by ERM prior to May 2004 ⊙ Soil Boring Location ▣ Grab Groundwater Sample Location ▭ North Yard Excavation Completed in 2004 	<p>GE Healthcare Caral Division 578 Cleveland Avenue Albany, California Clayton Project No. 33104-004583.03</p>	<p>2</p>	



LEGEND	Proposed Excavation West of Warehouse	FIGURE	
 Areas to be Excavated to 3 Feet Deep  Fence	GE Healthcare Caral Division 578 Cleveland Avenue Albany, California Clayton Project No. 33104-004583.03	<h1>3</h1>	