

**Agenda for Meeting  
January 10, 2008, 10:00 a.m.  
Crow Canyon Cleaners-Montessori Plus School  
Dublin, California**

1. Introductions (all)

2. DTSC's School Program (DTSC)

3. What Can DTSC Bring to the Project? (DTSC)

- Experience with VOC contaminated sites and indoor air issues
- Toxicological Expertise
- Public Participation Expertise

4. Site Background (ERM/Alameda County)

- Site Description
- Historical site uses
- Current property use
- Previous Environmental Investigation Results

5. Areas of Concern (ERM/Alameda County)

- VOC (PCE and TCE) impacted soils, soil vapor, and groundwater
- Intrusion of VOCs into indoor air from soil vapors

6. Discussion of Next Steps (all)

**CROW CANYON CLEANERS MEETING  
JANUARY 10, 2008**

**PARTICIPANT LIST**

**DEPARTMENT OF TOXIC SUBSTANCES CONTROL**

Mark Malinowski, P.G., Chief  
Schools Program and Engineering/Geology Support Division  
(916) 255-3717      [MMalinow@dtsc.ca.gov](mailto:MMalinow@dtsc.ca.gov)

Bud Duke, Senior Engineering Geologist  
Schools Program and Engineering/Geology Support Division  
(916) 255-3695      [BDuke@dtsc.ca.gov](mailto:BDuke@dtsc.ca.gov)

Thomas Booze, Staff Toxicologist  
(916) 255-6628      [Tbooze@dtsc.ca.gov](mailto:Tbooze@dtsc.ca.gov)

**ALAMEDA COUNTY HEALTH AGENCY**

Donna L. Drogos, P. E., LOP Program Manager  
Department of Environmental Health  
(510) 567-6721      [donna.drogos@acgov.org](mailto:donna.drogos@acgov.org)

Steven Plunkett, Hazardous Materials Specialist  
Department of Environmental Health  
(510) 383-1767      [steven.plunkett@acgov.gov](mailto:steven.plunkett@acgov.gov)

**CROW CANYON CLEANERS**

John Park  
(925) 286-2612      [JPARK1015@gmail.com](mailto:JPARK1015@gmail.com)

**MONTESSORI PLUS PRE-SCHOOL**

Howard J. Wong  
(925) 423-5722      [hasswong@aol.com](mailto:hasswong@aol.com)

**LAMPS PLUS PLAZA**

Tiana Jenkins, Property Manager  
(925) 997-8881      [tianacjenkins@aol.com](mailto:tianacjenkins@aol.com)

**ENVIRONMENTAL RESOURCES MANAGEMENT (ERM)**

Michael Quillin, R.G., Principal  
(925) 946-0455      [mike.quillin@erm.com](mailto:mike.quillin@erm.com)

John Lucio, P.G., Program Director  
(925) 946-0455      [john.lucio@erm.com](mailto:john.lucio@erm.com)

Kevin Mucha, P.E.  
(925) 946-0455      [kevin.mucha@erm.com](mailto:kevin.mucha@erm.com)

**KARL R. MORTHOLE, ATTORNEY AT LAW**

Karl R. Morthole  
(415) 986-0227      [karl@mortholelaw.com](mailto:karl@mortholelaw.com)

**GREBEN AND ASSOCIATES**

Jan Adam Greben, Esq.  
(805) 963-9090      [Jan@GrebenLaw.com](mailto:Jan@GrebenLaw.com)

**BURNHAM BROWN, A PROFESSIONAL LAW CORPORATION**

Thomas M. Downey  
(510) 835-6716      [tdowney@burnhambrown.com](mailto:tdowney@burnhambrown.com)

**THE BURROWS COMPANY**

Bruce Burrows  
(925) 788-5213      [bburrowsre@aol.com](mailto:bburrowsre@aol.com)

Residential Zone

Residential Zone

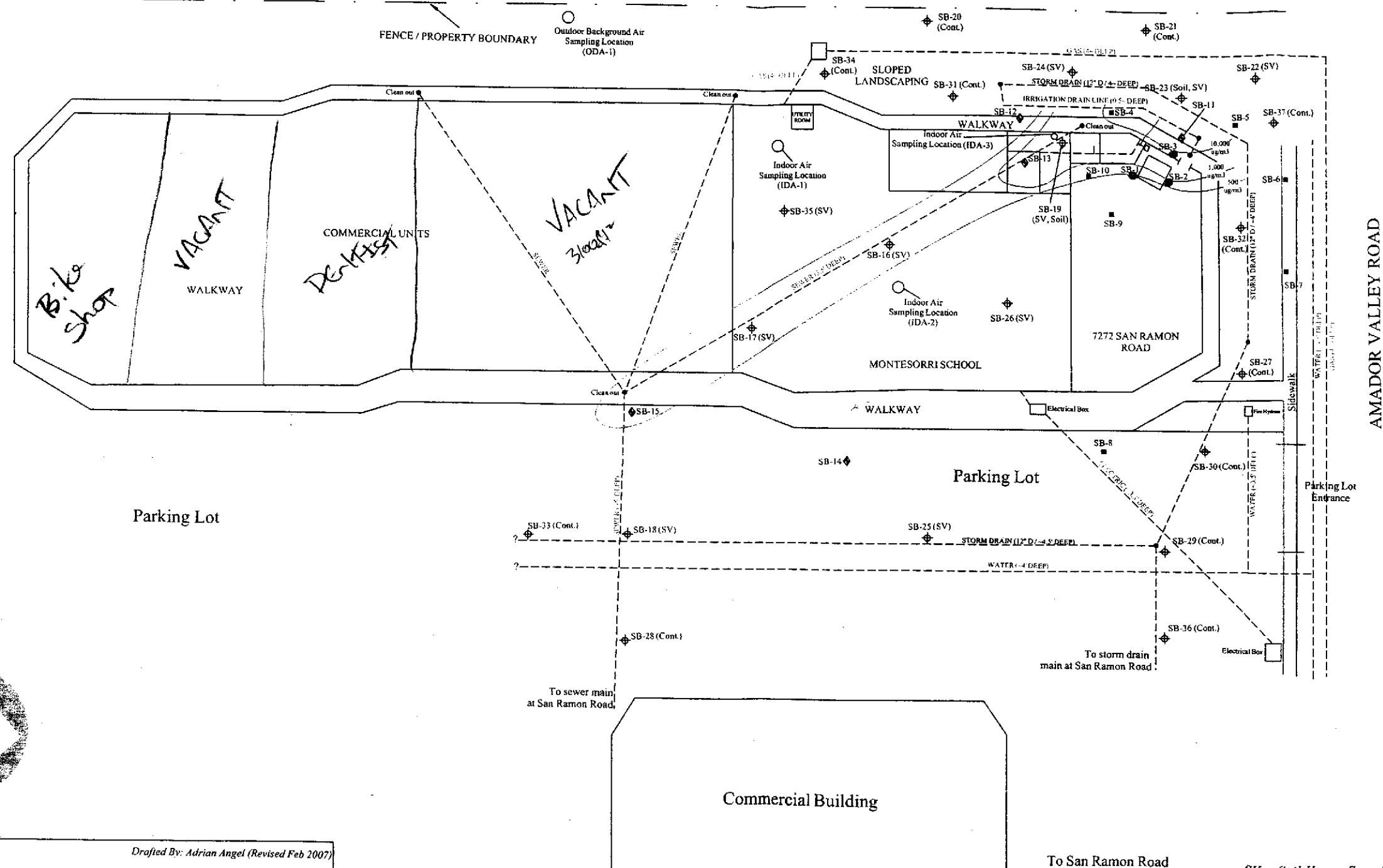

AMADOR VALLEY ROAD

7272 SAN RAMON ROAD

Commercial Building

Parking Lot

MONTESORRI SCHOOL

COMMERCIAL UNITS

VACANT

Bike Shop

Parking Lot

SV = Soil Vapor Sample Collection  
 Soil = Soil Sample Collection  
 Cont. = Contingency Boring

**AEI CONSULTANTS**  
 2500 CAMINO DIABLO BLVD, SUITE 200, WALNUT CREEK, CA

**UTILITY MAP**

7272 San Ramon Road  
 Dublin, CA 94568

**FIGURE 3**  
 PROJECT NO. 263294

Drafted By: Adrian Angel (Revised Feb 2007)

- Legend:**
- Soil Boring Locations (02/2-6/06)
  - Soil Boring Locations (01/27/05)
  - ◆ Soil Boring (12/27/06 and 1/15/07)
  - ◆ Proposed Soil Vapor Location
  - Utility Line
  - PCE Vapor Isoconcentration Line

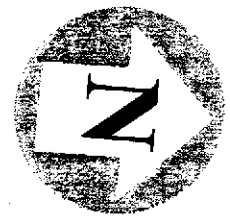
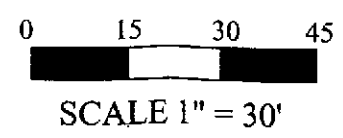

Project CROW CANYON CLEARERS MTG Project No. \_\_\_\_\_ Sheet \_\_\_\_\_ of \_\_\_\_\_  
 Subject 1/10/08 (1000) By \_\_\_\_\_ Date \_\_\_\_\_  
 Chkd. by \_\_\_\_\_ Date \_\_\_\_\_

<u>NAME</u>	<u>PHONE</u>	<u>E-MAIL</u>
MIKE QUILLIN (ERM)	925.946.9968 (Fax)	MIKE.QUILLIN@ERM.COM
BRUCE BURROWS	925-788-5213	BBURROWSRE@AOL
JOHN LUCIO ERM	925-946-0455	John.lucio@erm.com
KEVIN MURHA ERM	925-946-0455	KEVIN.MURHA@ERM.COM
DONNA DROGOS ACEH	510-567-6721	donna.drogos@aigau.org
STEVEN PLUNKETT ACEH	510-383-1767	Steven.plunkett@accgov.org
Mark Malinowski DTSC	916 255-3717	MMalinow@dtsc.ca.gov
Thomas F. Booze DTSC	916-255-6628	tbooze@dtsc.ca.gov
Bud Duke DTSC	916 255 3695	bduke@dtsc.ca.gov
<b>KARL MORTHOUE</b>	<b>415-996-0227</b>	<b>karl@mortholelaw.com</b>
JAN GREBEN	805 963-9090	jan@grebenlaw.com
John Park	925-286-2612	jpark1015@gmail.com
Tiana Jenkins	925 997 8881	tianacjenkins@aol.com
Tom Downey	510-835-6716	tdowney@burnhambrown.com

**Plunkett, Steven, Env. Health**

---

**From:** Bud Duke [BDuke@dtsc.ca.gov]  
**Sent:** Thursday, January 10, 2008 4:23 PM  
**To:** Plunkett, Steven, Env. Health  
**Subject:** RE: Crow Canyon Cleaners-Montessori Plus School

Thank you Steven. Have a nice weekend as well! :^)

bud

>>> "Plunkett, Steven, Env. Health" <steven.plunkett@acgov.org>  
>>> 1/10/2008 4:19 PM >>>  
Bud,

It was good to meet you as well, put a face to the name.

I have attached the fact sheet, because I thought you might like to have it electronically as well.

Absolutely, we would appreciate any comments that DTSC has regarding the Public Participation.

Have a great weekend.

Regards,  
Steven

Steven Plunkett  
Hazardous Materials Specialist  
Alameda County Environmental Health  
1131 Harbor Bay Parkway, Suite 250  
Alameda, CA 94502-6577  
510-383-1767  
510-337-9355 Fax  
steven.plunkett@acgov.org

o  
v<  
(\*)/ (\*)

"The bicycle is a curious invention,  
the passenger is its engine."

-----Original Message-----

From: Bud Duke [mailto:BDuke@dtsc.ca.gov]  
Sent: Thursday, January 10, 2008 4:02 PM  
To: Plunkett, Steven, Env. Health  
Subject: Fwd: Crow Canyon Cleaners-Montessori Plus School

Sorry, Steven.

I found out that Tom picked up the fact sheet. Is it ok for our public participation people to comment on the fact sheet?

Bud

-----  
Harold (Bud) Duke, PG  
Senior Engineering Geologist  
Department of Toxic Substances Control

Schools Program & Engineering/Geology Support Division 8800 Cal Center  
Drive Sacramento, CA 95826  
>BDuke@dtsc.ca.gov<  
Phn: (916) 255-3695  
Fax: (916) 255-3734  
Cell: (916) 708-3728

>>> Bud Duke 1/10/2008 3:25 PM >>>  
Hi, Steven.

It was nice meeting you and Donna this morning. I meant to retain a copy of the Fact Sheet and apparently neglected to do so. Could I please have a copy sent/e-mailed to me? If it is ok, I'd like our Public Participation specialist to take a look at it and I will forward to you their comments.

Thank you, and I look forward to working with you on this project.

Bud

---

Harold (Bud) Duke, PG  
Senior Engineering Geologist  
Department of Toxic Substances Control  
Schools Program & Engineering/Geology Support Division 8800 Cal Center  
Drive Sacramento, CA 95826  
>BDuke@dtsc.ca.gov<  
Phn: (916) 255-3695  
Fax: (916) 255-3734  
Cell: (916) 708-3728

## Plunkett, Steven, Env. Health

---

**From:** Bud Duke [BDuke@dtsc.ca.gov]  
**Sent:** Thursday, January 10, 2008 4:02 PM  
**To:** Plunkett, Steven, Env. Health  
**Subject:** Fwd: Crow Canyon Cleaners-Montessori Plus School

Sorry, Steven.

I found out that Tom picked up the fact sheet. Is it ok for our public participation people to comment on the fact sheet?

Bud

---

Harold (Bud) Duke, PG  
Senior Engineering Geologist  
Department of Toxic Substances Control  
Schools Program & Engineering/Geology Support Division 8800 Cal Center Drive Sacramento, CA 95826  
>BDuke@dtsc.ca.gov<  
Phn: (916) 255-3695  
Fax: (916) 255-3734  
Cell: (916) 708-3728

>>> Bud Duke 1/10/2008 3:25 PM >>>  
Hi, Steven.

It was nice meeting you and Donna this morning. I meant to retain a copy of the Fact Sheet and apparently neglected to do so. Could I please have a copy sent/e-mailed to me? If it is ok, I'd like our Public Participation specialist to take a look at it and I will forward to you their comments.

Thank you, and I look forward to working with you on this project.

Bud

---

Harold (Bud) Duke, PG  
Senior Engineering Geologist  
Department of Toxic Substances Control  
Schools Program & Engineering/Geology Support Division 8800 Cal Center Drive Sacramento, CA 95826  
>BDuke@dtsc.ca.gov<  
Phn: (916) 255-3695  
Fax: (916) 255-3734  
Cell: (916) 708-3728



## Plunkett, Steven, Env. Health

---

**From:** Bud Duke [BDuke@dtsc.ca.gov]  
**Sent:** Thursday, January 10, 2008 3:26 PM  
**To:** Plunkett, Steven, Env. Health  
**Subject:** Crow Canyon Cleaners-Montessori Plus School

Hi, Steven.

It was nice meeting you and Donna this morning. I meant to retain a copy of the Fact Sheet and apparently neglected to do so. Could I please have a copy sent/e-mailed to me? If it is ok, I'd like our Public Participation specialist to take a look at it and I will forward to you their comments.

Thank you, and I look forward to working with you on this project.

Bud

---

Harold (Bud) Duke, PG  
Senior Engineering Geologist  
Department of Toxic Substances Control  
Schools Program & Engineering/Geology Support Division 8800 Cal Center Drive Sacramento, CA 95826  
>BDuke@dtsc.ca.gov<  
Phn: (916) 255-3695  
Fax: (916) 255-3734  
Cell: (916) 708-3728