



ENVIRONMENTAL HEALTH SERVICES
ENVIRONMENTAL PROTECTION
1131 Harbor Bay Parkway, Suite 250
Alameda, CA 94502-6577
(510) 567-6700
FAX (510) 337-9335

PUBLIC NOTIFICATION OF POTENTIAL CASE CLOSURE
SHELL #13-5695
May 6, 2010

Site Location: 506-510 International Boulevard, Oakland, CA 94606
Fuel Leak Case RO0002853 and Geotracker Global ID T0600112421

Summary – This fact sheet has been prepared to inform community members and other interested parties of potential case closure for a fuel leak case at 506-510 International Boulevard in Oakland, California (see attached map on back). Site investigation and cleanup activities have been completed and it does not appear that the fuel release presents a risk to human health for nearby residents or site workers based upon current land use. Case closure will be granted for commercial land use only. Site investigation activities, which were conducted in 2005 and 2006, have defined the extent of petroleum hydrocarbons in soil and groundwater beneath the site. Groundwater monitoring has been conducted since July 2006 using five groundwater monitoring wells at the site. The groundwater monitoring data indicate that the concentrations of petroleum hydrocarbons in groundwater have decreased since 2006 and that water quality is expected to be restored to water quality objectives through natural attenuation processes within a reasonable period of time. During the most recent groundwater sampling event in November 2009, the maximum concentration of methyl tert-butyl ether (MTBE) detected in groundwater beneath the site was 90 micrograms per liter (parts per billion). The residual contamination does not appear to pose a risk to site workers or nearby residents.

Background – A release of gasoline from the fueling system was discovered during the upgrade of dispensers, sumps, and vapor-recovery equipment in July 2004. Soil borings were advanced to collect soil and groundwater samples in 2005. Five groundwater monitoring wells were installed in July 2006. As part of a groundwater monitoring program, groundwater samples were collected quarterly from the five monitoring wells from August 2006 to November 2009. No water supply wells are known to be located within one mile of the site.

Next Step – The public is invited to review and comment on the potential closure of the fuel leak case. The entire case file can be viewed over the Internet on the ACEH website (<http://www.acgov.org/aceh/lop/ust.htm>) or the State of California Water Resources Control Board Geotracker website (<http://geotracker.swrcb.ca.gov>). Please send written comments to Jerry Wickham at the address below; all comments will be forwarded to the responsible parties. **Comments received by June 10, 2010** will be considered and responded to prior to a final determination on the proposed case closure.

Additional information: Contact Jerry Wickham of the Alameda County Department of Environmental Health, 1131 Harbor Bay Parkway, Alameda, CA 94502 at 510-567-6791 or by email at jerry.wickham@acgov.org

I:\Shell\TEMP\6-chars\2408-1240898-Oakland 510 E. 14th (506-510 International Blvd)\240898-FIGURES\241898 3QW08.DWG

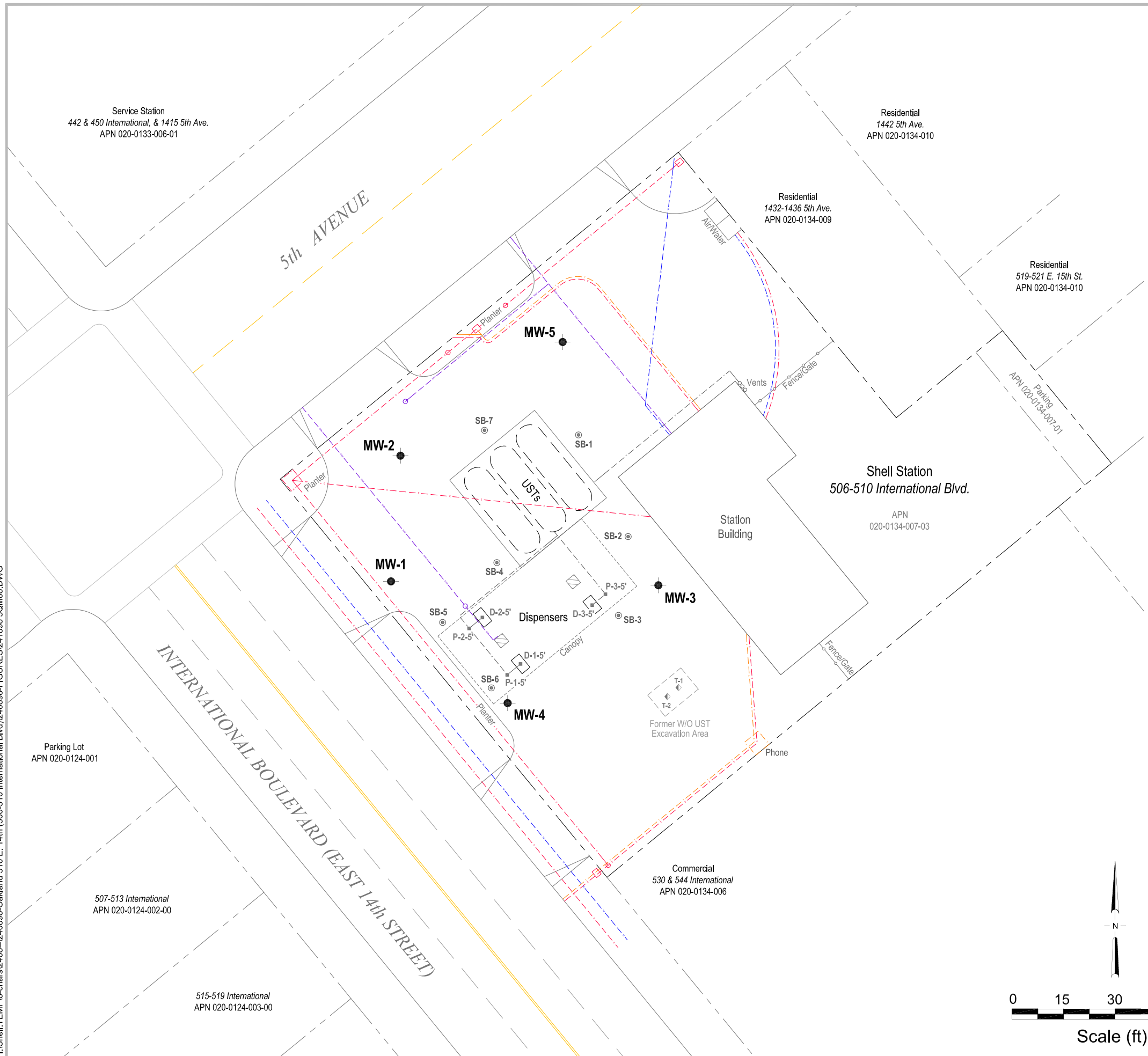

EXPLANATION	
MW-1	Monitoring well location
SB-1	Soil boring location (10/18-19/05)
D-1-5'	Soil and groundwater sample location (7/22/04)
T-1	Soil sample location (1993)
	Electrical line (E)
	Telecommunication line (T)
	Sanitary sewer line (SAN)
	Water line (W)
	Product piping line (P)
	Vent line (V)

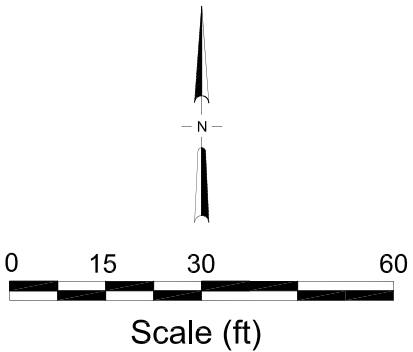

FIGURE 2

Site Plan



Shell-branded Service Station
 510 East 14th Street (506-510 International Boulevard)
 Oakland, California

CONESTOGA-ROVERS & ASSOCIATES