

CHIPS Environmental Consultants

01-1307
REGIONAL WATER
FEB 02 1987
QUALITY CONTROL BOARD

1285 Edmondson Ave
Morgan Hill, Ca 95037

(408) 241-1828

File
102091

1-26-87 JF32-B:SWFrey.RWJ 214

R.W. Johnston and Sons
801 53rd Avenue
OAKLAND, CA 94601

ATTENTION: Dick Burg

33

SUBJECT: Field sampling and analysis at Schwabacher/Frey,
5733 Paladeau Street, Emeryville, California
Alameda

Dear Dick Burg:

Enclosed are the results for the analysis of soil samples taken from excavation holes at the subject facility. This site presented one 2000 gallon diesel tank 6.5' in diameter which rested 8.5' below grade. George Warren of the city of Emeryville was present to observe and direct the sampling. The attached plot plan shows the approximate location of the tank in respect to the facility.

The tank appeared to have two corrosion holes on its side 2 and 8" long at half height. The soil under the tank appeared to be contaminated with product. Samples were taken at 11 feet depth.

Sampling was performed in accordance with approved methodology. The samples were obtained in zero headspace brass tubes which were sealed, logged, chilled and transported to the laboratory for same day analysis.

The samples were analysed in accordance with approved methodology. The results are presented on page three of this report.

Reportage

Submission to the Regional Water Quality Control Board and the City of Emeryville should include copies of this report. The property owner should attach a cover letter and submit all documents together in a package.

The following addresses have been listed for your convenience:

Water Quality Control Board
San Francisco Bay Region
1111 Jackson Street
Room 6040
Oakland, CA 94607
Attention: Tom Calahan

City of Emeryville
6303 Hollis Street
Emeryville, CA 94608
Attention: George Warren

If you have any questions or if we can be of further assistance, please feel free to contact us at your convenience.

Sincerely,

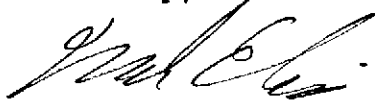
A handwritten signature in cursive script, appearing to read "Mark Chips".

Mark Chips (For N. Kumagai)

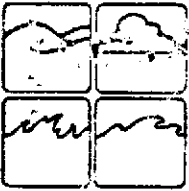

CHIPS Environmental Consultants

SAMPLE HANDLING/LOG-IN

Date 1/26/87

Test Location Schwabacher / Frey
5733 Peladeau, Emeryville
Comments

	Sample Type	Volume	Comments
1.	000764 GC 1	1	N end 11' depth 2000 gal tank
2.	000736 GC 2	1	S end 11' depth 2000 gal tank
3.			
4.			
5.			
6.			
7.			
8.			
9.			
10.			
11.			
12.			

CHAIN OF CUSTODY

Nancy J. Kumagai 10:45 field 1/26/87

Nancy J. Kumagai lab 1/26/87

Powell St.

Paladeau

NOT TO SCALE

bldg.

bldg.

Schwabacher/Frey

excavation
hole
7'

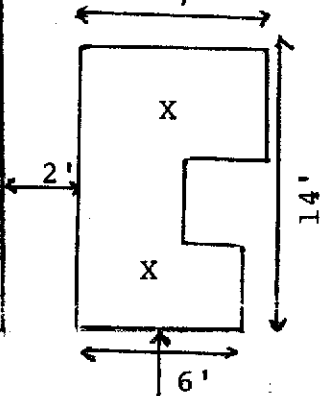

CHIPS ENVIRONMENTAL CONSULTANTS
1285 Edmundson Avenue (408) 241-1828
MORGAN HILL, CALIFORNIA 95037

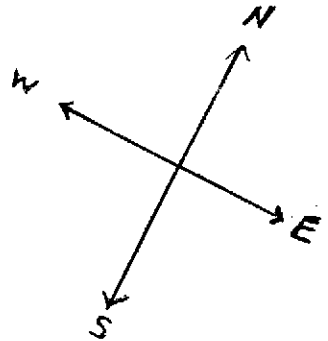

sampling location:
Schwabacher/Frey
5733 Paladeau
Emeryville

railroad tracks