

DEPARTMENT OF TRANSPORTATION

111 GRAND AVENUE
P. O. BOX 23660
OAKLAND, CA 94623-0660
PHONE (510) 286-5647
FAX (510) 286-5639

RO 2843



*Flex your power!
Be energy efficient!*

January 7, 2003

Ms. Lynn Nakashima
N. CA Coastal Cleanup Operations Branch
Department of Toxic Substances Control
700 Heinz Avenue, Suite 200
Berkeley, CA 94710-2721

Dear Ms. Nakashima:

With Caltrans' Office of Environmental Engineering having completed four quarters of sampling from the five monitoring wells on and around the former Church's Chicken site, and no data indicating residual contamination problems related to the excavated leaking underground gasoline storage tanks, the Department of Toxic Substances Control (DTSC) approved abandonment of the wells. The monitoring wells were abandoned according to the specifications of the Alameda County Public Works Agency, Water Resources Section. The work was performed by Caltrans' consultant, Shaw Environmental, and a drilling crew from West Hazmat Drilling.

The Alameda County Public Works Agency required that the wells be pressure grouted and the well casings drilled out from the ground surface to a depth of 5 feet. The borings were then to be filled with grout. On November 25, 2002, each 2-inch-diameter monitoring well was injected with a cement-bentonite grout mixture, using a 1-inch-diameter PVC pipe as a tremie, until the grout level was at the well's top of casing. An air compressor attachment was then placed on each well casing, and pressure was applied so that the grout might pass through the well screen and encroach into the well's sand pack. The air pressure was approximately 15 pounds per square-inch and was applied for approximately 15 minutes per well. The monitoring wells were then drilled out from the ground surface to a depth of five feet using a 10-inch-diameter hollow stem auger drill rig. This step destroyed and removed the well boxes and surface seals. Grout was pumped into each 5-foot-deep boring, filling them to the ground surface. The drilling cuttings were contained in a 55-gallon drum. This waste material is to be characterized for disposal at the proper landfill. The Well Completion Report papers filed with the Department of Water Resources describing the monitoring well destruction work are attached for your reference.

Ms. Lynn Nakashima

January 7, 2003

Page 2

If you have any questions regarding the monitoring well destruction work at the former Church's Chicken site, please call me at (510) 286-5647.

Sincerely,

Christopher R. Wilson

Christopher R. Wilson
Senior Engineer
Office of Environmental Engineering

Attachments

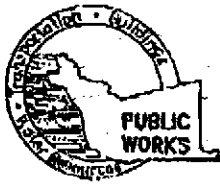

ALAMEDA COUNTY PUBLIC WORKS AGENCY

WATER RESOURCES SECTION

151 TURNER COURT, SUITE 300, HAYWARD, CA 94541-2631
PATRICK (510) 408-5755 ANDREAS (510) 408-5757
GARY (510) 408-5758 ALVIN (510) 408-5759

JAMES YOU 410-670-6633 PL
510-782-1939 FAX

DRILLING PERMIT APPLICATION

FOR APPLICANT TO COMPLETE

LOCATION OF PROJECT FORNER CHURCH'S CHURCH
1766 7th STREET
OAKLAND, CA 94612

California Coordinates Source _____ Accuracy _____ ft.
OCN _____ R CCG _____ ft.
APN 6-37-12

CLIENT
Name CALTRANS - DISTRICT 4
Address 111 GRANT AVE. HAYWARD Phone 510-782-4477
City OAKLAND, CA Zip 94612

APPLICANT
Name SHAW E.C.T. (MARINA ADAMS)
Address 1321 N. MARINE BLVD. Phone 916-566-4483
City OAKLAND, CA Zip 94612

TYPE OF PROJECT
Well Construction
Cathodic Protection Geotechnical Investigation
Water Supply Contamination
Monitoring Well Destruction (MW-1)

PROPOSED WATER SUPPLY WELL USE
New Domestic Replacement Domestic
Municipal Irrigation
Industrial Other A/B

DRILLING METHOD:
Mud Rotary Air Rotary Auger
Cable Other

DRILLER'S LICENSE NO. (C-57) 554979 - WEL HEAVY

WELL PROJECTS (Abandonment) : MW-1
Drill Hole Diameter 8 in. Maximum _____
Casing Diameter N/A in. Depth 15'
Surface Seal Depth 0-15 ft. Number 1

GEOTECHNICAL PROJECTS
Number of Borings _____ Maximum _____
Hole Diameter _____ in. Depth _____ ft.

ESTIMATED STARTING DATE 11/25/02
ESTIMATED COMPLETION DATE 11/26/02

I hereby agree to comply with all requirements of this permit and Alameda County Ordinance No. 73-88.

APPLICANT'S SIGNATURE Marina Adams DATE 11-7-02
MARINA ADAMS

FOR OFFICE USE

PERMIT NUMBER W02-1050
WELL NUMBER _____
APN _____

PERMIT CONDITIONS

Circled Permit Requirements Apply

- A. GENERAL
 1. A permit application should be submitted so as to arrive at the ACPWA office five days prior to proposed starting date.
 2. Submit to ACPWA within 60 days after completion of permit work the original Department of Water Resources Water Well Drilling Report or equivalent for well projects, or drilling logs and location sketch for geotechnical projects.
 3. Permit is void if project not begun within 90 days of approval date.
- B. WATER SUPPLY WELLS
 1. Minimum surface seal thickness is two inches of cement grout placed by tremie.
 2. Minimum seal depth is 50 feet for municipal and industrial wells or 20 feet for domestic and irrigation wells unless a lesser depth is specially approved.
- C. GROUNDWATER MONITORING WELLS INCLUDING PIEZOMETERS
 1. Minimum surface seal thickness is two inches of cement grout placed by tremie.
 2. Minimum seal depth for monitoring wells is the maximum depth practicable or 20 feet.
- D. GEOTECHNICAL

Backfill bore hole with compacted casing or heavy bentonite and upper two feet with compacted material. In areas of known or suspected contamination, tremied cement grout shall be used in place of compacted casing.
- E. CATHODIC

Fill hole above anode zone with concrete placed by tremie.
- F. WELL DESTRUCTION PG A1

See attached.
- G. SPECIAL CONDITIONS

APPROVED DATE 11-12-02

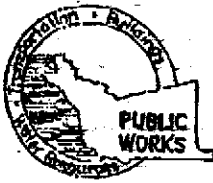

ALAMEDA COUNTY PUBLIC WORKS AGENCY

WATER RESOURCES SECTION

34 TURNER COURT, SUITE 308, RAYWARD, CA 94583-0000
PHONE (916) 778-5577 ADDRESS CHIEF/CLERK FAX (916) 778-5700
510 508 5716 ALVIN KAN

SINCE 400-510-620-6633
310-762-1535 HA

DRILLING PERMIT APPLICATION

FOR APPLICANT TO COMPLETE

LOCATION OF PROJECT FRANK CARON'S CHICKEN
126 7th Street
OAKLAND, CA 94612

California Coordinates Source _____ ft. Accuracy ± _____ ft.
CCM _____ R. CCE _____ ft.
APN 6-37-18

CLIENT
Name CALTRANS - District 4
Address 111 Grand Ave. 14th Floor Phone 510-376-5477
City OAKLAND, CA Zip 94612

APPLICANT
Name Shirley R. E. (Marjina Adams)
Address 126 N. Market Blvd. Phone 916-565-4183
City OAKLAND Zip 94612

TYPE OF PROJECT
Well Construction: Geotechnical Investigation:
Cathodic Protection: General:
Water Supply: Contamination:
Monitoring: Well Destruction: (M-2)

PROPOSED WATER SUPPLY WELL USE
New Domestic: Replacement Domestic:
Municipal: Irrigation:
Industrial: Other: N/A

DRILLING METHOD:
Mud Rotary: Air Rotary: Auger:
Cable: Other:

DRILLER'S LICENSE NO. 6697 554979 - West Hill Dr.

WELL PROJECTS/Abandonment
Drill Hole Diameter: 8 in. Maximum Depth: 15 ft.
Casing Diameter: N/A in. Number: M-2
Surface Seal Depth: 0-15 ft.

GEOTECHNICAL PROJECTS
Number of Borings: _____ Maximum Depth: _____ ft.
Hole Diameter: _____ in.

ESTIMATED STARTING DATE 11/25/02
ESTIMATED COMPLETION DATE 11/26/02

I hereby agree to comply with all requirements of this permit and Alameda County Ordinance No. 71-6R.

APPLICANT'S SIGNATURE Marjina Adams DATE 11-7-02
MARJINA ADAMS

FOR OFFICE USE

PERMIT NUMBER WD-1091
WELL NUMBER _____
APN _____

PERMIT CONDITIONS

Circled Permit Requirements Apply

A. GENERAL

- 1. A permit application should be submitted so as to arrive at the ACPWA office five days prior to proposed starting date.
- 2. Submit to ACPWA within 60 days after completion of permitted work the original Department of Water Resources Water Well Drillers Report or equivalent for well projects, or drilling logs and location sketch for geotechnical projects.
- 3. Permit is void if project not begun within 90 days of approval date.

B. WATER SUPPLY WELLS

- 1. Minimum surface seal thickness is two inches of cement grout placed by tremie.
- 2. Minimum seal depth is 50 feet for municipal and industrial wells or 20 feet for domestic and irrigation wells unless a lesser depth is specially approved.

C. GROUNDWATER MONITORING WELLS INCLUDING PIEZOMETERS

- 1. Minimum surface seal thickness is two inches of cement grout placed by tremie.
- 2. Minimum seal depth for monitoring wells is the maximum depth practicable or 20 feet.

D. GEOTECHNICAL

Backfill bore hole with compacted cuttings or heavy bentonite and upper two feet with compacted material. In areas of known or suspected contamination, grouted cement grout shall be used in place of compacted cuttings.

E. CATHODIC

FRT hole shall have anode zone with concrete placed by tremie.

F. WELL DESTRUCTION

See attached. -PGH1

G. SPECIAL CONDITIONS

APPROVED _____ DATE 11-12-02



ALAMEDA COUNTY PUBLIC WORKS AGENCY

WATER RESOURCES SECTION
371 TURNER COURT, SUITE 300, BAYVIEW, CA 94545-2451
PHONE (415) 678-6747 AMERICAN CORPUS FAX (415) 678-6742
(415) 678-5240 ALVIN KAL

JAMES TAD 510 670-6635
FAX 510 912-1535

DRELLING PERMIT APPLICATION

FOR APPLICANT TO COMPLETE

LOCATION OF PROJECT Former Church's Chicken
1366 7th Street
OAKLAND, CA 94612

California Coordinate System A. Accuracy ft.
CCN A. CCE ft.
APN 02-37-18

CLIENT
Name CALTRANS - District 4
Address 181 Grand Ave. 14th Floor, San Francisco, CA 94102
City OAKLAND, CA Zip 94612

APPLICANT
Name Shaw E + T (MARINA ADAMS)
Address 1324 N. Market Alameda Fax 916-825-4883
City SACRAMENTO Zip 95834

TYPE OF PROJECT
Well Construction Geotechnical Investigation
Cathodic Protection General
Water Supply Contamination
Monitoring Well Destruction (see 3)

PROPOSED WATER SUPPLY WELL USE
New Domestic Replacement Domestic
Municipal Irrigation
Industrial Other N/A

DRELLING METHOD:
Mud Rotary Air Rotary Auger
Cable Other

DRELLER'S LICENSE NO. (C-57) 554979 - West Habitat

WELL PROJECTS (Abandonment)
Drill Hole Diameter 8 in. Maximum Depth 15 ft.
Casing Diameter N/A in. Number 11W-3
Surface Seal Depth 0-15 ft.

GEOTECHNICAL PROJECTS
Number of Borings Maximum Depth ft.
Hole Diameter in.

ESTIMATED STARTING DATE 11/26/02
ESTIMATED COMPLETION DATE 11/26/02

I hereby agree to comply with all requirements of this permit and Alameda County Ordinance No. 23-68.

APPLICANT'S SIGNATURE Martha Adams DATE 11/20
MARINA ADAMS

FOR OFFICE USE

PERMIT NUMBER W02-1092
WELL NUMBER
APN

PERMIT CONDITIONS

Circled Permit Requirements Apply

- A. GENERAL
 1. A permit application should be submitted so as to arrive at the ACPWA office five days prior to proposed starting date.
 2. Submit to ACPWA within 60 days after completion of permitted work the original Department of Water Resources Water Well Drillers Report or equivalent for well projects; or drilling logs and location sketches for geotechnical projects.
 3. Permit is void if project not begun within 90 days of approval date.
- B. WATER SUPPLY WELLS
 1. Minimum surface seal thickness is two inches of cement grout placed by tremie.
 2. Minimum seal depth is 50 feet for municipal and industrial wells or 20 feet for domestic and irrigation wells unless a lesser depth is specially approved.
- C. GROUNDWATER MONITORING WELLS INCLUDING PIPESPISTERS
 1. Minimum surface seal thickness is one inch of cement grout placed by tremie.
 2. Minimum seal depth for monitoring wells is the maximum depth practicable or 20 feet.
- D. GEOTECHNICAL

Rackfill bore hole with compacted cuttings or heavy bentonite and upper two feet with compacted material. In areas of known or suspected contamination, treated cement grout shall be used in place of compacted cuttings.
- E. CATHODIC

Fill hole above annular zone with concrete placed by tremie.
- F. WELL DESTRUCTION - PG#7

See attached.
- G. SPECIAL CONDITIONS

APPROVED [Signature] DATE 11/20/02



ALAMEDA COUNTY PUBLIC WORKS AGENCY

WATER RESOURCES SECTION
951 TURNER COURT, SUITE 300, BAYVIEW, CA 94545-2601
PHONE (916) 670-5577 ANDREAS GODFREY FAX (916) 670-5232
(916) 670-5246 ALVIN

Permits 510-070-1633
Fax 510-782-1939

DRILLING PERMIT APPLICATION

FOR APPLICANT TO COMPLETE

FOR OFFICE USE

LOCATION OF PROJECT FORMER CHICKEN'S CHICKEN
1766 7th STREET
OAKLAND, CA 94612

PERMIT NUMBER W02-1093
WELL NUMBER
APN

California Coordinates Source Accuracy ft.
DCN N.CCE
APN 6-37-18

PERMIT CONDITIONS

Circled Permit Requirements Apply

CLIENT CALTRANS - AIRSTRIP 4
Name
Address 111 GRAND AVE.
City OAKLAND, CA Zip 94612

A. GENERAL

- 1. A permit application should be submitted to us to arrive at the ACPWA office five days prior to proposed starting date.
2. Submit to ACTWA within 60 days after completion of permitted work the original Department of Water Resources Water Well Drillers Report or equivalent for well projects, or drilling logs and location sketch for geotechnical projects.
3. Permit is void if project not begun within 90 days of approval date.

APPLICANT Name SHAWL E. J. (MARINA ADAMS)
Address 1121 AL MARKET BLVD.
City SACRAMENTO Zip 95834

B. WATER SUPPLY WELLS

- 1. Minimum surface seal thickness is two inches of concrete grout placed by tremie.
2. Minimum seal depth is 50 feet for municipal and industrial wells or 20 feet for domestic and irrigation wells unless a lesser depth is specially approved.

TYPE OF PROJECT

Well Construction Geotechnical Investigation
Cathodic Protection
Water Supply
Monitoring
General
Contamination
Well Destruction

C. GROUNDWATER MONITORING WELLS INCLUDING PIEZOMETERS

- 1. Minimum surface seal thickness is two inches of concrete grout placed by tremie.
2. Minimum seal depth for monitoring wells is the maximum depth practicable or 20 feet.

PROPOSED WATER SUPPLY WELL USE

New Domestic
Municipal
Industrial
Replacement Domestic
Irrigation
Other

D. GEOTECHNICAL

Backfill bore hole with compacted cuttings or heavy bentonite and upper two feet with compacted material. In areas of known or suspected contamination, grout cement grout shall be used in place of compacted cuttings.

DRILLING METHOD:

Mud Rotary
Cable
Air Rotary
Other
Auger

E. CATHODIC

Fill hole above anode zone with concrete placed by tremie.

DRILLER'S LICENSE NO. (C-57) 554979- EAST HAZ MAT

F. WELL DESTRUCTION

See attached - PG# 2

WELL PROJECTS (Abandonment)

Drill Hole Diameter
Casing Diameter
Surface Seal Depth
Maximum Depth
Number

G. SPECIAL CONDITIONS

GEOTECHNICAL PROJECTS

Number of Borings
Hole Diameter
Maximum Depth

ESTIMATED STARTING DATE 11/25/02
ESTIMATED COMPLETION DATE 11/26/02

APPROVED DATE 11-12-02

I hereby agree to comply with all requirements of this permit and Alameda County Ordinance No. 73-68.

APPLICANT'S SIGNATURE Martha Adams DATE 11.7.02
MARSHA ADAMS



ALAMEDA COUNTY PUBLIC WORKS AGENCY

WATER RESOURCES SECTION

577 FERRIS COURT, SUITE 200, BAYVIEW, CA 94534-1601
PHONE (510) 670-5575 ANDREAS GOSSELKY FAX (510) 670-5201
(510) 670-5125 KEVIN RAN

JAMES YOO 510-670-6633
Ext. 500-782-1535

DRILLING PERMIT APPLICATION

FOR APPLICANT TO COMPLETE

FOR OFFICE USE

LOCATION OF PROJECT FORMER CHURCH'S CHICKEN
1111 24th STREET
OAKLAND CA 94607

PERMIT NUMBER W02-1094
WELL NUMBER
APN

California Coordinates Source Accuracy
CCN Accuracy
APN 6-37-18

PERMIT CONDITIONS

Circled Permit Requirements Apply

CLIENT
Name CALTRANS - DISTRICT 4
Address 111 GRAND AVE. 14th FLOOR Phone 910-226-5647
City OAKLAND CA Zip 94612

A. GENERAL

- 1. A permit application should be submitted so as to arrive at the ACPWA office five days prior to proposed starting date.
2. Submit to ACPWA within 60 days after completion of permitted work the original Department of Water Resources Water Well Drillers Report or equivalent for well projects, or drilling logs and location sketch for geotechnical projects.
3. Permit is void if project not begun within 90 days of approval date.

APPLICANT
Name SFRW E.I. (MARINA ADAMS)
Address 126 N. MARKET AVE. Phone 916-565-4136
City SHERMAN OAKS CA Zip 91504

B. WATER SUPPLY WELLS

- 1. Minimum surface seal thickness is two inches of cement grout placed by trowel.
2. Minimum seal depth is 50 feet for municipal and industrial wells or 20 feet for domestic and irrigation wells unless a lesser depth is specially approved.

TYPE OF PROJECT
Well Construction Geotechnical Investigation
Cathodic Protection
Water Supply
Monitoring
General
Concentration
Well Destruction

C. GROUNDWATER MONITORING WELLS INCLUDING PIEZOMETERS

- 1. Minimum surface seal thickness is two inches of cement grout placed by trowel.
2. Minimum seal depth for monitoring wells is the maximum depth practicable or 20 feet.

PROPOSED WATER SUPPLY WELL USE
New Domestic
Municipal
Industrial
Replacement Domestic
Irrigation
Other N/A

D. GEOTECHNICAL

Backfill bore hole with compacted cuttings or heavy bentonite and upper 500 feet with compacted material. In areas of known or suspected contamination, treated cement grout shall be used in place of compacted cuttings.

DRILLING METHOD:
Mud Rotary
Cable
Air Rotary
Other
Auger

E. CATHODIC

Fill hole above anode zone with concrete placed by trowel.

DRILLER'S LICENSE NO. (C-57) 554976 - LAST YEAR AGT.

F. WELL DESTRUCTION

See attached - PG #2

WELL PROJECTS (Abandonment)
Drill Hole Diameter 8 in. Maximum
Casing Diameter N/A in. Depth 17 ft.
Surface Seal Depth 0-17 ft. Number W02-5

G. SPECIAL CONDITIONS

GEOTECHNICAL PROJECTS
Number of Borings
Hole Diameter in. Maximum Depth ft.

ESTIMATED STARTING DATE 11/26/02
ESTIMATED COMPLETION DATE 11/26/02

APPROVED DATE 11-12-02

I hereby agree to comply with all requirements of this permit and Alameda County Ordinance No. 73-68.

APPLICANT'S SIGNATURE DATE 11-7-02
MARINA ADAMS

CONFIDENTIAL

STATE OF CALIFORNIA DWR
WELL COMPLETION REPORT
(WELL LOGS)

REMOVED

CONFIDENTIAL

STATE OF CALIFORNIA DWR
WELL COMPLETION REPORT
(WELL LOGS)

REMOVED

CONFIDENTIAL

STATE OF CALIFORNIA DWR
WELL COMPLETION REPORT
(WELL LOGS)

REMOVED

CONFIDENTIAL

STATE OF CALIFORNIA DWR
WELL COMPLETION REPORT
(WELL LOGS)

REMOVED

CONFIDENTIAL

STATE OF CALIFORNIA DWR
WELL COMPLETION REPORT
(WELL LOGS)

REMOVED

PROJECT NUMBER	823340
CHECKED BY	DPB
APPROVED BY	5/8/02
DATE	

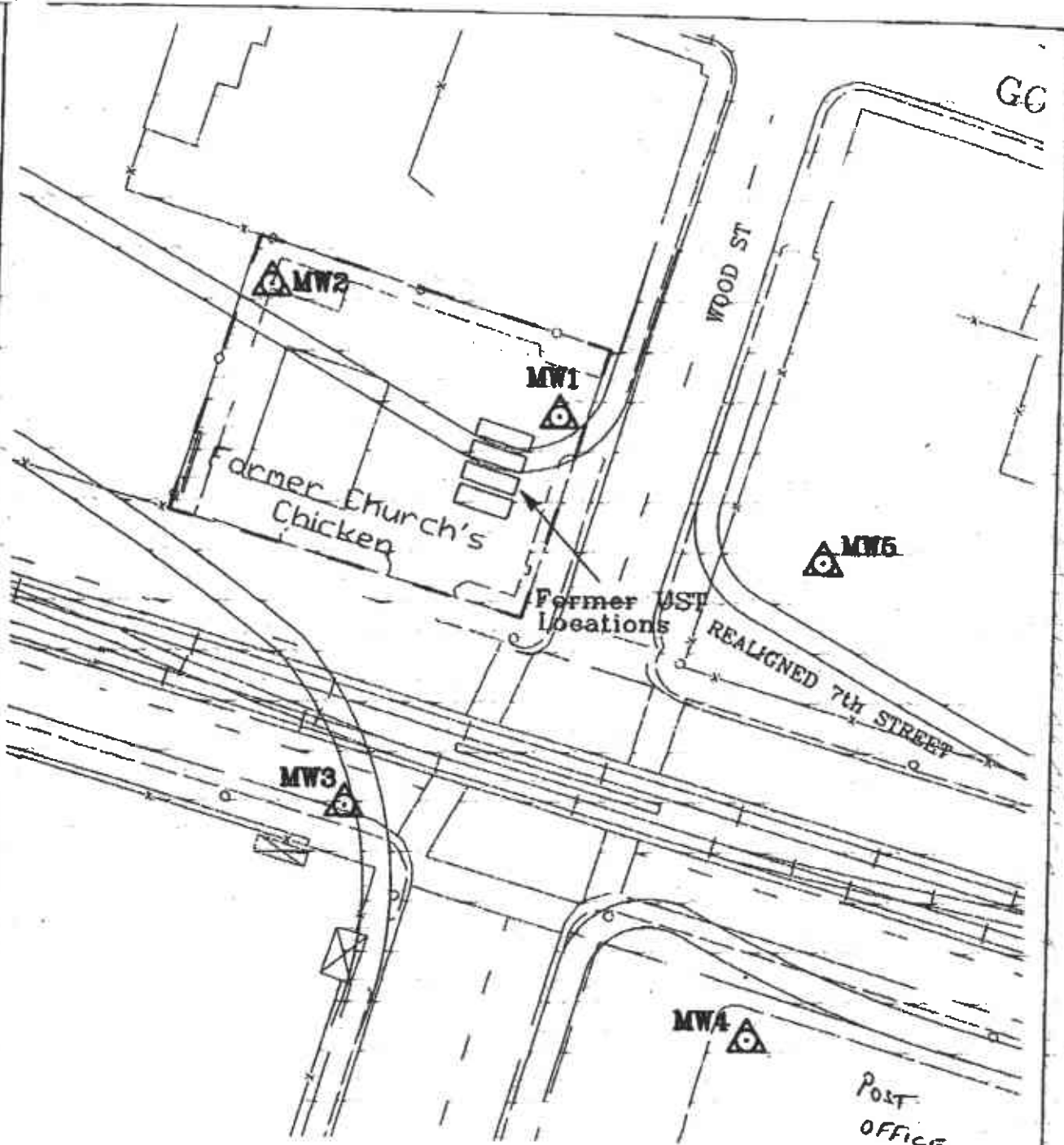

LEGEND

WELL LOCATION

- Notes:
1. Base map compiled from maps provided by Caltrans.
 2. All locations and dimensions are approximate.

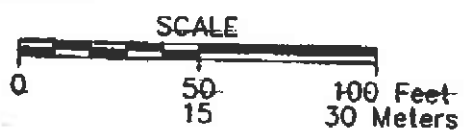

FIGURE 2

MONITORING WELL LOCATIONS

Caltrans - Former Church's Chicken Property
Oakland, California



IT CORPORATION
A Member of
The IT Group

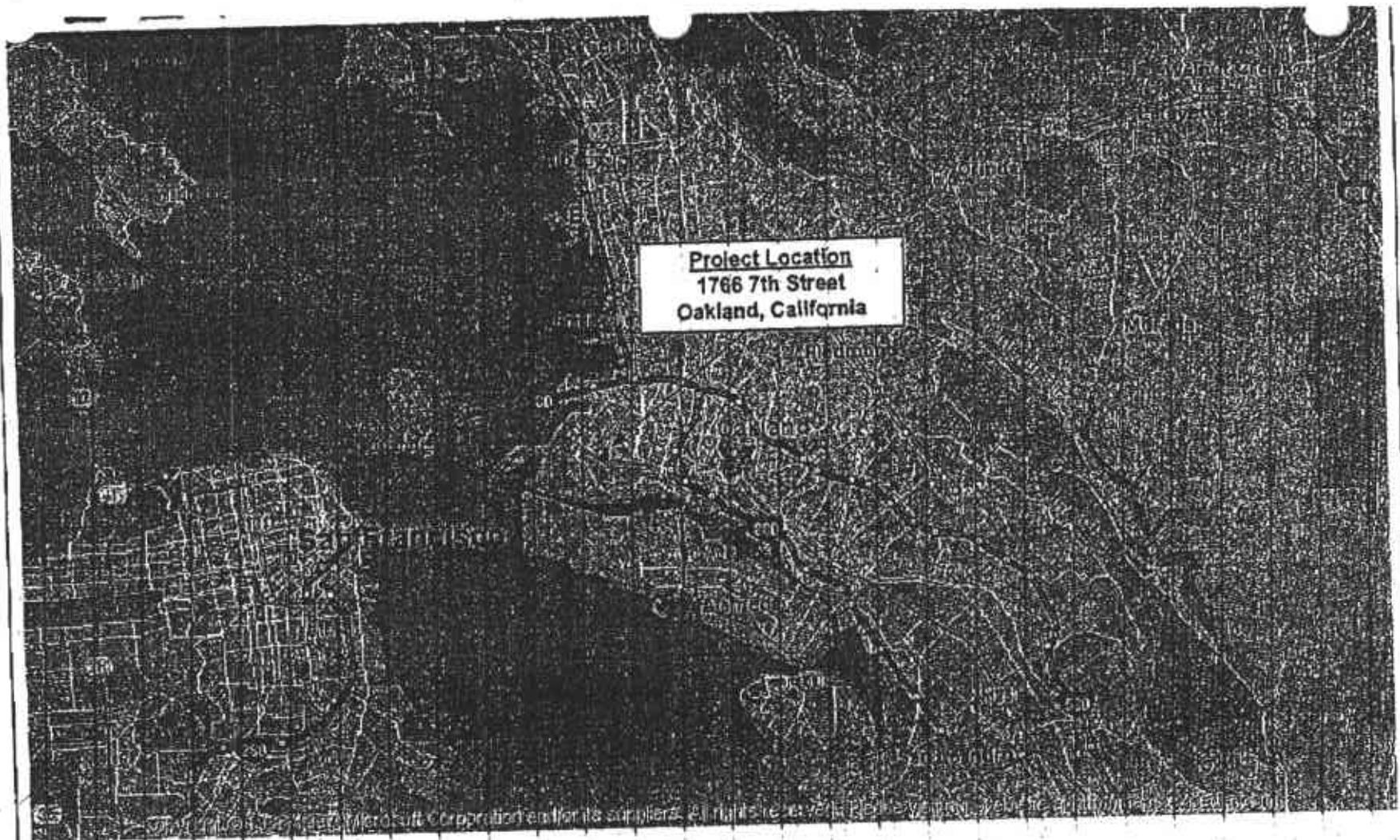

Project Location
 1766 7th Street
 Oakland, California

Reference:
 Microsoft Expedia, Streets 98



Figure 1

SITE LOCATION MAP

Caltrans-Cypress GW (Church's Fried Chicken)
 Quarterly GW Monitoring
 Task Order No.04-911052,WB

