



**BLAINE
TECH SERVICES** (INC)

1370 TULLY RD., SUITE 505
SAN JOSE, CA 95127
(408) 995-5530

January 15, 1988

Campanella Demolition
5401 San Leandro Street
Oakland, CA 94601

Attention: Dennis Brown

Re: Field sampling at

2411 BAUMANN AVENUE
SAN LORENZO, CA

DECEMBER 28, 1987

SAMPLING REPORT

Field sampling was undertaken in accordance with State and local enforcement agency standards and requirements for objective analytical information on the levels of residual contaminants found outside the primary containment structure. This project concerned the following:

A SUBSURFACE WATER SAMPLE FROM AN OPEN PIT WAS COLLECTED
WHERE TANKS HAD PREVIOUSLY BEEN REMOVED.

(Reference: Blaine Tech Services Report 87345C1)

Tanks previously removed -- One 10,000 gallon gasoline
One 10,000 gallon diesel

Sampling was performed in accordance with approved methodology at the locations shown on the accompanying site diagram. Additional information is presented on the diagram including our field sampling designations and the lab identification numbers which reference the analytical results which will be found in the separate laboratory report. Sample material was collected in special containers appropriate to the type of analysis intended. Sample containers were sealed, chilled, and transported to the laboratory with standard chain of custody records maintained at each transmittal. This sampling report, the chain of custody, and the analytical report comprise the formal documentation of the sampling conducted during this phase of work at the site.

**BLAINE
TECH SERVICES**

SAMPLING REPORT 87362FZ, 12-28-87, CAMPANELLA, 2411 BAUMANN AVENUE, SAN LORENZO, CA

MAP REF: THOMAS BROS.
ALAMEDA COUNTY
P.57 C-1

0 30' 60'
SCALE: 

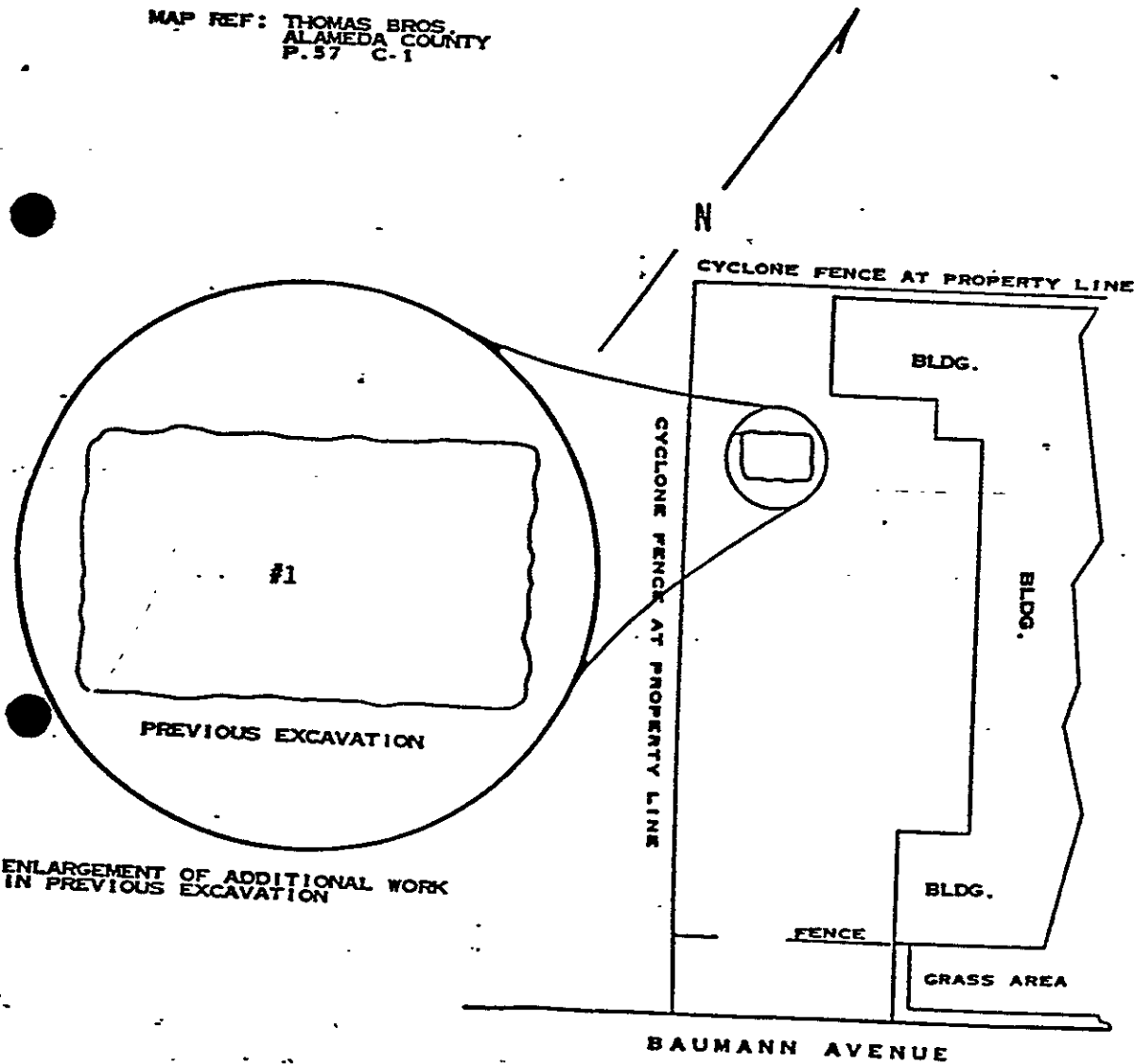

#1 SUBSURFACE WATER SAMPLE
ANALYSIS FOR TOTAL PETROLEUM
HYDROCARBONS (TPH) AS GASOLINE,
AND BENZENE, TOLUENE, XYLENES,
AND ETHYLBENZENE (BTX & E) AT
SEQUOIA ANALYTICAL LABORATORY
SEQUOIA LAB NO. 7122029

SAMPLING PERFORMED BY FRANK CLINE
DIAGRAM PREPARED BY BRENT ADAMS

REPORTAGE

Submission to the Regional Water Quality Control Board and the local regulatory/enforcement agency should include copies of the sampling report, the chain of custody, and the laboratory report. The property owner should attach a cover letter and submit all documents together in a package.

The following addresses have been listed here for your convenience:

Water Quality Control Board
San Francisco Bay Region
1111 Jackson Street
Room 6040
Oakland, CA 94607
ATTN: Greg Zentner

464 1255

Alameda County Health
Hazardous Materials Management
420 27th Street
Oakland, Ca 94612
ATTN: Lawrence Seto, Haz. Mat. Specialist

Please call if we can be of any further assistance.



Richard C. Blaine

RCB/jag



SEQUOIA Analytical Laboratory

2549 Middlefield Road
Redwood City, CA 94063 • (415) 364-9222

Blaine Tech Services
P.O. Box 5745
San Jose, CA 95150
Attn: Richard Blaine

Date Sampled: 12/28/87
Date Received: 12/28/87
Date Reported: 01/13/88
Project: BTS #87362F2,
Campanella, San Lorenzo

TOTAL PETROLEUM FUEL
HYDROCARBONS WITH BTX DISTINCTION

Sample Number

7122029

Sample Description

Water, #1

	<u>Detection Limit</u> ppb	<u>Sample Results</u> ppb
Low to Medium Boiling Point Hydrocarbons	50	< 50
Benzene	0.5	< 0.5
Toluene	0.5	0.58
Xylenes	0.5	3.8
Ethyl benzene	0.5	< 0.5

Method of Analysis: EPA 5030/602/8015

SEQUOIA ANALYTICAL LABORATORY

Arthur G. Burton
Laboratory Director

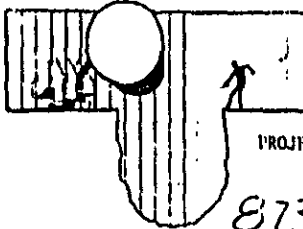

**BLAINE
TECH SERVICES INC.**

1370 TULLY RD., SUITE 50
SAN JOSE, CA 95128
(408) 995-5533

PROJECT NUMBER

SITE ADDRESS

8736212

Campanella Annex @
2411 Baumana Ave
San Lorenzo, CA

PLEASE INCLUDE PROJECT NUMBER AND SITE ADDRESS ON LAB REPORTS AND INVOICES

TURN-AROUND 1 week RESULTS BY 11/1/87 LAB USED SEQ

BILLING SPECIAL INSTRUCTIONS

Bill Blaine Tech Services
 Bill

T.O. ANALYSIS TO DETECT LAB # LAB RESULTS

#1 Liquid THC (Gas) BIXE

Field sampling completed 13:30 AM @ 12/28/87 performed by [Signature]

RELEASED BY

ACCEPTED BY

4:10 AM @ 12/28/87 [Signature]

4:10 AM @ 12/28/87 [Signature]

____ AM/PM - 87

____ AM/PM - 87

____ AM/PM - 87

____ AM/PM - 87