



The Sherwin-Williams Company
Coatings Division
101 Prospect Avenue, N.W.
Cleveland, OH 44115

November 30, 1994

Mr. Sum Arigala
Ca. Regional Water Quality Control Board
2101 Webster Street, Suite 500
Oakland, CA 94612

Dear Sum:

RE: Status/Plans
Interim Remediation Project
Sherwin-Williams, Emeryville, CA

As in the past, I want to give you a brief update on the status/plans of this project at our Emeryville site.

1. Purchase of R.R. Property

This was finalized in October, following the long delayed signing of the "lot line adjustment" by the City of Emeryville.

2. Slurry Wall

This was completed week of 11/21/94 by GeoCon. As you know, this completion depended on the acquisition of the R.R. property.

3. Environmental "Cap"

- a) *South end of plant*--this was completed in August, 1994, as we discussed with you during our last meeting (10/21/94).
- b) *North end of plant*--a contract has been awarded to Powers Engineering Co. to perform this work. Start date is 12/5/95, and the expected completion is mid-March, 1995--highly dependent on weather conditions. All building permits are secured.

4. New and Replacement Wells

This will be managed by Levine-Fricke and will be installed in February or March prior to the installation of asphalt and concrete for the "North end cap"--(3b. above). This will include three extraction wells (to pump groundwater), several replacement wells (destroyed under permit during construction or destroyed by others off-site), and the new monitoring wells previously agreed to.

5. Groundwater Treatment System

All equipment/controls have been in place for months. A contract for the interconnecting piping and electrical will be

awarded by mid-December, 1994. We plan to complete and start-up this system within a month of completing the "North end cap", or sometime in April.

6. Sampling of Rifkin Property Wells
Quarterly sampling of the 5 wells will be initiated in February of 1995, as previously agreed to.

Sum, I believe this covers the key points. We will discuss the details of this project, and related matters (including the NPDES permit) when we meet at 9:00 AM on December 12, 1994.

Sincerely,

David B. Gustafson
Director of Engineering
and Environmental

DBG/mgd
1130c.dbg

cc: L.Mencin
M.Knox
F.McHugh

bcc: W.Antonace
C.Johnson
A.Danzig

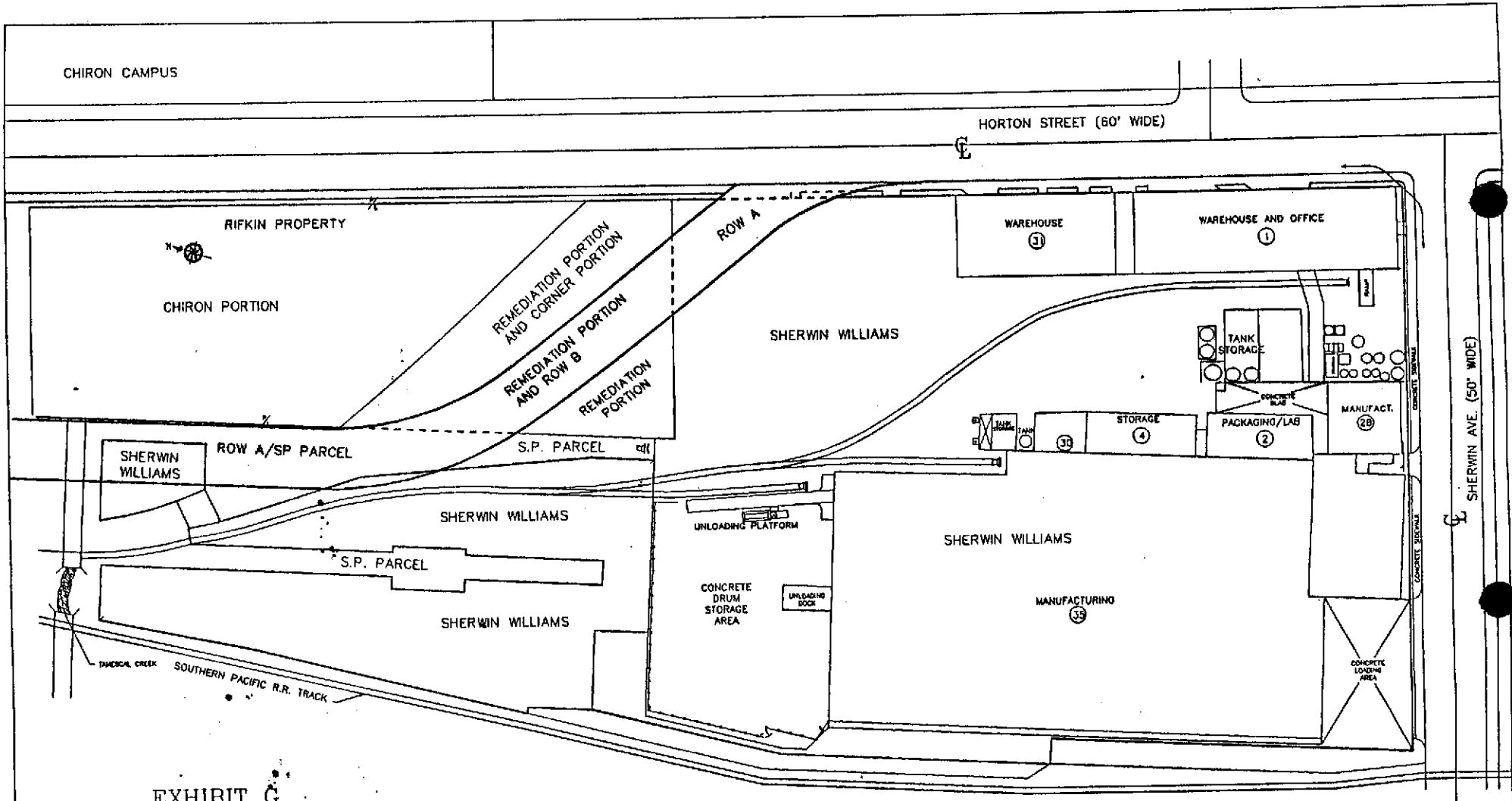

EXHIBIT C
CONCEPTUAL

1" = 120'

DATE	BY	DESIGNED BY	REVISION

SHERWIN WILLIAMS COATINGS DIVISION
ENGINEERING

EMERYVILLE, CALIFORNIA

MOU - GENERAL AREA
MAP OF PARCEL
& PORTIONS

DATE: 10/4/27/94

Y SLO 418 L