



1900 Powell Street, 12th Floor
Emeryville, California 94608-1827
(510) 652-4500, FAX (510) 652-2246

FAX TRANSMISSION: This cover page plus 6 pages.

Date	May 13, 1997
Time	2:50 PM
From	Mark Knox
Project No.	3042.95.008

Deliver To	Name Of Firm	FAX Number
Ravi Arulanantham	RWQCB	510-286-1380
Mark Johnson	RWQCB	510-286-1380
Tom Dunkelmann	EPA	415-744-1916
Barbara Cook	DTSC	510-540-3819
Susan Hugo	ACHD	510-337-9335
Ric Notini	Chiron Corp.	510-923-7476
Michael Biddle	City of Emeryville	510-596-3724
Ignacio Dayrit	City of Emeryville	510-596-3724
Larry Mencin	Sherwin Williams	216-566-2730
John Gerulis	Sherwin Williams	216-566-2730
Dave Gustafson	Sherwin Williams	216-566-1792
Allen Danzig	Sherwin Williams	216-566-1708
Sue Free	Sherwin-Williams	510-654-7997
Ed Sangster	McKenna and Cuneo	415-267-4198
Sharon Wilchar	45th Street Artists Coop	510-655-2807
Tom Kalinowski	EKI	415-578-9131
James Ritchie	Secor	415-882-4406
Mara Feeney	Mara Feeney and Associates	415-863-5671

THE INFORMATION CONTAINED IN THIS FACSIMILE IS CONFIDENTIAL AND IS INTENDED ONLY FOR THE USE OF THE INDIVIDUAL OR ENTITY TO WHICH IT IS ADDRESSED. IF YOU ARE NOT THE INTENDED RECIPIENT, OR THE PERSON RESPONSIBLE FOR DELIVERING IT TO THE INTENDED RECIPIENT, DO NOT USE OR DISCLOSE THIS FACSIMILE. IF YOU HAVE RECEIVED THIS FACSIMILE IN ERROR, PLEASE NOTIFY US IMMEDIATELY BY TELEPHONE AND RETURN THE ORIGINAL TO LEVINE-FRICKE-RECON VIA THE U.S. POSTAL SERVICE.
THANK YOU.

Comments: Enclosed are 3 figures which summarize the soil data collected last week on Horton Street. Each figure is 11x17 and has been faxed in 2 halves for clarity. The following summarizes each figure:

- 1) CONCRETE SAMPLING LOCATIONS FIGURE 1B This figure shows the results of sampling the concrete sidewalk for purposes of waste characterization for disposal.
- 2) SOIL SAMPLE LOCATIONS AND RESULTS HORTON STREET FIGURE 1A This figure presents the results of shallow soil sampling in Horton Street. Please note that we had a lot of sample locations where we had refusal due to the very tight compaction in the street. We also attempted to take a strata of samples at several locations (as requested by EKI) but either encountered refusal or had poor sample recovery.
- 3) OUTLYING SURFACE/SOIL BORING LOCATIONS FIGURE 3 - This figure is the same as previously submitted with the addition of 4 samples in the sidewalk. The new samples are SW-1 and SW-2 along the north side of Sherwin Ave. and SW-3 and SW-4 along the west side of Horton St. north of Sherwin-Williams. These additional samples were requested by the RWQCB.

3042C022.CDR 051397

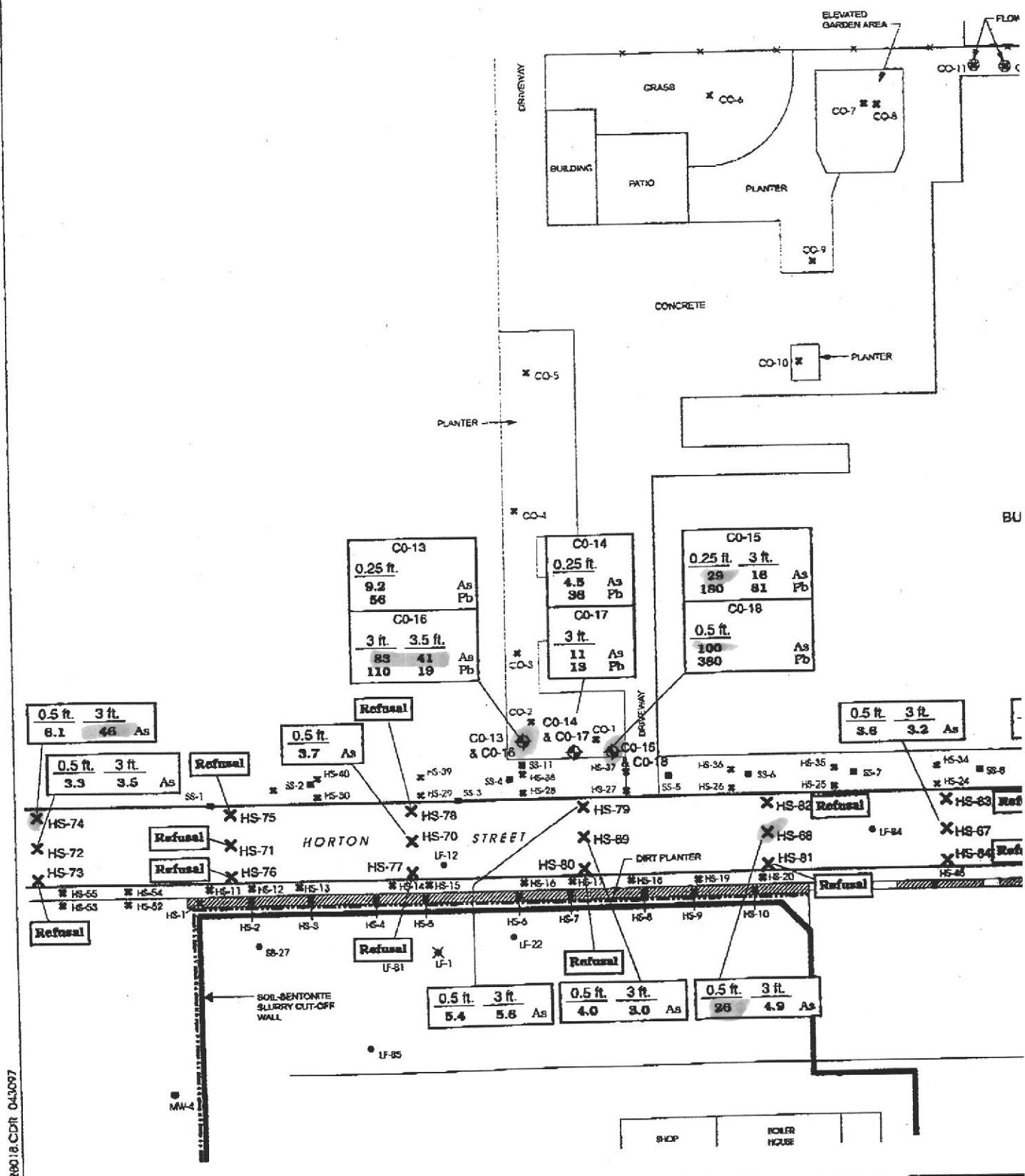

30429018.CDR 043097

Figure 1a - page A

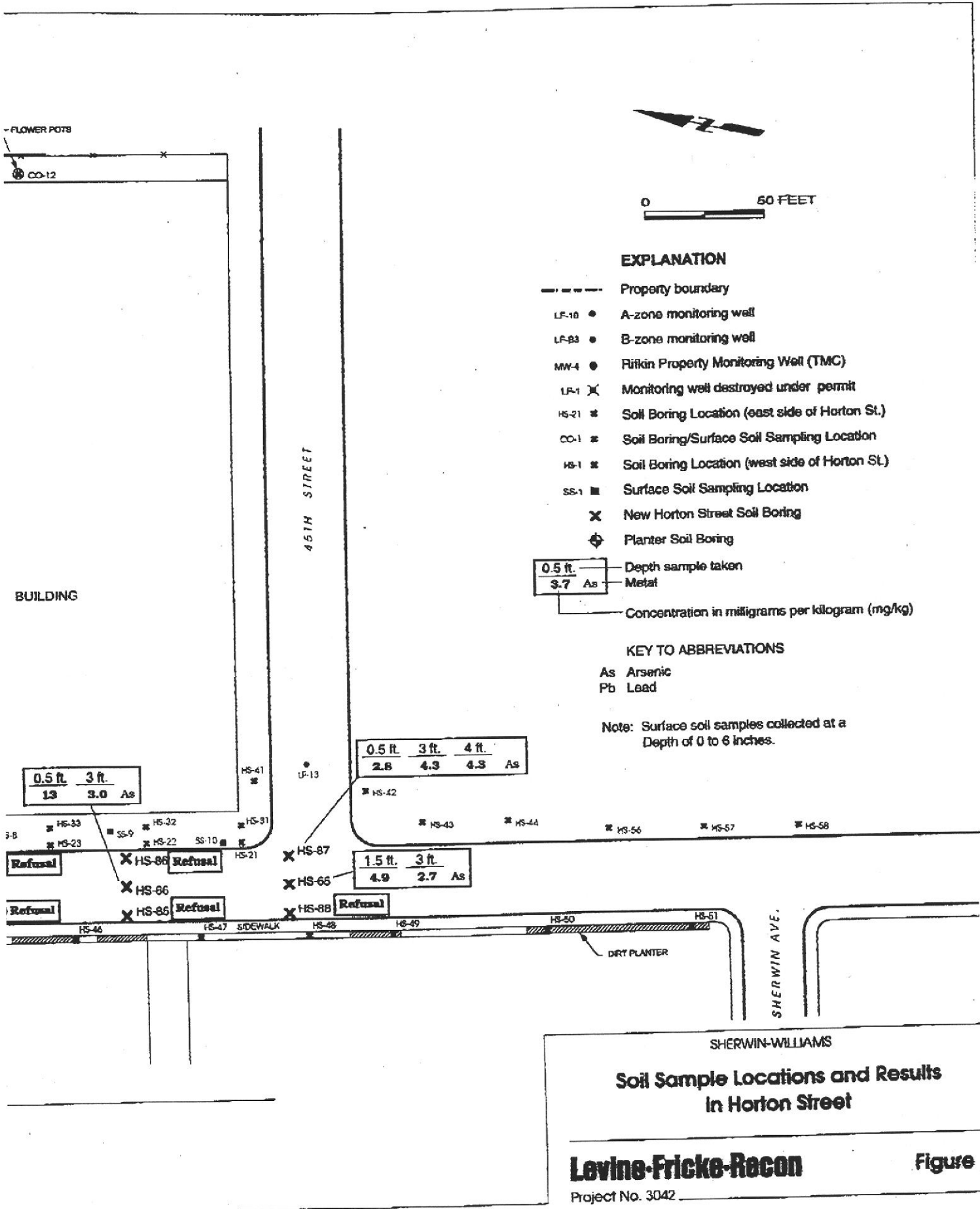

Figure 1a - page 13

SHERWIN-WILLIAMS
Soil Sample Locations and Results
in Horton Street

Levine-Fricke-Recon

Figure 1a

Project No. 3042

3042C021.CDR 051397

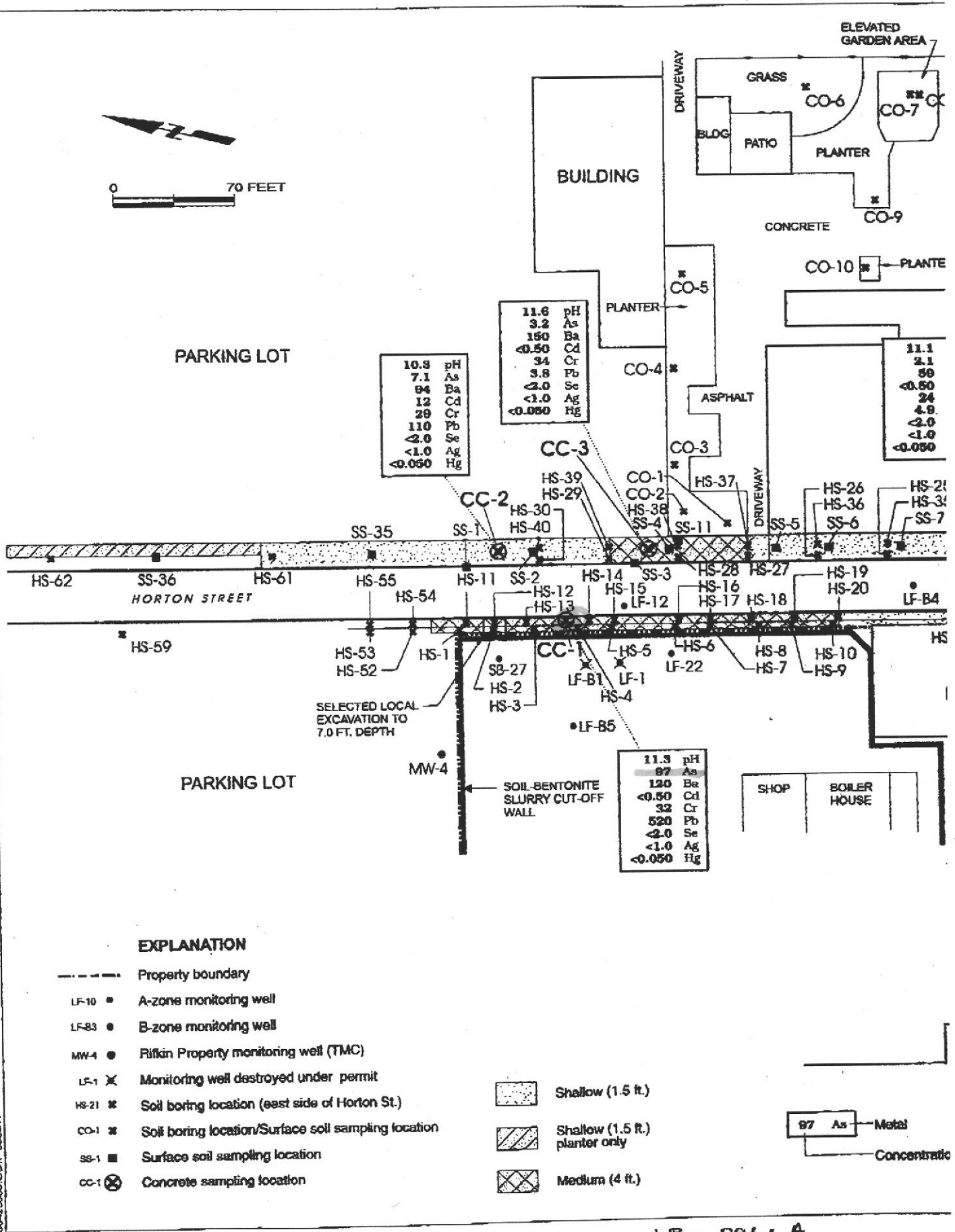

3042903.CDR 050297

Figure 1B - page A

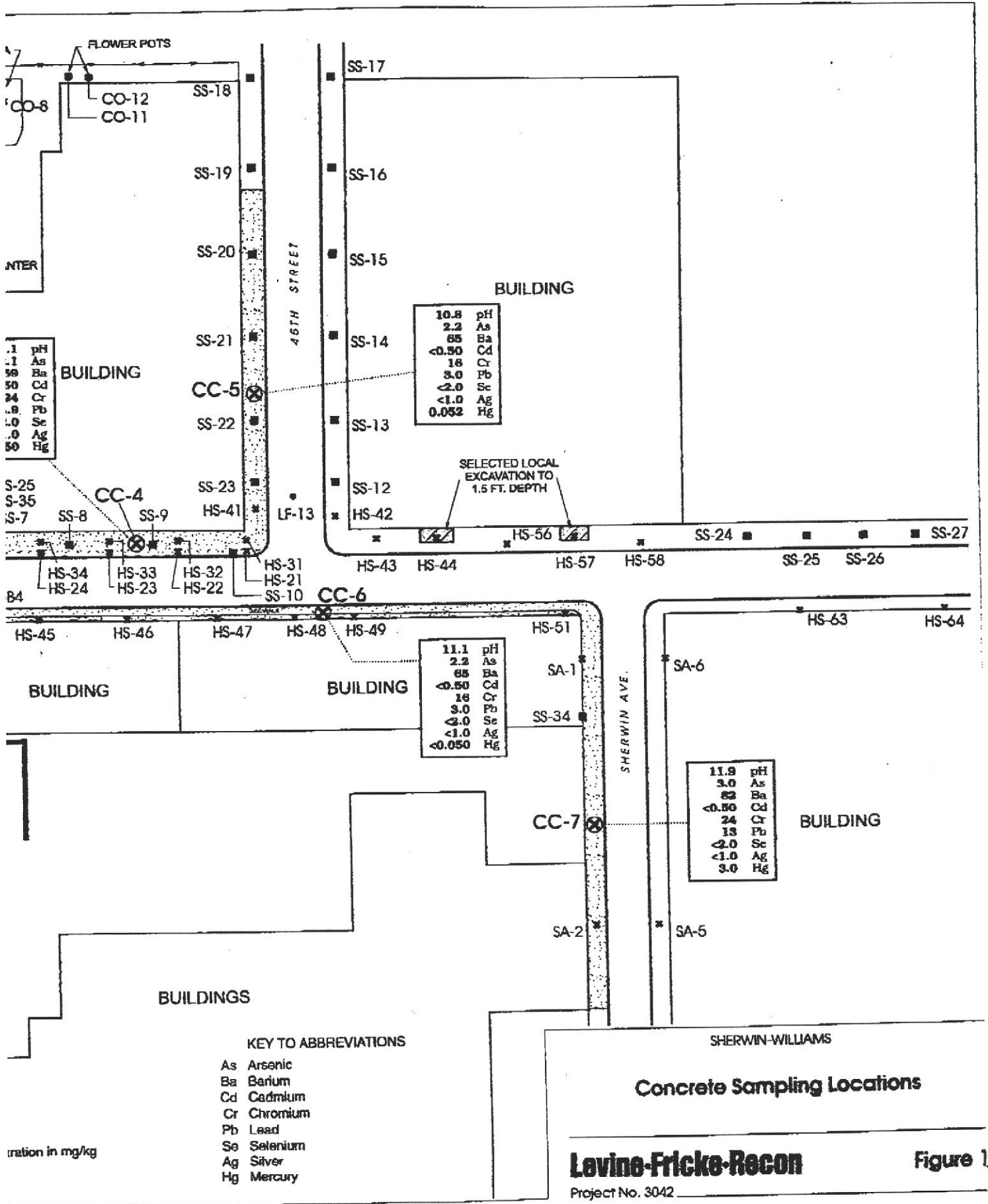
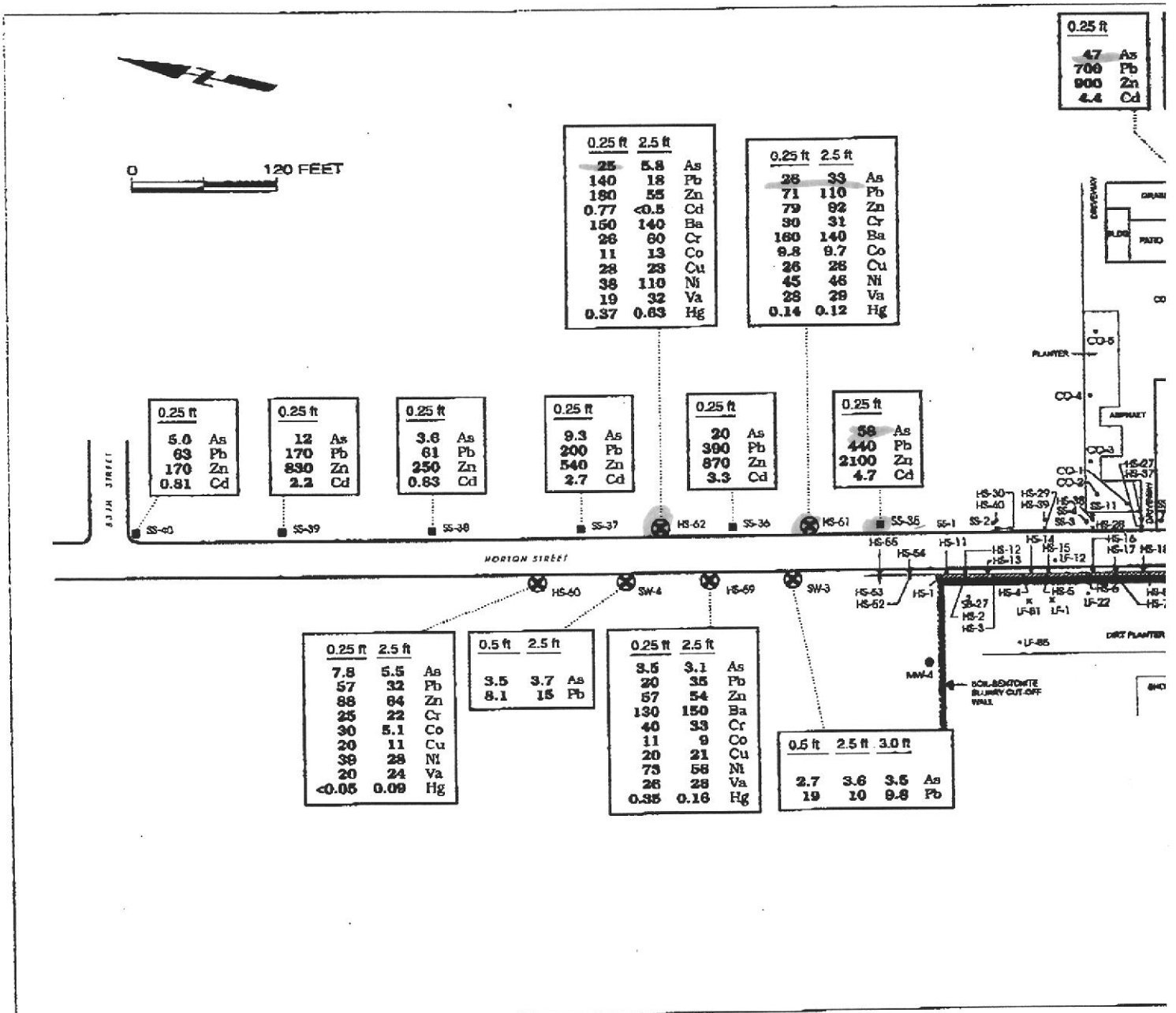

Figure 1B - page B



EXPLANATION

- Property boundary
- LF-10 ● A-zone monitoring well
- LF-B3 ● B-zone monitoring well
- MW-4 ● Rifkin Property Monitoring Well (TMC)
- LF-1 ✕ Monitoring well destroyed under permit
- HS-21 ✕ Soil Boring Location (east side of Horton St.)
- CO-1 ✕ Soil Boring Location/Surface Soil Sampling Location
- SS-1 ■ Surface Soil Sampling Location
- ⊗ Additional Soil Sampling Locations-(under sidewalk)
Shallow (0-3') and Medium (2 1/2') Depth Samples

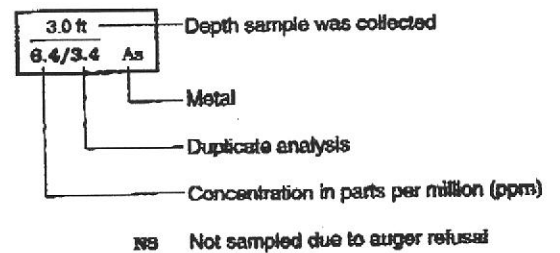
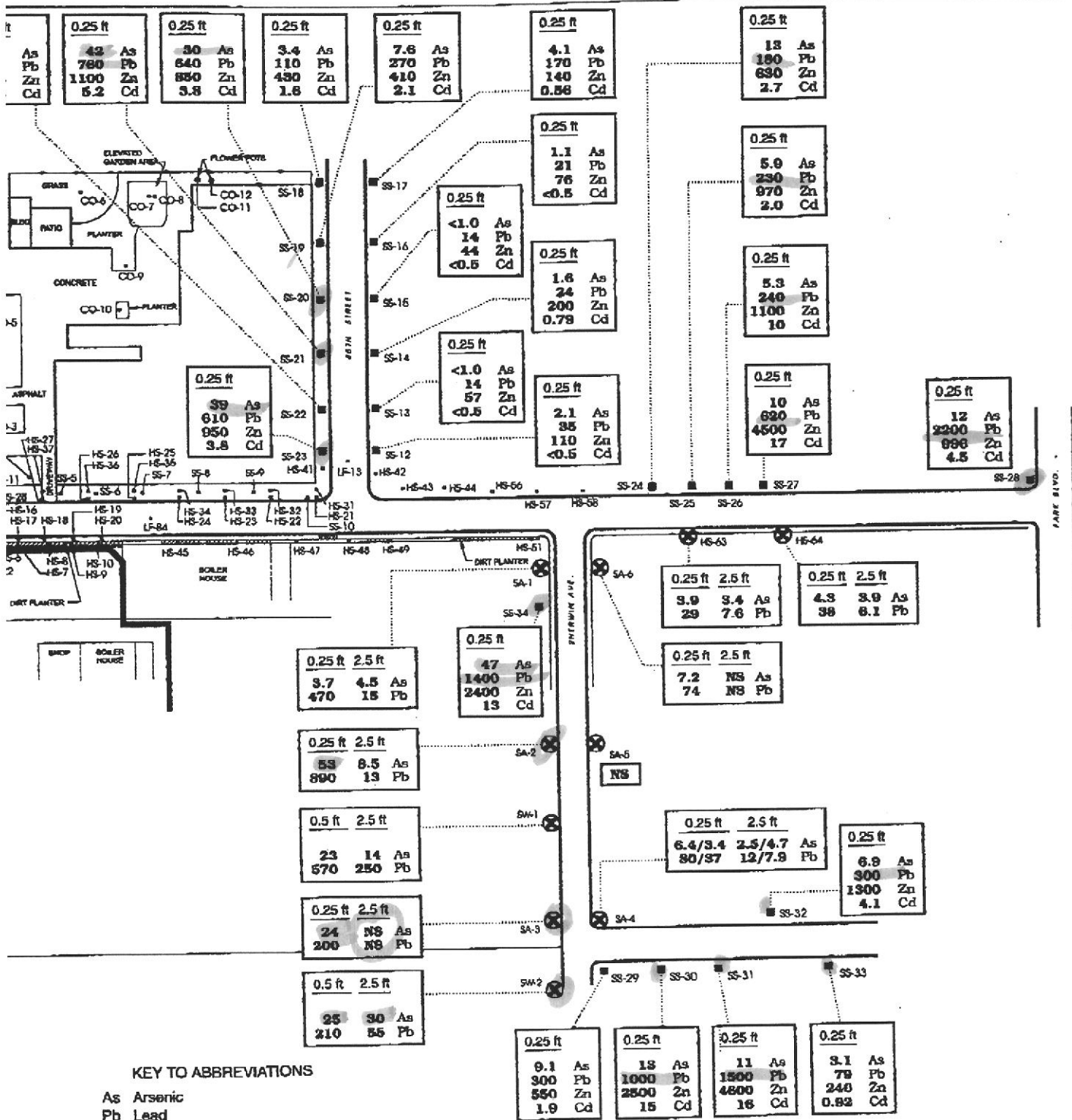

Figure 3 - page A



KEY TO ABBREVIATIONS

- As Arsenic
- Pb Lead
- Zn Zinc
- Ba Barium
- Cd Cadmium
- Cr Chromium
- Co Cobalt
- Cu Copper
- Ni Nickel
- Va Vanadium
- Hg Mercury

(ppm)

SHERWIN-WILLIAMS

Outlying Surface/Soil Boring Locations

Levine-Fricke-Recon Figure 3

Project No. 3042

Figure 3 - page 5