



RECEIVED

By Alameda County Environmental Health 3:12 pm, Sep 12, 2016

Keith Nowell
Alameda County Environmental Health
1131 Harbor Parkway, Suite 250
Alameda, CA 94502-6577

Shell Oil Products US

DS Soil & Groundwater Focus Delivery Group
20945 S. Wilmington Avenue
Carson, CA 90810
Tel (323) 291 9595
Fax (323) 291 9599
Email Deborah.Pryor@shell.com
Internet <http://www.shell.com>

September 7, 2016

**RE: Shell-Branded Service Station
1601 Webster Street
Alameda, CA
PlaNNet Site ID 10007774
PlaNNet Project ID 33072
ACEH Case No. RO0002745**

Dear Mr. Nowell:

I am informed and believe that, based on a reasonably diligent inquiry undertaken by AECOM on behalf of Equilon Enterprises LLC dba Shell Oil Products US, the information and/or recommendations contained in the attached document is true, and on that ground I declare under penalty of perjury in accordance with Water Code section 13267 that this statement is true and correct.

As always, please feel free to contact me directly at (323) 291-9595 with any questions or concerns.

Sincerely,
Shell Oil Products US

Deborah Pryor
Senior Program Manager

September 7, 2016

Keith Nowell
Alameda County Environmental Health
1131 Harbor Bay Parkway
Alameda, CA 94502

Re: Well Destruction Report
Shell-Branded Service Station
1601 Webster Street, Alameda, California
Shell PlaNet Site ID: 10007774
Shell PlaNet Project ID: 33072
Agency No. RO0002745

Dear Mr. Nowell:

On behalf of Equilon Enterprises LLC dba Shell Oil Products US, AECOM Technical Services, Inc. is pleased to submit this report documenting well destructions at the Shell-Branded Service Station at 1601 Webster Street in Alameda, California.

If you have any questions regarding this submittal, please contact Sara Heikkila at 213-996-2285 or Sara.Heikkila@aecom.com.

Sincerely,



Sara Heikkila
Project Manager



Aubrey Cool, P.G.
Portfolio Manager

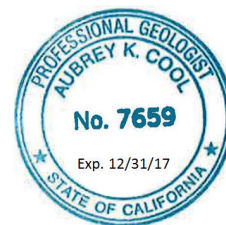

Enclosures: Well Destruction Report

cc: Deborah Pryor, Shell Oil Products US
Sam Trinh, 1601 Webster St, Alameda, CA 94501-2133

Well Destruction Report

Shell-Branded Service Station
1601 Webster Street
Alameda, California

September 2016

Well Destruction Report

Shell-Branded Service Station
1601 Webster Street
Alameda California

PlaNNet Site ID 10007774
PlaNNet Project ID 33072
Agency No. RO0002745

Submitted to:

Keith Nowell
Alameda County Environmental Health
1131 Harbor Bay Parkway, Suite 250
Alameda, California 94502-6577

Submitted by:

AECOM Technical Services, Inc.
1333 Broadway, Suite 800
Oakland, California 94612

On Behalf of

Shell Oil Products US

September 7, 2016

Table of Contents

1 Introduction.....	1-1
1.1 Site Information.....	1-1
1.2 Site Summary.....	1-1
2 Monitoring Well Destruction Activities	2-1
2.1 Pre-Mobilization Activities.....	2-1
2.2 Monitoring Well Destructions.....	2-1
2.2.1 Grouting Methodology.....	2-1
2.3 Waste Removal.....	2-1
3 Conclusion	3-1

List of Figures

Figure 1 Vicinity Map

Figure 2 Site Map

List of Tables

Table 1 Pressure Grout Volume Calculations and Actual Volumes

List of Appendices

Appendix A Regulatory Correspondence

Appendix B Well Destruction Permits

Appendix C Non-Hazardous Waste Data Form

List of Acronyms

ACEH	Alameda County Environmental Health
ACPWA	Alameda County Public Works Agency
AECOM	AECOM Technical Services, Inc.
DWR	California Department of Water Resources
HASP	Health and Safety Plan
Shell	Equilon Enterprises LLC dba Shell Oil Products US
USA	Underground Service Alert

1 Introduction

AECOM Technical Services, Inc. (AECOM) prepared this Well Destruction Report on behalf of Equilon Enterprises LLC dba Shell Oil Products US (Shell). This report is being submitted to document well destructions in accordance with Alameda County Environmental Health (ACEH) and Alameda County Public Works Agency (ACPWA) requirements.

1.1 Site Information

Site Name:	<u>Shell-Branded Service Station</u>
Site Address:	<u>1601 Webster Street, Alameda, California</u>
Shell Program Manager:	<u>Deborah Pryor</u>
Consulting Co./Contact Person:	<u>AECOM / Sara Heikkila</u>
Primary Agency:	<u>ACEH</u>

1.2 Site Summary

The site is an active Shell-Branded Service Station located on the northwest corner of the Webster Street and Lincoln Avenue intersection in Alameda, California. The general area is a mix of residential and commercial properties. The site layout includes three fuel underground storage tanks, two fuel dispenser islands, and a station building. ACEH directed the well destructions to obtain case closure in a letter dated June 10, 2016 (Appendix A).

Wells S-1, MW-1, MW-2, and MW-3 were properly destroyed following closure of the previous case in 1999.

2 Monitoring Well Destruction Activities

2.1 Pre-Mobilization Activities

Prior to performing the well destructions, AECOM obtained well destruction permits W2016-0504 to W2016-0512 from ACPWA (Appendix B). AECOM provided well construction details and obtained permits to destroy the wells by pressure grouting.

AECOM prepared a Health and Safety Plan (HASP) to protect site workers during the well destruction activities. The HASP was kept on site and contained a signature log of all site workers.

AECOM marked the site for Underground Service Alert (USA) clearance and notified USA before beginning work. Subtronic Corporation of Martinez, California, a private utility locator, was contracted to identify all subsurface utilities and potential obstructions near the wells and to confirm USA markings.

2.2 Monitoring Well Destructions

On July 25 and 26, 2016, PeneCore Drilling (C-57 No. 906899) properly destroyed nine on-site monitoring wells by pressure grouting in accordance the well destruction permits W2016-0504 to W2016-0512 from ACPWA (Appendix B).

2.2.1 Grouting Methodology

Monitoring wells S-2 through S-9 and S-4B were properly destroyed by pressure grouting. The wells were backfilled with neat cement grout using a tremie pipe to approximately 3 feet below the top of the casing. Approximately 25 pounds per square inch of pressure were attempted to be continuously applied for a minimum of 5 minutes for all wells. Following pressure grouting, well pads and boxes were removed by using a jackhammer. The remaining void was backfilled with neat cement grout to approximately 6 inches below ground surface and finished with concrete matched to the existing surface.

AECOM calculated the volume of neat cement grout to be added to properly destroy the monitoring wells. Grout volume calculations and actual volumes of neat cement grout used in the field during pressure grouting are included in Table 1. All wells added a greater volume of neat cement grout than the calculated amount.

2.3 Waste Removal

All waste was stored on site in California Department of Transportation approved 55-gallon drums. Three drums of construction debris and one drum of displaced groundwater were removed from the site on August 16, 2016, by Belshire Environmental Services, Inc. of Foothill Ranch, California. The construction debris was transported to the U.S. Ecology, Nevada Operations located in Beatty, Nevada, and the displaced groundwater was transported to Demenno/Kerdoon in Compton, California. Waste manifest and weight tickets are included as Appendix C.

3 Conclusion

All well destructions were completed and documented in accordance with State and County guidelines. Department of Water Resources (DWR) well completion reports were completed and submitted to ACEH for forwarding to DWR. Copies will be maintained by AECOM and made available for agency review upon request.

Figures

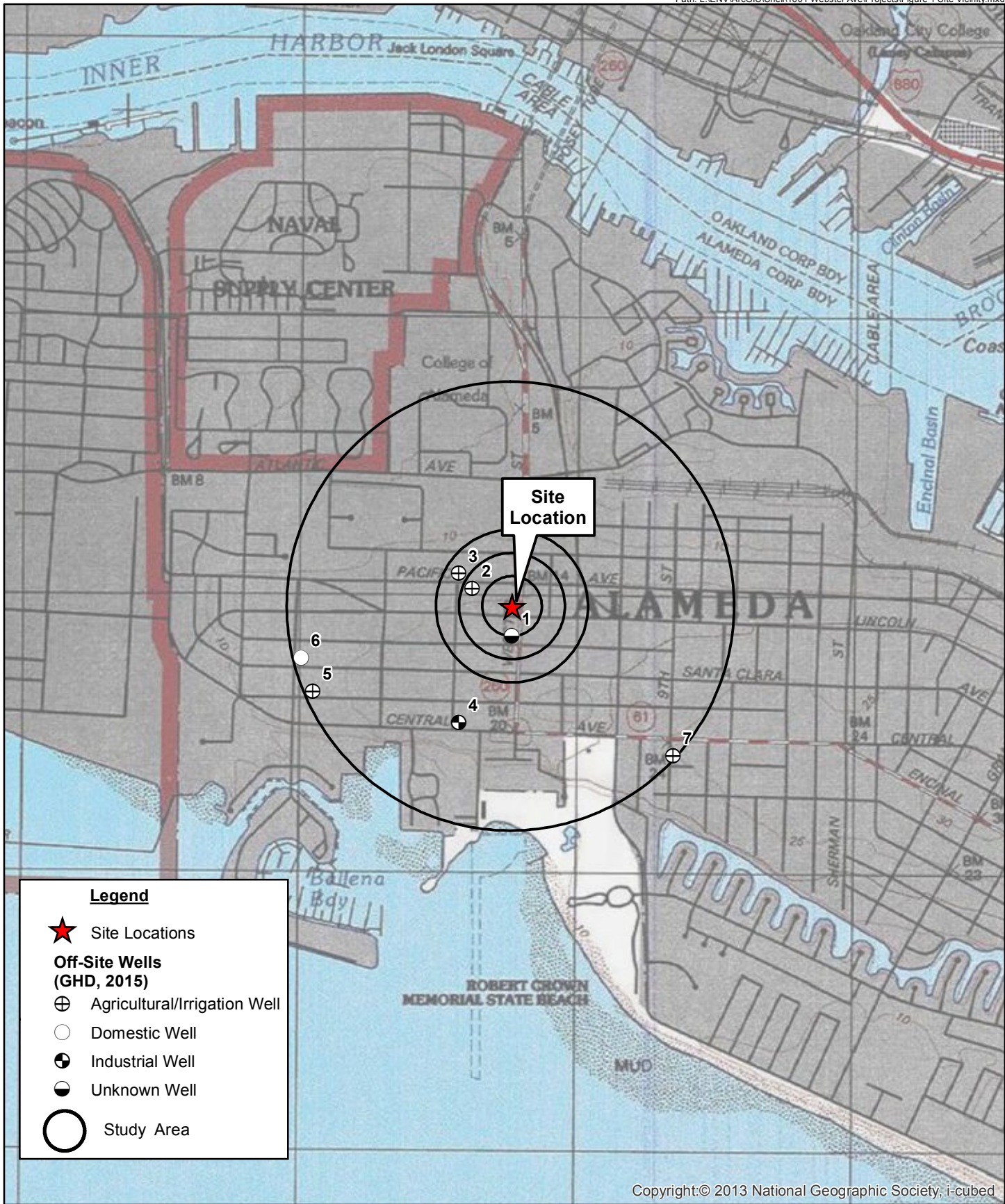

Copyright: © 2013 National Geographic Society, i-cubed

Figure 1
Site Vicinity Map

Shell-Branded Service Station
1601 Webster Street, Alameda, California

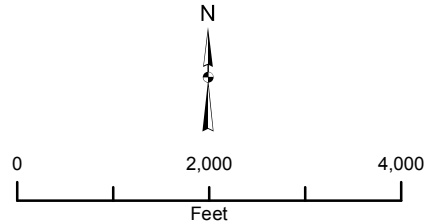

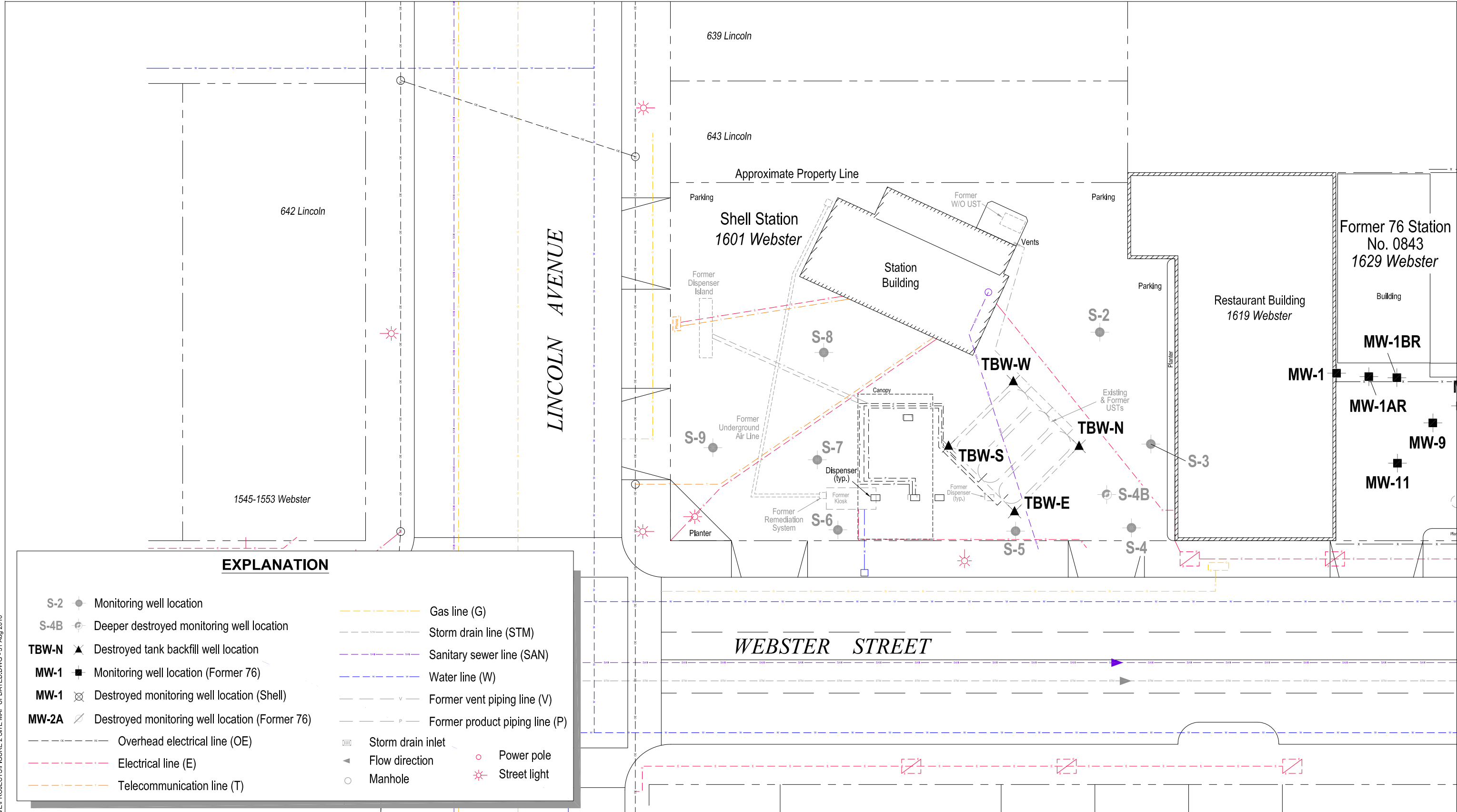

EXPLANATION

- | | | |
|--|--------------------------------|--------------|
| S-2 ● Monitoring well location | Gas line (G) | Power pole |
| S-4B ● Deeper destroyed monitoring well location | Storm drain line (STM) | Street light |
| TBW-N ▲ Destroyed tank backfill well location | Sanitary sewer line (SAN) | |
| MW-1 ■ Monitoring well location (Former 76) | Water line (W) | |
| MW-1 ☒ Destroyed monitoring well location (Shell) | Former vent piping line (V) | |
| MW-2A ☒ Destroyed monitoring well location (Former 76) | Former product piping line (P) | |
| — Overhead electrical line (OE) | Storm drain inlet | |
| — Electrical line (E) | Flow direction | |
| — Telecommunication line (T) | Manhole | |

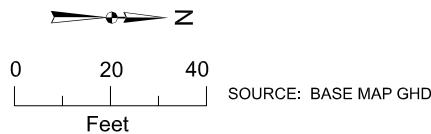

Figure 2
Site Map



Shell-Branded Service Station
1601 Webster Street, Alameda, California

L:\ENV\GIS\HELL\1601 WEBSTER AVE\PROJECTS\FIGURE 2 SITE MAP UPDATED.DWG - 31 Aug 2016

Table

Table 1
Pressure Grout Volume Calculations and Actual Volumes
Shell-Branded Service Station, 4212 1st Street, Pleasanton, California

Well ID	Total Well Depth (h ₁) (feet)	Well Casing Diameter (r ₂) (inches)	Borehole Diameter (r ₁) (inches)	Screen Length (h ₂) (feet)	Grout Volume				
					Casing (Cu. ft)	Sand Pack (Cu. ft)	Total (Cu. ft)	Total Calculated (V) (gallons)	Actual (gallons)
S-2	12	4	10	8	1.05	0.73	1.78	13.31	14
S-3	12	4	10	8	1.05	0.73	1.78	13.31	16
S-4	12	4	10	8	1.05	0.73	1.78	13.31	14
S-4B	20	4	10	5	1.74	0.46	2.20	16.47	22
S-5	12	4	10	8	1.05	0.73	1.78	13.31	16
S-6	12	4	10	8	1.05	0.73	1.78	13.31	20
S-7	12	4	10	8	1.05	0.73	1.78	13.31	20
S-8	12	4	10	8	1.05	0.73	1.78	13.31	20
S-9	12	4	10	8	1.05	0.73	1.78	13.31	18

$$V = [(\pi r_1^2 h_2) - (\pi r_2^2 h_2)] 30\% + (\pi r_2^2 h_1)$$

Notes and abbreviations:

The grout volume calculation assumes 30 percent pore space volume of the sand pack in the screen interval.

Actual grout volumes used in the field are approximate.

Cu. ft = cubic feet

V = volume

Appendix A.

Regulatory Correspondence



ENVIRONMENTAL HEALTH SERVICES
ENVIRONMENTAL PROTECTION
1131 Harbor Bay Parkway, Suite 250
Alameda, CA 94502-6577
(510) 567-6700
FAX (510) 337-9335

July 12, 2016

Ms. Deborah Prior
Shell Oil products
20945 S. Wilmington Ave.
Carson, CA 90810
(Sent via electronic mail to:
deborah.pryor@shell.com)

Mr. Sam Tranh
1601 Webster Street
Alameda, CA 94501

Subject: Well Destruction Authorization, Fuel Leak Case No. RO0002745 and GeoTracker Global ID T0600137103, Shell #13-5032, 1601 Webster St., Alameda, CA 94501

Dear Ms. Prior and Mr. Tranh:

The public comment period for the subject site ended on July 8, 2016. No comments were received by Alameda County Environmental Health (ACEH).

You are free to proceed with the destruction of all wells associated with the site (groundwater, vapor, etc.) As requested in ACEH's letter dated June 10, 2016, please provide ACEH with a well destruction report according to the schedule outlined below. The well destruction report should document site activities, provide well destruction permit documentation, and documentation indicating that any remaining investigation, remediation, and well destruction derived waste have been removed from the site. The State Water Resources Control Board's (SWRCBs) Well Destruction and Waste Removal Requirements fact sheet is included as an attachment.

TECHNICAL REPORT REQUEST

Please submit reports to Alameda County Environmental Health (Attention: Keith Nowell), and upload technical reports to the ACEH ftp site (Attention: Keith Nowell), and to the State Water Resources Control Board's Geotracker website, in accordance with the following specified file naming convention and schedule:

- **September 8, 2016 – Well Destruction Report** - File to be named RO2745_WELL_DCM_R_YYYY-mm-dd

These reports are being requested pursuant to California Health and Safety Code Section 25296.10. 23 CCR Sections 2652 through 2654, and 2721 through 2728 outline the responsibilities of a responsible party in response to an unauthorized release from a petroleum UST system, and require your compliance with this request.

Should you have any questions, please contact me at (510) 567 - 6764 or send me an electronic mail message at keith.nowell@acgov.org.

If your email address does not appear on the cover page of this notification ACEH is requesting you provide your email address so that we can correspond with you quickly and efficiently regarding your case.

Ms. Prior and Mr. Tranh
RO0002745
July 12, 2016, Page 2

Sincerely,



Digitally signed by Keith Nowell
DN: cn=Keith Nowell, o, ou,
email=keith.nowell@acgov.org,
c=US
Date: 2016.07.12 09:06:20 -07'00'

Keith Nowell, PG, CHG
Hazardous Materials Specialist

Enclosures: Attachment 1 – Responsible Party (ies) Legal Requirements/Obligations and
Electronic Report Upload (ftp) Instructions

Attachment 2 – The State Water Resources Control Board's Well Destruction and Waste
Removal Requirements Fact Sheet

cc: Aubrey Cool, AECOM, 1333 Broadway, Suite 800, Oakland, CA 94612, (*Sent via electronic mail
to electronic mail: aubrey.cool@aecom.com*)

James Yoo, Alameda Co. Dept. of Public Works, Water Resources Section, 399 Elmhurst Street,
Hayward, CA 94544 (*Sent via electronic mail to: jamesy@acpwa.org*)

Susan Hugo, ACEH (*Sent via electronic mail to: susan.hugo@acgov.org*)

Dilan Roe, ACEH, (*Sent via electronic mail to dilan.roe@acgov.org*)

Keith Nowell, ACEH, (*Sent via electronic mail keith.nowell@acgov.org*)

Geotracker, Electronic File

Attachment 1

Responsible Party(ies) Legal Requirements / Obligations

REPORT REQUESTS

These reports are being requested pursuant to California Health and Safety Code Section 25296.10. 23 CCR Sections 2652 through 2654, and 2721 through 2728 outline the responsibilities of a responsible party in response to an unauthorized release from a petroleum UST system, and require your compliance with this request.

ELECTRONIC SUBMITTAL OF REPORTS

ACEH's Environmental Cleanup Oversight Programs (LOP and SLIC) require submission of reports in electronic form. The electronic copy replaces paper copies and is expected to be used for all public information requests, regulatory review, and compliance/enforcement activities. Instructions for submission of electronic documents to the Alameda County Environmental Cleanup Oversight Program FTP site are provided on the attached "Electronic Report Upload Instructions." Submission of reports to the Alameda County FTP site is an addition to existing requirements for electronic submittal of information to the State Water Resources Control Board (SWRCB) GeoTracker website. In September 2004, the SWRCB adopted regulations that require electronic submittal of information for all groundwater cleanup programs. For several years, responsible parties for cleanup of leaks from underground storage tanks (USTs) have been required to submit groundwater analytical data, surveyed locations of monitoring wells, and other data to the GeoTracker database over the Internet. Beginning July 1, 2005, these same reporting requirements were added to Spills, Leaks, Investigations, and Cleanup (SLIC) sites. Beginning July 1, 2005, electronic submittal of a complete copy of all reports for all sites is required in GeoTracker (in PDF format). Please visit the SWRCB website for more information on these requirements (http://www.waterboards.ca.gov/water_issues/programs/ust/electronic_submittal/).

PERJURY STATEMENT

All work plans, technical reports, or technical documents submitted to ACEH must be accompanied by a cover letter from the responsible party that states, at a minimum, the following: "I declare, under penalty of perjury, that the information and/or recommendations contained in the attached document or report is true and correct to the best of my knowledge." This letter must be signed by an officer or legally authorized representative of your company. Please include a cover letter satisfying these requirements with all future reports and technical documents submitted for this fuel leak case.

PROFESSIONAL CERTIFICATION & CONCLUSIONS/RECOMMENDATIONS

The California Business and Professions Code (Sections 6735, 6835, and 7835.1) requires that work plans and technical or implementation reports containing geologic or engineering evaluations and/or judgments be performed under the direction of an appropriately registered or certified professional. For your submittal to be considered a valid technical report, you are to present site specific data, data interpretations, and recommendations prepared by an appropriately licensed professional and include the professional registration stamp, signature, and statement of professional certification. Please ensure all that all technical reports submitted for this fuel leak case meet this requirement.

UNDERGROUND STORAGE TANK CLEANUP FUND

Please note that delays in investigation, later reports, or enforcement actions may result in your becoming ineligible to receive grant money from the state's Underground Storage Tank Cleanup Fund (Senate Bill 2004) to reimburse you for the cost of cleanup.

AGENCY OVERSIGHT

If it appears as though significant delays are occurring or reports are not submitted as requested, we will consider referring your case to the Regional Board or other appropriate agency, including the County District Attorney, for possible enforcement actions. California Health and Safety Code, Section 25299.76 authorizes enforcement including administrative action or monetary penalties of up to \$10,000 per day for each day of violation.

Alameda County Environmental Cleanup Oversight Programs (LOP and SLIC)	REVISION DATE: May 15, 2014
	ISSUE DATE: July 5, 2005
	PREVIOUS REVISIONS: October 31, 2005; December 16, 2005; March 27, 2009; July 8, 2010, July 25, 2010
SECTION: Miscellaneous Administrative Topics & Procedures	SUBJECT: Electronic Report Upload (ftp) Instructions

The Alameda County Environmental Cleanup Oversight Programs (LOP and SLIC) require submission of all reports in electronic form to the county's ftp site. Paper copies of reports will no longer be accepted. The electronic copy replaces the paper copy and will be used for all public information requests, regulatory review, and compliance/enforcement activities.

REQUIREMENTS

- **Please do not submit reports as attachments to electronic mail.**
- Entire report including cover letter must be submitted to the ftp site as **a single portable document format (PDF) with no password protection.**
- It is **preferable** that reports be converted to PDF format from their original format, (e.g., Microsoft Word) rather than scanned.
- **Signature pages and perjury statements must be included and have either original or electronic signature.**
- **Do not password protect the document.** Once indexed and inserted into the correct electronic case file, the document will be secured in compliance with the County's current security standards and a password. **Documents with password protection will not be accepted.**
- Each page in the PDF document should be rotated in the direction that will make it easiest to read on a computer monitor.
- Reports must be named and saved using the following naming convention:

RO#_Report Name_Year-Month-Date (e.g., RO#5555_WorkPlan_2005-06-14)

Submission Instructions

- 1) Obtain User Name and Password
 - a) Contact the Alameda County Environmental Health Department to obtain a User Name and Password to upload files to the ftp site.
 - i) Send an e-mail to deh.loptoxic@acgov.org
 - b) In the subject line of your request, be sure to include "**ftp PASSWORD REQUEST**" and in the body of your request, include the **Contact Information, Site Addresses,** and the **Case Numbers (RO# available in Geotracker) you will be posting for.**
- 2) Upload Files to the ftp Site
 - a) Using Internet Explorer (IE4+), go to <ftp://alcoftp1.acgov.org>
 - (i) Note: Netscape, Safari, and Firefox browsers will not open the FTP site as they are NOT being supported at this time.
 - b) Click on Page located on the Command bar on upper right side of window, and then scroll down to Open FTP Site in Windows Explorer.
 - c) Enter your User Name and Password. (Note: Both are Case Sensitive.)
 - d) Open "My Computer" on your computer and navigate to the file(s) you wish to upload to the ftp site.
 - e) With both "My Computer" and the ftp site open in separate windows, drag and drop the file(s) from "My Computer" to the ftp window.
- 3) Send E-mail Notifications to the Environmental Cleanup Oversight Programs
 - a) Send email to deh.loptoxic@acgov.org notify us that you have placed a report on our ftp site.
 - b) Copy your Caseworker on the e-mail. Your Caseworker's e-mail address is the entire first name then a period and entire last name @acgov.org. (e.g., firstname.lastname@acgov.org)
 - c) The subject line of the e-mail must start with the RO# followed by **Report Upload.** (e.g., Subject: RO1234 Report Upload) If site is a new case without an RO#, use the street address instead.
 - d) If your document meets the above requirements and you follow the submission instructions, you will receive a notification by email indicating that your document was successfully uploaded to the ftp site.

ATTACHMENT 2



Fact Sheet

Well Destruction and Waste Removal Requirements Prior to Underground Storage Tank Case Closure

Background: Proper destruction of wells helps to protect groundwater from potential threats and is a critical component of the Underground Storage Tank (UST) case closure process. The Low-Threat Underground Storage Tank (UST) Case Closure Policy (Policy) mandates that monitoring wells be properly destroyed prior to UST case closure, unless they will be kept and maintained in accordance with applicable local and state requirements. The Policy also mandates that all investigation and remediation-derived waste materials be removed prior to case closure. As of May 15, 2015, there were a total of 836 “Open-Eligible for Closure” cases throughout California, for which remaining wells and wastes served as impediments to closure.

Information for Responsible Parties and

Site Owners: If you received a letter from the State Water Resources Control Board (State Water Board), Regional Water Quality Control Board, or a local agency directing well destruction and waste removal, you must take action before your UST case can be closed. A uniform closure letter (UCL) will not be issued for your case until the wastes are removed and the wells are either destroyed or approved for continued maintenance by the regulatory agency overseeing your UST case. Your local well permitting agency may require ongoing monitoring of wells even though the regulatory agency is not requiring it, so additional costs may be incurred. A list of open cases with directives to destroy wells and remove wastes can be viewed on the public GeoTracker webpage at: http://geotracker.waterboards.ca.gov/ptcp_destruction_report.asp.

Note: The State Water Board has the authority to administratively impose civil penalties of up to \$10,000 per day per UST on responsible parties and site owners that fail to comply with the requirements of UST case closure order. **Do not let penalties be imposed on you!**

The contractor that helped you with corrective actions at your site can provide more information about the well destruction and waste removal process. If you do not currently have a contractor, you can contact the regulatory agency that is responsible for oversight of your UST case and ask if they have a list of contractors in the area. Your regulatory agency can also let you know if your contractor is required to submit a work plan for approval before well destruction and waste removal begins. Once the work is complete, submit confirmation documentation to the regulatory agency overseeing your UST case. After the well and waste

Important: Check the current standing of any contractor with the California Contractors State License Board. You can do this at the following location on the web: <https://www2.cslb.ca.gov/OnlineServices/CheckLicense.aspx>



removal has been completed, approved by your regulatory agency, and communicated to the State Water Board, a UCL will be issued and uploaded to GeoTracker.

If you have an eligible claim with the UST Cleanup Fund, the cost of well destruction is considered corrective action and reasonable and necessary costs are typically reimbursable. Monitoring of wells after you have been informed that the wells should be destroyed is not normally considered to be corrective action and may not be eligible for reimbursement. Additional information can be obtained on the State Water Board UST Cleanup Fund (Fund) website at: http://www.waterboards.ca.gov/water_issues/programs/ustcf/. You may also contact the Fund staff by email: ustcleanupfund@waterboards.ca.gov, message phone line: 1-800-813-Fund (3863), or fax: 916-341-5806.

Information for Consultants/Contractors/Drillers: A list of open cases with directives to destroy wells can be viewed on the public GeoTracker webpage at: http://geotracker.waterboards.ca.gov/ptcp_destruction_report.asp. Seek approval with regulatory agencies having jurisdiction before performing any well destruction work. Encroachment permits and/or access agreements may also be necessary. A list of local well-permitting agencies can be found at: <http://water.ca.gov/groundwater/wells/permitting.cfm>

Reference: *Plan for Implementation of Low-Threat UST Case Closure Policy and Additional Program Improvements*
(http://www.waterboards.ca.gov/board_decisions/adopted_orders/resolutions/2012/110612_6_final_ltcp%20imp%20plan.pdf).

(This fact sheet was last updated May 21, 2015.)

Appendix B.

Well Destruction Permits

Alameda County Public Works Agency - Water Resources Well Permit

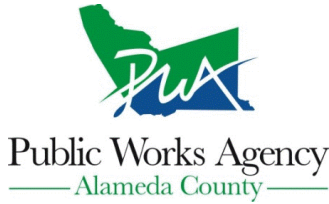

399 Elmhurst Street
Hayward, CA 94544-1395
Telephone: (510)670-6633 Fax:(510)782-1939

Application Approved on: 07/15/2016 By jamesy

Permit Numbers: W2016-0504 to W2016-0512
Permits Valid from 07/25/2016 to 07/26/2016

Application Id: 1466543643749
Site Location: 1601 Webster Street
Project Start Date: 07/25/2016
Assigned Inspector: Contact Minh Ngo at (510) 670-5759 or Minh@acpwa.org

City of Project Site:Alameda

Completion Date:07/26/2016

Applicant: AECOM - Sara Heikkila
915 Wilshire Blvd., Ste. 700, Los Angeles, CA 90017
Property Owner: Hung Trinh
1601 Webster Street, Alameda, CA 94501
Client: Equilon Enterprises LLC
20945 South Wilmington Ave, Carson, CA 90810
Contact: Sara Heikkila

Phone: 310-569-0209
Phone: 510-523-0191
Phone: 323-291-9595
Phone: 310-569-0209
Cell: --

Total Due: \$3573.00
Receipt Number: WR2016-0353 Total Amount Paid: \$3573.00
Payer Name : AECOM Technology Corporation Paid By: CHECK **PAID IN FULL**

Works Requesting Permits:

Well Destruction-Monitoring - 9 Wells
Driller: PeneCore Drilling - Lic #: 906899 - Method: press

Work Total: \$3573.00

Specifications

Permit #	Issued Date	Expire Date	Owner Well Id	Hole Diam.	Casing Diam.	Seal Depth	Max. Depth	State Well #	Orig. Permit #	DWR #
W2016-0504	07/15/2016	10/23/2016	S-2	10.00 in.	4.00 in.	1.50 ft	12.00 ft	No Records	W2005-0853	No Records
W2016-0505	07/15/2016	10/23/2016	S-3	10.00 in.	4.00 in.	1.50 ft	12.00 ft	No Records	W2005-0854	No Records
W2016-0506	07/15/2016	10/23/2016	S-4	10.00 in.	4.00 in.	1.50 ft	12.00 ft	No Records	W2005-0855	No Records
W2016-0507	07/15/2016	10/23/2016	S-4B	10.00 in.	4.00 in.	12.00 ft	20.00 ft	No Records	W2006-0582	No Records
W2016-0508	07/15/2016	10/23/2016	S-5	10.00 in.	4.00 in.	1.50 ft	12.00 ft	No Records	W2005-0856	No Records
W2016-0509	07/15/2016	10/23/2016	S-6	10.00 in.	4.00 in.	1.50 ft	12.00 ft	No Records	W2005-0857	No Records
W2016-0510	07/15/2016	10/23/2016	S-7	10.00 in.	4.00 in.	1.50 ft	12.00 ft	No Records	W2005-0858	No Records
W2016-0511	07/15/2016	10/23/2016	S-8	10.00 in.	4.00 in.	1.00 ft	12.00 ft	No Records	W2006-0583	No Records
W2016-0512	07/15/2016	10/23/2016	S-9	10.00 in.	4.00 in.	1.00 ft	12.00 ft	No Records	W2006-0584	No Records

Specific Work Permit Conditions

1. Drilling Permit(s) can be voided/ cancelled only in writing. It is the applicant's responsibility to notify Alameda County Public Works Agency, Water Resources Section in writing for an extension or to cancel the drilling permit application. No drilling permit application(s) shall be extended beyond ninety (90) days from the original start date. Applicants may not cancel a drilling permit application after the completion date of the permit issued has passed.
2. Prior to any drilling activities, it shall be the applicant's responsibility to contact and coordinate an Underground

Alameda County Public Works Agency - Water Resources Well Permit

Service Alert (USA), obtain encroachment permit(s), excavation permit(s) or any other permits or agreements required for that Federal, State, County or City, and follow all City or County Ordinances. No work shall begin until all the permits and requirements have been approved or obtained. It shall also be the applicants responsibilities to provide to the Cities or to Alameda County an Traffic Safety Plan for any lane closures or detours planned. No work shall begin until all the permits and requirements have been approved or obtained.

3. Compliance with the well-sealing specifications shall not exempt the well-sealing contractor from complying with appropriate State reporting-requirements related to well construction or destruction (Sections 13750 through 13755 (Division 7, Chapter 10, Article 3) of the California Water Code). Contractor must complete State DWR Form 188 and mail original to the Alameda County Public Works Agency, Water Resources Section, within 60 days. Include permit number and site map.
4. Permittee shall assume entire responsibility for all activities and uses under this permit and shall indemnify, defend and save the Alameda County Public Works Agency, its officers, agents, and employees free and harmless from any and all expense, cost and liability in connection with or resulting from the exercise of this Permit including, but not limited to, property damage, personal injury and wrongful death.
5. Applicant shall contact assigned inspector listed on the top of the permit at least five (5) working days prior to starting, once the permit has been approved. Confirm the scheduled date(s) at least 24 hours prior to drilling.
6. Permittee, permittee's contractors, consultants or agents shall be responsible to assure that all material or waters generated during drilling, boring destruction, and/or other activities associated with this Permit will be safely handled, properly managed, and disposed of according to all applicable federal, state, and local statutes regulating such. In no case shall these materials and/or waters be allowed to enter, or potentially enter, on or off-site storm sewers, dry wells, or waterways or be allowed to move off the property where work is being completed.
7. Remove the Christy box or similar structure.

Destroy well by grouting neat cement with a tremie pipe or pressure grouting (25 psi for 5min.) to the bottom of the well and by filling with neat cement to three (3-5) feet below surface grade. Allow the sealing material to spill over the top of the casing to fill any annular space between casing and soil.

After the seal has set, backfill the remaining hole with concrete or compacted material to match existing conditions.

8. Copy of approved drilling permit must be on site at all times. Failure to present or show proof of the approved permit application on site shall result in a fine of \$500.00.
 9. Electronic Reporting Regulations (Chapter 30, Division 3 of Title 23 & Division 3 of Title 27, CCR) require electronic submission of any report or data required by a regulatory agency from a cleanup site. Submission dates are set by a Regional Water Board or by a regulatory agency. Once a report/data is successfully uploaded, as required, you have met the reporting requirement (i.e. the compliance measure for electronic submittals is the actual upload itself). The upload date should be on or prior to the regulatory due date.
-

Appendix C.

Non-Hazardous Waste Data Forms

NO. 727517

10

NON-HAZARDOUS WASTE DATA FORM

BESI # 270756

GENERATOR

Generator's Name and Mailing Address: SHELL OIL PRODUCTS US, C/O AECOM, 1333 BROADWAY, SUITE 800, OAKLAND, CA 94512

Generator's Site Address (if different than mailing address): SHELL OIL 10007774, 1601 WEBSTER ST, ALAMEDA, CA 94501

Generator's Phone: 510-874-3255

Container type removed from site: Drums Vacuum Truck Roll-off Truck Dump Truck Other _____

Container type transported to receiving facility: Drums Vacuum Truck Roll-off Truck Dump Truck Other _____

Quantity: 001 Volume: 020 gal

WASTE DESCRIPTION: NON-HAZARDOUS WASTE LIQUIDS GENERATING PROCESS: DECON WATER

COMPONENTS OF WASTE	PPM	%	COMPONENTS OF WASTE	PPM	%
1. WATER		95-100%	3. SOLIDS		0-5%
2. TPH		< 1%	4.		

Waste Profile: _____ PROPERTIES: pH 4-10 SOLID LIQUID SLUDGE SLURRY OTHER _____

HANDLING INSTRUCTIONS: WEAR ALL APPROPRIATE PERSONAL PROTECTIVE CLOTHING.

Generator Printed/Typed Name: Larry Moothart, employed by BESI as a sub. to AECOM, on behalf of Shell OPUS

Signature: *[Signature]* Month Day Year: 8 | 16 | 16

The Generator certifies that the waste as described is 100% non-hazardous

TRANSPORTER

Transporter 1 Company Name: BELSHIRE Phone#: 949-460-5200

Transporter 1 Printed/Typed Name: Frank Torres Signature: *[Signature]* Month Day Year: 8 | 16 | 16

Transporter Acknowledgment of Receipt of Materials

Transporter 2 Company Name: NIETO & SONS TRUCKING, INC. Phone#: 714-990-8355

Transporter 2 Printed/Typed Name: Miguel Garcia Signature: *[Signature]* Month Day Year: 9 | 2 | 16

Transporter Acknowledgment of Receipt of Materials

RECEIVING FACILITY

Designated Facility Name and Site Address: DEMENNO KERDOON, 2000 N. ALAMEDA ST., COMPTON, CA 90222 Phone#: 310-537-7100

RWR: 8744

Printed/Typed Name: JOSE RAMOS Signature: *[Signature]* Month Day Year: 09 | 02 | 16

Designated Facility Owner or Operator: Certification of receipt of materials covered by this data form.

1000 7774
1403130

NO. 727516

NON-HAZARDOUS WASTE DATA FORM

BESI # 270756

Generator's Name and Mailing Address: SHELL OIL PRODUCTS US, C/O AECOM, 1333 BROADWAY, SUITE 800, OAKLAND, CA 94612. Generator's Site Address (if different than mailing address): SHELL OIL 10007774, 1801 WEBSTER ST, ALAMEDA, CA 94501.

Generator's Phone: 510-874-3255. Container type removed from site: [X] Drums, [] Vacuum Truck, [] Roll-off Truck, [] Dump Truck. Container type transported to receiving facility: [X] Drums, [] Vacuum Truck, [] Roll-off Truck, [] Dump Truck.

Quantity: 003. Quantity: 3, Volume: 1050 LBS.

Table with 2 main columns: WASTE DESCRIPTION and GENERATING PROCESS. Includes rows for Soil and Debris, and a section for Waste Profile and HANDLING INSTRUCTIONS.

Generator Printed/Typed Name: Larry Moothart, employed by BESI as a sub. to AECOM, on behalf of Shell OPUS. Signature: [Signature]. Month Day Year: 8/16/16.

Transporter 1 Company Name: BELSHIRE. Phone#: 949-460-5200.

Transporter 1 Printed/Typed Name: Frank Torres. Signature: [Signature]. Month Day Year: 8/16/16.

Transporter 2 Company Name: [Blank]. Phone#: [Blank].

Transporter 2 Printed/Typed Name: [Blank]. Signature: [Blank]. Month Day Year: [Blank].

Designated Facility Name and Site Address: U.S. ECOLOGY, NEVADA OPERATIONS, HIGHWAY 95, 11 MILES S. OF BEATTY, BEATTY, NV 89003. Phone#: 775-553-2203.

Printed/Typed Name: Robert [Signature]. Signature: [Signature]. RWR: 8743. Month Day Year: 8/24/16.

Designated Facility Owner or Operator: Certification of receipt of materials covered by this data form.

10007774
140 2316