

NO 2745



**Shell Oil Products US**

October 21, 2004

Mr. Robert Weston  
Alameda County Health Care Services Agency  
1131 Harbor Bay Parkway, Suite 250  
Alameda, California 94502-6577

**Subject: Shell-branded Service Station**  
1601 Webster Street  
Alameda, California

Alameda County Health Care Services Agency  
OCT 23 2004  
Environmental Health Services

Dear Mr. Weston:

Attached for your review and comment is a copy of the *Dispenser and Piping Upgrade Sampling Report* for the above referenced site. Upon information and belief, I declare, under penalty of perjury, that the information contained in the attached document is true and correct.

As always, please feel free to contact me directly at (559) 645-9306 with any questions or concerns.

Sincerely,

**Shell Oil Products US**

A handwritten signature in cursive script that reads "Karen Petryna".

Karen Petryna  
Sr. Environmental Engineer

October 21, 2004

Mr. Robert Weston  
Alameda County Health Care Services Agency  
Department of Environmental Health  
1131 Harbor Bay Parkway  
Alameda, California 94502

Re: **Dispenser and Piping Upgrade Sampling Report**  
Shell-branded Service Station  
1601 Webster Street  
Alameda, California  
SAP # 135032  
Cambria Project #206-0467-002



Dear Mr. Weston:

Cambria Environmental Technology, Inc. has prepared this report on behalf of Equilon Enterprises LLC dba Shell Oil Products US (Shell) to document field activities performed during dispenser and piping upgrades at the referenced site. Cambria performed inspections and soil sampling associated with the site upgrade activities. In addition, as a result of damage to one underground storage tank (UST) discovered on August 19, 2004, Cambria and other Shell contractors also conducted emergency response and remediation, including product recovery and groundwater extraction. The fuel release and subsequent activities will be reported under separate cover. Presented below are a description of the site conditions, sampling activities, analytical results, and conclusions.

## **SITE CONDITIONS AND BACKGROUND**

The subject property is an operating Shell-branded service station located on the northeast side of the Webster Street and Lincoln Avenue intersection in Alameda, California (Figure 1). The station layout includes three USTs, three dispenser islands, a service garage, and a kiosk (Figure 2). Mixed commercial and residential properties surround the site.

The site was previously an open environmental case under Alameda County Health Care Services Agency (ACHCSA) oversight. Case closure was granted on March 15, 1999.

**Cambria  
Environmental  
Technology, Inc.**

5900 Hollis Street  
Suite A  
Emeryville, CA 94608  
Tel (510) 420-0700  
Fax (510) 420-9170

**SAMPLING ACTIVITIES AND SAMPLE ANALYSIS**

<i>Personnel Present</i>	<i>Date</i>	<i>Title</i>	<i>Company</i>
Stu Dalie	8/10/04	Staff Scientist	Cambria
Scott Seery	8/10/04	Inspector	ACHCSA



**Dispenser Samples:** During August 2004, S. J. Weaver Construction, Inc. removed the dispensers and fuel piping at the site. On August 10, 2004, Cambria staff collected seven samples (D-1-2', D-2-2' and P-1-3' through P-5-3') in native soil beneath two former dispensers at a depth of approximately 2 feet below grade (fbg) and beneath the product piping at a depth of approximately 3 fbg. Dispenser island D-3 is located over fill material over the USTs, and a soil sample was not collected at that location. Product piping samples were collected at 20-foot intervals and at piping elbows at the locations shown on Figure 2. Cambria collected samples at locations as directed by Scott Seery of ACHCSA. Soil samples were retained in brass sample tubes, leaving no headspace, and covered on both ends with Teflon sheets and plastic end caps. The samples were labeled, placed into a cooler with ice, entered onto a chain-of-custody record, and transported to a California-certified analytical laboratory for analysis. Cambria's Standard Piping and Dispenser Removal Sampling Procedures is included as Attachment A.

**Sample Analyses:** Severn Trent Laboratory of Pleasanton, California analyzed all soil samples collected from beneath the dispensers and product piping. The soil samples were analyzed for total petroleum hydrocarbons as gasoline (TPHg), benzene, toluene, ethyl benzene, and xylenes (BTEX), and methyl tertiary butyl ether (MTBE) by EPA Method 8260.

**Soil Disposal:** Residual soils generated during upgrade activities were stockpiled, covered in visquine and profiled for disposal. To characterize stockpiled soil for disposal, one four-point composite sample was collected and analyzed for TPHg and BTEX by EPA Method 8260 and for total lead by EPA Method 6010B. Attachment B presents the disposal analytical results. Manley and Sons Trucking, Inc. transported 65.93 tons of soil to Allied Waste Industries' Forward Landfill in Manteca, California as a non-hazardous waste, upon receiving the profile approval from the landfill. A soil disposal confirmation report is included as Attachment D.

**SOIL ANALYTICAL RESULTS**

No benzene, toluene, ethyl benzene or MTBE was detected in any of the soil samples collected. Sample P-3-3', contained detectable concentrations of TPHg at 1,300 parts per million (ppm) and xylenes at 49 ppm. Sample P-5-3' contained 0.045 ppm xylenes. No other soil samples contained detectable hydrocarbon concentrations. Table 1 summarizes soil sample results, and Attachment B presents the certified analytical report.

**CONCLUSIONS**

No benzene or MTBE was detected in any soil samples collected during these activities. TPHg was detected in one soil sample and xylenes were detected in two soil samples from beneath fuel piping. The soil analytical results indicate that the highest residual hydrocarbon concentrations are located near the northwest corner of the kiosk building at sample location P-3-3'.

Due to the reported presence of TPHg and xylenes in soil, Shell filed an August 11, 2004 Unauthorized Release Report Form with ACHCSA. A copy is included as Attachment C.

As a result of damage to one UST, Shell's contractors conducted emergency response and remediation beginning on August 19, 2004. S.J. Weaver identified a product loss in one 10,000-gallon UST after installing the turbine pump into the UST on the previous day. On August 19, 2004, the remaining fuel in the damaged UST was removed by a tanker truck, and groundwater pumping from one of the tank backfill wells was started. A report documenting the product loss, emergency response activities, and emergency remediation efforts will be submitted under separate cover. As a result of the product loss, Shell filed an August 19, 2004 Unauthorized Release Report Form with ACHCSA. ACHCSA subsequently opened a new environmental case on September 3, 2004.

**CLOSING**

We appreciate the opportunity to work with you on this project. Please call Matt Derby at (510) 420-3332 if you have any questions or need additional information.

Sincerely,  
**Cambria Environmental Technology, Inc.**



Stewart A. Dalie IV  
Staff Scientist

Matthew W. Derby, P.E.  
Senior Project Engineer

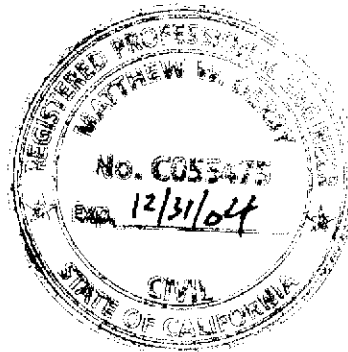

Figures:        1 - Site Vicinity/Well Survey Map  
                  2 - Soil Sample Location Map

Table:            1 - Soil Analytical Results

Attachments:    A - Cambria's Standard Piping and Dispenser Removal Sampling Procedures  
                      B - Certified Analytical Laboratory Reports  
                      C - August 11, 2004 Unauthorized Release Report Form  
                      D - Soil Disposal Confirmation Report

cc:            Barney Chan, Alameda County Health Care Services Agency, 1131 Harbor Bay  
                  Parkway, Suite 250 Alameda, California 94502-6577  
                  Mr. Bill Merchant, Shell Oil Products US, 9141 E. Stockton Boulevard, Suite 250-321,  
                  Elk Grove, California 95624  
                  Karen Petryna, Shell Oil Products US, 20945 S. Wilmington Ave., Carson, CA 90810

G:\Alameda 1601 Webster\2004 Upgrades\Dispenser upgrade Rpt July04.doc

- EXPLANATION**
- ⊗ Abandoned well
  - ⊕ Agricultural/Irrigation well
  - Catholic Protection well
  - Domestic well
  - ⦿ Geotechnical well
  - Industrial well
  - ⊕ Municipal well
  - e Unknown well
  - ★ Subject Site (Approx Loc)
  - Study Area

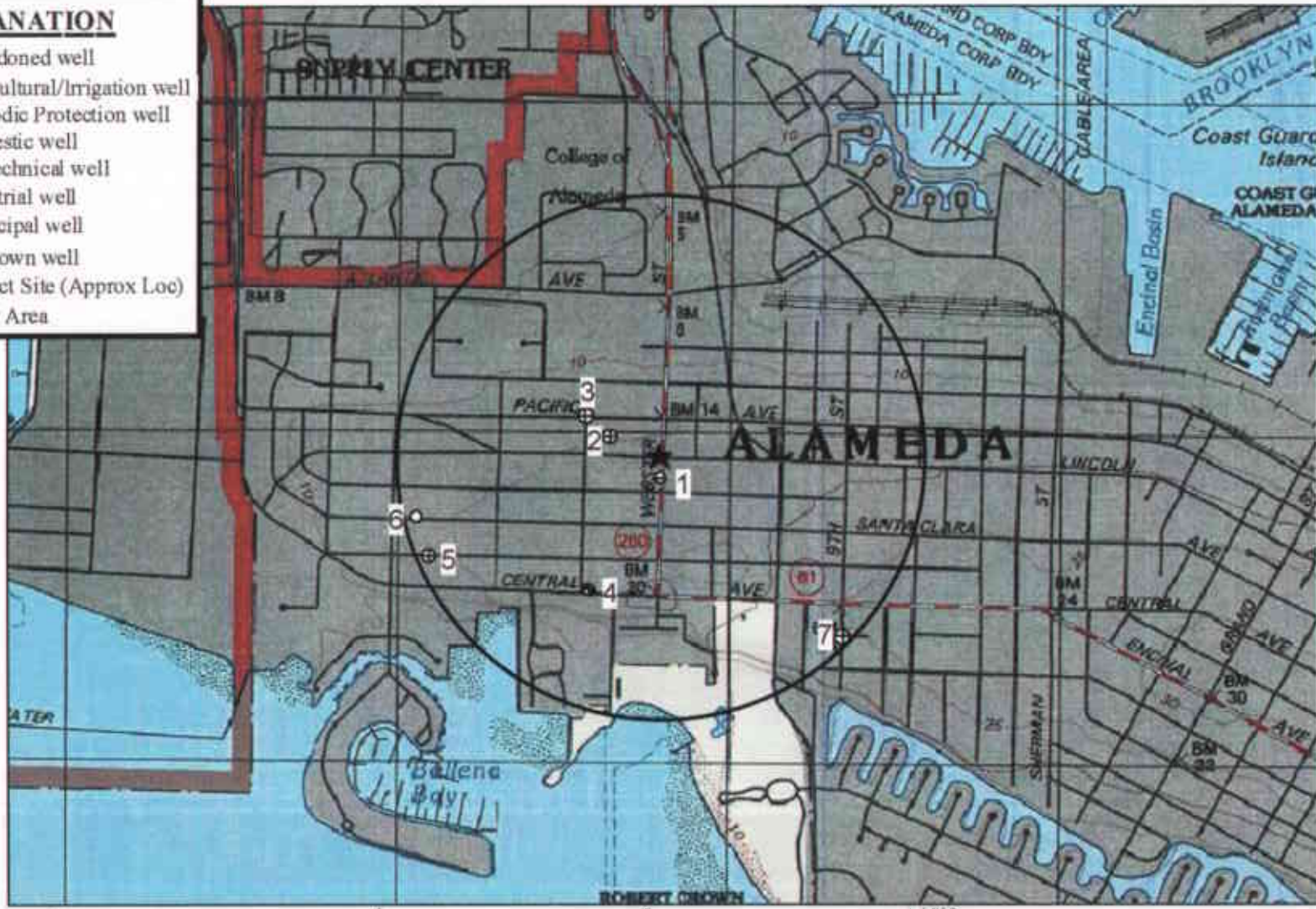

TN/MN  
15°

0 1000 FEET 0 500 1000 METERS 1 MILE  
Printed from TOPOI ©2000 Wildflower Productions (www.topo.com)

FIGURE  
**1**

Shell-branded Service Station  
1801 Webster Street  
Alameda, California



CAMBRIA

Site Vicinity/Well Survey Map

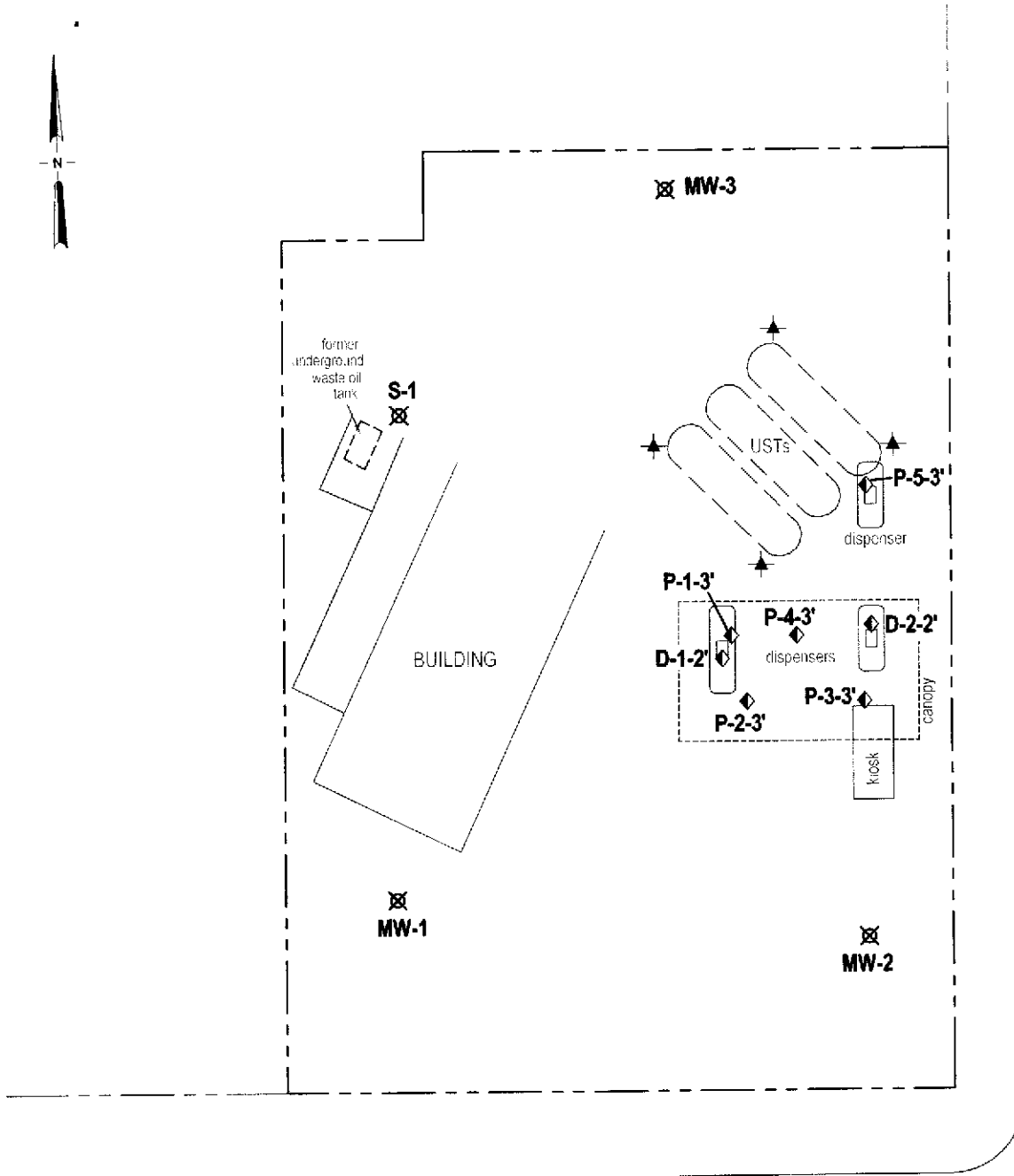
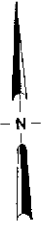

1601 WEBSTER STREET

DATE: 10/15/04

G:\ALAMEDA 1601 WEBSTER\FIGURES\SITE PLAN 10-04.DWG

<b>EXPLANATION</b>	
D-1-2' ◊	Soil sample location (8/10/04)
MW-1 X	Destroyed monitoring well location
★	Tank backfill well location



FIGURE 2

**Shell-branded Service Station**  
 1601 Webster Street  
 Oakland, California  
 Incident #97564701



C A M B R I A

**Soil Sample Location Map**

# CAMBRIA

**Table 1. Soil Analytical Results - Shell-branded Service Station, 1601 Webster Avenue, Alameda, CA, SAP #135032**

Sample	Depth (fbg)	Date Sampled	TPHg (mg/kg)	Benzene (mg/kg)	Toluene (mg/kg)	Ethylbenzene (mg/kg)	Xylenes (mg/kg)	MTBE (mg/kg)
P-1-3'	3.0	8/10/2004	<1.0	<0.0050	<0.0050	<0.0050	<0.0050	<0.0050
P-2-3'	3.0	8/10/2004	<1.0	<0.0050	<0.0050	<0.0050	<0.0050	<0.0050
P-3-3'	3.0	8/10/2004	<b>1,300</b>	<0.50	<0.50	<0.50	<b>49</b>	<0.50
P-4-3'	3.0	8/10/2004	<1.0	<0.0050	<0.0050	<0.0050	<0.0050	<0.0050
P-5-3'	3.0	8/10/2004	<1.0	<0.0050	<0.0050	<0.0050	<b>0.045</b>	<0.0050
D-1-2'	2.0	8/10/2004	<1.0	<0.0050	<0.0050	<0.0050	<0.0050	<0.0050
D-2-2'	2.0	8/10/2004	<1.0	<0.0050	<0.0050	<0.0050	<0.0050	<0.0050

Abbreviations and Notes:

fbg = Feet below grade

mg/kg = milligrams per kilogram (parts per million)

<x = Not detected at detection limit x

TPHg = Total petroleum hydrocarbons as gasoline analyzed by EPA Method 88260b

Benzene, toluene, ethylbenzene, and xylenes analyzed by EPA Method 8260B

MTBE = Methyl tertiary butyl ether analyzed by EPA Method 8260B



**ATTACHMENT A**

**Standard Piping and Dispenser Removal Sampling Procedures**

# CAMBRIA

## **STANDARD PIPING AND DISPENSER REMOVAL SAMPLING PROCEDURES**

Cambria Environmental Technology, Inc. (Cambria) has developed standard operating procedures for collecting soil samples during petroleum dispenser and piping removal. These procedures ensure that the samples are collected, handled, and documented in compliance with California Administration Code Title 23: Waters; Chapter 3: Water Resources Control Board; Subchapter 16: Underground Storage Tank Regulations (Title 23). Cambria's sampling procedures are based on guidelines contained in the California State Regional Water Quality Control Board Tri-Regional Staff Recommendations for Preliminary Evaluation and Investigation of Underground Tank Sites dated August 10, 1990.

### **Piping and Dispenser Removal Sampling**

The objective of sample collection during routine dispenser and piping removals is to determine whether hydrocarbons or other stored chemicals have leaked to the subsurface. We collect one soil sample from the native soil beneath each dispenser unit, at each piping elbow, and at every 20 ft of product piping, as applicable.

The soil samples are collected in steam cleaned brass or steel tubes from either a driven split-spoon type sampler or the bucket of a backhoe. When a backhoe is used, approximately three inches of soil are scraped from the surface and the tube is driven into the exposed soil.

Upon removal from the split-spoon sampler or the backhoe, the samples are trimmed flush, capped with Teflon sheets and plastic end caps, labeled, logged and refrigerated for delivery under chain of custody to a State certified analytic laboratory.

**ATTACHMENT B**

**Certified Analytical Laboratory Reports**

**Cambria Environmental Emeryville**

August 11, 2004

5900 Hollis Street, Ste. A

Emeryville, CA 94608

Attn.: Stu Dalie

Project#: 206-0467-003

Site: 1601 Webster Ave., Alameda, CA

Dear Mr. Dalie:

Attached is our report for your samples received on 08/10/2004 14:25

This report has been reviewed and approved for release. Reproduction of this report is permitted only in its entirety.

Please note that any unused portion of the samples will be discarded after 09/24/2004 unless you have requested otherwise.

We appreciate the opportunity to be of service to you. If you have any questions,

You can also contact me via email. My email address is: [mbrewer@stl-inc.com](mailto:mbrewer@stl-inc.com)

Sincerely,



Melissa Brewer  
Project Manager

Severn Trent Laboratories, Inc.

STL San Francisco \* 1220 Quarry Lane, Pleasanton, CA 94566

Tel 925 484 1919 Fax 925 484 1096 \* [www.stl-inc.com](http://www.stl-inc.com) \* CA DHS ELAP# 2496

**Gas/BTEXFuel Oxygenates by 8260B (High Level)**

Cambria Environmental Emeryville

Attn.: Stu Dalie

5900 Hollis Street, Ste. A

Emeryville, CA 94608

Phone: (510) 420-3339 Fax: (510) 420-9170

Project: 206-0467-003

Received: 08/10/2004 14:25

Site: 1601 Webster Ave., Alameda, CA

**Samples Reported**

Sample Name	Date Sampled	Matrix	Lab #
P-3-3	08/10/2004 09:50	Soil	4

Severn Trent Laboratories, Inc.

STL San Francisco \* 1220 Quarry Lane, Pleasanton, CA 94566

Tel 925 484 1919 Fax 925 484 1096 \* www.stl-inc.com \* CA DHS ELAP# 2496

08/11/2004 14:43

**Gas/BTEXFuel Oxygenates by 8260B (High Level)**

Cambria Environmental Emeryville

Attn.: Stu Dalie

5900 Hollis Street, Ste. A

Emeryville, CA 94608

Phone: (510) 420-3339 Fax: (510) 420-9170

Project: 206-0467-003

Received: 08/10/2004 14:25

Site: 1601 Webster Ave., Alameda, CA

Prep(s):	5030B	Test(s):	8260B
Sample ID:	P-3-3	Lab ID:	2004-08-0250 - 4
Sampled:	08/10/2004 09:50	Extracted:	8/11/2004 11:29
Matrix:	Soil	QC Batch#:	2004/08/11-3A.62

Compound	Conc.	RL	Unit	Dilution	Analyzed	Flag
Gasoline	1300	50	mg/Kg	1.00	08/11/2004 11:29	
Benzene	ND	0.50	mg/Kg	1.00	08/11/2004 11:29	
Toluene	ND	0.50	mg/Kg	1.00	08/11/2004 11:29	
Ethyl benzene	ND	0.50	mg/Kg	1.00	08/11/2004 11:29	
Total xylenes	49	0.50	mg/Kg	1.00	08/11/2004 11:29	
Methyl tert-butyl ether (MTBE)	ND	0.50	mg/Kg	1.00	08/11/2004 11:29	
<b>Surrogate(s)</b>						
1,2-Dichloroethane-d4	85.4	53-129	%	1.00	08/11/2004 11:29	
Toluene-d8	87.6	47-136	%	1.00	08/11/2004 11:29	

**Gas/BTEXFuel Oxygenates by 8260B (High Level)**

Cambria Environmental Emeryville

Attn.: Stu Dalie

5900 Hollis Street, Ste. A  
Emeryville, CA 94608  
Phone: (510) 420-3339 Fax: (510) 420-9170

Project: 206-0467-003

Received: 08/10/2004 14:25

Site: 1601 Webster Ave., Alameda, CA

Batch QC Report					
Prep(s): 5030B				Test(s): 8260B	
Method Blank		Soil		QC Batch # 2004/08/11-3A.62	
MB: 2004/08/11-3A.62-033				Date Extracted: 08/11/2004 13:33	

Compound	Conc.	RL	Unit	Analyzed	Flag
Gasoline	ND	50	mg/Kg	08/11/2004 13:33	
Benzene	ND	0.50	mg/Kg	08/11/2004 13:33	
Toluene	ND	0.50	mg/Kg	08/11/2004 13:33	
Ethyl benzene	ND	0.50	mg/Kg	08/11/2004 13:33	
Total xylenes	ND	0.50	mg/Kg	08/11/2004 13:33	
Methyl tert-butyl ether (MTBE)	ND	0.50	mg/Kg	08/11/2004 13:33	
<b>Surrogates(s)</b>					
1,2-Dichloroethane-d4	98.8	53-129	%	08/11/2004 13:33	
Toluene-d8	95.2	47-136	%	08/11/2004 13:33	

**Gas/BTEXFuel Oxygenates by 8260B (High Level)**

Cambria Environmental Emeryville

Attn.: Stu Dalie

5900 Hollis Street, Ste. A  
Emeryville, CA 94608  
Phone: (510) 420-3339 Fax: (510) 420-9170

Project: 206-0467-003

Received: 08/10/2004 14:25

Site: 1601 Webster Ave., Alameda, CA

Batch QC Report										
Prep(s): 5030B					Test(s): 8260B					
Laboratory Control Spike			Soil		QC Batch # 2004/08/11-3A.62					
LCS	2004/08/11-3A.62-006		Extracted: 08/11/2004		Analyzed: 08/11/2004 11:06					
LCSD	2004/08/11-3A.62-044		Extracted: 08/11/2004		Analyzed: 08/11/2004 10:44					
Compound	Conc. mg/Kg		Exp. Conc.	Recovery %		RPD	Ctrl.Limits %		Flags	
	LCS	LCSD		LCS	LCSD		%	Rec.	RPD	LCS
Benzene	9.29	9.02	10	92.9	90.2	2.9	69-129	20		
Toluene	9.89	10.0	10	98.9	100.0	1.1	70-130	20		
Methyl tert-butyl ether (MTBE)	6.92	7.82	10	69.2	78.2	12.2	65-165	20		
<b>Surrogates(s)</b>										
1,2-Dichloroethane-d4	230	219	250	92.0	87.6		53-129			
Toluene-d8	234	250	250	93.6	100.0		47-136			

Severn Trent Laboratories, Inc.

STL San Francisco \* 1220 Quarry Lane, Pleasanton, CA 94566

Tel 925 484 1919 Fax 925 484 1096 \* www.stl-inc.com \* CA DHS ELAP# 2496

08/11/2004 14:43



**Gas/BTEX/MTBE by 8260B (C6-C12)**

Cambria Environmental Emeryville

Attn.: Stu Dalie

5900 Hollis Street, Ste. A

Emeryville, CA 94608

Phone: (510) 420-3339 Fax: (510) 420-9170

Project: 206-0467-003

Received: 08/10/2004 14:25

Site: 1601 Webster Ave., Alameda, CA

**Samples Reported**

Sample Name	Date Sampled	Matrix	Lab #
D-1-2'	08/10/2004 09:30	Soil	1
P-1-3'	08/10/2004 09:40	Soil	2
P-2-3'	08/10/2004 09:45	Soil	3
P-4-3'	08/10/2004 09:55	Soil	5
D-2-2'	08/10/2004 10:00	Soil	6
P-5-3'	08/10/2004 10:10	Soil	7

Severn Trent Laboratories, Inc.

STL San Francisco \* 1220 Quarry Lane, Pleasanton, CA 94566

Tel 925 484 1919 Fax 925 484 1096 \* www.stl-inc.com \* CA DHS ELAP# 2496

08/11/2004 16:34

**Gas/BTEX/MTBE by 8260B (C6-C12)**

Cambria Environmental Emeryville

Attn.: Stu Dalie

5900 Hollis Street, Ste. A

Emeryville, CA 94608

Phone: (510) 420-3339 Fax: (510) 420-9170

Project: 206-0467-003

Received: 08/10/2004 14:25

Site: 1601 Webster Ave., Alameda, CA

Prep(s):	5030B	Test(s):	8260B
Sample ID:	D-1-2	Lab ID:	2004-08-0250-1
Sampled:	08/10/2004 09:30	Extracted:	8/11/2004 08:44
Matrix:	Soil	QC Batch#:	2004/08/11-1B.69

Compound	Conc.	RL	Unit	Dilution	Analyzed	Flag
Gasoline	ND	1.0	mg/Kg	1.00	08/11/2004 08:44	
Benzene	ND	0.0050	mg/Kg	1.00	08/11/2004 08:44	
Toluene	ND	0.0050	mg/Kg	1.00	08/11/2004 08:44	
Ethyl benzene	ND	0.0050	mg/Kg	1.00	08/11/2004 08:44	
Total xylenes	ND	0.0050	mg/Kg	1.00	08/11/2004 08:44	
Methyl tert-butyl ether (MTBE)	ND	0.0050	mg/Kg	1.00	08/11/2004 08:44	
<b>Surrogate(s)</b>						
1,2-Dichloroethane-d4	89.3	76-124	%	1.00	08/11/2004 08:44	
Toluene-d8	110.0	75-116	%	1.00	08/11/2004 08:44	

Severn Trent Laboratories, Inc.

STL San Francisco \* 1220 Quarry Lane, Pleasanton, CA 94566

Tel 925 484 1919 Fax 925 484 1096 \* www.stl-inc.com \* CA DHS ELAP# 2496

08/11/2004 16:34

**Gas/BTEX/MTBE by 8260B (C6-C12)**

Cambria Environmental Emeryville

Attn.: Stu Dalie

5900 Hollis Street, Ste. A

Emeryville, CA 94608

Phone: (510) 420-3339 Fax: (510) 420-9170

Project: 206-0467-003

Received: 08/10/2004 14:25

Site: 1601 Webster Ave., Alameda, CA

Prep(s):	5030B	Test(s):	8260B
Sample ID:	P-1-3	Lab ID:	2004-08-0250-2
Sampled:	08/10/2004 09:40	Extracted:	8/11/2004 09:02
Matrix:	Soil	QC Batch#:	2004/08/11-1B.69

Compound	Conc.	RL	Unit	Dilution	Analyzed	Flag
Gasoline	ND	1.0	mg/Kg	1.00	08/11/2004 09:02	
Benzene	ND	0.0050	mg/Kg	1.00	08/11/2004 09:02	
Toluene	ND	0.0050	mg/Kg	1.00	08/11/2004 09:02	
Ethyl benzene	ND	0.0050	mg/Kg	1.00	08/11/2004 09:02	
Total xylenes	ND	0.0050	mg/Kg	1.00	08/11/2004 09:02	
Methyl tert-butyl ether (MTBE)	ND	0.0050	mg/Kg	1.00	08/11/2004 09:02	
<b>Surrogate(s)</b>						
1,2-Dichloroethane-d4	95.9	76-124	%	1.00	08/11/2004 09:02	
Toluene-d8	104.4	75-116	%	1.00	08/11/2004 09:02	

Severn Trent Laboratories, Inc.

STL San Francisco \* 1220 Quarry Lane, Pleasanton, CA 94566

Tel 925 484 1919 Fax 925 484 1096 \* www.stl-inc.com \* CA DHS ELAP# 2496

08/11/2004 16:34

**Gas/BTEX/MTBE by 8260B (C6-C12)**

Cambria Environmental Emeryville

Attn.: Stu Dalie

5900 Hollis Street, Ste. A

Emeryville, CA 94608

Phone: (510) 420-3339 Fax: (510) 420-9170

Project: 206-0467-003

Received: 08/10/2004 14:25

Site: 1601 Webster Ave., Alameda, CA

Prep(s): 5030B	Test(s): 8260B
Sample ID: P-2-3	Lab ID: 2004-08-0250 - 3
Sampled: 08/10/2004 09:45	Extracted: 8/11/2004 09:20
Matrix: Soil	QC Batch#: 2004/08/11-1B.69

Compound	Conc.	RL	Unit	Dilution	Analyzed	Flag
Gasoline	ND	1.0	mg/Kg	1.00	08/11/2004 09:20	
Benzene	ND	0.0050	mg/Kg	1.00	08/11/2004 09:20	
Toluene	ND	0.0050	mg/Kg	1.00	08/11/2004 09:20	
Ethyl benzene	ND	0.0050	mg/Kg	1.00	08/11/2004 09:20	
Total xylenes	ND	0.0050	mg/Kg	1.00	08/11/2004 09:20	
Methyl tert-butyl ether (MTBE)	ND	0.0050	mg/Kg	1.00	08/11/2004 09:20	
<b>Surrogate(s)</b>						
1,2-Dichloroethane-d4	88.9	76-124	%	1.00	08/11/2004 09:20	
Toluene-d8	104.8	75-116	%	1.00	08/11/2004 09:20	

Severn Trent Laboratories, Inc.

STL San Francisco \* 1220 Quarry Lane, Pleasanton, CA 94566

Tel 925 484 1919 Fax 925 484 1096 \* www.stl-inc.com \* CA DHS ELAP# 2496

08/11/2004 16:34

**Gas/BTEX/MTBE by 8260B (C6-C12)**

Cambria Environmental Emeryville

Attn.: Stu Dalie

5900 Hollis Street, Ste. A

Emeryville, CA 94608

Phone: (510) 420-3339 Fax: (510) 420-9170

Project: 206-0467-003

Received: 08/10/2004 14:25

Site: 1601 Webster Ave., Alameda, CA

Prep(s):	5030B	Test(s):	8260B
Sample ID:	P-4-3	Lab ID:	2004-08-0250 - 5
Sampled:	08/10/2004 09:55	Extracted:	8/11/2004 14:02
Matrix:	Soil	QC Batch#:	2004/08/11-1B.69

Compound	Conc.	RL	Unit	Dilution	Analyzed	Flag
Gasoline	ND	1.0	mg/Kg	1.00	08/11/2004 14:02	
Benzene	ND	0.0050	mg/Kg	1.00	08/11/2004 14:02	
Toluene	ND	0.0050	mg/Kg	1.00	08/11/2004 14:02	
Ethyl benzene	ND	0.0050	mg/Kg	1.00	08/11/2004 14:02	
Total xylenes	ND	0.0050	mg/Kg	1.00	08/11/2004 14:02	
Methyl tert-butyl ether (MTBE)	ND	0.0050	mg/Kg	1.00	08/11/2004 14:02	
<b>Surrogate(s)</b>						
1,2-Dichloroethane-d4	86.9	76-124	%	1.00	08/11/2004 14:02	
Toluene-d8	45.6	75-116	%	1.00	08/11/2004 14:02	sl

**Gas/BTEX/MTBE by 8260B (C6-C12)**

Cambria Environmental Emeryville

Attn.: Stu Dalie

5900 Hollis Street, Ste. A  
Emeryville, CA 94608  
Phone: (510) 420-3339 Fax: (510) 420-9170

Project: 206-0467-003

Received: 08/10/2004 14:25

Site: 1601 Webster Ave., Alameda, CA

Prep(s):	5030B	Test(s):	8260B
Sample ID:	D-2-2	Lab ID:	2004-08-0250 - 6
Sampled:	08/10/2004 10:00	Extracted:	8/11/2004 14:21
Matrix:	Soil	QC Batch#:	2004/08/11-1B.69

Compound	Conc.	RL	Unit	Dilution	Analyzed	Flag
Gasoline	ND	1.0	mg/Kg	1.00	08/11/2004 14:21	
Benzene	ND	0.0050	mg/Kg	1.00	08/11/2004 14:21	
Toluene	ND	0.0050	mg/Kg	1.00	08/11/2004 14:21	
Ethyl benzene	ND	0.0050	mg/Kg	1.00	08/11/2004 14:21	
Total xylenes	ND	0.0050	mg/Kg	1.00	08/11/2004 14:21	
Methyl tert-butyl ether (MTBE)	ND	0.0050	mg/Kg	1.00	08/11/2004 14:21	
<b>Surrogate(s)</b>						
1,2-Dichloroethane-d4	90.7	76-124	%	1.00	08/11/2004 14:21	
Toluene-d8	86.7	75-116	%	1.00	08/11/2004 14:21	

Severn Trent Laboratories, Inc.

STL San Francisco \* 1220 Quarry Lane, Pleasanton, CA 94566

Tel 925 484 1919 Fax 925 484 1096 \* www.stl-inc.com \* CA DHS ELAP# 2496

08/11/2004 16:34

**Gas/BTEX/MTBE by 8260B (C6-C12)**

Cambria Environmental Emeryville

Attn.: Stu Dalie

5900 Hollis Street, Ste. A  
Emeryville, CA 94608  
Phone: (510) 420-3339 Fax: (510) 420-9170

Project: 206-0467-003

Received: 08/10/2004 14:25

Site: 1601 Webster Ave., Alameda, CA

Prep(s):	5030B	Test(s):	8260B
Sample ID:	P-5-3	Lab ID:	2004-08-0250 - 7
Sampled:	08/10/2004 10:10	Extracted:	8/11/2004 10:58
Matrix:	Soil	QC Batch#:	2004/08/11-1B.69

Compound	Conc.	RL	Unit	Dilution	Analyzed	Flag
Gasoline	ND	1.0	mg/Kg	1.00	08/11/2004 10:58	
Benzene	ND	0.0050	mg/Kg	1.00	08/11/2004 10:58	
Toluene	ND	0.0050	mg/Kg	1.00	08/11/2004 10:58	
Ethyl benzene	ND	0.0050	mg/Kg	1.00	08/11/2004 10:58	
Total xylenes	0.045	0.0050	mg/Kg	1.00	08/11/2004 10:58	
Methyl tert-butyl ether (MTBE)	ND	0.0050	mg/Kg	1.00	08/11/2004 10:58	
<b>Surrogate(s)</b>						
1,2-Dichloroethane-d4	93.1	76-124	%	1.00	08/11/2004 10:58	
Toluene-d8	83.6	75-116	%	1.00	08/11/2004 10:58	

**Gas/BTEX/MTBE by 8260B (C6-C12)**

Cambria Environmental Emeryville  
Attn.: Stu Dalie

5900 Hollis Street, Ste. A  
Emeryville, CA 94608  
Phone: (510) 420-3339 Fax: (510) 420-9170  
Project: 206-0467-003

Received: 08/10/2004 14:25

Site: 1601 Webster Ave., Alameda, CA

Batch QC Report					
Prep(s): 5030B		Test(s): 8260B			
Method Blank		Soil		QC Batch # 2004/08/11-1B.69	
MB: 2004/08/11-1B.69-034		Date Extracted: 08/11/2004 07:34			
Compound	Conc.	RL	Unit	Analyzed	Flag
Gasoline	ND	1.000	mg/Kg	08/11/2004 07:34	
Methyl tert-butyl ether (MTBE)	ND	0.0050	mg/Kg	08/11/2004 07:34	
Benzene	ND	0.0050	mg/Kg	08/11/2004 07:34	
Toluene	ND	0.0050	mg/Kg	08/11/2004 07:34	
Ethyl benzene	ND	0.0050	mg/Kg	08/11/2004 07:34	
Total xylenes	ND	0.0050	mg/Kg	08/11/2004 07:34	
<b>Surrogates(s)</b>					
1,2-Dichloroethane-d4	93.2	76-124	%	08/11/2004 07:34	
Toluene-d8	101.2	75-116	%	08/11/2004 07:34	



**Gas/BTEX/MTBE by 8260B (C6-C12)**

Cambria Environmental Emeryville

Attn.: Stu Dalie

5900 Hollis Street, Ste. A

Emeryville, CA 94608

Phone: (510) 420-3339 Fax: (510) 420-9170

Project: 206-0467-003

Received: 08/10/2004 14:25

Site: 1601 Webster Ave., Alameda, CA

Batch QC Report										
Prep(s): 5030B					Test(s): 8260B					
Laboratory Control Spike			Soil		QC Batch # 2004/08/11-1B-69					
LCS	2004/08/11-1B-69-058		Extracted: 08/11/2004		Analyzed: 08/11/2004 06:57					
LCSD	2004/08/11-1B-69-057		Extracted: 08/11/2004		Analyzed: 08/11/2004 07:57					
Compound	Conc. mg/Kg		Exp.Conc.	Recovery %		RPD	Ctrl.Limits %		Flags	
	LCS	LCSD		LCS	LCSD		%	Rec.	RPD	LCS
Methyl tert-butyl ether (MTBE)	0.0397	0.0369	0.05	79.4	73.8	7.3	65-165	20		
Benzene	0.0522	0.0538	0.05	104.4	107.6	3.0	69-129	20		
Toluene	0.0510	0.0513	0.05	102.0	102.6	0.6	70-130	20		
<b>Surrogates(s)</b>										
1,2-Dichloroethane-d4	445	444	500	89.0	88.8		76-124			
Toluene-d8	529	551	500	105.8	110.2		75-116			

Severn Trent Laboratories, Inc.

STL San Francisco \* 1220 Quarry Lane, Pleasanton, CA 94566

Tel 925 484 1919 Fax 925 484 1096 \* www.stl-inc.com \* CA DHS ELAP# 2496

08/11/2004 16:34

**Gas/BTEX/MTBE by 8260B (C6-C12)**

Cambria Environmental Emeryville

Attn.: Stu Dalie

5900 Hollis Street, Ste. A

Emeryville, CA 94608

Phone: (510) 420-3339 Fax: (510) 420-9170

Project: 206-0467-003

Received: 08/10/2004 14:25

Site: 1601 Webster Ave., Alameda, CA

---

**Legend and Notes**

---

**Result Flag**

sl

Surrogate recoveries were lower than QC limit due to matrix interference,  
confirmed by reanalysis.

Lab Identification (if necessary)

Address: 1220 Quince Lane

City, State, Zip: Pleasanton, CA 94566

Shell Project Manager to be Invoiced:

SCIENCE & ENGINEERING  
 TECHNICAL SERVICES  
 CRMT HOUSTON

Bill Merchant

INCIDENT NUMBER (S&E ONLY)

SAP or CRMT NUMBER (S/CRMT)

1 3 5 0 3 2

DATE: 8/10/04

Page 1 of 1

**LAB/CRMT COMPANY:** Cambria Environmental  
**LOG CODE:** CETO  
**SITE ADDRESS (Street and City):** 1601 Webster Avenue, Alameda, CA  
**GLOBAL ID NO.:** No site ID number identified

**ADDRESS:** 5900 Hollis St., Ste A, Emeryville, CA  
**USE DELIVERABLE TO (Responsible Party & Address):**  
**PHONE NO.:** 510-420-3339  
**EMAIL:** sdale@cambria-env.com  
**CONSULTANT PROJECT NO.:** 206-0467-003

**PROJECT CONTACT (Name, Title, Phone, Fax, Email):**  
 shalokar@delco@cambria-env.com  
 510-420-3339  
 sdale@cambria-env.com

**Site Date:** 8/10/04  
**TELEPHONE:** 510-420-33324  
**FAX:** 510-420-3170  
**EMAIL:** sdale@cambria-env.com

**TURNAROUND TIME (BUSINESS DAYS):**  
 10 DAYS  5 DAYS  72 HOURS  48 HOURS  24 HOURS  LESS THAN 24 HOURS

LA - RWOCB REPORT FORM  USE AGENCY:

**GC/MS MTBE CONFIRMATION:** HIGHEST \_\_\_\_\_ HIGHEST per BORING \_\_\_\_\_ ALL \_\_\_\_\_

**SPECIAL INSTRUCTIONS OR NOTES:** CHECK BOX IF EDD IS NOT NEEDED   
 Please cc results to sdale@cambria-env.com

REQUESTED ANALYSIS

LA P US	Field Sample Identification	SAMPLING		MATRIX	NO. OF CONT.	TPH - Gas, Purgeable	BTEX	TPH, d, mc	MTBE (3260B - 0.5ppb RL)	Fuel oxygenates 8-260 SEE NOTES	Ethanol (826b)	Methanol	EDB & 1,2-DCA (8260B)	EPA 5035 Extraction for Volatiles	VOCs Halogenated/Aromatic (802) (S)	TRPH (418-1)	Vapor VOCs - BTEX / MTBE (10-15)	Vapor VOCs - Fuel List (10-15)	Vapor TPH (ASTM 3415m)	Vapor Fixed Gases (ASTM D1846)	Test for Disposal (48 - )	Test for Disposal, see attached	TPH - Diesel, Extractable (8015m)	MTBE (3260B) (see map on page 2)	FIELD NOTES: Container/Preservative or PID Readings or Laboratory Notes
		DATE	TIME																						
	- P-1-2'	8/10/04	9:30	soil	1	X	X	X	X																On ICE Field point ID
	- P-1-3'		9:40			X	X	X	X																TEMPERATURE IN RECEIPT
	- P-2-3'		9:45			X	X	X	X																
	- P-3-3'		9:50			X	X	X	X																
	- P-4-3'		9:55																						
	- D-2-2'		10																						
	- P-5-3'		10:10																						

**RUSH**

**Requested by (Signature):** [Signature]  
**Received by (Signature):** [Signature]  
**Requested by (Signature):** [Signature]  
**Received by (Signature):** [Signature]  
**Requested by (Signature):** [Signature]  
**Received by (Signature):** [Signature]

**Date:** 8/10/04  
**Time:** 12:00 A.M.

**Date:** 8/10/04  
**Time:** 14:25

**Date:** 8/10/04  
**Time:** 18:15

**Sale Location:** Emeryville office refrigerator; Stewart Dale

Mr. Robert Weston  
October 4, 2004

**Waste Disposal Samples**

**Cambria Environmental Emeryville**

August 11, 2004

5900 Hollis Street, Ste. A  
Emeryville, CA 94608

Attn.: Stu Dalie

Project#: 206-0467-003

Site: 1601 Webster Ave., Alameda, CA

Dear Mr. Dalie:

Attached is our report for your samples received on 08/10/2004 14:25

This report has been reviewed and approved for release. Reproduction of this report is permitted only in its entirety.

Please note that any unused portion of the samples will be discarded after 09/24/2004 unless you have requested otherwise.

We appreciate the opportunity to be of service to you. If you have any questions,

You can also contact me via email. My email address is: [mbrewer@stl-inc.com](mailto:mbrewer@stl-inc.com)

Sincerely,



Melissa Brewer  
Project Manager

Severn Trent Laboratories, Inc.

STL San Francisco \* 1220 Quarry Lane, Pleasanton, CA 94566

Tel 925 484 1919 Fax 925 484 1096 \* [www.stl-inc.com](http://www.stl-inc.com) \* CA DHS ELAP# 2496

**Total Lead**

Cambria Environmental Emeryville  
Attn.: Stu Dalie

5900 Hollis Street, Ste. A  
Emeryville, CA 94608  
Phone: (510) 420-3339 Fax: (510) 420-9170  
Project: 206-0467-003

Received: 08/10/2004 14:25

Site: 1601 Webster Ave., Alameda, CA

**Samples Reported**

Sample Name	Date Sampled	Matrix	Lab #
SP-1	08/10/2004 10:30	Soil	1

**Total Lead**

Cambria Environmental Emeryville

Attn.: Stu Dalie

5900 Hollis Street, Ste. A  
Emeryville, CA 94608  
Phone: (510) 420-3339 Fax: (510) 420-9170

Project: 206-0467-003

Received: 08/10/2004 14:25

Site: 1601 Webster Ave., Alameda, CA

Prep(s):	3050B	Test(s):	6010B
Sample ID:	SP-1	Lab ID:	2004-08-0247 - 1
Sampled:	08/10/2004 10:30	Extracted:	8/11/2004 05:07
Matrix:	Soil	QC Batch#:	2004/08/11-01.15

Compound	Conc.	RL	Unit	Dilution	Analyzed	Flag
Lead	22	1.0	mg/Kg	1.00	08/11/2004 10:37	

**Total Lead**

Cambria Environmental Emeryville  
Attn.: Stu Dalie

5900 Hollis Street, Ste. A  
Emeryville, CA 94608  
Phone: (510) 420-3339 Fax: (510) 420-9170  
Project: 206-0467-003

Received: 08/10/2004 14:25

Site: 1601 Webster Ave., Alameda, CA

Batch QC Report					
Prep(s): 3050B				Test(s): 6010B	
Method Blank		Soil		QC Batch # 2004/08/11-01.15	
MB: 2004/08/11-01.15-031				Date Extracted: 08/11/2004 05:07	
Compound	Conc.	RL	Unit	Analyzed	Flag
Lead	ND	1.0	mg/Kg	08/11/2004 10:11	



**Total Lead**

Cambria Environmental Emeryville

Attn.: Stu Dalie

5900 Hollis Street, Ste. A  
Emeryville, CA 94608  
Phone: (510) 420-3339 Fax: (510) 420-9170

Project: 206-0467-003

Received: 08/10/2004 14:25

Site: 1601 Webster Ave., Alameda, CA

Batch QC Report										
Prep(s): 3050B					Test(s): 6010B					
Laboratory Control Spike			Soil			QC Batch # 2004/08/11-01-15				
LCS	2004/08/11-01-15-032		Extracted: 08/11/2004			Analyzed: 08/11/2004 10:16				
LCSD	2004/08/11-01-15-035		Extracted: 08/11/2004			Analyzed: 08/11/2004 10:33				
Compound	Conc. mg/Kg		Exp. Conc.	Recovery %		RPD	Ctrl. Limits %		Flags	
	LCS	LCSD		LCS	LCSD		%	Rec.	RPD	LCS
Lead	97.1	97.7	100.0	97.1	97.7	0.6	80-120	20		

**Total Lead**

Cambria Environmental Emeryville

Attn.: Stu Dalie

5900 Hollis Street, Ste. A  
Emeryville, CA 94608  
Phone: (510) 420-3339 Fax: (510) 420-9170

Project: 206-0467-003

Received: 08/10/2004 14:25

Site: 1601 Webster Ave., Alameda, CA

Batch QC Report			
Prep(s):	3050B		Test(s): 6010B
<b>Matrix Spike ( MS / MSD )</b>		<b>Soil</b>	<b>QC Batch # 2004/08/11-01.15</b>
SP-1 >> MS			Lab ID: 2004-08-0247 - 001
MS: 2004/08/11-01.15-037		Extracted: 08/11/2004	Analyzed: 08/11/2004 10:40
			Dilution: 1.00
MSD: 2004/08/11-01.15-038		Extracted: 08/11/2004	Analyzed: 08/11/2004 10:44
			Dilution: 1.00

Compound	Conc. mg/Kg		Spk.Level mg/Kg	Recovery %			Limits %		Flags		
	MS	MSD		Sample	MS	MSD	RPD	Rec.	RPD	MS	MSD
Lead	108	114	21.8	98.0	88.0	93.1	5.6	75-125	20		

**Gas/BTEX Fuel Oxygenates by 8260B (C6-C12)**

Cambria Environmental Emeryville

Attn.: Stu Dalie

5900 Hollis Street, Ste. A

Emeryville, CA 94608

Phone: (510) 420-3339 Fax: (510) 420-9170

Project: 206-0467-003

Received: 08/10/2004 14:25

Site: 1601 Webster Ave., Alameda, CA

**Samples Reported**

Sample Name	Date Sampled	Matrix	Lab #
SP-1	08/10/2004 10:30	Soil	1

Severn Trent Laboratories, Inc.

STL San Francisco \* 1220 Quarry Lane, Pleasanton, CA 94566

Tel 925 484 1919 Fax 925 484 1096 \* www.stl-inc.com \* CA DHS ELAP# 2496

08/11/2004 13:31

**Gas/BTEX Fuel Oxygenates by 8260B (C6-C12)**

Cambria Environmental Emeryville

Attn.: Stu Dalie

5900 Hollis Street, Ste. A  
Emeryville, CA 94608  
Phone: (510) 420-3339 Fax: (510) 420-9170

Project: 206-0467-003

Received: 08/10/2004 14:25

Site: 1601 Webster Ave., Alameda, CA

Prep(s):	5030B	Test(s):	8260B
Sample ID:	SP-1	Lab ID:	2004-08-0247 - 1
Sampled:	08/10/2004 10:30	Extracted:	8/11/2004 11:16
Matrix:	Soil	QC Batch#:	2004/08/11-1A-69

Compound	Conc.	RL	Unit	Dilution	Analyzed	Flag
Gasoline	ND	1.0	mg/Kg	1.00	08/11/2004 11:16	
Benzene	ND	0.0050	mg/Kg	1.00	08/11/2004 11:16	
Toluene	ND	0.0050	mg/Kg	1.00	08/11/2004 11:16	
Ethyl benzene	ND	0.0050	mg/Kg	1.00	08/11/2004 11:16	
Total xylenes	ND	0.0050	mg/Kg	1.00	08/11/2004 11:16	
<b>Surrogate(s)</b>						
1,2-Dichloroethane-d4	92.1	76-124	%	1.00	08/11/2004 11:16	
Toluene-d8	62.6	75-116	%	1.00	08/11/2004 11:16	sl

Severn Trent Laboratories, Inc.

STL San Francisco \* 1220 Quarry Lane, Pleasanton, CA 94566

Tel 925 484 1919 Fax 925 484 1096 \* www.stl-inc.com \* CA DHS ELAP# 2496

08/11/2004 13:31

**Gas/BTEX Fuel Oxygenates by 8260B (C6-C12)**

Cambria Environmental Emeryville

Attn.: Stu Dalie

5900 Hollis Street, Ste. A  
Emeryville, CA 94608  
Phone: (510) 420-3339 Fax: (510) 420-9170

Project: 206-0467-003

Received: 08/10/2004 14:25

Site: 1601 Webster Ave., Alameda, CA

Batch QC Report					
Prep(s): 5030B				Test(s): 8260B	
Method Blank		Soil		QC Batch # 2004/08/11-1A.69	
MB: 2004/08/11-1A.69-034				Date Extracted: 08/11/2004 07:34	

Compound	Conc.	RL	Unit	Analyzed	Flag
Gasoline	ND	1.0	mg/Kg	08/11/2004 07:34	
Benzene	ND	0.0050	mg/Kg	08/11/2004 07:34	
Toluene	ND	0.0050	mg/Kg	08/11/2004 07:34	
Ethyl benzene	ND	0.0050	mg/Kg	08/11/2004 07:34	
Total xylenes	ND	0.0050	mg/Kg	08/11/2004 07:34	
<b>Surrogates(s)</b>					
1,2-Dichloroethane-d4	93.2	76-124	%	08/11/2004 07:34	
Toluene-d8	101.2	75-116	%	08/11/2004 07:34	

**Gas/BTEX Fuel Oxygenates by 8260B (C6-C12)**

Cambria Environmental Emeryville

Attn.: Stu Dalie

5900 Hollis Street, Ste. A  
Emeryville, CA 94608  
Phone: (510) 420-3339 Fax: (510) 420-9170

Project: 206-0467-003

Received: 08/10/2004 14:25

Site: 1601 Webster Ave., Alameda, CA

**Batch QC Report**

Prep(s): 5030B

Test(s): 8260B

**Laboratory Control Spike**

**Soil**

**QC Batch # 2004/08/11-1A.69**

LCS 2004/08/11-1A.69-058

Extracted: 08/11/2004

Analyzed: 08/11/2004 06:57

LCSD 2004/08/11-1A.69-057

Extracted: 08/11/2004

Analyzed: 08/11/2004 07:57

Compound	Conc. mg/Kg		Exp.Conc.	Recovery %		RPD %	Ctrl.Limits %		Flags	
	LCS	LCSD		LCS	LCSD		Rec.	RPD	LCS	LCSD
Benzene	0.0522	0.0538	0.05	104.4	107.6	3.0	69-129	20		
Toluene	0.0510	0.0513	0.05	102.0	102.6	0.6	70-130	20		
<b>Surrogates(s)</b>										
1,2-Dichloroethane-d4	445	444	500	89.0	88.8		76-124			
Toluene-d8	529	551	500	105.8	110.2		75-116			

Severn Trent Laboratories, Inc.

08/11/2004 13:31

STL San Francisco \* 1220 Quarry Lane, Pleasanton, CA 94566

**Gas/BTEX Fuel Oxygenates by 8260B (C6-C12)**

Cambria Environmental Emeryville

Attn.: Stu Dalie

5900 Hollis Street, Ste. A  
Emeryville, CA 94608  
Phone: (510) 420-3339 Fax: (510) 420-9170

Project: 206-0467-003

Received: 08/10/2004 14:25

Site: 1601 Webster Ave., Alameda, CA

Batch QC Report			
Prep(s):	5030B	Test(s):	8260B
<b>Matrix Spike ( MS / MSD )</b>		<b>Soil</b>	<b>QC Batch # 2004/08/11-1A.69</b>
SP-1 >> MS		Lab ID:	2004-08-0247-001
MS: 2004/08/11-1A.69-035	Extracted: 08/11/2004	Analyzed:	08/11/2004 11:35
		Dilution:	1.00
MSD: 2004/08/11-1A.69-053	Extracted: 08/11/2004	Analyzed:	08/11/2004 11:53
		Dilution:	1.00

Compound	Conc. mg/Kg		Spk.Level mg/Kg	Recovery %			Limits %		Flags		
	MS	MSD		Sample	MS	MSD	RPD	Rec.	RPD	MS	MSD
Benzene	0.0399	0.0381	ND	0.047984	83.1	78.2	6.1	69-129	20		
Toluene	0.0381	0.0293	ND	0.047984	79.4	60.2	27.5	70-130	20		rpd
<b>Surrogate(s)</b>											
1,2-Dichloroethane-d4	475	448		500	95.0	89.6		76-124			
Toluene-d8	454	342		500	90.8	68.4		75-116			sh

Severn Trent Laboratories, Inc.

STL San Francisco \* 1220 Quarry Lane, Pleasanton, CA 94566

Tel 925 484 1919 Fax 925 484 1096 \* www.stl-inc.com \* CA DHS ELAP# 2496

08/11/2004 13:31

**Gas/BTEX Fuel Oxygenates by 8260B (C6-C12)**

Cambria Environmental Emeryville

Attn.: Stu Dalie

5900 Hollis Street, Ste. A

Emeryville, CA 94608

Phone: (510) 420-3339 Fax: (510) 420-9170

Project: 206-0467-003

Received: 08/10/2004 14:25

Site: 1601 Webster Ave., Alameda, CA

**Legend and Notes**

**Result Flag**

rpd

Analyte RPD was out of QC limits due to sample heterogeneity.

sh

Surrogate recovery was higher than QC limit due to matrix interference.

sl

Surrogate recoveries were lower than QC limit due to matrix interference, confirmed by reanalysis.



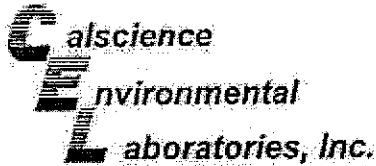

August 13, 2004

Melissa Brewer  
Severn Trent Laboratories  
1220 Quarry Lane  
Pleasanton, CA 94566-4756

Subject: Calscience Work Order No.: 04-08-0648  
Client Reference: 2004-08-0247 / 206-0467-003

Dear Client:

Enclosed is an analytical report for the above-referenced project. The samples included in this report were received 8/12/2004 and analyzed in accordance with the attached chain-of-custody.

Unless otherwise noted, all analytical testing was accomplished in accordance with the guidelines established in our Quality Assurance Program Manual, applicable standard operating procedures, and other related documentation. The original report of any subcontracted analysis is provided herein, and follows the standard Calscience data package. The results in this analytical report are limited to the samples tested and any reproduction thereof must be made in its entirety.

If you have any questions regarding this report, please do not hesitate to contact the undersigned.

Sincerely,

Calscience Environmental  
Laboratories, Inc.  
Ranjit Clarke  
Project Manager



Severn Trent Laboratories  
 1220 Quarry Lane  
 Pleasanton, CA 94586-4756

Date Received: 08/12/04  
 Work Order No: 04-08-0648  
 Preparation: DHS LUFT  
 Method: DHS LUFT

Project: 2004-08-0247 / 206-0467-003

Page 1 of 1

Client Sample Number	Lab Sample Number	Date Collected	Matrix	Date Prepared	Date Analyzed	QC Batch ID
SP-1	04-08-0648-1	08/10/04	Solid	08/12/04	08/12/04	040812L07

Parameter	Result	RL	DF	Qual	Units
Organic Lead	ND	1.00	1		mg/kg

Client Sample Number	Lab Sample Number	Date Collected	Matrix	Date Prepared	Date Analyzed	QC Batch ID
Method Blank	099-10-020-222	N/A	Solid	08/12/04	08/12/04	040812L07

Parameter	Result	RL	DF	Qual	Units
Organic Lead	ND	1.00	1		mg/kg

RL - Reporting Limit    DF - Dilution Factor    Qual - Qualifiers



Severn Trent Laboratories  
 1220 Quarry Lane  
 Pleasanton, CA 94566-4756

Date Received: 08/12/04  
 Work Order No: 04-08-0648  
 Preparation: DHS LUFT  
 Method: DHS LUFT

Project: 2004-08-0247 / 206-0467-003

Quality Control Sample ID	Matrix	Instrument	Date Prepared	Date Analyzed	MS/MSD Batch Number
04-08-0607-1	Solid	FLAA	08/12/04	08/12/04	040812507

Parameter	MS %REC	MSD %REC	%REC CL	RPD	RPD CL	Qualifiers
Organic Lead	84	84	50-130	1	0-20	

RPD - Relative Percent Difference, CL - Control Limit



**Environmental Quality Control - Laboratory Control Sample**  
**Laboratories, Inc.**



Severn Trent Laboratories  
 1220 Quarry Lane  
 Pleasanton, CA 94566-4756

Date Received: N/A  
 Work Order No: 04-08-0648  
 Preparation: DHS LUFT  
 Method: DHS LUFT

Project: 2004-08-0247 / 206-0467-003

Quality Control Sample ID	Matrix	Instrument	Date Analyzed	Lab File ID	LCS Batch Number
089-10-020-222	Solid	FLAA	08/12/04		040812L07

Parameter	Conc Added	Conc Recovered	LCS %Rec	%Rec CL	Qualifies
Organic Lead	25.0	24.0	96	50-100	

RPD - Relative Percent Difference, CL - Control Limit



Work Order Number: 04-08-0648

<u>Qualifier</u>	<u>Definition</u>
*	See applicable analysis comment.
1	Surrogate compound recovery was out of control due to a required sample dilution, therefore, the sample data was reported without further clarification.
2	Surrogate compound recovery was out of control due to matrix interference. The associated method blank surrogate spike compound was in control and, therefore, the sample data was reported without further clarification.
3	Recovery of the Matrix Spike or Matrix Spike Duplicate compound was out of control due to matrix interference. The associated LCS and/or LCSD was in control and, therefore, the sample data was reported without further clarification.
4	The MS/MSD RPD was out of control due to matrix interference. The LCS/LCSD RPD was in control and, therefore, the sample data was reported without further clarification.
5	The PDS/PDSD associated with this batch of samples was out of control due to a matrix interference effect. The associated batch LCS/LCSD was in control and, hence, the associated sample data was reported with no further corrective action required.
A	Result is the average of all dilutions, as defined by the method.
B	Analyte was present in the associated method blank.
C	Analyte presence was not confirmed on primary column.
D	The analyte concentration was reported from analysis of the diluted sample.
E	Concentration exceeds the calibration range.
H	Sample received and/or analyzed past the recommended holding time.
J	Analyte was detected at a concentration below the reporting limit and above the laboratory method detection limit. Reported value is estimated.
N	Nontarget Analyte.
ND	Parameter not detected at the indicated reporting limit.
Q	Spike recovery and RPD control limits do not apply resulting from the parameter concentration in the sample exceeding the spike concentration by a factor of four or greater.
U	Undetected at the laboratory method detection limit.
X	% Recovery and/or RPD out-of-range.
Z	Analyte presence was not confirmed by second column or GC/MS analysis.

A handwritten signature in black ink, appearing to be "M. M. M." or similar.

SEVERN

TRENT

STL

Chain of Custody

Date Shipped: 8/11/2004

2004-08-0247 - 1

08-06158

From: STL San Francisco (CL)  
1220 Quarry Lane  
Pleasanton, CA 94556-4756

To: CalScience Analytical Laboratory  
7440 Lincoln Way  
Garden Grove, CA 92841

Project Manager: Melissa Brewer  
Phone: Ext  
Fax: (925) 454-1096  
Email: mbrewer@stl-loc.com

Phone: (714) 895-5494 Ext  
Fax: () -  
Contact: Sample Control  
Phone: (714) 895-5494 Ext

CL Submission #: 2004-08-0247

Project #: 206-0467-003

CL PO #:

Project Name:

Client Sample ID		Sample ID		Method	
SP-1	1	8/10/2004 10:30:00AM	Soil	5 Day	
Subcontract - Organic Lead			LUFT		

PLEASE INCLUDE QC WITH FAXED AND HARD-COPY RESULTS

24 hr TAT

**RUSH**

RELINQUISHED BY: *[Signature]* 14:45<sup>1</sup>  
 Signature Time  
 Printed Name: Bryan Thomas 8/11/04  
 Date  
 Company: STL-SF

RECEIVED BY: *[Signature]* 11:00<sup>1</sup>  
 Signature Time  
 Printed Name: [Name] 8/12/04  
 Date  
 Company:

RELINQUISHED BY: 2.  
 Signature Time  
 Printed Name Date  
 Company

RECEIVED BY: 2.  
 Signature Time  
 Printed Name Date  
 Company

RELINQUISHED BY: 3.  
 Signature Time  
 Printed Name Date  
 Company

RECEIVED BY: 3.  
 Signature Time  
 Printed Name Date  
 Company

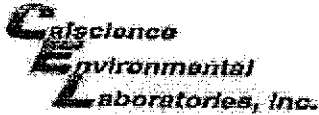

WORK ORDER #: 04-08-0648

Cooler 1 of 1

SAMPLE RECEIPT FORM

CLIENT: SCV

DATE: 8/17/04

TEMPERATURE - SAMPLES RECEIVED BY:

CALSCIENCE COURIER:

- Chilled, cooler with temperature blank provided.
Chilled, cooler without temperature blank.
Chilled and placed in cooler with wet ice.
Ambient and placed in cooler with wet ice.
Ambient temperature.
°C Temperature blank.

LABORATORY (Other than Calscience Courier):

- °C Temperature blank.
3.2 °C IR thermometer.
Ambient temperature.

Initial: [Signature]

CUSTODY SEAL INTACT:

Sample(s): Cooler: No (Not Intact): Not Applicable (N/A): [X] [check]

Initial: JM

SAMPLE CONDITION:

Table with 4 columns: Description, Yes, No, N/A. Rows include Chain-Of-Custody document(s), Sample container label(s), Sample container(s) intact, Correct containers for analyses, Proper preservation, VOA vial(s) free of headspace, Tedlar bag(s) free of condensation.

Initial: JM

COMMENTS:

Blank lines for handwritten comments.

# AB STL San Francisco **2004-08-0247** SHELL Chain Of Custody Record

Lab Identification (if necessary)

Address: 1220 Quarry Lane

City, State, Zip: Pleasanton CA 94566

Shell Project Manager to be Invoiced:

- SCIENCE & ENGINEERING
- TECHNICAL SERVICES
- CRMT HOUSTON

Bill Merchant

INCIDENT NUMBER (S&E ONLY)

DATE: 8/10/04

SAP or CRMT NUMBER (TS/CRMT)

Page 1 of 2

1 3 5 0 3 2

89958

SAMPLING COMPANY: <b>Cambria Environmental</b> ADDRESS: 5900 Hollis St. Ste A, Emeryville, CA PROJECT CONTACT (Name/Title or POC Number): Stu Dalia TELEPHONE: 510-420-3324 FAX: 510-420-9170 EMAIL: sdalia@cambria-env.com	LAB CODE: <b>CETO</b>	SITE ADDRESS (Street and City): <b>1601 Webster Avenue, Alameda, CA</b> OFF DELIVERABLES TO (S/Supplier, POC or Signature): shelipak@delco.com PHONE NO.: 510-420-3339 SAMPLER NAME(S) (Poc): Stu Dalia	REGIONAL ID NO.: No site ID number identified EMAIL: sdalia@cambria-env.com CONSULTANT PROJECT ID: 206-0467-003 LAB USE ONLY
---	--------------------------	--	---

TURNAROUND TIME (BUSINESS DAYS):  
 10 DAYS  5 DAYS  72 HOURS  48 HOURS  24 HOURS  LESS THAN 24 HOURS

LA - RWQCE REPORT FORM  JUST AGENCY

GC/MS MTBE CONFIRMATION: HIGHEST \_\_\_\_\_ HIGHEST per BORING \_\_\_\_\_ ALL \_\_\_\_\_

SPECIAL INSTRUCTIONS OR NOTES: (CHECK BOX IF EDD IS NOT NEEDED)

Please cc results to sdalia@cambria-env.com

**REQUESTED ANALYSIS**

LAB ID	Field Sample Identification	SAMPLING		MATRIX	NO. OF CONT.	TPH - Gas, Purgeable	BTEX	TPH, 4, MS	MTBE (R250B - 0.5ppb RL)	Fuel oxygenates BASED SEE NOTES	Ethanol (R250B)	Methanol	EDB & 1,2-DCA (R250B)	EPA 5025 Extraction for Volatiles	VOCs: Halogenated/Aromatic (R021B)	TRPH (418.1)	Vapor VOCs: BTEX / MTBE (10-15)	Vapor VOCs: Full List (10-15)	Vapor TPH (ASTM 3416m)	Vapor Fixed Gases: (ASTM D1946)	Test for Disposal (4B)	Test for Disposal, see attached	TPH - Dissol. Extractable (80.15m)	MTBE (R250B) Confirmation, See Note	FIELD NOTES: Contains Preservative or PID Readings or Laboratory Notes	
		DATE	TIME																							
	SP-1A	8/10/04	0:30	Soil	1	X	X																		On ICE Field point ID TEMPERATURE OF REFRIG. COOLANT 40° 30° SP-1 8/10	
	SP-1B	8/10/04	↓	Soil	1	X	X																			
	SP-1C	8/10/04	↓	Soil	1	X	X																			
	SP-1D	8/10/04	↓	Soil	1	X	X																			

RUSH

Requisitioned by (Signature): 	Received by (Signature): 	Date: 8/10/04	Time: 10:00 A.M.
Requisitioned by (Signature): 	Received by (Signature): 	Date: 8/10/04	Time: 14:25
Requisitioned by (Signature): 	Received by (Signature): 	Date: 8/10/04	Time: 18:15



**ATTACHMENT C**

**August 11, 2004 Unauthorized Release Report Form**

UNDERGROUND STORAGE TANK UNAUTHORIZED RELEASE (LEAK) / CONTAMINATION SITE REPORT			
EMERGENCY <input type="checkbox"/> YES <input checked="" type="checkbox"/> NO		HAS STATE OFFICE OF EMERGENCY SERVICES REPORT BEEN FILED? <input type="checkbox"/> YES <input checked="" type="checkbox"/> NO	
FOR LOCAL AGENCY USE ONLY I HEREBY CERTIFY THAT I HAVE DISTRIBUTED THIS INFORMATION ACCORDING TO THE DISTRIBUTION SHOWN ON THE INSTRUCTION SHEET ON THE BACK PAGE OF THIS FORM.			
REPORT DATE 048w1d2d04y		CASE #	
REPORTED BY	NAME OF INDIVIDUAL FILING REPORT Karen Petryna		PHONE (559) 695-9306
	SIGNATURE <i>Karen Petryna</i>		
	REPRESENTING <input checked="" type="checkbox"/> OWNER/OPERATOR <input type="checkbox"/> REGIONAL BOARD <input type="checkbox"/> LOCAL AGENCY <input type="checkbox"/> OTHER		
COMPANY OR AGENCY NAME Shell Oil Products US			
ADDRESS 20945 S. Wilmington Avenue Carson CA 90810			
RESPONSIBLE PARTY	NAME Equilon Enterprises dba Shell Oil Products US <input type="checkbox"/> UNKNOWN		CONTACT PERSON Karen Petryna
	ADDRESS 20945 S. Wilmington Avenue Carson CA 90810		PHONE (559) 695-9306
SITE LOCATION	FACILITY NAME (IF APPLICABLE) Shell-branded Service Station		OPERATOR ( )
	ADDRESS 1601 Webster Street Alameda CA 94501		PHONE ( )
	CROSS STREET Lincoln Avenue		
IMPLEMENTING AGENCIES	LOCAL AGENCY AGENCY NAME Alameda County Health Agency		CONTACT PERSON Robert Weston
	REGIONAL BOARD San Francisco Bay Regional Water Quality Control Board		PHONE (510) 567-6781
SUBSTANCES INVOLVED	(1) Gasoline Constituents		QUANTITY LOST (GALLONS) <input checked="" type="checkbox"/> UNKNOWN
	(2) NAME TPH <sub>3</sub> , Total xylenes		<input type="checkbox"/> UNKNOWN
DISCOVERY/ABATEMENT	DATE DISCOVERED 048w1d1d04y		HOW DISCOVERED <input type="checkbox"/> TANK TEST <input type="checkbox"/> TANK REMOVAL <input checked="" type="checkbox"/> OTHER
	DATE DISCHARGE BEGAN w d d d y y		METHOD USED TO STOP DISCHARGE (CHECK ALL THAT APPLY) <input type="checkbox"/> REMOVE CONTENTS <input type="checkbox"/> CLOSE TANK & REMOVE <input type="checkbox"/> REPAIR PIPING
	HAS DISCHARGE BEEN STOPPED? <input type="checkbox"/> YES <input type="checkbox"/> NO IF YES, DATE w d d d y y		<input type="checkbox"/> REPAIR TANK <input type="checkbox"/> CLOSE TANK & FILL IN PLACE <input type="checkbox"/> CHANGE PROCEDURE
SOURCE/ CAUSE	SOURCE OF DISCHARGE <input type="checkbox"/> TANK LEAK <input checked="" type="checkbox"/> UNKNOWN <input type="checkbox"/> PIPING LEAK <input type="checkbox"/> OTHER		CAUSE(S) <input type="checkbox"/> OVERFILL <input type="checkbox"/> RUPTURE/FAILURE <input type="checkbox"/> SPILL
			<input type="checkbox"/> CORROSION <input type="checkbox"/> UNKNOWN <input type="checkbox"/> OTHER
CASE TYPE	CHECK ONE ONLY <input checked="" type="checkbox"/> UNDETERMINED <input type="checkbox"/> SOIL ONLY <input type="checkbox"/> GROUNDWATER <input type="checkbox"/> DRINKING WATER - (CHECK ONLY IF WATER WELLS HAVE ACTUALLY BEEN AFFECTED)		
CURRENT STATUS	CHECK ONE ONLY <input type="checkbox"/> NO ACTION TAKEN <input type="checkbox"/> PRELIMINARY SITE ASSESSMENT WORKPLAN SUBMITTED <input type="checkbox"/> POLLUTION CHARACTERIZATION <input type="checkbox"/> LEAK BEING CONFIRMED <input type="checkbox"/> PRELIMINARY SITE ASSESSMENT UNDERWAY <input type="checkbox"/> POST CLEANUP MONITORING IN PROGRESS <input type="checkbox"/> REMEDIATION PLAN <input type="checkbox"/> CASE CLOSED (CLEANUP COMPLETED OR UNNECESSARY) <input type="checkbox"/> CLEANUP UNDERWAY		
REMEDIAL ACTION	CHECK APPROPRIATE ACTION(S) <input type="checkbox"/> CAP SITE (CS) <input type="checkbox"/> EXCAVATE & DISPOSE (ED) <input type="checkbox"/> REMOVE FREE PRODUCT (FP) <input type="checkbox"/> ENHANCED BIO DEGRADATION (BT) <input type="checkbox"/> CONTAINMENT BARRIER (CB) <input type="checkbox"/> EXCAVATE & TREAT (ET) <input type="checkbox"/> PUMP & TREAT GROUNDWATER (GT) <input type="checkbox"/> REPLACE SUPPLY (RS) <input type="checkbox"/> VACUUM EXTRACT (VE) <input type="checkbox"/> NO ACTION REQUIRED (NA) <input type="checkbox"/> TREATMENT AT HOOKUP (HU) <input type="checkbox"/> VENT SOIL (VS) <input type="checkbox"/> OTHER (OT)		
COMMENTS	Soil samples collected on 8/10/04 during fuel system upgrades. Laboratory analytical report dated 8/11/04 reported highest concentrations of 1,300 ppm TPH <sub>3</sub> , 49 ppm total xylenes. There were no other analytes detected above laboratory's reporting limits.		

**ATTACHMENT D**

**Soil Disposal Confirmation Report**



Hazardous Waste Hauler (Registration #2843)

8896 Elder Creek Rd. • Sacramento, CA 95828 • FAX (916) 381-1573

### Disposal Confirmation

Request for Transportation Received: 08/18/04

#### Consultant Information

Company: Cambria Environmental  
 Contact: Stu Dalie  
 Phone: 510 420-3339  
 Fax: 510 420-9170

#### Site Information

Station #: N/A  
 Street Address: 1601 Webster Street  
 City, State, ZIP: Alameda, CA

Customer: Shell Oil Company RESA-0023-LDC  
 RIPR #: 37133  
 SAP # / Location: 135032  
 Incident #:  
 Location / WIC #: 204-0072-0403  
 Environmental Engineer: Bill Merchant

Material Description: Contaminated soil  
 Estimated Quantity: 5-15 yards  
 Service Requested Date:

Disposal Facility: Forward Landfill  
 Contact: Joe Griffith  
 Phone: 800 204-4242  
 Approval #: 4756  
 Date of Disposal: 8/24/04  
 Actual Tonnage: 65.93

Transporter: Manley & Sons Trucking, Inc.  
 Contact: Janice Cox  
 Phone: 916 381-6864  
 Fax: 916 381-1573  
 Invoice: 52451  
 Date of Invoice: 8/26/04