



4703 Tidewater Avenue, Suite B
Oakland, CA 94601
phone: 510.434.9200
fax: 510.434.7676
intertek.com/building
psiusa.com

October 12, 2016

Mr. Mark Detterman
Alameda County Environmental Health Services
1131 Harbor Bay Parkway
Alameda, California 94502

RECEIVED

By Alameda County Environmental Health 10:43 am, Oct 13, 2016

Subject: Filing Error: Laboratory Analytical Report
Tidewater Business Park
4703, 4721, and 4723 Tidewater Avenue, Oakland, California
PSI Project No. 575-1102
SLIC Case No. RO0002664

Dear Mr. Detterman:

On September 27, 2016, PSI had a meeting with you regarding the open Spills, Leaks, Investigations, and Cleanups (SLIC) case for the Tidewater Business Park at 4703, 4721, and 4723 Tidewater Avenue, Oakland, California. During the meeting, you indicated that a laboratory report and part of a figure was found in your file for the Tidewater Business Park. The laboratory report referenced the subject property address and a PSI project number (575-443), but did not appear to be actually part of work performed at the subject property. You asked PSI to investigate the laboratory report and figure to determine whether they were related to SLIC case at the subject property.

PSI pulled the file for project number 575-443 and identified that the laboratory report and figure were from a PSI project in Dublin, California (see attached). PSI believes the laboratory report and figure were misfiled in the SLIC file for the Tidewater Business Park, since PSI is a tenant at the Tidewater Business Park and has the address of 4703 Tidewater Avenue, Oakland, California

If you have any questions regarding this letter, please give us a call at 510-434-9200.

Respectfully Submitted,

Professional Service Industries, Inc.

Brand Burfield, PG 6986
Project Geologist

Frank Poss
Department Manager
Principal Consultant

Attachments: Perjury Letter
PSI Project Number 575-443 Report

PERJURY LETTER

October 12, 2016

Mr. Mark Detterman
Alameda County Environmental Health Services
1131 Harbor Bay Parkway
Alameda, California 94502

Subject: Filing Error: Laboratory Analytical Report
Tidewater Business Park
4703, 4721, and 4723 Tidewater Avenue, Oakland, California
PSI Project No. 575-1102-1
SLIC Case No. RO0002664

Dear Mr. Detterman:

Please accept our submittal of the Laboratory Analytical Report letter for the subject site dated October 12, 2016 and prepared by Professional Service Industries, Inc. Please refer to the attached letter for details.

I declare, under penalty of perjury, that the information and/or conclusions contained in the attached letter are true and correct to the best of my knowledge, without independently investigating or verifying the information contained therein.

If you have any questions regarding this report or any aspect of the project, please call Mr. Frank Poss with PSI at 510-434-9200 (x303).

Sincerely,



Mr. Bill Schmitt
Property Owner
4703 Tidewater Avenue
Oakland, California 94601

cc: Mr. Frank Poss, PSI

PSI PROJECT NUMBER 575-443 REPORT

TANK CLOSURE REPORT

**East County Hall of Justice
Gleason Drive and Hacienda Drive
Dublin, Alameda County, California**

TANK CLOSURE REPORT

**East County Hall of Justice
Gleason Drive and Hacienda Drive
Dublin, Alameda County, California**

Prepared For

Alameda County General Services Agency
1401 Lakeside Drive, Room 1115
Oakland, California 94612

Prepared By

Professional Service Industries, Inc.
4703 Tidewater Avenue, Suite B
Oakland, California 94601
PSI Project No. 575-443

December 20, 2012

TABLE OF CONTENTS

STATEMENT OF LIMITATIONS AND PROFESSIONAL CERTIFICATION	i
1.0 INTRODUCTION	1
2.0 SITE BACKGROUND	1
3.0 FIELD PROCEDURES	1
4.0 INITIAL CHEMICAL ANALYSIS AND RESULTS	3
5.0 OVER-EXCAVATION PROCEDURES	4
6.0 OVER-EXCAVATION ANALYSIS AND RESULTS	6
7.0 CONCLUSIONS	7
8.0 RECOMENDATIONS	7

FIGURES

FIGURE 1	SITE LOCATION MAP
FIGURE 2	EXCAVATION PIT SAMPLE RESULTS
FIGURE 3	STOCKPILE SAMPLING MAP

TABLE

TABLE 1	EXCAVATION PIT SOIL SAMPLE RESULTS
TABLE 2	STOCKPILE SOIL SAMPLE RESULTS

APPENDICES

APPENDIX A	PSI FIELD PROCEDURES
APPENDIX B	DISPOSAL CERTIFICATES
APPENDIX C	LABORATORY REPORTS AND CHAIN-OF-CUSTODY DOCUMENTS
APPENDIX D	ESL LOOK UP TABLES

STATEMENT OF LIMITATIONS AND PROFESSIONAL CERTIFICATION

The information provided in this tank closure report prepared by PSI, Project Number 575-443, is intended exclusively for Alameda County General Services Agency (ACGSA) for the documentation of tank closure activities at the subject property located at Gleason Drive and Hacienda Drive in Dublin, California at the time the activities were conducted.

The professional services provided have been performed in accordance with practices generally accepted by other environmental professionals, geologists, hydrologists, hydrogeologists, engineers, and environmental scientists practicing in this field. No other warranty, either expressed or implied, is made. PSI is not an insurer and makes no guarantee or warranty that the services supplied will avert or mitigate occurrences, or the consequences of occurrences, that the services are designed to prevent or ameliorate.

As with all subsurface soil sampling, there is no guarantee that the work conducted has identified any and all sources or locations of petroleum hydrocarbons or hazardous substances or chemicals in the soil. A copy of this report will be issued to the Regional Water Quality Control Board (RWQCB).



Frank Poss
Principal Consultant

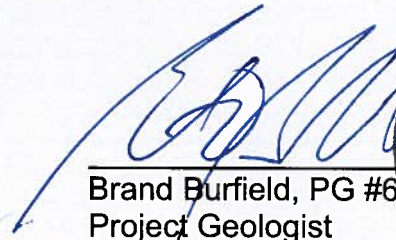

Brand Burfield, PG #6986
Project Geologist

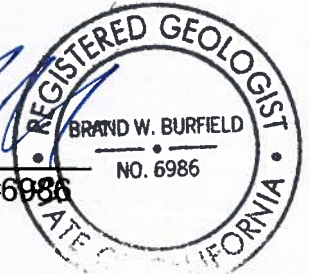

1.0 INTRODUCTION

The subject property is located on the north side of Gleason Drive at its intersection with Hacienda Drive in Dublin, Alameda County, California (see Figure 1 – Site Location Map).

This Tank Closure Report summarizes underground storage tank (UST) removal activities and presents the analytical results for the soil samples collected as part of the UST removal activities.

2.0 SITE BACKGROUND

The subject property is the proposed future location of the East County Hall of Justice (ECHOJ) and was formerly a part of the Camp Parks Army Base. The subject property is owned by the ACGSA.

During activities to prepare the ECHOJ site for construction, two concrete vaults were discovered in the area of a former military boiler room (Camp Parks Boiler House No. 1). The vaults were encountered at about 3 feet below the ground surface at the base of an approximately 20- to 25-foot high berm along the north side of the property. For the purpose of this report, these vaults are referred to as USTs.

3.0 FIELD PROCEDURES

The field activities completed for the removal of the USTs are summarized in the following sections.

3.1 *Pre-UST Removal Activities*

Pre-UST removal activities included mobilization to the site, uncovering the USTs, obtaining a permit for the removal of the USTs and pumping the contents of the USTs. PARC Services, Inc. (PARC) was the general contractor for the UST removal activities.

3.1.1 *Mobilization and UST Preparation*

Equipment to prepare for removal of the USTs was mobilized to the project site by PARC on July 9, 2012. On July 10, 2012, the tops of the USTs were uncovered with subsequent excavation of soil from around the USTs revealing two (2) straight-sided concrete USTs, each measuring approximately 7 feet high by 21½ feet long by 7½ feet in width. Each UST was observed to have a 2½-foot square, open port at the top center and a 2- to 3-inch diameter open pipe fitting (pipes cut off) on either end of the top of each UST. The USTs were observed to be filled to the top with oily fluid.

Based on historic use (in the 1940s and 50s) of the site, the USTs are Bunker C fuel oil tanks associated with the former military boiler room at this location. The oily fluid is primarily water with residual fuel oil. A sample was collected for analysis to characterize the fluid for disposal purposes (see Section 5.5). The top and sides of each tank appeared to be in good condition and no holes, cracks or signs of leakage were observed in the tank walls, however oil-stained soil was observed near the tops

and on the western sides of the tanks – primarily in the southwest quadrant of the UST excavation pit.

Five 2- to 3-inch diameter pipes, 2 or 3 of which appeared to contain a viscous oily fluid, were observed leading northward together from the northwest corner of the UST excavation. The pipes were roughly horizontal, all within a 3 foot area, at about 2 feet below the surface grade. The open ends of the pipes were sealed with plastic to minimize the spread of contaminants and bent upward out of the excavation pit until their subsequent removal (see Section 5.4).

3.1.2 *Permitting*

PARC developed a UST Closure Plan for the removal of the USTs at the subject property and submitted the application to Mr. Rob Weston of the Alameda County Department of Environmental Health, Division of Hazardous Materials (ACDEH). Permit approval was granted by the ACDEH on August 17, 2012. Per Mr. Jack Cook of PARC, the Alameda County Fire District indicated that due to the planned in-place demolition of the tanks, a permit from the Fire Department was not required.

3.1.3 *UST Pumping*

On August 22, 2012, approximately 7,965 gallons of liquid (water with Bunker C fuel oil) and 550 gallons of solids (sludge) were pumped out of the USTs by Evergreen Environmental Services using a vacuum truck. The liquid was transported for disposal to Evergreen's Newark, California Treatment Storage and Disposal facility (See Section 5.5 and Appendix B).

3.2 *UST Removal*

On August 24, 2012, the two concrete USTs were broken into pieces and removed from the ground using an excavator. The concrete debris generated from the UST removal was stockpiled on visqueen at the site for later characterization and proper disposal.

Visual and olfactory indications of contaminated soil were noted during the tank removal activities and excavated soil was stockpiled on visqueen at the site for sampling and disposal (see Section 5.5). Segregation of soil was performed during excavation by stockpiling obviously contaminated soil in separate stockpiles from soil that did not appear to be contaminated.

The resultant UST excavation pit measured about 25 feet wide (north-south), 30 feet long (east-west) and 14 feet deep. There was a smaller area (about 10 ft. wide by 8 ft. long by 3 ft. deep) at the northwest corner of the pit where the 5 pipes led north, away from the former USTs. Groundwater was not encountered during tank removal. Based on boring logs from soil borings performed at the site in 2001 and 2004 near (within 300 feet of) the USTs, groundwater is expected to be approximately 42 to 45 feet below the ground surface.

3.3 Post-UST Removal Activities

The following sections provide a summary of tasks performed following removal of the USTs.

3.3.1 Initial Soil Sample Collection

On August 27, 2012, four soil samples were taken from the bottom of the UST excavation pit - from beneath each end of each UST at a depth of about 14 feet below ground surface (bgs). Due to the depth of the pit, the samples were taken using the bucket of the excavator and collected from the bucket with hand sampling equipment. The sampling equipment was decontaminated between samples to minimize the possibility of cross-contamination between samples.

Based on apparent contamination present in the 14-foot samples, two small trenches were excavated within the tank pit to a depth of 17 feet bgs. Based on the absence of obvious contamination at the 17-foot depth, 2 additional soil samples (TP-CTR-17' and TP-E-17') were collected to attempt to evaluate the vertical extent of petroleum hydrocarbon impacted soil. The approximate soil sample collection locations are presented in Figure 2.

PSI also collected discrete and composite soil samples from the several stockpiles generated during UST removal (see Figure 3 for sample locations). The discrete and composite samples were analyzed for waste disposal characterization purposes. Based on the laboratory results, all of the stockpiled soil, with the exception of Stockpile C-3, was designated for off-site disposal.

Soil samples were collected into new stainless steel tubes driven into the soil in the excavator bucket. A summary of general soil sampling procedures is provided in Appendix A. The soil samples collected were labeled and placed in a chilled ice chest for transport to the analytical laboratory with chain-of-custody documentation. Mr. Barney Chan of the ACDEH was present for the collection of the soil samples from the UST pit.

4.0 INITIAL CHEMICAL ANALYSIS AND RESULTS

4.1 Analytical Methodology

The ACDEH requested the following analysis be performed on the soil samples.

- Total Petroleum Hydrocarbons as Diesel (TPH-D) using EPA Method 8015.
- Select volatile organic constituents (VOCs) - benzene, toluene, ethylbenzene, xylenes, 1,2-Dibromoethane, 1,2-Dichloro-ethane, di-isopropyl ether, ethyl tert-butyl ether, methyl tert-butyl ether, tert-amyl methyl ether and tert-butyl alcohol - using EPA Method 8260.

Additionally, TPH as Motor Oil (TPH-MO) was run on the 14-foot samples using EPA Method 8015 - required by the landfill to characterize the soil for planned disposal at a later time.

4.2 Analytical Results

The results of the analyses from of the soil samples collected from the UST excavation at 14 feet bgs indicate the following:

- TPH-D concentrations ranged from 720 to 11,000 milligrams per kilogram (mg/kg).
- TPH-MO concentrations ranged from 2,600 to 15,000 mg/kg.
- Ethylbenzene and xylenes were the only VOCs detected at or above their respective laboratory reporting limit. The ethylbenzene and xylene concentrations detected were all between 0.022 and 0.0276 mg/kg.

The results indicate that heavy hydrocarbons (represented as TPH-D and TPH-MO) are the primary contaminants of concern for the site. VOCs were only detected in 2 of the 6 soil samples, in which only 2 VOCs were detected; both at relatively low concentrations. A summary of the soil analytical results is presented in Tables 1 and 2. A copy of the laboratory reports and chain-of-custody record are included in Appendix C.

The results for the 14-foot soil samples were compared to the Regional Water Quality Control Board Environmental Screening Levels (ESLs) for commercial/industrial land use with impact to deep soil where groundwater is a drinking water resource. Due to the expected deep groundwater (greater than 40 feet) at the site and the future use of the site as a parking lot for the future ECHOJ, the gross contamination ESL was used. The gross contamination ESL for TPH-D and TPH-MO (residual fuels) is 5,000 mg/kg. A copy of the ESL comparison table for TPH-D and TPH-MO is presented in Appendix D. The concentrations of contamination in 2 of the soil samples collected from the UST excavation at 14 feet bgs were above the ESL of 5,000 mg/kg. The ethylbenzene and xylenes concentrations were well below their respective ESLs.

The results from the soil samples collected from the UST excavation at 17 feet bgs were significantly lower than the concentrations in the samples from 14 feet, indicating that TPH-D concentrations decrease significantly with depth and that over-excavation may remove petroleum hydrocarbon impacted soil to concentrations below ESLs.

5.0 OVER-EXCAVATION PROCEDURES

Based on the initial analytical results described above, it was decided to return to the site and continue the excavation of contaminated soil from the UST pit. The field activities completed for the removal of additional contaminated soil are summarized in the following sections.

5.1 Pre-Soil Removal Activities

Following receipt of the initial soil analytical results, they were forwarded to Mr. Rob Weston of the ACDEH. Upon review of the results, Mr. Weston stated that, since there appears to have been a release from the concrete tanks, the case was being transferred for investigation to the LOP and that an unauthorized release report needed to be filed with the ACDEH. Mr. Rod Freitag of the ACGSA filed the unauthorized release report on September 24, 2012. On September 28, 2012, PSI informed the ACGSA of the planned over-excavation of the UST pit to remove residual TPH - impacted soil.

5.2 Soil Removal and Sampling

On October 9 and 10, 2012, PARC completed the over excavation of the soil with an excavator. PARC excavated to approximately 17 feet bgs on the east side of the UST excavation and, because of the apparent presence of deeper levels of contaminated soil on the west side of the excavation, to 20 feet bgs on the west side. Following excavation, residual impact was visually identified only on the west side wall. The west side wall could not be further excavated due to site restrictions.

On October 9, 10, and 19, 2012, four soil samples were taken from the bottom of the UST excavation pit (at locations corresponding to each end of the former USTs) at a depth of about 17 and 20 feet bgs on the east and west sides of the pit, respectively. Due to the depth of the pit, the samples were again taken using the bucket of the excavator and collected from the bucket with hand sampling equipment using standard sampling and decontamination protocol. Four additional samples were collected, 1 from each wall of the UST excavation pit, at levels just below the bottom of the former USTs (12 to 15 feet bgs).

The soil samples were collected into new stainless steel tubes driven into the soil the excavator bucket. A summary of general soil sampling procedures is provided in Appendix A. The soil samples collected were labeled and placed in a chilled ice chest for transport to the analytical laboratory with chain-of-custody documentation.

5.3 Excavation Backfill

Following the over-excavation of soil from the UST pit, soil from another area of the site and clean stockpiled soil from the excavation (stockpile C-3) was used to backfill the excavation on October 18, 19, 23 and 25, 2012.

5.4 Piping Removal and Soil Sampling

The 5 pipes observed leading northward away from the northwest corner of the former UST excavation pit, were uncovered on October 29, 2012. During this excavation, it was observed that all 5 pipes ran north from the UST pit into an east-west oriented concrete wall or footing, located about 10 feet north of the north edge of the pit. All of the pipes were discovered to be cut off at about 1 foot beyond (north of) the concrete footing. An excavator was used to break up the concrete footing and remove the pipes.

After removal of the pipes, a soil sample was collected from beneath the former location of the pipes at a depth of about 6 feet bgs (about 2 feet below the bottom of the former pipes). The soil sample was collected into a new stainless steel tube driven into the soil beneath the former piping run in accordance with PSIs general soil sampling procedures (see Appendix A). The soil samples collected were labeled and placed in a chilled ice chest for transport to the analytical laboratory with chain-of-custody documentation.

5.5 *Liquid, Concrete and Soil Disposal*

During tank removal activities, 8,515 gallons of oily water and sludge were generated. The liquid and sludge were removed by Evergreen Environmental Services on August 22, 2012 and transported to Evergreen Oil Inc. in Newark, California. Please refer to Appendix B for a copy of the disposal certification.

Approximately 50 tons of concrete debris, derived from the demolition of the USTs, was transported to the Vasco Road Landfill in Livermore, California for disposal. Approximately 790 tons of petroleum hydrocarbon contaminated soil was removed from the excavation and transported to the Vasco Road Landfill in Livermore, California for disposal. Please refer to Appendix B for a copy of the disposal certification.

Piping generated during the UST removal activities was taken to DC Metals, Inc. for recycling. Please refer to Appendix B for a copy of the disposal certification.

6.0 OVER-EXCAVATION ANALYSIS AND RESULTS

6.1 *Analytical Methodology*

The ACDEH requested the following analysis be performed on the soil samples.

- Total Petroleum Hydrocarbons as Diesel (TPH-D) using EPA Method 8015.
- Select volatile organic constituents (VOCs) - benzene, toluene, ethylbenzene, xylenes, 1,2-Dibromoethane, 1,2-Dichloro-ethane, di-isopropyl ether, ethyl tert-butyl ether, methyl tert-butyl ether, tert-amyl methyl ether and tert-butyl alcohol - using EPA Method 8260.

Additionally, since significant concentrations of TPH-MO had been detected in previous analyses, testing for TPH-MO using EPA Method 8015 was also performed.

6.2 *Analytical Results*

The results of the soil analyses from samples collected from the final excavation indicate the following:

- TPH-D concentrations were not detected at or above their respective laboratory detection limit in all but 3 of the soil samples, which had TPH-D concentrations of between 240 and 760 mg/kg.

- TPH-MO concentrations were not detected at or above their respective laboratory detection limit in all but 5 of the soils samples, which had TPH-MO concentrations ranging from 32 mg/kg to 4,100 mg/kg.
- VOCs were not detected at or above their respective laboratory detection limit in any of the soil samples.

The results for the soil samples collected from the excavation were compared to the Regional Water Quality Control Board Environmental Screening Levels (ESLs) for commercial/industrial land use with impact to deep soil where groundwater is a drinking water resource. None of the soil samples had concentrations greater than their gross contamination ESL.

A summary of the soil analytical results is presented in Table 1. A copy of the laboratory reports and chain-of-custody records are included in Appendix C.

7.0 CONCLUSIONS

The following conclusions are based on the field observations and analytical results presented in this report.

- Petroleum hydrocarbon staining and odor were noted in the soil during the initial removal of the USTs, primarily in the southwest quadrant of the base of the UST excavation.
- No holes or cracks in the walls of the USTs were observed when the USTs were removed.
- Groundwater was not encountered during the removal of the USTs and, based on depth to groundwater from borings drilled at the subject property, is anticipated to be greater than 40 feet bgs.
- TPH-D and TPH-MO impacted soil above the ESL was noted in the initial sampling. However, after over excavation to between 17 and 20 feet bgs, residual TPH-D and TPH-MO concentrations are below the ESL.

8.0 RECOMMENDATIONS

PSI recommends that the site be considered for no further action associated with the former USTs based on the following factors:

- Removal of the USTs and over-excavation constitutes removal of the source of contamination.
- Soil beneath the USTs was removed to below the ESLs.
- No groundwater was encountered (expected at greater than 40 feet bgs).
- VOCs were not detected in any of the final confirmation samples.

FIGURES

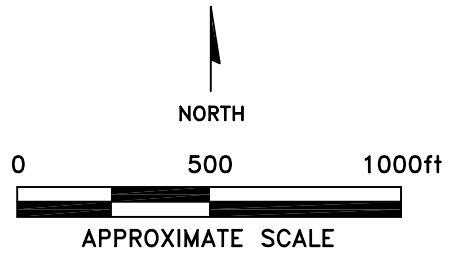
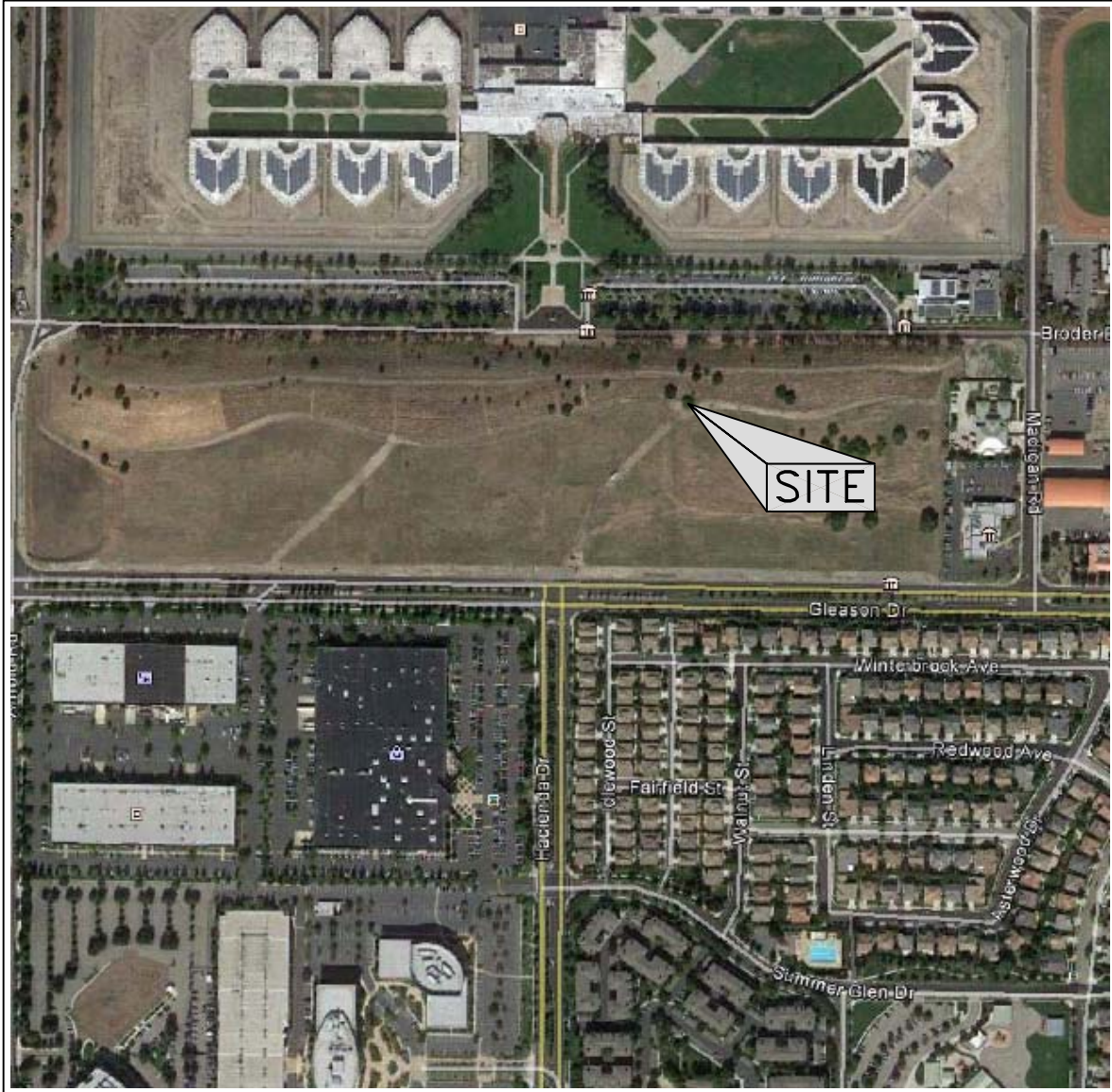

REFERENCE:
 AERIAL PHOTOGRAPHY
 FROM GOOGLE EARTH,
 IMAGE DATED 10/11/2011.

 Information To Build On <i>Engineering • Consulting • Testing</i>		4703 Tidewater Avenue, Suite B Oakland, California 94601 (510) 434-9200			
Project Name: EAST COUNTY HALL OF JUSTICE GLEASON DR. & HACIENDA DR., DUBLIN, CALIFORNIA		Drawn By: S.R.	Date: 12/12	File No.: 443-1-1	1
Title: SITE LOCATION MAP		Approved By: B.B.	Project No.: 575-443-1		

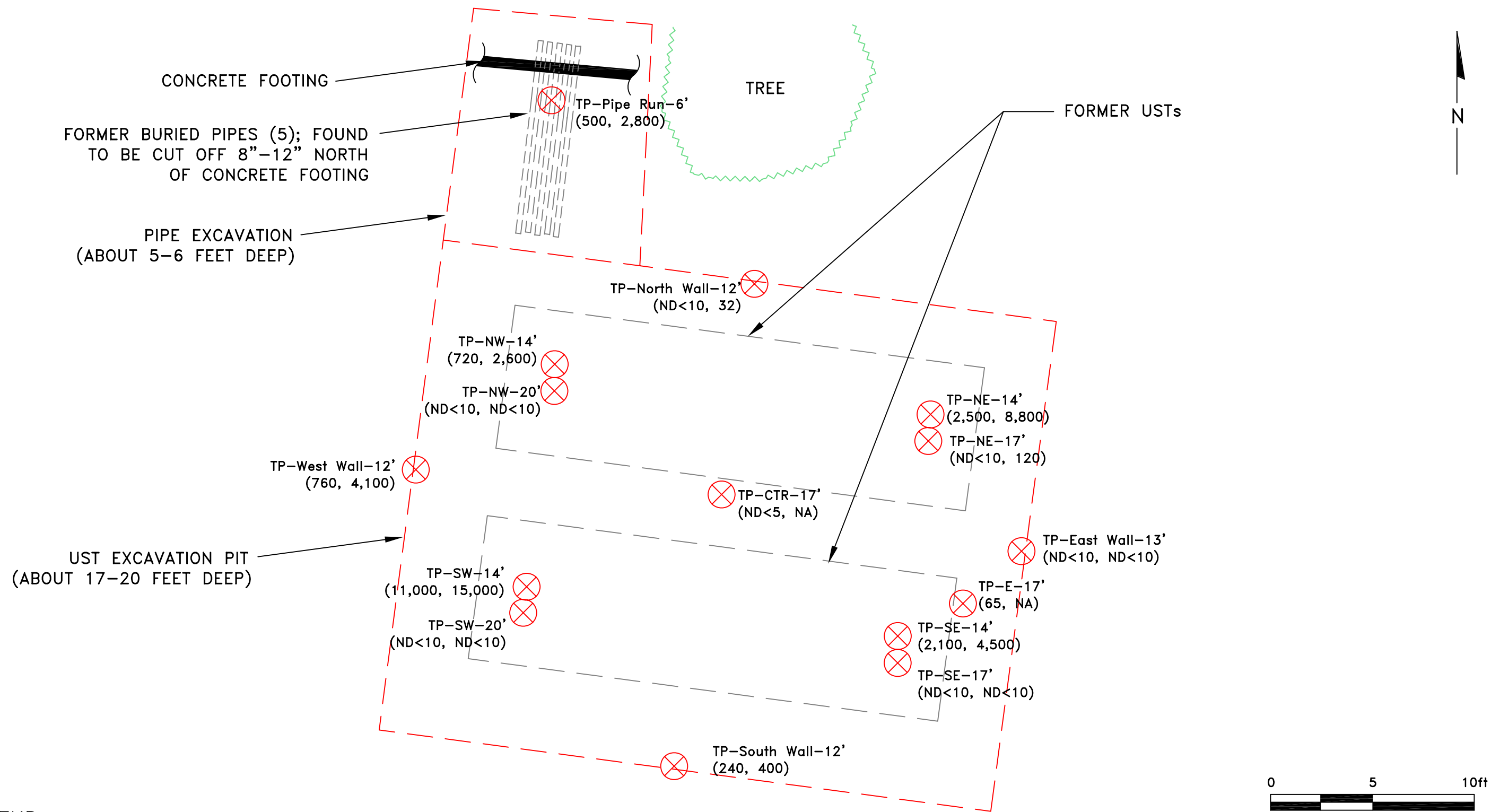

LEGEND

⊗ TP-NW-20' (ND<10, ND<10) - APPROXIMATE SOIL SAMPLE LOCATION, SAMPLE ID AND DEPTH (TPH-D AND TPH-MO CONCENTRATIONS GIVEN IN mg/kg)

NOTES

1. MAP DISTANCES ARE BASED ON FIELD MEASUREMENTS AND ARE APPROXIMATE IN NATURE. THIS IS NOT A SURVEY.
2. ND INDICATES NOT DETECTED ABOVE LAB REPORTING LIMIT SHOWN.
3. NA INDICATES NOT ANALYZED.

Information To Build On Engineering • Consulting • Testing		4703 Tidewater Avenue, Suite B Oakland, California 94601 (510) 434-9200		
Project Name: EAST COUNTY HALL OF JUSTICE GLEASON DR. & HACIENDA DR., DUBLIN, CALIFORNIA	Drawn By: B.B.	Date: 12/12	File No.: 443-1-2	Figure No.: 2
Title: EXCAVATION PIT SAMPLE RESULTS	Approved By: F.P.	Project No.: 575-443-1		

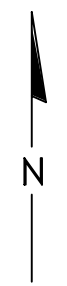
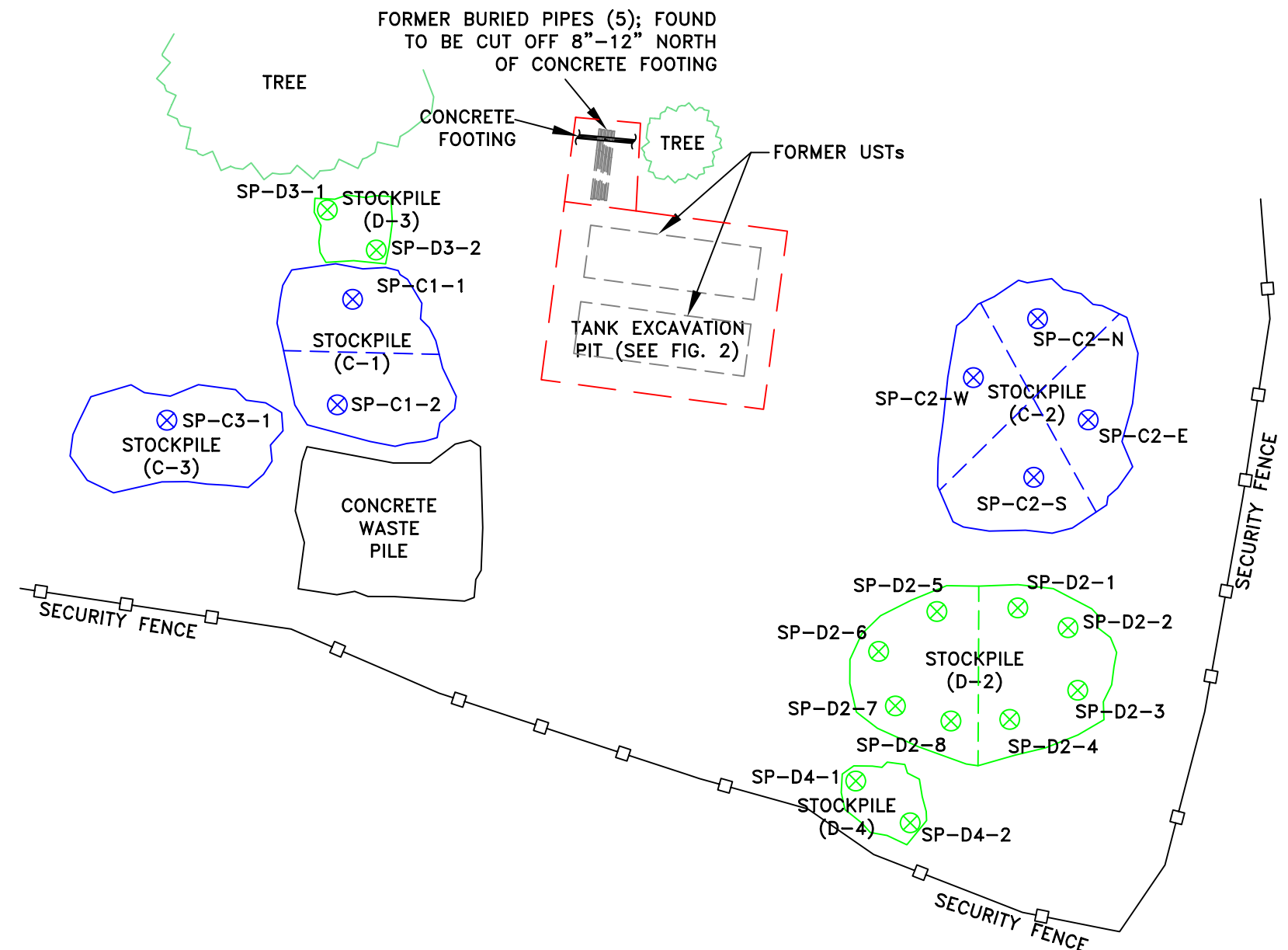

LEGEND

SP-XX-XX - APPROXIMATE STOCKPILE SOIL SAMPLE LOCATION AND SAMPLE ID (8/27/12)

STOCKPILE DATA

- C-1 - APPROX. 50 CU. YDS.
- C-2 - APPROX. 100 CU. YDS.
- C-3 - APPROX. 25 CU. YDS.
- D-1 - APPROX. 50 CU. YDS.
- D-2 - APPROX. 100 CU. YDS.
- D-3 - APPROX. 10 CU. YDS.
- D-4 - APPROX. 10 CU. YDS.

NOTES

MAP DISTANCES AND VOLUMES ARE BASED ON FIELD MEASUREMENTS AND ARE APPROXIMATE IN NATURE. THIS IS NOT A SURVEY.

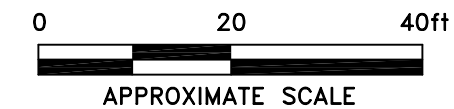
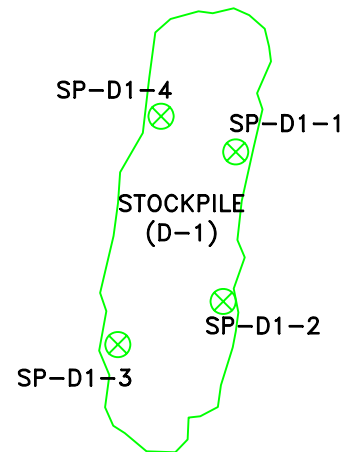

Information To Build On Engineering • Consulting • Testing	4703 Tidewater Avenue, Suite B Oakland, California 94601 (510) 434-9200			
	Project Name: EAST COUNTY HALL OF JUSTICE GLEASON DR. & HACIENDA DR., DUBLIN, CALIFORNIA	Drawn By: B.B.	Date: 12/12	File No.: 443-1-3
Title: STOCKPILE SAMPLING MAP	Approved By: F.P.	Project No.: 575-443-1		

TABLES

TABLE 1
EXCAVATION PIT SOIL SAMPLE RESULTS

EAST COUNTY HALL OF JUSTICE
GLEASON DRIVE AND HACIENDA DRIVE, DUBLIN, CALIFORNIA

Sample ID	Date	TPH-D (mg/kg)	TPH-MO (mg/kg)	VOCs* (ug/kg)
TP-NW-14'	8/27/2012	720	2,600	ND
TP-SW-14'		11,000	15,000	ethylbenzene - 22 total xylenes - 22.8 all others - ND
TP-NE-14'		2,500	8,800	ND
TP-SE-14'		2,100	4,500	ethylbenzene - 25 total xylenes - 27.6 all others - ND
TP-CTR-17'		ND<5		ND
TP-E-17'		65		ND
TP-NW-20'		10/9/2012	ND<10	ND<10
TP-SW-20'	ND<10		ND<10	ND
TP-NE-17'	ND<10		120	ND
TP-SE-17'	ND<10		ND<10	ND
TP - East Wall - 13'	ND<10		ND<10	ND
TP - South Wall - 15'	10/10/2012	240	400	ND
TP - North Wall - 12'	10/19/2012	ND<10	32	ND
TP - West Wall - 12'		760	4,100	ND
PIPE RUN-6'	10/29/2012	500	2,800	ND

Notes:

* - VOCs list includes only benzene, toluene, ethylbenzene, xylenes, methyl-tert-butyl ether, tert-amyl methyl ether, ethyl-tert-butyl ether, di-isopropyl ether, tert-butyl alcohol, ethanol, 1,2-dibromoethane and 1,2-dichloroethane.

ND - Not detected above lab reporting limit indicated (or as indicated in lab report).

TABLE 2
STOCKPILE SOIL SAMPLE RESULTS
 EAST COUNTY HALL OF JUSTICE
 GLEASON DRIVE & HACIENDA DRIVE, DUBLIN, CALIFORNIA

Sample ID	Type	Date	TPH-D (mg/kg)	TPH-MO (mg/kg)	VOCs* (ug/kg)
SP-C1-1	Discrete	8/27/2012	290	1,700	ND
SP-C1-2	Discrete		590	5,900	ND
SP-C2-N	Discrete		290	1,400	ND
SP-C2-S	Discrete		180	790	ND
SP-C2-E	Discrete		430	2,700	ND
SP-C2-W	Discrete		160	1,200	ND
SP-C3-1	Discrete		29	130	ND
SP-D1-1 thru 4	Composite		680	4,300	ND
SP-D2-1 thru 4	Composite		4,900	8,200	ethylbenzene - 5.6 all others - ND
SP-D2-5 thru 8	Composite		5,400	9,200	ND
SP-D3-1 and 2	Composite		56	870	ND
SP-D4-1 and 2	Composite		490	2,300	ND

Notes:

* - VOCs list includes only benzene, toluene, ethylbenzene, xylenes, methyl-tert-butyl ether, tert-amyl methyl ether, ethyl-tert-butyl ether, di-isopropyl ether, tert-butyl alcohol, ethanol, 1,2-dibromoethane and 1,2-dichloroethane.

ND - Not detected above lab reporting limit (see lab report).

APPENDIX A
PSI FIELD PROCEDURES

FIELD PROCEDURES

I. DRILLING OF SOIL SAMPLES

The following procedures were used for the sampling of soil at the site:

1. Soil samples were collected using a stainless steel trowel into a 2.0-inch diameter stainless steel tube. Once the sample was collected, the ends of the sample tube were covered with Teflon sheets and capped with polyethylene end caps. The sample was labeled and placed in a chilled cooler pending delivery to the laboratory for analysis.
2. Soil samples were assigned identification numbers such as S-1, where S indicates the sample as being collected from soil and -1 indicates that the numeric order of sampling. The sample was labeled with the sampling designation, date, client name, and project number.
3. Soil sampler was washed before and after soil sampling with Alconox soap followed by two deionized-water rinses.
4. Chain-of-custody procedures using chain-of-custody forms were used to document sample handling and transportation.

APPENDIX B
DISPOSAL CERTIFICATES

**** Generator, Mail a copy to: DTSC P.O. Box 400 Sacramento, Ca. 95812-0400 within 30 days. ****

Please print or type. (Form designed for use on elite (12-pitch) typewriter.)

Form Approved. OMB No. 2050-0039

UNIFORM HAZARDOUS WASTE MANIFEST		1. Generator ID Number <i>MI 002 611 476</i>	2. Page 1 of <i>1</i>	3. Emergency Response Phone <i>1-800-424-9300</i>		4. Manifest Tracking Number 007036060 JJK					
		5. Generator's Name and Mailing Address <i>ALAMEDA COUNTY 630 1401 COLLEGE DR RD 115 ALAMEDA CA 94533</i>			Generator's Site Address (if different than mailing address) <i>ALAMEDA HAZARDOUS OR ALAMEDA CA 94533</i>				Generator's Phone: <i>510-765-1522</i>		6. Transporter 1 Company Name EVERGREEN ENVIRONMENTAL SERVICES
7. Transporter 2 Company Name		U.S. EPA ID Number		8. Designated Facility Name and Site Address Evergreen Oil, Inc. 3850 Smith Ave. Newark, Ca. 94560 510-765-4400		U.S. EPA ID Number QAD980867418					
9a. HM	9b. U.S. DOT Description (including Proper Shipping Name, Hazard Class, ID Number, and Packing Group (if any))			10. Containers No. Type		11. Total Quantity	12. Unit Wt./Vol.	13. Waste Codes			
1.	<i>NON-FLAMMABLE LIQUID (FULL WATER)</i>			<i>01 TT</i>		<i>3165</i>	<i>G</i>	<i>201 203</i>			
2.											
3.											
4.											
14. Special Handling Instructions and Additional Information <i>201</i> <i>203</i> <i>W003K2492</i>											
15. GENERATOR'S/OFFEROR'S CERTIFICATION: I hereby declare that the contents of this consignment are fully and accurately described above by the proper shipping name, and are classified, packaged, marked and labeled/placarded, and are in all respects in proper condition for transport according to applicable international and national governmental regulations. If export shipment and I am the Primary Exporter, I certify that the contents of this consignment conform to the terms of the attached EPA Acknowledgment of Consent. I certify that the waste minimization statement identified in 40 CFR 262.27(a) (if I am a large quantity generator) or (b) (if I am a small quantity generator) is true.											
Generator's/Offeror's Printed/Typed Name <i>Rudolf Kitzke for ALAMEDA COUNTY</i>					Signature <i>[Signature]</i>			Month Day Year <i>8 22 12</i>			
16. International Shipments <input type="checkbox"/> Import to U.S. <input type="checkbox"/> Export from U.S. Port of entry/exit: _____ Date leaving U.S.: _____											
17. Transporter Acknowledgment of Receipt of Materials											
Transporter 1 Printed/Typed Name <i>Fred Okina</i>					Signature <i>[Signature]</i>			Month Day Year <i>8 22 12</i>			
Transporter 2 Printed/Typed Name					Signature			Month Day Year			
18. Discrepancy											
18a. Discrepancy Indication Space <input type="checkbox"/> Quantity <input type="checkbox"/> Type <input type="checkbox"/> Residue <input type="checkbox"/> Partial Rejection <input type="checkbox"/> Full Rejection											
18b. Alternate Facility (or Generator) U.S. EPA ID Number											
18c. Signature of Alternate Facility (or Generator) Month Day Year											
19. Hazardous Waste Report Management Method Codes (i.e., codes for hazardous waste treatment, disposal, and recycling systems)											
1.	2.	3.	4.								
20. Designated Facility Owner or Operator: Certification of receipt of hazardous materials covered by the manifest except as noted in Item 18a											
Printed/Typed Name					Signature			Month Day Year			

****Generator, Mail a copy to: DTSG P.O. Box 400 Sacramento, Ca. 95812-0400 within 90 days.****

Please print or type. (Form designed for use on elite (12-pitch) typewriter.)

Form Approved, OMB No. 2050-0039

UNIFORM HAZARDOUS WASTE MANIFEST		1. Generator ID Number ARC 002692478	2. Page 1 of 1	3. Emergency Response Phone 1-800-424-9300	4. Manifest Tracking Number 007036061 JJK			
5. Generator's Name and Mailing Address ALAMEDA COUNTY SWP 1401 CALIFORNIA DR., ROOM 415 OAKLAND, CA			Generator's Site Address (if different than mailing address) EVERGREEN OIL SERVICES 510-228-1522					
6. Transporter 1 Company Name EVERGREEN ENVIRONMENTAL SERVICES			U.S. EPA ID Number QAD982413292					
7. Transporter 2 Company Name			U.S. EPA ID Number					
8. Designated Facility Name and Site Address Evergreen Oil, Inc. 8840 Smith Ave. Newark, Ca. 94500			U.S. EPA ID Number QAD980887416					
Facility's Phone: 510-795-4400								
9a. HM	9b. U.S. DOT Description (including Proper Shipping Name, Hazard Class, ID Number, and Packing Group (if any))	10. Containers		11. Total Quantity	12. Unit Wt./Vol.	13. Waste Codes		
		No.	Type					
1.	HAZARDOUS WASTE LIQUID (OIL/WASTE)	01	TT	5350	G	221	223	
2.								
3.								
4.								
14. Special Handling Instructions and Additional Information W00352541 P00034								
15. GENERATOR'S/OFFEROR'S CERTIFICATION: I hereby declare that the contents of this consignment are fully and accurately described above by the proper shipping name, and are classified, packaged, marked and labeled/placarded, and are in all respects in proper condition for transport according to applicable international and national governmental regulations. If export shipment and I am the Primary Exporter, I certify that the contents of this consignment conform to the terms of the attached EPA Acknowledgment of Consent. I certify that the waste minimization statement identified in 40 CFR 262.27(a) (if I am a large quantity generator) or (b) (if I am a small quantity generator) is true.								
Generator's/Offoror's Printed/Typed Name Rob Fleitag For Alameda County			Signature <i>[Signature]</i>		Month 8	Day 22	Year 12	
16. International Shipments <input type="checkbox"/> Import to U.S. <input type="checkbox"/> Export from U.S. Port of entry/exit: _____ Date leaving U.S.: _____								
17. Transporter Acknowledgment of Receipt of Materials								
Transporter 1 Printed/Typed Name James R. [Signature]			Signature <i>[Signature]</i>		Month 8	Day 22	Year 12	
Transporter 2 Printed/Typed Name			Signature		Month	Day	Year	
18. Discrepancy								
18a. Discrepancy Indication Space <input type="checkbox"/> Quantity <input type="checkbox"/> Type <input type="checkbox"/> Residue <input type="checkbox"/> Partial Rejection <input type="checkbox"/> Full Rejection								
18b. Alternate Facility (or Generator)				Manifest Reference Number:				
Facility's Phone:				U.S. EPA ID Number				
18c. Signature of Alternate Facility (or Generator)						Month	Day	Year
19. Hazardous Waste Report Management Method Codes (i.e., codes for hazardous waste treatment, disposal, and recycling systems)								
1.	2.	3.	4.					
20. Designated Facility Owner or Operator: Certification of receipt of hazardous materials covered by the manifest except as noted in Item 18a								
Printed/Typed Name			Signature		Month	Day	Year	

**Vasco Road Landfill**4001 N Vasco Rd
Livermore, CA 94551**INVOICE (cont.)**

PARC SERVICES INC

Invoice Date	10/15/2012
Invoice No	013472
Customer No	021549
Site No	0000
Page No	9 of 9
Due Date	11/14/2012

Date	Code	Description	Reference	Quantity	Amount
10/15	Z8	ADMINISTRATION FEE	284	1.00	1.92
----- Material Summary -----					
		SW-CONT SOIL-ALT DAILY COVER			
		SW-CONST DEBRIS <i>CONCRETE</i>		775.89	17,069.58
		ENVIRONMENTAL FEE		50.28	2,916.24
		FUEL RECOVERY FEE		41.00	410.00
				41.00	839.41
Total Current Charges =====>					\$21,237.15



Vasco Road Landfill
 4001 N Vasco Rd
 Livermore, CA 94551



INVOICE

Invoice Date 10/31/2012
 Invoice No 013633
 Customer No 021549
 Site No 0000
 Page No 1 of 2
 Due Date 11/30/2012

PARC SERVICES INC
 253 RICKENBACKER CIR, STE. B
 LIVERMORE, CA 94551

RECEIVED
 NOV 13 2012

Current Charges	Total Amount Due
\$515.72	\$21,752.87

BY: P.O. 5366

Please Pay Total Amount Due

Billing Questions? Call 925-458-9800 X14

For account inquiries, please call (925) 458-9800.
Accounts with balances over 30 days past due will incur a 1.5% late fee charge.

Date	Code	Description	Reference	Quantity	Amount
10/15		Balance forward			21,237.15
10/18	VI	SW-CONT SOIL-ALT DAILY COVER	208489	14.08	309.76
10/18	VI	Vehicle: YAH2			
10/18	VI	Contract: 38501216531 ✓			
10/18	{}	ENVIRONMENTAL FEE	208489	1.00	10.00
10/18	{}	Vehicle: YAH2			
10/18	{}	Contract: 38501216531 ✓			
10/18	}1	FUEL RECOVERY FEE	208489	1.00	13.01
10/18	}1	Vehicle: YAH2			
10/18	}1	Contract: 38501216531 ✓			
10/30	YB	SW-CONST DEBRIS	210230	2.83	164.14
10/30	YB	Vehicle: CK111			
10/30	YB	Contract: 38501216531 ✓			
10/30	{}	ENVIRONMENTAL FEE	210230	1.00	10.00
10/30	{}	Vehicle: CK111			
10/30	{}	Contract: 38501216531 ✓			

PAYMENT OK	DATE 11/16/12	INITIALS OK
ACCT. NO. 42100-57200		
DATE PAID	CHECK NO.	

ACCOUNT STATUS

\$21,752.87	0.00	0.00	0.00	\$21,752.87
-------------	------	------	------	-------------

↓ ↓ Please return the portion below with your payment. Do not attach check to stub. ↓ ↓



Vasco Road Landfill
 4001 N Vasco Rd
 Livermore, CA 94551

Invoice Date 10/31/2012
 Invoice No 013633
 Customer No 021549
 Site No 0000

Current Charges: \$515.72
Total Amount Due: \$21,752.87

Amount Paid: _____

Please check if address has changed, and indicate change(s) on reverse side or call phone number above.

Please write your account number on your check and make payable to:

Please Return Payment To: Vasco Road Landfill
 File 749313
 Los Angeles, CA 90074-9313

PARC SERVICES INC
 253 RICKENBACKER CIR, STE. B
 LIVERMORE, CA 94551



DC Metals, Inc.
 2399 Davis Street
 San Leandro, CA 94577
 (510) 569-2255

Weighmaster Certificate



RC - 14089
Cert #
173100
Consumer

Customer PARC Services 12:09 PM Date 10/30/2012
 Street 253 Rickenbacker Circle Suite
 City: Livermore State: CA Zip 94551 Paid Cash 0

WeighDate: 10/30/2012

Commodity	Gross:	Tare:	Net:	ADJ:	Price:	UM:	Amount:
Iron Unprepared	10000	8860	1140	0	\$0.0600	Lbs	\$68.40
Total							\$68.40

Customer Signature: _____ 654465

I hereby state that I am the lawful owner of the material described hereon, that I have the right to sell same, and that for payment received in full, hereby acknowledged, I sell and convey title of same to DC Metals, Inc.
 Furthermore I state this material is not stolen.

WEIGHMASTER CERTIFICATE

THIS IS TO CERTIFY: that the following described commodity was weighed, measured, or counted by a weighmaster, whose signature is on this certificate, who is a recognized authority of accuracy, as prescribed by Chapter 7 (commencing with Section 12700) of Division 5 of the California Business and Professions Code administered by the Division of Measurement Standards of the California Department of Food and Agriculture.

(SW) Segregated by Weight
 (SC) Segregated by Count
 (CO) Comingled

Source Docs:

Deputy Weighmaster

Ray Cherry

Drawer: 1

License Plate:

State CA

10/30/12

8/8

Please print or type. (Form designed for use on elite (12-pitch) typewriter.) **Generator, mail a copy to : DTSC, P.O. Box 400, Sacramento, CA 95812-0400 within 30 days** Form Approved. OMB No. 2050-0039

UNIFORM HAZARDOUS WASTE MANIFEST 1. Generator ID Number CAC002692478 2. Page 1 of 1 3. Emergency Response Phone 1-800-424-9300 4. Manifest Tracking Number 009443745 JJK

5. Generator's Name and Mailing Address ALAMEDA COUNTY GSA 1401 LAKESIDE DR STE 1115 OAKLAND, CA 94612 Generator's Phone: 510-208-9522 Generator's Site Address (if different than mailing address) HACIENDA DR, BLEASON DR DUBLIN, CA

6. Transporter 1 Company Name EVERGREEN ENVIRONMENTAL SERVICES PARC Services U.S. EPA ID Number CAR000164745

7. Transporter 2 Company Name U.S. EPA ID Number

8. Designated Facility Name and Site Address EVERGREEN OIL, INC. 6880 SMITH AVE. NEWARK, CA 94560 Facility's Phone: 510-705-4400 U.S. EPA ID Number CAD980887418

9a. HM	9b. U.S. DOT Description (including Proper Shipping Name, Hazard Class, ID Number, and Packing Group (if any))	10. Containers		11. Total Quantity	12. Unit Wt./Vol.	13. Waste Codes	
		No.	Type				
1	NON-RCRA HAZARDOUS WASTE, LIQUID (OIL, WATER)	1	DM	200	P	223	
2							
3							
4							

14. Special Handling Instructions and Additional Information A. 805D4 ERG 171-8b1 Document # 136474

15. GENERATOR'S/OFFEROR'S CERTIFICATION: I hereby declare that the contents of this consignment are fully and accurately described above by the proper shipping name, and are classified, packaged, marked and labeled/placarded, and are in all respects in proper condition for transport according to applicable international and national governmental regulations. If export shipment and I am the Primary Exporter, I certify that the contents of this consignment conform to the terms of the attached EPA Acknowledgment of Consent. I certify that the waste minimization statement identified in 40 CFR 262.27(a) (if I am a large quantity generator) or (b) (if I am a small quantity generator) is true.

Generator's/Offero's Printed/Typed Name: ROD FREITAS FOR ALAMEDA COUNTY Signature: [Signature] Month: 10 Day: 30 Year: 12

16. International Shipments Import to U.S. Export from U.S. Port of entry/exit: Date leaving U.S.:

17. Transporter Acknowledgment of Receipt of Materials Transporter 1 Printed/Typed Name: WILFRIDO M. LUNA Signature: WILFRIDO LUNA RIANZANO Month: 10 Day: 30 Year: 12

18. Discrepancy 18a. Discrepancy Indication Space Quantity Type Residue Partial Rejection Full Rejection

18b. Alternate Facility (or Generator) Manifest Reference Number: U.S. EPA ID Number: Facility's Phone: 18c. Signature of Alternate Facility (or Generator) Month: Day: Year:

19. Hazardous Waste Report Management Method Codes (i.e., codes for hazardous waste treatment, disposal, and recycling systems) 1. H141 2. 3. 4.

20. Designated Facility Owner or Operator: Certification of receipt of hazardous materials covered by the manifest except as noted in Item 18a Printed/Typed Name: [Signature] Signature: [Signature] Month: 10 Day: 30 Year: 12

GENERATOR
INTL
TRANSPORTER
DESIGNATED FACILITY

APPENDIX C
LABORATORY REPORTS AND CHAIN-OF-CUSTODY
DOCUMENTS



25712 Commercentre Drive
Lake Forest, California 92630
949.297.5020 Phone
949.297.5027 Fax

12 October 2012

Brand Burfield
PSI -- Oakland
4703 Tidewater Ave Ste B
Oakland, CA 94601
RE: ECHOJ

Enclosed are the results of analyses for samples received by the laboratory on 10/10/12 10:45. If you have any questions concerning this report, please feel free to contact me.

Sincerely,

Wendy Hsiao
Project Manager

PSI -- Oakland
4703 Tidewater Ave Ste B
Oakland CA, 94601

Project: ECHOJ
Project Number: 575-443
Project Manager: Brand Burfield

Reported:
10/12/12 17:19

ANALYTICAL REPORT FOR SAMPLES

Sample ID	Laboratory ID	Matrix	Date Sampled	Date Received
TP-NW-20'	T121812-01	Soil	10/09/12 14:35	10/10/12 10:45
TP-SW-20'	T121812-02	Soil	10/09/12 15:20	10/10/12 10:45
TP-NE-17'	T121812-03	Soil	10/09/12 14:30	10/10/12 10:45
TP-SE-17'	T121812-04	Soil	10/09/12 14:25	10/10/12 10:45
TP-EAST WALL-13'	T121812-05	Soil	10/09/12 10:25	10/10/12 10:45

SunStar Laboratories, Inc.



The results in this report apply to the samples analyzed in accordance with the chain of custody document. This analytical report must be reproduced in its entirety.

Wendy Hsiao, Project Manager

PSI -- Oakland
4703 Tidewater Ave Ste B
Oakland CA, 94601

Project: ECHOJ
Project Number: 575-443
Project Manager: Brand Burfield

Reported:
10/12/12 17:19

TP-NW-20'
T121812-01 (Soil)

Analyte	Result	Reporting Limit	Units	Dilution	Batch	Prepared	Analyzed	Method	Notes
---------	--------	-----------------	-------	----------	-------	----------	----------	--------	-------

SunStar Laboratories, Inc.

Extractable Petroleum Hydrocarbons by 8015C

C13-C28 (DRO)	ND	10	mg/kg	1	2101017	10/10/12	10/10/12	EPA 8015C	
C29-C40 (MORO)	ND	10	"	"	"	"	"	"	
<i>Surrogate: p-Terphenyl</i>		82.0 %	65-135		"	"	"	"	

Volatile Organic Compounds by EPA Method 8260B

1,2-Dibromoethane (EDB)	ND	5.0	ug/kg	1	2101015	10/10/12	10/11/12	EPA 8260B	
1,2-Dichloroethane	ND	5.0	"	"	"	"	"	"	
Benzene	ND	5.0	"	"	"	"	"	"	
Toluene	ND	5.0	"	"	"	"	"	"	
Ethylbenzene	ND	5.0	"	"	"	"	"	"	
m,p-Xylene	ND	5.0	"	"	"	"	"	"	
o-Xylene	ND	5.0	"	"	"	"	"	"	
Tert-amyl methyl ether	ND	20	"	"	"	"	"	"	
Tert-butyl alcohol	ND	50	"	"	"	"	"	"	
Di-isopropyl ether	ND	20	"	"	"	"	"	"	
Ethyl tert-butyl ether	ND	20	"	"	"	"	"	"	
Methyl tert-butyl ether	ND	20	"	"	"	"	"	"	
Ethanol	ND	500	"	"	"	"	"	"	
<i>Surrogate: Toluene-d8</i>		112 %	85.5-116		"	"	"	"	
<i>Surrogate: 4-Bromofluorobenzene</i>		97.9 %	81.2-123		"	"	"	"	
<i>Surrogate: Dibromofluoromethane</i>		98.4 %	95.7-135		"	"	"	"	

SunStar Laboratories, Inc.

The results in this report apply to the samples analyzed in accordance with the chain of custody document. This analytical report must be reproduced in its entirety.



Wendy Hsiao, Project Manager

PSI -- Oakland 4703 Tidewater Ave Ste B Oakland CA, 94601	Project: ECHOJ Project Number: 575-443 Project Manager: Brand Burfield	Reported: 10/12/12 17:19
---	--	------------------------------------

TP-SW-20'
T121812-02 (Soil)

Analyte	Result	Reporting Limit	Units	Dilution	Batch	Prepared	Analyzed	Method	Notes
---------	--------	-----------------	-------	----------	-------	----------	----------	--------	-------

SunStar Laboratories, Inc.

Extractable Petroleum Hydrocarbons by 8015C

C13-C28 (DRO)	ND	10	mg/kg	1	2101017	10/10/12	10/10/12	EPA 8015C	
C29-C40 (MORO)	ND	10	"	"	"	"	"	"	
<i>Surrogate: p-Terphenyl</i>		80.8 %	65-135		"	"	"	"	

Volatile Organic Compounds by EPA Method 8260B

1,2-Dibromoethane (EDB)	ND	5.0	ug/kg	1	2101015	10/10/12	10/11/12	EPA 8260B	
1,2-Dichloroethane	ND	5.0	"	"	"	"	"	"	
Benzene	ND	5.0	"	"	"	"	"	"	
Toluene	ND	5.0	"	"	"	"	"	"	
Ethylbenzene	ND	5.0	"	"	"	"	"	"	
m,p-Xylene	ND	5.0	"	"	"	"	"	"	
o-Xylene	ND	5.0	"	"	"	"	"	"	
Tert-amyl methyl ether	ND	20	"	"	"	"	"	"	
Tert-butyl alcohol	ND	50	"	"	"	"	"	"	
Di-isopropyl ether	ND	20	"	"	"	"	"	"	
Ethyl tert-butyl ether	ND	20	"	"	"	"	"	"	
Methyl tert-butyl ether	ND	20	"	"	"	"	"	"	
Ethanol	ND	500	"	"	"	"	"	"	
<i>Surrogate: Toluene-d8</i>		112 %	85.5-116		"	"	"	"	
<i>Surrogate: 4-Bromofluorobenzene</i>		95.5 %	81.2-123		"	"	"	"	
<i>Surrogate: Dibromofluoromethane</i>		96.8 %	95.7-135		"	"	"	"	

SunStar Laboratories, Inc.

The results in this report apply to the samples analyzed in accordance with the chain of custody document. This analytical report must be reproduced in its entirety.



Wendy Hsiao, Project Manager

PSI -- Oakland 4703 Tidewater Ave Ste B Oakland CA, 94601	Project: ECHOJ Project Number: 575-443 Project Manager: Brand Burfield	Reported: 10/12/12 17:19
---	--	------------------------------------

TP-NE-17'
T121812-03 (Soil)

Analyte	Result	Reporting Limit	Units	Dilution	Batch	Prepared	Analyzed	Method	Notes
---------	--------	-----------------	-------	----------	-------	----------	----------	--------	-------

SunStar Laboratories, Inc.

Extractable Petroleum Hydrocarbons by 8015C

C13-C28 (DRO)	ND	10	mg/kg	1	2101017	10/10/12	10/10/12	EPA 8015C	
C29-C40 (MORO)	120	10	"	"	"	"	"	"	
<i>Surrogate: p-Terphenyl</i>		80.7 %	65-135		"	"	"	"	

Volatile Organic Compounds by EPA Method 8260B

1,2-Dibromoethane (EDB)	ND	5.0	ug/kg	1	2101015	10/10/12	10/11/12	EPA 8260B	
1,2-Dichloroethane	ND	5.0	"	"	"	"	"	"	
Benzene	ND	5.0	"	"	"	"	"	"	
Toluene	ND	5.0	"	"	"	"	"	"	
Ethylbenzene	ND	5.0	"	"	"	"	"	"	
m,p-Xylene	ND	5.0	"	"	"	"	"	"	
o-Xylene	ND	5.0	"	"	"	"	"	"	
Tert-amyl methyl ether	ND	20	"	"	"	"	"	"	
Tert-butyl alcohol	ND	50	"	"	"	"	"	"	
Di-isopropyl ether	ND	20	"	"	"	"	"	"	
Ethyl tert-butyl ether	ND	20	"	"	"	"	"	"	
Methyl tert-butyl ether	ND	20	"	"	"	"	"	"	
Ethanol	ND	500	"	"	"	"	"	"	
<i>Surrogate: Toluene-d8</i>		113 %	85.5-116		"	"	"	"	
<i>Surrogate: 4-Bromofluorobenzene</i>		96.2 %	81.2-123		"	"	"	"	
<i>Surrogate: Dibromofluoromethane</i>		95.6 %	95.7-135		"	"	"	"	S-GC

SunStar Laboratories, Inc.

The results in this report apply to the samples analyzed in accordance with the chain of custody document. This analytical report must be reproduced in its entirety.



Wendy Hsiao, Project Manager

PSI -- Oakland 4703 Tidewater Ave Ste B Oakland CA, 94601	Project: ECHOJ Project Number: 575-443 Project Manager: Brand Burfield	Reported: 10/12/12 17:19
---	--	------------------------------------

TP-SE-17'
T121812-04 (Soil)

Analyte	Result	Reporting Limit	Units	Dilution	Batch	Prepared	Analyzed	Method	Notes
---------	--------	-----------------	-------	----------	-------	----------	----------	--------	-------

SunStar Laboratories, Inc.

Extractable Petroleum Hydrocarbons by 8015C

C13-C28 (DRO)	ND	10	mg/kg	1	2101017	10/10/12	10/10/12	EPA 8015C	
C29-C40 (MORO)	ND	10	"	"	"	"	"	"	
<i>Surrogate: p-Terphenyl</i>		85.8 %	65-135		"	"	"	"	

Volatile Organic Compounds by EPA Method 8260B

1,2-Dibromoethane (EDB)	ND	5.0	ug/kg	1	2101015	10/10/12	10/11/12	EPA 8260B	
1,2-Dichloroethane	ND	5.0	"	"	"	"	"	"	
Benzene	ND	5.0	"	"	"	"	"	"	
Toluene	ND	5.0	"	"	"	"	"	"	
Ethylbenzene	ND	5.0	"	"	"	"	"	"	
m,p-Xylene	ND	5.0	"	"	"	"	"	"	
o-Xylene	ND	5.0	"	"	"	"	"	"	
Tert-amyl methyl ether	ND	20	"	"	"	"	"	"	
Tert-butyl alcohol	ND	50	"	"	"	"	"	"	
Di-isopropyl ether	ND	20	"	"	"	"	"	"	
Ethyl tert-butyl ether	ND	20	"	"	"	"	"	"	
Methyl tert-butyl ether	ND	20	"	"	"	"	"	"	
Ethanol	ND	500	"	"	"	"	"	"	
<i>Surrogate: Toluene-d8</i>		110 %	85.5-116		"	"	"	"	
<i>Surrogate: 4-Bromofluorobenzene</i>		94.9 %	81.2-123		"	"	"	"	
<i>Surrogate: Dibromofluoromethane</i>		97.1 %	95.7-135		"	"	"	"	

SunStar Laboratories, Inc.

The results in this report apply to the samples analyzed in accordance with the chain of custody document. This analytical report must be reproduced in its entirety.



Wendy Hsiao, Project Manager

PSI -- Oakland 4703 Tidewater Ave Ste B Oakland CA, 94601	Project: ECHOJ Project Number: 575-443 Project Manager: Brand Burfield	Reported: 10/12/12 17:19
---	--	------------------------------------

**TP-EAST WALL-13'
T121812-05 (Soil)**

Analyte	Result	Reporting Limit	Units	Dilution	Batch	Prepared	Analyzed	Method	Notes
---------	--------	--------------------	-------	----------	-------	----------	----------	--------	-------

SunStar Laboratories, Inc.

Extractable Petroleum Hydrocarbons by 8015C

C13-C28 (DRO)	ND	10	mg/kg	1	2101017	10/10/12	10/10/12	EPA 8015C	
C29-C40 (MORO)	ND	10	"	"	"	"	"	"	
<i>Surrogate: p-Terphenyl</i>		86.2 %	65-135		"	"	"	"	

Volatile Organic Compounds by EPA Method 8260B

1,2-Dibromoethane (EDB)	ND	5.0	ug/kg	1	2101015	10/10/12	10/11/12	EPA 8260B	
1,2-Dichloroethane	ND	5.0	"	"	"	"	"	"	
Benzene	ND	5.0	"	"	"	"	"	"	
Toluene	ND	5.0	"	"	"	"	"	"	
Ethylbenzene	ND	5.0	"	"	"	"	"	"	
m,p-Xylene	ND	5.0	"	"	"	"	"	"	
o-Xylene	ND	5.0	"	"	"	"	"	"	
Tert-amyl methyl ether	ND	20	"	"	"	"	"	"	
Tert-butyl alcohol	ND	50	"	"	"	"	"	"	
Di-isopropyl ether	ND	20	"	"	"	"	"	"	
Ethyl tert-butyl ether	ND	20	"	"	"	"	"	"	
Methyl tert-butyl ether	ND	20	"	"	"	"	"	"	
Ethanol	ND	500	"	"	"	"	"	"	
<i>Surrogate: Toluene-d8</i>		112 %	85.5-116		"	"	"	"	
<i>Surrogate: 4-Bromofluorobenzene</i>		98.2 %	81.2-123		"	"	"	"	
<i>Surrogate: Dibromofluoromethane</i>		107 %	95.7-135		"	"	"	"	

SunStar Laboratories, Inc.

The results in this report apply to the samples analyzed in accordance with the chain of custody document. This analytical report must be reproduced in its entirety.



Wendy Hsiao, Project Manager

PSI -- Oakland
4703 Tidewater Ave Ste B
Oakland CA, 94601

Project: ECHOJ
Project Number: 575-443
Project Manager: Brand Burfield

Reported:
10/12/12 17:19

Extractable Petroleum Hydrocarbons by 8015C - Quality Control
SunStar Laboratories, Inc.

Analyte	Result	Reporting Limit	Units	Spike Level	Source Result	%REC	%REC Limits	RPD	RPD Limit	Notes
---------	--------	-----------------	-------	-------------	---------------	------	-------------	-----	-----------	-------

Batch 2101017 - EPA 3550B GC

Blank (2101017-BLK1)

Prepared & Analyzed: 10/10/12

C13-C28 (DRO)	ND	10	mg/kg							
C29-C40 (MORO)	ND	10	"							
Surrogate: <i>p</i> -Terphenyl	78.6		"	100		78.6	65-135			

LCS (2101017-BS1)

Prepared & Analyzed: 10/10/12

C13-C28 (DRO)	400	10	mg/kg	500		80.7	75-125			
Surrogate: <i>p</i> -Terphenyl	73.4		"	100		73.4	65-135			

LCS Dup (2101017-BSD1)

Prepared & Analyzed: 10/10/12

C13-C28 (DRO)	410	10	mg/kg	500		81.7	75-125	1.26	20	
Surrogate: <i>p</i> -Terphenyl	73.2		"	100		73.2	65-135			

SunStar Laboratories, Inc.

The results in this report apply to the samples analyzed in accordance with the chain of custody document. This analytical report must be reproduced in its entirety.



Wendy Hsiao, Project Manager

PSI -- Oakland
4703 Tidewater Ave Ste B
Oakland CA, 94601

Project: ECHOJ
Project Number: 575-443
Project Manager: Brand Burfield

Reported:
10/12/12 17:19

Volatile Organic Compounds by EPA Method 8260B - Quality Control

SunStar Laboratories, Inc.

Analyte	Result	Reporting Limit	Units	Spike Level	Source Result	%REC	%REC Limits	RPD	RPD Limit	Notes
---------	--------	-----------------	-------	-------------	---------------	------	-------------	-----	-----------	-------

Batch 2101015 - EPA 5030 GCMS

Blank (2101015-BLK1)

Prepared: 10/10/12 Analyzed: 10/11/12

1,2-Dibromoethane (EDB)	ND	5.0	ug/kg							
1,2-Dichloroethane	ND	5.0	"							
Benzene	ND	5.0	"							
Toluene	ND	5.0	"							
Ethylbenzene	ND	5.0	"							
m,p-Xylene	ND	5.0	"							
o-Xylene	ND	5.0	"							
Tert-amyl methyl ether	ND	20	"							
Tert-butyl alcohol	ND	50	"							
Di-isopropyl ether	ND	20	"							
Ethyl tert-butyl ether	ND	20	"							
Methyl tert-butyl ether	ND	20	"							
Ethanol	ND	500	"							
<i>Surrogate: Toluene-d8</i>	44.4		"	40.0		111	85.5-116			
<i>Surrogate: 4-Bromofluorobenzene</i>	38.6		"	40.0		96.6	81.2-123			
<i>Surrogate: Dibromofluoromethane</i>	41.0		"	40.0		102	95.7-135			

LCS (2101015-BS1)

Prepared: 10/10/12 Analyzed: 10/11/12

Chlorobenzene	88.4	5.0	ug/kg	100		88.4	75-125			
1,1-Dichloroethene	94.4	5.0	"	100		94.4	75-125			
Trichloroethene	94.9	5.0	"	100		94.9	75-125			
Benzene	90.8	5.0	"	100		90.8	75-125			
Toluene	89.4	5.0	"	100		89.4	75-125			
<i>Surrogate: Toluene-d8</i>	44.4		"	40.0		111	85.5-116			
<i>Surrogate: 4-Bromofluorobenzene</i>	41.0		"	40.0		102	81.2-123			
<i>Surrogate: Dibromofluoromethane</i>	44.9		"	40.0		112	95.7-135			

LCS Dup (2101015-BSD1)

Prepared: 10/10/12 Analyzed: 10/11/12

Chlorobenzene	87.0	5.0	ug/kg	100		87.0	75-125	1.60	20	
1,1-Dichloroethene	114	5.0	"	100		114	75-125	18.6	20	
Trichloroethene	91.9	5.0	"	100		91.9	75-125	3.21	20	
Benzene	96.2	5.0	"	100		96.2	75-125	5.72	20	
Toluene	86.6	5.0	"	100		86.6	75-125	3.07	20	
<i>Surrogate: Toluene-d8</i>	42.8		"	40.0		107	85.5-116			
<i>Surrogate: 4-Bromofluorobenzene</i>	39.5		"	40.0		98.8	81.2-123			
<i>Surrogate: Dibromofluoromethane</i>	39.2		"	40.0		98.1	95.7-135			

SunStar Laboratories, Inc.

The results in this report apply to the samples analyzed in accordance with the chain of custody document. This analytical report must be reproduced in its entirety.



Wendy Hsiao, Project Manager



25712 Commercentre Drive
 Lake Forest, California 92630
 949.297.5020 Phone
 949.297.5027 Fax

PSI -- Oakland 4703 Tidewater Ave Ste B Oakland CA, 94601	Project: ECHOJ Project Number: 575-443 Project Manager: Brand Burfield	Reported: 10/12/12 17:19
---	--	------------------------------------

Volatile Organic Compounds by EPA Method 8260B - Quality Control
SunStar Laboratories, Inc.

Analyte	Result	Reporting Limit	Units	Spike Level	Source Result	%REC	%REC Limits	RPD	RPD Limit	Notes
---------	--------	-----------------	-------	-------------	---------------	------	-------------	-----	-----------	-------

Batch 2101015 - EPA 5030 GCMS

SunStar Laboratories, Inc.

The results in this report apply to the samples analyzed in accordance with the chain of custody document. This analytical report must be reproduced in its entirety.

Wendy Hsiao, Project Manager

PSI -- Oakland

4703 Tidewater Ave Ste B

Oakland CA, 94601

Project: ECHOJ

Project Number: 575-443

Project Manager: Brand Burfield

Reported:

10/12/12 17:19

Notes and Definitions

- S-GC Surrogate recovery outside of established control limits. The data was accepted based on valid recovery of the remaining surrogate(s).
- DET Analyte DETECTED
- ND Analyte NOT DETECTED at or above the reporting limit
- NR Not Reported
- dry Sample results reported on a dry weight basis
- RPD Relative Percent Difference

SunStar Laboratories, Inc.

The results in this report apply to the samples analyzed in accordance with the chain of custody document. This analytical report must be reproduced in its entirety.



Wendy Hsiao, Project Manager

SunStar Laboratories, Inc.
 25712 Commercentre Dr
 Lake Forest, CA 92630
 949-297-5020

Chain of Custody Record

Client: PSI
 Address: 4709 TIDEWATER AVE, STE B OAKLAND CA 94601
 Phone: (510) 434-9200 Fax: (510) 434-7676
 Project Manager: BRAND BURFELD

Date: OCTOBER 9, 2012 Page: 1 Of 1
 Project Name: ECHOJ
 Collector: B. BURFELD Client Project #: 579-443
 Batch #: 7121812 EDF #: N/A

Sample ID	Date Sampled	Time	Sample Type	Container Type	8260	8260 + OXY	8260 BTEX, OXY only*	8270	8021 BTEX	8015M (gasoline)	8015M (diesel) (TOTAL OIL)	8015M Ext./Carbon Chain	6010/7000 Title 22 Metals	Laboratory ID #	Comments/Preservative	Total # of containers
TP-NW-20'	10/9/12	14:35	SOIL	TUBE			/				/			01		
TP-SW-20'		15:20					/				/			02		
TP-NE-17'		14:30					/				/			03		
TP-SE-17'		14:25					/				/			04		
TP-EAST WALL-13'		10:25					/				/			05		
Relinquished by: (signature) <u>[Signature]</u> Date / Time <u>10/9/12 16:45</u> Received by: (signature) <u>GSO AEREN # 107416981</u> Date / Time _____ Relinquished by: (signature) <u>GSO</u> Date / Time <u>10-10-12 10:45</u> Received by: (signature) <u>[Signature]</u> Date / Time <u>10-10-12</u> Relinquished by: (signature) _____ Date / Time _____ Received by: (signature) _____ Date / Time _____					Total # of containers _____ Chain of Custody seals <input checked="" type="checkbox"/> Y / <input type="checkbox"/> N / <input type="checkbox"/> NA Seals intact? <input checked="" type="checkbox"/> Y / <input type="checkbox"/> N / <input type="checkbox"/> NA Received good condition/cold <u>3.8</u>			Notes * OXY TO INCLUDE; EDS, EDC, EtOH, MTBE, TAME, ETBE, PIPE, TBA								
					Turn around time: <u>2 DAY</u>											
					Sample disposal instructions: Disposal @ \$2.00 each _____ Return to client _____ Pickup _____											

COC112269



25712 Commercentre Drive
Lake Forest, California 92630
949.297.5020 Phone
949.297.5027 Fax

12 October 2012

Brand Burfield
PSI -- Oakland
4703 Tidewater Ave Ste B
Oakland, CA 94601
RE: ECHOJ

Enclosed are the results of analyses for samples received by the laboratory on 10/11/12 09:57. If you have any questions concerning this report, please feel free to contact me.

Sincerely,

Wendy Hsiao
Project Manager



25712 Commercentre Drive
Lake Forest, California 92630
949.297.5020 Phone
949.297.5027 Fax

PSI -- Oakland
4703 Tidewater Ave Ste B
Oakland CA, 94601

Project: ECHOJ
Project Number: 575-443
Project Manager: Brand Burfield

Reported:
10/12/12 16:07

ANALYTICAL REPORT FOR SAMPLES

Sample ID	Laboratory ID	Matrix	Date Sampled	Date Received
TP-SOUTH WALL-15'	T121816-01	Soil	10/10/12 12:40	10/11/12 09:57

SunStar Laboratories, Inc.

The results in this report apply to the samples analyzed in accordance with the chain of custody document. This analytical report must be reproduced in its entirety.

Wendy Hsiao, Project Manager



25712 Commercentre Drive
 Lake Forest, California 92630
 949.297.5020 Phone
 949.297.5027 Fax

PSI -- Oakland 4703 Tidewater Ave Ste B Oakland CA, 94601	Project: ECHOJ Project Number: 575-443 Project Manager: Brand Burfield	Reported: 10/12/12 16:07
---	--	-----------------------------

TP-SOUTH WALL-15'
T121816-01 (Soil)

Analyte	Result	Reporting Limit	Units	Dilution	Batch	Prepared	Analyzed	Method	Notes
---------	--------	-----------------	-------	----------	-------	----------	----------	--------	-------

SunStar Laboratories, Inc.

Extractable Petroleum Hydrocarbons by 8015C

C13-C28 (DRO)	240	10	mg/kg	1	2101123	10/11/12	10/11/12	EPA 8015C	
C29-C40 (MORO)	400	10	"	"	"	"	"	"	
<i>Surrogate: p-Terphenyl</i>		88.0 %	65-135		"	"	"	"	

Volatile Organic Compounds by EPA Method 8260B

1,2-Dibromoethane (EDB)	ND	5.0	ug/kg	1	2101126	10/11/12	10/11/12	EPA 8260B	
1,1-Dichloroethene	ND	5.0	"	"	"	"	"	"	
Benzene	ND	5.0	"	"	"	"	"	"	
Toluene	ND	5.0	"	"	"	"	"	"	
Ethylbenzene	ND	5.0	"	"	"	"	"	"	
m,p-Xylene	ND	5.0	"	"	"	"	"	"	
o-Xylene	ND	5.0	"	"	"	"	"	"	
Tert-amyl methyl ether	ND	20	"	"	"	"	"	"	
Tert-butyl alcohol	ND	50	"	"	"	"	"	"	
Di-isopropyl ether	ND	20	"	"	"	"	"	"	
Ethyl tert-butyl ether	ND	20	"	"	"	"	"	"	
Methyl tert-butyl ether	ND	20	"	"	"	"	"	"	
Ethanol	ND	500	"	"	"	"	"	"	
<i>Surrogate: Toluene-d8</i>		111 %	85.5-116		"	"	"	"	
<i>Surrogate: 4-Bromofluorobenzene</i>		93.1 %	81.2-123		"	"	"	"	
<i>Surrogate: Dibromofluoromethane</i>		99.1 %	95.7-135		"	"	"	"	

SunStar Laboratories, Inc.

The results in this report apply to the samples analyzed in accordance with the chain of custody document. This analytical report must be reproduced in its entirety.

Wendy Hsiao, Project Manager

PSI -- Oakland
4703 Tidewater Ave Ste B
Oakland CA, 94601

Project: ECHOJ
Project Number: 575-443
Project Manager: Brand Burfield

Reported:
10/12/12 16:07

Extractable Petroleum Hydrocarbons by 8015C - Quality Control
SunStar Laboratories, Inc.

Analyte	Result	Reporting Limit	Units	Spike Level	Source Result	%REC	%REC Limits	RPD	RPD Limit	Notes
---------	--------	--------------------	-------	----------------	------------------	------	----------------	-----	--------------	-------

Batch 2101123 - EPA 3550B GC

Blank (2101123-BLK1)

Prepared & Analyzed: 10/11/12

C13-C28 (DRO)	ND	10	mg/kg							
C29-C40 (MORO)	ND	10	"							
Surrogate: <i>p</i> -Terphenyl	85.5		"	100		85.5	65-135			

LCS (2101123-BS1)

Prepared & Analyzed: 10/11/12

C13-C28 (DRO)	470	10	mg/kg	500		94.5	75-125			
Surrogate: <i>p</i> -Terphenyl	83.3		"	100		83.3	65-135			

LCS Dup (2101123-BSD1)

Prepared & Analyzed: 10/11/12

C13-C28 (DRO)	440	10	mg/kg	500		88.0	75-125	7.09	20	
Surrogate: <i>p</i> -Terphenyl	77.3		"	100		77.3	65-135			

SunStar Laboratories, Inc.

The results in this report apply to the samples analyzed in accordance with the chain of custody document. This analytical report must be reproduced in its entirety.



Wendy Hsiao, Project Manager

PSI -- Oakland 4703 Tidewater Ave Ste B Oakland CA, 94601	Project: ECHOJ Project Number: 575-443 Project Manager: Brand Burfield	Reported: 10/12/12 16:07
---	--	-----------------------------

Volatile Organic Compounds by EPA Method 8260B - Quality Control

SunStar Laboratories, Inc.

Analyte	Result	Reporting Limit	Units	Spike Level	Source Result	%REC	%REC Limits	RPD	RPD Limit	Notes
---------	--------	-----------------	-------	-------------	---------------	------	-------------	-----	-----------	-------

Batch 2101126 - EPA 5030 GCMS

Blank (2101126-BLK1)

Prepared & Analyzed: 10/11/12

1,2-Dibromoethane (EDB)	ND	5.0	ug/kg							
Benzene	ND	5.0	"							
Toluene	ND	5.0	"							
Ethylbenzene	ND	5.0	"							
m,p-Xylene	ND	5.0	"							
o-Xylene	ND	5.0	"							
Tert-amyl methyl ether	ND	20	"							
Tert-butyl alcohol	ND	50	"							
Di-isopropyl ether	ND	20	"							
Ethyl tert-butyl ether	ND	20	"							
Methyl tert-butyl ether	ND	20	"							
Ethanol	ND	500	"							
<i>Surrogate: Toluene-d8</i>	45.8		"	40.0		115	85.5-116			
<i>Surrogate: 4-Bromofluorobenzene</i>	37.5		"	40.0		93.8	81.2-123			
<i>Surrogate: Dibromofluoromethane</i>	37.6		"	40.0		94.0	95.7-135			S-GC

LCS (2101126-BS1)

Prepared & Analyzed: 10/11/12

Chlorobenzene	84.7	5.0	ug/kg	100		84.7	75-125			
1,1-Dichloroethene	81.2	5.0	"	100		81.2	75-125			
Trichloroethene	93.7	5.0	"	100		93.7	75-125			
Benzene	93.4	5.0	"	100		93.4	75-125			
Toluene	88.6	5.0	"	100		88.6	75-125			
<i>Surrogate: Toluene-d8</i>	45.4		"	40.0		113	85.5-116			
<i>Surrogate: 4-Bromofluorobenzene</i>	43.4		"	40.0		108	81.2-123			
<i>Surrogate: Dibromofluoromethane</i>	47.2		"	40.0		118	95.7-135			

LCS Dup (2101126-BSD1)

Prepared & Analyzed: 10/11/12

Chlorobenzene	99.4	5.0	ug/kg	100		99.4	75-125	16.0	20	
1,1-Dichloroethene	107	5.0	"	100		107	75-125	27.2	20	QR-02
Trichloroethene	97.2	5.0	"	100		97.2	75-125	3.72	20	
Benzene	103	5.0	"	100		103	75-125	9.93	20	
Toluene	104	5.0	"	100		104	75-125	16.4	20	
<i>Surrogate: Toluene-d8</i>	45.8		"	40.0		114	85.5-116			
<i>Surrogate: 4-Bromofluorobenzene</i>	40.6		"	40.0		101	81.2-123			
<i>Surrogate: Dibromofluoromethane</i>	34.6		"	40.0		86.5	95.7-135			S-GC

SunStar Laboratories, Inc.

The results in this report apply to the samples analyzed in accordance with the chain of custody document. This analytical report must be reproduced in its entirety.



Wendy Hsiao, Project Manager

PSI -- Oakland

Project: ECHOJ

4703 Tidewater Ave Ste B

Project Number: 575-443

Oakland CA, 94601

Project Manager: Brand Burfield

Reported:

10/12/12 16:07

Notes and Definitions

- S-GC Surrogate recovery outside of established control limits. The data was accepted based on valid recovery of the remaining surrogate(s).
- QR-02 The RPD result exceeded the QC control limits; however, both percent recoveries were acceptable. Sample results for the QC batch were accepted based on percent recoveries and completeness of QC data.
- DET Analyte DETECTED
- ND Analyte NOT DETECTED at or above the reporting limit
- NR Not Reported
- dry Sample results reported on a dry weight basis
- RPD Relative Percent Difference

SunStar Laboratories, Inc.

The results in this report apply to the samples analyzed in accordance with the chain of custody document. This analytical report must be reproduced in its entirety.



Wendy Hsiao, Project Manager

SunStar Laboratories, Inc.
 25712 Commercentre Dr
 Lake Forest, CA 92630
 949-297-5020

Chain of Custody Record

Client: PZ
 Address: 4703 TIDEWATER AVE SEB, OAKLAND CA 94601
 Phone: 910 434-9200 Fax: 910 434-7676
 Project Manager: BRAND BURFIELD

Date: OCT 10, 2012 Page: 1 Of 1
 Project Name: ECHOJ
 Collector: B. BURFIELD Client Project #: 579-443
 Batch #: T121816 EDF #: N/A

Sample ID	Date Sampled	Time	Sample Type	Container Type	8260	8260 + OXY	8260-BTEX, OXY only *	8270	8021 BTEX	8015M (gasoline)	8015M (diesel) + (METALS etc.)	8015M Ext./Carbon Chain	6010/7000 Title 22 Metals	Laboratory ID #	Comments/Preservative	Total # of containers	
TP-9000 WALK-15	10/10/12	12:40	SOIL	TUBE			<input checked="" type="checkbox"/>				<input checked="" type="checkbox"/>			01			

Relinquished by: (signature) <u>[Signature]</u>					Date / Time		Received by: (signature) <u>[Signature]</u>					Date / Time		Total # of containers		* Notes OXK TO INCLUDE; EDB, EDC, ETOL, MTBE, TAME, ETBE, DIPE, TBA	
Relinquished by: (signature) <u>GSO</u>					Date / Time		Received by: (signature) <u>[Signature]</u>					Date / Time		Chain of Custody seals Y/N/NA			
Relinquished by: (signature)					Date / Time		Received by: (signature)					Date / Time		Seals intact? Y/N/NA			
Relinquished by: (signature)					Date / Time		Received by: (signature)					Date / Time		Received good condition/cold		Turn around time: <u>2 DAY</u>	

Sample disposal Instructions: Disposal @ \$2.00 each _____ Return to client _____ Pickup _____

COC 112394



25712 Commercentre Drive
Lake Forest, California 92630
949.297.5020 Phone
949.297.5027 Fax

17 October 2012

Brand Burfield
PSI -- Oakland
4703 Tidewater Ave Ste B
Oakland, CA 94601
RE: ECHOJ

Enclosed are the results of analyses for samples received by the laboratory on 08/28/12 10:40. If you have any questions concerning this report, please feel free to contact me.

Sincerely,

Wendy Hsiao
Project Manager



25712 Commercentre Drive
 Lake Forest, California 92630
 949.297.5020 Phone
 949.297.5027 Fax

PSI -- Oakland
 4703 Tidewater Ave Ste B
 Oakland CA, 94601

Project: ECHOJ
 Project Number: 575-443
 Project Manager: Brand Burfield

Reported:
 10/17/12 09:29

ANALYTICAL REPORT FOR SAMPLES

Sample ID	Laboratory ID	Matrix	Date Sampled	Date Received
TP-NW-14'	T121480-01	Soil	08/27/12 10:35	08/28/12 10:40
TP-SW-14'	T121480-02	Soil	08/27/12 10:45	08/28/12 10:40
TP-NE-14'	T121480-03	Soil	08/27/12 10:55	08/28/12 10:40
TP-SE-14'	T121480-04	Soil	08/27/12 11:05	08/28/12 10:40
TP-CTR-17'	T121480-05	Soil	08/27/12 12:15	08/28/12 10:40
TP-E-17'	T121480-06	Soil	08/27/12 13:00	08/28/12 10:40
SP-C1-1	T121480-07	Soil	08/27/12 11:40	08/28/12 10:40
SP-C1-2	T121480-08	Soil	08/27/12 12:05	08/28/12 10:40
SP-C2-N	T121480-09	Soil	08/27/12 14:00	08/28/12 10:40
SP-C2-S	T121480-10	Soil	08/27/12 14:20	08/28/12 10:40
SP-C2-E	T121480-11	Soil	08/27/12 14:10	08/28/12 10:40
SP-C2-W	T121480-12	Soil	08/27/12 13:50	08/28/12 10:40
SP-C3-1	T121480-13	Soil	08/27/12 12:45	08/28/12 10:40
SP-D1-1 thru SP-D1-4	T121480-30	Soil	08/27/12 00:00	08/28/12 10:40
SP-D2-1 thru SP-D2-4	T121480-31	Soil	08/27/12 00:00	08/28/12 10:40
SP-D2-5 thru SP-D2-8	T121480-32	Soil	08/27/12 00:00	08/28/12 10:40
SP-D3-1 & SP-D3-2	T121480-33	Soil	08/27/12 00:00	08/28/12 10:40
SP-D4-1 & SP-D4-2	T121480-34	Soil	08/27/12 00:00	08/28/12 10:40

SunStar Laboratories, Inc.

The results in this report apply to the samples analyzed in accordance with the chain of custody document. This analytical report must be reproduced in its entirety.

Wendy Hsiao, Project Manager

PSI -- Oakland
4703 Tidewater Ave Ste B
Oakland CA, 94601

Project: ECHOJ
Project Number: 575-443
Project Manager: Brand Burfield

Reported:
10/17/12 09:29

TP-NW-14'
T121480-01 (Soil)

Analyte	Result	Reporting Limit	Units	Dilution	Batch	Prepared	Analyzed	Method	Notes
---------	--------	-----------------	-------	----------	-------	----------	----------	--------	-------

SunStar Laboratories, Inc.

Extractable Petroleum Hydrocarbons by 8015C

C29-C40 (MORO)	2600	10	mg/kg	1	2090722	09/07/12	09/08/12	EPA 8015C	
Surrogate: <i>p</i> -Terphenyl		131 %	65-135		"	"	"	"	
Diesel Range Hydrocarbons	720	5.0	"	"	2082916	08/29/12	08/31/12	"	
Surrogate: <i>p</i> -Terphenyl		104 %	65-135		"	"	"	"	

Volatile Organic Compounds by EPA Method 8260B

1,2-Dibromoethane (EDB)	ND	5.0	ug/kg	1	2083026	08/30/12	08/31/12	EPA 8260B	
1,2-Dichloroethane	ND	5.0	"	"	"	"	"	"	
Benzene	ND	5.0	"	"	"	"	"	"	
Toluene	ND	5.0	"	"	"	"	"	"	
Ethylbenzene	ND	5.0	"	"	"	"	"	"	
m,p-Xylene	ND	5.0	"	"	"	"	"	"	
o-Xylene	ND	5.0	"	"	"	"	"	"	
Tert-amyl methyl ether	ND	20	"	"	"	"	"	"	
Tert-butyl alcohol	ND	50	"	"	"	"	"	"	
Di-isopropyl ether	ND	20	"	"	"	"	"	"	
Ethyl tert-butyl ether	ND	20	"	"	"	"	"	"	
Methyl tert-butyl ether	ND	20	"	"	"	"	"	"	
Ethanol	ND	500	"	"	"	"	"	"	
Surrogate: Toluene-d8		102 %	85.5-116		"	"	"	"	
Surrogate: 4-Bromofluorobenzene		88.2 %	81.2-123		"	"	"	"	
Surrogate: Dibromofluoromethane		102 %	95.7-135		"	"	"	"	

SunStar Laboratories, Inc.

The results in this report apply to the samples analyzed in accordance with the chain of custody document. This analytical report must be reproduced in its entirety.



Wendy Hsiao, Project Manager

PSI -- Oakland 4703 Tidewater Ave Ste B Oakland CA, 94601	Project: ECHOJ Project Number: 575-443 Project Manager: Brand Burfield	Reported: 10/17/12 09:29
---	--	------------------------------------

TP-SW-14'
T121480-02 (Soil)

Analyte	Result	Reporting Limit	Units	Dilution	Batch	Prepared	Analyzed	Method	Notes
---------	--------	--------------------	-------	----------	-------	----------	----------	--------	-------

SunStar Laboratories, Inc.

Extractable Petroleum Hydrocarbons by 8015C

Analyte	Result	Reporting Limit	Units	Dilution	Batch	Prepared	Analyzed	Method	Notes
C29-C40 (MORO)	15000	100	mg/kg	10	2090722	09/07/12	09/08/12	EPA 8015C	
<i>Surrogate: p-Terphenyl</i>		134 %	65-135		"	"	"	"	
Diesel Range Hydrocarbons	11000	5.0	"	"	2082916	08/29/12	08/31/12	"	E
<i>Surrogate: p-Terphenyl</i>		114 %	65-135		"	"	"	"	

Volatile Organic Compounds by EPA Method 8260B

Analyte	Result	Reporting Limit	Units	Dilution	Batch	Prepared	Analyzed	Method	Notes
1,2-Dibromoethane (EDB)	ND	5.0	ug/kg	1	2083026	08/30/12	08/31/12	EPA 8260B	
1,2-Dichloroethane	ND	5.0	"	"	"	"	"	"	
Benzene	ND	5.0	"	"	"	"	"	"	
Toluene	ND	5.0	"	"	"	"	"	"	
Ethylbenzene	22	5.0	"	"	"	"	"	"	
m,p-Xylene	13	5.0	"	"	"	"	"	"	
o-Xylene	9.8	5.0	"	"	"	"	"	"	
Tert-amyl methyl ether	ND	20	"	"	"	"	"	"	
Tert-butyl alcohol	ND	50	"	"	"	"	"	"	
Di-isopropyl ether	ND	20	"	"	"	"	"	"	
Ethyl tert-butyl ether	ND	20	"	"	"	"	"	"	
Methyl tert-butyl ether	ND	20	"	"	"	"	"	"	
Ethanol	ND	500	"	"	"	"	"	"	
<i>Surrogate: Toluene-d8</i>		100 %	85.5-116		"	"	"	"	
<i>Surrogate: 4-Bromofluorobenzene</i>		99.1 %	81.2-123		"	"	"	"	
<i>Surrogate: Dibromofluoromethane</i>		105 %	95.7-135		"	"	"	"	

SunStar Laboratories, Inc.

The results in this report apply to the samples analyzed in accordance with the chain of custody document. This analytical report must be reproduced in its entirety.



Wendy Hsiao, Project Manager

PSI -- Oakland 4703 Tidewater Ave Ste B Oakland CA, 94601	Project: ECHOJ Project Number: 575-443 Project Manager: Brand Burfield	Reported: 10/17/12 09:29
---	--	------------------------------------

TP-NE-14'
T121480-03 (Soil)

Analyte	Result	Reporting Limit	Units	Dilution	Batch	Prepared	Analyzed	Method	Notes
---------	--------	-----------------	-------	----------	-------	----------	----------	--------	-------

SunStar Laboratories, Inc.

Extractable Petroleum Hydrocarbons by 8015C

Analyte	Result	Reporting Limit	Units	Dilution	Batch	Prepared	Analyzed	Method	Notes
C29-C40 (MORO)	8800	10	mg/kg	1	2090722	09/07/12	09/08/12	EPA 8015C	
<i>Surrogate: p-Terphenyl</i>		133 %	65-135		"	"	"	"	
Diesel Range Hydrocarbons	2500	5.0	"	"	2082916	08/29/12	08/31/12	"	
<i>Surrogate: p-Terphenyl</i>		132 %	65-135		"	"	"	"	

Volatile Organic Compounds by EPA Method 8260B

Analyte	Result	Reporting Limit	Units	Dilution	Batch	Prepared	Analyzed	Method	Notes
1,2-Dibromoethane (EDB)	ND	5.0	ug/kg	1	2083026	08/30/12	08/31/12	EPA 8260B	
1,2-Dichloroethane	ND	5.0	"	"	"	"	"	"	
Benzene	ND	5.0	"	"	"	"	"	"	
Toluene	ND	5.0	"	"	"	"	"	"	
Ethylbenzene	ND	5.0	"	"	"	"	"	"	
m,p-Xylene	ND	5.0	"	"	"	"	"	"	
o-Xylene	ND	5.0	"	"	"	"	"	"	
Tert-amyl methyl ether	ND	20	"	"	"	"	"	"	
Tert-butyl alcohol	ND	50	"	"	"	"	"	"	
Di-isopropyl ether	ND	20	"	"	"	"	"	"	
Ethyl tert-butyl ether	ND	20	"	"	"	"	"	"	
Methyl tert-butyl ether	ND	20	"	"	"	"	"	"	
Ethanol	ND	500	"	"	"	"	"	"	
<i>Surrogate: Toluene-d8</i>		92.0 %	85.5-116		"	"	"	"	
<i>Surrogate: 4-Bromofluorobenzene</i>		96.4 %	81.2-123		"	"	"	"	
<i>Surrogate: Dibromofluoromethane</i>		85.4 %	95.7-135		"	"	"	"	S-GC

SunStar Laboratories, Inc.

The results in this report apply to the samples analyzed in accordance with the chain of custody document. This analytical report must be reproduced in its entirety.



Wendy Hsiao, Project Manager

PSI -- Oakland 4703 Tidewater Ave Ste B Oakland CA, 94601	Project: ECHOJ Project Number: 575-443 Project Manager: Brand Burfield	Reported: 10/17/12 09:29
---	--	------------------------------------

TP-SE-14'
T121480-04 (Soil)

Analyte	Result	Reporting Limit	Units	Dilution	Batch	Prepared	Analyzed	Method	Notes
---------	--------	-----------------	-------	----------	-------	----------	----------	--------	-------

SunStar Laboratories, Inc.

Extractable Petroleum Hydrocarbons by 8015C

Analyte	Result	Reporting Limit	Units	Dilution	Batch	Prepared	Analyzed	Method	Notes
C29-C40 (MORO)	4500	10	mg/kg	1	2090722	09/07/12	09/08/12	EPA 8015C	
<i>Surrogate: p-Terphenyl</i>		133 %	65-135		"	"	"	"	
Diesel Range Hydrocarbons	2100	5.0	"	"	2082916	08/29/12	08/31/12	"	
<i>Surrogate: p-Terphenyl</i>		128 %	65-135		"	"	"	"	

Volatile Organic Compounds by EPA Method 8260B

Analyte	Result	Reporting Limit	Units	Dilution	Batch	Prepared	Analyzed	Method	Notes
1,2-Dibromoethane (EDB)	ND	5.0	ug/kg	1	2083026	08/30/12	08/31/12	EPA 8260B	
1,2-Dichloroethane	ND	5.0	"	"	"	"	"	"	
Benzene	ND	5.0	"	"	"	"	"	"	
Toluene	ND	5.0	"	"	"	"	"	"	
Ethylbenzene	25	5.0	"	"	"	"	"	"	
m,p-Xylene	18	5.0	"	"	"	"	"	"	
o-Xylene	9.6	5.0	"	"	"	"	"	"	
Tert-amyl methyl ether	ND	20	"	"	"	"	"	"	
Tert-butyl alcohol	ND	50	"	"	"	"	"	"	
Di-isopropyl ether	ND	20	"	"	"	"	"	"	
Ethyl tert-butyl ether	ND	20	"	"	"	"	"	"	
Methyl tert-butyl ether	ND	20	"	"	"	"	"	"	
Ethanol	ND	500	"	"	"	"	"	"	
<i>Surrogate: Toluene-d8</i>		91.4 %	85.5-116		"	"	"	"	
<i>Surrogate: 4-Bromofluorobenzene</i>		101 %	81.2-123		"	"	"	"	
<i>Surrogate: Dibromofluoromethane</i>		85.5 %	95.7-135		"	"	"	"	S-GC

SunStar Laboratories, Inc.

The results in this report apply to the samples analyzed in accordance with the chain of custody document. This analytical report must be reproduced in its entirety.



Wendy Hsiao, Project Manager

PSI -- Oakland 4703 Tidewater Ave Ste B Oakland CA, 94601	Project: ECHOJ Project Number: 575-443 Project Manager: Brand Burfield	Reported: 10/17/12 09:29
---	--	------------------------------------

TP-CTR-17'
T121480-05 (Soil)

Analyte	Result	Reporting Limit	Units	Dilution	Batch	Prepared	Analyzed	Method	Notes
---------	--------	-----------------	-------	----------	-------	----------	----------	--------	-------

SunStar Laboratories, Inc.

Extractable Petroleum Hydrocarbons by 8015C

Diesel Range Hydrocarbons	ND	5.0	mg/kg	1	2082916	08/29/12	08/31/12	EPA 8015C	
<i>Surrogate: p-Terphenyl</i>		123 %	65-135		"	"	"	"	

Volatile Organic Compounds by EPA Method 8260B

1,2-Dibromoethane (EDB)	ND	5.0	ug/kg	1	2083026	08/30/12	08/31/12	EPA 8260B	
1,2-Dichloroethane	ND	5.0	"	"	"	"	"	"	
Benzene	ND	5.0	"	"	"	"	"	"	
Toluene	ND	5.0	"	"	"	"	"	"	
Ethylbenzene	ND	5.0	"	"	"	"	"	"	
m,p-Xylene	ND	5.0	"	"	"	"	"	"	
o-Xylene	ND	5.0	"	"	"	"	"	"	
Tert-amyl methyl ether	ND	20	"	"	"	"	"	"	
Tert-butyl alcohol	ND	50	"	"	"	"	"	"	
Di-isopropyl ether	ND	20	"	"	"	"	"	"	
Ethyl tert-butyl ether	ND	20	"	"	"	"	"	"	
Methyl tert-butyl ether	ND	20	"	"	"	"	"	"	
Ethanol	ND	500	"	"	"	"	"	"	
<i>Surrogate: Toluene-d8</i>		93.0 %	85.5-116		"	"	"	"	
<i>Surrogate: 4-Bromofluorobenzene</i>		99.2 %	81.2-123		"	"	"	"	
<i>Surrogate: Dibromofluoromethane</i>		84.0 %	95.7-135		"	"	"	"	S-GC

SunStar Laboratories, Inc.

The results in this report apply to the samples analyzed in accordance with the chain of custody document. This analytical report must be reproduced in its entirety.



Wendy Hsiao, Project Manager

PSI -- Oakland 4703 Tidewater Ave Ste B Oakland CA, 94601	Project: ECHOJ Project Number: 575-443 Project Manager: Brand Burfield	Reported: 10/17/12 09:29
---	--	------------------------------------

TP-E-17'
T121480-06 (Soil)

Analyte	Result	Reporting Limit	Units	Dilution	Batch	Prepared	Analyzed	Method	Notes
---------	--------	-----------------	-------	----------	-------	----------	----------	--------	-------

SunStar Laboratories, Inc.

Extractable Petroleum Hydrocarbons by 8015C

Analyte	Result	Reporting Limit	Units	Dilution	Batch	Prepared	Analyzed	Method	Notes
Diesel Range Hydrocarbons	65	5.0	mg/kg	1	2082916	08/29/12	08/31/12	EPA 8015C	
<i>Surrogate: p-Terphenyl</i>		125 %	65-135		"	"	"	"	

Volatile Organic Compounds by EPA Method 8260B

1,2-Dibromoethane (EDB)	ND	5.0	ug/kg	1	2083026	08/30/12	08/31/12	EPA 8260B	
1,2-Dichloroethane	ND	5.0	"	"	"	"	"	"	
Benzene	ND	5.0	"	"	"	"	"	"	
Toluene	ND	5.0	"	"	"	"	"	"	
Ethylbenzene	ND	5.0	"	"	"	"	"	"	
m,p-Xylene	ND	5.0	"	"	"	"	"	"	
o-Xylene	ND	5.0	"	"	"	"	"	"	
Tert-amyl methyl ether	ND	20	"	"	"	"	"	"	
Tert-butyl alcohol	ND	50	"	"	"	"	"	"	
Di-isopropyl ether	ND	20	"	"	"	"	"	"	
Ethyl tert-butyl ether	ND	20	"	"	"	"	"	"	
Methyl tert-butyl ether	ND	20	"	"	"	"	"	"	
Ethanol	ND	500	"	"	"	"	"	"	
<i>Surrogate: Toluene-d8</i>		93.0 %	85.5-116		"	"	"	"	
<i>Surrogate: 4-Bromofluorobenzene</i>		100 %	81.2-123		"	"	"	"	
<i>Surrogate: Dibromofluoromethane</i>		86.0 %	95.7-135		"	"	"	"	S-GC

SunStar Laboratories, Inc.

The results in this report apply to the samples analyzed in accordance with the chain of custody document. This analytical report must be reproduced in its entirety.



Wendy Hsiao, Project Manager

PSI -- Oakland 4703 Tidewater Ave Ste B Oakland CA, 94601	Project: ECHOJ Project Number: 575-443 Project Manager: Brand Burfield	Reported: 10/17/12 09:29
---	--	-----------------------------

**SP-C1-1
T121480-07 (Soil)**

Analyte	Result	Reporting Limit	Units	Dilution	Batch	Prepared	Analyzed	Method	Notes
---------	--------	-----------------	-------	----------	-------	----------	----------	--------	-------

SunStar Laboratories, Inc.

Extractable Petroleum Hydrocarbons by 8015C

Analyte	Result	Reporting Limit	Units	Dilution	Batch	Prepared	Analyzed	Method	Notes
C29-C40 (MORO)	1700	10	mg/kg	1	2091213	09/12/12	09/12/12	EPA 8015C	I-02
Surrogate: <i>p</i> -Terphenyl		95.0 %	65-135		"	"	"	"	I-02
Diesel Range Hydrocarbons	290	5.0	"	"	2082916	08/29/12	08/31/12	"	
Surrogate: <i>p</i> -Terphenyl		129 %	65-135		"	"	"	"	

Volatile Organic Compounds by EPA Method 8260B

Analyte	Result	Reporting Limit	Units	Dilution	Batch	Prepared	Analyzed	Method	Notes
1,2-Dibromoethane (EDB)	ND	5.0	ug/kg	1	2083026	08/30/12	08/31/12	EPA 8260B	
1,2-Dichloroethane	ND	5.0	"	"	"	"	"	"	
Benzene	ND	5.0	"	"	"	"	"	"	
Toluene	ND	5.0	"	"	"	"	"	"	
Ethylbenzene	ND	5.0	"	"	"	"	"	"	
<i>m,p</i> -Xylene	ND	5.0	"	"	"	"	"	"	
<i>o</i> -Xylene	ND	5.0	"	"	"	"	"	"	
Tert-amyl methyl ether	ND	20	"	"	"	"	"	"	
Tert-butyl alcohol	ND	50	"	"	"	"	"	"	
Di-isopropyl ether	ND	20	"	"	"	"	"	"	
Ethyl tert-butyl ether	ND	20	"	"	"	"	"	"	
Methyl tert-butyl ether	ND	20	"	"	"	"	"	"	
Ethanol	ND	500	"	"	"	"	"	"	
Surrogate: Toluene-d8		93.2 %	85.5-116		"	"	"	"	
Surrogate: 4-Bromofluorobenzene		98.4 %	81.2-123		"	"	"	"	
Surrogate: Dibromofluoromethane		85.9 %	95.7-135		"	"	"	"	S-GC

SunStar Laboratories, Inc.

The results in this report apply to the samples analyzed in accordance with the chain of custody document. This analytical report must be reproduced in its entirety.



Wendy Hsiao, Project Manager

PSI -- Oakland 4703 Tidewater Ave Ste B Oakland CA, 94601	Project: ECHOJ Project Number: 575-443 Project Manager: Brand Burfield	Reported: 10/17/12 09:29
---	--	-----------------------------

**SP-C1-2
T121480-08 (Soil)**

Analyte	Result	Reporting Limit	Units	Dilution	Batch	Prepared	Analyzed	Method	Notes
---------	--------	-----------------	-------	----------	-------	----------	----------	--------	-------

SunStar Laboratories, Inc.

Extractable Petroleum Hydrocarbons by 8015C

Analyte	Result	Reporting Limit	Units	Dilution	Batch	Prepared	Analyzed	Method
C29-C40 (MORO)	5900	10	mg/kg	1	2090722	09/07/12	09/08/12	EPA 8015C
<i>Surrogate: p-Terphenyl</i>		123 %	65-135		"	"	"	"
Diesel Range Hydrocarbons	590	5.0	"	"	2082916	08/29/12	08/31/12	"
<i>Surrogate: p-Terphenyl</i>		113 %	65-135		"	"	"	"

Volatile Organic Compounds by EPA Method 8260B

Analyte	Result	Reporting Limit	Units	Dilution	Batch	Prepared	Analyzed	Method	Notes
1,2-Dibromoethane (EDB)	ND	5.0	ug/kg	1	2083026	08/30/12	08/31/12	EPA 8260B	
1,2-Dichloroethane	ND	5.0	"	"	"	"	"	"	
Benzene	ND	5.0	"	"	"	"	"	"	
Toluene	ND	5.0	"	"	"	"	"	"	
Ethylbenzene	ND	5.0	"	"	"	"	"	"	
m,p-Xylene	ND	5.0	"	"	"	"	"	"	
o-Xylene	ND	5.0	"	"	"	"	"	"	
Tert-amyl methyl ether	ND	20	"	"	"	"	"	"	
Tert-butyl alcohol	ND	50	"	"	"	"	"	"	
Di-isopropyl ether	ND	20	"	"	"	"	"	"	
Ethyl tert-butyl ether	ND	20	"	"	"	"	"	"	
Methyl tert-butyl ether	ND	20	"	"	"	"	"	"	
Ethanol	ND	500	"	"	"	"	"	"	
<i>Surrogate: Toluene-d8</i>		92.2 %	85.5-116		"	"	"	"	
<i>Surrogate: 4-Bromofluorobenzene</i>		96.0 %	81.2-123		"	"	"	"	
<i>Surrogate: Dibromofluoromethane</i>		87.1 %	95.7-135		"	"	"	"	S-GC

SunStar Laboratories, Inc.

The results in this report apply to the samples analyzed in accordance with the chain of custody document. This analytical report must be reproduced in its entirety.



Wendy Hsiao, Project Manager

PSI -- Oakland 4703 Tidewater Ave Ste B Oakland CA, 94601	Project: ECHOJ Project Number: 575-443 Project Manager: Brand Burfield	Reported: 10/17/12 09:29
---	--	-----------------------------

**SP-C2-N
T121480-09 (Soil)**

Analyte	Result	Reporting Limit	Units	Dilution	Batch	Prepared	Analyzed	Method	Notes
---------	--------	-----------------	-------	----------	-------	----------	----------	--------	-------

SunStar Laboratories, Inc.

Extractable Petroleum Hydrocarbons by 8015C

Analyte	Result	Reporting Limit	Units	Dilution	Batch	Prepared	Analyzed	Method	Notes
C29-C40 (MORO)	1400	10	mg/kg	1	2091213	09/12/12	09/12/11	EPA 8015C	I-02
<i>Surrogate: p-Terphenyl</i>		109 %	65-135		"	"	"	"	I-02
Diesel Range Hydrocarbons	290	5.0	"	"	2082916	08/29/12	08/31/12	"	
<i>Surrogate: p-Terphenyl</i>		113 %	65-135		"	"	"	"	

Volatile Organic Compounds by EPA Method 8260B

Analyte	Result	Reporting Limit	Units	Dilution	Batch	Prepared	Analyzed	Method	Notes
1,2-Dibromoethane (EDB)	ND	5.0	ug/kg	1	2083026	08/30/12	08/31/12	EPA 8260B	
1,2-Dichloroethane	ND	5.0	"	"	"	"	"	"	
Benzene	ND	5.0	"	"	"	"	"	"	
Toluene	ND	5.0	"	"	"	"	"	"	
Ethylbenzene	ND	5.0	"	"	"	"	"	"	
m,p-Xylene	ND	5.0	"	"	"	"	"	"	
o-Xylene	ND	5.0	"	"	"	"	"	"	
Tert-amyl methyl ether	ND	20	"	"	"	"	"	"	
Tert-butyl alcohol	ND	50	"	"	"	"	"	"	
Di-isopropyl ether	ND	20	"	"	"	"	"	"	
Ethyl tert-butyl ether	ND	20	"	"	"	"	"	"	
Methyl tert-butyl ether	ND	20	"	"	"	"	"	"	
Ethanol	ND	500	"	"	"	"	"	"	
<i>Surrogate: Toluene-d8</i>		91.6 %	85.5-116		"	"	"	"	
<i>Surrogate: 4-Bromofluorobenzene</i>		96.2 %	81.2-123		"	"	"	"	
<i>Surrogate: Dibromofluoromethane</i>		84.9 %	95.7-135		"	"	"	"	S-GC

SunStar Laboratories, Inc.

The results in this report apply to the samples analyzed in accordance with the chain of custody document. This analytical report must be reproduced in its entirety.



Wendy Hsiao, Project Manager

PSI -- Oakland 4703 Tidewater Ave Ste B Oakland CA, 94601	Project: ECHOJ Project Number: 575-443 Project Manager: Brand Burfield	Reported: 10/17/12 09:29
---	--	-----------------------------

**SP-C2-S
T121480-10 (Soil)**

Analyte	Result	Reporting Limit	Units	Dilution	Batch	Prepared	Analyzed	Method	Notes
---------	--------	-----------------	-------	----------	-------	----------	----------	--------	-------

SunStar Laboratories, Inc.

Extractable Petroleum Hydrocarbons by 8015C

C29-C40 (MORO)	790	10	mg/kg	1	2091213	09/12/12	09/12/11	EPA 8015C	I-02
<i>Surrogate: p-Terphenyl</i>		102 %	65-135		"	"	"	"	I-02
Diesel Range Hydrocarbons	180	5.0	"	"	2082916	08/29/12	08/31/12	"	
<i>Surrogate: p-Terphenyl</i>		133 %	65-135		"	"	"	"	

Volatile Organic Compounds by EPA Method 8260B

1,2-Dibromoethane (EDB)	ND	5.0	ug/kg	1	2083026	08/30/12	08/31/12	EPA 8260B	
1,2-Dichloroethane	ND	5.0	"	"	"	"	"	"	
Benzene	ND	5.0	"	"	"	"	"	"	
Toluene	ND	5.0	"	"	"	"	"	"	
Ethylbenzene	ND	5.0	"	"	"	"	"	"	
m,p-Xylene	ND	5.0	"	"	"	"	"	"	
o-Xylene	ND	5.0	"	"	"	"	"	"	
Tert-amyl methyl ether	ND	20	"	"	"	"	"	"	
Tert-butyl alcohol	ND	50	"	"	"	"	"	"	
Di-isopropyl ether	ND	20	"	"	"	"	"	"	
Ethyl tert-butyl ether	ND	20	"	"	"	"	"	"	
Methyl tert-butyl ether	ND	20	"	"	"	"	"	"	
Ethanol	ND	500	"	"	"	"	"	"	
<i>Surrogate: Toluene-d8</i>		92.1 %	85.5-116		"	"	"	"	
<i>Surrogate: 4-Bromofluorobenzene</i>		96.5 %	81.2-123		"	"	"	"	
<i>Surrogate: Dibromofluoromethane</i>		85.1 %	95.7-135		"	"	"	"	S-GC

SunStar Laboratories, Inc.

The results in this report apply to the samples analyzed in accordance with the chain of custody document. This analytical report must be reproduced in its entirety.



Wendy Hsiao, Project Manager

PSI -- Oakland 4703 Tidewater Ave Ste B Oakland CA, 94601	Project: ECHOJ Project Number: 575-443 Project Manager: Brand Burfield	Reported: 10/17/12 09:29
---	--	------------------------------------

**SP-C2-E
T121480-11 (Soil)**

Analyte	Result	Reporting Limit	Units	Dilution	Batch	Prepared	Analyzed	Method	Notes
---------	--------	-----------------	-------	----------	-------	----------	----------	--------	-------

SunStar Laboratories, Inc.

Extractable Petroleum Hydrocarbons by 8015C

Analyte	Result	Reporting Limit	Units	Dilution	Batch	Prepared	Analyzed	Method
C29-C40 (MORO)	2700	10	mg/kg	1	2090722	09/07/12	09/08/12	EPA 8015C
<i>Surrogate: p-Terphenyl</i>		128 %	65-135		"	"	"	"
Diesel Range Hydrocarbons	430	5.0	"	"	2082916	08/29/12	08/31/12	"
<i>Surrogate: p-Terphenyl</i>		134 %	65-135		"	"	"	"

Volatile Organic Compounds by EPA Method 8260B

Analyte	Result	Reporting Limit	Units	Dilution	Batch	Prepared	Analyzed	Method	Notes
1,2-Dibromoethane (EDB)	ND	5.0	ug/kg	1	2083026	08/30/12	08/31/12	EPA 8260B	
1,2-Dichloroethane	ND	5.0	"	"	"	"	"	"	
Benzene	ND	5.0	"	"	"	"	"	"	
Toluene	ND	5.0	"	"	"	"	"	"	
Ethylbenzene	ND	5.0	"	"	"	"	"	"	
m,p-Xylene	ND	5.0	"	"	"	"	"	"	
o-Xylene	ND	5.0	"	"	"	"	"	"	
Tert-amyl methyl ether	ND	20	"	"	"	"	"	"	
Tert-butyl alcohol	ND	50	"	"	"	"	"	"	
Di-isopropyl ether	ND	20	"	"	"	"	"	"	
Ethyl tert-butyl ether	ND	20	"	"	"	"	"	"	
Methyl tert-butyl ether	ND	20	"	"	"	"	"	"	
Ethanol	ND	500	"	"	"	"	"	"	
<i>Surrogate: Toluene-d8</i>		92.0 %	85.5-116		"	"	"	"	
<i>Surrogate: 4-Bromofluorobenzene</i>		96.0 %	81.2-123		"	"	"	"	
<i>Surrogate: Dibromofluoromethane</i>		85.5 %	95.7-135		"	"	"	"	S-GC

SunStar Laboratories, Inc.

The results in this report apply to the samples analyzed in accordance with the chain of custody document. This analytical report must be reproduced in its entirety.



Wendy Hsiao, Project Manager

PSI -- Oakland
4703 Tidewater Ave Ste B
Oakland CA, 94601

Project: ECHOJ
Project Number: 575-443
Project Manager: Brand Burfield

Reported:
10/17/12 09:29

**SP-C2-W
T121480-12 (Soil)**

Analyte	Result	Reporting Limit	Units	Dilution	Batch	Prepared	Analyzed	Method	Notes
---------	--------	-----------------	-------	----------	-------	----------	----------	--------	-------

SunStar Laboratories, Inc.

Extractable Petroleum Hydrocarbons by 8015C

Analyte	Result	Reporting Limit	Units	Dilution	Batch	Prepared	Analyzed	Method	Notes
C29-C40 (MORO)	1200	10	mg/kg	1	2091213	09/12/12	09/12/11	EPA 8015C	I-02
<i>Surrogate: p-Terphenyl</i>		93.4 %	65-135		"	"	"	"	I-02
Diesel Range Hydrocarbons	160	5.0	"	"	2082916	08/29/12	08/31/12	"	
<i>Surrogate: p-Terphenyl</i>		129 %	65-135		"	"	"	"	

Volatile Organic Compounds by EPA Method 8260B

Analyte	Result	Reporting Limit	Units	Dilution	Batch	Prepared	Analyzed	Method	Notes
1,2-Dibromoethane (EDB)	ND	5.0	ug/kg	1	2083026	08/30/12	08/31/12	EPA 8260B	
1,2-Dichloroethane	ND	5.0	"	"	"	"	"	"	
Benzene	ND	5.0	"	"	"	"	"	"	
Toluene	ND	5.0	"	"	"	"	"	"	
Ethylbenzene	ND	5.0	"	"	"	"	"	"	
m,p-Xylene	ND	5.0	"	"	"	"	"	"	
o-Xylene	ND	5.0	"	"	"	"	"	"	
Tert-amyl methyl ether	ND	20	"	"	"	"	"	"	
Tert-butyl alcohol	ND	50	"	"	"	"	"	"	
Di-isopropyl ether	ND	20	"	"	"	"	"	"	
Ethyl tert-butyl ether	ND	20	"	"	"	"	"	"	
Methyl tert-butyl ether	ND	20	"	"	"	"	"	"	
Ethanol	ND	500	"	"	"	"	"	"	
<i>Surrogate: Toluene-d8</i>		91.2 %	85.5-116		"	"	"	"	
<i>Surrogate: 4-Bromofluorobenzene</i>		94.9 %	81.2-123		"	"	"	"	
<i>Surrogate: Dibromofluoromethane</i>		84.8 %	95.7-135		"	"	"	"	S-GC

SunStar Laboratories, Inc.

The results in this report apply to the samples analyzed in accordance with the chain of custody document. This analytical report must be reproduced in its entirety.



Wendy Hsiao, Project Manager

PSI -- Oakland 4703 Tidewater Ave Ste B Oakland CA, 94601	Project: ECHOJ Project Number: 575-443 Project Manager: Brand Burfield	Reported: 10/17/12 09:29
---	--	-----------------------------

**SP-C3-1
T121480-13 (Soil)**

Analyte	Result	Reporting Limit	Units	Dilution	Batch	Prepared	Analyzed	Method	Notes
---------	--------	-----------------	-------	----------	-------	----------	----------	--------	-------

SunStar Laboratories, Inc.

Extractable Petroleum Hydrocarbons by 8015C

Analyte	Result	Reporting Limit	Units	Dilution	Batch	Prepared	Analyzed	Method	Notes
C29-C40 (MORO)	130	10	mg/kg	1	2091213	09/12/12	09/12/11	EPA 8015C	I-02
<i>Surrogate: p-Terphenyl</i>		110 %	65-135		"	"	"	"	I-02
Diesel Range Hydrocarbons	29	5.0	"	"	2082916	08/29/12	08/31/12	"	
<i>Surrogate: p-Terphenyl</i>		127 %	65-135		"	"	"	"	

Volatile Organic Compounds by EPA Method 8260B

Analyte	Result	Reporting Limit	Units	Dilution	Batch	Prepared	Analyzed	Method	Notes
1,2-Dibromoethane (EDB)	ND	5.0	ug/kg	1	2083026	08/30/12	08/31/12	EPA 8260B	
1,2-Dichloroethane	ND	5.0	"	"	"	"	"	"	
Benzene	ND	5.0	"	"	"	"	"	"	
Toluene	ND	5.0	"	"	"	"	"	"	
Ethylbenzene	ND	5.0	"	"	"	"	"	"	
m,p-Xylene	ND	5.0	"	"	"	"	"	"	
o-Xylene	ND	5.0	"	"	"	"	"	"	
Tert-amyl methyl ether	ND	20	"	"	"	"	"	"	
Tert-butyl alcohol	ND	50	"	"	"	"	"	"	
Di-isopropyl ether	ND	20	"	"	"	"	"	"	
Ethyl tert-butyl ether	ND	20	"	"	"	"	"	"	
Methyl tert-butyl ether	ND	20	"	"	"	"	"	"	
Ethanol	ND	500	"	"	"	"	"	"	
<i>Surrogate: Toluene-d8</i>		92.2 %	85.5-116		"	"	"	"	
<i>Surrogate: 4-Bromofluorobenzene</i>		95.0 %	81.2-123		"	"	"	"	
<i>Surrogate: Dibromofluoromethane</i>		86.4 %	95.7-135		"	"	"	"	S-GC

SunStar Laboratories, Inc.

The results in this report apply to the samples analyzed in accordance with the chain of custody document. This analytical report must be reproduced in its entirety.



Wendy Hsiao, Project Manager

PSI -- Oakland
4703 Tidewater Ave Ste B
Oakland CA, 94601

Project: ECHOJ
Project Number: 575-443
Project Manager: Brand Burfield

Reported:
10/17/12 09:29

**SP-D1-1 thru SP-D1-4
T121480-30 (Soil)**

Analyte	Result	Reporting Limit	Units	Dilution	Batch	Prepared	Analyzed	Method	Notes
---------	--------	-----------------	-------	----------	-------	----------	----------	--------	-------

SunStar Laboratories, Inc.

Extractable Petroleum Hydrocarbons by 8015C

C13-C28 (DRO)	680	10	mg/kg	1	2082916	08/29/12	08/31/12	EPA 8015C	
C29-C40 (MORO)	4300	10	"	"	"	"	"	"	
<i>Surrogate: p-Terphenyl</i>		131 %	65-135		"	"	"	"	

Volatile Organic Compounds by EPA Method 8260B

1,2-Dibromoethane (EDB)	ND	5.0	ug/kg	1	2083026	08/30/12	08/31/12	EPA 8260B	
1,2-Dichloroethane	ND	5.0	"	"	"	"	"	"	
Benzene	ND	5.0	"	"	"	"	"	"	
Toluene	ND	5.0	"	"	"	"	"	"	
Ethylbenzene	ND	5.0	"	"	"	"	"	"	
m,p-Xylene	ND	5.0	"	"	"	"	"	"	
o-Xylene	ND	5.0	"	"	"	"	"	"	
Tert-amyl methyl ether	ND	20	"	"	"	"	"	"	
Tert-butyl alcohol	ND	50	"	"	"	"	"	"	
Di-isopropyl ether	ND	20	"	"	"	"	"	"	
Ethyl tert-butyl ether	ND	20	"	"	"	"	"	"	
Methyl tert-butyl ether	ND	20	"	"	"	"	"	"	
Ethanol	ND	500	"	"	"	"	"	"	
<i>Surrogate: Toluene-d8</i>		92.0 %	85.5-116		"	"	"	"	
<i>Surrogate: 4-Bromofluorobenzene</i>		94.5 %	81.2-123		"	"	"	"	
<i>Surrogate: Dibromofluoromethane</i>		86.4 %	95.7-135		"	"	"	"	S-GC

SunStar Laboratories, Inc.

The results in this report apply to the samples analyzed in accordance with the chain of custody document. This analytical report must be reproduced in its entirety.



Wendy Hsiao, Project Manager

PSI -- Oakland
4703 Tidewater Ave Ste B
Oakland CA, 94601

Project: ECHOJ
Project Number: 575-443
Project Manager: Brand Burfield

Reported:
10/17/12 09:29

**SP-D2-1 thru SP-D2-4
T121480-31 (Soil)**

Analyte	Result	Reporting Limit	Units	Dilution	Batch	Prepared	Analyzed	Method	Notes
---------	--------	-----------------	-------	----------	-------	----------	----------	--------	-------

SunStar Laboratories, Inc.

Extractable Petroleum Hydrocarbons by 8015C

C13-C28 (DRO)	4900	10	mg/kg	1	2082916	08/29/12	08/31/12	EPA 8015C	
C29-C40 (MORO)	8200	10	"	"	"	"	"	"	
<i>Surrogate: p-Terphenyl</i>		125 %	65-135		"	"	"	"	

Volatile Organic Compounds by EPA Method 8260B

1,2-Dibromoethane (EDB)	ND	5.0	ug/kg	1	2083026	08/30/12	08/31/12	EPA 8260B	
1,2-Dichloroethane	ND	5.0	"	"	"	"	"	"	
Benzene	ND	5.0	"	"	"	"	"	"	
Toluene	ND	5.0	"	"	"	"	"	"	
Ethylbenzene	5.6	5.0	"	"	"	"	"	"	
m,p-Xylene	ND	5.0	"	"	"	"	"	"	
o-Xylene	ND	5.0	"	"	"	"	"	"	
Tert-amyl methyl ether	ND	20	"	"	"	"	"	"	
Tert-butyl alcohol	ND	50	"	"	"	"	"	"	
Di-isopropyl ether	ND	20	"	"	"	"	"	"	
Ethyl tert-butyl ether	ND	20	"	"	"	"	"	"	
Methyl tert-butyl ether	ND	20	"	"	"	"	"	"	
Ethanol	ND	500	"	"	"	"	"	"	
<i>Surrogate: Toluene-d8</i>		89.4 %	85.5-116		"	"	"	"	
<i>Surrogate: 4-Bromofluorobenzene</i>		100 %	81.2-123		"	"	"	"	
<i>Surrogate: Dibromofluoromethane</i>		85.1 %	95.7-135		"	"	"	"	S-GC

SunStar Laboratories, Inc.

The results in this report apply to the samples analyzed in accordance with the chain of custody document. This analytical report must be reproduced in its entirety.



Wendy Hsiao, Project Manager

PSI -- Oakland 4703 Tidewater Ave Ste B Oakland CA, 94601	Project: ECHOJ Project Number: 575-443 Project Manager: Brand Burfield	Reported: 10/17/12 09:29
---	--	------------------------------------

**SP-D2-5 thru SP-D2-8
T121480-32 (Soil)**

Analyte	Result	Reporting Limit	Units	Dilution	Batch	Prepared	Analyzed	Method	Notes
---------	--------	--------------------	-------	----------	-------	----------	----------	--------	-------

SunStar Laboratories, Inc.

Extractable Petroleum Hydrocarbons by 8015C

C13-C28 (DRO)	5400	10	mg/kg	1	2082916	08/29/12	08/31/12	EPA 8015C	
C29-C40 (MORO)	9200	10	"	"	"	"	"	"	
<i>Surrogate: p-Terphenyl</i>		133 %	65-135		"	"	"	"	

Volatile Organic Compounds by EPA Method 8260B

1,2-Dibromoethane (EDB)	ND	5.0	ug/kg	1	2083026	08/30/12	08/31/12	EPA 8260B	
1,2-Dichloroethane	ND	5.0	"	"	"	"	"	"	
Benzene	ND	5.0	"	"	"	"	"	"	
Toluene	ND	5.0	"	"	"	"	"	"	
Ethylbenzene	ND	5.0	"	"	"	"	"	"	
m,p-Xylene	ND	5.0	"	"	"	"	"	"	
o-Xylene	ND	5.0	"	"	"	"	"	"	
Tert-amyl methyl ether	ND	20	"	"	"	"	"	"	
Tert-butyl alcohol	ND	50	"	"	"	"	"	"	
Di-isopropyl ether	ND	20	"	"	"	"	"	"	
Ethyl tert-butyl ether	ND	20	"	"	"	"	"	"	
Methyl tert-butyl ether	ND	20	"	"	"	"	"	"	
Ethanol	ND	500	"	"	"	"	"	"	
<i>Surrogate: Toluene-d8</i>		89.1 %	85.5-116		"	"	"	"	
<i>Surrogate: 4-Bromofluorobenzene</i>		91.4 %	81.2-123		"	"	"	"	
<i>Surrogate: Dibromofluoromethane</i>		82.2 %	95.7-135		"	"	"	"	S-GC

SunStar Laboratories, Inc.

The results in this report apply to the samples analyzed in accordance with the chain of custody document. This analytical report must be reproduced in its entirety.



Wendy Hsiao, Project Manager

PSI -- Oakland
4703 Tidewater Ave Ste B
Oakland CA, 94601

Project: ECHOJ
Project Number: 575-443
Project Manager: Brand Burfield

Reported:
10/17/12 09:29

**SP-D3-1 & SP-D3-2
T121480-33 (Soil)**

Analyte	Result	Reporting Limit	Units	Dilution	Batch	Prepared	Analyzed	Method	Notes
---------	--------	-----------------	-------	----------	-------	----------	----------	--------	-------

SunStar Laboratories, Inc.

Extractable Petroleum Hydrocarbons by 8015C

C13-C28 (DRO)	56	10	mg/kg	1	2082916	08/29/12	08/31/12	EPA 8015C	
C29-C40 (MORO)	870	10	"	"	"	"	"	"	
Surrogate: <i>p</i> -Terphenyl		135 %	65-135		"	"	"	"	

Volatile Organic Compounds by EPA Method 8260B

1,2-Dibromoethane (EDB)	ND	5.0	ug/kg	1	2083026	08/30/12	08/31/12	EPA 8260B	
1,2-Dichloroethane	ND	5.0	"	"	"	"	"	"	
Benzene	ND	5.0	"	"	"	"	"	"	
Toluene	ND	5.0	"	"	"	"	"	"	
Ethylbenzene	ND	5.0	"	"	"	"	"	"	
m,p-Xylene	ND	5.0	"	"	"	"	"	"	
o-Xylene	ND	5.0	"	"	"	"	"	"	
Tert-amyl methyl ether	ND	20	"	"	"	"	"	"	
Tert-butyl alcohol	ND	50	"	"	"	"	"	"	
Di-isopropyl ether	ND	20	"	"	"	"	"	"	
Ethyl tert-butyl ether	ND	20	"	"	"	"	"	"	
Methyl tert-butyl ether	ND	20	"	"	"	"	"	"	
Ethanol	ND	500	"	"	"	"	"	"	
Surrogate: <i>Toluene-d8</i>		92.8 %	85.5-116		"	"	"	"	
Surrogate: <i>4-Bromofluorobenzene</i>		97.1 %	81.2-123		"	"	"	"	
Surrogate: <i>Dibromofluoromethane</i>		84.5 %	95.7-135		"	"	"	"	S-GC

SunStar Laboratories, Inc.

The results in this report apply to the samples analyzed in accordance with the chain of custody document. This analytical report must be reproduced in its entirety.



Wendy Hsiao, Project Manager

PSI -- Oakland
4703 Tidewater Ave Ste B
Oakland CA, 94601

Project: ECHOJ
Project Number: 575-443
Project Manager: Brand Burfield

Reported:
10/17/12 09:29

**SP-D4-1 & SP-D4-2
T121480-34 (Soil)**

Analyte	Result	Reporting Limit	Units	Dilution	Batch	Prepared	Analyzed	Method	Notes
---------	--------	-----------------	-------	----------	-------	----------	----------	--------	-------

SunStar Laboratories, Inc.

Extractable Petroleum Hydrocarbons by 8015C

C13-C28 (DRO)	490	10	mg/kg	1	2082916	08/29/12	08/31/12	EPA 8015C	
C29-C40 (MORO)	2300	10	"	"	"	"	"	"	
<i>Surrogate: p-Terphenyl</i>		132 %	65-135		"	"	"	"	

Volatile Organic Compounds by EPA Method 8260B

1,2-Dibromoethane (EDB)	ND	5.0	ug/kg	1	2083026	08/30/12	08/31/12	EPA 8260B	
1,2-Dichloroethane	ND	5.0	"	"	"	"	"	"	
Benzene	ND	5.0	"	"	"	"	"	"	
Toluene	ND	5.0	"	"	"	"	"	"	
Ethylbenzene	ND	5.0	"	"	"	"	"	"	
m,p-Xylene	ND	5.0	"	"	"	"	"	"	
o-Xylene	ND	5.0	"	"	"	"	"	"	
Tert-amyl methyl ether	ND	20	"	"	"	"	"	"	
Tert-butyl alcohol	ND	50	"	"	"	"	"	"	
Di-isopropyl ether	ND	20	"	"	"	"	"	"	
Ethyl tert-butyl ether	ND	20	"	"	"	"	"	"	
Methyl tert-butyl ether	ND	20	"	"	"	"	"	"	
Ethanol	ND	500	"	"	"	"	"	"	
<i>Surrogate: Toluene-d8</i>		89.6 %	85.5-116		"	"	"	"	
<i>Surrogate: 4-Bromofluorobenzene</i>		98.0 %	81.2-123		"	"	"	"	
<i>Surrogate: Dibromofluoromethane</i>		83.4 %	95.7-135		"	"	"	"	S-GC

SunStar Laboratories, Inc.

The results in this report apply to the samples analyzed in accordance with the chain of custody document. This analytical report must be reproduced in its entirety.



Wendy Hsiao, Project Manager

PSI -- Oakland
4703 Tidewater Ave Ste B
Oakland CA, 94601

Project: ECHOJ
Project Number: 575-443
Project Manager: Brand Burfield

Reported:
10/17/12 09:29

Extractable Petroleum Hydrocarbons by 8015C - Quality Control
SunStar Laboratories, Inc.

Analyte	Result	Reporting Limit	Units	Spike Level	Source Result	%REC	%REC Limits	RPD	RPD Limit	Notes
---------	--------	-----------------	-------	-------------	---------------	------	-------------	-----	-----------	-------

Batch 2082916 - EPA 3550B GC

Blank (2082916-BLK1)

Prepared: 08/29/12 Analyzed: 08/31/12

Diesel Range Hydrocarbons	ND	5.0	mg/kg							
C29-C40 (MORO)	ND	10	"							
Surrogate: <i>p</i> -Terphenyl	127		"	100		127	65-135			
Surrogate: <i>p</i> -Terphenyl	127		"	100		127	65-135			

LCS (2082916-BS1)

Prepared: 08/29/12 Analyzed: 08/31/12

Diesel Range Hydrocarbons	540	5.0	mg/kg	500	ND	108	75-125			
Surrogate: <i>p</i> -Terphenyl	115		"	100		115	65-135			
Surrogate: <i>p</i> -Terphenyl	115		"	100		115	65-135			

Matrix Spike (2082916-MS1)

Source: T121480-05

Prepared: 08/29/12 Analyzed: 08/31/12

Diesel Range Hydrocarbons	520	5.0	mg/kg	500	ND	104	75-125			
Surrogate: <i>p</i> -Terphenyl	106		"	100		106	65-135			
Surrogate: <i>p</i> -Terphenyl	106		"	100		106	65-135			

Matrix Spike Dup (2082916-MSD1)

Source: T121480-05

Prepared: 08/29/12 Analyzed: 08/31/12

Diesel Range Hydrocarbons	550	5.0	mg/kg	500	ND	110	75-125	5.48	20	
Surrogate: <i>p</i> -Terphenyl	131		"	100		131	65-135			
Surrogate: <i>p</i> -Terphenyl	131		"	100		131	65-135			

Batch 2090722 - EPA 3550B GC

Blank (2090722-BLK1)

Prepared: 09/07/12 Analyzed: 09/08/12

C29-C40 (MORO)	ND	10	mg/kg							
Surrogate: <i>p</i> -Terphenyl	134		"	100		134	65-135			

LCS (2090722-BS1)

Prepared: 09/07/12 Analyzed: 09/08/12

Surrogate: <i>p</i> -Terphenyl	130		mg/kg	100		130	65-135			
--------------------------------	-----	--	-------	-----	--	-----	--------	--	--	--

SunStar Laboratories, Inc.

The results in this report apply to the samples analyzed in accordance with the chain of custody document. This analytical report must be reproduced in its entirety.



Wendy Hsiao, Project Manager



25712 Commercentre Drive
 Lake Forest, California 92630
 949.297.5020 Phone
 949.297.5027 Fax

PSI -- Oakland 4703 Tidewater Ave Ste B Oakland CA, 94601	Project: ECHOJ Project Number: 575-443 Project Manager: Brand Burfield	Reported: 10/17/12 09:29
---	--	------------------------------------

Extractable Petroleum Hydrocarbons by 8015C - Quality Control
SunStar Laboratories, Inc.

Analyte	Result	Reporting Limit	Units	Spike Level	Source Result	%REC	%REC Limits	RPD	RPD Limit	Notes
---------	--------	-----------------	-------	-------------	---------------	------	-------------	-----	-----------	-------

Batch 2090722 - EPA 3550B GC

Matrix Spike (2090722-MS1)	Source: T121548-31		Prepared: 09/07/12		Analyzed: 09/08/12	
Surrogate: <i>p</i> -Terphenyl	127		mg/kg	100	127	65-135
Matrix Spike Dup (2090722-MSD1)	Source: T121548-31		Prepared: 09/07/12		Analyzed: 09/08/12	
Surrogate: <i>p</i> -Terphenyl	127		mg/kg	100	127	65-135

Batch 2091213 - EPA 3550B GC

Blank (2091213-BLK1)			Prepared & Analyzed: 09/12/12			
C29-C40 (MORO)	ND	10	mg/kg			
Surrogate: <i>p</i> -Terphenyl	105		"	100	105	65-135
LCS (2091213-BS1)			Prepared & Analyzed: 09/12/12			
Surrogate: <i>p</i> -Terphenyl	106		mg/kg	100	106	65-135
Matrix Spike (2091213-MS1)	Source: T121480-07		Prepared & Analyzed: 09/12/12			
Surrogate: <i>p</i> -Terphenyl	94.7		mg/kg	100	94.7	65-135
Matrix Spike Dup (2091213-MSD1)	Source: T121480-07		Prepared & Analyzed: 09/12/12			
Surrogate: <i>p</i> -Terphenyl	118		mg/kg	100	118	65-135

SunStar Laboratories, Inc.

The results in this report apply to the samples analyzed in accordance with the chain of custody document. This analytical report must be reproduced in its entirety.

Wendy Hsiao, Project Manager

PSI -- Oakland
4703 Tidewater Ave Ste B
Oakland CA, 94601

Project: ECHOJ
Project Number: 575-443
Project Manager: Brand Burfield

Reported:
10/17/12 09:29

Volatile Organic Compounds by EPA Method 8260B - Quality Control

SunStar Laboratories, Inc.

Analyte	Result	Reporting Limit	Units	Spike Level	Source Result	%REC	%REC Limits	RPD	RPD Limit	Notes
---------	--------	-----------------	-------	-------------	---------------	------	-------------	-----	-----------	-------

Batch 2083026 - EPA 5030 GCMS

Blank (2083026-BLK1)

Prepared: 08/30/12 Analyzed: 08/31/12

1,2-Dibromoethane (EDB)	ND	5.0	ug/kg							
1,2-Dichloroethane	ND	5.0	"							
Benzene	ND	5.0	"							
Toluene	ND	5.0	"							
Ethylbenzene	ND	5.0	"							
m,p-Xylene	ND	5.0	"							
o-Xylene	ND	5.0	"							
Tert-amyl methyl ether	ND	20	"							
Tert-butyl alcohol	ND	50	"							
Di-isopropyl ether	ND	20	"							
Ethyl tert-butyl ether	ND	20	"							
Methyl tert-butyl ether	ND	20	"							
Ethanol	ND	500	"							
<i>Surrogate: Toluene-d8</i>	40.4		"	40.0		101	85.5-116			
<i>Surrogate: 4-Bromofluorobenzene</i>	35.8		"	40.0		89.6	81.2-123			
<i>Surrogate: Dibromofluoromethane</i>	38.9		"	40.0		97.2	95.7-135			

LCS (2083026-BS1)

Prepared: 08/30/12 Analyzed: 08/31/12

Chlorobenzene	87.2	5.0	ug/kg	100		87.2	75-125			
1,1-Dichloroethene	85.2	5.0	"	100		85.2	75-125			
Trichloroethene	91.0	5.0	"	100		91.0	75-125			
Benzene	86.2	5.0	"	100		86.2	75-125			
Toluene	94.2	5.0	"	100		94.2	75-125			
<i>Surrogate: Toluene-d8</i>	39.6		"	40.0		99.0	85.5-116			
<i>Surrogate: 4-Bromofluorobenzene</i>	36.6		"	40.0		91.6	81.2-123			
<i>Surrogate: Dibromofluoromethane</i>	35.6		"	40.0		89.0	95.7-135			S-GC

Matrix Spike (2083026-MS1)

Source: T121480-01

Prepared: 08/30/12 Analyzed: 08/31/12

Chlorobenzene	92.5	5.0	ug/kg	100	ND	92.5	75-125			
1,1-Dichloroethene	89.9	5.0	"	100	ND	89.9	75-125			
Trichloroethene	80.7	5.0	"	100	ND	80.7	75-125			
Benzene	87.5	5.0	"	100	ND	87.5	75-125			
Toluene	89.0	5.0	"	100	ND	89.0	75-125			
<i>Surrogate: Toluene-d8</i>	40.0		"	40.0		99.9	85.5-116			
<i>Surrogate: 4-Bromofluorobenzene</i>	42.3		"	40.0		106	81.2-123			
<i>Surrogate: Dibromofluoromethane</i>	37.1		"	40.0		92.8	95.7-135			S-GC

SunStar Laboratories, Inc.

The results in this report apply to the samples analyzed in accordance with the chain of custody document. This analytical report must be reproduced in its entirety.



Wendy Hsiao, Project Manager

PSI -- Oakland
4703 Tidewater Ave Ste B
Oakland CA, 94601

Project: ECHOJ
Project Number: 575-443
Project Manager: Brand Burfield

Reported:
10/17/12 09:29

Volatile Organic Compounds by EPA Method 8260B - Quality Control

SunStar Laboratories, Inc.

Analyte	Result	Reporting Limit	Units	Spike Level	Source Result	%REC	%REC Limits	RPD	RPD Limit	Notes
---------	--------	-----------------	-------	-------------	---------------	------	-------------	-----	-----------	-------

Batch 2083026 - EPA 5030 GCMS

Matrix Spike Dup (2083026-MSD1)	Source: T121480-01			Prepared: 08/30/12		Analyzed: 08/31/12				
Chlorobenzene	102	5.0	ug/kg	100	ND	102	75-125	10.2	20	
1,1-Dichloroethene	90.6	5.0	"	100	ND	90.6	75-125	0.776	20	
Trichloroethene	80.0	5.0	"	100	ND	80.0	75-125	0.809	20	
Benzene	87.4	5.0	"	100	ND	87.4	75-125	0.0572	20	
Toluene	87.8	5.0	"	100	ND	87.8	75-125	1.41	20	
<i>Surrogate: Toluene-d8</i>	39.2		"	40.0		98.0	85.5-116			
<i>Surrogate: 4-Bromofluorobenzene</i>	45.6		"	40.0		114	81.2-123			
<i>Surrogate: Dibromofluoromethane</i>	37.6		"	40.0		93.9	95.7-135			S-GC

SunStar Laboratories, Inc.

The results in this report apply to the samples analyzed in accordance with the chain of custody document. This analytical report must be reproduced in its entirety.



Wendy Hsiao, Project Manager

PSI -- Oakland

Project: ECHOJ

4703 Tidewater Ave Ste B

Project Number: 575-443

Oakland CA, 94601

Project Manager: Brand Burfield

Reported:

10/17/12 09:29

Notes and Definitions

- S-GC Surrogate recovery outside of established control limits. The data was accepted based on valid recovery of the remaining surrogate(s).
- I-02 This result was analyzed outside of the EPA recommended holding time.
- E The concentration indicated for this analyte is above the calibration range of the instrument. This value should be considered as an estimate as the actual value may be higher.
- DET Analyte DETECTED
- ND Analyte NOT DETECTED at or above the reporting limit
- NR Not Reported
- dry Sample results reported on a dry weight basis
- RPD Relative Percent Difference

SunStar Laboratories, Inc.

The results in this report apply to the samples analyzed in accordance with the chain of custody document. This analytical report must be reproduced in its entirety.



Wendy Hsiao, Project Manager

SunStar Laboratories, Inc.
 25712 Commercentre Dr
 Lake Forest, CA 92630
 949-297-5020

Chain of Custody Record

Client: PSI
 Address: 4703 TIDEWATER AVE. SE. B, OAKLAND CA 94601
 Phone: (510) 434-9200 (x19) Fax: (510) 434-7676
 Project Manager: BRAND BURFIELD

Date: Aug 27, 2012 Page: 1 Of 3
 Project Name: ECHOJ
 Collector: B. BURFIELD Client Project #: 575-443
 Batch #: _____ EDF #: N/A

Sample ID	Date Sampled	Time	Sample Type	Container Type	8260	8260 + OXY	8260 BTEX, OXY only *	8270	8021 BTEX	8015M (gasoline)	8015M (diesel)	8015M Ext./Carbon Chain	6010/7000 Title 22 Metals	Laboratory ID #	Comments/Preservative	Total # of containers
TP-NW-14'	8-27-12	10:35	Soil	TUBE			/				/					
TP-SW-14'		10:45			/	/										
TP-NE-14'		10:55			/	/										
TP-SE-14'		11:05			/	/										
TP-CNR-17'		12:15			/	/										
TP-E-17'		13:00			/	/										
SP-C1-1		11:40			/	/										
SP- C1-1 C1-2		12:05			/	/										
SP-C2-N		14:00			/	/										
SP-C2-S		14:20			/	/										
SP-C2-E	14:10	/	/													
SP-C2-W	13:50	/	/													
Relinquished by: (signature) <u>[Signature]</u>		Date / Time	Received by: (signature)		Date / Time		Total # of containers		Chain of Custody seals Y/N/NA		Seals intact? Y/N/NA		Received good condition/cold		* Notes	
		8/27/12 18:15	CSO ASBEN No, 107416574												OXY TO INCLUDE; EDB, EDC, EtOH, MTBE, TAME, ETBE, DIPE, TBA	
Relinquished by: (signature)		Date / Time	Received by: (signature)		Date / Time		Turn around time: <u>STD</u>									
Relinquished by: (signature)		Date / Time	Received by: (signature)		Date / Time											

Sample disposal Instructions: Disposal @ \$2.00 each _____ Return to client _____ Pickup _____

COC112267

SunStar Laboratories, Inc.
 25712 Commercentre Dr
 Lake Forest, CA 92630
 949-297-5020

Chain of Custody Record

Client: PSC
 Address: 4703 TIDEWATER AVE, STE B, OAKLAND CA 94601
 Phone: _____ Fax: _____
 Project Manager: BRAND BURFIELD

Date: AUG 27, 2012 Page: 2 Of 3
 Project Name: ECHOJ
 Collector: B. BURFIELD Client Project #: 575-443
 Batch #: _____ EDF #: N/A

Sample ID	Date Sampled	Time	Sample Type	Container Type	8260	8260 + OXY	8260 BTEX, OXY only *	8270	8021 BTEX	8015M (gasoline)	8015M (diesel)	8015M Ext./Carbon Chain	6010/7000 Title 22 Metals	8015M (MOTOR OIL)	Laboratory ID #	Comments/Preservative	Total # of containers			
SP-C3-1	8-27-12	12:45	SOIL	TUBE			/													
SP-D1-1		15:35					/										COMPOSITE 1 TUBE 4			
SP-D1-2		15:40																		
SP-D1-3		15:45																		
SP-D1-4		15:50																		
SP-D2-1		14:50					/										COMPOSITE 1 TUBE 4			
SP-D2-2		14:55																		
SP-D2-3		15:00																		
SP-D2-4		15:05																		
SP-D2-5		15:10																		
SP-D2-6		15:15																		
SP-D2-7		15:20																		
SP-D2-8		15:25																		
Relinquished by: (signature) <u>[Signature]</u> Date / Time <u>8/27/12 18:15</u>			Received by: (signature) <u>G/O ADREN NO</u> Date / Time <u>107416574</u>			Total # of containers			Chain of Custody seals Y/N/NA			Seals intact? Y/N/NA			Received good condition/cold			Notes * OXY NONE ON PG 1		
Relinquished by: (signature)			Received by: (signature)			Turn around time: <u>STD</u>														
Relinquished by: (signature)			Received by: (signature)																	

Sample disposal Instructions: Disposal @ \$2.00 each _____ Return to client _____ Pickup _____

COC112265

SunStar Laboratories, Inc.
 25712 Commercentre Dr
 Lake Forest, CA 92630
 949-297-5020

Chain of Custody Record

Client: PSI
 Address: 4703 TIDENATER AVE. STE B, OAKLAND CA 94601
 Phone: _____ Fax: _____
 Project Manager: BRAND BURFIELD

Date: AUG 27, 2012 Page: 3 Of 3
 Project Name: ECHOJ
 Collector: B. BURFIELD Client Project #: 575-443
 Batch #: _____ EDF #: N/A

Sample ID	Date Sampled	Time	Sample Type	Container Type	8260	8260 + OXY	8260 BTEX, OXY only *	8270	8021 BTEX	8015M (gasoline)	8015M (diesel)	8015M Ext./Carbon Chain	6010/7000 Title 22 Metals	8015M (MOTOR OIL)	Laboratory ID #	Comments/Preservative	Total # of containers
SP-D3-1	8-27-12		SOIL	TUBE			/				/			/		COMPOSITE	
SP-D3-2							/				/			/		COMPOSITE	
SP-D4-1							/				/			/		COMPOSITE	
SP-D4-2							/				/			/			
Relinquished by: (signature) <u>[Signature]</u>					Date / Time		Received by: (signature)			Date / Time		Total # of containers		* Notes OXY NONE ON PG 1			
Relinquished by: (signature)					Date / Time		Received by: (signature)			Date / Time		Chain of Custody seals Y/N/NA					
Relinquished by: (signature)					Date / Time		Received by: (signature)			Date / Time		Seals intact? Y/N/NA					
Relinquished by: (signature)					Date / Time		Received by: (signature)			Date / Time		Received good condition/cold		Turn around time: <u>STD</u>			

Sample disposal Instructions: Disposal @ \$2.00 each _____ Return to client _____ Pickup _____

COC112266



25712 Commercentre Drive
Lake Forest, California 92630
949.297.5020 Phone
949.297.5027 Fax

25 October 2012

Brand Burfield
PSI -- Oakland
4703 Tidewater Ave Ste B
Oakland, CA 94601
RE: ECHOJ

Enclosed are the results of analyses for samples received by the laboratory on 10/20/12 09:55. If you have any questions concerning this report, please feel free to contact me.

Sincerely,

Wendy Hsiao
Project Manager

PSI -- Oakland
4703 Tidewater Ave Ste B
Oakland CA, 94601

Project: ECHOJ
Project Number: 575-443
Project Manager: Brand Burfield

Reported:
10/25/12 14:27

ANALYTICAL REPORT FOR SAMPLES

Sample ID	Laboratory ID	Matrix	Date Sampled	Date Received
TP-NORTH WALL-12'	T121885-01	Soil	10/19/12 16:00	10/20/12 09:55
TP-WEST WALL-11'	T121885-02	Soil	10/19/12 16:15	10/20/12 09:55

SunStar Laboratories, Inc.

The results in this report apply to the samples analyzed in accordance with the chain of custody document. This analytical report must be reproduced in its entirety.



Wendy Hsiao, Project Manager

PSI -- Oakland
4703 Tidewater Ave Ste B
Oakland CA, 94601

Project: ECHOJ
Project Number: 575-443
Project Manager: Brand Burfield

Reported:
10/25/12 14:27

TP-NORTH WALL-12'
T121885-01 (Soil)

Analyte	Result	Reporting Limit	Units	Dilution	Batch	Prepared	Analyzed	Method	Notes
---------	--------	-----------------	-------	----------	-------	----------	----------	--------	-------

SunStar Laboratories, Inc.

Extractable Petroleum Hydrocarbons by 8015C

C13-C28 (DRO)	ND	10	mg/kg	1	2102216	10/22/12	10/24/12	EPA 8015C	
C29-C40 (MORO)	32	10	"	"	"	"	"	"	
Surrogate: <i>p</i> -Terphenyl		111 %	65-135		"	"	"	"	

Volatile Organic Compounds by EPA Method 8260B

1,2-Dibromoethane (EDB)	ND	5.0	ug/kg	1	2102330	10/23/12	10/24/12	EPA 8260B	
1,2-Dichloroethane	ND	5.0	"	"	"	"	"	"	
Benzene	ND	5.0	"	"	"	"	"	"	
Toluene	ND	5.0	"	"	"	"	"	"	
Ethylbenzene	ND	5.0	"	"	"	"	"	"	
m,p-Xylene	ND	5.0	"	"	"	"	"	"	
o-Xylene	ND	5.0	"	"	"	"	"	"	
Tert-amyl methyl ether	ND	20	"	"	"	"	"	"	
Tert-butyl alcohol	ND	50	"	"	"	"	"	"	
Di-isopropyl ether	ND	20	"	"	"	"	"	"	
Ethyl tert-butyl ether	ND	20	"	"	"	"	"	"	
Methyl tert-butyl ether	ND	20	"	"	"	"	"	"	
Ethanol	ND	500	"	"	"	"	"	"	
Surrogate: Toluene-d8		117 %	85.5-116		"	"	"	"	S-GC
Surrogate: 4-Bromofluorobenzene		95.6 %	81.2-123		"	"	"	"	
Surrogate: Dibromofluoromethane		88.8 %	95.7-135		"	"	"	"	S-GC

SunStar Laboratories, Inc.

The results in this report apply to the samples analyzed in accordance with the chain of custody document. This analytical report must be reproduced in its entirety.



Wendy Hsiao, Project Manager

PSI -- Oakland
4703 Tidewater Ave Ste B
Oakland CA, 94601

Project: ECHOJ
Project Number: 575-443
Project Manager: Brand Burfield

Reported:
10/25/12 14:27

TP-WEST WALL-11'
T121885-02 (Soil)

Analyte	Result	Reporting Limit	Units	Dilution	Batch	Prepared	Analyzed	Method	Notes
---------	--------	-----------------	-------	----------	-------	----------	----------	--------	-------

SunStar Laboratories, Inc.

Extractable Petroleum Hydrocarbons by 8015C

C13-C28 (DRO)	760	10	mg/kg	1	2102216	10/22/12	10/24/12	EPA 8015C	
C29-C40 (MORO)	4100	10	"	"	"	"	"	"	
<i>Surrogate: p-Terphenyl</i>		106 %	65-135		"	"	"	"	

Volatile Organic Compounds by EPA Method 8260B

1,2-Dibromoethane (EDB)	ND	5.0	ug/kg	1	2102330	10/23/12	10/24/12	EPA 8260B	
1,2-Dichloroethane	ND	5.0	"	"	"	"	"	"	
Benzene	ND	5.0	"	"	"	"	"	"	
Toluene	ND	5.0	"	"	"	"	"	"	
Ethylbenzene	ND	5.0	"	"	"	"	"	"	
m,p-Xylene	ND	5.0	"	"	"	"	"	"	
o-Xylene	ND	5.0	"	"	"	"	"	"	
Tert-amyl methyl ether	ND	20	"	"	"	"	"	"	
Tert-butyl alcohol	ND	50	"	"	"	"	"	"	
Di-isopropyl ether	ND	20	"	"	"	"	"	"	
Ethyl tert-butyl ether	ND	20	"	"	"	"	"	"	
Methyl tert-butyl ether	ND	20	"	"	"	"	"	"	
Ethanol	ND	500	"	"	"	"	"	"	
<i>Surrogate: Toluene-d8</i>		117 %	85.5-116		"	"	"	"	S-GC
<i>Surrogate: 4-Bromofluorobenzene</i>		90.6 %	81.2-123		"	"	"	"	
<i>Surrogate: Dibromofluoromethane</i>		93.2 %	95.7-135		"	"	"	"	S-GC

SunStar Laboratories, Inc.

The results in this report apply to the samples analyzed in accordance with the chain of custody document. This analytical report must be reproduced in its entirety.



Wendy Hsiao, Project Manager

PSI -- Oakland 4703 Tidewater Ave Ste B Oakland CA, 94601	Project: ECHOJ Project Number: 575-443 Project Manager: Brand Burfield	Reported: 10/25/12 14:27
---	--	-----------------------------

Extractable Petroleum Hydrocarbons by 8015C - Quality Control
SunStar Laboratories, Inc.

Analyte	Result	Reporting Limit	Units	Spike Level	Source Result	%REC	%REC Limits	RPD	RPD Limit	Notes
---------	--------	-----------------	-------	-------------	---------------	------	-------------	-----	-----------	-------

Batch 2102216 - EPA 3550B GC

Blank (2102216-BLK1)

Prepared: 10/22/12 Analyzed: 10/24/12

C13-C28 (DRO)	ND	10	mg/kg							
C29-C40 (MORO)	ND	10	"							

Surrogate: <i>p</i> -Terphenyl	79.5		"	100		79.5	65-135			
--------------------------------	------	--	---	-----	--	------	--------	--	--	--

LCS (2102216-BS1)

Prepared: 10/22/12 Analyzed: 10/24/12

C13-C28 (DRO)	470	10	mg/kg	500		94.3	75-125			
Surrogate: <i>p</i> -Terphenyl	93.2		"	100		93.2	65-135			

Matrix Spike (2102216-MS1)

Source: T121885-01

Prepared: 10/22/12 Analyzed: 10/24/12

C13-C28 (DRO)	480	10	mg/kg	500	4.7	95.3	75-125			
Surrogate: <i>p</i> -Terphenyl	89.8		"	100		89.8	65-135			

Matrix Spike Dup (2102216-MSD1)

Source: T121885-01

Prepared: 10/22/12 Analyzed: 10/24/12

C13-C28 (DRO)	460	10	mg/kg	500	4.7	90.8	75-125	4.81	20	
Surrogate: <i>p</i> -Terphenyl	90.6		"	100		90.6	65-135			

SunStar Laboratories, Inc.

The results in this report apply to the samples analyzed in accordance with the chain of custody document. This analytical report must be reproduced in its entirety.



Wendy Hsiao, Project Manager

PSI -- Oakland
4703 Tidewater Ave Ste B
Oakland CA, 94601

Project: ECHOJ
Project Number: 575-443
Project Manager: Brand Burfield

Reported:
10/25/12 14:27

Volatile Organic Compounds by EPA Method 8260B - Quality Control

SunStar Laboratories, Inc.

Analyte	Result	Reporting Limit	Units	Spike Level	Source Result	%REC	%REC Limits	RPD	RPD Limit	Notes
---------	--------	-----------------	-------	-------------	---------------	------	-------------	-----	-----------	-------

Batch 2102330 - EPA 5030 GCMS

Blank (2102330-BLK1)

Prepared: 10/23/12 Analyzed: 10/24/12

1,2-Dibromoethane (EDB)	ND	5.0	ug/kg							
1,2-Dichloroethane	ND	5.0	"							
Benzene	ND	5.0	"							
Toluene	ND	5.0	"							
Ethylbenzene	ND	5.0	"							
m,p-Xylene	ND	5.0	"							
o-Xylene	ND	5.0	"							
Tert-amyl methyl ether	ND	20	"							
Tert-butyl alcohol	ND	50	"							
Di-isopropyl ether	ND	20	"							
Ethyl tert-butyl ether	ND	20	"							
Methyl tert-butyl ether	ND	20	"							
Ethanol	ND	500	"							
Surrogate: Toluene-d8	46.8		"	40.0		117	85.5-116			S-GC
Surrogate: 4-Bromofluorobenzene	38.0		"	40.0		95.0	81.2-123			
Surrogate: Dibromofluoromethane	35.6		"	40.0		89.0	95.7-135			S-GC

LCS (2102330-BS1)

Prepared: 10/23/12 Analyzed: 10/24/12

Chlorobenzene	110	5.0	ug/kg	100		110	75-125			
1,1-Dichloroethene	124	5.0	"	100		124	75-125			
Trichloroethene	106	5.0	"	100		106	75-125			
Benzene	122	5.0	"	100		122	75-125			
Toluene	117	5.0	"	100		117	75-125			
Surrogate: Toluene-d8	44.2		"	40.0		110	85.5-116			
Surrogate: 4-Bromofluorobenzene	40.6		"	40.0		102	81.2-123			
Surrogate: Dibromofluoromethane	40.2		"	40.0		101	95.7-135			

Matrix Spike (2102330-MS1)

Source: T121885-01

Prepared: 10/23/12 Analyzed: 10/24/12

Chlorobenzene	115	5.0	ug/kg	100	ND	115	75-125			
1,1-Dichloroethene	119	5.0	"	100	ND	119	75-125			
Trichloroethene	105	5.0	"	100	ND	105	75-125			
Benzene	124	5.0	"	100	ND	124	75-125			
Toluene	116	5.0	"	100	ND	116	75-125			
Surrogate: Toluene-d8	43.8		"	40.0		110	85.5-116			
Surrogate: 4-Bromofluorobenzene	41.6		"	40.0		104	81.2-123			
Surrogate: Dibromofluoromethane	40.3		"	40.0		101	95.7-135			

SunStar Laboratories, Inc.

The results in this report apply to the samples analyzed in accordance with the chain of custody document. This analytical report must be reproduced in its entirety.



Wendy Hsiao, Project Manager

PSI -- Oakland
4703 Tidewater Ave Ste B
Oakland CA, 94601

Project: ECHOJ
Project Number: 575-443
Project Manager: Brand Burfield

Reported:
10/25/12 14:27

Volatile Organic Compounds by EPA Method 8260B - Quality Control

SunStar Laboratories, Inc.

Analyte	Result	Reporting Limit	Units	Spike Level	Source Result	%REC	%REC Limits	RPD	RPD Limit	Notes
---------	--------	-----------------	-------	-------------	---------------	------	-------------	-----	-----------	-------

Batch 2102330 - EPA 5030 GCMS

Matrix Spike Dup (2102330-MSD1)	Source: T121885-01			Prepared: 10/23/12	Analyzed: 10/24/12				
Chlorobenzene	111	5.0	ug/kg	100	ND	111	75-125	3.28	20
1,1-Dichloroethene	118	5.0	"	100	ND	118	75-125	0.465	20
Trichloroethene	102	5.0	"	100	ND	102	75-125	3.39	20
Benzene	120	5.0	"	100	ND	120	75-125	2.79	20
Toluene	116	5.0	"	100	ND	116	75-125	0.345	20
Surrogate: Toluene-d8	44.2		"	40.0		110	85.5-116		
Surrogate: 4-Bromofluorobenzene	41.0		"	40.0		103	81.2-123		
Surrogate: Dibromofluoromethane	40.0		"	40.0		100	95.7-135		

SunStar Laboratories, Inc.

The results in this report apply to the samples analyzed in accordance with the chain of custody document. This analytical report must be reproduced in its entirety.



Wendy Hsiao, Project Manager

PSI -- Oakland

Project: ECHOJ

4703 Tidewater Ave Ste B

Project Number: 575-443

Oakland CA, 94601

Project Manager: Brand Burfield

Reported:

10/25/12 14:27

Notes and Definitions

S-GC Surrogate recovery outside of established control limits. The data was accepted based on valid recovery of the remaining surrogate(s).

DET Analyte DETECTED

ND Analyte NOT DETECTED at or above the reporting limit

NR Not Reported

dry Sample results reported on a dry weight basis

RPD Relative Percent Difference

SunStar Laboratories, Inc.

The results in this report apply to the samples analyzed in accordance with the chain of custody document. This analytical report must be reproduced in its entirety.



Wendy Hsiao, Project Manager

SunStar Laboratories, Inc.
 25712 Commercentre Dr
 Lake Forest, CA 92630
 949-297-5020

Chain of Custody Record

Client: PSI
 Address: 4703 TIDEWATER AVE STE B, OAKLAND, CA 94601
 Phone: 510 434 9200 Fax: 510 434 7676
 Project Manager: BRAND BURFIED

Date: 10/19/12 Page: 1 Of 1
 Project Name: ECHO 5
 Collector: B. BURFIED Client Project #: 579-443
 Batch #: T121885 EDF #: N/A

Sample ID	Date Sampled	Time	Sample Type	Container Type	8260	8260 + OXY	8260 BTEX-OXY only *	8270	8021 BTEX	8015M (gasoline)	8015M (diesel + heavy oil)	8015M Ext./Carbon Chain	6010/7000 Title 22 Metals	Laboratory ID #	Comments/Preservative	Total # of containers	
TP-NORTH WALL-12'	10/19/12	16:00	90SL	TUBE										01			
TP-WEST WALL-11'	"	16:15	71	11										02			

Relinquished by: (signature) <u>[Signature]</u>		Date / Time <u>10/19/12 18:00</u>		Received by: (signature) <u>[Signature]</u>		Date / Time <u>10/20/12 9:55</u>		Total # of containers		Chain of Custody seals <u>Y/N/NA</u>		Seals intact? <u>Y/N/NA</u>		Received good condition/cold <u>5.7</u>		Notes * <u>OK TO INCLUDE; EDB, EDC, ETOH, MTBE, TAME, ETBC, DPC, TBA</u>	
Relinquished by: (signature) <u>GSO</u>		Date / Time <u>10/20/12 9:55</u>		Received by: (signature) <u>[Signature]</u>		Date / Time <u>10/20/12 9:55</u>		Turn around time: <u>STD</u>									
Relinquished by: (signature) _____		Date / Time _____		Received by: (signature) _____		Date / Time _____											

Sample disposal Instructions: Disposal @ \$2.00 each _____ Return to client _____ Pickup _____

COC112271



25712 Commercentre Drive
Lake Forest, California 92630
949.297.5020 Phone
949.297.5027 Fax

05 November 2012

Brand Burfield
PSI -- Oakland
4703 Tidewater Ave Ste B
Oakland, CA 94601
RE: ECHOJ

Enclosed are the results of analyses for samples received by the laboratory on 10/30/12 10:30. If you have any questions concerning this report, please feel free to contact me.

Sincerely,

Wendy Hsiao
Project Manager



25712 Commercentre Drive
Lake Forest, California 92630
949.297.5020 Phone
949.297.5027 Fax

PSI -- Oakland
4703 Tidewater Ave Ste B
Oakland CA, 94601

Project: ECHOJ
Project Number: 575-443
Project Manager: Brand Burfield

Reported:
11/05/12 14:08

ANALYTICAL REPORT FOR SAMPLES

Sample ID	Laboratory ID	Matrix	Date Sampled	Date Received
PIPE RUN-6'	T121966-01	Soil	10/29/12 11:50	10/30/12 10:30

SunStar Laboratories, Inc.

The results in this report apply to the samples analyzed in accordance with the chain of custody document. This analytical report must be reproduced in its entirety.

Wendy Hsiao, Project Manager

PSI -- Oakland
4703 Tidewater Ave Ste B
Oakland CA, 94601

Project: ECHOJ
Project Number: 575-443
Project Manager: Brand Burfield

Reported:
11/05/12 14:08

**PIPE RUN-6'
T121966-01 (Soil)**

Analyte	Result	Reporting Limit	Units	Dilution	Batch	Prepared	Analyzed	Method	Notes
---------	--------	-----------------	-------	----------	-------	----------	----------	--------	-------

SunStar Laboratories, Inc.

Extractable Petroleum Hydrocarbons by 8015C

C13-C28 (DRO)	500	10	mg/kg	1	2103029	10/30/12	11/02/12	EPA 8015C	
C29-C40 (MORO)	2800	10	"	"	"	"	"	"	
<i>Surrogate: p-Terphenyl</i>		100 %	65-135		"	"	"	"	

Volatile Organic Compounds by EPA Method 8260B

1,2-Dibromoethane (EDB)	ND	5.0	ug/kg	1	2103023	10/30/12	10/31/12	EPA 8260B	
1,2-Dichloroethane	ND	5.0	"	"	"	"	"	"	
Benzene	ND	5.0	"	"	"	"	"	"	
Toluene	ND	5.0	"	"	"	"	"	"	
Ethylbenzene	ND	5.0	"	"	"	"	"	"	
m,p-Xylene	ND	5.0	"	"	"	"	"	"	
o-Xylene	ND	5.0	"	"	"	"	"	"	
Tert-amyl methyl ether	ND	20	"	"	"	"	"	"	
Tert-butyl alcohol	ND	50	"	"	"	"	"	"	
Di-isopropyl ether	ND	20	"	"	"	"	"	"	
Ethyl tert-butyl ether	ND	20	"	"	"	"	"	"	
Methyl tert-butyl ether	ND	20	"	"	"	"	"	"	
Ethanol	ND	500	"	"	"	"	"	"	
<i>Surrogate: Toluene-d8</i>		96.8 %	85.5-116		"	"	"	"	
<i>Surrogate: 4-Bromofluorobenzene</i>		107 %	81.2-123		"	"	"	"	
<i>Surrogate: Dibromofluoromethane</i>		157 %	95.7-135		"	"	"	"	S-GC

SunStar Laboratories, Inc.

The results in this report apply to the samples analyzed in accordance with the chain of custody document. This analytical report must be reproduced in its entirety.



Wendy Hsiao, Project Manager

PSI -- Oakland
4703 Tidewater Ave Ste B
Oakland CA, 94601

Project: ECHOJ
Project Number: 575-443
Project Manager: Brand Burfield

Reported:
11/05/12 14:08

Extractable Petroleum Hydrocarbons by 8015C - Quality Control
SunStar Laboratories, Inc.

Analyte	Result	Reporting Limit	Units	Spike Level	Source Result	%REC	%REC Limits	RPD	RPD Limit	Notes
---------	--------	-----------------	-------	-------------	---------------	------	-------------	-----	-----------	-------

Batch 2103029 - EPA 3550B GC

Blank (2103029-BLK1)

Prepared: 10/30/12 Analyzed: 11/02/12

C13-C28 (DRO)	ND	10	mg/kg							
C29-C40 (MORO)	ND	10	"							

Surrogate: *p*-Terphenyl 72.3 " 100 72.3 65-135

LCS (2103029-BS1)

Prepared: 10/30/12 Analyzed: 11/02/12

C13-C28 (DRO)	450	10	mg/kg	500		89.8	75-125			
Surrogate: <i>p</i> -Terphenyl	78.4		"	100		78.4	65-135			

Matrix Spike (2103029-MS1)

Source: T121942-01

Prepared: 10/30/12 Analyzed: 11/02/12

C13-C28 (DRO)	440	10	mg/kg	500	ND	88.9	75-125			
Surrogate: <i>p</i> -Terphenyl	84.2		"	100		84.2	65-135			

Matrix Spike Dup (2103029-MSD1)

Source: T121942-01

Prepared: 10/30/12 Analyzed: 11/02/12

C13-C28 (DRO)	430	10	mg/kg	500	ND	86.8	75-125	2.38	20	
Surrogate: <i>p</i> -Terphenyl	82.4		"	100		82.4	65-135			

SunStar Laboratories, Inc.

The results in this report apply to the samples analyzed in accordance with the chain of custody document. This analytical report must be reproduced in its entirety.



Wendy Hsiao, Project Manager

PSI -- Oakland
4703 Tidewater Ave Ste B
Oakland CA, 94601

Project: ECHOJ
Project Number: 575-443
Project Manager: Brand Burfield

Reported:
11/05/12 14:08

Volatile Organic Compounds by EPA Method 8260B - Quality Control

SunStar Laboratories, Inc.

Analyte	Result	Reporting Limit	Units	Spike Level	Source Result	%REC	%REC Limits	RPD	RPD Limit	Notes
---------	--------	-----------------	-------	-------------	---------------	------	-------------	-----	-----------	-------

Batch 2103023 - EPA 5030 GCMS

Blank (2103023-BLK1)

Prepared & Analyzed: 10/30/12

1,2-Dibromoethane (EDB)	ND	5.0	ug/kg							
1,2-Dichloroethane	ND	5.0	"							
Benzene	ND	5.0	"							
Toluene	ND	5.0	"							
Ethylbenzene	ND	5.0	"							
m,p-Xylene	ND	5.0	"							
o-Xylene	ND	5.0	"							
Tert-amyl methyl ether	ND	20	"							
Tert-butyl alcohol	ND	50	"							
Di-isopropyl ether	ND	20	"							
Ethyl tert-butyl ether	ND	20	"							
Methyl tert-butyl ether	ND	20	"							
Ethanol	ND	500	"							
Surrogate: Toluene-d8	39.8		"	40.0		99.6	85.5-116			
Surrogate: 4-Bromofluorobenzene	37.8		"	40.0		94.5	81.2-123			
Surrogate: Dibromofluoromethane	55.5		"	40.0		139	95.7-135			S-GC

LCS (2103023-BS1)

Prepared: 10/30/12 Analyzed: 10/31/12

Chlorobenzene	111	5.0	ug/kg	100		111	75-125			
1,1-Dichloroethene	111	5.0	"	100		111	75-125			
Trichloroethene	109	5.0	"	100		109	75-125			
Benzene	115	5.0	"	100		115	75-125			
Toluene	112	5.0	"	100		112	75-125			
Surrogate: Toluene-d8	35.3		"	40.0		88.2	85.5-116			
Surrogate: 4-Bromofluorobenzene	45.0		"	40.0		112	81.2-123			
Surrogate: Dibromofluoromethane	56.2		"	40.0		141	95.7-135			S-GC

Matrix Spike (2103023-MS1)

Source: T121961-01

Prepared: 10/30/12 Analyzed: 10/31/12

Chlorobenzene	103	5.0	ug/kg	100	ND	103	75-125			
1,1-Dichloroethene	103	5.0	"	100	ND	103	75-125			
Trichloroethene	99.2	5.0	"	100	ND	99.2	75-125			
Benzene	113	5.0	"	100	ND	113	75-125			
Toluene	105	5.0	"	100	ND	105	75-125			
Surrogate: Toluene-d8	34.2		"	40.0		85.4	85.5-116			S-GC
Surrogate: 4-Bromofluorobenzene	43.8		"	40.0		110	81.2-123			
Surrogate: Dibromofluoromethane	56.8		"	40.0		142	95.7-135			S-GC

SunStar Laboratories, Inc.

The results in this report apply to the samples analyzed in accordance with the chain of custody document. This analytical report must be reproduced in its entirety.



Wendy Hsiao, Project Manager

PSI -- Oakland
4703 Tidewater Ave Ste B
Oakland CA, 94601

Project: ECHOJ
Project Number: 575-443
Project Manager: Brand Burfield

Reported:
11/05/12 14:08

Volatile Organic Compounds by EPA Method 8260B - Quality Control

SunStar Laboratories, Inc.

Analyte	Result	Reporting Limit	Units	Spike Level	Source Result	%REC	%REC Limits	RPD	RPD Limit	Notes
---------	--------	-----------------	-------	-------------	---------------	------	-------------	-----	-----------	-------

Batch 2103023 - EPA 5030 GCMS

Matrix Spike Dup (2103023-MSD1)	Source: T121961-01			Prepared: 10/30/12	Analyzed: 10/31/12					
Chlorobenzene	116	5.0	ug/kg	100	ND	116	75-125	11.5	20	
1,1-Dichloroethene	116	5.0	"	100	ND	116	75-125	11.5	20	
Trichloroethene	111	5.0	"	100	ND	111	75-125	10.8	20	
Benzene	116	5.0	"	100	ND	116	75-125	2.89	20	
Toluene	119	5.0	"	100	ND	119	75-125	12.7	20	
Surrogate: Toluene-d8	36.1		"	40.0		90.2	85.5-116			
Surrogate: 4-Bromofluorobenzene	43.7		"	40.0		109	81.2-123			
Surrogate: Dibromofluoromethane	59.6		"	40.0		149	95.7-135			S-GC

SunStar Laboratories, Inc.

The results in this report apply to the samples analyzed in accordance with the chain of custody document. This analytical report must be reproduced in its entirety.



Wendy Hsiao, Project Manager

PSI -- Oakland

Project: ECHOJ

4703 Tidewater Ave Ste B

Project Number: 575-443

Oakland CA, 94601

Project Manager: Brand Burfield

Reported:

11/05/12 14:08

Notes and Definitions

- S-GC Surrogate recovery outside of established control limits. The data was accepted based on valid recovery of the remaining surrogate(s).
- DET Analyte DETECTED
- ND Analyte NOT DETECTED at or above the reporting limit
- NR Not Reported
- dry Sample results reported on a dry weight basis
- RPD Relative Percent Difference

SunStar Laboratories, Inc.

The results in this report apply to the samples analyzed in accordance with the chain of custody document. This analytical report must be reproduced in its entirety.



Wendy Hsiao, Project Manager

SunStar Laboratories, Inc.
 25712 Commercentre Dr
 Lake Forest, CA 92630
 949-297-5020

Chain of Custody Record

Client: PSI
 Address: 4703 TIDEWATER AVE STE B, OAKLAND CA 94601
 Phone: 510 434-9200 (x19) Fax: 510 434-7676
 Project Manager: BRAND BURSEED

Date: 10/29/12 Page: 1 Of 1
 Project Name: ECHOJ
 Collector: B. BURSEED Client Project #: 579-443
 Batch #: 7121966 EDF #: N/A

Sample ID	Date Sampled	Time #	Sample Type	Container Type	8260	8260 + OXY	8260 BTEX, OXY only *	8270	8021 BTEX	8015M (gasoline)	8015M (diesel) <u>MOTOR OIL</u>	8015M Ext./Carbon Chain	6010/7000 Title 22 Metals	Laboratory ID #	Comments/Preservative	Total # of containers
PIPE RUN - 6'	10/29/12	11:50	SOIL	PIPE										0		
Relinquished by: (signature) <u>[Signature]</u> Date / Time <u>10/29/12 17:30</u>					Received by: (signature) <u>C90 ADJBL #107416590</u> Date / Time <u>10/30/12 10:30</u>					Total # of containers		Notes				
Relinquished by: (signature) <u>GSO</u> Date / Time <u>10/30/12 10:30</u>					Received by: (signature) <u>[Signature]</u> Date / Time <u>10/30/12 10:30</u>					Chain of Custody seals <u>(Y) N/NA</u>		Seals intact? <u>(Y) N/NA</u>				
Relinquished by: (signature) _____ Date / Time _____					Received by: (signature) _____ Date / Time _____					Received good condition/cold <u>50</u>		Turn around time: <u>5D</u>				

Sample disposal Instructions: Disposal @ \$2.00 each _____ Return to client _____ Pickup _____

APPENDIX D
ESL LOOK UP TABLES

**Environmental Screening Levels Surfer
(Screening Levels For Specific Environmental Concerns)**

TPH (middle distillates)

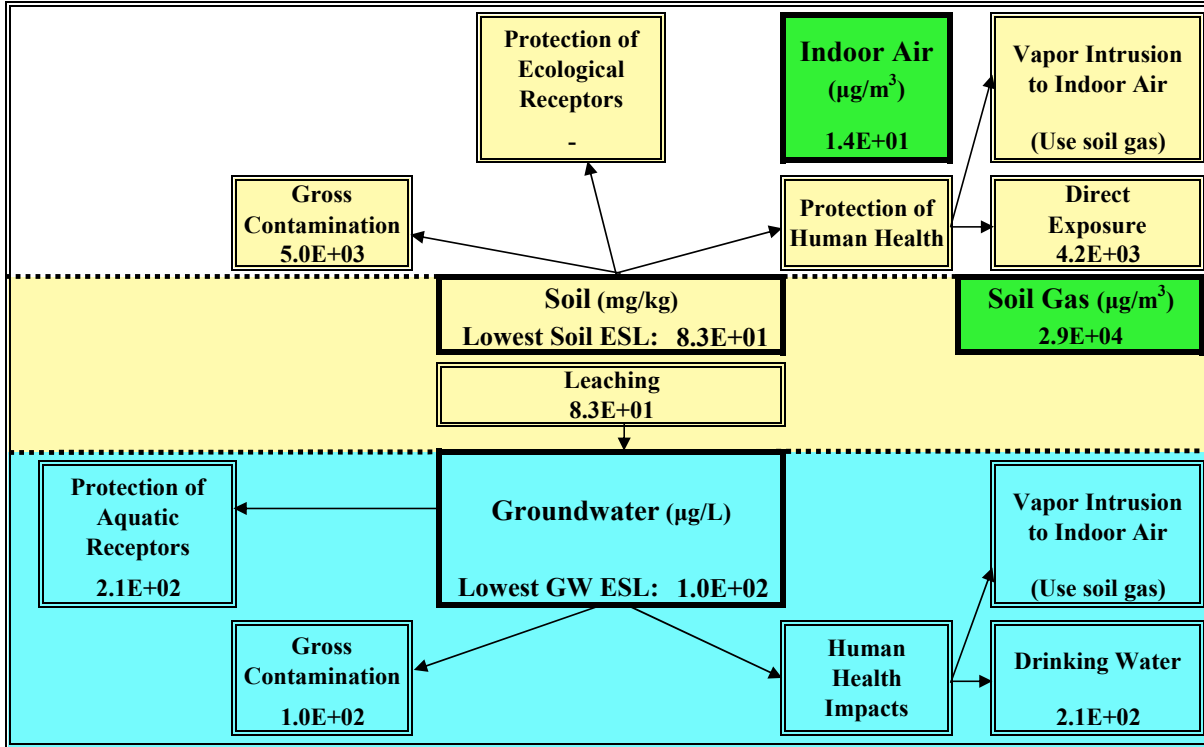

Reference:

Screening For Environmental Concerns at Sites With Contaminated Soil and Groundwater (November 2007), San Francisco Bay Regional Water Quality Control Board, California EPA, <http://www.waterboards.ca.gov/sanfranciscobay/esl.shtm>

**Environmental Screening Levels Surfer
(Screening Levels For Specific Environmental Concerns)**

TPH (residual fuels)

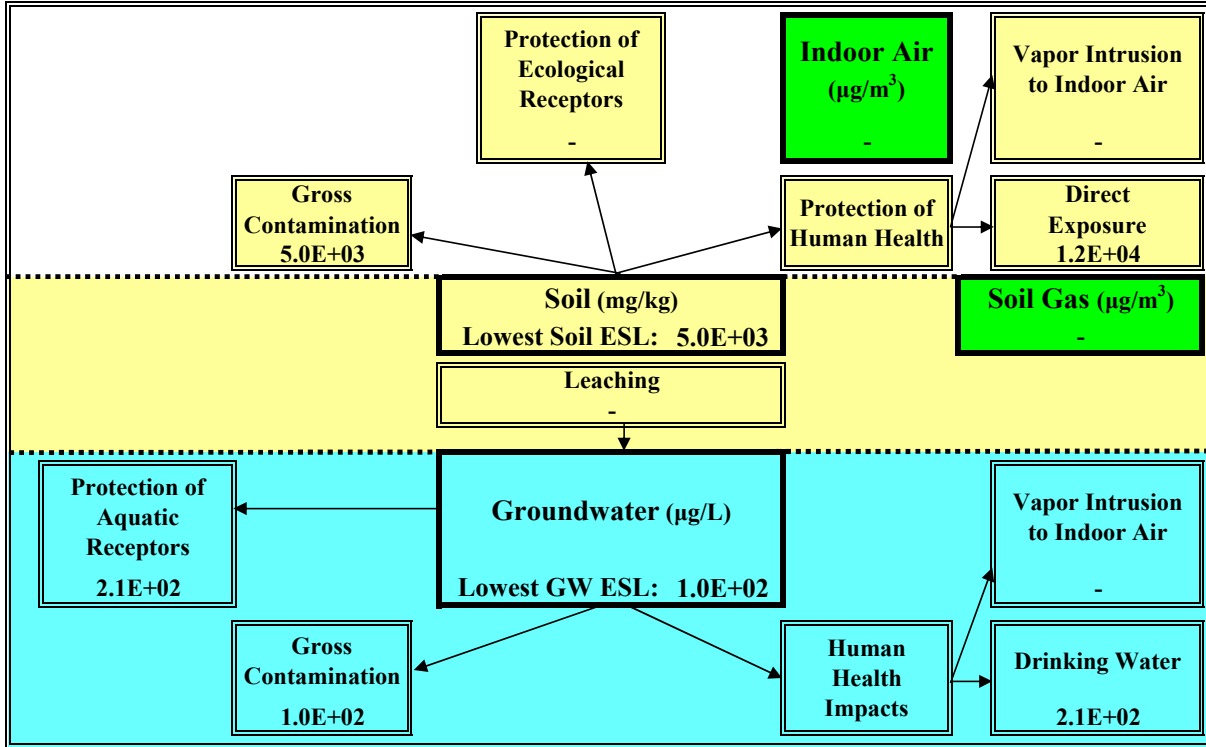

Reference:

Screening For Environmental Concerns at Sites With Contaminated Soil and Groundwater November 2007), San Francisco Bay Regional Water Quality Control Board, California EPA, <http://www.waterboards.ca.gov/sanfranciscobay/esl.shtm>